

- Building 1 Office Retail
- Building 2 Old Mill
(Need 3phase For Milling)
- Building 3 Being Removed
- Building 4 Dry Storage
(Need single phase for
garage door)
- Building 5 Will Be removed
- Building 6 Air Shed
- Building 7 Kiln
(Not in use)
- Building 8 Dry Storage
- Building 9 Old Kiln
(has been removed)
- Building 10 Boiler
(Not in use)
- Building 11 Steamer
Not in use

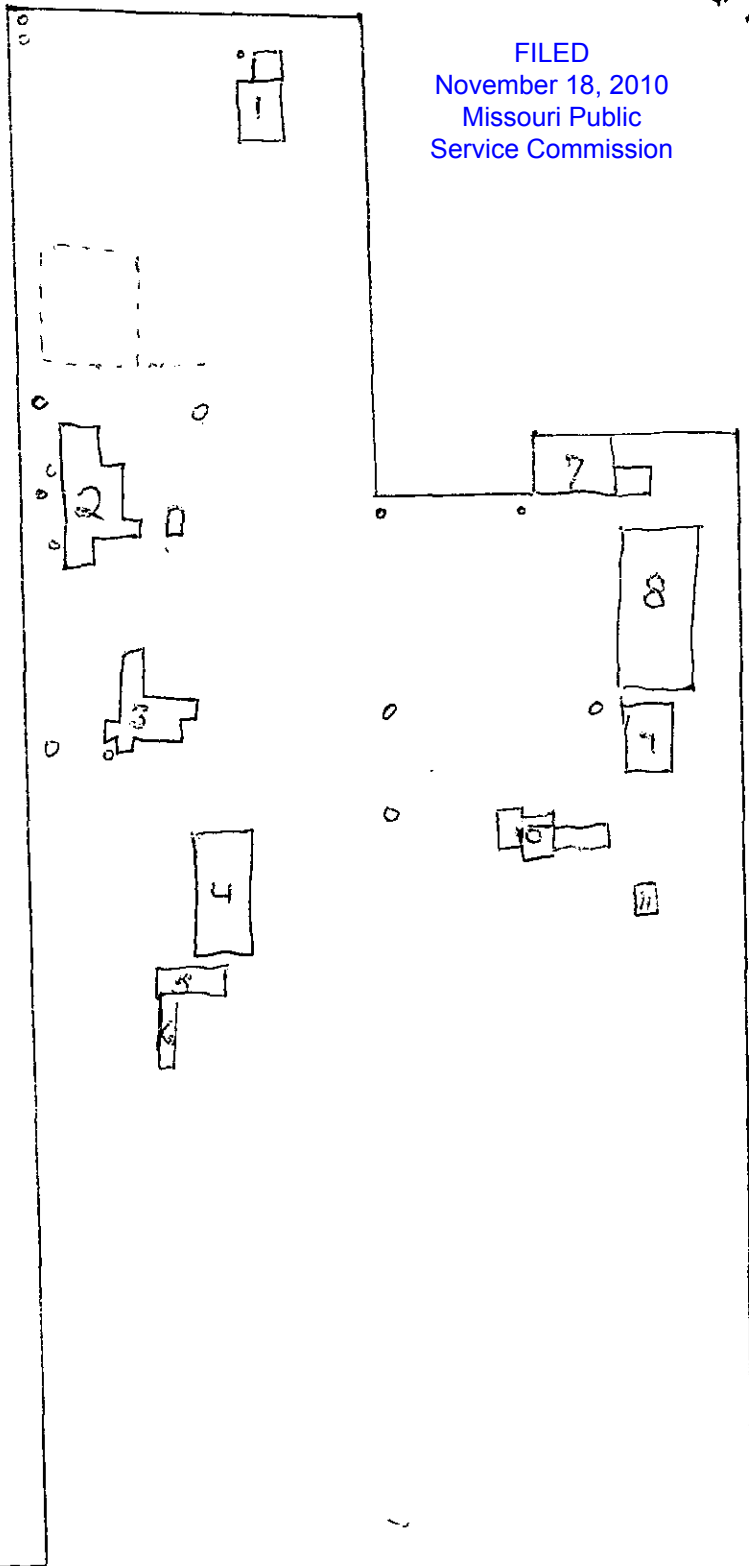

Cardwell Exhibit No. 1
Date 11/12/10 Reporter JMB
File No. EO-2011-0052