

Missouri American Water Company
 Name of Issuing Corporation

For

Missouri Service Area
 Community, Town or City

TABLE OF CONTENTS

Certificated Area Description	Sheet No.
Riverside Estates Area (Map)	CA 15.22
Riverside Estates Area (Legal Description)	CA 15.23
Stonebridge Village Area (Map)	CA 15.24
Stonebridge Village Area (Legal Description)	CA 15.25
Saddlebrooke Area (Map)	CA 15.26
Saddlebrooke Area (Legal Description)	CA 15.27 – 15.28
Tri-States Area (Map)	CA 15.29
Tri-States Area (Legal Description)	CA 15.30
Hickory Hills Service Area	
Hickory Hills Area (Map)	CA 16.1 - 16.2
Hickory Hills Area (Legal Description)	CA 16.3
Woodland Manor Service Area	
Woodland Manor Area (Map)	CA 17.1 *
Woodland Manor Area (Legal Description)	CA 17.2 *

* Indicates new rate or text
 + Indicates change

DATE OF ISSUE: June 30, 2017

DATE OF EFFECTIVE: July 30, 2017

ISSUED BY: Cheryl Norton, President
727 Craig Road, St. Louis, MO 63141

For

Missouri-American Water Company
Name of Issuing Corporation

Woodland Manor Stone County
Community, Town or City

Service Area Boundary Map

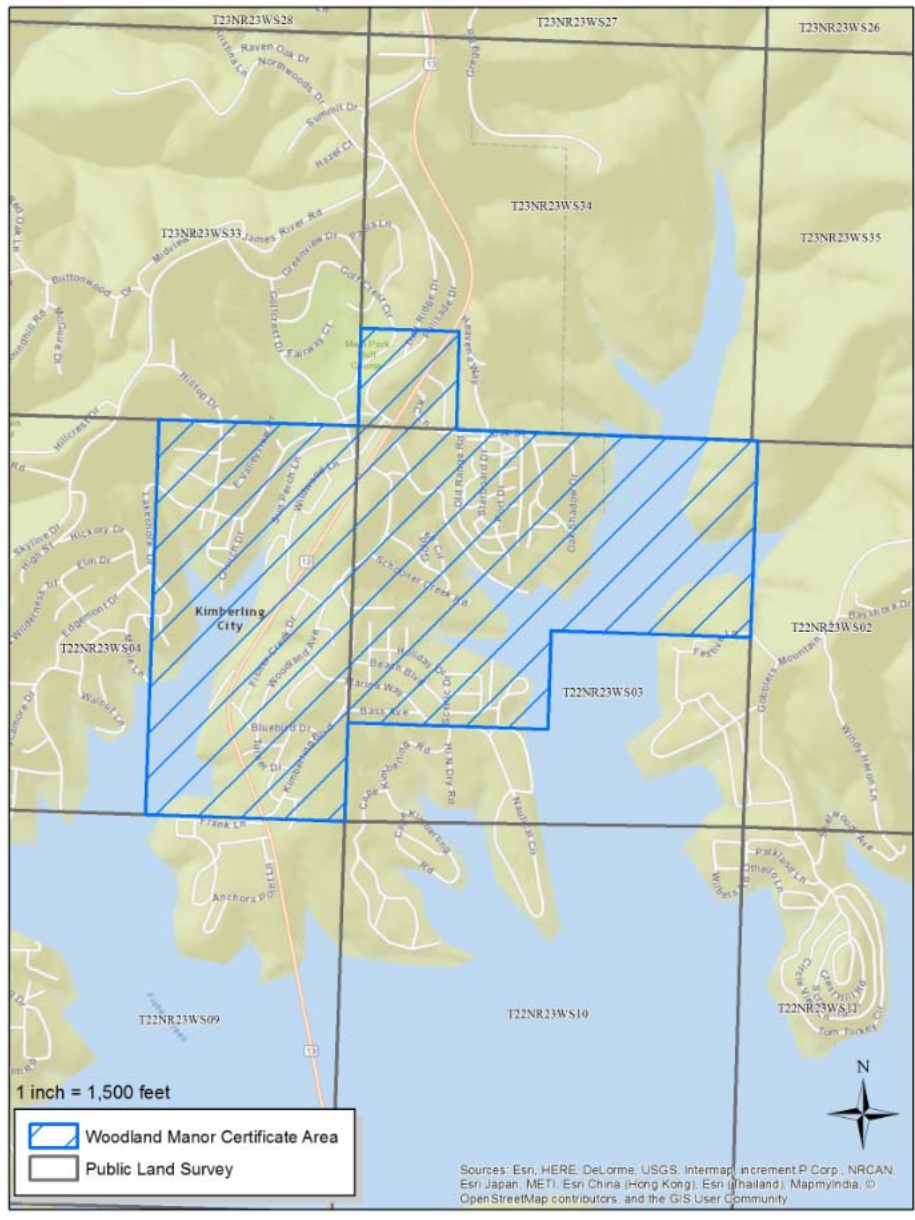

+
+
+

* Indicates new rate or text
+ Indicates change

DATE OF ISSUE: June 30, 2017

DATE OF EFFECTIVE: July 30, 2017

ISSUED BY: Cheryl Norton, President
727 Craig Road, St. Louis, MO 63141

For

Missouri-American Water Company
Name of Issuing Corporation

Woodland Manor Stone County
Community, Town or City

Legal Description of Service Area

The North 1/2 of Sec 3, T22N, R23W and the N 1/2 of the SW 1/4 of said Sec 3 which lies to the west of Schooner Creek Cove of Table Rock Lake, and lies to the east of a line 200' west of and parallel to Wildwood Lane, also known as Old MO Hwy 13.

The E 1/2 of Sec 4, T22N, R23W which lies to the east of MO Hwy 13, and the NE 1/4 of said Sec 4 which lies to the west of MO Hwy 13, and lies east of a line 200' west of and parallel to Wildwood Lane, also known as Old MO Hwy 13.

The SW 1/4 of the SW 1/4 of Sec 34, T23N, R23W which lies to the east of MO Hwy 13, and lies west of a line 200' east of and parallel to Oak Drive.

+
+
+

* Indicates new rate or text
+ Indicates change

DATE OF ISSUE: June 30, 2017

DATE OF EFFECTIVE: July 30, 2017

ISSUED BY: Cheryl Norton, President
727 Craig Road, St. Louis, MO 63141

Missouri-American Water Company
 Name of Issuing Corporation

For

Missouri Service Area
 Community, Town or City

TABLE OF CONTENTS

Rates for Service

<u>Rate</u>	<u>Description</u>		
Rate A	Residential Rates	RT 1.1	+
Rate A-1	Nonresidential Rates – Commercial, Industrial, and Other Public Authority	RT 1.2-1.12	*
Rate B	Sale of Water for Resale	RT 2.1 – 2.3	
Rate F	Private Fire Protection - Hydrant Charges	RT 3.1 – 3.8	
Rate F Cont.	Private Fire Protection - Fire Lines	RT 4.1 – 4.8	
Rate J	Rate for Manufacturers and Large Quantity Users of Water - Rates	RT 5.1 – 5.6	
	Held for Future Use	RT 6.1 – 6.2	
	Held for Future Use	RT 7	
	Billing for License, Occupations, Franchise or Other Similar Charges or Taxes	RT 8	
	Miscellaneous Charges	RT 9.1 – 9.4	
Rate I	Infrastructure System Replacement Surcharge (ISRS) – St Louis County	RT 10	
	Held for Future Use	RT 11.1 – 11.8	
	Held for Future Use	RT 12	
Rate C-1	City of St. Louis, at Howard Bend – St Louis County	RT 13	
Rate C-2	City of St. Louis, at Interconnections other than Howard Bend – St Louis County	RT 14	
	Municipal Rates and Public Service	RT 15	
	Held for Future Use	RT 16	
	Pass Through of St. Louis County Service Line Charge	RT 17	
Rate E	Rate for Public Water Supply District 2	RT 18	
Rate B-1	Public Water Supply District No. 1, No. 3, and No.10 of Jefferson County, MO	RT 19	+
Rate B-2	Held for Future Use	RT 20	+
Rate B-3	Held for Future Use	RT 21	+
	MSD Termination of service charge	RT 22	
	MSD Water Usage data	RT 23	
Rate P	Held For Future Use	RT 24	+
Rate P	Special Retail Sale Contract Rate – Premium Pork, LLC	RT 25	
Rate P	Special Sale for Resale Contract Rate – Consolidated Public Water Supply District No. C-1	RT 26	
Rate P	Special Sale for Resale Contract Rate – City of Kirkwood	RT 27	
Rate P	Special Sale for Resale Contract Rate – Chariton County Public Water Supply	RT 28	
	Low Income Rate Tariff	RT 29	
	Revenue Stabilization Mechanism (RSM)	RT 30.1 – 30.2	*

* Indicates new rate or text
 + Indicates change

DATE OF ISSUE: June 30, 2017

DATE OF EFFECTIVE: July 30, 2017

ISSUED BY: Cheryl Norton, President
727 Craig Road, St. Louis, MO 63141

For

Missouri-American Water Company
 Name of Issuing Corporation

Missouri Service Area
 Community, Town or City

<u>RATE A</u>			
<u>RESIDENTIAL WATER SERVICE +</u>			
<p>AVAILABILITY – This rate is available to all residential (“domestic”) customers.</p>			+
<p><u>MINIMUM CUSTOMER CHARGE</u> - The minimum charge for water service available through the facilities of the Company for the billing period and for the meter size furnished the customer is:</p>			
<u>Meter Size</u>	<u>(AM) Monthly Billing</u>	<u>(AQ) Quarterly Billing</u>	
5/8"	\$10.00	\$30.00	+
3/4"	\$12.25	\$36.75	+
1"	\$16.58	\$49.74	+
1-1/2"	\$27.42	\$82.26	+
2"	\$40.43	\$121.29	+
3"	\$71.10	\$213.30	+
4"	\$114.11	\$342.33	+
6"	\$222.47	\$667.41	+
8"	\$379.54	\$1,138.62	+
10"	\$637.71	\$1,913.13	+
12"	\$765.25	\$2,295.75	+
<p><u>COMMODITY CHARGE</u> - In addition to the Minimum Customer Charge, for all water used as registered by the meter the Commodity Charge is \$.62953 per 100 gallons or \$6.2953 per 1,000 gallons.</p>			+
<p><u>FLAT RATE</u> - Customers who do not have water meters will be billed a monthly charge of \$48.40.</p>			+
<p><u>PAYMENT TERMS</u> - All bills for service under this schedule will be rendered in arrears either on a monthly or quarterly basis. The due date on the tariff shall be ten (10) days after the "date of rendition" of the bill to the customer. The customer's bill will be due and payable after this due date. The delinquent date printed on the bill will not be less than twenty-one (21) days after the date of the postmark of the bill. Any accounts remaining unpaid at the expiration of twenty-one (21) days shall be considered delinquent and the Company may take such action as specified in its filed rules and regulations.</p>			
<p>These rates do not include any municipal, state or federal taxes computed on either billing or consumption basis. Any such taxes applicable shall be added as separate items in rendering each bill.</p>			+

* Indicates new rate or text

+ Indicates change

DATE OF ISSUE: June 30, 2017

DATE OF EFFECTIVE: July 30, 2017

ISSUED BY: Cheryl Norton, President
727 Craig Road, St. Louis, MO 63141

Missouri-American Water Company
 Name of Issuing Corporation

For

Missouri Service Area
 Community, Town or City

RATE A - 1
NONRESIDENTIAL WATER SERVICE +

AVAILABILITY – This rate is available to commercial, industrial, and other public authority customers.

MINIMUM CUSTOMER CHARGE - The minimum charge for water service available through the facilities of the Company for the billing period and for the meter size furnished the customer is:

<u>Meter Size</u>	<u>(AM) Monthly Billing</u>	<u>(AQ) Quarterly Billing</u>	
5/8"	\$10.00	\$30.00	+
3/4"	\$12.25	\$36.75	+
1"	\$16.58	\$49.74	+
1-1/2"	\$27.42	\$82.26	+
2"	\$40.43	\$121.29	+
3"	\$71.10	\$213.30	+
4"	\$114.11	\$342.33	+
6"	\$222.47	\$667.41	+
8"	\$379.54	\$1,138.62	+
10"	\$637.71	\$1,913.13	+
12"	\$765.25	\$2,295.75	+

COMMODITY CHARGE - In addition to the Minimum Customer Charge, for all water used as registered by the meter the Commodity Charge is 0.585000 per 100 gallons or \$5.85000 per 1,000 gallons. +

PAYMENT TERMS - All bills for service under this schedule will be rendered in arrears on a monthly or quarterly basis. The due date on the tariff shall be ten (10) days after the "date of rendition" of the bill to the customer. The customer's bill will be due and payable after this due date. The delinquent date printed on the bill will not be less than twenty-one (21) days after the date of the postmark of the bill. Any accounts remaining unpaid at the expiration of twenty-one (21) days shall be considered delinquent and the Company may take such action as specified in its filed rules and regulations. +

These rates do not include any municipal, state or federal taxes computed on either billing or consumption basis. Any such taxes applicable shall be added as separate items in rendering each bill.

* Indicates new rate or text

+ Indicates change

DATE OF ISSUE: June 30, 2017

DATE OF EFFECTIVE: July 30, 2017

ISSUED BY: Cheryl Norton, President
727 Craig Road, St. Louis, MO 63141

For

Missouri-American Water Company
Name of Issuing Corporation

Missouri Service Area
Community, Town or City

HELD FOR FUTURE USE	+
	+
	+
	+
	+
	+
	+
	+
	+
	+
	+
	+
	+
	+
	+
	+
	+
	+
	+
	+
	+
	+
	+
	+
	+
	+
	+

* Indicates new rate or text
+ Indicates change

DATE OF ISSUE: June 30, 2017

DATE OF EFFECTIVE: July 30, 2017

ISSUED BY: Cheryl Norton, President
727 Craig Road, St. Louis, MO 63141

Missouri-American Water Company
Name of Issuing Corporation

For

Missouri Service Area
Community, Town or City

CLASSIFICATION OF SERVICE GENERAL WATER SERVICE	
HELD FOR FUTURE USE	+
	+
	+
	+
	+
	+
	+
	+
	+
	+
	+
	+

* Indicates new rate or text
+ Indicates change

DATE OF ISSUE: June 30, 2017

DATE OF EFFECTIVE: July 30, 2017

ISSUED BY: Cheryl Norton, President
727 Craig Road, St. Louis, MO 63141

Missouri-American Water Company
Name of Issuing Corporation

For

Missouri Service Area
Community, Town or City

CLASSIFICATION OF SERVICE	
GENERAL WATER SERVICE	
HELD FOR FUTURE USE	+ + + + + + + + + + + +

* Indicates new rate or text
+ Indicates change

DATE OF ISSUE: June 30, 2017

DATE OF EFFECTIVE: July 30, 2017

ISSUED BY: Cheryl Norton, President
727 Craig Road, St. Louis, MO 63141

For

St Louis Metro, Mexico, Jefferson City, Lake
 Carmel, Hickory Hills, Anna Meadows, and
 Redfield Service Areas

Missouri-American Water Company

Name of Issuing Corporation

Community, Town or City

RATE B		
SALE OF WATER FOR RESALE		
AVAILABILITY - This rate is available for supply of water for resale.		
<u>RATE COMPONENTS:</u>		
<u>MINIMUM CUSTOMER CHARGE</u> – The minimum charge for water service available through the facilities of The Company for the billing period and for the meter size furnished the customer is:		
<u>Meter Size</u>	<u>Monthly Billing</u>	+
5/8"	\$10.00	
3/4"	\$12.25	
1"	\$16.58	
1 1/2"	\$27.42	+
2"	\$40.43	+
3"	\$71.10	+
4"	\$114.11	+
6"	\$222.47	+
8"	\$379.54	+
10"	\$637.71	+
12"	\$765.25	+
<u>COMMODITY CHARGE:</u> - In addition to the Minimum Customer Charge, for all water used as registered by the meter the Commodity Charge is: \$2.3350 per thousand gallons or \$0.23350 per 100 gallons.		
PAYMENT TERMS - Bills are net, and are due and payable within twenty-one (21) days after date of bill.		
RULES AND REGULATIONS - The General Rules and Regulations set forth in this tariff shall govern the supply of service under this rate.		
Exclusive of every tax or payment imposed upon the Company by any political subdivision of the State of Missouri, for the right to do business in such political subdivision. See P.S.C. MO No. 13 RT 8.		

* Indicates new rate or text
 + Indicates change

DATE OF ISSUE: June 30, 2017

DATE OF EFFECTIVE: July 30, 2017

ISSUED BY: Cheryl Norton, President
727 Craig Road, St. Louis, MO 63141

Missouri-American Water Company

For

All Missouri Service Areas except Service Areas on Sheet RT 2.1

Name of Issuing Corporation

Community, Town or City

RATE B
SALE OF WATER FOR RESALE

AVAILABILITY - This rate is available for supply of water for resale.

RATE COMPONENTS:

MINIMUM CUSTOMER CHARGE – The minimum charge for water service available through the facilities of the

Company for the billing period and for the meter size furnished the customer is:

<u>Meter Size</u>	<u>Monthly Billing</u>
5/8"	\$10.00
3/4"	\$12.25
1"	\$16.58
1 1/2"	\$27.42
2"	\$40.43
3"	\$71.10
4"	\$114.11
6"	\$222.47
8"	\$379.54
10"	\$637.71
12"	\$765.25

+
+
+
+
+
+
+
+
+
+

COMMODITY CHARGE: - In addition to the Minimum Customer Charge, for all water used as registered by the meter the Commodity Charge is: \$3.2000 per thousand gallons or \$0.32000 per 100 gallons.

+

PAYMENT TERMS - Bills are net, and are due and payable within twenty-one (21) days after date of bill.

RULES AND REGULATIONS - The General Rules and Regulations set forth in this tariff shall govern the supply of service under this rate.

Exclusive of every tax or payment imposed upon the Company by any political subdivision of the State of Missouri, for the right to do business in such political subdivision. See P.S.C. MO No. 13 RT 8.

* Indicates new rate or text
+ Indicates change

DATE OF ISSUE: June 30, 2017

DATE OF EFFECTIVE: July 30, 2017

ISSUED BY: Cheryl Norton, President
727 Craig Road, St. Louis, MO 63141

Missouri-American Water Company
Name of Issuing Corporation

For

Missouri Service Area
Community, Town or City

HELD FOR FUTURE USE	+
	+
	+
	+
	+
	+
	+
	+
	+
	+
	+
	+
	+
	+
	+
	+
	+
	+
	+
	+
	+
	+
	+
	+
	+

* Indicates new rate or text
+ Indicates change

DATE OF ISSUE: June 30, 2017

DATE OF EFFECTIVE: July 30, 2017

ISSUED BY: Cheryl Norton, President
727 Craig Road, St. Louis, MO 63141

Missouri-American Water Company
 Name of Issuing Corporation

For

Missouri Service Area
 Community, Town or City

RATE F PRIVATE FIRE PROTECTION			
HYDRANTS			
<u>Availability</u>			
Available for hydrants that are placed on private property and attached to public mains.			
Rate			
Charge	Monthly	Annual	
Per private hydrant(1)	\$80.40	\$964.80	+
Billing			
Bills for water service will be distributed on a monthly or annual basis. The due date on the bill shall be twenty-one (21) days after the "date of rendition" of the bill to the customer. The customer's bill will be due and payable by this due date.			
(1) Exclusive of every tax or payment imposed upon the Company by any political subdivision of the State of Missouri, for the right to do business in such political subdivision. See P.S.C. MO No. 13 Sheet No. RT 8.			

* Indicates new rate or text
 + Indicates change

DATE OF ISSUE: June 30, 2017

DATE OF EFFECTIVE: July 30, 2017

ISSUED BY: Cheryl Norton, President
727 Craig Road, St. Louis, MO 63141

Missouri-American Water Company
Name of Issuing Corporation

For

Missouri Service Area
Community, Town or City

HELD FOR FUTURE USE	+
	+
	+
	+
	+
	+
	+
	+
	+
	+
	+
	+
	+
	+
	+
	+
	+
	+
	+
	+
	+
	+

* Indicates new rate or text
+ Indicates change

DATE OF ISSUE: June 30, 2017

DATE OF EFFECTIVE: July 30, 2017

ISSUED BY: Cheryl Norton, President
727 Craig Road, St. Louis, MO 63141

Missouri-American Water Company
Name of Issuing Corporation

For

Missouri Service Area
Community, Town or City

HELD FOR FUTURE USE	+
	+
	+
	+
	+
	+
	+
	+
	+
	+

* Indicates new rate or text
+ Indicates change

DATE OF June 30, 2017
ISSUE:

DATE OF EFFECTIVE: July 30, 2017

ISSUED BY: Cheryl Norton, President
727 Craig Road, St. Louis, MO 63141

Missouri-American Water Company
Name of Issuing Corporation

For

Missouri Service Area
Community, Town or City

**RATE F
PRIVATE FIRE PROTECTION**

FIRE LINES

Availability

For fire protection systems installed on private property. Expense of the installations will be borne by the customer. If, in the opinion of the Company, a detector check meter is needed, the cost shall be a part of the installation. If a detector check meter has to be added to an existing service not having the check meter, the cost will be paid by the customer.

Rate

Monthly Charge

<u>Fire outlet or tap connection size</u>	<u>Monthly Charge</u>	<u>Annual Charge</u>	
2" or less	\$8.98	\$107.76	+
3"	\$28.98	\$347.76	+
4"	\$35.71	\$428.52	+
6"	\$80.40	\$964.80	+
8"	\$143.05	\$1,716.60	+
10"	\$223.45	\$2,681.40	+
12"	\$321.80	\$3,861.60	+
20"	\$728.14	\$8,737.68	+

Exclusive of every tax or payment imposed upon the Company by any political subdivision of the State of Missouri, for the right to do business in such political subdivision. See P.S.C. MO No. 13 RT 8.

Billing

Bills for water service will be distributed on a monthly or annual basis. The due date on the tariff shall be twenty-one (21) days after the "date of rendition" of the bill to the customer.

* Indicates new rate or text
+ Indicates change

DATE OF ISSUE: June 30, 2017

DATE OF EFFECTIVE: July 30, 2017

ISSUED BY: Cheryl Norton, President
727 Craig Road, St. Louis, MO 63141

Missouri-American Water
Company
Name of Issuing Corporation

For

Missouri Service Area
Community, Town or City

HELD FOR FUTURE USE	+
	+
	+
	+
	+
	+
	+
	+
	+
	+
	+
	+
	+
	+
	+
	+
	+
	+
	+

* Indicates new rate or text
+ Indicates change

DATE OF ISSUE: June 30, 2017

DATE OF EFFECTIVE: July 30, 2017

ISSUED BY: Cheryl Norton, President
727 Craig Road, St. Louis, MO 63141

Missouri-American Water
Company
Name of Issuing Corporation

For

Missouri Service Area
Community, Town or City

HELD FOR FUTURE USE	+
	+
	+
	+
	+
	+
	+
	+
	+
	+
	+
	+
	+
	+
	+
	+
	+
	+
	+
	+
	+
	+

* Indicates new rate or text
+ Indicates change

DATE OF ISSUE: June 30, 2017

DATE OF EFFECTIVE: July 30, 2017

ISSUED BY: Cheryl Norton, President
727 Craig Road, St. Louis, MO 63141

Missouri-American Water Company

For

St Louis Metro, Mexico, Jefferson City, Lake Carmel, Hickory Hills, Anna Meadows, and Redfield Service Areas

Name of Issuing Corporation

Community, Town or City

RATE J
RATE FOR MANUFACTURERS AND LARGE QUANTITY USERS OF WATER

AVAILABILITY - This rate is available to Manufacturers and Large Quantity Users of Water whose use is fairly constant throughout the year and is not less than 450,000 gallons per month.

This rate is not available to users of water in residences, apartment dwellings or for irrigation, construction purposes, or sale for resale customers.

RATE COMPONENTS:

METER CHARGE (1) - The charge for each month shall be based on the meter size or multiple meter sizes if more than one meter is installed as follows:

<u>Meter Size</u>	<u>Monthly Billing</u>
5/8"	\$10.00
3/4"	\$12.25
1"	\$16.58
1-1/2"	\$27.42
2"	\$40.43
3"	\$71.10
4"	\$114.11
6"	\$222.47
8"	\$379.54
10"	\$637.71
12"	\$765.25

COMMODITY RATE (1) - In addition to the Meter Charge, for all water used as registered by the meter the Commodity Charge is \$2.2100 per 1,000 gallons or \$0.22100 per 100 gallons. See P.S.C. MO No. 13 Original Sheet RT 8.

MINIMUM USAGE CHARGE (1) - in addition to the Meter Charge, a monthly minimum usage charge for any month shall be equal to the commodity rate, times the greater of 1) 60% of the maximum usage during any of the months of June, July, August, or September in the twelve (12) month period preceding the month for which the bill is to be rendered or 2) 450,000 gallons or 3) actual usage as registered by the meter.

(1) Exclusive of every tax or payment imposed upon the Company by any political subdivision of the State of Missouri, for the right to do business in such political subdivision.

* Indicates new rate or text
 + Indicates change

DATE OF ISSUE: June 30, 2017

DATE OF EFFECTIVE: July 30, 2017

ISSUED BY: Cheryl Norton, President
727 Craig Road, St. Louis, MO 63141

Missouri-American Water Company

For

St Louis Metro, Mexico, Jefferson City, Lake Carmel, Hickory Hills, Anna Meadows, and Redfield Service Areas

Name of Issuing Corporation

Community, Town or City

Rate J
RATE FOR MANUFACTURERS AND LARGE QUANTITY USERS OF WATER (Continued)

PRO-RATA ADJUSTMENT OF MONTHLY MINIMUM CHARGE – If the customer is forced to close operations of its works for a period of 10 days or more on account of accidents, fires, damage to works, strikes of its own employees, act of God, Governmental regulations or other physical cause not reasonably within its control, and customer gives Water Company written notice not later than forty days after such occurrence the customer will be entitled to pro rata reduction in the monthly minimum charge which is based on 60% of the maximum usage during the previous months of June, July, August, or September for the period during which the customer is unable to use full water service for such cause.

DURATION OF CLASSIFICATION

A Rate J customer whose usage is less than 450,000 gallons per month more than two times during a twelve (12) month period will no longer meet the eligibility requirements of this classification.

Customers who no longer meet the eligibility requirements of this classification, or elect to leave this classification, will be reclassified to Tariff Rate A 1, and must remain in the Rate A 1 classification for a minimum of twelve (12) months and meet the monthly minimum usage requirements again before being classified under the Tariff Rate J. Customers electing to return to Tariff Rate J, are required to remain in this classification for a period of a minimum of twelve (12) months.

PAYMENT TERMS – Bills are net, and are due and payable within twenty-one (21) days after date of bill.

RULES AND REGULATIONS – The General Rules and Regulations set forth in this tariff shall govern the supply of service under this rate.

+
+

+
+
+
+

* Indicates new rate or text
+ Indicates change

DATE OF ISSUE: June 30, 2017

DATE OF EFFECTIVE: July 30, 2017

ISSUED BY: Cheryl Norton, President
727 Craig Road, St. Louis, MO 63141

Missouri-American Water Company

For

All Missouri Service Areas except Service Areas on Sheet RT 5.1

Name of Issuing Corporation

Community, Town or City

RATE J
RATE FOR MANUFACTURERS AND LARGE QUANTITY USERS OF WATER

AVAILABILITY - This rate is available to Manufacturers and Large Quantity Users of Water whose use is fairly constant throughout the year and is not less than 450,000 gallons per month.

This rate is not available to users of water in residences, apartment dwellings or for irrigation, construction purposes, or sale for resale customers.

RATE COMPONENTS:

METER CHARGE (1) - The charge for each month shall be based on the meter size or multiple meter sizes if more than one meter is installed as follows:

<u>Meter Size</u>	<u>Monthly Billing</u>
5/8"	\$10.00
3/4"	\$12.25
1"	\$16.58
1-1/2"	\$27.42
2"	\$40.43
3"	\$71.10
4"	\$114.11
6"	\$222.47
8"	\$379.54
10"	\$637.71
12"	\$765.25

COMMODITY RATE (1) - In addition to the Meter Charge, for all water used as registered by the meter the Commodity Charge is \$3.0316 per 1,000 gallons or \$0.30316 per 100 gallons. See P.S.C. MO No. 13 Original Sheet RT 8.

MINIMUM USAGE CHARGE (1) - in addition to the Meter Charge, a monthly minimum usage charge for any month shall be equal to the commodity rate, times the greater of 1) 60% of the maximum usage during any of the months of June, July, August, or September in the twelve (12) month period preceding the month for which the bill is to be rendered or 2) 450,000 gallons or 3) actual usage as registered by the meter.

(1) Exclusive of every tax or payment imposed upon the Company by any political subdivision of the State of Missouri, for the right to do business in such political subdivision.

*

+

+

+

+

+

+

+

+

+

+

+

+

+

* Indicates new rate or text
 + Indicates change

DATE OF ISSUE: June 30, 2017

DATE OF EFFECTIVE: July 30, 2017

ISSUED BY: Cheryl Norton, President
727 Craig Road, St. Louis, MO 63141

Missouri-American Water Company
Name of Issuing Corporation

For

All Missouri Service Areas except Service
Areas on Sheet RT 5.1
Community, Town or City

Rate J RATE FOR MANUFACTURERS AND LARGE QUANTITY USERS OF WATER (Continued)	
<p>PRO-RATA ADJUSTMENT OF MONTHLY MINIMUM CHARGE – If the customer is forced to close operations of its works for a period of 10 days or more on account of accidents, fires, damage to works, strikes of its own employees, act of God, Governmental regulations or other physical cause not reasonably within its control, and customer gives Water Company written notice not later than forty days after such occurrence the customer will be entitled to pro rata reduction in the monthly minimum charge which is based on 60% of the maximum usage during the previous months of June, July, August, or September for the period during which the customer is unable to use full water service for such cause.</p>	
<p>DURATION OF CLASSIFICATION</p> <p>A Rate J customer whose usage is less than 450,000 gallons per month more than two times during a twelve (12) month period will no longer meet the eligibility requirements of this classification.</p> <p>Customers who no longer meet the eligibility requirements of this classification, or elect to leave this classification, will be reclassified to Tariff Rate A 1, and must remain in the Rate A 1 classification for a minimum of twelve (12) months and meet the monthly minimum usage requirements again before being classified under the Tariff Rate J. Customers electing to return to Tariff Rate J, are required to remain in this classification for a period of a minimum of twelve (12) months.</p>	<p>+</p> <p>+</p> <p>+</p> <p>+</p> <p>+</p>
<p>PAYMENT TERMS – Bills are net, and are due and payable within twenty-one (21) days after date of bill.</p>	
<p>RULES AND REGULATIONS – The General Rules and Regulations set forth in this tariff shall govern the supply of service under this rate.</p>	

* Indicates new rate or text
+ Indicates change

DATE OF ISSUE: June 30, 2017

DATE OF EFFECTIVE: July 30, 2017

ISSUED BY: Cheryl Norton, President
727 Craig Road, St. Louis, MO 63141

Missouri-American Water Company
Name of Issuing Corporation

For

Missouri Service Area
Community, Town or City

HELD FOR FUTURE USE	+
	+
	+
	+
	+
	+
	+
	+
	+
	+
	+
	+
	+
	+
	+
	+
	+
	+
	+
	+
	+
	+
	+
	+
	+
	+
	+
	+
	+
	+

* Indicates new rate or text
+ Indicates change

DATE OF ISSUE: June 30, 2017

DATE OF EFFECTIVE: July 30, 2017

ISSUED BY: Cheryl Norton, President
727 Craig Road, St. Louis, MO 63141

Missouri-American Water Company
Name of Issuing Corporation

For

Missouri Service Area
Community, Town or City

HELD FOR FUTURE USE	+ +
---------------------	--

* Indicates new rate or text
+ Indicates change

DATE OF ISSUE: June 30, 2017

DATE OF EFFECTIVE: July 30, 2017

ISSUED BY: Cheryl Norton, President
727 Craig Road, St. Louis, MO 63141

Missouri-American Water Company
 Name of Issuing Corporation

For

Missouri Service Area
 Community, Town or City

MISCELLANEOUS CHARGES

The following miscellaneous charges apply as authorized and described elsewhere in Company's filed Rules and Regulations.

Service Activation Fee	\$25.00	Per Trip	
Service Activation Fee Overtime	\$150.00	Per Trip	
Temporary Water Service	\$61.00	Per Application	
Regular Hours Restoration Charge	\$50.00	Per Trip	
After Hours Restoration Charge	\$150.00	Per Trip	
Returned Deposit Item	\$12.00	Per Item	
Meter Reading Appointment	\$20.00	Per Trip	
Rescheduled Taps	\$65.00	Per Trip	
Discontinuation or Termination of Service (leaking service line)	\$31.00	Per Trip	
After Hours Discontinuance or Termination of Service	\$150.00		+
Water Usage from Company Hydrant (except political subdivisions for street cleaning)	\$15.00	day of allowed usage	+
Hydrant Inspection Fee	\$15.00	hydrant	
Investigation Report Fee	\$25.00		
Meter Testing	\$75.00		*
Service Line Inspection Fee (Regular Hours)	\$21.00		*
New Service Connection Fee	Actual Cost		
Consists of the costs incurred by the Company for the construction including parts, material, labor and equipment, but excluding the cost of the meter. See Rule 4H and 4I			
Bulk Sales through Coin-Operated Vending Machine (where available)	\$4.50	per 1,000 gallons	*
Late Fee	A charge of 1.5% per month times the unpaid balance will be added to the delinquent accounts.		*
			*

* Indicates new rate or text

+ Indicates change

DATE OF ISSUE: June 30, 2017

DATE OF EFFECTIVE: July 30, 2017

ISSUED BY: Cheryl Norton, President
727 Craig Road, St. Louis, MO 63141

Missouri-American Water Company
Name of Issuing Corporation

For

Missouri Service Area
Community, Town or City

HELD FOR FUTURE USE

+
+
+

+
+
+
+
+
+
+
+
+
+
+
+
+
+
+
+
+
+
+
+
+
+
+

* Indicates new rate or text
+ Indicates change

DATE OF ISSUE: June 30, 2017

DATE OF EFFECTIVE: July 30, 2017

ISSUED BY: Cheryl Norton, President
727 Craig Road, St. Louis, MO 63141

Missouri-American Water Company
Name of Issuing Corporation

For

Missouri Service Area
Community, Town or City

RATE B-1	
<p>AVAILABILITY - This rate is available to Public Water Supply District No. 1 of Jefferson County, Public Water Supply District No. 3 of Jefferson County, and Public Water Supply District No. 10 of Jefferson County, MO only, for supply of water for resale.</p>	*
<p>RATE - For all water used as registered by meter: (1)</p> <p style="text-align: center;">\$.23350 per 100 gallons</p>	+
<p>This rate is available to Public Water Supply District No. 1 of Jefferson County, Public Water Supply District No. 3 of Jefferson County, and Public Water Supply District No. 10 of Jefferson County under the terms and conditions of the contracts on file with the Missouri Public Service Commission.</p>	*
<p>PAYMENT TERMS - Bills are net, and are considered delinquent if not paid within twenty-one (21) days after date of bill.</p>	*
<p>RULES AND REGULATIONS - The General Rules and Regulations set forth in this tariff shall govern the supply of service under this rate.</p>	
<p>(1) Exclusive of every tax or payment imposed upon the Company by any political subdivision of the State of Missouri, for the right to do business in such political subdivision. See P. S. C. MO No. 13 Original Sheet No. RT 8.</p>	

* Indicates new rate or text

+ Indicates change

DATE OF ISSUE: June 30, 2017

DATE OF EFFECTIVE: July 30, 2017

ISSUED BY: Cheryl Norton, President
727 Craig Road, St. Louis, MO 63141

Missouri-American Water Company
Name of Issuing Corporation

For

Missouri Service Area
Community, Town or City

HELD FOR FUTURE USE	
	*
	+
	+
	+
	+
	+
	+
	+
	+
	+
	+
	+
	+
	+

* Indicates new rate or text
+ Indicates change

DATE OF ISSUE: June 30, 2017

DATE OF EFFECTIVE: July 30, 2017

ISSUED BY: Cheryl Norton, President
727 Craig Road, St. Louis, MO 63141

Missouri-American Water Company
Name of Issuing Corporation

For

Missouri Service Area
Community, Town or City

HELD FOR FUTURE USE	
	*
	+
	+
	+
	+
	+
	+
	+
	+
	+
	+
	+
	+
	+
	+
	+
	+
	+
	+
	+
	+
	+

* Indicates new rate or text

+ Indicates change

DATE OF ISSUE: June 30, 2017

DATE OF EFFECTIVE: July 30, 2017

ISSUED BY: Cheryl Norton, President
727 Craig Road, St. Louis, MO 63141

Missouri-American Water Company
Name of Issuing Corporation

For

Missouri Service Area
Community, Town or City

HELD FOR FUTURE USE	* + + + + +
---------------------	------------------------------------

* Indicates new rate or text

+ Indicates change

DATE OF ISSUE: June 30, 2017

DATE OF EFFECTIVE: July 30, 2017

ISSUED BY: Cheryl Norton, President
727 Craig Road, St. Louis, MO 63141

Missouri-American Water Company
Name of Issuing Corporation

For

Missouri Service Area
Community, Town or City

Minimum Customer Charge Rate for Low-Income Customers

Tariff Qualifications

The program administrator will determine a customer's eligibility using the following criteria: the customer's household earnings meet the low-income guidelines for the Missouri Low-Income Home Energy Assistance Program (LIHEAP). Residential customers, who demonstrate a financial need and qualify for LIHEAP, should contact a local Community Action Agency referenced below or any subsequent program administrator whose contact information may be found on Missouri American Water's web site. Upon qualification for LIHEAP, residential customers with a 5/8" meter will receive a discount of 80% of the fixed 5/8" meter minimum customer charge. The current fixed monthly 5/8" meter minimum customer charge is \$10.00, the discount applied to the customer's monthly bill would be \$8.00.

+
+

Missouri American Water Districts	County	Community Action Agency Contact (Available 8:00 am – 5:00 pm)
Brunswick	Chariton County	Missouri Valley Community Action Agency 660-548-3155
Parkville	Platte County	United Services Community Action Agency 816-858-5153
St. Joseph	Buchanan County	Community Action Partnership of Greater St. Joseph 816-233-8281

Availability

Customers that default on payments for two (2) consecutive months will no longer be eligible for this rate, and will not be allowed to requalify for twelve (12) months. Customers must reestablish eligibility on an annual basis. This rate will be available until the effective date of new rates in Missouri American Water's next general rate proceeding.

* Indicates new rate or text

+ Indicates change

DATE OF ISSUE: June 30, 2017

DATE OF EFFECTIVE: July 30, 2017

ISSUED BY: Cheryl Norton, President
727 Craig Road, St. Louis, MO 63141

Missouri-American Water Company
Name of Issuing Corporation

For

All Missouri Service Areas
Community, Town or City

Revenue Stabilization Mechanism (RSM)

Applicable to All residential ("domestic"), commercial, other public authority and sale for resale metered water customers.

Section A - Definitions

The terms below are defined to mean:

Actual Revenue (AR) shall mean the actual dollar amount of revenues billed to customers for the identified Service Classifications, excluding revenues arising from adjustments under this tariff and any other tariff, which were billed for the applicable Fiscal Year.

Actual Production Costs (APC) shall mean the actual dollar amount of power, chemicals, purchased water and waste disposal incurred by the Company in the Fiscal Year.

Effective Period shall mean the period for which the adjustments in Section B are to be billed to customers, and shall be the nine-month period April through December after the Filing Month.

Effective Period Usage (G) shall mean the number of 100 gallon units delivered to customers by the Company, including the number of 100 gallon units for the applicable Effective Period.

Filing Month shall mean the month in which an adjustment is determined by the Company and submitted to the Commission, on or before January 31.

Fiscal Year shall mean the Fiscal Year of the Company that ended as of the most recent December 31.

Previous Amortization Period shall mean the nine-month reconciliation amortization period that ended as of the most recent Fiscal Year.

Rate Case Revenue (RCR) shall mean the dollar amount of revenues reflected in the revenue requirements approved by the Commission for the applicable Service Classifications in the Company's most recent general rate case. In a month or year in which new rates come into effect, the RCR shall be prorated based upon the number of days in the month or year under the old rates and the number of days in the month or year under the new rates. If the dollar amount of revenues is expected to change as a result of the Commission's approval of one or more water system acquisitions by the Company, then the RCR will be adjusted to reflect the additional revenue as determined in the acquisition case. In a month or year in which the Commission approves a water acquisition by the Company, the RCR shall be prorated based upon the number of days in the month or year that do not reflect the revenues billed to customers in the acquired system(s) and the number of days in the month or year that do reflect the revenues billed to customers in the acquired system(s).

* Indicates new rate or text

+ Indicates change

DATE OF ISSUE: June 30, 2017

DATE OF EFFECTIVE: July 30, 2017

ISSUED BY: Cheryl Norton, President
727 Craig Road, St. Louis, MO 63141

Missouri-American Water Company
Name of Issuing Corporation

For

All Missouri Service Areas
Community, Town or City

Revenue Stabilization Mechanism (RSM)

Section A - Definitions – continued

Rate Case Production Costs (RPC) shall mean the dollar amount of power, chemicals, purchased water and waste disposal expenses reflected in revenue requirements approved by the Commission in the Company's most recent general rate case. In a month or year in which new rates come into effect, the RPC shall be prorated based upon the number of days in the month or year under the old rates and the number of days in the month or year under the new rates. If the dollar amount of production costs is expected to change as a result of the Commission's approval of one or more water system acquisitions by the Company, then the RPC will be adjusted to reflect the additional production costs as determined in the acquisition case. In a month or year in which the Commission approves a water acquisition by the Company, the RPC shall be prorated based upon the number of days in the month or year that do not reflect the production costs in the acquired system(s) and the number of days in the month or year that do reflect the production costs in the acquired system(s).

Upcoming Amortization Period shall mean the nine-month reconciliation amortization period commencing on April 1 following the Fiscal Year.

Section B - Determination of Adjustment

$$\frac{((RCR-RPC) - (AR-APC)) + RA}{G}$$

Where:

- RCR represents the Rate Case Revenue for the Fiscal Year.
- RPC represents the Rate Case Production Costs for the Fiscal Year.
- AR represents the Actual Revenue for the Fiscal Year.
- APC represents the Actual Production Costs for the Fiscal Year.
- G represents the Factor G for the Effective Period.
- RA represents the dollar amount due the Company (+RA) or the customers (-RA) arising from adjustments under this tariff that were under-billed or over-billed in the prior Fiscal Year.

The adjustment components above shall be summed together for billing purposes. If either component of the adjustments computes to \$0.0001 per 100 gallons or more, any fraction of \$0.0001 in the computed per 100 Gallons adjustment amount shall be dropped if less than \$0.00005 or, if \$0.00005 or more, shall be rounded up to the next full \$0.0001.

Section C - Reports and Reconciliations

The Company shall file with the Commission on or before January 31 of each year, the RSM calculation and support for any annual adjustments to be effective under this tariff. The Commission Staff will have 60 days to review. The reconciliation amount will be surcharged from April 1 through December 31 of each calendar year. Any credit will be issued as soon as administratively possible.

Rate Components: In addition to the other charges provided for in the company's tariffs, a separate charge for the RSM will apply for service rendered on and after the effective date.

Surcharge Rate (1) \$.0000 per hundred gallons

(1) Exclusive of every tax or payment imposed upon the Company by any political subdivision for the State of Missouri, for the right to do business in such political subdivision.

* Indicates new rate or text

+ Indicates change

DATE OF ISSUE: June 30, 2017

DATE OF EFFECTIVE: July 30, 2017

ISSUED BY: Cheryl Norton, President
727 Craig Road, St. Louis, MO 63141