

NEWMAN, COMLEY & RUTH P.C.

ATTORNEYS AND COUNSELORS AT LAW

601 MONROE STREET, SUITE 301

P.O. BOX 537

JEFFERSON CITY, MISSOURI 65102-0537

TELEPHONE: (573) 634-2266

FACSIMILE: (573) 636-3306

www.ncrpc.com

ROBERT K. ANGSTEAD
ROBERT J. BRUNDAGE
MARK W. COMLEY
LANETTE R. GOOCH
CATHLEEN A. MARTIN

MARTIN A. MILLER
STEPHEN G. NEWMAN
JOHN A. RUTH
ALICIA EMBLEY TURNER

January 4, 2007

The Honorable Colleen M. Dale
Secretary
Missouri Public Service Commission
P.O. Box 360
Jefferson City, MO 65102-0360

Re: Lake Region Water & Sewer Company
Case No. WA-2005-0463

FILED³
JAN 4 2007
Missouri Public
Service Commission

Dear Judge Dale:

Under cover of this letter you will find six executed copies of a *Consolidation of and Amendments to Development Agreements* pertaining to projects involving the new service area approved in the Commission's Order Approving Application for Certificate of Convenience and Necessity dated October 26, 2007 in the referenced matter. This agreement concludes lengthy negotiations which were referred to in the Commission's referenced Order at page 3. This agreement is the basis for the Contribution in Aid of Construction Surcharge (CIAC) that is part of the revised tariff sheets submitted and described below:

PSC MO No. 1, Original Title Page
PSC MO No. 1, First Revised Sheet No. 1, Replacing Original Sheet No. 1
PSC MO No. 1, Second Revised Sheet No. 2, Replacing First Revised Sheet No. 2
PSC MO No. 1, First Revised Sheet No. 7, Replacing Original Sheet No. 7
PSC MO No. 1, Original Sheet No. 7-A

* * * *

PSC MO No. 2, Original Title Page
PSC MO No. 2, First Revised Adoption Notice, Replacing Original Adoption Notice
PSC MO No. 2, First Revised Sheet No. 4, Replacing Original Sheet No. 4
PSC MO No. 2, First Revised Sheet No. 6, Replacing Original Sheet No. 6
PSC MO No. 2, Original Sheet 6-A

The Honorable Colleen M. Dale
January 4, 2007
Page 2

Regarding the sewer tariffs, the Original Adoption Notice currently on file with the Commission is labeled PSC MO No. 1. Please be advised that the First Revised Adoption Notice is being filed to correct what appears to be an error in the Original Adoption Notice.

Each of the tariffs above bear an issue date of January 4, 2007 and an effective date thirty days thereafter of February 3, 2007.

These tariffs are being filed to comply with the terms of ORDERED paragraph 5 of the Commission's October 26, 2006 Order.

Would you please bring this filing to the attention of the appropriate commission personnel.
Thank you.

Very truly yours,

NEWMAN, COMLEY & RUTH P.C.

By:

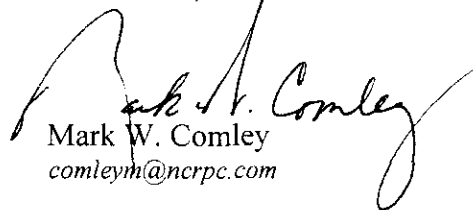
Mark W. Comley
comleym@ncrpc.com

MWC:ab

Enclosure

cc: Office of Public Counsel
General Counsel's Office
Dale Johansen
John R. Summers

P.S.C. MO No. 2

Original Title Page

Lake Region Water & Sewer Company

For: Missouri Service Areas

Sewer Tariff Title Page

LAKE REGION WATER & SEWER COMPANY

**SCHEDULE OF RATES AND RULES GOVERNING
THE PROVISION AND TAKING OF SEWER SERVICE**

* Indicates New Rate or Text

+ Indicates Changed Rate or Text

Issue Date: January 4, 2007

Effective Date: February 3, 2007

Issued By: John R. Summers, General Manager

Lake Region Water & Sewer Company
P.O. Box 9, Lake Ozark, MO 65049

P.S.C. MO No. 2

First Revised Adoption Notice
Replacing Original Adoption Notice

Lake Region Water & Sewer Company

Certificated Service Areas Previously
Served by Four Seasons Water & Sewer Co.

Sewer Tariff Adoption Notice

Lake Region Water & Sewer Company, hereby adopts, ratifies, and makes its own, in every respect as if the same had been originally filed by it, all tariffs filed with the Public Service Commission, State of Missouri, under the name Four Seasons Water & Sewer Co., currently on file with and approved by the Commission, representing the rates, terms and conditions of the regulated sewer service previously provided by Four Seasons Water & Sewer Co.

* Indicates New Rate or Text

+ Indicates Changed Rate or Text

Issue Date: January 4, 2007

Effective Date: February 3, 2007

Issued By: John R. Summers, General Manager

Lake Region Water & Sewer Company
P.O. Box 9, Lake Ozark, MO 65049

P.S.C. MO NO. 2 SECOND REVISED SHEET NO. 2

CANCELLING P.S.C. MO NO. 1 FIRST REVISED SHEET NO. 2

LAKE REGION WATER AND SEWER COMPANY: SHAWNEE BEND SERVICE AREA

FOR SEWER SERVICE

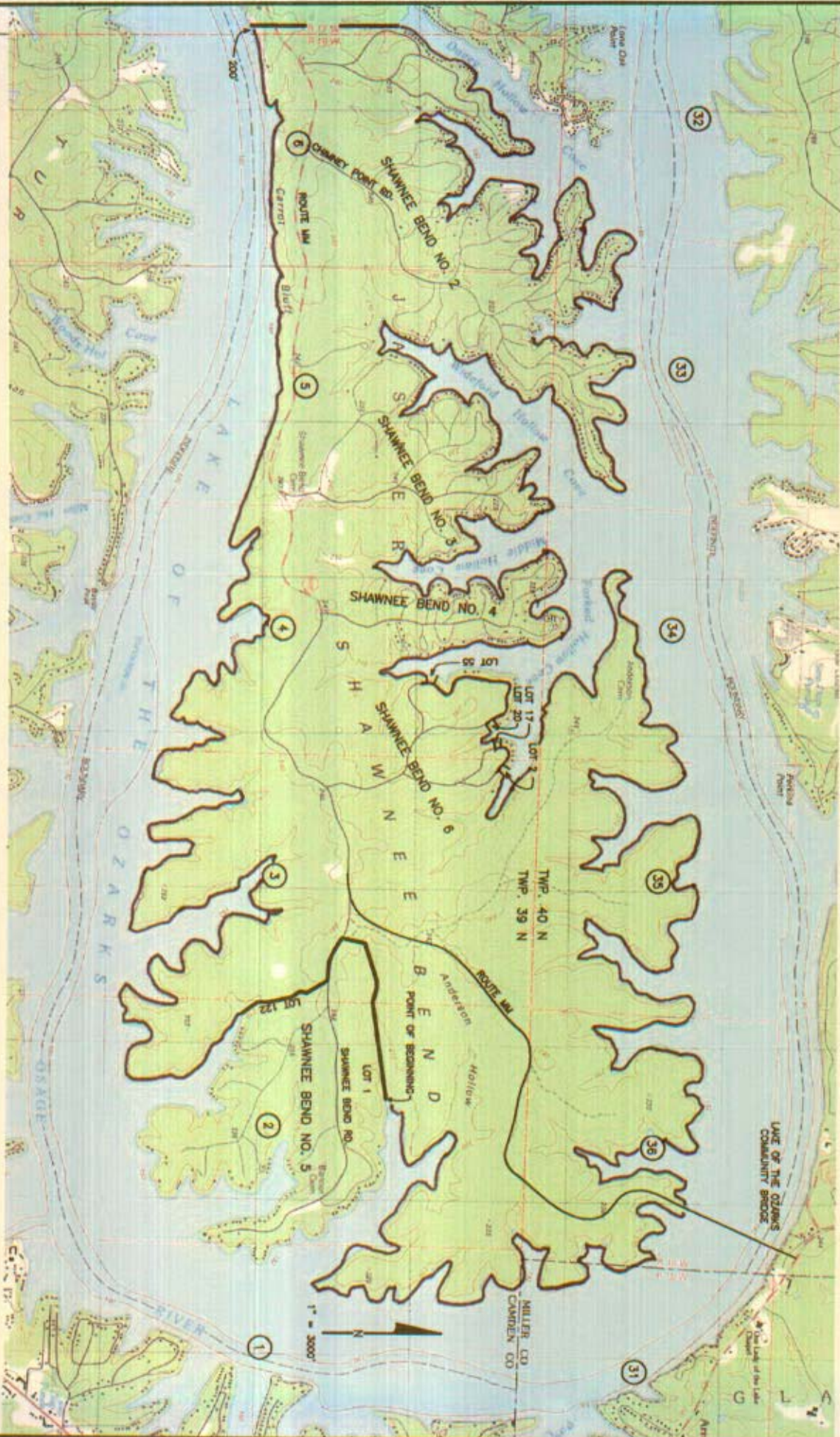

R. 17 W
R. 16 W

DATE OF ISSUE 1-4-2007 DATE EFFECTIVE 2-3-2007

ISSUED BY:

NAME OF OFFICER: John Summers TITLE: General Manager ADDRESS: P.O. Box 608 Lake Ozark, Missouri 65049

Lake Region Water & Sewer Company

For: Missouri Service Areas

**Rules Governing Rendering of
Sewer Service****Legal Description of the Service Area: Sewer – Shawnee Bend**

+

Lake Region Water & Sewer Company general description for sewer service area on Shawnee Bend, Lake of the Ozarks, Camden and Miller Counties, Missouri.

Generally includes all of the Shawnee Bend peninsula east of and including Section 6, Township 39 North, Range 16 West, excluding the subdivision of Shawnee Bend No. 5; and, lots 2 thru 17 and lots 20 thru 55 of the Shawnee Bend No. 6 subdivision, more particularly described as:

Beginning at the shoreline (662 contour) at the northerly most corner of Lot 1 of Shawnee Bend No. 5, then following the north line of Lot 1 to the north right-of-way of Shawnee Bend Road, then following this right-of-way in an easterly direction to a point adjacent to the northwest corner of Lot 122 Shawnee Bend No. 5, then crossing Shawnee Bend Road to the said northwest corner of Lot 122, then following the westerly line of Lot 122 southerly to the shoreline (662 contour) then following the shoreline westerly through Section 2, Section 3, Section 4, section 5 and Section 6 to a point 200 feet west of the west section line of Section 6, the Rangeline, Township 39 north, Range 16 west, then leaving the shoreline and going north on a line parallel and 200 feet west of said Rangeline to the shoreline on Davey Hollow Cove, then following the shoreline in a generally and resultant easterly direction (to and through Section 6, Section 5, Section 4, Section 3, section 2, and Section 1 of Township 39 North, Range 16 West, and through Section 32, Section 33, Section 34, Section 35 and Section 36 of Township 40 North, Range 16 West, and through Section 31, Township 40 North, Range 15 West) to the Point of Beginning.

* Indicates New Rate or Text

+ Indicates Changed Rate or Text

Issue Date: January 4, 2007

Effective Date: February 3, 2007

Issued By: John R. Summers, General Manager

Lake Region Water & Sewer Company
P.O. Box 9, Lake Ozark, MO 65049

Lake Region Water & Sewer Company

For: Missouri Service Areas

**Rules Governing Rendering of
Sewer Service****Schedule of Rates and Charges**
Shawnee Bend Service Area**AVAILABILITY:**

Any Customer adjacent to the Company's sewer collection main or other Customer who can deliver sewage to a collection point within the Company's certified area.

SEWER SERVICE RATES:**Residential:**

Single Family Rate: \$21.96 per month

Single family, duplex unit or unit of a multi-unit building where water utility service is provided through individual water meters

Multi-unit Rate: \$21.96 per month plus \$3.66 per thousand gallons used over 6000 gallons/month

Multi-unit buildings where water utility service is provided to the building by master metering.

Commercial:

Minimum \$21.96/month plus \$3.66 per thousand gallons used over 6000 gallons/month.

CONNECTION CHARGES: Shawnee Bend Service Area

All residential customers shall pay a one-time \$280.00 connection charge when making application for service. This charge includes valve box, tap fee, valve and labor equipment necessary to connect the service sewer to a collection sewer. This does not include a collection tank or effluent pump. All non-residential or multi-family service connection charges shall be at actual cost in accordance with Rules 10 and 11.

* Indicates New Rate or Text

+ Indicates Changed Rate or Text

Issue Date: January 4, 2007

Effective Date: February 3, 2007

Issued By: John R. Summers, General Manager

Lake Region Water & Sewer Company
P.O. Box 9, Lake Ozark, MO 65049

Lake Region Water & Sewer Company

For: Missouri Service Areas

**Rules Governing Rendering of
Sewer Service****Schedule of Rates and Charges**
Shawnee Bend Service Area**MM-CHIMNEY POINT CIAC:** MM-Chimney Point Pipeline

*

The following charges shall apply to new connections to the MM-Chimney Point sewer main extension (the MM-Chimney Point Pipeline) within the Company's present service area, or any additions to its service area:

For residential buildings,
whether single family or multi-family \$625 per unit

For commercial or industrial buildings and wholesale customers the connection charge shall be calculated by multiplying \$625 by a water usage factor, with the usage factor to be determined by dividing the subject customer's expected monthly usage by 7,000 gallons; provided, however, that the usage factor shall not be less than 1.

This charge is in addition to connection or other charges authorized by the Company's tariffs. The charge shall be paid by the customer when making application for service.

Exceptions to this charge:

This charge shall not be applied to the first 215 living units constructed within the "Majestic Pointe Condominium Project" or the first 200 living units constructed within the "Shawnee Bend Project" which projects are located within the Company's service area.

TAXES:**Sales, Gross Receipts, Occupation or Franchise Taxes:**

SEE PROVISION ON SHEET 8.

* Indicates New Rate or Text

+ Indicates Changed Rate or Text

Issue Date: January 4, 2007

Effective Date: February 3, 2007

Issued By: John R. Summers, General Manager

Lake Region Water & Sewer Company
P.O. Box 9, Lake Ozark, MO 65049