

DEC 26 1991

SANDRA L. DOWD

W. L. DOWD
Clerk of the Circuit Court, Platte County, MO

In re:

Petitioner.

Case No. CV91-2675-CC

Division I

PETITION FOR APPOINTMENT OF COMMISSIONERS
TO ESTABLISH BOUNDARIES OF COMMON SEWER DISTRICT

Comes now the County Commission of Platte County, Missouri, and, pursuant to section 204.250 RSMo. 1986, files herein its resolution and order to begin proceedings for the establishment of a regional sewer district and petitions this court for the appointment of commissioners to establish the boundaries for such a sewer district encompassing the entire unincorporated area of Platte County, Missouri. Attached hereto and incorporated herein as "Exhibit A" is the resolution and order of the Platte County Commission dated December 26, 1991.

Petitioner further suggests to this court that the name of the proposed district be "The Platte County Regional Sewer District".

WHEREFORE, Petitioner prays this court to appoint three (3) disinterested persons, one of whom shall be a licensed civil engineer or surveyor, as commissioners to lay out and define the boundaries of the proposed district, and that said commissioners be ordered, pursuant to section 204.260 RSMo. 1986 to hold a hearing at the courthouse in Platte County, Missouri, for the purpose of hearing any and all persons who wish to be heard as to the location of the boundaries of the proposed district, and to report back to this court upon completion of their duties.

Carol Tomb

CAROL TOMB
PRESIDING COMMISSIONER

Scott D. Spangler

SCOTT D. SPANGLER
EASTERN DISTRICT COMMISSIONER

Charles E. Reineke

CHUCK REINEKE
WESTERN DISTRICT COMMISSIONER

ATTEST:

Ann Hines

COUNTY CLERK

MCGINNESS & SHAW LAW OFFICES

By: *Robert H. Shaw*

ROBERT H. SHAW-#29007
303 Marshall Road
P.O. Box 168
Platte City, Mo. 64079
Tel.: 816-431-2630
816-329-4645
COUNTY COUNSELOR

RESOLUTION AND ORDER OF THE COUNTY COMMISSION OF
PLATTE COUNTY TO BEGIN PROCEEDINGS FOR THE
ESTABLISHMENT OF A REGIONAL SEWER DISTRICT

WHEREAS, the County Commission of Platte County, Missouri has determined that the construction and maintenance of a common system of trunk sewers and sewage treatment facilities is necessary to secure proper sanitary conditions for the preservation of public health; and

WHEREAS, major portions of this county constitute a natural drainage area, the major portion of which lies within Platte County, a second class county, and which natural drainage area contains portions of several drainage basins, municipalities and sewer districts; and

WHEREAS, a common sewer district comprising the entire area would be eligible for federal aid and assistance under the provisions of Title 33, Section 1151 et seq., of the United States Code Annotated, 1971 Edition, as redesignated and as amended; and

WHEREAS, the establishment of such a sewer system of trunk sewers and sewage treatment facilities is necessary to guarantee the orderly growth and expansion of Platte County and to preserve its lakes, streams and natural waterways; and

WHEREAS, the issue of the creation of such a district should be presented to legal voters residing in the area sought to be organized and incorporated as a sewer district;

NOW, THEREFORE, IT IS ORDERED that this commission present to the Circuit Court of Platte County an application for the appointment of commissioners pursuant to chapter 204 RSMo. 1986 for the formation of a regional sewer district encompassing the entire unincorporated area of Platte County; and

IT IS FURTHER ORDERED that the suggested name for the proposed district shall be "The Platte County Regional Sewer District".

Carol Tomb
CAROL TOMB
PRESIDING COMMISSIONER

Scott D. Spangler
SCOTT D. SPANGLER
EASTERN DISTRICT COMMISSIONER

Chuck Reineke
CHUCK REINEKE
WESTERN DISTRICT COMMISSIONER

ATTEST:

Kim Spaul
COUNTY CLERK

EXHIBIT "A"

STATE OF MISSOURI, COUNTY OF PLATTE
This is to certify that the foregoing is a true and
exact copy of the documents on file in my office.
Witness my hand and official seal this 8th
day of February 20 10
Clerk of Circuit Court SANDRA L. DOWD
By Leresa Morris D.C.

IN THE CIRCUIT COURT OF PLATTE COUNTY, MISSOURI
AT PLATTE CITY

FILED

DEC 30 1991

In re:

The Matter of the Platte County
Regional Sewer District

The County Commission of
Platte County, Missouri,
Petitioner.

SANDRA L. DOWD

Clerk of the Circuit Court Platte County, MO

Case No. CV191-2693CC

Division I

O R D E R

Now on this 30th day of December, 1991, the
Petition for Appointment of Commissioners to Establish
Boundaries of Common Sewer District filed by the County
Commission of Platte County, Missouri is taken up and
considered. Being fully advised in the premises, it is the
finding of the court that the request for appointment of
commissioners shall be granted.

WHEREFORE, IT IS ORDERED, ADJUDGED AND DECREED that _____
Wallace Beasley, Joseph H. Collison and Donald Soper,
who are three disinterested persons, one of whom is a licensed
civil engineer or surveyor, are hereby appointed commissioners
to lay out and define the boundaries of the proposed common
sewer district. It is further ordered that the said
commissioners shall forthwith meet, qualify according to law,
hold a public hearing as required by Section 204.260 RSMo. 1986
and report back to this court upon completion of their duties.

J. M. Jarman
JUDGE

STATE OF MISSOURI, COUNTY OF PLATTE
This is to certify that the foregoing is a true and
exact copy of the documents on file in my office.
Witness my hand and official seal this 8th
day of February, 20 10
Clerk of Circuit Court SANDRA L. DOWD
By Debra Manno D.C.

IN THE CIRCUIT COURT OF PLATTE COUNTY, MISSOURI
AT PLATTE CITY

FILED

FEB 07 1992

SANDRA L. DOWD
Clerk of the Circuit Court Platte County, MO

In re:

The Matter of the Platte County
Regional Sewer District

The County Commission of
Platte County, Missouri,

Petitioner.

)
)
)
) Case No. CV191-2693CC
) Division I
)
)
)

REPORT OF COMMISSIONERS

Come now Wallace Beasley, Joseph H. Collison and Donald Soper, appointed by this court as commissioners (hereinafter referred to as "The Commissioners"), to lay out and define the boundaries of the proposed Platte County Regional Sewer District, and make the following written report to this court pursuant to the order of this court entered on December 30, 1991, and state that:

1. The Commissioners caused notice to be given by publication in the Kansas City Star, a newspaper having a general circulation within the area proposed to be encompassed by the Platte County Regional Sewer District, on January 12, 13, 14, 15 and 16, 1992, of a meeting to be held by said Commissioners at 7:00 p.m. on February 5, 1992, in the Platte County Administration Building at 409 Third Street, Platte City, Missouri, to consider and establish the boundaries of the proposed Platte County Regional Sewer District.

2. Affidavit of publication of such notice, setting forth the notice that was published, the name of the newspaper in which said notice was published and the dates of publication of such notice by the newspaper is attached hereto, marked Exhibit "A", and made a part hereof by reference.

3. The Commissioners held a meeting open to the public in accordance with the aforesaid published notice at 7:00 p.m. on February 5, 1992 in the Platte County Administration Building, at 409 Third Street, Platte City, Missouri, to consider and establish the boundaries of the proposed Platte County Regional Sewer District. All persons present, residing or owning real property in the proposed district, or adjacent thereto, desiring to be heard, were heard as to the location of the boundaries of the proposed district.

4. Following said meeting, and upon due consideration of the views of all persons wishing to be heard therein, the Commissioners have unanimously fixed and determined the boundaries of the proposed Platte County Regional Sewer District to be as set forth in Exhibit "B", which is attached hereto and made a part hereof by reference.

5. Attached hereto as Exhibit "C" and made a part hereof by reference is a map showing the boundaries of the proposed Platte County Regional Sewer District, as fixed and determined by the Commissioners subsequent to and pursuant to the aforesaid meetings, in relation to the property lines intersected or followed by them, and also in relation to city or county boundaries.

WHEREFORE, the Commissioners hereby pray that if this report and the attached map are approved by this court, that the court establish compensation amounts for the Commissioners and for the court reporter employed by the Commissioners and that the Commissioners be thereupon discharged.

Dated this 7 day of February, 1992.

WALLACE BEASLEY

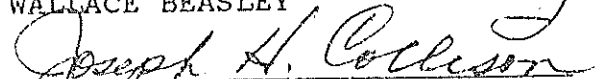
JOSEPH H. COLLISON



DONALD SOPER

EXHIBIT "A"

AFFIDAVIT OF PUBLICATION

THE KANSAS CITY STAR COMPANY, publishers of THE KANSAS CITY STAR, a newspaper published in the City of Kansas City, County of Jackson, State of Missouri, confirms that the notice and/or advertisement of:

McGinness & Shaw
PO Box 168
Platte City, MO 64079

True copy of which is hereto attached, was duly published in the above said newspaper

THE PERIOD OF: 5 Days

COMMENCING: JANUARY 12

ENDING: JANUARY 16

STAR EDITION: JANUARY 12, 13, 14, 15, 16

STAR PAPER #: 117, 118, 119, 120, 121
VOLUME # 112

PUBLIC NOTICE
Please take notice that on February 5, 1992, at 7:00 o'clock p.m. in the Platte County Administration Building, of 407 Third Street, Platte City, Missouri, the Commissioners appointed by the Circuit Court of Platte County, Missouri to establish the boundaries of a proposed common sewer district shall hold a public hearing to discuss the boundaries of the proposed district. All interested parties will be given a chance to offer their opinions on this issue.
Wallace Beasley
Joe Collison
Don Seper
Commissioners

Subscribed and sworn to before me,
this 21st day of JANUARY, 1992.
I certify that I was duly qualified
as a Notary Public for the State of
Missouri, commissioned in Jackson County,
Missouri. My commission expires September 17, 1995.

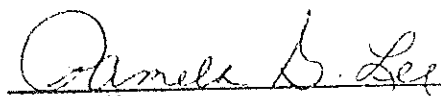

NOTARY

EXHIBIT "B"

PLATTE COUNTY REGIONAL SEWER DISTRICT BOUNDARY

All that part of the unincorporated area of Platte County, State of Missouri, as that area exists on February 5, 1992, being more fully and completely described as follows:

Beginning in the middle of the main channel of the Missouri River, at a point where a prolongation south of the old boundary line of the state would intersect the same; thence north with said boundary line to line run and marked by Matthew M. Hughs, under an act of the General Assembly of 1838 and 1839; thence west with said line to the middle of the main channel of the Missouri River; thence down said river, in the middle of the main channel thereof, to the place of beginning; excluding all property lying within the incorporated areas of Platte County.

The boundary shall specifically exclude all property lying within the corporate limits of the following incorporated areas: the cities of Camden Point, Dearborn, Edgerton, Houston Lake, Kansas City, Lake Waukomis, Northmoor, Parkville, Platte City, Platte Woods, Riverside, Tracy, Weatherby Lake, Weston; the villages of Farley, Ferrelview, Iatan, and Ridgely.

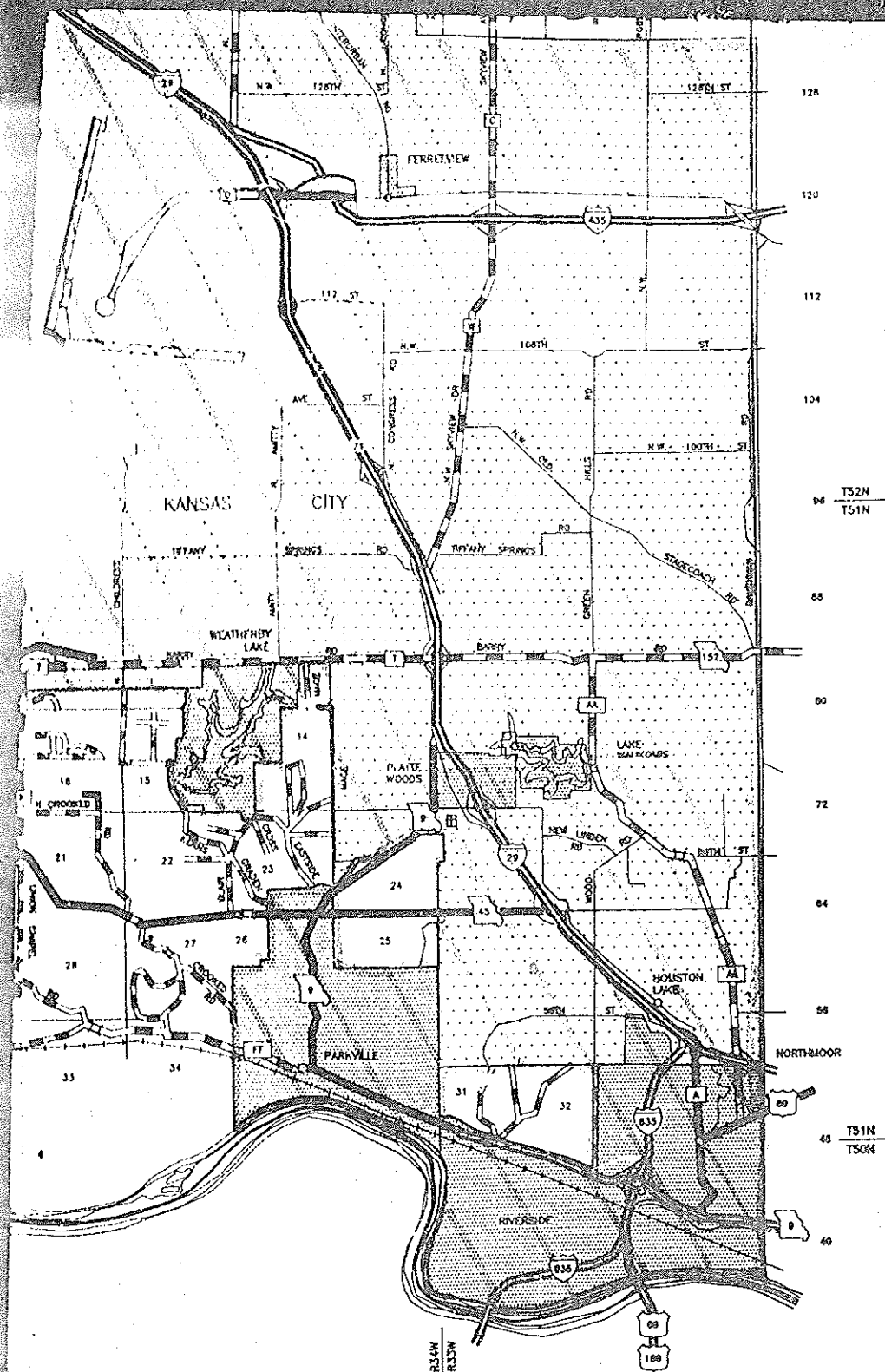

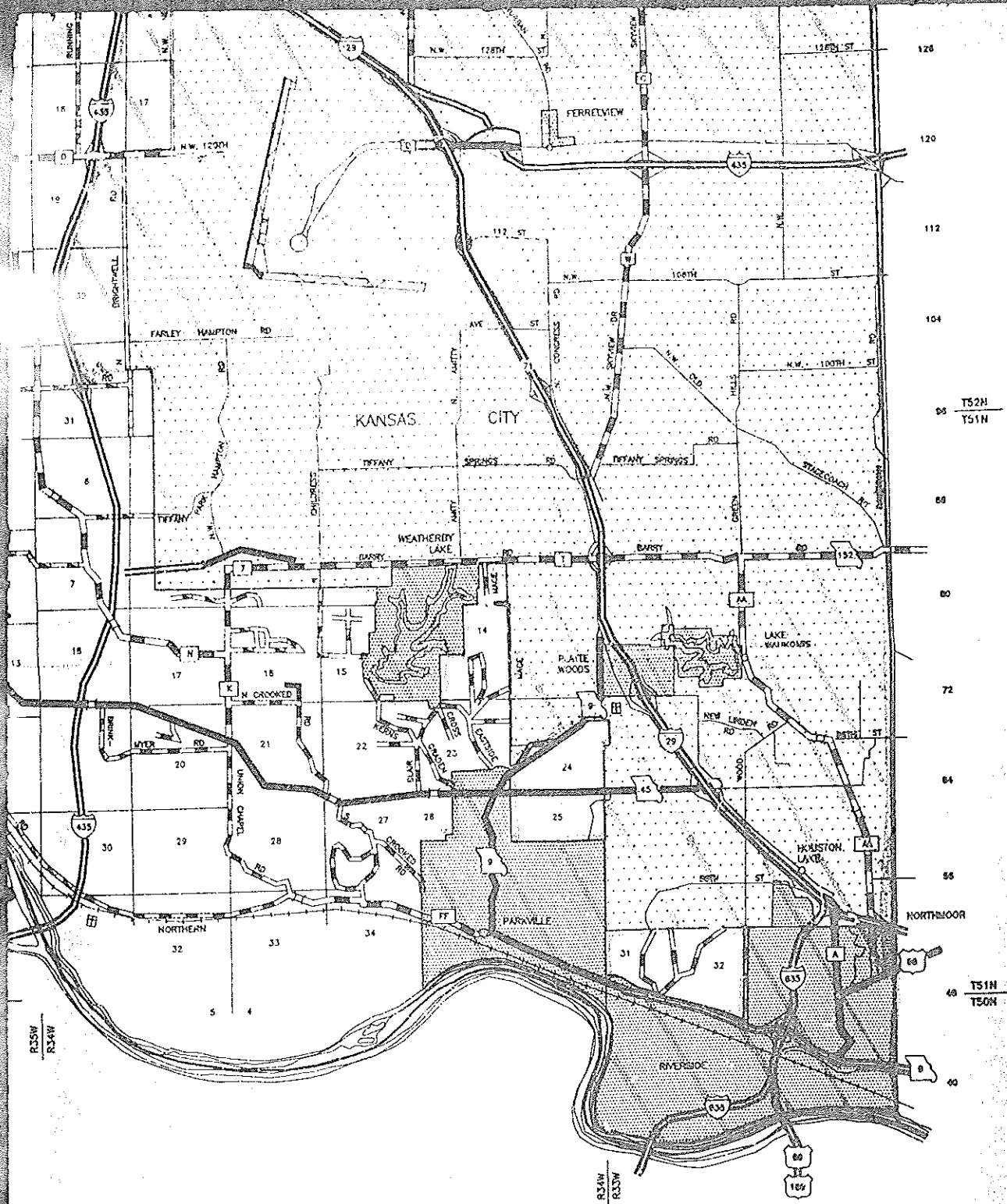

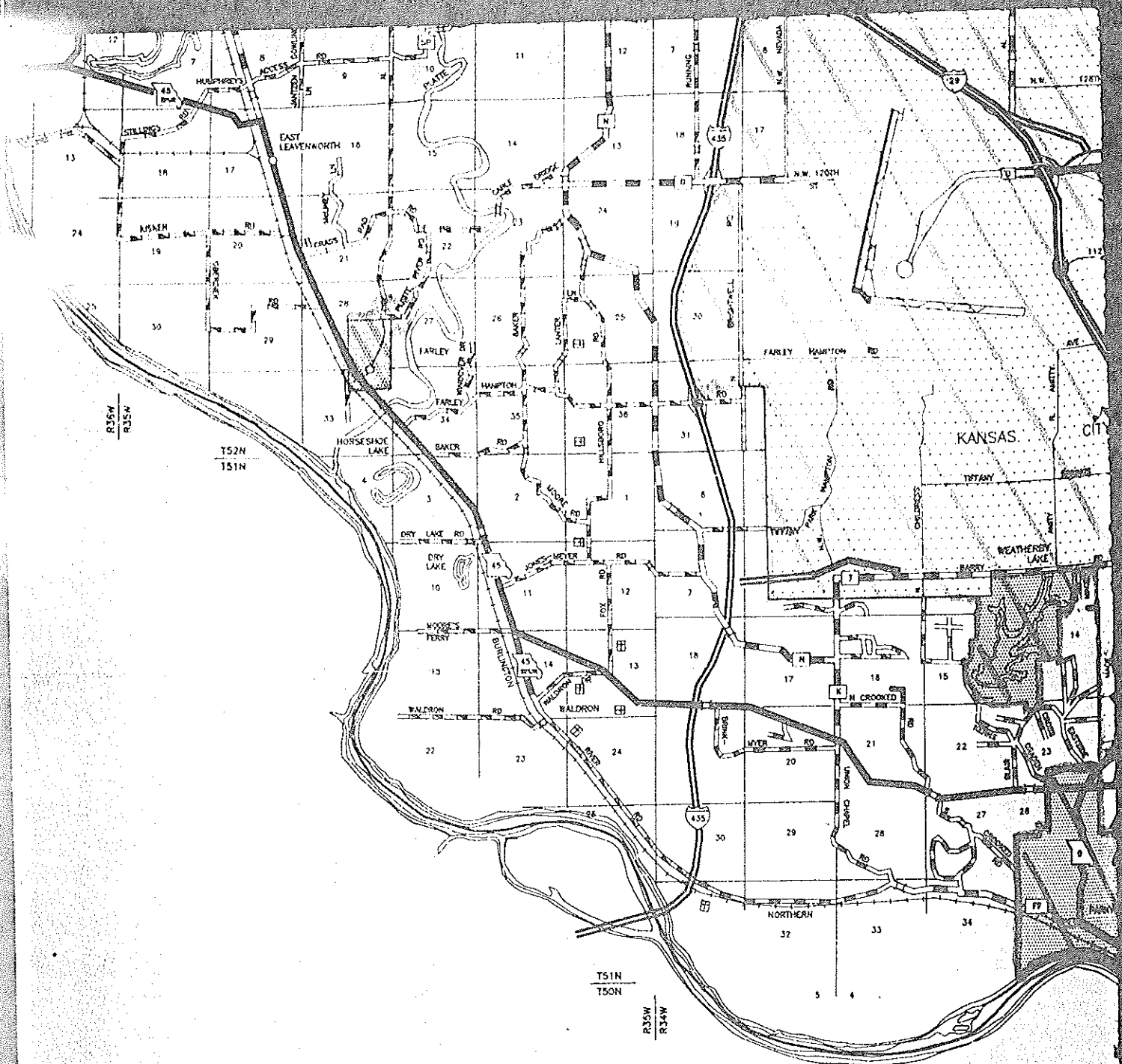

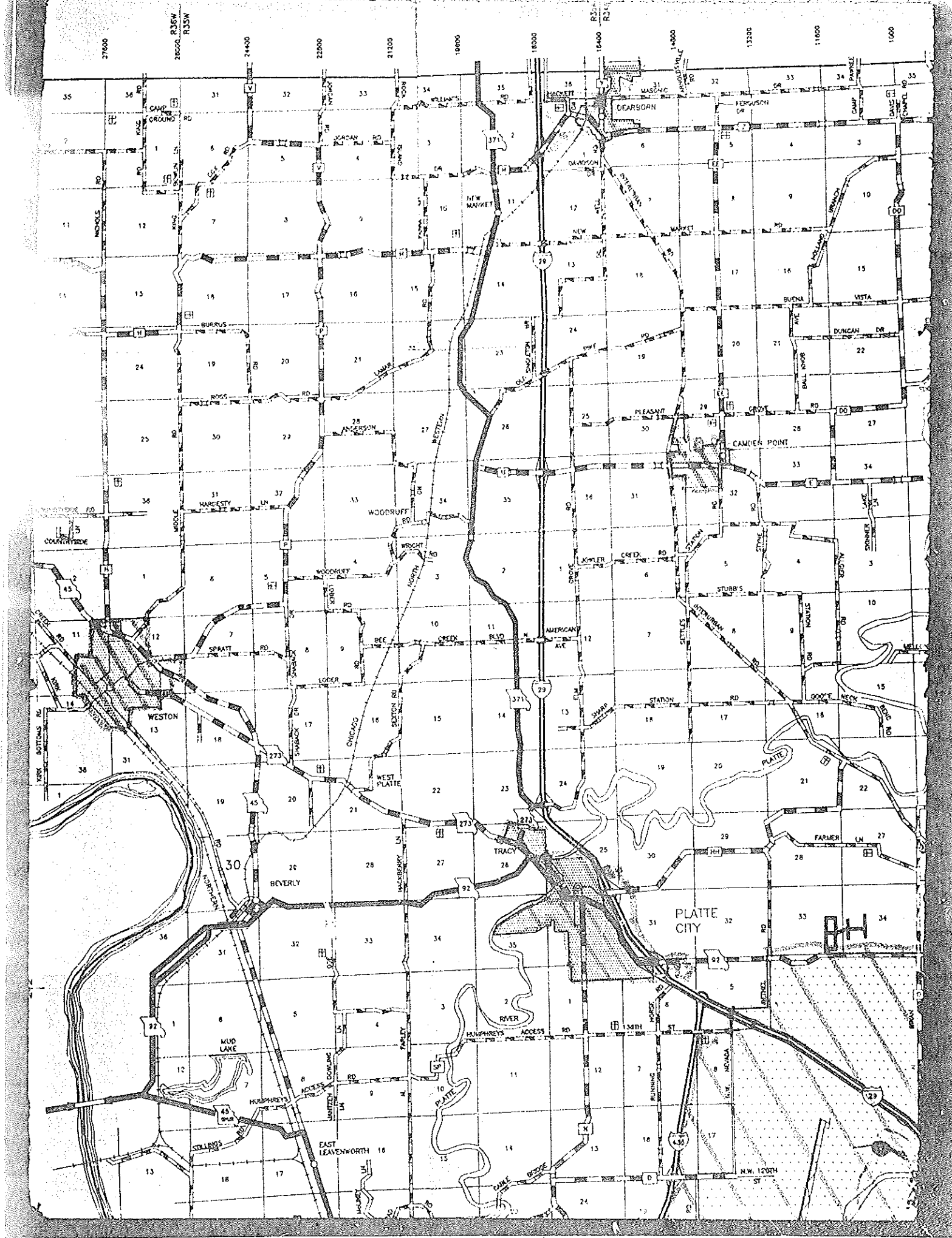

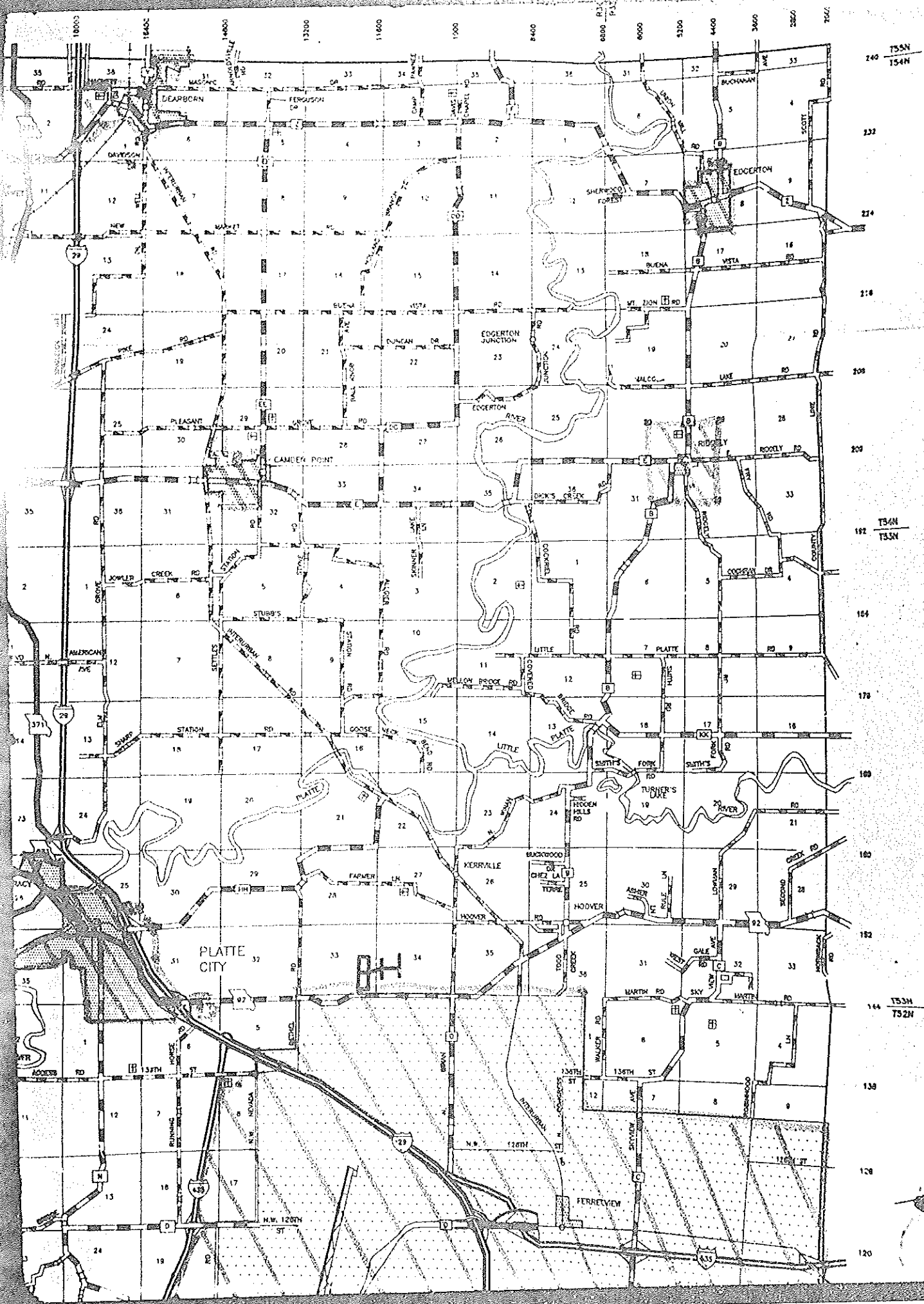

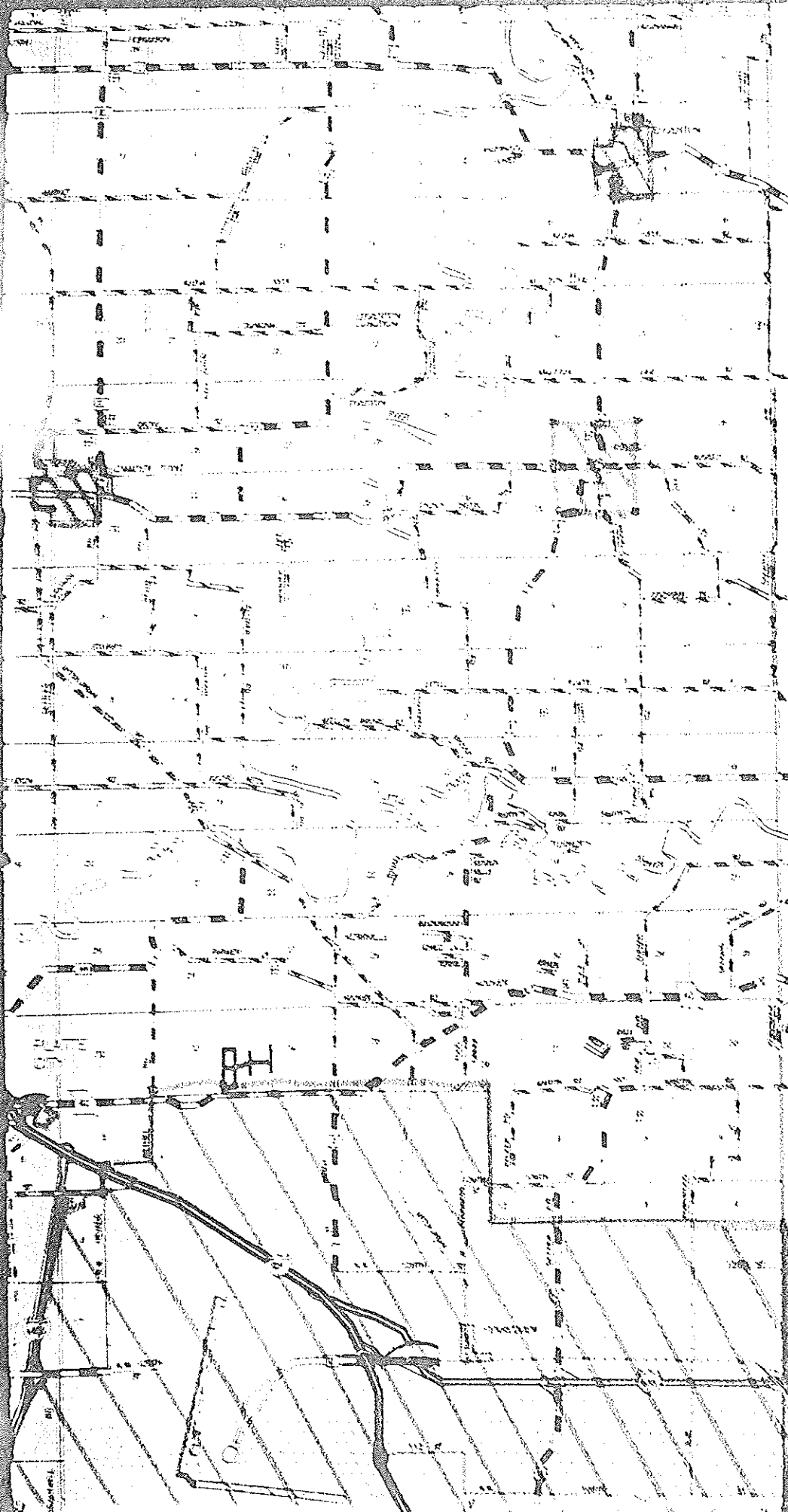

12
11
10
9
8
7
6
5
4
3
2
1



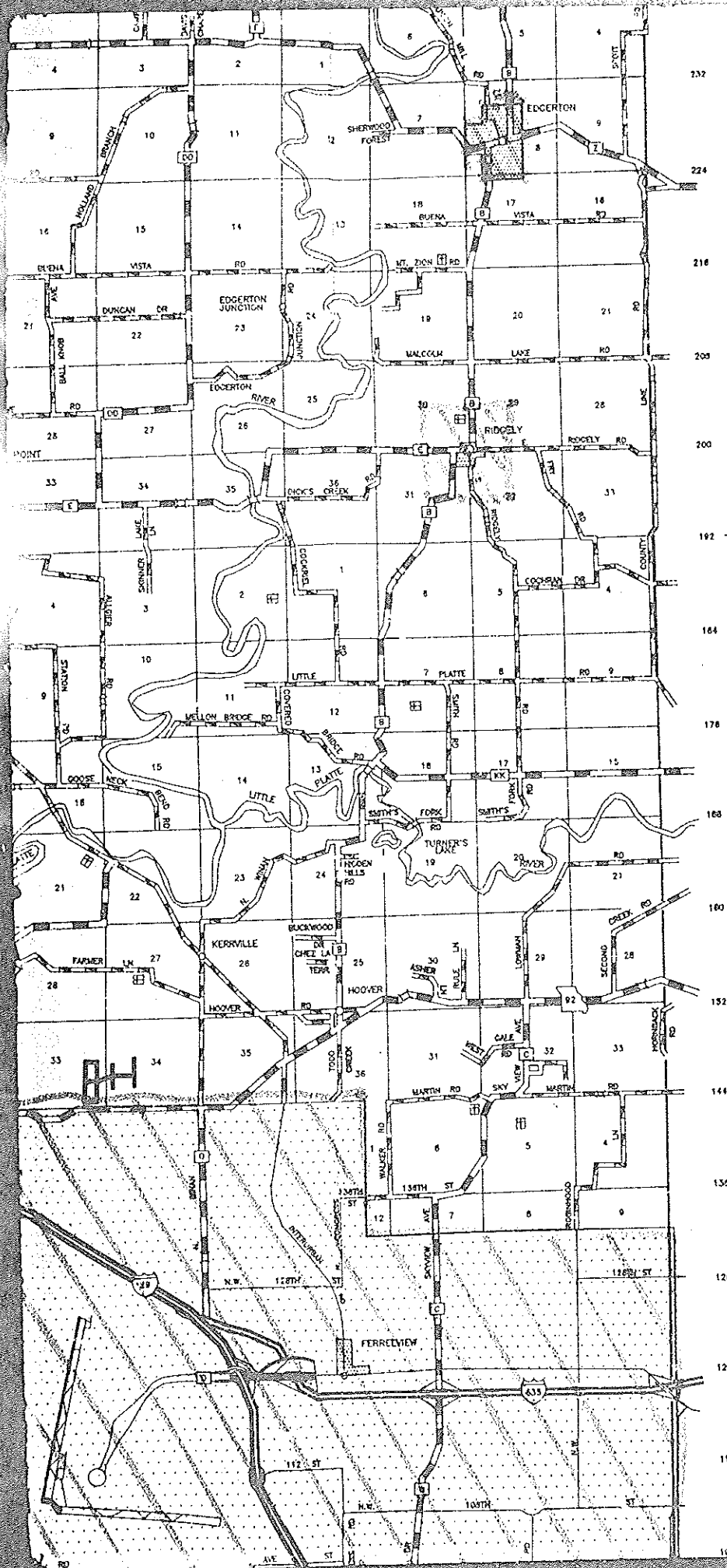

1954
1954

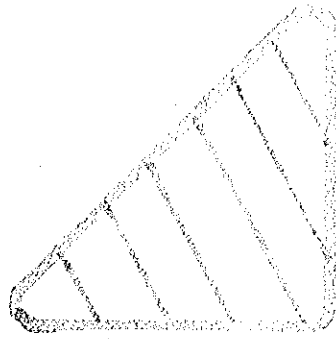

EXCLUDED BOUNDARIES



SCALE 1" = 100'



MILLER ASSOCIATES

ENGINEERS, PLANNERS & SURVEYORS, INC.

Columbia, MO

EXCLUDED BOUNDARIES

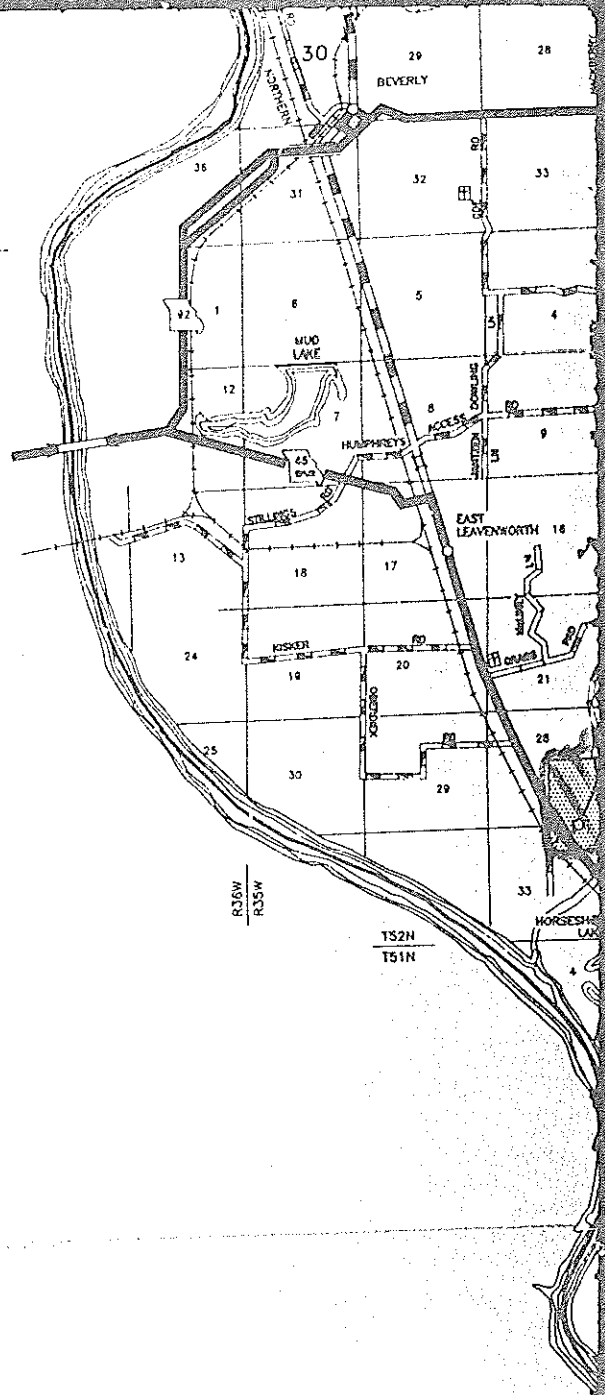

T53N
T52N

T52N
T51N



= 5280'

R ASSOCIATES

PLANNING & SURVEYING, INC.
Columbia, MO

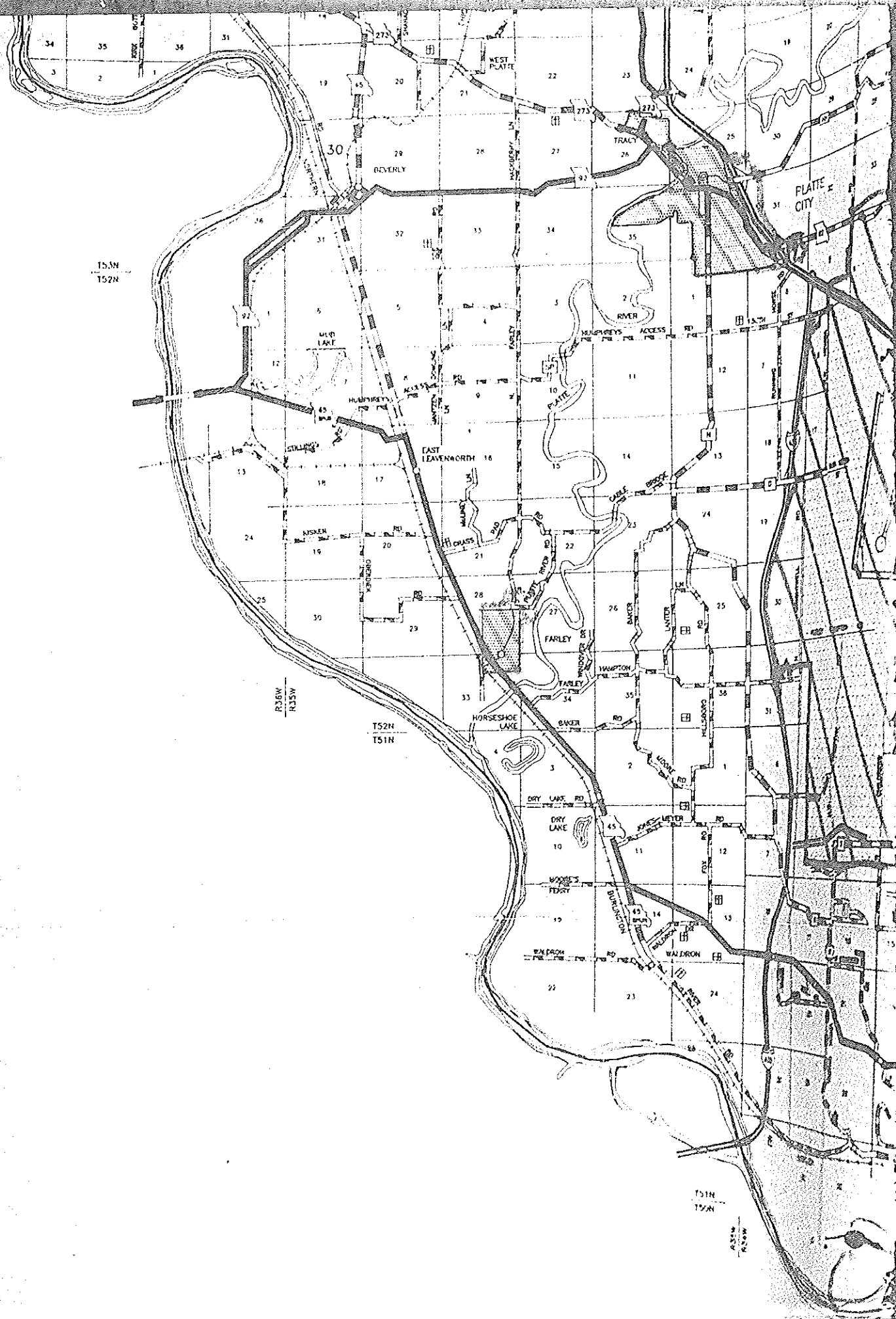

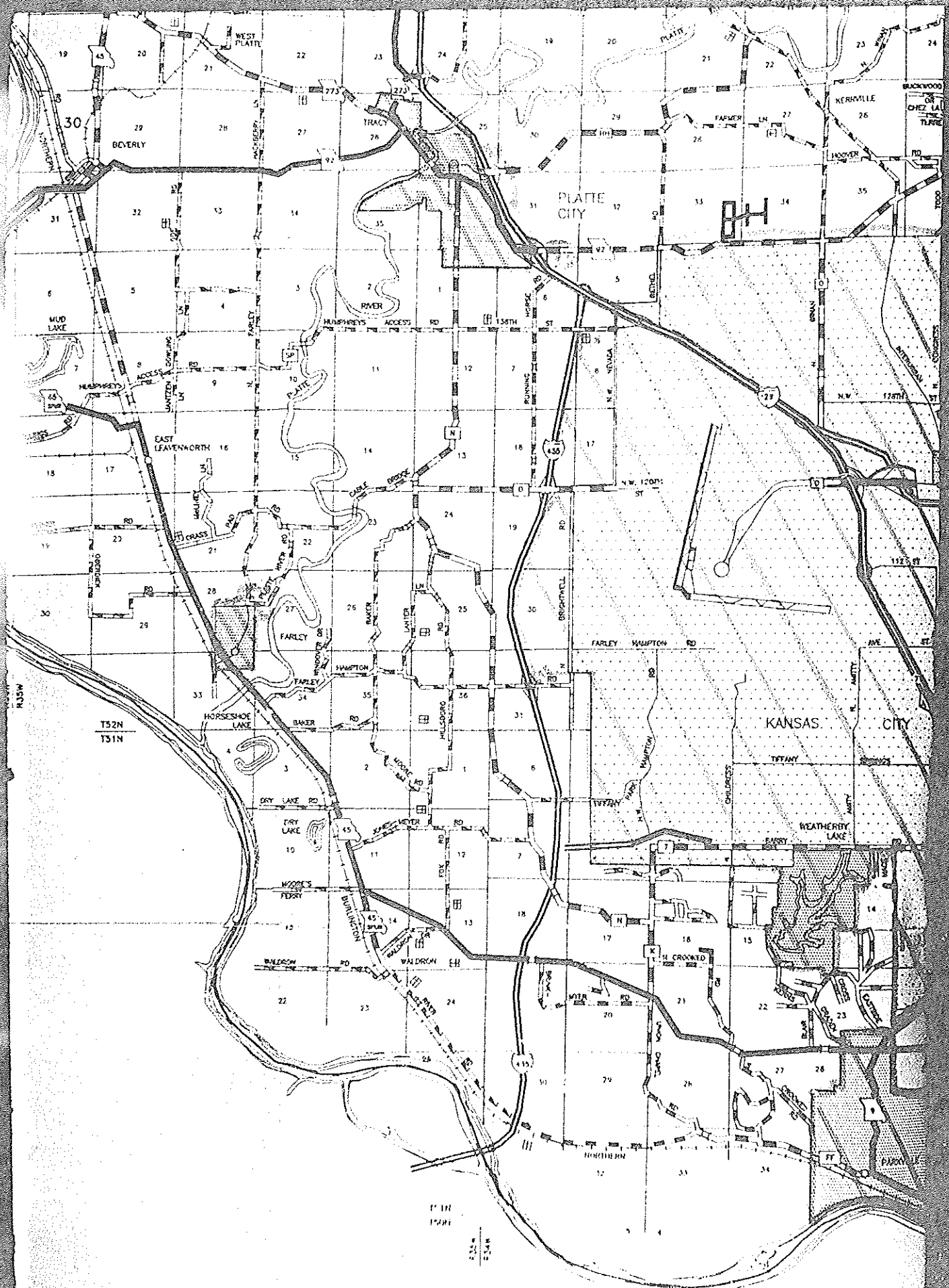

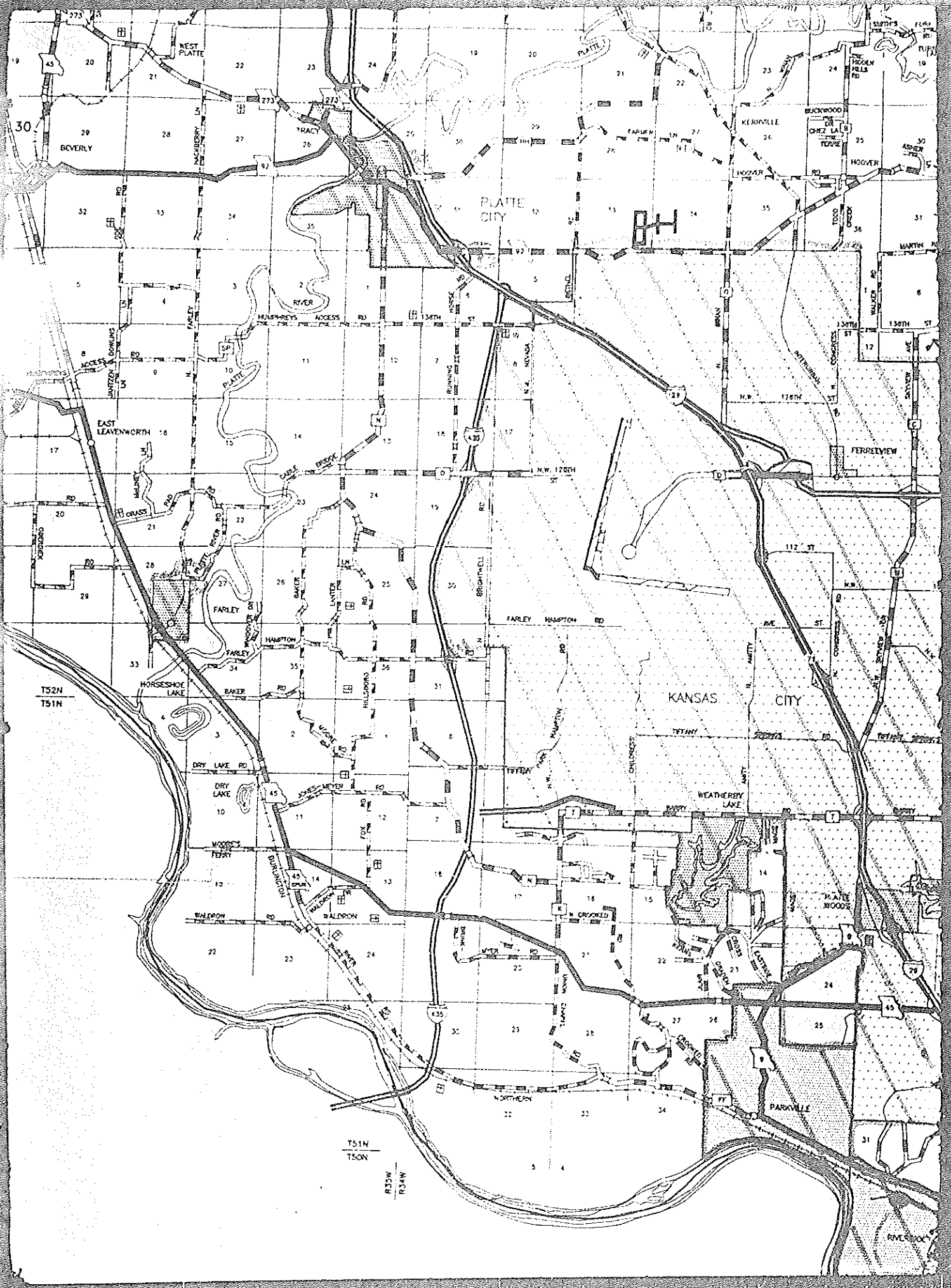

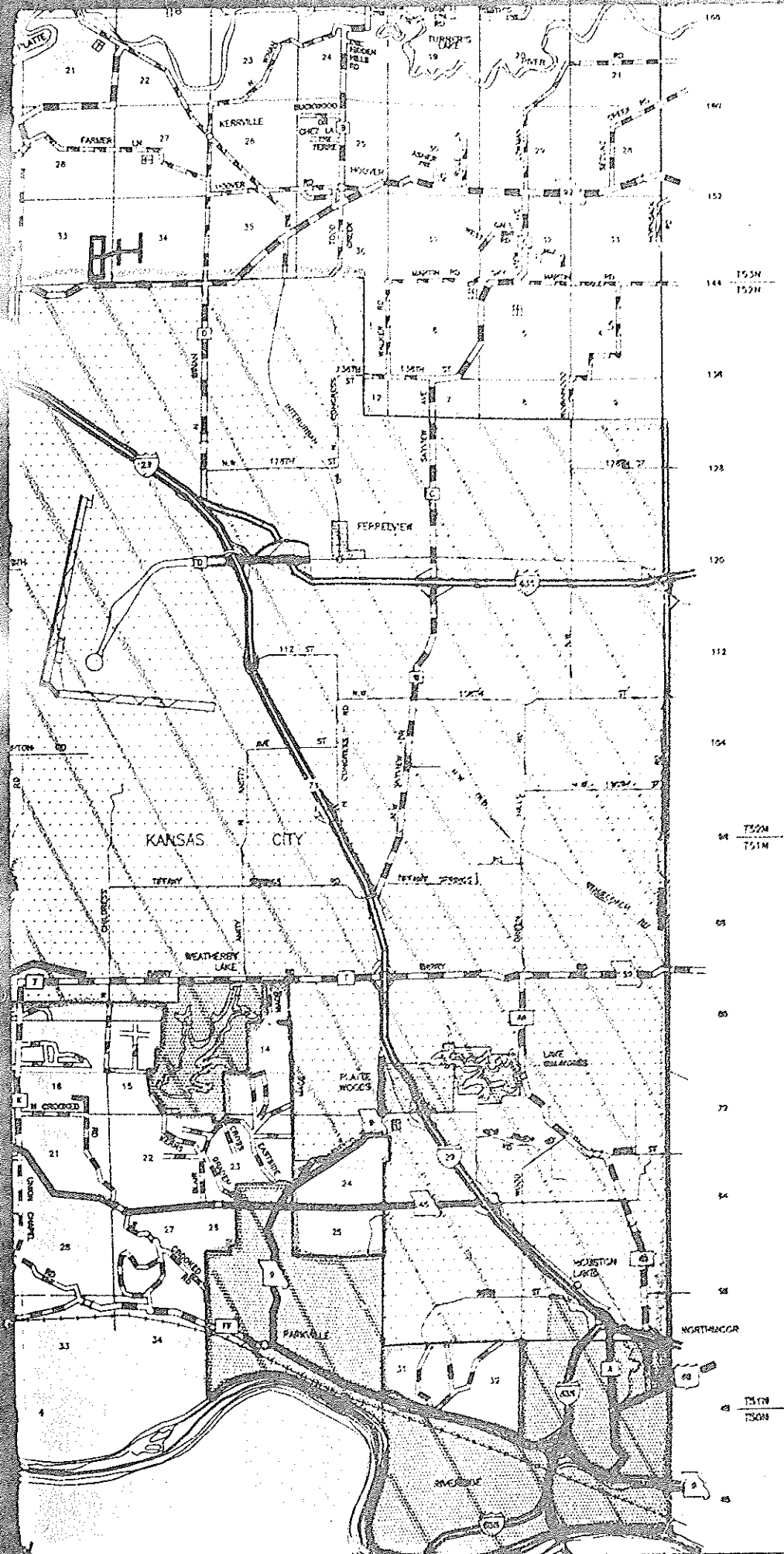

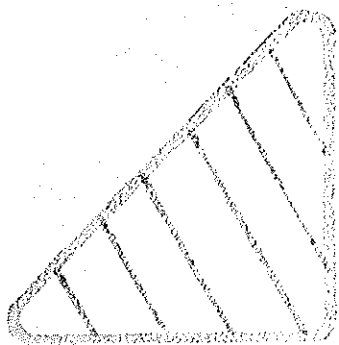

EXCLUDED BOUNDARIES

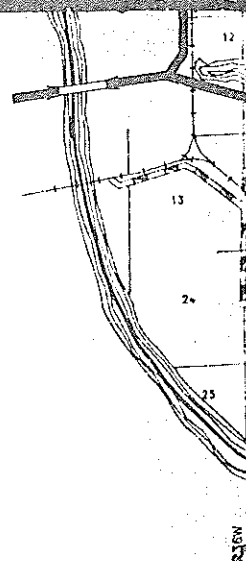

SCALE 1" = 5280'



MILLER ASSOCIATES
ENGINEERS, PLANNERS & SURVEYORS, INC.
Columbia, MO

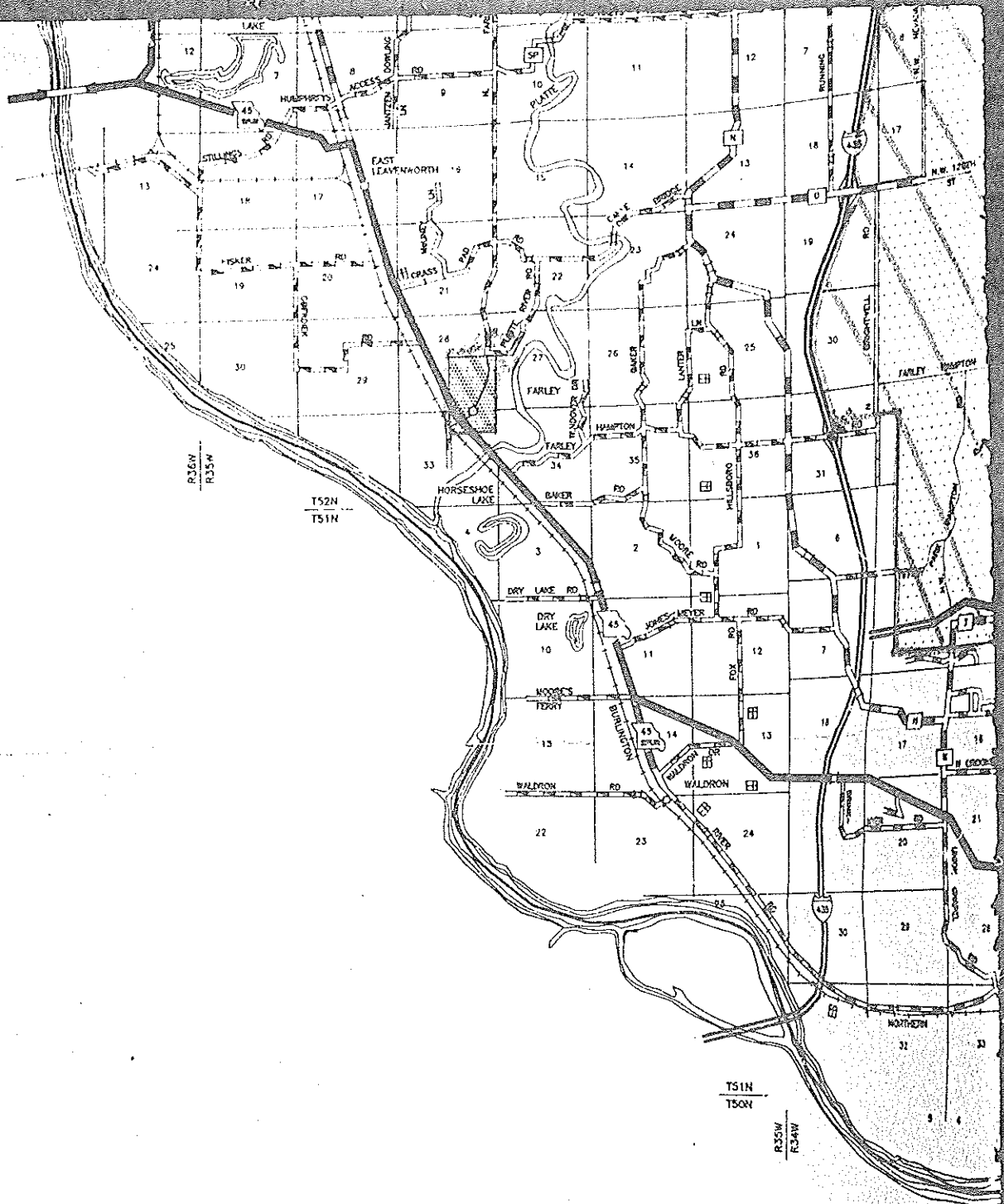

STATE OF MISSOURI, COUNTY OF PLATTE
 This is to certify that the foregoing is a true and
 exact copy of the documents on file in my office.
 Witness my hand and official seal this 8th
 day of February, 2010
 Clerk of Circuit Court SANDRA L. DOWD
 By Leesh Morris c.c.

FILED

FEB 17 1992

SANDRA L. DOWD

Clerk of Circuit Court, Platte County, MO

IN THE CIRCUIT COURT OF PLATTE COUNTY, MISSOURI
AT PLATTE CITY

In re:

The Matter of the Platte County
Regional Sewer District

The County Commission of
Platte County, Missouri,

Petitioner.

)
)
)
)
) Case No. CV191-2693CC
) Division I
)
)

O R D E R

Now on this 10th day of February, 1992, the report of Commissioners filed in the above-entitled cause is taken up and considered. The Court finds that the report and map filed by the Commissioners should be approved.

WHEREFORE, IT IS ORDERED, ADJUDGED AND DECREED that:

1. The County Commission shall call an election of the voters of the proposed district in order to approve the organization and incorporation of the proposed Platte County Regional Sewer District, with the boundaries of said proposed district as defined in the Report and map filed by the Commissioners; and

2. A copy of the Report of Commissioners and attached map shall be filed with the Recorder of Deeds and with the Platte County Commission.

STATE OF MISSOURI COUNTY OF PLATTE

This is to certify that the foregoing is a true and exact copy of the documents on file in my office.

Witness my hand and official seal this 8th

day of February 20 10

Clerk of Circuit Court SANDRA L. DOWD

By Teresh Morris D.C.

JUDGE [Signature]

CLARK L. DOWD
Clerk of the Circuit Court Platte County, MO

Seal of the County Clerk

AFFIDAVIT OF PUBLICATION

THE KANSAS CITY STAR COMPANY, publishers of THE KANSAS CITY STAR, a newspaper published in the City of Kansas City, County of Jackson, State of Missouri, confirms that the notice and/or advertisement of:

McGinness & Shaw
PO Box 168
Platte City, MO 64079

a true copy of which is hereto attached, was duly published in the above said newspaper

FOR THE PERIOD OF: 5 Days

COMMENCING: JANUARY 12

ENDING: JANUARY 16

STAR EDITION: JANUARY 12, 13, 14, 15, 16

STAR PAPER #: 117, 118, 119, 120, 121

VOLUME # 112

Kenn Smith

Subscribed and sworn to before me,
this 11th day of FEBRUARY, 1992.
I certify that I was duly qualified
as a Notary Public for the State of
Missouri, commissioned in Jackson County,
Missouri. My commission expires
September 17, 1995.

Pamela D. Lee
NOTARY

PUBLIC NOTICE
Please take notice that on
February 3, 1992, at 1:00
o'clock p.m. in the Platte
County Administration
Building, at 407 Third
Street, Platte City, Missouri,
the Commissioners appointed by the Circuit
Court of Platte County,
Missouri to establish the
boundaries of a proposed
common sewer district
shall hold a public hearing
to discuss the boundaries
of the proposed district. All
interested parties will be
given a chance to offer
their opinions on this issue.
Wallace Beasley
Joe Collison
Don Soper
Commissioners

STATE OF MISSOURI, COUNTY OF PLATTE

This is to certify that the foregoing is a true and
exact copy of the documents on file in my office.
Witness my hand and official seal this 8th

day of February 20, 1992

Clerk of Circuit Court SANDRA L. DOWD

By Leresa Morris D.C.

IN THE CIRCUIT COURT OF PLATTE COUNTY, MISSOURI
AT PLATTE CITY

FILED

In re:

APR 15 1992

The Matter of the Platte County)
Regional Sewer District)

SANDRA L. DOWD

Clerk of the Circuit Court Platte County, MO

The County Commission of)
Platte County, Missouri,)
Petitioner.)

Case No. CV191-2693CC
Division I

DECREE OF INCORPORATION OF THE PLATTE COUNTY
REGIONAL SEWER DISTRICT

WHEREAS an election concerning the proposition of the organization and incorporation of the Platte County Regional Sewer District was duly held on the 7th day of April, 1992, and the County Clerk has certified to the Court the results of the election, the Court finds that a majority of the votes cast in the election were in favor of the organization and incorporation of the proposed district as a common sewer district pursuant to Section 204.280 RSMo. 1986.

WHEREFORE, IT IS ORDERED, ADJUDGED AND DECREED that the Platte County Regional Sewer District be, and is hereby incorporated as a common sewer district and a separate body corporate as of April 15, 1992.

Ward B. Stuckey
JUDGE

STATE OF MISSOURI COUNTY OF PLATTE
This is to certify that the foregoing is a true and
exact copy of the documents on file in my office.
Witness my hand and official seal this 8th
day of February 20 10
Clerk of Circuit Court SANDRA L. DOWD
By Loren Morris b.c.