

**LAW OFFICE**  
**WITHERS, BRANT, IGOE & MULLENNIX**

A PROFESSIONAL CORPORATION

TWO SOUTH MAIN STREET

LIBERTY, MISSOURI 64068

816-781-4788

FAX 816-792-2807

CONN WITHERS (1907-1993)

JEROME E. BRANT

VINCENT F. IGOE, JR.

RONALD C. MULLENNIX

STEVEN D. WOLCOTT

JOHN M. CROSSETT

THOMAS C. CAPPS

ALISON K. BLESSING\*

MARK E. KELLY\*

MICHAEL S. SHIPLEY

JOSEPH F. O'HARA

NANCY A. NORTON\*\*

SUSAN E. LONG\*

LEIGH A. GOUCHER\*

DUANE A. MARTIN\*

\*ALSO ADMITTED IN KANSAS

\*\*RETIRED

February 7, 2000

**FILED<sup>2</sup>**

FEB 10 2000

Missouri Public  
Service Commission

Mr. Dale Hardy Roberts  
Secretary/Chief Regulatory Law Judge  
Missouri Public Service Commission  
PO Box 360  
Jefferson City, Missouri 65102

Re: Wil Mar Estates Subdivision - Case No. SA-2000-248  
Fox Run Estates Subdivision - Case No. SA-2000-105

Dear Mr. Roberts:

Enclosed for filing on behalf of Central Rivers for Wil Mar Estates and Fox Run Estates, please find an original and six (6) copies of the Tariff.

If there are any questions regarding the filing, please direct them to the undersigned. I thank you in advance for your attention to and cooperation in this matter.

Sincerely,

Mark E. Kelly

MEK/adb

Enclosures

cc: Mr. Kevin Hawthorne  
Mr. Mark Geisinger  
Office of the Public Counsel  
General Counsel

200000724

6

Name of Utility: **Central Rivers Wastewater Utility, Inc.**

For Service Areas in the State of Missouri

**Rules Governing Rendering of Sewer Service****INDEX**

Sheet No.

1	Index	+
2	Intentionally left blank	
3	Map of Countryside Meadows Service Area	
4	Map of Fox Run Subdivision Service Area	+
5	Map of Wil Mar Estates Subdivision Service Area	+
6	Intentionally left blank for future maps	
7	Description of Service Area: Sewer – Countryside Meadows Subdivision	
8	Description of Service Area: Sewer – Wil Mar Estates Subdivision	+
9	Description of Service Area: Sewer – Fox Run Subdivision	+
10	Intentionally left blank for future descriptions	
11	Intentionally left blank for future descriptions	
12	Schedule of Rates for Countryside Meadows Service Area	+
13	Intentionally left blank for future Schedules of Rates	
14	Schedule of Charges	+
15	Schedule of Charges	
16	Intentionally left blank for future Schedules of Charges	
17	Intentionally left blank	
18	Intentionally left blank	

Rule No.

18-21	1.	Definitions
22	2.	General
23	3.	Limited Authority of Company Employees
24-25	4.	Application for Sewer Service
26-28	5.	Inside Piping and Customer Service Sewers
29-32	6.	STEP or STEG Systems
33-34	7.	Improper or Excessive Use
35-36	8.	Discontinuance of Service by Company
37	9.	Interruptions in Service
38-39	10.	Bills for Services
40	11.	Special Contract for Excessive Capacity
41-44	12.	Extension of Collecting Sewer

\*indicates new rate or text

+indicates change

DATE OF ISSUE February 7, 2000 DATE EFFECTIVE March 15, 2000 +  
 Month Day Year Month Day Year

ISSUED BY : Mark Geisinger President P. O. V Box 459, Kearney, MO 64060 +  
 Name of Officer Title Address

Name of Utility: **Central Rivers Wastewater Utility, Inc.**  
For Service Areas in the State of Missouri

## Rules Governing Rendering of Sewer Service

### Map of Fox Run Subdivision Service Area

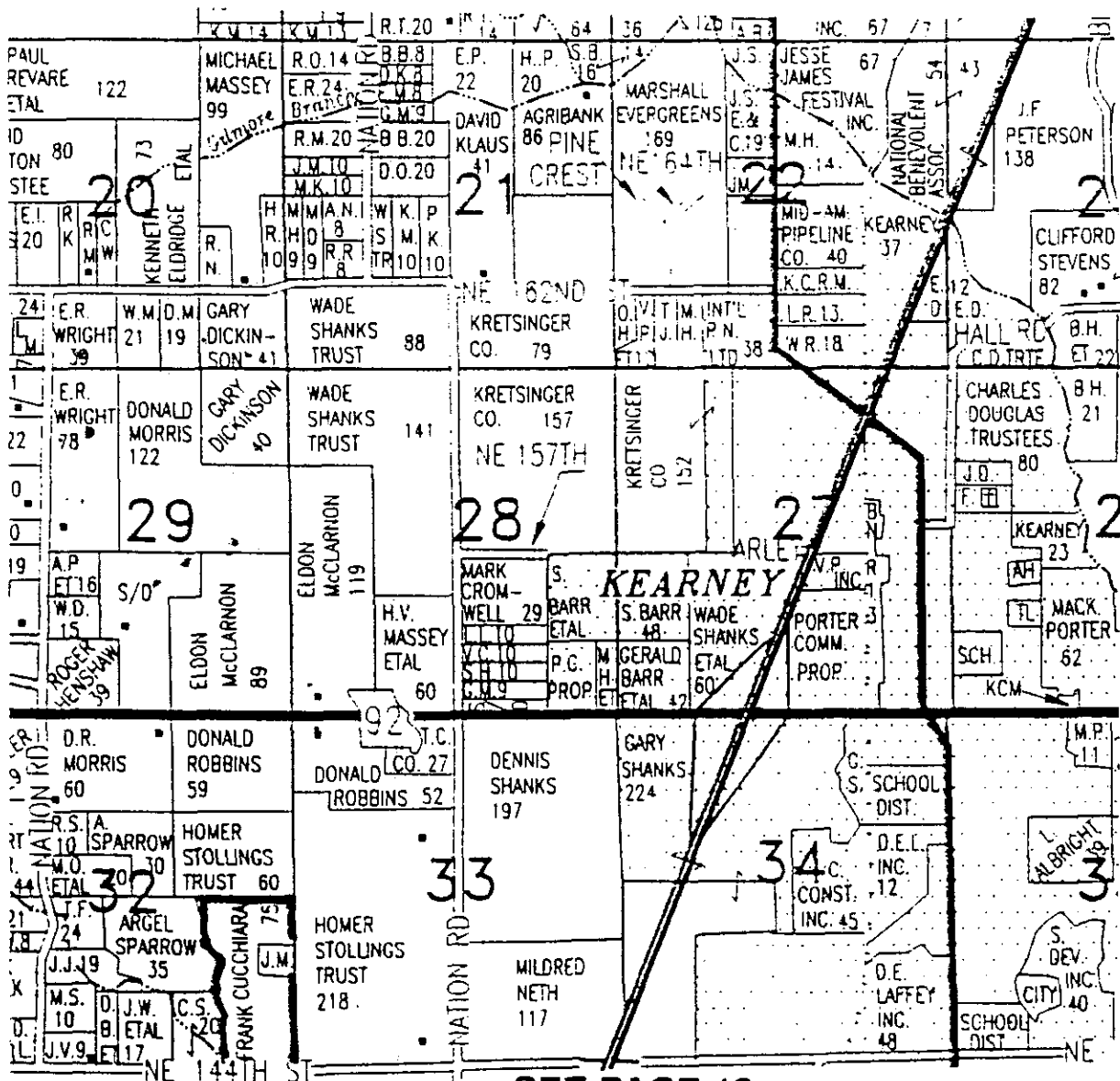

**SEE PAGE 18**

© 1996 Mil

\*indicates new rate or text

+indicates change

DATE OF ISSUE February 7, 2000  
Month Day Year

DATE EFFECTIVE    March 15, 2000    +  
                                 Month    Day    Year

ISSUED BY : Mark Geisinger President P. O. V Box 459, Kearney, MO 64060

Name of Utility: **Central Rivers Wastewater Utility, Inc.**  
For Service Areas in the State of Missouri

Rules Governing Rendering of Sewer Service

Map of Wil Mar Estates Subdivision service Area

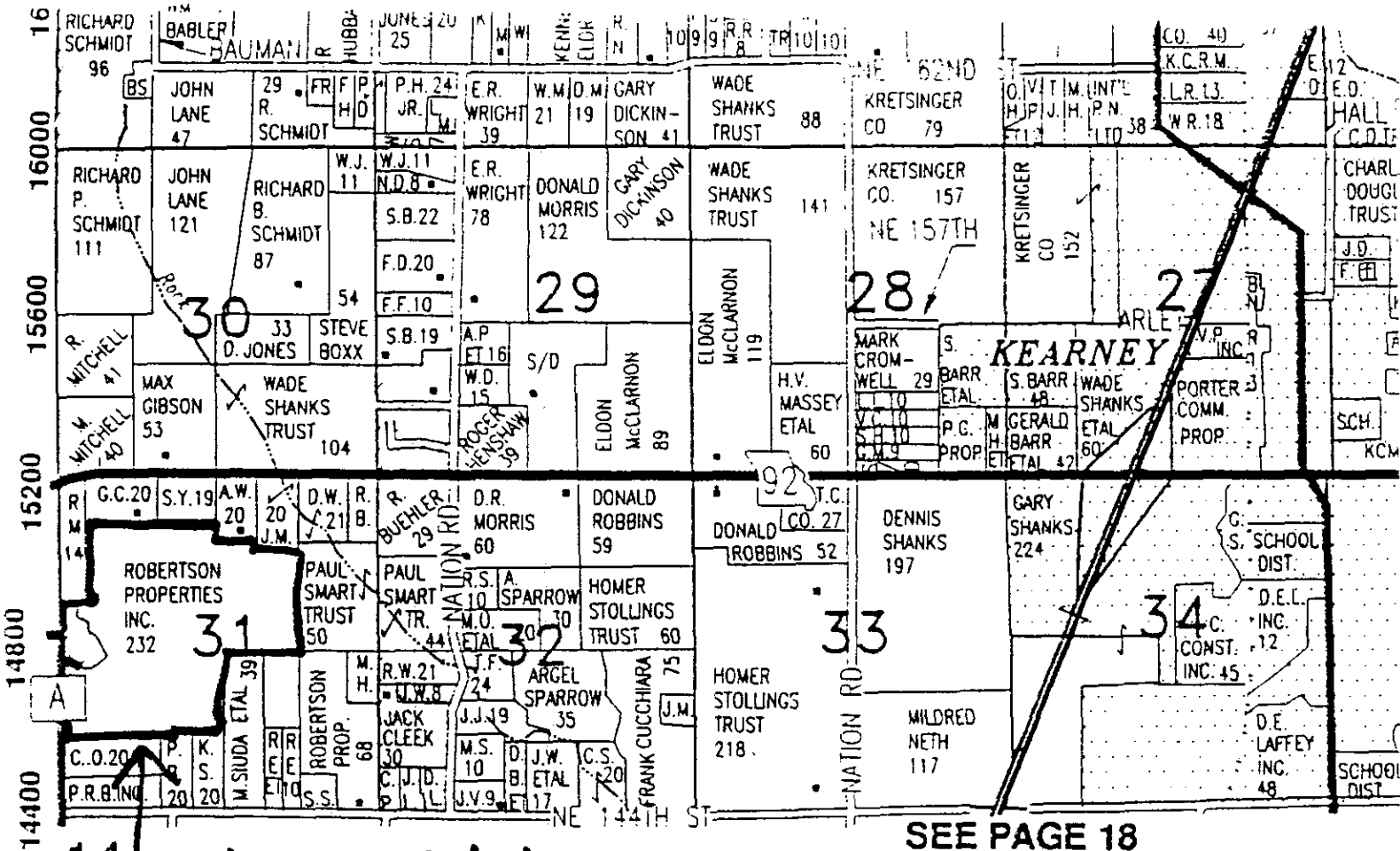

14 Wil Mar Estates

SEE PAGE 18

© 199

\*indicates new rate or text

+indicates change

DATE OF ISSUE February 7, 2000 DATE EFFECTIVE March 15, 2000 +  
Month Day Year Month Day Year

ISSUED BY : Mark Geisinger President P. O. V Box 459, Kearney, MO 64060 +  
Name of Officer Title Address

Name of Utility: **Central Rivers Wastewater Utility, Inc.**  
For Service Areas in the State of Missouri

**Rules Governing Rendering of Sewer Service**

Description of Service Area: Sewer – **Wil Mar Estates Subdivision** +

Sewer Company general description for sewer service area in Fox Run Subdivision, Clay County.

**General Description:**

A subdivision located approximately three miles West of Kearney Missouri, South ½ mile on Missouri State Highway A to the entrance of subdivision. This service area includes platted lots of Wil Mar Estates EXCEPT all the portions platted as WIL MAR ESTATES FIRST PLAT.

**Legal Description:**

Those portions of Section 36 T53N, R32W and Section 31, T53N, R31W of the 5<sup>th</sup> P.M., Clay County, Missouri, described as follows: Beginning at the E ¼ corner of said Section 36 (also the W ¼ corner of said Section 31), thence N00-23-23E, 406.78 feet along the East line of said Section 36 (also the West line of said Section 31), thence N47-57-00W, 620.51 feet; thence S89-55-28W, 810.59 feet to the Easterly right of way line of Missouri Highway "A"; thence N00-02-35E, 614.49 feet along said r.o.w. line; thence N00-03-00E, 174.61 feet along said r.o.w. line; thence N89-55-28E, 1106.74 feet; thence S00-23-23W, 496.42 feet; thence N89-55-01E, 550.00 feet; thence N00-23-23E, 791-44 feet; thence S89-00-27E, 2096.26 feet; thence South 285.56 feet; thence East 783.20 feet; thence S00-04-00W, 49.11 feet; thence S89-05-15E, 764.29 feet to the East line of the W ½ of the NE ¼ of said Section 31; thence S00-04-00W, 1517.95 feet along said East line to the SE corner of said W ½ NE ¼; thence S89-54-12W, 1317.50 feet to the center of said Section 31; thence S00-00-10W, 1281.28 feet along the East line of the SW ¼ of said Section 31; thence N89-46-58W, 1060.40 feet; thence South 100.00 feet; thence N89-46-58W, 1615.01 feet to the Easterly right of way line of Missouri Highway "A"; thence N00-06-49W, 793.93 feet along said r.o.w. line; thence along a curve to the left having a radius of 607.96 feet, through a central angle of 70-27-13, an arc distance of 747.58 feet along said r.o.w. line to the North line of the SE ¼ of said Section 36; thence N89-55-28E, 367.91 feet along said North line to the point of beginning, EXCEPT all that portion platted as WIL MAR ESTATES FIRST PLAT, a subdivision of land in Clay County, Missouri, according to the recorded plat thereof, said plat having been filed August 23, 1994 and recorded in Plat Cabinet D, at Sleeve 57.

\*indicates new rate or text

+indicates change

DATE OF ISSUE February 7, 2000 DATE EFFECTIVE March 15, 2000 +  
Month Day Year Month Day Year

ISSUED BY : Mark Geisinger President P. O. V Box 459, Kearney, MO 64060 +  
Name of Officer Title Address

Name of Utility: **Central Rivers Wastewater Utility, Inc.**  
For Service Areas in the State of Missouri

**Rules Governing Rendering of Sewer Service**

**Description of Service Area: Sewer – Fox Run Subdivision**

Sewer Company general description for sewer service area in Fox Run Subdivision, Clay County.

**General Description:**

A subdivision located approximately ½ Mile West of Kearney Missouri on Missouri Highway 92, south on Nations Road 1 Mile, East on 144<sup>th</sup> street to the entrance of a 40 lot subdivision. This area generally includes the East ½ of the S.E. Quarter of Section 32, township 53N, Range 31W in Clay County Missouri.

**Legal Description:**

All that part of the Southeast Quarter of Section 32, Township 53, Range 31 in Clay County, Missouri described as follows: Beginning at the Southeast corner of the Southeast Quarter of said Section 32; thence North 89 degrees 45 minutes 16 seconds West along the South line of the Southeast Quarter of said Section 32, a distance of 50.00 feet; thence North 00 degrees 08 minutes 21 seconds West, a distance of 208.71 feet; thence North 89 degrees 45 minutes 18 seconds West, a distance of 208.71 feet; thence South 00 degrees 08 minutes 21 seconds East, a distance of 208.71 feet to a point on the South line of the Southeast Quarter of said Section 32; thence North 80 degrees 45 minutes 16 seconds West along the South line of the Southeast Quarter of said Section 32, a distance of 1024.48 feet; thence North 00 degrees 57 minutes 15 seconds West, a distance of 944.34 feet; thence North 50 degrees 12 minutes 27 seconds West, a distance of 180.72 feet; thence North 26 degrees 06 minutes 49 seconds West, a distance of 115.00 feet; thence North 21 degrees 34 minutes 02 seconds East, a distance of 196.46 feet; thence North 13 degrees 11 minutes 28 seconds East, a distance of 88.35 feet; thence North 78 degrees 19 minutes 20 seconds East, a distance of 287.04 feet; thence Northwesterly along a curve to the right, having an initial tangent bearing of North 12 degrees 15 minutes 28 seconds West and a radius of 480.00 feet, an arc distance of 4.86 feet; thence North 11 degrees 40 minutes 40 seconds West, a distance of 87.22 feet; thence North 78 degrees 19 minutes 20 seconds East, a distance of 285.00 feet; thence North 57 degrees 31 minutes 40 seconds East, a distance of 195.14 feet; thence South 11 degrees 40 minutes 40 seconds East, a distance of 331.84 feet; thence North 64 degrees 48 minutes 34 seconds East, a distance of 213.17 feet; thence North 00 degrees 09 minutes 34 seconds West, a distance of 133.92 feet; thence South 80 degrees 28 minutes 55 seconds East, a distance of 416.71 feet to a point on the East line of the Southeast Quarter of said Section 32; thence South 00 degrees 08 minutes 21 seconds East along the East line of the Southeast Quarter of said Section 32, a distance of 1566.06 feet to the Point of Beginning. Said tract of land contains 46.71 acres more or less.

\*indicates new rate or text

+indicates change

DATE OF ISSUE February 7, 2000 DATE EFFECTIVE March 15, 2000 +  
Month Day Year Month Day Year

ISSUED BY : Mark Geisinger President P. O. V Box 459, Kearney, MO 64060 +  
Name of Officer Title Address

Name of Utility: **Central Rivers Wastewater Utility, Inc.**  
For Service Areas in the State of Missouri

Rules Governing Rendering of Sewer Service

SCHEDULE OF RATES

AVAILABILITY:

Any Customer adjacent to the Company's sewer collection main or other Customer who can deliver sewage to a collection point within the Company's certified area in a manner compatible with the company's sewage collection and treatment system.

SEWER SERVICE RATES FOR SERVICE AREA:

COUNTRYSIDE MEADOWS SUBDIVISION, RAY COUNTY  
FOX RUN SUBDIVISION, CLAY COUNTY  
WIL MAR ESTATES SUBDIVISION, CLAY COUNTY

Residential:

Single Family Rate: \$ 32.00 per month  
Single family, duplex unit or unit of a multi-unit building  
where water utility service is or is not provided through  
individual water meters.

Commercial:

Minimum \$ 32.00/month plus \$2.50 per thousand gallons used over 6500 gallons/month

Sales, Gross Receipts, Occupation or Franchise Taxes:

SEE PROVISION ON SHEET 15.

\*indicates new rate or text

+indicates change

DATE OF ISSUE February 7, 2000 DATE EFFECTIVE March 15, 2000 +  
Month Day Year Month Day Year

ISSUED BY : Mark Geisinger President P. O. V Box 459, Kearney, MO 64060 +  
Name of Officer Title Address

Name of Utility: **Central Rivers Wastewater Utility, Inc.**  
For Service Areas in the State of Missouri

**Rules Governing Rendering of Sewer Service**  
**SCHEDULE OF SERVICE CHARGES**

**CONNECTION CHARGES:**

All single family residential customers utilizing a STEP system that the company will maintain shall pay a one-time \$4,500.00 connection charge for three bedroom homes and \$4,800 for four bedroom when making + application for service. This charge is inclusive of all accessories and inspections as hereinafter referenced.

All non-residential or multi-family service connection charges shall be at actual cost incurred by the Company in accordance with Rules 10 and 11. The Company shall have sole discretionary authority to decide who may install equipment and will provide a letter to any person, company, incorporation or other business entity that has the authority to install equipment that will ultimately be operated and maintained by Company. Upon request that person, company, incorporation or other business entity shall produce a letter stating in writing that they are so granted authority to install equipment that will ultimately be operated and maintained by Company and if so unable to produce said letter, that entity or person shall not install any equipment to be ultimately operated and maintained by company.

This charge does include: Cost for connecting the home to the sewer main. This includes any and all costs associated with the following: watertight septic tank, post construction testing of tank and system, pump or pumps, effluent filters, electrical control panel, splice box and wiring from control panel to septic tank, wiring from stubbed out electrical service at customer home to control panel (see Rule No. 6), 4" SCH 40 (or equal) piping from single family residence to septic tank up to 120 linear feet, 1" SCH 40 (or equal) piping from septic tank to main collection systems line up to 800 linear feet, risers and lids, service connection valves and appurtenances, inspections.

This charge does not include: any surveying to determine actual location of easements or property lines for customer, any electrical service beyond connecting to a 30 amp dedicated circuit and another minimum 20 amp circuit that need not be a dedicated circuit (minimum two separate circuits, see Rule 6) single phase electrical connection stubbed by customer to exterior of house, any plumbing closer than 5' of customer's building or residence,

Connection charges for STEG and Gravity collection systems will be based on actual costs as allowed by the Missouri Public Service Commission. The cost for a connection charge to a STEG or Gravity flow collection system will be stated in the Company's Tariff when data is obtained to present a reasonably accurate cost.

\*indicates new rate or text

+indicates change

DATE OF ISSUE February 7, 2000 DATE EFFECTIVE March 15, 2000 +  
Month Day Year Month Day Year

ISSUED BY : Mark Geisinger President P. O. V Box 459, Kearney, MO 64060 +  
Name of Officer Title Address