

LAW OFFICES
BRYDON, SWEARENGEN & ENGLAND

PROFESSIONAL CORPORATION

312 EAST CAPITOL AVENUE

P.O. BOX 456

JEFFERSON CITY, MISSOURI 65102-0456

TELEPHONE (573) 635-7166

FACSIMILE (573) 635-3847

E-MAIL: DCOOPER@BRYDONLAW.COM

DAVID V.G. BRYDON
JAMES C. SWEARENGEN
WILLIAM R. ENGLAND, III
JOHNNY K. RICHARDSON
GARY W. DUFFY
PAUL A. BOUDREAU
SONDRA B. MORGAN
CHARLES E. SMARR

DEAN L. COOPER
MARK G. ANDERSON
TIMOTHY T. STEWART
GREGORY C. MITCHELL
BRIAN T. MCCARTNEY
DALE T. SMITH
BRIAN K. BOGARD

OF COUNSEL
RICHARD T. CIOTTONE

April 19, 2001

FILED³

APR 19 2001

Missouri Public
Service Commission

Mr. Dale Hardy Roberts
Public Service Commission
P. O. Box 360
Jefferson City, MO 65102

RE: **Foxfire Utility Company** ~~Case No. WA-2001-53~~ *OK rh*

Dear Mr. Roberts:

WA-2001-53

Enclosed for filing in the above-referenced proceeding please find an original and eight copies of a Motion for Expedited Treatment and Effective Date of Fewer Than Thirty Days. Please stamp the enclosed extra copy "filed" and return same to me.

If you have any questions concerning this matter, then please do not hesitate to contact me. Thank you very much for your attention to this matter.

Sincerely,

BRYDON, SWEARENGEN & ENGLAND P.C.

By:

DL Cooper
Dean L. Cooper

DLC/rhg

Enclosures

cc: Office of the Public Counsel
Mr. Cliff Snodgrass
Ms. Ruth O'Neill

200101076

200101076

FORM No. 13

P.S.C. Mo. No. 1 1st {Revised} Sheet No. W 1
Canceling P.S.C. Mo. No. 1 {Original} Sheet No. W 1

Foxfire Utility Company, Inc.
Name of Issuing Corporation

Benton and Stone County Service Area
Community, Town or City

*

Rules and Regulations Governing
Rendering of Service

FOXFIRE UTILITY COMPANY
Water Division
Jefferson City, Missouri

SERVICE AREA DEFINITION
SCHEDULE OF RATES
SCHEDULE OF SERVICE CHARGES
RULES AND REGULATIONS

*Indicates new rate or text
+Indicates change

DATE OF ISSUE April 19, 2001 DATE EFFECTIVE May 19, 2001

ISSUED BY Garrah F. Helms, President 323 Fox Creek Road, Jefferson City, MO 65102
Name of Officer Title Address

FORM No. 13

P.S.C. Mo. No. 1 ^{1st} {Revised} Sheet No. W2
 Canceling P.S.C. Mo. No. 1 {Original} Sheet No. W2

Foxfire Utility Company, Inc.
 Name of Issuing Corporation

For Benton and Stone County, MO
 Community, Town or City

<u>Water Division</u>		
	<u>Sheet No.</u>	
Title Page	W 1	*
Index	W 2	*
Map of Stone County Service Area	WM 1	
Map of Benton County Service Area	WM 2	*
Legal Description of Stone County Service Area	WL 1-2	
Legal Description of Benton County Service Area	WL 3	*
Schedule of Rates for Stone County Service Area	WR 1	
Schedule of Rates for Benton County Service Area	WR 2	*
Schedule of Service Charges	WSC 1	*
<u>Rule No</u>		
A Applicability of Rules	WRR A	*
1 Definitions	WRR 1-6	
2 General Rules and Regulations	WRR 7-8	
3 Company Employees and Customer Relations	WRR 9	
4 Applications for Service	WRR 10-11	
5 Inside piping and Customer Service Lines	WRR 12-15	
6 Improper or Excessive Use	WRR 16-17	
7 Discontinuance of Service by Company	WRR 18-21	
8 Discontinuance of Service by Customer's Request	WRR 22	
9 Interruption in Service	WRR 23	
10 Bills for Service	WRR 24-29	
11 Meters and Meter Installations	WRR 30-34	
12 Meter Tests and Test Fees	WRR 35	
13 Bill Adjustments Based on Meter Tests	WRR 36-37	
14 Extension of Water System	WRR 38-46	
<u>Exhibits</u>		
A Extension Agreement (Individual)	WE 1-10	
B Extension Agreement (Developer)	WE 11-18	
*Indicates new rate or text		
+Indicates change		

DATE OF ISSUE April 19, 2001 DATE EFFECTIVE May 19, 2001

ISSUED BY Garah F. Helms, President 323 Fox Creek Road, Jefferson City, MO 65109
 Name of Officer Title Address

Foxfire Utility Company, Inc.
Name of Issuing Corporation

For Benton County Service Area
Community, Town or City

Map of Service Area

*

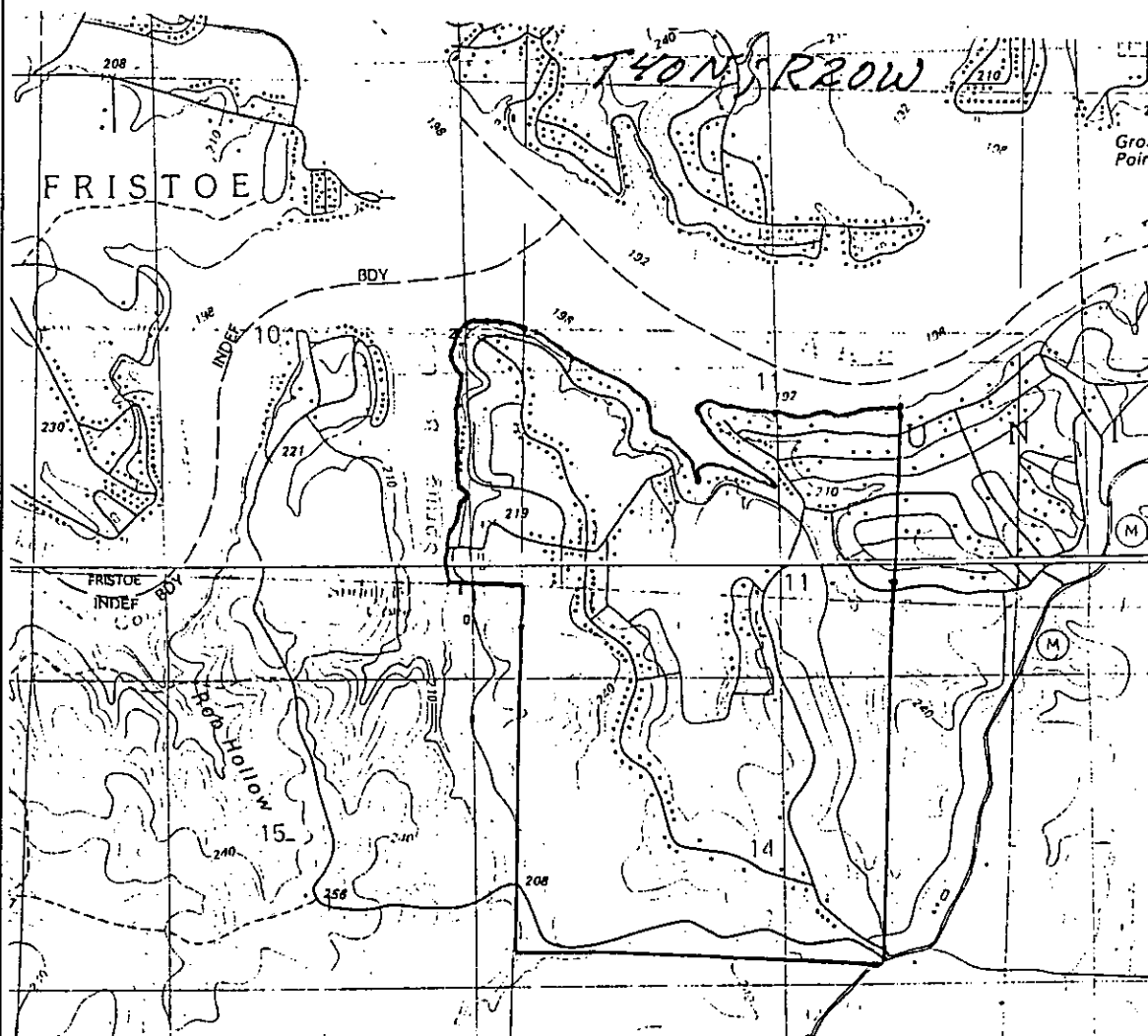

*Indicates new rate or text
+Indicates change

DATE OF ISSUE April 19, 2001 DATE EFFECTIVE May 19, 2001

ISSUED BY Garah F. Helms, President 323 Fox Creek Road, Jefferson City, MO 65102
Name of Officer Title Address

Foxfire Utility Company, Inc.
Name of Issuing Corporation

For Benton County Service Area
Community, Town or City

Legal Description of Service Area	*
<p>Beginning at the SW corner of the NW 1/4 of the SW 1/4 of Section 14; T40N; R21W in Benton County, MO; thence north along the 1/4 section line parallel to the East section line of section 14 to the shore of the Lake of the Ozarks, thence in a westerly direction along the shoreline to Spring Branch Cove; thence in a southerly direction along the cove shoreline to the south line of section 10; T40N; R21W; thence east along the south line of section 10 to the SE corner of section 10 which is also the NW corner of section 14, thence south along the west line of section 14 to the NW corner of the SW 1/4 of the SW 1/4 of section 14, thence east along the north line of this 1/4, 1/4 section and parallel to the south line to section 14 to the point of beginning.</p>	

*Indicates new rate or text
+Indicates change

DATE OF ISSUE April 19, 2001 DATE EFFECTIVE May 19, 2001

ISSUED BY Garah F. Helms, President 323 Fox Creek Road, Jefferson City, MO 65102
Name of Officer Title Address

Foxfire Utility Company, Inc.
Name of Issuing Corporation

For Benton County, MO
Community, Town or City

Schedule of Rates

*

A. Application -- The following monthly water service charges will be in effect for Customers of Foxfire Utility Company located within the Company's Benton County Service Area, also identified as the Spring Branch water system serving a subdivision known as Lake Arrowhead Estates.

Service Charge for Customers who are full time residents:

\$22.28 per month (Flat Rate)

Service Charge for Customers who are part time residents:

\$19.00 per month (Flat Rate)

All Applicable Federal, State and Local Taxes shall be in addition to the above charges.

*Indicates new rate or text

+Indicates change

DATE OF ISSUE April 19, 2001 DATE EFFECTIVE May 19, 2001

ISSUED BY Garah F. Helms, President 323 Fox Creek Road, Jefferson City, MO 65109
Name of Officer Title Address

Foxfire Utility Company, Inc.
Name of Issuing Corporation

Benton and Stone County Service Areas
Community, Town or City

Schedule of Service Charges

A. Application: The following water service charges are in effect for Customers of Foxfire Utility Company in all Missouri Service Areas.

Meter Test	\$ 25.00
Connection Fee (metered service)	\$300.00
Connection Fee (flat rate service – no meter)	\$250.00
Turn-on	\$ 10.00
Turn-on & Turn –off (After Hours)	\$ 20.00

*

*Indicates new rate or text
+Indicates change

DATE OF ISSUE April 19, 2001 DATE EFFECTIVE May 19, 2001

ISSUED BY Garah F. Helms, President 323 Fox Creek Road, Jefferson City, MO 65102
Name of Officer Title Address

Foxfire Utility Company, Inc.
Name of Issuing Corporation

For Benton and Stone County Service Areas
Community, Town or City

APPLICABILITY OF RULES

*

All rules and regulations are applicable to both Benton and Stone Counties as a result of Commission Case No. WA-2001-53.

*Indicates new rate or text
+Indicates change

DATE OF ISSUE April 19, 2001 DATE EFFECTIVE May 19, 2001

ISSUED BY Garah F. Helms, President 323 Fox Creek Road, Jefferson City, MO 65102
Name of Officer Title Address