



Missouri-American Water Company  
 Name of Issuing Corporation

For

St Louis County Service Area  
 Community, Town or City

<b>Rate A</b>			
<b>Meter Rate – Residential, Commercial and Other</b>			
<b>AVAILABILITY</b> – This rate is available to all residential (“domestic”), commercial, industrial, and other public authority metered customers.			
<b>MINIMUM CUSTOMER CHARGE</b> – The minimum charge for water service available through the facilities of the Company for the billing period and for the meter size furnished the customer is:			
<u>Meter Size</u>	<u>Monthly Billing</u>	<u>Quarterly Billing</u>	
5/8”	\$9.00	\$27.00	+
3/4”	\$12.25	\$36.75	+
1”	\$16.58	\$49.74	+
1-1/2”	\$27.42	\$82.26	+
2”	\$40.43	\$121.29	+
3”	\$71.10	\$213.30	+
4”	\$114.11	\$342.33	+
6”	\$222.47	\$667.41	+
8”	\$379.54	\$1,138.62	+
10”	\$637.71	\$1,913.13	+
12”	\$765.25	\$2,295.75	+
<b>COMMODITY CHARGE</b> – In addition to the Minimum Customer Charge, the Commodity Charge for all water used registered by the meter is \$0.47814 per 100 gallons or \$4.7814 per 1,000 gallons.			+
<b>PAYMENT TERMS</b> - All bills for service under this schedule will be rendered in arrears either on a monthly or quarterly basis. The due date on the tariff shall be ten (10) days after the "date of rendition" of the bill to the customer. The customer's bill will be due and payable after this due date. The delinquent date printed on the bill will not be less than twenty-one (21) days after the date of the postmark of the bill. Any accounts remaining unpaid at the expiration of twenty-one (21) days shall be considered delinquent and the Company may take such action as specified in its filed rules and regulations.			
<b>TAXES</b> - These rates do not include any municipal, state or federal taxes computed on either billing or consumption basis. Any such taxes applicable shall be added as separate items in rendering each bill.			*

\* *Indicates new rate or text*

+ *Indicates change*

Date of Issue: May 4, 2018                      Effective Date: June 3, 2018

Issued By: Cheryl Norton, President  
727 Craig Road, St. Louis, MO 63141

Missouri-American Water Company

For

All Missouri Service Areas Outside of St. Louis County  
 and Outside of Mexico

Name of Issuing Corporation

Community, Town or City

<b>Rate A</b>		
<b>Meter Rate – Residential, Commercial and Other</b>		
<b>AVAILABILITY</b> – This rate is available to all residential (“domestic”), commercial, industrial, and other public authority metered customers.		
<b>MINIMUM CUSTOMER CHARGE</b> – The minimum charge for water service available through the facilities of the Company for the billing period and for the meter size furnished the customer is:		
<b>Meter Size</b>	<b>Monthly Billing</b>	
5/8”	\$9.00	+
3/4”	\$12.25	+
1”	\$16.58	+
1-1/2”	\$27.42	+
2”	\$40.43	+
3”	\$71.10	+
4”	\$114.11	+
6”	\$222.47	+
8”	\$379.54	+
10”	\$637.71	+
12”	\$765.25	+
<b>COMMODITY CHARGE</b> – In addition to the Minimum Customer Charge, the Commodity Charge for all water used as registered by the meter is \$0.62469 per 100 gallons or \$6.2469 per 1,000 gallons.		+
<b>FLAT RATE</b> - Customers who do not have water meters will be billed a monthly charge of \$48.40. When bills are rendered for a period of less than one-half (1/2) of a complete billing period due to connection or termination of service, the billing shall be for one-half(1/2) the monthly charge; if a bill is rendered for a period equal to or greater than one-half (1/2) of a complete billing period due to connection or termination of service, the billing shall be for the full monthly charge.		+
<b>PAYMENT TERMS</b> - All bills for service under this schedule will be rendered in arrears on a monthly basis. The due date on the tariff shall be ten (10) days after the "date of rendition" of the bill to the customer. The customer's bill will be due and payable after this due date. The delinquent date printed on the bill will not be less than twenty-one (21) days after the date of the postmark of the bill. Any accounts remaining unpaid at the expiration of twenty-one (21) days shall be considered delinquent and the Company may take such action as specified in its filed rules and regulations.		
<b>TAXES</b> - These rates do not include any municipal, state or federal taxes computed on either billing or consumption basis. Any such taxes applicable shall be added as separate items in rendering each bill.		*

\* *Indicates new rate or text*

+ *Indicates change*

Date of Issue:

May 4, 2018

Effective Date:

June 3, 2018

Issued By:

Cheryl Norton, President

727 Craig Road, St. Louis, MO 63141

Missouri-American Water Company  
 Name of Issuing Corporation

For

Mexico Service Area  
 Community, Town or City

<b>Rate A</b>		
<b>Meter Rate – Residential, Commercial and Other</b>		
<p><b>AVAILABILITY</b> – This rate is available to all residential (“domestic”), commercial, industrial, and other public authority metered customers.</p>		
<p><b>MINIMUM CUSTOMER CHARGE</b> – The minimum charge for water service available through the facilities of the Company for the billing period and for the meter size furnished the customer is:</p>		
<u>Meter Size</u>	<u>Monthly Billing</u>	
5/8”	\$9.00	+
3/4”	\$12.25	+
1”	\$16.58	+
1-1/2”	\$27.42	+
2”	\$40.43	+
3”	\$71.10	+
4”	\$114.11	+
6”	\$222.47	+
8”	\$379.54	+
10”	\$637.71	+
12”	\$765.25	+
<p><b>RESIDENTIAL COMMODITY CHARGE</b> – In addition to the Minimum Customer Charge, the Commodity Charge for all water used as registered by the meter is:</p>		
<u>Monthly Consumption</u>	<u>per 100 Gallons</u>	<u>per 1,000 Gallons</u>
Up to 3,000 Gallons	\$0.58887	\$5.8887
Next 7,000 Gallons	\$0.67720	\$6.7720
Over 10,000 Gallons	\$0.84650	\$8.4650
<p><b>NON-RESIDENTIAL COMMODITY CHARGE</b> – In addition to the Minimum Customer Charge, for all water used as registered by the meter, the Commodity Charge is \$0.62469 per 100 gallons or \$6.2469 per 1,000 gallons.</p>		
<p><b>PAYMENT TERMS</b> - All bills for service under this schedule will be rendered in arrears on a monthly basis. The due date on the tariff shall be ten (10) days after the "date of rendition" of the bill to the customer. The customer's bill will be due and payable after this due date. The delinquent date printed on the bill will not be less than twenty-one (21) days after the date of the postmark of the bill. Any accounts remaining unpaid at the expiration of twenty-one (21) days shall be considered delinquent and the Company may take such action as specified in its filed rules and regulations.</p>		
<p><b>TAXES</b> - These rates do not include any municipal, state or federal taxes computed on either billing or consumption basis. Any such taxes applicable shall be added as separate items in rendering each bill.</p>		

\* *Indicates new rate or text*

+ *Indicates change*

Date of Issue: May 4, 2018                      Effective Date: June 3, 2018

Issued By: Cheryl Norton, President  
727 Craig Road, St. Louis, MO 63141

Missouri-American Water Company  
Name of Issuing Corporation

For

\_\_\_\_\_  
Community, Town or City

<b>HELD FOR FUTURE USE</b>	
----------------------------	--

\* *Indicates new rate or text*

+ *Indicates change*

Date of Issue: May 4, 2018      Effective Date: June 3, 2018

Issued By: Cheryl Norton, President  
727 Craig Road, St. Louis, MO 63141

Missouri-American Water Company  
Name of Issuing Corporation

For

\_\_\_\_\_  
Community, Town or City

<b>HELD FOR FUTURE USE</b>	

\* *Indicates new rate or text*

+ *Indicates change*

Date of Issue: May 4, 2018

Effective Date: June 3, 2018

Issued By: Cheryl Norton, President  
727 Craig Road, St. Louis, MO 63141

Missouri-American Water Company  
 Name of Issuing Corporation

For

All Missouri Service Areas  
 Community, Town or City

<b>Rate B</b>		
<b>Sale of Water for Resale</b>		
<p><b>AVAILABILITY</b> – This rate is available for supply of water for resale by Public Water Supplies under the terms and conditions of their contract.</p>		+
<p><b>MINIMUM CUSTOMER CHARGE</b> – The minimum charge for water service available through the facilities of the Company for the billing period and for the meter size furnished the customer is:</p>		
<u>Meter Size</u>	<u>Monthly Billing</u>	
5/8"	\$9.00	+
3/4"	\$12.25	+
1"	\$16.58	+
1-1/2"	\$27.42	+
2"	\$40.43	+
3"	\$71.10	+
4"	\$114.11	+
6"	\$222.47	+
8"	\$379.54	+
10"	\$637.71	+
12"	\$765.25	+
<p><b>COMMODITY CHARGE</b> – In addition to the Minimum Customer Charge, the Commodity Charge for all water used as registered by the meter is \$0.26194 per 100 gallons or \$2.6194 per 1,000 gallons.</p>		+
<p><b>PAYMENT TERMS</b> - All bills for service under this schedule will be rendered in arrears on a monthly basis. The due date on the tariff shall be ten (10) days after the "date of rendition" of the bill to the customer. The customer's bill will be due and payable after this due date. The delinquent date printed on the bill will not be less than twenty-one (21) days after the date of the postmark of the bill. Any accounts remaining unpaid at the expiration of twenty-one (21) days shall be considered delinquent and the Company may take such action as specified in its filed rules and regulations.</p>		
<p><b>TAXES</b> - These rates do not include any municipal, state or federal taxes computed on either billing or consumption basis. Any such taxes applicable shall be added as separate items in rendering each bill.</p>		*

\* Indicates new rate or text

+ Indicates change

Date of Issue: May 4, 2018                      Effective Date: June 3, 2018

Issued By: Cheryl Norton, President  
727 Craig Road, St. Louis, MO 63141

Missouri-American Water Company  
Name of Issuing Corporation

For

\_\_\_\_\_  
Community, Town or City

<b>HELD FOR FUTURE USE</b>	

\* *Indicates new rate or text*

+ *Indicates change*

Date of Issue:

May 4, 2018

Effective Date:

June 3, 2018

Issued By:

Cheryl Norton, President

727 Craig Road, St. Louis, MO 63141



Missouri-American Water Company  
Name of Issuing Corporation

For

\_\_\_\_\_  
Community, Town or City

<b>HELD FOR FUTURE USE</b>	

\* *Indicates new rate or text*

+ *Indicates change*

Date of Issue: May 4, 2018

Effective Date: June 3, 2018

Issued By: Cheryl Norton, President  
727 Craig Road, St. Louis, MO 63141

Missouri-American Water Company  
 Name of Issuing Corporation

For

All Missouri Service Areas  
 Community, Town or City

<b>Rate F</b>			
<b>Private Fire Protection</b>			
<b>AVAILABILITY</b> – This rate is available for hydrants that are placed on private property and attached to public mains.			+
<b>MINIMUM CUSTOMER CHARGE</b> – The minimum charge for water service available through the facilities of the Company for the billing period and for hydrants that are placed on private property and attached to public mains is:			
	<b><u>Monthly Billing</u><sup>1</sup></b>	<b><u>Annual Billing</u><sup>1</sup></b>	+
Per Private Hydrant	\$53.70	\$644.40	+
<sup>1</sup> Annual billing for customers in St. Louis County, monthly billing for all other customers			+
<b>PAYMENT TERMS</b> - All bills for service under this schedule will be rendered in advance either on a monthly or on an annual basis. The due date on the tariff shall be ten (10) days after the "date of rendition" of the bill to the customer. The customer's bill will be due and payable after this due date. The delinquent date printed on the bill will not be less than twenty-one (21) days after the date of the postmark of the bill. Any accounts remaining unpaid at the expiration of twenty-one (21) days shall be considered delinquent and the Company may take such action as specified in its filed rules and regulations.			*
			*
			*
			*
			*
			*
<b>TAXES</b> - These rates do not include any municipal, state or federal taxes computed on either billing or consumption basis. Any such taxes applicable shall be added as separate items in rendering each bill.			*
			*

\* *Indicates new rate or text*

+ *Indicates change*

Date of Issue: May 4, 2018                      Effective Date: June 3, 2018

Issued By: Cheryl Norton, President  
727 Craig Road, St. Louis, MO 63141

Missouri-American Water Company  
 Name of Issuing Corporation

For

All Missouri Service Areas  
 Community, Town or City

<b>Rate F</b>			
<b>Private Fire Protection</b>			
<p><b>AVAILABILITY</b> – This rate is available for fire protection systems installed on private property. Expense of the installations will be borne by the customer. If, in the opinion of the Company, a detector check meter is needed, the cost shall be a part of the installation. If a detector check meter has to be added to an existing service not having the check meter, the cost will be paid by the customer.</p>			+
<b>Fire Outlet or Tap</b>			
<b>Connection Size</b>	<b>Monthly Billing <sup>1</sup></b>	<b>Annual Billing <sup>1</sup></b>	
2" or Less	\$6.00	\$72.00	+
3"	\$19.36	\$232.32	+
4"	\$23.85	\$286.20	+
6"	\$53.70	\$644.40	+
8"	\$95.55	\$1,146.60	+
10"	\$149.25	\$1,791.00	+
12"	\$214.94	\$2,579.28	+
<p><sup>1</sup> Annual billing for customers in St. Louis County, monthly billing for all other customers</p>			+
<p><b>PAYMENT TERMS</b> - All bills for service under this schedule will be rendered in advance either on a monthly or on an annual basis. The due date on the tariff shall be ten (10) days after the "date of rendition" of the bill to the customer. The customer's bill will be due and payable after this due date. The delinquent date printed on the bill will not be less than twenty-one (21) days after the date of the postmark of the bill. Any accounts remaining unpaid at the expiration of twenty-one (21) days shall be considered delinquent and the Company may take such action as specified in its filed rules and regulations.</p>			* * * * * *
<p><b>TAXES</b> - These rates do not include any municipal, state or federal taxes computed on either billing or consumption basis. Any such taxes applicable shall be added as separate items in rendering each bill.</p>			*

\* *Indicates new rate or text*

+ *Indicates change*

Date of Issue: May 4, 2018                      Effective Date: June 3, 2018

Issued By: Cheryl Norton, President  
727 Craig Road, St. Louis, MO 63141

Missouri-American Water Company  
Name of Issuing Corporation

For

\_\_\_\_\_  
Community, Town or City

<b>HELD FOR FUTURE USE</b>	

\* *Indicates new rate or text*

+ *Indicates change*

Date of Issue: May 4, 2018

Effective Date: June 3, 2018

Issued By: Cheryl Norton, President  
727 Craig Road, St. Louis, MO 63141

Missouri-American Water Company  
Name of Issuing Corporation

For

Community, Town or City

<b>HELD FOR FUTURE USE</b>	
----------------------------	--

\* *Indicates new rate or text*

+ *Indicates change*

Date of Issue:	<u>May 4, 2018</u>	Effective Date:	<u>June 3, 2018</u>
----------------	--------------------	-----------------	---------------------

Issued By: Cheryl Norton, President  
727 Craig Road, St. Louis, MO 63141

Missouri-American Water Company  
Name of Issuing Corporation

For

\_\_\_\_\_  
Community, Town or City

<b>HELD FOR FUTURE USE</b>	

\* *Indicates new rate or text*

+ *Indicates change*

Date of Issue:

May 4, 2018

Effective Date:

June 3, 2018

Issued By:

Cheryl Norton, President

727 Craig Road, St. Louis, MO 63141

Missouri-American Water Company  
Name of Issuing Corporation

For

\_\_\_\_\_  
Community, Town or City

<b>HELD FOR FUTURE USE</b>	
----------------------------	--

\* *Indicates new rate or text*

+ *Indicates change*

Date of Issue:

May 4, 2018

Effective Date:

June 3, 2018

Issued By:

Cheryl Norton, President

727 Craig Road, St. Louis, MO 63141

Missouri-American Water Company  
 Name of Issuing Corporation

For

St. Louis County Service Area  
 Community, Town or City

<b>Rate J</b>																																						
<b>Rate for Manufacturers and Large Quantity Users of Water</b>																																						
<p><b>AVAILABILITY</b> – This rate is available to manufacturers and large quantity users of water whose use is fairly constant throughout the year and is not less than 450,000 gallons per month.</p> <p>This rate is not available to users of water in residences, apartment dwellings or for irrigation or construction purposes.</p> <p><b>METER CHARGE</b> – The charge for each month shall be based on the meter size or multiple meter sizes if more than one meter is installed as follows:</p> <table style="margin-left: auto; margin-right: auto;"> <thead> <tr> <th style="text-align: center;"><u>Meter Size</u></th> <th style="text-align: center;"><u>Monthly Billing</u></th> <th></th> </tr> </thead> <tbody> <tr><td style="text-align: center;">5/8"</td><td style="text-align: center;">\$9.00</td><td style="text-align: center;">+</td></tr> <tr><td style="text-align: center;">3/4"</td><td style="text-align: center;">\$12.25</td><td style="text-align: center;">+</td></tr> <tr><td style="text-align: center;">1"</td><td style="text-align: center;">\$16.58</td><td style="text-align: center;">+</td></tr> <tr><td style="text-align: center;">1-1/2"</td><td style="text-align: center;">\$27.42</td><td style="text-align: center;">+</td></tr> <tr><td style="text-align: center;">2"</td><td style="text-align: center;">\$40.43</td><td style="text-align: center;">+</td></tr> <tr><td style="text-align: center;">3"</td><td style="text-align: center;">\$71.10</td><td style="text-align: center;">+</td></tr> <tr><td style="text-align: center;">4"</td><td style="text-align: center;">\$114.11</td><td style="text-align: center;">+</td></tr> <tr><td style="text-align: center;">6"</td><td style="text-align: center;">\$222.47</td><td style="text-align: center;">+</td></tr> <tr><td style="text-align: center;">8"</td><td style="text-align: center;">\$379.54</td><td style="text-align: center;">+</td></tr> <tr><td style="text-align: center;">10"</td><td style="text-align: center;">\$637.71</td><td style="text-align: center;">+</td></tr> <tr><td style="text-align: center;">12"</td><td style="text-align: center;">\$765.25</td><td style="text-align: center;">+</td></tr> </tbody> </table> <p><b>COMMODITY CHARGE</b> – In addition to the Meter Charge, the Commodity Charge for all water used as registered by the meter is \$0.17680 per 100 gallons or \$1.7680 per 1,000 gallons.</p> <p><b>MINIMUM USAGE CHARGE</b> - in addition to the Meter Charge, a monthly minimum usage charge for any month shall be equal to the commodity rate, times the greater of 1) 60% of the maximum usage during any of the months of June, July, August, or September in the twelve (12) month period preceding the month for which the bill is to be rendered or 2) 450,000 gallons or 3) actual usage as registered by the meter.</p>			<u>Meter Size</u>	<u>Monthly Billing</u>		5/8"	\$9.00	+	3/4"	\$12.25	+	1"	\$16.58	+	1-1/2"	\$27.42	+	2"	\$40.43	+	3"	\$71.10	+	4"	\$114.11	+	6"	\$222.47	+	8"	\$379.54	+	10"	\$637.71	+	12"	\$765.25	+
<u>Meter Size</u>	<u>Monthly Billing</u>																																					
5/8"	\$9.00	+																																				
3/4"	\$12.25	+																																				
1"	\$16.58	+																																				
1-1/2"	\$27.42	+																																				
2"	\$40.43	+																																				
3"	\$71.10	+																																				
4"	\$114.11	+																																				
6"	\$222.47	+																																				
8"	\$379.54	+																																				
10"	\$637.71	+																																				
12"	\$765.25	+																																				

\* Indicates new rate or text

+ Indicates change

Date of Issue: May 4, 2018                      Effective Date: June 3, 2018

Issued By: Cheryl Norton, President  
727 Craig Road, St. Louis, MO 63141



Missouri-American Water Company  
Name of Issuing Corporation

For

St. Louis County Service Area  
Community, Town or City

<b>Rate J</b>	
<b>Rate for Manufacturers and Large Quantity Users of Water (Continued)</b>	
<b>PRO-RATA ADJUSTMENT OF MONTHLY MINIMUM CHARGE</b> – If the customer is forced to close operations of its works for a period of 10 days or more on account of accidents, fires, damage to works, strikes of its own employees, act of God, governmental regulations or other physical cause not reasonably within its control, and customer gives water company written notice not later than forty days after such occurrence, the customer will be entitled to pro rata reduction in the monthly minimum charge which is based on 60% of the maximum usage during the previous months of June, July, August, or September for the period during which the customer is unable to use full water service for such cause.	
<b>DURATION OF CLASSIFICATION</b> – Customers electing Tariff Rate J are required to remain in this classification for a period of at least twelve (12) months.	
A Rate J customer whose usage is less than 450,000 gallons per month more than two times during a twelve (12) month period will no longer meet the eligibility requirements of this classification.	
Customers who no longer meet the eligibility requirements of this classification, or elect to leave this classification, will be reclassified to Tariff Rate A, and must remain in the Rate A classification for a minimum of twelve (12) months and meet the monthly minimum usage requirements again before being reclassified under the Tariff Rate J.	+
<b>PAYMENT TERMS</b> - All bills for service under this schedule will be rendered in arrears on a monthly basis.	+
The due date on the tariff shall be ten (10) days after the "date of rendition" of the bill to the customer. The customer's bill will be due and payable after this due date. The delinquent date printed on the bill will not be less than twenty-one (21) days after the date of the postmark of the bill. Any accounts remaining unpaid at the expiration of twenty-one (21) days shall be considered delinquent and the Company may take such action as specified in its filed rules and regulations.	+
	+
<b>TAXES</b> - These rates do not include any municipal, state or federal taxes computed on either billing or consumption basis. Any such taxes applicable shall be added as separate items in rendering each bill.	+
	+

\* *Indicates new rate or text*

+ *Indicates change*

Date of Issue:

May 4, 2018

Effective Date:

June 3, 2018

Issued By:

Cheryl Norton, President

727 Craig Road, St. Louis, MO 63141

Missouri-American Water Company  
 Name of Issuing Corporation

For

All Missouri Service Areas Outside of St. Louis County  
 Community, Town or City

<b>Rate J</b>																																						
<b>Rate for Manufacturers and Large Quantity Users of Water</b>																																						
<p><b>AVAILABILITY</b> – This rate is available to manufacturers and large quantity users of water whose use is fairly constant throughout the year and is not less than 450,000 gallons per month.</p> <p>This rate is not available to users of water in residences, apartment dwellings or for irrigation or construction purposes.</p> <p><b>METER CHARGE</b> – The charge for each month shall be based on the meter size or multiple meter sizes if more than one meter is installed as follows:</p> <table style="margin-left: auto; margin-right: auto;"> <thead> <tr> <th style="text-align: center;"><u>Meter Size</u></th> <th style="text-align: center;"><u>Monthly Billing</u></th> <th></th> </tr> </thead> <tbody> <tr><td style="text-align: center;">5/8"</td><td style="text-align: center;">\$9.00</td><td style="text-align: center;">+</td></tr> <tr><td style="text-align: center;">3/4"</td><td style="text-align: center;">\$12.25</td><td style="text-align: center;">+</td></tr> <tr><td style="text-align: center;">1"</td><td style="text-align: center;">\$16.58</td><td style="text-align: center;">+</td></tr> <tr><td style="text-align: center;">1-1/2"</td><td style="text-align: center;">\$27.42</td><td style="text-align: center;">+</td></tr> <tr><td style="text-align: center;">2"</td><td style="text-align: center;">\$40.43</td><td style="text-align: center;">+</td></tr> <tr><td style="text-align: center;">3"</td><td style="text-align: center;">\$71.10</td><td style="text-align: center;">+</td></tr> <tr><td style="text-align: center;">4"</td><td style="text-align: center;">\$114.11</td><td style="text-align: center;">+</td></tr> <tr><td style="text-align: center;">6"</td><td style="text-align: center;">\$222.47</td><td style="text-align: center;">+</td></tr> <tr><td style="text-align: center;">8"</td><td style="text-align: center;">\$379.54</td><td style="text-align: center;">+</td></tr> <tr><td style="text-align: center;">10"</td><td style="text-align: center;">\$637.71</td><td style="text-align: center;">+</td></tr> <tr><td style="text-align: center;">12"</td><td style="text-align: center;">\$765.25</td><td style="text-align: center;">+</td></tr> </tbody> </table> <p><b>COMMODITY CHARGE</b> – In addition to the Meter Charge, the Commodity Charge for all water used as registered by the meter is \$0.28268 per 100 gallons or \$2.8268 per 1,000 gallons.</p> <p><b>MINIMUM USAGE CHARGE</b> - in addition to the Meter Charge, a monthly minimum usage charge for any month shall be equal to the commodity rate, times the greater of 1) 60% of the maximum usage during any of the months of June, July, August, or September in the twelve (12) month period preceding the month for which the bill is to be rendered or 2) 450,000 gallons or 3) actual usage as registered by the meter.</p>			<u>Meter Size</u>	<u>Monthly Billing</u>		5/8"	\$9.00	+	3/4"	\$12.25	+	1"	\$16.58	+	1-1/2"	\$27.42	+	2"	\$40.43	+	3"	\$71.10	+	4"	\$114.11	+	6"	\$222.47	+	8"	\$379.54	+	10"	\$637.71	+	12"	\$765.25	+
<u>Meter Size</u>	<u>Monthly Billing</u>																																					
5/8"	\$9.00	+																																				
3/4"	\$12.25	+																																				
1"	\$16.58	+																																				
1-1/2"	\$27.42	+																																				
2"	\$40.43	+																																				
3"	\$71.10	+																																				
4"	\$114.11	+																																				
6"	\$222.47	+																																				
8"	\$379.54	+																																				
10"	\$637.71	+																																				
12"	\$765.25	+																																				

\* Indicates new rate or text

+ Indicates change

Date of Issue: May 4, 2018                      Effective Date: June 3, 2018

Issued By: Cheryl Norton, President  
727 Craig Road, St. Louis, MO 63141

Missouri-American Water Company  
 Name of Issuing Corporation

For

All Missouri Service Areas Outside of St. Louis County  
 Community, Town or City

<b>Rate J</b>	
<b>Rate for Manufacturers and Large Quantity Users of Water (Continued)</b>	
<p><b>PRO-RATA ADJUSTMENT OF MONTHLY MINIMUM CHARGE</b> – If the customer is forced to close operations of its works for a period of 10 days or more on account of accidents, fires, damage to works, strikes of its own employees, act of God, governmental regulations or other physical cause not reasonably within its control, and customer gives water company written notice not later than forty days after such occurrence, the customer will be entitled to pro rata reduction in the monthly minimum charge which is based on 60% of the maximum usage during the previous months of June, July, August, or September for the period during which the customer is unable to use full water service for such cause.</p> <p><b>DURATION OF CLASSIFICATION</b> – Customers electing Tariff Rate J are required to remain in this classification for a period of at least twelve (12) months.</p> <p>A Rate J customer whose usage is less than 450,000 gallons per month more than two times during a twelve (12) month period will no longer meet the eligibility requirements of this classification.</p> <p>Customers who no longer meet the eligibility requirements of this classification, or elect to leave this classification, will be reclassified to Tariff Rate A, and must remain in the Rate A classification for a minimum of twelve (12) months and meet the monthly minimum usage requirements again before being reclassified under the Tariff Rate J.</p> <p><b>PAYMENT TERMS</b> - All bills for service under this schedule will be rendered in arrears on a monthly basis. The due date on the tariff shall be ten (10) days after the "date of rendition" of the bill to the customer. The customer's bill will be due and payable after this due date. The delinquent date printed on the bill will not be less than twenty-one (21) days after the date of the postmark of the bill. Any accounts remaining unpaid at the expiration of twenty-one (21) days shall be considered delinquent and the Company may take such action as specified in its filed rules and regulations.</p> <p><b>TAXES</b> - These rates do not include any municipal, state or federal taxes computed on either billing or consumption basis. Any such taxes applicable shall be added as separate items in rendering each bill.</p>	<p>+ + + + + + +</p>

\* *Indicates new rate or text*

+ *Indicates change*

Date of Issue: May 4, 2018                      Effective Date: June 3, 2018

Issued By: Cheryl Norton, President  
727 Craig Road, St. Louis, MO 63141

Missouri-American Water Company  
Name of Issuing Corporation

For

\_\_\_\_\_  
Community, Town or City

<b>HELD FOR FUTURE USE</b>	

\* *Indicates new rate or text*

+ *Indicates change*

Date of Issue:

May 4, 2018

Effective Date:

June 3, 2018

Issued By:

Cheryl Norton, President

727 Craig Road, St. Louis, MO 63141

Missouri-American Water Company  
Name of Issuing Corporation

For

\_\_\_\_\_  
Community, Town or City

<b>HELD FOR FUTURE USE</b>	

\* *Indicates new rate or text*

+ *Indicates change*

Date of Issue: May 4, 2018

Effective Date: June 3, 2018

Issued By: Cheryl Norton, President  
727 Craig Road, St. Louis, MO 63141

Missouri-American Water Company  
 Name of Issuing Corporation

For

All Missouri Service Areas  
 Community, Town or City

<b>Miscellaneous Charges Water Service</b>			
<u>Service Activation Fee (turn on):</u>			
During Normal Business Hours	\$27.50	per Trip	+
Outside of Normal Business Hours	\$159.00	per Trip	+
<u>Service Discontinuance (turn off)</u>			
During Normal Business Hours	\$27.50	per Trip	+
Outside of Normal Business Hours	\$159.00	per Trip	+
Requiring the Company to excavate and install a new meter or valve	Actual Cost		
New Service Connection Fee <sup>1</sup>	Actual Cost		
Meter Testing (Accuracy of the Meter) <sup>2</sup>	\$41.50	per Test	+
Special Meter Reading <sup>3</sup>	\$27.50	per Trip	+
Late Payment Charge - Applied each Month to the Unpaid Balance	1.50%	per Month	*
Returned Deposit Item <sup>4</sup>	\$12.00	per Item	
Hydrant Inspection	\$15.00	per Hydrant	
Temporary Water Use from Hydrant	\$15.00	per Day	
Investigation Report	\$25.00	per Report	
Service Line Inspection	\$82.50	per Inspection	+
Bulk Sales Via Coin Operated Vending Machine (where available)	\$4.50	per 1,000 gallons	
Temporary Water Service	\$61.00	per Application	
<sup>1</sup> Consists of the costs incurred by the Company for the construction including parts, material, labor and equipment, but excluding the cost of the meter. See Rule 4H and 4I.			
<sup>2</sup> The Company will test a meter for accuracy, if not tested in the prior 12 months, at no cost. See Rule 16.			
<sup>3</sup> Includes special meter reading trips resulting from customer refusal to allow AMI installation.			
<sup>4</sup> The Company may serve a Customer on a cash-only basis if more than one check or Returned Deposit Item of the Customer is returned NSF or any other valid return reason in a 12-month period. "Cash" shall be deemed to mean U.S. currency, money order, or certified check.			

\* *Indicates new rate or text*

+ *Indicates change*

Date of Issue: May 4, 2018                      Effective Date: June 3, 2018

Issued By: Cheryl Norton, President  
727 Craig Road, St. Louis, MO 63141

Missouri-American Water Company  
Name of Issuing Corporation

For

\_\_\_\_\_  
Community, Town or City

<b>HELD FOR FUTURE USE</b>	

\* *Indicates new rate or text*

+ *Indicates change*

Date of Issue: May 4, 2018

Effective Date: June 3, 2018

Issued By: Cheryl Norton, President  
727 Craig Road, St. Louis, MO 63141

Missouri-American Water Company  
 Name of Issuing Corporation

For

St Louis County Operations  
 Community, Town or City

<b>Rate I</b>		
<b>Infrastructure System Replacement Surcharge (ISRS)</b>		
<p><b>DESCRIPTION</b> - Rate I is designed to recover the costs associated with the Company's eligible main, valve, and hydrant replacements, main relocations, and main cleaning and relining projects. This ISRS rate is calculated and implemented in accordance with the provisions of sections 393.1000 to 393.1006 RSMO. Any future changes to this rate will also be made in accordance with those provisions.</p>		
<p><b>APPLICABILITY</b> - This rate is applicable to any customer class who benefits from the subject utility plant projects eligible for ISRS recovery. The surcharge is calculated consistent with the customer class cost-of-service study recognized by the Missouri Commission in a Company's recent applicable general rate proceeding.</p>		
<p><b>RATE COMPONENTS</b> - In addition to the other charges provided for in the Company's tariffs, a separate charge for the ISRS will apply for service rendered on and after the effective date.</p>		
<b>Customer Rate Class</b>	<b>Rate per 100 Gallons</b>	
Rate A	\$0.0000	+
Rate B	\$0.0000	+
Rate J	\$0.0000	+
<p><b>RULES AND REGULATIONS</b> – The General Rules and Regulations set forth in this tariff shall govern the supply of service under this rate.</p>		
<p><b>PAYMENT TERMS</b> - All bills for service under this schedule will be rendered in arrears on a monthly or quarterly basis. The due date on the tariff shall be ten (10) days after the "date of rendition" of the bill to the customer. The customer's bill will be due and payable after this due date. The delinquent date printed on the bill will not be less than twenty-one (21) days after the date of the postmark of the bill. Any accounts remaining unpaid at the expiration of twenty-one (21) days shall be considered delinquent and the Company may take such action as specified in its filed rules and regulations.</p>		
<p><b>TAXES</b> - These rates do not include any municipal, state or federal taxes computed on either billing or consumption basis. Any such taxes applicable shall be added as separate items in rendering each bill.</p>		

\* *Indicates new rate or text*

+ *Indicates change*

Date of Issue: May 4, 2018                      Effective Date: June 3, 2018

Issued By: Cheryl Norton, President  
727 Craig Road, St. Louis, MO 63141



Missouri-American Water Company  
Name of Issuing Corporation

For

\_\_\_\_\_  
Community, Town or City

<b>HELD FOR FUTURE USE</b>	

\* *Indicates new rate or text*

+ *Indicates change*

Date of Issue:

May 4, 2018

Effective Date:

June 3, 2018

Issued By:

Cheryl Norton, President

727 Craig Road, St. Louis, MO 63141

Missouri-American Water Company  
Name of Issuing Corporation

For

\_\_\_\_\_  
Community, Town or City

<b>HELD FOR FUTURE USE</b>	

\* *Indicates new rate or text*

+ *Indicates change*

Date of Issue:

May 4, 2018

Effective Date:

June 3, 2018

Issued By:

Cheryl Norton, President

727 Craig Road, St. Louis, MO 63141

Missouri-American Water Company  
Name of Issuing Corporation

For

\_\_\_\_\_  
Community, Town or City

<b>HELD FOR FUTURE USE</b>	
----------------------------	--

\* *Indicates new rate or text*

+ *Indicates change*

Date of Issue: May 4, 2018

Effective Date: June 3, 2018

Issued By: Cheryl Norton, President  
727 Craig Road, St. Louis, MO 63141

Missouri-American Water Company  
Name of Issuing Corporation

For

\_\_\_\_\_  
Community, Town or City

<b>HELD FOR FUTURE USE</b>	

\* *Indicates new rate or text*

+ *Indicates change*

Date of Issue:

May 4, 2018

Effective Date:

June 3, 2018

Issued By:

Cheryl Norton, President

727 Craig Road, St. Louis, MO 63141

Missouri-American Water Company  
Name of Issuing Corporation

For

St. Joseph Service Area  
Community, Town or City

<b>Rate P</b> <b>Special Retail Sale Contract Rate</b>	
<b><u>Triumph Foods, LLC</u></b>	+
<b><u>AVAILABILITY</u></b> - This rate is available for service provided to Triumph Foods, LLC pursuant to the <u>Contract for the Retail Sale and Delivery of Potable Water</u> (Contract).	+
The Company will provide service pursuant to rates to be generated by the provisions of the Contract. The rates generated by the provisions of the Contract may not be modified without Commission approval.	+

\* *Indicates new rate or text*

+ *Indicates change*

Date of Issue:

May 4, 2018

Effective Date:

June 3, 2018

Issued By:

Cheryl Norton, President

727 Craig Road, St. Louis, MO 63141

Missouri-American Water Company  
Name of Issuing Corporation

For

St. Louis County Service Area  
Community, Town or City

<b>Rate P</b> <b>Special Retail Sale Contract Rate</b>	
<p><b><u>Consolidated Public Water Supply District No. C-1</u></b></p> <p><b><u>AVAILABILITY</u></b> - This rate is available for transmission line, points of delivery and sales for resale service provided to the Consolidated Public Water Supply District NO. C-1 pursuant to the <u>Contract to Construct Transmission Main and to Sell and Deliver Water For Resale</u> (Contract).</p> <p>The Company has contracted to provide transmission lines to transport water to the Consolidated Public Water Supply District No. C-1 pursuant to the Contract.</p> <p>The Company will provide service pursuant to rates to be generated by the provisions of the Contract. The rates generated by the provisions of the Contract may not be modified without Commission approval.</p>	+

\* *Indicates new rate or text*

+ *Indicates change*

Date of Issue: May 4, 2018

Effective Date: June 3, 2018

Issued By: Cheryl Norton, President  
727 Craig Road, St. Louis, MO 63141

Missouri-American Water Company  
Name of Issuing Corporation

For

St. Louis County Service Area  
Community, Town or City

<b>Rate P</b> <b>Special Retail Sale Contract Rate</b>	
<p><b><u>City of Kirkwood</u></b></p> <p><b><u>AVAILABILITY</u></b> - This rate is available for transmission line, points of delivery and sales for resale service provided to the City of Kirkwood pursuant to the <u>Contract to Construct Transmission Main and Points of Delivery and to Sell and Deliver Water For Resale</u> (Contract).</p> <p>The Company has contracted to provide transmission lines to transport water to the City of Kirkwood pursuant to the Contract.</p> <p>The Company will provide service pursuant to rates to be generated by the provisions of the Contract. The rates generated by the provisions of the Contract may not be modified without Commission approval.</p>	+

\* *Indicates new rate or text*

+ *Indicates change*

Date of Issue:

May 4, 2018

Effective Date:

June XX 2018

Issued By:

Cheryl Norton, President

727 Craig Road, St. Louis, MO 63141

Missouri-American Water Company  
 Name of Issuing Corporation

For

St. Joseph, Brunswick and Platte County Service Areas  
 Community, Town or City

**Minimum Customer Charge Rate for Low-Income Customers**

**AVAILABILITY**- Customers that default on payments for two (2) consecutive months will no longer be eligible for this rate, and will not be allowed to requalify for twelve (12) months. Customers must reestablish eligibility on an annual basis. This rate will be available until the effective date of new rates in Missouri American Water’s next general rate proceeding.

**TARIFF QUALIFICATIONS**

The program administrator will determine a customer’s eligibility using the following criteria: the customer’s household earnings meet the low-income guidelines for the Missouri Low-Income Home Energy Assistance Program (LIHEAP). Residential customers, who demonstrate a financial need and qualify for LIHEAP, should contact a local Community Action Agency referenced below or any subsequent program administrator whose contact information may be found on Missouri American Water’s web site. Upon qualification for LIHEAP, residential customers with a 5/8” meter will receive a discount of 80% of the fixed 5/8” meter minimum customer charge. The current fixed monthly 5/8” meter minimum customer charge for St. Joseph, Brunswick and Platte County is \$9.00, the discount applied to the customer’s monthly bill would be \$7.20.

+  
 +

Missouri American Service Area	County	Community Action Agency Contact (Available 8:00 am – 5:00 pm)
Brunswick	Chariton County	Missouri Valley Community Action Agency 660-548-3155
Parkville	Platte County	United Services Community Action Agency 816-585-5153
St. Joseph	Buchanan County	Community Action Partnership of St. Joseph 816-233-8281

\* *Indicates new rate or text*

+ *Indicates change*

Date of Issue: May 4, 2018                      Effective Date: June 3, 2018

Issued By: Cheryl Norton, President  
727 Craig Road, St. Louis, MO 63141



Missouri-American Water Company  
Name of Issuing Corporation

For

Woodland Manor Service Area  
Community, Town or City

TABLE OF CONTENTS		
Certificated Area Description	Sheet No	
Branson Area		
Rankin Acres Service Area (Map)	CA 15.1	
Rankin Acres Service Area (Legal Description)	CA 15.2	
Spring Valley Area (Map)	CA 15.3	
Spring Valley Area (Legal Description)	CA 15.4	
Lakewood Manor (Map)	CA 15.5	
Lakewood Manor (Legal Description)	CA 15.6	
Ozark Mountain Area (Map)	CA 15.7	
Ozark Mountain Area (Legal Description)	CA 15.8-15.15	
Lake Taneycomo Acres Area (Map)	CA 15.16	
Lake Taneycomo Acres Area (Legal Description)	CA 15.17	
Whitebranch Area (Map)	CA 15.18	
Whitebranch Area (Legal Description)	CA 15.19	
Maplewood Area (Map)	CA 15.20	
Maplewood Area (Legal Description)	CA 15.21	
Riverside Estates Area (Map)	CA 15.22	
Riverside Estates Area (Legal Description)	CA 15.23	
Stonebridge Village Area (Map)	CA 15.24	
Stonebridge Village Area (Legal Description)	CA 15.25	
Saddlebrooke Area (Map)	CA 15.26	
Saddlebrooke Area (Legal Description)	CA 15.27-15.28	
Tri-States Area (Map)	CA 15.29	
Tri-States Area (Legal Description)	CA 15.30	
Spokane Highlands (Map)	CA 15.31	
Spokane Highlands (Legal Description)	CA 15.32	
Hickory Hills Service Area		
Hickory Hills Area (Map)	CA 16.1-16.2	
Hickory Hills Area (Legal Description)	CA 16.3	
Woodland Manor Service Area		
Woodland Manor Area (Map)	CA 17.1	*
Woodland Manor Area (Legal Description)	CA 17.2	*

\* Indicates new rate or text

+ Indicates change

Date of Issue: May 4, 2018                      Effective Date:                      June 3, 2018

Issued By:                      Cheryl Norton, President  
    727 Craig Road, St. Louis, MO 63141

Missouri-American Water Company  
Name of Issuing Corporation

For

Woodland Manor Service Area  
Community, Town or City

**Water Service Area  
Boundary Area Map**

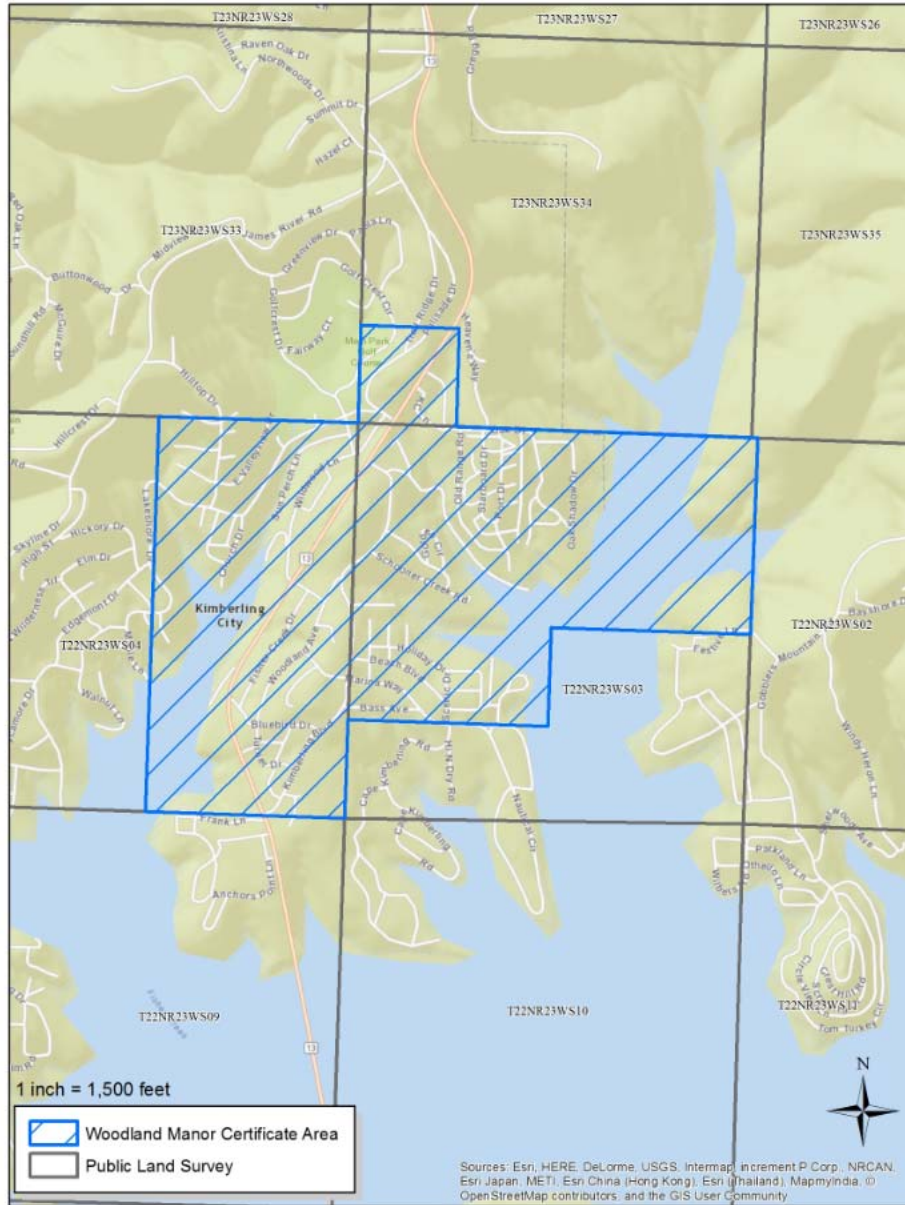

\* Indicates new rate or text

+ Indicates change

Date of Issue:

May 4, 2018

Effective Date:

June 3, 2018

Issued By:

Cheryl Norton, President  
727 Craig Road, St. Louis, MO 63141

Missouri-American Water Company  
Name of Issuing Corporation

For

Woodland Manor Service Area  
Community, Town or City

**Water Service Area  
Legal Description**

The North 1/2 of Sec 3, T22N, R23W and the N 1/2 of the SW 1/4 of said Sec 3 which lies to the west of Schooner Creek Cove of Table Rock Lake, and lies to the east of a line 200' west of and parallel to Wildwood Lan, also also known as Old MO Hwy 13.

The E 1/2 of Sec 4, T22N, R23W which lies to the east of MO Hwy 13, and the NE 1/4 of said Sec 4 which lies to the west of MO Hwy 13, and lies east of a line 200' west of and parallel to Wildwood Lane, also known as Old MO Hwy 13.

The SW 1/4 of the SW 1/4 of Sec 34, T23N, R23W which lies to the east of MO Hwy 13, and lies west of a line 200' east of and parallel to Oak Drive.

\* *Indicates new rate or text*

+ *Indicates change*

Date of Issue: May 4, 2018

Effective Date: June 3, 2018

Issued By: Cheryl Norton, President  
727 Craig Road, St. Louis, MO 63141