

ADOPTION NOTICE
GENERAL AND LOCAL EXCHANGE TARIFF

(D)

(D)

This tariff contains the descriptions, regulations, and rates applicable to the furnishing of service and facilities for telecommunications services provided by New London Telephone Company within the State of Missouri. This tariff is on file with the Missouri Public Service Commission and copies may be inspected during normal business hours, at the Company's place of business.

(T)

ISSUED: September 29, 2014

EFFECTIVE: November 21, 2014

By: Garrin Bott, President

CANCELLED
September 2, 2018
Missouri Public
Service Commission
IN-2019-0055, JI-2019-0020

FILED
Missouri Public
Service Commission
IN-2015-0079; JI-2015-0128

NEW LONDON TELEPHONE COMPANY
d/b/a TDS Telecom
Missouri
Notice

PSC MO No. 7
Original Sheet – Adoption

ADOPTION NOTICE

GENERAL AND LOCAL EXCHANGE TARIFF

New London Telephone Company d/b/a TDS Telecom hereby adopts, ratifies and makes its own in every respect, as if the same had been originally filed by it, all tariffs of New London Telephone Company filed with and approved by the Missouri Public Service Commission before the effective date of this tariff.

(N)

This tariff contains the descriptions, regulations, and rates applicable to the furnishing of service and facilities for telecommunications services provided by New London Telephone Company d/b/a TDS Telecom within the State of Missouri. This tariff is on file with the Missouri Public Service Commission and copies may be inspected during normal business hours, at the Company's place of business.

(N)

FILED
Missouri Public
Service Commission
IN-2014-0051; JI-2014-0092

ISSUED: August 22, 2013

EFFECTIVE: September 1, 2013

BY: Joel Dohmeier, Vice-President

CANCELLED
November 21, 2014
Missouri Public
Service Commission
IN-2015-0079; JI-2015-0128

P.S.C. MO. No. 8
Cancels P.S.C. MO. No. 7

NEW LONDON TELEPHONE COMPANY
Missouri

(T)

FIRST AMENDED TITLE PAGE
REPLACES ORIGINAL TITLE PAGE

NEW LONDON TELEPHONE COMPANY

(T)

SCHEDULE OF RATES
FOR
TELEPHONE SERVICE
APPLYING TO THE FOLLOWING TERRITORIES
NEW LONDON, MISSOURI

ISSUED: September 29, 2014

EFFECTIVE: November 21, 2014

By: Garrin Bott, President

CANCELLED
September 2, 2018
Missouri Public
Service Commission
IN-2019-0055, JI-2019-0020

FILED
Missouri Public
Service Commission
IN-2015-0079; JI-2015-0128

**P.S.C. MO. No. 7
Cancels P.S.C. MO No. 6**

NEW LONDON TELEPHONE COMPANY
Missouri

TITLE PAGE

NEW LONDON TELEPHONE COMPANY
Name of Corporation

**SCHEDULE OF RATES
FOR
TELEPHONE SERVICE
APPLYING TO THE FOLLOWING TERRITORIES
NEW LONDON, MISSOURI**

ISSUED: February 27, 2013

BY: Joel Dohmeier, Vice-President

CANCELLED
September 1, 2013
Missouri Public
Service Commission
IN-2014-0051; JI-2014-0092

EFFECTIVE: March 29, 2013

FILED
Missouri Public
Service Commission
JI-2013-0373

P.S.C. MO. No. 7
Cancels P.S.C. MO No. 6

NEW LONDON TELEPHONE COMPANY
d/b/a TDS Telecom
Missouri

(N)

TITLE PAGE

NEW LONDON TELEPHONE COMPANY D/B/A TDS TELECOM

(N)

SCHEDULE OF RATES
FOR
TELEPHONE SERVICE
APPLYING TO THE FOLLOWING TERRITORIES
NEW LONDON, MISSOURI

FILED
Missouri Public
Service Commission
IN-2014-0051; JI-2014-0092

ISSUED: August 22, 2013

EFFECTIVE: September 1, 2013

BY: Joel Dohmeier, Vice-President

Attachment B

CANCELLED
November 21, 2014
Missouri Public
Service Commission
IN-2015-0079; JI-2015-0128

GENERAL EXCHANGE TARIFF

P.S.C. MO No. 7
NEW LONDON TELEPHONE COMPANY.
d/b/a TDS Telecom
Missouri

Section 1
Original Contents Sheet 1

TABLE OF CONTENTS

SECTION 1	Table of Contents, General Subject Index and Symbols
SECTION 2	General Rules and Regulations
SECTION 3	Definitions
SECTION 4	Local Exchange Service
SECTION 5	Miscellaneous Service Arrangements
SECTION 6	Service Connection Charges
SECTION 7	Directory Services
SECTION 8	Optional Services
SECTION 9	Construction Charges
SECTION 10	Private Line Service
SECTION 11	Access Service

ISSUED: February 27, 2013

By: Joel Dohmeier, Vice-President

CANCELLED
September 2, 2018
Missouri Public
Service Commission
IN-2019-0055, JI-2019-0020

EFFECTIVE: March, 29, 2013

FILED
Missouri Public
Service Commission
JI-2013-0373

GENERAL EXCHANGE TARIFF

P.S.C. MO No. 7
NEW LONDON TELEPHONE COMPANY.
d/b/a TDS Telecom
Missouri

Section 2
Original Sheet 1

GENERAL REGULATIONS

CONCURRENCE

New London Telephone Company, d/b/a TDS Telecom hereby assents to, adopts and concurs in the General Regulations as set forth in Section 2 of Stoutland Telephone Company, d/b/a TDS Telecom tariff, on file with the Missouri Public Service Commission and makes itself a party thereto and obligates itself to observe the provisions therein with the exceptions listed below.

EXCEPTIONS

No Exceptions

ISSUED: February 27, 2013

By: Joel Dohmeier, Vice-President

CANCELLED
September 2, 2018
Missouri Public
Service Commission
IN-2019-0055, JI-2019-0020

EFFECTIVE: March 29, 2013

FILED
Missouri Public
Service Commission
JI-2013-0373

GENERAL EXCHANGE TARIFF

P.S.C. MO No. 7
NEW LONDON TELEPHONE COMPANY.
d/b/a TDS Telecom
Missouri

Section 3
Original Sheet 1

DEFINITIONS

CONCURRENCE

New London Telephone Company, d/b/a TDS Telecom hereby assents to, adopts and concurs in the Definitions as set forth in Section 3 of Stoutland Telephone Company, d/b/a TDS Telecom tariff, on file with the Missouri Public Service Commission and makes itself a party thereto and obligates itself to observe the provisions therein with the exceptions listed below.

EXCEPTIONS

No Exceptions

ISSUED: February 27, 2013

By: Joel Dohmeier, Vice-President

CANCELLED
September 2, 2018
Missouri Public
Service Commission
IN-2019-0055, JI-2019-0020

EFFECTIVE: March 29, 2013

FILED
Missouri Public
Service Commission
JI-2013-0373

GENERAL EXCHANGE TARIFF

P.S.C. MO No. 8
NEW LONDON TELEPHONE COMPANY
Missouri

Section 4
Second Revised Sheet 1
Replaces First Revised Sheet 1

LOCAL EXCHANGE SERVICE

CONCURRENCE

New London Telephone Company hereby assents to, adopts and concurs in the Local Exchange Service as set forth in Section 4 of Stoutland Telephone Company tariff, on file with the Missouri Public Service Commission and makes itself a party thereto and obligates itself to observe the provisions therein with the exceptions listed below.

EXCEPTIONS

BASIC ACCESS LINE SERVICE

B. RATES

	<u>Access</u>
Business One-Party	\$22.10
Residence One-Party	\$18.00

(I)

ISSUED: April 29, 2016

EFFECTIVE: June 1, 2016

By: Garrin Bott, President

CANCELLED
September 2, 2018
Missouri Public
Service Commission
IN-2019-0055, JI-2019-0020

FILED
Missouri Public
Service Commission
JI-2016-0305

GENERAL EXCHANGE TARIFF

P.S.C. MO No. 8
NEW LONDON TELEPHONE COMPANY
Missouri

Section 4
First Revised Sheet 1
Replaces Original Sheet 1

LOCAL EXCHANGE SERVICE

CONCURRENCE

New London Telephone Company hereby assents to, adopts and concurs in the Local Exchange Service as set forth in Section 4 of Stoutland Telephone Company tariff, on file with the Missouri Public Service Commission and makes itself a party thereto and obligates itself to observe the provisions therein with the exceptions listed below.

(T)
(T)

EXCEPTIONS

BASIC ACCESS LINE SERVICE

B. RATES

	<u>Access</u>
Business One-Party	\$22.10
Residence One-Party	\$16.00

(I)

(D)

(D)

CANCELLED
June 1, 2016
Missouri Public
Service Commission
JI-2016-0305

ISSUED: April 29, 2015

EFFECTIVE: June 1, 2015

By: Garrin Bott, President

FILED
Missouri Public
Service Commission
JI-2015-0317

GENERAL EXCHANGE TARIFF

P.S.C. MO No. 7
NEW LONDON TELEPHONE COMPANY.
d/b/a TDS Telecom
Missouri

Section 4

Original Sheet 1

LOCAL EXCHANGE SERVICE

CONCURRENCE

New London Telephone Company, d/b/a TDS Telecom hereby assents to, adopts and concurs in the Local Exchange Service as set forth in Section 4 of Stoutland Telephone Company, d/b/a TDS Telecom tariff, on file with the Missouri Public Service Commission and makes itself a party thereto and obligates itself to observe the provisions therein with the exceptions listed below.

EXCEPTIONS

BASIC ACCESS LINE SERVICE

B. RATES

Phase 1 Rates:

	Touch Tone	(T)
	<u>Access</u>	
Business One-Party	\$22.10	
Residence One-Party	\$12.30 ¹	(T)
Coin Telephone Service		
Coin Box Telephone Service	\$24.90	
Customer Owned /Coin Operated Telephone Service	\$22.10	

¹ Rates Effective through May 27, 2013 (T)

Phase 2 Rates: Effective May 28, 2013

	Touch Tone	(T)
	<u>Access</u>	
Business One-Party	\$22.10	
Residence One-Party	\$14.00	(I)

PAYSTATION SERVICE

B. Rates

	<u>Coin Rate</u> ²
4. Each outgoing local message	\$0.25

² Upon implementation of the FCC rules preempting state regulations of payphone rates, this subsection will not apply.

ISSUED: February 27, 2013

EFFECTIVE: March 29, 2013

GENERAL EXCHANGE TARIFF

P.S.C. MO No. 8
NEW LONDON TELEPHONE COMPANY
Missouri

Section 4
First Revised Sheet 2
Replaces Original Sheet 2

LOCAL EXCHANGE SERVICE

EXCEPTIONS - Continued

SYSTEM PLUS CENTREX SERVICE (SPCS)

B. SYSTEM FEATURES

j. Speed Calling 6

Allows a user to place calls to a previously designated list of six (6) frequently dialed numbers.

E. RATES AND CHARGES

b. The monthly rates for Simulated Facility Trunks are:

	Business Monthly <u>Rate</u>	Residence Monthly <u>Rate</u>	
1) 1 to 6 Trunks, each	\$24.10	\$14.30	(l)
2) 7 and above, each	\$23.45	\$13.70	(l)

ISSUED: April 29, 2016

EFFECTIVE: June 1, 2016

By: Garrin Bott, President

CANCELLED
September 2, 2018
Missouri Public
Service Commission
IN-2019-0055, JI-2019-0020

FILED
Missouri Public
Service Commission
JI-2016-0305

GENERAL EXCHANGE TARIFF

P.S.C. MO No. 7
NEW LONDON TELEPHONE COMPANY.
d/b/a TDS Telecom
Missouri

Section 4
Original Sheet 2

LOCAL EXCHANGE SERVICE

EXCEPTIONS - Continued

SYSTEM PLUS CENTREX SERVICE (SPCS)

B. SYSTEM FEATURES

j. Speed Calling 6

Allows a user to place calls to a previously designated list of six (6) frequently dialed numbers.

E. RATES AND CHARGES

b. The monthly rates for
Simulated Facility Trunks are:

	Business Monthly <u>Rate</u>	Residence Monthly <u>Rate</u>
1) 1 to 6 Trunks, each	\$22.10	\$12.30
2) 7 and above, each	21.45	11.70

CANCELLED
June 1, 2016
Missouri Public
Service Commission
JI-2016-0305

ISSUED: February 27, 2013

EFFECTIVE: March 29, 2013

By: Joel Dohmeier, Vice-President

FILED
Missouri Public
Service Commission
JI-2013-0373

GENERAL EXCHANGE TARIFF

P.S.C. MO No. 7
NEW LONDON TELEPHONE COMPANY.
d/b/a TDS Telecom
Missouri

Section 4
Original Sheet 3

LOCAL EXCHANGE SERVICE

EXCHANGE BOUNDARY MAP

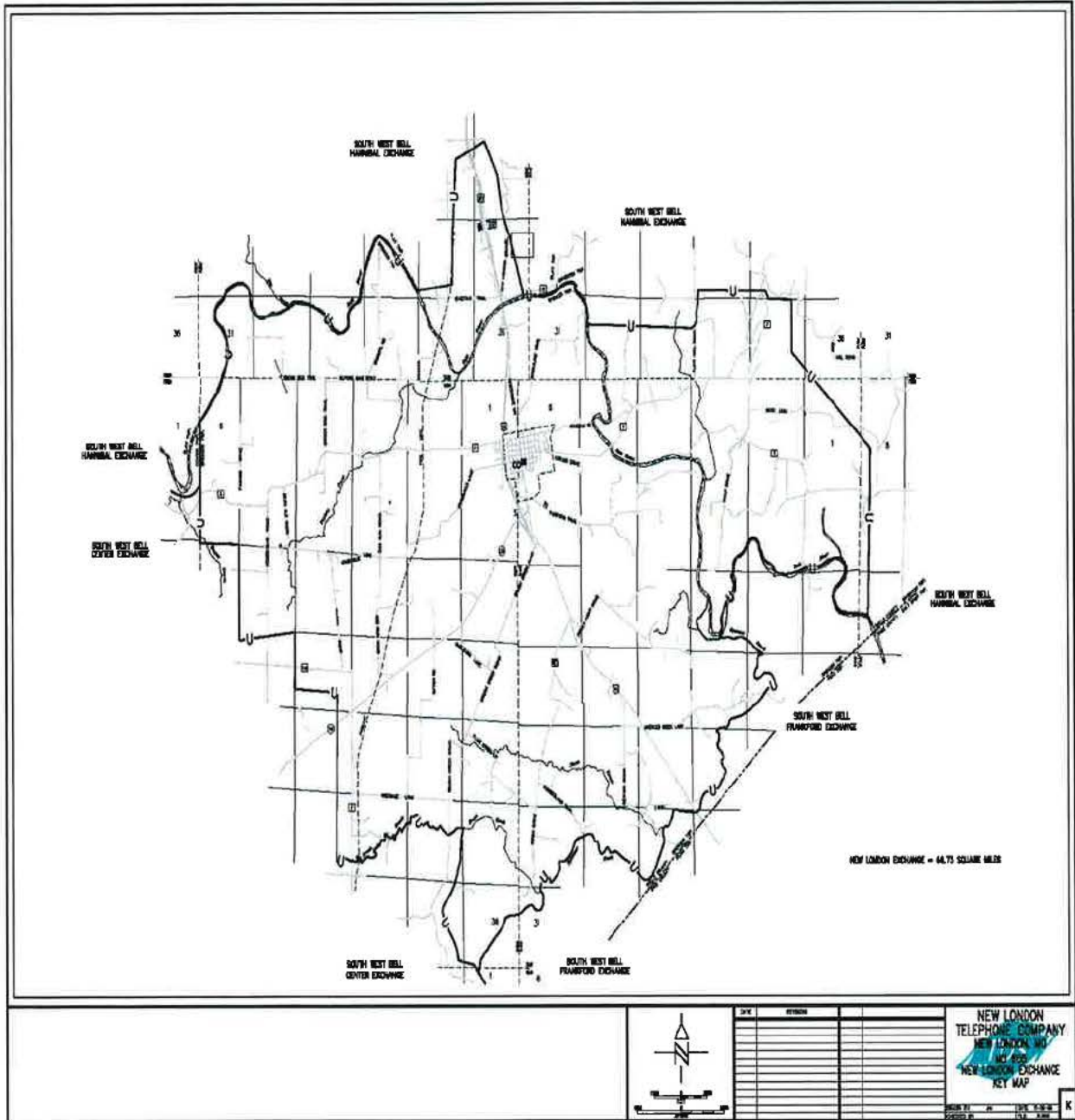

ISSUED: February 27, 2013

EFFECTIVE: March 29, 2013

By: Joel Dohmeier, Vice-President

CANCELLED
September 2, 2018
Missouri Public
Service Commission
IN-2019-0055, JI-2019-0020

FILED
Missouri Public
Service Commission
JI-2013-0373

GENERAL EXCHANGE TARIFF

P.S.C. MO No. 7
NEW LONDON TELEPHONE COMPANY.
d/b/a TDS Telecom
Missouri

Section 4
First Revised Sheet 4
Cancels Original Sheet 4

LOCAL EXCHANGE SERVICE

Reserved for Future Use

(T)

(D)

(D)

ISSUED: May 17, 2013

By: Joel Dohmeier, Vice-President

CANCELLED
September 2, 2018
Missouri Public
Service Commission
IN-2019-0055, JI-2019-0020

EFFECTIVE: June 17, 2013

FILED
Missouri Public
Service Commission
JI-2013-0539

GENERAL EXCHANGE TARIFF

P.S.C. MO No. 7
NEW LONDON TELEPHONE COMPANY.
d/b/a TDS Telecom
Missouri

Section 4
Original Sheet 4

LOCAL EXCHANGE SERVICE

TDS LOCAL ENHANCED

A. General

Missouri Call Plan is an optional calling plan that provides one-way calling for all customers located in the exchanges of New London Telephone Company to Hannibal.

B. Regulations

1. Missouri Call Plan is provided to all classes of business and residence service.
2. A separate package plan will apply to each line on a multiline service.
3. This plan provides customers with ten digit dialing to Hannibal. If a customer dials 1+, the call will default to the customers toll provider.
4. Missouri Call Plan applies only to direct dialed station-to-station calls. Operator assisted calls and calling card calls are not included in this plan.
5. For calls that are made to Call Forwarded lines, the customer pays the appropriate usage rate for the duration of the call from the originating number to the called number. The customer of the Call Forwarding service pays any applicable usage rate from the called number to the terminating location of the call.
6. Calls placed from an off-premises extension of an access line will be billed as if the local calls had been placed from the primary service location.
7. Missouri Call Plan provides residence and business customers with a choice of one of three block of times for a set rate. The rates as specified in Part D. following, will be assessed for a group of minutes or rounded to the next higher minute on all minutes above the block of time.
8. The chargeable time will be rate sensitive to each specific package. When the minutes exceed the block of time, a per minute rate will be assessed on each minute above the block of time.
9. Chargeable time is started when the called party answers or when the caller is connected to automatic answering services, (i.e., automatic answer/record equipment, voice mail, or an answering service).

ISSUED: February 27, 2013

EFFECTIVE: March 29, 2013

By: Joel Dohmeier, Vice-President

GENERAL EXCHANGE TARIFF

P.S.C. MO No. 7
NEW LONDON TELEPHONE COMPANY.
d/b/a TDS Telecom
Missouri

Section 4
First Revised Sheet 5
Cancels Original Sheet 5

LOCAL EXCHANGE SERVICE

Reserved for Future Use

(T)

(D)

(D)

ISSUED: May 17, 2013

By: Joel Dohmeier, Vice-President

CANCELLED
September 2, 2018
Missouri Public
Service Commission
IN-2019-0055, JI-2019-0020

EFFECTIVE: June 17, 2013

FILED
Missouri Public
Service Commission
JI-2013-0539

GENERAL EXCHANGE TARIFF

P.S.C. MO No. 7
NEW LONDON TELEPHONE COMPANY.
d/b/a TDS Telecom
Missouri

Section 4
Original Sheet 5

LOCAL EXCHANGE SERVICE

TDS LOCAL ENHANCED(Continued)

B. Regulations (Continued)

10. Chargeable time ends when the calling station "hangs up", thereby releasing the network connection. If the called station "hangs up" but the calling station does not, chargeable time ends when the network connection is released by automatic timing equipment in the telephone network.
11. Chargeable time does not include time lost because of faults or defects in the service.
12. All charges assessed under this plan are in addition to Local Exchange line rates.
13. All per minute rates will be billed in arrears.
14. Time of day discounts are not applicable.
15. Customers will automatically receive message detailed billing.
16. Business customer designation includes individual, Multiline, Key, PBX, and CENTREX customers.

C. Exchange Listing

Calls originating in the New London exchanges and terminating in Hannibal will be included as part of this expanded calling plan.

ISSUED: February 27, 2013

EFFECTIVE: March 29, 2013

By: Joel Dohmeier, Vice-President

FILED
Missouri Public
Service Commission
JI-2013-0373

GENERAL EXCHANGE TARIFF

P.S.C. MO No. 8
NEW LONDON TELEPHONE COMPANY
Missouri

Section 5
First Revised Sheet 1
Replaces Original Sheet 1

MISCELLANEOUS SERVICES

CONCURRENCE

New London Telephone Company hereby assents to, adopts and concurs in the Miscellaneous Services as set forth in Section 5 of Stoutland Telephone Company tariff on file with the Missouri Public Service Commission and makes itself a party thereto and obligates itself to observe the provisions therein with the exceptions listed below.

EXCEPTIONS

TOTAL TALK PACK¹

C. RATES		(D)
		(D)
	<u>Rate Per Month</u>	
1. Residence ² Local Bundle, per line	\$30.70	(I)
2. Business ³ Local Bundle, per line	\$39.05	(I)

STAR PACKAGES⁴

C. RATES		
	<u>Rate Per Month</u>	
1. <u>Residence</u>		
a) 3 STAR Standard Package, per line	\$31.99 ⁴	
b) 4 STAR Standard Package, per line	\$41.99 ⁴	(I)
c) 5 STAR Standard Package, per line	\$51.99 ⁴	(I)
		(I)
2. Package Upgrade	\$ 5.00	
3. Package Change Fee	\$ 7.50	

¹ Customers must also subscribe to Direct Long Distance.

² This service is grandfathered to existing Residential customers effective January 7, 2009. The service will not be available to new customers after this date.

³ This service is grandfathered to existing Business customers effective December 30, 2010. The service will not be available to new customers after this date.

⁴ This service is grandfathered to existing customers effective June 1, 2016. The service will not be available to new customers after this date.

ISSUED: April 29, 2016

EFFECTIVE: June 1, 2016

By: Garrin Bott, President

CANCELLED
September 2, 2018
Missouri Public
Service Commission
IN-2019-0055, JI-2019-0020

FILED
Missouri Public
Service Commission
JI-2016-0305

GENERAL EXCHANGE TARIFF

P.S.C. MO No. 7
NEW LONDON TELEPHONE COMPANY.
d/b/a TDS Telecom
Missouri

Section 5

Original Sheet 1

MISCELLANEOUS SERVICES

CONCURRENCE

New London Telephone Company d/b/a TDS Telecom hereby assents to, adopts and concurs in the Miscellaneous Services as set forth in Section 5 of Stoutland Telephone Company, d/b/a TDS Telecom tariff, on file with the Missouri Public Service Commission and makes itself a party thereto and obligates itself to observe the provisions therein with the exceptions listed below.

EXCEPTIONS

TOTAL TALK PACK

C. RATES¹

Phase 1 Rates:

	<u>Rate Per Month</u>	
1. Residence ² Local Bundle, per line	\$27.00 ⁴	(T)
2. Business ³ Local Bundle, per line	\$37.05	

Phase 2 Rates: Effective May 28, 2013

	<u>Rate Per Month</u>	
1. Residence ² Local Bundle, per line	\$28.70	(I)
2. Business ³ Local Bundle, per line	\$37.05	

¹ Customers must also subscribe to TDS Long Distance's Total Talk Pack.

² This service is grandfathered to existing Residential customers effective January 7, 2009. The service will not be available to new customers after this date.

³ This service is grandfathered to existing Business customers effective December 30, 2010. This service will not be available to new customers after this date.

⁴ Rate Effective through May 27, 2013 (T)

STAR PACKAGES

C. RATES

	<u>Rate Per Month</u>
1. <u>Residence</u>	
a) 3 STAR Standard Package, per line	\$29.99
b) 4 STAR Standard Package, per line	\$39.99
c) 5 STAR Standard Package, per line	\$49.99
2. Package Upgrade	\$5.00
3. Package Change Fee	\$7.50

CANCELLED
June 1, 2016
Missouri Public
Service Commission
JI-2016-0305

ISSUED: February 27, 2013

EFFECTIVE: March 29, 2013

By: Joel Dohmeier, Vice-President

FILED
Missouri Public
Service Commission
JI-2013-0373

GENERAL EXCHANGE TARIFF

P.S.C. MO No. 8
NEW LONDON TELEPHONE COMPANY
Missouri

Section 5
Fourth Revised Sheet 2
Replaces Third Revised Sheet 2

MISCELLANEOUS SERVICES

EXCEPTIONS – Continued

SAFETY LINE SERVICE²

C. RATES AND CHARGES

Monthly Rate

Bundle Base Rate – DSL Market A	\$53.95 ¹	(I)
Bundle Base Rate – DSL Market B	\$59.20 ¹	(I)

SECURITY LINE SERVICE³

C. RATES AND CHARGES

Monthly Rate

Bundle Base Rate – DSL Market A	\$43.95 ¹	(I)
Bundle Base Rate – DSL Market B	\$49.20 ¹	(I)

¹ Other data speeds may be available for an additional charge

² This service is grandfathered to existing customers effective August 1, 2012. The service will not be available to new customers after this date.

³ This service is grandfathered to existing customers effective June 1, 2016. The service will not be available to new customers after this date.

ISSUED: April 29, 2016

EFFECTIVE: June 1, 2016

By: Garrin Bott, President

CANCELLED
September 2, 2018
Missouri Public
Service Commission
IN-2019-0055, JI-2019-0020

FILED
Missouri Public
Service Commission
JI-2016-0305

GENERAL EXCHANGE TARIFF

P.S.C. MO No. 7
NEW LONDON TELEPHONE COMPANY.
d/b/a TDS Telecom
Missouri

Section 5
Third Revised Sheet 2
Cancels Second Revised Sheet 2

MISCELLANEOUS SERVICES

EXCEPTIONS - Continued

SAFETY LINE SERVICE ²

C. RATES AND CHARGES

Monthly Rate

Bundle Base Rate – DSL Market A	\$51.95 ¹
Bundle Base Rate – DSL Market B	\$57.20 ¹

¹ Other data speeds may be available for an additional charge.

² This service is grandfathered to existing customers effective August 1, 2012. This service will not be available to new customers as of this date.

SECURITY LINE SERVICE

C. RATES AND CHARGES

Monthly Rate

Bundle Base Rate – DSL Market A	\$41.95 ¹	(T)
Bundle Base Rate – DSL Market B	\$47.20 ¹	(N)

¹ Other data speeds may be available for an additional charge.

CANCELLED
June 1, 2016
Missouri Public
Service Commission
JI-2016-0305

ISSUED: September 20, 2013

EFFECTIVE: September 30, 2013

By: Joel Dohmeier, Vice-President

FILED
Missouri Public
Service Commission
JI-2014-0133

GENERAL EXCHANGE TARIFF

P.S.C. MO No. 7
NEW LONDON TELEPHONE COMPANY,
d/b/a TDS Telecom
Missouri

Section 5
Second Revised Sheet 2
Cancels First Revised Sheet 2

MISCELLANEOUS SERVICES

EXCEPTIONS - Continued

SAFETY LINE SERVICE ²

C. RATES AND CHARGES

Monthly Rate

Bundle Base Rate – DSL Market A	\$51.95 ¹	(l)
Bundle Base Rate – DSL Market B	\$57.20 ¹	(l)

¹ Other data speeds may be available for an additional charge.

² This service is grandfathered to existing customers effective August 1, 2012. This service will not be available to new customers as of this date.

SECURITY LINE SERVICE

C. RATES AND CHARGES

Monthly Rate

Bundle Base Rate	\$41.95 ¹
------------------	----------------------

¹ Other data speeds may be available for an additional charge.

CANCELLED
September 30, 2012
Missouri Public
Service Commission
JI-2014-0133

ISSUED: September 6, 2013

EFFECTIVE: September 16, 2013

By: Joel Dohmeier, Vice-President

FILED
Missouri Public
Service Commission
JI-2014-0115

GENERAL EXCHANGE TARIFF

P.S.C. MO No. 7
NEW LONDON TELEPHONE COMPANY.
d/b/a TDS Telecom
Missouri

Section 5
First Revised Sheet 2
Cancels Original Sheet 2

MISCELLANEOUS SERVICES

EXCEPTIONS - Continued

SAFETY LINE SERVICE ²

C. RATES AND CHARGES

Monthly Rate

Bundle Base Rate – DSL Market A	\$49.95 ¹
Bundle Base Rate – DSL Market B	\$55.20 ¹

¹ Other data speeds may be available for an additional charge.

² This service is grandfathered to existing customers effective August 1, 2012. This service will not be available to new customers as of this date.

SECURITY LINE SERVICE

C. RATES AND CHARGES

Monthly Rate

Bundle Base Rate	\$41.95 ¹
------------------	----------------------

(I)

¹ Other data speeds may be available for an additional charge.

ISSUED: July 15, 2013

EFFECTIVE: July 28, 2013

Filed

CANCELED
September 16, 2013
Missouri Public
Service Commission
JI-2014-0115

By: Joel Dohmeier, Vice-President

Missouri Public
Service Commission
JI-2014-0020

GENERAL EXCHANGE TARIFF

P.S.C. MO No. 7
NEW LONDON TELEPHONE COMPANY.
d/b/a TDS Telecom
Missouri

Section 5
Original Sheet 2

MISCELLANEOUS SERVICES

EXCEPTIONS - Continued

SAFETY LINE SERVICE ²

C. RATES AND CHARGES

Monthly Rate

Bundle Base Rate – DSL Market A	\$49.95 ¹
Bundle Base Rate – DSL Market B	\$55.20 ¹

¹ Other data speeds may be available for an additional charge.

² This service is grandfathered to existing customers effective August 1, 2012. This service will not be available to new customers as of this date.

SECURITY LINE SERVICE

C. RATES AND CHARGES

Monthly Rate

Bundle Base Rate	\$39.95 ¹
------------------	----------------------

¹ Other data speeds may be available for an additional charge.

CANCELLED
July 28, 2013
Missouri Public
Service Commission
JI-2014-0020

ISSUED: February 27, 2013

EFFECTIVE: March 29, 2013

By: Joel Dohmeier, Vice-President

FILED
Missouri Public
Service Commission
JI-2013-0373

GENERAL EXCHANGE TARIFF

P.S.C. MO No. 7
NEW LONDON TELEPHONE COMPANY.
d/b/a TDS Telecom
Missouri

Section 6
Original Sheet 1

SERVICE CONNECTION CHARGES

CONCURRENCE

New London Telephone Company. d/b/a TDS Telecom hereby assents to, adopts and concurs in the Service Connection Charges as set forth in Section 6 of Stoutland Telephone Company, d/b/a TDS Telecom tariff, on file with the Missouri Public Service Commission and makes itself a party thereto and obligates itself to observe the provisions therein with the exceptions listed below.

EXCEPTIONS

B. SERVICE DESCRIPTIONS

- 1. Service Order Charge – Initial:
Initial Service Order charge applies to the work performed by the telephone company to establish a new customer into the billing system. It is also applicable for the connection of additional central office lines, trunks, or line segments to an established service. Transfer of service involving a request for a final bill or, if a final bill is not requested, a refusal of the future customer to accept full responsibility for the former customer's account.
- 4. Line Connection Charge:
Central Office Work is included in the Line Connection Charge.
- 5. Premise Visit Charge
Additional work operations such as premises visits made to deliver new telephone number designations or additional service orders processed to effect multiple completion dates requested by the customer will be charged for at levels not to exceed differential costs of labor and material.

D. RATES

	<u>Non-Recurring Rates</u>
1. Initial Service Order	\$14.00
2. Subsequent Service Order	\$5.00
3. Central Office Work	Included in Line Connection
4. Line Connection	\$16.00
5. Premise Visit	See Description Above
6. Rearrangement/Repair	\$16.00
7. Reconnect for Non-Payment	\$18.00
8. NSF Charge	\$15.00

ISSUED: February 27, 2013

EFFECTIVE: March 29, 2013

By: Joel Dohmeier, Vice-President

CANCELLED
September 2, 2018
Missouri Public
Service Commission
IN-2019-0055, JI-2019-0020

FILED
Missouri Public
Service Commission
JI-2013-0373

GENERAL EXCHANGE TARIFF

P.S.C. MO No. 8
NEW LONDON TELEPHONE COMPANY
Missouri

Section 7
First Revised Sheet 1
Replaces Original Sheet 1

DIRECTORY SERVICES

HOLD FOR FUTURE USE

(D)

(D)

ISSUED: February 17, 2016

EFFECTIVE: March 18, 2016

By: Garrin Bott, President

CANCELLED
September 2, 2018
Missouri Public
Service Commission
IN-2019-0055, JI-2019-0020

FILED
Missouri Public
Service Commission
JI-2016-0217

GENERAL EXCHANGE TARIFF

P.S.C. MO No. 7
NEW LONDON TELEPHONE COMPANY.
d/b/a TDS Telecom
Missouri

Section 7
Original Sheet 1

DIRECTORY SERVICES

CONCURRENCE

New London Telephone Company. d/b/a TDS Telecom hereby assents to, adopts and concurs in the Directory Services as set forth in Section 7 of Stoutland Telephone Company, d/b/a TDS Telecom tariff, on file with the Missouri Public Service Commission and makes itself a party thereto and obligates itself to observe the provisions therein with the exceptions listed below.

EXCEPTIONS

DIRECTORY LISTINGS

C. RATES

	Monthly Rate
1. Primary Listings (See Condition 1)	
2. Additional Line of Information , per listing	\$1.00
3. Additional Directory Listings, Business	\$2.00
4. Additional Directory Listings, Residence	\$1.00
5. Foreign Directory Listings, per listing ¹	\$1.50
6. Non-Published Service, per listing ²	\$2.00
7. Non-listed Service, per listing ²	\$1.50

¹ A foreign or noncustomer listing may be furnished to customers requesting that their listing be included in the directory of an exchange other than that from which service is rendered.

² The charge will be omitted for customers having other listed service.

CANCELLED
March 18, 2016
Missouri Public
Service Commission
JI-2016-0217

ISSUED: February 27, 2013

EFFECTIVE: March 29, 2013

By: Joel Dohmeier, Vice-President

FILED
Missouri Public
Service Commission
JI-2013-0373

GENERAL EXCHANGE TARIFF

P.S.C. MO No. 7
NEW LONDON TELEPHONE COMPANY.
d/b/a TDS Telecom
Missouri

Section 8
Original Sheet 1

OPTIONAL SERVICES

CONCURRENCE

New London Telephone Company, d/b/a TDS Telecom hereby assents to, adopts and concurs in the Optional Services as set forth in Section 8 of Stoutland Telephone Company, d/b/a TDS Telecom tariff, on file with the Missouri Public Service Commission and makes itself a party thereto and obligates itself to observe the provisions therein with the exceptions listed below.

EXCEPTIONS

CUSTOM CALLING SERVICES

B. Service Descriptions

11. Personal Ringing Service – *Not Available*

D. Rates And Discounts

1. Rates

<u>One Service Per Line</u>	<u>Rate Per Month</u>	<u>Trans Code</u>	<u>Activation Code</u>	<u>Deactivation Code</u>
h. Home Intercom-Basic	0.75	CCHI	N/A	N/A
k. Personal Ringing	N/A	N/A	N/A	N/A

ISSUED: February 27, 2013

EFFECTIVE: March 29, 2013

By: Joel Dohmeier, Vice-President

CANCELLED
September 2, 2018
Missouri Public
Service Commission
IN-2019-0055, JI-2019-0020

FILED
Missouri Public
Service Commission
JI-2013-0373

GENERAL EXCHANGE TARIFF

P.S.C. MO No. 7
NEW LONDON TELEPHONE COMPANY.
d/b/a TDS Telecom
Missouri

Section 9
Original Sheet 1

CONSTRUCTION CHARGES

CONCURRENCE

New London Telephone Company, d/b/a TDS Telecom hereby assents to, adopts and concurs in the Construction Charges as set forth in Section 9 of Stoutland Telephone Company, d/b/a TDS Telecom tariff, on file with the Missouri Public Service Commission and makes itself a party thereto and obligates itself to observe the provisions therein with the exceptions listed below.

EXCEPTIONS

No Exceptions

ISSUED: February 27, 2013

By: Joel Dohmeier, Vice-President

CANCELLED
September 2, 2018
Missouri Public
Service Commission
IN-2019-0055, JI-2019-0020

EFFECTIVE: March 29, 2013

FILED
Missouri Public
Service Commission
JI-2013-0373

GENERAL EXCHANGE TARIFF

P.S.C. MO No. 7
NEW LONDON TELEPHONE COMPANY.
d/b/a TDS Telecom
Missouri

Section 10
Original Sheet 1

PRIVATE LINE SERVICES

CONCURRENCE

New London Telephone Company, d/b/a TDS Telecom hereby assents to, adopts and concurs in the Private Line Services as set forth in Section 10 of Stoutland Telephone Company, d/b/a TDS Telecom tariff, on file with the Missouri Public Service Commission and makes itself a party thereto and obligates itself to observe the provisions therein with the exceptions listed below.

EXCEPTIONS

No Exceptions

ISSUED: February 27, 2013

By: Joel Dohmeier, Vice-President

CANCELLED
September 2, 2018
Missouri Public
Service Commission
IN-2019-0055, JI-2019-0020

EFFECTIVE: March 29, 2013

FILED
Missouri Public
Service Commission
JI-2013-0373

GENERAL EXCHANGE TARIFF

P.S.C. MO No. 7
NEW LONDON TELEPHONE COMPANY.
d/b/a TDS Telecom
Missouri

Section 11
Second Revised Sheet 1
Cancels First Revised Sheet 1

ACCESS SERVICES

CONCURRENCE

New London Telephone Company. d/b/a TDS Telecom hereby assents to, adopts and concurs in the Access Services as set forth in Section 11 of Stoutland Telephone Company, d/b/a TDS Telecom tariff, on file with the Missouri Public Service Commission and makes itself a party thereto and obligates itself to observe the provisions therein with the exceptions listed below.

EXCEPTIONS

D. RATES AND CHARGES

1. Common Line Access Service

		<u>Rate</u>	<u>Tariff Section Reference</u>
(a)	<u>Intrastate Carrier Common Line Access</u>		
	-Originating	\$0.013191	3.6
	-Terminating	\$0.00	3.6

2. Switched Access Service

		<u>Rate</u>	<u>Tariff Section Reference</u>
(b)	<u>Local Transport</u>		
	4. <u>Tandem Switched Transport</u>		
	b. <u>Tandem Switched Termination</u>		
	Per Access Minute Per Termination		6.2.(A)(3)(c)
	-Originating	\$0.010782	

(D)

ISSUED: May 30, 2014

By: Joel Dohmeier, Vice-President

CANCELLED
September 2, 2018
Missouri Public
Service Commission
IN-2019-0055, JI-2019-0020

EFFECTIVE: July 1, 2014

FILED
Missouri Public
Service Commission
JI-2014-0516

GENERAL EXCHANGE TARIFF

P.S.C. MO No. 7
NEW LONDON TELEPHONE COMPANY.
d/b/a TDS Telecom
Missouri

Section 11
First Revised Sheet 1
Cancels Original Sheet 1

ACCESS SERVICES

CONCURRENCE

New London Telephone Company. d/b/a TDS Telecom hereby assents to, adopts and concurs in the Access Services as set forth in Section 11 of Stoutland Telephone Company, d/b/a TDS Telecom tariff, on file with the Missouri Public Service Commission and makes itself a party thereto and obligates itself to observe the provisions therein with the exceptions listed below.

EXCEPTIONS

D. RATES AND CHARGES

1. Common Line Access Service

		Rate	Tariff Section Reference
(a)	<u>Intrastate Carrier Common Line Access</u>		
	-Originating	\$0.013191	3.6
	-Terminating	\$0.00	3.6

2. Switched Access Service

		Rate	Tariff Section Reference
(b)	<u>Local Transport</u>		
	4. <u>Tandem Switched Transport</u>		
	b. <u>Tandem Switched Termination</u>		
	Per Access Minute Per Termination		6.2.(A)(3)(c)
	-Originating	\$0.010782	
	-Terminating	\$0.002171	

(I)
(D)
|
(D)

ISSUED: May 31, 2013

EFFECTIVE: July 2, 2013

By: Joel Dohmeier, Vice-President

CANCELLED
July 1, 2014
Missouri Public
Service Commission
JI-2014-0516

FILED
Missouri Public
Service Commission
JI-2013-0571

GENERAL EXCHANGE TARIFF

P.S.C. MO No. 7
NEW LONDON TELEPHONE COMPANY.
d/b/a TDS Telecom
Missouri

Section 11
Original Sheet 1

ACCESS SERVICES

CONCURRENCE

New London Telephone Company. d/b/a TDS Telecom hereby assents to, adopts and concurs in the Access Services as set forth in Section 11 of Stoutland Telephone Company, d/b/a TDS Telecom tariff, on file with the Missouri Public Service Commission and makes itself a party thereto and obligates itself to observe the provisions therein with the exceptions listed below.

EXCEPTIONS

D. RATES AND CHARGES

1. Common Line Access Service

		Rate	Tariff Section Reference
(a)	<u>Intrastate Carrier Common Line Access</u>		
	-Originating	\$0.013191	3.6
	-Terminating	\$0.00	3.6

2. Switched Access Service

		Rate	Tariff Section Reference
(b)	<u>Local Transport</u>		
	4. <u>Tandem Switched Transport</u>		
	b. <u>Tandem Switched Termination</u>		
	Per Access Minute Per Termination		6.2.(A)(3)(c)
	-Originating	\$0.010782	
	-Terminating	\$0.002090	
(c)	<u>End Office</u>		
	2. <u>Transitional Rate Element</u>		
	-Terminating	\$0.025620	6.2(B)(2)

CANCELLED
July 2, 2013
Missouri Public
Service Commission
JI-2013-0571

ISSUED: February 27, 2013

EFFECTIVE: March 29, 2013

By: Joel Dohmeier, Vice-President

FILED
Missouri Public
Service Commission
JI-2013-0373

GENERAL EXCHANGE TARIFF

P.S.C. MO No. 7
NEW LONDON TELEPHONE COMPANY.
d/b/a TDS Telecom
Missouri

Section 11
Original Sheet 2

ACCESS SERVICES

D. RATES AND CHARGES (Continued)

3 Special Access Service

	<u>Monthly Rates</u>	<u>Nonrecurring Charges</u>	<u>Tariff Section Reference</u>
a. Channel Termination, per termination*			
(2) Metallic Channel Two-Wire	Not Available		7.1.1(A)

* The Channel Termination rate includes non-chargeable Channel Interfaces as set forth in 7.1.4.

5 Miscellaneous Services

e. Operator Transfer Service Not Available

ISSUED: February 27, 2013

By: Joel Dohmeier, Vice-President

CANCELLED
September 2, 2018
Missouri Public
Service Commission
IN-2019-0055, JI-2019-0020

EFFECTIVE: March 29, 2013

FILED
Missouri Public
Service Commission
JI-2013-0373