

SBC PSC MO #17
Valley Park, Missouri
14th Revised Sheet 2
Replacing 13th Revised Sheet 2

Non-Scannable Map

(Is viewable in the Data Center
200 Madison Street, 1st Floor
Jefferson City MO)

SBC PSC MO #17
Versailles, Missouri
Original Sheet 2
Replacing Ozark Tel. Co.
P.S.C. Mo. No. 1
Original Sheet 2

Non-Scannable Map

(Is viewable in the Data Center
200 Madison Street, 1st Floor
Jefferson City MO)

CANCELLED
June 29, 2007
TO-2002-185
Missouri Public
Service Commission

NO SUPPLEMENT TO THIS TARIFF WILL
BE ISSUED EXCEPT FOR THE PURPOSE OF
CANCELING THIS TARIFF.

P. S. C. Mo. No. 17
EXCHANGE AREA MAP

RECEIVED
Versailles, Missouri
15th REVISED SHEET 3
REPLACING 14th REVISED SHEET 3
FEB 14 1977

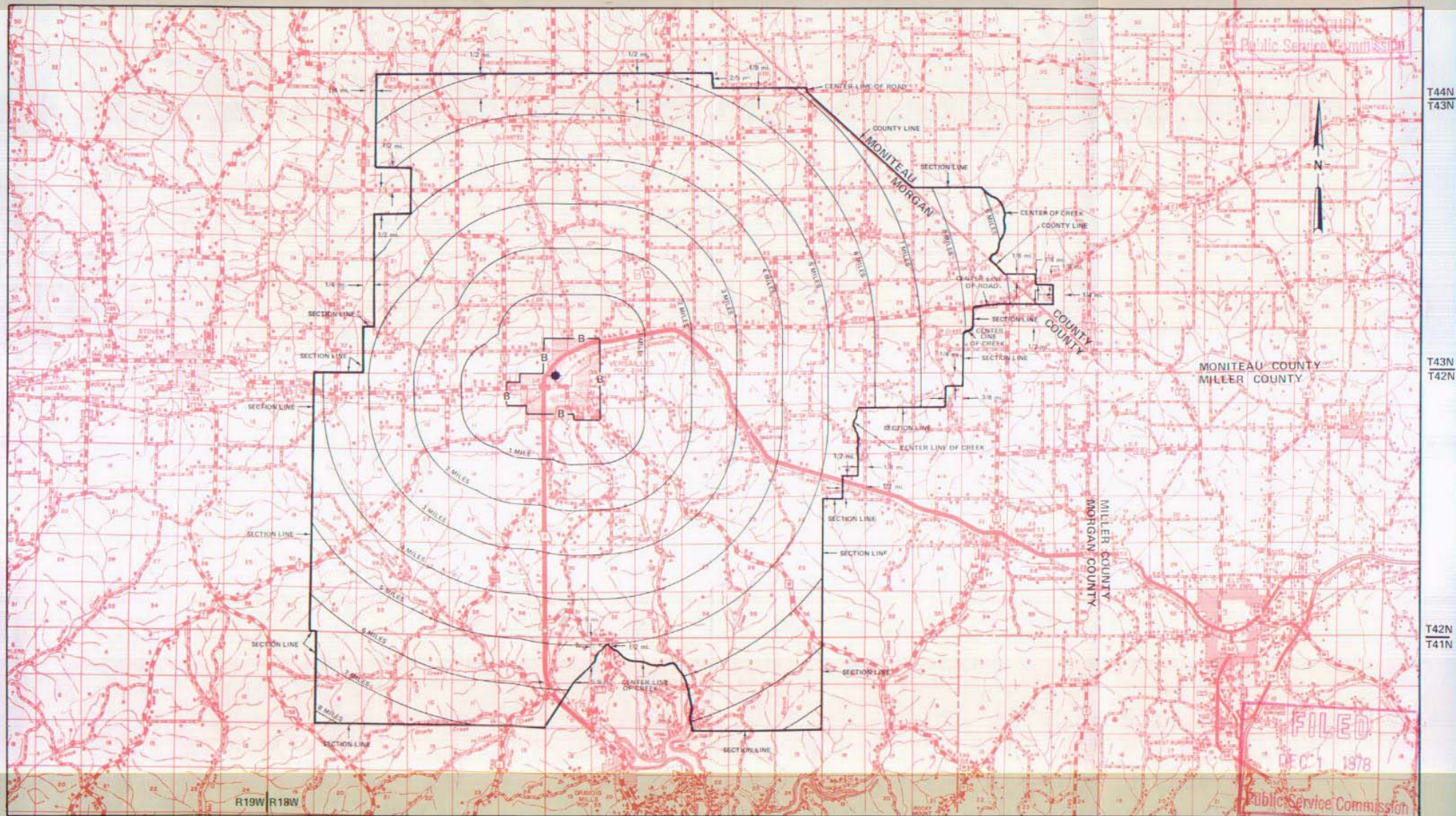

T44N

T43N

T43N

T42N

T42N

T41N

FILED
DEC 1 1978
Public Service Commission

By R. R. SHOCKLEY, Vice President, Missouri
Southwestern Bell Telephone Company
St. Louis, Missouri

R18W|R17W

R17W|R16W

R16W|R15W

R15W|R14W

Issued: February 15, 1977

Effective: DEC 1 1978

NO SUPPLEMENT TO THIS TARIFF WILL BE ISSUED EXCEPT FOR THE PURPOSE OF CANCELING THIS TARIFF.

Vienna, Missouri

P. S. C. Mo. No. 17 BASE RATE AREA MAP

1st REVISED SHEET 2
REPLACING ORIGINAL SHEET 2

CANCELLED
June 29, 2007
TO-2002-185
Missouri Public
Service Commission

RECEIVED
FEB 2 1990
MISSOURI
Public Service Commission

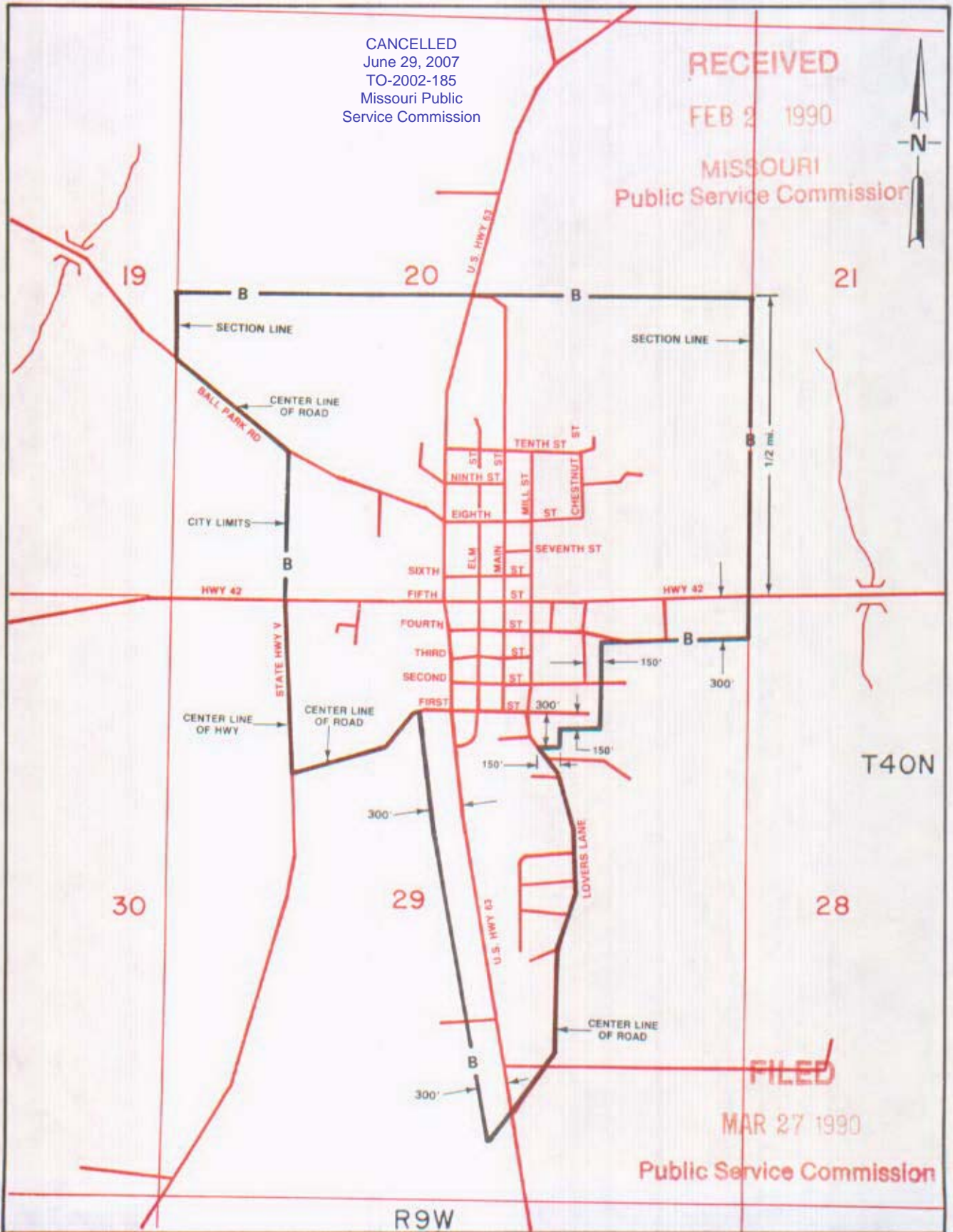
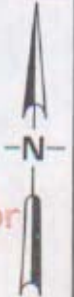

FILED
MAR 27 1990
Public Service Commission

FEB 2 1990

By R. D. BARRON, U.S. PRESIDENT, MISSOURI DIVISION
Southwestern Bell Telephone Company
St. Louis, Missouri

MAR 27 1990

Issued: _____

Effective: _____

CANCELLED
June 29, 2007
TO-2002-185
Missouri Public
Service Commission

NO SUPPLEMENT TO THIS TARIFF WILL
BE ISSUED EXCEPT FOR THE PURPOSE OF
CANCELING THIS TARIFF.

P. S. C. Mo. No. 17 EXCHANGE AREA MAP

Vienna, Missouri

7th REVISED SHEET 3
REPLACING 6th REVISED SHEET 3

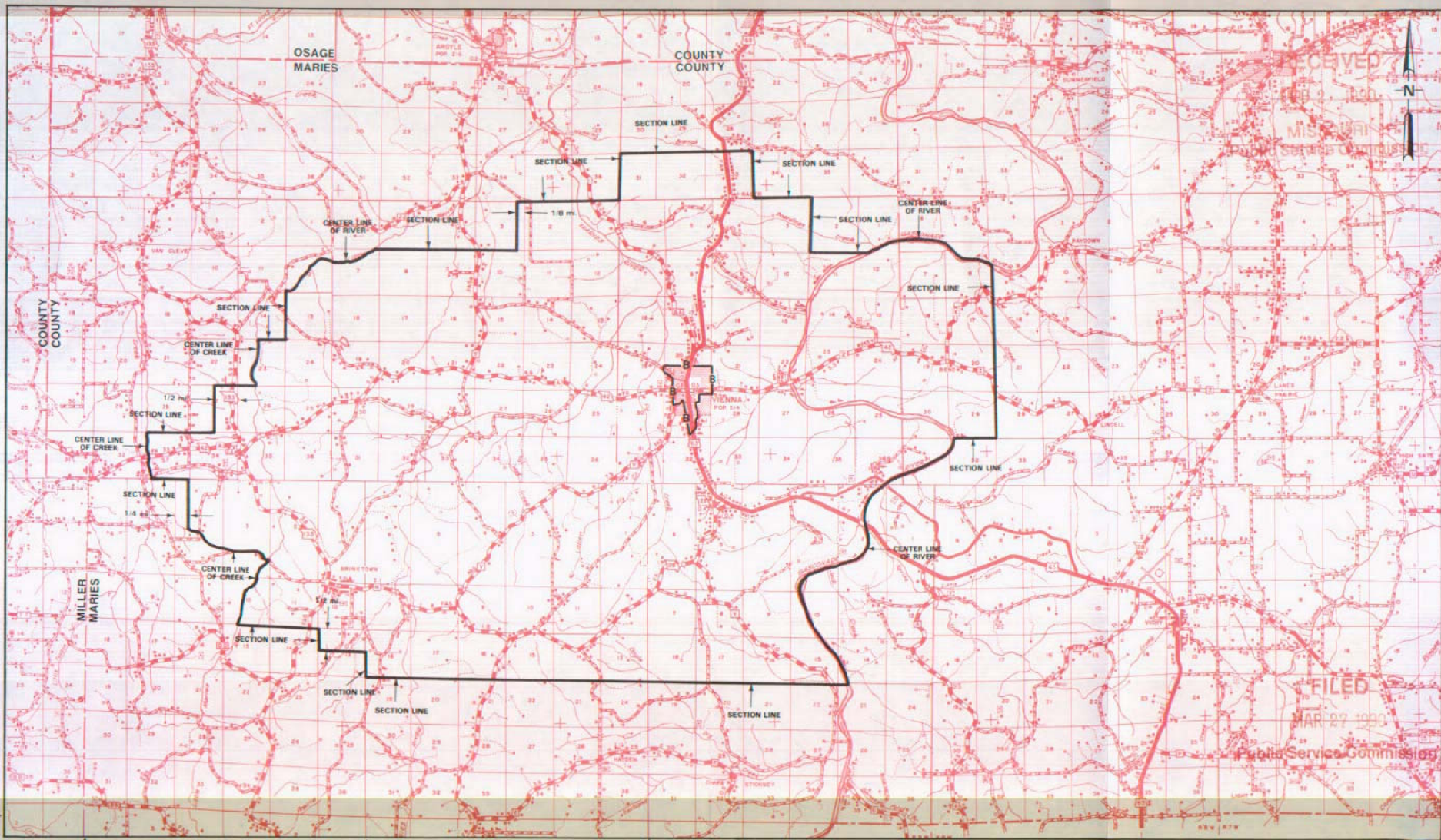

R12W | R11W

R11W | R10W

R10W | R9W

R9W | R8W

R8W | R7W

FEB 2 1990

Issued:

By R. D. BARRON, PRESIDENT, MISSOURI DIVISION
Southwestern Bell Telephone Company
St. Louis, Missouri

MAR 27 1990

Effective:

CANCELLED
June 29, 2007
TO-2002-185
Missouri Public
Service Commission

NO SUPPLEMENT TO THIS TARIFF WILL
BE ISSUED EXCEPT FOR THE PURPOSE OF
CANCELING THIS TARIFF.

P. S. C. Mo. No. 17
BASE RATE AREA MAP

Walnut Grove, Missouri
1st REVISED SHEET 2
REPLACING ORIGINAL SHEET 2

RECEIVED
JUL 23 1974
MISSOURI
Public Service Commission

Base Rate Area

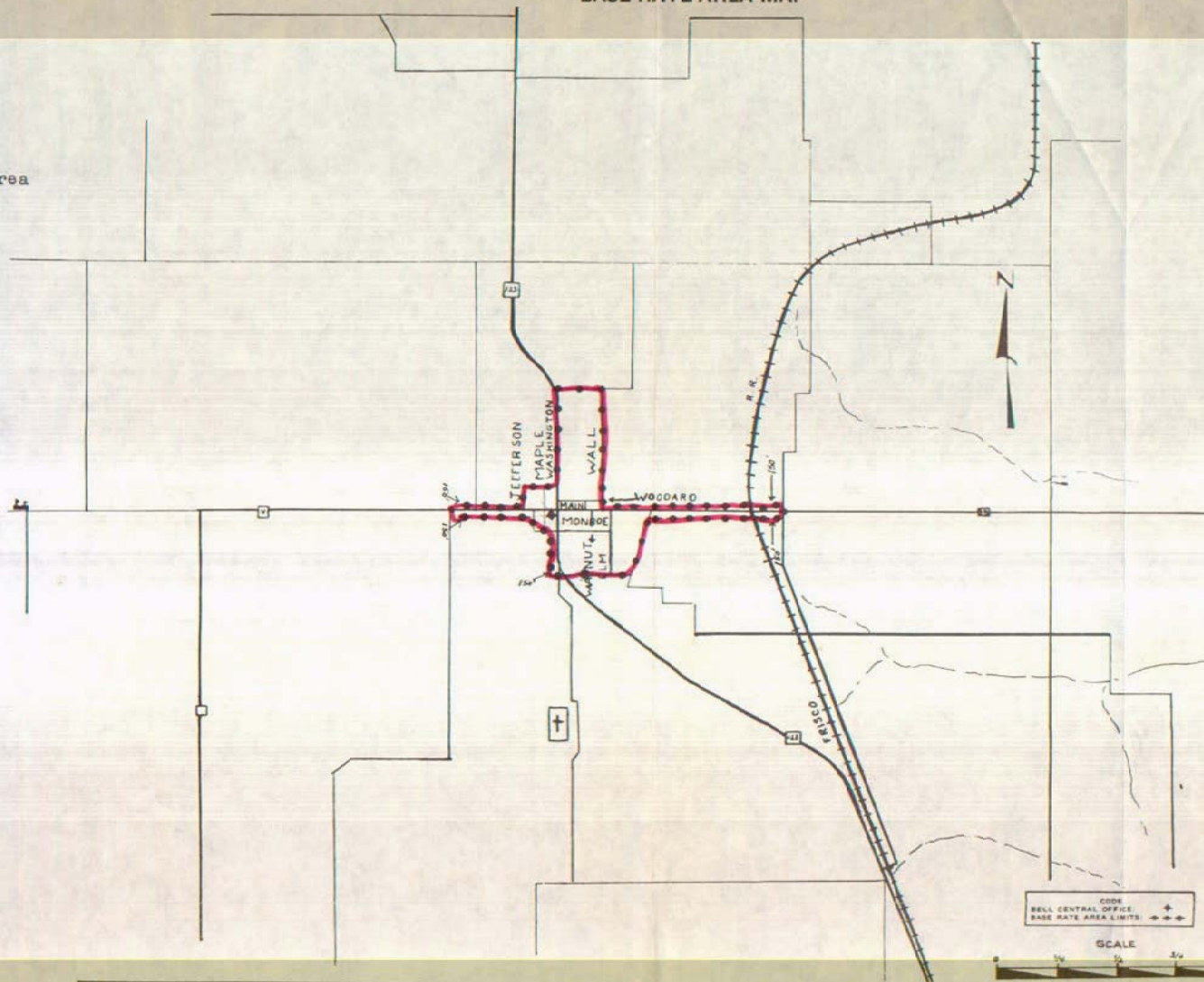

FILED
SEP 3 1974
Public Service Commission

Issued: August 2, 1974

By R. R. SHOCKLEY, Vice President, Missouri-Illinois
Southwestern Bell Telephone Company
St. Louis, Missouri

Effective: September 3, 1974