

NO SUPPLEMENT TO THIS TARIFF WILL BE ISSUED EXCEPT FOR THE PURPOSE OF CANCELING THIS TARIFF.

Camdenton, Missouri
1st REVISED SHEET 2
REPLACING ORIGINAL SHEET 2

P. S. C. Mo. No. 1
(Canceling all Previous Schedules)

INITIAL RATE AREA MAP

LINNCREEK, MO



RECEIVED
AUG 29 1950
MISSOURI
Public Service Comm.

FILED
OCT 1 1950

PUBLIC SERVICE COMMISSION

CAMDENTON, MO

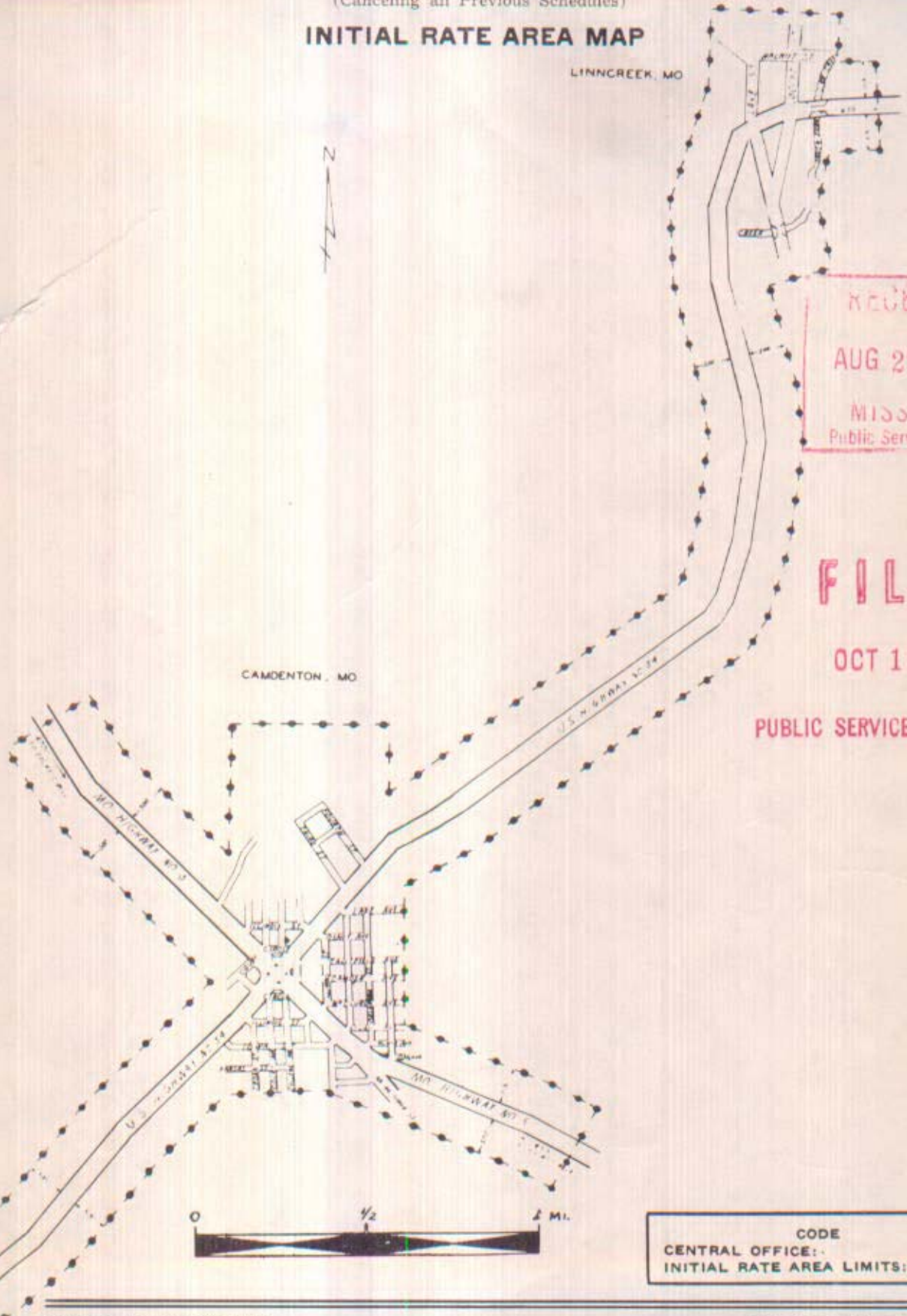

CODE
CENTRAL OFFICE: [Symbol]
INITIAL RATE AREA LIMITS: [Symbol]

Issued: August 28, 1950

Effective: October 1, 1950

CANCELLED
June 29, 2007
TO-2002-185
Missouri Public
Service Commission

By T. L. LEONARD, President
Ozark Central Telephone Company
St. Louis, Missouri

P. S. C. Mo. No. 17
Camdenton North
ISLAND BASE RATE AREA

RECEIVED
APR 27 1972
MISSOURI
Public Service Commission

CAMDENTON NORTH ISLAND BASE RATE AREA

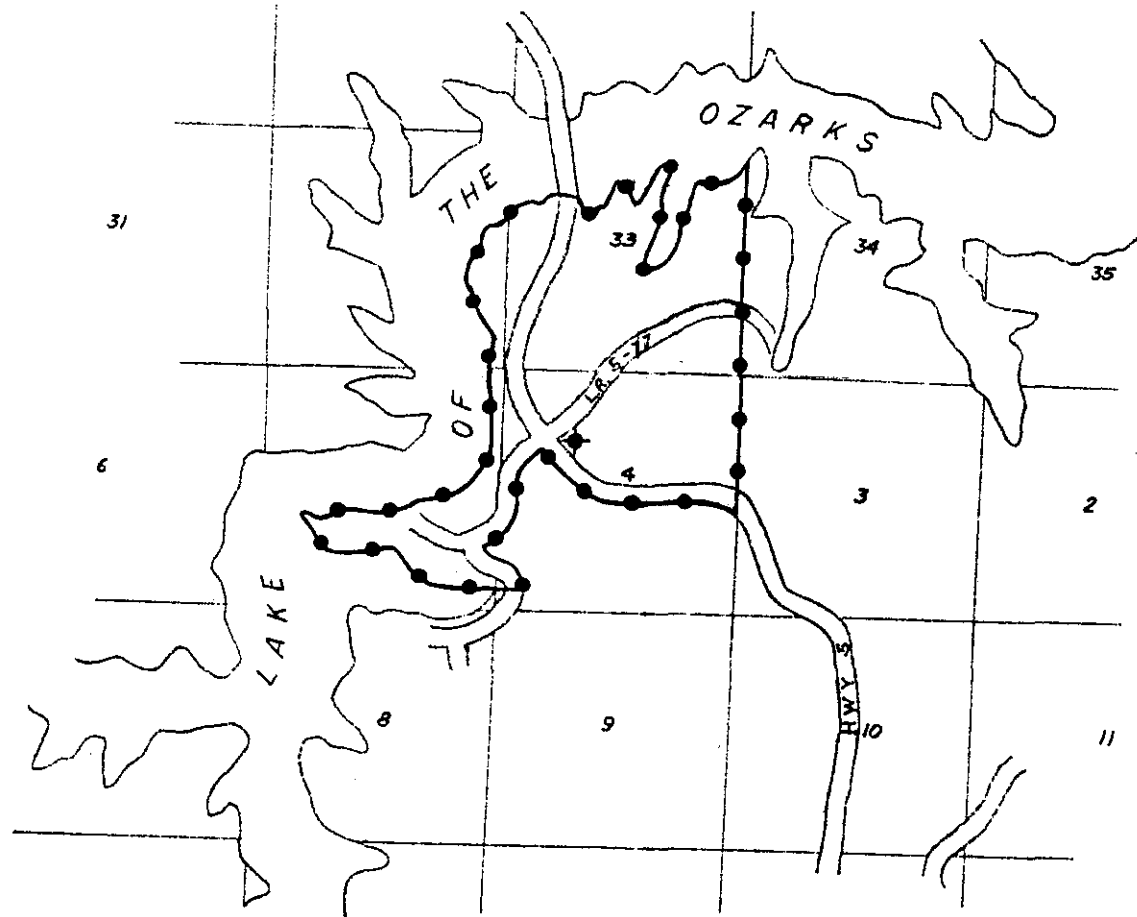

FILED
JUN 4 1972
Public Service Commission



CODE
BELL CENTRAL OFFICE: ◆
BASE RATE AREA LIMITS: ●●●●

Issued: May 4, 1972

By R. R. SHOCKLEY, Vice President, Missouri-Illinois
Southwestern Bell Telephone Company
St. Louis, Missouri

Effective: June 4, 1972

CANCELLED
June 29, 2007
TO-2002-185
Missouri Public
Service Commission

CANCELLED
June 29, 2007
TO-2002-185
Missouri Public
Service Commission

NO SUPPLEMENT TO THIS TARIFF WILL
BE ISSUED EXCEPT FOR THE PURPOSE OF
CANCELING THIS TARIFF.

P. S. C. Mo. No. 17
EXCHANGE AREA MAP

Missouri Public
Service Commission

Camdenton, Missouri

REC'D SEP 21 1998

13
12
REPLACING 13th REVISED SHEET 3
12th REVISED SHEET 3 ✓

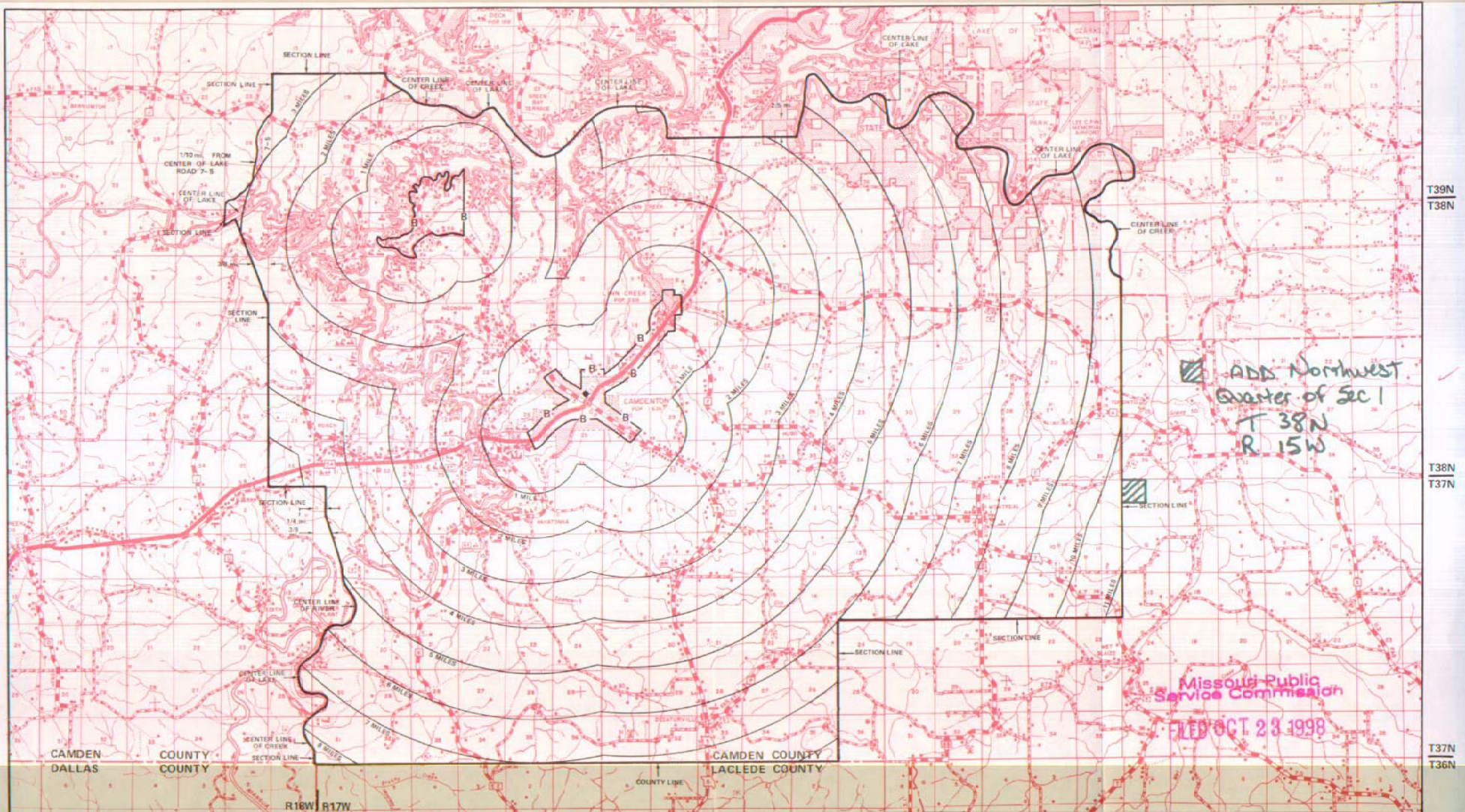

Missouri Public
Service Commission

FILED OCT 23 1998

R19W | R18W | SEP 21 1998

By R. R. SHOCKLEY, Vice President, Missouri
Southwestern Bell Telephone Company

Priscilla Hill-Ardoin,

R17W | R16W

R16W | R15W

R15W | R14W

OCT 23 1998

Issued: MARCH 18 1980

St. Louis, Missouri

Effective: APRIL 17 1980

NO SUPPLEMENT TO THIS TARIFF WILL
BE ISSUED EXCEPT FOR THE PURPOSE OF
CANCELING THIS TARIFF.

P. S. C. Mo. No. 17
EXCHANGE AREA MAP

Camdenton, Missouri
12A REVISED SHEET 3
REPLACING 11A REVISED SHEET 3

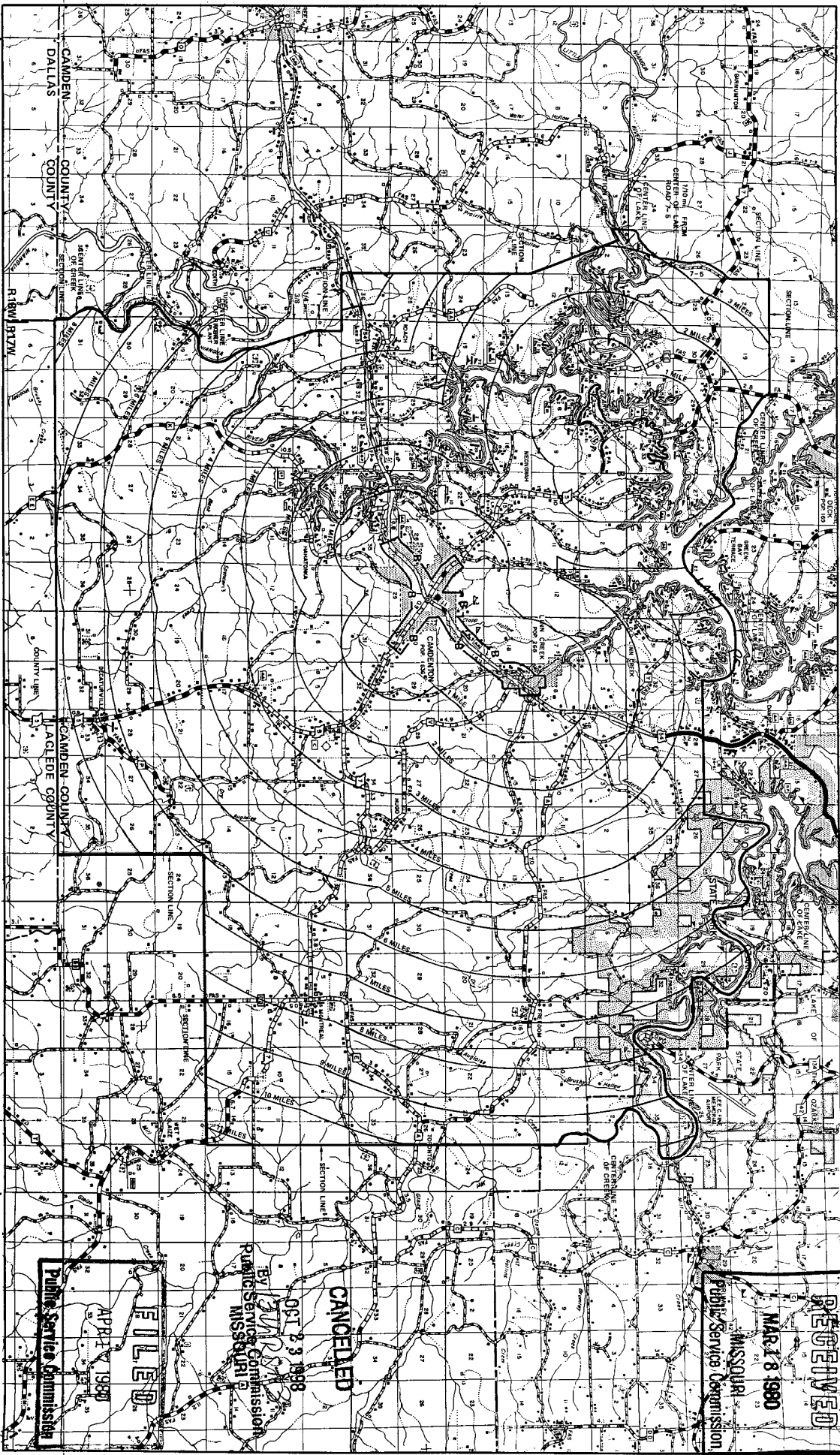

RECEIVED
MAR 18 1980
MISSOURI
Public Service Commission

CANCELLED
OCT 23 1988
BY
Public Service Commission
MISSOURI

FILED
APR 17 1980
Public Service Commission

By R. R. SHOCKLEY, Vice President, Missouri
Southwestern Bell Telephone Company
St. Louis, Missouri

Effective: APRIL 17, 1980

Issued: MARCH 18, 1980

NO SUPPLEMENT TO THE TARIFF WILL BE ISSUED EXCEPT FOR THE PURPOSE OF CANCELING THIS TARIFF.

P. S. C. Mo. No. 17 BASE RATE AREA MAP

Campbell, MO. LOCAL
ORIGINAL SHEET 2
REPLACING SOUTHEAST MO. TEL. CO.
P. S. C. Mo. No. 2
FIRST REVISED SHEET 1-A

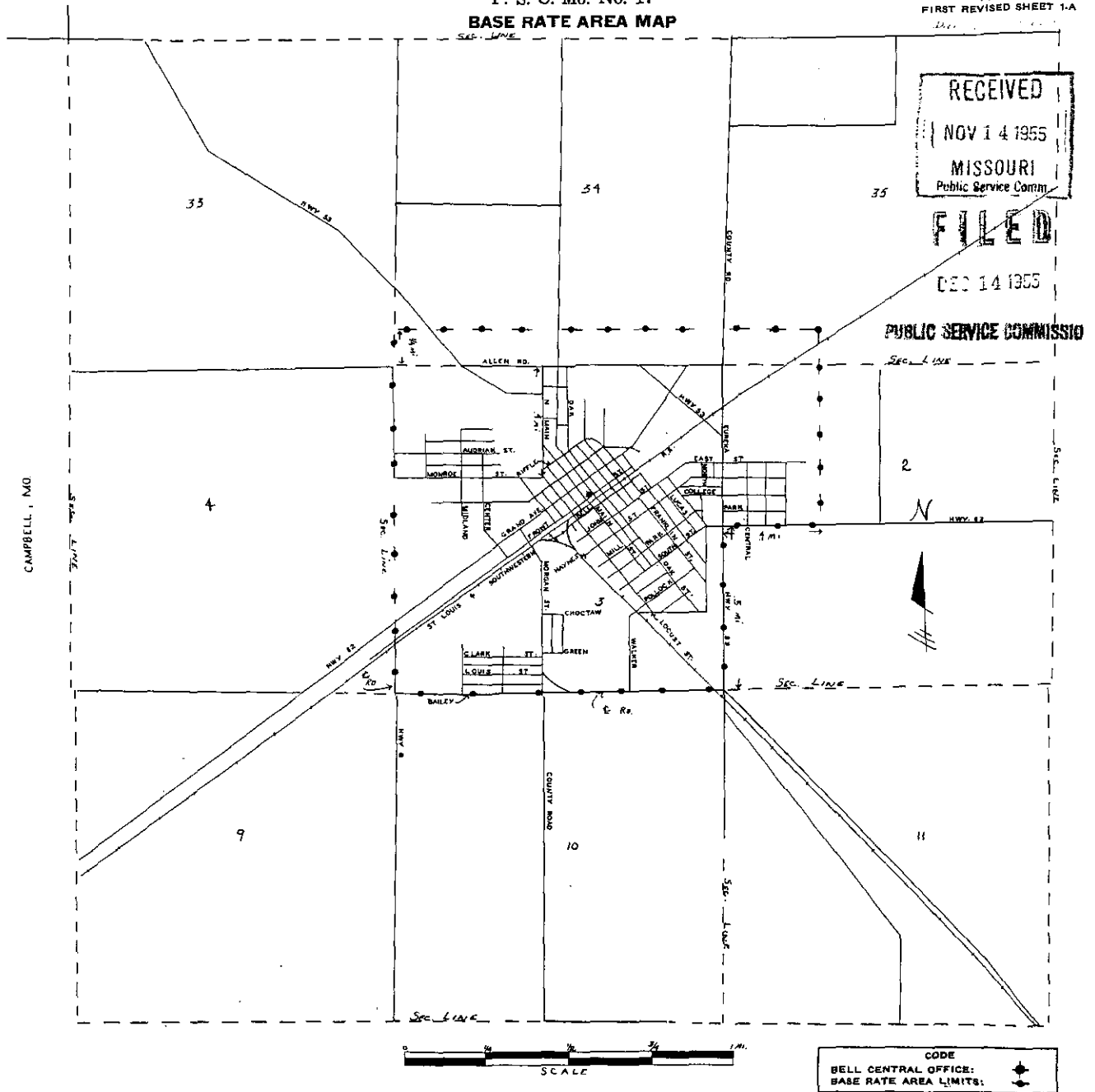

CANCELLED
June 29, 2007
TO-2002-185
Missouri Public
Service Commission

Issued: November 14, 1955

By J. R. PETERSON, General Manager
Southwestern Bell Telephone Company
St. Louis, Missouri

Effective: December 14, 1955

NO SUPPLEMENT TO THIS TARIFF WILL BE ISSUED EXCEPT FOR THE PURPOSE OF CANCELING THIS TARIFF.

P. S. C. Mo. No. 17

Campbell, Missouri

6th REVISED SHEET 3
REPLACING 5th REVISED SHEET 3

EXCHANGE AREA MAP

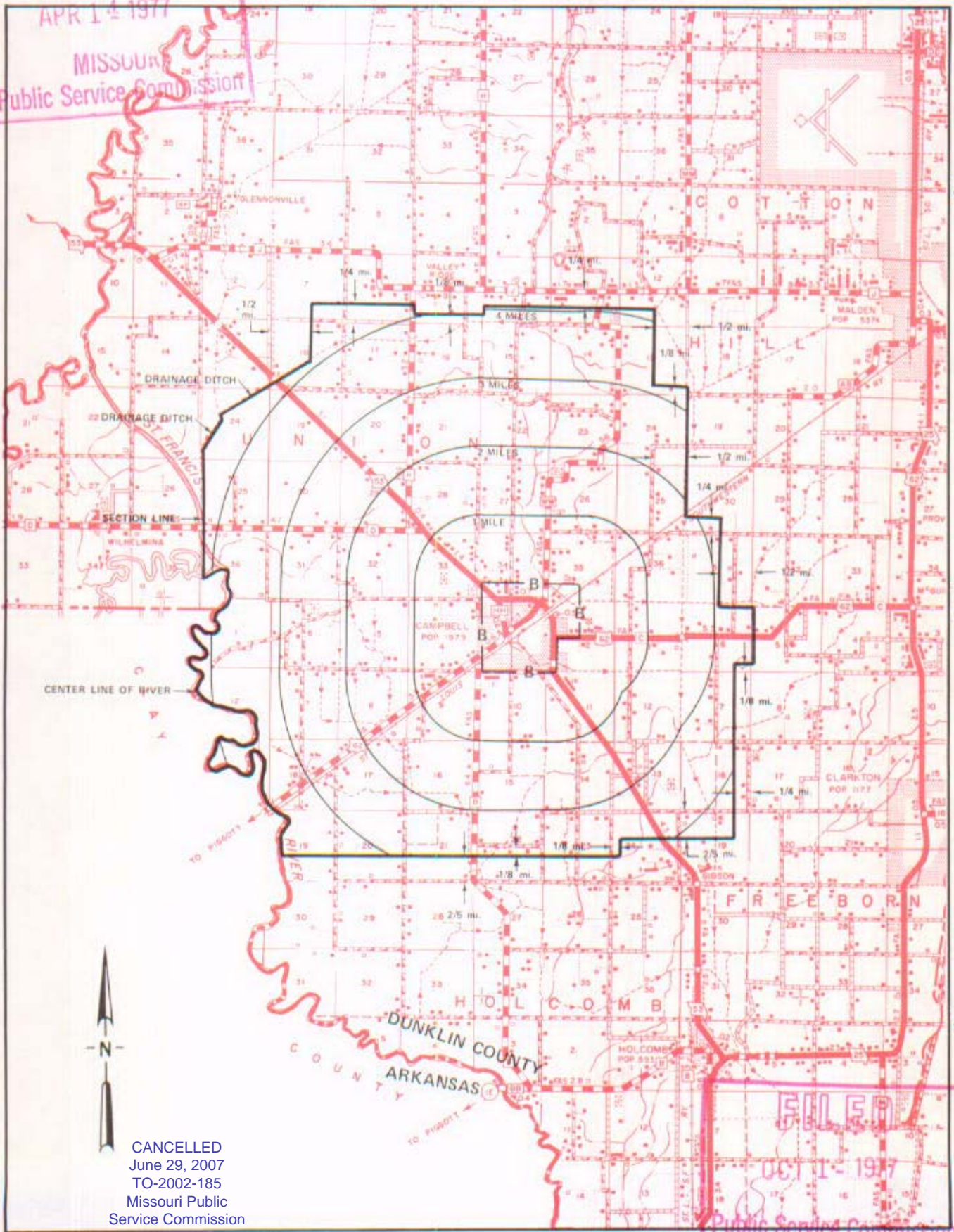

RECEIVED
APR 1 - 1977
MISSOURI
Public Service Commission

FILED
OCT 1 - 1977
Public Service Commission

CANCELLED
June 29, 2007
TO-2002-185
Missouri Public
Service Commission

By R. R. SHOCKLEY, Vice President, Missouri
Southwestern Bell Telephone Company
St. Louis, Missouri

Issued: April 1977

Effective: OCT 1 1977

SBC PSC MO #17
Cape Girardeau, Missouri
3rd Revised Sheet 2
Replacing 2nd Revised Sheet 2

Non-Scannable Map

(Is viewable in the Data Center
200 Madison Street, 1st Floor
Jefferson City MO)

NO SUPPLEMENT TO THIS TARIFF WILL
BE ISSUED EXCEPT FOR THE PURPOSE OF
CANCELING THIS TARIFF.

P. S. C. Mo. No. 17
EXCHANGE AREA MAP

Cape Girardeau, Missouri

7th REVISED SHEET 3
REPLACING 6th REVISED SHEET 3

CANCELLED
June 29, 2007
TO-2002-185
Missouri Public
Service Commission

RECEIVED

SEP 8 1994

MISSOURI
Public Service Commission

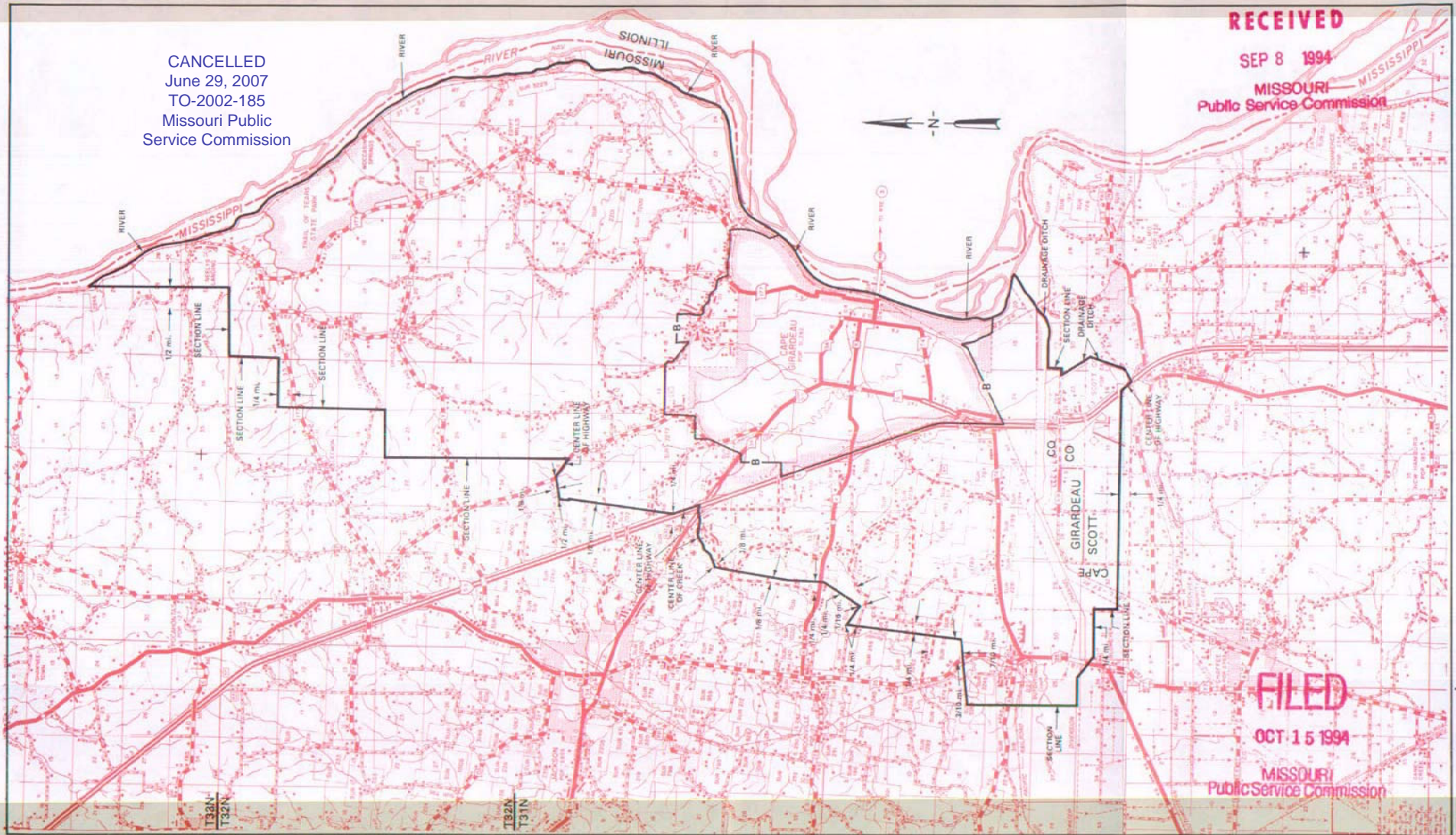

FILED

OCT 15 1994

MISSOURI
Public Service Commission

Issued: September 15, 1994

By HORACE WILKINS, JR., President-Missouri
Southwestern Bell Telephone Company
St. Louis, Missouri

Effective: October 15, 1994

SBC PSC MO #17
Cardwell, Missouri
1st Revised Sheet 2
Replacing Original Sheet 2

CANCELLED
June 29, 2007
TO-2002-185
Missouri Public
Service Commission

Non-Scannable Map

(Is viewable in the Data Center
200 Madison Street, 1st Floor
Jefferson City MO)

NO SUPPLEMENT TO THIS TARIFF WILL
BE ISSUED EXCEPT FOR THE PURPOSE OF
CANCELING THIS TARIFF.

Cardwell, Missouri
3rd REVISED SHEET 3 -
REPLACING 2nd REVISED SHEET 3 -

P. S. C. Mo. No. 17
EXCHANGE AREA MAP

RECEIVED
JAN 20 1966
MISSOURI
Public Service Comm.

CANCELLED
June 29, 2007
TO-2002-185
Missouri Public
Service Commission

CARDWELL, MO.

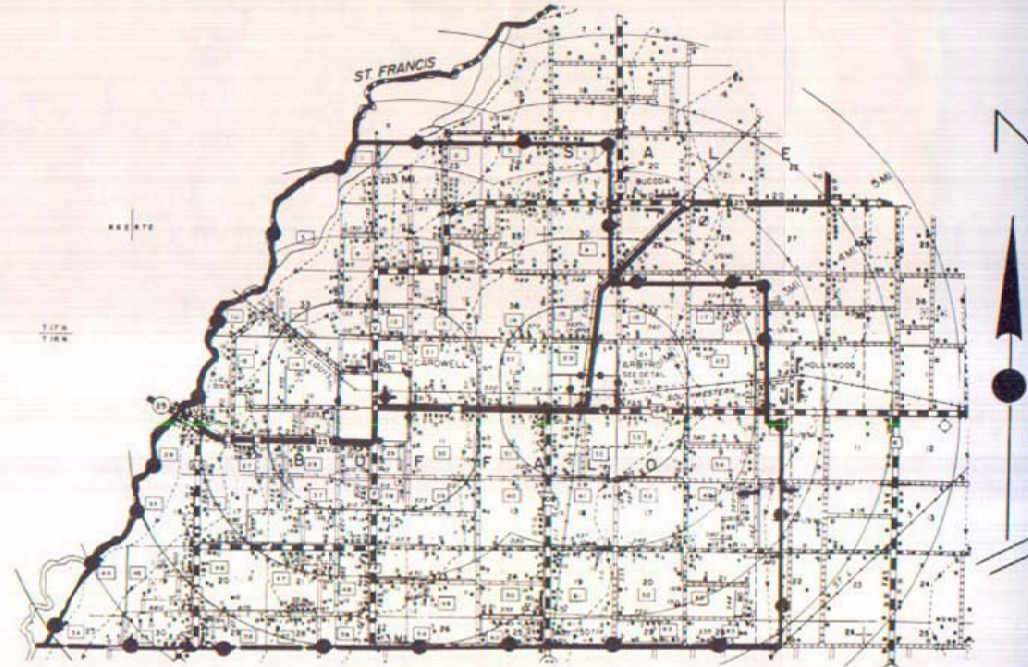

FILED

FEB 23 1966

PUBLIC SERVICE COMMISSION

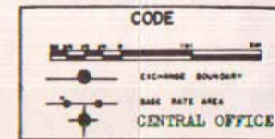

Issued: January 21, 1966

Effective: March 1, 1966

By R. R. SHOCKLEY, Vice President and General Manager
Southwestern Bell Telephone Company
St. Louis, Missouri

NO SUPPLEMENT TO THIS TARIFF SHALL
BE ISSUED EXCEPT FOR THE PURPOSE OF
CANCELING THIS TARIFF.

P. S. C. Mo. No. 17
BASE RATE AREA MAP

Carlin Junction, Missouri
REVISED SHEET 2
REPLACING ORIGINAL SHEET 2

CANCELLED
June 29, 2007
TO-2002-185
Missouri Public
Service Commission

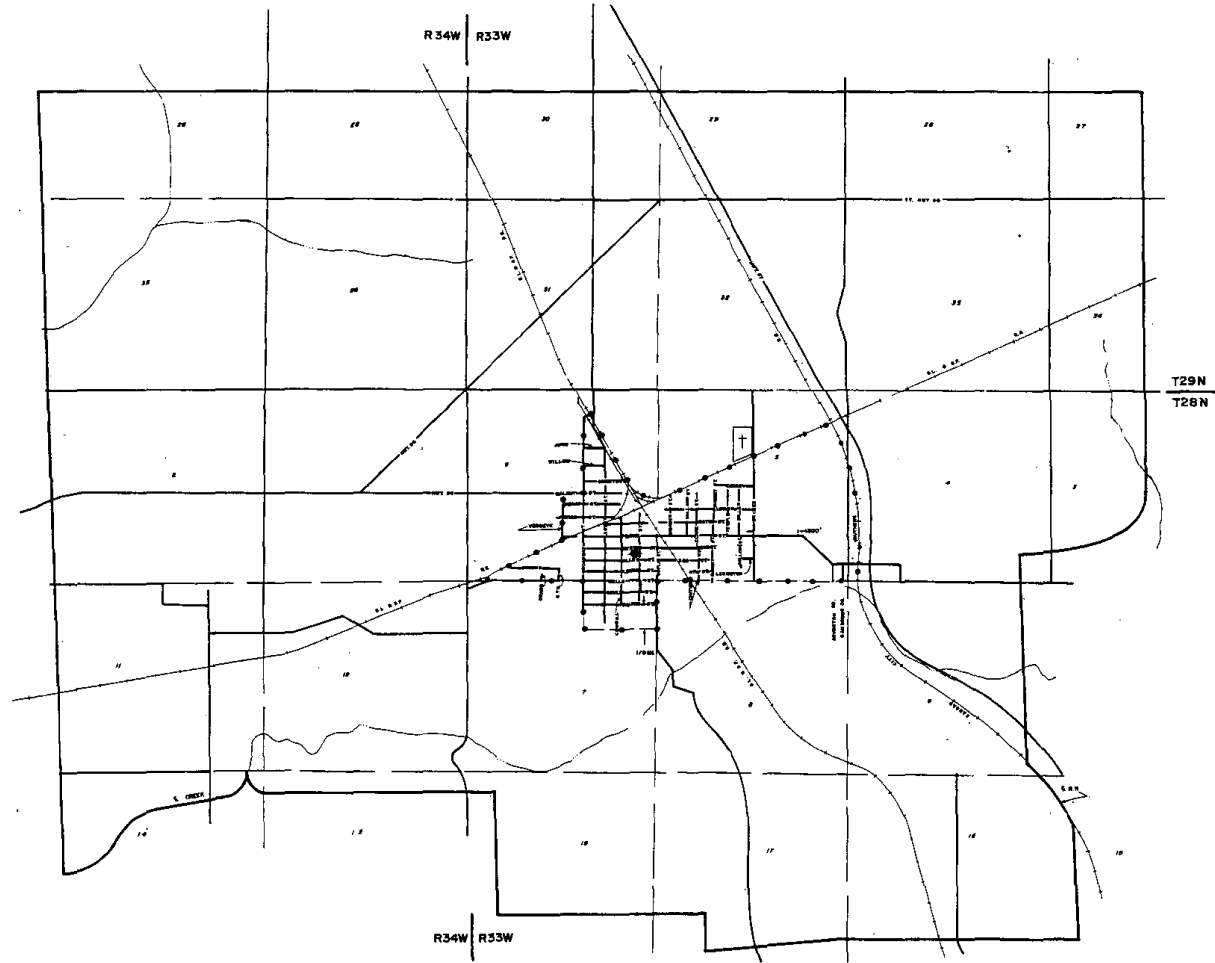

CODE

0 1/4 1/2 3/4 1

BASE RATE AREA

TOWNSHIP BOUNDARY

CENTRAL OFFICE

RECEIVED
JAN 20 1966
MISSOURI
Public Service Comm.

N

FILED

FEB 23 1966

PUBLIC SERVICE COMMISSION

NO SUPPLEMENT TO THIS TARIFF WILL BE ISSUED EXCEPT FOR THE PURPOSE OF CANCELING THIS TARIFF.

P. S. C. Mo. No. 17 EXCHANGE AREA MAP

Carl Junction, Missouri
RECEIVED
4th REVISED SHEET 3
REPLACING 3rd REVISED SHEET 3

JUL 11 1977

MISSOURI
Public Service Commission

T30N
T29N

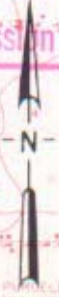

CANCELLED
June 29, 2007
TO-2002-185
Missouri Public
Service Commission

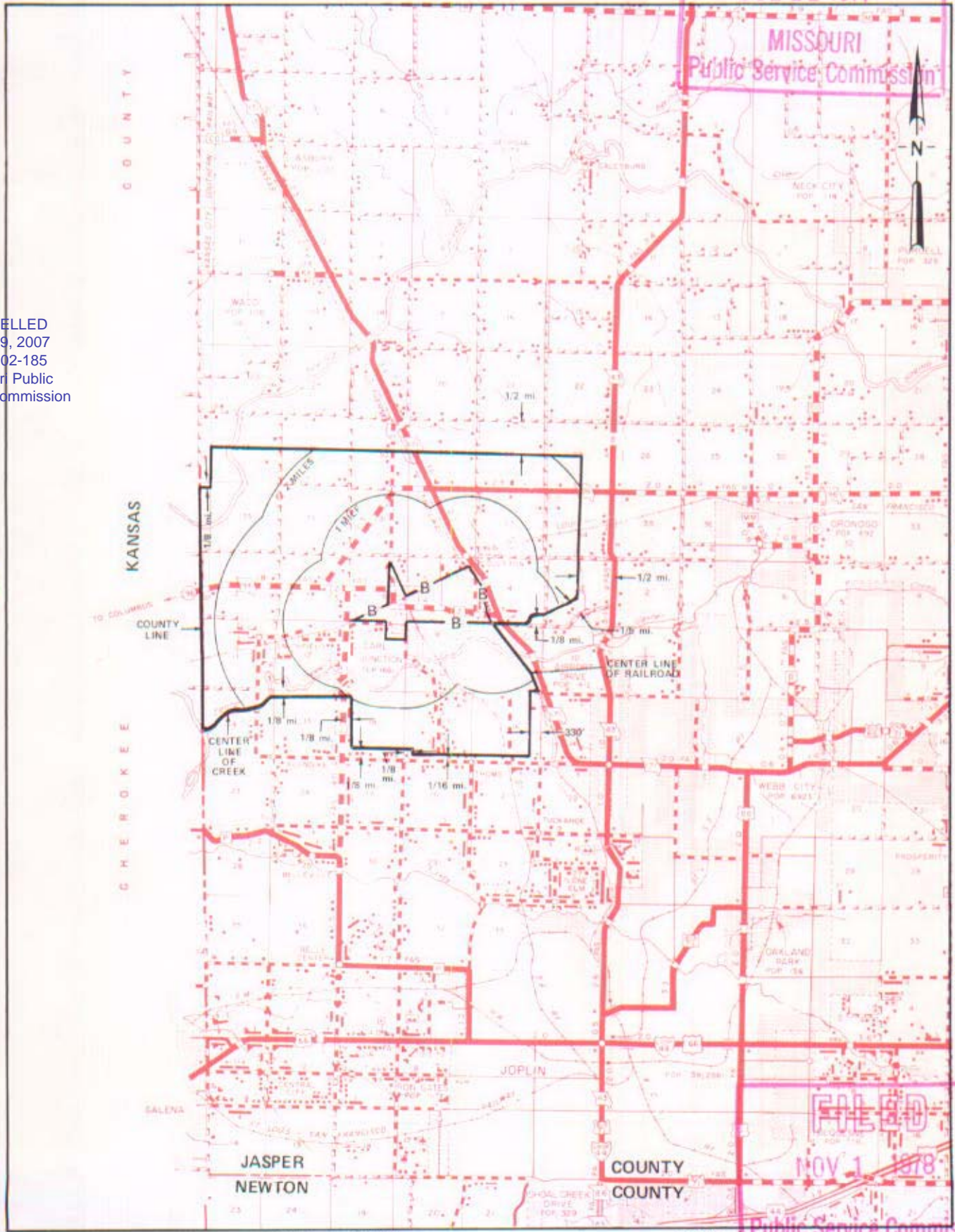

T29N
T28N

T28N
T27N

R34W | R33W

R33W | R32W

FILED

NOV 1 1978

Public Service Commission

By R. R. SHOCKLEY, Vice President, Missouri
Southwestern Bell Telephone Company
St. Louis, Missouri

Issued: July 11, 1977

Effective: NOV 1 - 1978

SBC PSC MO #17
Carrollton, Missouri
2nd Revised Sheet 2
Replacing 1st Sheet 2

CANCELLED
June 29, 2007
TO-2002-185
Missouri Public
Service Commission

Non-Scannable Map

(Is viewable in the Data Center
200 Madison Street, 1st Floor
Jefferson City MO)

CANCELLED
June 29, 2007
TO-2002-185
Missouri Public
Service Commission

NO SUPPLEMENT TO THIS TARIFF WILL
BE ISSUED EXCEPT FOR THE PURPOSE OF
CANCELING THIS TARIFF.

P. S. C. Mo. No. 17
EXCHANGE AREA MAP

Carrollton, Missouri

7th REVISED SHEET 3
REPLACING 6th REVISED SHEET 3

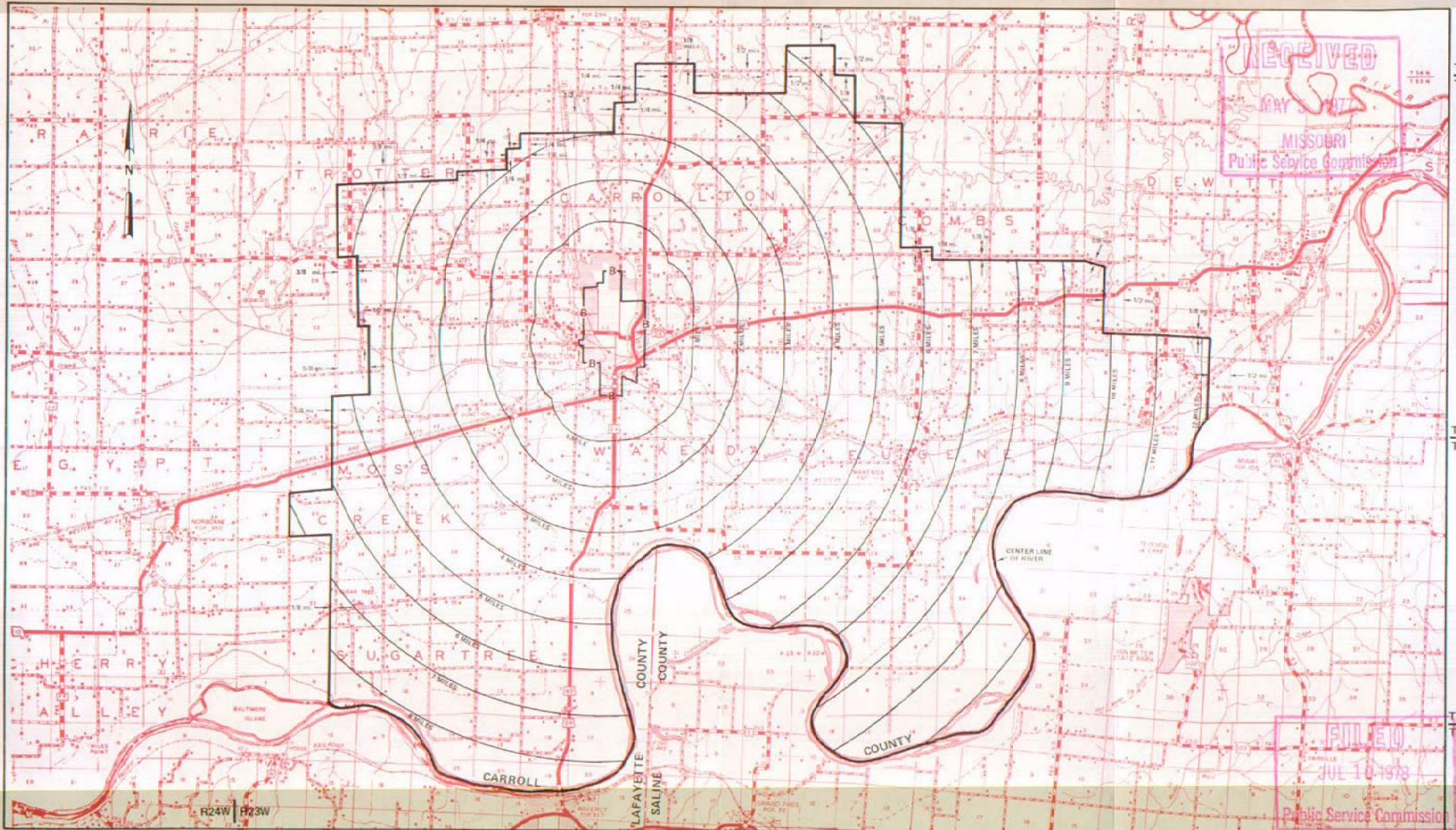

T54N
T53N

T53N
T52N

T52N
T51N

R24W R23W

R23W R22W

R22W R21W

R21W R20W

Issued: May 10, 1977

By R. R. SHOCKLEY, Vice President, Missouri
Southwestern Bell Telephone Company
St. Louis, Missouri

Effective: JUL 10 1978

SOUTHWESTERN BELL TELEPHONE COMPANY
LOCAL EXCHANGE TARIFF
SUPERSEDING ALL TARIFFS PREVIOUSLY ISSUED

This exchange was included in the Webb City Exchange Area as of July 28, 1928, and, therefore, all rates and rate practices formerly authorized for this exchange are withdrawn.

RECEIVED
APR 12 1930
DAVID P. JAMES, Sec'y
PUBLIC SERVICE COM.

Issued: June 1, 1929

By S. R. SMITH, General Manager Eastern Missouri
St. Louis, Missouri

Effective: July 28, 1928

SBC PSC MO #17
Carthage, Missouri
2nd Revised Sheet 2
Replacing 1st Revised Sheet 2

Non-Scannable Map

(Is viewable in the Data Center
200 Madison Street, 1st Floor
Jefferson City MO)

NO SUPPLEMENT TO THIS TARIFF WILL BE ISSUED EXCEPT FOR THE PURPOSE OF CANCELING THIS TARIFF.

P. S. C. Mo. No. 17 EXCHANGE AREA MAP

Carthage, Missouri

10th REVISED SHEET 3
REPLACING 9th REVISED SHEET 3

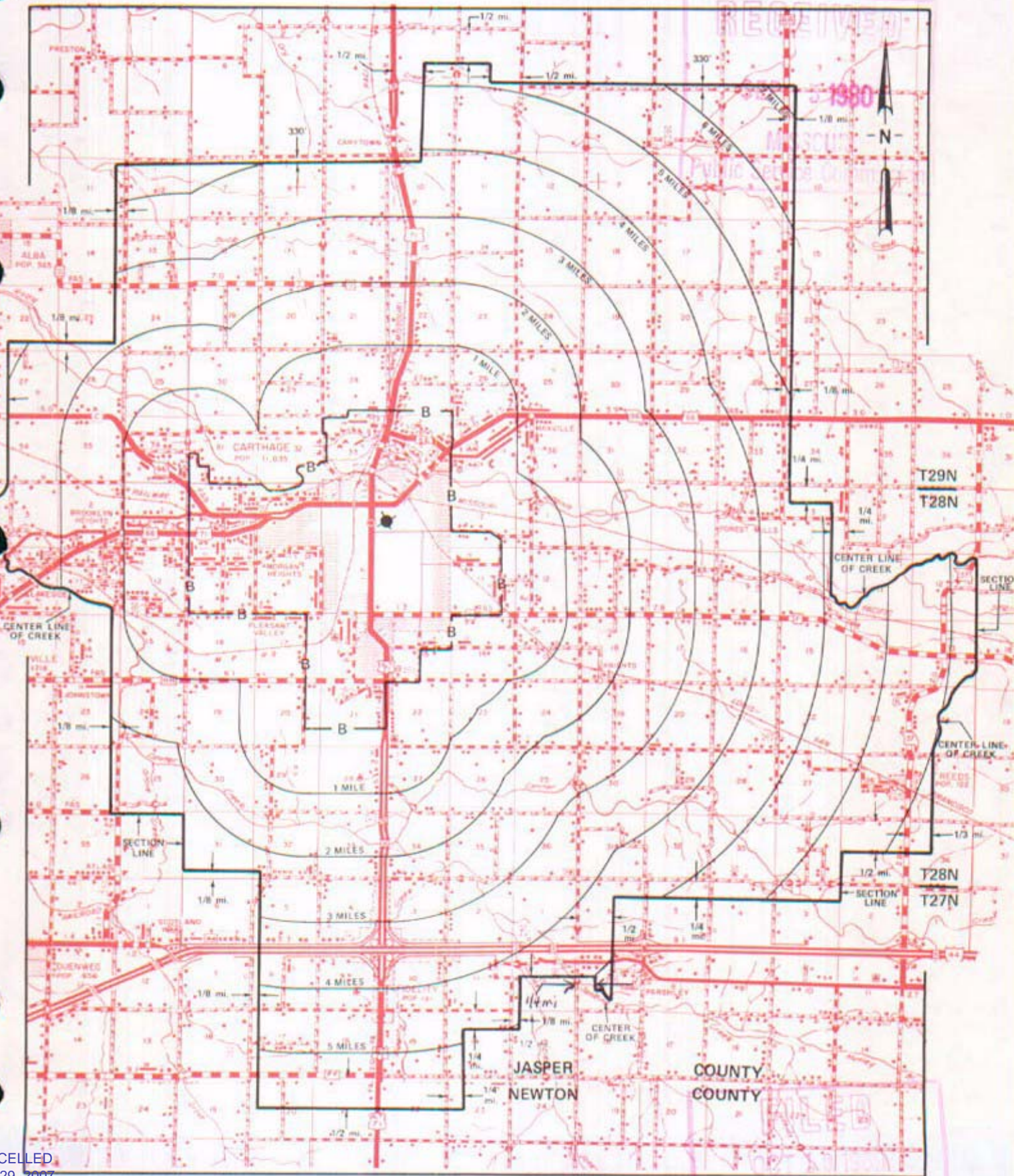

CANCELLED
June 29, 2007
TO-2002-185
Missouri Public
Service Commission

Issued: SEPT 9, 1980

R32W | R31W

R31W | R30W

By R. R. SHOCKLEY, Vice President, Missouri
Southwestern Bell Telephone Company

St. Louis, Missouri

Public Service Commission
Effective: OCT 10, 1980

NO SUPPLEMENT TO THIS TARIFF WILL BE ISSUED EXCEPT FOR THE PURPOSE OF CANCELING THIS TARIFF.

P. S. C. Mo. No. 17

Caruthersville, Missouri

2nd REVISED SHEET 2
REPLACING 1st REVISED SHEET 2

BASE RATE AREA MAP

RECEIVED
JAN 21 1986
MISSOURI
Public Service Commission

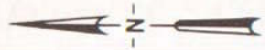

CANCELLED
June 29, 2007
TO-2002-185
Missouri Public
Service Commission

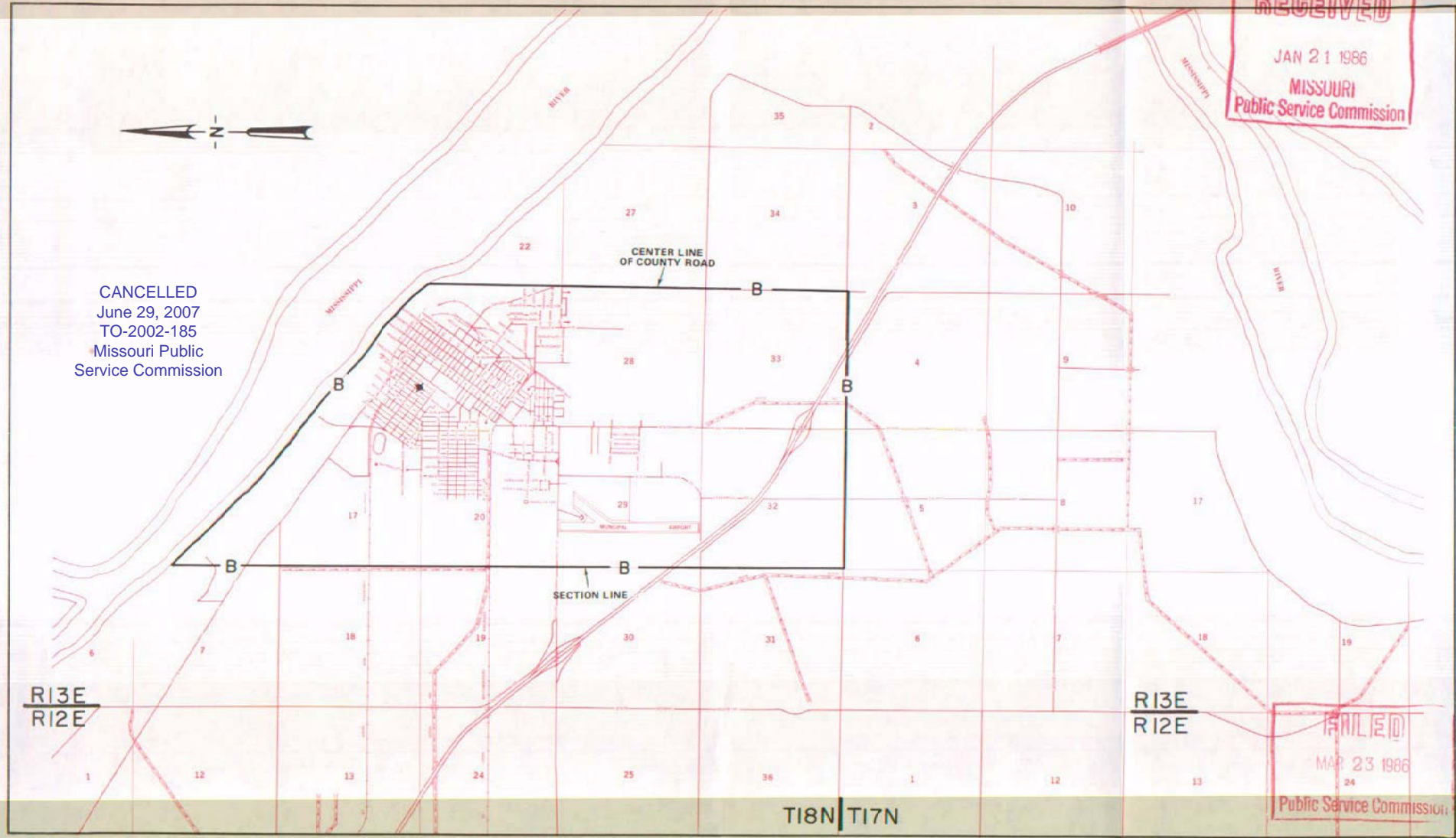

FILED
MAR 23 1986
24
Public Service Commission

By R.D. BARRON, PRESIDENT—MISSOURI DIVISION
Southwestern Bell Telephone Company
St. Louis, Missouri

Issued: January 27, 1986

Effective: March 23, 1986

NO SUPPLEMENT TO THIS TARIFF WILL BE ISSUED EXCEPT FOR THE PURPOSE OF CANCELING THIS TARIFF.

P. S. C. Mo. No. 17

Caruthersville, Missouri

EXCHANGE AREA MAP

5th REVISED SHEET 3
REPLACING 4th REVISED SHEET 3

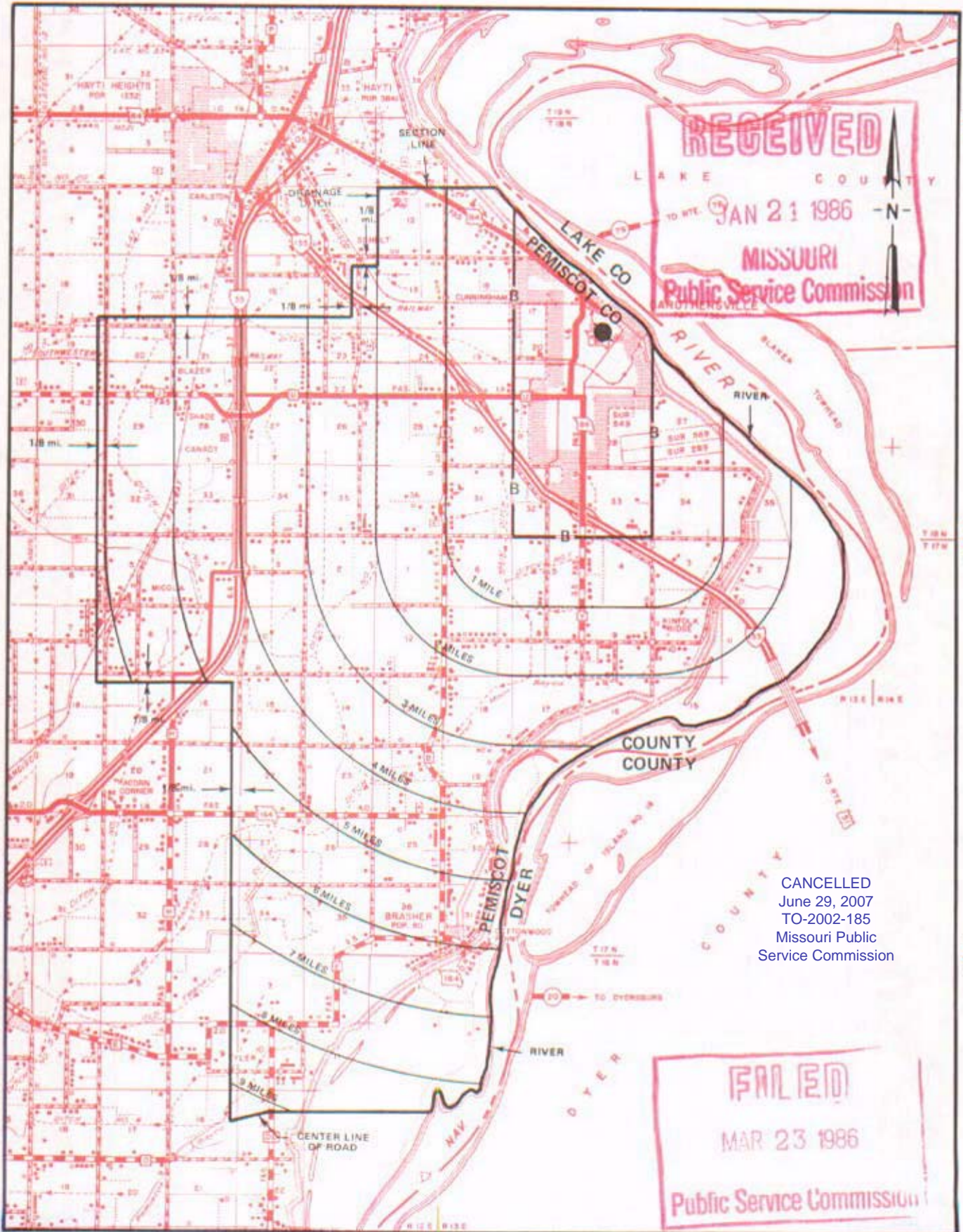

CANCELLED
June 29, 2007
TO-2002-185
Missouri Public
Service Commission

NO SUPPLEMENT TO THIS TARIFF WILL BE ISSUED EXCEPT FOR THE PURPOSE OF CANCELING THIS TARIFF.

P. S. C. Mo. No. 17

Cedar Hill, Missouri

BASE RATE AREA MAP

REPLACING 2nd REVISED SHEET 2
1st REVISED SHEET 2

RECEIVED

MAY 20 1977

MISSOURI Public Service Commission

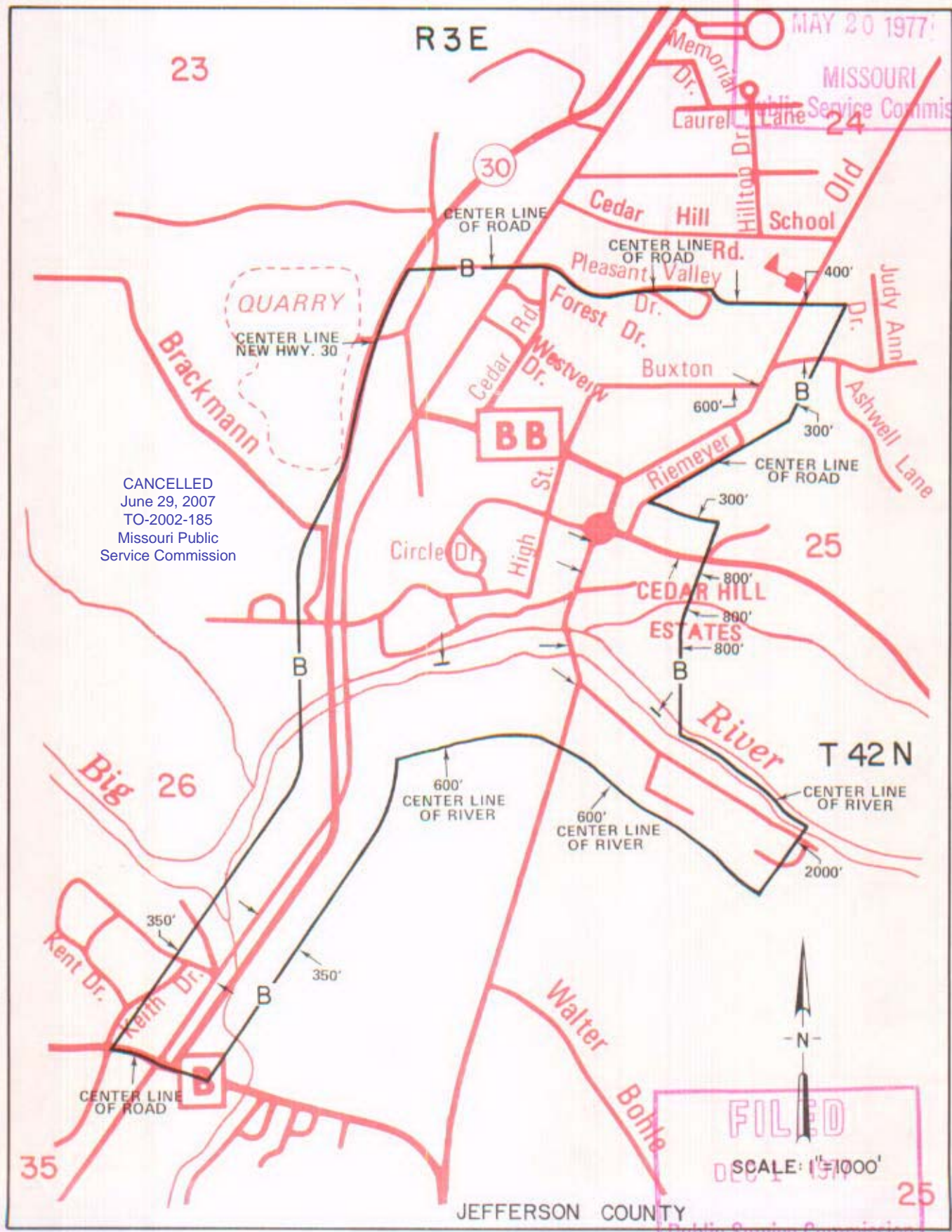

CANCELLED
June 29, 2007
TO-2002-185
Missouri Public
Service Commission

FILED
SCALE: 1"=1000'
DEC 1 1977
Public Service Commission

By R. R. SHOCKLEY, Vice President, Missouri

Southwestern Bell Telephone
St. Louis, Missouri

Issued: MAY 23 1977

Effective: DEC 1 1977

NO SUPPLEMENT TO THIS TARIFF WILL BE ISSUED EXCEPT FOR THE PURPOSE OF CANCELING THIS TARIFF.

P. S. C. Mo. No. 17

Cedar Hill, Missouri

EXCHANGE AREA MAP REPLACING 10th REVISED SHEET 3

11th REVISED SHEET 3

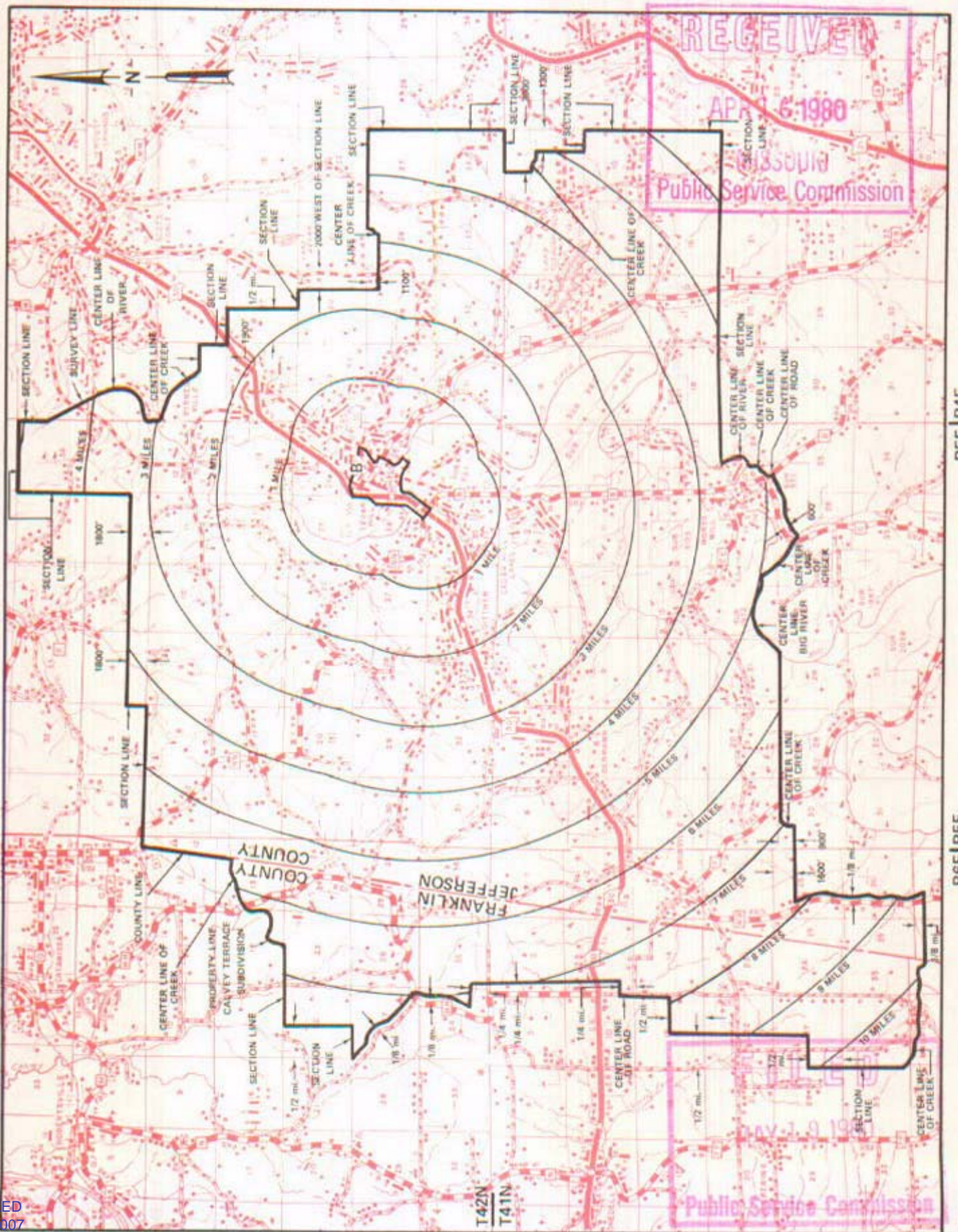

CANCELLED
June 29, 2007
TO-2002-185
Missouri Public
Service Commission

By R. R. SHOCKLEY, Vice President, Missouri
Southwestern Bell Telephone Company

T43N
T42N

T42N
T41N

T41N
T40N

SBC PSC MO #17
Center, Missouri
Original Sheet 2
Replacing Western Light & Telephone
Company's P.S.C. Mo. No. 4
Original Sheet 5
Ralls County

Non-Scannable Map

(Is viewable in the Data Center
200 Madison Street, 1st Floor
Jefferson City MO)

NO SUPPLEMENT TO THIS TARIFF WILL BE ISSUED EXCEPT FOR THE PURPOSE OF CANCELING THIS TARIFF.

P. S. C. Mo. No. 17

Center, Missouri

EXCHANGE AREA MAP

6th REVISED SHEET 3 REPLACING 5th REVISED SHEET 3

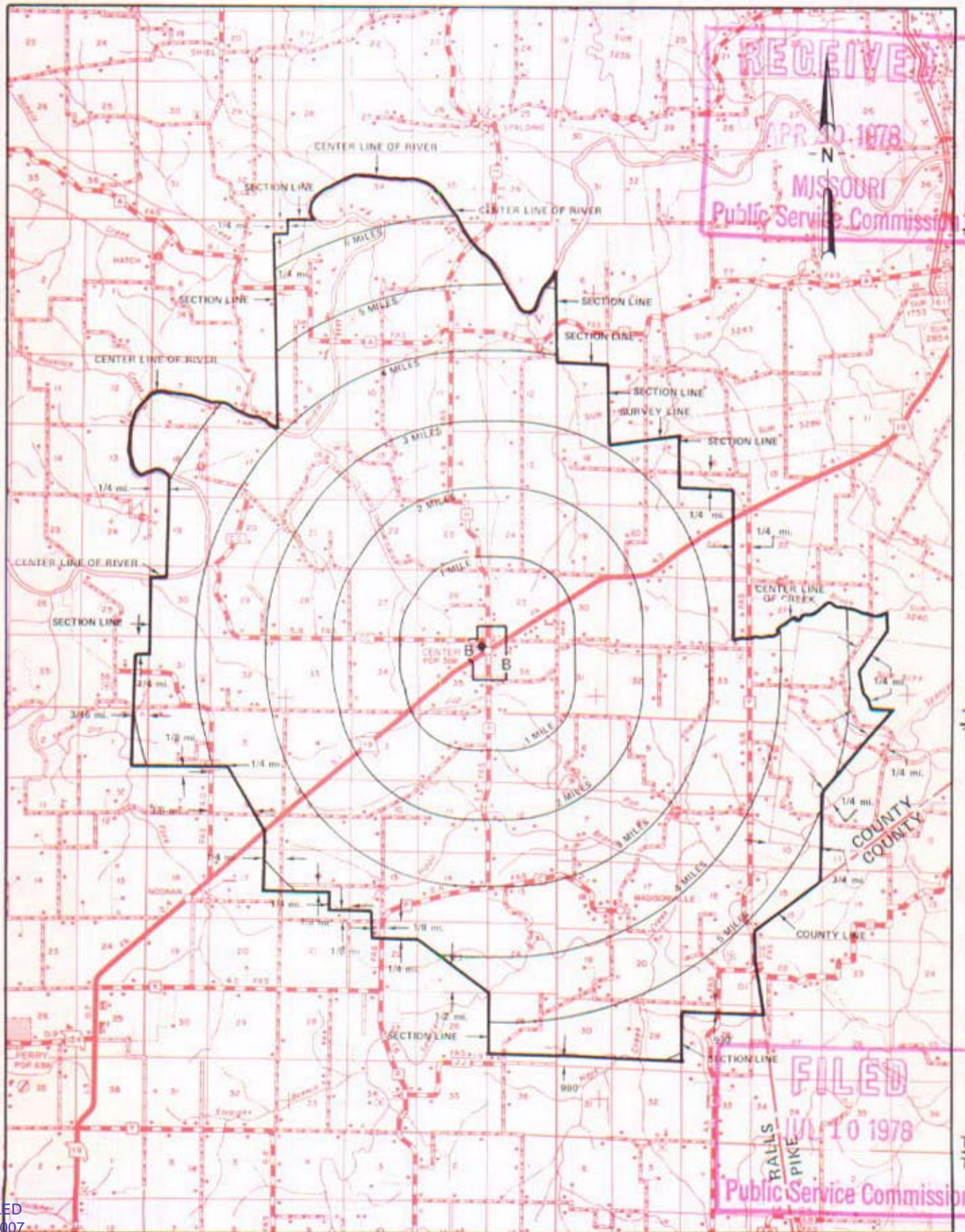

T52N
T53N

T53N
T54N

T54N
T55N

R7W | R6W

R6W | R5W

By R. R. SHOCKLEY, Vice President, Missouri Southwestern Bell Telephone Company

CANCELLED
June 29, 2007
TO-2002-185
Missouri Public Service Commission

JUL 10 1978

NO SUPPLEMENT TO THIS TARIFF WILL BE ISSUED EXCEPT FOR THE PURPOSE OF CANCELING THIS TARIFF.

P. S. C. Mo. No. 17 BASE RATE AREA MAP

Chaffee, Missouri
2nd REVISED SHEET 2
REPLACING 1st REVISED SHEET 2

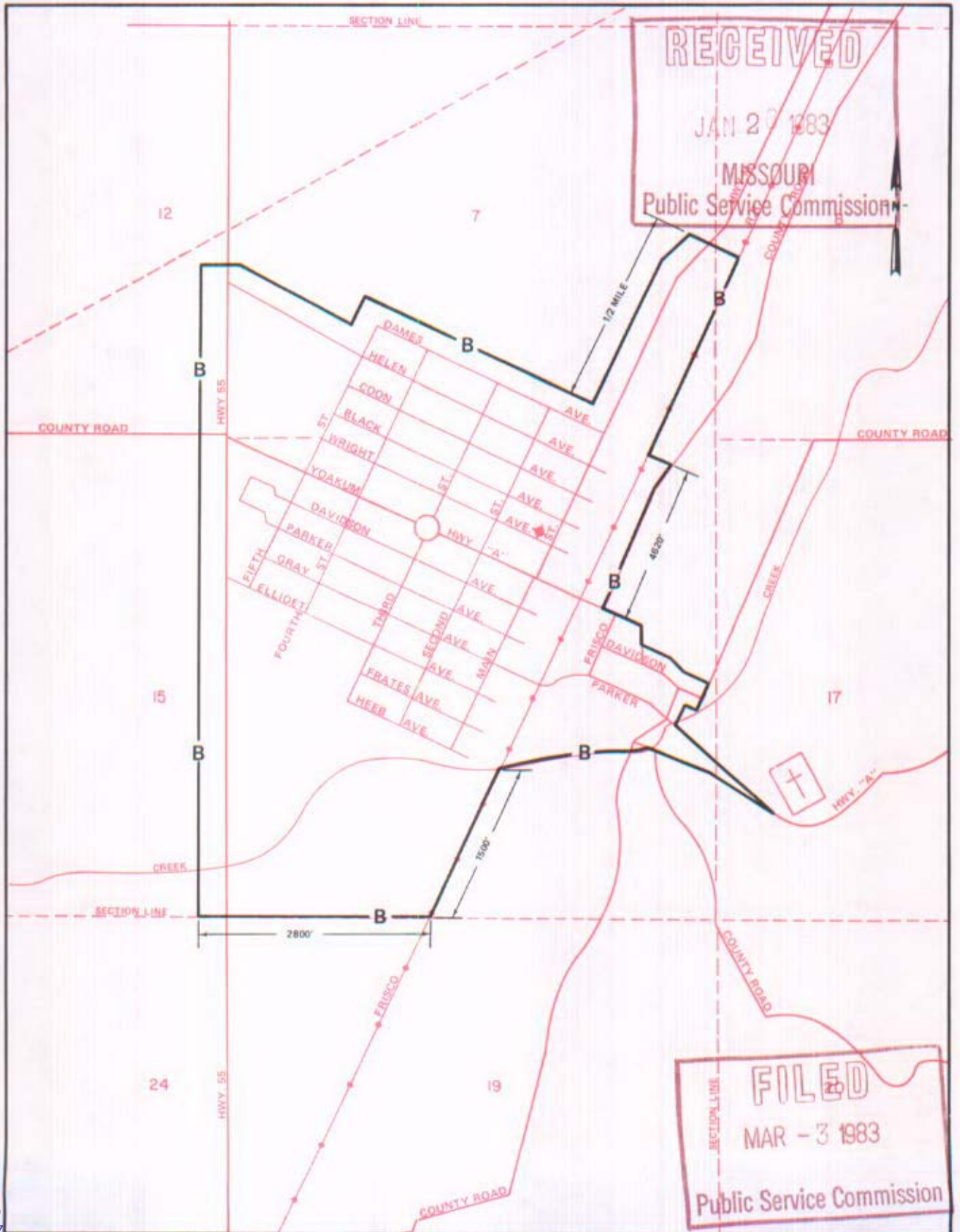

Issued: FEBRUARY 1, 1983

By R. D. BARRON, Vice President, Missouri
Southwestern Bell Telephone Company
St. Louis, Missouri

Effective: MARCH 3, 1983

CANCELLED
June 29, 2007
TO-2002-185
Missouri Public
Service Commission

NO SUPPLEMENT TO THIS TARIFF WILL BE ISSUED EXCEPT FOR THE PURPOSE OF CANCELING THIS TARIFF.

P. S. C. Mo. No. 17

Chaffee, Missouri

EXCHANGE AREA MAP

REPLACING 3rd REVISED SHEET 3
2nd REVISED SHEET 3

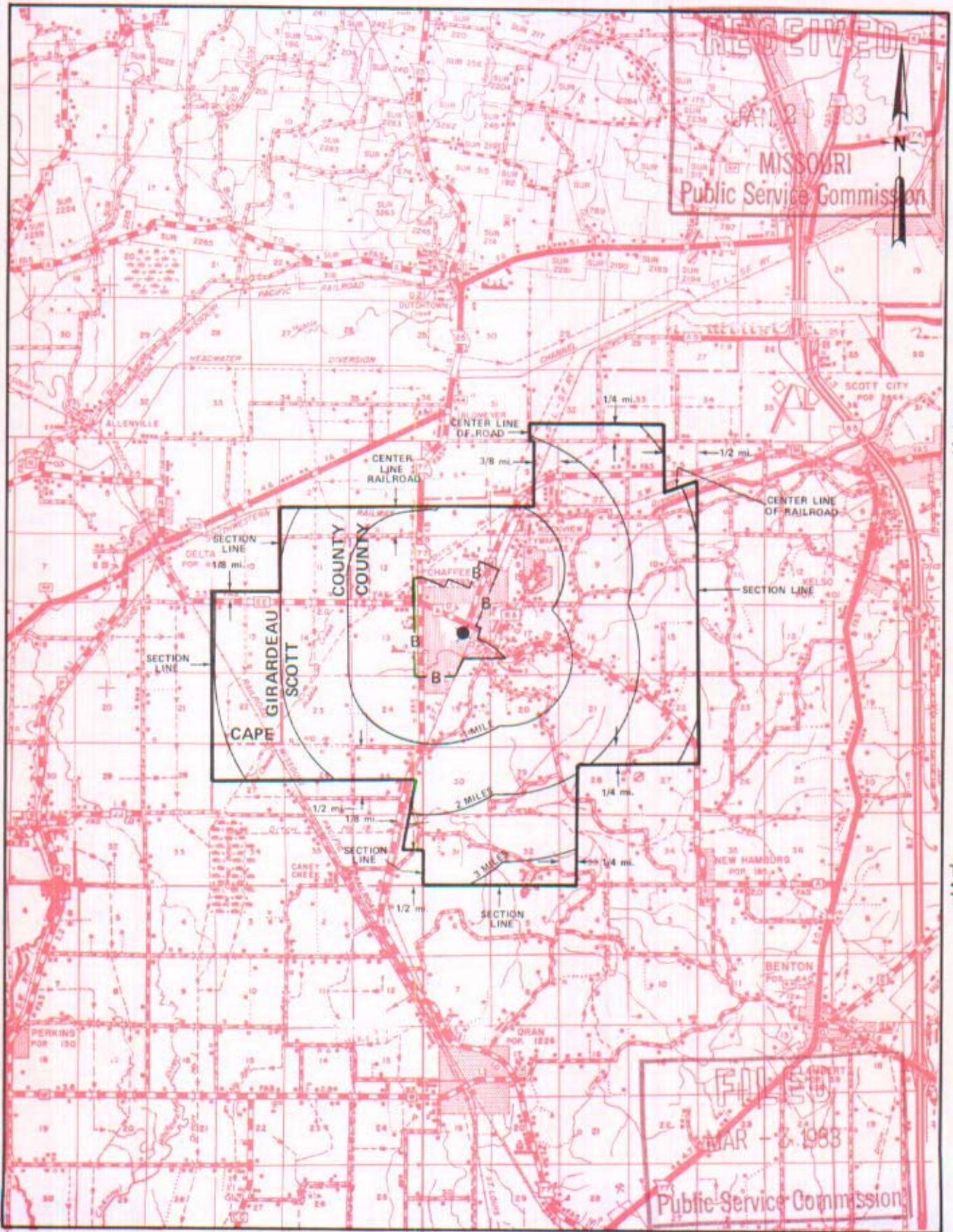

CANCELLED
June 29, 2007
TO-2002-185
Missouri Public
Service Commission

Issued: FEBRUARY 1, 1983

By R. D. BARRON, Vice President, Missouri
Southwestern Bell Telephone Company
St. Louis, Missouri

Effective: MARCH 3 1983

CANCELLED
June 29, 2007
TO-2002-185
Missouri Public
Service Commission

NO SUPPLEMENT TO THIS TARIFF WILL
BE ISSUED EXCEPT FOR THE PURPOSE OF
CANCELING THIS TARIFF.

P. S. C. Mo. No. 17
BASE RATE AREA MAP

Charleston, Missouri

2nd REVISED SHEET 2
REPLACING 1st REVISED SHEET 2

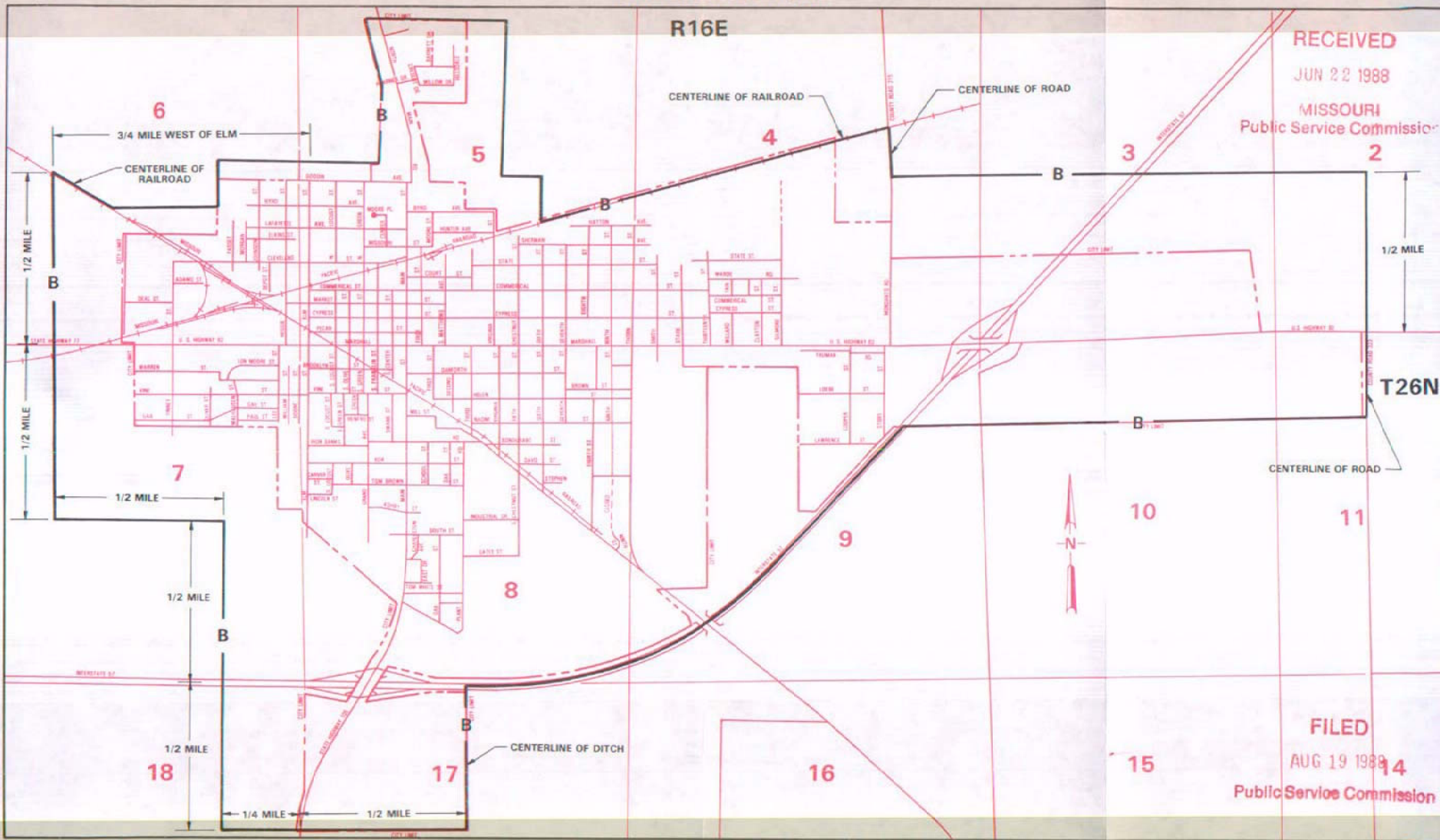

RECEIVED
JUN 22 1988
MISSOURI
Public Service Commission

FILED
AUG 19 1988
Public Service Commission

Issued: JUN 23 1988

By R. D. BARRON, President, Missouri Division
Southwestern Bell Telephone Company
St. Louis, Missouri

Effective: AUG 19 1988

SBC PSC MO #17
Charleston, Missouri
Bertrand Island Bra
Original Sheet 2

Non-Scannable Map

(Is viewable in the Data Center
200 Madison Street, 1st Floor
Jefferson City MO)

NO SUPPLEMENT TO THIS TARIFF WILL BE ISSUED EXCEPT FOR THE PURPOSE OF CANCELING THIS TARIFF.

P. S. C. Mo. No. 17 EXCHANGE AREA MAP

Charleston, Missouri

3rd REVISED SHEET 3
REPLACING 2nd REVISED SHEET 3

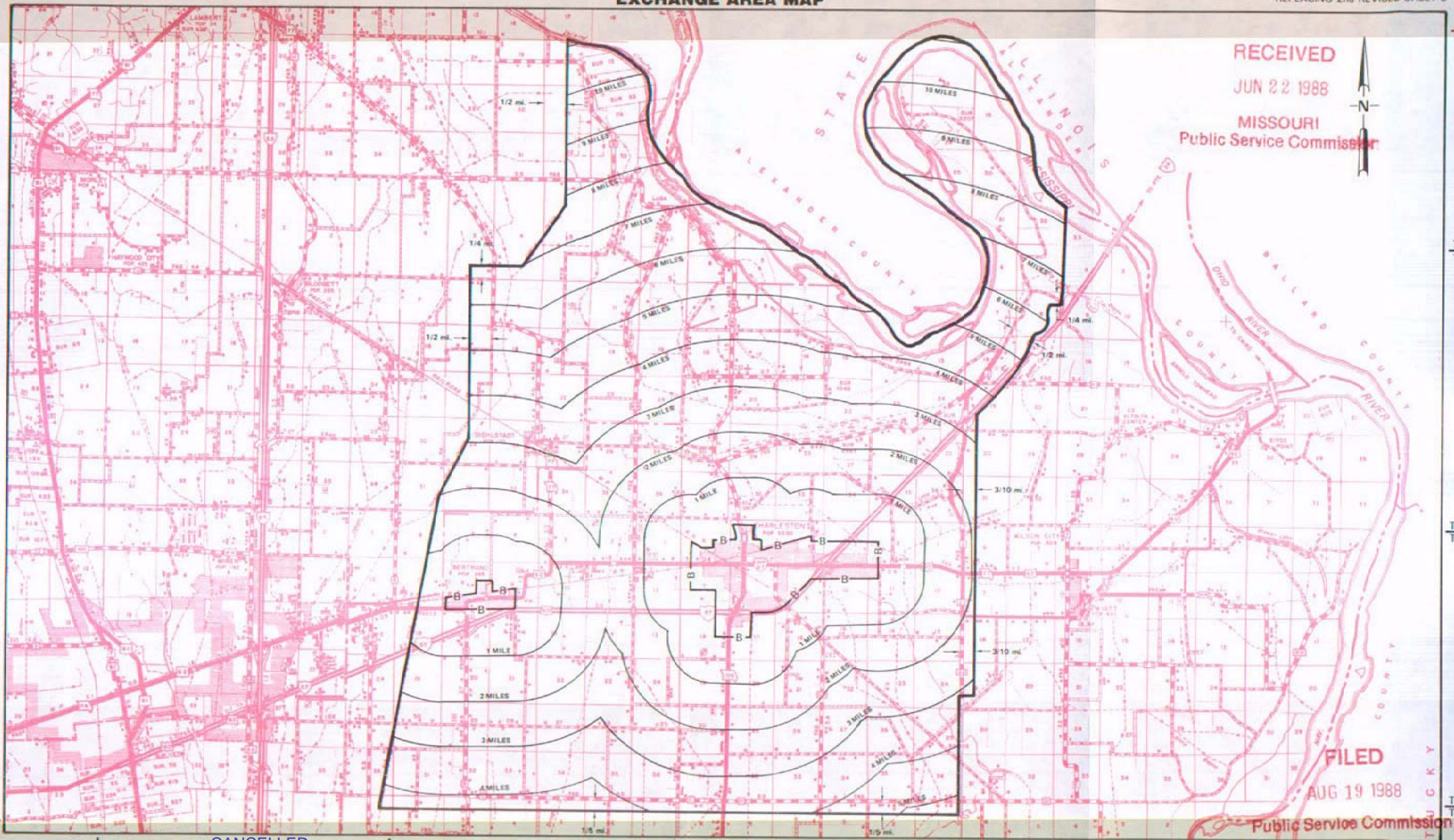

RECEIVED
JUN 22 1988
MISSOURI
Public Service Commission

FILED
AUG 19 1988

Public Service Commission

T28N
T27N

T27N
T26N

T26N
T25N

R13E|R14E

R14E|R15E

R15E|R16E

R16E|R17E

R17E|R18E

Issued: JUN 23 1988

CANCELLED
June 29, 2007
TO-2002-185
Missouri Public
Service Commission

By R. D. BARRON, President, Missouri Division
Southwestern Bell Telephone Company
St. Louis, Missouri

Effective: AUG 19 1988

SBC PSC MO #17
Chesterfield, Missouri
15th Revised Sheet 2
Replacing 14th Revised Sheet 2

Non-Scannable Map

(Is viewable in the Data Center
200 Madison Street, 1st Floor
Jefferson City MO)

NO SUPPLEMENT TO THIS TARIFF WILL BE ISSUED EXCEPT FOR THE PURPOSE OF CANCELING THIS TARIFF.

P. S. C. Mo. No. 17

Chillicothe, Missouri

BASE RATE AREA MAP

2nd REVISED SHEET 2
REPLACING 1st REVISED SHEET 2

RECEIVED
SEP 29 1978
MISSOURI
Public Service Commission

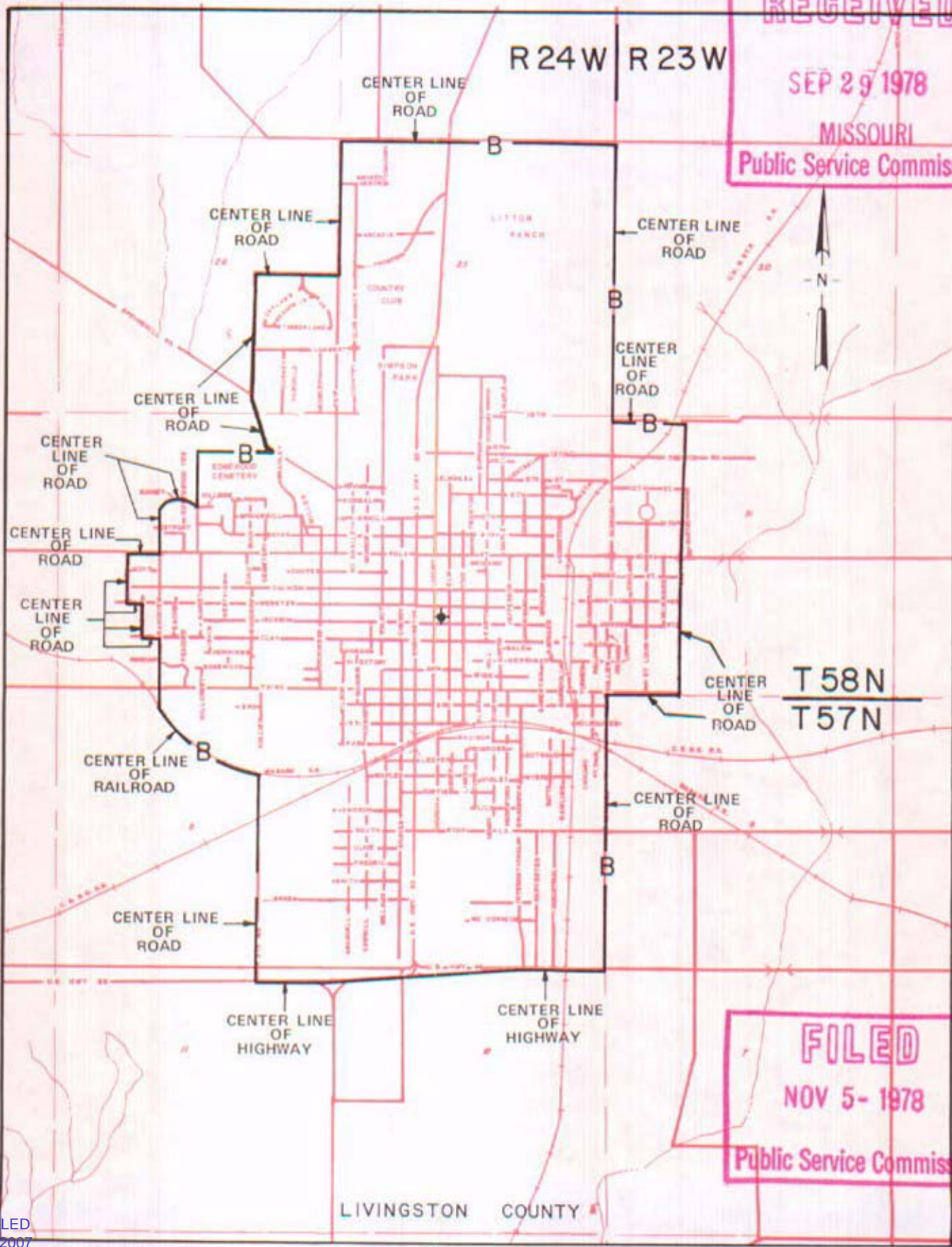

FILED
NOV 5- 1978
Public Service Commission

CANCELLED
June 29, 2007
TO-2002-185
Missouri Public
Service Commission

By R. R. SHOCKLEY, Vice President, Missouri
Southwestern Bell Telephone Company

Issued: OCTOBER 5, 1978

NO SUPPLEMENT TO THIS TARIFF WILL BE ISSUED EXCEPT FOR THE PURPOSE OF CANCELING THIS TARIFF.

P. S. C. Mo. No. 17
EXCHANGE AREA MAP

Chillicothe, Missouri
11th REVISED SHEET 3
REPLACING 10th REVISED SHEET 3

RECEIVED
MAY 11 1979
MISSOURI
Public Service Commission

CANCELLED
June 29, 2007
TO-2002-185
Missouri Public
Service Commission

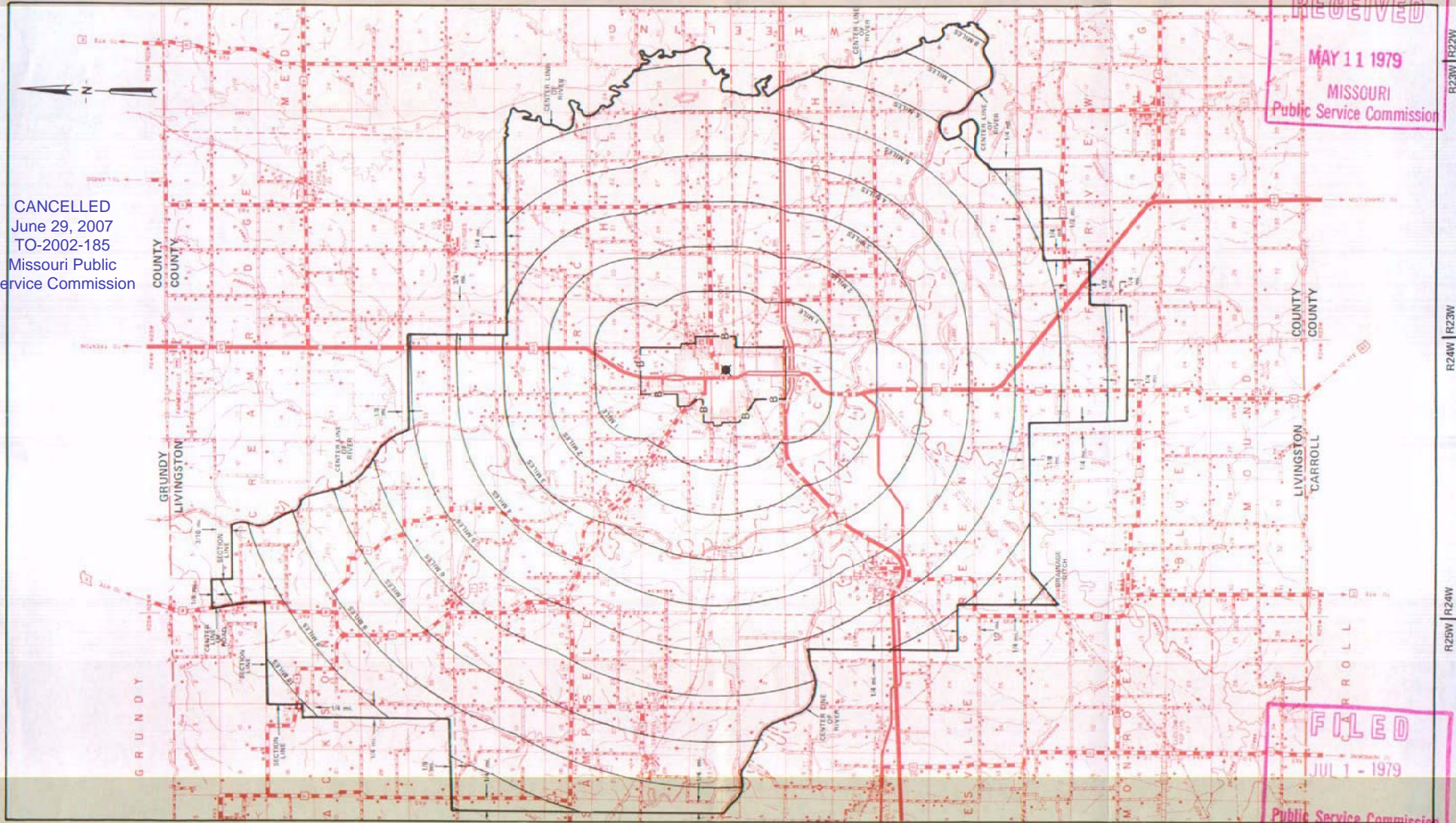

Issued: MAY 11, 1979

By R. R. SHOCKLEY, Vice President, Missouri
Southwestern Bell Telephone Company
St. Louis, Missouri

FILED
JUL 1 - 1979
Public Service Commission

Effective: JUL 1 - 1979

NO SUPPLEMENT TO THIS TARIFF WILL BE ISSUED EXCEPT FOR THE PURPOSE OF CANCELING THIS TARIFF.

P. S. C. Mo. No. 17

Clarksville, Missouri

EXCHANGE AREA MAP

4th REVISED SHEET 3
REPLACING 3rd REVISED SHEET 3

RECEIVED
MAY 5 1977
MISSOURI
Public Service Commission

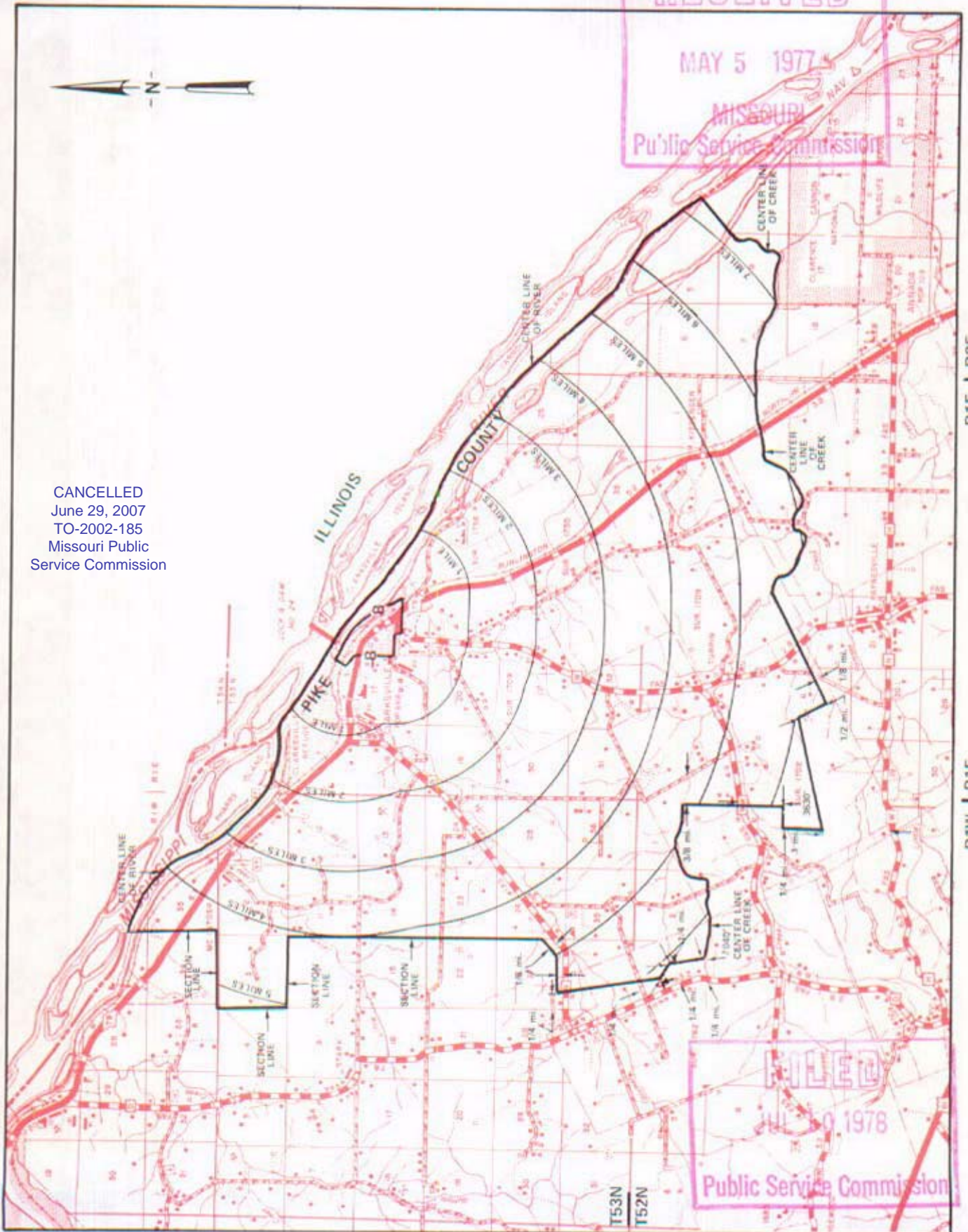

CANCELLED
June 29, 2007
TO-2002-185
Missouri Public
Service Commission

T54N
T53N

By R. R. SHOCKLEY, Vice President, Missouri
Southwestern Bell Telephone Company

FILED
JUL 10 1978
Public Service Commission

May 10 1977

JUL 10 1978

NO SUPPLEMENT TO THIS TARIFF WILL BE ISSUED EXCEPT FOR THE PURPOSE OF CANCELING THIS TARIFF.

Clarksville, Missouri
ORIGINAL SHEET 2
REPLACING ORIGINAL SHEET 1-A

P. S. C.-Mo. No. 17
BASE RATE AREA MAP

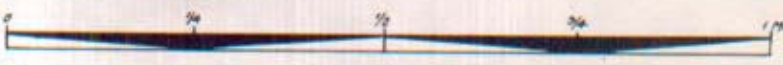



RECEIVED
JUN 27 1950
MISSOURI
Public Service Comm.

CANCELLED
June 29, 2007
TO-2002-185
Missouri Public
Service Commission

CLARKSVILLE, MO.

FILED

JUL 6 1950
Case No. 11634
PUBLIC SERVICE COMMISSION

CODE
BELL CENTRAL OFFICE: 
BASE RATE AREA LIMITS: 

Issued: June 27, 1950

Effective: July 6, 1950

By H. R. TOWLES, General Manager
Southwestern Bell Telephone Company
St. Louis, Missouri

NO SUPPLEMENT TO THIS TARIFF WILL BE ISSUED EXCEPT FOR THE PURPOSE OF CANCELING THIS TARIFF.

Clever, Missouri
ORIGINAL SHEET 2

P. S. C. Mo. No. 17
BASE RATE AREA MAP

RECEIVED
AUG 8 1958
MISSOURI
Public Service Comm.

CANCELLED
June 29, 2007
TO-2002-185
Missouri Public
Service Commission

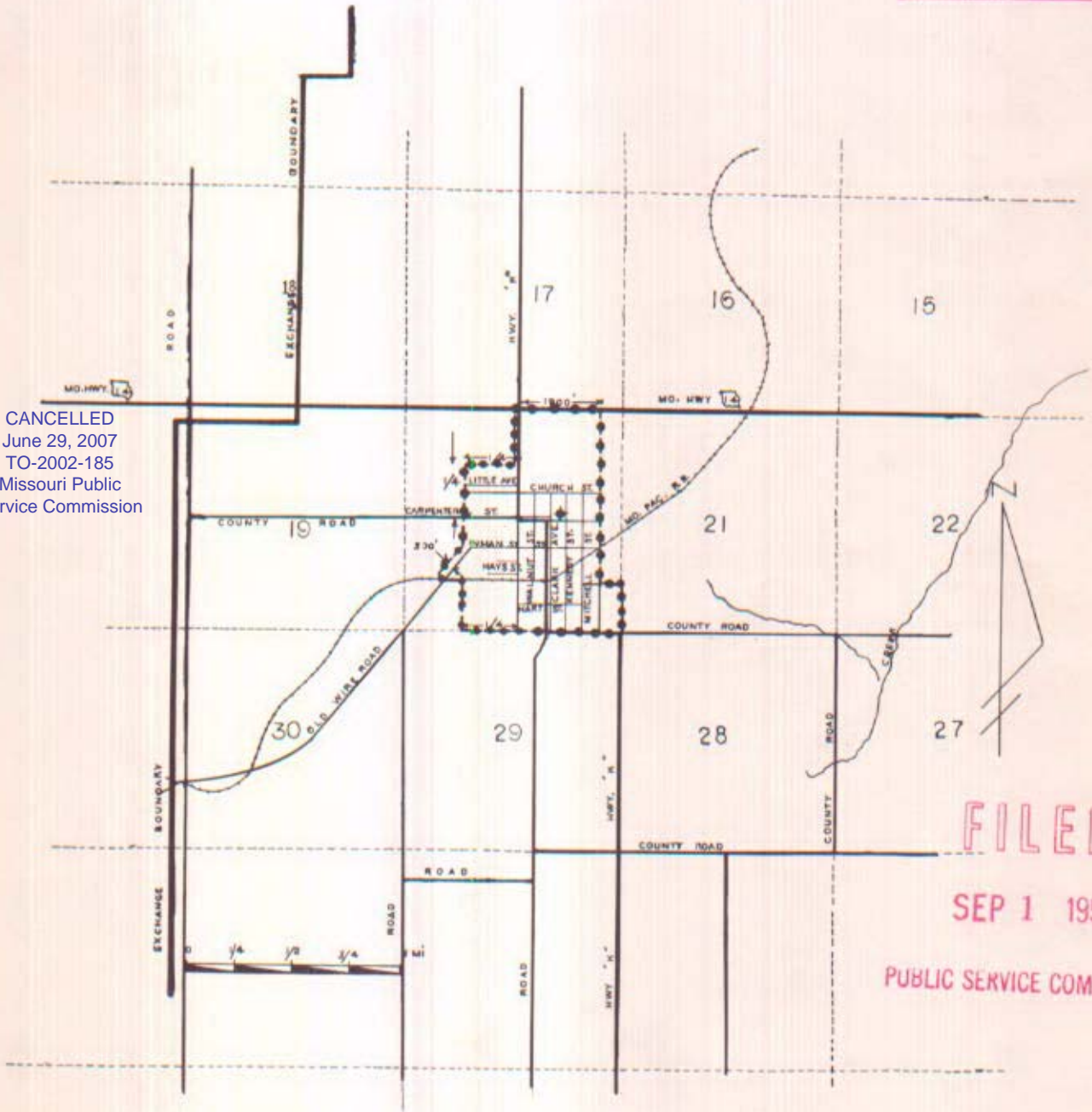

FILED
SEP 1 1958
PUBLIC SERVICE COMMISSION

ISSUED UNDER ORDER OF THE PUBLIC SERVICE COMMISSION IN CASE NO. 13881 ✓
Issued: August 12, 1958 Effective: September 1, 1958
By E. G. GREBER, Vice President and General Manager
Southwestern Bell Telephone Company
St. Louis, Missouri

NO SUPPLEMENT TO THIS TARIFF WILL BE ISSUED EXCEPT FOR THE PURPOSE OF CANCELING THIS TARIFF.

P. S. C. Mo. No. 17

Clever, Missouri

3rd REVISED SHEET 3
REPLACING 2nd REVISED SHEET 3

EXCHANGE AREA MAP

RECEIVED
JUN 1 1977
MISSOURI
Public Service Commission

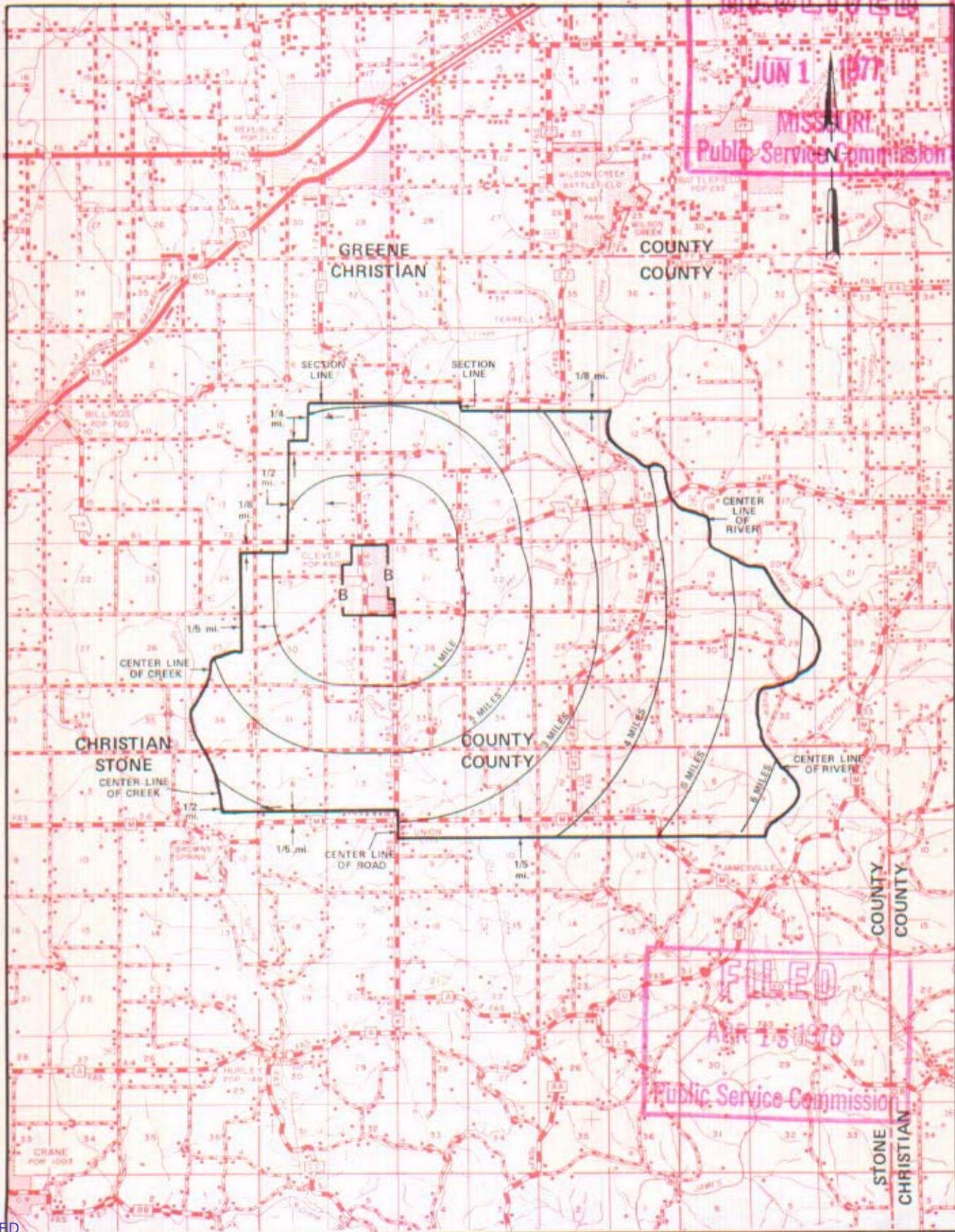

T28N
T27N

T27N
T26N

T26N
T25N

FILED
APR 15 1976
Public Service Commission

R24W | R23W | R23W | R22W

By R. R. SHOCKLEY, Vice President, Missouri
Southwestern Bell Telephone Company
St. Louis, Missouri

Effective: **APR 15 1978**

Issued: **June 1, 1977**

CANCELLED
June 29, 2007
TO-2002-185
Missouri Public
Service Commission

NO SUPPLEMENT TO THIS TARIFF WILL
BE ISSUED EXCEPT FOR THE PURPOSE OF
CANCELING THIS TARIFF.

P. S. C. Mo. No. 17
BASE RATE AREA MAP

Climax Springs, Missouri
1st REVISED SHEET 2
REPLACING ORIGINAL SHEET 2

RECEIVED
MAR 13 1975
MISSOURI
Public Service Commission

FILED
APR 21 1975
Public Service Commission

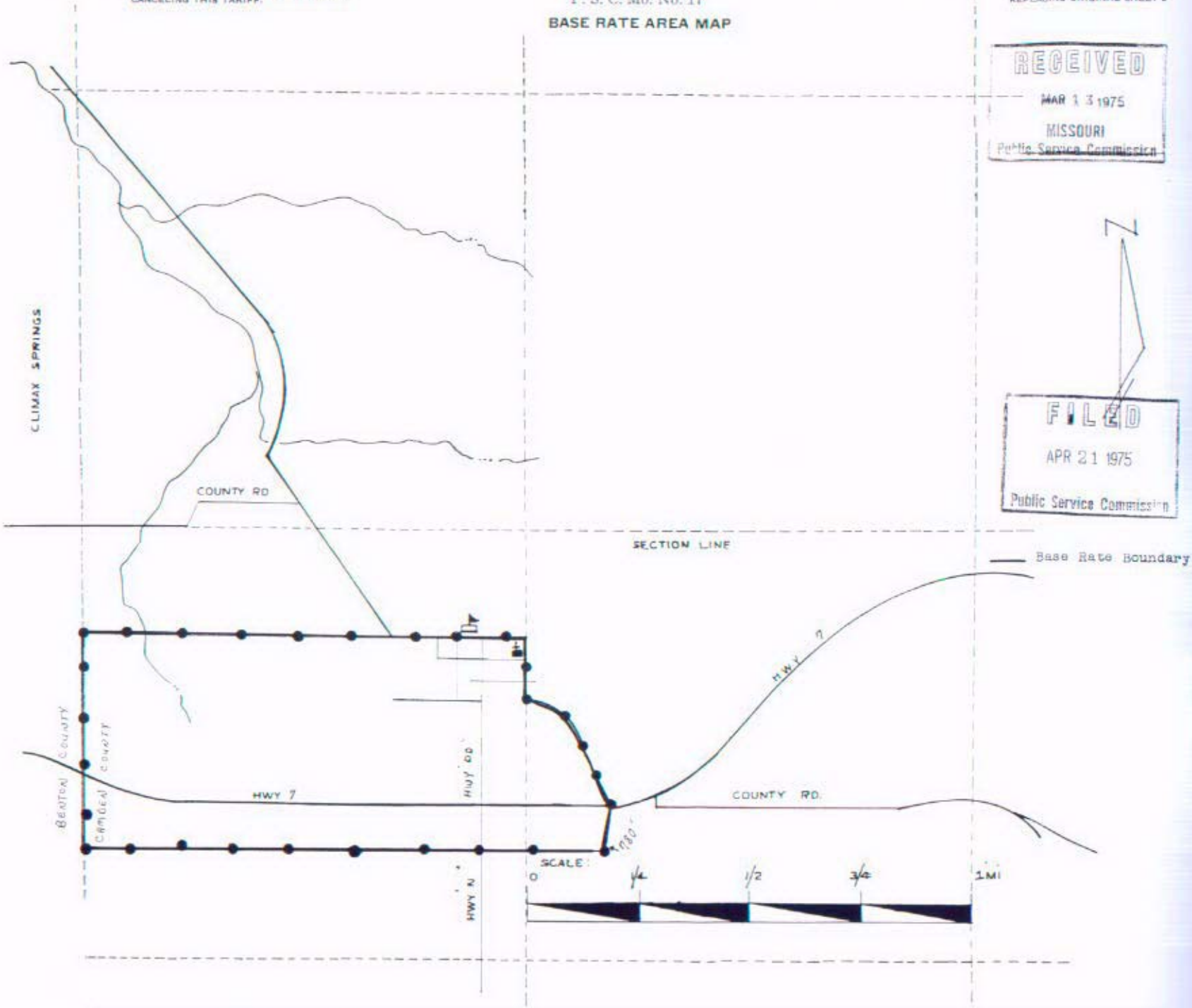

Issued: March 21, 1975

By R. N. SHOCKLEY, Vice President, Missouri-Illinois
Southwestern Bell Telephone Company
St. Louis, Missouri

Effective: April 21, 1975

CANCELLED
June 29, 2007
TO-2002-185
Missouri Public
Service Commission

SBC PSC MO #17
Climax Springs, Missouri
Climax Springs North Island Bra
Original Sheet 2A

Non-Scannable Map

(Is viewable in the Data Center
200 Madison Street, 1st Floor
Jefferson City MO)

CANCELLED
June 29, 2007
TO-2002-185
Missouri Public
Service Commission

NO SUPPLEMENT TO THIS TARIFF WILL
BE ISSUED EXCEPT FOR THE PURPOSE OF
CANCELING THIS TARIFF.

P. S. C. Mo. No. 17
EXCHANGE AREA MAP

Climax Springs, Missouri

11th REVISED SHEET 3
REPLACING 10th REVISED SHEET 3

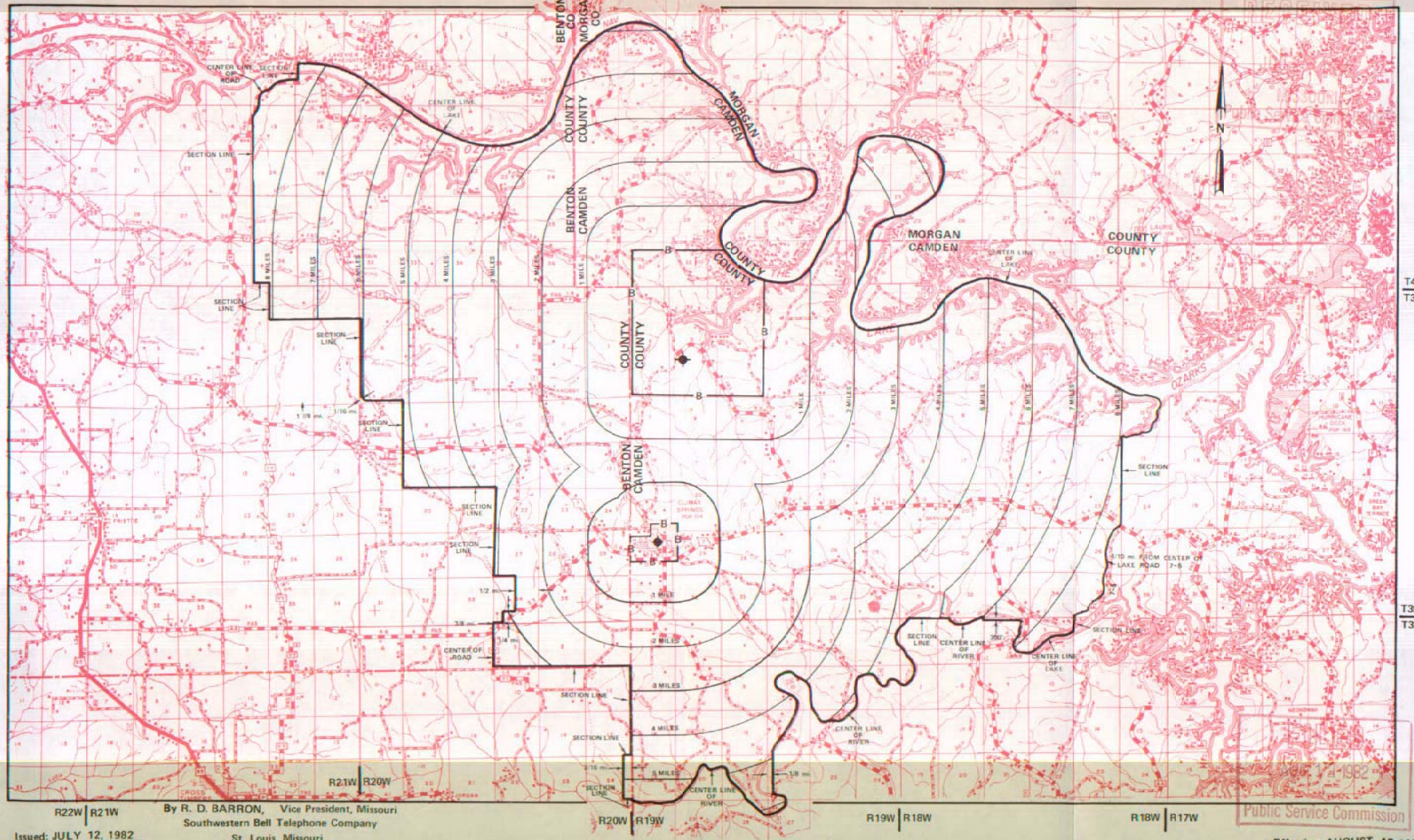

T40N
T39N

T39N
T38N

R22W | R21W

By R. D. BARRON, Vice President, Missouri
Southwestern Bell Telephone Company
St. Louis, Missouri

R20W | R19W

R19W | R18W

R18W | R17W

Issued: JULY 12, 1982

Effective: AUGUST 12, 1982

CREVE COEUR

See

St. Louis District Exchange Rates

under

"St. LOUIS"

(June 1, 1937)