

P. S. C. MO. No. 1
Cancelling P. S. C. MO. No. _____

No supplement of this tariff will be
issued except for the purpose
of cancelling the tariff.

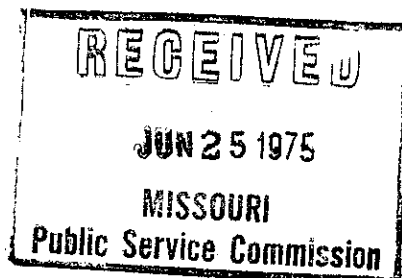

L. W. SEWER CORPORATION

Name of Corporation

SCHEDULE OF RATES FOR SEWER

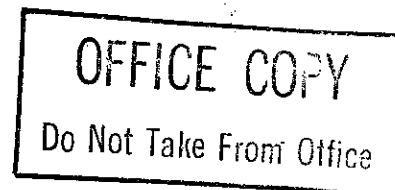

APPLYING TO THE FOLLOWING TERRITORY _____

LAKE WAUWANOKA

HILLSBORO

JEFFERSON COUNTY, MISSOURI

as described herein.

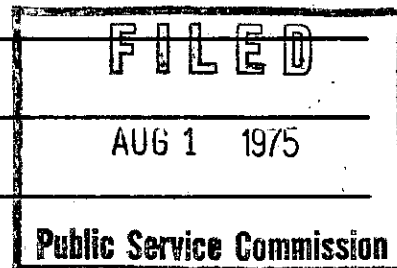

ISSUED June 23, 1975
month day year

EFFECTIVE August 1, 1975
month day year

BY Robt. D. Clark, President
Name of Officer title
Lake Wauwanoka, Route 3, Hillsboro, Mo.
Address of Officer

X7233

L. W. SEWER CORPORATION
Name of Issuing CorporationFor Lake Wauwanoka, Hillsboro
Community, Town or City
Jefferson County, MissouriRULES AND REGULATIONS
APPLYING TO SEWER SERVICE

RECEIVED

JUN 25 1975

MISSOURI
Public Service Commission

L. W. SEWER CORPORATION

RULES AND REGULATIONS

APPLYING TO

SEWER SERVICE

Filed with the
Public Service Commission of Missouri

FILED

AUG 1 1975

Public Service Commission

*Indicates new rate or text

+Indicates change

DATE OF ISSUE June 23, 1975
month day yearDATE EFFECTIVE August 1, 1975
month day yearISSUED BY Robt. D. Clark
name of officerPresident-
titleLake Wauwanoka
address
Route 3
Hillsboro, Missouri

FORM NO. 13 P.S.C.MO. No. 1 1st {Original} SHEET No. 1
Cancelling P.S.C.MO. No. 1 {Revised} SHEET No. 1
L. W. SEWER CORPORATION For Lake Wauwanoka, Hillsboro
Name of Issuing Corporation Community, Town or City
Jefferson County, Missouri

TABLE OF CONTENTS		III 31 1989
		MISSOURI
		Public Service Commission
		Page No.
Map of Area to be Served	2	
Legal Description of Area to be Served	3	
Rate Schedules.....	4	
<u>RULES AND REGULATIONS APPLYING TO SEWER SERVICE</u>		
Rule 1 - General.....	5	
Rule 2 - Definitions.....	6	
Rule 3 Applications for Sewer Service.....	7	
Rule 4 - Bills and Payment for Sewer Service.....	8	
Rule 5 - Discontinuance of Service.....	9	
Rule 6 - Limitations Upon Obligations of Company.....	10	
Rule 7 - Service Connection and Taps.....	11	
Rule 8 - Inside Piping and Customer Sewer Services.....	12 13 14	
Rule 9 - Improper Waste or Excessive Use.....	15 16	
Rule 10 - Charges.....	17	
Rule 11- Extension of Collecting Sewers.....	18 19 20 21	
FILED		
SEP 1 1989		
Public Service Commission		
*Indicates new rate or text		
+Indicates change		

DATE OF ISSUE August 1, 1989 DATE EFFECTIVE September 1, 1989
month day year month day year
ISSUED BY D. C. Mikusch President 109 South Lake Drive
name of officer title address
Hillsboro, MO 63050

L. W. SEWER CORPORATION

Name of Issuing Corporation

For Lake Wauwanoka, Hillsboro

Community, Town or City

Jefferson County, Missouri

TABLE OF CONTENTS

RECEIVED

JUN 25 1975

MISSOURI

Page No. _____

Public Service Commission

Map of Area to be Served -----	2
Legal Description of Area to be Served -----	3
Rate Schedules-----	4
<u>RULES AND REGULATIONS APPLYING TO SEWER SERVICE</u>	
Rule 1 - General-----	5
Rule 2 - Definitions-----	6
Rule 3-A - Applications for Sewer Service-----	7
Rule 3-B - Extension of Company Facilities-----	7-8-9-10
Rule 4 - Bills and Payment for Sewer Service-----	11
Rule 5 - Discontinuance of Service-----	12
Rule 6 - Limitations Upon Obligations of Company-----	13
Rule 7 - Service Connection and Taps-----	14
Rule 8 - Inside Piping and Customer Sewer Services-----	15-16-17
Rule 9 - Improper Waste or Excessive Use-----	18-19
Rule 10 - Charges-----	20

CANCELLED

SEP 1 1989

BY 1st P.S. #1Public Service Commission
MISSOURI*Indicates new rate or tax
+Indicates change

FILED

AUG 1 1975

Public Service Commission

DATE OF ISSUE June 23, 1975

month day year

DATE EFFECTIVE August 1, 1975

month day year

ISSUED BY Robt. D. Clark, President

name of officer

Lake Wauwanoka, Route 3, Hillsboro, Mo.

title

address

FORM NO. 13

P.S.C.MO. No. 1{ Original } SHEET No. 2
{ ~~Revised~~ }

Cancelling P.S.C.MO. No. _____

{ Original } SHEET No. _____
{ Revised }L. W. SEWER CORPORATION

Name of Issuing Corporation

For Lake Wauwanoka, Hillsboro

Community, Town or City

Jefferson County, Missouri

MAP OF AREA TO BE SERVED

RECEIVED

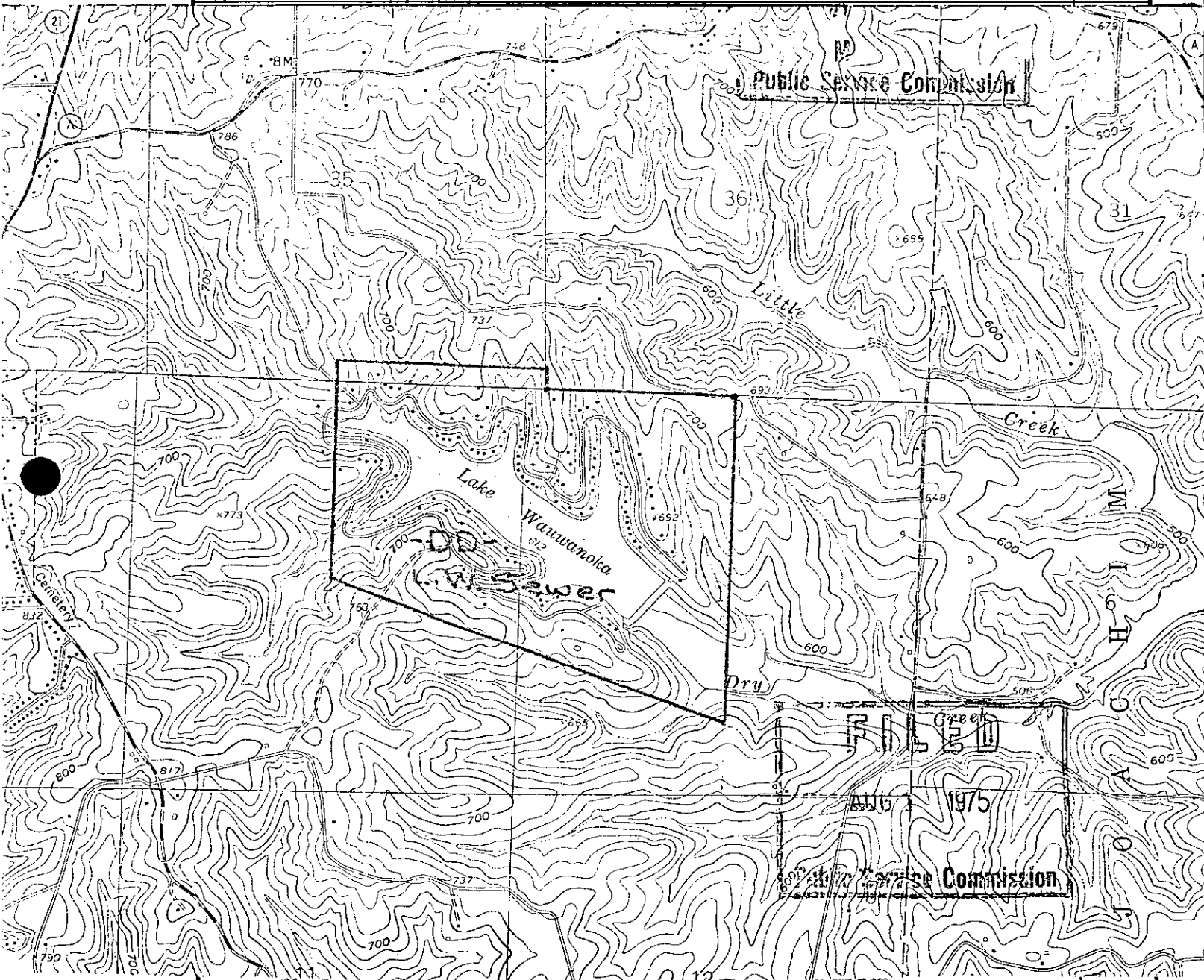

*Indicates new rate or text

+Indicates change

DATE OF ISSUE June 23, 1975
month day yearDATE EFFECTIVE August 1, 1975
month day yearISSUED BY Robt. D. Clark
name of officerPresident Lake Wauwanoka, Route 3
title address
Hillsboro, Mo.Cancelled
March 9, 2007Missouri Public
Service Commission SA-2007-0105

L. W. SEWER CORPORATION

Name of Issuing Corporation

For Lake Wauwanoka, Hillsboro

Community, Town or City

Jefferson County, Missouri

LEGAL DESCRIPTION OF AREA TO BE SERVED

RECEIVED

JUN 25 1975

Beginning at the Southwest corner of Section 36, Township 41 North, Range 4 East; Thence East along the Township line dividing Section 36, Township 41 North, Range 4 East, and Section 1, Township 40 North, Range 4 East, to the Northeast corner of the Northwest quarter of Section 1, Township 40 North, Range 4 East; Thence South along the East line of the Northwest quarter and the Southwest quarter of Section 1, Township 40 North, Range 4 East, a distance of 4526 feet, more or less to a point; Thence North 69 degrees 34 minutes West 6091 feet, more or less to a point on the West line of the Northeast quarter of Section 2, Township 40 North, Range 4 East; Thence North along West line of the Northeast quarter of Section 2, Township 40 North, Range 4 East, and its prolongation 3000 feet, more or less to a point in Section 35, Township 41 North, Range 4 East; Thence East 2937 feet, more or less to the West line of Section 36, Township 41 North, Range 4 East; Thence South along the West line of said Section 36, to the Southwest corner of Section 36, Township 41 North, Range 4 East, said point being the point of beginning.

FILED

AUG 1 1975

Public Service Commission

*Indicates new rate or text

+Indicates change

DATE OF ISSUE June 23, 1975

month day year

DATE EFFECTIVE August 1, 1975

month day year

ISSUED BY Robt. D. Clark, President

name of officer

Route 3, Lake Wauwanoka, Hillsboro, Mo.

title

address

Cancelled

March 9, 2007

Missouri Public

Service Commission

SA-2007-0105

P.S.C. MO No. 1

5th Revised Sheet No. 4

Canceling 4th Revised Sheet No. 4

L W Sewer Corporation
Name of Issuing Company

For: Lake Wauwanoka, Hillsboro
Community, Town or City
Jefferson County, Missouri

**Rules Governing
the Rendering of Sewer Service** +
+ +

Single Family Residence *

AVAILABILITY: This rate is available in service area to single family residences for domestic sewage only.

RATE TABLE:

New Service Connection and Inspection Charge - - - - \$600.00
Monthly Service Charge - - - - - 15.16 +

PAYMENT TERMS: Bills are net, are rendered quarterly, and are due and payable on receipt.

RULES AND REGULATIONS: The general rules and regulations set forth in this tariff shall govern the supply of service under this rate.

* Indicates New Rate or Text
+ Indicates Changed Rate or Text

Issue Date: March 30, 2005
Month/Day/Year

Effective Date: ~~May 1, 2005~~
Month/Day/Year
May 31, 2005

Issued By: Clyde Pratt-President
Name & Title of Issuing Officer

P.O. Box 265 Hillsboro MO 63050
Company Mailing Address

Cancelled
March 9, 2007
Missouri Public
Service Commission

SA-2007-0105

SR-2005-0338

Filed
Missouri Public
Service Commission

L. W. SEWER CORPORATION
 Name of Issuing Corporation

For Lake Wauwanoka, Hillsboro
 Community, Town or City
Jefferson County, Missouri

RATE "A"		RECEIVED
SINGLE FAMILY RESIDENCES		
AVAILABILITY: This rate is available in service area to single family residences for domestic sewage only.		MAY 10 1996
RATE TABLE:		MISSOURI Public Service Commission
New Service Connection and Inspection Charge	----- \$ 600.00	
Monthly Service Charge	----- 13.18	*
PAYMENT TERMS: Bills are net, are rendered quarterly, and are due and payable upon receipt.		
RULES AND REGULATIONS: The general rules and regulations set forth in this tariff shall govern the supply of service under this rate.		
CANCELLED MAY 31 2005 BY 54HRS4 Public Service Commission MISSOURI		
FILED JUL 1 1996 96 - 378 MO. PUBLIC SERVICE COM		
*Indicates new rate or text +Indicates change		

DATE OF ISSUE May 10, 1996 DATE EFFECTIVE July 1, 1996
 month day year month day year
 ISSUED BY Stan Link Vice-President, Lake Wauwanoka, P.O. Box 265, Hillsboro, MO
 name of officer title address

FORM NO. 13

P.S.C.MO. No. 3rd

{ Original } SHEET No. 4
{ Revised }

Cancelling P.S.C.MO. No. 2nd

{ Original } SHEET No. 4
{ Revised }L. W. SEWER CORPORATION
Name of Issuing Corporation

For

Lake Wauwanoka, Hillsboro
Community Town or City
Jefferson County Missouri

RATE "A"

SINGLE FAMILY RESIDENCES

APR 11 1978

AVAILABILITY: This rate is available in service area to single
family residences for domestic sewage only.MISSOURI
Public Service Commission

RATE TABLE:

New Service Connection and Inspection Charge \$ 600.00

Monthly Service Charge \$ 9.25 *

PAYMENT TERMS: Bills are net, are rendered quarterly, and are due
and payable upon receipt.RULES AND REGULATIONS: The general rules and regulations set forth
in this tariff shall govern the supply of service under this rate.

CANCELLED

JUL 1 1996
BY *H. R. S. #4*
Public Service Commission
MISSOURI

FILED

JUN 1 - 1978

78 - 144

Public Service Commission

JUN 1 - 1978

*Indicates new rate or text

+Indicates change

DATE OF ISSUE April 8, 1978
month day yearDATE EFFECTIVE May 1, 1978
month day yearISSUED BY Glenn A. Pauly, President
name of officerLake Wauwanoka, Route 5
title address
Hillsboro, Missouri

FORM NO. 13 P.S.C.MO. No. 2nd {Original} SHEET No. 4
{Revised}
Cancelling P.S.C.MO. No. 1st {Original} SHEET No. 4
{Revised}
L. W. SEWER CORPORATION For Lake Wauwanoka, Hillsboro
Name of Issuing Corporation Community, Town or City
Jefferson County, Missouri

RATE "A"
SINGLE FAMILY RESIDENCES

RECEIVED

MAR 25 1976

AVAILABILITY: This rate is available in service area to ~~MISSOURI~~
family residences for domestic sewage only.

MISSOURI
Public Service Commission

RATE TABLE:

New Service Connection and Inspection Charge \$ 600.00 *

Monthly Service Charge \$ 8.00 *

PAYMENT TERMS: Bills are net, are rendered quarterly, and are due
and payable upon receipt.

RULES AND REGULATIONS: The general rules and regulations set forth
in this tariff shall govern the supply of service under this rate.

CANCELLED

JUN 1 - 1978

BY 3rd RS 4
PUBLIC SERVICE COMMISSION
OF MISSOURI

FILED

MAY 1 1976

Public Service Commission

*Indicates new rate or text
+Indicates change

DATE OF ISSUE March 25, 1976 DATE EFFECTIVE May 1, 1976
month day year month day year
ISSUED BY Robt. D. Clark President Lake Wauwanoka
name of officer title address
Route 3, Hillsboro, Missouri

FORM NO. 13

P.S.C.MO. No.

1st

(Original)

SHEET No. 4

(Revised)

Cancelling P.S.C.MO. No.

1st

(Original)

SHEET No. 4

(Revised)

L. W. SEWER CORPORATION
Name of Issuing CorporationFor Lake Wauwanoka, Hillsboro
Community, Town or City

Jefferson County, Missouri

RECEIVED

RATE "A"

SINGLE FAMILY RESIDENCES

DEC 31 1975

AVAILABILITY: This rate is available in service area to single family residences for domestic sewage only. MISSOURI Public Service Commission

RATE TABLE:

New Service Connection and Inspection Charge \$ 250.00

Inspection of "In Use" service sewer connections and/or appliance or swimming pool, etc. of customer used in connection with this service.

Rule 10-4 15.00

Monthly Service Charge 8.00

PAYMENT TERMS: Bills are net, are rendered quarterly, and are due and payable upon receipt.

RULES AND REGULATIONS: The general rules and regulations set forth in this tariff shall govern the supply of service under this rate.

CANCELLED

MAY 1 1976

BY 2nd R.S. 4
PUBLIC SERVICE COMMISSION
OF MISSOURI

FILED

JAN 1 1976

Case # 18592

Public Service Commission

*Indicates new rate or text

+Indicates change

DATE OF ISSUE November 1, 1975
month day yearDATE EFFECTIVE January 1, 1976
month day yearISSUED BY Robert D. Clark
name of officerPresident
titleLake Wauwanoka
Rt. 3 address
Hillsboro, Mo.

L. W. SEWER CORPORATION
Name of Issuing Corporation

For Lake Wauwanoka, Hillsboro,
Community, Town or City
Jefferson County, Missouri

Name of Issuing Corporation

RATE 11.41

SINGLE FAMILY RESIDENCES

RECEIVED

JUN 25 1975

MISSOURI

Public Service Commission

AVAILABILITY: This rate is available in service area to single family residences for domestic sewage only.

RATE TABLE:

New Service Connection and Inspection Charge\$ 250.00

Inspection of "In Use" service sewer connections and/or appliance or swimming pool, etc. of customer used in connection with this service.

Rule 10-4	15.00
-----------------	-------

Monthly Service Charge	6.50
------------------------------	------

PAYMENT TERMS: Bills are net, are rendered quarterly, and are due and payable upon receipt.

RULES AND REGULATIONS: The general rules and regulations set forth in this tariff shall govern the supply of service under this rate.

CANCELLED

JAN 1 1976

BY 1st R.S. 4
PUBLIC SERVICE COMMISSION
OF MISSOURI

**PUBLIC SERVICE COMMISSION
OF MISSOURI**

FILED

AUG 1 1975

Public Service Commission

*Indicates new rate or text

+Indicates change

DATE OF ISSUE June 23, 1975
month day year

month day year

DATE EFFECTIVE August 1, 1975
month day year

month day year

ISSUED BY Robt. D. Clark
name of officer

name of officer

President
title

title

Lake Wauwanoka
address

address

Route 3
Hillsboro, Missouri

P.S.C. MO No. 1

2nd Revised Sheet No. 4A

Canceling 1st Original Sheet No. 4A

L W Sewer Corporation
Name of Issuing Company

For: Lake Wauwanoka, Hillsboro
Community, Town or City
Jefferson County, Missouri

**Rules Governing
the Rendering of Sewer Service**

THIS PAGE IS *

INTENTIONALLY LEFT *

BLANK *

* Indicates New Rate or Text
+ Indicates Changed Rate or Text

Issue Date: March 30, 2005
Month/Day/Year

Effective Date: May 1, 2005
Month/Day/Year
May 31, 2005

Issued By: Clyde Pratt-President
Name & Title of Issuing Officer

P.O. Box 265 Hillsboro MO 63050
Company Mailing Address

L.W. Sewer Corporation

PSC MO. NO. 1

1st rs 4A

Unable to Locate

FORM NO. 13

P.S.C.MO. No. 1{ Original } SHEET No. 4A
{ Revised }

Cancelling P.S.C.MO. No. _____

{ Original } SHEET No. _____
{ Revised }

L W Sewer Corporation

For

Lake Wau Wanoka, Hillsboro

Name of Issuing Corporation

Community, Town or City

RECEIVED

SEWER SERVICE

SURCHARGE

JUN 21 1994

Monthly Surcharge per Residential Customer

MO. PUBLIC SERVICE COMM.
\$ 5.42

This surcharge may be changed annually by the filing of a revision of this tariff sheet when the number of customers changes significantly from 184. The surcharge will terminate when principal and interest on the \$50,000 EIERA loan approved in Case No. SF-94-202 has been paid for by customers or five (5) years from the effective date of this tariff sheet.

On June 1 of each year, L. W. Sewer Corporation will notify the Commission's Water and Sewer Department and the Office of the Public Counsel of the amount of surcharge funds charged to customers during the past year and of any change in the level of customers.

CANCELLED

MAY 31 2005
BY *2nd RS 4A*
Public Service Commission
MISSOURI

FILED

94-202

JUL 21 1994

94-378

MO. PUBLIC SERVICE COMM.

*Indicates new rate or text

+Indicates change

DATE OF ISSUE June 21, 1994
month day yearDATE EFFECTIVE July 21, 1994
month day yearISSUED BY *[Signature]*

name of officer

PRESIDENT

title

P.O. BOX 265

HILLSBORO, MO 63050
address

L. W. SEWER CORPORATION

For Lake Wauwanoka, Hillsboro

Name of Issuing Corporation

Community, Town or City

Jefferson County, Missouri

RULES AND REGULATIONS

APPLYING TO SEWER SERVICE

JUN 25 1975

Rule 1 GENERAL

MISSOURI

Public Service Commission

(a) Every Customer, upon signing an application for any service rendered by the Company, or upon taking of sewer service, shall be considered to have expressed consent to the Company's rates, rules and regulations.

(b) The Company reserves the right, subject to authority of the Public Service Commission of Missouri, to prescribe additional rates, rules or regulations or to alter existing rates, rules or regulations as it may from time to time deem necessary or proper.

(c) The sewer service made available under these rules is for the use of the Customer on his premises, and he shall not re-sell any of it without written consent of this Company.

(d) The Company's rates are predicated upon the supply of service being rendered separately for each premise and the ultimate usage in or on such separate premises.

(e) The properly authorized agents of the Company shall have the right to enter upon the premises of the Customer at all reasonable times for the purpose of inspecting any appliance of the Customer used in connection with this service.

FILED

AUG 1 1975

Public Service Commission

*Indicates new rate or text

+Indicates change

DATE OF ISSUE June 23, 1975 DATE EFFECTIVE August 1, 1975
month day year month day yearISSUED BY Robt. D. Clark President Lake Wauwanoka
name of officer title addressRoute 3
Hillsboro, Missouri

Cancelling P.S.C.MO. No. _____

{ Original }

SHEET No. _____

{ Revised }

L. W. SEWER CORPORATION
Name of Issuing CorporationFor Lake Wauwanoka, Hillsboro
Community, Town or City
Jefferson County, MissouriRULES AND REGULATIONS
APPLYING TO SEWER SERVICE

RECEIVED

JUN 25 1975

MISSOURI

Public Service Commission

Rule 2 DEFINITIONS

- (a) The "COMPANY" means L. W. Sewer Corporation.
- (b) The "CUSTOMER" is any person, firm, corporation or governmental body receiving sewer service from Company or whose facilities are connected for utilizing such service.
- (c) A "COLLECTING SEWER" is a pipeline which is owned and maintained by the Company, located on public property or on private easements, and used to transport sewage wastes to a central point for disposal.
- (d) A "CUSTOMER'S SERVICE SEWER" is a pipe with appurtenances installed, owned, and maintained by the Customer, used to conduct sewage from the Customer's premise to the collecting sewer.
- (e) A "SERVICE CONNECTION" is the point at which the Customer's sewer service is connected to the collecting sewer through a "Y" branch.

FILED

AUG 1 1975

Public Service Commission

*Indicates new rate or text

+Indicates change

DATE OF ISSUE June 23, 1975 DATE EFFECTIVE August 1, 1975
month day year month day yearISSUED BY Robt. D. Clark President Lake Wauwanoka
name of officer title addressRoute 3
Hillsboro, Missouri

L. W. SEWER CORPORATION

Name of Issuing Corporation

For Lake Wauwanoka, Hillsboro

Community, Town or City

Jefferson County, Missouri

RULES AND REGULATIONS

JUL 31 1989

APPLYING TO SEWER SERVICE

Rule 3 APPLICATIONS FOR SEWER SERVICEMISSOURI
Public Service Commission

(a) At the time of application for service, applicant may be required to execute a written application or contract provided, however, that the Company shall have the right to reject, for failure to comply with Company's rules and regulations, any application. In any case where unusual construction or equipment expense is necessary to furnish the service, the Company may require a contract for such reasonable period of time as is specified by the Company at the time of the making of such contract.

(b) The Customer shall, upon request of the Company, present in writing to the Company a list of the devices which are to be attached to the Company's lines, giving the location of the building. The Company will then advise the form and the character of the waste collection facilities available.

(c) No substantial addition to the water-using equipment or appliances connected to the sewer system of the Company shall be made except upon written notice to, and with the written consent of, the Company.

FILED

SEP 1 1989

Public Service Commission

*Indicates new rate or text

+Indicates change

DATE OF ISSUE August 1, 1989
month day yearDATE EFFECTIVE September 1, 1989
month day yearISSUED BY D. C. MikuschD. C. Mikusch
name of officerPresident, 109 So. Lake Drive, Hillsboro, MO
title address

63050

Cancelling P.S.C.MO. No. _____

{ Original } SHEET No. _____
{ Revised }L. W. SEWER CORPORATION

Name of Issuing Corporation

For

Lake Wauwanoka, Hillsboro

Community, Town or City

Jefferson County, MissouriRULES AND REGULATIONS
APPLYING TO SEWER SERVICE

RECEIVED

JUN 25 1975

MISSOURI

Public Service Commission

Rule 3-A, APPLICATIONS FOR SEWER SERVICE

(a) At the time of application for service, applicant may be required to execute a written application or contract provided, however, that the Company shall have the right to reject, for failure to comply with Company's rules and regulations, any application. In any case where unusual construction or equipment expense is necessary to furnish the service, the Company may require a contract for such reasonable period of time as is specified by the Company at the time of the making of such contract.

(b) The Customer shall, upon request of the Company, present in writing to the Company a list of the devices which are to be attached to the Company's lines, giving the location of the building. The Company will then advise the form and the character of the waste collection facilities available.

(c) No substantial addition to the water-using equipment or appliances connected to the sewer system of the Company shall be made except upon written notice to, and with the written consent of, the Company.

Rule 3-B, EXTENSION OF COMPANY FACILITIES

The Company will install additional plant facilities and will extend its sewer mains along public highways, parkways, streets or alleys where grades have been established, or within easements acceptable to the Company on the following terms and conditions.

(a) A written application is required from all persons desiring service, as set forth in Rule 3-A. If such service requires the construction of new mains or enlargement of existing mains, the Company shall supply the Customer with an estimate showing the total cost of construction, together with data on any contributions or deposits required in accordance with these rules and regulations. This estimate shall be dated and considered as effective and binding upon the Company for a period of 120 days from such date.

CANCELED

SEP 1 1989

BY W.R.S.H.

AUG 1 1975

FILED

*Indicates new rate or text

+Indicates change

DATE OF ISSUE June 23, 1975
month day yearDATE EFFECTIVE August 1, 1975
month day yearISSUED BY Robt. D. Clark, President - Lake Wauwanoka, Route 3, Hillsboro, Mo.
name of officer title address

FORM NO. 13 P.S.C.MO. No. 1 2nd {Original} SHEET No. 8
{Revised}
Cancelling P.S.C.MO. No. 1 1st {Original} SHEET No. 8
{Revised}

L. W. SEWER CORPORATION For Lake Wauwanoka, Hillsboro
Name of Issuing Corporation Community, Town or City
Jefferson County, Missouri

RULES AND REGULATIONS APPLYING TO SEWER SERVICE		JUL 31 1989
		MISSOURI Public Service Commission
Rule 4 <u>BILLS AND PAYMENT FOR SEWER SERVICE</u>		
<p>(a) Customers are liable for payment for all sewer service to the premises until notice has been received at the Company's office that the use of the sewer is no longer desired.</p> <p>(b) Bills for sewer services will be mailed or delivered to the Customer's last address as shown by the records of the Company, but failure to receive a bill will not relieve the Customer from the obligation to pay the same. All bills and other accounts must be paid at the office of the Company or other place designated by the Company. All bills for sewer service become delinquent after the due date stated on the bill and service will be discontinued after 30 days' written notice by the Company that the bill is delinquent unless the bill is paid according to said notice.</p> <p>(c) When bills are rendered for a period of less than a complete billing period due to the connection or termination of service, the billing shall be for the proportionate part of the monthly charge, or a proportionate part of the minimum, whichever is greater. Customers terminating with less than one month's service shall pay not less than the monthly minimum.</p> <p>(d) The Company shall have the right to render bills quarterly, on or about the first day of January, April, July, and October, and such bills shall be due and payable on the due date indicated on the bill.</p>		
		FILED SEP 1 1989 Public Service Commission
*Indicates new rate or text +Indicates change		

DATE OF ISSUE August 1, 1989 DATE EFFECTIVE September 1, 1989
month day year month day year

ISSUED BY D. C. Mikusch President, 109 So. Lake Drive, Hillsboro, MO
name of officer title address 63050

SA-2007-0105

L. W. SEWER CORPORATION
Name of Issuing Corporation

For Lake Wauwanoka, Hillsboro
Community, Town or City
Jefferson County, Missouri

RULES AND REGULATIONS
APPLYING TO SEWER SERVICE

RECEIVED

MAR 25 1976

Rule 3 B EXTENSION OF COMPANY FACILITIES (continued)

(b) Before the Company designs the required facilities and provides a final cost estimate, the applicant shall

MISSOURI
Public Service Commission

(1) Provide the Company, without cost, any plats, surveys, plans or other available information requested by the Company. The applicant shall guarantee or qualify the accuracy of such data.

(2) Deposit with the Company a sum equal to 25% of the estimated cost of construction to cover engineering costs. If no contract is executed within four (4) months from the date the Company provides the applicant with the final cost estimate, the deposit shall be retained by the Company for engineering costs. If the contract is subsequently executed, the amount will be applied toward payments due from applicant under the contract, or refunded without interest provided no payment is due.

(c) Upon applicant's compliance with (b) above, the Company will design the required service extension facilities consistent with sound engineering practices and make an estimate of their cost, including all labor and materials, supervision, engineering, and other expenses as listed in a prescribed System of Accounts. All required manholes and lift stations as well as the expansion, reconstruction or retirement of existing sewer mains or plant facilities shall be included. A main extension-connection contract, including the cost estimate, will then be submitted to the applicant or a designated representative.

(d) The facilities and/or mains will be installed as soon as practical after receipt of the executed extension-connection contract provided that:

(1) The applicant has paid to the Company the required connection fee as provided in Rule 10.

CANCELLED

SEP 1 1989

BY *[Signature]* #8
Public Service Commission

FILED

MAY 1 1976

*Indicates new rate or text

+Indicates change

DATE OF ISSUE March 25, 1976 month day year DATE EFFECTIVE May 1, 1976 month day year

ISSUED BY Robt. D. Clark President Lake Wauwanoka
name of officer title address
Route 3, Hillsboro, Missouri

L. W. SEWER CORPORATION
Name of Issuing CorporationFor Lake Wauwanoka, Hillsboro
Community, Town or City
Jefferson County, MissouriRULES AND REGULATIONS
APPLYING TO SEWER SERVICE

RECEIVED

JUN 25 1975

MISSOURI

Public Service Commission

Rule 3 B EXTENSION OF COMPANY FACILITIES (continued)

(b) Before the Company designs the required service extension, the applicant shall provide a final cost estimate, the applicant shall:

(1) Provide the Company, without cost, any plats, surveys, plans or other available information requested by the Company. The applicant shall guarantee or qualify the accuracy of such data.

(2) Deposit with the Company a sum equal to 25% of the estimated cost of construction to cover engineering costs. If no contract is executed within four (4) months from the date the Company provides the applicant with the final cost estimate, the deposit shall be retained by the Company for engineering costs. If the contract is subsequently executed, the amount will be applied toward payments due from applicant under the contract, or refunded without interest provided no payment is due.

(c) Upon applicant's compliance with (b) above, the Company will design the required service extension facilities consistent with sound engineering practices and make an estimate of their cost, including all labor and materials, supervision, engineering, and other expenses as listed in a prescribed System of Accounts. All required manholes and lift stations as well as the expansion, reconstruction or retirement of existing sewer mains or plant facilities shall be included. A main extension-connection contract, including the cost estimate, will then be submitted to the applicant or a designated representative.

(d) The facilities and/or mains will be installed as soon as practical after receipt of the executed extension-connection contract provided that:

(1) The applicant has paid to the Company the required connection fee as provided in Rule 3

CANCELLED

MAY 1 1976

*Indicates new rate or text
+Indicates changeBY Let R.S. 8
PUBLIC SERVICE COMMISSION

OF MISSOURI

AUG 1 1975

Public Service Commission

DATE OF ISSUE June 23, 1975
month day yearDATE EFFECTIVE August 1, 1975
month day year

ISSUED BY Robt. D. Clark

name of officer

President

title

Lake Wauwanoka

address

Route 3
Hillsboro, Missouri

L. W. SEWER CORPORATION

For Lake Wauwanoka, Hillsboro

Name of Issuing Corporation

Community, Town or City

Jefferson County, Missouri

RECEIVED

RULES AND REGULATIONS
APPLYING TO SEWER SERVICE

JUL 31 1989

MISSOURI
Public Service CommissionRule 5 DISCONTINUANCE OF SERVICE

(a) The Company reserves the right upon the giving of not less than thirty (30) days' written notice to the Customer by Certified Mail, Return Receipt Requested, to discontinue service for non-payment of sewer bills or for violation of or refusal to comply with these rules and regulations. Copy of written notice will be forwarded to Missouri Public Service Commission.

(b) In case of violation by the Customer of any of the provisions of Rule 9, or if a condition shall exist which, in the opinion of the Company, renders further service to the Customer dangerous to his health and safety or to the health and safety of other parties, or detrimental to the sewer system, the Company may discontinue service immediately upon the giving of verbal or written notice to the Customer.

(c) When the Company disconnects and plugs the Customer's sewer service at the point of connection to the Company's main, the total cost of disconnection and re-establishment of service shall be at the Customer's expense.

(d) Discontinuance of sewage service to a premise for any reason shall not prevent the Company from pursuing any lawful remedy by action at law or otherwise for the collection of moneys due from the Customer.

FILED

SEP 1 1989

Public Service Commission

*Indicates new rate or text

+Indicates change

DATE OF ISSUE August 1, 1989DATE EFFECTIVE September 1, 1989

ISSUED BY

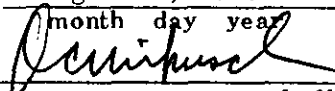

name of officer

D. C. Mikusch

President, 109 So. Lake Drive, Hillsboro, MO

title

address

63050

L. W. SEWER CORPORATION
Name of Issuing Corporation

For

Lake Wauwanoka, Hillsboro
Community, Town or City
Jefferson County, Missouri

RULES AND REGULATIONS
APPLYING TO SEWER SERVICE

RECEIVED

MAR 25 1976

MISSOURI

Public Service Commission

Rule 3 B EXTENSION OF COMPANY FACILITIES (continued)

(2) The applicant has deposited with the Company a sum equivalent to the difference between the estimated cost of extension and the connection fee provided in Rule 10. If the connection fee paid exceeds the estimated cost of extension, no deposit shall be required. If the connection fee is less than the estimated cost, the deposit is required and in such event the applicant shall be entitled to equivalent refund of the difference out of future connection fees received by future customers paying for connections to and within the limits of the extension covered by this specific contract or agreement. Deposits shall not bear interest.

(3) Any required deposits are to be received within 120 days after submission of the contract to the applicant or designated representative. After such 120 day period, the contract shall be null and void at the Company's option.

(4) Applicant has entered into standard sewage disposal maintenance agreements covering the premise to be served.

(e) Refunds of deposits required by Rule 3 B shall be made only to the depositors, their successors, assigns or authorized agents, as follows: *

(1) Should the actual cost of the extension be less than the estimated cost, the Company shall refund the difference as soon as the actual cost has been ascertained.

(f) Extensions made under this rule shall be and remain the property of the Company in consideration of its perpetual upkeep and maintenance. The Company also reserves the right to extend further the main and connect mains on intersecting streets. Customers connected to such further extensions shall not entitle the depositor paying for the original extension to a refund for such Customers.

CANCELLED

SEP 1 1989

BY *gals #9*

Public Service Commission

FILED

MAY 1 1976

Public Service Commission

*Indicates new rate or text
+Indicates change

DATE OF ISSUE March 25, 1976
month day year

DATE EFFECTIVE May 1, 1976
month day year

ISSUED BY Robt. D. Clark
name of officer

President

Lake Wauwanoka

title address
Route 3, Hillsboro, Missouri

Cancelling P.S.C.MO. No. _____

{ Original } SHEET No. _____
{ Revised }

L. W. SEWER CORPORATION

Name of Issuing Corporation

For Lake Wauwanoka, Hillsboro
Community, Town or City
Jefferson County, Missouri

RULES AND REGULATIONS

APPLYING TO SEWER SERVICE

RECEIVED

JUN 25 1975

Rule 3 B EXTENSION OF COMPANY FACILITIES (continued)

MISSOURI

Public Service Commission

(2) The applicant has deposited with ~~the Company~~ a sum equivalent to the difference between the estimated cost of extension and the connection fee provided in Rule 3. If the connection fee paid exceeds the estimated cost of extension, no deposit shall be required. If the connection fee is less than the estimated cost, the deposit is required and in such event the applicant shall be entitled to equivalent refund of the difference out of future connection fees received by future customers paying for connections to and within the limits of the extension covered by this specific contract or agreement. Deposits shall not bear interest.

(3) Any required deposits are to be received within 120 days after submission of the contract to the applicant or designated representative. After such 120 day period, the contract shall be null and void at the Company's option.

(4) Applicant has entered into standard sewage disposal maintenance agreements covering the premise to be served.

(e) Refunds of deposits required by Section 3 (d) shall be made only to the depositors, their successors, assigns or authorized agents, as follows:

(1) Should the actual cost of the extension be less than the estimated cost, the Company shall refund the difference as soon as the actual cost has been ascertained.

(f) Extensions made under this rule shall be and remain the property of the Company in consideration of its perpetual upkeep and maintenance. The Company also reserves the right to extend further the main and connect mains on intersecting streets. Customers connected to such further extensions shall not entitle the depositor paying for the original extension to a refund for such customers.

MAY 1 1976

BY for R.S. 9

*Indicates new rate
+Indicates change
PUBLIC SERVICE COMMISSION
OF MISSOURI

FILED

AUG 1 1975

Public Service Commission

DATE OF ISSUE June 23, 1975
month day yearDATE EFFECTIVE August 1, 1975
month day yearISSUED BY Robt. D. Clark
name of officerPresident
titleLake Wauwanoka
address
Route 3
Hillsboro, Missouri

L. W. SEWER CORPORATION

Name of Issuing Corporation

For Lake Wauwanoka, Hillsboro

Community, Town or City

Jefferson County, Missouri

RECEIVED

RULES AND REGULATIONS
APPLYING TO SEWER SERVICE

JUL 31 1989

MISSOURI

Public Service Commission

Rule 6 LIMITATIONS UPON OBLIGATIONS OF COMPANY

(a) The Company shall not be responsible in damages for any failure to remove waste water from the premises or for interruption if such failure or interruption is without willful default or negligence on the part of the Company.

(b) The Company shall not be liable for damages resulting to Customer or to third persons, unless due to contributory negligence on the part of the Company, and without any contributory negligence on the part of the Customer or such third party.

(c) The Company shall not be liable for damages because of any interruption of sewer service or for damages caused by defective piping and appliances on the Customer's premises.

(d) The Company reserves the right to discontinue sewer service in its mains at any time, without notice, for making repairs, extensions or alterations to the distribution system or station equipment.

(e) Employees or agents of the Company are expressly forbidden to demand or accept any compensation for any service rendered to its Customers except as covered in the Company's rules and regulations.

(f) No employee or agent of the Company shall have the right or authority to bind it by any promise, agreement or representation contrary to the letter or intent of these rules and regulations. Nor shall any employee or agent of the Company have authority to bind it by any promise, agreement, or representation not provided for in these rules, unless such authority is in writing and signed by the General Manager, of the Company.

FILED

SEP 1 1989

Public Service Commission

*Indicates new rate or text

+Indicates change

DATE OF ISSUE August 1, 1989 DATE EFFECTIVE September 1, 1989
month day year month day year

ISSUED BY

*D. C. Mikusch*D. C. Mikusch
name of officerPresident, 100 So. Lake Dr. Hillsboro NY
title address

Cancelled

March 9, 2007

Missouri Public

Service Commission

SA-2007-0105

L. W. SEWER CORPORATION
Name of Issuing CorporationFor Lake Wauwanoka, Hillsboro
Community, Town or City
Jefferson County, MissouriRULES AND REGULATIONS
APPLYING TO SEWER SERVICE

RECEIVED

JUN 25 1975

Rule 3 B EXTENSION OF COMPANY FACILITIES (continued) MISSOURI

Public Service Commission

(g) The sizing and design of additional facilities shall be determined by the Company consistent with the applicants' requirements.

(h) If the Company desires to install mains or facilities larger in size than required by the needs of the depositor in accordance with sound engineering or waterworks practices, the additional costs of the larger installations shall be borne by the Company.

CANCELLED

SEP 1 1989

BY RS #10Public Service Commission
MISSOURI

FILED

AUG 1 1975

Public Service Commission

*Indicates new rate or text

+Indicates change

DATE OF ISSUE June 23, 1975- DATE EFFECTIVE August 1, 1975
month day year month day yearISSUED BY Robt. D. Clark President Lake Wauwanoka
name of officer title address
Route 3
Hillsboro, Missouri

FORM NO. 13 P.S.C.MO. No. 1 1st { Original } SHEET No. 11Cancelling P.S.C.MO. No. 1 { Original } SHEET No. 11
{ Revised }L. W. SEWER CORPORATION
Name of Issuing CorporationFor Lake Wauwanoka, Hillsboro
Community, Town or City
Jefferson County, Missouri

RECEIVED

RULES AND REGULATIONS
APPLYING TO SEWER SERVICE

JUL 31 1989

MISSOURI

Public Service Commission

Rule 7 SERVICE CONNECTION AND TAPS

(a) The Company will locate the point to which service connection will be made and Customer will furnish a "Y" branch at the collecting sewer which shall be located in the public street or right-of-way. All taps are to be made by licensed plumbers, subject to inspection and approval by the Company. Application, accompanied by a \$600.00 connection and inspection fee, must be filed in writing 24 hours in advance stating the street, the house number, name of applicant, name of property owner, and time at which tap is to be made. The Company will not be required to supply sewer service until each such tap has been inspected and approved by it. Customer will be liable for any damages to Company sewer mains resulting from such work.

(b) The building sewer service connection from the collecting sewer to the Customer's building shall be installed by, and at the expense of the Customer. A service sewer connection shall not be used to supply more than a single property without the consent of the Company.

(c) Customer service sewer will not be extended along public streets or roadways or through property of others in connecting with collecting sewers, unless approved by the Company.

(d) Any change in the location of an existing service connection requested by the Customer shall be made at his expense.

FILED

SEP 1 1989

*Indicates new rate or text
+Indicates change

Public Service Commission

DATE OF ISSUE August 1, 1989 DATE EFFECTIVE September 1, 1989
month day year month day year

ISSUED BY

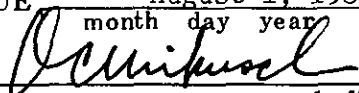

D. C. Mikusch name of officer

President, 109 So. Lake Drive, Hillsboro, MO 63050

title

address

L. W. SEWER CORPORATION
Name of Issuing CorporationFor Lake Wauwanoka, Hillsboro
Community, Town or City
Jefferson County, Missouri

RULES AND REGULATIONS

APPLYING TO SEWER SERVICE

RECEIVED

JUN 25 1975

MISSOURI

Public Service Commission

Rule 4 BILLS AND PAYMENT FOR SEWER SERVICE

(a) Customers are liable for payment for ~~all sewer service to~~ the premises until notice has been received at the Company's office that the use of the sewer is no longer desired.

(b) Bills for sewer services will be mailed or delivered to the Customer's last address as shown by the records of the Company, but failure to receive a bill will not relieve the Customer from the obligation to pay the same. All bills and other accounts must be paid at the office of the Company or other place designated by the Company. All bills for sewer service become delinquent after the due date stated on the bill and service will be discontinued after 30 days' written notice by the Company that the bill is delinquent unless the bill is paid according to said notice.

(c) When bills are rendered for a period of less than a complete billing period due to the connection or termination of service, the billing shall be for the proportionate part of the monthly charge, or a proportionate part of the minimum, whichever is greater. Customers terminating with less than one month's service shall pay not less than the monthly minimum.

(d) The Company shall have the right to render bills quarterly, on or about the first day of January, April, July, and October, and such bills shall be due and payable on the due date indicated on the bill.

CANCELLED

SEP 1 1989

BY 1st P.S.#11Public Service Commission
MISSOURI

FILED

AUG 1 1975

Public Service Commission

*Indicates new rate or text

+Indicates change

DATE OF ISSUE June 23, 1975
month day yearDATE EFFECTIVE August 1, 1975
month day yearISSUED BY Robt. D. Clark
name of officerPresident
titleLake Wauwanoka
address
Route 3
Hillsboro, Missouri

L. W. SEWER CORPORATION

For

Lake Wauwanoka, Hillsboro

Name of Issuing Corporation

Community, Town or City

Jefferson County, Missouri

RECEIVED

RULES AND REGULATIONS
APPLYING TO SEWER SERVICE

JUL 31 1989

Rule 8 INSIDE PIPING AND CUSTOMER SEWER SERVICES

Missouri Public Service Commission

(a) The Customer will provide the Customer's sewer service at his expense and risk. As a condition of service, inside piping and building sewer construction must meet all of the requirements of the latest editions of the Plumbing Rules and Regulations of the Administrative Building Council, Volume III, at the time of connection to the system. The Company shall deny service where footing drains, downspouts, or other sources of water are permitted to enter the system through either the inside piping or through the building sewer.

(b) A separate and independent Customer sewer service shall be required for every building; except where one building stands at the rear of another on an interior lot and no private sewer is available or can be constructed to the rear building through an adjoining alley, court, yard, or driveway, the Customer's sewer service from the front building may be extended to the rear building and the whole considered as one Customer's sewer service.

(c) Old Customer sewer services may be used in connection with new buildings only when they are found on examination and test to meet all requirements of the Company.

(d) The Customer's sewer service shall be cast iron soil pipe, ASTM specification or equal; vitrified clay sewer pipe, ASTM specification or equal; or other suitable material approved by the Company. Joints shall be tight and waterproof. Any part of the Customer's sewer service that is located within ten feet of a water service pipe shall be constructed of cast iron soil pipe. Cast iron pipes may be required where the Customer's sewer service is exposed to damage by tree roots. If installed in filled or unstable ground, the Customer's sewer service shall be of cast iron soil pipe, except that non-metallic material may be accepted if laid on a suitable concrete bed or cradle as approved by the said Company.

(e) The size and slope of the Customer's sewer service shall be subject to the approval of the Company, but in no event shall the diameter be less than four (4) inches for a single family residence. The slope of such four (4) inch pipe shall not be less than one-eighth (1/8) inch per foot.

*Indicates new rate or text

+Indicates change

SEP 1 1989

Public Service Commission

DATE OF ISSUE August 1, 1989
month day yearDATE EFFECTIVE September 1, 1989
month day year

ISSUED BY

name of officer

President, 109 So. Lake Drive, Hillsboro, MO

title

address

D. C. Mikusch

L. W. SEWER CORPORATION
Name of Issuing Corporation

For Lake Wauwanoka, Hillsboro
Community, Town or City
Jefferson County, Missouri

RULES AND REGULATIONS
APPLYING TO SEWER SERVICE

RECEIVED

JUN 25 1975

MISSOURI

Public Service Commission

Rule 5 DISCONTINUANCE OF SERVICE

(a) The Company reserves the right upon ~~the giving of not less~~ than thirty (30) days' written notice to the Customer by Certified Mail, Return Receipt Requested, to discontinue service for non-payment of sewer bills or for violation of or refusal to comply with these rules and regulations. Copy of written notice will be forwarded to Missouri Public Service Commission.

(b) In case of violation by the Customer of any of the provisions of Rule 9, or if a condition shall exist which, in the opinion of the Company, renders further service to the Customer dangerous to his health and safety or to the health and safety of other parties, or detrimental to the sewer system, the Company may discontinue service immediately upon the giving of verbal or written notice to the Customer.

(c) When the Company disconnects and plugs the Customer's sewer service at the point of connection to the Company's main, the total cost of disconnection and re-establishment of service shall be at the Customer's expense.

(d) Discontinuance of sewage service to a premise for any reason shall not prevent the Company from pursuing any lawful remedy by action at law or otherwise for the collection of moneys due from the Customer.

CANCELLED

SEP 1 1989

BY Pat R. S. #12
Public Service Commission
MISSOURI

FILED

AUG 1 1975

Public Service Commission

*Indicates new rate or text

+Indicates change

DATE OF ISSUE June 23, 1975
month day year

DATE EFFECTIVE August 1, 1975
month day year

ISSUED BY Robt. D. Clark
name of officer

President
title

Lake Wauwanoka
address
Route 3
Hillsboro, Missouri

L. W. SEWER CORPORATION

For Lake Wauwanoka, Hillsboro

Name of Issuing Corporation

Community, Town or City
Jefferson County, Missouri

RECEIVED

RULES AND REGULATIONS
APPLYING TO SEWER SERVICE

JUL 31 1989

MISSOURI

Rule 8 INSIDE PIPING AND CUSTOMER SEWER SERVICES (Continued) Public Service Commission

(f) Whenever possible the Customer's sewer service shall be brought to the building at an elevation below the basement floor. No building sewer shall be laid parallel to or within three (3) feet of any bearing wall. The depth shall be sufficient to afford protection from frost. The Customer's sewer service shall be laid at a uniform grade and in straight alignment insofar as possible. Changes in direction shall be made only with properly curved pipes and fittings.

(g) In all buildings in which any building drain is too low to permit gravity flow to the Company's main, sanitary sewage carried by such drains shall be lifted by approved artificial means and discharged to the building sewer. No water operated sewage ejector shall be used.

(h) All excavations required for the installation of a Customer's sewer service shall be open trench work unless otherwise approved by the Company; Pipe laying and backfill shall be performed in accordance with ASTM specifications except that no backfill shall be placed until the work has been inspected by the Company; Only those jointing materials and methods which are approved by the Company may be used.

(i) The connection of the Customer's sewer service into the main shall be made at the "Y" branch, if such branch is available at a suitable location. If the Company's collecting sewer is twelve (12) inches in diameter or less and no properly located "Y" branch in the Company's collecting sewer at the location specified by the Company, a "Y" branch must be installed. Where the Company's main is greater than twelve (12) inches in diameter, and no properly located "Y" branch is available, a neat hole may be cut in the Company's main and a saddle installed to receive the Customer's service sewer. The invert of the Customer's sewer service at the point of connection shall be at the same or at a higher elevation than the invert of the Company's main. A smooth neat joint shall be made, and the connection made secure and water tight by encasement in concrete.

FILED

SEP 1 1989

*Indicates new rate or text

+Indicates change

Public Service Commission

DATE OF ISSUE August 1, 1989
month day yearDATE EFFECTIVE September 1, 1989
month day year

ISSUED BY

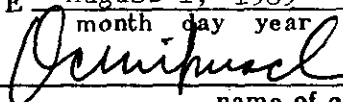

name of officer

President, 109 So. Lake Drive, Hillsboro, MO

title

address

D. C. Mikusch

Cancelled

March 9, 2007

Missouri Public

Service Commission

SA-2007-0105

63050

L. W. SEWER CORPORATION
Name of Issuing CorporationFor Lake Wauwanoka, Hillsboro
Community, Town or City
Jefferson County, MissouriRULES AND REGULATIONS
APPLYING TO SEWER SERVICE

RECEIVED

JUN 25 1975

Rule 6 LIMITATIONS UPON OBLIGATIONS OF COMPANYMISSOURI
Public Service Commission

(a) The Company shall not be responsible in damages for any failure to remove waste water from the premises or for interruption if such failure or interruption is without willful default or negligence on the part of the Company.

(b) The Company shall not be liable for damages resulting to Customer or to third persons, unless due to contributory negligence on the part of the Company, and without any contributory negligence on the part of the Customer or such third party.

(c) The Company shall not be liable for damages because of any interruption of sewer service or for damages caused by defective piping and appliances on the Customer's premises.

(d) The Company reserves the right to discontinue sewer service in its mains at any time, without notice, for making repairs, extensions or alterations to the distribution system or station equipment.

(e) Employees or agents of the Company are expressly forbidden to demand or accept any compensation for any service rendered to its Customers except as covered in the Company's rules and regulations.

(f) No employee or agent of the Company shall have the right or authority to bind it by any promise, agreement or representation contrary to the letter or intent of these rules and regulations. Nor shall any employee or agent of the Company have authority to bind it by any promise, agreement, or representation not provided for in these rules, unless such authority is in writing and signed by the General Manager of the Company.

CANCELLED

SEP 1 1989

BY 14 R.S. #13Public Service Commission
MISSOURI

FILED

AUG 1 1975

Public Service Commission

*Indicates new rate or text

+Indicates change

DATE OF ISSUE June 23, 1975
month day yearDATE EFFECTIVE August 1, 1975
month day yearISSUED BY Robt. D. Clark
name of officerPresident
titleLake Wauwanoka
address
Route 3
Hillsboro, Missouri

FORM NO. 13

P.S.C.MO. No. 1 2nd~~(Original)~~ SHEET No. 14~~(Revised)~~Cancelling P.S.C.MO. No. 1 1st~~(Original)~~~~(Revised)~~SHEET No. 14

L. W. SEWER CORPORATION

Name of Issuing Corporation

For Lake Wauwanoka, Hillsboro
Community, Town or City
Jefferson County, Missouri

RECEIVED

RULES AND REGULATIONS
APPLYING TO SEWER SERVICE

JUL 31 1989

MISSOURI,

Rule 8 INSIDE PIPING AND CUSTOMER SEWER SERVICES (Continued) Public Service Commission

(j) It is understood that all facilities above described are to be constructed and maintained by the applicant subject to the approval of any authorized inspector, and in accordance with the Rules and information of the Company in force at that time.

FILED

SEP 1 1989

*Indicates new rate or text
+Indicates change

Public Service Commission

DATE OF ISSUE August 1, 1989DATE EFFECTIVE September 1, 1989

ISSUED BY

D. C. Mikusch
name of officer
D. C. Mikusch

President, 109 So. Lake Drive, Hillsboro, MO
title address 63050

L. W. SEWER CORPORATION
Name of Issuing CorporationFor Lake Wauwanoka, Hillsboro
Community, Town or City
Jefferson County, MissouriRULES AND REGULATIONS
APPLYING TO SEWER SERVICE

RECEIVED

MAR 25 1976

MISSOURI

Public Service Commission

Rule 7 SERVICE CONNECTION AND TAPS

(a) The Company will locate the point to which will be made and Customer will furnish a "Y" branch at the collecting sewer which shall be located in the public street or right-of-way. All taps are to be made by licensed plumbers, subject to inspection and approval by the Company. Application, accompanied by a \$600.00 connection and inspection fee, must be filed in writing 24 hours in advance stating the street, the house number, name of applicant, name of property owner, and time at which tap is to be made. The Company will not be required to supply sewer service until each such tap has been inspected and approved by it. Customer will be liable for any damages to Company sewer mains resulting from such work.

(b) The building sewer service connection from the collecting sewer to the Customer's building shall be installed by and at the expense of the Customer. A service sewer connection shall not be used to supply more than a single property without the consent of the Company.

(c) Customer service sewer will not be extended along public streets or roadways or through property of others in connecting with collecting sewers, unless approved by the Company.

(d) Any change in the location of an existing service connection requested by the Customer shall be made at his expense.

CANCELLED

SEP 1 1989

BY 2nd RS #14Public Service Commission
MISSOURI

FILED

MAY 1 1976

*Indicates new rate or text

+Indicates change

Public Service Commission

DATE OF ISSUE March 25, 1976
month day yearDATE EFFECTIVE May 1, 1976
month day yearISSUED BY Robt. D. Clark
name of officerPresident Lake Wauwanoka
title address
Route 3, Hillsboro, Missouri

L. W. SEWER CORPORATION

Name of Issuing Corporation

For Lake Wauwanoka, Hillsboro

Community, Town or City

Jefferson County, Missouri

RULES AND REGULATIONS

APPLYING TO SEWER SERVICE

RECEIVED

JUN 25 1975

MISSOURI

Public Service Commission

Rule 7 SERVICE CONNECTION AND TAPS

(a) The Company will locate the point to which service connection will be made and Customer will furnish a "Y" branch at the collecting sewer which shall be located in the public street or right-of-way. All taps are to be made by licensed plumbers, subject to inspection and approval by the Company. Application, accompanied by a \$250.00 connection and inspection fee, must be filed in writing 24 hours in advance stating the street, the house number, name of applicant, name of property owner, and time at which tap is to be made. The Company will not be required to supply sewer service until each such tap has been inspected and approved by it. Customer will be liable for any damages to Company sewer mains resulting from such work.

(b) The building sewer service connection from the collecting sewer to the Customer's building shall be installed by and at the expense of the Customer. A service sewer connection shall not be used to supply more than a single property without the consent of the Company.

(c) Customer service sewer will not be extended along public streets or roadways or through property of others in connecting with collecting sewers, unless approved by the Company.

(d) Any change in the location of an existing service connection requested by the Customer shall be made at his expense.

CANCELLED

MAY 1 1976

BY Let RS. 14
PUBLIC SERVICE COMMISSION
OF MISSOURI

FILED

AUG 1 1975

Public Service Commission

*Indicates new rate or text

+Indicates change

DATE OF ISSUE June 23, 1975
month day yearDATE EFFECTIVE August 1, 1975
month day yearISSUED BY Robt. D. Clark
name of officerPresident
titleLake Wauwanoka
address
Route 3
Hillsboro, Missouri

FORM NO. 13 P.S.C.MO. No. 1 1st { ~~Original~~ } SHEET No. 15
{ Revised }
Cancelling P.S.C.MO. No. 1 { ~~Original~~ } SHEET No. 15
{ Revised }
L. W. SEWER CORPORATION For Lake Wauwanoka, Hillsboro
Name of Issuing Corporation Community, Town or City
Jefferson County, Missouri

RULES AND REGULATIONS APPLYING TO SEWER SERVICE		JUL 31 1989
Rule 9 <u>IMPROPER WASTE OR EXCESSIVE USE</u>		MISSOURI Public Service Commission
<p>(a) The following requirements for the use of the sanitary sewer system shall be observed. Violation of these requirements will result in the discontinuance of service to the Customer.</p> <p>(b) No person shall discharge or cause to be discharged, any storm water, surface water, ground water, roof runoff, sub-surface drainage, cooling water or unpolluted industrial process waters to any Company's mains.</p> <p>(c) No person shall discharge or cause to be discharged any abnormal or unusual waters or wastes into the Company's mains.</p> <p>(d) Grease, oil, and sand interceptors shall be provided and installed by the Customer when, in the opinion of the Company, they are necessary for the proper handling of liquid wastes containing grease in excessive amount, or any flammable wastes, sand, and other harmful ingredients; except that such interceptors shall not be required for private living quarters or dwelling units. All interceptors shall be of a type and capacity approved by the Company and shall be located as to be readily and easily accessible for cleaning and inspection.</p> <p>(e) Where installed, all grease, oil and sand interceptors shall be maintained by the Customer, at his expense, in continuously efficient operation at all times.</p> <p>(f) Where preliminary treatment facilities are provided for any waters or wastes, they shall be maintained continuously in satisfactory and effective operation, by the Customer, at his expense.</p>		
*Indicates new rate or text +Indicates change		FILED SEP 1 1989 Public Service Commission

DATE OF ISSUE August 1, 1989 DATE EFFECTIVE September 1, 1989
month day year month day year
ISSUED BY D. C. Mikusch President, 109 So. Lake Drive, Hillsboro, MO
name of officer title address
D. C. Mikusch

L. W. SEWER CORPORATION
Name of Issuing Corporation

For Lake Wauwanoka, Hillsboro
Community, Town or City
Jefferson County, Missouri

RULES AND REGULATIONS
APPLYING TO SEWER SERVICE

RECEIVED

JUN 25 1975

Rule 8 INSIDE PIPING AND CUSTOMER SEWER SERVICES MISSOURI

Public Service Commission

(a) The Customer will provide the Customer's sewer service at his expense and risk. As a condition of service, inside piping and building sewer construction must meet all of the requirements of the latest editions of the Plumbing Rules and Regulations of the Administrative Building Council, Volume III, at the time of connection to the system. The Company shall deny service where footing drains, downspouts, or other sources of water are permitted to enter the system through either the inside piping or through the building sewer.

(b) A separate and independent Customer sewer service shall be required for every building; except where one building stands at the rear of another on an interior lot and no private sewer is available or can be constructed to the rear building through an adjoining alley, court, yard, or driveway, the Customer's sewer service from the front building may be extended to the rear building and the whole considered as one Customer's sewer service.

(c) Old Customer sewer services may be used in connection with new buildings only when they are found on examination and test to meet all requirements of the Company.

(d) The Customer's sewer service shall be cast iron soil pipe, ASTM specification or equal; vitrified clay sewer pipe, ASTM specification or equal; or other suitable material approved by the Company. Joints shall be tight and waterproof. Any part of the Customer's sewer service that is located within ten feet of a water service pipe shall be constructed of cast iron soil pipe. Cast iron pipes may be required where the Customer's sewer service is exposed to damage by tree roots. If installed in filled or unstable ground, the Customer's sewer service shall be of cast iron soil pipe, except that non-metallic material may be accepted if laid on a suitable concrete bed or cradle as approved by the said Company.

(e) The size and slope of the Customer's sewer service shall be subject to the approval of the Company, but in no event shall the diameter be less than six (6) inches for a single family residence. The slope of such six (6) inch pipe shall not be less than one-eighth (1/8) inch per foot.

*Indicates new rate or text

+Indicates change

CANCELLED

SEP 1 1989

AUG 1 1975

Public Service Commission

DATE OF ISSUE June 23, 1975 DATE EFFECTIVE August 1, 1975
month day year month day year

ISSUED BY Robt. D. Clark President Lake Wauwanoka
name of officer title address
Route 3
Hillsboro, Missouri

L. W. SEWER CORPORATION

Name of Issuing Corporation

For Lake Wauwanoka, Hillsboro

Community, Town or City

Jefferson County, Missouri

RECEIVED

RULES AND REGULATIONS
APPLYING TO SEWER SERVICE

JUL 31 1989

MISSOURI

Public Service Commission

Rule 9 IMPROPER WASTE OR EXCESSIVE USE (continued)

(g) When required by the Company, the Customer sewer service carrying industrial wastes shall include a suitable control manhole in the Customer sewer service to facilitate observation, sampling, and measurement of the wastes. Such manhole, when required, shall be accessibly and safely located, and shall be constructed in accordance with plans approved by the Company. The manhole shall be installed by the Customer at his expense, and shall be maintained by him so as to be safe and accessible at all times.

(h) All measurements, test, and analyses of the characteristics of waters and wastes to which reference is made in Rule 9, Paragraph (c) shall be determined in accordance with "Standard Methods of Analyses for Water, Sewage and Industrial Wastes" as published by the American Public Health Association and shall be determined at the control manhole provided for in Rule 9, Paragraph (g), or upon suitable samples taken at said control manhole. In the event that no special manhole has been required, the control manhole shall be considered to be the nearest downstream manhole in the Company main sewer to the point at which the Customer service sewer is connected.

FILED

SEP 1 1989

Public Service Commission

*Indicates new rate or text.

+Indicates change

DATE OF ISSUE August 1, 1989
month day yearDATE EFFECTIVE September 1, 1989
month day year

ISSUED BY

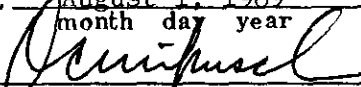
name of officer

President, 109 So. Lake Drive, Hillsboro, MO

title

address

D. C. Mikusch

Cancelling P.S.C.MO. No. _____

{ Original } SHEET No. _____
{ Revised }

L. W. SEWER CORPORATION

For Lake Wauwanoka, Hillsboro

Name of Issuing Corporation

Community, Town or City

Jefferson County, Missouri

RULES AND REGULATIONS
APPLYING TO SEWER SERVICE

RECEIVED

JUN 25 1975

Rule 8 INSIDE PIPING AND CUSTOMER SEWER SERVICES (Continued)

Public Service Commission

(f) Whenever possible the Customer's sewer service shall be brought to the building at an elevation below the basement floor. No building sewer shall be laid parallel to or within three (3) feet of any bearing wall. The depth shall be sufficient to afford protection from frost. The Customer's sewer service shall be laid at a uniform grade and in straight alignment insofar as possible. Changes in direction shall be made only with properly curved pipes and fittings.

(g) In all buildings in which any building drain is too low to permit gravity flow to the Company's main, sanitary sewage carried by such drains shall be lifted by approved artificial means and discharged to the building sewer. No water operated sewage ejector shall be used.

(h) All excavations required for the installation of a Customer's sewer service shall be open trench work unless otherwise approved by the Company. Pipe laying and backfill shall be performed in accordance with ASTM specifications except that no backfill shall be placed until the work has been inspected by the Company. Only those jointing materials and methods which are approved by the Company may be used.

(i) The connection of the Customer's sewer service into the main shall be made at the "Y" branch, if such branch is available at a suitable location. If the Company's collecting sewer is twelve (12) inches in diameter or less and no properly located "Y" branch in the Company's collecting sewer at the location specified by the Company, a "Y" branch must be installed. Where the Company's main is greater than twelve (12) inches in diameter, and no properly located "Y" branch is available, a neat hole may be cut in the Company's main and a saddle installed to receive the Customer's service sewer. The invert of the Customer's sewer service at the point of connection shall be at the same or at a higher elevation than the invert of the Company's main. A smooth neat joint shall be made, and the connection made secure and water tight by encasement in concrete.

CANCELLED

SEP 1 1989

BY *et R.S. #16*

AUG 1 1975

Public Service Commission

*Indicates new rate or text

+Indicates change

DATE OF ISSUE June 23, 1975

month day year

DATE EFFECTIVE August 1, 1975

month day year

ISSUED BY Robt. D. Clark, President

name of officer

Lake Wauwanoka, Route 3, Hillsboro, Mo.

title

address

L. W. SEWER CORPORATION

Name of Issuing Corporation

For Lake Wauwanoka, Hillsboro
Community, Town or City
Jefferson County, MissouriRULES AND REGULATIONS
APPLYING TO SEWER SERVICE

RECEIVED

JUL 31 1989

Rule 10 CHARGESMISSOURI
Public Service Commission

Service Charges:

1. Service Connection and Inspection Charge \$ 600.00
2. In the event service to any Customer has been discontinued for any reason set forth in Rule 5, and a reconnect charge is provided for, such charge shall be based on cost thereby incurred by the Company.
3. Monthly Service Charge 9.25
4. Company personnel will not work upon sewer piping or facilities not owned by the Company.
5. The service charges cited in the various sections of this Rule are "Net" and do not include any applicable municipal, state, or federal taxes computed on the Company's collections of such charges. Any such taxes will be added in collection or billing service charges, as appropriate.

FILED

SEP 1 1989

*Indicates new rate or text
+Indicates change

Public Service Commission

DATE OF ISSUE August 1, 1989
month day yearDATE EFFECTIVE September 1, 1989
month day year

ISSUED BY

D. C. Mikusch
name of officerPresident, 109 So. Lake Drive, Hillsboro, MO
title address

FORM NO. 13

P.S.C.MO. No.

1

{ Original } SHEET No. 17

{ Revised }

Cancelling P.S.C.MO. No.

{ Original }

SHEET No.

{ Revised }

L. W. SEWER CORPORATION
Name of Issuing Corporation

For

Lake Wauwanoka, Hillsboro
Community, Town or City

Jefferson County, Missouri

181210121171210

RULES AND REGULATIONS

APPLYING TO SEWER SERVICE

JUN 25 1975

Rule 8

INSIDE PIPING AND CUSTOMER SEWER SERVICES

MISSOURI

Service Commission

(j) It is understood that all facilities above described are to be constructed and maintained by the applicant subject to the approval of any authorized inspector, and in accordance with the Rules and information of the Company in force at that time.

CANCELLED

SEP 1 1989

BY PLRS #17Public Service Commission
MISSOURI

FILED

AUG 1 1975

Public Service Commission

*Indicates new rate or text

+Indicates change

DATE OF ISSUE June 23, 1975
month day yearDATE EFFECTIVE August 1, 1975
month day yearISSUED BY Robt. D. Clark
name of officerPresident
titleLake Wauwanoka
address
Route 3
Hillsboro, Missouri

FORM NO. 13 P.S.C.MO. No. 1 1st ~~Original~~ SHEET No. 18
~~Revised~~
Cancelling P.S.C.MO. No. 1 ~~Original~~ SHEET No. 18
~~Revised~~

L. W. SEWER CORPORATION

Name of Issuing Corporation

For Lake Wauwanoka, Hillsboro
Community, Town or City

Jefferson County, Missouri

RECEIVED

RULES AND REGULATIONS GOVERNING
RENDERING OF SEWER SERVICE

JUL 31 1989

Rule 11 EXTENSION OF COLLECTING SEWERS

MISSOURI
Public Service Commission

A. This rule shall govern the extension of collecting sewers by the Company in areas where there are no collecting sewers in the streets and/or roadways. The Company will extend its collecting sewers along streets or roads within its certified area to serve new customers under the following terms and conditions:

1. Upon receipt of written application for service in compliance with Rule 3, the Company will provide the Applicant(s) an itemized estimate of the cost of the proposed extension. Said estimate shall include the cost of all labor and materials required, including manholes, cleanouts, lift stations, reconstruction of existing sewers (if necessary), and the direct costs associated with supervision, engineering, permits and bookkeeping. Applicable income tax cost will be added to this estimate calculated at the maximum rate.
2. Applicant(s) shall enter into a contract with the Company for the installation of said extension and shall tender to the Company a contribution in-aid-of construction equal to the amount determined in A.1, plus the appropriate customer connection fee(s).

FILED

SEP 1 1989

*Indicates new rate or text
+Indicates change

Public Service Commission

DATE OF ISSUE August 1, 1989 DATE EFFECTIVE September 1, 1989
month day year month day year

ISSUED BY D. C. Mikusch

President, 109 So. Lake Drive, Hillsboro, MO
title address

D. C. Mikusch

SA-2007-0105

63050

L. W. SEWER CORPORATION
Name of Issuing Corporation

For Lake Wauwanoka, Hillsboro
Community, Town or City
Jefferson County, Missouri

RULES AND REGULATIONS
APPLYING TO SEWER SERVICE

RECEIVED

JUN 25 1975

MISSOURI

Public Service Commission

Rule 9 IMPROPER WASTE OR EXCESSIVE USE

(a) The following requirements for the use of the sewer system shall be observed. Violation of these requirements will result in the discontinuance of service to the Customer.

(b) No person shall discharge or cause to be discharged, any storm water, surface water, ground water, roof runoff, sub-surface drainage, cooling water or unpolluted industrial process waters to any Company's mains.

(c) No person shall discharge or cause to be discharged any abnormal or unusual waters or wastes into the Company's mains.

(d) Grease, oil, and sand interceptors shall be provided and installed by the Customer when, in the opinion of the Company, they are necessary for the proper handling of liquid wastes containing grease in excessive amount, or any flammable wastes, sand, and other harmful ingredients; except that such interceptors shall not be required for private living quarters or dwelling units. All interceptors shall be of a type and capacity approved by the Company and shall be located as to be readily and easily accessible for cleaning and inspection.

(e) Where installed, all grease, oil and sand interceptors shall be maintained by the Customer, at his expense, in continuously efficient operation at all times.

(f) Where preliminary treatment facilities are provided for any waters or wastes, they shall be maintained continuously in satisfactory and effective operation, by the Customer, at his expense.

CANCELLED

SEP 1 1989

BY 1st R.S.#18

Public Service Commission
MISSOURI

*Indicates new rate or text
+Indicates change

FILED

AUG 1 1975

Public Service Commission

DATE OF ISSUE June 23, 1975
month day year

DATE EFFECTIVE August 1, 1975
month day year

ISSUED BY Robt. D. Clark
name of officer

President
title

Lake Wauwanoka
address

Route 3
Hillsboro, Missouri

L. W. SEWER CORPORATION
Name of Issuing CorporationFor Lake Wauwanoka, Hillsboro
Community, Town or City
Jefferson County, Missouri

RECEIVED

RULES AND REGULATIONS GOVERNING

RENDERING OF SEWER SERVICE

JUL 31 1989

MISSOURI

Public Service Commission

Rule 11 EXTENSION OF COLLECTING SEWERS (continued)

3. If, as a result of reasonably unforeseen circumstances, the actual cost of the extension exceeds the estimated cost of the extension, the Applicant(s) shall pay the added cost.
4. The cost to an Applicant or Applicants connecting to a sewer that was contributed by other Applicants shall be as follows:
 - (a) For single-family residential Applicants that are applying for service in a platted subdivision, the Company shall divide the actual cost of the extension (including income taxes) by the number of lots abutting said extension to determine the per lot extension cost. When counting lots, corner lots which abut existing mains shall be excluded.

FILED

SEP 1 1989

*Indicates new rate or text
 †Indicates change

Public Service Commission

DATE OF ISSUE August 1, 1989
month day yearDATE EFFECTIVE September 1, 1989
month day yearISSUED BY D. C. Mikusch

name of officer

D. C. Mikusch

President, 109 So. Lake Drive, Hillsboro,
title address

L. W. SEWER CORPORATION
Name of Issuing Corporation

For Lake Wauwanoka, Hillsboro
Community, Town or City
Jefferson County, Missouri

RULES AND REGULATIONS
APPLYING TO SEWER SERVICE

JUN 25 1975

Rule 9 IMPROPER WASTE OR EXCESSIVE USE (continued)

MISSOURI

Public Service Commission

(g) When required by the Company, the Customer ~~sewer service~~ carrying industrial wastes shall include a suitable control manhole in the Customer sewer service to facilitate observation, sampling, and measurement of the wastes. Such manhole, when required, shall be accessibly and safely located, and shall be constructed in accordance with plans approved by the Company. The manhole shall be installed by the Customer at his expense, and shall be maintained by him so as to be safe and accessible at all times.

(h) All measurements, test, and analyses of the characteristics of waters and wastes to which reference is made in Rule 9, Paragraph (c) shall be determined in accordance with "Standard Methods of Analyses for Water, Sewage and Industrial Wastes" as published by the American Public Health Association and shall be determined at the control manhole provided for in Rule 9, Paragraph (g), or upon suitable samples taken at said control manhole. In the event that no special manhole has been required, the control manhole shall be considered to be the nearest downstream manhole in the Company main sewer to the point at which the Customer service sewer is connected.

CANCELLED

SEP 1 1989

BY 124 R.S. #19

Public Service Commission
MISSOURI

FILED

AUG 1 1975

Public Service Commission

*Indicates new rate or text

+Indicates change

DATE OF ISSUE June 23, 1975
month day year

DATE EFFECTIVE August 1, 1975
month day year

ISSUED BY Robt. D. Clark
name of officer

President
title

Lake Wauwanoka
address
Route 3
Hillsboro, Missouri

L. W. SEWER CORPORATION

Name of Issuing Corporation

For Lake Wauwanoka, Hillsboro

Community, Town or City

Jefferson County, Missouri

RECEIVED

RULES AND REGULATIONS GOVERNING

RENDERING OF SEWER SERVICE

JUL 31 1989

MISSOURI

Rule 11 EXTENSION OF COLLECTING SEWERS (continued) Public Service Commissioner

5. Refunds of contributions shall be made to Applicant(s) as follows:

- (a) Should the actual cost of extension be less than the estimated cost, the Company shall refund the difference as soon as the actual cost has been ascertained.
- (b) After the Company has closed its books for the year in which a contribution was made, it will determine its actual income tax cost associated with each extension and refund any excess income tax costs collected from each Applicant.
- (c) During the first ten years after the extension is completed, the Company will refund to the Applicants who paid for the extension monies collected from Applicants in accordance with Rule 11A 4 above.
- (d) The sum of all refunds to any Applicant shall not exceed the total contribution, adjusted for taxes associated with the extension, which the Applicant has paid.
- (e) Each refund shall be distributed to initial Applicant(s) based upon the percentage of the actual extension cost contributed by each Applicant.

FILED

SEP 1 1989

*Indicates new rate or text

+Indicates change

Public Service Commissioner

DATE OF ISSUE August 1, 1989DATE EFFECTIVE September 1, 1989

Cancelled

March 9, 2007

Missouri Public

Service Commission

ISSUED BY D. C. Mikusch

name of officer

D. C. Mikusch

President, 109 So. Lake Drive, Hillsboro, M

title

address

SA-2007-0105

63056

FORM NO. 13

P.S.C.MO. No.

2nd

{ Original }

SHEET No. 20

{ Revised }

Cancelling P.S.C.MO. No.

1st

{ Original }

SHEET No. 20

{ Revised }

L. W. SEWER CORPORATION

For Lake Wauwanoka, Hillsboro

Name of Issuing Corporation

Community, Town or City

Jefferson County, Missouri

RULES AND REGULATIONS
APPLYING TO SEWER SERVICE

RECEIVED

APR 11 1978

MISSOURI
Public Service Commission

Rule 10 CHARGES

Service Charges:

1. Service Connection and Inspection Charge ~~\$600.00~~

2. In the event service to any Customer has been discontinued for any reason set forth in Rule 5, and a reconnect charge is provided for, such charge shall be based on cost thereby incurred by the Company.

3. Monthly Service Charge

\$ 9.25 *

4. Company personnel will not work upon sewer piping or facilities not owned by the Company.

5. The service charges cited in the various sections of this Rule are "Net" and do not include any applicable municipal, state, or federal taxes computed on the Company's collections of such charges. Any such taxes will be added in collection or billing service charges, as appropriate.

CANCELLED

SEP 1 1989
BY 322 R.S.#20
Public Service Commission
MISSOURI

FILED

JUN 1 - 1978

78-144

Public Service Commission

JUN 1 - 1978

*Indicates new rate or text

+Indicates change

DATE OF ISSUE April 8, 1978
month day year

DATE EFFECTIVE ~~April 8, 1978~~
month day year

ISSUED BY Glenn A. Pauly, President
name of officer

Lake Wauwanoka, Route 3
title address
Hillsboro, Missouri

L. W. SEWER CORPORATION
Name of Issuing Corporation

For Lake Wauwanoka, Hillsboro
Community, Town or City
Jefferson County, Missouri

RULES AND REGULATIONS
APPLYING TO SEWER SERVICE

RECEIVED

MAR 25 1976

MISSOURI
Public Service Commission

Rule 10 CHARGES

Service Charges:

1. New Service Connection and Inspection Charge ~~\$ 600.00~~ *
2. In the event service to any Customer has been discontinued for any reason set forth in Rule 5, and a reconnect charge is provided for, such charge shall be based on cost thereby incurred by the Company.
3. Monthly Service Charge \$ 8.00 *
4. Company personnel will not work upon sewer piping or facilities not owned by the Company.
5. The service charges cited in the various sections of this Rule are "Net" and do not include any applicable municipal, state, or federal taxes computed on the Company's collections of such charges. Any such taxes will be added in collection or billing service charges, as appropriate.

CANCELLED

JUN 1 - 1978

BY And RS 26
PUBLIC SERVICE COMMISSION
OF MISSOURI

FILED

MAY 1 1976

Public Service Commission

*Indicates new rate or text
+Indicates change

DATE OF ISSUE March 25, 1976 DATE EFFECTIVE May 1, 1976
month day year month day year
ISSUED BY Robt. D. Clark President Lake Wauwanoka
name of officer title address
Route 3, Hillsboro, Missouri

L. W. SEWER CORPORATION
Name of Issuing Corporation

For _____

Lake Wauwanoka, Hillsboro
Community, Town or City
Jefferson County, Missouri

RULES AND REGULATIONS
APPLYING TO SEWER SERVICE

JUN 25 1975

MISSOURI
Public Service Commission

Rule 10 CHARGES

Service Charges:

1. New Service Connection and Inspection Charge \$250.00

2. In the event service to any Customer has been discontinued for any reason set forth in Rule 5, and a reconnect charge is provided for, such charge shall be based on cost thereby incurred by the Company.

3. Monthly Service Charge \$ 6.50

4. Inspection of "In Use" service sewer connections and/or appliance or swimming pool of Customer used in connection with sewer service includes inspection of area to determine entry of surface or ground water including roof runoff or cooling water \$ 15.00

5. Company personnel will not work upon sewer piping or facilities not owned by the Company.

6. The service charges cited in the various sections of this Rule are "Net" and do not include any applicable municipal, state, or federal taxes computed on the Company's collections of such charges. Any such taxes will be added in collection or billing service charges, as appropriate.

CANCELLED

MAY 1 1976

BY 1st Rs. 20
PUBLIC SERVICE COMMISSION
OF MISSOURI

FILED

AUG 1 1975

Public Service Commission

*Indicates new rate or text

+Indicates change

DATE OF ISSUE June 23, 1975
month day year

DATE EFFECTIVE August 1, 1975
month day year

ISSUED BY Robt. D. Clark
name of officer

President
title

Lake Wauwanoka
address
Route 3
Hillsboro, Missouri

Cancelling P.S.C.MO. No. _____

{ Original } SHEET No. _____
{ Revised }L. W. SEWER CORPORATION
Name of Issuing CorporationFor Lake Wauwanoka, Hillsboro
Community, Town or City
Jefferson County, Missouri

RECEIVED

RULES AND REGULATIONS GOVERNING
RENDERING OF SEWER SERVICE

JUL 31 1989

MISSOURI

Rule 11 EXTENSION OF COLLECTING SEWERS (continued) Public Service Commission

6. Extensions made under this rule shall be and remain the property of the Company in consideration of its perpetual upkeep and maintenance.
7. The Company reserves the right to connect future extensions to this collecting sewer and the attaching of customers to such further extensions shall not entitle Applicant(s) contracting for the original extension to additional refund.
8. The pipe used in making extensions under this rule shall be of a type and size which will be reasonably adequate to supply the area to be served. Such determination as to size and type of pipe shall be left solely to the judgment of the Company. If the Company desires a pipe size or lift station larger than reasonably required to provide service to the lots abutting said extension, the additional cost due to larger size shall be borne by the Company.

FILED

SEP 1 1989

Public Service Commission

*Indicates new rate or text
+Indicates changeDATE OF ISSUE August 1, 1989
month day yearDATE EFFECTIVE September 1, 1989
month day year

ISSUED BY _____

B. C. Mikusch

name of officer

President, 100 So. Lake Drive, Hillsboro,
title address