

Name of the Utility: Liberty Utilities (Missouri Water) LLC d/b/a Liberty Utilities
Service Area: Noel, Missouri

**Rules Governing Rendering of
Water Service**

**Liberty Utilities (Missouri Water) LLC
d/b/a
Liberty Utilities**

**Schedule of Rates, Rules and Regulations
And Conditions of Service
Governing the Provision and Taking of Water Service**

* Indicates new rate or text
+ Indicates change

FILED
Missouri Public
Service Commission
WN-2014-0035; YW-2014-0079

DATE OF ISSUE: August 15, 2013

DATE EFFECTIVE: September 14, 2013

ISSUED BY:

Greg Sorensen, Vice President of Operations, 12725 W. Indian School Road, D-101. Avondale,
AZ 85392

Name of the Utility: Algonquin Water Resources of Missouri LLC d/b/a Liberty Utilities
Service Area: Noel, Missouri

**Rules Governing Rendering of
Water Service**

Algonquin Water Resources of Missouri, LLC
d/b/a
Liberty Utilities

**Schedule of Rates, Rules and Regulations
And Conditions of Service
Governing the Provision and Taking of Water Service**

* Indicates new rate or text
+ Indicates change

FILED
Missouri Public
Service Commission
WN-2012-0403; YW-2012-0778

CANCELLED
September 14, 2013
Missouri Public
Service Commission
WN-2014-0035; YW-2014-0079

DATE OF ISSUE: June 1, 2012

DATE EFFECTIVE: July 1, 2012

ISSUED BY: Greg Sorensen, Vice President of Operations, 12725 W. Indian School Road, D-101. Avondale, AZ 85392

Name of Utility: Algonquin Water Resources of Missouri LLC d/b/a Liberty Water
Service Area: Noel, Missouri

Rules Governing Rendering of Water Service	
<p>Algonquin Water Resources of Missouri, LLC d/b/a Liberty Water</p> <p>Schedule of Rates, Rules and Regulations And Conditions of Service Governing the Provision and Taking of Water Service</p>	
<p>* Indicates new rate or text + Indicates change</p>	

DATE OF ISSUE September 22, 2011 DATE EFFECTIVE October 22, 2011
Month Day Year Month Day Year

ISSUED BY Greg Sorensen, Vice President of Service Delivery, 12725 W. Indian School Rd D-101,
Avondale, AZ 85392

CANCELLED name of officer title address
July 1, 2012
Missouri Public
Service Commission

Filed
Missouri Public
Service Commission
WO-2011-0328; YW-2012-0124

Name of the Utility: Liberty Utilities (Missouri Water) LLC d/b/a Liberty Utilities
Service Area: Noel, Missouri

**Rules Governing Rendering of
Water Service**

Liberty Utilities (Missouri Water) LLC d/b/a Liberty Utilities hereby adopts, ratifies, and makes its own, in every respect, all tariffs filed with the Public Service Commission, State of Missouri, under the name Algonquin Water Resources of Missouri, LLC d/b/a Liberty Utilities, Algonquin Water Resources of Missouri, LLC d/b/a Liberty Water or Noel Water Co., Inc., currently on file with and approved by the Commission, representing the rates, terms and conditions of the regulated water service previously provided by these companies or under these previous names.

- * Indicates new rate or text
- + Indicates change

FILED
Missouri Public
Service Commission
WN-2014-0035; YW-2014-0079

DATE OF ISSUE: August 15, 2013

DATE EFFECTIVE: September 14, 2013

ISSUED BY: Greg Sorensen, Vice President of Operations, 12725 W. Indian School Road, D-101.
Avondale, AZ 85392

Name of the Utility: Algonquin Water Resources of Missouri LLC d/b/a Liberty Utilities
Service Area: Noel, Missouri

**Rules Governing Rendering of
Water Service**

Algonquin Water Resources of Missouri, LLC d/b/a Liberty Utilities hereby adopts, ratifies, and makes its own, in every respect, all tariffs filed with the Public Service Commission, State of Missouri, under the name Algonquin Water Resources of Missouri, LLC d/b/a Liberty Water or Noel Water Co., Inc., currently on file with and approved by the Commission, representing the rates, terms and conditions of the regulated water service previously provided by these companies or under these previous names.

- * Indicates new rate or text
- + Indicates change

FILED
Missouri Public
Service Commission
WN-2012-0403; YW-2012-0778

DATE OF ISSUE: June 1, 2012

DATE EFFECTIVE: July 1, 2012

ISSUED BY: Greg Sorensen, Vice President of Operations, 12725 W. Indian School Road, D-101.
Avondale, AZ 85392

CANCELLED
September 14, 2013
Missouri Public
Service Commission
WN-2014-0035; YW-2014-0079

Name of Utility: Algonquin Water Resources of Missouri LLC d/b/a Liberty Water
Service Area: Noel, Missouri

Rules Governing Rendering of
Water Service

Algonquin Water Resources of Missouri, LLC d/b/a Liberty Water hereby adopts, ratifies, and makes it own, in every respect, all tariffs filed with the Public Service Commission, State of Missouri, under the name Noel Water Co., Inc., currently on file with and approved by the Commission, representing the rates, terms and conditions of the regulated water service previously provided by Noel Water Co., Inc.

* Indicates new rate or text
+ Indicates change

DATE OF ISSUE September 22, 2011 DATE EFFECTIVE October 22, 2011
Month Day Year Month Day Year

ISSUED BY Greg Sorensen, Vice President of Service Delivery, 12725 W. Indian School Rd D-101, Avondale, AZ 85392

name of officer title address

FORM NO. 13 P.S.C. MO. NO. 3 (Original) Sheet No. 1
(Revised)

CANCELING P.S.C. MO. NO. 2 All Sheets (Original) Sheet No. _____
(Revised)

Noel Water Company For Noel, Missouri **RECEIVED**
Name of Issuing Corporation Community, Town or City
FEB 27 1997

TABLE OF CONTENTS		MISSOURI Public Service Commission
Description	Beginning Sheet No.	
Table of Contents.....	1	
Map of certificated area.....	2	
Legal description of certificated area.....	3	
Rate Schedules for General Water Service		
Residential.....	5	
Commercial.....	7	
Industrial.....	8	
Rate Schedules for Special Water Service		
Flat Rate Service and Private Fire Protection.....	10	
Unmetered Tank Water.....	11	
Tax Adjustment.....	12	
Service Charges and Miscellaneous Charges.....	13	
Rules and Regulations		
1. Definitions.....	15	
2. General.....	16	
3. Company Employees and Customer Relations.....	17	
4. Applications and Contracts for Service.....	18	
5. Inside Piping and Customer Water Service Lines.....	19	
6. Improper or Excessive Use.....	21	
7. Discontinuance of Water Service by Company.....	22	
8. Discontinuance of Water Service at Customer's Request.....	24	
9. Interruptions in Service.....	24	
10. Bills for Service; Deposits; Estimated Bills.....	25	
11. Meters and Meter Installations.....	28	
12. Meter Tests and Test Fees.....	30	
13. Bill Adjustments Based on Meter Tests.....	30	
14. Extension of Water Mains.....	31	
15. Fire Hydrants.....	33	

DATE OF ISSUE March 1, 1997 DATE EFFECTIVE March 10, 1997

ISSUED BY Dan M. Harmon, President Noel, Missouri **FILED**
Name of Officer Title Address

FILED
MAR 10 1997
97-167
MO. PUBLIC SERVICE COMM

FORM NO. 13 P.S.C. MO. NO. 3 (Original) Sheet No. 2

CANCELING P.S.C. MO. NO. 2 All Sheets (~~Revised~~) (Original) Sheet No. _____

Noel Water Company For Noel, Missouri **RECEIVED**

Name of Issuing Corporation Community, Town or City

FEB 27 1997

MAP OF CERTIFICATED AREA

MISSOURI
Public Service Commission

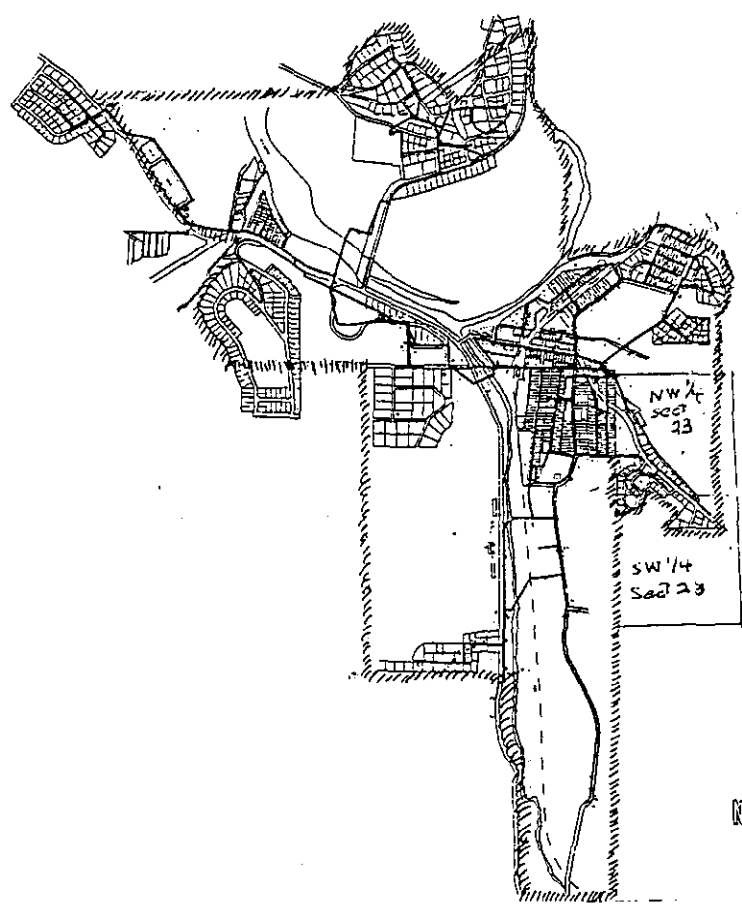

NOEL WATER COMPANY
NOEL, MISSOURI

DATE OF ISSUE March 1, 1997 DATE EFFECTIVE March 10, 1997

ISSUED BY Dan M. Harmon, President Noel, Missouri **FILED**
Name of Officer Title Address

MAR 19 1997
97-987

MO. PUBLIC SERVICE COMM

FORM NO. 13 P.S.C. MO. NO. 3 (Original) Sheet No. 3

~~(Revised)~~

CANCELING P.S.C. MO. NO. 2 All Sheets (~~Original~~) Sheet No. _____

~~(Revised)~~

Noel Water Company For Noel, Missouri **RECEIVED**

Name of Issuing Corporation Community, Town or City

FEB 27 1997

LEGAL DESCRIPTION OF CERTIFICATED AREA	MISSOURI Public Service Commission
<p>The Company is authorized to own, maintain and operate a waterworks system in the City of Noel, Missouri, as the corporate limits of the same may change from time to time, and in an area adjacent to the City of Noel in McDonald County, Missouri, more particularly described as follows:</p> <p>(A) All of Lots 29, 30 and 31 in Block 1 of Kistler and Davis Addition to Noel, Missouri; and</p> <p>(B) All of Lots 29, 30, 31, 32, 33, 34, 35 and 36, and that part of Lots 25, 27 and 28 lying North and East of State Highway P, in Block 2 of Kistler and Davis Addition to Noel, Mo.; and</p> <p>(C) All of Lots 5, 6, 9 and 10 in Block 6 of Kistler and Davis Addition to Noel, Mo.; and</p> <p>(D) All of Lots 4, 5, 6, 7, 8, 9, 10, 11, 12, 13, 14, 15, 16, 17, 18, 19, 20, 25, 26, 27, 28, 29, 30, 31, 32, 33, 34, 35, 36, 41, 42, 43, 44, 45, 46, 47, 48, 49, 50 and 51, in McMillen Heights Subdivision in the West Half (W 1/2) of the Northwest Quarter (NW 1/4) of Section 23, Township 21, Range 33; and</p> <p>(E) All of the Northeast Quarter (NE 1/4) of the Southwest Quarter (SW 1/4) of Section 23, Township 21, Range 33, lying North and East of State Highway P.</p> <p>(F) All of the Northwest Quarter (NW 1/4) of Section 23, Township 21, Range 33, exclusive of McMillen Heights Subdivision and EXCEPTING the three following described tracts:</p> <p>(1) Beginning at a point where the South Right-of-way line of State Highway P intersects with the West line of said Section 23, thence South along said Section line to intersection with the North Right-of-way line of Davis Avenue, thence East along said North Right-of-way of Davis Avenue to intersection with said State Highway P, thence Northwesterly along and with the West or South Right-of-way line of said Highway to the point of beginning; and</p> <p>(2) Beginning at the southeast corner of Lot 22 in Block 1 of Kistler and Davis Addition to Noel, thence South 50° 5' East a distance of 142 feet, thence North 30° East a distance of 50 feet,</p> <p>(Continued on next sheet)</p>	

DATE OF ISSUE March 1, 1997 DATE EFFECTIVE March 10, 1997

ISSUED BY Dan M. Harmon, President Noel, Missouri **FILED**

Name of Officer Title Address

MAR 10 1997
97-167
MO. PUBLIC SERVICE COMM

FORM NO. 13 P.S.C. MO. NO. 3 (Original) Sheet No. 4

(Revised)

CANCELING P.S.C. MO. NO. 2 All Sheets (Original) Sheet No. _____

(Revised)

Noel Water Company For Noel, Missouri RECEIVED

Name of Issuing Corporation Community, Town or City

FEB 27 1997

MISSOURI
Public Service Commission

thence North 16° 15' West a distance of 110 feet, thence North 25° West a distance of 184 feet to the East line of said Kistler and Davis Addition, thence South along said East line of said Addition a distance of 280 feet more or less to the point of beginning; and

(3) Beginning at an iron pin at the northwest corner of Lot 1 in McMillen Heights Subdivision, thence North 23° 15' East a distance of 63 feet 2 inches to an iron pin---the point of beginning: thence North 16° 15' West a distance of 130 feet, thence North 22° West a distance of 60 feet, thence North 73° East a distance of 50 feet, thence South 35° East a distance of 64 feet to an iron pin, thence South 41° East (along road) a distance of 212 feet to an iron pin, thence South 54° 15' East a distance of 35 feet to an iron pin, thence South 48° West a distance of 35 feet, thence South 31° 30' East a distance of 80 feet, thence South 27° 45' East a distance of 160 feet, thence South 61° 30' West a distance of 90 feet to the Easterly Right-of-way of Otis Drive, thence northwesterly along the said Right-of-way of Otis Drive a distance of 381 feet more or less to the point of beginning.

DATE OF ISSUE March 1, 1997 DATE EFFECTIVE March 10, 1997

ISSUED BY Dan M. Harmon, President Noel, Missouri FILED

Name of Officer Title

Address MAR 10 1997

37-167
MO. PUBLIC SERVICE COMMISSION

Noel Water Company
Name of Issuing Company

For: Noel Missouri
Certificated Service Area

GENERAL WATER SERVICE – RESIDENTIAL

AVAILABILITY

This service is available at points on the Company’s existing distribution facilities located within the Company’s certificated area.

APPLICABILITY

This rate schedule applies to water service supplied at one point of delivery to residential customers for domestic use by the customer or by members of customer’s household for nonbusiness, noncommercial or nonindustrial purposes. Such domestic use shall include water which is ultimately used or consumed for household purposes such as bathing, cooking and sanitary uses. Such sales shall include, but not be limited to, water service provided through a single or master meter for residential apartments or condominiums, including service for common areas and facilities and vacant residential units. Sales of water to customers who purchase water for domestic use under this rate schedule shall be classified by the Company as “residential” sales exempt from state sales tax. This tariff is intended to satisfy the provision of section 144.030(23) RSMo, by establishing a classification system permitting the sales and purchases of metered water for domestic use under this tariff to be classified as “residential” and exempt from sales tax. Taxes other than sales tax may still be applicable to such sales.

The rates for any service in this schedule consist of a minimum charge which is payable whether there is any water usage during a month or not. The fixed minimum charge includes 1,000 gallons of water. The commodity charge applies for all water passing through the meter in excess of the 1,000 gallons included in the monthly charge.

MINIMUM FIXED MONTHLY CHARGES (includes first 1,000 gallons of usage)

5/8” Meter	\$ 7.76 per mo.	+
3/4” Meter	\$ 10.50 per mo.	+
1” Meter	\$ 15.65 per mo.	+
2” Meter	\$ 44.20 per mo.	+
4” Meter	\$ 132.30 per mo.	+

(Continued on next sheet)

- * Indicates New Rate or Text
- + Indicates Changed Rate or Text

Issue Date: October 13, 2009
Month/Day/Year

Effective Date: November 12, 2009
Month/Day/Year

Issued By: Dan M. Harmon
Name & Title of Issuing Officer

P.O. Box 465 Noel MO 64854
Company Mailing Address

Noel Water Company
Name of Issuing Company

For: Noel Missouri
Certificated Service Area +

GENERAL WATER SERVICE – RESIDENTIAL

AVAILABILITY +

This service is available at points on the Company's existing distribution facilities located within the Company's certificated area.

APPLICABILITY +

This rate schedule applies to water service supplied at one point of delivery to residential customers for domestic use by the customer or by members of customer's household for nonbusiness, noncommercial or nonindustrial purposes. Such domestic use shall include water which is ultimately used or consumed for household purposes such as bathing, cooking and sanitary uses. Such sales shall include, but not be limited to, water service provided through a single or master meter for residential apartments or condominiums, including service for common areas and facilities and vacant residential units. Sales of water to customers who purchase water for domestic use under this rate schedule shall be classified by the Company as "residential" sales exempt from state sales tax. This tariff is intended to satisfy the provisions of section 144.030(23) RSMo, by establishing a classification system permitting the sales and purchases of metered water for domestic use under this tariff to be classified as "residential" and exempt from sales tax. Taxes other than state sales tax may still be applicable to such sales.

The rates for service in this schedule consist of minimum charge which is payable whether there is any water usage during a month or not. The fixed minimum charge includes 1,000 gallons of water. The commodity charge applies for all water passing through the meter in excess of the 1,000 gallons included in the monthly charge.

MINIMUM FIXED MONTHLY CHARGES (includes first 1,000 gallons of usage) +

5/8" Meter	\$ 3.97 per mo.	+
3/4" Meter	\$ 5.27 per mo.	+
1" Meter	\$ 7.86 per mo.	+
2" Meter	\$22.15 per mo.	+
4" Meter	\$66.31 per mo.	+

(Continued on next sheet)

* Indicates New Rate or Text

+ Indicates Changed Rate or Text

Issue Date: May 31, 2005
Month/Day/Year

Effective Date: June 30, 2005
Month/Day/Year

Issued By: Dan M. Harmon
Name & Title of Issuing Officer

P.O. Box 465 Noel MO 64854
Company Mailing Address

FORM NO. 13 P.S.C. MO. NO. 3 (Original) Sheet No. 5

CANCELING P.S.C. MO. NO. 2 All Sheets ~~(Original)~~ Sheet No.

Noel Water Company For Noel, Missouri
Name of Issuing Corporation Community, Town or City

RECEIVED

FEB 27 1997

GENERAL WATER SERVICE - RESIDENTIAL

**MISSOURI
Public Service Commission**

AVAILABLE:

This service is available at points on the Company's existing distribution facilities located within the Company's certificated area.

APPLICABLE:

This rate schedule applies to water service supplied at one point of delivery to residential customers for domestic use by the customer or by members of customer's household for nonbusiness, noncommercial or nonindustrial purposes. Such domestic use shall include water which is ultimately used or consumed for household purposes such as bathing, cooking and sanitary uses. Such sales shall include, but not be limited to, water service provided through a single or master meter for residential apartments or condominiums, including service for common areas and facilities and vacant residential units. Sales of water to customers who purchase water for domestic use under this rate schedule shall be classified by the Company as "residential" sales exempt from state sales tax. This tariff is intended to satisfy the provisions of section 144.030(23) RSMo, by establishing a classification system permitting the sales and purchases of metered water for domestic use under this tariff to be classified as "residential" and exempt from sales tax. Taxes other than state sales taxes may still be applicable to such sales.

The rates for service in this schedule consist of a minimum charge which is payable whether there is any water usage during a month or not. The fixed minimum charge includes 1,000 gallons of water. The commodity charge applies for all water passing through the meter in excess of the 1,000 gallons included in the minimum monthly charge.

MINIMUM FIXED MONTHLY CHARGES WHICH INCLUDE 1,000 GALLONS OF WATER:

5/8" Meter	\$	3.39 per mo.
3/4" Meter		4.50 per mo.
1" Meter		6.71 per mo.
2" Meter		18.90 per mo.
4" Meter		56.57 per mo.

(Continued on next sheet)

DATE OF ISSUE March 1, 1997 DATE EFFECTIVE March 10, 1997

ISSUED BY Dan M. Harmon, President Noel, Missouri
Name of Officer Title Address

FILED
MAR 10 1997
97-167
MO. PUBLIC SERVICE COMMISSION

P.S.C. MO No. 3

2nd Revised Sheet No. 6

Canceling 1st Sheet No. 6

Noel Water Company
Name of Issuing Company

For: Noel Missouri
Certificated Service Area

GENERAL WATER SERVICE - RESIDENTIAL

COMMODITY CHARGE (applied to all usage over 1,000 gallons per month) +
All water metered over 1,000 gal. \$1.800 per 1,000 gallons +

TAX ADJUSTMENT

The tax adjustment provision on Sheet No. 12 applies to this rate schedule.

* Indicates New Rate or Text

+ Indicates Changed Rate or Text

Issue Date: October 13, 2009
Month/Day/Year

Effective Date: November 12, 2009
Month/Day/Year

Issued By: Dan M. Harmon
Name & Title of Issuing Officer

P.O. Box 465 Noel MO 64854
Company Mailing Address

P.S.C. MO No. 3

1st Revised Sheet No. 6

Canceling Original Sheet No. 6

Noel Water Company
Name of Issuing Company

For: Noel Missouri
Certificated Service Area +

GENERAL WATER SERVICE – RESIDENTIAL

COMMODITY CHARGE (applied to all usage over 1,000 gallons per month) +

All water metered over 1,000 gal. \$1.518 per 1,000 gallons +

TAX ADJUSTMENT

The tax adjustment provision on Sheet No. 12 applies to this rate schedule.

* Indicates New Rate or Text

+ Indicates Changed Rate or Text

Issue Date: May 31, 2005
Month/Day/Year

Effective Date: June 30, 2005
Month/Day/Year

Issued By: Dan M. Harmon
Name & Title of Issuing Officer

P.O. Box 465 Noel MO 64854
Company Mailing Address

FORM NO. 13 P.S.C. MO. NO. 3 (Original) Sheet No. 6

CANCELING P.S.C. MO. NO. 2 All Sheets (~~Revised~~) (Original) Sheet No. _____

Noel Water Company For Noel, Missouri **RECEIVED**

Name of Issuing Corporation Community, Town or City

FEB 27 1997

GENERAL WATER SERVICE - RESIDENTIAL

MISSOURI

Public Service Commission

COMMODITY CHARGE APPLIED TO ALL USAGE OVER 1,000 GALLONS PER MONTH:

All water metered over 1,000 gal. \$ 1.30 per 1,000 gal.

TAX ADJUSTMENT:

The tax adjustment provision on sheet no. 12 applies to this rate schedule.

DATE OF ISSUE March 1, 1997 DATE EFFECTIVE March 10, 1997

ISSUED BY Dan M. Harmon, President Noel, Missouri **FILED**
Name of Officer Title Address

MAR 10 1997

97-167
MO. PUBLIC SERVICE COMMISSION

Noel Water Company
Name of Issuing Company

For: Noel Missouri
Certificated Service Area

GENERAL WATER SERVICE - COMMERCIAL

AVAILABILITY

This service is available at points on the Company's existing distribution facilities located within the Company's certificated area.

APPLICABILITY

This rate schedule applies to water service supplied at one point of delivery to commercial customers for non-domestic use by the customer.

Commercial customers shall mean those at premises where the customers are engaged in the wholesale or retail trade, professional services and miscellaneous business services; hotels or other commercial lodging places; clubs; office buildings; warehouses; service stations; hospitals; schools; institutions for the care or detention of persons; military installations, and other similar establishments.

The rates for any service in this schedule consist of a minimum charge which is payable whether there is any water usage during a month or not. The fixed minimum charge includes 1,000 gallons of water. The commodity charge applies for all water passing through the meter in excess of the 1,000 gallons included in the monthly charge.

MINIMUM FIXED MONTHLY CHARGES (includes first 1,000 gallons of usage)

5/8" Meter	\$ 7.76 per mo.	+
3/4" Meter	\$ 10.50 per mo.	+
1" Meter	\$ 15.65 per mo.	+
2" Meter	\$ 44.20 per mo.	+
4" Meter	\$ 132.30 per mo.	+

COMMODITY CHARGE (applied to all usage over 1,000 gallons per month) +

All water metered over 1,000 gal. \$1.800 per 1,000 gallons +

TAX ADJUSTMENT

The tax adjustment provision on Sheet No. 12 applies to this rate schedule.

* Indicates New Rate or Text

+ Indicates Changed Rate or Text

Issue Date: October 13, 2009
Month/Day/Year

Effective Date: November 12, 2009
Month/Day/Year

Issued By: Dan M. Harmon
Name & Title of Issuing Officer

P.O. Box 465 Noel MO 64854
Company Mailing Address

Noel Water Company
Name of Issuing Company

For: Noel Missouri
Certificated Service Area +

GENERAL WATER SERVICE – COMMERCIAL

AVAILABILITY +

This service is available at points on the Company's existing distribution facilities located within the Company's certificated area.

APPLICABILITY +

This rate schedule applies to water service supplied at one point of delivery to commercial customers for non-domestic use by the customer.

Commercial customers shall mean those at premises where the customers are engaged in the wholesale or retail trade, professional services and miscellaneous business services; hotels or other commercial lodging places; clubs; office buildings; warehouses; service stations; hospitals; schools; institutions for the care or detention of persons; military installations, and other similar establishments.

The rates for service in this schedule consist of minimum charge which is payable whether there is any water usage during a month or not. The fixed minimum charge includes 1,000 gallons of water. The commodity charge applies for all water passing through the meter in excess of the 1,000 gallons included in the monthly charge.

MINIMUM FIXED MONTHLY CHARGES (includes first 1,000 gallons of usage) +

5/8" Meter	\$ 3.97 per mo.	+
3/4" Meter	\$ 5.27 per mo.	+
1" Meter	\$ 7.86 per mo.	+
2" Meter	\$22.15 per mo.	+
4" Meter	\$66.31 per mo.	+

COMMODITY CHARGE (applied to all usage over 1,000 gallons per month) +

All water metered over 1,000 gal. \$1.518 per 1,000 gallons +

TAX ADJUSTMENT

The tax adjustment provision on Sheet No. 12 applies to this rate schedule.

* Indicates New Rate or Text

+ Indicates Changed Rate or Text

Issue Date: May 31, 2005
Month/Day/Year

Effective Date: June 30, 2005
Month/Day/Year

Issued By: Dan M. Harmon
Name & Title of Issuing Officer

P.O. Box 465 Noel MO 64854
Company Mailing Address

FORM NO. 13 P.S.C. MO. NO. 3 (Original) Sheet No. 7

CANCELING P.S.C. MO. NO. 2 All Sheets (Revised) (Original) Sheet No. _____

Noel Water Company For Noel, Missouri **RECEIVED**
Name of Issuing Corporation Community, Town or City

FEB 27 1997

GENERAL WATER SERVICE - COMMERCIAL

MISSOURI
Public Service Commission

AVAILABLE:

This service is available at points on the Company's existing distribution facilities located within the Company's certificated area.

APPLICABLE:

This rate schedule applies to water service supplied at one point of delivery to commercial customers for non-domestic use by the customer.

Commercial customers shall mean those at premises where the customers are engaged in the wholesale or retail trade, professional services and miscellaneous business services; hotels or other commercial lodging places; clubs; office buildings; warehouses; service stations; hospitals; schools; institutions for the care or detention of persons; military installations, and other similar establishments.

The rates for service in this schedule consist of a minimum charge which is payable whether there is any water usage during a month or not. The fixed minimum charge includes 1,000 gallons of water. The commodity charge applies for all water passing through the meter in excess of the 1,000 gallons included in the minimum monthly charge.

MINIMUM FIXED MONTHLY CHARGES WHICH INCLUDE 1,000 GALLONS OF WATER:

5/8" Meter	\$	3.39 per mo.
3/4" Meter		4.50 per mo.
1" Meter		6.71 per mo.
2" Meter		18.90 per mo.
4" Meter		56.57 per mo.

COMMODITY CHARGE APPLIED TO ALL USAGE OVER 1,000 GALLONS PER MONTH:

All water metered over 1,000 gal..... \$ 1.30 per 1,000 gal.

TAX ADJUSTMENT:

The tax adjustment provision on sheet no. 12 applies to this rate schedule.

DATE OF ISSUE March 1, 1997 DATE EFFECTIVE March 10, 1997

ISSUED BY Dan M. Harmon, President Noel, Missouri **FILED**
Name of Officer Title Address

MAR 10 1997
97-167
MO. PUBLIC SERVICE COMMISSION

Noel Water Company
Name of Issuing Company

For: Noel Missouri
Certificated Service Area

GENERAL WATER SERVICE – INDUSTRIAL

AVAILABILITY

This service is available at points on the Company's existing distribution facilities located within the Company's certificated area but only to customers who will use more than 1,000,000 gallons per month.

APPLICABILITY

This rate schedule applies to water service supplied at one point of delivery to commercial customers for non-domestic use by the customer.

Industrial customers shall mean those at premises where the customers are engaged primarily in the changing of raw or unfinished materials into other forms or products. Such uses can include, but are not limited to, processing of food and kindred products; textiles or apparel; lumber and wood products; establishments engaged in mining or quarrying; printing and publishing; and other similar industrial facilities.

The rates for service in this schedule consist of minimum charge which is payable whether there is any water usage during a month or not. The fixed minimum charge includes 1,000 gallons of water. The commodity charge applies for all water passing through the meter in excess of the 1,000 gallons included in the monthly charge.

MINIMUM FIXED MONTHLY CHARGES (includes first 1,000 gallons of usage)

5/8" Meter	\$ 7.76 per mo.	+
3/4" Meter	\$ 10.50 per mo.	+
1" Meter	\$ 15.65 per mo.	+
2" Meter	\$ 44.20 per mo.	+
4" Meter	\$ 132.30 per mo.	+
6" Meter	\$ 222.00 per mo.	+

* Indicates New Rate or Text

+ Indicates Changed Rate or Text

Issue Date: October 13, 2009
Month/Day/Year

Effective Date: November 12, 2009
Month/Day/Year

Issued By: Dan M. Harmon
Name & Title of Issuing Officer

P.O. Box 465 Noel MO 64854
Company Mailing Address

Noel Water Company
Name of Issuing Company

For: Noel Missouri
Certificated Service Area +

GENERAL WATER SERVICE – INDUSTRIAL

AVAILABILITY +

This service is available at points on the Company's existing distribution facilities located within the Company's certificated area but only to customers who will use more than 1,000,000 gallons per month and only where the Company and Customer have entered into a special contract for such service due to the consideration of the capacity of the Company's system to deliver such service..

APPLICABILITY +

This rate schedule applies to water service supplied at one point of delivery to industrial customers for non-domestic use by the customer.

Industrial customers shall mean those at premises where the customers are engaged primarily in the changing of raw or unfinished materials into other forms or products. Such uses can include, but are not limited to, processing of food and kindred products; textiles or apparel; lumber and wood products; establishments engaged in mining or quarrying; printing and publishing; and other similar industrial facilities.

The rates for service in this schedule consist of minimum charge which is payable whether there is any water usage during a month or not. The fixed minimum charge includes 1,000 gallons of water. The commodity charge applies for all water passing through the meter in excess of the 1,000 gallons included in the monthly charge.

MINIMUM FIXED MONTHLY CHARGES (includes first 1,000 gallons of usage) +

5/8" Meter	\$ 3.97 per mo.	+
3/4" Meter	\$ 5.27 per mo.	+
1" Meter	\$ 7.86 per mo.	+
2" Meter	\$ 22.15 per mo.	+
4" Meter	\$ 66.31 per mo.	+
6" Meter	\$113.46 per mo.	+

(Continued on next sheet)

* Indicates New Rate or Text
+ Indicates Changed Rate or Text

Issue Date: May 31, 2005
Month/Day/Year

Effective Date: June 30, 2005
Month/Day/Year

Issued By: Dan M. Harmon
Name & Title of Issuing Officer

P.O. Box 465 Noel MO 64854
Company Mailing Address

FORM NO. 13 P.S.C. MO. NO. 3 (Original) Sheet No. 8

~~(Revised)~~

CANCELING P.S.C. MO. NO. 2 All Sheets ~~(Original)~~ Sheet No.

~~(Revised)~~

Noel Water Company For Noel, Missouri

Name of Issuing Corporation Community, Town or City

RECEIVED

FEB 27 1997

GENERAL WATER SERVICE - INDUSTRIAL MISSOURI Public Service Commission

AVAILABLE:

This service is available at points on the Company's existing distribution facilities located within the Company's certificated area but only to customers who will use more than 1,000,000 gallons per month and only where the Company and Customer have entered into a special contract for such service due to the consideration of the capacity of the Company's system to deliver such service.

APPLICABLE:

This rate schedule applies to water service supplied at one point of delivery to industrial customers for non-domestic use by the customer.

Industrial customers shall mean those at premises where the customers are engaged primarily in the changing of raw or unfinished materials into other forms or products. Such uses can include, but are not limited to, processing of food and kindred products; textiles or apparel; lumber and wood products; establishments engaged in mining or quarrying; printing and publishing; and other similar industrial facilities.

The rates for service in this schedule consist of a minimum charge which is payable whether there is any water usage during a month or not. The fixed minimum charge includes 1,000 gallons of water. The commodity charge applies for all water passing through the meter in excess of the 1,000 gallons included in the minimum monthly charge.

MINIMUM FIXED MONTHLY CHARGES WHICH INCLUDE 1,000 GALLONS OF WATER:

5/8" Meter	\$	3.39 per mo.
3/4" Meter		4.50 per mo.
1" Meter		6.71 per mo.
2" Meter		18.90 per mo.
4" Meter		56.57 per mo.
6" Meter		96.80 per mo.

(continued on next sheet)

DATE OF ISSUE March 1, 1997 DATE EFFECTIVE March 10, 1997

ISSUED BY Dan M. Harmon, President Noel, Missouri
Name of Officer Title Address

FILED
MAR 10 1997
97-167
MO. PUBLIC SERVICE COMM

Noel Water Company
Name of Issuing Company

For: Noel Missouri
Certificated Service Area

GENERAL WATER SERVICE - INDUSTRIAL

COMMODITY CHARGE (applied to all usage over 1,000 gallons per month)

Metered usage over 1,000 gallons per month: \$1.67 per 1,000 gal. +

TAX ADJUSTMENT

The tax adjustment provision on Sheet No. 12 applies to this rate schedule.

* Indicates New Rate or Text
+ Indicates Changed Rate or Text

Issue Date: October 13, 2009
Month/Day/Year

Effective Date: November 12, 2009
Month/Day/Year

Issued By: Dan M. Harmon
Name & Title of Issuing Officer

P.O. Box 465 Noel MO 64854
Company Mailing Address

P.S.C. MO No. 3

1st Revised Sheet No. 9

Canceling Original Sheet No. 9

Noel Water Company
Name of Issuing Company

For: Noel Missouri
Certificated Service Area +

GENERAL WATER SERVICE – INDUSTRIAL

COMMODITY CHARGE (applied to all usage over 1,000 gallons per month) +
Metered usage up to and including 1,000,000 gallons per month \$2.121 per 1,000 gal. +
Metered usage over 1,000,000 gallons per month: \$0.32 per 1,000 gal. +

TAX ADJUSTMENT

The tax adjustment provision on Sheet No. 12 applies to this rate schedule.

* Indicates New Rate or Text
+ Indicates Changed Rate or Text

Issue Date: May 31, 2005
Month/Day/Year

Effective Date: June 30, 2005
Month/Day/Year

Issued By: Dan M. Harmon
Name & Title of Issuing Officer

P.O. Box 465 Noel MO 64854
Company Mailing Address

FORM NO. 13 P.S.C. MO. NO. 3 (Original) Sheet No. 9

~~(Revised)~~

CANCELING P.S.C. MO. NO. 2 All Sheets (Original) Sheet No. _____

~~(Revised)~~

Noel Water Company For Noel, Missouri

Name of Issuing Corporation Community, Town or City

RECEIVED

FEB 27 1997

MISSOURI
GENERAL WATER SERVICE - INDUSTRIAL Public Service Commission

COMMODITY CHARGE APPLIED TO ALL USAGE OVER 1,000 GALLONS PER MONTH:

All water metered over 1,000 gal.
per month up to and including 1,000,000
gallons in the same month.....\$ 1.81 per 1,000 gal.

All water metered over 1,000,000 per month: \$.26 per 1,000 gal.

TAX ADJUSTMENT:

The tax adjustment provision on sheet no. 12 applies to this rate schedule.

DATE OF ISSUE March 1, 1997 DATE EFFECTIVE March 10, 1997

ISSUED BY Dan M. Harmon, President Noel, Missouri
Name of Officer Title Address

FILED

MAR 10 1997
97-167
MO. PUBLIC SERVICE COMM

P.S.C. MO No. 3

1st Revised Sheet No. 10

Canceling Original Sheet No. 10

Noel Water Company
Name of Issuing Company

For: Noel Missouri
Certificated Service Area +

**SPECIAL WATER SERVICE – FLAT RATE WATER SERVICE
AND PRIVATE FIRE PROTECTION SERVICE**

RESIDENTIAL AND COMMERCIAL FLAT RATE WATER SERVICE

AVAILABILITY +

This service is only available at certain points on the Company's existing distribution facilities located within the Company's certificated area. The availability of this schedule is restricted to existing residential and commercial customers with an unmetered service connection of one inch diameter or smaller. This service is also restricted to those special situations or unusual circumstances which, in the opinion of the Company, make it applicable.

APPLICABILITY +

This rate schedule applies to water service supplied at one point of delivery.

RATE

Residential and Commercial.....\$7.00 per month +

SALES TAX

Pursuant to section 144.030.2(23), Revised Statutes of Missouri, the Company shall add all applicable sales taxes to the amount billed.

TAX ADJUSTMENT

The tax adjustment provision on Sheet No. 12 applies to this rate schedule.

* Indicates New Rate or Text
+ Indicates Changed Rate or Text

Issue Date: May 31, 2005
Month/Day/Year

Effective Date: June 30, 2005
Month/Day/Year

Issued By: Dan M. Harmon
Name & Title of Issuing Officer

P.O. Box 465 Noel MO 64854
Company Mailing Address

FORM NO. 13 P.S.C. MO. NO. 3 (Original) Sheet No. 10

CANCELING P.S.C. MO. NO. 2 All Sheets ~~(Original)~~ Sheet No.

Noel Water Company For Noel, Missouri

Name of Issuing Corporation Community, Town or City

RECEIVED

FEB 27 1997

SPECIAL WATER SERVICE - FLAT RATE WATER SERVICE AND PRIVATE FIRE PROTECTION SERVICE MISSOURI Public Service Commission

RESIDENTIAL AND COMMERCIAL FLAT RATE WATER SERVICE:

AVAILABLE:

This service is only available at certain points on the Company's existing distribution facilities located within the Company's certificated area. The availability of this schedule is restricted to existing residential and commercial customers with an unmetered service connection of one inch diameter or smaller. This service is also restricted to those special situations or unusual circumstances which, in the opinion of the Company, make it applicable.

APPLICABLE:

This rate schedule applies to water service supplied at one point of delivery.

RATE:

Residential and commercial.....\$5.97 per month

PRIVATE FIRE PROTECTION SERVICE

AVAILABLE:

To Industrial customers who wish to make use of this schedule for fire protection (sprinkler) systems installed on private property. This service shall be provided only with the permission of the Company and only where the connection is to a main of six inches diameter or greater. This service is restricted to those special situations or unusual circumstances which, in the opinion of the Company, make it applicable. If, in the opinion of the Company, a detecto check meter is needed at the installation, the actual cost of installation shall be paid by the Customer.

APPLICABLE:

This rate schedule applies to water service supplied at one point of delivery.

RATE:.....the same charge as the monthly minimum for a 6 inch meter under the Industrial rate schedule (Sheet 8)

SALES TAX:

Pursuant to section 144.030.2(23), Revised Statutes of Missouri, the Company shall add all applicable sales taxes to the amount billed.

TAX ADJUSTMENT:

The tax adjustment provision on sheet no. 12 applies to this rate schedule.

DATE OF ISSUE March 1, 1997 DATE EFFECTIVE March 10, 1997

ISSUED BY Dan M. Harmon, President Noel, Missouri
Name of Officer Title Address

FILED

MAR 10 1997
97-167

MISSOURI PUBLIC SERVICE COMMISSION

Noel Water Company
Name of Issuing Company

For: Noel Missouri
Certificated Service Area +

**SPECIAL WATER SERVICE – FLAT RATE WATER SERVICE
AND PRIVATE FIRE PROTECTION SERVICE**

PRIVATE FIRE PROTECTION SERVICE

AVAILABILITY +

This service is available to Industrial customers who wish to make use of this schedule for fire protection (sprinkler) systems installed on private property. This service shall be provided only with the permission of the Company and only where the connection is to a main of six inches diameter or greater. This service is restricted to those special situations or unusual circumstances which, in the opinion of the Company, make it applicable. If, in the opinion of the Company, a detecto check meter is needed at the installation, the actual cost of installation, shall be paid by the Customer. +

APPLICABILITY +

This rate schedule applies to water service supplied at one point of delivery.

RATE

Same charge as the monthly minimum for a 6" meter under the Industrial rate schedule (Sheet 8) +

SALES TAX

Pursuant to section 144.030.2(23), Revised Statutes of Missouri, the Company shall add all applicable sales taxes to the amount billed.

TAX ADJUSTMENT

The tax adjustment provision on Sheet No. 12 applies to this rate schedule.

* Indicates New Rate or Text

+ Indicates Changed Rate or Text

Issue Date: May 31, 2005
Month/Day/Year

Effective Date: June 30, 2005
Month/Day/Year

Issued By: Dan M. Harmon
Name & Title of Issuing Officer

P.O. Box 465 Noel MO 64854
Company Mailing Address

Noel Water Company
Name of Issuing Company

For: Noel Missouri
Certificated Service Area +

SPECIAL WATER SERVICE – UNMETERED TANK WATER

AVAILABILITY +

This service is available from a facility located at the Company's headquarters which dispenses water. It is available to any person who wishes to purchase water utilizing the person's own container. The person taking water under these conditions assumes responsibility for ensuring the continued sanitary condition of the water once the water leaves the Company's facility.

APPLICABILITY +

Customers utilizing this schedule are required to show the container to be used to Company personnel and to allow Company personnel to track the gallons taken. Bills will be rendered each month based on actual water taken.

RATE

Except as noted herein, the charge for water under this rate schedule is \$5.10 per 1,000 gallons per month. Persons taking water under this rate schedule may fill up a container as many times per month as desired, so long as the actual water taken aggregates no more than 1,000 gallons in one calendar month. If more than 1,000 gallons are taken in one calendar month, another charge of \$5.10 per 1,000 gallons shall be applied to each 1,000 gallons taken over 1,001 gallons. +

SALES TAX

Pursuant to section 144.030.2(23), Revised Statutes of Missouri, the Company shall add all applicable sales taxes to the amount billed.

TAX ADJUSTMENT

The tax adjustment provision on Sheet No. 12 applies to this rate schedule.

- * Indicates New Rate or Text
- + Indicates Changed Rate or Text

Issue Date: May 31, 2005
Month/Day/Year

Effective Date: June 30, 2005
Month/Day/Year

Issued By: Dan M. Harmon
Name & Title of Issuing Officer

P.O. Box 465 Noel MO 64854
Company Mailing Address

FORM NO. 13 P.S.C. MO. NO. 3 (Original) Sheet No. 11

CANCELING P.S.C. MO. NO. 2 All Sheets (~~Revised~~) (Original) Sheet No. _____

Noel Water Company For Noel, Missouri
Name of Issuing Corporation Community, Town or City

RECEIVED

FEB 27 1997

SPECIAL WATER SERVICE - UNMETERED TANK WATER

**MISSOURI
Public Service Commission**

AVAILABLE:

This service is available from a facility located at the Company's headquarters which dispenses water. It is available to any person who wishes to purchase water utilizing the person's own container. The person taking water under these conditions assumes responsibility for ensuring the continued sanitary condition of the water once the water leaves the Company's facility.

APPLICABLE:

Customers utilizing this schedule are required to show the container to be used to Company personnel and to allow Company personnel to track the gallons taken. Bills will be rendered each month based on actual water taken.

RATE:

The charge for water under this rate schedule is \$4.35 per 1,000 gallons per month. Persons taking water under this rate schedule may fill up a container as many times per month as desired, so long as the actual water taken aggregates no more than 1,000 gallons in one calendar month. If more than 1,000 gallons are taken in one calendar month, another charge of \$4.35 per 1,000 gallons shall be applied to each 1,000 gallons taken over 1,001 gallons.

SALES TAX:

Pursuant to section 144.030.2(23), Revised Statutes of Missouri, the Company shall add all applicable sales taxes to the amount billed.

TAX ADJUSTMENT:

The tax adjustment provision on sheet no. 12 applies to this rate schedule.

DATE OF ISSUE March 1, 1997 DATE EFFECTIVE March 10, 1997

ISSUED BY Dan M. Harmon, President Noel, Missouri
Name of Officer Title Address

FILED

MAR 10 1997

MO. PUBLIC SERVICE COMM

FORM NO. 13 P.S.C. MO. NO. 3 (Original) Sheet No. 12

CANCELING P.S.C. MO. NO. 2 All Sheets (~~Revised~~) (Original) Sheet No.

Noel Water Company For Noel, Missouri (~~Revised~~)

Name of Issuing Corporation Community, Town or City

RECEIVED

FEB 27 1997

TAX ADJUSTMENT	MISSOURI Public Service Commission
<p>There shall be added to the customer's bill, as a separate item, an amount equal to the proportionate part of any license, occupation, franchise, sales or other tax or fee now or hereafter imposed upon the Company by any municipality or any other governmental or political subdivision, whether imposed by ordinance, franchise or otherwise, in which the tax or fee is based upon a percentage of the Company's gross receipts, net receipts, or revenues from the provision of water service by the Company to a customer.</p>	

DATE OF ISSUE March 1, 1997 DATE EFFECTIVE March 10, 1997

ISSUED BY Dan M. Harmon, President Noel, Missouri **FILED**
Name of Officer Title Address

MAR 10 1997
97-167
MO. PUBLIC SERVICE COMMISSION

Noel Water Company
Name of Issuing Company

For: Noel Missouri
Certificated Service Area

SERVICE CHARGES AND MISCELLANEOUS CHARGES

The following charges are applicable only during normal business hours of the Company, which are 8am, to 5pm on Monday through Saturday, legal holidays excepted. None of these services listed shall be performed during other than normal working hours unless a charge is listed below.

Connection Charge

All persons requesting to initiative service from the Company after the effective date of this tariff sheet (i.e., a new customer or an existing customer at a new location) shall pay a non refundable connection fee of \$15.00 for the installation of a water meter and service connection in advance of the time the person is connected to the Company's system.

Reconnection Charge

If Company has discontinued service to Customer for any reason other than diversion of service, the charge for reconnecting service shall be \$15.00.

Meter Test Charge

Fee for testing meter at Customer request when the meter has been tested within previous twelve months and meter registers accurate within 5% more or less (See Rule 12): Actual cost of test plus shipping charges to and from approved testing facility to which meter is sent for testing.

Returned Check Charge

The Company will charge the customer \$25.00 for any check returned by the bank for insufficient funds. +

* Indicates New Rate or Text

+ Indicates Changed Rate or Text

Issue Date: October 13, 2009
Month/Day/Year

Effective Date: November 12, 2009
Month/Day/Year

Issued By: Dan M. Harmon
Name & Title of Issuing Officer

P.O. Box 465 Noel MO 64854
Company Mailing Address

Noel Water Company
Name of Issuing Company

For: Noel Missouri
Certificated Service Area +

SERVICE CHARGES AND MISCELLANEOUS CHARGES

The following charges are applicable only during normal business hours of the Company, which are 8 a.m. to 5 p.m. on Monday through Saturday, legal holidays excepted. None of these services listed shall be performed during other than normal working hours unless a charge is listed below.

Connection Charge

All persons requesting to initiate service from the Company after the effective date of this tariff sheet (i.e., a new customer or an existing customer at a new location) shall pay a non-refundable connection fee of \$15.00 for the installation of a water meter and service connection in advance of the time the person is connected to the Company's system. +

Reconnection Charge

If Company has discontinued service to Customer for any reason other than diversion of service, the charge for reconnecting service shall be \$15.00. +

If Company has discontinued service because of diversion of service, the applicable above amount, plus all actual costs of the Company for investigation of the diversion, and the estimated cost of all water diverted, shall be paid by the customer before reconnection shall take place.

Meter Test Charge

Fee for testing meter at Customer request when meter has been tested within previous twelve months and meter registers accurate within 5% more or less (See Rule 12): Actual cost of test plus shipping charges to and from approved testing facility to which meter is sent for testing.

Returned Check Charge

The Company will charge the customer \$15.00 for any check returned by the bank for insufficient funds. *

* Indicates New Rate or Text

+ Indicates Changed Rate or Text

Issue Date: May 31, 2005
Month/Day/Year

Effective Date: June 30, 2005
Month/Day/Year

Issued By: Dan M. Harmon
Name & Title of Issuing Officer

P.O. Box 465 Noel MO 64854
Company Mailing Address

FORM NO. 13 P.S.C. MO. NO. 3 (Original) Sheet No. 13

CANCELING P.S.C. MO. NO. 2 All Sheets ~~(Revised)~~
~~(XXXXXX)~~ (Original) Sheet No. _____
~~(XXXXXX)~~ (Revised)

Noel Water Company For Noel, Missouri
Name of Issuing Corporation Community, Town or City

RECEIVED

FEB 27 1997

SERVICE CHARGES AND MISCELLANEOUS CHARGES MISSOURI
Public Service Commission

The following charges are applicable only during normal business hours of the Company, which are 8 a.m. to 5 p.m. on Monday through Saturday, legal holidays excepted. None of these services listed shall be performed during other than normal working hours unless a charge therefor is listed below.

Connection Charge:

All persons requesting to initiate service from the Company after the effective date of this tariff sheet (i.e., a new customer or an existing customer at a new location) shall pay a non-refundable connection fee for the installation of a water meter and service connection in advance of the time the person is connected to the Company's system. The charge shall be \$5.00

Reconnection Charge:

If Company has discontinued service to Customer for any reason other than diversion of service, the charge shall be \$5.00.

If Company has discontinued service because of diversion of service, the applicable above amount, plus all actual costs of the Company for investigation, of the diversion, and the estimated cost of all water diverted, shall be paid by the customer before reconnection shall take place.

Meter Test Charge: Fee for testing meter at Customer request when meter has been tested within previous twelve months and meter registers accurate within 5% more or less (See Rule 12): Actual cost of test plus shipping charges to and from approved testing facility to which the meter is sent for testing.

(Continued on next sheet)

DATE OF ISSUE March 1, 1997 DATE EFFECTIVE March 10, 1997

ISSUED BY Dan M. Harmon, President Noel, Missouri
Name of Officer Title Address

FILED
MAR 10 1997
97-167
MO. PUBLIC SERVICE COMM

FORM NO. 13 P.S.C. MO. NO. 3 (Original) Sheet No. 14

CANCELING P.S.C. MO. NO. 2 All Sheets ~~(Revised)~~ (Original) Sheet No. _____

Noel Water Company For Noel, Missouri **RECEIVED**

Name of Issuing Corporation Community, Town or City

FEB 27 1997

MISSOURI
Public Service Commission

Reserved for future use

DATE OF ISSUE March 1, 1997 DATE EFFECTIVE March 10, 1997

ISSUED BY Dan M. Harmon, President Noel, Missouri **FILED**

Name of Officer

Title

Address **MAR 10 1997**

97-167

MO. PUBLIC SERVICE COMMISSION

FORM NO. 13 P.S.C. MO. NO. 3 (Original) Sheet No. 15

CANCELING P.S.C. MO. NO. 2 All Sheets (~~Original~~) Sheet No. _____

Noel Water Company For Noel, Missouri

Name of Issuing Corporation Community, Town or City FEB 21 1997

RULES AND REGULATIONS	MISSOURI Public Service Commission
<p>Rule 1 <u>DEFINITIONS</u></p> <p>(a) The "COMPANY" is Noel Water Company, Inc., acting through its officers, managers, or other duly authorized employees or agents.</p> <p>(b) The "CUSTOMER" is any person, firm, corporation or governmental body which has contracted with the Company for water service or is receiving or using service from Company, or whose facilities are connected for utilizing such service.</p> <p>(c) The word "UNIT" shall be used herein to define the standard user or property served and shall pertain to any building whether residential or commercial, owned or leased. Mobile homes or separate rental units in a multi-family structure are considered as separate units.</p> <p>(d) A "MAIN" is a pipeline which is owned and maintained by the Company, located on public property or private easement, and used to transport water throughout the Company's service area.</p> <p>(e) A "CUSTOMER'S WATER SERVICE LINE" is a pipe with appurtenances installed, owned and maintained by the customer, used to conduct water to the customer's unit from the property line or outdoor meter setting. If the property line is in a street, then the said customer's water service line shall be deemed to begin at the edge of the street abutting the customer's property.</p> <p>(f) A "SERVICE CONNECTION" is the pipeline connecting the main to the customer's water service line at the property line, or outdoor meter setting including all necessary appurtenances. This service connection shall be installed, owned and maintained by the Company. If the property line is in a street, the said service connection shall be deemed to be at the edge of the street abutting the customer's property.</p> <p>(g) The "DATE OF CONNECTION" shall be the date of the permit for installation and connection issued by the Company. In the event no permit is taken and a connection is made, the date of connection may be the date of commencement of construction of the building upon the property.</p>	

(continued on next sheet)

DATE OF ISSUE March 1, 1997 DATE EFFECTIVE March 10, 1997

ISSUED BY Dan M. Harmon, President Noel, Missouri
Name of Officer Title Address

FILED
MAR 10 1997
97-167
MO. PUBLIC SERVICE COMM

FORM NO. 13 P.S.C. MO. NO. 3 (Original) Sheet No. 16

CANCELING P.S.C. MO. NO. 2 All Sheets ~~(Original)~~ Sheet No. _____
~~(Revised)~~

Noel Water Company For Noel, Missouri **RECEIVED**

Name of Issuing Corporation Community, Town or City

FEB 27 1997

MISSOURI
Public Service Commission

- (h) The "METER SETTING" includes the meter box, meter yoke, meter, and appurtenances, all of which shall be owned and maintained by the Company.
- (i) "DEVELOPER" means any person, firm, corporation, partnership or other entity that, directly or indirectly, holds title to, or sells or leases, or offers to sell or lease, or advertises for sale or lease, any lots in a subdivision.
- (j) "SUBDIVISION" means any land in this state which is divided or proposed to be divided into two or more lots or other divisions of land, whether contiguous or not, or uniform in size or not, for the purpose of sale or lease, and includes resubdivision thereof.
- (k) "COMMISSION" means the Public Service Commission of the State of Missouri.

Rule 2 GENERAL

- (a) Every water customer, upon signing an application for any water service rendered by the Company, or upon taking of water service, shall be considered to have expressed consent to be bound by these rates, rules and regulations.
- (b) The Company's rules and regulations governing rendering of service are set forth in these numbered sheets. The rates applicable to appropriate water service or rate determination areas are set forth in rate schedules and constitute a part of these rules and regulations.
- (c) The Company reserves the right, subject to authority of the Commission, to prescribe additional rates, rules or regulations, or to alter existing rates, rules or regulations as it may from time to time deem necessary and proper.

(continued on next sheet)

DATE OF ISSUE March 1, 1997 DATE EFFECTIVE March 10, 1997

ISSUED BY Dan M. Harmon, President Noel, Missouri **FILED**
Name of Officer Title Address

FILED
MAR 10 1997
97-167
MO. PUBLIC SERVICE COMM

FORM NO. 13 P.S.C. MO. NO. 3 (Original) Sheet No. 17

CANCELING P.S.C. MO. NO. 2 All Sheets (~~Revised~~) (Original) Sheet No. _____

Noel Water Company For Noel, Missouri (~~Revised~~)

Name of Issuing Corporation Community, Town or City

RECEIVED

FEB 27 1997

MISSOURI
Public Service Commission

(d) After the effective date of these rules and regulations, all new facilities, construction contracts, and written agreements shall conform to these rules and regulations in accordance with the statutes of Missouri and authority of the Commission. Pre-existing facilities that do not comply with applicable rules and regulations may remain provided that their existence does not constitute a service problem or improper use, and reconstruction is not practical.

(e) The Customer shall furnish all easements, permits or rights of way necessary to enable the Company to supply permanent service, except where the Company's lines will lie in public property.

Rule 3 COMPANY EMPLOYEES AND CUSTOMER RELATIONS

(a) Employees or agents of the Company are expressly forbidden to demand or accept any compensation for any services rendered to its Customers except as set forth in this tariff.

(b) No employee or agent of the Company shall have the right or authority to bind it by any promise, agreement or representation contrary to the intent of these rules and regulations.

(c) No promises, agreements, or representations of any solicitor or any other employee of the Company shall be binding on the Company unless the same shall be incorporated in a written contract before the same is signed and accepted.

DATE OF ISSUE March 1, 1997 DATE EFFECTIVE March 10, 1997

ISSUED BY Dan M. Harmon, President Noel, Missouri **FILED**
Name of Officer Title Address

MAR 10 1997
97-167
MO. PUBLIC SERVICE COM.

FORM NO. 13 P.S.C. MO. NO. 3 (Original) Sheet No. 18

CANCELING P.S.C. MO. NO. 2 All Sheets (~~Revised~~) Sheet No.

Noel Water Company For Noel, Missouri **RECEIVED**
Name of Issuing Corporation Community, Town or City

FEB 27 1997

MISSOURI
Public Service Commission

Rule 4 APPLICATIONS AND CONTRACTS FOR SERVICE

(a) A written application for service, signed by the customer, stating the type of service required and accompanied by any other pertinent information, will be required from each customer before service is provided to any unit. Every customer, upon signing an application for any service rendered by the Company, or upon taking of service, shall be considered to have expressed consent to the Company's rates, rules and regulations as approved by the Commission.

(b) All applications for service shall be made in the true and legal name of the person desiring the service. In case of any violation of this provision by an applicant for service, the Company shall have the right to discontinue service to such customer after providing written notice as set forth in Rule No. 7.

(c) If service is requested at a point not already served by a main of adequate capacity, a main of adequate size shall be extended by the Company as may be necessary according to Rule No. 14.

(d) When, in order to provide the service requested, a main extension or other unusual construction or equipment expense is required, the Company may require a special contract for service. Said contract shall specify a reasonable period of time necessary to provide such service. Such contract may require a pre-payment of the Minimum Fixed Monthly Charge for the applicable rate schedule for twelve months to ensure utilization of the new facilities.

(e) Applications for a new connection shall be accompanied by the appropriate connection charge. The connection charge is due and payable in advance of the actual connection, and the Company shall be entitled to at least twenty-four hour's notice for meter installation and service line inspection.

(f) The Company may require a contract committing the customer to service for a period longer than one year when the customer's requirements for water are unusually large and require Company to invest in extra or special equipment or larger than normal piping.

DATE OF ISSUE March 1, 1997 DATE EFFECTIVE March 10, 1997

ISSUED BY Dan M. Harmon, President Noel, Missouri **FILED**
Name of Officer Title Address

MAR 10 1997

97-167

MISSOURI PUBLIC SERVICE COMMISSION

FORM NO. 13 P.S.C. MO. NO. 3 (Original) Sheet No. 19

~~(Revised)~~

CANCELING P.S.C. MO. NO. 2 All Sheets (Original) Sheet No. _____

~~(Revised)~~

Noel Water Company For Noel, Missouri

Name of Issuing Corporation Community, Town or City

RECEIVED

FEB 27 1997

Rule 5	MISSOURI Public Service Commission
INSIDE PIPING AND CUSTOMER WATER SERVICE LINES	
<p>(a) The Company will provide the Customer water service at the outdoor meter, or at the property line. Should it become necessary to place the meter at some other location, any additional expense related to the initial placement of the meter shall be borne by the Company. Separate buildings shall be served through separate service lines, except where in the Company's judgment, a group of buildings or service outlets owned by one party may be served by one water meter.</p> <p>(b) The Service Connection from the water main to the Customer's property line, the meter installation and the setting shall be installed, owned and maintained by the Company. Service line installation and maintenance from the property line or meter setting to the building shall be the responsibility of the Customer, and is subject to inspection by the Company. Customers shall be responsible for the cost of repairing any damage to the Company's lines, meters, and meter installations caused by the Customer or his agent.</p> <p>(c) Existing water service lines may be used in connecting with new buildings only when they are found on examination and test not to constitute a hazard to the health and safety of other Customers or the Company's facilities.</p> <p>(d) The Customer's water service lines shall be brought to the unit at a depth of no less than twenty-four (24) inches and, upon entering the building, shall be valved. This valve must be kept in good repair in order to shut off the water supply and drain the inside plumbing, if necessary.</p> <p>(e) The Customer's water service lines and inside piping shall be of material conforming to recognized standards for potable water service and shall have a pressure rating of at least 160 psi working pressure and have a minimum inside diameter of 3/4 of an inch.</p> <p>(f) The Company shall not install a service connection to a vacant lot.</p> <p>(g) Any change in the location of an existing service connection requested by the Customer shall be made at the Customer's expense.</p>	
(Continued on next sheet)	

DATE OF ISSUE March 1, 1997 DATE EFFECTIVE March 10, 1997

ISSUED BY Dan M. Harmon, President Noel, Missouri

Name of Officer

Title

Address

FILED

**MAR 10 1997
97-167**

MISSOURI PUBLIC SERVICE COMM

FORM NO. 13 P.S.C. MO. NO. 3 (Original) Sheet No. 20

(Revised)

CANCELING P.S.C. MO. NO. 2 All Sheets (Original) Sheet No. _____

(Revised)

Noel Water Company For Noel, Missouri

Name of Issuing Corporation Community, Town or City

RECEIVED

FEB 27 1997

MISSOURI
Public Service Commission

(h) The Company shall have the right to enter the Customer's premises for purposes of inspection to ensure compliance with these rules and regulations. The Company's representatives shall identify themselves and make these inspections only at reasonable hours, except in case of an emergency. The Company shall have the right to remove its equipment and facilities if service is no longer being provided.

(i) Neither Customer's water service lines nor the Service Connection may be extended along public streets or roadways or through property of others in connecting with the Company's mains, except where the service connection is in the water main easement in order to be connected to the main. The service connection and service line must be laid in a straight line and at right angles to the main. Any deviation from this because of physical obstruction will be at the discretion of the Company.

(j) Any customer that has a plumbing arrangement, or a water using device that could allow back siphonage of any chemical, petroleum, process water, water from a questionable supply, or other substance that could create a health hazard or damage to the water system, shall be required to install and maintain a backflow prevention device. This rule may also apply to customers on whose premises it is impossible or impractical for the company to perform a cross connection survey. The device, installation, location, and maintenance program shall be approved by the company. The Customer shall be responsible for the cost of the device, the installation, annual inspection and certification. If the Customer refuses to install the device, the Company may discontinue water service or, at the Customer's request, may install the device and place the amount of the Company's cost therefor on the next bill to the Customer. Failure of the customer to pay such charges shall be grounds for discontinuance of service.

(k) The Customer may purchase and install, at its own expense, a pressure reducing device. The Company shall have no responsibility for maintaining such device. The device is not permitted to be installed in the Company's lines. The device must be located in the customer's service line downstream of the meter.

DATE OF ISSUE March 1, 1997 DATE EFFECTIVE March 10, 1997

ISSUED BY Dan M. Harmon, President Noel, Missouri

Name of Officer Title Address

FILED

MAR 10 1997
97-167

MO. PUBLIC SERVICE COMMISSION

FORM NO. 13 P.S.C. MO. NO. 3 (Original) Sheet No. 21

CANCELING P.S.C. MO. NO. 2 All Sheets (~~Revised~~) (Original) Sheet No. _____

Noel Water Company For Noel, Missouri **RECEIVED**
Name of Issuing Corporation Community, Town or City

FEB 27 1997

MISSOURI
Public Service Commission

Rule 6 IMPROPER OR EXCESSIVE USE

- (a) No customer or his agent shall be wasteful of the water supplied to a premises by his willful action or inaction. It shall be the responsibility and duty of each Customer to maintain all piping and fixtures at his unit in a good and efficient state of repair at all times.
- (b) No customer or his agent shall make or cause to be made a cross connection between the potable water supply and any source of chemical or bacterial contamination or any water supply not approved by the Missouri Department of Natural Resources. The Company shall deny or discontinue service where Customer's Water Service Line or inside piping may, in the opinion of the Company, cause a cross connection with non-potable water or otherwise jeopardize the health and safety of other Customers or the Company's facilities.
- (c) No customer or his agent shall make or cause to be made a connection to a device that will result in excessive water demand or excessive shock, such as water-hammer, to the Company's mains.
- (d) No customer or his agent shall tamper with, remove, or willfully damage a water meter or attempt to operate the shutoff cock on the meter yoke.
- (e) No customer or his agent shall attempt to take unmetered water from the Company mains by an unauthorized tap, direct connection to service connection, by connection to a fire hydrant, or other unauthorized means.
- (f) Customers or their agents are not permitted to supply water in any way to premises other than the service address, nor to permit others to use their hose or attachments, nor leave them exposed to use by others without permission from the Company.

DATE OF ISSUE March 1, 1997 DATE EFFECTIVE March 10, 1997

ISSUED BY Dan M. Harmon, President Noel, Missouri **FILED**
Name of Officer Title Address

MAR 10 1997
97-167
MO. PUBLIC SERVICE COMMISSION

FORM NO. 13 P.S.C. MO. NO. 3 (Original) Sheet No. 22

CANCELING P.S.C. MO. NO. 2 All Sheets ~~(Original)~~ Sheet No. XXXXXX

Noel Water Company For Noel, Missouri

Name of Issuing Corporation Community, Town or City

RECEIVED

FEB 27 1997

MISSOURI
Public Service Commission

Rule 7 DISCONTINUANCE OF WATER SERVICE BY COMPANY

(a) The Company reserves the right to shut off services for any of the following reasons:

- (1) Failure to comply with these rules and regulations.
- (2) Nonpayment of utility bill (see Rule 10).
- (3) Resale or redistribution of water service.
- (4) Unauthorized interference, diversion, or water connection to Company mains.

- (5) Failure to post a security deposit or guarantee acceptable to the Company.
- (6) Failure to comply with the terms and conditions of a settlement agreement.
- (7) Misrepresentation of identity for the purpose of obtaining service.
- (8) Any condition which adversely affects the safety of the customer or other persons, or the integrity of the Company's delivery system.

(9) Pursuant to a Commission-approved agreement between the Company and a municipal sewer system or public sewer district to enforce the payment of a delinquent sewer bill.

(b) In the event that a Customer is in violation of any of these rules and regulations, the Company shall have the right to discontinue service and remove the meter.

(1) Discontinuance of service for the above-listed reasons, when no emergency exists, may occur after ten (10) days' notice to the customer if such notice is sent by first-class mail or after ninety-six (96) hours' notice if written notice is delivered in hand to the customer. The Company shall maintain an accurate record of the date of mailing or delivery of the notice.

(2) At least twenty-four (24) hours preceding a discontinuance, the Company shall make reasonable efforts to contact the customer to advise him/her of the proposed discontinuance and what steps must be taken to avoid it. Reasonable efforts shall include either a written notice following the notice provided for above, a door hanger notice, or at least two (2) phone call attempts reasonably calculated and timed to reach the customer.

(continued on next sheet)

DATE OF ISSUE March 1, 1997 DATE EFFECTIVE March 10, 1997

ISSUED BY Dan M. Harmon, President Noel, Missouri **FILED**
Name of Officer Title Address

MAR 10 1997
97-167
MO. PUBLIC SERVICE COMM

FORM NO. 13 P.S.C. MO. NO. 3 (Original) Sheet No. 23

CANCELING P.S.C. MO. NO. 2 All Sheets ~~(Original)~~ Sheet No.

Noel Water Company For Noel, Missouri
Name of Issuing Corporation Community, Town or City

RECEIVED

FEB 27 1997

MISSOURI
Public Service Commission

(3) Should Company determine such discontinuance may adversely affect the Customer's health or well-being, Company may give up to twenty-one (21) additional days of notice.

(4) In non-emergency situations, service may be discontinued between the hours of 8:00 a.m. and 4:00 p.m. on the date specified or within a reasonable time thereafter. Service shall not be discontinued on a day when utility personnel are not available to reconnect the Customer's service, or on a day immediately preceding such day.

(c) Service may be discontinued immediately without prior notice any time there is a threat to the health and welfare of other customers or a situation affecting the operation or integrity of the system causing the likelihood of major property damage to the system, the public or the customer's premises. Notice to the customer of such emergency discontinuance shall be provided by the Company as soon after the discontinuance as reasonably practical.

(d) Discontinuance of service to a unit for any reason shall not prevent the Company from pursuing any lawful remedy by action at law or otherwise for the collection of monies due from the Customer.

(e) In case the Company discontinues its service for any violation of these Rules and Regulations, then any monies due the Company shall become immediately due and payable.

(f) The Company has the right to refuse or to discontinue service to any unit to protect itself against fraud or abuse.

(g) The Company shall deal with customers and handle customer accounts in accordance with the Commission's Residential Utility Billing Practices, 4 CSR 240-13, where applicable.

DATE OF ISSUE March 1, 1997 DATE EFFECTIVE March 10, 1997

ISSUED BY Dan M. Harmon, President Noel, Missouri
Name of Officer Title Address

FILED

MAR 10 1997
97-167

MO. PUBLIC SERVICE COM

FORM NO. 13 P.S.C. MO. NO. 3 (Original) Sheet No. 24

CANCELING P.S.C. MO. NO. 2 All Sheets (~~Revised~~) (Original) Sheet No.

Noel Water Company For Noel, Missouri

Name of Issuing Corporation Community, Town or City FEB 27 1997

MISSOURI
Public Service Commission

Rule 8 DISCONTINUANCE OF WATER SERVICE AT CUSTOMER'S REQUEST

(a) Service will be discontinued at the Customer's request, by the Customer giving not less than twenty-four (24) hours notice to the Company during its regular office hours. The Company shall, at the requested time during normal business hours, read the Customer's meter. Charges for water service rendered up to and including the time of discontinuance shall be computed and will become due and payable immediately.

(b) Turn-on of water service so discontinued shall be considered new service and a new application for service shall be required, as provided in Rule 4; provided, however, that no new connection fees shall be payable except for additional service, if any, to the unit.

(c) A customer may request temporary discontinuance of service for any length of time for his own convenience; however, the customer shall still be charged the customer charge (minimum bill) during the time the service is turned off. Turn off and turn on charges are specified in the schedule of service charges.

Rule 9 INTERRUPTIONS IN SERVICE

(a) The Company reserves the right to discontinue water in its mains at any time, without notice, for making emergency repairs to the water system, well, storage, collection system, or station equipment.

(b) Whenever service is interrupted for repairs, all Customers affected by such interruptions will be notified in advance whenever it is possible to do so. Every effort will be made to minimize interruption of service.

(c) No refunds of charges for water service will be made for interruptions of service unless due to willful misconduct of the Company.

(continued on next sheet)

DATE OF ISSUE March 1, 1997 DATE EFFECTIVE March 10, 1997

ISSUED BY Dan M. Harmon, President Noel, Missouri
Name of Officer Title Address

FILED

MAR 10 1997
97-167

MO. PUBLIC SERVICE COMM

FORM NO. 13 P.S.C. MO. NO. 3 (Original) Sheet No. 25

CANCELING P.S.C. MO. NO. 2 All Sheets ~~(Original)~~ Sheet No. RECEIVED
~~(Revised)~~

Noel Water Company For Noel, Missouri
Name of Issuing Corporation Community, Town or City FEB 27 1997

MISSOURI
Public Service Commission

(d) In order to avoid exceeding the capacities of Company mains and supply facilities, the Company reserves the right, at all times, to determine the limit of and regulate in a reasonable and non-discriminatory manner, and where practical, the maximum amounts of water drawn from the Company mains.

(e) The Company shall use reasonable diligence in providing a regular and uninterrupted water supply, but in case the supply is interrupted or water escapes from the Company's facilities by reason of strike, accident, breakdown, storm, necessary repairs or reconstruction, actions of governmental authorities, or other cause not reasonably in the control of the Company, the Company shall not be liable for damages resulting from same.

Rule 10 BILLS FOR SERVICE; DEPOSITS; ESTIMATES

(a) The charges for water service shall be at the rates specified in the applicable tariffs on file with the Commission. The point of assumption of water service shall be at the property line or outdoor meter setting depending upon whichever is closer to the Customer. Service charges for turn-on of service or turn-off of service are set forth in the Schedule of Service Charges.

(b) A Customer who has made application for water service to a unit shall be held liable for all water service provided to said unit until the Customer notifies the Company in writing to discontinue service.

(c) Deposits: The Company shall have the right at lawful times to require the Customer to make a reasonable deposit, in an amount not to exceed the estimated bill for one billing period plus 30 days, to secure the prompt payment of bills. Interest at the rate of six percent (6%) per annum, payable upon return of the deposit, will be paid for the time such deposit was held by the Company unless such period of time be less than twelve (12) months. Such deposits shall be refunded at the termination of service after all charges that may be due and payable by the Customer have been paid or when the Customer has demonstrated prompt payments for service during twelve (12) consecutive billing periods
(Continued on next sheet)

DATE OF ISSUE March 1, 1997 DATE EFFECTIVE March 10, 1997

ISSUED BY Dan M. Harmon, President Noel, Missouri **FILED**
Name of Officer Title Address

MAR 10 1997
97-167
MISSOURI PUBLIC SERVICE COMMISSION

FORM NO. 13 P.S.C. MO. NO. 3 (Original) Sheet No. 26

CANCELING P.S.C. MO. NO. 2 All Sheets ~~(Original)~~ Sheet No. 26

Noel Water Company For Noel, Missouri
Name of Issuing Corporation Community, Town or City FEB 27 1997

RECEIVED

MISSOURI
Public Service Commission

and requests same. The Company may require a security deposit or other guarantee as a condition of continued service due to any of the following:

- (1) The service of the customer has been discontinued by the utility for nonpayment of a delinquent account not in dispute.
- (2) In an unauthorized manner, the customer interfered with or diverted the service of the utility situated on or about or delivered to the customer's premises.
- (3) The customer has failed to pay an undisputed bill before the delinquency date for five billing periods out of twelve consecutive billing periods.
- (d) Each Customer is responsible for furnishing the Company with his correct address. Failure to receive bills will not be considered an excuse for non-payment nor reason to permit an extension of the date when the account would be considered delinquent.
- (e) Bills and notices relating to the Company or its business will be mailed or delivered to the mailing address entered in the Customer's application unless the Company is notified in writing by the Customer of a change in address.
- (f) Payments shall be made at the office of the Company or at such other places conveniently located as may be designated by the Company or by ordinary mail. Payment must be received by the close of business on the date due.
- (g) The Company will not be bound by bills rendered under mistake of fact as to the quantity of service rendered or as a result of clerical error.
- (h) A separate bill shall be rendered for each Customer with itemization of all water service charges. Where service is rendered at more than one point of delivery for more than one class of service, each shall be billed separately.
- (i) The Company shall have the right to render bills monthly and such bills shall be due and payable to it no later than twenty-one (21) calendar days from the date of rendition.

(Continued on next sheet)

DATE OF ISSUE March 1, 1997 DATE EFFECTIVE March 10, 1997

ISSUED BY Dan M. Harmon, President Noel, Missouri
Name of Officer Title Address

FILED

MAR 10 1997
97-167
MO. PUBLIC SERVICE COMM

FORM NO. 13 P.S.C. MO. NO. 3 (Original) Sheet No. 27

CANCELING P.S.C. MO. NO. 2 All Sheets (~~Revised~~) (Original) Sheet No.

Noel Water Company For Noel, Missouri
Name of Issuing Corporation Community, Town or City FEB 27 1997

RECEIVED

MISSOURI
Public Service Commission

(j) All bills for service shall bear a due date. Bills unpaid after twenty-one (21) days from the date of rendition are delinquent and the Company, after providing the notice specified in these rules and regulations, shall have the right to discontinue all service to such delinquent Customer forthwith, and shall not be required to restore or connect any new service for such delinquent Customer until the unpaid account due the Company under these Rules and Regulations has been paid in full or arrangements satisfactory to the Company have been made to pay said account.

(k) When bills are rendered for a period of less than a complete billing period due to the connection or termination of service, the billing shall be the monthly customer charge (minimum) plus an amount based on the water used at the appropriate rate.

(l) All residential billing matters shall be handled in accordance with the Commission's specified billing practices, 4 CSR 240-13.

(m) **Estimated bills.** The Company may render a bill based upon estimated usage when extreme weather conditions, emergencies, labor disputes or work stoppages, or meter failure or destruction prevents an actual meter reading. In such a situation, the Company shall estimate the bill based upon the reading for the same month for the previous calendar year at the same location. If no such data is available, the Company may utilize the average of the previous and the subsequent month's usage. Alternatively, the Company may utilize an amount for the corresponding month from the billing history of another customer with a reasonably comparable monthly usage pattern.

1. When the Company renders an estimated bill in accordance with these procedures, it shall maintain accurate records of the reasons for the estimate and the effort made to secure an actual reading.

2. The Company shall clearly and conspicuously note on the bill that it is based on estimated usage.

DATE OF ISSUE March 1, 1997 DATE EFFECTIVE March 10, 1997

ISSUED BY Dan M. Harmon, President Noel, Missouri
Name of Officer Title Address

FILED

MAR 10 1997
97-167
MO. PUBLIC SERVICE COM

FORM NO. 13 P.S.C. MO. NO. 3 (Original) Sheet No. 28

CANCELING P.S.C. MO. NO. 2 All Sheets ~~(Original)~~ Sheet No. XXXXXX

Noel Water Company For Noel, Missouri

Name of Issuing Corporation Community, Town or City FEB 27 1997

RECEIVED

MISSOURI
Public Service Commission

Rule 11 METERS AND METER INSTALLATIONS

- (a) Except for special situations identified in the Residential Flat Rate Service rate schedule, all permanent service connections shall be metered. The Company's installed meter shall be the standard for measuring water used to determine the bill.
 - (b) All meters and meter installations shall be furnished, installed, maintained and removed by the Company and shall remain its property.
 - (c) The Company shall have the right to determine on the basis of the Customer's stated flow requirements the type and size of meter to be installed and location of same. If flow requirements increase or decrease subsequent to installation and a larger or smaller meter is requested by the Customer, the cost of installing such meter shall be paid by the Customer.
 - (d) Service to any one Customer shall be furnished through a single metering installation. Where a building is occupied by more than one tenant, the building shall be served by one meter. The Customer may rearrange piping at his own expense so as to separate the units and meter his tenants as he chooses, then divide the bill accordingly. A group of buildings or service outlets that are owned by one party may be served through one water meter when, in the Company's judgment, it is practical to do so.
 - (e) The meters and meter installations furnished by the Company shall remain its property, and the owners of premises wherein they are located shall be held responsible for their safekeeping and the carelessness of said owner, his agent, or tenant. For failure to protect same against damage, the Company may refuse to supply water until the Company is paid for such damage. The amount of the charge shall be the cost of the necessary replacement parts and the labor cost necessary to make the repair.
 - (f) The meter shall be installed at or near the Customer's property line. It shall be placed in a meter box vault constructed by the Company in accordance with its specifications. Company shall furnish and install suitable metering equipment for
- (Continued on next sheet)

DATE OF ISSUE March 1, 1997 DATE EFFECTIVE March 10, 1997

ISSUED BY Dan M. Harmon, President Noel, Missouri
Name of Officer Title Address

FILED

MAR 10 1997

97-167
MO. PUBLIC SERVICE COM.

FORM NO. 13 P.S.C. MO. NO. 3 (Original) Sheet No. 29

~~(Revised)~~

CANCELING P.S.C. MO. NO. 2 All Sheets (Original) Sheet No. _____

~~(Revised)~~

Noel Water Company For Noel, Missouri

Name of Issuing Corporation Community, Town or City

RECEIVED

FEB 27 1997

MISSOURI
Public Service Commission

each Customer except where installation in a special setting is necessary, in which case the excess cost of installation shall be paid by the Customer.

(g) The Customer shall promptly notify the Company of any defect in, or damage to, the Meter Setting.

(h) Any change in the location of any existing meter or Meter Setting at the request of the Customer shall be made at the expense of the Customer, and only with the approval of the Company.

(i) It is the responsibility of the Customer or owner of the premises to provide a location for a water meter as near as possible to the property line and which, in the event of water discharge as a result of leakage from the meter or couplings, will not result in damage to property. The Company's liability for damages to any and all property caused by such leakage shall in no event exceed the price of water service to the affected premises for one average billing period in the preceding year. Where damage is caused by the active negligence of Company personnel at the premises, this limitation shall not apply. If a customer refuses to provide an accessible location for a meter as determined by Company, the Company will notify the Public Service Commission before ultimately refusing service or proceeding to discontinue service.

DATE OF ISSUE March 1, 1997 DATE EFFECTIVE March 10, 1997

ISSUED BY Dan M. Harmon, President Noel, Missouri

Name of Officer

Title

Address

FILED

MAR 10 1997
97-167

MO. PUBLIC SERVICE COM

FORM NO. 13 P.S.C. MO. NO. 3 (Original) Sheet No. 30

CANCELING P.S.C. MO. NO. 2 All Sheets ~~(Revised)~~ (Original) Sheet No. XXXXXX ~~(Revised)~~

Noel Water Company For Noel, Missouri
Name of Issuing Corporation Community, Town or City FEB 27 1997

MISSOURI
Public Service Commission

Rule 12 METER TESTS AND TEST FEES

(a) Any customer may request the Company to make a special test of the accuracy of the meter through which water is supplied to him. This test will be made in accordance with regulations adopted by the Public Service Commission. (See Meter Test Charge in Schedule of Charges)

(b) The Company reserves the right to remove and test a meter at any time and to substitute another in its place. In case of a dispute involving a question as to the accuracy of the meter, a test will be made by the Company upon the request of the Customer without charge if the meter has not been tested within twelve (12) months preceding the requested test; otherwise, an approved charge will be made if the test indicates meter accuracy within five percent (5%) more or less.

(c) A meter test requested by the Customer may be witnessed by the Customer or his duly authorized representative, but the Customer will have to make independent arrangements to view the test at the testing facility to which the meter is shipped since the Company does not test its own meters.

(d) If a test shall show an average error of greater than five percent (5%), billings shall be adjusted as provided in Rule 13.

Rule 13 BILL ADJUSTMENTS BASED ON METER TESTS

(a) Whenever any test by the Company of a meter while in service or upon its removal from service shall show such meter to have an average error more than five percent (5%) on the test streams prescribed by the Commission, the Company shall adjust the Customer's bills by the amount of the actual average error of the meter and not the difference between the allowable error and the error as found. The period of adjustment on account of the under-registration or over-registration shall be determined as follows:

(1) Where a definite period of error can be demonstrated, the adjustment shall be made for such period.

(Continued on next sheet)

DATE OF ISSUE March 1, 1997 DATE EFFECTIVE March 10, 1997

ISSUED BY Dan M. Harmon, President Noel, Missouri
Name of Officer Title Address

FILED
MAR 10 1997
97-167
MO. PUBLIC SERVICE COMM

FORM NO. 13 P.S.C. MO. NO. 3 (Original) Sheet No. 31

CANCELING P.S.C. MO. NO. 2 All Sheets ~~(Revised)~~ (Original) Sheet No.

Noel Water Company For Noel, Missouri

Name of Issuing Corporation Community, Town or City FEB 27 1997

RECEIVED

MISSOURI
Public Service Commission

- (2) Where the period of error cannot be reasonably demonstrated, the error found shall be considered to have existed for three (3) months preceding the test.
- (b) If the meter is found on any such test to under-register, the Company may render a bill to the Customer concerned for the estimated consumption not covered by bills previously rendered during the period of inaccuracy as above outlined. Such action shall be taken only when the Company was not at fault for allowing the inaccurate meter to remain in service.
- (c) If the meter is found to register faster than allowable, the Company shall refund to the Customer concerned any overcharge caused thereby during the period of inaccuracy as above defined. Said refund may, at the Company's option, be in the form of a credit to the Customer's bill.

Rule 14 EXTENSION OF WATER MAINS

- (a) This rule shall govern the extension of the Company's water mains after the effective date hereof which are necessary to serve customers within its service area. For purposes of this rule, enlargement or expansion of existing facilities necessary for service to new customers, for which the system was not originally designed, shall be considered an extension.
- (b) When a request is made for an extension of water mains, or the Company determines that an extension must be made, the Company shall first determine the closest adequate source of water in its existing distribution system. The Company will then determine the sizes of mains needed and will make an estimate of the cost of the proposed extension. The estimate shall include "estimable costs" such as cost of pipe, valves, fittings, booster stations, storage facilities, other material, necessary reconstruction of existing facilities, construction labor, planning, supervision, inspection, engineering, insurance, tools, accounting expense and other associated direct costs. If it shall reasonably appear that the extension will cause the Company to incur income tax liability, the estimate shall also include concomitant income tax liability. An itemization of the estimate shall be available.

(Continued on next sheet)

DATE OF ISSUE March 1, 1997 DATE EFFECTIVE March 10, 1997

ISSUED BY Dan M. Harmon, President Noel, Missouri

Name of Officer Title Address

FILED

MAR 10 1997
97-167
MO. PUBLIC SERVICE COMM

FORM NO. 13 P.S.C. MO. NO. 3 (Original) Sheet No. 32

CANCELING P.S.C. MO. NO. 2 All Sheets ~~(Original)~~ Sheet No. _____

Noel Water Company For Noel, Missouri
Name of Issuing Corporation Community, Town or City

RECEIVED

FEB 27 1997

**MISSOURI
Public Service Commission**

The estimate shall not include specific amounts for "inestimable costs", i.e. those which are not readily capable of being estimated such as rock excavation, tunneling, and paving, but shall indicate that such are a possibility, and that actual amounts expended for such "inestimable costs" shall be included in the actual and final cost.

(c) If the total estimable cost is less than \$200.00, then the Company will make the extension at Company expense. If the total estimable cost is greater than \$200.00, then the Customer shall pay to the Company the amount above \$200.00 and the Company shall pay the \$200.00.

(d) Prospective customers who desire water service shall apply for service under Rule 4. One or more of the applicants, or the applicants' authorized agent, shall enter into a contract with the Company for the extension of the Company's mains.

(e) Payment of all estimable costs due the Company, as specified in the contract, shall be made prior to initiation of construction and prior to the provision of water service or the acceptance of the facilities as part of the Company system.

(f) The "estimable costs" of the Company's work set forth in the estimate shall be compared to the actual cost of the work done as soon as the work is completed and final cost is ascertained. If the estimated cost of the work in the "estimable cost" category as defined in Rule 14(b) is greater than the completed and final actual cost as ascertained by the Company's accounting department, the Company shall refund the difference within 30 days of such determination. If the completed and final actual cost of the work in the "estimable cost" category is greater than the estimate, the Company shall be responsible for those costs. Applicant(s) shall be responsible for the full payment of the actual costs of the work in the "inestimable cost" category as defined in Rule 14(b) and the applicant(s) shall pay that amount to the Company within 30 days of being billed therefor. If a refund is due from an over estimate in the "estimable costs" category, such a refund may be utilized to offset the amounts due from actual costs from the "inestimable costs" category.

(g) The Company reserves the right to further extend the main and to connect mains on intersecting streets and easements.

DATE OF ISSUE March 1, 1997 DATE EFFECTIVE March 10, 1997

ISSUED BY Dan M. Harmon, President Noel, Missouri
Name of Officer Title Address

FILED

MAR 10 1997
97-167

MO. PUBLIC SERVICE COMM

FORM NO. 13 P.S.C. MO. NO. 3 (Original) Sheet No. 33

~~(Revised)~~
CANCELING P.S.C. MO. NO. 2 All Sheets ~~(Original)~~ Sheet No. _____
~~(Revised)~~

Noel Water Company For Noel, Missouri
Name of Issuing Corporation Community, Town or City

RECEIVED

FEB 27 1997

MISSOURI
Public Service Commission

Rule 15 FIRE HYDRANTS

(a) Within the boundaries of a municipality or fire protection district, the Company will install, relocate or remove fire hydrants when required to do so by ordinance of an incorporated municipality or direction from the fire protection district. Location of such fire hydrants shall be specified by the designated official empowered to act on behalf of the municipality or fire protection district. The Company may, within its discretion, refuse to install, relocate, or remove fire hydrants if such installation, relocation, or removal is contrary to the recommendations of the Insurance Service Office which are appropriate for the insurance rating for which the municipality or fire protection district is at that time eligible, based upon all factors other than fire hydrants within the municipality or district. The Company may, within its discretion, refuse to install or relocate fire hydrants to locations where there is not an existing water main four inches or larger in diameter. The Company will not install or relocate fire hydrants on private property. Installation or relocation of fire hydrants by the Company shall be subject to the approval of all political subdivisions having or asserting jurisdiction over the installation or relocation of fire hydrants and shall comply with all published standards of such political subdivisions.

(b) Outside the boundaries of a municipality or fire protection district, the Company may install, relocate or remove fire hydrants subject to the requirements of Rule 15(a) and subject to the applicant(s) entering into a contract with the Company providing for the payment to the Company of the costs of such installation, relocation or removal. The contract shall include such conditions necessary to protect the interests of the Company and its customers.

(c) **Rental.** Outside the boundaries of a municipality or fire protection district, the Company may provide fire hydrant service. Such service shall be subject to the applicable requirements of Rule 15(a). Any rental fee shall be agreed to by Company and the applicant(s) and be subject to the approval of the Commission.

(d) Fire hydrants shall not be used by any person or persons other than those designated by the municipality or fire protection district or, in the case of Rule 15(c) situations, the applicant(s), and then such use shall be only for the legitimate purpose of extinguishing fires. Exceptions to this restriction shall be granted only upon written consent by the Company.

DATE OF ISSUE March 1, 1997 DATE EFFECTIVE March 10, 1997

ISSUED BY Dan M. Harmon, President Noel, Missouri
Name of Officer Title Address

FILED

MAR 19 1997
97-1967

MO. PUBLIC SERVICE COMM