

**LAW OFFICE**  
**WITHERS, BRANT, IGOE & MULLENNIX**

A PROFESSIONAL CORPORATION  
TWO SOUTH MAIN STREET  
LIBERTY, MISSOURI 64068

816-781-4788  
FAX 816-792-2807

CONN WITHERS (1907-1993)  
JEROME E. BRANT  
VINCENT F. IGOE, JR.  
RONALD C. MULLENNIX  
STEVEN D. WOLCOTT  
JOHN M. CROSSETT  
THOMAS C. CAPPS  
ALISON K. BLESSING\*  
MARK E. KELLY\*

MICHAEL S. SHIPLEY  
JOSEPH F. O'HARA  
NANCY A. NORTON\*\*  
SUSAN E. LONG\*  
LEIGH A. GOUCHER\*  
DUANE A. MARTIN \*

**FILED**

\* NEWLY ADMITTED IN KANSAS  
\*\* RETIRED

AUG 10 1999

August 3, 1999

Mr. Dale Hardy Roberts  
Secretary/Chief Regulatory Law Judge  
Missouri Public Service Commission  
PO Box 360  
Jefferson City, Missouri 65102

SA-2000-105

Missouri Public  
Service Commission

Re: Central Rivers Wastewater Utility, Inc./Fox Run Estates Subdivision

Dear Mr. Roberts:

Enclosed for filing on behalf of Central Rivers Wastewater Utility, Inc., please find an original and fourteen (14) copies of an Application for Certificate of Convenience for Wastewater's treatment system for the above-referenced subdivision. Would you please see that this filing is brought to the attention of the appropriate Commission personnel.

If there are any questions regarding the filing, please direct them to the undersigned. I thank you in advance for your attention to and cooperation in this matter.

Sincerely,

Mark E. Kelly

MEK/adb

Enclosures

cc: Mr. Kevin Hawthorne  
Mr. Mark Geisinger

FILED

AUG 10 1999

BEFORE THE PUBLIC SERVICE COMMISSION  
OF THE STATE OF MISSOURI

Missouri Public  
Service Commission

In the matter of the application of Central )  
Rivers Wastewater Utility, Inc., a certificate )  
of convenience and necessity authorizing it )  
to construct, install, own, operate, control, )  
manage and maintain sewer system for the )  
public, located on an unincorporated area in )  
Clay County, Missouri. )

SA-2000-105  
Case No. ~~SA-98-530~~

APPLICATION

Comes now Central Rivers Wastewater Utility, Inc. (Applicant), pursuant to Section 393.170, RSMo. (1986), and 4 CSR 240-2.060(2) and, for its application for a certificate of convenience and necessity authorizing it to construct, install, own, operate, control, manage and maintain a sewer system for the public in an unincorporated area of Clay County, Missouri, states to the Missouri Public Service Commission (Commission) as follows:

1. Applicant is a Missouri corporation duly organized and existing under the laws of the State of Missouri with its principal office and place of business located at 205 S. Spartan Drive, Richmond, Missouri 64085. A certified copy of its certificate of incorporation and articles of incorporation were filed with the Commission under previous application, namely for Case No. SA-98-530. By this Application, Applicant proposes to provide sewer service to the public as a public utility pursuant to the jurisdiction, regulation and supervision of the Commission.

2. Correspondence, communications, orders and decisions regarding this matter should be addressed to:

Mark Geisinger  
205 S. Spartan Drive  
Richmond, MO 64085  
Telephone No. (816) 470-3300

With copies to:

Kevin Hawthorne  
1114 N. Walrond  
Kansas City, MO 64120  
Telephone No. (816) 483-3888

And

Withers, Brant, Igoe & Mullennix, P.C.  
Attn: Mark Kelly  
2 South Main Street  
Liberty, MO 64068  
Telephone No. (816) 781-4788  
Fax No. (816) 792-2807

3. By this application, Applicant seeks permission, approval and a certificate of public convenience and necessity authorizing it to construct, install, own, operate, control, manage and maintain a sewer system for the public in an unincorporated area of Clay County, Missouri, as set forth on the map attached to this application as Exhibit 1 and legally described by metes and bounds attached to this application as Exhibit 2.

4. Marked as Exhibit 3A-3E, attached hereto and made a part of hereof for all purposes, is a feasibility study containing:
  - a) A narrative. (Exhibit 3A)
  - b) An overall plan for the existing STEP system and recirculating sand filter wastewater treatment system. (Exhibit 3B and Exhibit 3C)
  - c) Estimated operational cost of the facilities in the area proposed to be served including the proposed rates, charges, revenues and expenses for the estimated number of customers in the proposed area. (Exhibit 3D and Exhibit 3E)
5. There is currently one residence residing in the proposed service area. The name and address of the one residence is:

Don Schwartz  
1461 NE 147<sup>th</sup> Street  
Kearney, MO 64060

6. There are no municipalities located within the proposed areas. Applicant has complied with all known legal requirements of the Clay County Commission to operate in said county.
7. Said sewer system will meet all requirements of the Commission and the Department of Natural Resources. A copy of the operating permit from the Department of Natural Resources will be forwarded to the Commission as soon as it is available. Application for the operating permit has been made to the

Missouri Department of Natural Resources. DNR is withholding granting of the operating permit until the Company has obtained the certificate of convenience and necessity from the PSC.

8. There are no other public utilities or governmental bodies operation or rendering sewer service within the area proposed to be served.
9. The area proposed to be served is rapidly being developed into a subdivision by a developer. The majority of the soils in the subdivision are not well suited for on-site disposal systems. Therefore, a public need exists for adequate sewer service within the area proposed to be served and the public convenience and necessity will be promoted by the granting of the authority herein requested. A central collection and treatment system that is operated and maintained in a safe and orderly manner is the best suited wastewater system for this subdivision and for the Citizens of Missouri in general.
10. The granting of this application is in the public interest because it will present an opportunity for the public in the area proposed to be served to obtain and utilize sewer service which is otherwise unavailable, and make the area more attractive to develop, with the corresponding benefits of temporary and permanent jobs and, in general, better livelihood for citizens of Clay County and the State of Missouri.

WHEREFORE, Applicant respectfully requests that the Commission issue its order:

(a) Granting Applicant permission, approval and a certificate of convenience and necessity authorizing it to construct, install, own, operate, control, manage and maintain a sewer utility system for the public in an unincorporated area in Clay County, Missouri, as more particularly described herein;

(b) Granting such further relief as the commission deems appropriate.

WITHERS, BRANT, IGOE & MULLENNIX, P.C.

By: 

Mark E. Kelly #33984

Two South Main

Liberty, Missouri 64068

(816) 781-4788 Telephone

(816) 792-2807 Facsimile

ATTORNEYS FOR CENTRAL RIVERS  
WASTEWATER UTILITY, INC.

BEFORE THE PUBLIC SERVICE COMMISSION  
OF THE STATE OF MISSOURI

In the matter of the application of Central Rivers )  
Wastewater Utility, Inc., a certificate of )  
convenience and necessity authorizing it to )  
construct, install, own, operate, control, manage )  
and maintain sewer system for the public, located )  
on an unincorporated area in Clay County, Missouri. )

Case No. \_\_\_\_\_

AFFIDAVIT

STATE OF MISSOURI )  
 )  
COUNTY OF CLAY )

ss.

Mark Geisinger, of lawful age, being duly sworn upon his oath, states as follows:

1. I am the president of Central Rivers Wastewater Utility, Inc.
2. That I have reviewed the Application for an unincorporated area of Clay County, Missouri, commonly known as the Fox Run Subdivision, and the same is true and correct to the best of my knowledge.

Further affiant saith not.

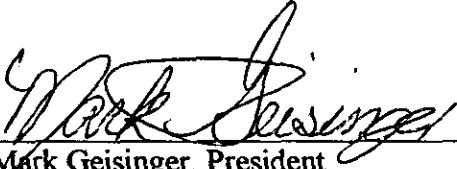
  
\_\_\_\_\_  
Mark Geisinger, President

Subscribed and sworn to before me, a Notary Public, this 5<sup>th</sup> day of August, 1999.

  
\_\_\_\_\_  
Notary Public

My Commission Expires:  
ALICIA D BATTLES  
NOTARY PUBLIC STATE OF MISSOURI  
CLAY COUNTY  
MY COMMISSION EXP. MAY 29, 2000

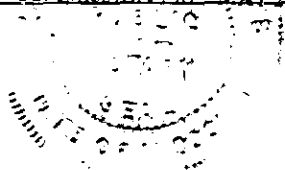
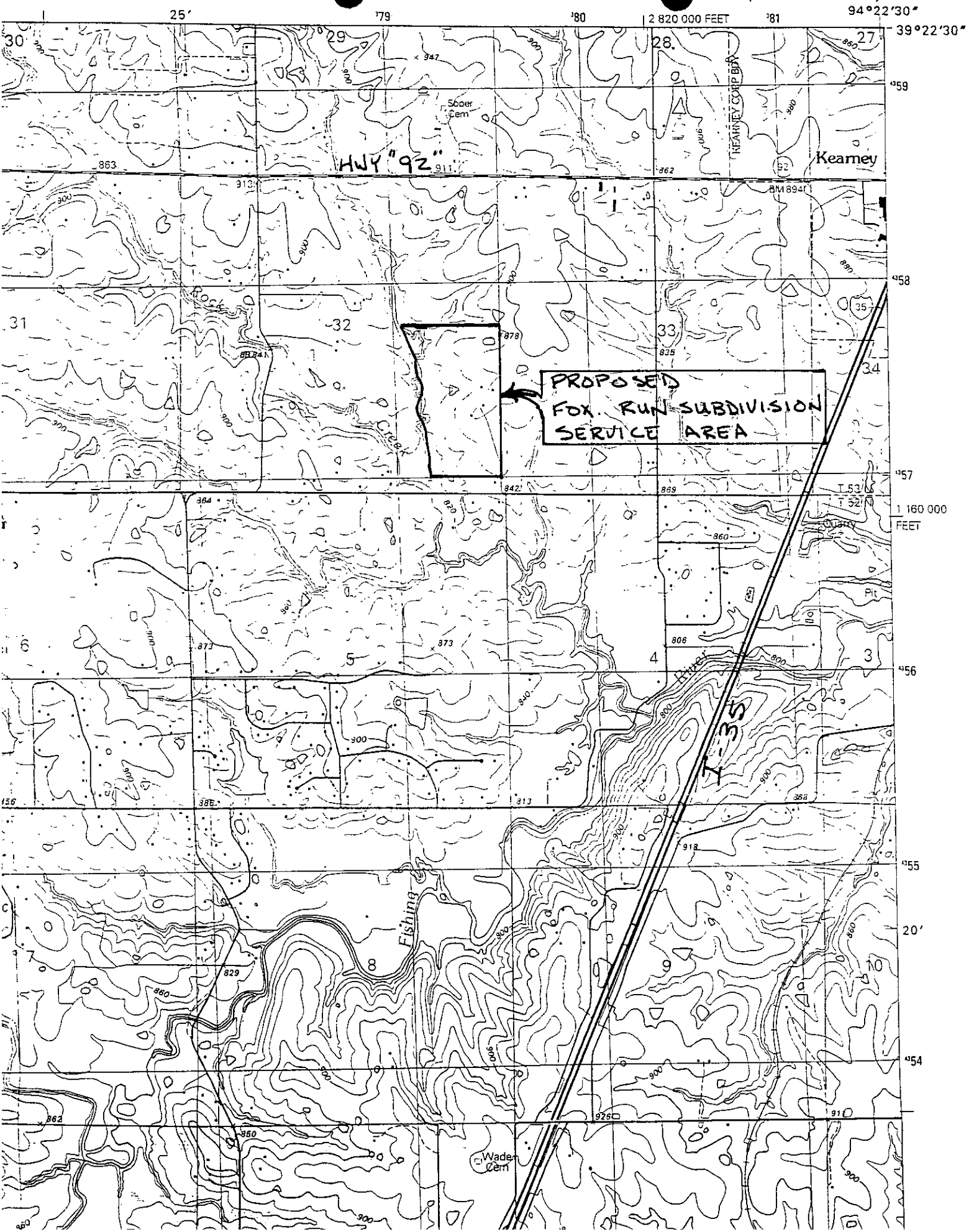

EXHIBIT 1

KEARNEY SW QUADRANGLE  
MISSOURI-CLAY CO.  
7.5-MINUTE SERIES (TOPOGRAPHIC)





# EXHIBIT 3D

## Central Rivers Wastewater Utility Rate Structure for:

Fox Run Estates Subdivision

5 year build-out (100%)

Based on serving 40 residences

Rate Base: Customer base use 40 residences (equivalent)  
 \$ 12,000 Rate base<sup>1</sup> \$300.00 rate base/customer  
 100.0% equity<sup>2</sup> and 0.0% debt<sup>2</sup>

EXPENSE ITEM					AMOUNT/MONTH	NOTES
The following values are for buildout at 90 homes. These are Pro-Forma estimates only.						See Attached Sheets
ITEM	TYPE OF SERVICE	ESTIMATED COST/HOUR	ESTIMATED AVERAGE HOURS	ESTIMATED MONTHLY COST		Yearly Hours
Billing:	CLERICAL	\$ 25.00	3.2	\$ 80.00		38.4
Paper cost	SUPPLIES	#N/A	-	\$ 5.00		-
Postage	POSTAGE	#N/A		\$ 15.05		
Filing/Miscellaneous Office	CLERICAL	\$ 25.00	1	\$ 25.00		12
Telephone/Customers	CLERICAL	\$ 25.00	1	\$ 25.00		12
Telephone/Other	CLERICAL	\$ 25.00	1	\$ 25.00		12
Operator-time	OPERATOR	\$ 40.00	10.63	\$ 425.00		127.5
Lab Services	REGULATORY	#N/A		\$ 40.00		
Treatment Plant:		#N/A				
routine maintenance	OPERATOR	\$ 40.00	0	\$ -		0
electricity	SUPPLIES	#N/A		\$ 31.00		
equipment	SUPPLIES	#N/A		\$ 30.00		
chemicals	SUPPLIES	#N/A		\$ 10.00		
water	SUPPLIES	#N/A		\$ 5.00		
Office:						
Telephone	OFFICE EQUIPMENT	#N/A		\$ 12.00		
Copies	SUPPLIES	#N/A		\$ 5.60		
Rent	RENT	#N/A		\$ 30.00		
electricity & water	UTILITIES	#N/A		\$ 5.00		
Service Area Management	MANAGEMENT	\$ 50.00	1.20	\$ 60.00		14.4
Insurance	INSURANCE	#N/A		\$ 50.00		
Legal Services	LEGAL	\$ 100.00	0.75	\$ 75.00		9
Accounting	ACCOUNTING	\$ 100.00	0.75	\$ 75.00		9
Other Professional Service	OTHER SERVICES	\$ 50.00	0.75	\$ 37.50		9
Sludge Removal	MAINTENANCE	#N/A		\$ 37.04		
Collection System Repair	MAINTENANCE	#N/A		\$ 146.67		
Emergency Repair	REPAIR	#N/A		\$ 146.67		
Depreciation	DEPRECIATION	\$ 12,000.00	4.00%	\$ 40.00		4% per year
Income tax	TAXES			\$ -		
PSC Assessment	REGULATORY			\$ -		

Operations Cost: @ 100% participation \$ 1,436.52

Operations Cost: per Customer/Month \$ 35.91

Proforma Rate for 80% build-out \$ 32.00

NOTE: costs are not linear (i.e. 80% \* cost at 100% participation is not correct) and may be slightly different than detailed itemized costs. See detailed spreadsheet for cost breakdown

Note:

Due to the anticipated rapid development of this subdivision and the anticipated granting of nearby certificated areas, a proforma rate of \$32.00/month/customer is being submitted even though calculated expenses indicate a higher rate. The Company's belief is that a \$32.00/month/customer rate for this particular subdivision due to its location and specific features will ultimately prove to be an acceptable rate for the Company and for the citizens of this subdivision in general.

Number of Customers	Owner Equity Paid to the Developer Upon Customer Hook-up to System	Return on Investment	Billing Costs			
			Billing (Clerical Time)	Billing (Paper)	Billing (Postage)	Filling/Misc. Office
1	\$ 300.00	\$ 3.00	\$ 50.00	\$ 0.50	\$ 1.05	\$ 50.00
2	\$ 600.00	\$ 6.00	\$ 50.00	\$ 0.50	\$ 1.75	\$ 50.00
3	\$ 900.00	\$ 9.00	\$ 50.00	\$ 0.50	\$ 2.10	\$ 50.00
4	\$ 1,200.00	\$ 12.00	\$ 50.00	\$ 0.50	\$ 2.45	\$ 50.00
5	\$ 1,500.00	\$ 15.00	\$ 50.00	\$ 0.63	\$ 2.80	\$ 50.00
6	\$ 1,800.00	\$ 18.00	\$ 50.00	\$ 0.75	\$ 3.15	\$ 50.00
7	\$ 2,100.00	\$ 21.00	\$ 50.00	\$ 0.88	\$ 3.50	\$ 50.00
8	\$ 2,400.00	\$ 24.00	\$ 50.00	\$ 1.00	\$ 3.85	\$ 50.00
9	\$ 2,700.00	\$ 27.00	\$ 50.00	\$ 1.13	\$ 4.20	\$ 50.00
10	\$ 3,000.00	\$ 30.00	\$ 50.00	\$ 1.25	\$ 4.55	\$ 50.00
11	\$ 3,300.00	\$ 33.00	\$ 50.00	\$ 1.38	\$ 4.90	\$ 50.00
12	\$ 3,600.00	\$ 36.00	\$ 50.00	\$ 1.50	\$ 5.25	\$ 50.00
13	\$ 3,900.00	\$ 39.00	\$ 50.00	\$ 1.63	\$ 5.60	\$ 50.00
14	\$ 4,200.00	\$ 42.00	\$ 50.00	\$ 1.75	\$ 5.95	\$ 50.00
15	\$ 4,500.00	\$ 45.00	\$ 50.00	\$ 1.88	\$ 6.30	\$ 50.00
16	\$ 4,800.00	\$ 48.00	\$ 50.00	\$ 2.00	\$ 6.65	\$ 50.00
17	\$ 5,100.00	\$ 51.00	\$ 50.00	\$ 2.13	\$ 7.00	\$ 50.00
18	\$ 5,400.00	\$ 54.00	\$ 50.00	\$ 2.25	\$ 7.35	\$ 50.00
19	\$ 5,700.00	\$ 57.00	\$ 50.00	\$ 2.38	\$ 7.70	\$ 50.00
20	\$ 6,000.00	\$ 60.00	\$ 50.00	\$ 2.50	\$ 8.05	\$ 50.00
21	\$ 6,300.00	\$ 63.00	\$ 50.00	\$ 2.63	\$ 8.40	\$ 50.00
22	\$ 6,600.00	\$ 66.00	\$ 50.00	\$ 2.75	\$ 8.75	\$ 50.00
23	\$ 6,900.00	\$ 69.00	\$ 50.00	\$ 2.88	\$ 9.10	\$ 50.00
24	\$ 7,200.00	\$ 72.00	\$ 50.00	\$ 3.00	\$ 9.45	\$ 50.00
25	\$ 7,500.00	\$ 75.00	\$ 50.00	\$ 3.13	\$ 9.80	\$ 50.00
26	\$ 7,800.00	\$ 78.00	\$ 52.00	\$ 3.25	\$ 10.15	\$ 50.00
27	\$ 8,100.00	\$ 81.00	\$ 54.00	\$ 3.38	\$ 10.50	\$ 50.00
28	\$ 8,400.00	\$ 84.00	\$ 56.00	\$ 3.50	\$ 10.85	\$ 50.00
29	\$ 8,700.00	\$ 87.00	\$ 58.00	\$ 3.63	\$ 11.20	\$ 50.00
30	\$ 9,000.00	\$ 90.00	\$ 60.00	\$ 3.75	\$ 11.55	\$ 50.00
31	\$ 9,300.00	\$ 93.00	\$ 62.00	\$ 3.88	\$ 11.90	\$ 50.00
32	\$ 9,600.00	\$ 96.00	\$ 64.00	\$ 4.00	\$ 12.25	\$ 50.00
33	\$ 9,900.00	\$ 99.00	\$ 66.00	\$ 4.13	\$ 12.60	\$ 50.00
34	\$ 10,200.00	\$ 102.00	\$ 68.00	\$ 4.25	\$ 12.95	\$ 50.00
35	\$ 10,500.00	\$ 105.00	\$ 70.00	\$ 4.38	\$ 13.30	\$ 50.00
36	\$ 10,800.00	\$ 108.00	\$ 72.00	\$ 4.50	\$ 13.65	\$ 50.00
37	\$ 11,100.00	\$ 111.00	\$ 74.00	\$ 4.63	\$ 14.00	\$ 50.00
38	\$ 11,400.00	\$ 114.00	\$ 76.00	\$ 4.75	\$ 14.35	\$ 50.00
39	\$ 11,700.00	\$ 117.00	\$ 78.00	\$ 4.88	\$ 14.70	\$ 50.00
40	\$ 12,000.00	\$ 120.00	\$ 80.00	\$ 5.00	\$ 15.05	\$ 50.00

**EXHIBIT 3E - Page 1 of 5**

**EXHIBIT 3E - Page 2 of 5**

Office Equipment & Supplies				Professional Services and Responsibilities			
Office Equipment & Supplies (Telephone)	Office Equipment & Supplies (Copies)	Office Equipment & Supplies (Rent)	Office Equipment & Supplies (Electricity & Water)	Insurance (Liability)	Legal Services	Accounting	Other Professional Services
\$ 6.00	\$ 1.00	\$ 30.00	\$ 10.00	\$ 50.00	\$ 50.00	\$ 100.00	\$ 25.00
\$ 6.00	\$ 1.00	\$ 30.00	\$ 10.00	\$ 50.00	\$ 50.00	\$ 100.00	\$ 25.00
\$ 6.00	\$ 1.00	\$ 30.00	\$ 10.00	\$ 50.00	\$ 50.00	\$ 100.00	\$ 25.00
\$ 6.00	\$ 1.00	\$ 30.00	\$ 10.00	\$ 50.00	\$ 50.00	\$ 100.00	\$ 25.00
\$ 6.00	\$ 1.00	\$ 30.00	\$ 10.00	\$ 50.00	\$ 50.00	\$ 100.00	\$ 25.00
\$ 6.00	\$ 1.00	\$ 30.00	\$ 10.00	\$ 50.00	\$ 50.00	\$ 100.00	\$ 25.00
\$ 6.00	\$ 1.00	\$ 30.00	\$ 10.00	\$ 50.00	\$ 50.00	\$ 100.00	\$ 25.00
\$ 6.00	\$ 1.12	\$ 30.00	\$ 10.00	\$ 50.00	\$ 50.00	\$ 100.00	\$ 25.00
\$ 6.00	\$ 1.26	\$ 30.00	\$ 10.00	\$ 50.00	\$ 50.00	\$ 100.00	\$ 25.00
\$ 6.00	\$ 1.40	\$ 30.00	\$ 10.00	\$ 50.00	\$ 50.00	\$ 100.00	\$ 25.00
\$ 6.00	\$ 1.54	\$ 30.00	\$ 10.00	\$ 50.00	\$ 50.00	\$ 100.00	\$ 25.00
\$ 6.00	\$ 1.68	\$ 30.00	\$ 10.00	\$ 50.00	\$ 50.00	\$ 100.00	\$ 25.00
\$ 6.00	\$ 1.82	\$ 30.00	\$ 10.00	\$ 50.00	\$ 50.00	\$ 100.00	\$ 25.00
\$ 6.00	\$ 1.96	\$ 30.00	\$ 10.00	\$ 50.00	\$ 50.00	\$ 100.00	\$ 25.00
\$ 6.00	\$ 2.10	\$ 30.00	\$ 10.00	\$ 50.00	\$ 50.00	\$ 100.00	\$ 25.00
\$ 6.00	\$ 2.24	\$ 30.00	\$ 10.00	\$ 50.00	\$ 50.00	\$ 100.00	\$ 25.00
\$ 6.00	\$ 2.38	\$ 30.00	\$ 10.00	\$ 50.00	\$ 50.00	\$ 100.00	\$ 25.00
\$ 6.00	\$ 2.52	\$ 30.00	\$ 10.00	\$ 50.00	\$ 50.00	\$ 100.00	\$ 25.00
\$ 6.00	\$ 2.66	\$ 30.00	\$ 10.00	\$ 50.00	\$ 50.00	\$ 100.00	\$ 25.00
\$ 6.00	\$ 2.80	\$ 30.00	\$ 10.00	\$ 50.00	\$ 50.00	\$ 100.00	\$ 25.00
\$ 6.00	\$ 2.94	\$ 30.00	\$ 10.00	\$ 50.00	\$ 50.00	\$ 100.00	\$ 25.00
\$ 6.00	\$ 3.08	\$ 30.00	\$ 10.00	\$ 50.00	\$ 50.00	\$ 100.00	\$ 25.00
\$ 6.00	\$ 3.22	\$ 30.00	\$ 10.00	\$ 50.00	\$ 50.00	\$ 100.00	\$ 25.00
\$ 6.00	\$ 3.36	\$ 30.00	\$ 10.00	\$ 50.00	\$ 50.00	\$ 100.00	\$ 25.00
\$ 6.00	\$ 3.50	\$ 30.00	\$ 10.00	\$ 50.00	\$ 50.00	\$ 100.00	\$ 25.00
\$ 6.00	\$ 3.64	\$ 30.00	\$ 10.00	\$ 50.00	\$ 50.00	\$ 100.00	\$ 25.00
\$ 6.00	\$ 3.78	\$ 30.00	\$ 10.00	\$ 50.00	\$ 50.63	\$ 100.00	\$ 25.31
\$ 6.00	\$ 3.92	\$ 30.00	\$ 10.00	\$ 50.00	\$ 52.50	\$ 100.00	\$ 26.25
\$ 6.00	\$ 4.06	\$ 30.00	\$ 10.00	\$ 50.00	\$ 54.38	\$ 100.00	\$ 27.19
\$ 6.00	\$ 4.20	\$ 30.00	\$ 10.00	\$ 50.00	\$ 56.25	\$ 100.00	\$ 28.13
\$ 6.00	\$ 4.34	\$ 30.00	\$ 10.00	\$ 50.00	\$ 58.13	\$ 100.00	\$ 29.06
\$ 6.00	\$ 4.48	\$ 30.00	\$ 10.00	\$ 50.00	\$ 60.00	\$ 100.00	\$ 30.00
\$ 6.00	\$ 4.62	\$ 30.00	\$ 10.00	\$ 50.00	\$ 61.88	\$ 100.00	\$ 30.94
\$ 6.00	\$ 4.76	\$ 30.00	\$ 10.00	\$ 50.00	\$ 63.75	\$ 100.00	\$ 31.88
\$ 6.00	\$ 4.90	\$ 30.00	\$ 10.00	\$ 50.00	\$ 65.63	\$ 100.00	\$ 32.81
\$ 6.00	\$ 5.04	\$ 30.00	\$ 10.00	\$ 50.00	\$ 67.50	\$ 100.00	\$ 33.75
\$ 6.00	\$ 5.18	\$ 30.00	\$ 10.00	\$ 50.00	\$ 69.38	\$ 100.00	\$ 34.69
\$ 6.00	\$ 5.32	\$ 30.00	\$ 10.00	\$ 50.00	\$ 71.25	\$ 100.00	\$ 35.63
\$ 6.00	\$ 5.46	\$ 30.00	\$ 10.00	\$ 50.00	\$ 73.13	\$ 100.00	\$ 36.56
\$ 6.00	\$ 5.60	\$ 30.00	\$ 10.00	\$ 50.00	\$ 75.00	\$ 100.00	\$ 37.50

**EXHIBIT 3E - Page 3 of 5**

STEP Unit & Collection System Maintenance			Management	Depreciation	Income Tax	Assessment
Sludge Removal from Septic Tanks	Routine & Emergency STEP Unit Maintenance	Collection System Routine Maintenance and Emergency Repair	General Service Area Management	Treatment Plant Depreciation (Replacement of Plant Based on 25 Year Life)	Income Tax	PSC Assessment @ 8.44% of Total Expenditures
\$ 0.93	\$ 7.33	\$ 17.08	\$ 50.00	\$ 40.00	\$ 0.05	\$ 7.12
\$ 1.85	\$ 14.67	\$ 17.08	\$ 50.00	\$ 40.00	\$ 0.09	\$ 7.18
\$ 2.78	\$ 22.00	\$ 17.08	\$ 50.00	\$ 40.00	\$ 0.14	\$ 7.24
\$ 3.70	\$ 29.33	\$ 17.08	\$ 50.00	\$ 40.00	\$ 0.18	\$ 7.30
\$ 4.63	\$ 36.67	\$ 17.08	\$ 50.00	\$ 40.00	\$ 0.23	\$ 7.37
\$ 5.56	\$ 44.00	\$ 17.08	\$ 50.00	\$ 40.00	\$ 0.27	\$ 7.43
\$ 6.48	\$ 51.33	\$ 17.08	\$ 50.00	\$ 40.00	\$ 0.32	\$ 7.49
\$ 7.41	\$ 58.67	\$ 17.08	\$ 50.00	\$ 40.00	\$ 0.36	\$ 7.55
\$ 8.33	\$ 66.00	\$ 17.08	\$ 50.00	\$ 40.00	\$ 0.41	\$ 7.61
\$ 9.26	\$ 73.33	\$ 17.08	\$ 50.00	\$ 40.00	\$ 0.45	\$ 7.68
\$ 10.19	\$ 80.67	\$ 17.08	\$ 50.00	\$ 40.00	\$ 0.50	\$ 7.74
\$ 11.11	\$ 88.00	\$ 17.08	\$ 50.00	\$ 40.00	\$ 0.54	\$ 7.80
\$ 12.04	\$ 95.33	\$ 17.08	\$ 50.00	\$ 40.00	\$ 0.59	\$ 7.86
\$ 12.96	\$ 102.67	\$ 17.08	\$ 50.00	\$ 40.00	\$ 0.63	\$ 7.93
\$ 13.89	\$ 110.00	\$ 17.08	\$ 50.00	\$ 40.00	\$ 0.68	\$ 7.99
\$ 14.81	\$ 117.33	\$ 17.08	\$ 50.00	\$ 40.00	\$ 0.72	\$ 8.05
\$ 15.74	\$ 124.67	\$ 17.08	\$ 50.00	\$ 40.00	\$ 0.77	\$ 8.11
\$ 16.67	\$ 132.00	\$ 17.08	\$ 50.00	\$ 40.00	\$ 0.81	\$ 8.18
\$ 17.59	\$ 139.33	\$ 17.08	\$ 50.00	\$ 40.00	\$ 0.86	\$ 8.24
\$ 18.52	\$ 146.67	\$ 17.08	\$ 50.00	\$ 40.00	\$ 0.90	\$ 8.30
\$ 19.44	\$ 154.00	\$ 17.08	\$ 50.00	\$ 40.00	\$ 0.95	\$ 8.37
\$ 20.37	\$ 161.33	\$ 17.08	\$ 50.00	\$ 40.00	\$ 0.99	\$ 8.43
\$ 21.30	\$ 168.67	\$ 17.08	\$ 50.00	\$ 40.00	\$ 1.04	\$ 8.50
\$ 22.22	\$ 176.00	\$ 17.08	\$ 50.00	\$ 40.00	\$ 1.08	\$ 8.57
\$ 23.15	\$ 183.33	\$ 17.08	\$ 50.00	\$ 40.00	\$ 1.13	\$ 8.63
\$ 24.07	\$ 190.67	\$ 17.08	\$ 50.00	\$ 40.00	\$ 1.17	\$ 8.72
\$ 25.00	\$ 198.00	\$ 17.08	\$ 50.00	\$ 40.00	\$ 1.22	\$ 8.80
\$ 25.93	\$ 205.33	\$ 17.08	\$ 50.00	\$ 40.00	\$ 1.26	\$ 8.90
\$ 26.85	\$ 212.67	\$ 17.08	\$ 50.00	\$ 40.00	\$ 1.31	\$ 9.00
\$ 27.78	\$ 220.00	\$ 34.17	\$ 50.00	\$ 40.00	\$ 1.35	\$ 9.22
\$ 28.70	\$ 227.33	\$ 34.17	\$ 50.00	\$ 40.00	\$ 1.40	\$ 9.33
\$ 29.63	\$ 234.67	\$ 34.17	\$ 50.00	\$ 40.00	\$ 1.44	\$ 9.43
\$ 30.56	\$ 242.00	\$ 34.17	\$ 50.00	\$ 40.00	\$ 1.49	\$ 9.53
\$ 31.48	\$ 249.33	\$ 34.17	\$ 50.00	\$ 40.00	\$ 1.53	\$ 9.64
\$ 32.41	\$ 256.67	\$ 34.17	\$ 50.00	\$ 40.00	\$ 1.58	\$ 9.81
\$ 33.33	\$ 264.00	\$ 34.17	\$ 50.00	\$ 40.00	\$ 1.62	\$ 9.99
\$ 34.26	\$ 271.33	\$ 34.17	\$ 50.00	\$ 40.00	\$ 1.67	\$ 10.16
\$ 35.19	\$ 278.67	\$ 34.17	\$ 50.00	\$ 40.00	\$ 1.71	\$ 10.34
\$ 36.11	\$ 286.00	\$ 34.17	\$ 50.00	\$ 40.00	\$ 1.76	\$ 10.51
\$ 37.04	\$ 293.33	\$ 34.17	\$ 50.00	\$ 40.00	\$ 1.80	\$ 10.69

**EXHIBIT 3E - Page 4 of 5**

Cost of Operation of Wastewater Collection and Treatment System/Month	Cost per Month per EDU	Number of Customers	Rate/Month/ Customer Estimate
\$ 1,019.56	\$ 1,019.56	1	\$ 32.00
\$ 1,028.63	\$ 514.31	2	\$ 32.00
\$ 1,037.34	\$ 345.78	3	\$ 32.00
\$ 1,046.05	\$ 261.51	4	\$ 32.00
\$ 1,054.90	\$ 210.98	5	\$ 32.00
\$ 1,063.74	\$ 177.29	6	\$ 32.00
\$ 1,072.58	\$ 153.23	7	\$ 32.00
\$ 1,081.54	\$ 135.19	8	\$ 32.00
\$ 1,090.52	\$ 121.17	9	\$ 32.00
\$ 1,099.50	\$ 109.95	10	\$ 32.00
\$ 1,108.48	\$ 100.77	11	\$ 32.00
\$ 1,117.47	\$ 93.12	12	\$ 32.00
\$ 1,126.45	\$ 86.65	13	\$ 32.00
\$ 1,135.43	\$ 81.10	14	\$ 32.00
\$ 1,144.41	\$ 76.29	15	\$ 32.00
\$ 1,153.39	\$ 72.09	16	\$ 32.00
\$ 1,162.37	\$ 68.37	17	\$ 32.00
\$ 1,171.36	\$ 65.08	18	\$ 32.00
\$ 1,180.34	\$ 62.12	19	\$ 32.00
\$ 1,189.32	\$ 59.47	20	\$ 32.00
\$ 1,198.93	\$ 57.09	21	\$ 32.00
\$ 1,208.54	\$ 54.93	22	\$ 32.00
\$ 1,218.15	\$ 52.96	23	\$ 32.00
\$ 1,227.76	\$ 51.16	24	\$ 32.00
\$ 1,237.37	\$ 49.49	25	\$ 32.00
\$ 1,249.00	\$ 48.04	26	\$ 32.00
\$ 1,261.57	\$ 46.72	27	\$ 32.00
\$ 1,276.03	\$ 45.57	28	\$ 32.00
\$ 1,290.48	\$ 44.50	29	\$ 32.00
\$ 1,322.14	\$ 44.07	30	\$ 32.00
\$ 1,336.60	\$ 43.12	31	\$ 32.00
\$ 1,351.06	\$ 42.22	32	\$ 32.00
\$ 1,365.52	\$ 41.38	33	\$ 32.00
\$ 1,381.23	\$ 40.62	34	\$ 32.00
\$ 1,406.39	\$ 40.18	35	\$ 32.00
\$ 1,431.55	\$ 39.77	36	\$ 32.00
\$ 1,456.70	\$ 39.37	37	\$ 32.00
\$ 1,481.86	\$ 39.00	38	\$ 32.00
\$ 1,507.02	\$ 38.64	39	\$ 32.00
\$ 1,532.18	\$ 38.30	40	\$ 32.00

**EXHIBIT 3E - Page 5 of 5**

EXHIBIT 3A

**FEASIBILITY STUDY**

For

**WASTEWATER COLLECTION AND TREATMENT SYSTEM**

at

***FOX RUN ESTATES SUBDIVISION***

**CLAY COUNTY, MISSOURI**

by

**CENTRAL RIVERS WASTEWATER UTILITY, INC.  
205 S. Spartan  
Richmond, MO 64085**



## Background

The rural areas of the rapidly developing Kansas City metropolitan region have been growing as more and more people find that the area offers many benefits and high quality of life. As this metropolitan area has developed and grown, wastewater treatment for these developments has become a primary concern. Due to soils that are not well suited for on-site wastewater disposal systems and higher density, central wastewater collection and treatment that is well operated and maintained has become a growing need. However, economic factors make a single large scale central collection and treatment facility in outlying subdivisions and communities impractical. Sound technological advances in how wastewater is collected and treated lead to a more practical approach. Cluster type treatment and collections systems, each serving a single subdivision or small group of subdivisions can be economically installed and economically maintained and can provide high quality wastewater treatment. Quality installation, operation and maintenance are essential for this type of system to consistently produce safe and effective wastewater treatment. Therefore, operation and maintenance should be handled by professionals that are well trained and have financial incentives to provide safe wastewater treatment facilities. The operation and maintenance authority should also be well regulated to ensure that the public good is served. A Missouri Public Service regulated private utility company is very well suited for this approach.

Central Rivers Wastewater Utility, Inc., upon final approval of its Tariff currently under review by the Missouri Public Service Commission, will maintain and operate a central wastewater collection and treatment facility in Ray County, Missouri (Case No. SA-98-530). Central Rivers Wastewater Utility, Inc. is also planning to provide wastewater treatment and collection system operation and maintenance for a new subdivision currently being developed in Clay County, Missouri. The new subdivision is known as Fox Estates Subdivision.

### Purpose of serving Fox Run Estates Subdivision

Due to experience Central Rivers Wastewater Utility, Inc. is well suited to provide an operation and maintenance authority for this subdivision. The company can provide dependable wastewater collection and treatment service for this subdivision at a reasonable cost while at the same time provide a financial incentive to the owners of the company.

### Financing

Costs to provide engineering documents necessary to obtain a Missouri Department of Natural Resources Construction Permit will be paid by the subdivision developer. The developer has paid to install the collection system's main collection lines. The developer has also paid for initial costs for the installation of the wastewater treatment facility.

Central Rivers Wastewater Utility, Inc. will reimburse the developer \$300 for each customer that takes service from Central Rivers Wastewater Utility, Inc.

The \$300 investment by this utility will be financed through \$300 equity. The rate of return on the equity investment is 10%. This rate is recommended based on current money market conditions. The company realizes that final interest and equity return rates must be approved by the Missouri Public Service Commission.

A contract between the subdivision developer and the utility in which the developer has agreed to fund the difference between revenue collected through rates and the required revenue has been signed and agreed upon by both parties. The developer has obtained an Irrevocable Letter of Credit from a reputable bank that the utility company will draw upon if the developer, for any reason, is unable or unwilling to pay the agreed upon difference. This agreement ensures that utility company will have sufficient revenue to operate the wastewater collection and treatment system in the initial stages of the development.

### Plan

A map of the area is attached to the company's application. On the map is a layout of the collection system and treatment plant location. Wastewater from the homes will initially be collected in 1,500 gallon septic tanks located near the residence. The effluent will be screened and pumped into a force main that eventually will tie into the treatment facility. A second

phase of the treatment plant is planned to be installed when sewage flows require. The treatment plant has been constructed to meet Department of Natural Resources administered regulations and will be expanded as necessary to continue to do so.

### Customers

There are currently no customers within the proposed service area. The newly constructed homes will each have an individual 1,500 gallon watertight septic tank located near the residence but within an easement granted to the utility company. The subdivision plan is to have approximately 40 homes when completely developed. All of the customers will be single family residences. It is anticipated that at least 60% of the customers will be connected within 5 years.

### System Construction

The collection system has been constructed and is existing. The first phase recirculating sand filter has been constructed and is existing. Plans prepared by a professional engineer registered in the State of Missouri are on file at the Missouri Department of Natural Resources.

### Operation

The management of the company will be furnished by the owners, Mr. Mark Geisinger and Mr. Kevin Hawthorne. The company will contract with Accurate Boring and Construction, Inc. for service calls and treatment plant operation and maintenance of this facility. Billing will be done on a contract basis and time sheets will be maintained for the purpose of determining cost tot he utility.

The utility company will keep in stock a new pump and controls for the residential pumping installation as well as repairable parts. One pump of each make will be kept for each fifty customers it has on the force main sewer system. The company will inspect the customer's pumping facilities once per year to assure that they are functioning properly. All maintenance will be provided by the utility company. The company will also replace the customer's pump and controls, as well as repairable parts, when necessary as part of the rate structure provided the customer does not purposefully or willfully cause intentional harm to the system through negligence or sabotage.

### Tariff and Rules

The company's Tariff will be amended to include a service area that includes this subdivision. The rules governing the customers' responsibilities and the company's responsibilities will be those filed with its Tariff and approved by the Missouri Public Service Commission.

The base single family wastewater rate will likely be \$32.00/month. This rate is consistent with other similar wastewater collection and treatment facilities and reasonable for the area.

### Conclusion

The proposed services by Central Rivers Wastewater Utility, Inc. for this proposed subdivision is feasible because the rates are within an acceptable range for this area and the style of homes to be constructed. The agreement between the developer and the company satisfies the financial obligation the company will need to remain viable until several customers are connected. By providing this service the developer is better able to market the lots in the subdivision and the County and subdivision are benefited by increased temporary and permanent jobs and better and safer overall living conditions for the residents.

# Non-Scannable Maps

(Can be viewable in the Data Center)

## EXHIBIT 2

LEGAL DESCRIPTION: All that part of the Southeast Quarter of Section 32, Township 53, Range 31 in Clay County, Missouri described as follows: Beginning at the Southeast corner of the Southeast Quarter of said Section 32; thence North 89 degrees 45 minutes 16 seconds West along the South line of the Southeast Quarter of said Section 32, a distance of 50.00 feet; thence North 00 degrees 08 minutes 21 seconds West, a distance of 208.71 feet; thence North 89 degrees 45 minutes 16 seconds West, a distance of 208.71 feet; thence South 00 degrees 08 minutes 21 seconds East, a distance of 208.71 feet to a point on the South line of the Southeast Quarter of said Section 32; thence North 89 degrees 45 minutes 16 seconds West along the South line of the Southeast Quarter of said Section 32, a distance of 1024.48 feet; thence North 00 degrees 57 minutes 15 seconds West, a distance of 944.34 feet; thence North 50 degrees 12 minutes 27 seconds West, a distance of 160.72 feet; thence North 26 degrees 06 minutes 49 seconds West, a distance of 115.00 feet; thence North 21 degrees 34 minutes 02 seconds East, a distance of 196.46 feet; thence North 13 degrees 11 minutes 28 seconds East, a distance of 88.35 feet; thence North 78 degrees 19 minutes 20 seconds East, a distance of 287.04 feet; thence Northwesterly along a curve to the right, having an initial tangent bearing of North 78 degrees 15 minutes 28 seconds West and a radius of 480.00 feet, an arc distance of 4.86 feet; thence North 11 degrees 40 minutes 40 seconds West, a distance of 87.22 feet; thence North 78 degrees 19 minutes 20 seconds East, a distance of 285.00 feet; thence North 57 degrees 31 minutes 40 seconds East, a distance of 195.14 feet; thence South 11 degrees 40 minutes 40 seconds East, a distance of 331.84 feet; thence North 64 degrees 48 minutes 34 seconds East, a distance of 213.17 feet; thence North 00 degrees 09 minutes 34 seconds West, a distance of 133.92 feet; thence South 80 degrees 28 minutes 55 seconds East, a distance of 416.71 feet to a point on the East line of the Southeast Quarter of said Section 32; thence South 00 degrees 08 minutes 21 seconds East along the East line of the Southeast Quarter of said Section 32, a distance of 1566.06 feet to the Point of Beginning. Said tract of land contains 46.71 acres more or less.