

**Otelco Mid-Missouri LLC
P.S.C. MO. No. 1 Consolidated**

No supplement to this tariff will be issued except for the purpose of canceling this tariff.

Section 1
8th Revised Sheet 1
Canceling 7th Revised Sheet 1

LOCAL EXCHANGE SERVICE

GENERAL

Unless otherwise specified, the charges quoted in this tariff are for one month and entitle the subscriber to an access line and messages to all stations within the calling scope of the exchanges as listed on Sheet 3.

Rates:

Touch Button Access Line:

Business One Party	\$23.00 +
Residence One Party	\$18.00 +
Trunk	\$27.30 +

When any municipality imposes upon the Company any license, occupation, or other similar charge or tax applicable to service by the Company to the customer, or imposes a charge or tax based upon a percentage of gross receipts, net receipts, or other revenues from sale of telephone service by the Company, the charges for local service to customers within such municipality shall be increased by an amount equal to each such customer's proportionate part of any such charge or tax, and such amount shall be shown separately on the customer's bill.

See Missouri School Discount Program, Section 1, 2nd Revised Sheet 2 Canceling 1st Revised Sheet 2

*Indicates New Rate
+Indicates Change

ISSUED: April 28, 2016

EFFECTIVE: June 1, 2016

BY: Todd Wessing, Vice-President & General Manager
215 Roe Street
P O Box 38
Pilot Grove, Missouri

CANCELLED
June 1, 2018
Missouri Public
Service Commission
JI-2018-0144

FILED
Missouri Public
Service Commission
JI-2016-0293

**Otelco Mid-Missouri LLC
P.S.C. MO. No. 1 Consolidated**

No supplement to this tariff will be issued except for the purpose of canceling this tariff.

Section 1
7th Revised Sheet 1
Canceling 6th Revised Sheet 1

LOCAL EXCHANGE SERVICE

GENERAL

Unless otherwise specified, the charges quoted in this tariff are for one month and entitle the subscriber to an access line and messages to all stations within the calling scope of the exchanges as listed on Sheet 3.

Rates:

Touch Button Access Line:

Business One Party	\$20.85 +
Residence One Party	\$16.00 +
Trunk	\$25.30 +

When any municipality imposes upon the Company any license, occupation, or other similar charge or tax applicable to service by the Company to the customer, or imposes a charge or tax based upon a percentage of gross receipts, net receipts, or other revenues from sale of telephone service by the Company, the charges for local service to customers within such municipality shall be increased by an amount equal to each such customer's proportionate part of any such charge or tax, and such amount shall be shown separately on the customer's bill.

See Missouri School Discount Program, Section 1, 2nd Revised Sheet 2 Canceling 1st Revised Sheet 2

*Indicates New Rate
+Indicates Change

ISSUED: October 17, 2014

EFFECTIVE: December 1, 2014

CANCELLED
June 1, 2016
Missouri Public
Service Commission
JI-2016-0293

BY: Todd Wessing, Vice-President & General Manager
215 Roe Street
P O Box 38
Pilot Grove, Missouri

FILED
Missouri Public
Service Commission
JI-2015-0169

**Otelco Mid-Missouri LLC
P.S.C. MO. No. 1 Consolidated**

No supplement to this tariff will be issued except for the purpose of canceling this tariff.

Section 1
6th Revised Sheet 1
Canceling 5th Revised Sheet 1

LOCAL EXCHANGE SERVICE

GENERAL

Unless otherwise specified, the charges quoted in this tariff are for one month and entitle the subscriber to an access line and messages to all stations within the calling scope of the exchanges as listed on Sheet 3.

Rates:

Touch Button Access Line:

Business One Party	\$18.85 +
Residence One Party	\$14.00 +
Trunk	\$23.30 +

When any municipality imposes upon the Company any license, occupation, or other similar charge or tax applicable to service by the Company to the customer, or imposes a charge or tax based upon a percentage of gross receipts, net receipts, or other revenues from sale of telephone service by the Company, the charges for local service to customers within such municipality shall be increased by an amount equal to each such customer's proportionate part of any such charge or tax, and such amount shall be shown separately on the customer's bill.

See Missouri School Discount Program, Section 1, 2nd Revised Sheet 2 Canceling 1st Revised Sheet 2

*Indicates New Rate
+Indicates Change

ISSUED: April 19, 2013

EFFECTIVE: June 1, 2013

BY: Todd Wessing, Vice-President & General Manager
215 Roe Street
P O Box 38
Pilot Grove, Missouri

CANCELED
December 1, 2014
Missouri Public
Service Commission
JI-2015-0169

FILED
Missouri Public
Service Commission
JI-2013-0461

Otelco Mid-Missouri LLC
P.S.C. MO. No. 1 Consolidated

No supplement to this
tariff will be issued except
for the purpose of
canceling this tariff.

Section 1
5th Revised Sheet 1
Canceling 4th Revised Sheet 1

LOCAL EXCHANGE SERVICE

GENERAL

Unless otherwise specified, the charges quoted in this tariff are for one month and entitle the subscriber to an access line and messages to all stations within the calling scope of the exchanges as listed on Sheet 3.

Rates:

Touch Button Access Line:

Business One Party	\$14.85 +
Residence One Party	\$10.00 +
Trunk	\$19.30

When any municipality imposes upon the Company any license, occupation, or other similar charge or tax applicable to service by the Company to the customer, or imposes a charge or tax based upon a percentage of gross receipts, net receipts, or other revenues from sale of telephone service by the Company, the charges for local service to customers within such municipality shall be increased by an amount equal to each such customer's proportionate part of any such charge or tax, and such amount shall be shown separately on the customer's bill.

See Missouri School Discount Program, Section 1, 2nd Revised Sheet 2 Canceling 1st Revised Sheet 2

*Indicates New Rate
+Indicates Change

ISSUED: May 1, 2012

EFFECTIVE: June 1, 2012

BY: Todd Wessing, President
215 Roe Street
P O Box 38
Pilot Grove, Missouri

FILED
Missouri Public
Service Commission
JI-2012-0638

CANCELLED
June 1, 2013
Missouri Public
Service Commission
JI-2013-0461

P.S.C. Mo. No. 1 Consolidated

No supplement to this tariff will be issued except for the purpose of canceling this tariff.

Section 1
4th Revised Sheet 1
Canceling 3rd Revised Sheet 1
For All Missouri Exchanges +

LOCAL EXCHANGE SERVICE

Missouri Public Service Commission

REC'D MAY 21 1999

GENERAL

Unless otherwise specified, the charges quoted in this tariff are for one month and entitle the subscriber to an access line and messages to all stations within the calling scope of the exchanges as listed on Sheet 3.

Rates:

+Touch Button Access Line:

Business One Party	\$12.85
Residence One Party	8.00
Trunk	19.30

When any municipality imposes upon the Company any license, occupation, or other similar charge or tax applicable to service by the Company to the customer, or imposes a charge or tax based upon a percentage of gross receipts, net receipts, or revenues from sale of telephone service by the Company, the charges for local service to customers within such municipality shall be increased by an amount equal to each such customer's proportionate part of any such charge or tax, and such amount shall be shown separately on the customer's bill.

See Missouri School Discount Program, Section 1, 2nd Revised Sheet 2 Canceling 1st Revised Sheet 2

*Indicates New Rate
+Indicates Change

Missouri Public Service Commission
98-343
FILED JUN 15 1999

ISSUED: May 21, 1999

EFFECTIVE: [REDACTED]

By Harold A. Jones, Manager
MID-MISSOURI TELEPHONE COMPANY
Pilot Grove, Missouri

JUN 15 1999

CANCELED
June 1, 2012
Missouri Public Service Commission
JI-2012-0638

P.S.C. Mo. No. 1 Consolidated

No supplement to this tariff will be issued except for the purpose of canceling this tariff.

Section 1
3rd Revised Sheet
Cancelling 2nd Revised Sheet 1

RECEIVED

NOV 7 1996

LOCAL EXCHANGE SERVICE

MISSOURI
Public Service Commission

GENERAL

Unless otherwise specified, the charges quoted in this tariff are for one month and entitle the subscriber to an access line and messages to all stations within the calling scope of the exchanges as listed on Sheet 3.

Rates:

Rotary Dial Access Line:

Business One Party	\$12.85+
Residence One Party	8.00
Trunk	19.30

When any municipality imposes upon the Company any license, occupation, or other similar charge or tax applicable to service by the Company to the customer, or imposes a charge or tax based upon a percentage of gross receipts, net receipts, or revenues from sale of telephone service by the Company, the charges for local service to customers within such municipality shall be increased by an amount equal to each such customer's proportionate part of any such charge or tax, and such amount shall be shown separately on the customer's bill.

+See Missouri School Discount Program, Section 1, 2nd Revised Sheet 2 Cancelling 1st Revised Sheet 2

CANCELLED

JUN 15 1999
By *4hRS*
Public Service Commission
MISSOURI

FILED

JAN 01 1997

*Indicates New Rate
+Indicates Change

MO. PUBLIC SERVICE COMM

ISSUED: 11-7-96

EFFECTIVE: 01-01-97

By Harold A. Jones, Manager
MID-MISSOURI TELEPHONE COMPANY
Pilot Grove, Missouri

P.S.C. Mo. No. 1 Consolidated

RECEIVED

No supplement to this tariff will be issued except for the purpose of canceling this tariff.

Section 1
2nd Revised Sheet 1
Cancelling 1st Revised Sheet 1

MISSOURI

LOCAL EXCHANGE SERVICE

Public Service Commission

GENERAL*

Unless otherwise specified, the charges quoted in this tariff are for one month and entitle the subscriber to an access line and messages to all stations within the calling scope of the exchanges as listed on Sheet 3.

Rates:

Rotary Dial Access Line:

Business One Party	\$12.85
Residence One Party	8.00
Trunk	19.30

*When any municipality imposes upon the Company any license, occupation, or other similar charge or tax applicable to service by the Company to the customer, or imposes a charge or tax based upon a percentage of gross receipts, net receipts, or revenues from sale of telephone service by the Company, the charges for local service to customers within such municipality shall be increased by an amount equal to each such customer's proportionate part of any such charge or tax, and such amount shall be shown separately on the customer's bill.

CANCELLED

JAN -1 1957
BY 3rd R.S.
Public Service Commission
MISSOURI

JAN 01 1988
Public Service Commission

*Indicates new rate
+Indicates Change

ISSUED:

DEC 1 1987

EFFECTIVE:

JAN 1 1988

By Harold A. Jones, Manager
MID-MISSOURI TELEPHONE COMPANY
Pilot Grove, Missouri

P.S.C. Mo. No. 1 Consolidated

No supplement to this tariff will be issued except for the purpose of canceling this tariff.

Section 1
1st Revised Sheet 1
Cancelling Original Sheet 1

RECEIVED

LOCAL EXCHANGE SERVICE

+GENERAL

Unless otherwise specified, the charges quoted in this tariff are for one month and entitle the subscriber to an access line and messages to all stations within the calling scope of the exchanges as listed on Sheet 3.

JUL 27 1981
PUBLIC SERVICE COMMISSION

Rates:

Rotary Dial Access Line:

Business One Party	\$12.85
Residence One Party	8.00

CANCELLED

JAN 01 1988

BY 2nd R.S. #1
PUBLIC SERVICE COMMISSION
OF MISSOURI

+When any municipality imposes upon the Company any license, occupation, or other similar charge or tax applicable to service by the Company to the customer, or imposes a charge or tax based upon a percentage of gross receipts, net receipts, or revenues from sale of telephone service by the Company, the charges for local service to customers within such municipality shall be increased by an amount equal to each such customer's proportionate part of any such charge or tax, and such amount shall be shown separately on the customer's bill.

⊕ ACCESS LINE RATES do not include the charge for telephone instruments. The charge for instruments is set out elsewhere in the Tariff.

*Indicates new rate
+Indicates Change

FILED
AUG - 1 1981
81 - 169

ISSUED: July 24, 1981

EFFECTIVE: August 1, 1981

By Harold A. Jones, Manager
MID-MISSOURI TELEPHONE COMPANY
Pilot Grove, Missouri

No supplement to this tariff will be issued except for the purpose of canceling this tariff.

Section 1
Original Sheet 1

LOCAL EXCHANGE TARIFFS INDEX

RECEIVED
JAN 25 1977
MISSOURI
Public Service Commission

Arrow Rock

Local Rates

Maps

Exchange Area

5.1

Base Rate Area

5.2

Blackwater

Local Rates

6

Maps

Exchange Area

6.1

Base Rate Area

6.2

Bunceton

Local Rates

7

Maps

Exchange Area

7.1

Base Rate Area

7.2

Fortuna

Local Rates

Maps

Exchange Area

Base Rate Area

FILED⁸
MAR 1 1977
Public Service Commission

*Indicates new rate

+Indicates Change

ISSUED: January 26, 1977

EFFECTIVE: March 1, 1977

By Harold A. Jones, Manager
MID-MISSOURI TELEPHONE COMPANY
Pilot Grove, Missouri

CANCELLED
AUG -1 1981
BY *RS*
PUBLIC SERVICE COMMISSION
OF MISSOURI

**Otelco Mid-Missouri LLC
PSC Mo No 1 Consolidated**

No supplement to this
tariff will be issued
except for the purpose
of canceling this tariff

Section 1
6th Revised Sheet 1.2
Canceling 5th Revised Sheet 1.2

LOCAL EXCHANGE SERVICE

LIFELINE AND DISABLED PROGRAMS+

A. General Regulations

1. Lifeline and Disabled service is a discounted voice telephony service available to qualifying residential subscribers.+
2. The monthly discount will be the maximum amount allowed by the Missouri Public Service Commission and the Federal Communications Commission; however, this discount will not exceed the sum of the federal subscriber line charge and the recurring charges for voice telephony service. The monthly discount will be the same for Lifeline and Disabled customers solely subscribing to voice telephony service and for Lifeline and Disabled customers subscribing to a bundle of services.+
3. A Lifeline or Disabled subscriber's voice telephony service will not be disconnected for non-payment of charges unless the subscriber fails to pay charges directly related to voice telephony service.+
4. Lifeline service is available with optional toll blocking or toll limitation service restricting access to 1+, 0+, and 0- dialed calls at no charge.
5. Participants are limited to one program benefit per household. Subscribers cannot receive additional discounts for service from another provider. Subscribers may not receive discounts from both the Lifeline and Disabled programs.+
6. Program requirements are identified in the Missouri Public Service Commission rules.+

*Indicates New Rate
+Indicates Change

ISSUED: October 17, 2014

EFFECTIVE: November 17, 2014

BY: Todd Wessing, Vice-President & General Manager
215 Roe Street
P O Box 38
Pilot Grove, Missouri 65276

CANCELLED
December 2, 2016
Missouri Public
Service Commission
JI-2017-0081

FILED
Missouri Public
Service Commission
JI-2015-0170

LOCAL EXCHANGE SERVICE

Lifeline (Low-Income) Program

A. General Regulations

1. Lifeline service is a discounted voice telephony service available to qualifying residential subscribers.
2. The monthly discount will be the maximum amount allowed by the Missouri Public Service Commission and the Federal Communications Commission; however, this discount will not exceed the sum of the federal subscriber line charge and the recurring charges for voice telephony service. The monthly discount will be the same for Lifeline customers solely subscribing to voice telephony service and for Lifeline customers subscribing to a bundle of services.
3. A Lifeline subscriber's voice telephony service will not be disconnected for non-payment of charges unless the subscriber fails to pay charges directly related to voice telephony service.
4. Lifeline service is available with optional toll blocking or toll limitation service restricting access to 1+, 0+ and 0- dialed calls at no charge.
5. A household is limited to one discount. A Lifeline subscriber cannot receive additional discounts for Lifeline service from another provider or through the Missouri Disabled program.

B. Eligibility and Subscriber Requirements

1. An applicant must submit a completed application form along with proof of meeting one of the following eligibility criteria:
 1. Missouri HealthNet (Medicaid)
 2. Food Stamps
 3. Supplemental Security Income (SSI)
 4. Federal public housing assistance (Section 8)
 5. Low Income Home Energy Assistance Program
 6. Temporary Assistance for Needy Families
 7. National School Free Lunch Program;
 8. The customer's income, as defined in 47 CFR Section 54.400(f), is at or below 135% of the Federal Poverty Guidelines, effective June 1, 2012.

No supplement to this tariff will be issued except for the purpose of canceling this tariff.

Section 1
3rd Revised Sheet 1.2
Canceling 2nd Revised Sheet 1.2

LOCAL EXCHANGE SERVICE

LIFELINE SERVICE

A. General Regulations

1. Lifeline service is available to qualifying low-income subscribers for single party residence service.
2. Lifeline service is a reduction in the monthly local service charges normally paid by qualifying low-income consumers. Eligible Lifeline subscribers will receive a total reduction in the amount for residential one party service of \$8.25+. The components of the reduction to basic residential one-party rates are as follows:

State reduction in local rate: \$1.75

Federal baseline Lifeline reduction: \$6.50+

The Federal baseline Lifeline reduction shall be used to waive the consumer Federal End-User Common Line charge.

3. Lifeline will not be furnished on a Foreign Exchange Service.
4. Lifeline service shall not be disconnected for non-payment of toll charges.
5. Toll blocking provides a means of restricting access to the Long Distance Message Telecommunications Network. Toll blocking for the purposes of Lifeline service will restrict 1+ and 900 calls.
 - a. If the customer chooses "toll blocking" the company will not charge a service deposit.
 - b. Toll blocking is offered to Lifeline subscribers at no charge.

*Indicates New Rate
+Indicates Change

ISSUED: June 18, 2003

EFFECTIVE: July 18, 2003

By Gary B. Romig, Co-CEO
MID-MISSOURI TELEPHONE COMPANY
Pilot Grove, Missouri

CANCELLED
September 22, 2008
Missouri Public
Service Commission

No supplement to this tariff will be issued except for the purpose of canceling this tariff.

Section 1
2nd Revised Sheet 1.2
Canceling 1st Revised Sheet 1.2

LOCAL EXCHANGE SERVICE

Missouri Public

REC'D DEC 05 2001

LIFELINE SERVICE

Service Commission

A. General Regulations

1. Lifeline service is available to qualifying low-income subscribers for single party residence service.
2. Lifeline service is a reduction in the monthly local service charges normally paid by qualifying low-income consumers. Eligible Lifeline subscribers will receive a total reduction in the amount for residential one party service of \$6.75+. The components of the reduction to basic residential one-party rates are as follows:

State reduction in local rate:	\$1.75
Federal baseline Lifeline reduction:	\$5.00+

The Federal baseline Lifeline reduction shall be used to waive the consumer Federal End-User Common Line charge.

3. Lifeline will not be furnished on a Foreign Exchange Service.
4. Lifeline service shall not be disconnected for non-payment of toll charges.
5. Toll blocking provides a means of restricting access to the Long Distance Message Telecommunications Network. Toll blocking for the purposes of Lifeline service will restrict 1+ and 900 calls.
 - a. If the customer chooses "toll blocking" the company will not charge a service deposit.
 - b. Toll blocking is offered to Lifeline subscribers at no charge.

CANCELLED

JUL 18 2003
2nd R S 1.2

Missouri Public Service Commission
MISSOURI

Missouri Public Service Commission

02 - 262
FILED JAN 01 2002

*Indicates New Rate
+Indicates Change

ISSUED: December 11, 2001

EFFECTIVE: [REDACTED]

By Gary B. Romig, Co-CEO
MID-MISSOURI TELEPHONE COMPANY
Pilot Grove, Missouri

JAN 01 2002

Mid Missouri Telephone Company
of Pilot Grove, Missouri

P.S.C. MO. NO. 1 Consolidated
Section 1
1st Revised Sheet No. 1.2
Cancels Original Sheet No. 1.2

RECEIVED

LOCAL EXCHANGE SERVICE

JAN 07 1998

LIFELINE SERVICE

MISSOURI
Public Service Commission

A. General Regulations

1. Lifeline service is available to qualifying low-income subscribers for single party residence service.
2. Lifeline service is a reduction in the monthly local service charges normally paid by qualifying low-income consumers. Eligible Lifeline subscribers will receive a total reduction in the amount for residential one party service of \$5.25. The components of the reduction to basic residential one-party rates are as follows:

State reduction in local rate:	\$1.75
Federal baseline Lifeline reduction:	\$3.50

The Federal baseline lifeline reduction shall be used to waive the consumers federal End-User Common Line charge.

3. Lifeline will not be furnished on a Foreign Exchange service.
4. Lifeline service shall not be disconnected for non-payment of toll charges.
5. Toll blocking provides a means of restricting access to the Long Distance Message Telecommunications Network. Toll blocking for the purposes of lifeline service will restrict 1+ and 900 calls.
 - a. If the customer chooses "toll blocking" the company will not charge a service deposit.
 - b. Toll blocking is offered to Lifeline subscribers at no charge. +

CANCELLED

JAN 01 2002
By *20R S1.2*
Public Service Commission
MISSOURI

FILED

FEB 10 1998

MO. PUBLIC SERVICE COMM

* Indicates new rate or text
+ Indicates change

Issued: ~~February 10, 1998~~

JAN 07 1998

Harold Jones
Mid Missouri Telephone Co.
Pilot Grove, Missouri

Effective: February 10, 1998

Mid Missouri Telephone Company
of Pilot Grove, Missouri

LOCAL EXCHANGE SERVICE

RECEIVED

LIFELINE SERVICE

NOV 19 1997

A. General Regulations

MO. PUBLIC SERVICE COMMISSION

1. Lifeline service is available to qualifying low-income subscribers for single party residence service.
2. Lifeline service is a reduction in the monthly local service charges normally paid by qualifying low-income consumers. Eligible Lifeline subscribers will receive a total reduction in the amount for residential one party service of \$5.25. The components of the reduction to basic residential one-party rates are as follows:

State reduction in local rate:	\$1.75
Federal baseline Lifeline reduction:	\$3.50

The Federal baseline lifeline reduction shall be used to waive the consumers federal End-User Common Line charge.

3. Lifeline will not be furnished on a Foreign Exchange service.
4. Lifeline service shall not be disconnected for non-payment of toll charges.
5. Toll blocking provides a means of restricting access to the Long Distance Message Telecommunications Network. Toll blocking for the purposes of lifeline service will restrict 1+ and 900 calls.
 - a. If the customer chooses "toll blocking" the company will not charge a service deposit.
 - b. The rate for toll blocking will be charged on a monthly basis, as specified in Section 4, Toll Access Restriction.

CANCELLED

FEB 10 1998
 By 1st RS #1.2
 Public Service Commission
 MISSOURI

FILED

JAN -1 1998

* Indicates new rate or text
+ Indicates change

MISSOURI
Public Service Commission
Effective: January 1, 1998

Issued: November 25, 1997

Harold Jones
Mid Missouri Telephone Co.
Pilot Grove, Missouri

**Otelco Mid-Missouri LLC
PSC Mo No 1 Consolidated**

No supplement to this
tariff will be issued
except for the purpose
of canceling this tariff

Section 1
3rd Revised Sheet 1.3
Canceling 2nd Revised Sheet 1.3

LOCAL EXCHANGE SERVICE

LIFELINE AND DISABLED PROGRAMS (CONTINUED)+

B. Eligibility Requirements

1. Subscribers must apply with the Company and submit proof of eligibility to participate in the Lifeline or Disabled programs.+
2. Applicants must agree to certain conditions and responsibilities, including but not limited to:+
 - a. All Lifeline customers must verify annually with the Company that they are still eligible for Lifeline support.+
3. An applicant that makes false statements or fails to comply with program requirements will be de-enrolled from the Lifeline or Disabled Program.+
4. Eligibility criteria are identified in the Missouri Public Service Commission rules.+

*Indicates New Rate
+Indicates Change

ISSUED: October 17, 2014

EFFECTIVE: November 17, 2014

BY: Todd Wessing, Vice-President & General Manager
215 Roe Street
P O Box 38
Pilot Grove, Missouri 65276

CANCELLED
December 2, 2016
Missouri Public
Service Commission
JI-2017-0081

FILED
Missouri Public
Service Commission
JI-2015-0170

LOCAL EXCHANGE SERVICE

LIFELINE SERVICES (CONTINUED)

B. Eligibility Requirements (Continued)

2. A Lifeline subscriber must agree to notify the company within 30 days if:
 - i. The subscriber's household receives multiple discounts through either the Lifeline program and/or the Missouri Disabled program.
 - ii. The subscriber fails to meet eligibility criteria.
3. A Lifeline subscriber agrees to respond in a timely manner to annual requests to verify continued eligibility.
4. False statements made by a Lifeline subscriber or failure to comply with Lifeline service subscriber obligations will result in de-enrollment from the program.
5. The Lifeline subscriber's address must be the subscriber's permanent address. If the Lifeline subscriber's address is temporary then the subscriber must verify the subscriber's address every 90 days.

Missouri Disabled Program

A. General Regulations

1. The Missouri Disabled program offers a \$3.50 discount for voice telephony service to qualifying residential subscribers.
2. A household is limited to one discount. A subscriber cannot receive additional discounts from the Missouri Disabled program or through the Lifeline program.

B. Eligibility and Subscriber Requirements

1. An applicant must submit a completed application form along with proof of meeting one of the following eligibility criteria:
 - 1) Federal Social Security Disability benefits.
 - 2) Federal Supplemental Security income.
 - 3) Veterans Administration Disability benefits.
 - 4) State blind pension pursuant to Section 209.010 to 209.160 RSMo
 - 5) State aid to blind persons pursuant to Section 209.240 RSMo
 - 6) State supplemental payments pursuant to Section 208.030, RSMo Section 660.100.2 RSMo 2000.

Issued March 15, 2012

Effective April 14, 2012

Todd Wessing, President
215 Roe Street
P.O. Box 38
Pilot Grove, Missouri 65726

CANCELED
November 17, 2014
Missouri Public
Service Commission
JI-2015-0170

Filed
Missouri Public
Service Commission
JI-2012-0445

No supplement to this
tariff will be issued
except for the purpose
of canceling this tariff

LOCAL EXCHANGE SERVICE

LIFELINE SERVICE (CONTINUED)

B. Eligibility Requirements

An applicant must meet all of the following criteria in order to qualify for Lifeline Service:

1. To qualify for Lifeline the consumer must participate in one of the following programs:
 - a. MO HealthNet (f/k/a Medicaid)
 - b. Food Stamps
 - c. Supplemental Security Income
 - d. Low-Income Home Energy Assistance (LIHEAP)
 - e. Federal Public Housing Assistance or Section 8
 - f. National School Lunch Program
 - g. Temporary Assistance for Needy Families
2. The customer must sign, under penalty of perjury, a document certifying:
 - a. He/she is receiving benefits from one of the programs in B.1. above.
 - b. Name of the program(s) from which he/she is receiving benefits.
 - c. That he/she will notify the company if he/she no longer participates in the program(s) named in B.1. preceding.
 - d. That he/she authorizes the agency disbursing benefits to confirm and provide documents verifying current participation in a qualifying program in B.1. above to the Missouri Public Service Commission or any delegate thereof.
3. The customer must provide documentation to the Company verifying participation in at least one of the programs listed in B.1. above.
3. The premises at which the residence service is requested must be the applicant's principal place of residence.
4. There is only one telephone line serving the residence premises. The residence premises household (dwelling unit) shall consist of that portion of an individual house or building or one flat or apartment occupied by a single family or individuals functioning as one domestic establishment.

* Indicates New Rate or Text
+ Indicates Change

ISSUED: AUGUST 22, 2008

EFFECTIVE: SEPTEMBER 22, 2008

By Gary B. Romig, President
215 Roe Street
P O Box 38
Pilot Grove, Missouri 65276

CANCELLED
April 14, 2012
Missouri Public
Service Commission
JI-2012-0445

FILED
Missouri Public
Service Commission

Mid Missouri Telephone Company
of Pilot Grove, Missouri

LOCAL EXCHANGE SERVICE

RECEIVED

LIFELINE SERVICE

NOV 19 1997

B. Eligibility Requirements

MISSOURI PUBLIC SERVICE COMMISSION

An applicant must meet all of the following criteria in order to qualify for Lifeline Service:

1. To qualify for Lifeline the consumer must participate in one of the following programs:
 - a. Medicaid
 - b. Food stamps
 - c. Supplemental Security Income (SSI)
 - d. Federal public housing assistance
 - e. Low Income Home Energy Assistance Program
2. The customer must sign, under penalty of perjury a document certifying:
 - a. He/she is receiving benefits from one of the programs in B.1. above.
 - b. Name of the program(s) from which they are receiving benefits.
 - c. That he/she will notify the company if he/she no longer participates in the program(s) named in 1. preceding.
3. The premises at which the residence service is requested must be the applicant's principal place of residence.
4. There is only one telephone line serving the residence premises. The residence premises household (dwelling unit) shall consist of that portion of an individual house or building or one flat or apartment occupied by a single family or individuals functioning as one domestic establishment.

FILED

JAN - 1 1998

MISSOURI
Public Service Commission
Effective: January 1, 1998

* Indicates new rate or text
+ Indicates change

Issued: November 25, 1997

Harold Jones
Mid Missouri Telephone Co.
Pilot Grove, Missouri

CANCELLED
September 22, 2008
Missouri Public
Service Commission

No supplement to this
Tariff will be issued
Except for the purpose
of canceling this tariff

Section 1
~~1st Revised Sheet 1.4~~
~~Canceling 2nd Revised Sheet 1.4~~
Should be 2nd Revised Sheet 1.4
Canceling 1st Revised Sheet 1.4

LOCAL EXCHANGE SERVICE

LIFELINE SERVICES (CONTINUED)

1. A subscriber with the Missouri Disabled Program must agree to notify the company within 30 days if:
 - i. The subscriber's household receives multiple discounts from the Missouri Disabled Program and/or Lifeline program.
 - ii. The subscriber fails to meet eligibility criteria.
2. A subscriber to the Missouri Disabled Program agrees to respond in a timely manner to annual requests to verify continued eligibility.
3. False statements made by a subscriber or failure to comply with subscriber obligations will result in de-enrollment from the program.

(rest of page reserved for future use)+

Issued March 15, 2012

Todd Wessing, President
215 Roe Street
P.O. Box 38
Pilot Grove, Missouri 65726

Effective April 14, 2012

CANCELED
November 17, 2014
Missouri Public
Service Commission
JI-2015-0170

Filed
Missouri Public
Service Commission
JI-2012-0445

No supplement to this
tariff will be issued
except for the purpose
of canceling this tariff

Section 1
1st Revised Sheet No. 1.4
Cancelling Original Sheet 1.4

LOCAL EXCHANGE SERVICE

LIFELINE SERVICE (CONTINUED)

C. Missouri USF Low-Income Assistance

1. General – A low-income customer is any customer who requests or receives residential essential local telecommunications service and who has been certified by the Department of Social Services (DSS) as economically disadvantaged. Qualified individuals will receive discounted services under either the low-income assistance or the disabled assistance program.

2. Regulations – Low income assistance is available to all residential customers who demonstrate, by certifying with the company under penalty of perjury and by providing verifying documents to the company, that they are eligible for support by participation in:

- a. MO HealthNet (f/k/a Medicaid)
- b. Food Stamps
- c. Supplemental Security Income
- d. Low-Income Home Energy Assistance (LIHEAP)
- e. Federal Public Housing Assistance or Section 8
- f. National School Lunch Program
- g. Temporary Assistance for Needy Families

The customer must also authorize the agency disbursing benefits to confirm and provide documents verifying current participation in a qualifying program above to the Missouri Public Service Commission or any delegate thereof.

3. Eligible Services – Essential local telecommunications service is defined as two (2) way switched voice residential service within a local calling scope as determined by the commission, comprised of the following services and their recurring charges:

- a. Single line residential service, including touch-tone dialing and any applicable mileage or zone charges.
- b. Access to local emergency services, including, but not limited to, 911 service established by local authorities.
- c. Access to basic local operator services.
- d. Access to basic local directory assistance.
- e. Standard intercept service.
- f. Equal access to Inter-Exchange Carriers consistent with rules and regulations of the FCC.
- g. One (1) standard white pages directory listing.
- h. Toll blocking or toll control for qualifying low-income customers.

* Indicates New Rate or Text
+ Indicates Change

ISSUED: AUGUST 22, 2008

EFFECTIVE: SEPTEMBER 22, 2008

By Gary B. Romig, President
215 Roe Street
P O Box 38
Pilot Grove, Missouri 65276

CANCELLED
April 14, 2012
Missouri Public
Service Commission
JI-2012-0445

FILED
Missouri Public
Service Commission

No supplement to this tariff will be issued except for the purpose of canceling this tariff

LOCAL EXCHANGE SERVICE

(*)

LIFELINE SERVICE (CONTINUED)

1. Missouri USF Low-Income Assistance

- A. **General-** A low-income customer is any customer who requests or receives residential essential local telecommunications service and who has been certified by the Department of Social Services (DSS) as economically disadvantaged. Qualified individuals will receive discounted services under either the low-income assistance or the disabled assistance program.
- B. **Regulations-** Low income assistance is available to all residential customers who demonstrate, by self certifying with the company under penalty of perjury, that they are eligible for support by participation in:
1. Medicaid
 2. Food stamps
 3. Supplementary Security Income (SSI)
 4. Federal Public Housing Assistance or section 8
 5. Low Income Home Energy Assistance Program (LIHEAP)
- C. **Eligible Services-** Essential local telecommunications service is defined as two (2) way switched voice residential service within a local calling scope as determined by the commission, comprised of the following services and their recurring charges:
1. Single line residential service, including touch-tone dialing and any applicable mileage or zone charges
 2. Access to local emergency services, including, but not limited to, 911 service established by local authorities
 3. Access to basic local operator services
 4. Access to basic local directory assistance
 5. Standard intercept service
 6. Equal access to Inter-Exchange Carriers consistent with rules and regulations of the FCC
 7. One (1) standard white pages directory listing
 8. Toll blocking or toll control for qualifying low-income customers
- D. **Support Amount-** Customers eligible under the established criteria can receive a discount from their bill for essential local telecommunications service equal to the amounts approved by the Missouri Public Service Commission and the Federal Communications Commission. The amount of combined federal and state lifeline support for any customer will not exceed the sum of the federal Subscriber Line Charge (SLC) and the recurring charges for essential local telecommunications services (including the basic service rate, Touch-Tone calling charge, extended area service additive, and mileage additives, if any).

(*)

*Indicates new rate or text
+Indicates change

Issued: March 31, 2005

Effective: May 1, 2005

CANCELLED
September 22, 2008
Missouri Public
Service Commission

By Gary B. Romig
MID-MISSOURI TELEPHONE COMPANY
Pilot Grove, Missouri

No supplement to this
tariff will be issued
except for the purpose
of canceling this tariff

LOCAL EXCHANGE SERVICE

LIFELINE SERVICE (CONTINUED)

4. Support Amount – Customers eligible under the established criteria can receive a discount from their bill for essential local telecommunications service equal to the amounts approved by the Missouri Public Service Commission and the Federal Communications Commission. The amount of combined federal and state lifeline support for any customer will not exceed the sum of the federal Subscriber Line Charge (SLC) and the recurring charges for essential local telecommunications services (including the basic service rate, Touch-Tone calling charge, extended area service additive, and mileage additives, if any).

* Indicates New Rate or Text
+ Indicates Change

ISSUED: AUGUST 22, 2008

EFFECTIVE: SEPTEMBER 22, 2008

By Gary B. Romig, President
215 Roe Street
P O Box 38
Pilot Grove, Missouri 65276

CANCELLED
April 14, 2012
Missouri Public
Service Commission
JI-2012-0445

FILED
Missouri Public
Service Commission

Mid-Missouri Telephone Company
P.S.C. Mo. No. 1 Consolidated

No supplement to this
tariff will be issued
except for the purpose
of canceling this tariff

Section 1
1st Revised Sheet 1.5
Canceling Original Sheet 1.5

LOCAL EXCHANGE SERVICE

LIFELINE SERVICE (CONTINUED)

D. Missouri USF Disabled Assistance

1. General – A disabled customer, or a dependent, is a customer who requests or receives residential essential local telecommunications service, as defined in section C.3. of this tariff, and meets the eligibility requirements set forth in this tariff.
2. Regulations – Disabled assistance is available to all residential customers who demonstrate, by certifying with the company under penalty of perjury and by providing verification documents to the company, that they, or a dependant, are totally and permanently disabled or blind and receive any of the following:
 - a. Veteran Administration Disability benefits
 - b. State blind pension pursuant to Section 209.010 to 209.160 RSMo
 - c. State aid to blind persons pursuant to Section 209.240 RSMo
 - d. State supplemental disability assistance payments pursuant to Section 208.030, RSMo Section 660.100.2 RSMo 2000
 - e. Federal Social Security Disability benefits
 - f. Federal Supplemental Security Income benefits

The customer must also authorize the agency disbursing benefits to confirm and provide documents verifying current participation in a qualifying program above to the Missouri Public Service Commission or any delegate thereof.

3. Support Amount – Customers eligible under the established criteria can receive a discount equal to the amount approved by the Missouri Public Service Commission from their bill for essential local telecommunications service. The amount of state lifeline support for any customer will not exceed the recurring charges for essential local telecommunications services (including the basic service rate, Touch-Tone calling charge, extended area service additive, and mileage additives, if any).

* Indicates New Rate or Text
+ Indicates Change

ISSUED: AUGUST 22, 2008

EFFECTIVE: SEPTEMBER 22, 2008

By Gary B. Romig, President
215 Roe Street
P O Box 38
Pilot Grove, Missouri 65276

CANCELLED
April 14, 2012
Missouri Public
Service Commission
JI-2012-0445

FILED
Missouri Public
Service Commission

No supplement to this tariff will be issued except for the purpose of canceling this tariff

Section 1
Original Sheet No. 1.5

LOCAL EXCHANGE SERVICE

(*)

LIFELINE SERVICES (CONTINUED)

2. Missouri USF Disabled Assistance

- A. **General-** A disabled customer, or a dependent, is a customer who requests or receives residential essential local telecommunications service, as defined in section 1(c) of this tariff, and meets the eligibility requirements set forth in this tariff.
- B. **Regulations-** Disabled assistance is available to all residential customers who demonstrate, by self certifying with the company under penalty of perjury, that they, or a dependant, are totally and permanently disabled or blind and receiving any of the following:
 - 1) Federal Social Security Disability benefits.
 - 2) Federal Supplemental Security income benefits
 - 3) Veterans Administration benefits
 - 4) State blind pension pursuant to Section 209.010 to 209.160 RSMo
 - 5) State aid to blind persons pursuant to Section 209.240 RSMo
 - 6) State supplemental payments pursuant to Section 208.030, RSMo Section 660.100.2 RSMo 2000.
- C. **Support Amount-** Customers eligible under the established criteria can receive a discount equal to the amount approved by the Missouri Public Service Commission from their bill for essential local telecommunications service. The amount of state lifeline support for any customer will not exceed the recurring charges for essential local telecommunications services (including the basic service rate, Touch-Tone calling charge, extended area service additive, and mileage additives, if any.)

3. "Missouri Universal Service Fund"

- A. Company will place on each end retail end-user customer's bill, a surcharge equal to the Missouri Universal Service Fund percentage assessment ordered by the commission.
- B. The surcharge will appear as a separate line item detailed as "Missouri Universal Service Fund."
- C. The surcharge percentage will be applied to the total of each customer's charges for intrastate regulated telecommunications services that meet the definition of net jurisdictional revenues at 4 CSR 240-31.010(12).

(*)

*Indicates new rate or text
+Indicates change

Issued: March 31, 2005

Effective: May 1, 2005

CANCELLED
September 22, 2008
Missouri Public
Service Commission

By Gary B. Romig
MID-MISSOURI TELEPHONE COMPANY
Pilot Grove, Missouri

No supplement to this
tariff will be issued
except for the purpose
of canceling this tariff

LOCAL EXCHANGE SERVICE

LIFELINE SERVICE (CONTINUED)

E. "Missouri Universal Service Fund"

1. Company will place on each end retail end-user customer's bill, a surcharge equal to the Missouri Universal Service Fund percentage assessment ordered by the commission.
2. The surcharge will appear as a separate line item detailed as "Missouri Universal Service Fund."
3. The surcharge percentage will be applied to the total of each customer's charges for intrastate regulated telecommunications services that meet the definition of net jurisdictional revenues at 4 CSR 240-31.010(12).

* Indicates New Rate or Text
+ Indicates Change

ISSUED: AUGUST 22, 2008

EFFECTIVE: SEPTEMBER 22, 2008

By Gary B. Romig, President
215 Roe Street
P O Box 38
Pilot Grove, Missouri 65276

CANCELLED
April 14, 2012
Missouri Public
Service Commission
JI-2012-0445

FILED
Missouri Public
Service Commission

P.S.C. Mo. No. 1 Consolidated

No supplement to this tariff will be issued except for the purpose of canceling this tariff.

Section 1
2nd Revised Sheet 2
Cancelling 1st Revised Sheet 2

LOCAL EXCHANGE SERVICE

‡MISSOURI SCHOOL DISCOUNT PROGRAM

1. A discount from standard monthly rates for local exchange business service may be allowed in connection with service furnished through the Missouri School Discount Program, pursuant to the Video Instructional Development and Educational Opportunity Program, as enacted by the Missouri State Legislature.
2. Upon the customer's request, a discount of twenty percent (20%) from standard monthly access line rates may be allowed to educational institutions within the Company's certified area, as determined by Paragraph 3, following.
3. An educational institution shall be defined either as an accredited public school, or a private school which is tax exempt pursuant to 26 U.S.C. 501(c)(3). Persons operating home schools, as defined in 167.031 RSMo, shall not be eligible for this school discount program. Public Schools must be accredited by the Department of Elementary and Secondary Education for the State of Missouri and /or the North Central Association of Colleges and Schools.
4. The qualifying discount will be permitted only on the local exchange access line. All other features, ancillary services or options, relative to the particular service, shall continue to be billed at the appropriate tariffed rates.
5. The qualifying discount will be permitted only where the predominant use is providing educational and instructional programs and for the educational institutions administrative use. The discount is not allowed to residential complexes associated with the institution.
6. In addition to meeting the qualification specified in Paragraph 3 preceding, an eligible customer must sign an affidavit certifying that the qualification is met. The affidavit will be retained on file with the Company.
7. The customer should request to receive the discount on all subsequent additions of eligible services which are ordered. There will be no additional affidavits required.
8. The following local exchange services are eligible for a discount under this program:

Flat Rate, business one-party service.

*Indicates New Rate

+Indicates Change

ISSUED: 11-7-96

EFFECTIVE: 01-01-97

By Harold A. Jones, Manager
MID-MISSOURI TELEPHONE COMPANY
Pilot Grove, Missouri

P.S.C. Mo. No. 1 Consolidated

No supplement to this tariff will be issued except for the purpose of canceling this tariff.

Section 1
1st Revised Sheet 2
Cancelling Original Sheet 2

LOCAL EXCHANGE SERVICE

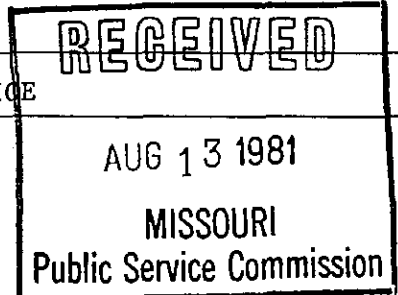

HOLD FOR FUTURE USE

CANCELLED

JAN -1 1987
BY *2nd R.S. #2*
Public Service Commission
MISSOURI

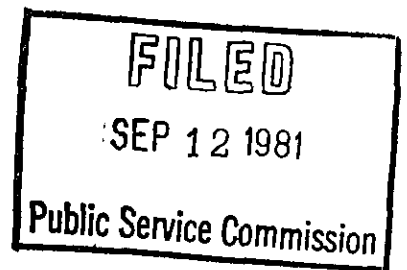

*Indicates new rate
+Indicates Change

ISSUED: August 12, 1981

EFFECTIVE: September 12, 1981

By Harold A. Jones, Manager
MID-MISSOURI TELEPHONE COMPANY
Pilot Grove, Missouri

Mo. P.S.C. Mo. No. 1 Consolidated

No supplement to this tariff will be issued except for the purpose of canceling this tariff.

Section 1
Original Sheet 2

RECEIVED
JAN 25 1977
Sheet No.
MISSOURI
Public Service Commission
9

LOCAL EXCHANGE TARIFF INDEX

Gilliam		
Local Rates		
Maps		
Exchange Area		9.1
Base Rate Area		9.2
High Point		
Local Rates		10
Maps		
Exchange Area		10.1
Base Rate Area		10.2
Latham		
Local Rates		11
Maps		
Exchange Area		11.1
Base Rate Area		11.2
Marshall Junction		
Local Rates		12
Maps		
Exchange Area		12.1
Base Rate Area		12.2

CANCELLED

SEP 12 1981
BY 1st RS 2
PUBLIC SERVICE COMMISSION
OF MISSOURI

FILED
MAR 1 1977
Public Service Commission
12.2

*Indicates new rate
+Indicates Change

ISSUED: January 26, 1977

EFFECTIVE: March 1, 1977

By Harold A. Jones, Manager
MID-MISSOURI TELEPHONE COMPANY
Pilot Grove, Missouri

P.S.C. Mo. No. 1 Consolidated

No supplement to this tariff will be issued except for the purpose of canceling this tariff.

Section 1
1st Revised Sheet 3
Cancelling Original Sheet 3

LOCAL EXCHANGE SERVICE

Exchange Calling Scope

Exchanges

Arrow Rock
Blackwater
Bunceton
Fortuna
Gilliam
High Point
Latham
Marshall Junction
Miami
Nelson
Pilot Grove
Speed

RECEIVED
JUL 27 1981
MISSOURI
Public Service Commission

Blackwater, Nelson
Arrow Rock, Nelson
Speed
Latham, High Point

Fortuna, Latham
Fortuna, High Point

Arrow Rock, Blackwater

Bunceton

*Indicates new rate
+Indicates Change

FILED
AUG - 1 1981
81-169
Public Service Commission

ISSUED: July 24, 1981

EFFECTIVE: August 1, 1981

CANCELED
June 1, 2012
Missouri Public
Service Commission
JI-2012-0638

By Harold A. Jones, Manager
MID-MISSOURI TELEPHONE COMPANY
Pilot Grove, Missouri

No supplement to this tariff will be issued except for the purpose of canceling this tariff.

Section 1
Original Sheet 3

LOCAL EXCHANGE TARIFF INDEX

RECEIVED
Sheet No.
JAN 25 1977
MISSOURI 13
Public Service Commission

Miami

Local Rates

Maps

Exchange Area

13.1

Base Rate Area

13.2

Nelson

Local Rates

14

Maps

Exchange Area

14.1

Base Rate Area

14.2

Pilot Grove

Local Rates

15

Maps

Exchange Area

15.1

Base Rate Area

15.2

Speed

Local Rates

16

Maps

Exchange Area

Base Rate Area

*Indicates new rate
+Indicates Change.

FILED
MAR 1 1977
16.1
16.2
Public Service Commission

CANCELLED
AUG -1 1981
BY 1st RS 3
PUBLIC SERVICE COMMISSION
OF MISSOURI

ISSUED: January 26, 1977

EFFECTIVE: March 1, 1977

By Harold A. Jones, Manager
MID-MISSOURI TELEPHONE COMPANY
Pilot Grove, Missouri

Mo. P.S.C. Mo. No. 1 Consolidated

No supplement to this tariff will be issued except for the purpose of canceling this tariff.

Section 1
Original Sheet 4

LOCAL EXCHANGE SERVICE

RESERVED

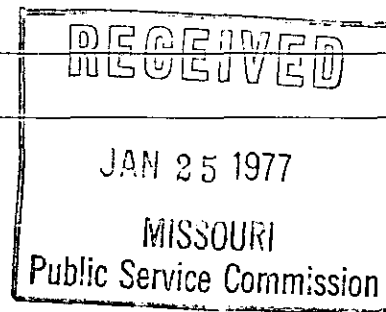

CANCELLED

AUG - 1 1981
BY 1st RS 4
PUBLIC SERVICE COMMISSION
OF MISSOURI

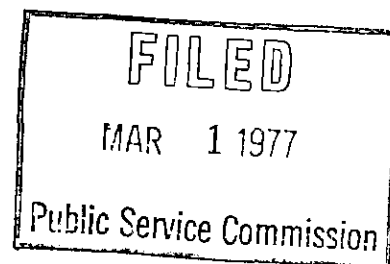

*Indicates new rate
+Indicates Change

ISSUED: January 26, 1977

EFFECTIVE: March 1, 1977

By Harold A. Jones, Manager
MID-MISSOURI TELEPHONE COMPANY
Pilot Grove, Missouri

No supplement to this tariff will be issued except for the purpose of canceling this tariff.

Section 1
1st Revised Sheet 5
Cancelling Original Sheet 5

For: Arrow Rock, Missouri

RECEIVED
AUG 21 1978

LOCAL EXCHANGE SERVICE

+GENERAL

Unless otherwise specified, the charges quoted in this tariff are for one month and entitle the subscriber to standard telephone equipment and messages to all stations, in exchanges bearing the designation:

MISSOURI
Public Service Commission

RATES

WITHIN THE INITIAL RATE AREA:

CLASS OF SERVICE			
		One Party	Extension
Business	Rotary Dial	\$ 9.95	\$1.50
	Touch Button Dial	\$11.95	\$1.65
Residence	Rotary Dial	\$ 6.75	\$1.00
	Touch Button Dial	\$ 8.75	\$1.15

RATES (Rural)

OUTSIDE THE INITIAL RATE AREA, But Within the Exchange Area.

CLASS OF SERVICE			
		One Party	Extension
Business	Rotary Dial	\$ 9.95	\$1.50
	Touch Button Dial	\$11.95	\$1.65
Residence	Rotary Dial	\$ 6.75	\$1.00
	Touch Button Dial	\$ 8.75	\$1.15

+When any municipality imposes upon the Company any license, occupation, or other similar charge or tax applicable to service by the Company to the customer, or imposes a charge or tax based upon a percentage of gross receipts, net receipts, or revenues from sale of telephone service by the Company, the charges for local service to customers within such municipality shall be increased by an amount equal to each such customer's proportionate part of any such charge or tax, and such amount shall be shown separately on the customer's bill.

CANCELLED
AUG -1 1981
BY SF R54
PUBLIC SERVICE COMMISSION
OF MISSOURI

FILED
OCT 1 - 1978
Public Service Commission

*Indicates new rate
+Indicates change

ISSUED: August 18, 1978

EFFECTIVE: October 1, 1978

By Harold A. Jones, Manager
MID-MISSOURI TELEPHONE COMPANY
Pilot Grove, Missouri

P. S. C. Mo. No. 1 Consolidated

No supplement to this tariff will be issued except for the purpose of canceling this tariff.

Section 1
Original Sheet 5

For: Arrow Rock, Missouri

RECEIVED

JAN 25 1977
MISSOURI
Public Service Commission

LOCAL EXCHANGE SERVICE

+GENERAL

Unless otherwise specified, the charges quoted in this tariff are for one month and entitle the subscriber to standard telephone equipment and messages to all stations, in exchanges bearing the designation:

RATES

WITHIN THE INITIAL RATE AREA:

CLASS OF SERVICE		
	One-Party	Extensions
Business	\$ 9.95	\$ 1.50
Residence	6.75	1.00

RATES (Rural)

OUTSIDE THE INITIAL RATE AREA, But Within the Exchange Area.

CANCELLED

OCT 1 - 1970

BY ST RS S
PUBLIC SERVICE COMMISSION
OF MISSOURI

CLASS OF SERVICE		
	One-Party	Extensions
Business	\$ 9.95	\$ 1.50
Residence	6.75	1.00

+When any municipality imposes upon the Company any license, occupation, or other similar charge or tax applicable to service by the Company to the customer, or imposes a charge or tax based upon a percentage of gross receipts, net receipts, or revenues from sale of telephone service by the Company, the charges for local service to customers within such municipality shall be increased by an amount equal to each such customer's proportionate part of any such charge or tax, and such amount shall be shown separately on the customer's bill.

MAR 1 1977
Public Service Commission

*Indicates new rate
+Indicates change

ISSUED: January 26, 1977

EFFECTIVE: March 1, 1977

By Harold A. Jones, Manager
MID-MISSOURI TELEPHONE COMPANY
Pilot Grove, Missouri

Mo. P.S.C. Mo. No. 1 Consolidated

No supplement to this tariff will be issued except for the purpose of canceling this tariff.

Section 1
Original Sheet 5.1

Arrow Rock, Missouri

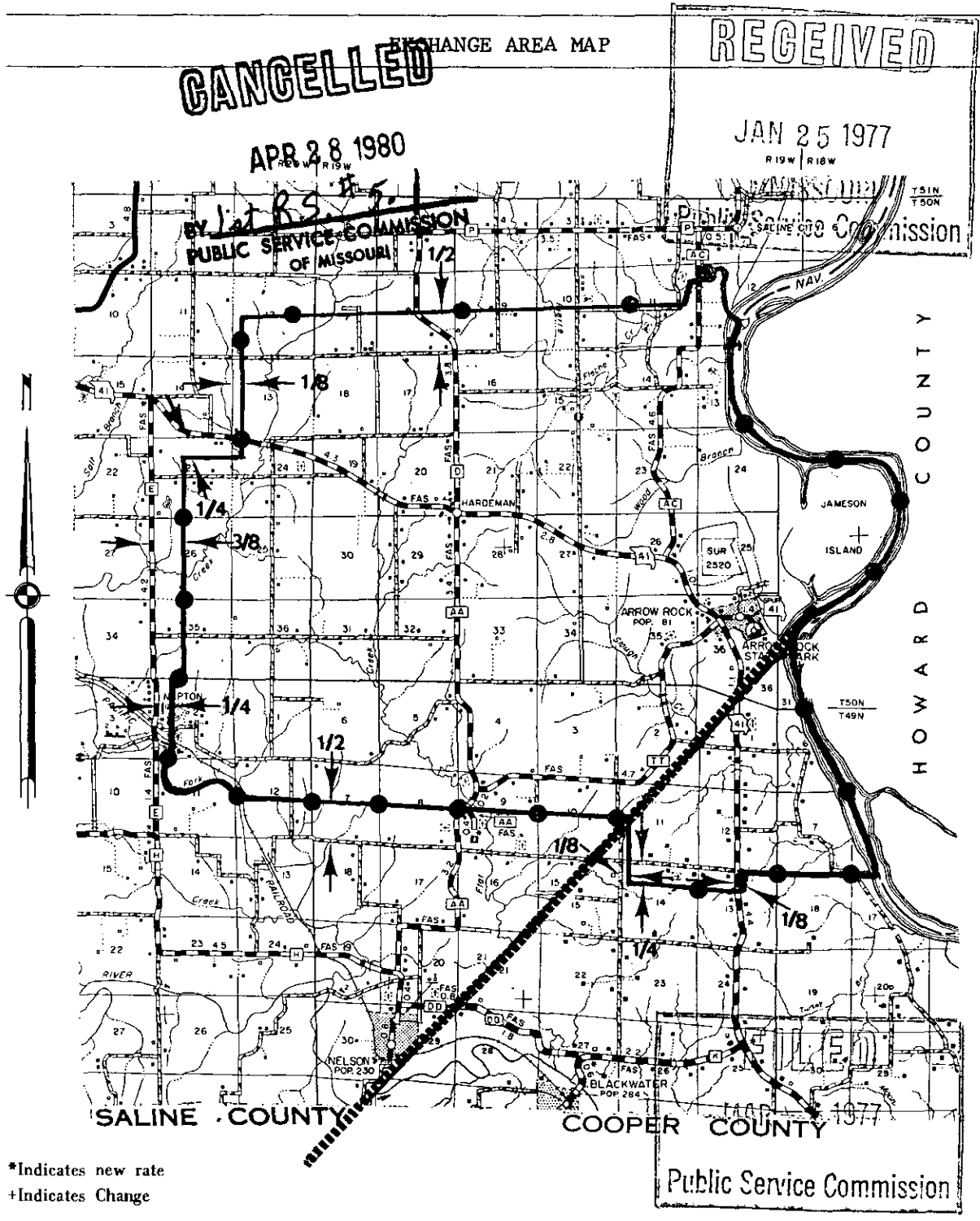

ISSUED: January 26, 1977

EFFECTIVE: March 1, 1977

By Harold A. Jones, Manager
MID-MISSOURI TELEPHONE COMPANY
Pilot Grove, Missouri

No supplement to this tariff will be issued except for the purpose of canceling this tariff.

Section 1
1st Revised Sheet 6
~~Cancelling Original Sheet 6~~

For: Blackwater, Missouri

RECEIVED

AUG 21 1978

LOCAL EXCHANGE SERVICE

MISSOURI

+GENERAL

Public Service Commission

Unless otherwise specified, the charges quoted in this tariff are for one month and entitle the subscriber to standard telephone equipment and messages to all stations, in exchanges bearing the designation:

RATES

WITHIN THE INITIAL RATE AREA:

CLASS OF SERVICE			
		One Party	Extension
Business	Rotary Dial	\$ 9.95	\$1.50
	Touch Button Dial	\$11.95	\$1.65
Residence	Rotary Dial	\$ 6.75	\$1.00
	Touch Button Dial	\$ 8.75	\$1.15

RATES (Rural)

OUTSIDE THE INITIAL RATE AREA, But Within the Exchange Area.

CLASS OF SERVICE			
		One Party	Extension
Business	Rotary Dial	\$ 9.95	\$1.50
	Touch Button Dial	\$11.95	\$1.65
Residence	Rotary Dial	\$ 6.75	\$1.00
	Touch Button Dial	\$ 8.75	\$1.15

+When any municipality imposes upon the Company any license, occupation, or other similar charge or tax applicable to service by the Company to the customer, or imposes a charge or tax based upon a percentage of gross receipts, net receipts, or revenues from sale of telephone service by the Company, the charges for local service to customers within such municipality shall be increased by an amount equal to each such customer's proportionate part of any such charge or tax, and such amount shall be shown separately on the customer's bill.

CANCELLED

AUG -1 1981

BY *LSR 254*
PUBLIC SERVICE COMMISSION
OF MISSOURI

FILED

OCT 1 - 1978

Public Service Commission

*Indicates new rate
+Indicates change

ISSUED: August 18, 1978

By Harold A. Jones, Manager

EFFECTIVE: October 1, 1978

MID-MISSOURI TELEPHONE COMPANY
Pilot Grove, Missouri

P. S. C. Mo. No. 1 Consolidated

No supplement to this tariff will be issued except for the purpose of canceling this tariff.

Section 1
Original Sheet 6

For: Blackwater, Missouri

RECEIVED

LOCAL EXCHANGE SERVICE

JAN 25 1977

+GENERAL

Unless otherwise specified, the charges quoted in this tariff are for one month and entitle the subscriber to standard telephone equipment and messages to all stations in exchanges bearing the designation:

PUBLIC SERVICE COMMISSION

RATES

WITHIN THE INITIAL RATE AREA:

CLASS OF SERVICE		
	One-Party	Extensions
Business	\$ 9.95	\$ 1.50
Residence	6.75	1.00

RATES (Rural)

OUTSIDE THE INITIAL RATE AREA, But Within the Exchange Area.

CANCELLED

OCT 1 - 1978

BY ST RSG
PUBLIC SERVICE COMMISSION
OF MISSOURI

CLASS OF SERVICE		
	One-Party	Extensions
Business	\$ 9.95	\$ 1.50
Residence	6.75	1.00

+When any municipality imposes upon the Company any license, occupation, or other similar charge or tax applicable to service by the Company to the customer, or imposes a charge or tax based upon a percentage of gross receipts, net receipts, or revenues from sale of telephone service by the Company, the charges for local service to customers within such municipality shall be increased by an amount equal to each such customer's proportionate part of any such charge or tax, and such amount shall be shown separately on the customer's bill.

MAR 1 1977

PUBLIC SERVICE COMMISSION

*Indicates new rate
+Indicates change

ISSUED: January 26, 1977

EFFECTIVE: March 1, 1977

By Harold A. Jones, Manager
MID-MISSOURI TELEPHONE COMPANY
Pilot Grove, Missouri

No supplement to this tariff will be issued except for the purpose of canceling this tariff.

Section 1
1st Revised Sheet 7
Cancelling Original Sheet 7

For: Bunceton, Missouri

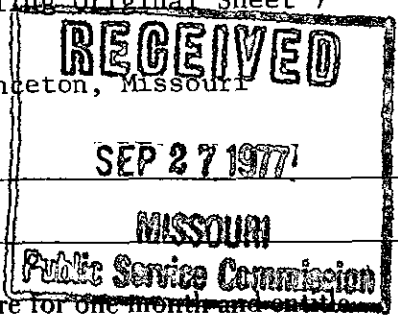

LOCAL EXCHANGE SERVICE

+GENERAL

Unless otherwise specified, the charges quoted in this tariff are for one month and on the subscriber to standard telephone equipment and messages to all stations, in exchanges bearing the designation:

RATES

WITHIN THE INITIAL RATE AREA:

CLASS OF SERVICE			
		One Party	Extension
Business	Rotary Dial	\$ 9.95	\$1.50
	Touch Button Dial	\$11.95	\$1.65
Residence	Rotary Dial	\$ 6.75	\$1.00
	Touch Button Dial	\$ 8.75	\$1.15

RATES (Rural)

OUTSIDE THE INITIAL RATE AREA, But Within the Exchange Area.

CLASS OF SERVICE			
		One Party	Extension
Business	Rotary Dial	\$ 9.95	\$1.50
	Touch Button Dial	\$11.95	\$1.65
Residence	Rotary Dial	\$ 6.75	\$1.00
	Touch Button Dial	\$ 8.75	\$1.15

+When any municipality imposes upon the Company any license, occupation, or other similar charge or tax applicable to service by the Company to the customer, or imposes a charge or tax based upon a percentage of gross receipts, net receipts, or revenues from sale of telephone service by the Company, the charges for local service to customers within such municipality shall be increased by an amount equal to each such customer's proportionate part of any such charge or tax and such amount shall be shown separately on the customer's bill.

CANCELLED
AUG -1 1981
BY 1st RSD
PUBLIC SERVICE COMMISSION
OF MISSOURI

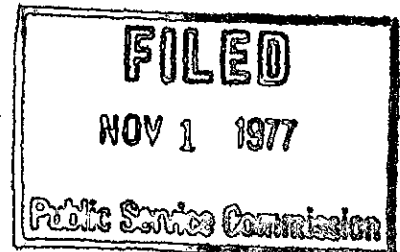

*Indicates new rate
+Indicates change

ISSUED: Sept. 27, 1977

EFFECTIVE: Nov. 1, 1977

By Harold A. Jones, Manager
MID-MISSOURI TELEPHONE COMPANY
Pilot Grove, Missouri

P. S. C. Mo. No. 1 Consolidated

Section 1
Original Sheet 7

No supplement to this tariff will be issued except for the purpose of canceling this tariff.

For: Bunceton, Missouri

RECEIVED
JAN 25 1977
MISSOURI
Public Service Commission

LOCAL EXCHANGE SERVICE

+GENERAL

Unless otherwise specified, the charges quoted in this tariff are for one month and entitle the subscriber to standard telephone equipment and messages to all stations, in exchanges bearing the designation:

RATES

WITHIN THE INITIAL RATE AREA:

CLASS OF SERVICE				
	One-Party	Two-Party	Four-Party	Extensions
Business	A 7.25	-	-	\$ 1.50
	\$B 9.95	\$ -	\$ -	
Residence	A 4.75	-	A 3.75	1.00
	B 6.75		B -	

CANCELLED

RATES (Rural)

OUTSIDE THE INITIAL RATE AREA, But Within the Exchange Area NOV 1 1977

CLASS OF SERVICE				BY <u>LFRS 7</u>
	One-Party	Two-Party	Ten-Party	PUBLIC SERVICE COMMISSION EXTENSION OF MISSOURI
Business	\$B 9.95	\$	A 4.00	\$ 1.50
			\$B -	
Residence	B 6.75		A 4.00	1.00
			B -	

+When any municipality imposes upon the Company any license, occupation, or other similar charge or tax applicable to service by the Company to the customer, or imposes a charge or tax based upon a percentage of gross receipts, net receipts, or revenues from sale of telephone service by the Company, the charges for local service to customers within such municipality shall be increased by an amount equal to each such customer's proportionate part of any such charge or tax, and such amount shall be shown separately on the customer's bill.

A. Applies to customers until facilities are available for all one-party service.

B. Applies outside the initial rate area when and as facilities are available for one-party service. Applies within the initial rate area with conversion of entire exchange to all one-party service.

*Indicates new rate
*Indicates change

RECEIVED
MAR 1 1977
PUBLIC SERVICE COMMISSION

ISSUED: January 26, 1977 By Harold A. Jones, Manager EFFECTIVE: March 1, 1977
MID-MISSOURI TELEPHONE COMPANY
Pilot Grove, Missouri

No supplement to this tariff will be issued except for the purpose of canceling this tariff.

Section 1
Interim 1st Revised Sheet 8
Cancelling Original Sheet 8

For: Fortuna, Missouri

REC-100

LOCAL EXCHANGE SERVICE

+GENERAL

Unless otherwise specified, the charges quoted in this tariff are for one month and entitle the subscriber to standard telephone equipment and messages to all stations, in exchanges bearing the designation:

RATES

WITHIN THE INITIAL RATE AREA:

CLASS OF SERVICE			
		One Party	Extension
Business	Rotary Dial	\$ 9.95	\$1.50
	Touch Button Dial	\$11.95	\$1.65
Residence	Rotary Dial	\$ 6.75	\$1.00
	Touch Button Dial	\$ 8.75	\$1.15

RATES (Rural)

OUTSIDE THE INITIAL RATE AREA, But Within the Exchange Area.

CLASS OF SERVICE			
		One Party	Extension
Business	Rotary Dial	\$ 9.95	\$1.50
	Touch Button Dial	\$11.95	\$1.65
Residence	Rotary Dial	\$ 6.75	\$1.00
	Touch Button Dial	\$ 8.75	\$1.15

+When any municipality imposes upon the Company any license, occupation, or other similar charge or tax applicable to service by the Company to the customer, or imposes a charge or tax based upon a percentage of gross receipts, net receipts, or revenues from sale of telephone service by the Company, the charges for local service to customers within such municipality shall be increased by an amount equal to each such customer's proportionate part of any such charge or tax, and such amount shall be shown separately on the customer's bill.

CANCELLED

AUG - 1 1981

157 P54
PUBLIC SERVICE COMMISSION
OF MISSOURI

FILED
JAN 19 1981
Public Service Commission

*Indicates new rate
+Indicates change

ISSUED: December 18, 1980

EFFECTIVE: January 19, 1981

By Harold A. Jones, Manager
MID-MISSOURI TELEPHONE COMPANY
Pilot Grove, Missouri

P. S. C. Mo. No. 1 Consolidated

No supplement to this tariff will be issued except for the purpose of canceling this tariff.

Section 1
Original Sheet 8

CANCELLED

For: Fortuna, Missouri

JAN 19 1981

BY *Int. 1-258*
PUBLIC SERVICE COMMISSION
LOCAL EXCHANGE SERVICE

RECEIVED
JAN 25 1977
Public Service Commission

+GENERAL

Unless otherwise specified, the charges quoted in this tariff are for one month and entitle the subscriber to standard telephone equipment and messages to all stations, in exchanges bearing the designation:

RATES

WITHIN THE INITIAL RATE AREA:

CLASS OF SERVICE				
	One-Party	Two-Party	Four-Party	Extensions
Business	A 7.25	-	-	\$ 1.50
	\$B 9.95	\$ -	\$ -	
Residence	A 4.75	-	A 3.75	1.00
	B 6.75		B -	

RATES (Rural)

OUTSIDE THE INITIAL RATE AREA, But Within the Exchange Area.

CLASS OF SERVICE				
	One-Party	Two-Party	Ten Party	Extensions
Business	\$B 9.95	\$ -	A 4.00	\$ 1.50
			\$ B -	
Residence	B 6.75	-	A 4.00	1.00
			B -	

+When any municipality imposes upon the Company any license, occupation, or other similar charge or tax applicable to service by the Company to the customer, or imposes a charge or tax based upon a percentage of gross receipts, net receipts, or revenues from sale of telephone service by the Company, the charges for local service to customers within such municipality shall be increased by an amount equal to each such customer's proportionate part of any such charge or tax, and such amount shall be shown separately on the customer's bill.

- A. Applies to customers until facilities are available for all one-party service.
- B. Applies outside the initial rate area when and as facilities are available for one-party service.

*Indicates new rate area with conversion of entire exchange to all one-party service.
*Indicates change area with conversion of entire exchange to all one-party service.

ISSUED: January 26, 1977 By Harold A. Jones, Manager EFFECTIVE: March 1, 1977
MID-MISSOURI TELEPHONE COMPANY
Pilot Grove, Missouri

P.S.C. Mo. No. 1 Consolidated

No supplement to this tariff will be issued except for the purpose of canceling this tariff.

Section 1
Dist Revised Sheet 8.1
Cancelling Original 8.1
Fortuna, Missouri

MAR 1 1979

+ EXCHANGE AREA MAP

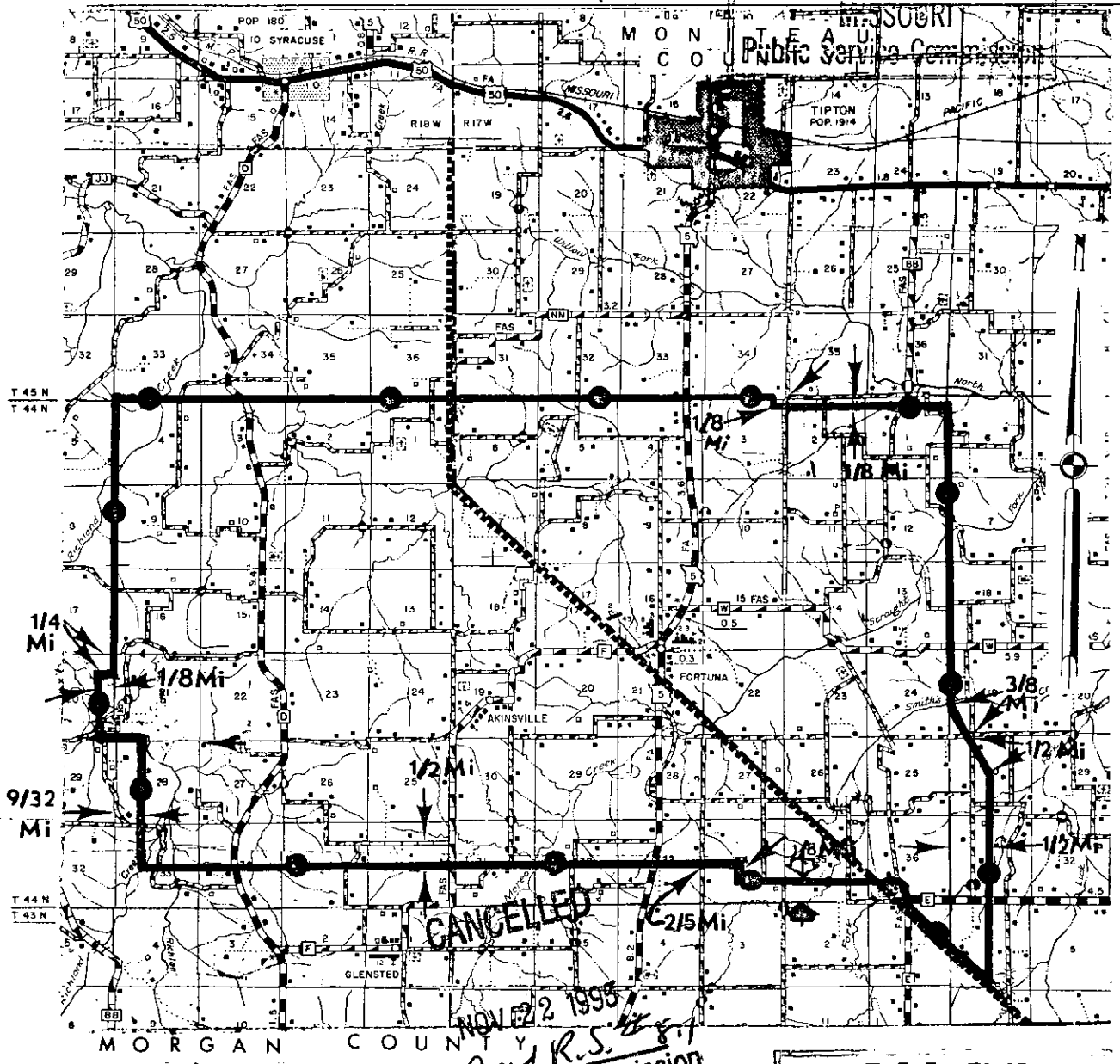

NOV 22 1993
BY 2nd R.S. 8.1
Public Service Commission
MISSOURI

FILED
APR 1 - 1979

*Indicates new rate
+Indicates Change

Issued: February 23, 1979

Public Service Commission
Effective: April 1, 1979

By Harold A. Jones, Manager
MID-MISSOURI TELEPHONE COMPANY
Pilot Grove, Missouri

Mo. P.S.C. Mo. No. 1 Consolidated

No supplement to this tariff will be issued except for the purpose of canceling this tariff.

Section 1
Original Sheet 8.1

Fortuna, Missouri

EXCHANGE AREA MAP

RECEIVED

MONITEAU JAN 25 1977
COUNTY MISSOURI

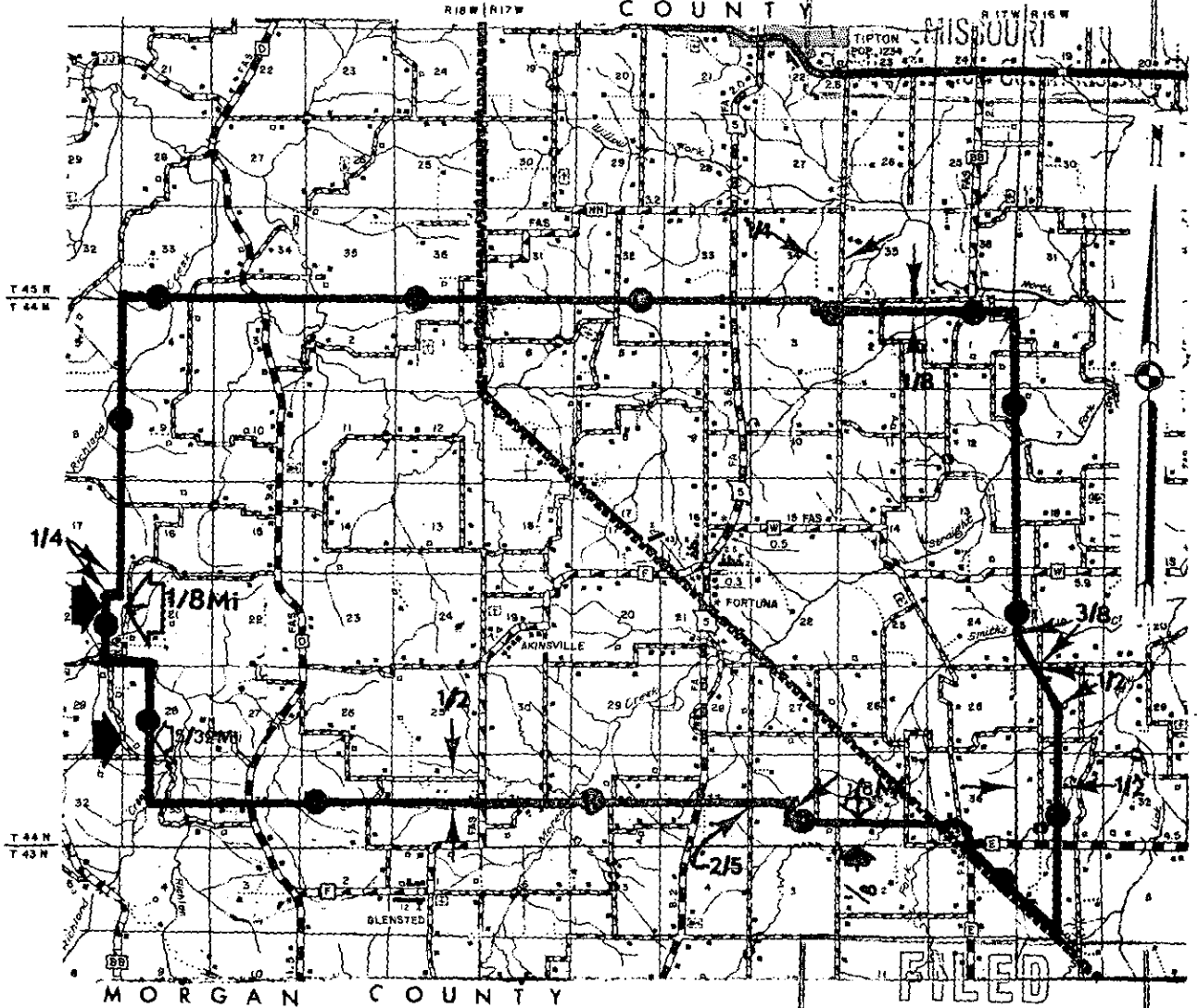

FILED

MAR 1 1977

Public Service Commission

*Indicates new rate
+Indicates Change

CANCELLED

January 26, 1977

EFFECTIVE: March 1, 1977

APR 1 - 1979

By Harold A. Jones, Manager
MID-MISSOURI TELEPHONE COMPANY
Pilot Grove, Missouri

No supplement to this tariff will be issued except for the purpose of canceling this tariff.

Section 1
1st Revised Sheet 9
Cancelling Original Sheet 9

For: Gilliam, Missouri

RECEIVED
AUG 21 1978
MISSOURI
Public Service Commission

LOCAL EXCHANGE SERVICE

+GENERAL

Unless otherwise specified, the charges quoted in this tariff are for one month and entitle the subscriber to standard telephone equipment and messages to all stations, in exchanges bearing the designation:

RATES

WITHIN THE INITIAL RATE AREA:

CLASS OF SERVICE			
		One Party	Extension
Business	Rotary Dial	\$ 9.95	\$1.50
	Touch Button Dial	\$11.95	\$1.65
Residence	Rotary Dial	\$ 6.75	\$1.00
	Touch Button Dial	\$ 8.75	\$1.15

RATES (Rural)

OUTSIDE THE INITIAL RATE AREA, But Within the Exchange Area.

CLASS OF SERVICE			
		One Party	Extension
Business	Rotary Dial	\$ 9.95	\$1.50
	Touch Button Dial	\$11.95	\$1.65
Residence	Rotary Dial	\$ 6.75	\$1.00
	Touch Button Dial	\$ 8.75	\$1.15

+When any municipality imposes upon the Company any license, occupation, or other similar charge or tax applicable to service by the Company to the customer, or imposes a charge or tax based upon a percentage of gross receipts, net receipts, or revenues from sale of telephone service by the Company, the charges for local service to customers within such municipality shall be increased by an amount equal to each such customer's proportionate part of any such charge or tax, and such amount shall be shown separately on the customer's bill.

CANCELLED

AUG -1 1981

BY: *1st RSC*
PUBLIC SERVICE COMMISSION
OF MISSOURI

FILED
OCT 1 - 1978
Public Service Commission

*Indicates new rate
+Indicates change

ISSUED: August 18, 1978

EFFECTIVE: October 1, 1978

By Harold A. Jones, Manager
MID-MISSOURI TELEPHONE COMPANY
Pilot Grove, Missouri

P. S. C. Mo. No. 1 Consolidated

No supplement to this tariff will be issued except for the purpose of canceling this tariff.

Section 1
Original Sheet 9

For: Gilliam, Missouri

LOCAL EXCHANGE SERVICE

RECEIVED
JAN 25 1977
MISSOURI
Public Service Commission

+GENERAL

Unless otherwise specified, the charges quoted in this tariff are for one month and entitle the subscriber to standard telephone equipment and messages to all stations, in exchanges bearing the designation:

RATES

WITHIN THE INITIAL RATE AREA:

CLASS OF SERVICE		
	One-Party	Extensions
Business	\$ 9.95	\$ 1.50
Residence	6.75	1.00

RATES (Rural)

OUTSIDE THE INITIAL RATE AREA, But Within the Exchange Area.

CANCELLED

OCT 1 - 1978
BY 187RS9
PUBLIC SERVICE COMMISSION
OF MISSOURI

CLASS OF SERVICE		
	One-Party	Extensions
Business	\$ 9.95	\$ 1.50
Residence	6.75	1.00

+When any municipality imposes upon the Company any license, occupation, or other similar charge or tax applicable to service by the Company to the customer, or imposes a charge or tax based upon a percentage of gross receipts, net receipts, or revenues from sale of telephone service by the Company, the charges for local service to customers within such municipality shall be increased by an amount equal to each such customer's proportionate part of any such charge or tax, and such amount shall be shown separately on the customer's bill.

MAR 1 1977
Public Service Commission

*Indicates new rate
+Indicates change

P. S. C. Mo. No. 1 Consolidated

No supplement to this tariff will be issued except for the purpose of canceling this tariff.

Section 1
Original Sheet 10

For: High Point, Missouri

RECEIVED

 JAN 25 1977
 Public Service Commission

LOCAL EXCHANGE SERVICE

+GENERAL

Unless otherwise specified, the charges quoted in this tariff are for one month and entitle the subscriber to standard telephone equipment and messages to all stations, in exchanges bearing the designation: Fortuna, Latham, and High Point, Missouri.

RATES

WITHIN THE INITIAL RATE AREA:

CLASS OF SERVICE		
	One-Party	Extensions
Business	\$ 7.25	\$ 1.50
Residence	5.00	1.00

RATES (Rural)

OUTSIDE THE INITIAL RATE AREA, But Within the Exchange Area.

CLASS OF SERVICE		
	One-Party	Extensions
Business	\$ 7.25	\$ 1.50
Residence	5.00	1.00

CANCELLED

AUG - 1 1981
 BY 157 RS
 PUBLIC SERVICE COMMISSION
 OF MISSOURI

When any municipality imposes upon the Company any license, occupation, or other similar charge or tax applicable to service by the Company to the customer, or imposes a charge or tax based upon a percentage of gross receipts, net receipts, or revenues from sale of telephone service by the Company, the charges for local service to customers within such municipality shall be increased by an amount equal to each such customer's proportionate part of any such charge or tax, and such amount shall be shown separately on the customer's bill.

The customer has choice of color telephone instrument at time of installation subject to colors that are available from manufacturer.

MAR 1 1977
 Public Service Commission

*Indicates new rate
+Indicates change

No supplement to this tariff will be issued except for the purpose of canceling this tariff.

Section 1
1st Revised Sheet 11
Cancelling Original Sheet 11

For: Latham, Missouri

RECEIVED
JAN 15 1981
MISSOURI
Public Service Commission

LOCAL EXCHANGE SERVICE

+GENERAL

Unless otherwise specified, the charges quoted in this tariff are for one month and entitle the subscriber to standard telephone equipment and messages to all stations in exchanges bearing the designation:

RATES WITHIN THE INITIAL RATE AREA:

CLASS OF SERVICE			
		One Party	Extension
Business	Rotary Dial	\$ 9.95	\$1.50
	Touch Button Dial	\$11.95	\$1.65
Residence	Rotary Dial	\$ 6.75	\$1.00
	Touch Button Dial	\$ 8.75	\$1.15

RATES (Rural) OUTSIDE THE INITIAL RATE AREA, But Within the Exchange Area.

CLASS OF SERVICE			
		One Party	Extension
Business	Rotary Dial	\$ 9.95	\$1.50
	Touch Button Dial	\$11.95	\$1.65
Residence	Rotary Dial	\$ 6.75	\$1.00
	Touch Button Dial	\$ 8.75	\$1.15

+When any municipality imposes upon the Company any license, occupation, or other similar charge or tax applicable to service by the Company to the customer, or imposes a charge or tax based upon a percentage of gross receipts, net receipts, or revenues from sale of telephone service by the Company, the charges for local service to customers within such municipality shall be increased by an amount equal to each such customer's proportionate part of any such charge or tax, and such amount shall be shown separately on the customer's bill.

CANCELLED
AUG -1 1981

FILED
MAR -1 1981
Public Service Commission

*Indicates new rate
+Indicates change

ISSUED: January 16, 1981 EFFECTIVE: March 1, 1981

By Harold A. Jones, Manager
MID-MISSOURI TELEPHONE COMPANY
Pilot Grove, Missouri

No supplement to this tariff will be issued except for the purpose of canceling this tariff.

CANCELLED

Section 1
Original Sheet 11

MAR - 1 1981

BY 1st RS 11
PUBLIC SERVICE COMMISSION
OF MISSOURI

For: Latham, Missouri

RECEIVED
JAN 25 1977
Public Service Commission

LOCAL EXCHANGE SERVICE

+GENERAL

Unless otherwise specified, the charges quoted in this tariff are for one month and entitle the subscriber to standard telephone equipment and messages to all stations, in exchanges bearing the designation:

RATES

WITHIN THE INITIAL RATE AREA:

CLASS OF SERVICE				
	One-Party	Two-Party	FourParty	Extensions
Business	A 7.25			
	B 9.95	\$ -	\$ -	\$ 1.50
Residence	A 4.75	A 4.50		
	B 6.75	B -	-	1.00

RATES (Rural)

OUTSIDE THE INITIAL RATE AREA, But Within the Exchange Area.

CLASS OF SERVICE				
	One-Party	Two-Party	FOUR Party	Extensions
Business	A -		A 6.50	
	B 9.95	\$ -	B -	\$ 1.50
Residence	A -		A 4.50	
	B 6.75		B -	1.00

+When any municipality imposes upon the Company any license, occupation, or other similar charge or tax applicable to service by the Company to the customer, or imposes a charge or tax based upon a percentage of gross receipts, net receipts, or revenues from sale of telephone service by the Company, the charges for local service to customers within such municipality shall be increased by an amount equal to each such customer's proportionate part of any such charge or tax, and such amount shall be shown separately on the customer's bill.

A Applies to customers until facilities are available for all one-party service.

B. Applies outside the initial rate area when and as facilities are available for one-party service. Applies within the initial rate

*Indicates new rate
+Indicates change area with conversion of entire exchange to all one-party service

MAR 1 1977
Public Service Commission

ISSUED: January 26, 1977

EFFECTIVE: March 1, 1977

By Harold A. Jones, Manager
MID-MISSOURI TELEPHONE COMPANY
Pilot Grove, Missouri

No supplement to this tariff will be issued except for the purpose of canceling this tariff.

Section 1
Original Sheet 12

For: Marshall Junction, Mo.

LOCAL EXCHANGE SERVICE

RECEIVED
JAN 23 1977
MISSOURI
Public Service Commission

+GENERAL

Unless otherwise specified, the charges quoted in this tariff are for one month and entitle the subscriber to standard telephone equipment and messages to all stations, in exchanges bearing the designation:

RATES

WITHIN THE INITIAL RATE AREA:

CLASS OF SERVICE			
		One Party	Extension
Business	Rotary Dial	\$ 9.95	\$1.50
	Touch Button Dial	\$11.95	\$1.65
Residence	Rotary Dial	\$ 6.75	\$1.00
	Touch Button Dial	\$ 8.75	\$1.15

RATES (Rural)

OUTSIDE THE INITIAL RATE AREA, But Within the Exchange Area.

CLASS OF SERVICE			
		One Party	Extension
Business	Rotary Dial	\$ 9.95	\$1.50
	Touch Button Dial	\$11.95	\$1.65
Residence	Rotary Dial	\$ 6.75	\$1.00
	Touch Button Dial	\$ 8.75	\$1.15

+When any municipality imposes upon the Company any license, occupation, or other similar charge or tax applicable to service by the Company to the customer, or imposes a charge or tax based upon a percentage of gross receipts, net receipts, or revenues from sale of telephone service by the Company, the charges for local service to customers within such municipality shall be increased by an amount equal to each such customer's proportionate part of any such charge or tax, and such amount shall be shown separately on the customer's bill.

CANCELLED

AUG - 1 1981

BY *HRB*
PUBLIC SERVICE COMMISSION
OF MISSOURI

FILED
MAR 1 1977
Public Service Commission

*Indicates new rate
+Indicates change

ISSUED: January 26, 1977

EFFECTIVE: March 1, 1977

By Harold A. Jones, Manager
MID-MISSOURI TELEPHONE COMPANY
Pilot Grove, Missouri

P. S. C. Mo. No. 1 Consolidated

No supplement to this tariff will be issued except for the purpose of canceling this tariff.

Section 1
Original Sheet 13

For: Miami, Missouri

RECEIVED
JAN 25 1977
Public Service Commission

LOCAL EXCHANGE SERVICE

+GENERAL

Unless otherwise specified, the charges quoted in this tariff are for one month and entitle the subscriber to standard telephone equipment and messages to all stations, in exchanges bearing the designation: Miami, Missouri

RATES

WITHIN THE INITIAL RATE AREA:

CLASS OF SERVICE		
	One-Party	Extensions
Business	\$ 7.25	\$ 1.50
Residence	5.00	1.00

RATES (Rural)

OUTSIDE THE INITIAL RATE AREA, But Within the Exchange Area.

CLASS OF SERVICE		
	One-Party	Extensions
Business	\$ 7.25	\$ 1.50
Residence	5.00	1.00

CANCELLED

AUG - 1 1981
BY *LSR PS*
PUBLIC SERVICE COMMISSION
OF MISSOURI

*When any municipality imposes upon the Company any license, occupation, or other similar charge or tax applicable to service by the Company to the customer, or imposes a charge or tax based upon a percentage of gross receipts, net receipts, or revenues from sale of telephone service by the Company, the charges for local service to customers within such municipality shall be increased by an amount equal to each such customer's proportionate part of any such charge or tax, and such amount shall be shown separately on the customer's bill.

The customer has choice of color telephone instrument at time of installation, subject to colors that are available from manufacturer.

- *Indicates new rate
- +Indicates change

MARCH 1 1977
Public Service Commission

ISSUED: January 26, 1977

EFFECTIVE: March 1, 1977

By Harold A. Jones, Manager
MID-MISSOURI TELEPHONE COMPANY
Pilot Grove, Missouri

No supplement to this tariff will be issued except for the purpose of canceling this tariff.

Section 1
1st Revised Sheet 14
Cancelling Original Sheet 14

For: Nelson, Missouri

RECEIVED
AUG 21 1978
MISSOURI
Public Service Commission

LOCAL EXCHANGE SERVICE

+GENERAL

Unless otherwise specified, the charges quoted in this tariff are for one month and entitle the subscriber to standard telephone equipment and messages to all stations, in exchanges bearing the designation:

RATES

WITHIN THE INITIAL RATE AREA:

CLASS OF SERVICE			
		One Party	Extension
Business	Rotary Dial	\$ 9.95	\$1.50
	Touch Button Dial	\$11.95	\$1.65
Residence	Rotary Dial	\$ 6.75	\$1.00
	Touch Button Dial	\$ 8.75	\$1.15

RATES (Rural)

OUTSIDE THE INITIAL RATE AREA, But Within the Exchange Area.

CLASS OF SERVICE			
		One Party	Extension
Business	Rotary Dial	\$ 9.95	\$1.50
	Touch Button Dial	\$11.95	\$1.65
Residence	Rotary Dial	\$ 6.75	\$1.00
	Touch Button Dial	\$ 8.75	\$1.15

+When any municipality imposes upon the Company any license, occupation, or other similar charge or tax applicable to service by the Company to the customer, or imposes a charge or tax based upon a percentage of gross receipts, net receipts, or revenues from sale of telephone service by the Company, the charges for local service to customers within such municipality shall be increased by an amount equal to each such customer's proportionate part of any such charge or tax, and such amount shall be shown separately on the customer's bill.

*Indicates new rate
+Indicates change

CANCELLED
AUG -1 1981
BY *1st PS 4*
PUBLIC SERVICE COMMISSION
OF MISSOURI

FILED
OCT 1 - 1978
Public Service Commission

ISSUED: August 18, 1978

EFFECTIVE: October 1, 1978

By Harold A. Jones, Manager
MID-MISSOURI TELEPHONE COMPANY
Pilot Grove, Missouri

P. S. C. Mo. No. 1 Consolidated

No supplement to this tariff will be issued except for the purpose of canceling this tariff.

Section 1
Original Sheet 14

For: Nelson, Missouri

LOCAL EXCHANGE SERVICE

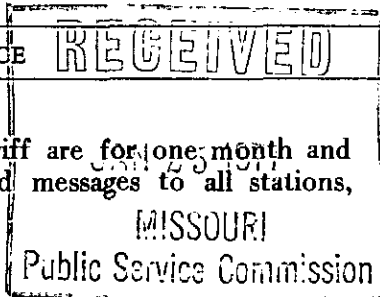

+GENERAL

Unless otherwise specified, the charges quoted in this tariff are for one month and entitle the subscriber to standard telephone equipment and messages to all stations, in exchanges bearing the designation:

RATES

WITHIN THE INITIAL RATE AREA:

CLASS OF SERVICE		
	One-Party	Extensions
Business	\$ 9.95	\$ 1.50
Residence	6.75	1.00

RATES (Rural)

OUTSIDE THE INITIAL RATE AREA, But Within the Exchange Area.

CANCELLED

CLASS OF SERVICE		
	One-Party	Extensions
Business	\$ 9.95	\$ 1.50
Residence	6.75	1.00

OCT 1 - 1978
BY 1st RS 14
PUBLIC SERVICE COMMISSION
OF MISSOURI

+When any municipality imposes upon the Company any license, occupation, or other similar charge or tax applicable to service by the Company to the customer, or imposes a charge or tax based upon a percentage of gross receipts, net receipts, or revenues from sale of telephone service by the Company, the charges for local service to customers within such municipality shall be increased by an amount equal to each such customer's proportionate part of any such charge or tax, and such amount shall be shown separately on the customer's bill.

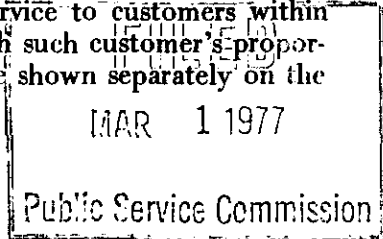

*Indicates new rate
+Indicates change

ISSUED: January 26, 1977

By Harold A. Jones, Manager
MID-MISSOURI TELEPHONE COMPANY
Pilot Grove, Missouri

EFFECTIVE: March 1, 1977

P. S. C. Mo. No. 1 Consolidated

No supplement to this tariff will be issued except for the purpose of canceling this tariff.

Section 1
1st Revised Sheet 15
Cancelling Original Sheet 15

For: Pilot Grove, Missouri

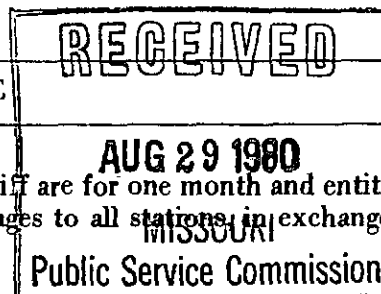

LOCAL EXCHANGE SERVICE

+GENERAL

Unless otherwise specified, the charges quoted in this tariff are for one month and entitle the subscriber to standard telephone equipment and messages to all stations in exchanges bearing the designation:

RATES
WITHIN THE INITIAL RATE AREA:

CLASS OF SERVICE			
		One Party	Extension
Business	Rotary Dial	\$ 9.95	\$1.50
	Touch Button Dial	\$11.95	\$1.65
Residence	Rotary Dial	\$ 6.75	\$1.00
	Touch Button Dial	\$ 8.75	\$1.15

RATES (Rural)
OUTSIDE THE INITIAL RATE AREA, But Within the Exchange Area.

CLASS OF SERVICE			
		One Party	Extension
Business	Rotary Dial	\$ 9.95	\$1.50
	Touch Button Dial	\$11.95	\$1.65
Residence	Rotary Dial	\$ 6.75	\$1.00
	Touch Button Dial	\$ 8.75	\$1.15

+When any municipality imposes upon the Company any license, occupation, or other similar charge or tax applicable to service by the Company to the customer, or imposes a charge or tax based upon a percentage of gross receipts, net receipts, or revenues from sale of telephone service by the Company, the charges for local service to customers within such municipality shall be increased by an amount equal to each such customer's proportionate part of any such charge or tax. Such amount shall be shown separately on the customer's bill.

CANCELLED
AUG - 1 1981
BY *LR RS*
PUBLIC SERVICE COMMISSION
OF MISSOURI

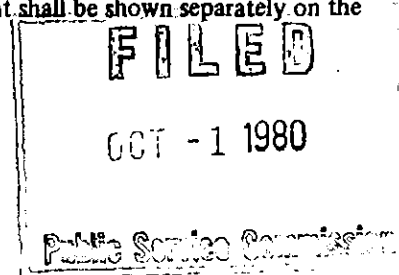

*Indicates new rate
+Indicates change

ISSUED: August 28, 1980

EFFECTIVE: October 1, 1980

By Harold A. Jones, Manager
MID-MISSOURI TELEPHONE COMPANY
Pilot Grove, Missouri

No supplement to this tariff will be issued except for the purpose of canceling this tariff.

CANCELLED

OCT - 1 1980

For: Pilot Grove, Missouri

BY 10th RS #15
PUBLIC SERVICE COMMISSION
OF MISSOURI

RECEIVED
JAN 25 1977
Public Service Commission

LOCAL EXCHANGE SERVICE

+GENERAL

Unless otherwise specified, the charges quoted in this tariff are for one month and entitle the subscriber to standard telephone equipment and messages to all stations, in exchanges bearing the designation:

RATES

WITHIN THE INITIAL RATE AREA:

CLASS OF SERVICE				
	One-Party	Two-Party	FourParty	Extensions
Business	A 7.25	-	-	\$ 1.50
	\$ B 9.95	\$ -	\$ -	
Residence	A 4.75	-	A 3.75	1.00
	B 6.75		B -	

RATES (Rural)

OUTSIDE THE INITIAL RATE AREA, But Within the Exchange Area.

CLASS OF SERVICE				
	One-Party	Two-Party	TenParty	Extensions
Business	\$ B 9.95	\$	A 4.00	\$ 1.50
			\$ B -	
Residence	B 6.75		A 4.00	1.00
			B -	

+When any municipality imposes upon the Company any license, occupation, or other similar charge or tax applicable to service by the Company to the customer, or imposes a charge or tax based upon a percentage of gross receipts, net receipts, or revenues from sale of telephone service by the Company, the charges for local service to customers within such municipality shall be increased by an amount equal to each such customer's proportionate part of any such charge or tax, and such amount shall be shown separately on the customer's bill.

A. Applies to customers until facilities are available for all one-party service.

B. Applies outside the initial rate area when and as facilities are available for one-party service. Applies within the initial rate

*Indicates new rate

*Indicates change

area with conversion of entire exchange to all one-party service.

No supplement to this tariff will be issued except for the purpose of canceling this tariff.

Section 1
Original Sheet 15.1

Pilot Grove, Missouri

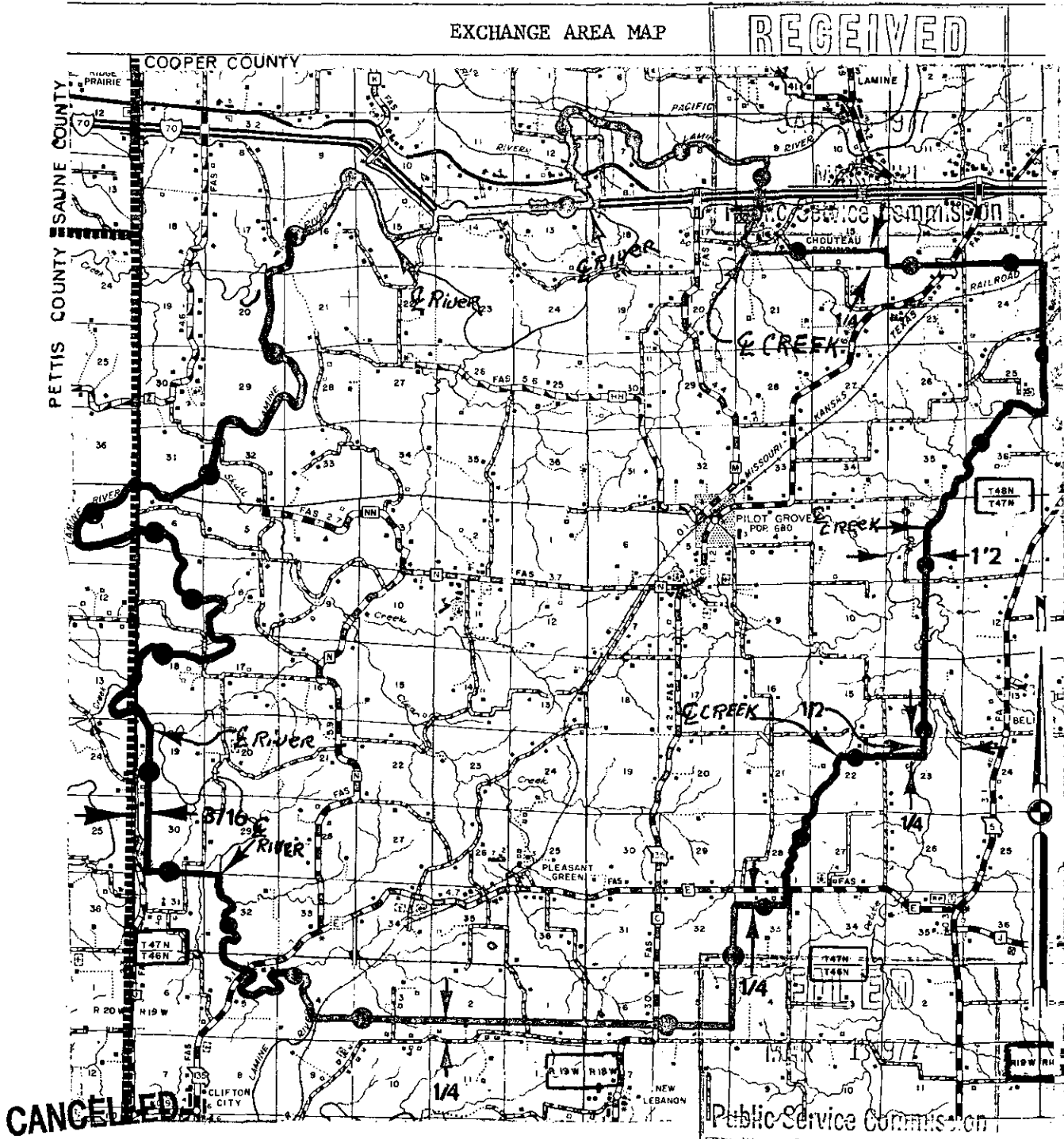

By *RS*
Public Service Commission
MISSOURI

NOV. 01 1948
ISSUED: January 26, 1977

EFFECTIVE: March 1, 1977

By Harold A. Jones, Manager
MID-MISSOURI TELEPHONE COMPANY
Pilot Grove, Missouri

No supplement to this tariff will be issued except for the purpose of canceling this tariff.

Section 1
1st Revised Sheet 16
Cancelling Original Sheet 16

For: Speed, Missouri

LOCAL EXCHANGE SERVICE

+GENERAL

Unless otherwise specified, the charges quoted in this tariff are for one month and entitle the subscriber to standard telephone equipment and messages to all stations, in exchanges bearing the designation:

RECEIVED

MAY 2 1978

MISSOURI
Public Service Commission

RATES

WITHIN THE INITIAL RATE AREA:

CLASS OF SERVICE			
		One Party	Extension
Business	Rotary Dial	\$ 9.95	\$1.50
	Touch Button Dial	\$11.95	\$1.65
Residence	Rotary Dial	\$ 6.75	\$1.00
	Touch Button Dial	\$ 8.75	\$1.15

RATES (Rural)

OUTSIDE THE INITIAL RATE AREA, But Within the Exchange Area.

CLASS OF SERVICE			
		One Party	Extension
Business	Rotary Dial	\$ 9.95	\$1.50
	Touch Button Dial	\$11.95	\$1.65
Residence	Rotary Dial	\$ 6.75	\$1.00
	Touch Button Dial	\$ 8.75	\$1.15

+When any municipality imposes upon the Company any license, occupation, or other similar charge or tax applicable to service by the Company to the customer, or imposes a charge or tax based upon a percentage of gross receipts, net receipts, or revenues from sale of telephone service by the Company, the charges for local service to customers within such municipality shall be increased by an amount equal to each such customer's proportionate part of any such charge or tax, and such amount shall be shown separately on the customer's bill.

CANCELLED

AUG - 1 1981

BY *LSX PS 4*
PUBLIC SERVICE COMMISSION
OF MISSOURI

FILED

JUN 1 - 1978

Public Service Commission

*Indicates new rate
+Indicates change

ISSUED: May 1, 1978

EFFECTIVE: June 1, 1978

BY Harold A. Jones, Manager
MID-MISSOURI TELEPHONE COMPANY
Pilot Grove, Missouri

P. S. C. Mo. No. 1 Consolidated

No supplement to this tariff will be issued except for the purpose of canceling this tariff.

Section 1
Original Sheet 16

For: Speed, Missouri

RECEIVED

 JAN 25 1977
CANCELLED

LOCAL EXCHANGE SERVICE

+GENERAL

Unless otherwise specified, the charges quoted in this tariff are for one month and entitle the subscriber to standard telephone equipment and messages to all stations, in exchanges bearing the designation:

RATES

WITHIN THE INITIAL RATE AREA:

JUN 1 1978

	CLASS OF SERVICE			Extensions
	One-Party	Two-Party	Four-Party	
Business	A 7.25	-	-	\$ 1.50
	\$ B 9.95	\$ -	\$ -	
Residence	A 4.75	-	A 3.75	1.00
	B 6.75	-	-	

BY 157 PS 16
PUBLIC SERVICE COMMISSION OF MISSOURI

RATES (Rural)

OUTSIDE THE INITIAL RATE AREA, But Within the Exchange Area.

	CLASS OF SERVICE			
	One-Party	Two-Party	Ten-Party	Extensions
Business	\$ B 9.95	\$	A 4.00	\$ 1.50
			\$ B -	
Residence	B 6.75		A 4.00	1.00
			B ..	

+When any municipality imposes upon the Company any license, occupation, or other similar charge or tax applicable to service by the Company to the customer, or imposes a charge or tax based upon a percentage of gross receipts, net receipts, or revenues from sale of telephone service by the Company, the charges for local service to customers within such municipality shall be increased by an amount equal to each such customer's proportionate part of any such charge or tax, and such amount shall be shown separately on the customer's bill.

A. Applies to customers until facilities are available for all one-party service.

B. Applies outside the initial rate area when and as facilities are available for one-party service. Applies within the initial rate

*Indicates new rate
*Indicates change area with conversion of entire exchange to all one-party service.

5011 1500
 MAR 1 1977

ISSUED: January 26, 1977

EFFECTIVE: March 1, 1977

By Harold A. Jones, Manager
MID-MISSOURI TELEPHONE COMPANY
Pilot Grove, Missouri

No supplement to this tariff will be issued except for the purpose of canceling this tariff.

Section 1
Original Sheet 16.1

Speed, Missouri

EXCHANGE AREA MAP

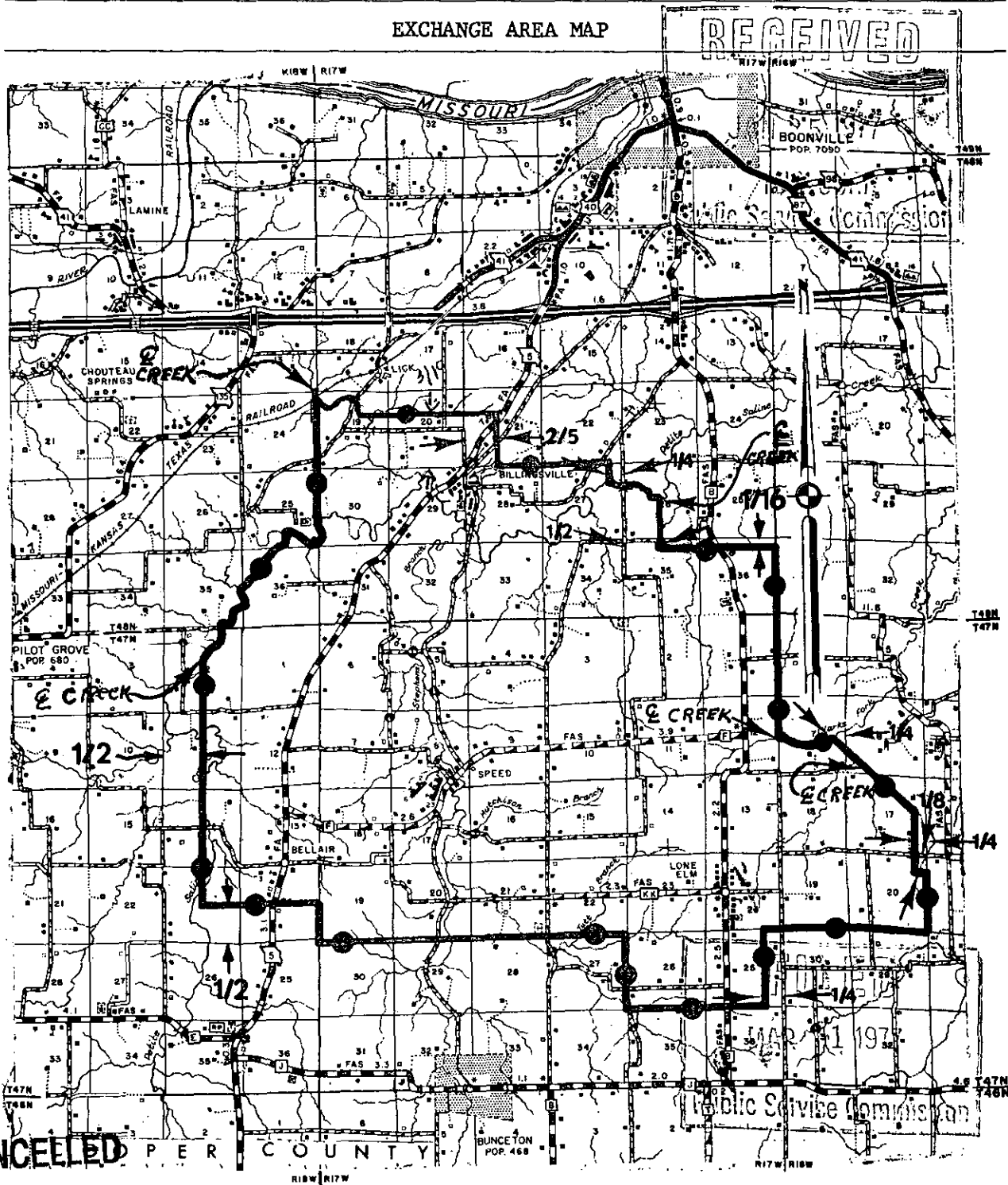

CANCELED

NOV 01 1998

ISSUED: January 26, 1977

EFFECTIVE: March 1, 1977

By *RS #16.1*
Public Service Commission
MISSOURI

By Harold A. Jones, Manager
MID-MISSOURI TELEPHONE COMPANY
Pilot Grove, Missouri

P.S.C. Mo. No. 1 Consolidated

RECEIVED

No supplement to this tariff will be issued except for the purpose of canceling this tariff.

Section 2
7th Revised Sheet 1
Cancelling 6th Revised Sheet 1

DEC 1 1987

Public Service Commission

GENERAL REGULATIONS INDEX

	Section	Sheet No.
Abuse or Fraudulent Use of Service.....	14	10
Adjustments for Municipality Payments.....	27	20
Advance Payments.....	6	5
Alterations.....	20	14
Application of Rates		
Business.....	4	3
Residence.....	5	4
Application of Regulations.....	1	3
Application for Service.....	3	3
Combination Main Station Service.....	28	21
Connection of Automatic Dialing-Announcing		
Devices Used for Solicitation.....	29	21
Customer		
Billing.....	12	9.1
Owned Equipment..... <i>Service Charge</i>	31	22
Premises Equipment.....	11	9
Use of Service.....	22	14
Deposit.....	8	6
Directories.....	19	13
Discontinuance of Service.....	9	7
Establishment of Credit.....	7	5
Minimum Contract Period.....	13	9.1
Obligation of the Company for		
Furnishing of Services.....	23	15
Maintenance and Repair.....	23	15
Liability.....	23	16
Provision of Facilities.....	11	7.1
Resale of Service.....	17	13
Restoral of Service.....	10	7
Solicitation.....	29	21
Special Construction.....	24	17
Special Facilities or Assemblies.....	25	18
Tax Adjustments.....	27	20

CANCELLED

OCT 30 2000

By *JHRS*
Public Service Commission
MISSOURI

JAN 01 1988
Public Service Commission

*Indicates new rate
+Indicates Change

ISSUED:

DEC 1 1987

EFFECTIVE:

JAN 1 1988

By Harold A. Jones, Manager
MID-MISSOURI TELEPHONE COMPANY
Pilot Grove, Missouri

P.S.C. Mo. No. 1 Consolidated

No supplement to this tariff will be issued except for the purpose of canceling this tariff.

Section 2
6th Revised Sheet 1
Cancelling 5th Revised Sheet 1

RECEIVED
 JUL 26 1983
 MISSOURI
 Public Service Commission

GENERAL REGULATIONS INDEX

	Regulation No.	Sheet No.
Abuse or Fraudulent Use of Service.....	14	10
Adjustments for Municipality Payments.....	27	20
Advance Payments.....	26	19
Advance Wiring.....	26	19
Alterations.....	20	14
Application of Rates		
Business.....	4	3
Residence.....	5	4
Application of Regulations.....	1	3
Application for Service.....	3	3
Combination Main Station Service.....	28	21
Connection of Automatic Dialing-Announcing		
Devices Used for Solicitation.....	29	21
Customer		
Billing.....	12	9.1
Owned Equipment.....	31	22
Premises Equipment.....	11	9
Use of Service.....	22	14
Deposit.....	8	6
Directories.....	9	13
Discontinuance of Service.....	5	7
Establishment of Credit.....	7	5
Minimum Contract Period.....	7	9.1
Obligation of the Company for		
Furnishing of Services.....	15	15
Maintenance and Repair.....	15	15
Liability.....	23	16
Provision of Equipment.....	11	7.1
Resale of Service.....	17	13
Restoral of Service.....	10	7
+Sale of Telephone Equipment.....	33	23
+Sale of Telephone Equipment In-Place.....	34	23
Solicitation.....	29	21
Special Construction.....	24	17
Special Equipment or Assemblies.....	25	18
Tax Adjustments.....	27	20

CANCELLED

JAN 01 1983

BY *J.H. R.S. #13*
 PUBLIC SERVICE COMMISSION
 OF MISSOURI

FILED
 SEP - 1 1983
 Public Service Commission

*Indicates new rate
+Indicates Change

ISSUED: July 22, 1983

EFFECTIVE: September 1, 1983

By Harold A. Jones, Manager
 MID-MISSOURI TELEPHONE COMPANY
 Pilot Grove, Missouri

P.S.C. Mo. No. 1 Consolidated

No supplement to this tariff will be issued except for the purpose of canceling this tariff.

Section 2
 5th Revised Sheet
 Cancelling 4th Revised Sheet 1

RECEIVED

GENERAL REGULATIONS INDEX

DEC 15 1982

	Regulation No.	MISSOURI Public Service Commission Sheet No.
Abuse or Fraudulent Use of Service.....	1	10
Adjustments for Municipality Payments.....	27	20
Advance Payments.....	6	5
Advance Wiring.....	26	19
Alterations.....	20	14
Application of Rates		
Business.....	4	3
Residence.....	5	4
Application of Regulations.....	1	3
Application for Service.....	3	3
Combination Main Station Service.....	28	21
Connection of Automatic Dialing-Announcing Devices Used for Solicitation.....	29	21
Customer		
+Billing.....	12	9.1
Owned Equipment.....	31	22
+Premises Equipment.....	11	9
Use of Service.....	22	14
Deposit.....	8	6
Directories.....	19	13
Discontinuance of Service.....	9	7
Establishment of Credit.....	7	5
+Minimum Contract Period.....	13	9.1
Obligation of the Company for		
Furnishing of Services.....	23	15
Maintenance and Repair.....	23	15
Liability.....	23	16
Provision of Equipment.....	11	7.1
Resale of Service.....	17	13
Restoral of Service.....	10	7
Solicitation.....	29	21
Special Construction.....	24	17
Special Equipment or Assemblies.....	25	18
Tax Adjustments.....	27	20

CANCELLED

SEP - 1 1983
 BY *lth RS 1*
 PUBLIC SERVICE COMMISSION
 OF MISSOURI

*Indicates new rate
 +Indicates Change

ISSUED: December 21, 1982

EFFECTIVE: **FILED** January 1, 1983

By Harold A. Jones, Manager
 MID-MISSOURI TELEPHONE COMPANY
 Pilot Grove, Missouri

JAN - 1 1983

Public Service Commission

No supplement to this tariff will be issued except for the purpose of canceling this tariff.

Section 2
4th Revised Sheet 1
Cancelling 3rd Revised Sheet 1

GENERAL REGULATIONS INDEX

RECEIVED

	Regulation No.	Sheet No.
Abuse or Fraudulent Use of Service.....	14	10
Adjustments for Municipality Payments.....	27	20
Advance Payments.....		5
Advance Wiring.....	26	19
Alterations.....	20	14
Application of Rates		
Business.....	4	3
Residence.....	5	4
Application of Regulations.....	1	3
Application for Service.....	3	3
Combination Main Station Service.....	28	21
Connection of Automatic Dialing-Announcing Devices Used for Solicitation.....	29	21
Customer		
Billing.....	12	9
Owned Equipment.....	31	22
Use of Service.....	22	14
Deposit.....	8	6
Directories.....	19	13
Discontinuance of Service.....	9	7
Establishment of Credit.....	7	5
Minimum Contract Period.....	13	9
Obligation of the Company for		
Furnishing of Services.....	23	15
Maintenance and Repair.....	23	15
Liability.....	23	16
Provision of Equipment.....	11	7.1
Resale of Service.....	17	13
Restoral of Service.....	10	7
Solicitation.....	29	21
Special Construction.....	24	17
Special Equipment or Assemblies.....	25	18
Tax Adjustments.....	27	20

NOV 13 1981
MISSOURI
Public Service Commission

CANCELLED

JAN - 1 1983
BY *RS*
PUBLIC SERVICE COMMISSION
OF MISSOURI

FILED
SEP 12 1981
Public Service Commission

*Indicates new rate
+Indicates Change

ISSUED: August 12, 1981

EFFECTIVE: September 12, 1981

By Harold A. Jones, Manager
MID-MISSOURI TELEPHONE COMPANY
Pilot Grove, Missouri

P.S.C. Mo. No. 1 Consolidated

No supplement to this tariff will be issued except for the purpose of canceling this tariff.

Section 2
3rd Revised Sheet
Cancelling 2nd Revised Sheet 1

RECEIVED

GENERAL REGULATIONS INDEX

SEP - 2 1980

MISSOURI
Regulations No. Sheet No.
Public Service Commission

Abuse or Fraudulent Use of Service.....	14	10
Adjustments for Municipality Payments.....	27	20
Advance Payments.....	6	5
Advance Wiring.....	26	19
Alterations.....	20	14
Application of Rates		
Business.....	4	3
Residence.....	5	4
Application of Regulations.....	1	3
Application For Services.....	3	3
Combination Main Station Service.....	28	21
Connection of Automatic Dialing-Announcing Devices Used for Solicitation.....	29	21
Customer		
Billing.....	12	9
+Owned Equipment.....	31	22
Use of Service.....	22	14
Deposit.....	8	6
Directories.....	19	13
Discontinuance of Service.....	9	7
Establishment of Credit.....	7	5
Minimum Contract Period.....	13	9
Obligation of the Company for		
Furnishing of Services.....	23	15
Maintenance and Repair.....	23	15
Liability.....	23	16
Party Line use of Service.....	21	14
Provision of Equipment.....	11	7.1
Resale of Service.....	17	13
Restoral of Service.....	10	7
Solicitation.....	29	21
Special Construction.....	24	17
Special Equipment or Assemblies.....	25	18
Tax Adjustments.....	27	20

CANCELLED
SEP 12 1981
BY 48/RS
PUBLIC SERVICE COMMISSION
OF MISSOURI

**TELEPHONE AUTHORITY
ORDER NO. 758**

FILED

OCT - 7 1980

*Indicates new rate
+Indicates Change

ISSUED: August 29, 1980

EFFECTIVE: September 2, 1980

OCT - 7 1980

By Harold A. Jones, Manager
MID-MISSOURI TELEPHONE COMPANY
Pilot Grove, Missouri

Mo. P.S.C. Mo. No. 1 Consolidated

No supplement to this tariff will be issued except for the purpose of canceling this tariff.

Section 2
2nd Revised Sheet 1
Cancelling 1st Revised Sheet 1

GENERAL REGULATIONS INDEX

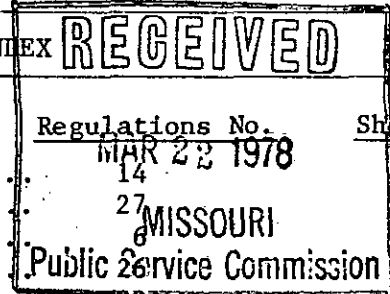

	Regulations No.	Sheet No.
Abuse or Fraudulent Use of Service.....	14	10
Adjustments for Municipality Payments.....	27	20
Advance Payments.....	6	5
Advance Wiring.....	2	19
Alterations.....	20	14
Application of Rates		
Business.....	4	3
Residence.....	5	4
Application of Regulations.....	1	3
Application for Services.....	3	3
Combination Main Station Service.....	28	21
+Connection of Automatic Dialing-Announcing Devices Used for Solicitation.....	29	21
Customer		
Billing.....	12	9
Use of Service.....	22	14
Deposit.....	8	6
Directories.....	19	13
Discontinuance of Service.....	9	7
Establishment of Credit.....	7	5
Minimum Contract Period.....	13	9
Obligation of the Company for		
Furnishing of Services.....	23	15
Maintenance and Repair.....	23	15
Liability.....	23	16
Party Line Use of Service.....	21	14
Provision of Equipment.....	11	7.1
Resale of Service.....	17	13
Restoral of Service.....	10	7
+Solicitation.....	29	21
Special Construction.....	24	17
Special Equipment or Assemblies.....	25	18
Tax Adjustments.....	27	20

CANCELLED

*Indicates new rate
+Indicates Change

OCT - 7 1980
BY 3rd RS#1
PUBLIC SERVICE COMMISSION
MISSOURI

ISSUED: March 24, 1978

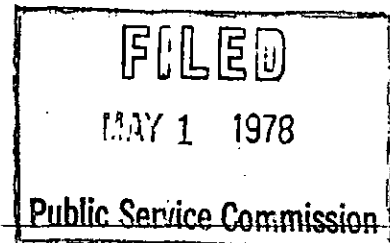

EFFECTIVE: May 1, 1978

By Harold A. Jones, Manager
MID-MISSOURI TELEPHONE COMPANY
Pilot Grove, Missouri

Mo. P.S.C. Mo. No. 1 Consolidated

No supplement to this tariff will be issued except for the purpose of canceling this tariff.

Section 2
1st Revised Sheet 1
Cancelling Original Sheet 1

RECEIVED

 DEC 14 1977

 MISSOURI
 Public Service Commission

	Regulations No.	Sheet No.
Abuse or Fradulent Use of Service.....	14	10
Adjustments for Municipality Payments.....	27	20
Advance Payments.....	6	5
Advance Wiring.....	26	19
Alterations.....	20	14
Application of Rates		
Business.....	4	3
Residence.....	5	4
Application of Regulations.....	1	3
Application for Services.....	3	3
Combination Main Station Service.....	28	21
Customer		
Billing.....	12	9
Use of Service.....	22	14
Deposit.....	8	6
Directories.....	19	13
Discontinuance of Service.....	9	7
Establishment of Credit.....	7	5
Minimum Contract Period.....	13	9
Obligation of the Company for		
Furnishing of Services.....	23	15
Maintenance and Repair.....	23	15
Liability.....	23	16
Party Line Use of Service.....	21	14
+ Provision of Equipment.....	11	7.1
Resale of Service.....	17	13
Restoral of Service.....	10	7
Special Construction.....	24	17
Special Equipment or Assemblies.....	25	18
Tax Adjustments.....	27	20

CANCELLED

MAY 1 1978
 BY J. R. S. I
 PUBLIC SERVICE COMMISSION
 OF MISSOURI

FILED
 MAR 1 1978
 Public Service Commission

*Indicates new rate
+Indicates Change

ISSUED: DEC 14 1977

EFFECTIVE: MAR 1 1978

By Harold A. Jones, Manager
 MID-MISSOURI TELEPHONE COMPANY
 Pilot Grove, Missouri

No supplement to this tariff will be issued except for the purpose of canceling this tariff.

Section 2
Original Sheet 1

GENERAL REGULATIONS INDEX

	Regulations No.	Sheet No
Abuse or Fraudulent Use of Service.....	14	10
Adjustments for Municipality Payments.....	27	20
Advance Payments.....	6	5
Advance Wiring.....	26	19
Alterations.....	20	14
Application of Rates		
Business.....	4	3
Residence.....	5	4
Application of Regulations.....	1	3
Application for Services.....	3	3
Combination Main Station Service.....	28	21
Customer		
Billing.....	12	9
Use of Service.....	22	14
Deposit.....	8	6
Directories.....	19	13
Discontinuance of Service.....	9	7
Establishment of Credit.....	7	5
Minimum Contract Period.....	13	9
Obligation of the Company for		
Furnishing of Services.....	23	15
Maintenance and Repair.....	23	15
Liability.....	23	16
Party Line Use of Service.....	21	14
Provision of Equipment.....	11	7
Resale of Service.....	17	13
Restoral of Service.....	10	7
Special Construction.....	24	17
Special Equipment or Assemblies.....	25	18
Tax Adjustments.....	27	20

CANCELLED

MAR 1 1978

BY 15X R S I
PUBLIC SERVICE COMMISSION
OF MISSOURI

*Indicates new rate
+Indicates Change

FILED
MAR 1 1977
Public Service Commission

ISSUED: January 26, 1977

EFFECTIVE: March 1, 1977

By Harold A. Jones, Manager
MID-MISSOURI TELEPHONE COMPANY
Pilot Grove, Missouri

P.S.C. Mo. No. 1 Consolidated

No supplement to this tariff will be issued except for the purpose of canceling this tariff.

Section 2
1st Revised Sheet 2
Cancelling Original Sheet 2

RECEIVED

GENERAL REGULATIONS INDEX

	Regulations No.	SEP - 2 1980 MISSOURI Public Service Commission	Sheet No.
Telephone Numbers.....	18		13
Termination of Service			
By the Company.....	16		12
By the Customer.....	16		12
+Uncollectibles.....	30		22
Undertaking of the Company.....	2		3
Unlawful Use of Service.....	15		11

CANCELLED

OCT 3 0 2000

By *2nd DS #2*
Public Service Commission
MISSOURI

TELEPHONE AUTHORITY
ORDER NO. 758

FILED

OCT - 7 1980

*Indicates new rate
+Indicates Change

ISSUED: August 29, 1980

EFFECTIVE: ~~SEP 2 1980~~

By Harold A. Jones, Manager
MID-MISSOURI TELEPHONE COMPANY
Pilot Grove, Missouri

OCT - 7 1980

Mo. P.S.C. Mo. No. 1 Consolidated

No supplement to this tariff will be issued except for the purpose of canceling this tariff.

Section 2
Original Sheet 2

GENERAL REGULATIONS INDEX

Regulations No. 1977 Sheet No.

Telephone Numbers.....	18	13
Termination of Service		
By the Company.....	16	11
By the Customer.....	16	12
Undertaking of the Company.....	2	3
Unlawful Use of Service.....	15	11

CANCELLED

OCT - 7 1980
BY *1st BS #2*
PUBLIC SERVICE COMMISSION
OF MISSOURI

FILED
MAR 1 1977
Public Service Commission

*Indicates new rate
+Indicates Change

ISSUED: January 26, 1977

EFFECTIVE: March 1, 1977

By Harold A. Jones, Manager
MID-MISSOURI TELEPHONE COMPANY
Pilot Grove, Missouri

CANCELLED

No supplement to this tariff will be issued except for the purpose of canceling this tariff.

Section 2
Original Sheet 3

OCT 30 2000

By *ISPS#3*
Public Service Commission
MISSOURI
GENERAL REGULATIONS

CANCELLED
JAN 25 1977
Commission

1. Application of Regulations

- A. The regulations set forth herein apply to intrastate services and facilities furnished within the state of Missouri by Mid-Missouri Telephone Company hereinafter referred to as the Company, subject to the jurisdiction of the Missouri Public Service Commission.
- B. When services and facilities are provided in part by the Company and in part by other companies, the regulations of the Company apply to that portion of the service or facilities furnished by it.

2. Undertaking of the Company

- A. The Company does not undertake to transmit messages, but offers the use of its facilities, where available, for communication between parties subject to the terms and conditions specified in these tariffs.

3. Applications for Services

- A. Applications for service may be made orally or in writing.
- B. Any change in rates or regulations prescribed by the Missouri Public Service Commission modifies the terms and regulations of contracts to the extent of such change.

4. Application of Business Rates

- A. Business rates apply in offices, stores, factories, and all other places of a strictly business nature.
- B. In boarding houses (except as noted under 5.B.) offices of hotels and offices of apartment buildings, quarters occupied by clubs or lodges, public, private, or parochial schools, or colleges, hospitals, libraries, churches, college fraternity houses, and other similar institutions (but excluding dormitory rooms at such schools or colleges).

CANCELLED
MAR 1 1977
Public Service Commission

*Indicates new rate
+Indicates Change

ISSUED: January 26, 1977

EFFECTIVE: March 1, 1977

By Harold A. Jones, Manager
MID-MISSOURI TELEPHONE COMPANY
Pilot Grove, Missouri

No supplement to this tariff will be issued except for the purpose of canceling this tariff.

Section 2
Original Sheet 4

GENERAL REGULATIONS (Continued)

4. Application of Business Rates (Continued)

JAN 23 1977

- C. At residence locations when the customer has no regular business telephone and the use of the service either by himself; members of his household, or his guests, or parties calling him can be considered as more of a business than of a residence nature, which fact might be indicated by advertising, either by business cards, newspapers, hand bills, billboards, circulars, motion picture screens, or other advertising matter, such as on vehicles, etc., or when such business use is not such as commonly arises and passes over to residence telephones during the intervals when, in compliance with the law or established custom, business places are ordinarily closed.
- D. Where the place of business and residence of a customer are in the same premises and no telephone is installed in the place of business, the business rate shall be charged for the telephone installed in the residence.
- E. At residence locations, when an extension station or extension bell is located in a shop, office, or other place of business.
- F. At any location where the listing of service at that location indicates a business, trade or profession, except as specified below.

5. Application of Residence Rates

- A. Residence rates apply in private residences where business alphabetical or classified telephone directory listings are not provided.
- B. In private apartments of hotels, rooming houses, or boarding houses where service is confined to the customer's use, and elsewhere in rooming houses which are not advertised as a place of business or which have less than five rooms for roomers or which furnish meals to less than ten boarders, provided business telephone directory listings are not furnished.

FILED
MAR 1 1977
Public Service Commission

CANCELLED

OCT 30 2000

By *BSR* #24
Public Service Commission
MISSOURI

*Indicates new rate
+Indicates Change

ISSUED: January 26, 1977

EFFECTIVE: March 1, 1977

By Harold A. Jones, Manager
MID-MISSOURI TELEPHONE COMPANY
Pilot Grove, Missouri

No supplement to this tariff will be issued except for the purpose of canceling this tariff.

Section 2
2nd Revised Sheet 5
Cancelling 1st Revised Sheet 5

RECEIVED

GENERAL REGULATIONS

OCT 26 1981

MISSOURI

Public Service Commission

5. Application of Residence Rates (Continued)

- C. In the places of residence of a clergyman, and in the place of residence of a physician, dentist, veterinarian, surgeon or other medical practitioner, provided the customer does not maintain an office in the residence. In the residence of a Christian Science practitioner, nurse or midwife, or in the office of any of this group of persons, provided the office is located in the customers residence and is not part of an office building. In any of such cases the listing may indicate the customer's profession, but only in connection with an individual name. If listings of firms or partnerships, etc., or additional listings of persons not residing in the same household are desired, business rates apply.
- D. Where the place of business and residence of a customer are in the same premises and no telephone is installed in the place of business the business rate shall be charged for the telephone installed in the residence.

6. Advance Payments

- A. At the time an application for service is made, an applicant may be required to pay an amount equal to at least one month's service and/or installation charges which may be applicable, in addition to such special construction and installation charges as are to be borne by the applicant. The amount of the advance payment is credited to the customer's account on the first bill rendered.
- B. Federal, State or Municipal governmental agencies may not be required to make advance payments.

+7. Establishment of Credit - Residence Service

- +A. The Company is not obligated to establish, furnish or continue to furnish service to any individual that owes for service previously rendered at the same or a different address, until arrangements have been made to liquidate such previous indebtedness to the Company. In order to insure the payment of all charges due for its service, the Company may require any customer to establish and maintain his credit. If he cannot show evidence of a

*Indicates new rate

+Indicates Change

ISSUED: October 23, 1981

EFFECTIVE: November 23, 1981

By Harold A. Jones, Manager
MID-MISSOURI TELEPHONE COMPANY NOV 23 1981
Pilot Grove, Missouri

FILED

Public Service Commission

No supplement to this tariff will be issued except for the purpose of canceling this tariff.

Section 2
1st Revised Sheet 5
Cancelling Original Sheet 5

RECEIVED

GENERAL REGULATIONS

SEP - 2 1980

5. Application of Residence Rates (Continued)

MISSOURI

- C. In the places of residence of a clergyman, and in the place of residence of a physician, dentist, veterinarian, surgeon or other medical practitioner, provided the customer does not maintain an office in the residence. In the residence of a Christian Science practitioner, nurse or midwife, or in the office of any of this group of persons, provided the office is located in the customers residence and is not part of an office building. In any of such cases the listing may indicate the customer's profession, but only in connection with an individual name. If listings of firms or partnerships, etc., or additional listings of persons not residing in the same household are desired, business rates apply.
- D. Where the place of business and residence of a customer are in the same premises and no telephone is installed in the place of business the business rate shall be charged for the telephone installed in the residence.

6. Advance Payments

- A. At the time an application for service is made, an applicant may be required to pay an amount equal to at least one month's service and/or installation charges which may be applicable, in addition to such special construction and installation charges as are to be borne by the applicant. The amount of the advance payment is credited to the customer's account on the first bill rendered.
- B. Federal, State or Municipal governmental agencies may not be required to make advance payments.

7. Establishment of Credit

- +A. The Company is not obligated to establish, furnish or continue to furnish service to any individual or firm that owes for service previously rendered at the same or a different address, until arrangements have been made to liquidate such previous indebtedness to the Company. In order to insure the payment of all charges due for its service, the Company may require any customer to establish and maintain his credit. If he cannot show evidence of a

*Indicates new rate
+Indicates Change

TELEPHONE AUTHORITY

ORDER NO. 758

Public Service Commission

ISSUED: August 29, 1980

EFFECTIVE: September 2, 1980

OCT - 7 1980

By Harold A. Jones, Manager
MID-MISSOURI TELEPHONE COMPANY
Pilot Grove, Missouri

CANCELLED

NOV 23 1981

BY Zad RS 5
PUBLIC SERVICE COMMISSION
OF MISSOURI

No supplement to this tariff will be issued except for the purpose of canceling this tariff.

Section 2
Original Sheet 5

GENERAL REGULATIONS (Continued)

5. Application of Residence Rates (Continued)

JAN 25 1977

- C. In the places of residence of a clergyman, and in the place of residence of a physician, dentist, veterinary surgeon or other medical practitioner, provided the customer does not maintain an office in the residence. In the residence of a Christian Science practitioner, nurse or midwife, or in the office of any of this group of persons, provided the office is located in the customers residence and is not part of an office building. In any of such cases the listing may indicate the customer's profession, but only in connection with an individual name. If listings of firms or partnerships, etc., or additional listings of persons not residing in the same household are desired, business rates apply.
- D. Where the place of business and residence of a customer are in the same premises and no telephone is installed in the place of business, the business rate shall be charged for the telephone installed in the residence.

6. Advance Payments

- A. At the time an application for service is made, an applicant may be required to pay an amount equal to at least one month's service and/or installation charges which may be applicable, in addition to such special construction and installation charges as are to be borne by the applicant. The amount of the advance payment is credited to the customer's account on the first bill rendered.
- B. Federal, State or Municipal governmental agencies may not be required to make advance payments.

7. Establishment of Credit

- A. The Company is not obligated to establish, furnish or continue to furnish service to any individual or firm that owes for service previously rendered at the same or a different address, until arrangements have been made to liquidate such ~~previous indebtedness~~ to the Company. In order to insure the payment of all charges due for its service, the Company may require any customer to establish and maintain his credit in one of the following ways:

*Indicates new rate
+Indicates Change

Public Service Commission

ISSUED: January 26, 1977

EFFECTIVE: March 1, 1977

By Harold A. Jones, Manager
MID-MISSOURI TELEPHONE COMPANY
Pilot Grove, Missouri

CANCELLED

OCT - 7 1980

BY 102 RS #5
PUBLIC SERVICE COMMISSION
OF MISSOURI

1977
1 1977

No supplement to this tariff will be issued except for the purpose of canceling this tariff.

Section 2
1st Revised Sheet 5.1
Cancelling Original Sheet 5.1

GENERAL REGULATIONS

+7. Establishment of Credit - Residence Service - (Continued) OCT 26 1981

A. (Continued)

satisfactory payment record for prior telephone bills. The following criteria will be applied:

RECEIVED

MISSOURI
Public Service Commission

1. Home ownership, excluding mobile homes.
2. Existence of a checking account, regardless of age.
3. Existence of a savings account, regardless of age.
4. Motor vehicle ownership
5. Full time employment more than two years with current employer.
6. Applicant being 50 years of age.
7. Possession of a recent charge card.
8. Possession of a major or national charge card.
9. Possession of a major oil company credit card.
10. An existing loan from a financial institution not considered delinquent by the creditor.

A positive response to any two of the above criteria, makes a deposit unnecessary.

*Indicates new rate
+Indicates Change

ISSUED: October 23, 1981

EFFECTIVE: November 1, 1981

By Harold A. Jones, Manager
MID-MISSOURI TELEPHONE COMPANY
Pilot Grove, Missouri

FILED
NOV 23 1981
Public Service Commission

No supplement to this tariff will be issued except for the purpose of canceling this tariff.

Section 2
Original Sheet 5.1

RECEIVED

GENERAL REGULATIONS

SEP - 2 1980

7. Establishment of Credit (Continued)

+A. (Continued)

MISSOURI
Public Service Commission

satisfactory payment record for prior telephone service, the following criteria will be applied:

1. Home ownership, excluding mobile homes.
2. Existence of a checking account, regardless of age.
3. Existence of a savings account, regardless of age.
4. Motor vehicle ownership
5. Full time employment more than two years with current employer.
6. Applicant being 50 years of age.
7. Possession of a recent charge card.
8. Possession of a major or national charge card.
9. Possession of a major oil company credit card.
10. An existing loan from a financial institution not considered delinquent by the creditor.

A positive response to any two of the above criteria, makes a deposit unnecessary.

CANCELLED

NOV 23 1981
BY 1st RS 5.1
PUBLIC SERVICE COMMISSION
OF MISSOURI

FILED

OCT - 7 1980

TELEPHONE AUTHORITY
ORDER NO 758

*Indicates new rate

+Indicates Change

ISSUED: August 29, 1980

EFFECTIVE: ~~September 2, 1980~~

OCT - 7 1980

By Harold A. Jones, Manager
MID-MISSOURI TELEPHONE COMPANY
Pilot Grove, Missouri

No supplement to this tariff will be issued except for the purpose of canceling this tariff.

Section 2
3rd Revised Sheet 6
Cancelling 2nd Revised Sheet 6

RECEIVED
OCT 26 1981
MISSOURI
Public Service Commission

GENERAL REGULATIONS

+8. Deposits and Guarantees of Payment - Residence Service

- A. The Company may require a deposit or guarantee as a condition of service if the customer or prospective customer:
 - 1. Is unable to establish that he or she had a previous service account with a telephone utility for a period of at least twelve (12) months for which all undisputed charges were satisfactorily paid.
 - 2. Is unable to establish a credit rating under standards contained in tariffs of the Company which shall be filed with and approved by the commission, provided that this subparagraph (2) shall only be applicable if a customer or prospective customer would otherwise be required to post a deposit or guarantee under subparagraph (1).
- B. The Company may require a deposit or guarantee as a condition of continued service if under any of the following circumstances:
 - 1. The customer has undisputed charges in two out of the last twelve (12) billing periods which have become delinquent. A telephone utility shall with respect to each customer maintain a record of all charges which have become delinquent within the last twelve (12) billing periods.
 - 2. The customer has had service discontinued for nonpayment at any time during the preceding twelve (12) billing periods.
 - 3. The customer established service with the telephone utility within the preceding six (6) months, and incurs toll or other charges in any one (1) billing period which are equal to at least 400 percent of the amount of the deposit or guarantee previously required by the telephone utility.

CANCELLED

OCT 30 2000
By *44h RS #6*
Public Service Commission
MISSOURI

*Indicates new rate
+Indicates Change

ISSUED: October 23, 1981

EFFECTIVE: November 23, 1981

By Harold A. Jones, Manager
MID-MISSOURI TELEPHONE COMPANY
Pilot Grove, Missouri

FILED
NOV 23 1981
Public Service Commission

No supplement to this tariff will be issued except for the purpose of canceling this tariff.

Section 2
2nd Revised Sheet 6
Cancelling 1st Revised Sheet 6

SEP - 2 1980

GENERAL REGULATIONS

MISSOURI
Public Service Commission

8. Deposits and Guarantees of Payment

- +A. The Company may require a deposit or guarantee as a condition of service if the customer or prospective customer;
 - +1. Is unable to establish that he or she had a previous service account with a telephone utility for a period of at least twelve (12) months for which all undisputed charges were satisfactorily paid.
 - +2. Is unable to establish a credit rating under standards contained in tariffs of the Company which shall be filed with and approved by the commission, provided that this subparagraph (2) shall only be applicable if a customer or prospective customer would otherwise be required to post a deposit or guarantee under subparagraph (1).
- +B. The Company may require a deposit or guarantee as a condition of continued service if under any of the following circumstances;
 - +1. The customer has undisputed charges in two out of the last twelve (12) billing periods which have become delinquent. A telephone utility shall with respect to each customer maintain a record of all charges which have become delinquent within the last twelve (12) billing periods.
 - +2. The customer has had service discontinued for nonpayment at any time during the preceding twelve (12) billing periods.
 - +3. The customer established service with the telephone utility within the preceding six (6) months, and incurs toll or other charges in any one (1) billing period which are equal to at least 400 percent of the amount of the deposit or guarantee previously required by the telephone utility.

CANCELLED

NOV 23 1981
BY 3rd RS 6
PUBLIC SERVICE COMMISSION
OF MISSOURI

TELEPHONE AUTHORITY
ORDER NO. 758

FILED

OCT - 7 1980

Public Service Commission

*Indicates new rate
+Indicates Change

ISSUED: August 29, 1980

EFFECTIVE: ~~September 1, 1980~~

OCT - 7 1980

By Harold A. Jones, Manager
MID-MISSOURI TELEPHONE COMPANY
Pilot Grove, Missouri

No supplement to this tariff will be issued except for the purpose of canceling this tariff.

Section 2
1st Revised Sheet 6
Cancelling Original Sheet 6

GENERAL REGULATIONS

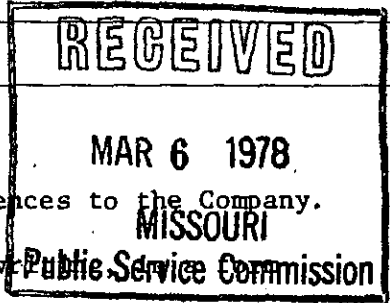

7. Establishment of Credit (Continued)

A. (Continued)

1. By furnishing acceptable credit references to the Company.
2. By providing a suitable guarantee in writing as prescribed by the Company.
3. By means of a cash deposit.

B. The Company shall be the sole judge as to whether or not the references or guarantee in writing are acceptable.

8. Deposits or Guarantee

A. A deposit or guarantee may be required for the purpose of establishing service if the customer or prospective customer has an unpaid and undisputed delinquent account with a telephone utility which accrued within the last two (2) years or if such a delinquent account was paid within the last six (6) months.

As a condition of continued service to an existing customer, a deposit or guarantee may be required if undisputed charges in two (2) out of the last twelve (12) billing periods became delinquent.

The deposit or guarantee shall not exceed estimated charges for two (2) months service based on the average bill during the preceding twelve (12) months or estimated for the next twelve (12) months by the customer and the company.

Concurrent with the establishment of service, a customer may post a deposit in two (2) equal monthly installments or as otherwise agreed upon.

CANCELLED

OCT - 7 1980

BY 2nd DS #6
PUBLIC SERVICE COMMISSION
OF MISSOURI

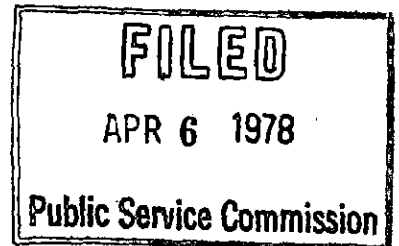

*Indicates new rate
+Indicates Change

ISSUED: MAR 3 1978

EFFECTIVE: APR 6 1978

By Harold A. Jones, Manager
MID-MISSOURI TELEPHONE COMPANY
Pilot Grove, Missouri

No supplement to this tariff will be issued except for the purpose of canceling this tariff.

GENERAL REGULATIONS

7. Establishment of Credit (Continued)

1. By furnishing acceptable credit references to the Company.
2. By providing a suitable guarantee in writing, in a form prescribed by the Company.
3. By means of a cash deposit.

B. The Company shall be the sole judge as to whether or not the references or guarantee in writing are acceptable.

8. Deposits

A. A deposit may be required for the purpose of establishing a customer's credit but shall not exceed his estimated bill for exchange service and toll charges for one normal billing period plus thirty days. The Company may require the customer to increase the amount of the deposit at any time if, in its opinion, the charges billed against the customer are found to warrant such an increase.

B. Deposit not to affect regular collection practices.

The fact that a deposit has been made shall in no way relieve the applicant or customer from complying with the Company's regulations as to advance payments and the prompt payment of bills on presentation, nor constitute a waiver or modification of the regular practices of the Company providing for the discontinuance of service for non-payment of any sums due the Company for services rendered. The Company may discontinue service to any customer failing to pay current bills without regard to the fact that such customer has made a deposit with the Company to secure payment of such bills or has furnished the Company with a guarantee in writing of such bills.

C. Interest to be paid on deposits.

CANCELLED

APR 6 1978

BY 1st AS 6
PUBLIC SERVICE COMMISSION

FILED

MAR 1 1977

Public Service Commission

*Indicates new rate

+Indicates Change

ISSUED: January 26, 1977

OF MISSOURI

EFFECTIVE: March 1, 1977

By Harold A. Jones, Manager
MID-MISSOURI TELEPHONE COMPANY
Pilot Grove, Missouri

No supplement to this tariff will be issued except for the purpose of canceling this tariff.

Section 2
2nd Revised Sheet 6.1
Cancelling 1st Revised Sheet 6.1

GENERAL REGULATIONS

RECEIVED

+8. Deposits and Guarantees of Payment - Residence Service (Continued)

C. No deposit or guarantee or additional deposit or guarantee shall be required by a telephone utility because of race, sex, national origin, marital status, age, number of dependents, source of income, condition of physical handicap or geographical area of residence.

OCT 26 1981
MISSOURI
Public Service Commission

D. A deposit shall be subject to the following terms:

1. It shall not exceed estimated charges for two (2) months service based on the average bill during the preceding twelve (12) months or in the case of new applications for service, the average monthly bill for all subscribers within a customer class.
2. It shall bear interest at nine (9) percent per annum, which shall be credited annually upon the account of the customer or paid upon the return of the deposit, whichever occurs first.
3. Upon discontinuance or termination, it shall be credited, with accrued interest to the charge stated on the final bill and the balance, if any, shall be returned to the customer within twenty-one days of the rendition of such final bill.

CANCELLED

OCT 30 2000
By *3rd RS #6.1*
Public Service Commission
MISSOURI

*Indicates new rate
+Indicates Change

ISSUED: October 23, 1981

EFFECTIVE: November 23, 1981

By Harold A. Jones, Manager
MID-MISSOURI TELEPHONE COMPANY
Pilot Grove, Missouri

FILED
NOV 23 1981
Public Service Commission

No supplement to this tariff will be issued except for the purpose of canceling this tariff.

Section 2
1st Revised Sheet 6.1
Cancelling Original Sheet 6.1

RECEIVED

GENERAL REGULATIONS

SEP - 2 1980

8. Deposits and Guarantees of Payment (Continued)

MISSOURI

+C. No deposit or guarantee or additional deposit or guarantee shall be required by a telephone utility because of race, sex, creed, national origin, marital status, age, number of dependents, source of income, condition of physical handicap or geographical area of residence.

+D. A deposit shall be subject to the following terms:

- +1. It shall not exceed estimated charges for two (2) months service based on the average bill during the preceding twelve (12) months or in the case of new applications for service, the average monthly bill for all subscribers within a customer class.
- +2. It shall bear interest at nine (9) percent per annum, which shall be credited annually upon the account of the customer or paid upon the return of the deposit, whichever occurs first.
- +3. Upon discontinuance or termination, it shall be credited, with accrued interest to the charge stated on the final bill and the balance, if any, shall be returned to the customer within twenty-one days of the rendition of such final bill.

CANCELLED

NOV 23 1981
BY *2nd RS 6.1*
PUBLIC SERVICE COMMISSION
OF MISSOURI

TELEPHONE AUTHORITY
ORDER NO. 758

FILED

OCT - 7 1980

*Indicates new rate
+Indicates Change

ISSUED: August 29, 1980

EFFECTIVE: ~~September 29, 1980~~

By Harold A. Jones, Manager
MID-MISSOURI TELEPHONE COMPANY
Pilot Grove, Missouri

OCT - 7 1980

No supplement to this tariff will be issued except for the purpose of canceling this tariff.

Section 2
Original Sheet 6.1

GENERAL REGULATIONS

8. Deposits or Guarantee (Continued)

B. Deposit not to affect regular collection practices.

The fact that a deposit has been made shall in no way relieve the applicant or customer from complying with the Company's regulations as to advance payments and the prompt payment of bills on presentation, nor constitute a waiver or modification of the regular practices of the Company providing for the discontinuance of service for non-payment of any sums due the Company for services rendered. The Company may discontinue service to any customer failing to pay current bills without regard to the fact that such customer has made a deposit with the Company to secure payment of such bills or has furnished the Company with a guarantee in writing of such bills.

C. Interest to be paid on deposits.

RECEIVED
MAR 6 1978
MISSOURI
Public Service Commission

CANCELLED

OCT - 7 1980

BY 1st RS #6.1
PUBLIC SERVICE COMMISSION
OF MISSOURI

FILED
APR 6 1978
Public Service Commission

*Indicates new rate
+Indicates Change.

ISSUED: MAR 3 1978

EFFECTIVE: APR 6 1978

By Harold A. Jones, Manager
MID-MISSOURI TELEPHONE COMPANY
Pilot Grove, Missouri

No supplement to this tariff will be issued except for the purpose of canceling this tariff.

Section 2
1st Revised Sheet 6.2
Cancelling Original Sheet 6.2

GENERAL REGULATIONS

RECEIVED
OCT 26 1981
MISSOURI
Public Service Commission

+8. Deposits and Guarantees of Payment - Residence Service

D. (Continued)

- 4. Upon satisfactory payment of all undelivered charges during the last twelve (12) billing periods, it shall be the accrued interest be promptly refunded or credited against charges stated on subsequent bills. Payment of a charge is satisfactory if received prior to the date upon which the charge becomes delinquent provided it is not in dispute. A telephone utility may withhold refund of a deposit pending the resolution of a dispute with respect to charges secured by such deposit.
- 5. A telephone utility shall maintain records which show the name of each customer who has posted a deposit, the current address of such customers, the date and amount of deposit, the date and amount of interest paid, and the earliest possible refund date.
- 6. Each customer posting a deposit shall receive in writing at the time of posting or within ten (10) days from the date a receipt which contains the following information:
 - 1. Name of customer.
 - 2. Address where the service for which the deposit is required will be provided.
 - 3. Place where deposit was received or a designated code which identifies the location.
 - 4. Date when the deposit was received.
 - 5. Amount of deposit.
 - 6. The terms which govern retention and refund of the deposit.
- 7. A telephone utility shall show on the customer's bill whether or not the customer has a deposit with the company and thereby provide means whereby a person entitled to a refund of a deposit is not deprived of the refund even though he may be unable to produce the receipt for the deposit, provided he can produce identification to ensure that he is the person entitled to the refund. A telephone utility shall maintain a record of the deposit refunded and interest paid on such deposit for a period of at least two (2) years after the refund is made.

CANCELLED

OCT 30 2000

By 2nd RS #6.2
Public Service Commission
MISSOURI

*Indicates new rate
+Indicates Change

ISSUED: October 23, 1981

EFFECTIVE: November 23, 1981

By Harold A. Jones, Manager
MID-MISSOURI TELEPHONE COMPANY
Pilot Grove, Missouri

FILED
NOV 23 1981
Public Service Commission

No supplement to this tariff will be issued except for the purpose of canceling this tariff.

Section 2
Original Sheet 6.2

RECEIVED

GENERAL REGULATIONS

SEP - 2 1980

8. Deposits and Guarantees of Payment (Continued)

MISSOURI
Public Service Commission

+D. (Continued)

+4. Upon satisfactory payment of all undisputed charges during the last twelve (12) billing periods, it shall with accrued interest be promptly refunded or credited against charges stated on subsequent bills. Payment of a charge is satisfactory if received prior to the date upon which the charge becomes delinquent provided it is not in dispute. A telephone utility may withhold refund of a deposit pending the resolution of a dispute with respect to charges secured by such deposit.

+5. A telephone utility shall maintain records which show the name of each customer who has posted a deposit, the current address of such customers, the date and amount of deposit, the date and amount of interest paid, and the earliest possible refund date.

+6. Each customer posting a deposit shall receive in writing at the time of posting or within ten (10) days from the date a receipt which contains the following information:

1. Name of customer.
2. Address where the service for which the deposit is required will be provided.
3. Place where deposit was received or a designated code which identifies the location.
4. Date when the deposit was received.
5. Amount of deposit.
6. The terms which govern retention and refund of the deposit.

+7. A telephone utility shall show on the customer's bill whether or not the customer has a deposit with the company and thereby provide means whereby a person entitled to a refund of a deposit is not deprived of the refund even though he may be unable to produce the receipt for the deposit, provided he can produce identification to ensure that he is the person entitled to the refund. A telephone utility shall maintain a record of the deposit refunded and interest paid on such deposit for a period of at least two years after the refund is made.

*Indicates new rate
+Indicates Change

TELEPHONE COMPANY

ORDER NO. 758

ISSUED: August 29, 1980

EFFECTIVE: [REDACTED]

OCT - 7 1980

By Harold A. Jones, Manager
MID-MISSOURI TELEPHONE COMPANY
Pilot Grove, Missouri

CANCELLED

NOV 23 1981
BY [Signature] 6.2
PUBLIC SERVICE COMMISSION
OF MISSOURI

No supplement to this tariff will be issued except for the purpose of canceling this tariff.

Section 2
1st Revised Sheet 6.3
~~Cancelling Original Sheet 6.3~~

RECEIVED
OCT 26 1981
MISSOURI
Public Service Commission

GENERAL REGULATIONS

+8. Deposits and Guarantees of Payment - Residence Service

D. (Continued)

8. A telephone utility shall permit a customer, concurrent with the beginning of service, to post a deposit in two (2) equal monthly installments or as otherwise agreed upon.

E. In lieu of a deposit a telephone utility may accept a written guarantee. The limit of the guarantee shall not exceed the amount of a cash deposit.

F. A guarantor shall be released upon satisfactory payment of all undisputed charges during the last twelve (12) billing periods. Payment of a charge is satisfactory if received prior to the date upon which the charge becomes delinquent provided it is not in dispute.

+8.1 Deposits and Guarantees of Payment - Business Service

+A. If it is deemed necessary by the Telephone Company in safeguarding its interests, applicants for service or present customers may be required to make a deposit of an amount not to exceed two months' exchange service charges plus two months' estimated long distance service charges, to be applied in payment of any unpaid charges for exchange or long distance service which may be rendered. Simple interest at the rate of nine percent (9%) per annum will be paid on deposits held thirty days or more.

+B. The Company is not obligated to establish, furnish or continue to furnish service to any individual or firm that owes for service previously rendered at the same or a different address, until arrangements have been made to liquidate such previous indebtedness to the Company. In order to insure the payment of all charges due for its service, the Company may require any customer to establish and maintain his credit.

CANCELLED

OCT 30 2000

By *2nd RS #63*

Public Service Commission
MISSOURI

*Indicates new rate
+Indicates Change

ISSUED: October 23, 1981

EFFECTIVE: November 23, 1981

By Harold A. Jones, Manager
MID-MISSOURI TELEPHONE COMPANY
Pilot Grove, Missouri

FILED
NOV 23 1981
Public Service Commission

No supplement to this tariff will be issued except for the purpose of canceling this tariff.

Section 2
Original Sheet 6.3

RECEIVED

GENERAL REGULATIONS

SEP - 2 1980

8. Deposits and Guarantees of Payment (Continued)

MISSOURI
Public Service Commission

+D. (Continued)

+8. A telephone utility shall permit a customer, concurrent with the beginning of service, to post a deposit in two (2) equal monthly installments or as otherwise agreed upon.

+E. In lieu of a deposit a telephone utility may accept a written guarantee. The limit of the guarantee shall not exceed the amount of a cash deposit.

+F. A guarantor shall be released upon satisfactory payment of all undisputed charges during the last twelve (12) billing periods. Payment of a charge is satisfactory if received prior to the date upon which the charge becomes delinquent provided it is not in dispute.

CANCELLED

NOV 23 1981
BY Late RS 6.3
PUBLIC SERVICE COMMISSION
OF MISSOURI

TELEPHONE AUTHORITY
ORDER NO. 758

FILED

OCT - 7 1980

*Indicates new rate
+Indicates Change

ISSUED: August 29, 1980

EFFECTIVE: ~~September 1, 1980~~

By Harold A. Jones, Manager
MID-MISSOURI TELEPHONE COMPANY
Pilot Grove, Missouri

OCT - 7 1980

No supplement to this tariff will be issued except for the purpose of canceling this tariff.

Section 2
Original Sheet 6.4

GENERAL REGULATIONS

RECEIVED
OCT 26 1981
MISSOURI
Public Service Commission

+8.1 Deposits and Guarantees of Payment - Business Service (Continued)

- +C. An applicant for service, or a present customer, may satisfy a deposit requirement by providing a Contract of Guaranty in an amount not less than the requested deposit from a source acceptable to the Telephone Company. The guaranty contract shall be on a form provided by the Telephone Company which shall include the Company's right to transfer charges to the limit of the guaranty, from a defaulted bill of the customer, from whom a deposit or a Contract of Guaranty was required, to the guarantor's account or accounts and the further right to suspend the guarantor's service.
- +D. The fact that a deposit has been made, or a guaranty provided, shall in no way relieve the customer from complying with the Telephone Company's regulations as to the prompt payment of bills, nor constitute a waiver or modification of the regular practices of the Telephone Company providing for the temporary suspension of service or the termination of the service contract for non-payment of bills.
- +E. Service may be discontinued for failure to furnish a suitable deposit, when conditions appear to require the Telephone Company to have such credit protection, after the Telephone Company has furnished five days' written notice to the customer requiring the customer to furnish such deposit. If, in the judgment of the Telephone Company, unusual risk of financial loss exists, service may be suspended after forty-eight hours written notice has been furnished to the customer.
- +F. Any balance of the amount deposited and credited to the customer's account is returned to the customer at the termination of the contract, or it may be returned at any time previous thereto at the option of the Telephone Company when it is deemed that the customer has established satisfactory credit.

CANCELLED

JAN 01 1998

By LSRS # 6.4
Public Service Commission
MISSOURI

*Indicates new rate
+Indicates Change

ISSUED: October 23, 1981

EFFECTIVE: November 25, 1981

By Harold A. Jones, Manager
MID-MISSOURI TELEPHONE COMPANY
Pilot Grove, Missouri

FILED
NOV 23 1981
Public Service Commission

Mid Missouri Telephone Company
of Pilot Grove, Missouri

P.S.C. MO. NO. 1 Consolidated
Section 2
5th Revised Sheet No. 7
Cancels 4th Revised Sheet No. 7

RECEIVED

GENERAL REGULATIONS

9. Discontinuance of Service for Failure to Maintain Credit

NOV 19 1997

A. A customer shall have at least twenty-one (21) days from rendition of a bill to pay charges as stated except when the customer has had service discontinued because of non payment within the last twelve (12) months, or where the customer incurs toll or other charges at any time during the billing period which are equal to at least 400 percent of the amount of the deposit or guarantee previously required from the customer, in which case payment may be demanded for the toll charges (in less than twenty-one (21) days) by a telephone call to the customer followed by written notification of such demand sent by First Class Mail. If the toll charges remain unpaid for ten (10) days from rendition of written notification or a mutually established late payment arrangement date after such demand, whichever is less or twenty-one (21) days from rendition of the bill, such charges will be deemed delinquent.

Service may be discontinued because of non payment of delinquent charges after the customer has been given five (5) days notice by means of a written notice sent by First Class Mail. Service shall not be discontinued because of non payment of a disputed item on the customers bill.

Non payment of undisputed, delinquent state or interstate long distance service charges billed by the Company or undisputed, delinquent exchange service charges including any FCC-approved end user charge or both, with the exception of Lifeline service. *

Service shall not be discontinued on a day when the offices of the Company are not open to facilitate reconnection of service, or on a day immediately preceding such day.

At least twenty-four (24) hours preceding a discontinuance, the Company shall make reasonable efforts to contact the customer to advise them of the proposed discontinuance and the steps the

CANCELLED

OCT 30 2000
By *WRS* #7
Public Service Commission
MISSOURI

FILED

JAN -1 1998

* Indicates new rate or text
+ Indicates change

MISSOURI
Public Service Commission

Issued: November 25, 1997

Harold Jones
Mid Missouri Telephone Co.
Pilot Grove, Missouri

Effective: January 1, 1998

No supplement to this tariff will be issued except for the purpose of canceling this tariff.

Section 2
4th Revised Sheet 7
Cancelling 3rd Revised Sheet 7

RECEIVED
MAY 21 1984

GENERAL REGULATIONS

+9. Discontinuance of Service for Failure to Maintain Credit

MISSOURI
Public Service Commission

+A. A customer shall have at least twenty-one (21) days from rendition of a bill to pay charges as stated except when the customer has had service discontinued because of non payment within the last twelve (12) months, or where the customer incurs toll or other charges at any time during the billing period which are equal to at least 400 percent of the amount of the deposit or guarantee previously required from the customer, in which case payment may be demanded for the toll charges (in less than twenty-one (21) days) by a telephone call to the customer followed by written notification of such demand sent by First Class Mail. If the toll charges remain unpaid for ten (10) days from rendition of written notification or a mutually established late payment arrangement date after such demand, whichever is less or twenty-one (21) days from rendition of the bill, such charges will be deemed delinquent.

Service may be discontinued because of non payment of delinquent charges after the customer has been given five (5) days notice by means of a written notice sent by First Class Mail. Service shall not be discontinued because of non payment of a disputed item on the customers bill.

+Non payment of undisputed, delinquent state or interstate long distance service charges billed by the Company or undisputed, delinquent exchange service charges including any FCC-approved end user charge or both.

Service shall not be discontinued on a day when the offices of the Company are not open to facilitate reconnection of service, or on a day immediately preceding such day.

At least twenty-four (24) hours preceding a discontinuance, the Company shall make reasonable efforts to contact the customer to advise them of the proposed discontinuance and the steps the

CANCELLED

FILED
JUL - 1 1984
Public Service Commission

JAN 01 1998
By 5th RS # 7
Public Service Commission
MISSOURI

*Indicates new rate
+Indicates Change

ISSUED: May 18, 1984

EFFECTIVE: July 1, 1984

By Harold A. Jones, Manager
MID-MISSOURI TELEPHONE COMPANY
Pilot Grove, Missouri

No supplement to this tariff will be issued except for the purpose of canceling this tariff.

Section 2
3rd Revised Sheet 7
Cancelling 2nd Revised Sheet 7

GENERAL REGULATIONS

RECEIVED

+9. Discontinuance of Service for Failure to Maintain Credit-Residence Service

NOV 23 1981

+A. A residential customer shall have at least twenty-one (21) days from rendition of a bill to pay charges at state when the customer has had service discontinued because of non payment within the last twelve (12) months, or where the customer incurs toll or other charges at any time during the billing period which are equal to at least 400 percent of the amount of the deposit or guarantee previously required from the customer, in which case payment may be demanded for the toll charges (in less than twenty-one (21) days) by a telephone call to the customer followed by written notification of such demand sent by First Class Mail. If the toll charges remain unpaid for ten (10) days from rendition of written notification or a mutually established late payment arrangement date after such demand, whichever is less or twenty-one (21) days from rendition of the bill, such charges will be deemed delinquent.

MISSOURI Public Service Commission

CANCELLED

JUL - 1 1984
BY 4th RS 7
PUBLIC SERVICE COMMISSION OF MISSOURI

Service may be discontinued because of non payment of delinquent charges after the customer had been given five (5) days notice by means of a written notice sent by First Class Mail. Service shall not be discontinued because of non payment of a disputed item on the customers bill.

Service shall not be discontinued on a day when the offices of the Company are not open to facilitate re-connection of service, or on a day immediately preceding such day.

At least twenty-four (24) hours preceding a discontinuance the Company shall make reasonable efforts to contact the customer to advise them of the proposed discontinuance and the steps the

*Indicates new rate
+Indicates Change

ISSUED: October 23, 1981

EFFECTIVE: November 23, 1981

By Harold A. Jones, Manager
MID-MISSOURI TELEPHONE COMPANY
Pilot Grove, Missouri

FILED
NOV 23 1981
Public Service Commission

No supplement to this tariff will be issued except for the purpose of canceling this tariff.

Section 2
2nd Revised Sheet 7
~~Cancelling 1st Revised Sheet 7~~

RECEIVED

GENERAL REGULATIONS

SEP - 2 1980

9. Discontinuance of Service for Failure to Maintain Credit

MISSOURI

Public Service Commission

+A. A customer shall have at least twenty-one (21) days from the rendition of a bill to pay charges as stated except when the customer has had service discontinued because of non payment within the last twelve (12) months, or where the customer incurs toll or other charges at any time during the billing period which are equal to at least 400 percent of the amount of the deposit or guarantee previously required from the customer, in which case payment may be demanded for the toll charges (in less than twenty-one (21) days) by a telephone call to the customer followed by written notification of such demand sent by First Class Mail. If the toll charges remain unpaid for ten (10) days from rendition of written notification or a mutually established late payment arrangement date after such demand, whichever is less or twenty-one (21) days from rendition of the bill, such charges will be deemed delinquent.

Service may be discontinued because of non payment of delinquent charges after the customer had been given five (5) days notice by means of a written notice sent by First Class Mail. Service shall not be discontinued because of non payment of a disputed item on the customers bill.

Service shall not be discontinued on a day when the offices of the Company are not open to facilitate re-connection of service, or on a day immediately preceding such day.

At least twenty-four (24) hours preceding a discontinuance the Company shall make reasonable efforts to contact customer to advise them of the proposed discontinuance and the steps the

FILED

TELEPHONE AUTHORITY

*Indicates new rate
+Indicates Change

ORDER NO. 758

ISSUED: August 29, 1980

EFFECTIVE: ~~September 2, 1980~~

By Harold A. Jones, Manager
MID-MISSOURI TELEPHONE COMPANY
Pilot Grove, Missouri

OCT - 7 1980

CANCELLED

NOV 23 1981
BY 3rd BS 7
PUBLIC SERVICE COMMISSION
OF MISSOURI

No supplement to this tariff will be issued except for the purpose of canceling this tariff.

Section 2
1st Revised Sheet 7
Canceling Original Sheet 7

RECEIVED
DEC 14 1977
MISSOURI
Public Service Commission

GENERAL REGULATIONS

8. Deposits (Continued)
C. (Continued)

Interest at the rate of not less than 6% per annum shall be paid by the Company on all deposits made for the purpose of establishing credit. Simple interest shall be computed from the date of payment of the deposit and shall be paid annually or at the time of discontinuance of service or withdrawal of the deposit.

Upon satisfactory payment of all undisputed charges during the last twelve (12) billing periods, the deposit shall with accrued interest be promptly credited against charges stated on subsequent bills. Payment of a charge is satisfactory if received prior to the date upon which the charge becomes delinquent provided it is not in dispute. The Company may withhold refund of a deposit pending the resolution of a dispute with respect to charges secured by the deposit.

9. Discontinuance of Service for Failure to Maintain Credit

A customer shall have at least twenty-one (21) days from the rendition of a bill to pay charges as stated except when the customer has had service discontinued because of non payment within the last twelve (12) months, in which case payment may be demanded for the toll charges in less than twenty-one (21) days. If the toll charges remain unpaid for five (5) days there after such charges will be delinquent.

Service may be discontinued because of non payment of delinquent charges after the customer had been given five (5) days notice by means of a written notice sent by First Class Mail. Service shall not be discontinued because of non payment of a disputed item on the customers bill.

Service shall not be discontinued on a day when the offices of the Company are not open to facilitate reconnection of service, or on a day immediately preceding such day.

At least twenty-four (24) hours preceding a discontinuance the Company shall make reasonable efforts to advise them of the proposed discontinuance and the steps the

FILED
MAR 1 1978
Public Service Commission

CANCELLED
OCT - 7 1980
BY *2nd BS #17*
PUBLIC SERVICE COMMISSION
OF MISSOURI

*Indicates new rate
+Indicates Change

ISSUED: DEC 14 1977

EFFECTIVE: MAR 1 1978

By Harold A. Jones, Manager
MID-MISSOURI TELEPHONE COMPANY
Pilot Grove, Missouri

No supplement to this tariff will be issued except for the purpose of canceling this tariff.

GENERAL REGULATIONS

JAN 25 1977

8. Deposits (Continued)

Interest at the rate of not less than 6% per annum shall be paid by the Company on all deposits made for the purpose of establishing credit. Simple interest shall be computed from the date of payment of the deposit and shall be paid annually or at the time of discontinuance of service or withdrawal of the deposit.

9. Discontinuance of Service for Failure to Maintain Credit

Service may be discontinued for failure to maintain credit, as specified above, five days after the Company has served or mailed notice requiring the customer to do so.

10. Restoral of Service after Discontinuance

Where service has been discontinued for failure to maintain credit as specified above, the restoral of service charge will be made and collected by the Company.

11. Provision of Equipment

- A. All equipment necessary for the provision of a given service will be furnished and owned by the Company except as provided elsewhere in this Tariff. The customer may be required to provide suitable housing or other protective measures where equipment is to be installed in locations exposed to weather or other hazards. Commercial power will be furnished by the customer at a suitable outlet when and where required.
- B. No equipment, apparatus, circuit, or device not furnished by the Company shall be attached to or connected with the facilities furnished by the Company, whether physically, by induction, accoustically, or otherwise, except as provided in this Tariff, or otherwise authorized in writing by the Company. In case such unauthorized attachment or connection is made, the Company shall have the right to remove or disconnect the same, or to terminate the service.
- C. The provisions of the preceding shall not be construed or applied to bar a customer from using devices which serve his convenience in his use of the service of the Company provided any such device so used does not:

*Indicates new rate

+Indicates Change

CANCELLED

MAR 1 1978

MAR 1 1977

Public Service Commission

EFFECTIVE: March 1, 1977

ISSUED: January 26, 1977

BY LS RS 7

PUBLIC SERVICE COMMISSION

By Harold M. Jones, Manager

MID-MISSOURI TELEPHONE COMPANY

Pilot Grove, Missouri

RECEIVED

No supplement to this tariff will be issued except for the purpose of canceling this tariff.

Section 2
2nd Revised Sheet 7.1
Cancelling 1st Revised Sheet 7.1

MISSOURI

GENERAL REGULATIONS

Public Service Commission

9. Discontinuance of Service - Residence Service (Continued)

A. (Contd)
customer may take to avoid it.

The Telephone Company shall postpone a discontinuance for a time not in excess of twenty-one (21) days if the telephone is necessary to obtain an emergency medical assistance for a person who is a member of the household where the telephone service is provided and where such person is under the care of a physician. Any person who alleges such emergency shall if requested provide the telephone utility with reasonable evidence of such necessity.

10. Restoral of Service after Discontinuance

Where service has been discontinued for failure to maintain credit as specified above, the restoral of service charge will be made and collected by the Company.

11. Provision of Facilities

A. All facilities necessary for the provision of a given service will be furnished and owned by the Company except as provided elsewhere in the Tariff. The customer may be required to provide suitable housing or other protective measures where facility is to be installed in locations exposed to weather or other hazards. Commercial power will be furnished by the customer at a suitable outlet when and where required.

B. No equipment, apparatus, circuit, or device not furnished by the Company shall be attached to or connected with the facilities furnished by the Company, whether physically, by induction, accoustically, or otherwise, except as provided in this Tariff, or otherwise authorized in writing by the Company. In case such unauthorized attachment or connection is made, the Company shall have the right to remove or disconnect the same, or to terminate the service.

C. The provisions of the preceding shall not be construed or applied to bar a customer from using devices which serve his convenience in his use of the facilities of the Company provided any such device so used does not:

*Indicates new rate
+Indicates Change

OCT 30 2000

By *BRD* #7.1
Public Service Commission
MISSOURI

CANCELLED

JAN 01 1988

ISSUED:

DEC 1 1987

EFFECTIVE:

Public Service Commission

By Harold A. Jones, Manager
MID-MISSOURI TELEPHONE COMPANY
Pilot Grove, Missouri

1988

No supplement to this tariff will be issued except for the purpose of canceling this tariff.

Section 2
1st Revised Sheet 7.1
Cancelling Original Sheet 7.1

GENERAL REGULATIONS

RECEIVED
OCT 26 1981
MISSOURI
Public Service Commission

+9. Discontinuance of Service - Residence Service (Continued)

+A. (Continued)

customer may take to avoid it.

The Telephone Company shall postpone a discontinuance for a time not in excess of twenty-one (21) days if the telephone is necessary to obtain an emergency medical assistance for a person who is a member of the household where the telephone service is provided and where such person is under the care of a physician. Any person who alleges such emergency shall if requested provide the telephone utility with reasonable evidence of such necessity.

10. Restoral of Service after Discontinuance

Where service has been discontinued for failure to maintain credit as specified above, the restoral of service charge will be made and collected by the Company.

11. Provision of Equipment

A. All Equipment necessary for the provision of a given service will be furnished and owned by the Company except as provided elsewhere in the Tariff. The customer may be required to provide suitable housing or other protective measures where equipment is to be installed in locations exposed to weather or other hazards. Commercial power will be furnished by the customer at a suitable outlet when and where required.

No equipment, apparatus, circuit, or device not furnished by the Company shall be attached to or connected with the facilities furnished by the Company, whether physically, by induction, accoustically, or otherwise, except as provided in this Tariff, or otherwise authorized in writing by the Company. In case such unauthorized attachment or connection is made, the Company shall have the right to remove or disconnect the same, or to terminate the service.

C. The provisions of the preceding shall not be construed or applied to bar a customer from using devices which serve his convenience in his use of the facilities of the Company provided any such device so used does not:

*Indicates new rate

+Indicates Change

CANCELLED

JAN 01 1988

BY 2nd R.S.#7.1
PUBLIC SERVICE COMMISSION
OF MISSOURI

ISSUED: October 23, 1981

EFFECTIVE: November 23, 1981

By Harold A. Jones, Manager
MID-MISSOURI TELEPHONE COMPANY
Pilot Grove, Missouri

FILED
NOV 23 1981
Public Service Commission

No supplement to this tariff will be issued except for the purpose of canceling this tariff.

RECEIVED
DEC 14 1977
MISSOURI
Public Service Commission

+ 9. Discontinuance of Service (Continued)

customer may take to avoid it.

The Telephone Company shall postpone a discontinuance for a time not in excess of twenty-one (21) days if the telephone is necessary to obtain an emergency medical assistance for a person who is a member of the household where the telephone service is provided and where such person is under the care of a physician. Any person who alleges such emergency shall if requested provide the telephone utility with reasonable evidence of such necessity.

10. Restoral of Service after Discontinuance

Where service has been discontinued for failure to maintain credit as specified above, the restoral of service charge will be made and collected by the Company.

Provision of Equipment

- A. All Equipment necessary for the provision of a given service will be furnished and owned by the Company except as provided elsewhere in the Tariff. The customer may be required to provide suitable housing or other protective measures where equipment is to be installed in locations exposed to weather or other hazards. Commercial power will be furnished by the customer at a suitable outlet when and where required.
- B. No equipment, apparatus, circuit, or device not furnished by the Company shall be attached to or connected with the facilities furnished by the Company, whether physically, by induction, accoustically, or otherwise, except as provided in this Tariff, or otherwise authorized in writing by the Company. In case such unauthorized attachment or connection is made, the Company shall have the right to remove or disconnect the same, or to terminate the service.
- C. The provisions of the preceding shall not be construed or applied to bar a customer from using devices which serve his convenience in his use of the facilities of the Company provided any such device so used does not:

MAR 1 1978
Public Service Commission

*Indicates new rate
+Indicates Change

ISSUED: DEC 14 1977

EFFECTIVE: MAR 1 1978

By Harold A. Jones, Manager
MID-MISSOURI TELEPHONE COMPANY
Pilot Grove, Missouri

CANCELLED
NOV 23 1981
BY 1st BS 7.1
PUBLIC SERVICE COMMISSION
OF MISSOURI

RECEIVED

SEP 29 2000

P.S.C. Mo. No. 1 Consolidated

No supplement to this tariff will be issued except for the purpose of canceling this tariff.

Section 2 **MISSOURI** Public Service Commission
Original Sheet 7.2

GENERAL REGULATIONS

+9. Discontinuance of Service – Residence Service (Continued)

- +G. At least twenty-four (24) hours preceding a discontinuance of basic local telecommunications service, the Company shall make reasonable efforts to advise the customer of the proposed discontinuance and what steps must be taken to avoid it. Reasonable efforts shall include either a written notice in addition to the notice required in section (2,)(9.E.), a door hanger or at least one (1) telephone call attempt to reach the customer.
- +H. Notwithstanding any other provision of this section, the Company shall postpone a discontinuance for at least twenty-one (21) days if service is necessary to obtain emergency medical assistance for a person who is a member of the household where the telephone service is provided and where such person is under the care of a physician. Any person who alleges such emergency, if requested, shall provide the Company with reasonable evidence of such necessity.
- +I. Upon the customer's request, the Company shall restore service consistent with all other provisions of this section when the cause of discontinuance has been eliminated.
- +J. Payment by personal check may be refused if the customer, within the last twelve (12) months, has tendered payment in this manner and the check has been dishonored, except when the dishonor is due to bank error.

*Indicates New Rate
+Indicates Change

FILED

OCT 30 2000

MISSOURI
Public Service Commission

ISSUED: September 29, 2000

EFFECTIVE: October 30, 2000

By David L. Jones, President
MID-MISSOURI TELEPHONE COMPANY
Pilot Grove, Missouri

CANCELLED
June 1, 2018
Missouri Public
Service Commission
JI-2018-0144

No supplement to this tariff will be issued except for the purpose of canceling this tariff.

Section 2
Original Sheet 8

GENERAL REGULATIONS (Continued)

11. Provision of Equipment (Continued)

JAN 25 1977

1. endanger the safety of Company employees or the public;
2. damage, require change in or alteration of, or involve direct electrical connection to, the equipment or other facilities of the Company, unless as provided for elsewhere in this Tariff;
3. interfere with the proper functioning of such equipment or facilities;
4. impair the operation of the communication system;
5. otherwise injure the public in its use of the Company's services.

D. Except as otherwise provided in this Tariff, nothing herein shall be construed to permit the use of a recording device, or of a device to inter-connect any line or channel of the Company with any other communication line or channel of the Company or of any other person.

CANCELLED

JAN 01 1988

BY 1st. R.S. #8
PUBLIC SERVICE COMMISSION
OF MISSOURI

Devices provided by the customer to obtain quietness or privacy may be used in conjunction with the telephone instrument furnished to the customer by the Company provided that:

1. such device does not involve direct electrical connection to the equipment of the Company, any change in or alteration of such equipment;
2. such device does not interfere with its proper functioning or damage it in any way.

F. Facilities of an electric power company or oil, oil products or natural gas, pipe line company, or railroad company, provided primarily to communicate with points located along a right-of-way (including premises of such company anywhere in cities, towns, or villages along the right-of-way) owned or controlled by such company and extending between or beyond exchange areas of the Com-

*Indicates new rate
+Indicates Change

Public Service Commission

ISSUED: January 26, 1977

EFFECTIVE: March 1, 1977

By Harold A. Jones, Manager
MID-MISSOURI TELEPHONE COMPANY
Pilot Grove, Missouri