



June 14, 2023

VIA ELECTRONIC FILING

Chief RLJ Nancy Dippell, Secretary
Missouri Public Service Commission
P.O. Box 360
Jefferson City, 65102

Re: MoPSC Case No. WA-2023-0345
Missouri American Water Company (Water)

Dear Judge Dippell,

On behalf of Missouri-American Water Company (“MAWC” or “Company”), I am providing to the Missouri Public Service Commission (“Commission”) for filing tariff sheets in electronic form. The compliance tariff sheets are being filed pursuant to and in conformity with the Order Approving Transfer of Assets and Granting Certificate of Convenience and Necessity issued on June 7, 2023. The proposed tariff sheets are listed on **Appendix A**, bear a date of issue of June 14, 2023, and an effective date of July 14, 2023.

Please see that this filing is brought to the attention of the appropriate Commission personnel, and please let me know if you have any questions or concerns regarding this tariff filing.

Brian LaGrand
Director of Rates
Missouri American Water

APPENDIX A

LIST OF TARIFF SHEETS BEING FILED

WATER

P.S.C. Mo. No. 13

6th Revised Sheet No. CA TOC D, Cancelling 5th Revised Sheet No. CA TOC D
Original Sheet No. CA 28.1
Original Sheet No. CA 28.2

SEWER

P.S.C. Mo. No. 26

12th Revised Sheet No. IN 1.1, Cancelling 11th Revised Sheet No. IN 1.1
17th Revised Sheet No. IN 1.3, Cancelling 16th Revised Sheet No. IN 1.3
18th Revised Sheet No. IN 1.4, Cancelling 17th Revised Sheet No. IN 1.4
21st Revised Sheet No. IN 1.5, Cancelling 20th Revised Sheet No. IN 1.5
12th Revised Sheet No. RT 3.1, Cancelling 11th Revised Sheet No. RT 3.1
Original Sheet No. CA 26.1
Original Sheet No. MP 27.1

Missouri-American Water Company
Name of Issuing Corporation

For

Wood Heights Service Area
Community, Town or City

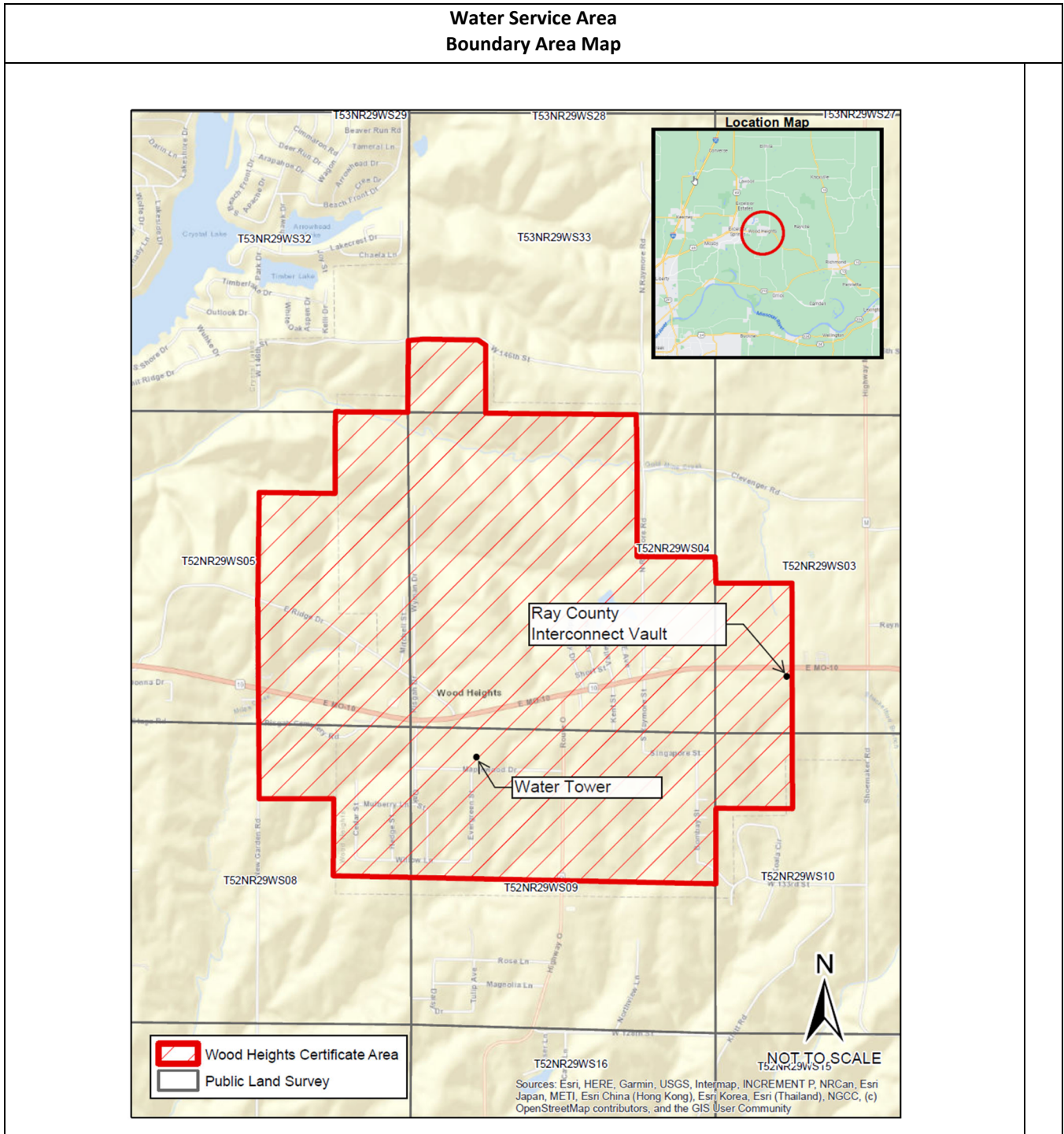

* Indicates new rate or text

+ Indicates change

Date of Issue: June 14, 2023

Effective Date:

July 14, 2023

Issued By: Rich C. Svindland, President
727 Craig Road, St. Louis, MO 63141

Missouri-American Water Company
Name of Issuing Corporation

For

Wood Heights Service Area
Community, Town or City

Water Service Area Legal Description
<p>A tract of land in part of Sections 32 and 33 of Township 53 North, Range 29 West and Sections 3, 4, 5, 8, 9 and 10 of Township 52 North, Range 29 West, City of Wood Heights, Ray County, Missouri and being more particularly described as follows:</p> <p>Beginning at the Northeast corner of the Northwest Quarter of the Northeast Quarter of Section 4, Township 52 North, Range 29 West; thence South, along the East line of said Quarter-Quarter Section to a point being 301 feet more or less North of the Southeast Corner of the Southwest Quarter of the Northeast Quarter of Section 4; thence East to a point on the East line of said Quarter-Quarter Section, being 301 feet more or less North from the Southeast Corner of the Southeast Quarter of the Northeast Quarter of said Section 4; thence South, along said East line to a point 144' South of more or less from the Northeast Corner of the Northeast Quarter of the Southeast Quarter of said Section 4; thence East to a point 144' South of more or less from the Northeast Corner of the Northwest Quarter of the Southwest Quarter of Section 3; thence South along the East line of said Quarter-Quarter Section and the South projection thereof to the Southeast Corner of the Northwest Quarter of the Northwest Quarter of Section 10; thence West, along the South line of said Quarter-Quarter Section to the Southwest Corner thereof, being also the Southwest Corner of the Northwest Quarter of the Northwest Quarter of said Section 10; thence South to the Southwest Corner of the Southwest Quarter of the Northwest Quarter of said Section 10; thence with a prolongation West to a point 128' West more or less from the Southwest corner of the Southeast Quarter of the Northeast Quarter of Section 8; thence North to a point 128' West of more or less from the Northwest Corner of the Southeast Quarter of the Northeast Quarter of said Section 8; thence West to a point being the Southwest Corner of the Northwest Quarter of the Northeast Quarter of said Section 8; thence with a prolongation North to a point being the Northwest Corner of the Southwest Quarter of the Northeast Quarter of Section 5; thence East to a point 167' West more or less from the Southeast Corner of the Northwest Quarter of the Northeast Quarter of said Section 5; thence North to a point 167' West of more or less from the Northwest Corner of the Northeast Quarter of the Northeast Quarter of said Section 5; thence East to a point being 107' West of more or less from the Northeast Corner of the Northeast Quarter of the Northeast Quarter of said Section 5, being also the Southeast Corner of the Southeast Quarter of the Southeast Quarter of Section 32 Township 53 North, Range 29 West; thence North to a point of intersection with the North Right of way line of West 146 Th Street; thence East along said North right of way line and Southeast to a point on the West line of the Northeast Quarter of the Southwest Quarter of Section 33; thence South, along said West line to the Southwest Corner thereof, being also the Northwest Corner of the Southeast Quarter of the Southwest Quarter of said Section 33; thence continuing South, along the west line of said Quarter-Quarter Section to the Northwest Corner of the Northeast Quarter of the Northwest Quarter of Section 4, Township 52 North, Range 29 West; thence East, along the North line of said Section 4 to the Northeast Corner of the Northwest Quarter of the Northeast Quarter of said Section 4 and the POINT OF BEGINNING. Containing 1,463 acres more or less.</p>

* *Indicates new rate or text*

+ *Indicates change*

Date of Issue: June 14, 2023

Effective Date: July 14, 2023

Issued By: Rich C. Svindland, President
727 Craig Road, St. Louis, MO 63141