

26. EXCHANGE AREA/BASE RATE BOUNDARY MAP - ALBANY

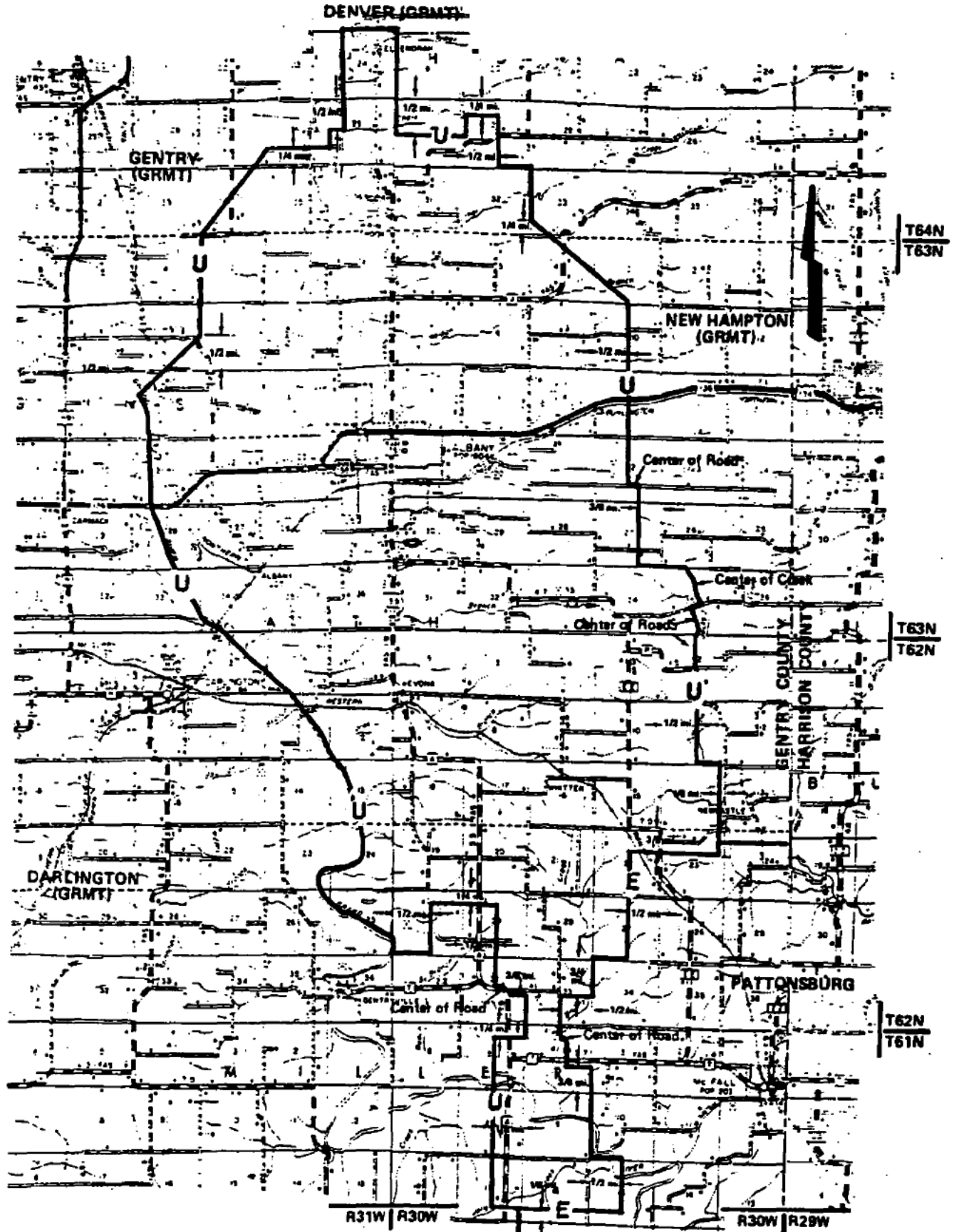

CANCELLED
August 20, 2015
Missouri Public
Service Commission
JI-2016-0057

ISSUED: December 9, 2005
ISSUED BY: Vice President
Little Rock, Arkansas

EFFECTIVE: January 9, 2006

26. EXCHANGE AREA/BASE RATE BOUNDARY MAP - ALDRICH

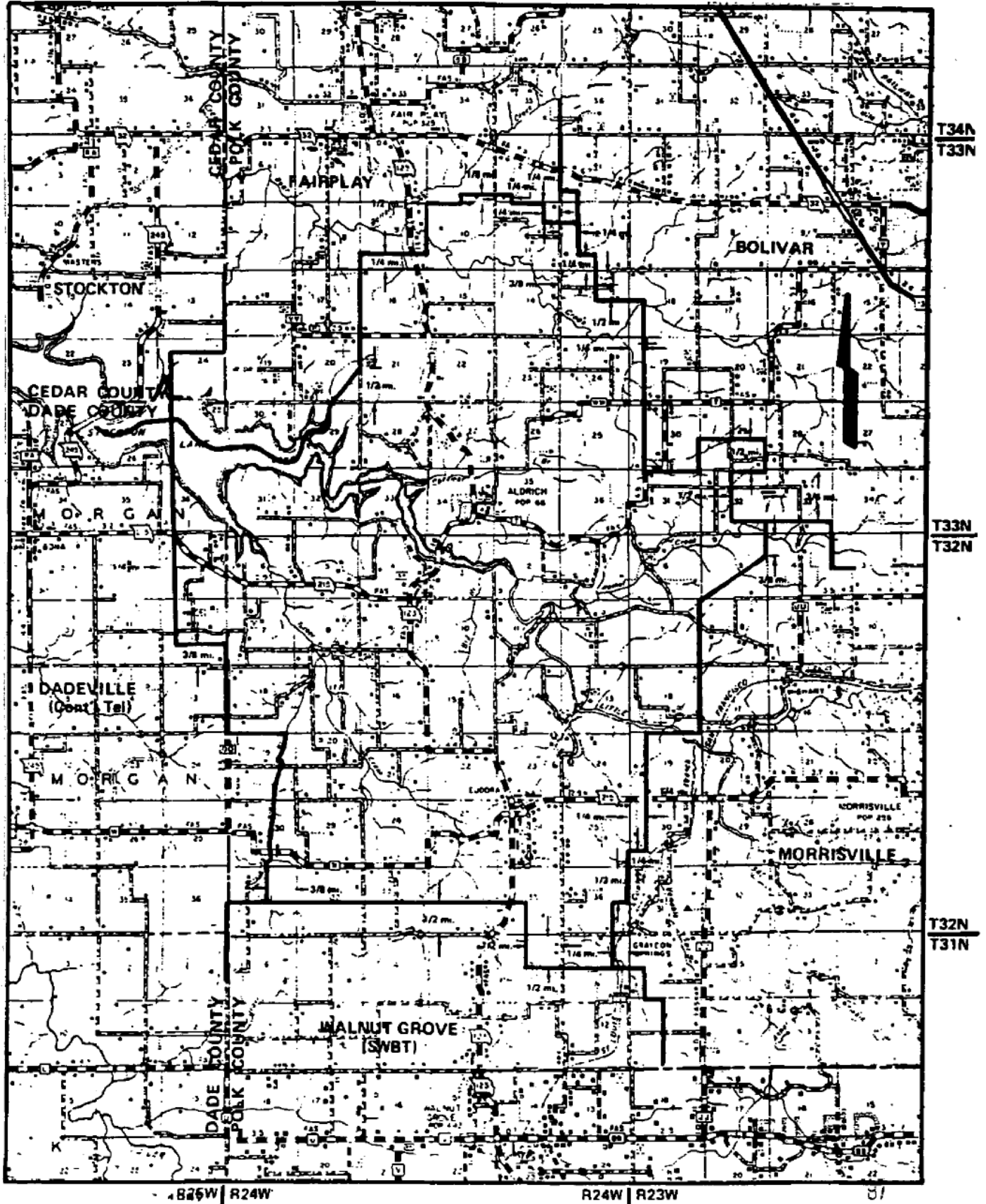

CANCELLED
August 20, 2015
Missouri Public
Service Commission
JI-2016-0057

ISSUED: December 9, 2005
ISSUED BY: Vice President
Little Rock, Arkansas

EFFECTIVE: January 9, 2006

26. EXCHANGE AREA/BASE RATE BOUNDARY MAP - ALLENDALE

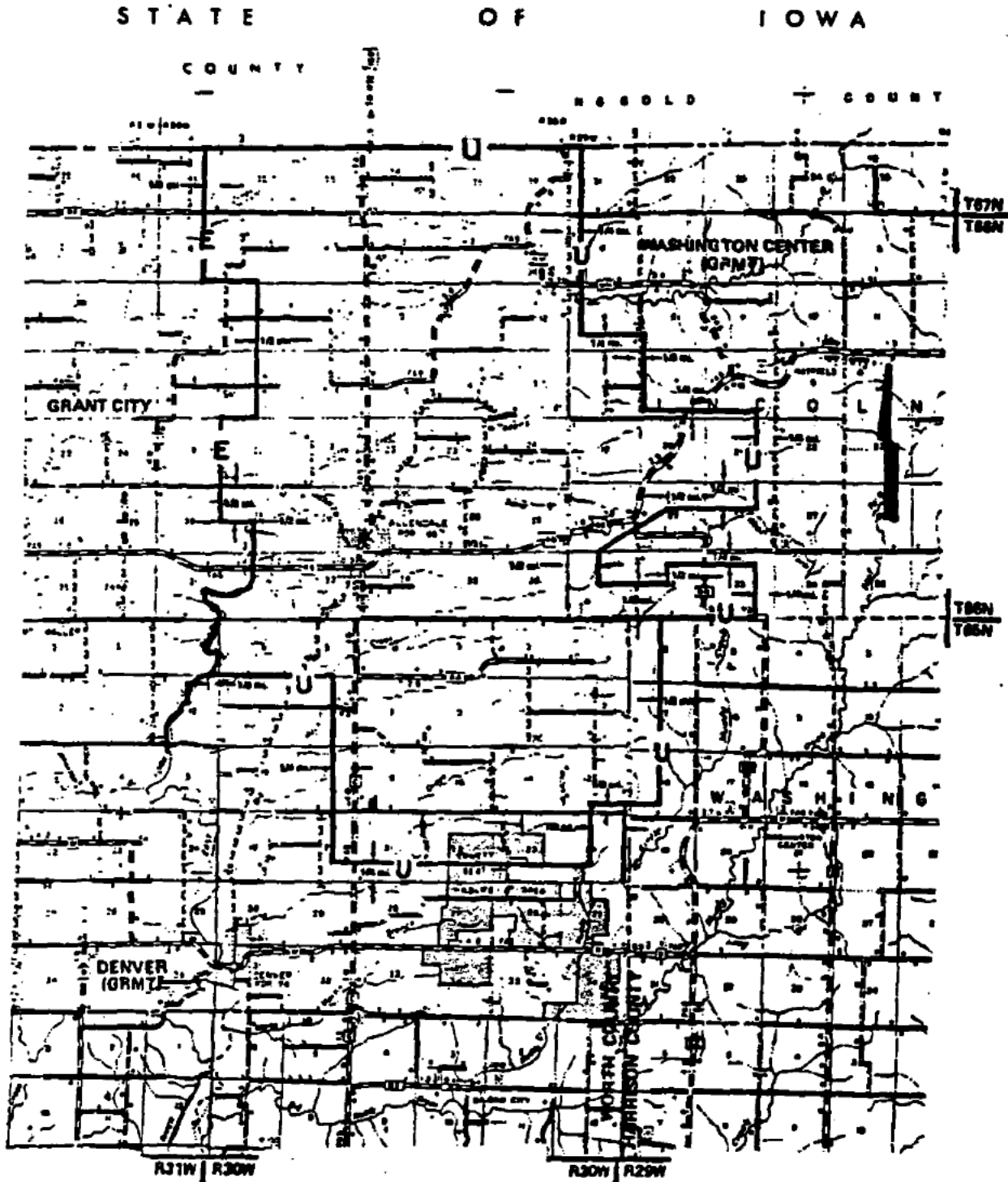

26. EXCHANGE AREA/BASE RATE BOUNDARY MAP - BELLFLOWER

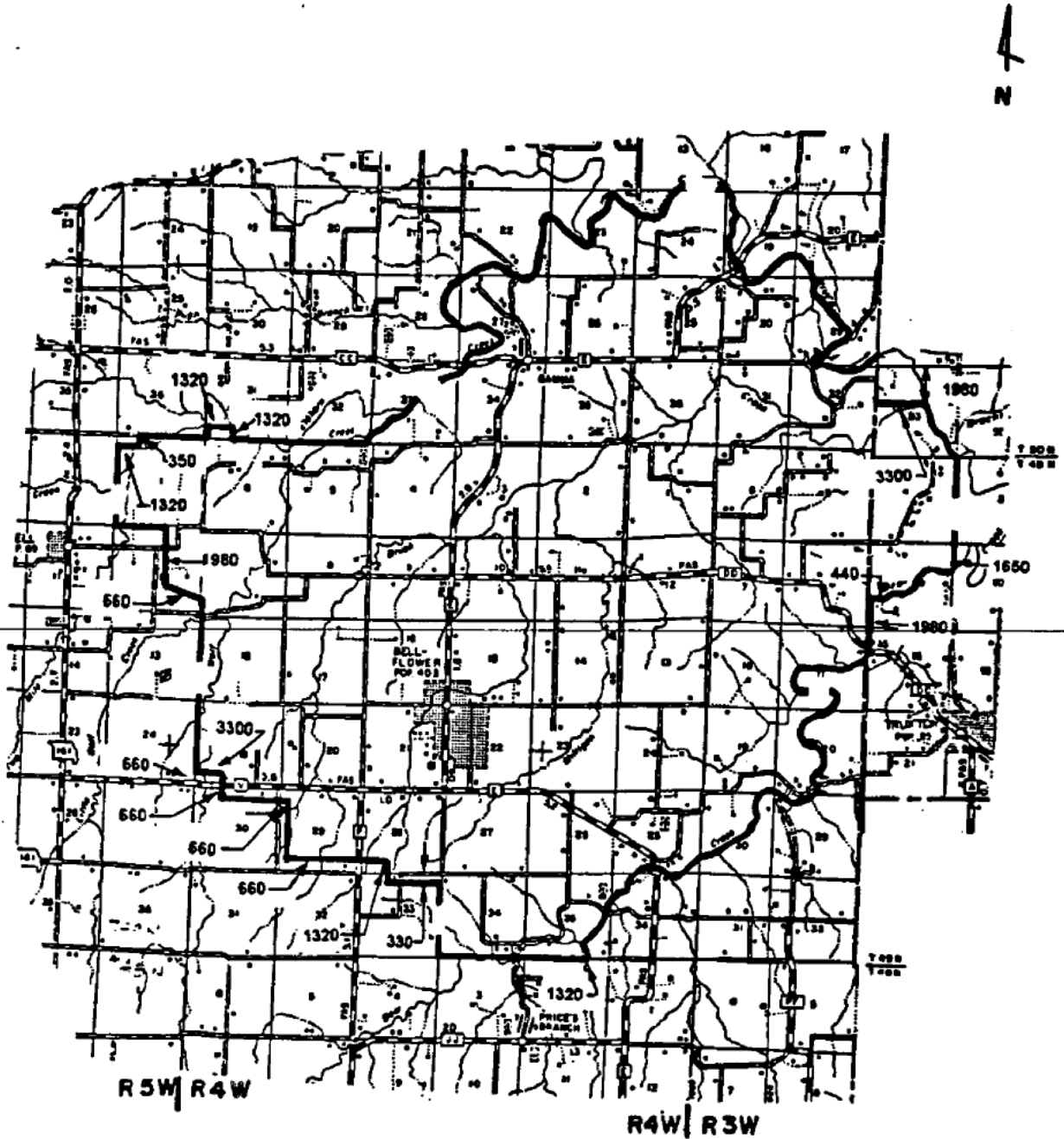

26. EXCHANGE AREA/BASE RATE BOUNDARY MAP - BOLIVAR



26. EXCHANGE AREA/BASE RATE BOUNDARY MAP - COFFEY

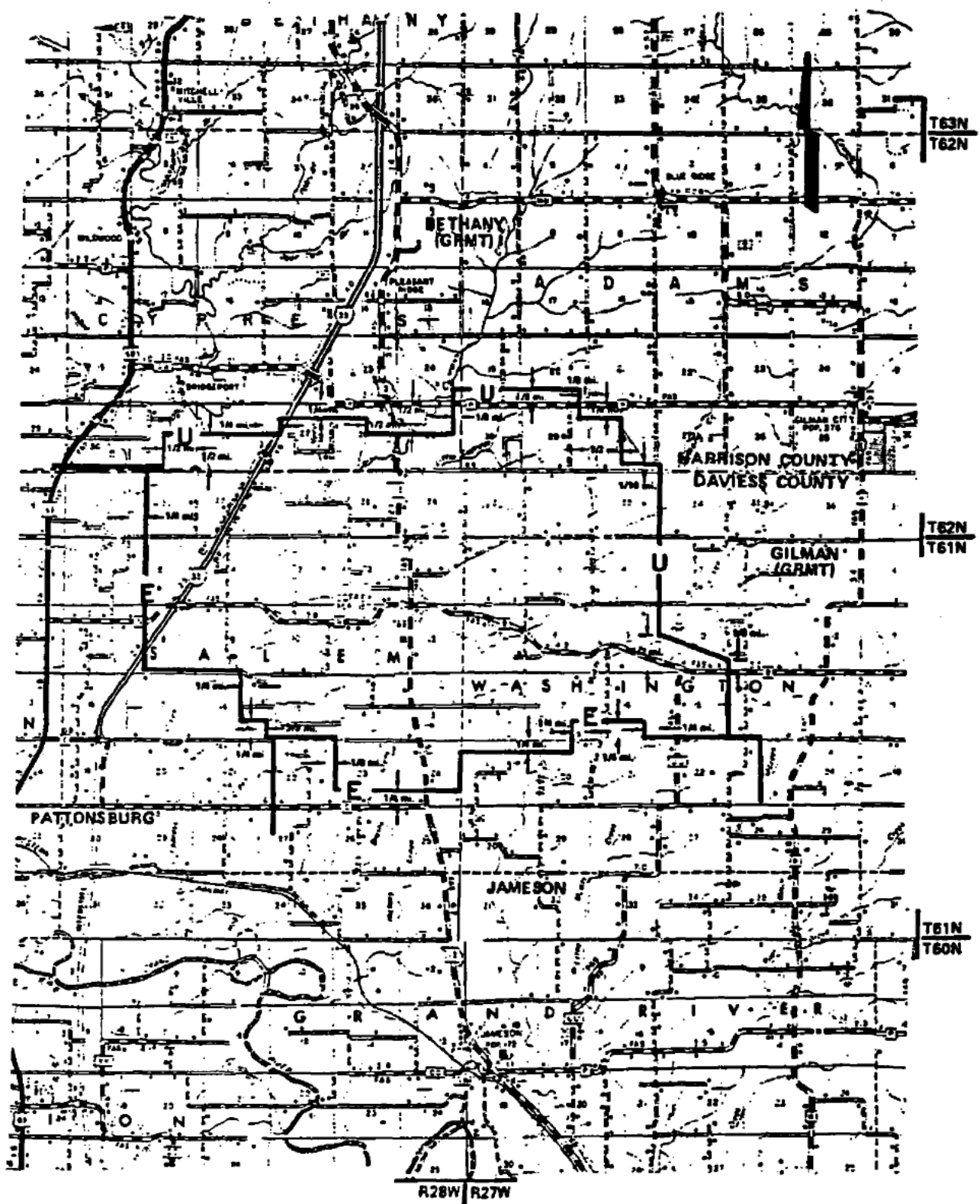

CANCELLED
August 20, 2015
Missouri Public
Service Commission
JI-2016-0057

ISSUED: December 9, 2005
ISSUED BY: Vice President
Little Rock, Arkansas

EFFECTIVE: January 9, 2006

26. EXCHANGE AREA/BASE RATE BOUNDARY MAP - CROCKER

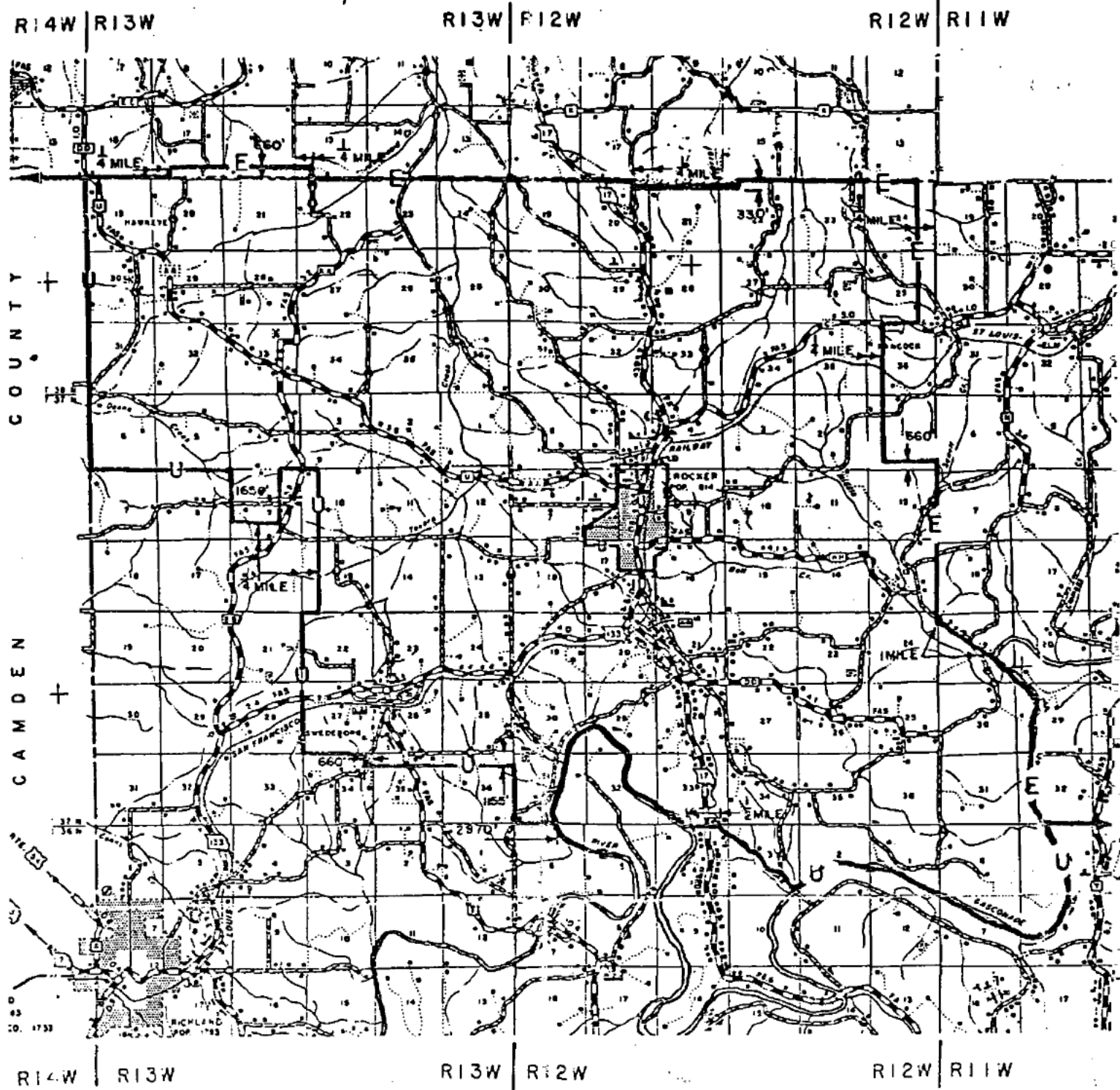

CANCELLED
August 20, 2015
Missouri Public
Service Commission
JI-2016-0057

ISSUED: December 9, 2005
ISSUED BY: Vice President
Little Rock, Arkansas

EFFECTIVE: January 9, 2006

26. EXCHANGE AREA/BASE RATE BOUNDARY MAP - CLUBB

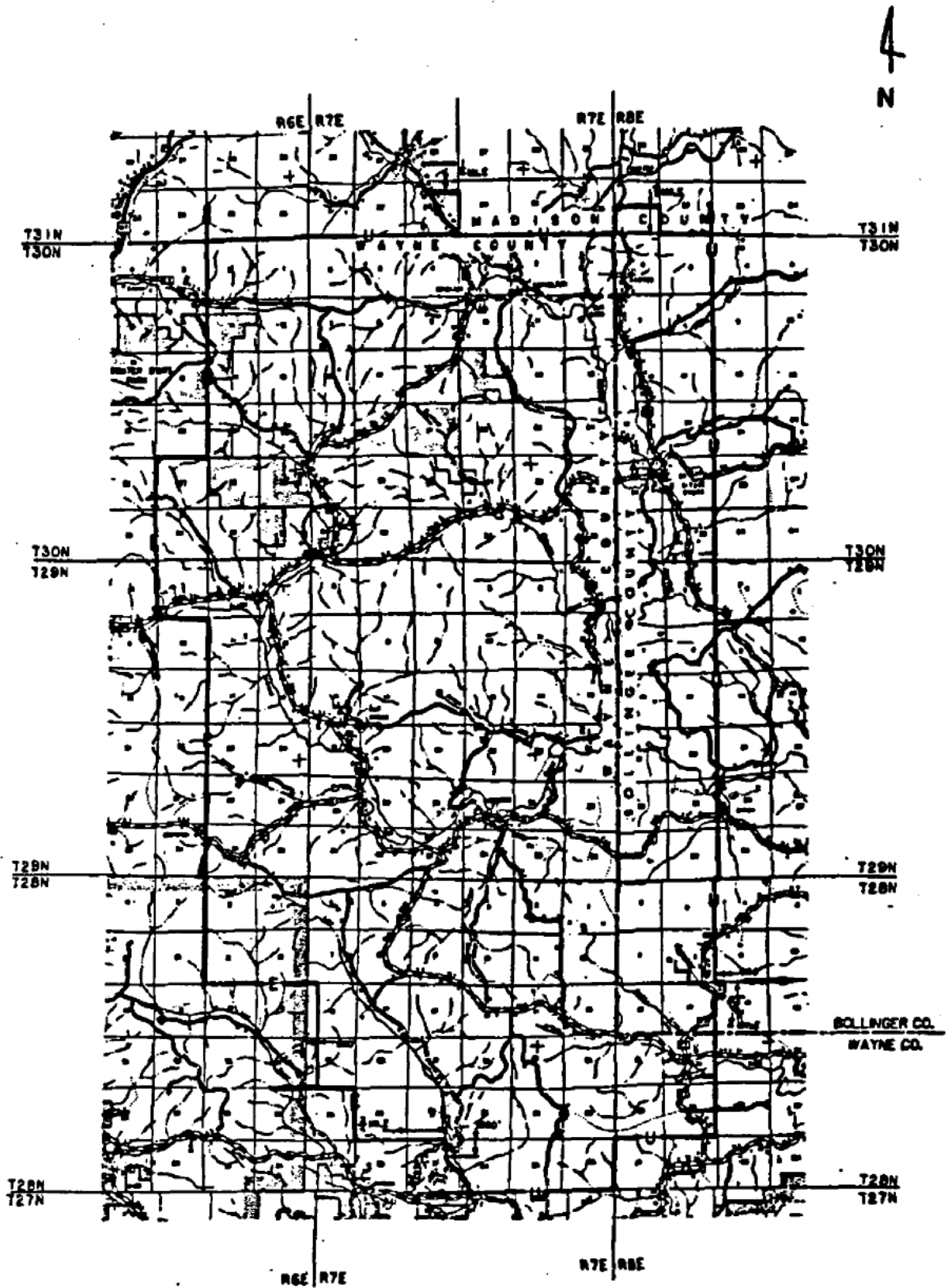

26. EXCHANGE AREA/BASE RATE BOUNDARY MAP - DIXON

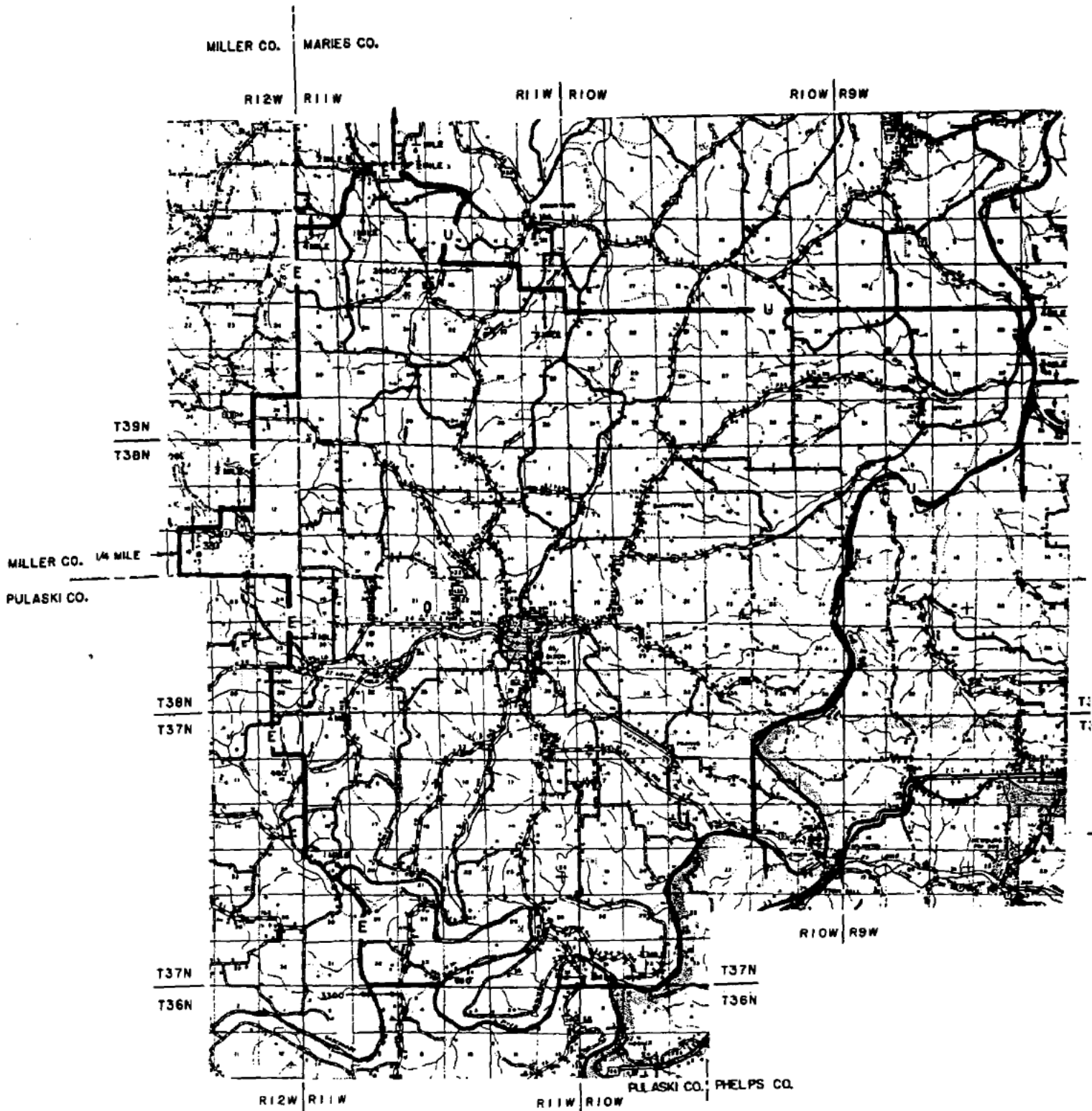

CANCELLED
August 20, 2015
Missouri Public
Service Commission
JI-2016-0057

ISSUED: December 9, 2005
ISSUED BY: Vice President
Little Rock, Arkansas

EFFECTIVE: January 9, 2006

26. EXCHANGE AREA/BASE RATE BOUNDARY MAP - DONIPHAN

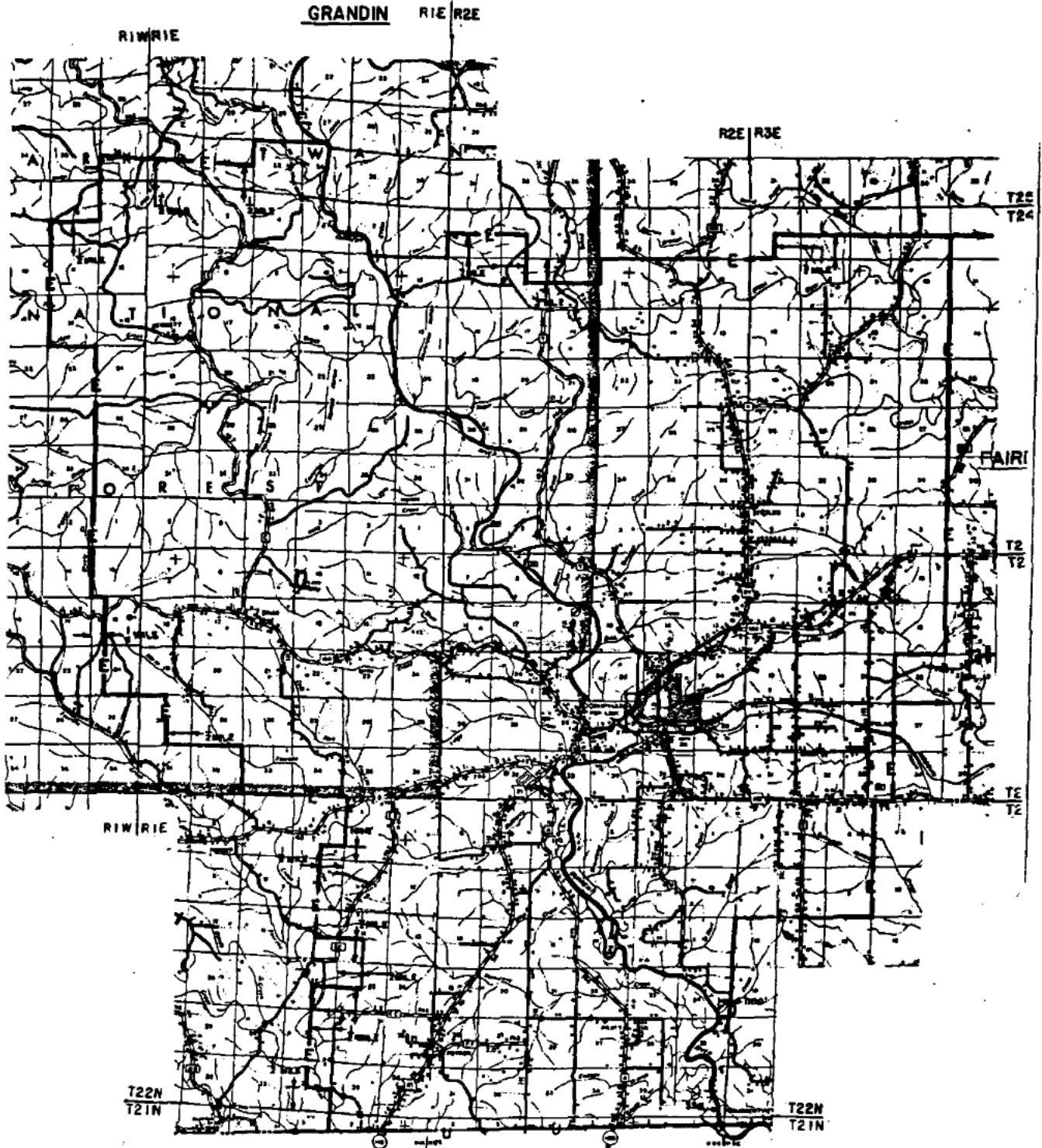

CANCELLED
August 20, 2015
Missouri Public
Service Commission
JI-2016-0057

ISSUED: December 9, 2005
ISSUED BY: Vice President
Little Rock, Arkansas

EFFECTIVE: January 9, 2006

26. EXCHANGE AREA/BASE RATE BOUNDARY MAP - EOLIA

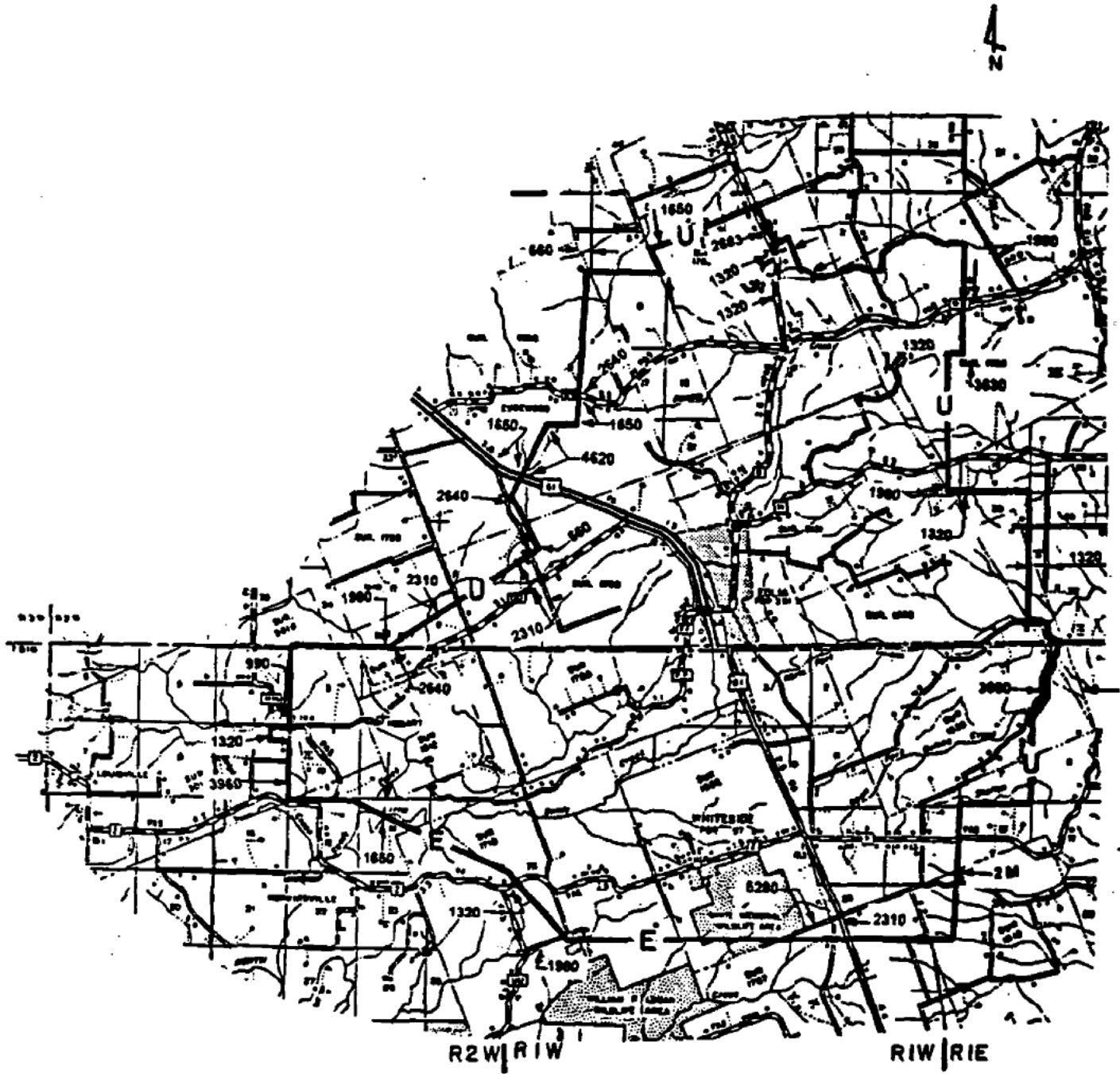

26. EXCHANGE AREA/BASE RATE BOUNDARY MAP - FAIRDEALING

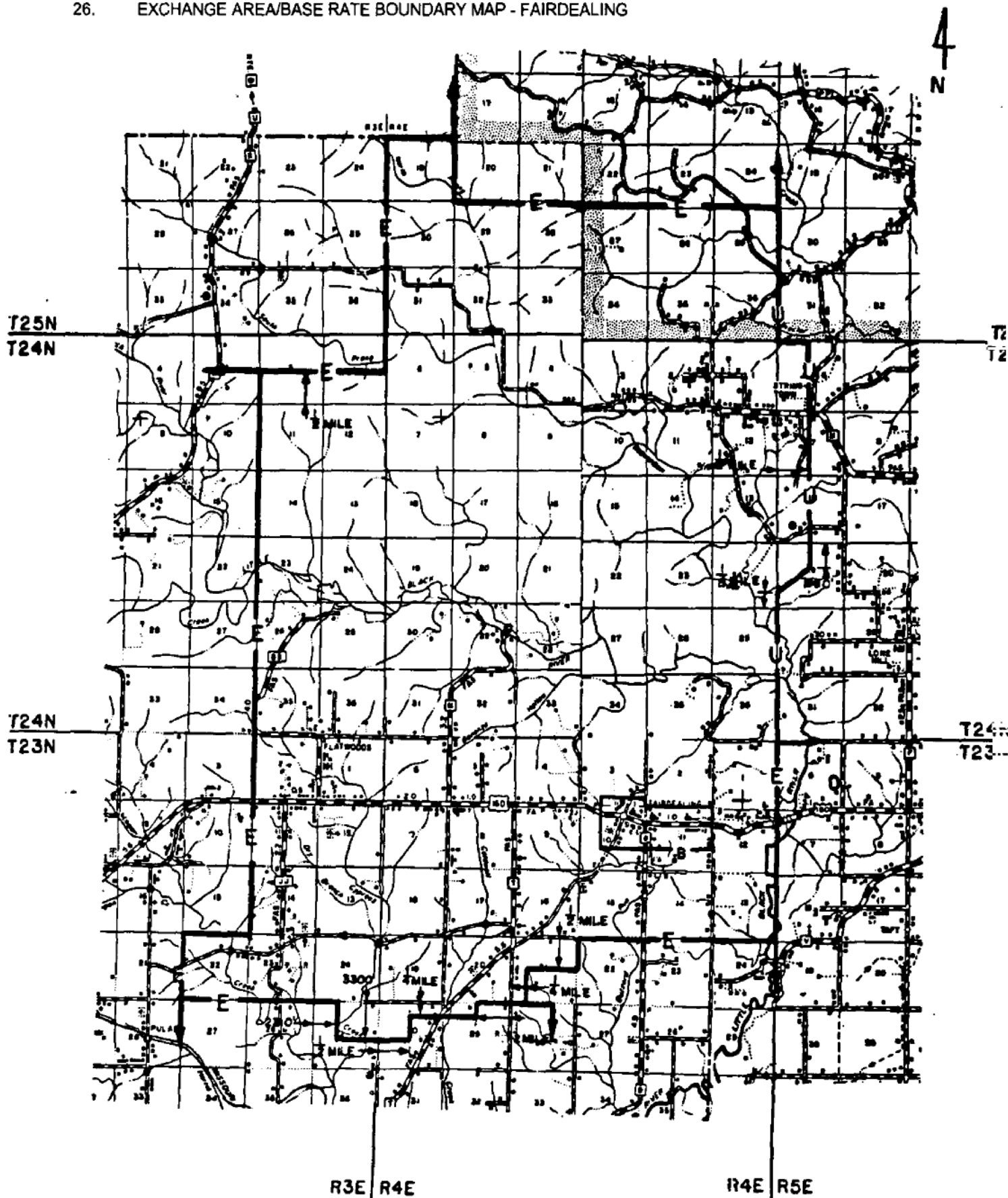

CANCELLED
August 20, 2015
Missouri Public
Service Commission
JI-2016-0057

ISSUED: December 9, 2005
ISSUED BY: Vice President
Little Rock, Arkansas

EFFECTIVE: January 9, 2006

26. EXCHANGE AREA/BASE RATE BOUNDARY MAP - FAIR PLAY

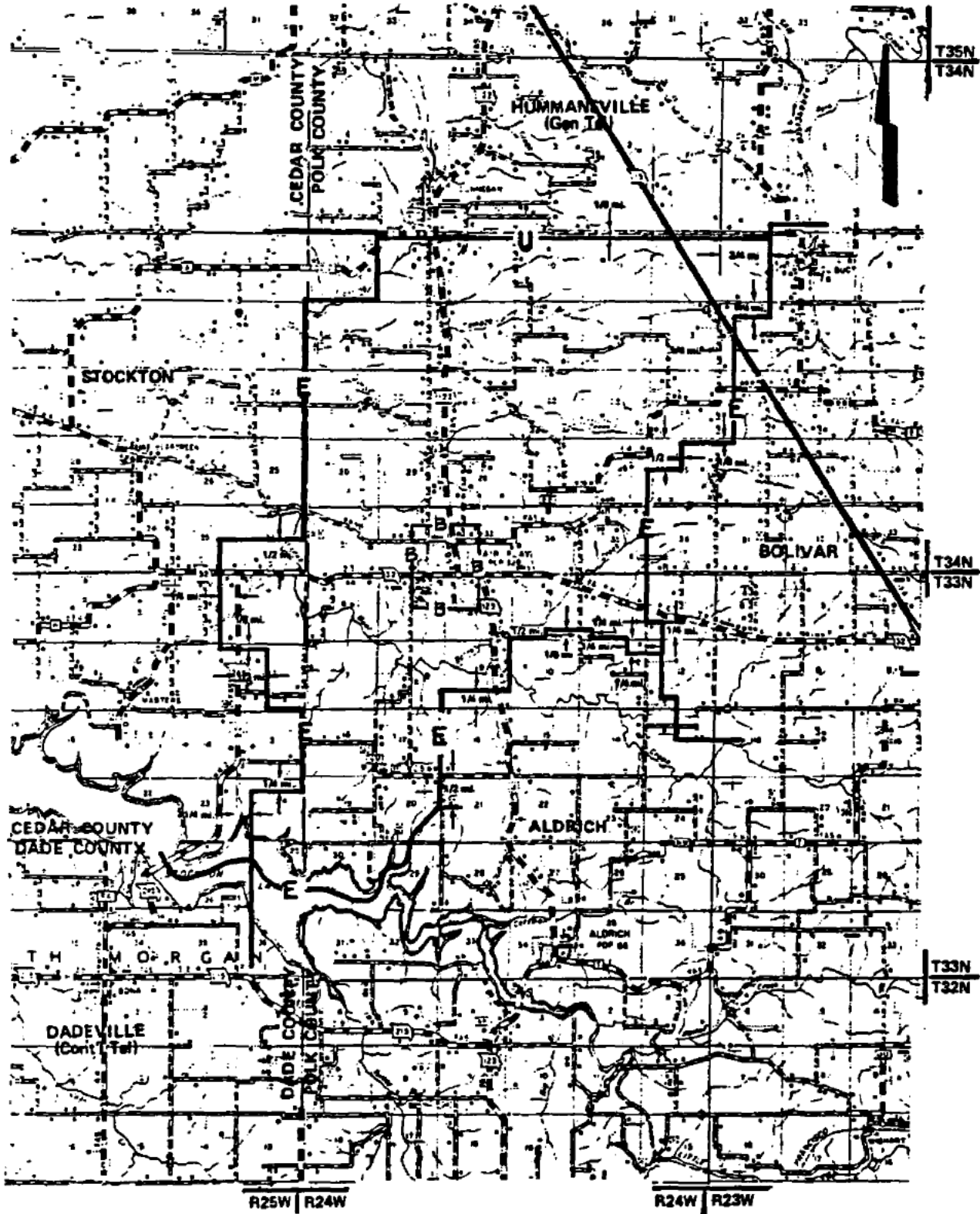

26. EXCHANGE AREA/BASE RATE BOUNDARY MAP - FAIRVIEW

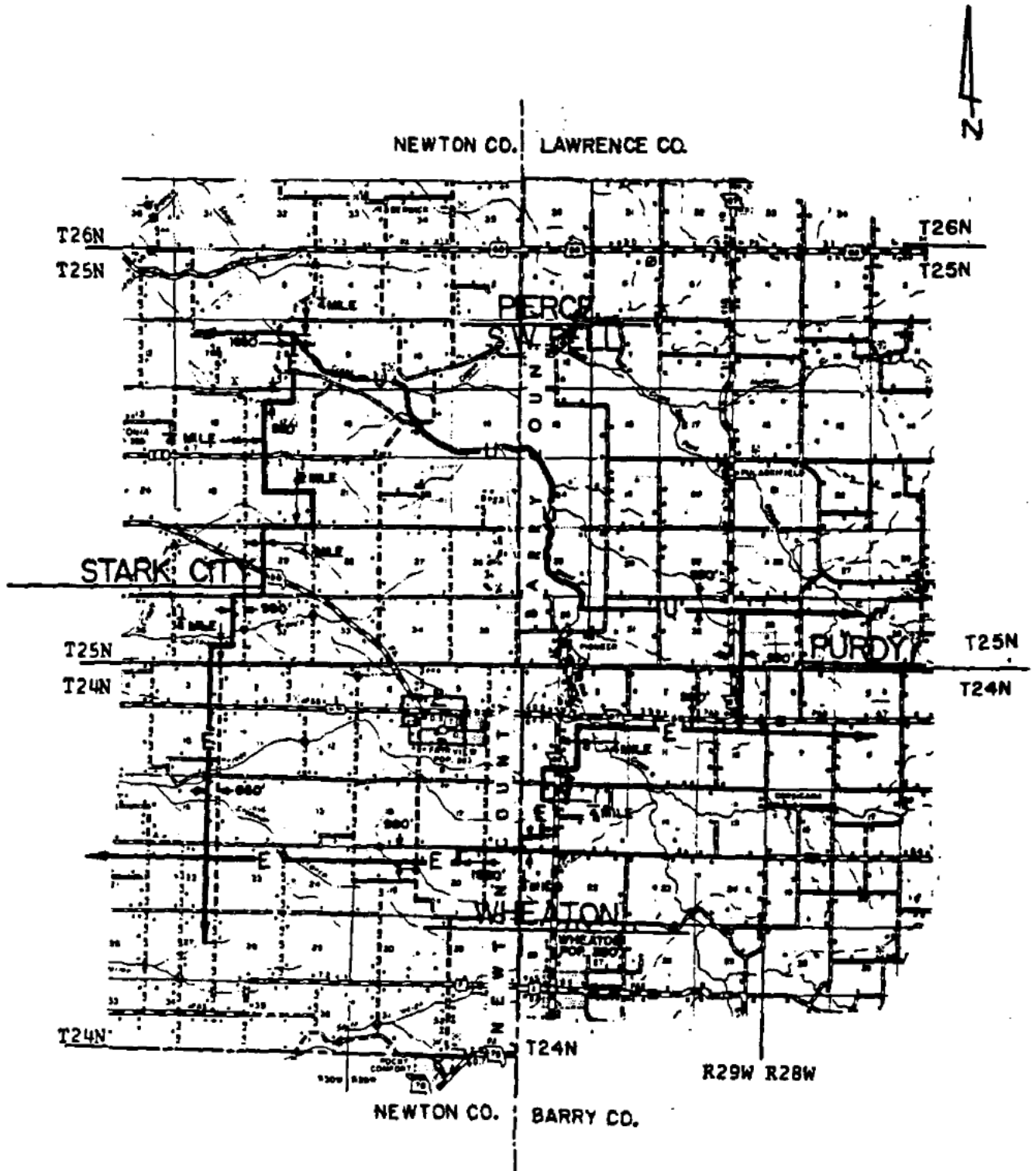

26. EXCHANGE AREA/BASE RATE BOUNDARY MAP - FLORENCE

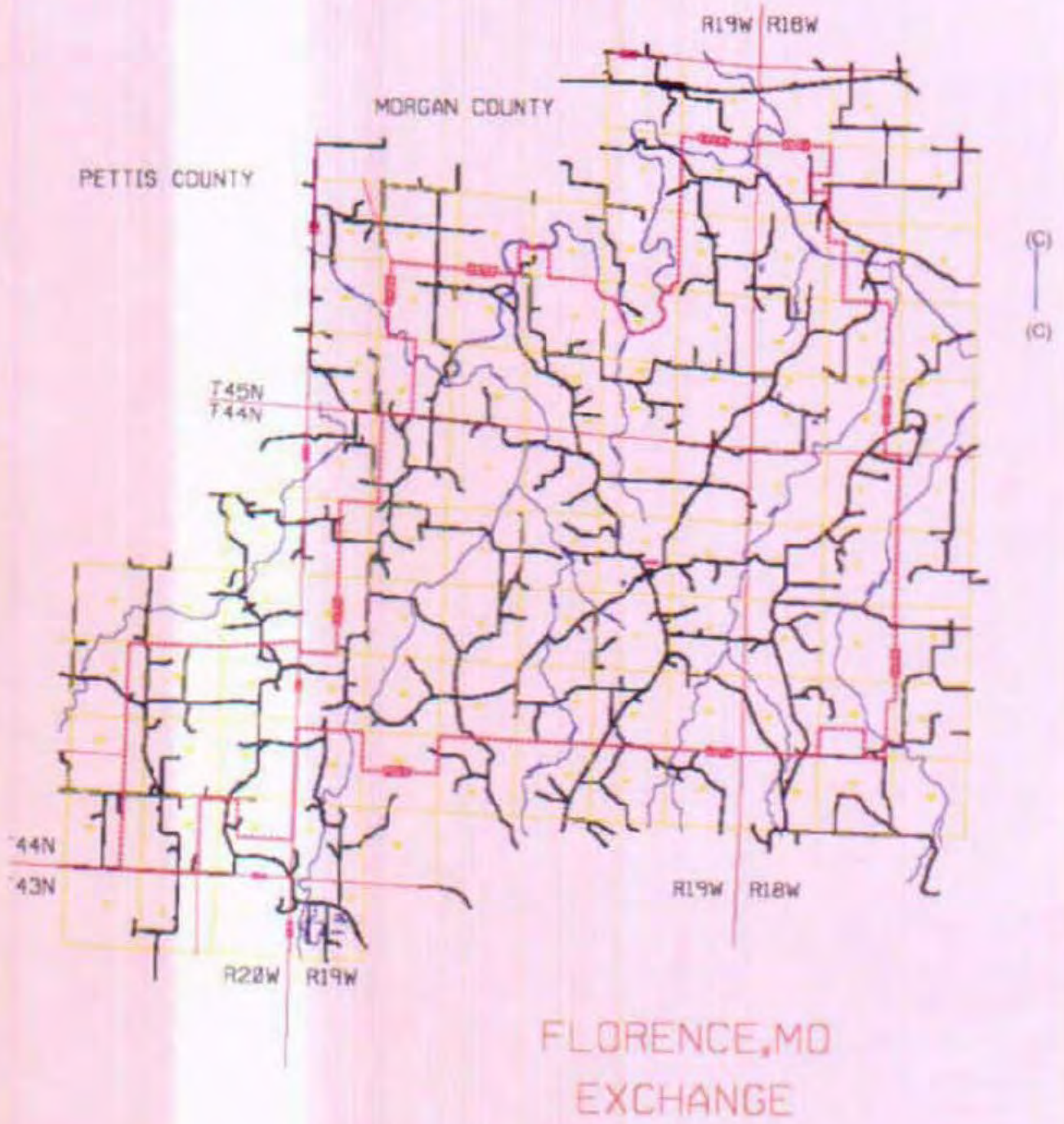

FLORENCE, MO
EXCHANGE

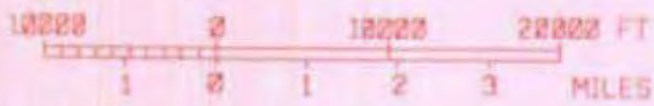

ISSUED: ~~December 7, 2009~~
ISSUED BY: Vice President
Little Rock, Arkansas

EFFECTIVE: ~~January 7, 2010~~
January 13, 2010

CANCELLED
August 20, 2015
Missouri Public
Service Commission
JI-2016-0057

FILED
Missouri Public
Service Commission
JI-2010-0382

26. EXCHANGE AREA/BASE RATE BOUNDARY MAP - FLORENCE

FILED
MO PSC

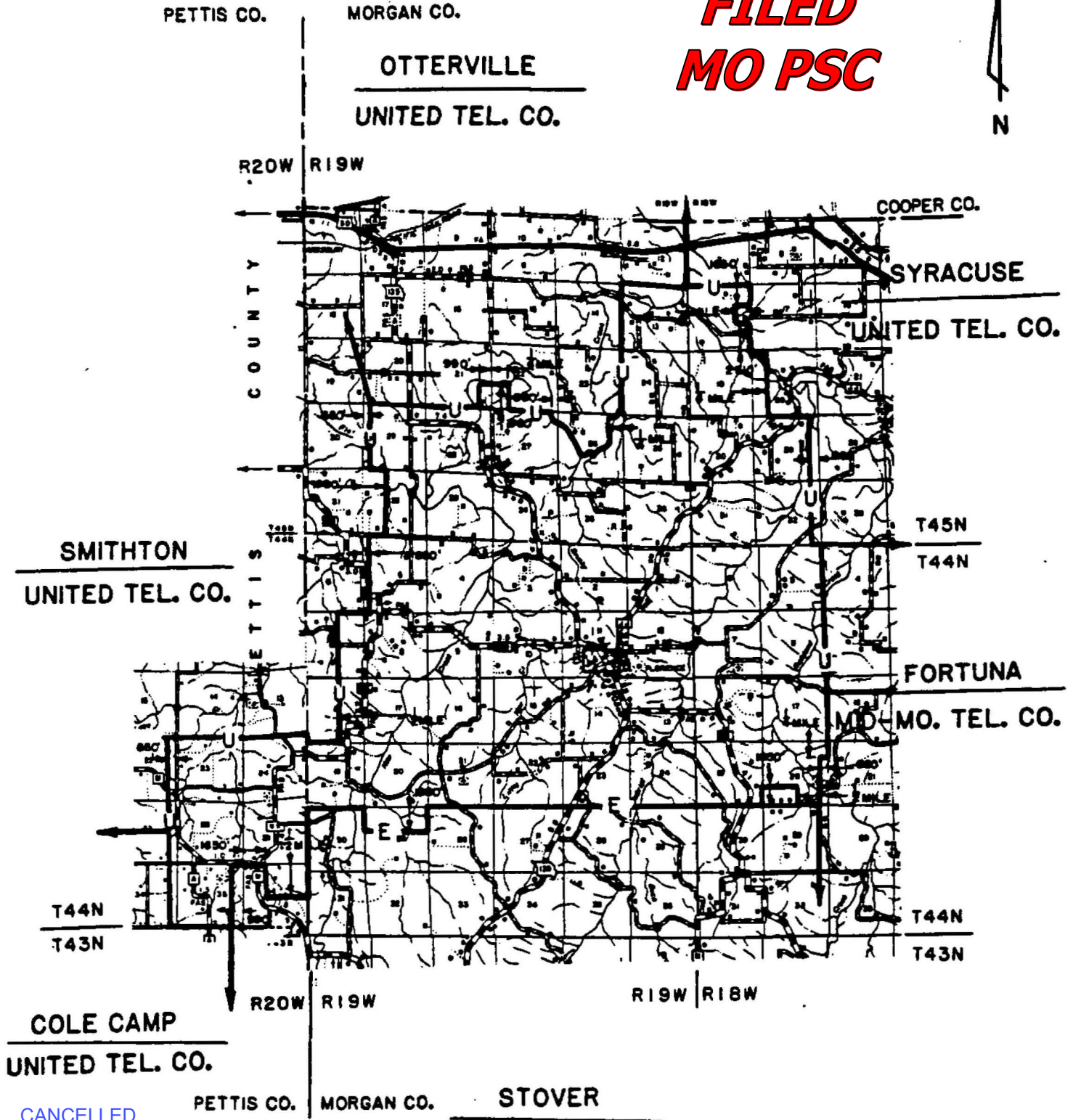

CANCELLED
January 13, 2010
Missouri Public
Service Commission
JI-2010-0382

ISSUED: December 9, 2005
ISSUED BY: Vice President
Little Rock, Arkansas

EFFECTIVE: January 9, 2006

26. EXCHANGE AREA/BASE RATE BOUNDARY MAP - GALLATIN

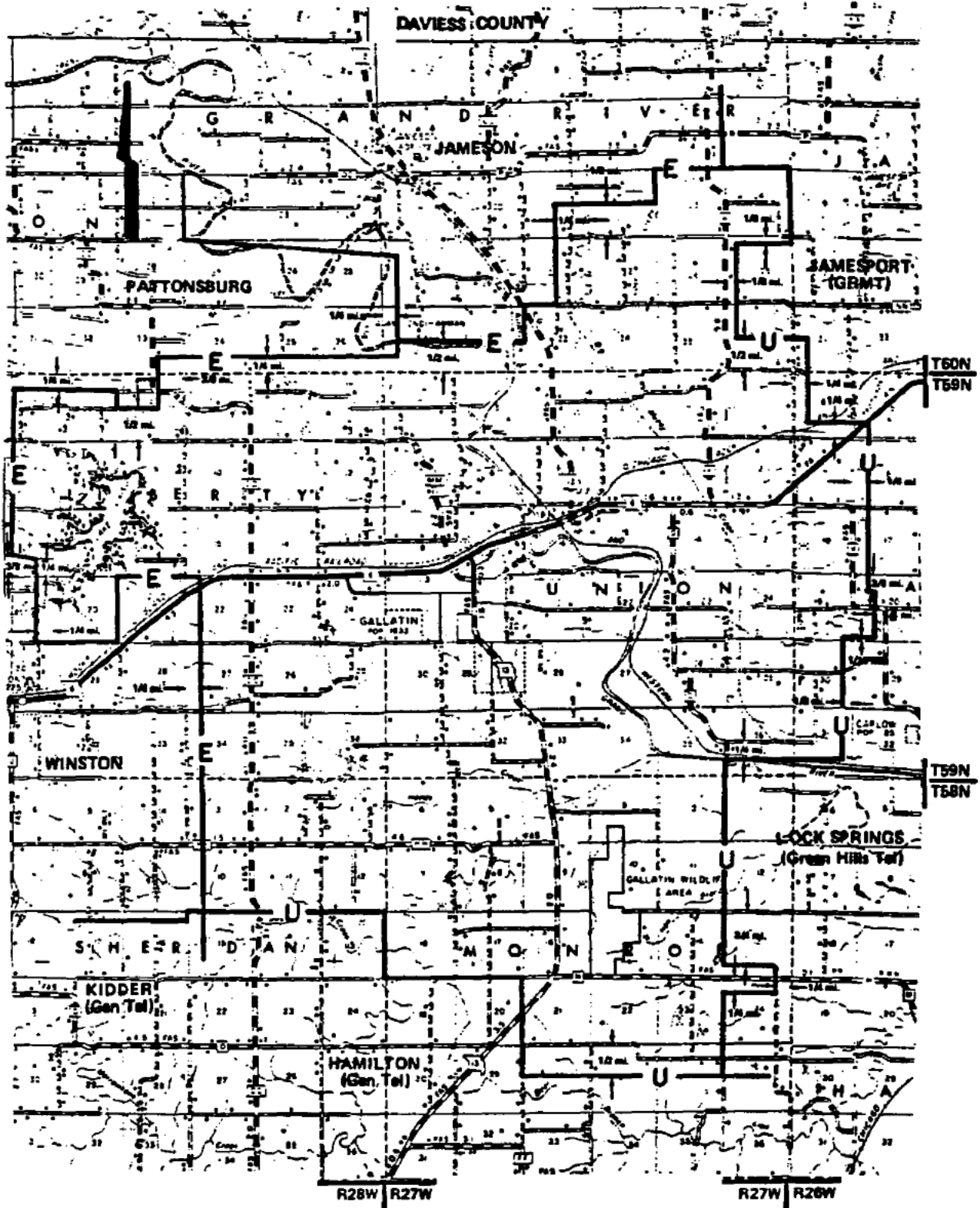

CANCELLED
August 20, 2015
Missouri Public
Service Commission
JI-2016-0057

ISSUED: December 9, 2005
ISSUED BY: Vice President
Little Rock, Arkansas

EFFECTIVE: January 9, 2006

26. EXCHANGE AREA/BASE RATE BOUNDARY MAP - GRANDIN

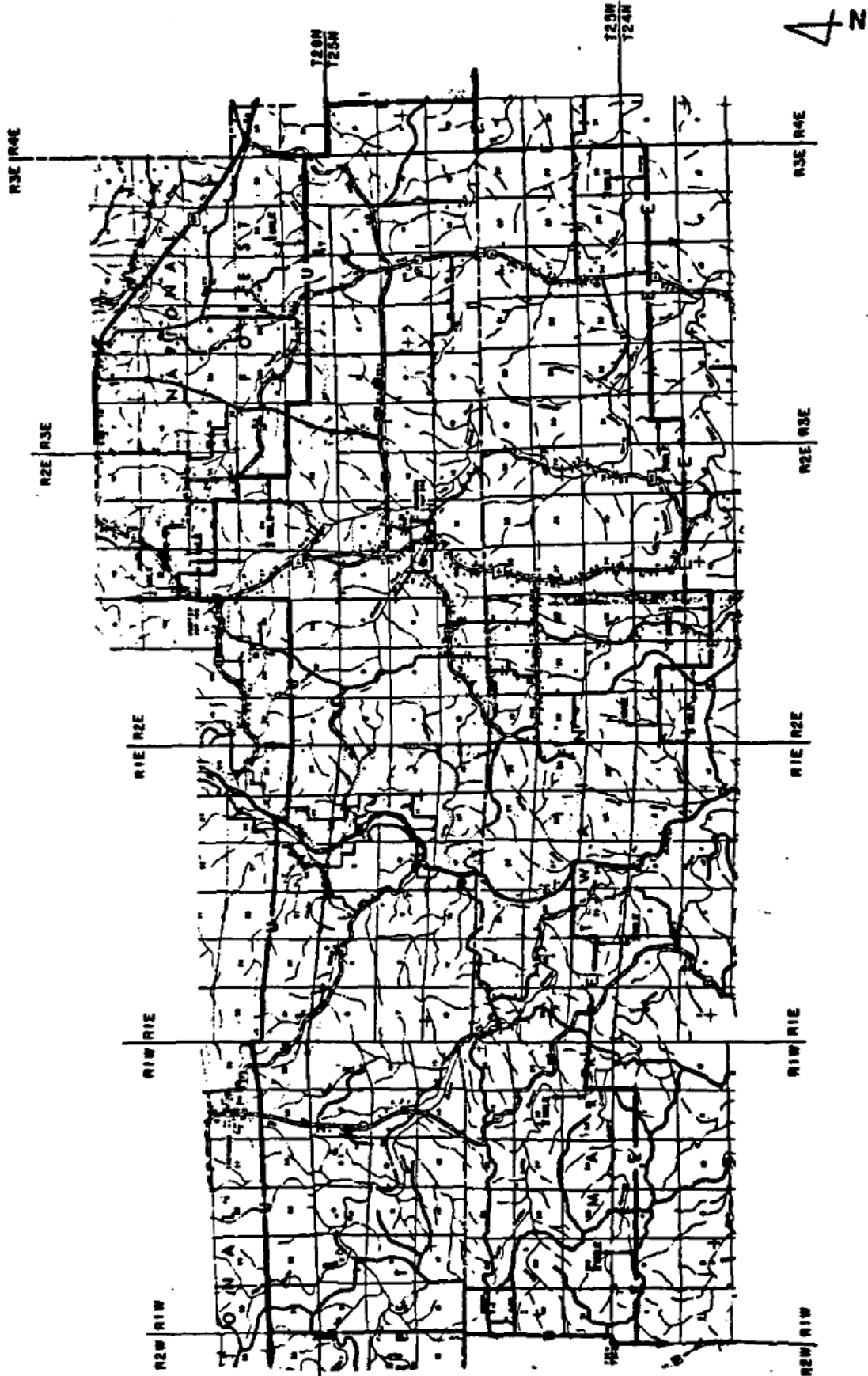

CANCELLED
August 20, 2015
Missouri Public
Service Commission
JI-2016-0057

ISSUED: December 9, 2005
ISSUED BY: Vice President
Little Rock, Arkansas

EFFECTIVE: January 9, 2006

26. EXCHANGE AREA/BASE RATE BOUNDARY MAP - GRANT CITY

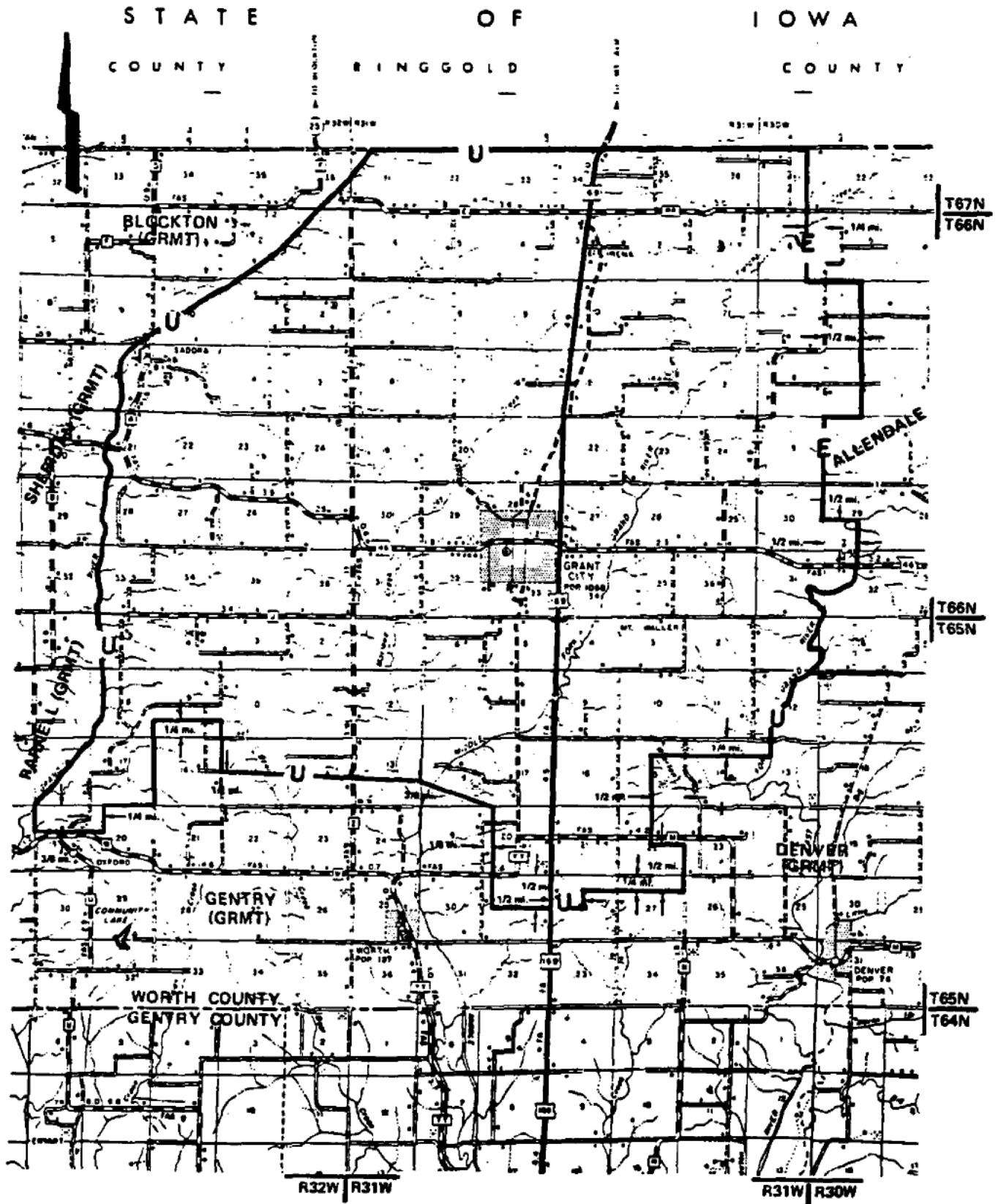

26. EXCHANGE AREA/BASE RATE BOUNDARY MAP - GREENVILLE

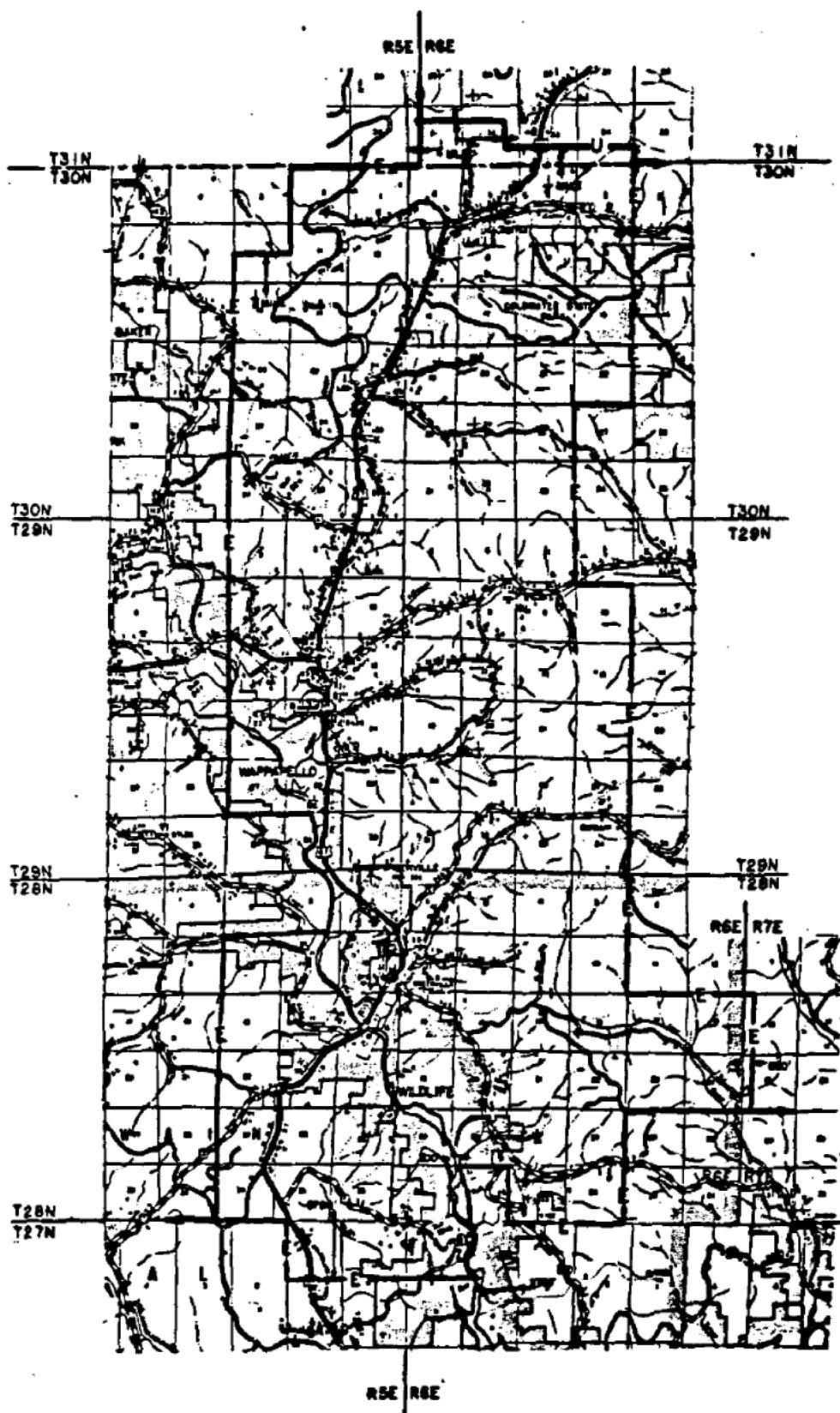

26. EXCHANGE AREA/BASE RATE BOUNDARY MAP - HOLLIDAY

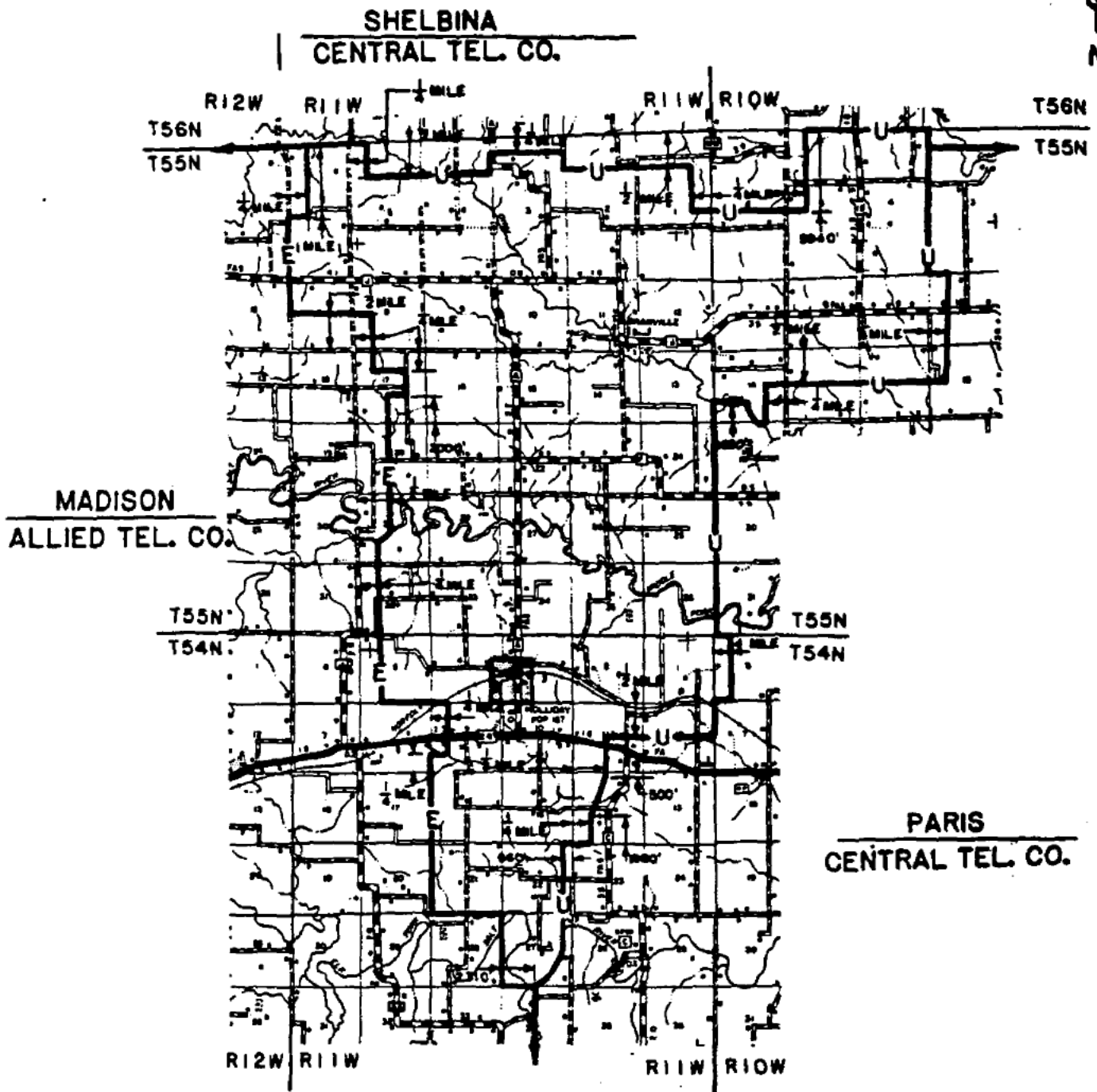

26. EXCHANGE AREA/BASE RATE BOUNDARY MAP - HALFWAY

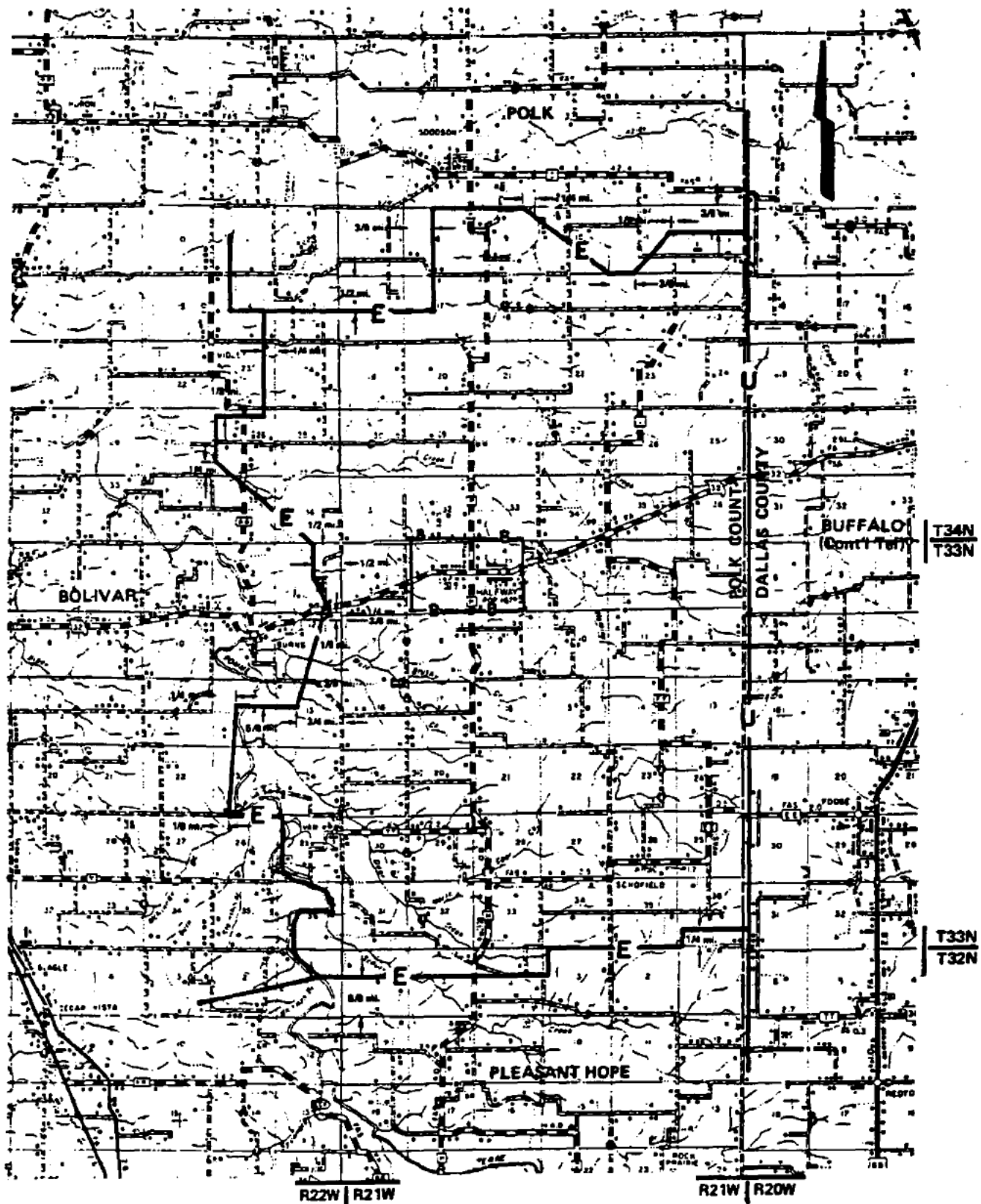

CANCELLED
August 20, 2015
Missouri Public
Service Commission
JI-2016-0057

ISSUED: December 9, 2005
ISSUED BY: Vice President
Little Rock, Arkansas

EFFECTIVE: January 9, 2006

26. EXCHANGE AREA/BASE RATE BOUNDARY MAP - IBERIA

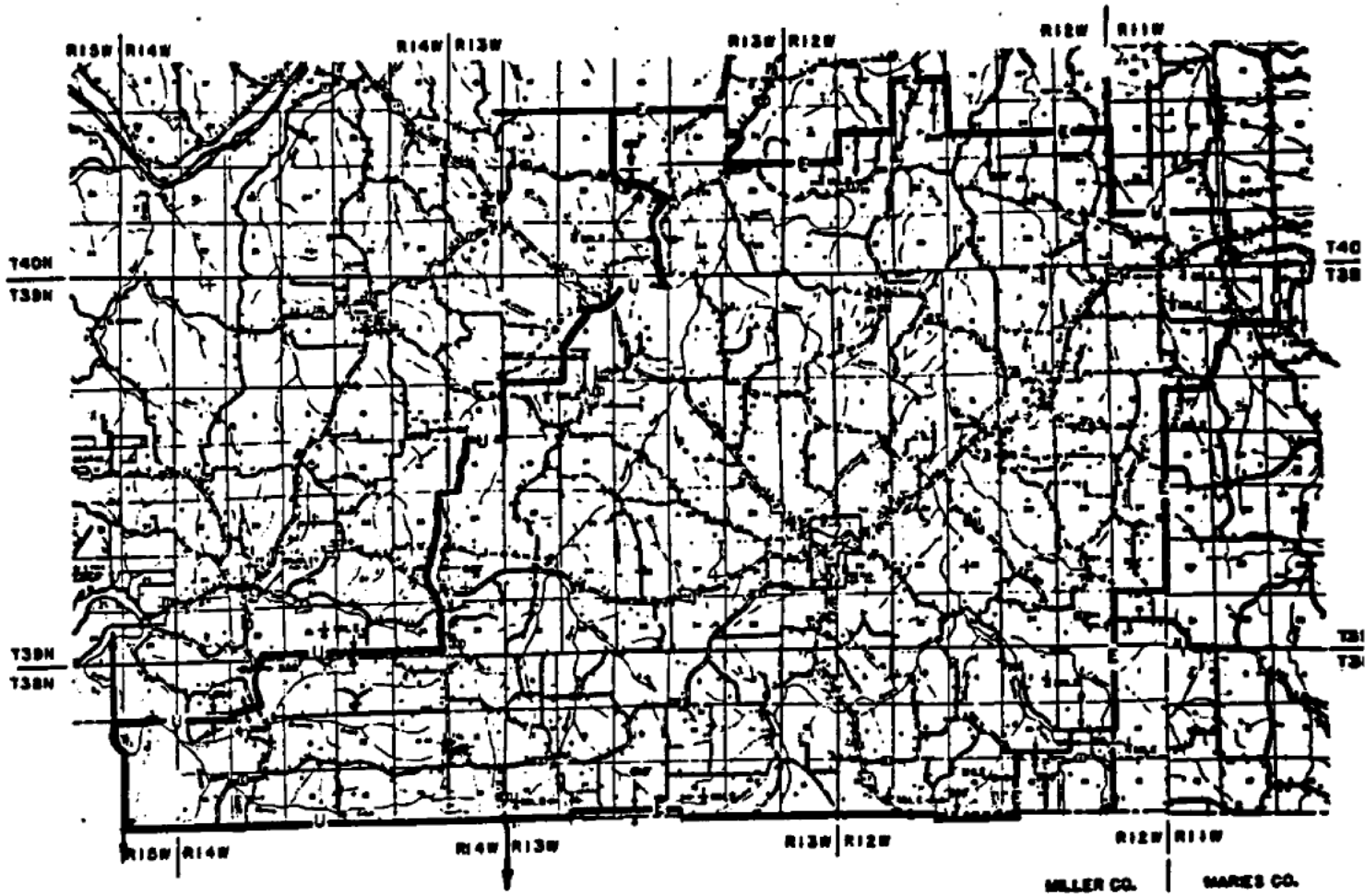

26. EXCHANGE AREA/BASE RATE BOUNDARY MAP - JAMESON

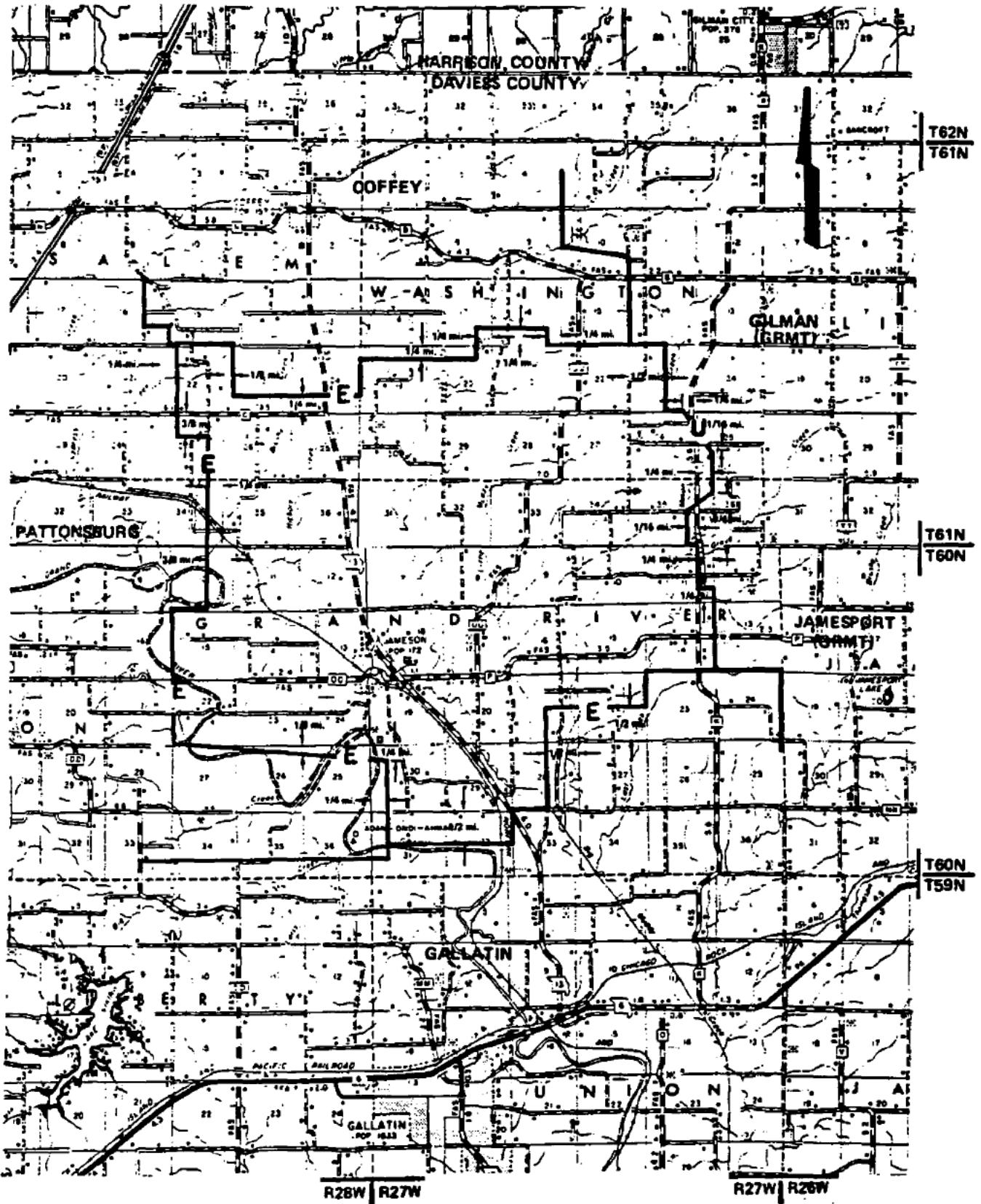

CANCELLED
August 20, 2015
Missouri Public
Service Commission
JI-2016-0057

ISSUED: December 9, 2005
ISSUED BY: Vice President
Little Rock, Arkansas

EFFECTIVE: January 9, 2006

26. EXCHANGE AREA/BASE RATE BOUNDARY MAP - LACLEDE

LINNEUS
GRAND RIVER MUT. TEL.

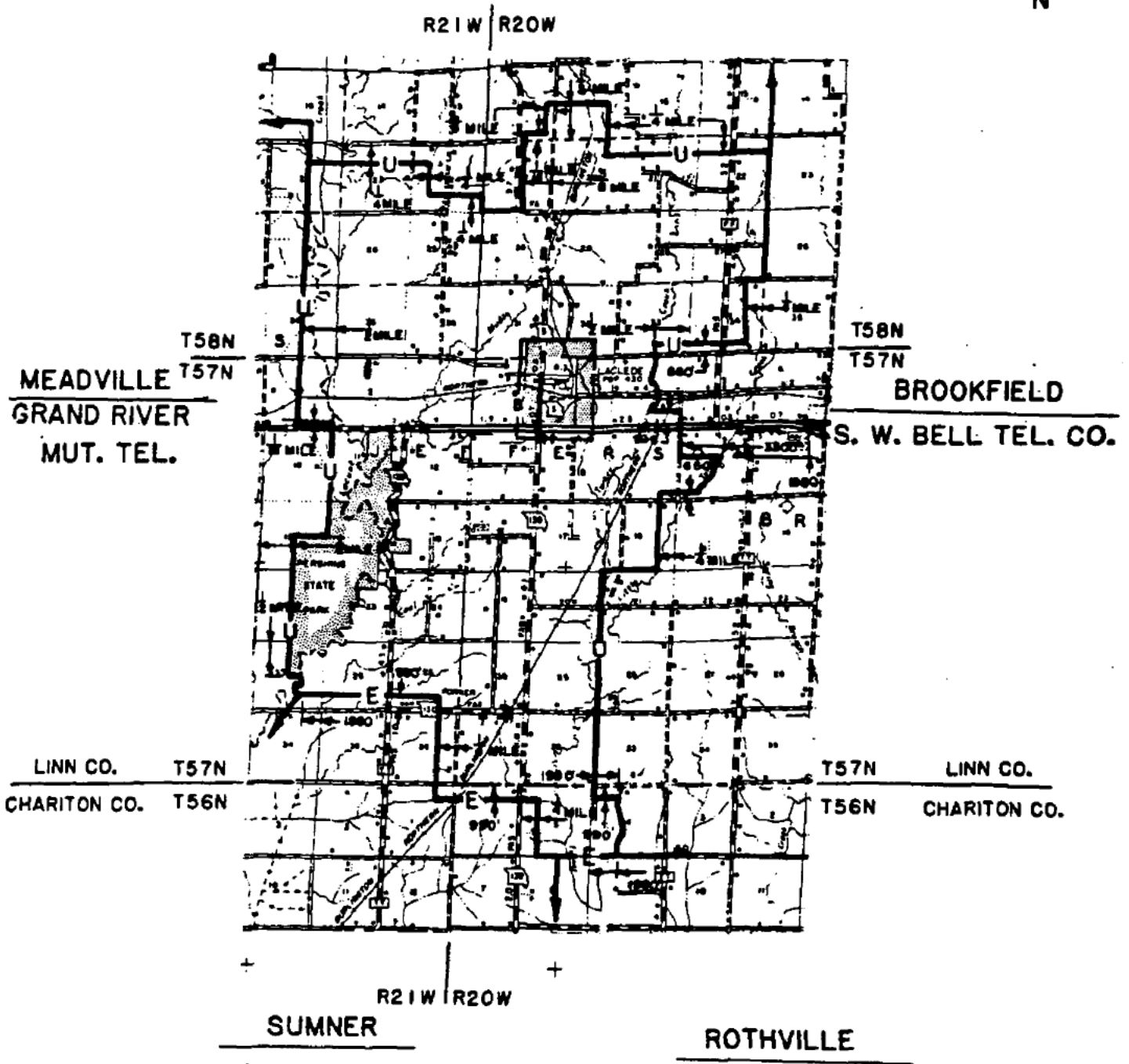

CANCELLED
August 20, 2015
Missouri Public
Service Commission
JI-2016-0057

ISSUED: December 9, 2005
ISSUED BY: Vice President
Little Rock, Arkansas

EFFECTIVE: January 9, 2006

26. EXCHANGE AREA/BASE RATE BOUNDARY MAP - LIBERAL

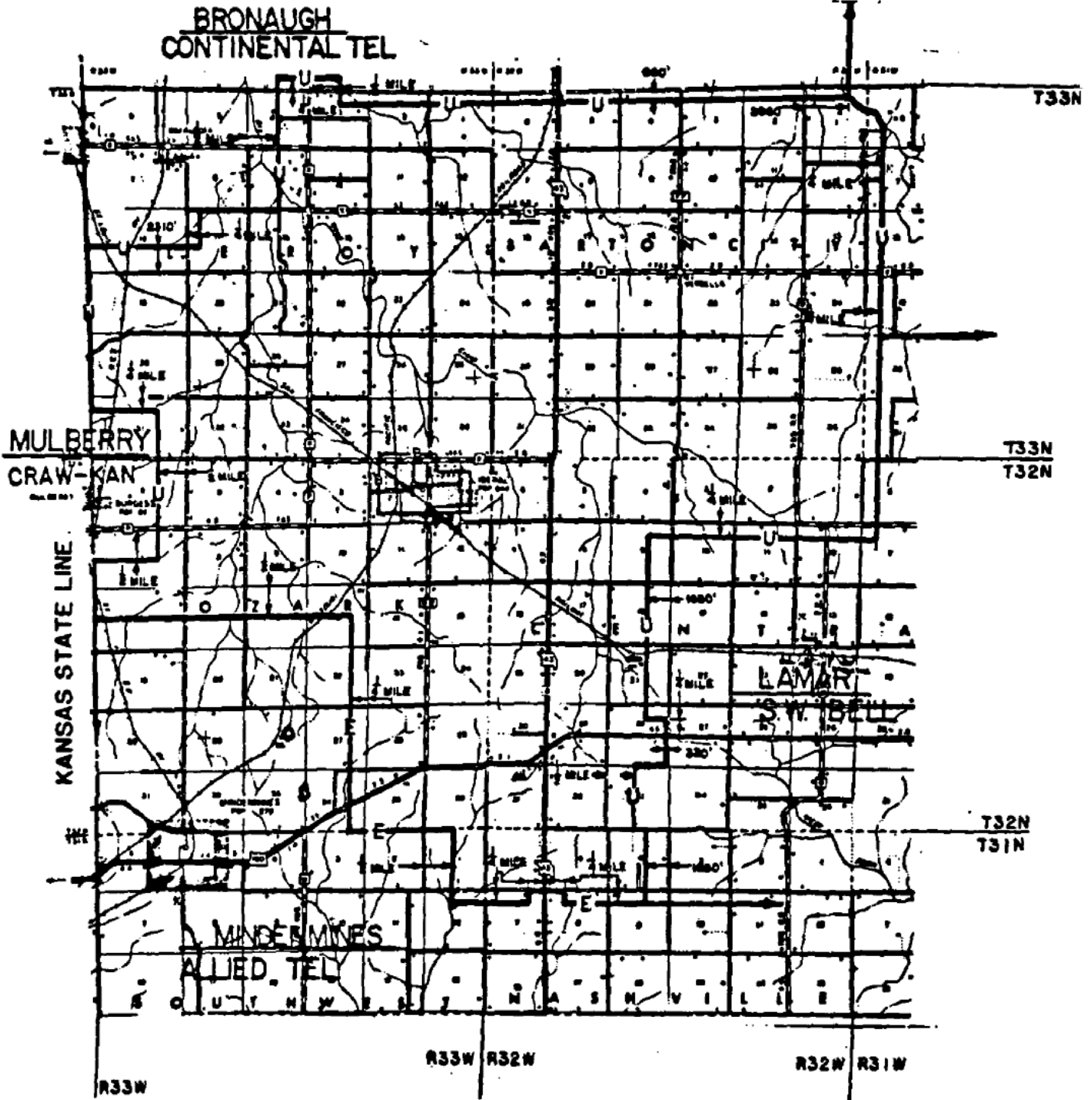

26. EXCHANGE AREA/BASE RATE BOUNDARY MAP - MADISON

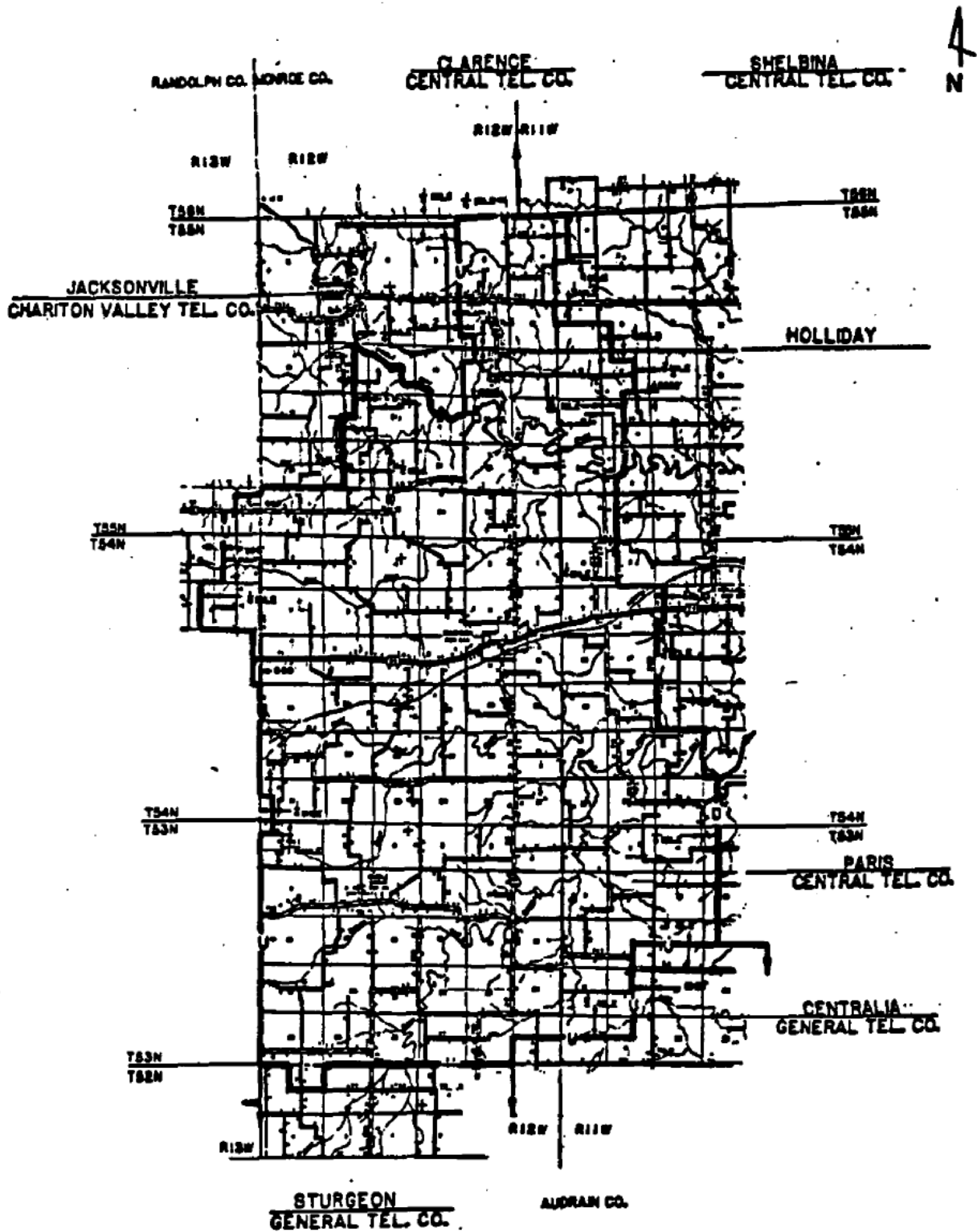

26. EXCHANGE AREA/BASE RATE BOUNDARY MAP - MARTINSBURG

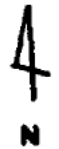
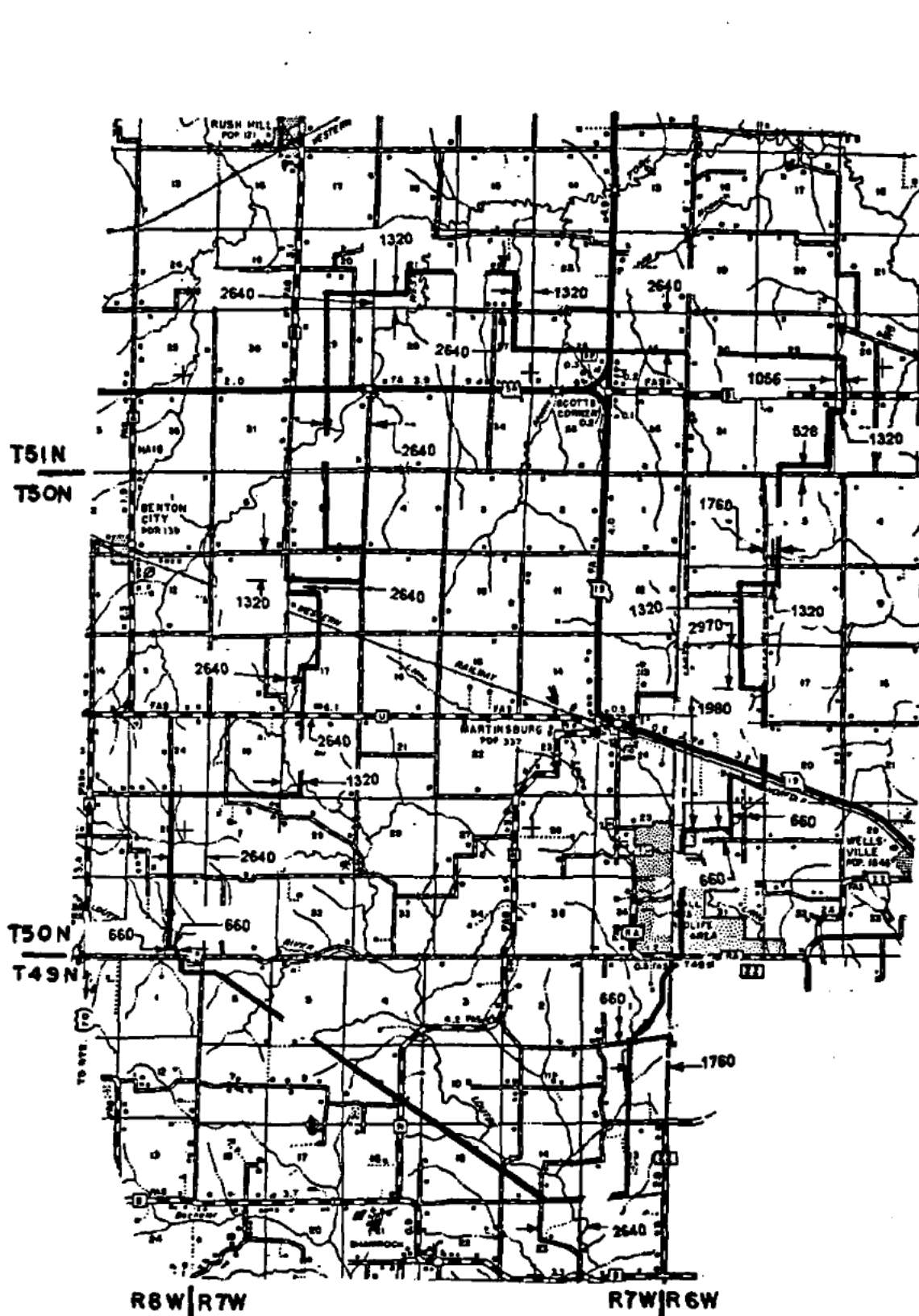

CANCELLED
August 20, 2015
Missouri Public
Service Commission
JI-2016-0057

ISSUED: December 9, 2005
ISSUED BY: Vice President
Little Rock, Arkansas

EFFECTIVE: January 9, 2006

26. EXCHANGE AREA/BASE RATE BOUNDARY MAP - MENDON

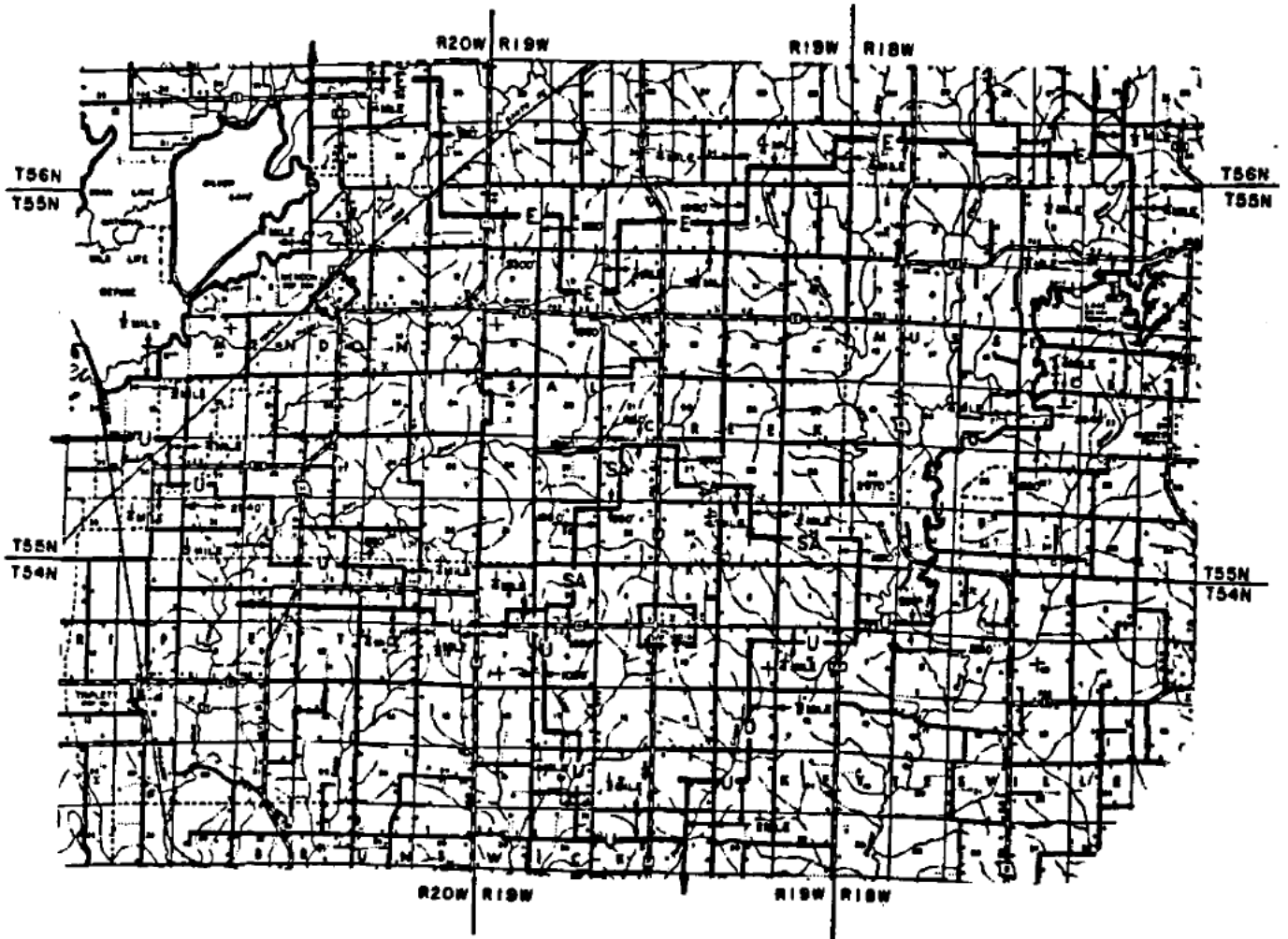

CANCELLED
August 20, 2015
Missouri Public
Service Commission
JI-2016-0057

ISSUED: December 9, 2005
ISSUED BY: Vice President
Little Rock, Arkansas

EFFECTIVE: January 9, 2006

26. EXCHANGE AREA/BASE RATE BOUNDARY MAP - MIDDLETOWN

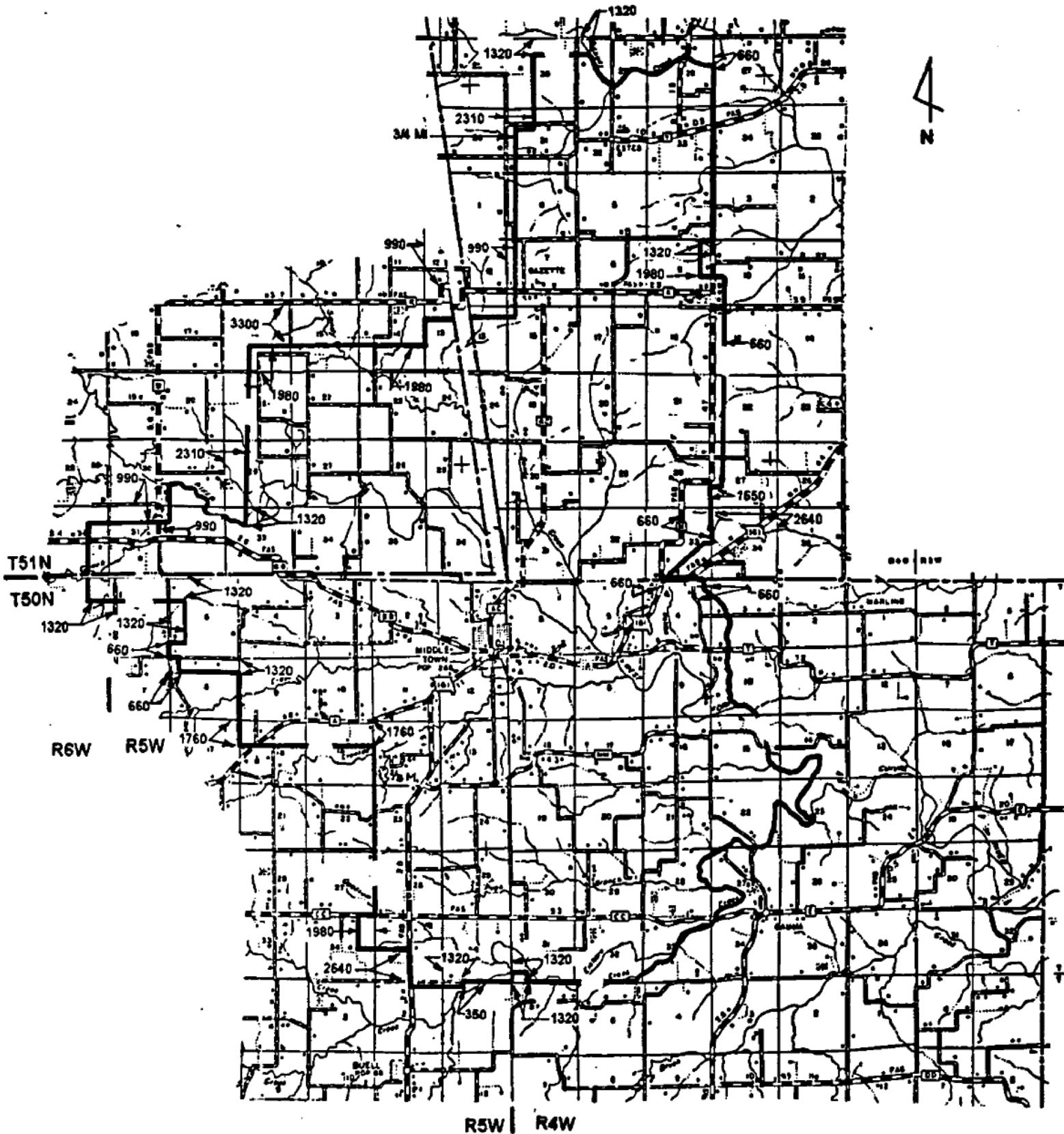

26. EXCHANGE AREA/BASE RATE BOUNDARY MAP - MILAN

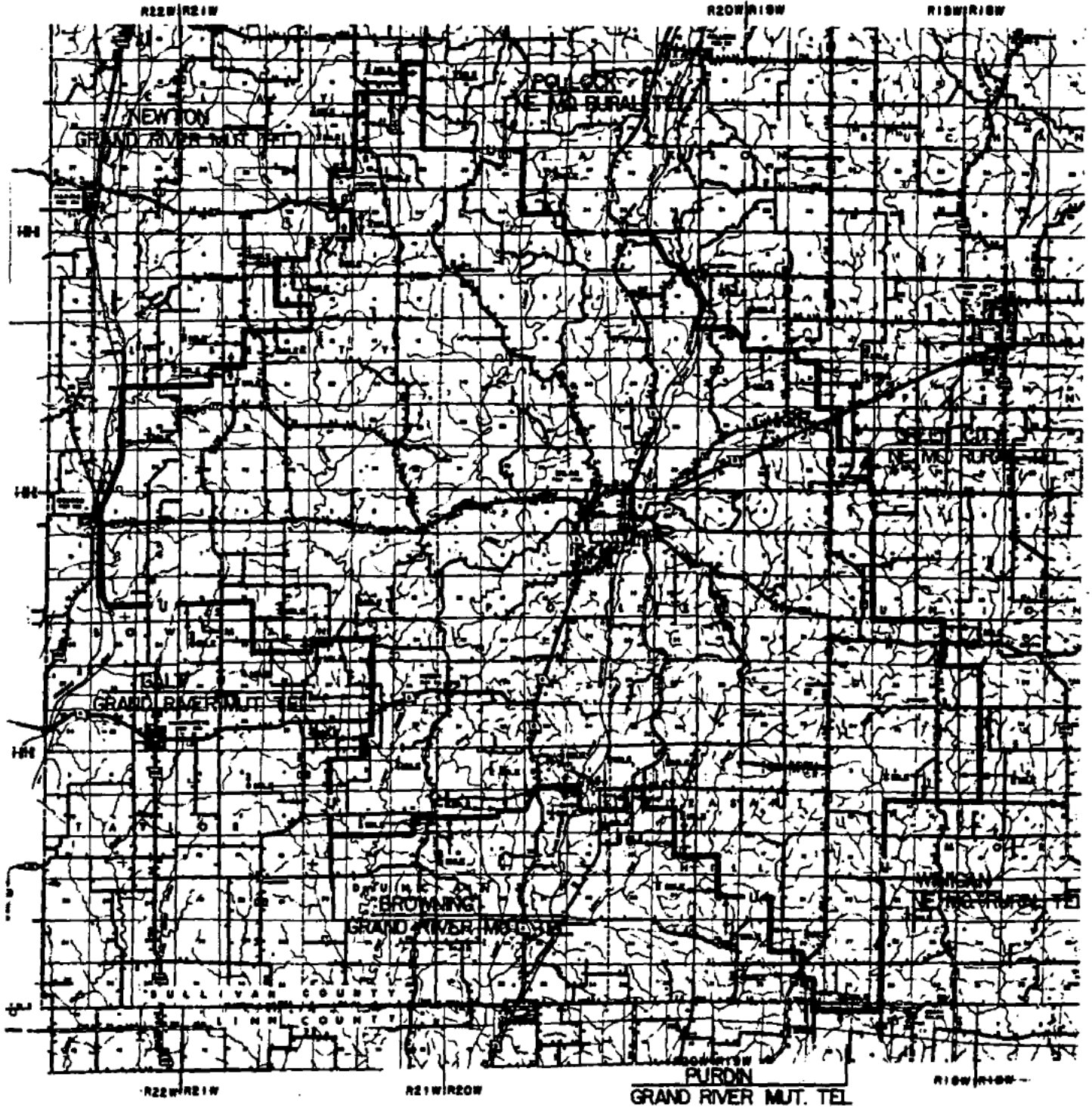

CANCELLED
August 20, 2015
Missouri Public
Service Commission
JI-2016-0057

ISSUED: December 9, 2005
ISSUED BY: Vice President
Little Rock, Arkansas

EFFECTIVE: January 9, 2006