

SBC PSC MO #17
Macks Creek, Missouri
Original Sheet 2

Non-Scannable Map

(Is viewable in the Data Center
200 Madison Street, 1st Floor
Jefferson City MO)

NO SUPPLEMENT TO THIS TARIFF WILL BE ISSUED EXCEPT FOR THE PURPOSE OF CANCELING THIS TARIFF.

P. S. C. Mo. No. 17

Macks Creek, Missouri

EXCHANGE AREA MAP

7th REVISED SHEET 3 REPLACING 6th REVISED SHEET 3

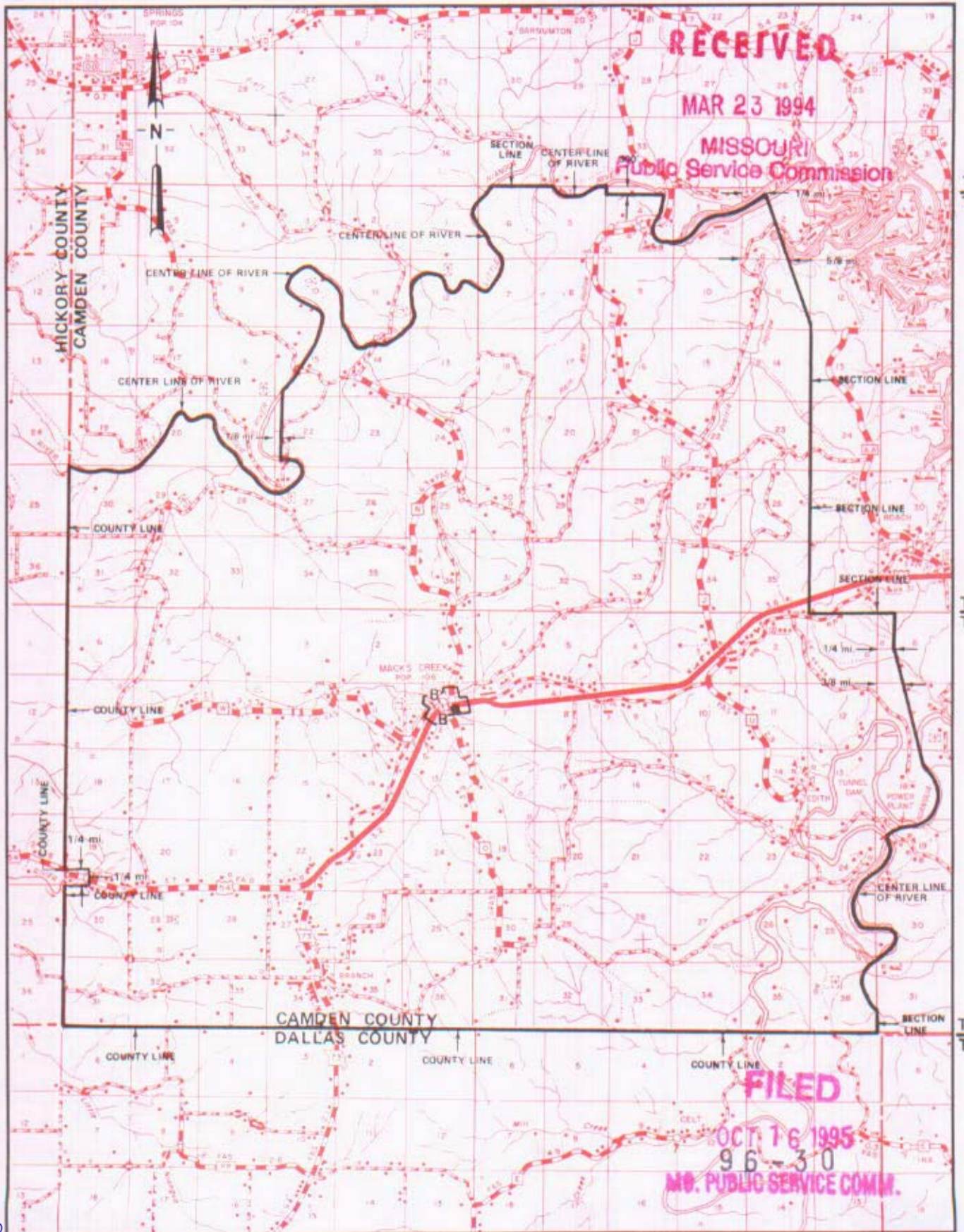

T39N
T38N

T38N
T37N

T37N
T36N

CANCELLED
June 29, 2007
TO-2002-185
Missouri Public
Service Commission

R20W | R19W

R19W | R18W

R18W | R17W

By HORACE WILKINS JR., President, Missouri
Southwestern Bell Telephone Company
St. Louis, Missouri

Issued: March 23, 1994

Effective: October 16, 1995

NO SUPPLEMENT TO THIS TARIFF WILL BE ISSUED EXCEPT FOR THE PURPOSE OF CANCELING THIS TARIFF.

P. S. C. Mo. No. 17
EXCHANGE AREA MAP

Macks-Creek, Missouri
RECEIVED
6th REVISED SHEET 3
REPLACING 5th REVISED SHEET 3

FEB 14 1977

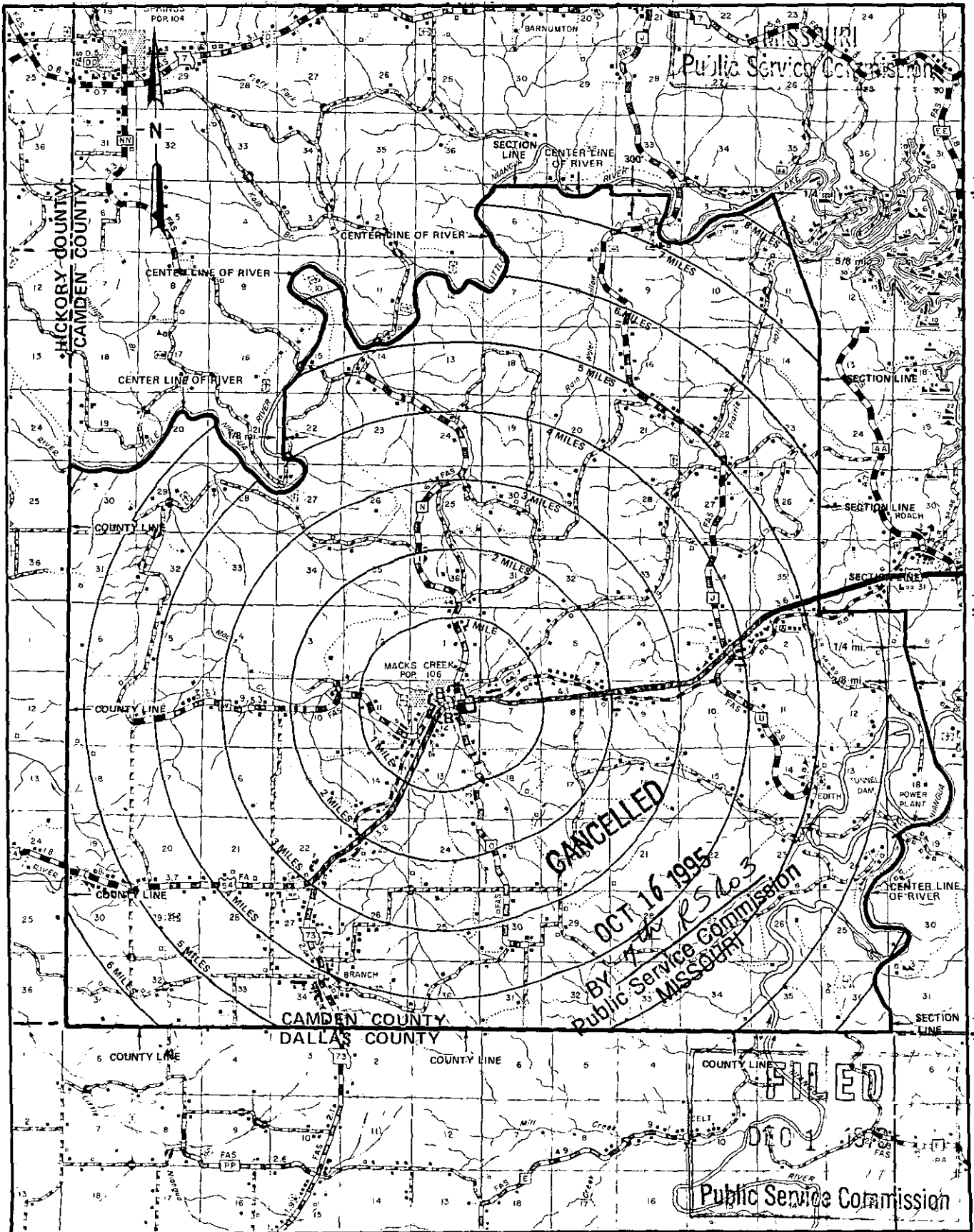

T39N
T38N

T38N
T37N

T37N
T36N

R20W | R19W

R19W | R18W

R18W | R17W

By R. R. SHOCKLEY, Vice President, Missouri
Southwestern Bell Telephone Company

DEC 1 1978

Issued: February 15, 1977

St. Louis, Missouri

SBC PSC MO #17
Malden, Missouri
2nd Revised Sheet 2
Replacing 1st Revised Sheet 2

Non-Scannable Map

(Is viewable in the Data Center
200 Madison Street, 1st Floor
Jefferson City MO)

CANCELLED
June 29, 2007
TO-2002-185
Missouri Public
Service Commission

P. S. C. Mo. No. 17
EXCHANGE AREA MAP

RECEIVED
Malden, Missouri
9th REVISED SHEET 3
REPLACING 8th REVISED SHEET 3
FEB 14 1977

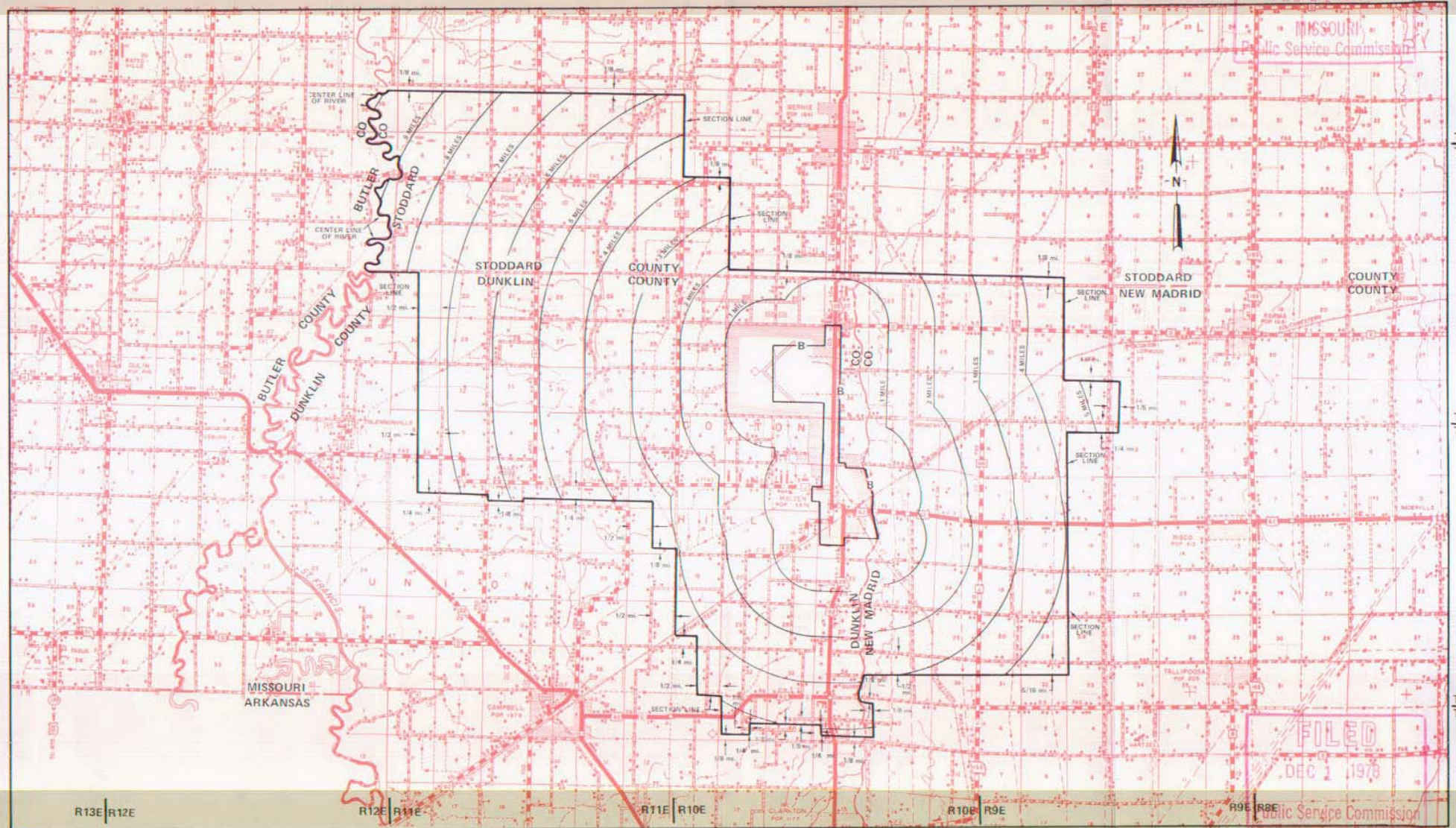

MISSOURI
Public Service Commission

FILED
DEC 1 1978
Public Service Commission

By R. R. SHOCKLEY, Vice President, Missouri
Southwestern Bell Telephone Company
St. Louis, Missouri

Issued: February 15, 1977

Effective: DEC 1 1978

CANCELLED
June 29, 2007
TO-2002-185
Missouri Public
Service Commission

SBC PSC MO #17
Manchester, Missouri
18th Revised Sheet 2
Replacing 17th Revised Sheet 2

Non-Scannable
Map

**(Is viewable in the Data Center
200 Madison Street, 1st Floor
Jefferson City MO)**

CANCELLED
June 29, 2007
TO-2002-185
Missouri Public
Service Commission

SBC PSC MO #17

Marble Hill-Lutesville, Missouri

Original Sheet 2

Replacing Southeast Missouri

Telephone Co.

P.S.C. Mo. No. 2

1st Revised Sheet 1-A

Non-Scannable Map

(Is viewable in the Data Center
200 Madison Street, 1st Floor
Jefferson City MO)

SBC PSC MO #17

CANCELLED
June 29, 2007
TO-2002-185
Missouri Public
Service Commission

Marble Hill - Lutesville, Missouri

11th Revised Sheet 3

Replacing 10th Revised Sheet 3

Non-Scannable Map

(Is viewable in the Data Center
200 Madison Street, 1st Floor
Jefferson City MO)

CANCELLED
June 29, 2007
TO-2002-185
Missouri Public
Service Commission

SBC PSC MO #17
Marceline, Missouri
1st Revised Sheet 2
Replacing Original Sheet 2
Linn County

Non-Scannable Map

(Is viewable in the Data Center
200 Madison Street, 1st Floor
Jefferson City MO)

NO SUPPLEMENT TO THIS TARIFF WILL BE ISSUED EXCEPT FOR THE PURPOSE OF CANCELING THIS TARIFF.

P. S. C. Mo. No. 17 EXCHANGE AREA MAP

Marceline, Missouri

RECEIVED
9th REVISED SHEET 3
REPLACING 8th REVISED SHEET 3

AUG 24 1979

MISSOURI
Public Service Commission

COUNTY
COUNTY



T58N
T57N

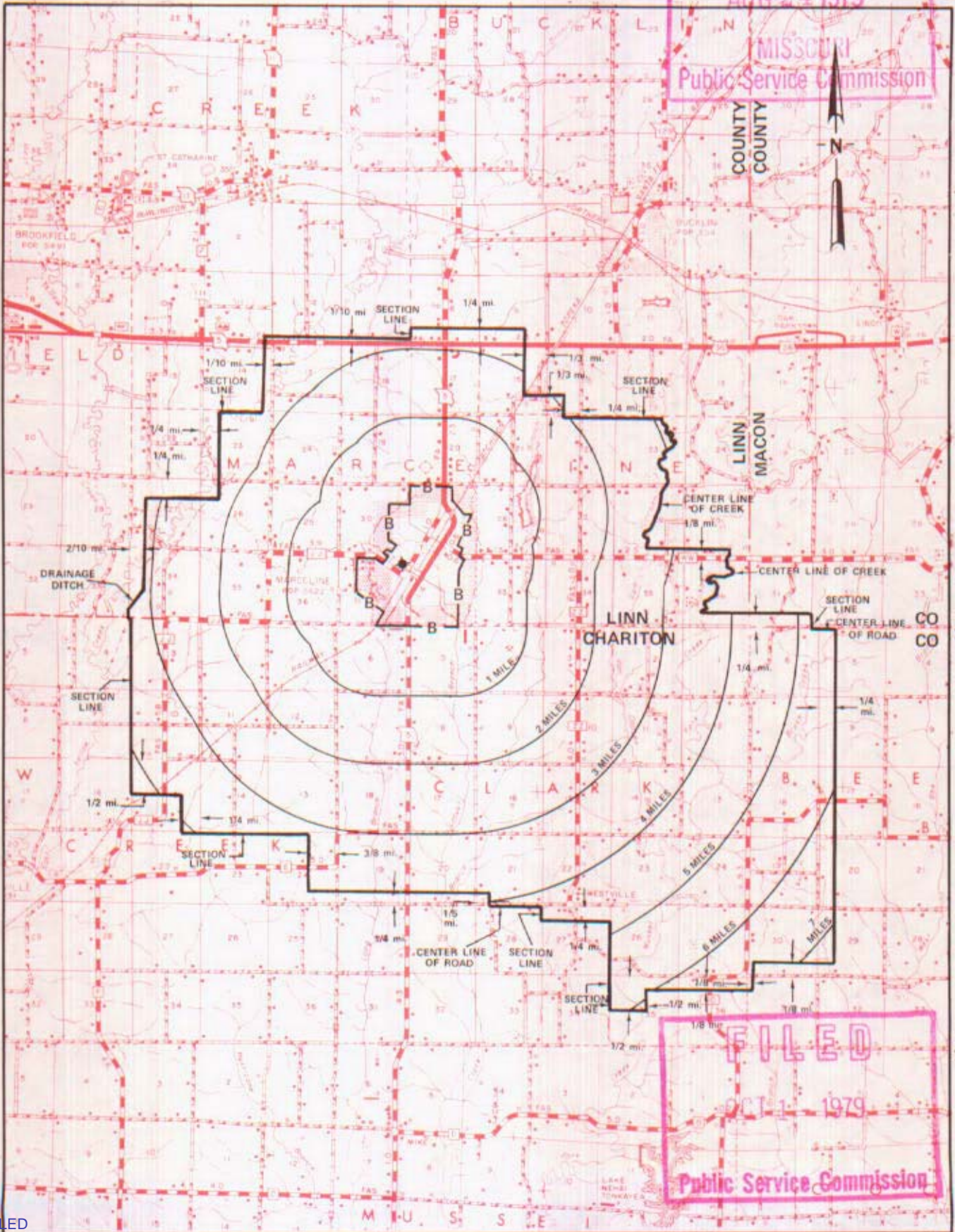

CO T57N
CO T56N

T56N
T55N

FILED
OCT 1 1979
Public Service Commission

R19W | R18W

R18W | R17W

By R. R. SHOCKLEY, Vice President, Missouri
Southwestern Bell Telephone Company

St. Louis, Missouri

OCT 1 1979

Effective: _____

CANCELLED
June 29, 2007
TO-2002-185
Missouri Public
Service Commission

Issued: AUGUST 28, 1979

NO SUPPLEMENT TO THIS TARIFF WILL BE ISSUED EXCEPT FOR THE PURPOSE OF CANCELING THIS TARIFF.

P. S. C. Mo. No. 17

Marionville, Missouri
ORIGINAL SHEET 2
REPLACING ORIGINAL SHEET 1-A

BASE RATE AREA MAP

U.S. HWY 60

RECEIVED
MAR 8 1949
MISSOURI
Public Service Comm.

FILED
APR 7 1949

Public Service Commission

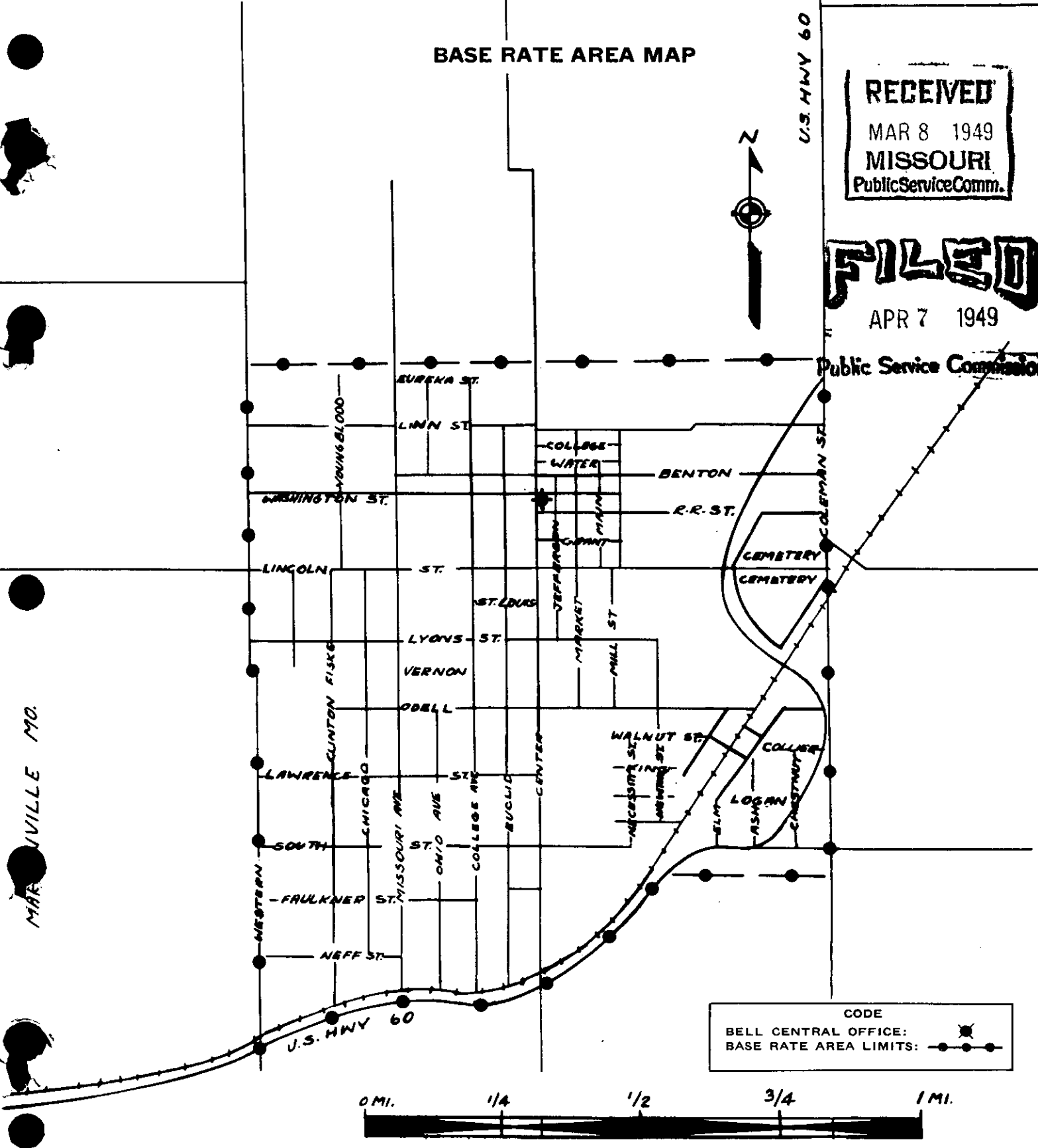

MARIONVILLE MO.

CODE
 BELL CENTRAL OFFICE: ★
 BASE RATE AREA LIMITS: —●—●—●—

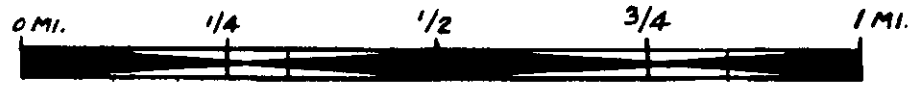

Issued: March 7, 1949

Effective: April 7, 1949

CANCELLED
June 29, 2007
TO-2002-185
Missouri Public
Service Commission

By M. L. PEARCY, General Manager
Southwestern Bell Telephone Company
St. Louis, Missouri

Schedule for Marquand cancelled

Jul 1, 1932

Exchange abandoned. Subscribers
trunked to Patton and considered
Patton subscribers.

CANCELLED
June 29, 2007
TO-2002-185
Missouri Public
Service Commission

P. S. C. Mo. No. 17
BASE RATE AREA MAP

Marshall, Missouri

2nd REVISED SHEET 2
REPLACING 1st REVISED SHEET 2

NO SUPPLEMENT TO THIS TARIFF WILL
BE ISSUED EXCEPT FOR THE PURPOSE OF
CANCELING THIS TARIFF.

RECEIVED

AUG 14 1991

MISSOURI
Public Service Commission

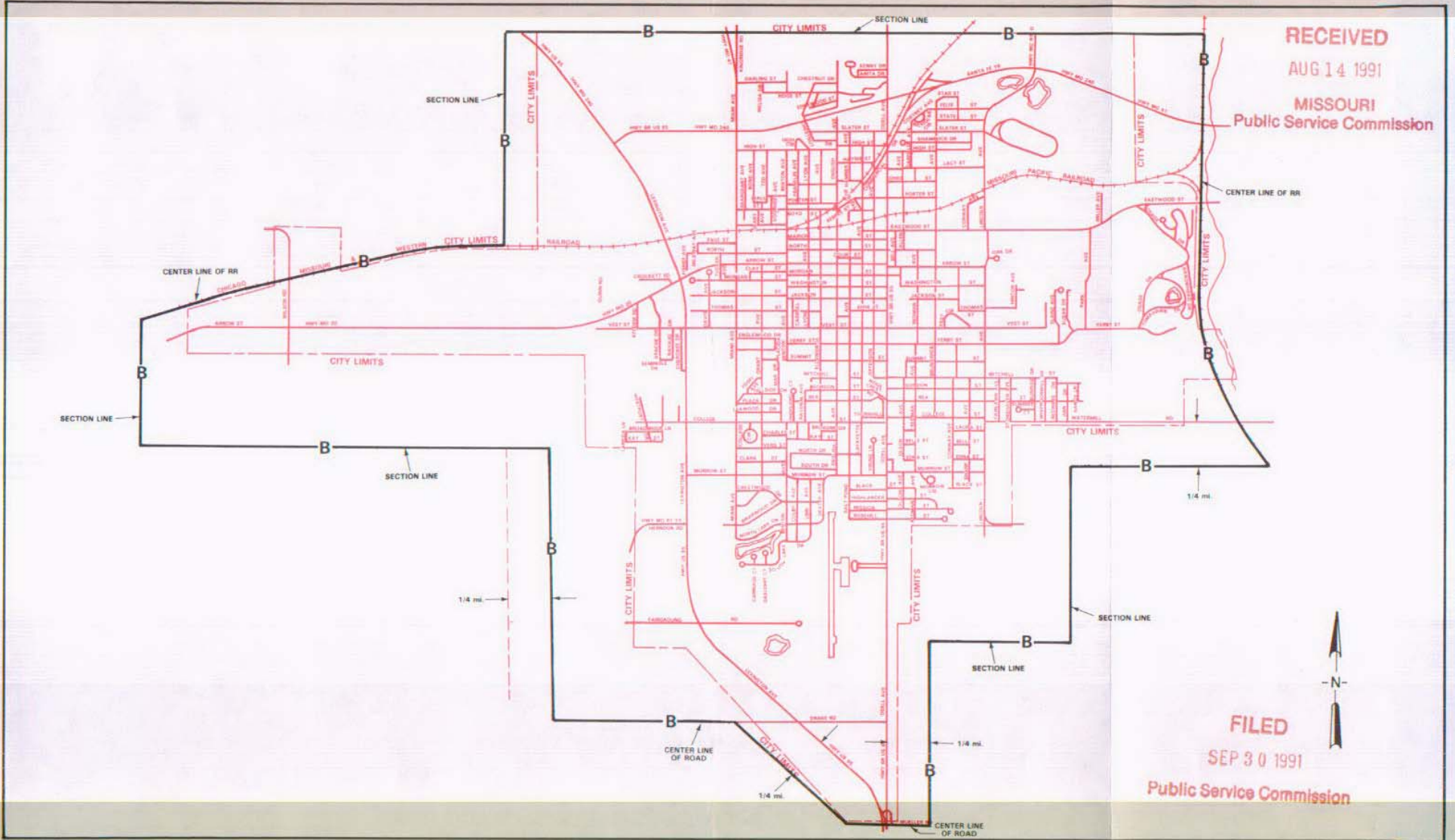

FILED
SEP 3 0 1991
Public Service Commission

By R. D. BARRON, PRESIDENT, MISSOURI DIVISION
Southwestern Bell Telephone Company
St. Louis, Missouri

Issued: AUG 23 1991

Effective: SEP 3 0 1991

CANCELLED
June 29, 2007
TO-2002-185
Missouri Public
Service Commission

SBC PSC MO #17
Marshall, Missouri
1st Revised Sheet 2
Replacing Original Sheet 2

Non-Scannable Map

(Is viewable in the Data Center
200 Madison Street, 1st Floor
Jefferson City MO)

CANCELLED
June 29, 2007
TO-2002-185
Missouri Public
Service Commission

P. S. C. Mo. No. 17
EXCHANGE AREA MAP

Marshall, Missouri

14th REVISED SHEET 3
REPLACING 13th REVISED SHEET 3

NO SUPPLEMENT TO THIS TARIFF WILL
BE ISSUED EXCEPT FOR THE PURPOSE OF
CANCELING THIS TARIFF.

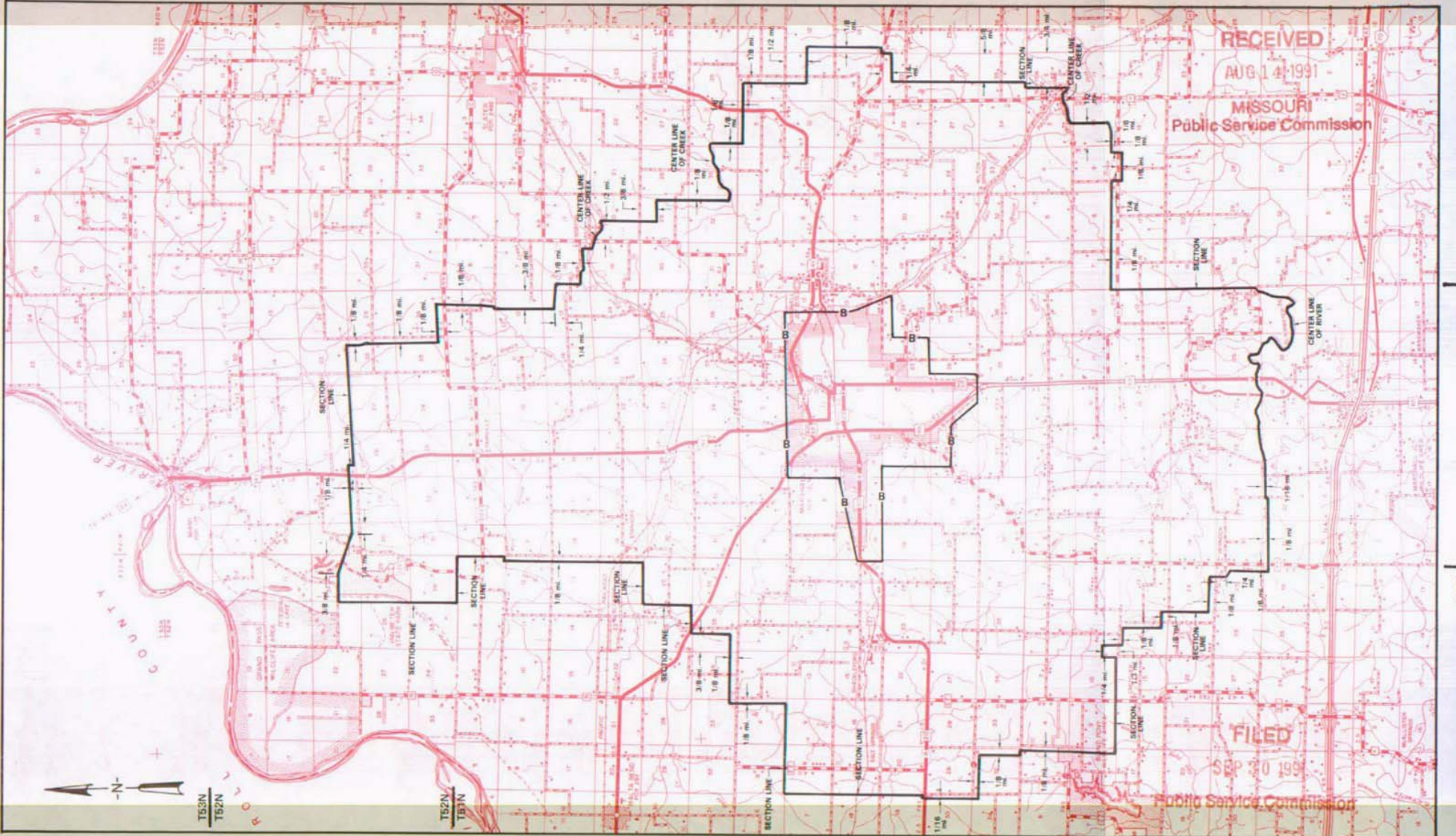

RECEIVED
AUG 14 1991
MISSOURI
Public Service Commission

FILED
SEP 30 1991
Public Service Commission

AUG 23 1991

Issued: _____

By R. D. BARRON, PRESIDENT, MISSOURI DIVISION
Southwestern Bell Telephone Company
St. Louis, Missouri

T51N
T50N

T50N
T49N

T49N
T48N

Effective: SEP 30 1991

R21W R20W

R22W R21W

CANCELLED
June 29, 2007
TO-2002-185
Missouri Public
Service Commission

SBC PSC MO #17

Marston, Missouri

Original Sheet 2

Southeast Missouri Telephone Company

P.S.C. Mo. No. 2

First Revised Sheet 1-A

Non-Scannable Map

(Is viewable in the Data Center
200 Madison Street, 1st Floor
Jefferson City MO)

NO SUPPLEMENT TO THIS TARIFF WILL BE ISSUED EXCEPT FOR THE PURPOSE OF CANCELING THIS TARIFF.

P. S. C. Mo. No. 17

EXCHANGE AREA MAP

Marston, Missouri
RECEIVED
2nd REVISED SHEET 3
REPLACING 1st REVISED SHEET 3

DEC 10 1978

MISSOURI
Public Service Commission

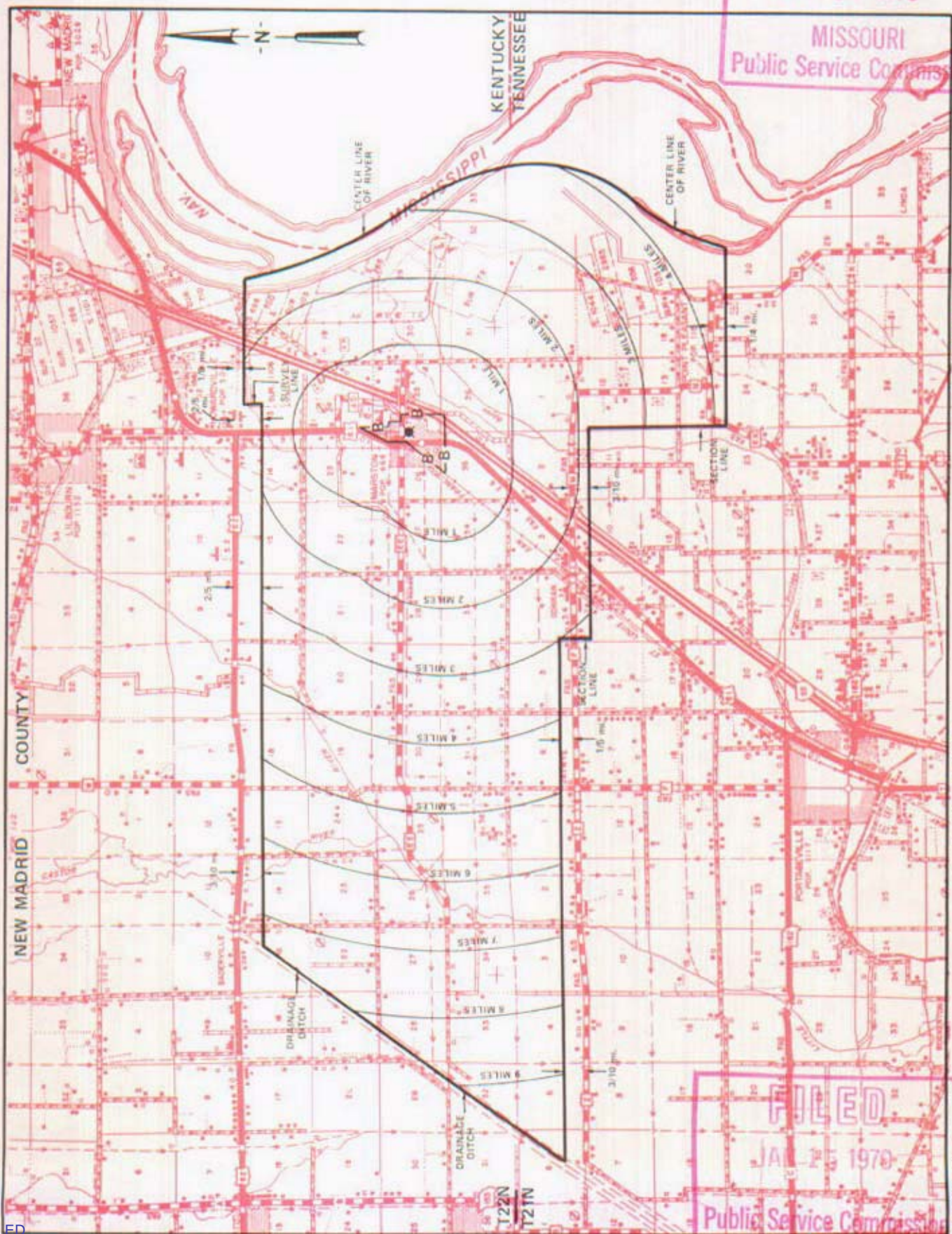

FILED
JAN 5 1979
Public Service Commission

CANCELLED
June 29, 2007
TO-2002-185
Missouri Public
Service Commission

DEC 15 1978

By R. R. SHOCKLEY, Vice President, Missouri
Southwestern Bell Telephone Company

JAN 5 1979

SBC PSC MO #17
Maxville, Missouri
14th Revised Sheet 2
Replacing 13th Revised Sheet 2

Non-Scannable Map

(Is viewable in the Data Center
200 Madison Street, 1st Floor
Jefferson City MO)

SBC Missouri
Exchange & Base Rate Area Map
Maxville
PSC MO No. 17
14th Revised Sheet 2

Non-Scannable Map

(Viewable in the Data Center
located at:
200 Madison Street, 1st Floor
Jefferson City MO)

SBC Missouri
Exchange & Base Rate Area Map
Maxville
PSC MO No. 17
13th Revised Sheet 2

Non-Scannable Map

(Viewable in the Data Center
located at:
200 Madison Street, 1st Floor
Jefferson City MO)

SBC Missouri
Exchange & Base Rate Area Map
Maxville
PSC MO No. 17
12th Revised Sheet 2

Non-Scannable Map

(Viewable in the Data Center
located at:
200 Madison Street, 1st Floor
Jefferson City MO)

MEHLVILLE

SEE

St. Louis District Exchange Rates

under

"St. Louis"

June 1, 1937

NO SUPPLEMENT TO THIS TARIFF WILL BE ISSUED EXCEPT FOR THE PURPOSE OF CANCELING THIS TARIFF.

Meta, Missouri

1st REVISED SHEET 2
REPLACING OZARK CENTRAL TELEPHONE COMPANY
P.S.C. Mo. No. 1
ORIGINAL SHEET 2

P. S. C. Mo. No. 17 BASE RATE AREA MAP

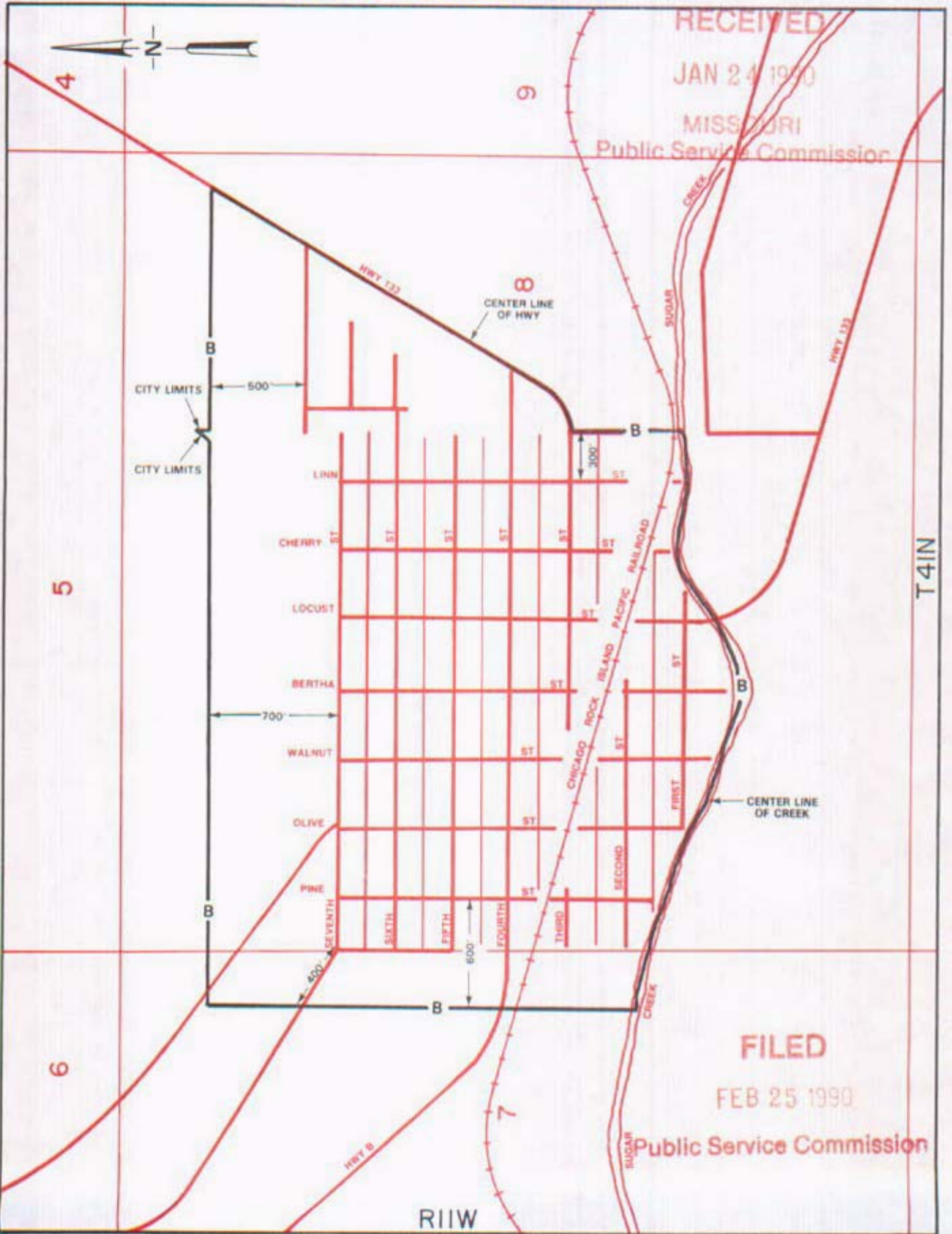

RECEIVED
JAN 24 1990
MISSOURI
Public Service Commission

FILED
FEB 25 1990
Public Service Commission

CANCELLED
June 29, 2007
TO-2002-185
Missouri Public
Service Commission

Issued: JAN 24 1990

By R. D. BARRON, PRESIDENT, MISSOURI DIVISION
Southwestern Bell Telephone Company
St. Louis, Missouri

Effective: FEB 25 1990

NO SUPPLEMENT TO THIS TARIFF WILL BE ISSUED EXCEPT FOR THE PURPOSE OF CANCELING THIS TARIFF.

Meta, Missouri

10th REVISED SHEET 3
REPLACING 9th REVISED SHEET 3

P. S. C. Mo. No. 17 EXCHANGE AREA MAP

RECEIVED

JAN 24 1990
MISSOURI
Public Service Commission

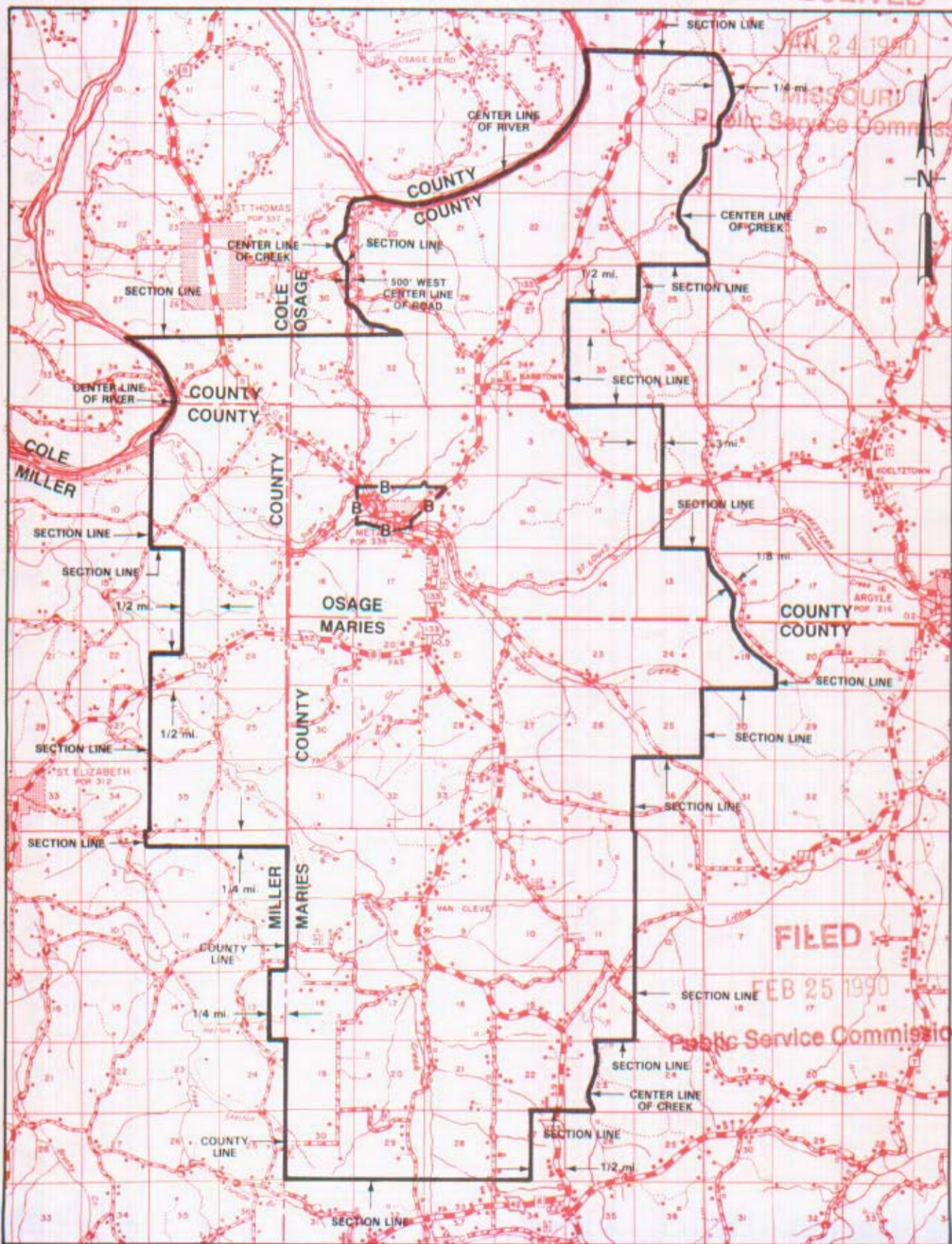

T42N
T41N

T41N
T40N

FILED
FEB 25 1990
Public Service Commission

CANCELLED
June 29, 2007
TO-2002-185
Missouri Public
Service Commission

Issued: JAN 24 1990

By R. D. BARRON, PRESIDENT, MISSOURI DIVISION
Southwestern Bell Telephone Company
St. Louis, Missouri

Effective: FEB 25 1990

SBC PSC MO #17
Mexico, Missouri
4th Revised Sheet 2
Replacing 3rd Revised Sheet 2

Non-Scannable Map

(Is viewable in the Data Center
200 Madison Street, 1st Floor
Jefferson City MO)

NO SUPPLEMENT TO THIS TARIFF WILL
BE ISSUED EXCEPT FOR THE PURPOSE OF
CANCELING THIS TARIFF.

P. S. C. Mo. No. 17
EXCHANGE AREA MAP

Mexico, Missouri

15th REVISED SHEET 3
REPLACING 14th REVISED SHEET 3

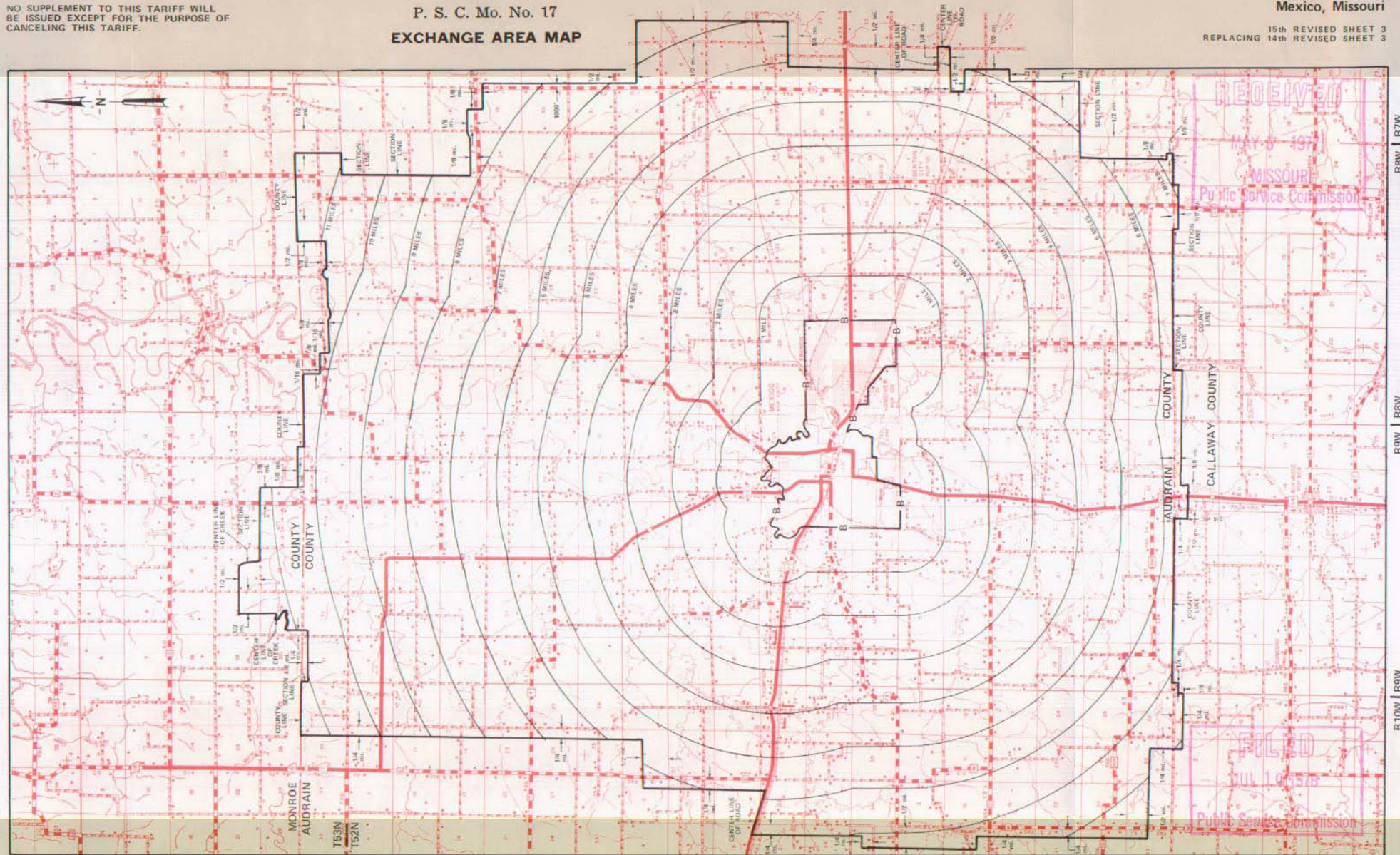

RECEIVED
MAY 6 1977
MISSOURI
Public Service Commission

FILED
JUL 10 1978
Public Service Commission

Issued: May 10, 1977

By R. R. SHOCKLEY, Vice President, Missouri
Southwestern Bell Telephone Company
St. Louis, Missouri

Effective: JUL 10 1978

CANCELLED
June 29, 2007
TO-2002-185
Missouri Public
Service Commission

SBC PSC MO #17
Moberly, Missouri
3rd Revised Sheet 2
Replacing 2nd Revised Sheet 2

Non-Scannable Map

(Is viewable in the Data Center
200 Madison Street, 1st Floor
Jefferson City MO)

NO SUPPLEMENT TO THIS TARIFF WILL BE ISSUED EXCEPT FOR THE PURPOSE OF CANCELING THIS TARIFF.

13th REVISED SHEET 3 REPLACING 12th REVISED SHEET 3

P. S. C. Mo. No. 17 EXCHANGE AREA MAP

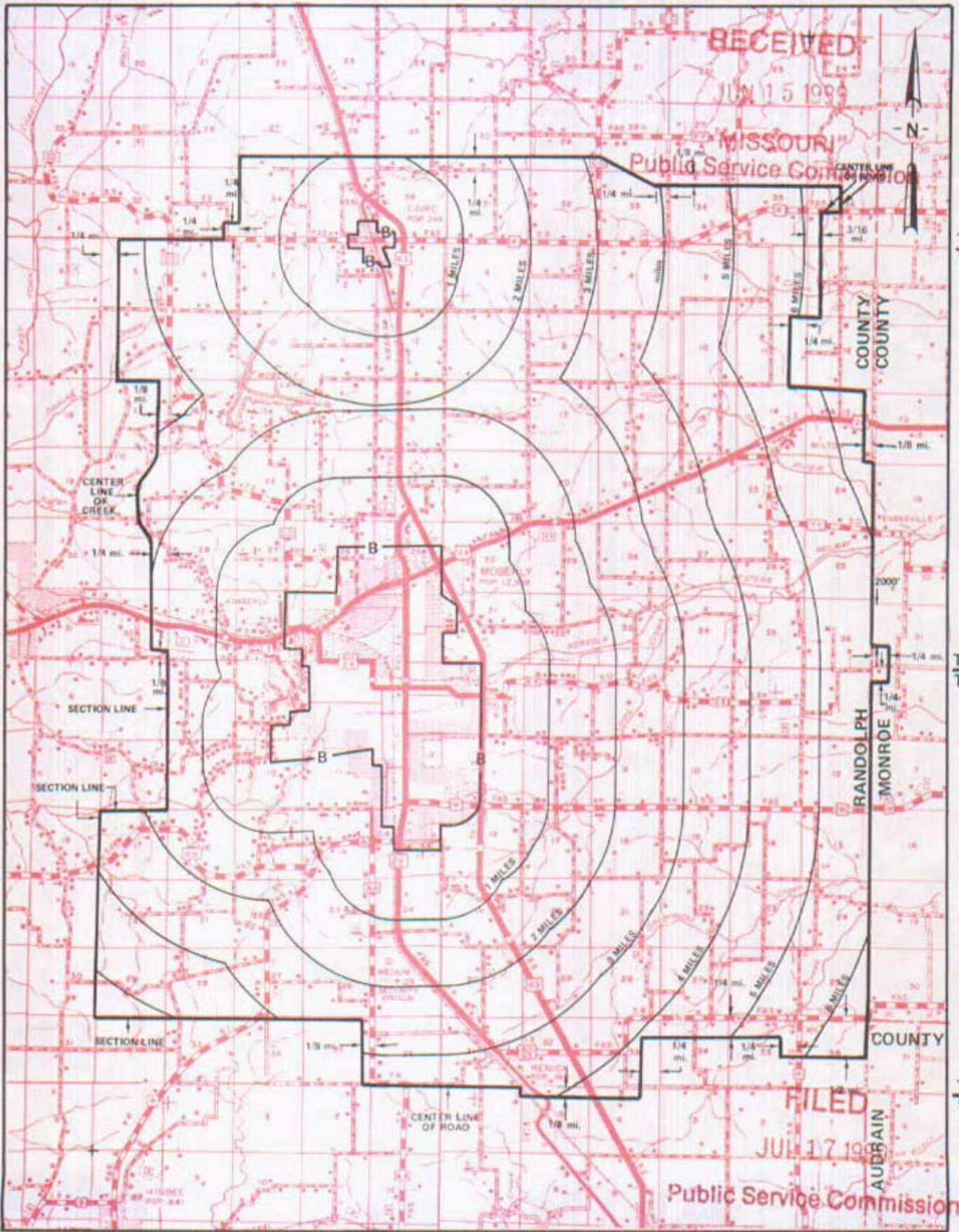

CANCELLED
June 29, 2007
TO-2002-185
Missouri Public
Service Commission

NO SUPPLEMENT TO THIS TARIFF WILL BE ISSUED EXCEPT FOR THE PURPOSE OF CANCELING THIS TARIFF.

P. S. C. Mo. No. 17

Monett, Missouri

6th REVISED SHEET 2
REPLACING 5th REVISED SHEET 2

BASE RATE AREA MAP

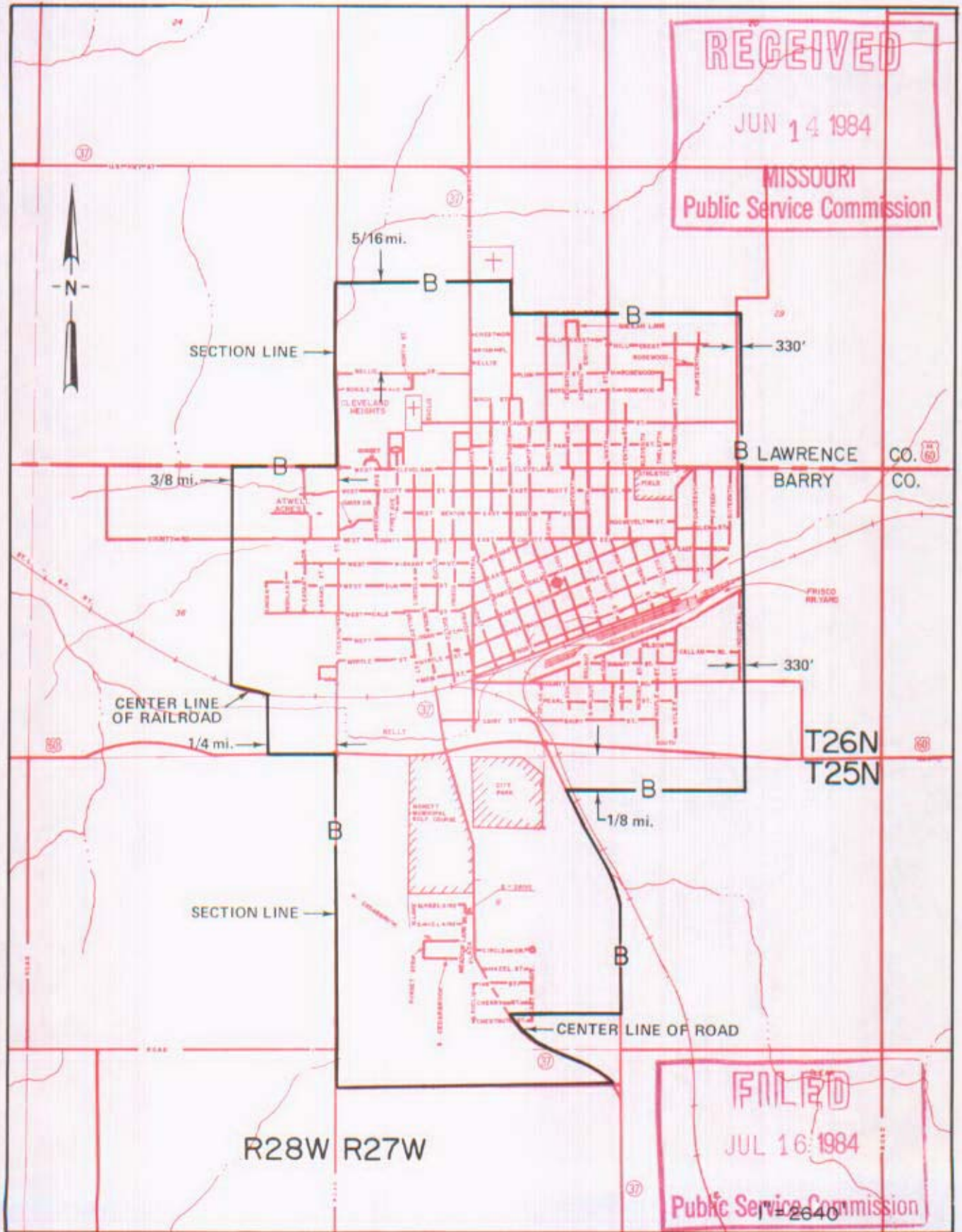

CANCELLED
June 29, 2007
TO-2002-185
Missouri Public
Service Commission

JUN 15 1984

By R.D. BARRON, President, Missouri Division
Southwestern Bell Telephone Company
St. Louis, Missouri

Effective: JUL 16 1984

Issued: _____

FILED
JUL 16 1984
Public Service Commission
1-2640

NO SUPPLEMENT TO THIS TARIFF WILL BE ISSUED EXCEPT FOR THE PURPOSE OF CANCELING THIS TARIFF.

P. S. C. Mo. No. 17

Monett, Missouri

Missouri Public

EXCHANGE AREA MAP

REPLACING

9th REVISED SHEET 3
10th REVISED SHEET 3
8th

REC'D NOV 12 2002

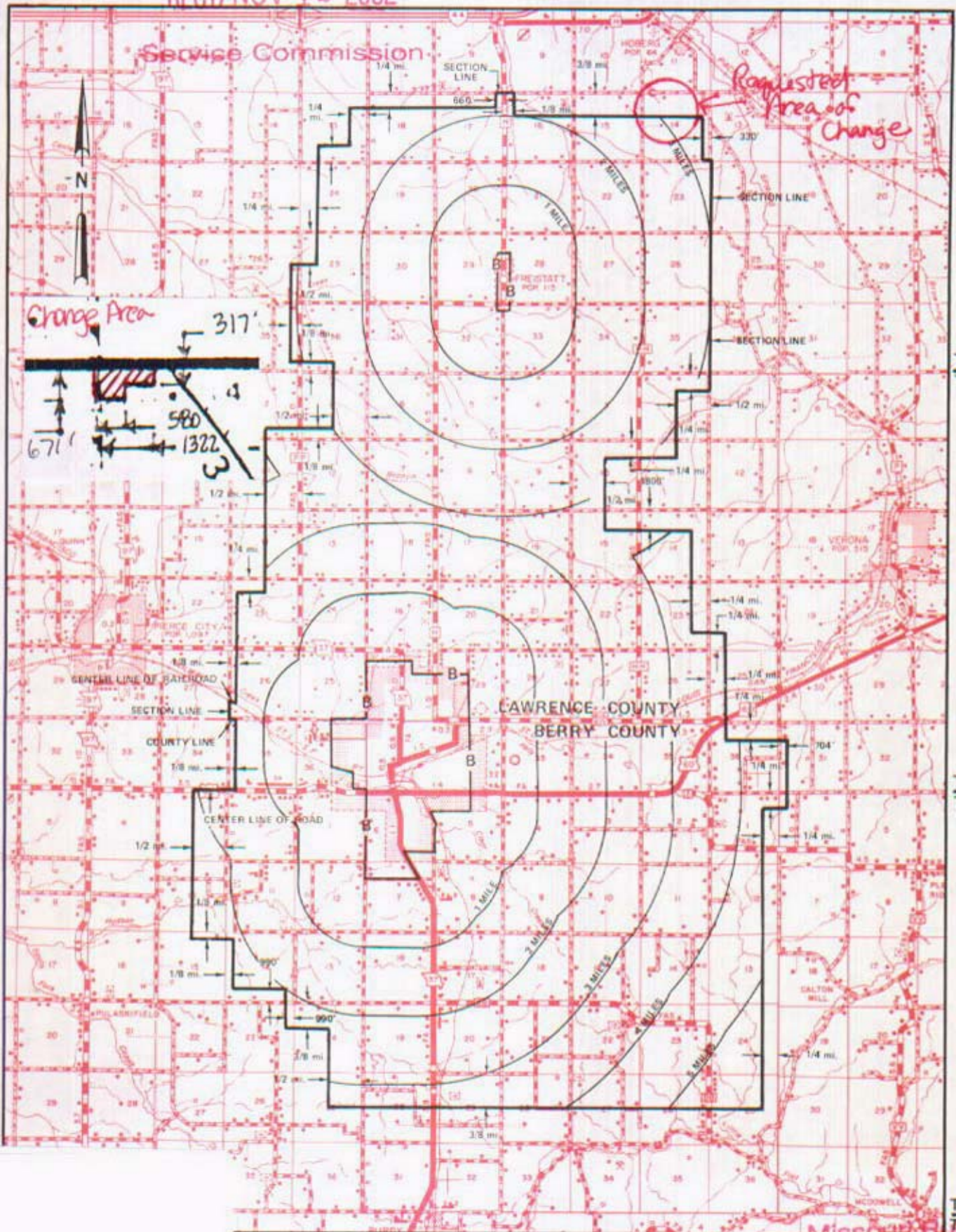

CANCELLED
June 29, 2007
TO-2002-185
Missouri Public
Service Commission

R28W | R27W

R27W | R26W

By Cindy Brinkley, President Missouri
Southwestern Bell Telephone, L.P., d/b/a Southwestern Bell Telephone Company
St. Louis, Missouri

Missouri Public Service Commission
FILED DEC 12 2002

NO SUPPLEMENT TO THIS TARIFF WILL BE ISSUED EXCEPT FOR THE PURPOSE OF CANCELING THIS TARIFF.

P. S. C. Mo. No. 17

Monett, Missouri

EXCHANGE AREA MAP

8th REVISED SHEET 3 REPLACING 7th REVISED SHEET 3

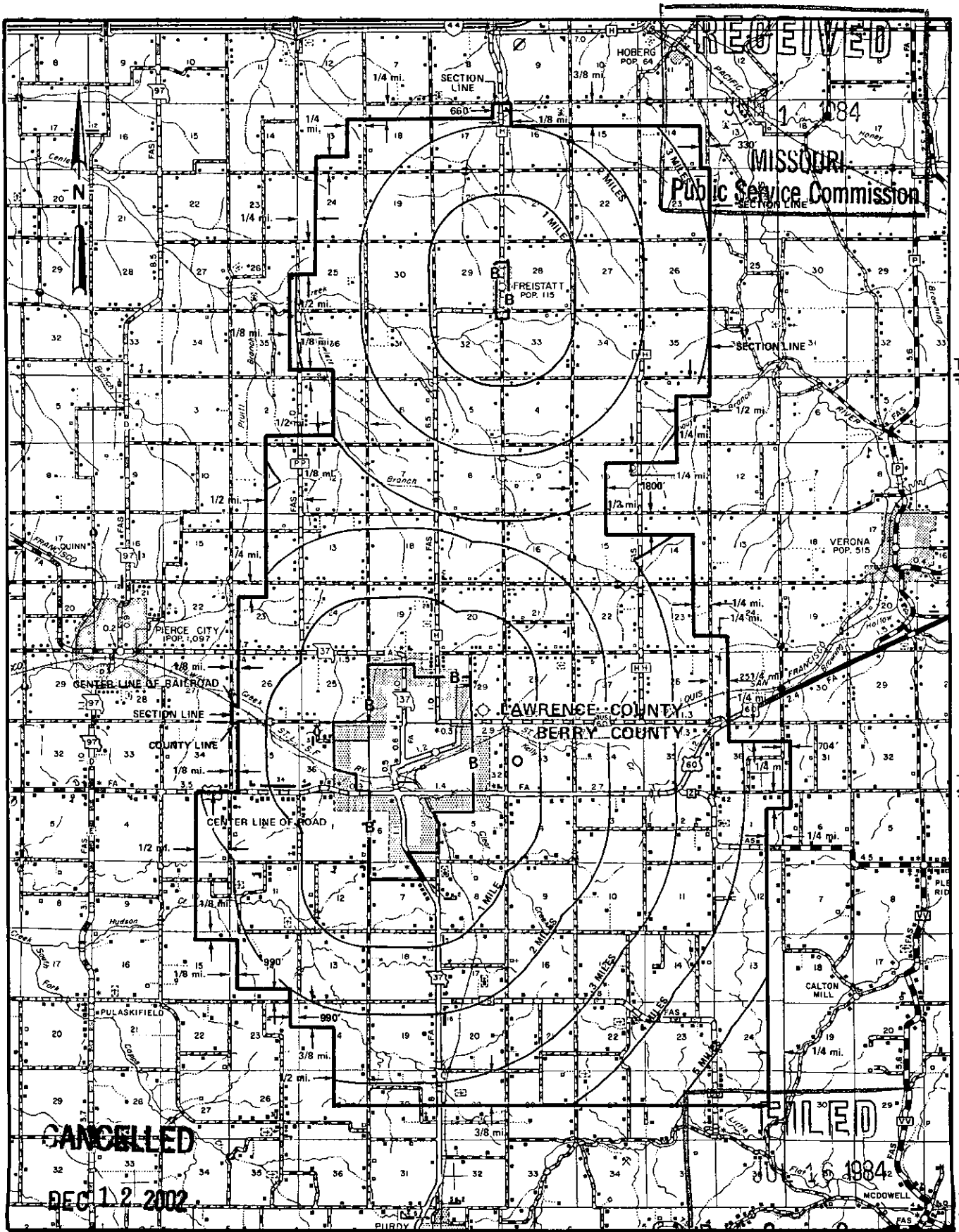

Public Service Commission MISSOURI

By R. D. BARRON, President, Missouri Division Southwestern Bell Telephone Company St. Louis, Missouri

Public Service Commission

Issued: JUNE 15, 1984

Effective: JULY 16, 1984

SBC PSC MO #17
Montgomery City, Missouri
1st Revised Sheet 2
Replacing Original Sheet 2

Non-Scannable
Map

(Is viewable in the Data Center
200 Madison Street, 1st Floor
Jefferson City MO)

CANCELLED
 June 29, 2007
 TO-2002-185
 Missouri Public
 Service Commission

NO SUPPLEMENT TO THIS TARIFF WILL
 BE ISSUED EXCEPT FOR THE PURPOSE OF
 CANCELING THIS TARIFF.

P. S. C. Mo. No. 17
 EXCHANGE AREA MAP

Missouri Public Service Commission
 RECD NOV 08 1999
 REPLACING REVISED SHEET 3
 6th

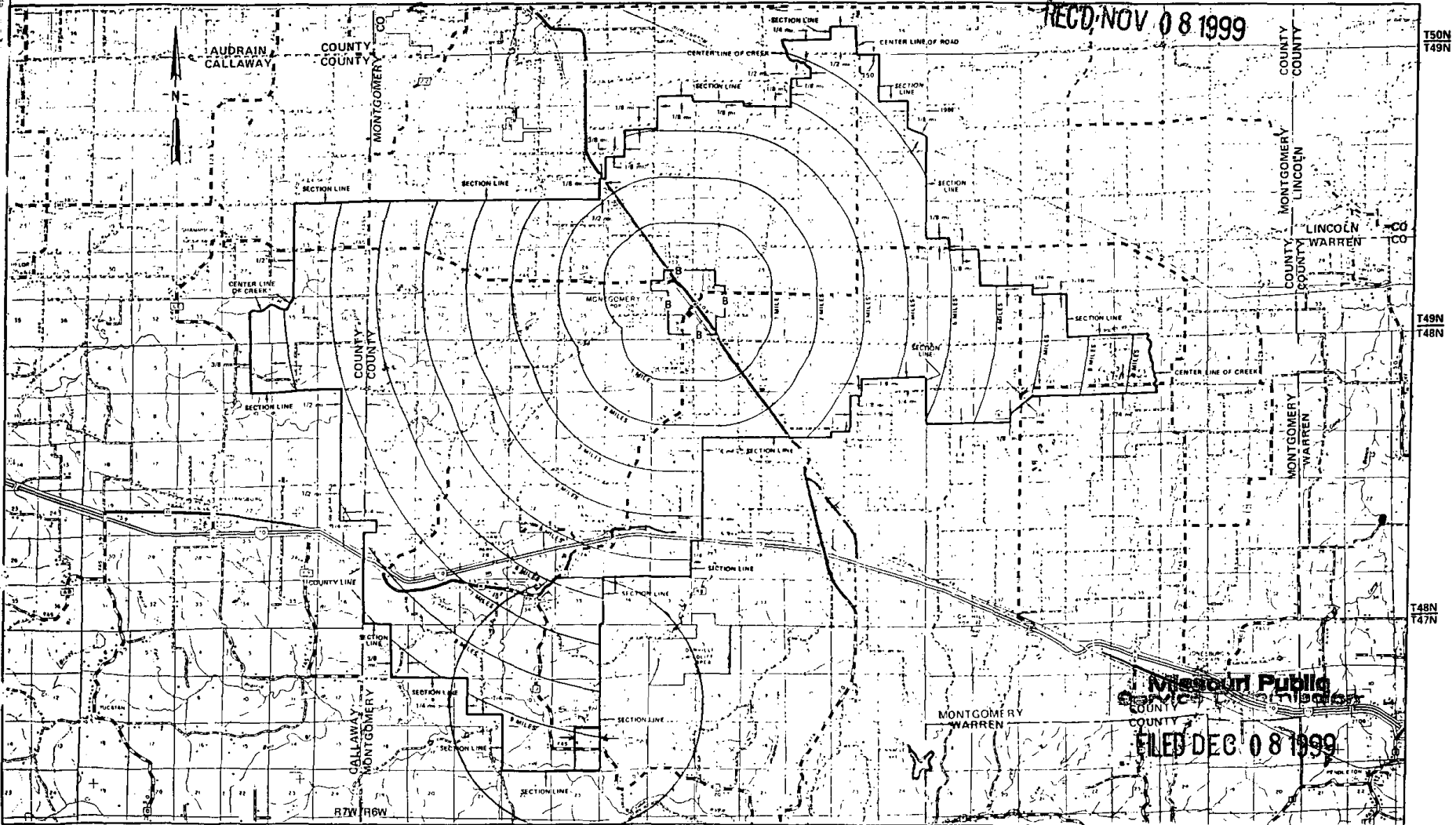

NO SUPPLEMENT TO THIS TARIFF WILL BE ISSUED EXCEPT FOR THE PURPOSE OF CANCELING THIS TARIFF.

P. S. C. Mo. No. 17
EXCHANGE AREA MAP

Missouri
Public Service Commission
6th REVISED SHEET 3
REPLACING 5th REVISED SHEET 3
FEB 14 1977

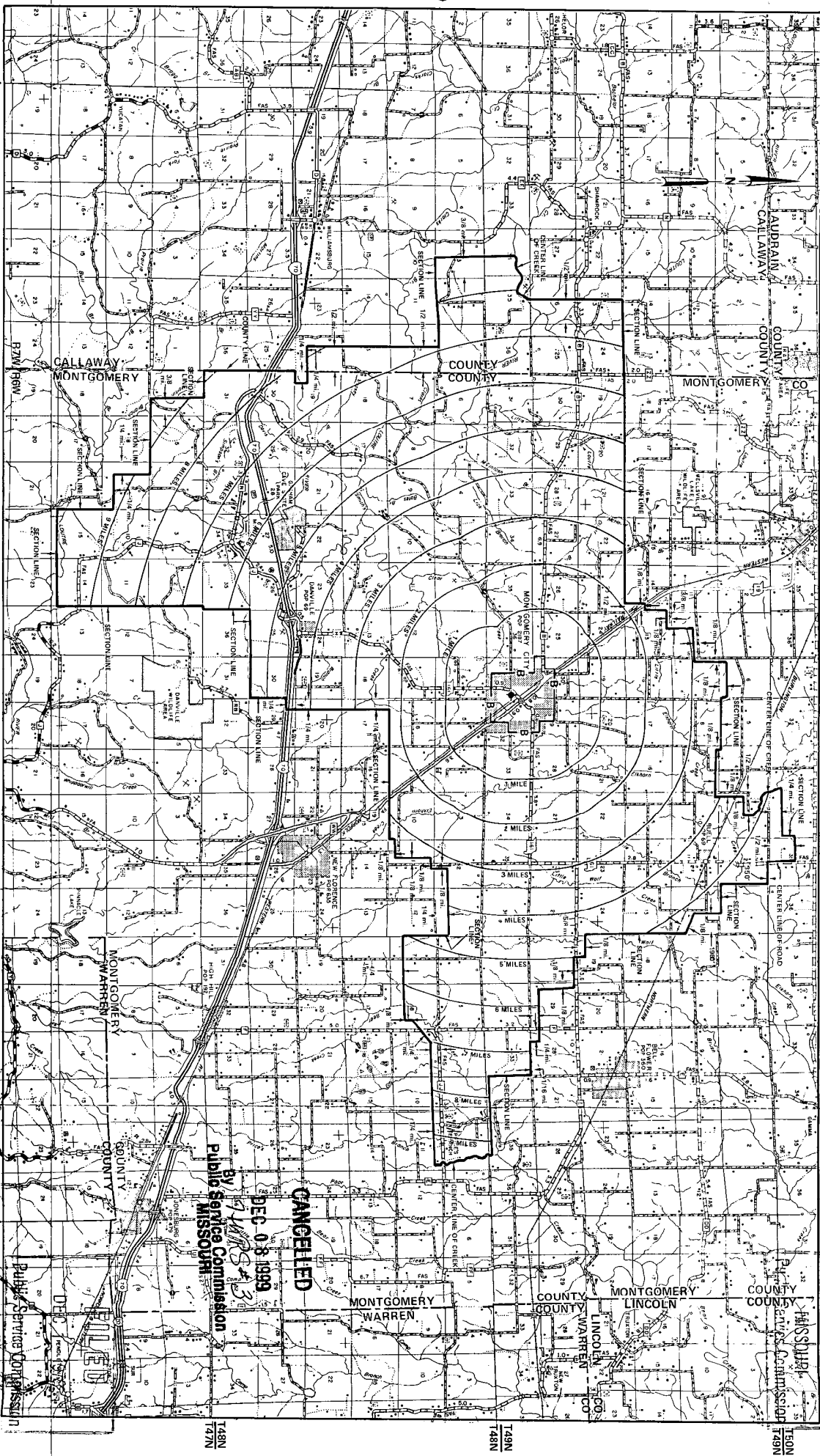

CANCELLED
DEC 08 1999
By Public Service Commission
Missouri

Issued: February 15, 1977

By R. R. SHOCKLEY, Vice President, Missouri
Southwestern Bell Telephone Company
St. Louis, Missouri

Effective: DEC 1 1978

NO SUPPLEMENT TO THIS TARIFF WILL BE ISSUED EXCEPT FOR THE PURPOSE OF CANCELING THIS TARIFF.

P. S. C. Mo. No. 17

Morehouse, Missouri

APR 14 1977

EXCHANGE AREA MAP

4th REVISED SHEET 3 REPLACING 3rd REVISED SHEET 3

CANCELLED
June 29, 2007
TO-2002-185
Missouri Public
Service Commission

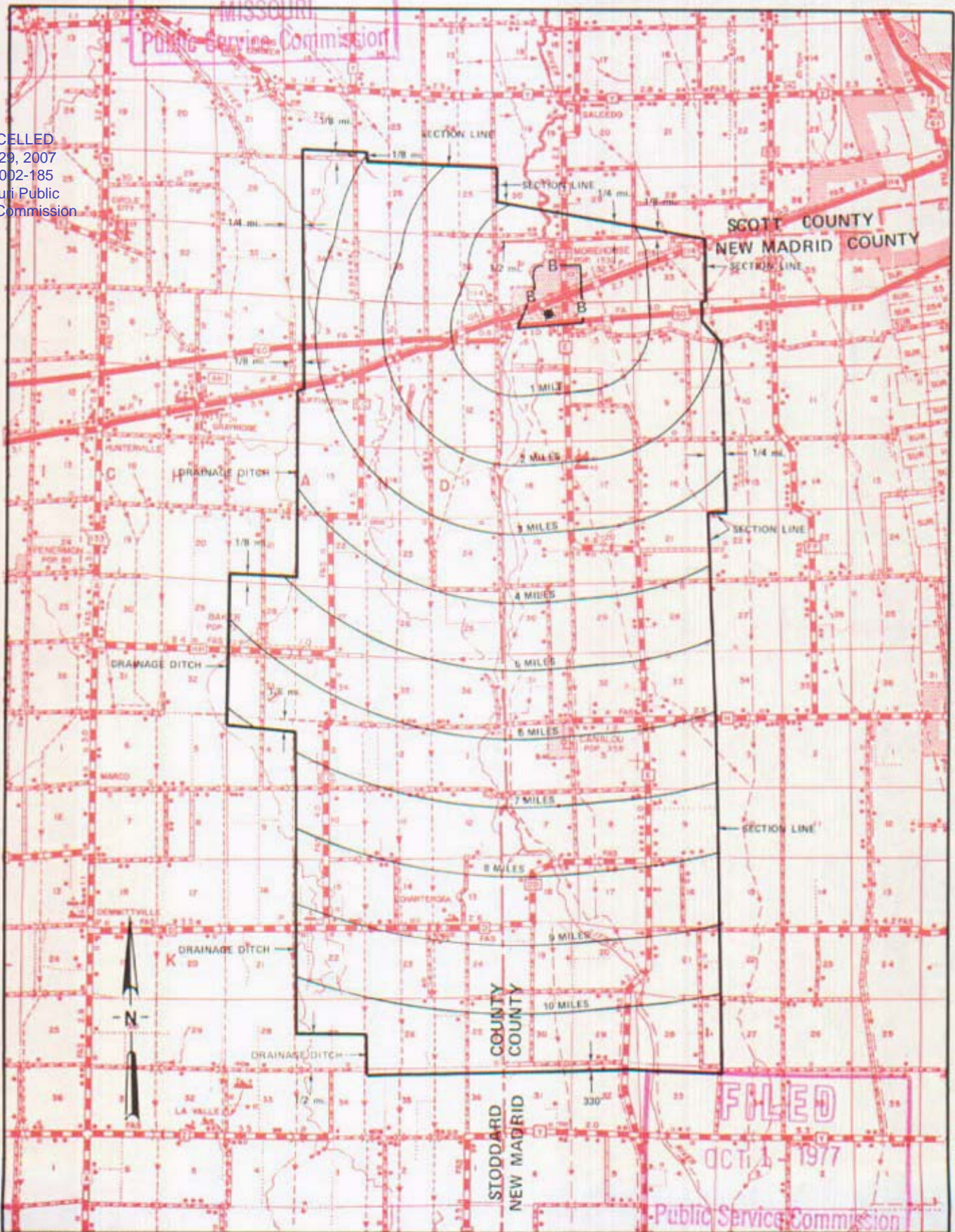

T26N
T25N

T25N
T24N

T24N
T23N

R11E | R12E

R12E | R13E

R13E

By R. R. SHOCKLEY, Vice President, Missouri
Southwestern Bell Telephone Company

FILED
OCT 1 - 1977