

Emerald Pointe Utility Company

For: Missouri Service Areas

RULES GOVERNING
RENDERING OF SEWER SERVICE

INDEX

Sheet No.

- 1..... Index
- 2..... Map of Service Area – Case No. WA-96-96
- 2.1..... Map of Service Area – Branson Canyon
- 2.2..... Map of Service Area – Case No. SA-2012-0362 +
- 2.3..... Map of Service Area – Case No. SA-2012-0362 +
- 3..... Legal Description of Service Area - Case No. WA-96-96
- 3.1..... Legal Description of Service Area – Branson Canyon
- 3.2..... Legal Description of Service Area – Case No. SA-2012-0362 +
- 4..... Schedule of Rates
- 5..... Schedule of Service Charges

Sheet
No.

Rule
Number

Rule
Subject

- 6..... 1. Definitions
- 9..... 2. General Rules and Regulations
- 10..... 3. Limited Authority of Company Employees
- 11..... 4. Applications for Sewer Service
- 13..... 5. Inside Piping and Customer Service Sewer
- 16..... 6. Improper or Excessive Use
- 18..... 7. Discontinuance of Service by Company
- 20..... 8. Interruptions in Service
- 21..... 9. Bills for Service
- 23..... 10. Special Contract for Excess Capacity
- 24..... 11. Extension of Collecting Sewers

* - indicates new rate

+ - indicates change

DATE OF ISSUE July 19, 2012
month day year

DATE EFFECTIVE August 18, 2012
month day year

ISSUED BY Gary Snadon, President Emerald Pointe Utility Company
118 State Drive, Hollister, Missouri 65672

Name of Utility: Emerald Pointe Utility Company
Service Area: Missouri Service Area

Rules Governing Rendering of
Sewer Service

INDEX

Sheet No.

1	Index	
2	Map of Service Area – Case No. WA-96-96	*
2.1	Map of Service Area – Branson Canyon	*
3	Legal Description of Service Area – Case No. WA-96-96	*
3.1	Legal Description of Service Area – Branson Canyon	*
4	Schedule of Rates	
5	Schedule of Service Charges	

Rule No.

6	1. Definitions	
9	2. General Rules and Regulations	
10	3. Limited Authority of Company Employees	
11	4. Applications for Sewer Service	
13	5. Inside Piping and Customer Service Sewer	
16	6. Improper or Excessive Use	
18	7. Discontinuance of Service by Company	
20	8. Interruptions in Service	
21	9. Bills for Service	
23	10. Special Contract for Excess Capacity	
24	11. Extension of Collecting Sewers	

* Indicates new rate or text

+ Indicates change

FILED
MO PSC
WA-2005-0306

DATE OF ISSUE 11/16/05
month day year

DATE EFFECTIVE 12/16/05
month day year

ISSUED BY: Gary W. Shadon President Branson, MO
Name of officer title address

CANCELLED
August 18, 2012
Missouri Public
Service Commission
SA-2012-0362; YS-2013-0047

Name of Utility: Emerald Pointe Utility Company

Service Area: Missouri Service Area

RECEIVED

Rules Governing Rendering of
Sewer Service

MAY 10 1996

MISSOURI
Public Service Commission

INDEX

Sheet No.

- 1 Index
- 2 Map of Service Area
- 3 Legal Description of Service Area
- 4 Schedule of Rates
- 5 Schedule of Service Charges

Rule No.

- 6 1. Definitions
- 9 2. General Rules and Regulations
- 10 3. Limited Authority of Company Employees
- 11 4. Applications for Sewer Service
- 13 5. Inside Piping and Customer Service Sewer
- 16 6. Improper or Excessive Use
- 18 7. Discontinuance of Service by Company
- 20 8. Interruptions in Service
- 21 9. Bills for Service
- 23 10. Special Contract for Excess Capacity
- 24 11. Extension of Collecting Sewers

CANCELLED

DEC 16 2005

FILED

MAY 31 1996

96 - 96

MO. PUBLIC SERVICE COMM

- * Indicates new rate or text
- + Indicates change

by *1st RS 1*
Public Service Commission
MISSOURI

DATE OF ISSUE MAY 10 1996
Month Day Year

DATE EFFECTIVE MAY 31 1996
Month Day Year

ISSUED BY Gary W. Snadon President Branson, MO
name of officer title address

Name of Utility: Emerald Pointe Utility Company

Service Area: Missouri Service Area

RECEIVED

MAY 10 1996

Rules Governing Rendering of Sewer Service

MISSOURI Public Service Commission

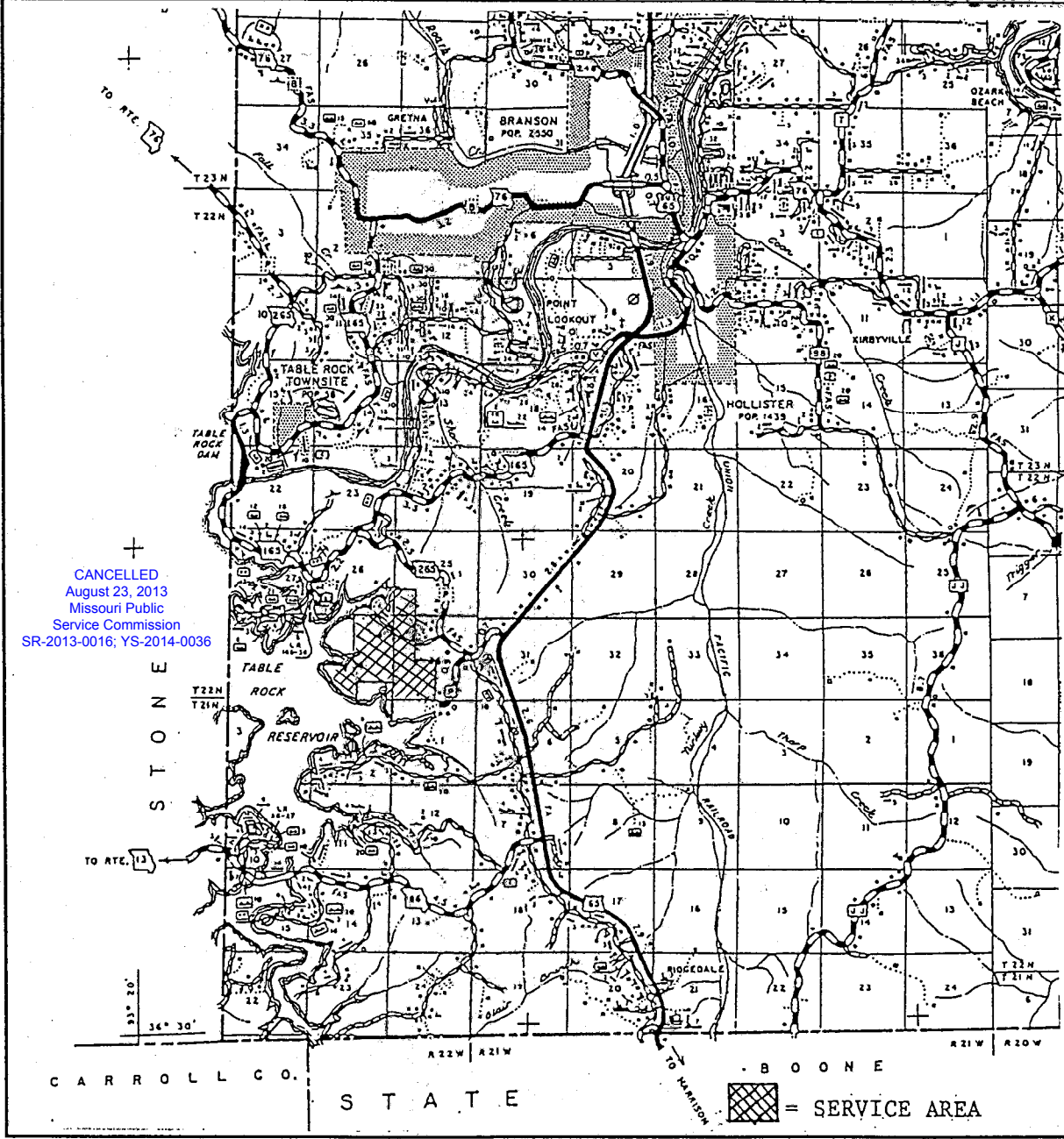

CANCELLED
August 23, 2013
Missouri Public
Service Commission
SR-2013-0016; YS-2014-0036

MAY 31 1996

DATE OF ISSUE MAY 10 1996
Month Day Year

DATE EFFECTIVE
Month Day Year

ISSUED BY Gary W. Snadon
name of officer

President
title

Branson, MO
address

MAY 31 1996
96-56

MO. PUBLIC SERVICE COMM

Name of Utility: Emerald Pointe Utility Company
Service Area: Missouri Service Area

Rules Governing Rendering of
Sewer Service
Map of Service Area – Branson Canyon

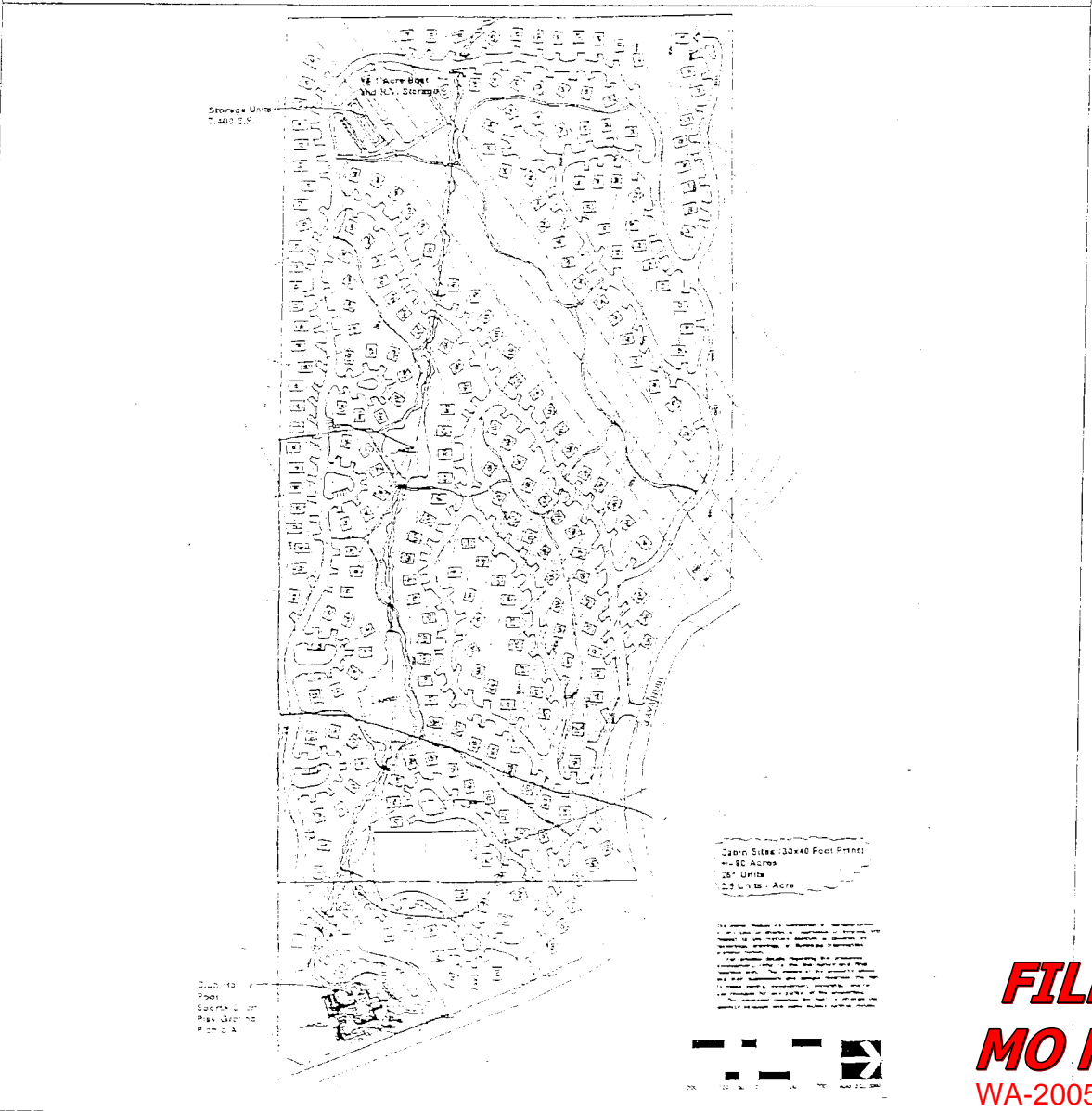

FILED
MO PSC
WA-2005-0306

DATE OF ISSUE 11/16/05
month day year

DATE EFFECTIVE 12/16/05
month day year

ISSUED BY: Gar. W. Snaddon President Branson, MO
Name of officer title address

CANCELLED
August 23, 2013
Missouri Public
Service Commission
SR-2013-0016; YS-2014-0036

Emerald Pointe Utility Company

For: Missouri Service Areas

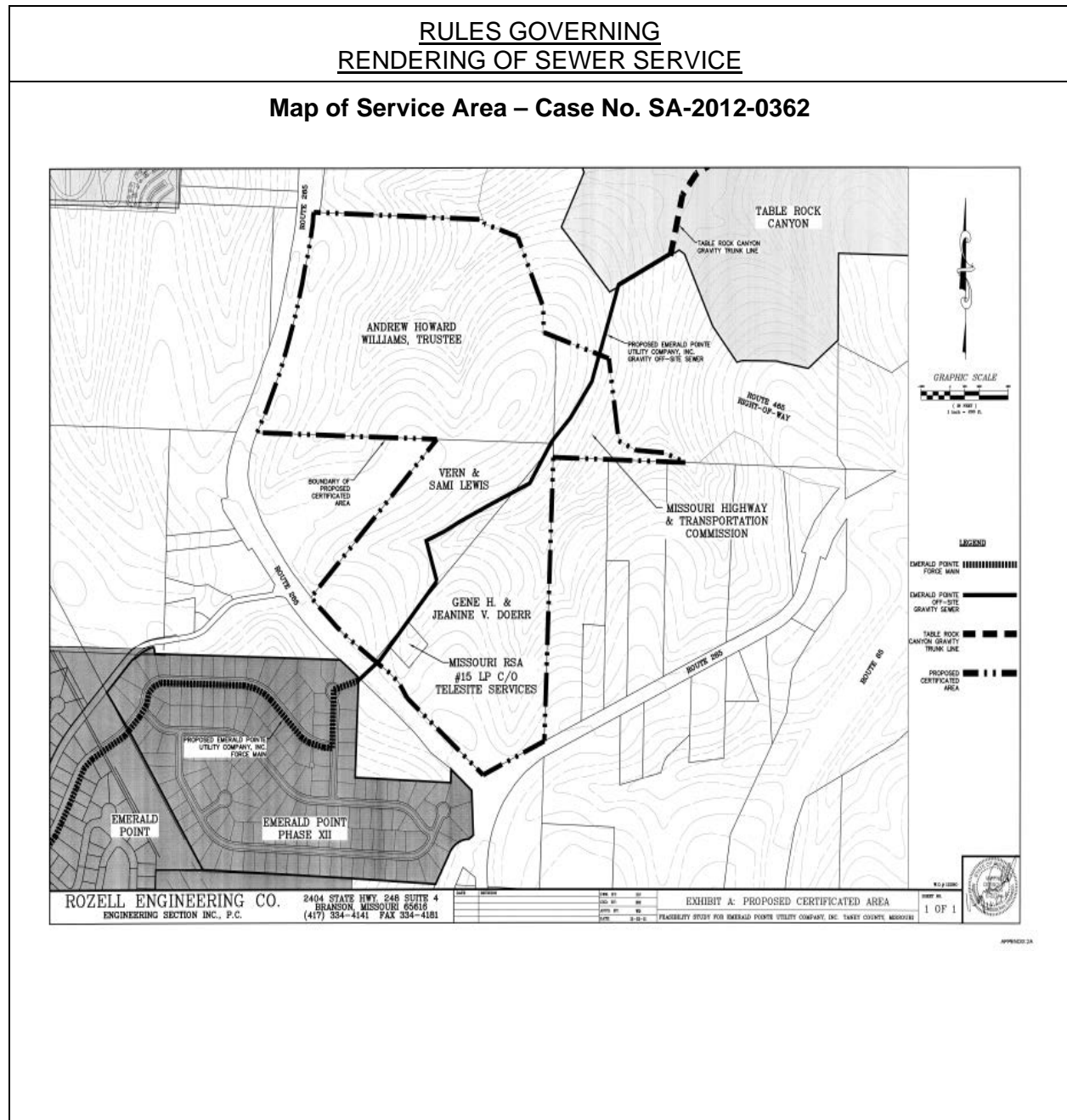

DATE OF ISSUE July 19, 2012
month day year

DATE EFFECTIVE August 18, 2012
month day year

ISSUED BY Gary Snadon, President Emerald Pointe Utility Company
118 State Drive, Hollister, Missouri 65672

CANCELLED
August 23, 2013
Missouri Public
Service Commission
SR-2013-0016; YS-2014-0036

Filed
Missouri Public
Service Commission
SA-2012-0362; YS-2013-0047

Name of Utility: Emerald Pointe Utility Company

Service Area: Missouri Service Area

RECEIVED

Rules Governing Rendering of Sewer Service

MAY 10 1996

LEGAL DESCRIPTION OF SERVICE AREA

MISSOURI Public Service Commission

Beginning at the Southeast Corner of the Southeast Quarter of the Southwest Quarter of Section 36, Township 22 North, Range 22 West, said point being a Missouri Department of Natural Resources Monument; thence N 88°1'4'49" W along the South line of said Section 36, 1976.49 feet; thence leaving said South line of Section 36, N 00°54'57" E, 330.06 feet; thence N 88°1'1'55" W, 660.25 feet to the West line of said Section 36; thence along said West line of Section 36, N 01°10'04" E, 1035.36 feet to a stone, said stone being the Northwest Corner of the Southwest Quarter of the Southwest Quarter of said Section 36; thence N 89°48'37" W, 2622.33 feet to the Northeast Corner of the Southeast Quarter of the Southwest Quarter of Section 35, Township 22 North, Range 22 West; thence along the North line of said Southeast Quarter of the Southwest Quarter of Section 35, N 88°17'38" W, 640.00 feet; thence leaving said line; S 01°57'46" W, 341.35 feet; thence S 55°02'46" E, 315.77 feet, thence S 01°05'46" W, 300.00 feet to a point on the Corp of Engineers take line for Table Rock Lake; thence along said take line N 55°12'46" W, 335.10 feet to Corp of Engineers Monument C 336-4; thence continuing along said take line N 43°05'01" W, 902.48 feet to Corp of Engineers Monument C 336-5/C 334-1; thence continuing along said take line N 24°03'11" W, 388.67 feet to Corp of Engineers Monument C 334-2; thence continuing along said take line N 16°55'32" W, 542.08 feet to Corp of Engineers Monument C 334-3; thence continuing along said take line N 01°01'39" E, 338.01 feet to Corp of Engineers Monument C 334-4; thence continuing along said take line S 60°36'45" E, 376.92 feet to Corp of Engineers Monument C 334-5/C 335-1; thence continuing along said take line S 87°05'13" E, 329.40 feet to Corp of Engineers Monument C 335-2; thence continuing along said take line S 60°49'41" E, 744.75 feet to Corp of Engineers Monument C 335-3; thence continuing along said take line N 27°02'55" E, 751.65 feet to Corp of Engineers Monument C 335-4/C 323-1; thence continuing along said take line N 65°00'41" E, 732.26 feet to Corp of Engineers Monument C 323-2; thence continuing along said take line N 27°35'15" E, 336.47 feet to Corp of Engineers Monument C 323-3; thence continuing along said take line N 87°04'58" W, 832.12 feet to Corp of Engineers Monument C 323-4/C 324-1-1, said monument being on the West line of the Northeast Quarter of said Section 35; thence along said West line of the Northeast Quarter of said Section 35, N 00°1'3'44" E, 675.77 feet to a stone, said stone being the Southwest Corner of the Northwest Quarter of the Northeast Quarter of Section 35; thence continuing said West line of the Northeast Quarter of Section 35, N 03°21'49" E, 1274.58 feet to Corp of Engineers Monument G 324-2-4/C 322-1, said monument being the Northwest Corner of said Northeast Quarter of Section 35; thence along the North line of said Section 35, S 88°00'2'47" E, 2646.95 feet to a stone, said stone being the Northeast Corner of said Section 35; thence N 01°43'53" E along the West line of Section 25, Township 22 North, Range 22 West, 1318.98 feet to the Northwest Corner of the Southwest Quarter of the Southwest Quarter of said Section 25; thence along the North line of said Southwest Quarter of the Southwest Quarter of Section 25, N 87°56'54" E, 1319.63 feet to the Northeast Corner of said Southwest Quarter of the Southwest Quarter of Section 25; thence S 01°35'33" W, along the East line of said Southwest Quarter of the Southwest Quarter of Section 25, 1314.44 feet to the section line; thence S 01°51'49" W along the West line of the Northeast Quarter of the Northwest Quarter of Section 36; thence S 87°04'2'10" E along the North line of the Southeast Quarter of the Northwest Quarter of said Section 36, 1326.37 feet to the Northeast Corner of said Southeast Quarter of the Northwest Quarter of Section 36; thence S 01°05'11" W along the East line of West half of said Section 36, 3935.82 feet to the point of beginning.

CANCELLED August 23, 2013 Missouri Public Service Commission

SR-2013-0016; YS-2014-0036

DATE OF ISSUE MAY 10 1996 Month Day Year

DATE EFFECTIVE MAY 31 1996 Month Day Year

ISSUED BY Gary W. Snadon name of officer

President title

Branson, MO address

MAY 31 1996 96-96

MO. PUBLIC SERVICE COMM

Name of Utility: Emerald Pointe Utility Company
 Service Area: Missouri Service Area

Rules Governing Rendering of
 Sewer Service
 Legal Description of Service Area – Branson Canyon

LEGAL DESCRIPTION OF SERVICE AREA

A tract of land situated in the a part of the NW $\frac{1}{4}$ of the NE $\frac{1}{4}$ of Section 1, Township 21 North, Range 22 West, and part of the W $\frac{1}{2}$ of the SE $\frac{1}{4}$ of Section 36, Township 22 North, Range 22 West, Taney County, Missouri, Being more particularly described as follows:

Beginning at an existing aluminum monument marking the Southwest corner of the W $\frac{1}{2}$ of the SE $\frac{1}{4}$ of Section 36; Thence North $01^{\circ}38'25''$ East, a distance of 2670.34 feet, to an existing stone marking the Northwest corner of the W $\frac{1}{2}$ of the SE $\frac{1}{4}$ of Section 36; Thence South $86^{\circ}59'15''$ East, a distance of 1329.13 feet, to an existing $\frac{1}{2}$ " iron pin marking the Northeast corner of the NW $\frac{1}{4}$ of the SE $\frac{1}{4}$ of Section 36; Thence South $01^{\circ}49'05''$ West, a distance of 1321.57 feet, to an existing stone marking the Northeast corner of the SW $\frac{1}{4}$ of the SE $\frac{1}{4}$ of Section 36; Thence South $01^{\circ}48'16''$ West, along the East line of the SW $\frac{1}{4}$ of the SE $\frac{1}{4}$ of Section 36, a distance of 425.69 feet to a point on the Northerly right-of-way line M.S.H.D. Route "P"; Along the Northerly and Westerly right-of-way line of M.S.H.D. Rout "P" as follows: Thence South $59^{\circ}39'29''$ West, a distance of 34.06 feet; Thence Southwesterly along a 12.8072 degree curve to the left, 321.43 feet (said curve having a radius of 447.37 feet); Thence South $18^{\circ}23'28''$ West, a distance of 228.00 feet; Thence Southerly along a 9.3468 degree curve to the left, 273.55 feet (said curve having a radius of 613.00 feet); Thence South $07^{\circ}10'37''$ East, a distance of 142.74 feet, to a point on the South line of the SW $\frac{1}{4}$ of the SE $\frac{1}{4}$ of Section 36; Thence continuing South $07^{\circ}10'37''$ East, a distance of 24.26 feet; Thence Southerly along a 27.4038 degree curve to the right, 284.63 feet (said curve having a radius of 209.08 feet); Thence South $70^{\circ}49'19''$ West, a distance of 570.30 feet; Thence South $56^{\circ}26'26''$ West, a distance of 80.52 feet' Thence South $70^{\circ}49'19''$ West, a distance of 275.37 feet to a point on the Table Rock Lake Government Fee Taking Line; Thence North $24^{\circ}43'55''$ West, leaving the North right-of-way line of the road and along the Government Fee Taking Line, a distance of 113.01 feet, to a point on the West line of the NW $\frac{1}{4}$ of the NE $\frac{1}{4}$ of Section 1; Thence North $00^{\circ}56'31''$ East, along the West line of the NW $\frac{1}{4}$ of the NE $\frac{1}{4}$ of Section 1, a distance of 504.17 feet, to the Point of Beginning;

DATE OF ISSUE 11/16/05
 month day year

DATE EFFECTIVE 12/16/05
 month day year

ISSUED BY: Gary W. Snadon President Branson, MO
 Name of officer title address

FILED
MO PSC
 WA-2005-0306

Emerald Pointe Utility Company

For: Missouri Service Areas

RULES GOVERNING
RENDERING OF SEWER SERVICE

Legal Description of Service Area – SA-2012-0362

All that part of the South Half (S1/2) lot 2 of the Southwest Quarter (SW1/4) of Section 30, Township 22 North, Range 21 West, Taney County, Missouri, which lies southerly of the southerly right-of-way line of Route 465 (as shown on the plan sheet for Missouri Department of Transportation Job No. J8P0623), containing 6.028 acres, more or less, lying in the southwesterly corner of said S1/2 Lot 2 SW1/4 of said Section 30.

Together with, all of the South Half (S1/2) of the Southeast Quarter (SE1/4) lying East of Highway No. 265 and West of westerly right-of-way line of Route 465 (as shown on the plan sheet for Missouri Department of Transportation Job No. J8P0623), all in Section 25, Township 22 North, Range 22 West, Taney County, Missouri.

And Together with, all of the East Half (E1/2) of the Northeast Quarter (NE1/4) and the Northwest Quarter (NW1/4) of the Northeast Quarter (NE1/4) of Section 36, Township 22 North, Range 22 West, Taney County, Missouri, lying North and East of Highway No. 265; Except that parcel described in Warranty Deed recorded in Book 415, at Pages 9660 through 9662 of the Recorder's Office of Taney County, Missouri.

Also:

A twenty foot (20.0') wide strip of ground lying over and across a portion of the Northeast Quarter (NE1/4) of the Northeast Quarter (NE1/4) and the South Half (S1/2) of the Northeast Quarter (NE1/4) of Section 36, Township 22 North, Range 22 West of the fifth principal meridian, Taney County, Missouri. The limits of the easement shall extended to, or truncate at the right-of-way limits of M.S.H.D. Route 265, All that part of the Grantor's land lying 10.00 feet on each side of the centerline described as follows:

Commencing at an existing 1 1/2" iron pipe marking the Southwest corner of Section 30, T22 North, Range 21 West; Thence North 00°08'56" East a distance of 55.17 feet to an aluminum monument marking the Northeast corner of the NE1/4 of the NE1/4 of Section 36; Thence South 47°35'25" West, along the North line of a parcel of land described in Book 310, at Page 2976, of the Recorder's Office of Taney County, a distance of 1784.55

DATE OF ISSUE July 19, 2012
month day year

DATE EFFECTIVE August 18, 2012
month day year

ISSUED BY Gary Snadon, President Emerald Pointe Utility Company

CANCELLED
August 23, 2013
Missouri Public
Service Commission
SR-2013-0016; YS-2014-0036

118 State Drive, Hollister, Missouri 65672
Filed
Missouri Public
Service Commission
SA-2012-0362; YS-2013-0047

Emerald Pointe Utility Company

For: Missouri Service Areas

RULES GOVERNING
RENDERING OF SEWER SERVICE

Legal Description of Service Area – SA-2012-0362, continued

feet to a point on the Northerly right-of-way line of M.S.H.D. Route 265; Thence South 49°00'32" East, along the Northerly right-of-way line of M.S.H.D. Route 265, a distance of 42.93 feet to the Point of Beginning; Thence South 45°06'23" West a distance of 141.83 feet to the South right-of-way line of M.S.H.D. Route 265 for a Point of Terminus, Containing 2837 square feet of land, more or less.

And Also:

A twenty foot (20.0') wide strip of ground lying over and across a portion of the South Half (S1/2) of Lot 2 of the fractional Southwest Quarter (SW1/4) of Section 30, Township 22 North, Range 21 West of the fifth principal meridian, Taney County, Missouri. The limits of the easement shall extended to, or truncate at the right-of-way line of M.S.H.D. Route 465, All that part of the Grantor's land lying 10.00 feet on each side of the centerline described as follows:

Commencing at an existing 11/2" iron pipe marking the Southwest corner of Section 30, Township 22 North, Range 21 West; Thence North 00°08'56" East a distance of 55.17 feet to an aluminum monument marking the Northeast corner of the NE1/4 of the NE1/4 of Section 36, Township 22 North, Range 22 West; Thence North 01°52'42" East, along the West line of said Section 30, a distance of 646.64 feet to a point on the Southerly right-of-way line of M.S.H.D. Route 465; Thence South 70°46'07" East, along the Southerly right-of-way line of M.S.H.D. Route 465, a distance of 273.80 feet to the Point of Beginning; Thence North 17°47'48" East a distance of 423.60 feet to a point on the Northerly right-of-way line of M.S.H.D. Route 465 for the Point of Terminus. Containing 8,473 square feet of land, more or less.

DATE OF ISSUE July 19, 2012
month day year

DATE EFFECTIVE August 18, 2012
month day year

ISSUED BY Gary Snadon, President Emerald Pointe Utility Company
118 State Drive, Hollister, Missouri 65672

Emerald Point Utility Company For **Missouri Service Area**

Name of Issuing Company

Community, Town or City

RECEIVED

RULES GOVERNING

RENDERING OF SEWER SERVICE

+ MAR 23 2000

SCHEDULE OF SEWER RATES

**MISSOURI
Public Service Commission**

Availability: *

Available to any customer located in the Company's certificated service territory.

Sewer Service Rates:

Monthly Customer Charge (served by a 5/8" water meter)	\$13.63	per Month	+
Monthly Customer Charge (served by a 1" water meter)	\$34.08	per Month	+
Monthly Customer Charge (served by a 2" water meter)	\$109.06	per Month	+

Monthly Minimum Bill: * Equals the applicable Monthly Customer Charge
The minimum monthly billing shall be billed customers based on this Charge.

Taxes: *

Any applicable Federal, State or local taxes computed on a billing basis shall be added as separate items in rendering each bill.

Late Payment Charge: *

Billings will be made and distributed at monthly intervals. Bills will be rendered net, bearing the last date on which payment will then be considered delinquent. The period after which the payment is considered delinquent is 21 days after rendition of the bill. A charge of \$3.00 or two percent (2%) per month times the unpaid balance, whichever is greater, will be added to delinquent amounts.

Bad Check Charge: *

A bad check charge of \$15 per check will be paid on all checks returned from the bank for insufficient funds.

FILED

00 - 595
MAY 10 2000

* Indicates new rate or text

+ Indicates change

**MISSOURI
Public Service Commission**

Date of Issue 3/23/00

Date Effective 5/10/00

Issued By: Gary W. Snadon, President

111 East Main, Branson, MO 65616

Name of Officer

Title

Address

Name of Utility: Emerald Pointe Utility Company

Service Area: Missouri Service Area

RECEIVED

Rules Governing Rendering of Sewer Service

MAY 10 1996

MISSOURI Public Service Commission

Schedule of Rates

Monthly rates:

First 2,000 gallons water use per month: \$16.59

Commodity charge, per 1,000 gallons water use: \$5.83

The maximum sewer bill for a residential customer will be for monthly water use representing 8,000 gallons.

CANCELLED

MAY 10 2000

By 1st R 54 Public Service Commission MISSOURI

FILE

* Indicates new rate or text

+ Indicates change

MAY 31 1996

96-96

DATE OF ISSUE MAY 10 1996 Month Day Year

DATE EFFECTIVE MAY 31 1996 Month Day Year

ISSUED BY Gary W. Snadon President Branson, MO name of officer title address

Name of Utility: Emerald Pointe Utility Company

Service Area: Missouri Service Area

RECEIVED

Rules Governing Rendering of Sewer Service

DEC 09 1997

MISSOURI
Public Service Commission

Schedule of Service Charges

New service connection to main line \$ 150 - *Actual Cost*

After normal business hours service call (per hour) \$ 40 - *Actual*

Customers utilizing grinder pumps obtained from the company shall pay for pump units in full before service is provided.

If a water meter is installed the minimum monthly sewer service fee is required.

CANCELLED
August 23, 2013
Missouri Public
Service Commission
SR-2013-0016; YS-2014-0036

- * Indicates new rate or text
- + Indicates change

FILED
JAN 16 1998
MO. PUBLIC SERVICE COMM

DATE OF ISSUE December 9, 1997
Month Day Year

DATE EFFECTIVE January 16, 1998
Month Day Year

ISSUED BY Gary W. Snadon President 111 E. Main Branson, MO
name of officer title address

Name of Utility: Emerald Pointe Utility Company

Service Area: Missouri Service Area

RECEIVED

Rules Governing Rendering of Sewer Service		MAY 10 1996
<u>Schedule of Service Charges</u>		MISSOURI Public Service Commission
Connection charge:	Actual cost of material and labor for the service connection.	
CANCELLED		
JAN 16 1998 By <u>GRS#5</u> Public Service Commission MISSOURI		
* Indicates new rate or text + Indicates change	MAY 31 1996 96-96	

DATE OF ISSUE MAY 10 1996
Month Day Year

DATE EFFECTIVE MAY 31 1996
Month Day Year

ISSUED BY Gary W. Snadon President Branson, MO
name of officer title address

Name of Utility: Emerald Pointe Utility Company

Service Area: Missouri Service Area

RECEIVED

Rules Governing Rendering of Sewer Service

MAY 10 1996

MISSOURI Public Service Commission

Rule 1 DEFINITIONS

- A. An "APPLICANT" is a person, firm, corporation, governmental body, or other entity which has applied for service or a sewer extension; two or more such entities may make one application for a sewer extension, and be considered one APPLICANT.
- B. "B.O.D" denotes biochemical oxygen demand. It is the quantity of oxygen utilized in the biochemical oxidation of organic matter under standard laboratory conditions expressed in milligrams per liter.
- C. A "COLLECTING SEWER" is a pipeline, including force lines, gravity sewers, interceptors, laterals, trunk sewers, manholes, lampholes, and necessary appurtenances, including service wyes, which is owned and maintained by the company, located on public property or on private easements, and used to transport sewage waste from the customer's service connection to the point of disposal.
- D. The "COMPANY" is Emerald Pointe Utility Company, acting through its officers, managers, or other duly authorized employees or agents.
- E. A "CUSTOMER" is any person, firm, corporation or governmental body which has contracted with the company for sewer service or is receiving service from company, or whose facilities are connected for utilizing such service.
- F. The "DATE OF CONNECTION" shall be the date the permit for a service connection is issued by the company. In the event no permit is taken and a service connection is made, the date of connection shall be determined based on available information, such as construction/occupancy permits, or water or electric service turn-on dates.
- G. A "DEVELOPER" is any person, firm, corporation, partnership or any entity that, directly or indirectly, holds title to, or sells or leases, or offers to sell or lease, or advertises for sale or lease, any lots in a subdivision.

FILM

* Indicates new rate or text
 + Indicates change

CANCELLED
 August 23, 2013
 Missouri Public
 Service Commission
 SR-2013-0016; YS-2014-0036

MAY 31 1996
96-96

MO. PUBLIC SERVICE COMM

DATE OF ISSUE MAY 10 1996
Month Day Year

DATE EFFECTIVE MAY 31 1996
Month Day Year

ISSUED BY Gary W. Snadon President Branson, MO
name of officer title address

Name of Utility: Emerald Pointe Utility Company

Service Area: Missouri Service Area

RECEIVED

Rules Governing Rendering of Sewer Service

MAY 10 1995

MISSOURI Public Service Commission

- H. "DISCONTINUANCE OF SERVICE" is intentional cessation of the use of sewer service by action of the company not at the request of the customer. Such DISCONTINUANCE OF SERVICE may be accomplished by methods including physical disconnection of the service sewer, or disconnection of water service by the water utility at the request of the company.
- I. "DOMESTIC SEWAGE" is sewage, excluding storm and surface water, resulting from normal household activities; and, "NON-DOMESTIC SEWAGE" is all sewage other than DOMESTIC SEWAGE including, but not limited to, commercial or industrial wastes. (See Rule 6 pertaining to Improper Waste and Excessive Use.)
- J. A "FOUNDATION DRAIN" is a pipe installed inside or outside the foundation of a structure for the purpose of draining ground or subsurface water away from the foundation.
- K. "pH" is the relative degree of acidity or alkalinity of water as indicated by the hydrogen ion concentration. PH is indicated on a scale reading from 1-14, with 7 being neutral, below 7 acid, and above 7 alkaline; more technically defined as the logarithm of the reciprocal of the hydrogen ion concentration.
- L. A "SERVICE CONNECTION" is the connection of a service sewer to the company collecting sewer either at the bell of a wye branch or the bell of a saddle placed on the barrel of the collecting sewer.
- M. A "SERVICE SEWER" is a pipe with appurtenances installed, owned and maintained by the customer, used to conduct sewage from the customer's premises to the collecting sewer, excluding service wyes or saddles.
- N. A "SUBDIVISION" is any land in the state of Missouri which is divided or proposed to be divided into two or more lots or other divisions of land, whether contiguous or not, or uniform in size or not, for the purpose of sale or lease, and includes resubdivision thereof.

FILED

* Indicates new rate or text
 + Indicates change

CANCELLED
 August 23, 2013
 Missouri Public
 Service Commission
 SR-2013-0016; YS-2014-0036

MAY 31 1996
96-96

MISSOURI PUBLIC SERVICE COMMISSION

DATE OF ISSUE MAY 10 1996
Month Day Year

DATE EFFECTIVE MAY 31 1996
Month Day Year

ISSUED BY Gary W. Snadon President Branson, MO
name of officer title address

Name of Utility: Emerald Pointe Utility Company

Service Area: Missouri Service Area

RECEIVED

Rules Governing Rendering of Sewer Service

MAY 10 1996

MISSOURI
Public Service Commission

- O. "SUSPENDED SOLIDS" are the insoluble materials suspended or dispersed in waste water, expressed in milligrams per liter on a dry weight basis, as determined by standard procedures.
- P. "TERMINATION OF SERVICE" is the cessation of the use of sewer service requested by the customer. Such TERMINATION OF SERVICE shall be accomplished by a method verified and recognized by the company, and may include physical disconnection of the service sewer, termination or disconnection of water service by the water utility, or the company's observation of non-occupancy of the unit served.
- Q. The word "UNIT", or LIVING UNIT shall be used herein to define the premises or property of a single sewer user, whether or not that sewer user is the customer. It shall pertain to any building whether multi-tenant or single occupancy, residential or commercial, owned or leased. Each mobile home in a mobile home park, and each rental unit of a multi-tenant rental property are considered as separate UNITS for each single family or firm occupying same as a residence or place of business.

FILED

- * Indicates new rate or text
- + Indicates change

CANCELLED
August 23, 2013
Missouri Public
Service Commission
SR-2013-0016; YS-2014-0036

MAY 31 1996

96 - 96

MO. PUBLIC SERVICE COMM

DATE OF ISSUE MAY 10 1996
Month Day Year

DATE EFFECTIVE MAY 31 1996
Month Day Year

ISSUED BY Gary W. Snadon President Branson, MO
name of officer title address

Name of Utility: Emerald Pointe Utility Company

Service Area: Missouri Service Area

RECEIVED

Rules Governing Rendering of Sewer Service

MAY 10 1996

MISSOURI Public Service Commission

Rule 2 GENERAL RULES AND REGULATIONS

- A. Every customer, upon signing an application for service or accepting service rendered by the company, shall be considered to have expressed consent to be bound by these rates and rules.
- B. The company's rules governing rendering of service are set forth in the numbered sheets of this tariff. The rates applicable to appropriate class of service are set forth in rate schedules and constitute a part of this tariff.
- C. The company reserves the right, subject to the authority from the Public Service Commission of Missouri, to prescribe additional rates or to alter existing rates or rules as it may deem necessary or proper.
- D. At the effective date of these rules, all new facilities, construction contracts and written agreements shall conform to these rules in accordance with the statutes of the State of Missouri and authority of the Public Service Commission of Missouri. Pre-existing facilities which do not conform with these rules may remain, if said facilities do not cause any service problems and reconstruction is impractical.
- E. The company shall have the right to enter upon the customer's premises for the purpose of inspecting for compliance with these rules. Company personnel shall identify themselves and such inspections shall be conducted during reasonable hours.

FILED

* Indicates new rate or text
 + Indicates change

CANCELLED
 August 23, 2013
 Missouri Public
 Service Commission
 SR-2013-0016; YS-2014-0036

MAY 31 1996

96-96

MISSOURI PUBLIC SERVICE COMMISSION

DATE OF ISSUE MAY 10 1996
Month Day Year

DATE EFFECTIVE MAY 31 1996
Month Day Year

ISSUED BY Gary W. Snadon President Branson, MO
name of officer title address

Name of Utility: Emerald Pointe Utility Company

Service Area: Missouri Service Area

RECEIVED

Rules Governing Rendering of Sewer Service

MAY 10 1996

MISSOURI Public Service Commission

Rule 3 LIMITED AUTHORITY OF COMPANY EMPLOYEES

- A. Employees or agents of the company are expressly forbidden to demand or accept any compensation for any service rendered to its customers except as covered in the company's rules.
- B. No employee or agent of the company shall have the right or authority to bind it by any promise, agreement or representation contrary to the letter or intent of these rules.

FILED

* Indicates new rate or text
 + Indicates change

CANCELLED
 August 23, 2013
 Missouri Public
 Service Commission
 SR-2013-0016; YS-2014-0036

MAY 31 1996
96-96

DATE OF ISSUE MAY 10 1996
Month Day Year

DATE EFFECTIVE MAY 31 1996
Month Day Year

ISSUED BY Gary W. Snadon President Branson, MO
name of officer title address

Name of Utility: Emerald Pointe Utility Company

Service Area: Missouri Service Area

RECEIVED

Rules Governing Rendering of Sewer Service

MAY 10 1996

MISSOURI Public Service Commission

Rule 4 APPLICATIONS FOR SEWER SERVICE

- A. A written application for service, signed by the customer, and accompanied by the appropriate fees as provided in the Schedule of Rates, Service Charges, or Rule 11 - Extension of Collecting Sewers, and other information required by these rules, must be received from each customer before service is provided to any unit. Said application must be filed in writing 24 hours in advance stating the street, house number, name of the applicant, name of the property owner, and the time, at which connection is to be made. The company shall have the right to refuse service for failure to comply with the rules herein, or if the customer owes a past due bill not in dispute for sewer service at any location within the company's service area. In any case where a sewer extension, or unusual construction or equipment expense is necessary to furnish the service, the company may require a contract for service specifying a reasonable period of time for the company to provide the service. If the customer is a tenant, the company shall notify the owner of the property that the owner may be responsible for payment of the sewer service bill.
- B. A prospective commercial or industrial customer shall, upon request of the company, present in writing to the company a list of devices which will discharge to the collecting sewers, the amount and specifications of any discharge, and the location of any buildings. The company will then advise the customer of the form and the character of the waste water collection facilities available. If a sewer extension as provided for in Rule 11 - Extension of Collecting Sewers will be necessary, or if the customer will be required to own, operate, and maintain a pretreatment facility, the customer will also be so advised.
- C. When sewer charges are based on water usage, the company reserves the right to refuse sewer service to any applicant unless said applicant agrees to install a water meter accessible by the company, so that there will be a basis for sewer charges. The company and customer may agree to an estimated water use amount, on an interim basis for a period not to exceed six (6) months, to allow time to install suitable metering equipment.

FILED

* Indicates new rate or text
+ Indicates change

CANCELLED
August 23, 2013
Missouri Public
Service Commission
SR-2013-0016; YS-2014-0036

MAY 31 1996
96 - 96

DATE OF ISSUE MAY 10 1996
Month Day Year

DATE EFFECTIVE MAY 31 1996
Month Day Year

ISSUED BY Gary W. Snadon President Branson, MO
name of officer title address

Name of Utility: Emerald Pointe Utility Company

Service Area: Missouri Service Area

RECEIVED

Rules Governing Rendering of Sewer Service

MISSOURI Public Service Commission

- D. The company will determine or approve the location of the service connection. Service sewers will not be extended along public streets or roadways or through property of others in connecting with collecting sewers. If a service connection is requested at a point not already served by a collecting sewer of adequate capacity, the collecting sewer shall be extended in accordance with Rule 11 - Extension of Collecting Sewers, unless, in the company's judgement such a collecting sewer would serve no other purpose and a service sewer may be constructed to serve the customer's premises in a reasonable manner.
- E. A new service connection shall be authorized when all conditions of Paragraphs A, B, C, and D, above, are met.
- F. When a service sewer is to be connected to the collecting sewer, the plumbing contractor shall obtain instructions from the company regarding location and material to be used for making the connection. The plumber shall advise the company 24 hours in advance of when he expects to make the connection so a representative of the company can inspect the installation. The company must inspect any connection made by the customer prior to trench backfilling.
- G. No substantial addition to the water using equipment or appliances connected to the sewer system shall be made by commercial or industrial customers except upon written notice to and with the written consent of the company.
- H. Any change in the location of an existing service connection and/or service sewer requested by the customer shall be made at the customer's expense.

FILED

* Indicates new rate or text
 + Indicates change

CANCELLED
 August 23, 2013
 Missouri Public
 Service Commission
 SR-2013-0016; YS-2014-0036

MAY 31 1996
 96-96

MO. PUBLIC SERVICE COMMISSION

DATE OF ISSUE MAY 10 1996 DATE EFFECTIVE MAY 31 1996
 Month Day Year Month Day Year

ISSUED BY Gary W. Snadon President Branson, MO
 name of officer title address

Name of Utility: Emerald Pointe Utility Company

Service Area: Missouri Service Area

RECEIVED

Rules Governing Rendering of Sewer Service

MAY 10 1996

MISSOURI PUBLIC SERVICE COMMISSION

Rule 5 INSIDE PIPING AND CUSTOMER SERVICE SEWER

- A. The customer is obligated to construct, repair, and maintain the service sewer from the collecting sewer to the building. The the connection to the collecting sewer shall be made under the authority of the company. The customer shall notify the company prior to cleaning or repairing the service sewer.
- B. Construction of the service sewer, and connection to the collecting sewer shall be subject to the inspection and approval of the company. No backfill shall be placed until the work has been inspected by the company. In the event the customer or the customer's agent shall damage a wye branch or saddle, or cause damage to the collecting sewer, then the customer shall be responsible for the cost to repair any such damage, including replacement of pipe or appurtenances as necessary.
- C. Plumbing specifications of all governmental agencies having jurisdiction, and the company's rules, in effect at the time of connection must be met. The company may deny service or may discontinue service where foundation drains, downspouts, or other sources of surface or storm water are permitted to enter the sewer system through either the inside piping or through the building sewer.
- D. A separate and independent service sewer shall generally be required for every building. Exceptions are:
 - (1) When one building stands at the rear of another building on an interior lot where a proper service sewer cannot be constructed through an adjoining easement. In that situation, the service sewer from the front building may be extended to the rear building and it will be considered as one service sewer.
 - (2) When two or more buildings are a part of a complex which cannot be subdivided.
- E. The service sewer shall be one of the following: ductile iron pipe, vitrified clay sewer

* Indicates new rate or text
 + Indicates change

CANCELLED
 August 23, 2013
 Missouri Public
 Service Commission
 SR-2013-0016; YS-2014-0036

FILED
 MAY 31 1996
 96 - 96

DATE OF ISSUE MAY 10 1996
Month Day Year

DATE EFFECTIVE MAY 31 1996
Month Day Year

ISSUED BY Gary W. Snadon President Branson, MO
name of officer title address

Name of Utility: Emerald Pointe Utility Company

Service Area: Missouri Service Area

RECEIVED

Rules Governing Rendering of Sewer Service

MAY 17 1996

MISSOURI Public Service Commission

pipe (VCP), or polyvinyl chloride pipe (PVC), ASTM specification or equal; or other suitable material approved by the company. Only those jointing materials and methods which are approved by the company may be used. Joints shall be tight and waterproof. Any part of the service sewer that is located within ten (10) feet of a water service pipe shall be constructed of ductile iron or PVC pressure pipe. The pipe shall be bedded according to the manufacturer's specifications, and on undisturbed earth or fill compacted to at least 95% proctor density. Fill may be non-organic soil or aggregate.

- F. The size and slope of the service sewer shall be subject to the approval of the company, but in no event shall the diameter be less than four (4) inches. The slope of such four (4) inch pipe shall not be less than one-eighth (1/8) inch per foot.
- G. Whenever possible the service sewer shall be brought to the building at an elevation below the basement floor. No building sewer shall be laid parallel to or within three (3) feet of any bearing wall. The depth shall be sufficient to afford protection from frost. The service sewer shall be laid at a uniform grade and in straight alignment insofar as possible. Changes in direction shall be made only with properly curved pipes and fittings.
- H. Existing service sewers may be used in connection with new buildings only when they are found on examination and test to meet all requirements of the company.
- I. In any building in which a building drain is too low to permit the required slope of the service sewer, sanitary sewage carried by such drain shall be lifted by approved artificial means and discharged to the service sewer. No water operated sewage ejector shall be used.
- J. All excavations required for the installation of a service sewer and connection to the collecting sewer shall be open trench work unless otherwise approved by the company. Pipe laying and backfill shall be performed in accordance with the latest published engineering specifications of the manufacturer of the materials used, and all applicable local plumbing codes.

FILED

* Indicates new rate or text
 + Indicates change

CANCELLED
 August 23, 2013
 Missouri Public
 Service Commission
 SR-2013-0016; YS-2014-0036

MAY 31 1996
96-96

DATE OF ISSUE MAY 10 1996 DATE EFFECTIVE MAY 31 1996
 Month Day Year Month Day Year

ISSUED BY Gary W. Snadon President Branson, MO
 name of officer title address

Name of Utility: Emerald Pointe Utility Company

Service Area: Missouri Service Area

RECEIVED

Rules Governing Rendering of Sewer Service

MAY 31 1996

Public Service Commission

- K. The connection of the service sewer to the collecting sewer shall be made at the wye branch, if such branch is available at a suitable location. If the collecting sewer is vitrified clay pipe of 12" diameter or less and there is no properly located wye branch at a suitable location, a wye branch shall be installed at a location specified by the company. If the collecting sewer is greater than 12" in diameter, or is PVC of any size, a neat hole may be cut at a location specified by the company, and a saddle installed to which the service sewer will be connected. The invert of the service sewer at the point of connection shall be at the centerline or higher elevation of the collecting sewer. The connection shall be secure and watertight. A wye branch or a saddle may be obtained from the company at cost.
- L. Company personnel may not work on piping or facilities not owned by the company unless authorized by the customer.

FILED

* Indicates new rate or text
 + Indicates change

CANCELLED
 August 23, 2013
 Missouri Public
 Service Commission
 SR-2013-0016; YS-2014-0036

MAY 31 1996
96 - 96

MO. PUBLIC SERVICE COMMISSION

DATE OF ISSUE MAY 10 1996
Month Day Year

DATE EFFECTIVE MAY 31 1996
Month Day Year

ISSUED BY Gary W. Snadon President Branson, MO
name of officer title address

Name of Utility: Emerald Pointe Utility Company

Service Area: Missouri Service Area

RECEIVED

Rules Governing Rendering of Sewer Service

MISSOURI Public Service Commission

Rule 6 IMPROPER OR EXCESSIVE USE

- A. The following requirements for the use of sewer service provided by the company shall be observed. Violation of the requirements will result in the discontinuance of service to the customer or an additional charge where discharge limits are exceeded.
- B. The company may require a customer discharging non-domestic sewage to install a pretreatment facility, grease trap or other device on the premises, to prevent exceedence of discharge limits or other adverse impacts upon the company's system. The installation of any such device as well as its operation and maintenance shall be the responsibility of the customer, and subject to approval and inspection by the company.
- C. No customer shall discharge or cause to be discharged any storm water, surface water, ground water, swimming pool water, roof runoff, sub-surface drainage, or cooling water into the collecting sewers.
- D. The customer shall be required to take any action necessary to meet the following described waste water limits before the wastewater is discharged into the collection sewer:
 - (1) Maximum temperature of 150 degrees Fahrenheit.
 - (2) Maximum strength of 400 parts per million Biological Oxygen Demand (B.O.D.).
 - (3) A maximum of 100 parts per million, by weight, any fat, oil or grease.
 - (4) A maximum of 25 parts per million, by weight, any soluble oils.
 - (5) No gasoline, benzene, naphtha, fuel oil, or other flammable or explosive liquid, solid or gas.

* Indicates new rate or text
 + Indicates change

CANCELLED
 August 23, 2013
 Missouri Public
 Service Commission
 SR-2013-0016; YS-2014-0036

MAY 31 1996
96 - 96

DATE OF ISSUE MAY 10 1996
Month Day Year

DATE EFFECTIVE MAY 31 1996
Month Day Year

ISSUED BY Gary W. Snadon President Branson, MO
name of officer title address

Name of Utility: Emerald Pointe Utility Company

Service Area: Missouri Service Area

RECEIVED

Rules Governing Rendering of Sewer Service

MAY 10 1996

MISSOURI PUBLIC SERVICE COMMISSION

Rule 7 DISCONTINUANCE OF SERVICE BY COMPANY

- A. The company reserves the right of discontinuance of service for any of the following reasons:
 - (1) For failure to comply with these rules.
 - (2) For nonpayment of the sewer utility bill (see Rule 9).
 - (3) For resale of sewer service.
 - (4) For an unauthorized service connection to the company's collecting sewer.
- B. Discontinuance of service to a customer for violation of these Rules shall not prevent the Company from pursuing any lawful remedy by action at law or otherwise for the collection of monies due from the customer.
- C. In the event of discontinuance of service by the company for any violation of these rules, then any monies due the company shall become immediately due and payable.
- D. The company reserves the right of discontinuance of service to a customer, or to refuse service to any applicant or for any unit to protect itself against fraud or abuse.
- E. At least thirty (30) days prior to discontinuance of service, the company will mail a written notice to the customer, and to the property owner if different than the customer, by certified mail, return receipt requested, with a copy of the notice sent to the Public Service Commission. Said notice shall state the nature of the violation, the amount of money owed if for a past due bill including the amount of any service charges owed, and that service may be discontinued at any time after the expiration of the notice period, provided satisfactory arrangements for continuance of the service have not been made by the customer. The thirty (30) day notice may be waived if there is any waste discharge which might be detrimental to the health and safety of the

* Indicates new rate or text
 + Indicates change

CANCELLED
 August 23, 2013
 Missouri Public
 Service Commission
 SR-2013-0016; YS-2014-0036

MAY 31 1996
96-96

MO. PUBLIC SERVICE COMM

DATE OF ISSUE MAY 10 1996
Month Day Year

DATE EFFECTIVE MAY 31 1996
Month Day Year

ISSUED BY Gary W. Snadon President Branson, MO
name of officer title address

Name of Utility: Emerald Pointe Utility Company

Service Area: Missouri Service Area

RECEIVED

Rules Governing Rendering of Sewer Service

MAY 10 1996

MISSOURI

Public Service Commission

public, or cause damage to the sewer system. In the event of discontinuance of service without the thirty (30) day notice as above provided, the customer and the Public Service Commission shall be notified immediately with a statement of the reasons for such discontinuance of service. If service is provided to a multi-tenant building or complex, the company will make an effort to notify tenants by door hangars or other type of notice of the possibility of discontinuance of service.

- F. Reconnection of any customer after discontinuance of service by authority of this rule will be made subject to payment of the cost of reconnection.
- G. Where the owner of rental property is the customer and has been notified of the intent of disconnection, the tenants shall be given the opportunity in a reasonable and timely manner to pay delinquent bills in lieu of disconnection of service.
- H. Termination of service at the customer's request may be accomplished at the expense of the customer, as provided in Rule 9 B.

FILED

MAY 31 1996
96-96

MO. PUBLIC SERVICE COM

* Indicates new rate or text
 + Indicates change

CANCELLED
 August 23, 2013
 Missouri Public
 Service Commission
 SR-2013-0016; YS-2014-0036

DATE OF ISSUE MAY 10 1996
Month Day Year

DATE EFFECTIVE MAY 31 1996
Month Day Year

ISSUED BY Gary W. Snadon President Branson, MO
name of officer title address

Name of Utility: Emerald Pointe Utility Company

Service Area: Missouri Service Area

RECEIVED

Rules Governing Rendering of Sewer Service

MAY 30 1996

MISSOURI Public Service Commission

Rule 8 INTERRUPTIONS IN SERVICE

- A. The company reserves the right to limit sewer service in its collecting sewers at any time, in a reasonable and non-discriminatory manner, for the purpose of making repairs to the sewer system.
- B. Whenever service is limited for repairs, all customers affected by such limitation will be notified in advance whenever it is possible to do so. Every effort will be made to minimize limitation of service.
- C. No refunds of charges for sewer service will be made for limitations of service unless due to willful misconduct of the company.

FILED

MAY 31 1996

96-96

MO. PUBLIC SERVICE COMMISSION

* Indicates new rate or text
 + Indicates change

CANCELLED
 August 23, 2013
 Missouri Public
 Service Commission
 SR-2013-0016; YS-2014-0036

DATE OF ISSUE MAY 10 1996
 Month Day Year

DATE EFFECTIVE MAY 31 1996
 Month Day Year

ISSUED BY Gary W. Snadon President Branson, MO
 name of officer title address

Name of Utility: Emerald Pointe Utility Company

Service Area: Missouri Service Area

RECEIVED

Rules Governing Rendering of Sewer Service

MISSOURI Public Service Commission

Rule 9 BILLS FOR SERVICE

- A. The charges for sewer service shall be at the rates specified in this tariff, which is on file with the Missouri Public Service Commission and at the company's office. The point of assumption of sewer service shall be at the service connection. Service charges for connection or disconnection are set forth in the Schedule of Service Charges.
- B. A customer who is or has been taking sewer service at one or more units connected to the collecting sewer shall be held liable for payment of any applicable charges for service furnished to such units from the date of connection until the date requested by the customer in writing for service to be terminated, or until service is discontinued by the company. If termination of service must be accomplished by physical disconnection, the customer shall notify the company of the date and time of the disconnect in writing at least five days prior to the disconnection. If termination is accomplished by discontinuance or termination of water service, such notice shall be on or before the date of the water turnoff. Service may not be terminated for one unit of a multi-unit building if the building is served by one service sewer, unless accomplished by discontinuance or termination of water service. The method used for termination of service shall be determined by the company.
- C. Bills for sewer service will be mailed or delivered to the customer's last address as shown by the records of the company, but failure to receive the bill will not relieve the customer from the obligation to pay the same.
- D. Payments shall be made at the office of the company or at a convenient location designated by the company, or by mailing to the company's office.
- E. Separate bills shall be rendered for each location at which sewer service is provided, even though one entity may be the customer at such separate locations.
- F. The company shall have the right to render bills monthly in advance. Bills shall have the due date indicated on the bill. The company shall have the right to charge

* Indicates new rate or text
 + Indicates change

CANCELLED
 August 23, 2013
 Missouri Public
 Service Commission
 SR-2013-0016; YS-2014-0036

FILED

MAY 31 1996
96-96

MO. PUBLIC SERVICE COMM

DATE OF ISSUE MAY 10 1996
Month Day Year

DATE EFFECTIVE ~~MAY 31 1996~~
Month Day Year

ISSUED BY Gary W. Snadon President Branson, MO
name of officer title address

Name of Utility: Emerald Pointe Utility Company

Service Area: Missouri Service Area

RECEIVED

Rules Governing Rendering of Sewer Service

MAY 30 1996

Public Service Commission

customers on a monthly basis in arrears when the sewer charges are based on water usage.

- G. Neither the company nor the customer will be bound by bills rendered under mistake of fact as to the quantity of service rendered or as a result of clerical error. Customers will be held responsible for charges based on service provided.
- H. All bills for sewer service become delinquent after the due date stated on the bill. Service may be discontinued after thirty (30) days written notice by certified mail return receipt requested from the company as provided by Rule 7, Discontinuance of Service by Company.
- I. When bills are rendered for a period of less than a complete billing period due to the connection or termination of service, the billing shall be for the proportionate part of the monthly charge, or where water usage is the basis for the charge, at the appropriate rate for water used. Customers terminating after taking service for less than one month shall pay not less than the monthly minimum.
- J. The owner of the property served will be held responsible for ultimate payment of a bill. Copies of all notices of violations of the rules, or of disconnection of service shall also be sent to the owner of the property.

FILED

* Indicates new rate or text
 + Indicates change

CANCELLED
 August 23, 2013
 Missouri Public
 Service Commission
 SR-2013-0016; YS-2014-0036

MAY 31 1996
96-96

DATE OF ISSUE MAY 10 1996
Month Day Year

DATE EFFECTIVE MAY 31 1996
Month Day Year

ISSUED BY Gary W. Snadon President Branson, MO
name of officer title address

Name of Utility: Emerald Pointe Utility Company

Service Area: Missouri Service Area

RECEIVED

Rules Governing Rendering of Sewer Service

MAY 10 1996

MISSOURI
Public Service Commission

Rule 10 SPECIAL CONTRACT FOR EXCESSIVE CAPACITY

A. In the event that the customer to be served proposes to discharge into the company's system an abnormally high volume or strength of waste as to require an enlargement of the company's existing sewage treatment plant or the construction of a temporary sewage treatment plant, and/or the construction or reconstruction of sewer lines or pump facilities, service shall be provided to such customer under the terms and conditions of a mutually satisfactory contract, in a form approved by the Public Service Commission, pursuant to which the cost of such improvements will be financed in such a manner as to be fair and reasonable to both parties and so as not to constitute a burden upon the company or the existing customers of the company.

FILED

* Indicates new rate or text
+ Indicates change
CANCELLED
August 23, 2013
Missouri Public
Service Commission
SR-2013-0016; YS-2014-0036

MAY 31 1996
96 - 96

MISSOURI PUBLIC SERVICE COMMISSION

DATE OF ISSUE MAY 10 1996
Month Day Year

DATE EFFECTIVE ~~_____~~ MAY 31 1996
Month Day Year

ISSUED BY Gary W. Snadon President Branson, MO
name of officer title address

Name of Utility: Emerald Pointe Utility Company

Service Area: Missouri Service Area

RECEIVED

Rules Governing Rendering of Sewer Service

MAY 10 1996

MISSOURI Public Service Commission

Rule 11 EXTENSION OF COLLECTING SEWERS

- A. Collecting sewers will be extended within the company's certificated service area, at the applicant's cost, if service is requested by the applicant at a location where facilities do not exist (the "applicant" is sometimes referred to in this rule as the "original applicant"). The applicant shall enter into a contract with the company. The applicant may choose to have the company perform all work under the terms and conditions of Paragraph C, following, or have a private contractor perform the work under the terms and conditions of Paragraph D, following. For purposes of this rule, an extension could include, in addition to a collecting sewer, one or more pump station or treatment plant facilities, as necessary to provide the service.
- B. The pipe used in making extensions shall be of a type and size which will be reasonably adequate for the area to be served. Such determination as to size and type of pipe shall be left solely to the judgment of the company. If the company desires a pipe size, lift station, treatment plant, or any other facility larger than reasonably required to provide service to the applicant, the additional cost due to larger size shall be borne by the company.
- C. The company will extend collecting sewers for the applicant under the following terms and conditions:
 - (1) Upon receipt of written application for service as provided in Rule 4, Applications for Service, the company will provide the applicant an itemized estimate of the cost of the proposed extension. Said estimate shall include the cost of all labor and materials required, including reconstruction of existing facilities if necessary, and the direct costs associated with supervision, engineering, permits, and bookkeeping. Applicable income tax cost calculated at the maximum rate will be added to this estimate.
 - (2) The applicant shall enter into a contract with the company for the installation of said extension and shall tender to the company a contribution-in-aid-of-

* Indicates new rate or text
 + Indicates change

CANCELLED
 August 23, 2013
 Missouri Public
 Service Commission
 SR-2013-0016; YS-2014-0036

FILED

MAY 31 1996
96-96

DATE OF ISSUE MAY 10 1996
Month Day Year

DATE EFFECTIVE MAY 31 1996
Month Day Year

ISSUED BY Gary W. Snadon President Branson, MO
name of officer title address

MO. PUBLIC SERVICE COMM

Name of Utility: Emerald Pointe Utility Company

Service Area: Missouri Service Area

RECEIVED

Rules Governing Rendering of Sewer Service

MAY 10 1996

MISSOURI Public Service Commission

construction equal to the amount determined in Paragraph C (1) above, plus any appropriate fees as provided in the Schedule of Rates or the Schedule of Service Charges.

- (3) If, as a result of reasonably unforeseen circumstances, the actual cost of the extension exceeds the estimated cost of the extension, the applicant shall pay the additional cost.

D. When the applicant elects to construct an extension, the company will connect said extension to its existing collecting sewers under the following terms and conditions:

- (1) Applicant shall enter into a contract with the company which provides that the applicant construct said collecting sewers and/or other facilities to meet the requirements of all governmental agencies and the company's rules. Plans for the extension shall be submitted to the company for approval prior to construction. Applicant's choice of construction contractor is subject to approval by the company. Applicant shall contribute said facilities to the company with a detailed accounting of the actual cost of construction, contribute to the company an amount equal to the company's estimated income tax cost calculated at the maximum rate, and contribute to the company the estimated cost of the company's inspection.
(2) The company, or its representative, shall have the right to inspect and test the extension prior to connecting it to the existing collecting sewers and acceptance of ownership.
(3) Connection of the extension to existing company collecting sewers shall be made only by representatives of the company.
(4) The company shall have the right to refuse ownership and responsibility for the sewer extension until applicant has met the contractual obligations as provided in Paragraph D (1).

FILED

* Indicates new rate or text
+ Indicates change
CANCELLED August 23, 2013 Missouri Public Service Commission SR-2013-0016; YS-2014-0036

MAY 31 1996 96-96

MO. PUBLIC SERVICE COMMISSION

MAY 31 1996

DATE OF ISSUE MAY 10 1996 Month Day Year

DATE EFFECTIVE Month Day Year

ISSUED BY Gary W. Snadon President Branson, MO name of officer title address

Name of Utility: Emerald Pointe Utility Company

Service Area: Missouri Service Area

RECEIVED

Rules Governing Rendering of Sewer Service

MAY 10 1996

MISSOURI Public Service Commission

E. The cost to additional applicants connecting to the sewer contributed by the original applicant shall be as follows:

- (1) For a single-family residential applicant applying for service in a platted subdivision, the company shall divide the actual cost of the extension, including income taxes, by the number of lots abutting said extension to determine the per lot extension cost. When counting lots, corner lots which abut existing sewers shall be excluded.
- (2) For a single-family residential applicant requesting service to areas that are not platted in subdivision lots, the applicant's cost shall be equal to the total cost of the extension times 100 feet divided by the total length of the extension in feet.
- (3) For an industrial, commercial, or multi-family residential applicant, the cost will be equal to the amount calculated for a single-family residence in E (1) above or E (2) above, as appropriate, multiplied by a water usage factor. The water usage factor shall be determined by dividing the average monthly usage in gallons by 7,000 gallons, but shall not be less than 1.

F. Refunds of contributions shall be made to the original applicant as follows:

- (1) Should the actual cost of an extension constructed by the company under Paragraph C, or actual costs for inspection by the company under Paragraph D, above, be less than the estimated cost, the company shall refund the difference as soon as the actual cost has been ascertained.

FILED

* Indicates new rate or text
 + Indicates change

CANCELLED
 August 23, 2013
 Missouri Public
 Service Commission
 SR-2013-0016; YS-2014-0036

MAY 31 1996
96-96

MO PUBLIC SERVICE COMM

DATE OF ISSUE MAY 10 1996
Month Day Year

DATE EFFECTIVE MAY 31 1996
Month Day Year

ISSUED BY Gary W. Snadon President Branson, MO
name of officer title address

Name of Utility: Emerald Pointe Utility Company

Service Area: Missouri Service Area

RECEIVED

MAY 10 1996

Rules Governing Rendering of Sewer Service

MISSOURI Public Service Commission

- (2) After the company has closed its books for the year, in which a contribution was made, it will determine its actual income tax cost associated with each extension and refund any excess income tax costs collected from the applicant.
 - (3) During the first ten years after the extension is completed, the company will refund to the original applicant who paid for the extension monies collected from additional applicants in accordance with Paragraph E above.
 - (4) The sum of all refunds to the applicant shall not exceed the total contribution, including income tax and inspection costs associated with the extension, which the applicant has paid.
 - (5) If two or more entities are considered an original applicant, the refund shall be distributed to each entity based upon the percentage of the actual extension cost contributed by each entity.
- G. Any extension made under this rule shall be and remain the property of the company in consideration of its perpetual upkeep and maintenance.
- H. The company reserves the right to connect additional extensions to a collecting sewer contributed by the applicant. The connection of new customers to such additional extensions shall not entitle the applicant to any refund.

FILED

MAY 31 1996

96 - 96

MO. PUBLIC SERVICE COMM

* Indicates new rate or text
+ Indicates change

CANCELLED
August 23, 2013
Missouri Public
Service Commission
SR-2013-0016; YS-2014-0036

DATE OF ISSUE MAY 10 1996
Month Day Year

DATE EFFECTIVE
Month Day Year

ISSUED BY Gary W. Snadon President Branson, MO
name of officer title address