

BE ISSUED EXCEPT FOR THE PURPOSE OF
CANCELING THIS TARIFF.

P. S. C. Mo. No. 17
BASE RATE AREA MAP

Deering, Missouri
ORIGINAL SHEET 2

RECEIVED
DEC 12 1951
MISSOURI
Public Service Comm.

FILED
JAN 11 1952
PUBLIC SERVICE COMMISSION

DEERING, MO.

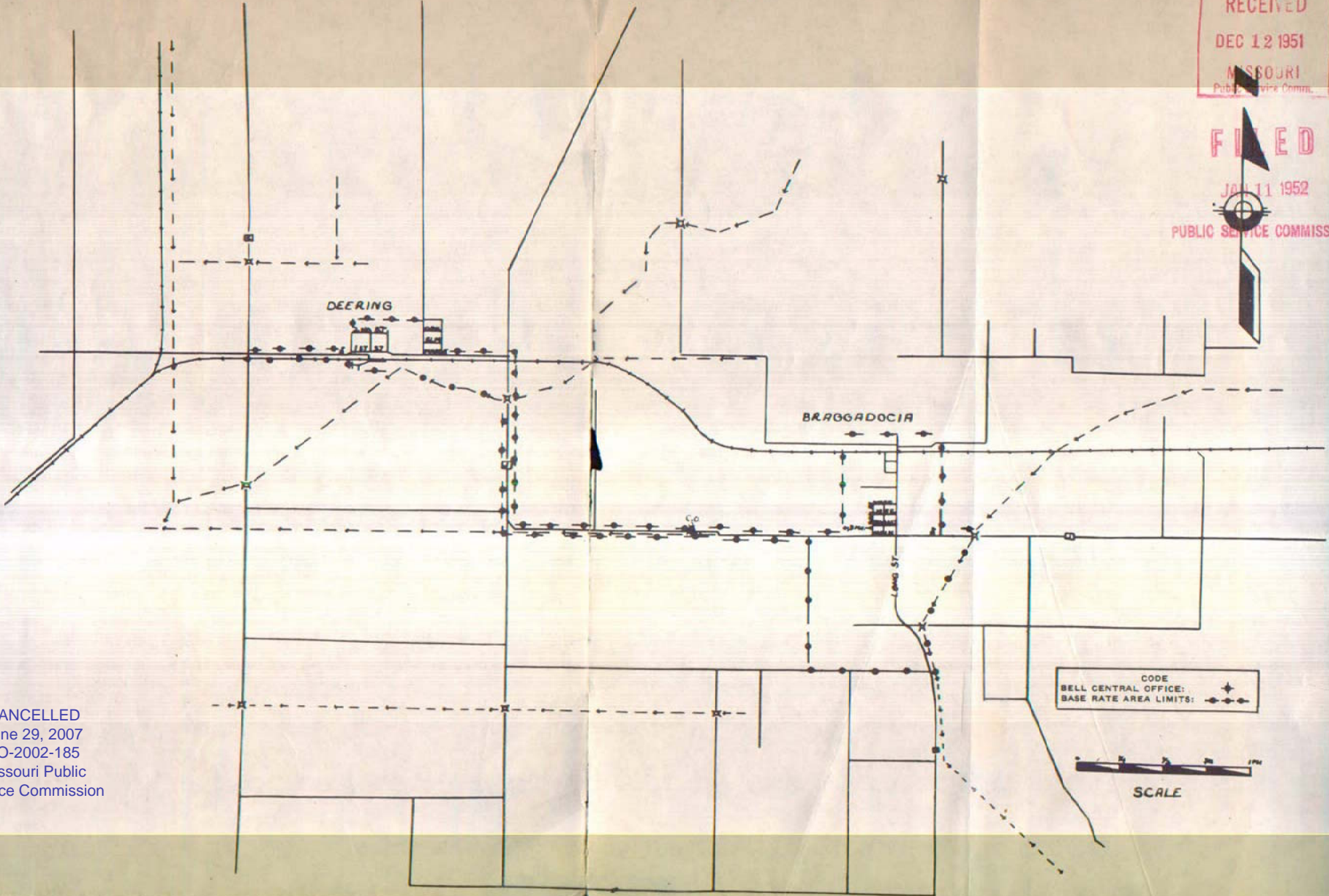

CANCELLED
June 29, 2007
TO-2002-185
Missouri Public
Service Commission

CODE
BELL CENTRAL OFFICE: +
BASE RATE AREA LIMITS: - - -



NO SUPPLEMENT TO THIS TARIFF WILL BE ISSUED EXCEPT FOR THE PURPOSE OF CANCELING THIS TARIFF.

P. S. C. Mo. No. 17 EXCHANGE AREA MAP

REPLACING 5th REVISED SHEET 3
4th REVISED SHEET 3

MAY 11 1979

MISSOURI
Public Service Commission

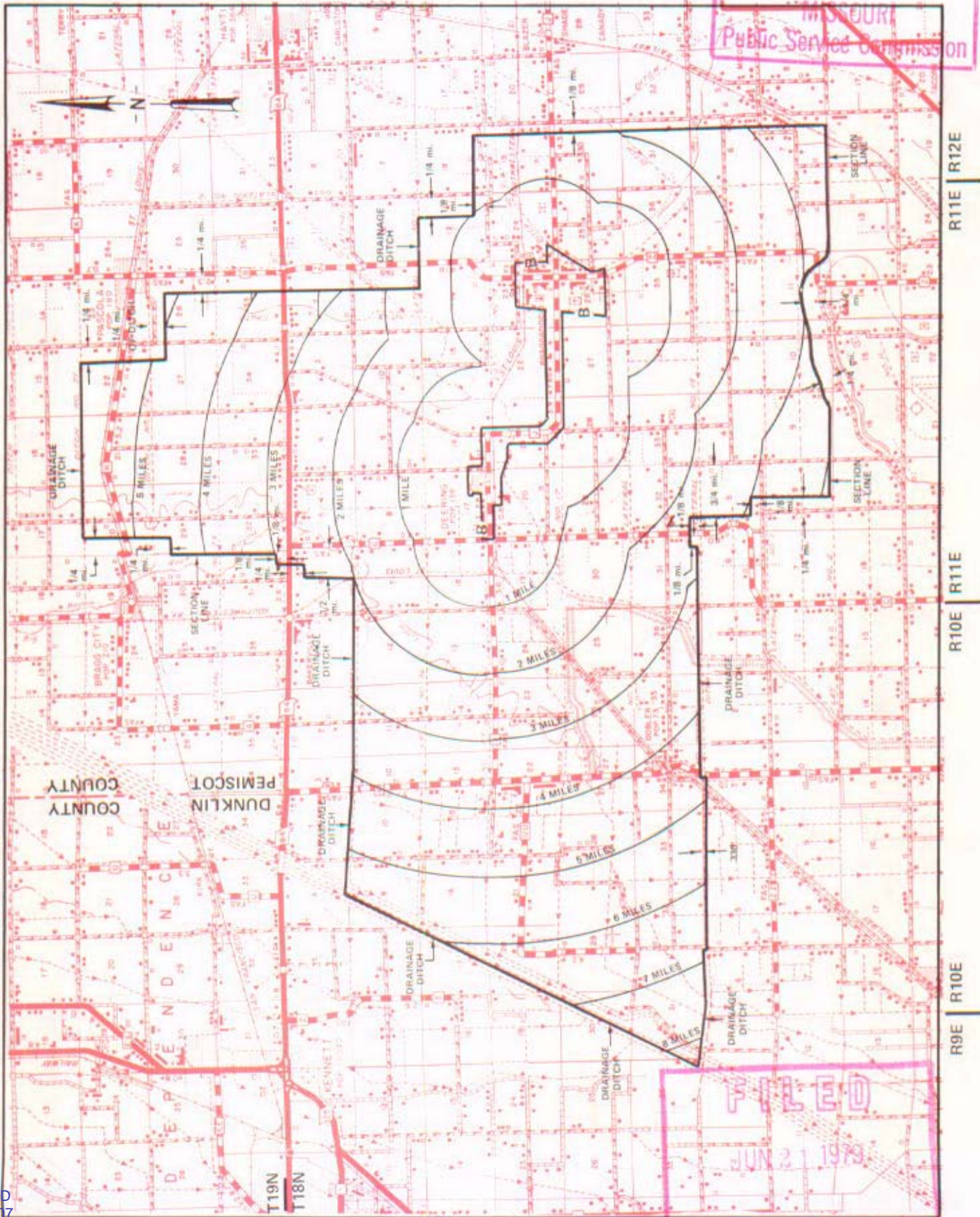

FILED
JUN 21 1979
Missouri Public Service Commission

CANCELLED
June 29, 2007
TO-2002-185
Missouri Public
Service Commission

By R. R. SHOCKLEY, Vice President, Missouri
Southwestern Bell Telephone Company
St. Louis, Missouri

Issued: May 21, 1979

Effective: June 21, 1979

SBC PSC MO #17
De Kalb, Missouri
Original Sheet 2

Non-Scannable Map

(Is viewable in the Data Center
200 Madison Street, 1st Floor
Jefferson City MO)

P. S. C. Mo. No. 17
EXCHANGE AREA MAP

RECEIVED
MAR 16 1965
MISSOURI
Public Service Comm.

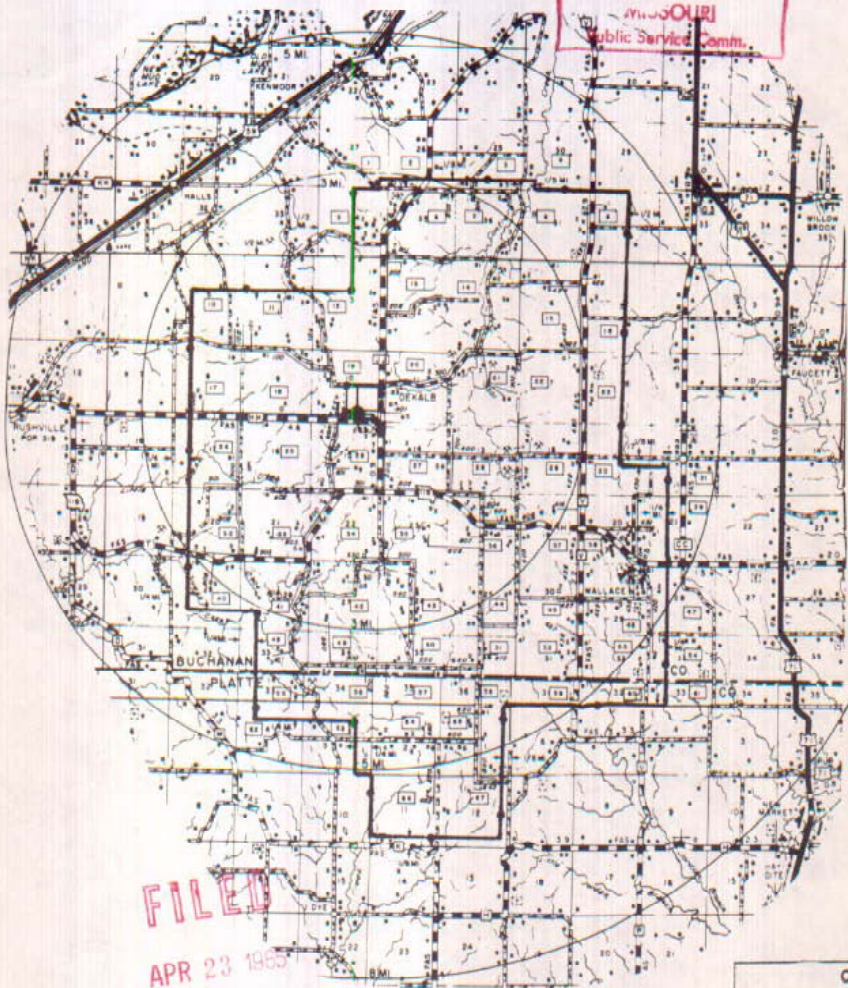

DEKALB, Mo.

FILED

APR 23 1965

PUBLIC SERVICE COMMISSION

CODE

EXCHANGE BOUNDARY
BASE RATE AREA
Central Office

Issued: March 23, 1965

Effective: April 23, 1965

By R. R. SHOCKLEY, Vice President and General Manager
Southwestern Bell Telephone Company
St. Louis, Missouri

WE HOLD EXCEPT FOR THE PURPOSE OF CANCELING THIS TARIFF.

P. S. C. Mo. No. 17 BASE RATE AREA MAP

ORIGINAL SHEET 2
REPLACING SOUTHEAST MISSOURI
TELEPHONE COMPANY P. S. C. Mo. No. 2
1st REVISED SHEET 2

RECEIVED
DEC 7 1955
MISSOURI
Public Service Comm.

DELTA, MO.

CANCELLED
June 29, 2007
TO-2002-185
Missouri Public
Service Commission

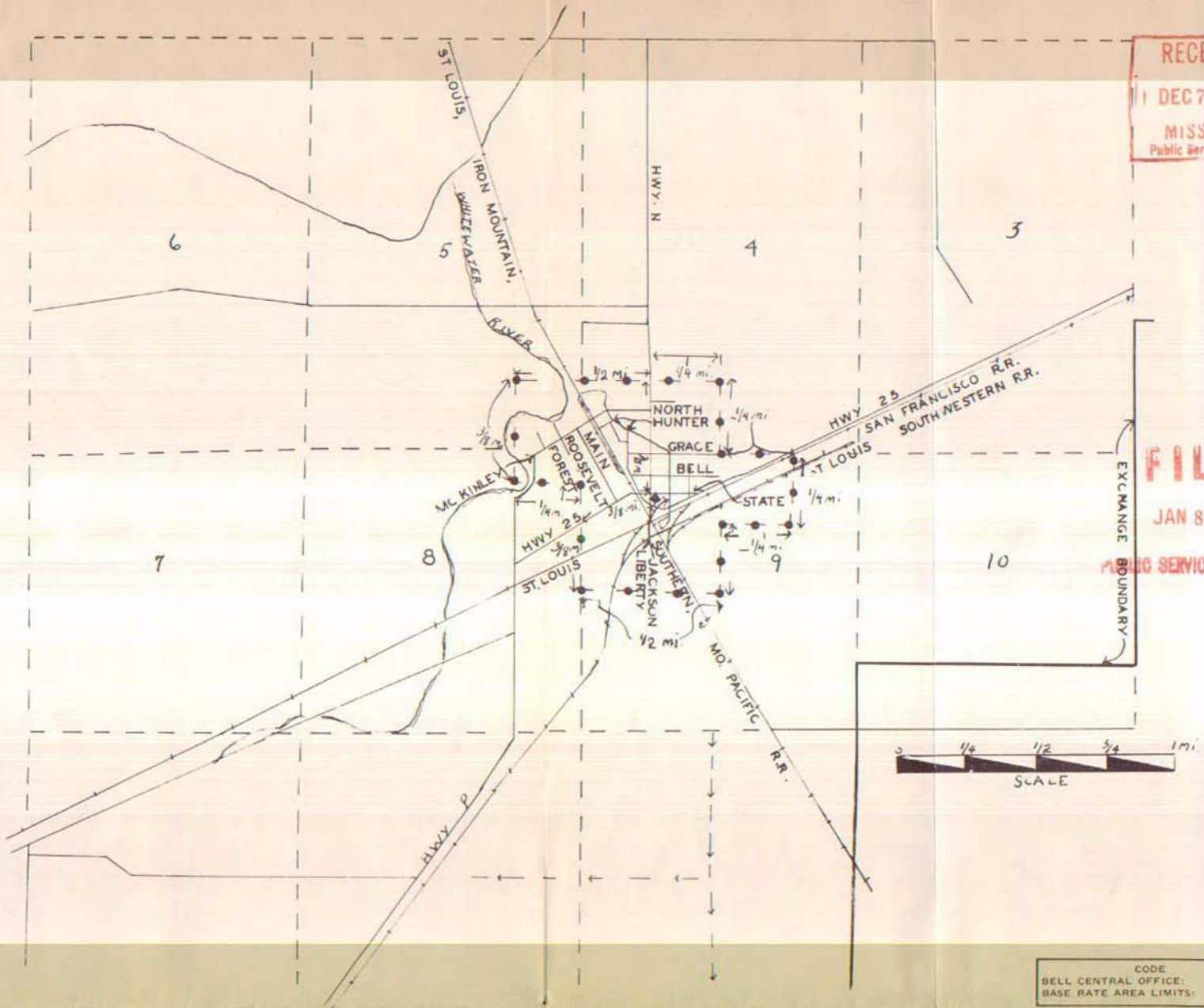

FILED
JAN 8 1956
PUBLIC SERVICE COMMISSION



CODE
 BELL CENTRAL OFFICE:
 BASE RATE AREA LIMITS:

Issued: December 8, 1955

By J. R. PETERSON, General Manager
Southwestern Bell Telephone Company
St. Louis, Missouri

Effective: January 8, 1956

NO SUPPLEMENT TO THIS TARIFF WILL BE ISSUED EXCEPT FOR THE PURPOSE OF CANCELING THIS TARIFF.

9th REVISED SHEET 3
REPLACING 8th REVISED SHEET 3

P. S. C. Mo. No. 17 EXCHANGE AREA MAP

JAN 24 1990

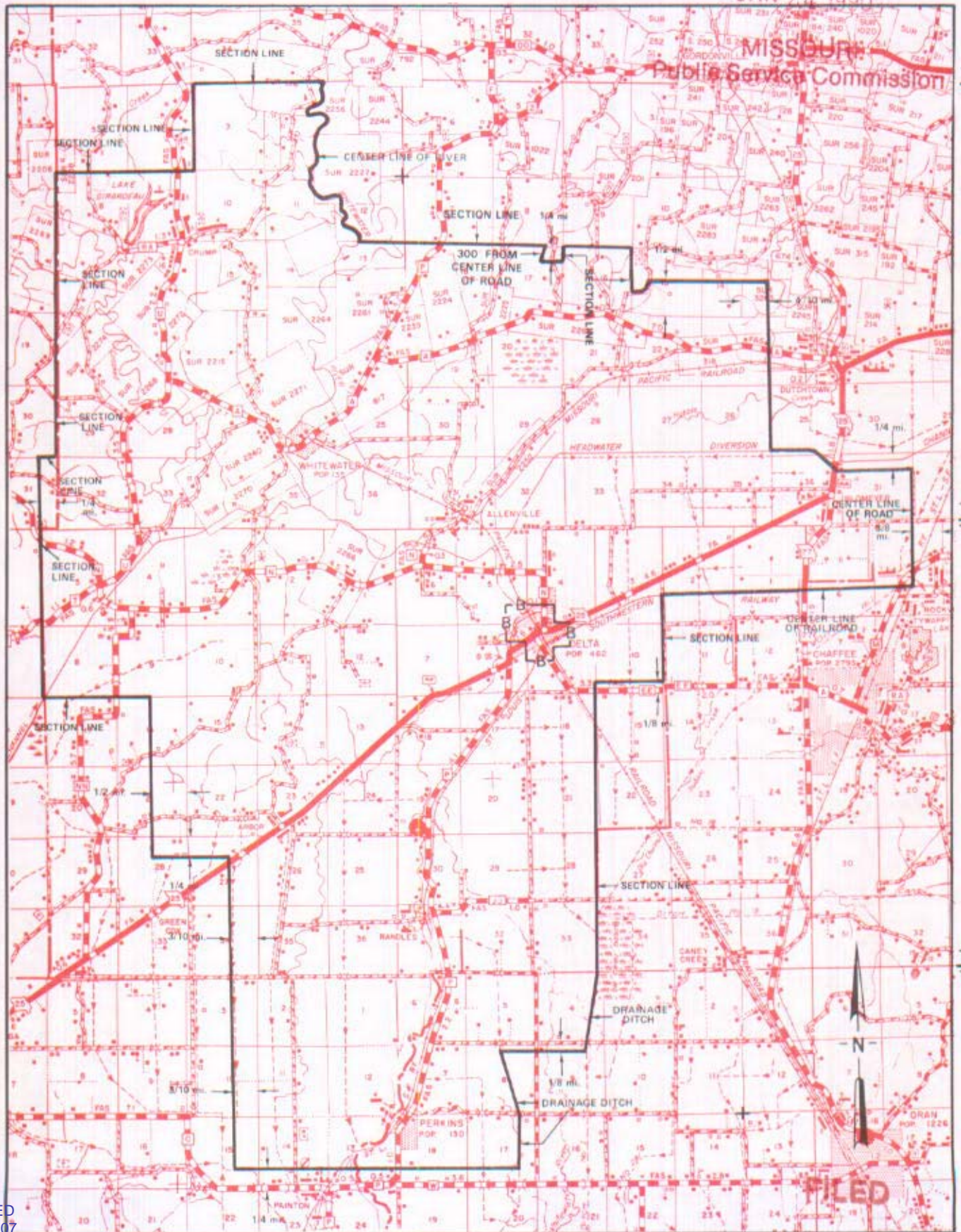

T31N
T30N

T30N
T29N

T29N
T28N

R1E | R2E

R2E | R3E 1990

By R. D. BARRON, PRESIDENT, MISSOURI DIVISION
Southwestern Bell Telephone Company
St. Louis, Missouri

Public Service Commission

Issued: January 29, 1990

Effective: March 1, 1990

CANCELLED
June 29, 2007
TO-2002-185
Missouri Public
Service Commission

FILED

CANCELLED
June 29, 2007
TO-2002-185
Missouri Public
Service Commission

NO SUPPLEMENT TO THIS TARIFF WILL
BE ISSUED EXCEPT FOR THE PURPOSE OF
CANCELING THIS TARIFF.

P. S. C. Mo. No. 17

BASE RATE AREA MAP

DeSoto, Missouri

2nd REVISED SHEET 2
REPLACING 1st REVISED SHEET 2

RECEIVED
AUG 27 1986
MISSOURI
Public Service Commission

SCALE: 1" = 1600'

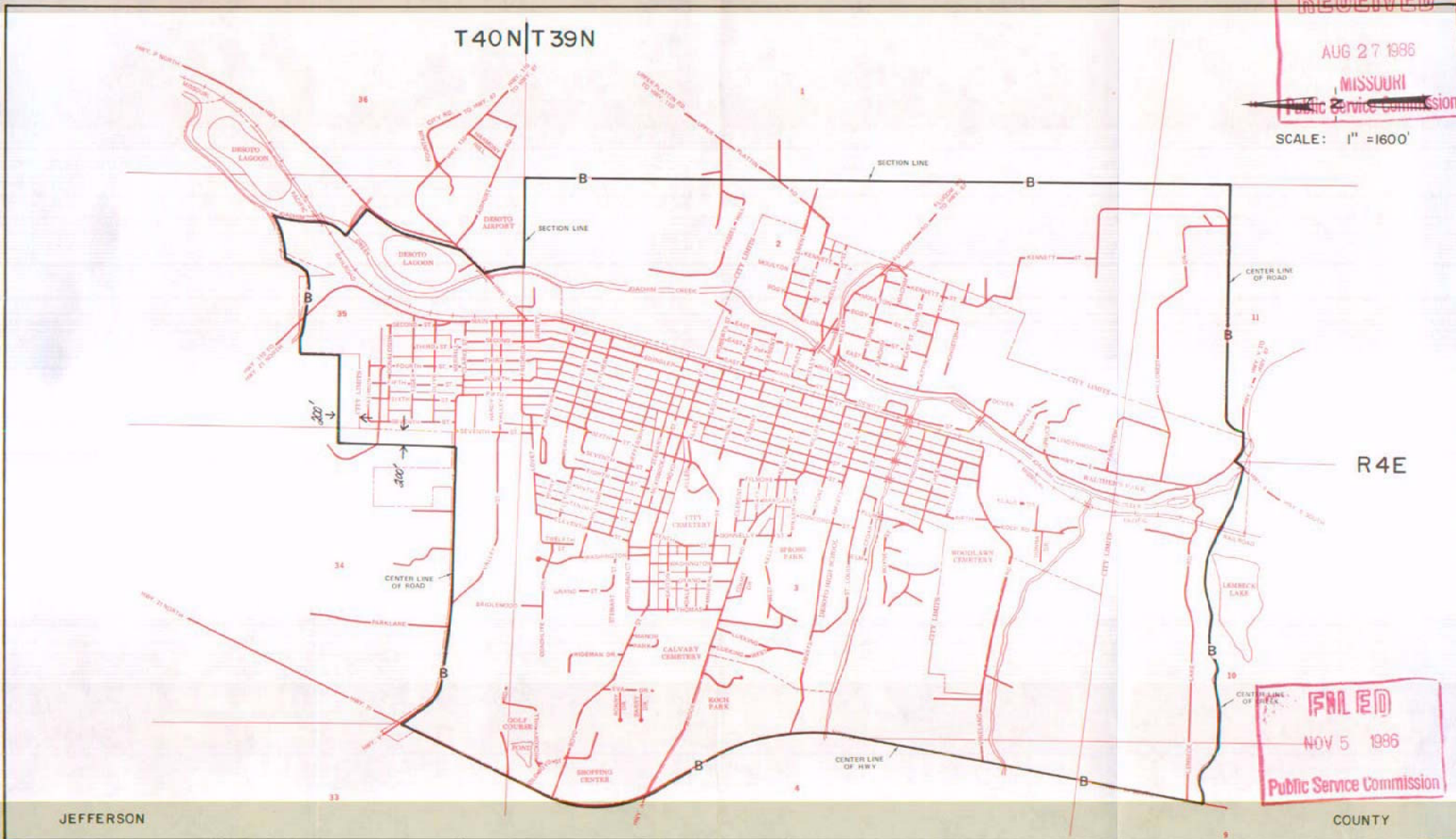

PAID
NOV 5 1986
Public Service Commission

Issued: AUG 29 1986

By R.D. BARRON, PRESIDENT—MISSOURI DIVISION
Southwestern Bell Telephone Company
St. Louis, Missouri

Effective: NOV 5 1986

CANCELLED
 June 29, 2007
 TO-2002-185
 Missouri Public
 Service Commission

NO SUPPLEMENT TO THIS TARIFF WILL
 BE ISSUED EXCEPT FOR THE PURPOSE OF
 CANCELING THIS TARIFF.

P. S. C. Mo. No. 17
EXCHANGE AREA MAP

DeSoto, Missouri

8th REVISED SHEET 3
 REPLACING 7th REVISED SHEET 3

RECEIVED
 AUG 27 1986
 MISSOURI
 Public Service Commission

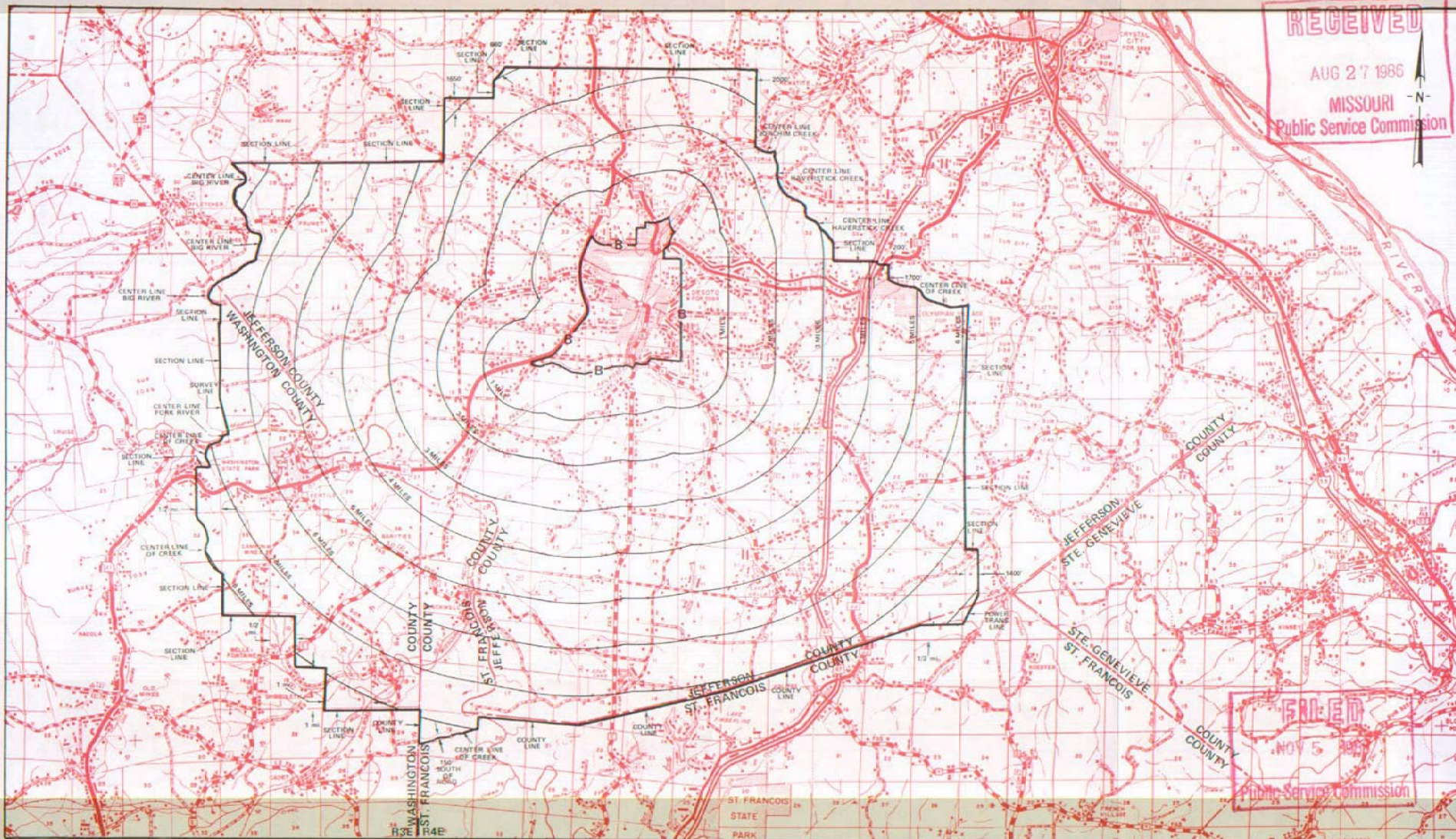

R2E | R3E By R.D. BARRON, PRESIDENT—MISSOURI DIVISION
 Southwestern Bell Telephone Company
 St. Louis, Missouri

R4E | R5E R5E | R6E

R6E | R7E

Issued: **AUG 29 1986**

RECEIVED
 NOV 5 1986
 Public Service Commission

Effective: **NOV 5 1986**

CANCELLED
June 29, 2007
TO-2002-185
Missouri Public
Service Commission

SBC PSC MO #17

Dexter, Missouri

2nd Revised Sheet 2

Replacing 1st Revised Sheet 2

Non-Scannable Map

(Is viewable in the Data Center
200 Madison Street, 1st Floor
Jefferson City MO)

NO SUPPLEMENT TO THIS TARIFF WILL BE ISSUED EXCEPT FOR THE PURPOSE OF CANCELING THIS TARIFF.

P. S. C. Mo. No. 17

Dexter, Missouri

EXCHANGE AREA MAP

7th REVISED SHEET 3 REPLACING 6th REVISED SHEET 3

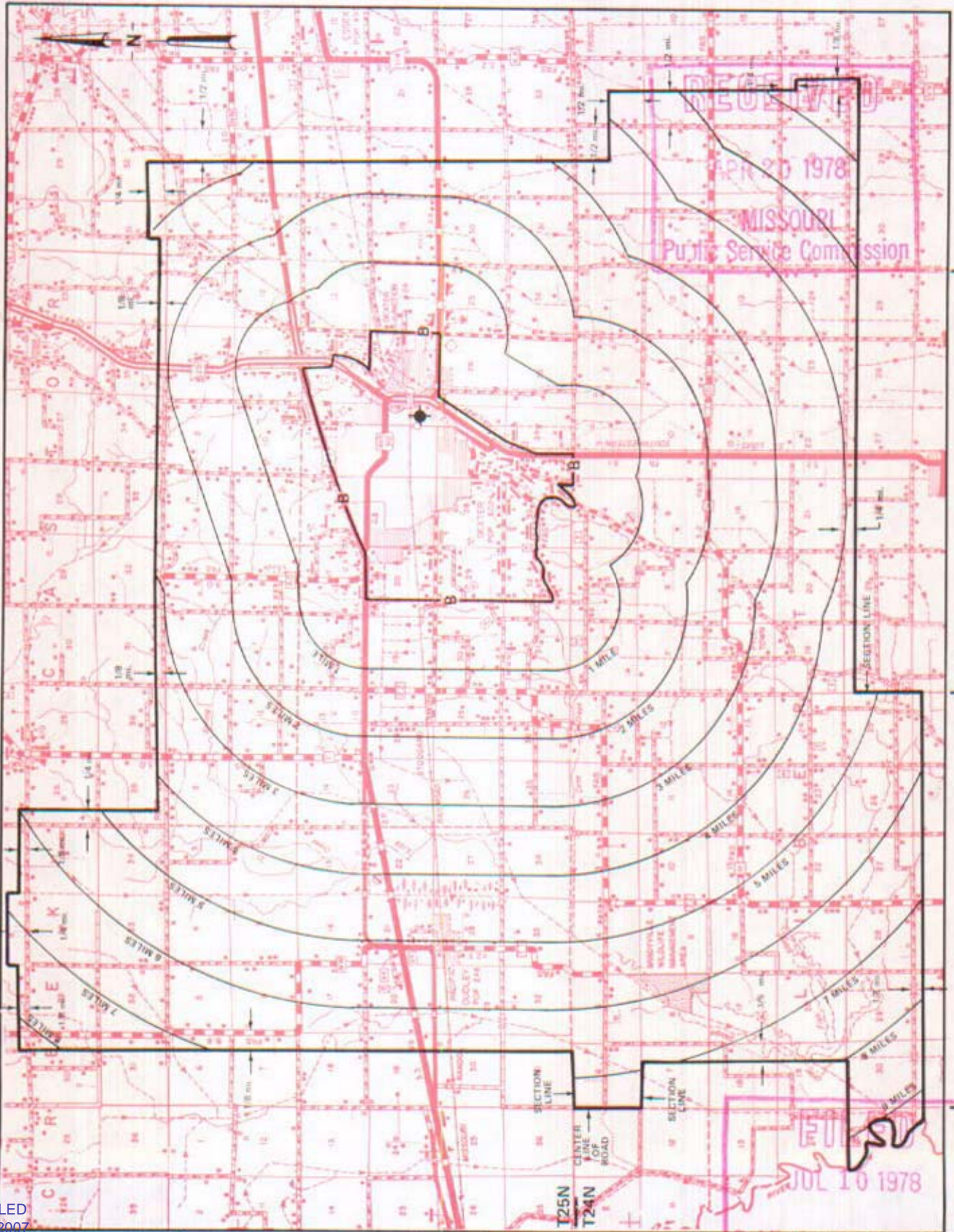

CANCELLED
June 29, 2007
TO-2002-185
Missouri Public
Service Commission

By R. R. SHOCKLEY, Vice President, Missouri
Southwestern Bell Telephone Company

JUL 10 1978

SBC PSC MO #17
Downing, Missouri
Original Sheet 2
Schuyler County

Non-Scannable Map

(Is viewable in the Data Center
200 Madison Street, 1st Floor
Jefferson City MO)

NO SUPPLEMENT TO THIS TARIFF WILL BE ISSUED EXCEPT FOR THE PURPOSE OF CANCELING THIS TARIFF.

P. S. C. Mo. No. 17

Downing, Missouri

EXCHANGE AREA MAP

6th REVISED SHEET 3 REPLACING 5th REVISED SHEET 3

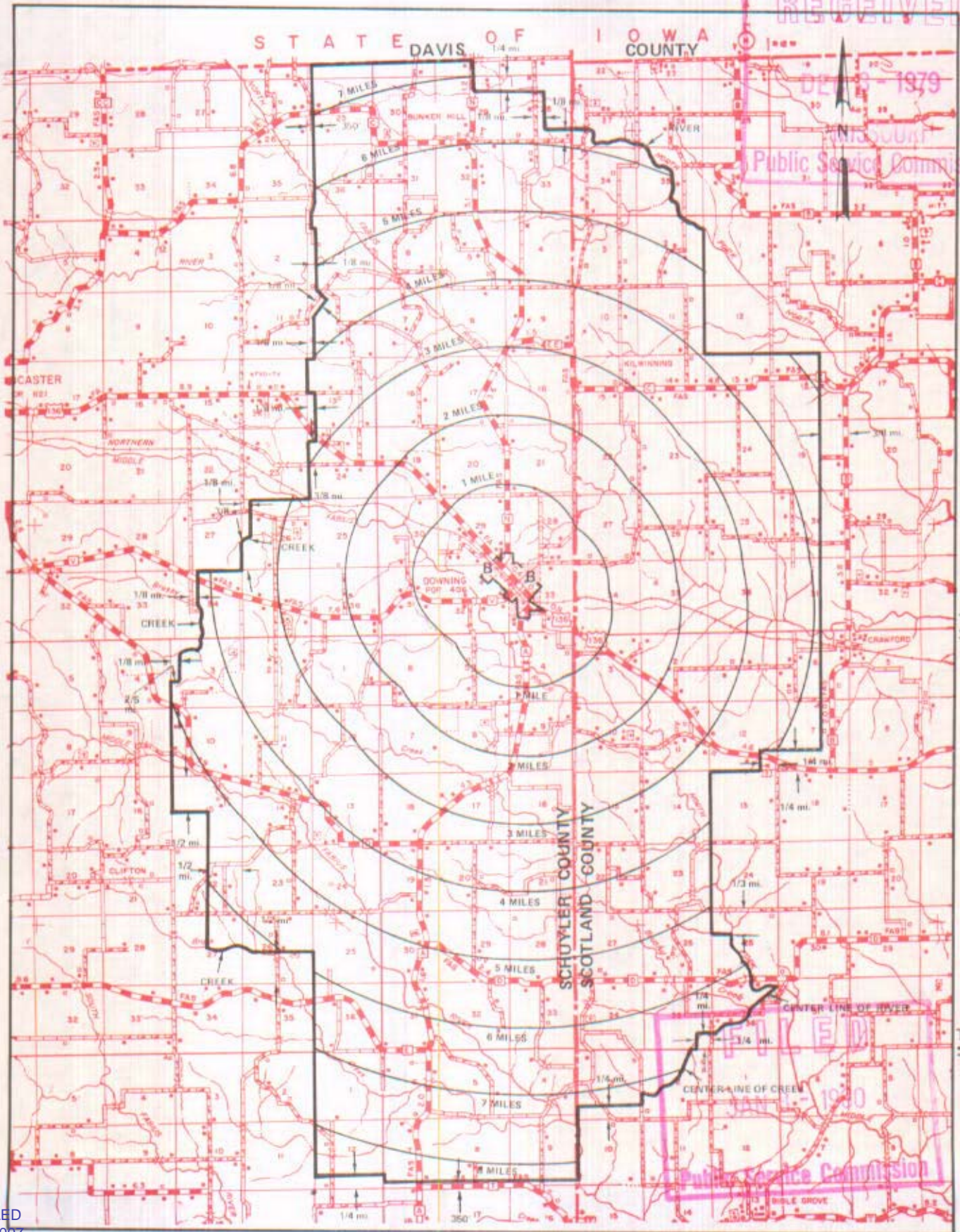

CANCELLED
June 29, 2007
TO-2002-185
Missouri Public
Service Commission

R14W | R13W

R13W | R12W

By R. R. SHOCKLEY, Vice President, Missouri
Southwestern Bell Telephone Company

JAN 3 1980

Issued: DECEMBER 7, 1979

Effective: