

Southwest Village Water Company  
Name of Issuing Corporation

For Greene County, Mississippi  
Community, Town or City

RECEIVED

SEP 5 1978

Map of Service Area

MISSOURI

Public Service Commission

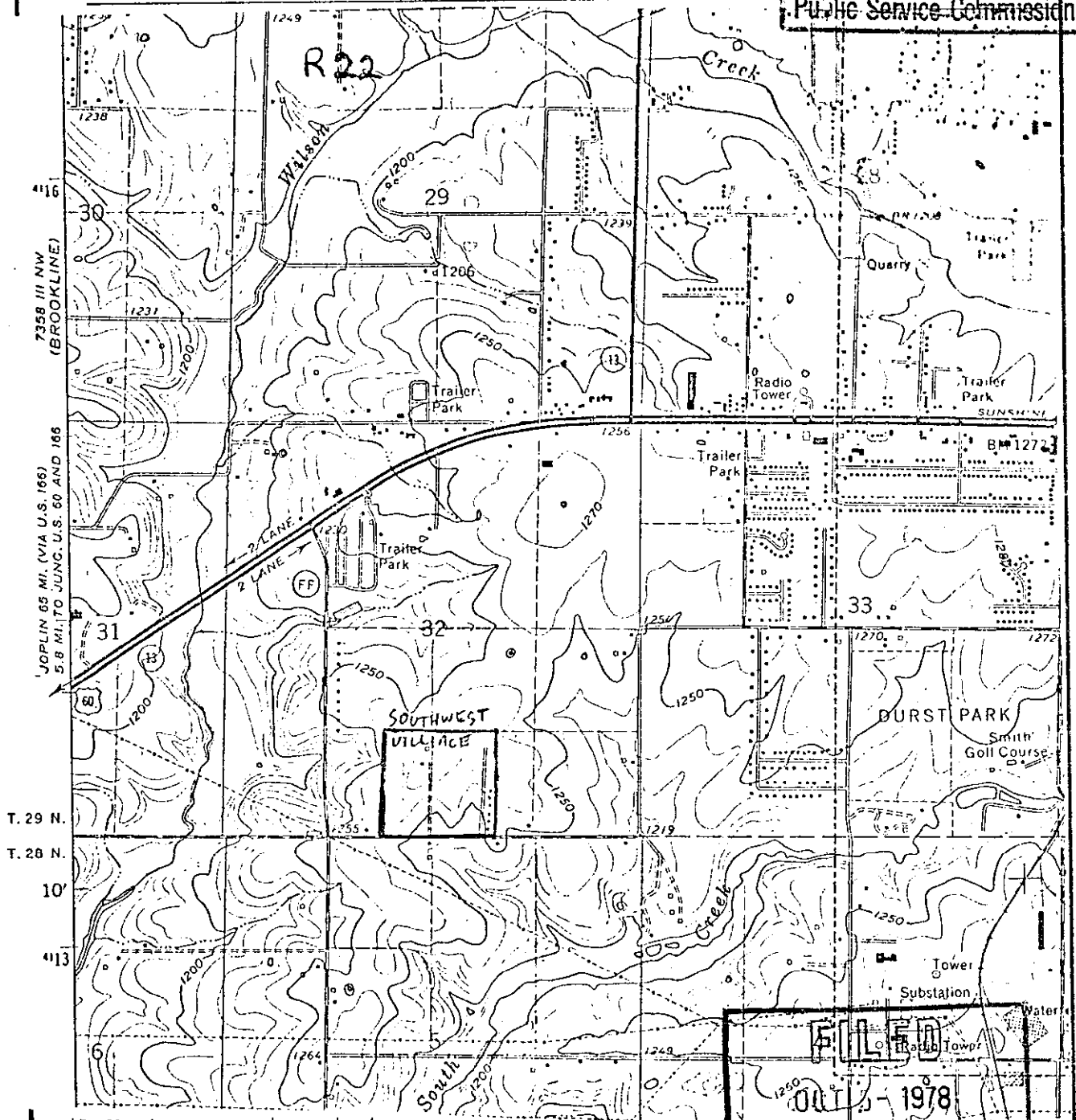

\*Indicates new rate or text

+Indicates change

**Public Service Commission**

DATE OF ISSUE 9/5/78  
month day year

DATE EFFECTIVE 10 / 5 / 78  
month day year

ISSUED BY Stephen Johnson  
name of officer

Secretary

2433 N. Gresham  
address

FORM NO. 13

P.S.C.MO. No. 11st ~~XXXXXX~~SHEET No. 1Cancelling P.S.C.MO. No. 1~~Revised~~~~Original~~~~Revised~~SHEET No. 1

SOUTHWEST VILLAGE WATER COMPANY

For Greene County, Missouri

Name of Issuing Corporation

Community, Town or City

GENERAL WATER SERVICE

RECEIVED

OCT 14 1980

Availability

Any customer adjacent to the Company's water distribution mains using standard water service, except those customers using water for cooling, condensing and/or air conditioning purposes.

Price Schedule

## Residential Rate:

Customer Charge \$3.91 per month  
Usage Charge \$1.47 per 1000 gallons

Delayed Payment Clause

Bills will be made out and distributed at monthly intervals. Bills will be rendered net, bearing last date on which payment is due; namely, twenty-one (21) days after date distributed.

FILED

DEC -1 1980

Public Service Commission

\*Indicates new rate or text  
+Indicates change

DATE OF ISSUE November 1, 1980

month day year

DATE EFFECTIVE December 1, 1980

month day year

ISSUED BY

*Stephen J. Johnson*  
name of officer

*Pres.*  
title

2433 North Glenstone  
address

Springfield, Missouri

FORM NO. 13 P.S.C.MO. No. 1 { Original } SHEET No. 1  
{ Revised }  
Cancelling P.S.C.MO. No. \_\_\_\_\_ { Original } SHEET No. \_\_\_\_\_  
{ Revised }

SOUTHWEST VILLAGE WATER COMPANY For Greene County, Missouri  
Name of Issuing Corporation Community, Town or City

GENERAL WATER SERVICE	
<div>RECEIVED MAR 9 1976 DISCOUNT</div>	
<p><u>Availability</u></p> <p>Any customer adjacent to the Company's water distribution mains using standard water service, except those customers using water for cooling, condensing and/or air conditioning purposes.</p>	
<p><u>Price Schedule</u></p> <p>\$10.00 per month, unmetered.</p>	
<p><u>Delayed Payment Clause</u></p> <p>Bills will be made out and distributed at monthly intervals. Bills will be rendered net, bearing last date on which payment is due; namely, twenty-one (21) days after date distributed.</p>	
<p>CANCELLED</p> <p>DEC - 1 1980</p> <p>BY <u>1st RS#1</u> PUBLIC SERVICE COMMISSION OF MISSOURI</p>	
CaseNo. 18,418	<div>FILED APR 15 1976 Public Service Commission</div>
<p>*Indicates new rate or text +Indicates change</p>	

DATE OF ISSUE March 2, 1976 DATE EFFECTIVE APR 15 1976  
month day year month day year  
ISSUED BY Wayne N. Murphy President, 3765 West Driftwood  
name of officer title address  
Springfield, Missouri

SOUTHWEST VILLAGE WATER COMPANY

For Greene County, Missouri

Name of Issuing Corporation

Community, Town or City

## MUNICIPAL EXCISE TAXES

MAR 3 1976

All excise taxes, including gross receipts taxes, franchise taxes, occupation taxes, license taxes, etc., imposed by a city, town or village or other local governmental agency, shall be included as a separate item in the charges for water purchased by customers located within the limits of the city, town or village imposing such tax, as follows:

1. Taxes based on receipts or income and calculated on a percentage thereof: Where any excise tax imposed by a city, town or village is based on a percentage of gross receipts, revenue or income, a prorata portion of such tax shall be included as a separate item in the customer's statement for water purchased and shall be calculated by applying thereto a percentage factor equivalent to the percentage factor of the tax.
2. Taxes consisting of a stated amount in dollars and cents: When a tax imposed by a city, town or village is a stated amount, a prorata portion of such tax shall be included as a separate item in the customer's statement for water purchased by him, and shall be calculated by applying thereto the same percentage factor as the total annual amount of the tax bears to the gross receipts of the Company from sales of water during the preceding calendar year to customers located within the taxing municipality.

Case No. 18,418

FILED

APR 15 1976

Public Service Commission

\*Indicates new rate or text

+Indicates change

APR 15 1976

DATE OF ISSUE March 2, 1976

month day year

DATE EFFECTIVE ~~April 5, 1976~~

month day year

ISSUED BY Wayne N. Murphy

name of officer

President,

title

3765 West Driftwood

address

Springfield, Missouri

SOUTHWEST VILLAGE WATER COMPANY  
Name of Issuing CorporationFor Greene County, Missouri  
Community, Town or City

## RULES AND REGULATIONS

MAR 3 1976

General:Missouri  
Public Service Commission

Rules applicable other than set out in this schedule will be in conformance with those prescribed by the Missouri Public Service Commission in its General Order No. 21.

1. Applications:

Parties desiring water service will be required to make application in writing for same.

2. Deposits:

A deposit or suitable guarantee to cover the payment of bills may be required from all new customers or those who are disconnected for violation of rules or non-payment equal to estimated service bills for a period of one (1) billing period plus thirty (30) days or not less than \$20.00. The Company shall pay 6% interest per annum on deposits.

3. Payments:

Bills will be rendered by the Company to the customer monthly in accordance with the applicable rate. Such bills are payable at the office of the Company within the period stated thereon. Failure of the customer to receive bill shall not, however, relieve him from the obligation of paying the amount owed by him to the Company. It is the intent that the consumer shall call at the office of the Company for the statement when not receiving same.

Case No. 18,418

\*Indicates new rate or text

+Indicates change

FILED

APR 15 1976

Public Service Commission

APR 15 1976

DATE OF ISSUE March 2, 1976  
month day yearDATE EFFECTIVE March 2, 1976  
month day yearISSUED BY Wayne N. Murphy  
name of officerPresident 3765 West Driftwood  
title address  
Springfield, Missouri

Southwest Village Water Company  
Name of Issuing CorporationFor Greene County, Missouri  
Community Town of CityRules and Regulations

OCT 2 1978

3. Payments: (Continued)MISSOURI  
Public Service Commission

After giving a domestic water consumer five (5) days written notice and any other consumer forty-eight (48) hours written notice that he is in arrears in the payment of bills rendered by the Company for service or he has failed to comply with the terms of the contract, agreement, or the Rules and Regulations contained herein; the Company may discontinue all service supplied to such consumer. At least twenty-four hours preceding discontinuance of service, the utility shall make reasonable efforts to contact the customer by telephone to advise the customer of the pending action and what steps must be taken to avoid discontinuance. In case the Company discontinues his service for any of these causes or is, through the fault of the consumer, prevented from supplying water according to the provisions of the contract and agreement as a minimum payment for the same. Also, in case the Company discontinues its water service for any of these causes, it shall require a charge of twenty (\$20.00) Dollars for the cost of each reconnection before water is again supplied to the consumer. Temporary, turn off and on at curb stop, for the consumers repairing convenience, shall be subject to a service charge not to exceed twenty (\$20.00) Dollars.

All bills for service shall be due and payable within twenty-one (21) days from the mailing or delivery thereof, and consumers whose bills are not so paid shall be considered in arrears.

4. All customers shall prevent unnecessary waste of water by keeping their faucets, valves and other appurtenances in good repair and accessible at all reasonable times to the Company's employees.

\*Indicates new rate or text

+Indicates change

Case No. 18,418

OCT 5 - 1978  
Public Service CommissionDATE OF ISSUE October 5, 1978DATE EFFECTIVE November 5, 1978

ISSUED BY

name of officer

Secretary

title

2433 N. Glenstone

address

SOUTHWEST VILLAGE WATER COMPANY

For Greene County, Missouri

Name of Issuing Corporation

Community, Town or City

## RULES AND REGULATIONS

MAR 3 1976

3. Payments: (Continued)MISSOURI  
Public Service Commission

After giving a domestic water consumer five (5) days written notice and any other consumer forty-eight (48) hours written notice that he is in arrears in the payment of bills rendered by the Company for service or he has failed to comply with the terms of the contract, agreement, or the Rules and Regulations contained herein, the Company may discontinue all service supplied to such consumer. At least twenty-four hours preceding discontinuance of service, the utility shall make reasonable efforts to contact the customer by telephone to advise the customer of the pending action and what steps must be taken to avoid discontinuance. In case the Company discontinues his service for any of these causes or is, through the fault of the consumer, prevented from supplying water according to the provisions of the contract and agreement, then there shall forthwith become due and payable to the Company as liquidated damages, and not as a penalty, the amount remaining unpaid, and also the amount which is guaranteed by the contract and agreement as a minimum payment for the same. Also, in case the Company discontinues its water service for any of these causes, it shall require a charge of Four (\$4.00) Dollars for the cost of each reconnection before water is again supplied to the consumer. Temporary, turn off and on at curb stop, for the consumers repairing convenience, shall be subject to a service charge not to exceed Four (\$4.00) Dollars.

CANCELLED

NOV 5 1978

BY 15+ RS 3.1

PUBLIC SERVICE COMMISSION  
OF MISSOURI

All bills for service shall be due and payable within twenty-one (21) days from the mailing thereof, and consumers whose bills are not so paid shall be considered in arrears.

4. All customers shall prevent unnecessary waste of water by keeping their faucets, valves and other appurtenances in good repair and accessible at all reasonable times to the Company's employees.

\*Indicates new rate or text

+Indicates change

Case No. 18,418

APR 15 1976

PUBLIC SERVICE COMMISSION

APR 15 1976

DATE OF ISSUE March 2, 1976  
month day yearDATE EFFECTIVE April 3, 1976  
month day yearISSUED BY Wayne N. Murphy  
name of officerPresident 3765 West Driftwood  
title address  
Springfield, Missouri



SOUTHWEST VILLAGE WATER COMPANYFor Greene County, Missouri

Name of Issuing Corporation

Community, Town or City

## RULES AND REGULATIONS

5. Employees or agents of the Company shall have access at all reasonable hours to the premises supplied, for the purpose of making necessary examination of plumbing, meter reading, installing or removing meters or for any other reasons deemed necessary by the Company.
6. The point of delivery of water by the Company will be at the curb or property line curb cock.
7. Customer's service line, from property line to house or building, shall have an inside diameter of at least 3/4 inch and shall be of material considered least susceptible to corrosion.
8. Each water service line, applicable above, must be placed in a trench separate from any other utility services.
9. Where the customers service pipe is extended into any building or residence, a brass or bronze stop and waste cock of approved pattern and make shall be installed on the service pipe, at, or immediately beyond the point where such service pipe enters the building. This stop and waste must be accessible to the occupant and the Water Company, and is to be in good repair at all times at the expense of such owner or customer.
10. Taps and service pipes will not be installed at or for vacant lots or in advance of building requirements. Plans and specifications must accompany application of service when requested by the Company.
11. Separate premises must have separate service pipes, curb cocks and curb boxes.

Case No. 18,418

\*Indicates new rate or text

+Indicates change

FILED

APR 15 1976

Public Service Commission

DATE OF ISSUE March 2, 1976  
month day yearDATE EFFECTIVE APR 15 1976  
month day yearISSUED BY Wayne N. Murphy,  
name of officerPresident, 3765 West Driftwood  
title addressSpringfield, Missouri



SOUTHWEST VILLAGE WATER COMPANY  
Name of Issuing CorporationFor Greene County, Missouri  
Community, Town or City

RECEIVED

## RULES AND REGULATIONS

MAR 3 1976

Public Service Commission

12. The Company shall use reasonable diligence in providing a regular and uninterrupted supply of water, but in case the supply of water is interrupted by reason of strike, riot, invasion, storm, fire, accident, breakdown, legal process, state or municipal interference or any cause beyond its control the Company shall not be liable for damage to the consumer for interruptions in service due to any of the aforesaid causes.
13. The manager of the Water Company shall be authorized to regulate or limit, any unusual, unnecessary or wasteful use of water requiring flows of water, where such use of water may affect service to other customers, and to restrict or regulate the quantity of water used by customers in case of scarcity or whenever in his judgment an emergency affecting public health and welfare may require such restrictions.
14. Discontinuance of Service by Consumer: When the premises are to be vacated or there is a change of owner, or occupant or agent, prompt notice must be given to the Company. Service may be discontinued by the customer by giving not less than twenty-four (24) hours notice to the Company during its regular office hours. Final bills for service shall become due and payable at once.

## ALTERATIONS TO RULES AND REGULATIONS

15. The Company reserves the right at any time to alter or amend, or add to its Rules and Regulations, or to substitute other Rules and Regulations therefor, subject to the approval of the Public Service Commission of the State of Missouri.

Case No. 18,418

\*Indicates new rate or text  
+Indicates change

FILED

APR 15 1976

Public Service Commission

DATE OF ISSUE March 2, 1976  
month day yearDATE EFFECTIVE APR 15 1976  
month day yearISSUED BY Wayne N. Murphy  
name of officerPresident, 3765 West Driftwood  
title address  
Springfield, Missouri

Cancelling P.S.C.MO. No. \_\_\_\_\_

{ Original } SHEET No. \_\_\_\_\_  
{ Revised }SOUTHWEST VILLAGE WATER COMPANY For Greene County, Missouri  
Name of Issuing Corporation Community, Town or City

## RULES AND REGULATIONS

16. All contracts for service under the scheduled rates of this Company, except those which make a definite exception, are for yearly periods. The Company may require a contract for a period of more than one year when the customer's requirements for water are unusually large or necessitate considerable special or reserve equipment.
17. The Company will extend, own and maintain all service lines from its mains to the curb or property line at its own expense. Beyond the curb or property line, service lines shall be installed by and at the expense of, and are to be kept in repair by the Customer.
18. EXTENSION OF WATER MAINS: The Company will extend its water mains within its service area on the following terms and conditions:
- (a) Upon application being made for an extension of water main the Company shall determine the necessary size of main and shall make an estimate of the cost of the proposed extension, including pipe, valves, fittings, booster pumps and storage tanks if required, all other materials, and all other costs such as labor, permits, etc., including the Company's expense for supervision, engineering, insurance, tools and equipment, accounting and other overhead expenses.
  - (b) If the estimated cost of the extension is not greater than Seventy-five (\$75.00) Dollars for each original prospective customer, the Company will finance and make the extension without the requirement of any payment.

Case No. 18,418

\*Indicates new rate or text  
+Indicates change

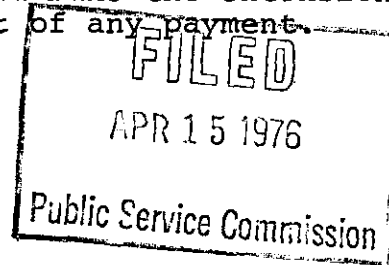
DATE OF ISSUE March 2, 1976  
month day yearDATE EFFECTIVE APR 15 1976  
month day yearISSUED BY Wayne N. Murphy  
name of officerPresident, 3765 West Driftwood  
title address  
Springfield, Missouri

Cancelling P.S.C.MO. No. \_\_\_\_\_

{ Original } SHEET No. \_\_\_\_\_

{ Revised }

SOUTHWEST VILLAGE WATER COMPANY

Name of Issuing Corporation

For Greene County, Missouri  
Community, Town or City

RECEIVED

## RULES AND REGULATIONS

MAR 9 1976

- (c) If the estimated cost of the proposed extension exceeds Seventy-five (\$75.00) Dollars per original prospective customer, the applicant or the applicant's authorized agent shall contract for such extension and shall pay in advance to the Company the estimated cost of the extension less Seventy-five (\$75.00) per customer.
- (d) Should the actual cost of the extension be less than the estimated cost, the Company shall refund the difference as soon as the actual cost has been ascertained.
- (e) Original prospective customers to be considered above, shall be those who sign contracts for one (1) year of water service, and guarantee to the Company that they will take water service at their premises within thirty (30) days after the date water is turned into the main. Estimates of annual revenue shall be made by the Company, and shall be based on the experience of the Company regarding use of water by other customers similarly situated.
- (f) The Company shall make refunds during the first five (5) years after completion of the extension only to the party who has contracted and paid for an extension as follows:
- During the first ten (10) days after completion of the extension and after the stated number of prospective customers are taking water service a refund of Seventy-five (\$75.00) Dollars shall be made for each additional new customer taking service from said extension under a regular yearly contract.
- (g) The sum of the refunds made by the Company shall in no event exceed in the aggregate the amount paid to the Company for the extension.

Case No. 18,418

\*Indicates new rate or text

+Indicates change

FILED

APR 15 1976

Public Service Commission

DATE OF ISSUE March 2, 1976  
month day yearDATE EFFECTIVE APR 15 1976  
month day yearISSUED BY Wayne N. Murphy,  
name of officerPresident, 3765 West Driftwood  
title address  
Springfield, Missouri

Cancelling P.S.C.MO. No. \_\_\_\_\_

{ Original } SHEET No. \_\_\_\_\_  
{ Revised }SOUTHWEST VILLAGE WATER COMPANY  
Name of Issuing CorporationFor Greene County, Missouri  
Community, Town or City

RECEIVED

## RULES AND REGULATIONS

MAR 3 1976

- (h) No interest shall be paid by the Company on the applicant's payment or on any unrefunded balances.
- (i) At the expiration of said five (5) year period the refund account will be closed and no further refunds will be made.
- (j) Extensions made under this rule shall be and remain the property of the Company.
- (k) The Company reserves the right to further extend its water mains from and beyond each water main extension made under this rule. The applicant or applicant's agent paying for an extension shall not be entitled to any refund for the attaching of customers to any further extension.
- (l) Extensions made under this rule shall be of pipe of such size as is reasonably required to serve the customers to be supplied immediately; provided, however, that such pipe shall in no event be less than four (4) inches in diameter, the exact size to be used to be determined by the Company. If the Company desires to make the extension with pipe of a size larger than four (4) inches, then the additional cost of the larger pipe shall be borne by the Company.

Case No. 18,418

FILED

APR 15 1976

Public Service Commission

\*Indicates new rate or text

+Indicates change

APR 15 1976

DATE OF ISSUE March 2, 1976  
month day yearDATE EFFECTIVE April 15, 1976  
month day yearISSUED BY Wayne N. Murphy  
name of officerPresident 3765 West Driftwood  
title address  
Springfield, Missouri

Cancelling P.S.C.MO. No. \_\_\_\_\_

{ Original } SHEET No. \_\_\_\_\_  
{ Revised }SOUTHWEST VILLAGE WATER COMPANY For Greene County, Missouri  
Name of Issuing Corporation Community, Town or City

## RULES AND REGULATIONS

NOV 27 1978

MISSOURI

Public Service Commission

19. METERS AND METER INSTALLATIONS

- (a) All permanent service connections shall be metered. Company's installed meter shall be the standard for measuring and/or billing water service.
- (b) All meters and meter installations shall be furnished, installed, maintained, and removed by the Company and shall remain its property.
- (c) The Company shall have the right to determine on the basis of the Customer's stated flow requirements the type and size of meter to be installed and location of same. If flow requirements increase or decrease subsequent to installation and a larger or smaller meter is requested by the Customer, the cost of installing such meter shall be borne by the Customer.
- (d) Company shall furnish and install suitable metering equipment for each Customer except where the Customer requests installation in a special setting, in which case the excess cost of installation shall be paid by the Customer.
- (e) All service to any one Customer at one building shall be furnished through a single metering installation. Where a building is occupied by more than one Customer, Company will set as many meters as there are separate applications for service, and will connect the meters to one service line. The Company's meters will be located adjacent to each other unless otherwise approved by the Company. Where service is now supplied through one meter to a location having two or more separate premises, the service shall be considered a multiple service. The Customer may rearrange piping, at his own expense, so as to separate the multiple service and permit the Company to install a separate meter for each premise.

Case No. 18,418

\*Indicates new rate or text

+Indicates change

FILED

JAN 1 - 1979

Public Service Commission

DATE OF ISSUE December 1, 1978 DATE EFFECTIVE January 1, 1979  
month day year month day year

ISSUED BY \_\_\_\_\_

name of officer

Secretary

title

2433 N. Glenstone

address

SOUTHWEST VILLAGE WATER COMPANY For Greene County, Missouri  
 Name of Issuing Corporation Community, Town or City

RECEIVED

RULES AND REGULATIONS

NOV 27 1978

MISSOURI

- (f) The meters and meter installations furnished by the Company shall remain its property and the owners of premises wherein they are located shall be held responsible for their safekeeping and liable for any damage thereto resulting from the carelessness of said owner, his agent, or tenant. For failure to protect same against damage, the Company may refuse to supply water until the Company is paid for such damage. The amount of the charge shall be the cost of the meter and appurtenances (including applicable taxes and other incidental charges) and the labor cost necessary to make the meter change.
- (g) Meters will be installed at or near the Customer's property line, it shall be placed in a meter box vault constructed by the Company in accordance with its specifications.
- (h) The Customer shall promptly notify the Company of any defect in, or damage to, the meter, its connections or housing.
- (i) Any change in the location of any existing meter or or meter installation at the request of the Customer shall be made by the Company at the expense of the Customer.
- (j) If additional meters are desired by the Customer for showing subdivision of the supply within a premise, they shall be furnished, installed and maintained at the expense of the Customer.

Case No. 18,418

\*Indicates new rate or text

+Indicates change

FILED

JAN 1 - 1979

Public Service Commission

DATE OF ISSUE December 1, 1978  
 month day year

DATE EFFECTIVE January 1, 1979  
 month day year

ISSUED BY [Signature]  
 name of officer

Secretary 2433 N. Glenstone  
 title address



SOUTHWEST VILLAGE WATER COMPANY For Greene County, Missouri  
Name of Issuing Corporation Community Town or City

## RULES AND REGULATIONS

JAN 27 1978

Rule 20 METER TESTS AND TEST FEESMISSOURI  
Public Service Commission

(a) Any Customer may request the Company to make a ~~special~~ test of the accuracy of the meter through which water is supplied to him. This test will be made in accordance with the standard regulations of the Commission.

(b) The Company reserves the right to remove and test a meter at any time and to substitute another in its place. In case of a dispute involving a question as to the accuracy of the meter, a test will be made by the Company upon the request of the Customer without charge if the meter has not been tested within twelve (12) months preceding the requested test; otherwise a charge will be made as follows if the test indicates meter accuracy within five per cent (5%) or less.

1" or less	\$10.00
Between 1" and 2"	\$15.00
2" or Larger	Actual Cost

(c) A meter test requested by the Customer will be witnessed by the Customer or his duly authorized representative, except for tests of meters larger than two (2") inch inlet which will be conducted by the meter manufacturer and a certified copy of the test provided to the Customer.

(d) If a test shall show an average error of more than five (5%) per cent, billings shall be adjusted as provided in Rule 21.

Case No. 18, 418

FILED

JAN 1 - 1979

Public Service Commission

\*Indicates new rate or text

+Indicates change

DATE OF ISSUE December 1, 1978 DATE EFFECTIVE January 1, 1979  
month day year month day year

ISSUED BY \_\_\_\_\_

name of officer

Secretary  
title2433 N. Glenstone  
address



SOUTHWEST VILLAGE WATER COMPANY For Greene County, Missouri  
Name of Issuing Corporation Community, Town or City

RECEIVED

## RULES AND REGULATIONS

NOV 27 1978

Rule 21 BILL ADJUSTMENTS BASED ON METER TESTS

MISSOURI

Public Service Commission

- (a) Whenever any test by the Company of a meter while in service or upon its removal from service shall show such meter to have an average error or more than five (5%) per cent on the test streams prescribed by the Commission, the Company shall adjust the Customer's bills by the amount of the actual average error of the meter and not the difference between the allowable error and the error as found. The period of adjustment on account of the under-registration will be determined as follows:

- (1) Where the period of error can be shown, the adjustment shall be made for such period.
- (2) Where the period of error cannot be shown, the error found shall be considered to have existed for three months preceding the test.

- (b) If the meter is found on any such test to under-register, the Company may render a bill to the Customer concerned for the estimated consumption not covered by bills previously rendered during the period of inaccuracy as above outlined. Such action shall be taken, however, only in cases where the bill for the estimated inaccuracy amounts to \$2.50 or more, and all such bills shall be conditioned upon the Company's not being at fault for allowing the inaccurate meter to remain in service.

- (c) If the meter is found faster than allowable, the Company shall refund to the Customer concerned any overcharge caused thereby during the period of inaccuracy as above defined. Said refund may, at the Company's option, be in the form of a credit to the Customer's bill.

Case No. 18, 418

\*Indicates new rate or text

+Indicates change

FILED

JAN 1 1979

Public Service Commission

DATE OF ISSUE December 1, 1978  
month day yearDATE EFFECTIVE January 1, 1979  
month day year

ISSUED BY \_\_\_\_\_

name of officer

Secretary

title

2433 N. Glenstone

address

SOUTHWEST VILLAGE WATER COMPANY For Greene County, Missouri  
Name of Issuing Corporation Community, Town or City

## RULES AND REGULATIONS

NOV 27 1978

Rule 22 SERVICE CONNECTION CHARGESMISSOURI  
Public Service Commission

- (a) Service is available to each customer located on Company's mains and pipes that are suitable for supplying the service.
- (b) The charge for supplying 3/4" service shall be \$200.00 and covers installation of meter and meter well only. This is the only charge when no water line has to be laid to supply customer service.
- (c) The charge for running a 3/4" water line off of a company main or pipe to supply a customer service at the time of the service connection shall be: \$3.50 per foot in open ground with a \$100.00 minimum charge, and \$450.00 for tunnelling under a street 30 feet across or less.

Case No. 18,418

\*Indicates new rate or text

+Indicates change

FILED

JAN 1 - 1979

Public Service Commission

DATE OF ISSUE December 1, 1978 DATE EFFECTIVE January 1, 1979  
month day year month day year

ISSUED BY \_\_\_\_\_

name of officer

Secretary

title

2433 N. Glenstone  
address

FORM NO. 13 P.S.C.MO. No. 1 {Original} SHEET No. 4  
~~Revised~~

Cancelling P.S.C.MO. No. \_\_\_\_\_ {Original} SHEET No. \_\_\_\_\_  
~~Revised~~

SOUTHWEST VILLAGE WATER COMPANY For Greene County, Missouri  
Name of Issuing Corporation Community, Town or City

LEGAL DESCRIPTION OF SERVICE AREA

All of the Southwest Quarter (SW 1/4) of the Southeast Quarter (SE 1/4), except the East 495 feet thereof, and all of the East 619.61 feet of the Southeast Quarter (SE 1/4) of the Southwest Quarter (SW 1/4) of Section Thirty-two (32), Township Twenty-nine (29), Range Twenty-two (22); all in Greene County, Missouri, and platted as Southwest Village, Southwest Village First Addition, and Southwest Village Second Addition.

Case No. 18,418

\*Indicates new rate or text  
+Indicates change

FILED

APR 15 1976

Public Service Commission

DATE OF ISSUE March 2, 1976 DATE EFFECTIVE APR 15 1976  
month day year month day year

ISSUED BY Wayne N. Murphy President, 3765 West Driftwood  
name of officer title address  
Springfield, Missouri

SOUTHWEST VILLAGE WATER COMPANY

For Greene County, Missouri

Name of Issuing Corporation

Community, Town or City

## LEGAL DESCRIPTION OF SERVICE AREA

<p style="text-align: center;">CENTER Sec 32, T-29, R-22 ↓</p> <div style="display: flex; justify-content: space-around;"> <div style="border: 1px solid black; padding: 10px; width: 45%;"> <p style="text-align: center;">SE 1/4 SW 1/4</p> </div> <div style="border: 1px solid black; padding: 10px; width: 45%;"> <p style="text-align: center;">SW 1/4 SE 1/4</p> </div> </div> <p style="text-align: center;">619.61'      825'</p> <p style="text-align: center;">1320'</p>		<p style="text-align: center;">APR 15 1976</p> <p style="text-align: center;">Public Service Commission</p>
---------------------------------------------------------------------------------------------------------------------------------------------------------------------------------------------------------------------------------------------------------------------------------------------------------------------------------------------------------------------------------------------------------------------------------------------------------------------------------------------	--	-------------------------------------------------------------------------------------------------------------

All of the Southwest Quarter (SW 1/4) of the Southeast Quarter (SE 1/4), except the East 495 feet thereof, and all of the East 619.61 feet of the Southeast Quarter (SE 1/4) of the Southwest Quarter (SW 1/4) of Section Thirty-two (32), Township Twenty-nine (29), Range Twenty-two (22); all in Greene County, Missouri, and platted as Southwest Village, Southwest Village First Addition, and Southwest Village Second Addition.

\*Indicates new rate or text  
+Indicates change

FILED

APR 15 1976

Public Service Commission

DATE OF ISSUE March 2, 1976  
month day yearDATE EFFECTIVE APR 15 1976  
month day yearISSUED BY Wayne N. Murphy  
name of officerPresident, 3765 West Driftwood  
title address  
Springfield, Missouri