



August 29, 2014

Missouri Public Service Commission
Governor Office Building
200 Madison
P.O. Box 360
Jefferson City, MO 65102-0360

RE: Notice of Election and Withdrawal of Spectra Communications Group, LLC (Missouri) d/b/a CenturyLink Tariffs Pursuant to §392.461, RSMo.

Dear Secretary:

Section 392.461 allows telecommunications companies, upon notice to the Missouri Public Service Commission ("Commission"), to elect to be exempt from the requirement that they offer retail services to residential or business end users only through tariff, and to withdraw such tariffs.

Spectra Communications Group, LLC (Missouri) d/b/a CenturyLink hereby provides notice of its election to be exempt from tariff filing requirements, and of its intent to withdraw the below-listed tariffs, effective October 1, 2014.

General and Local Exchange Tariff PSC MO. NO. 1
Long Distance Message Telecommunications Service Tariff PSC MO. NO 3
Wide Area Telecommunications Service Tariff PSC MO.NO 4
Private Line Service Tariff PSC MO.NO 5
Digital Data Transmission Service Tariff PSC MO. NO 6
Exchange Boundary Maps P.S.C. MO. NO. 7

Compliant with the requirement that electing companies publish generally available retail prices on a website, the *Local Terms of Service* containing the terms, conditions and rates for services previously provided under tariffs will be located on CenturyLink's website at www.CenturyLink.com/tariffs. Affected customers were advised at least thirty days in advance of CenturyLink's withdrawal of the above referenced tariffs and of the website at which *Local Terms of Service* are available.

The withdrawal of tariffs and establishment of *Local Terms of Service* will not result in any changes to customers' current services or rates. CenturyLink will notify customers in advance if future changes are made.

If you have any questions or need additional information, you may call me at (913) 353-7087.

Sincerely,

A handwritten signature in cursive script that reads "Robyn Crichton".

Robyn Crichton

Attachments

cc: Office of Public Counsel (email)
Richard Moore, CenturyLink

MO 14-09 (SCG)

CANCELLED
October 1, 2014
Missouri Public
Service Commission
JI-2015-0080

ROBYN CRICHTON
Tariff Analyst
Robyn.M.Crichton@CenturyLink.com
600 New Century Pkwy
New Century, KS, 66031
Voice: (913) 353-7087

JI-2015-0080

ADOPTION NOTICE A

Effective July 28, 2009, Spectra Communications Group, LLC registered the fictitious name CenturyLink. Effective October 19, 2009, Spectra Communications Group, LLC began operating under the name CenturyLink. As such, Spectra Communications Group, LLC d/b/a CenturyLink, hereby adopts, ratifies, and makes its own, in every respect as if the same had been originally filed by it, all tariffs, schedules, rules, notices, concurrences, schedule agreements, divisions, authorities or other instruments whatsoever, filed with the Public Service Commission, State of Missouri, by or adopted by Spectra Communications Group, LLC.

(N)

By this notice, Spectra Communications Group, LLC d/b/a CenturyLink also adopts and ratifies all supplements or amendments to any of the above schedules, etc., which Spectra Communications Group, LLC has heretofore filed with said Commission.

(N)

Effective March 28, 2001

Spectra Communications Group, LLC d/b/a CenturyTel, hereby adopts, ratifies, and makes its own, in every respect as if the same had been originally filed by it, all tariffs, schedules, rules, notices or other instruments filed with the Public Service Commission, State of Missouri, under the name Spectra Communications Group, LLC currently on file with and approved by the Commission.

Issued: September 21, 2009

Effective: October 21, 2009

CANCELLED
October 1, 2014
Missouri Public
Service Commission
JI-2015-0080

Chantel Mosby
Director - Tariffs
Monroe, Louisiana

FILED
Missouri Public
Service Commission
TN-2010-0092; YI-2010-0214

Spectra Communications Group, LLC
D/b/a CenturyTel

P.S.C. Mo. No. 7
Original Sheet No. Adoption Notice A

Missouri Public
Service Commission

ADOPTION NOTICE A

REC'D FEB 26 2001

Spectra Communications Group, LLC d/b/a CenturyTel, hereby adopts, ratifies, and makes its own, in every respect as if the same had been originally filed by it, all tariffs, schedules, rules, notices or other instruments filed with the Public Service Commission, State of Missouri, under the name Spectra Communications Group, currently on file with and approved by the Commission.

ISSUED: February 26, 2001

EFFECTIVE: March 28, 2001

Kenneth Matzdorff
Chief Operating Officer
Kansas City, MO

Missouri Public
Service Commission
01-437
FILED MAR 28 2001

CANCELLED
October 21, 2009
Missouri Public
Service Commission

TN-2010-0092; YI-2010-0214

APPENDIX B

Spectra Communications Group, LLC
d/b/a CenturyLink

P.S.C MO. NO. 7
1st Revised Title Sheet
Cancels Original Title Sheet

(C)

TITLE SHEET

SPECTRA COMMUNICATIONS GROUP, LLC
D/B/A CENTURYLINK

(C)

EXCHANGE BOUNDARY MAPS

ALL EXCHANGES

Issued: September 21, 2009

Effective: October 21, 2009

CANCELLED
October 1, 2014
Missouri Public
Service Commission
JI-2015-0080

Chantel Mosby
Director - Tariffs
Monroe, Louisiana

FILED
Missouri Public
Service Commission
TN-2010-0092; YI-2010-0214

Spectra Communications Group, LLC
d/b/a CenturyTel

P.S.C. Mo. No. 7
Original Title Sheet

Missouri Public
Service Commission

RECD FEB 26 2001

TITLE SHEET

SPECTRA COMMUNICATIONS GROUP, LLC
D/B/A CENTURYTEL

EXCHANGE BOUNDARY MAPS

ALL EXCHANGES

ISSUED: February 26, 2001

EFFECTIVE: March 28, 2001

Kenneth Matzdorff
Chief Operating Officer
Kansas City, Missouri

Missouri Public
Service Commission
01-437
FILED MAR 28 2001

CANCELLED
October 21, 2009
Missouri Public
Service Commission

TN-2010-0092; YI-2010-0214

APPENDIX C

AMAZONIA EXCHANGE
ANDREW COUNTY
EXCHANGE AREA MAP

ORIGINAL SHEET 1

Missouri Public
Service Commission

REC'D NOV 13 2000

LEGEND

EAB
ZONE
BRA

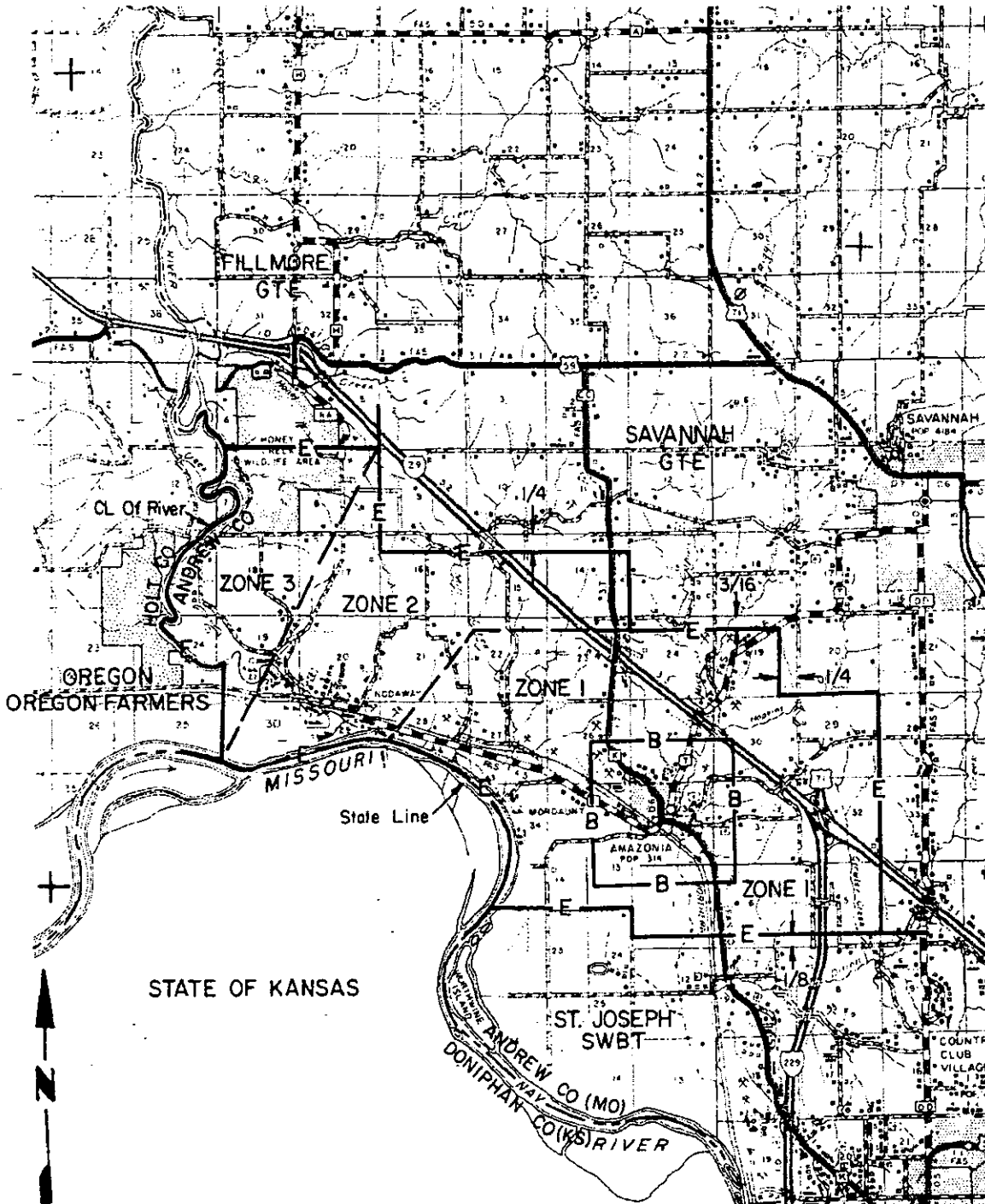
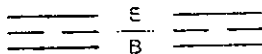

T-60-N

T-59-N

T-58-N

R-37-W

R-36-W

R-35-W

FILED DEC 13 2000

CANCELLED
October 1, 2014

Issued: Nov. 13, 2000

Kenneth Matzdorff
Chief Operating Officer
Kansas City, MO

Effective: Dec. 13, 2000

ANNAPOLIS EXCHANGE
REYNOLDS & IRON COUNTIES
EXCHANGE AREA MAP

REC'D NOV 13 2000 ORIGINAL SHEET 2

EAB _____
BRA _____ B _____

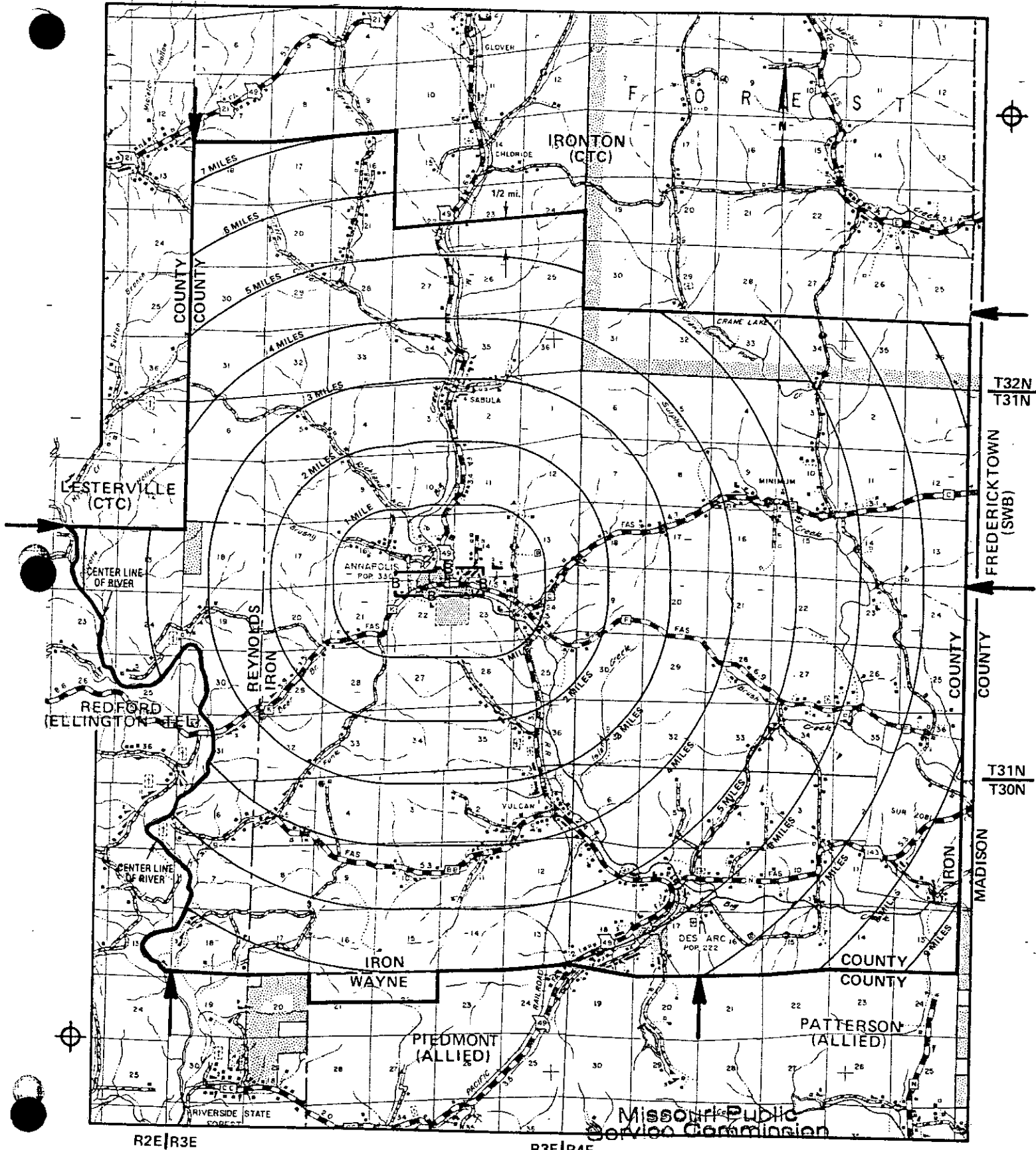

CANCELLED
October 1, 2014
Issued: Nov. 13, 2000
Missouri Public
Service Commission
JI-2015-0080

Kenneth Matzdorff
Chief Operating Officer
Kansas City, MO

FILED DEC 13 2000

Effective: Dec. 13, 2000

REC'D NOV 13 2000

LEGEND
EAB _____
BRA _____ B _____

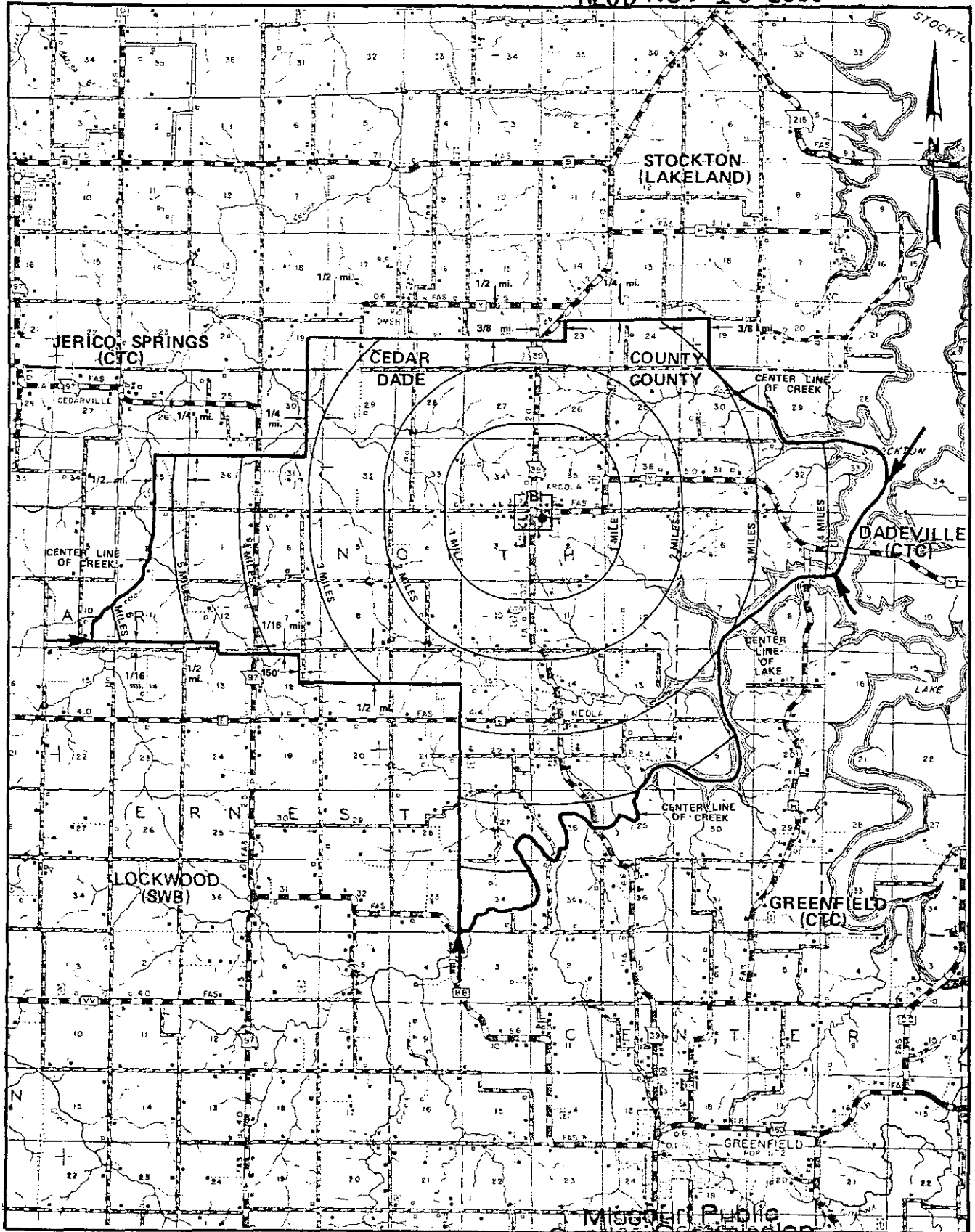

T34N
T33N

T33N
T32N

T32N
T31N

R28W | R27W

R26W

CANCELLED
October 1, 2014
Missouri Public
Service Commission
JI-2015-0080

Kenneth Matzdorff
Chief Operating Officer
Kansas City, MO

Missouri Public
Service Commission
FILED DEC 13 2000

Effective: Dec. 13, 2000

REC'D NOV 19 2000

EAB _____
BRA _____ B _____

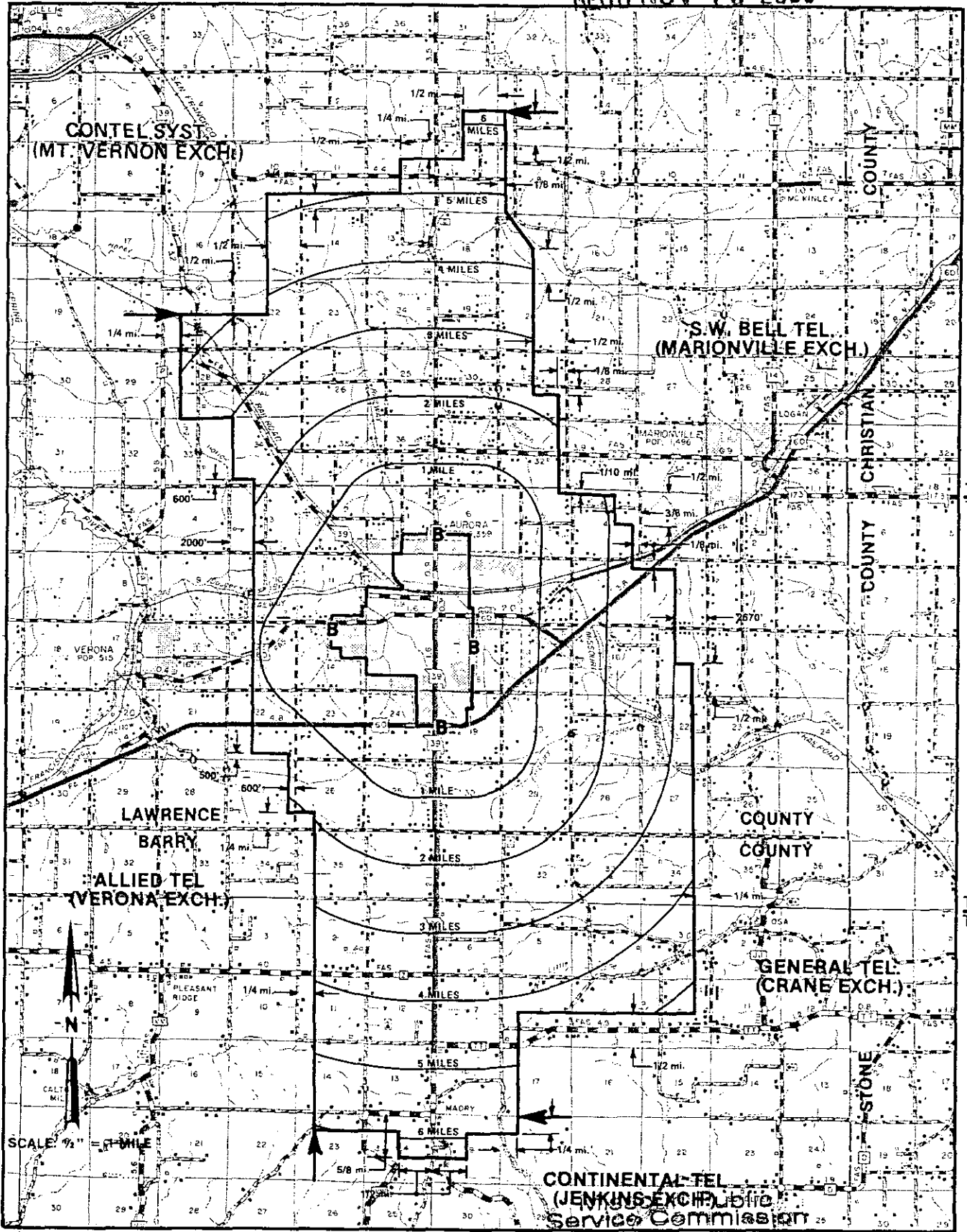

R27W | R26W

R26W | R25W

R25W | R24W

CANCELLED

October 1, 2014 Issued: Nov. 13, 2000

Missouri Public
Service Commission
JI-2015-0080

Kenneth Matzdorff
Chief Operating Officer
Kansas City, MO

FILED DEC 13 2000

Effective: Dec. 13, 2000

AVENUE CITY EXCHANGE
ANDREW COUNTY
EXCHANGE AREA MAP

EAB
ZONE
BRA

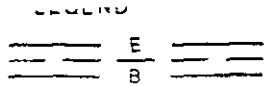

Missouri Public
Service Commission

REC'D NOV 13 2000

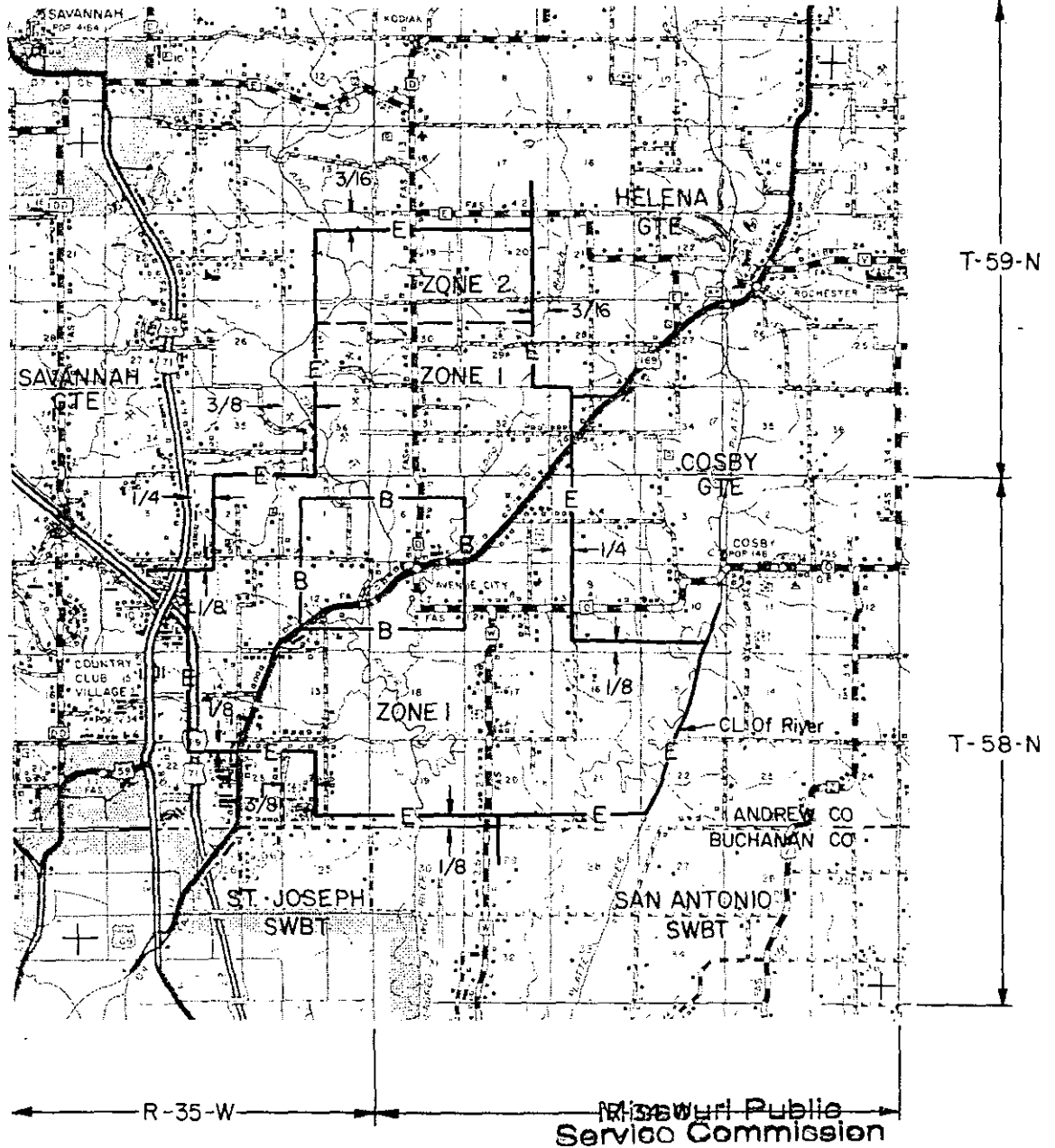

FILED DEC 13 2000

Kenneth Matzdorff
Chief Operating Officer
Kansas City, MO

Effective: Dec. 13, 2000

CANCELLED
October 1, 2014
Missouri Public
Service Commission
JI-2015-0080

Issued: Nov. 13, 2000

EXCHANGE AREA MAP RECD NOV 19 2000

LEGEND

FAB _____
BRA _____

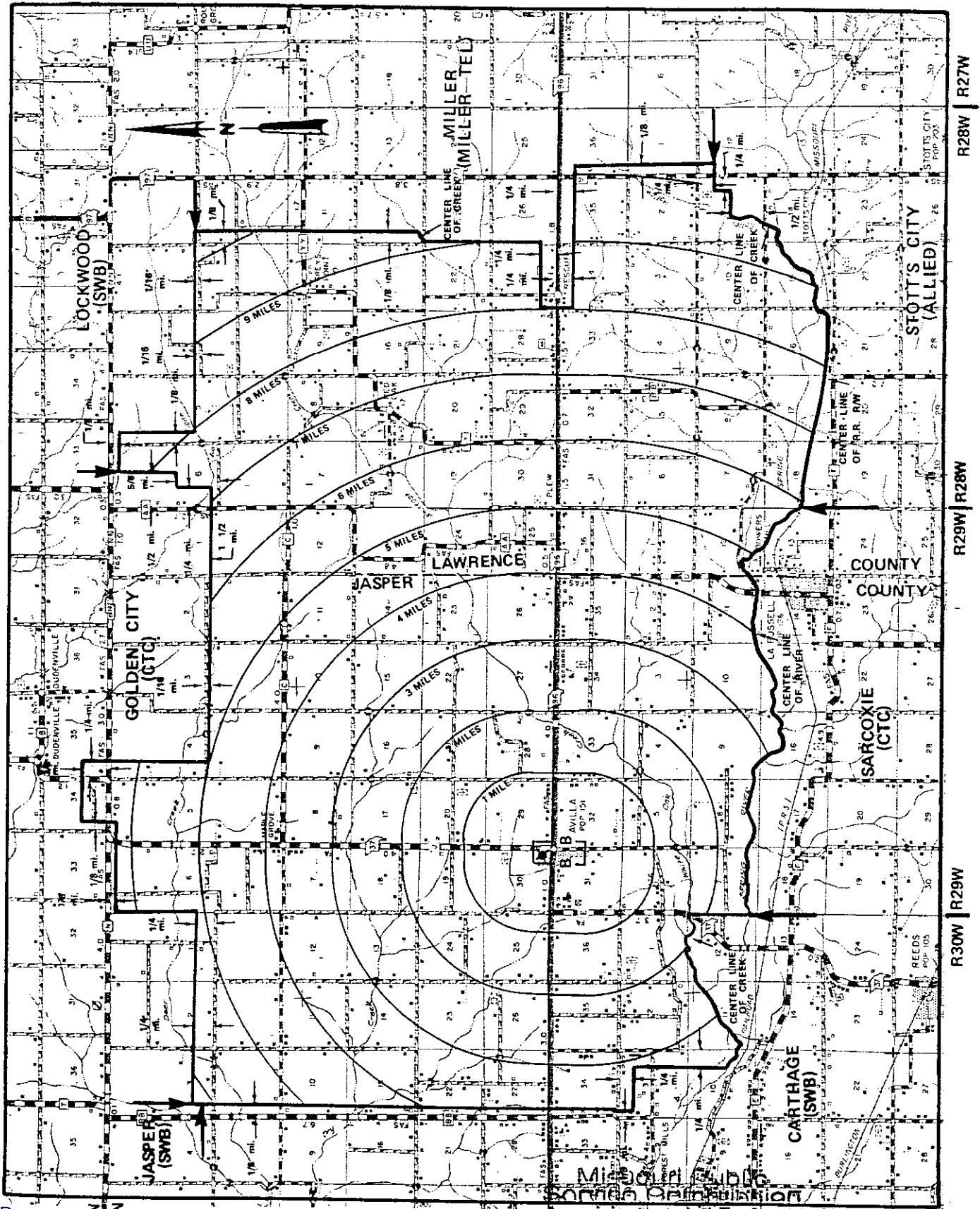

CANCELLED
October 1, 2014
Missouri Public
Service Commission
JI-2015-0080

Issued: Nov. 13, 2000

Kenneth Matzdorff
Chief Operating Officer
Kansas City, MO

FILED DEC 13 2000

Effective: Dec. 13, 2000

REC'D NOV 13 2000

LEGEND

EAB _____
BRA _____ B _____

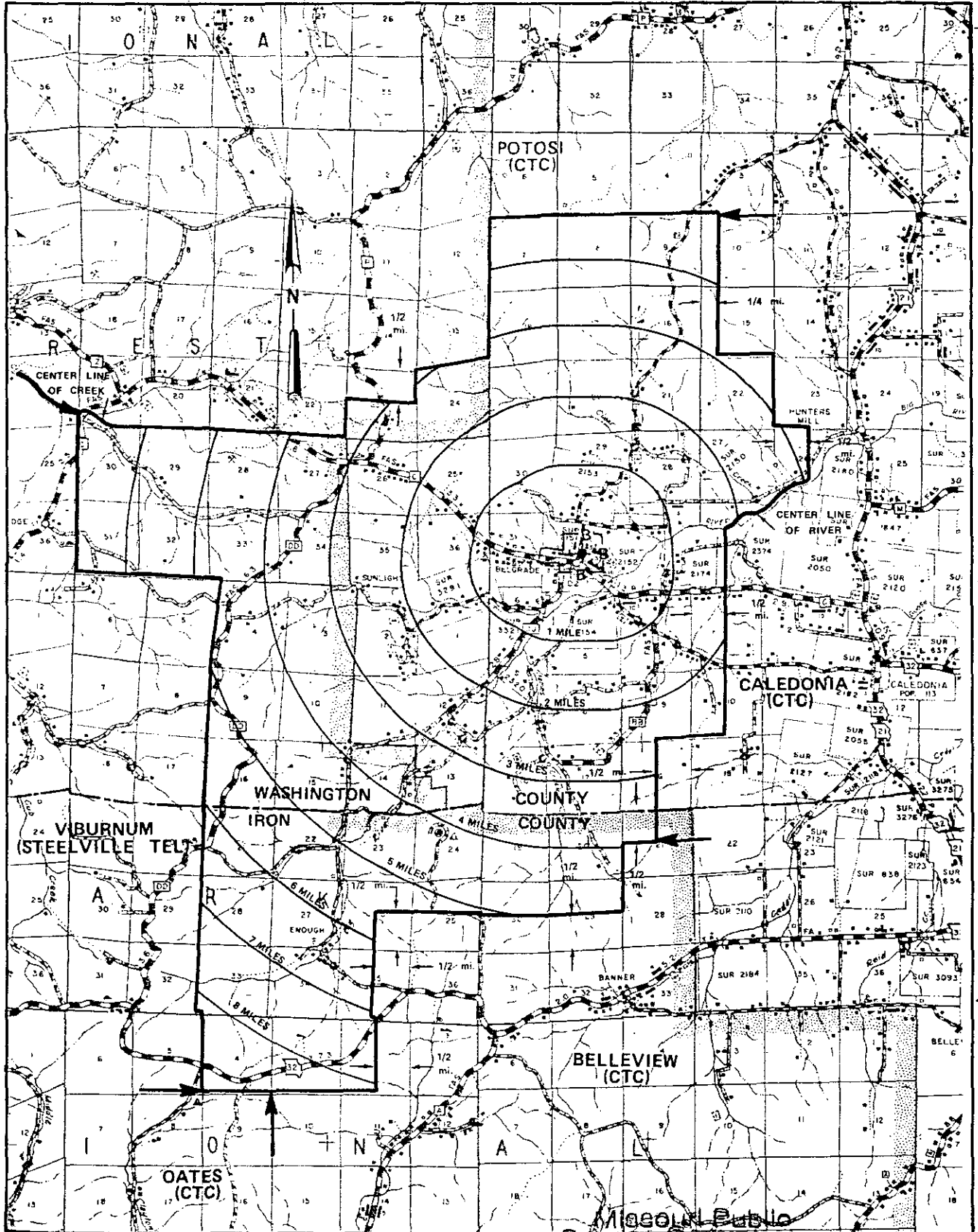

T37N

T36N

T30E

T31E

T36E

T37E

CANCELLED R1W | R1E

R1E | R2E

R2E | R3E

October 1, 2014

Missouri Public Service Commission

Issued: Nov. 13, 2000

Service Commission

JI-2015-0080

Kenneth Matzdorff
Chief Operating Officer
Kansas City, MO

Missouri Public Service Commission
FILED DEC 13 2000

Effective: Dec. 13, 2000

BELLEVUE EXCHANGE
IRON & REYNOLDS COUNTIES
EXCHANGE AREA MAP

ORIGINAL SHEET 8

REC'D NOV 18 2000

LEGEND

EAB _____
BRA _____ B _____

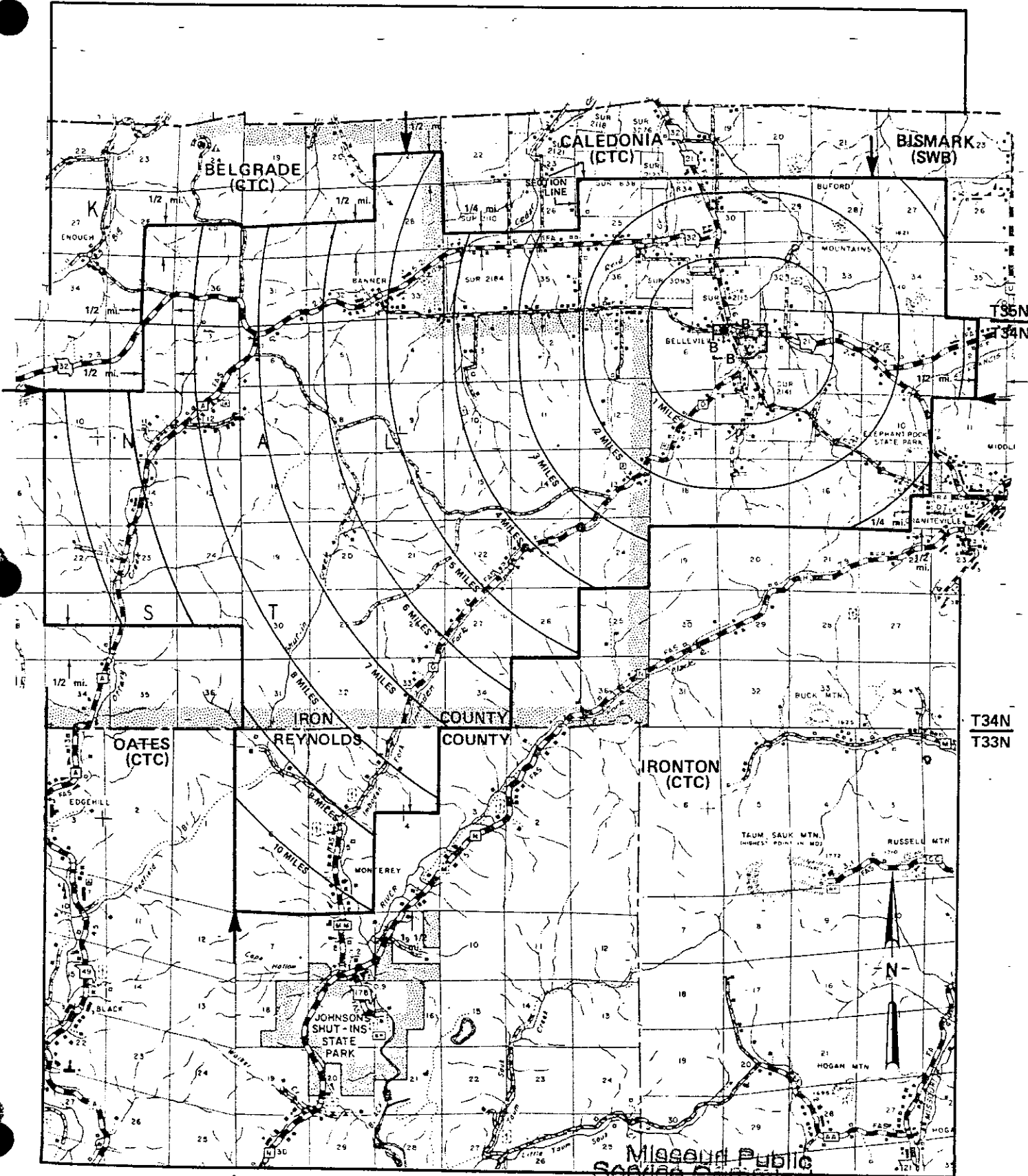

CANCELLED
October 1, 2014
Missouri Public
Service Commission
JI-2015-0080

Issued: Nov. 13, 2000

Kenneth Matzdorff
Chief Operating Officer
Kansas City, MO

FILED DEC 13 2000

Effective: Dec. 13, 2000

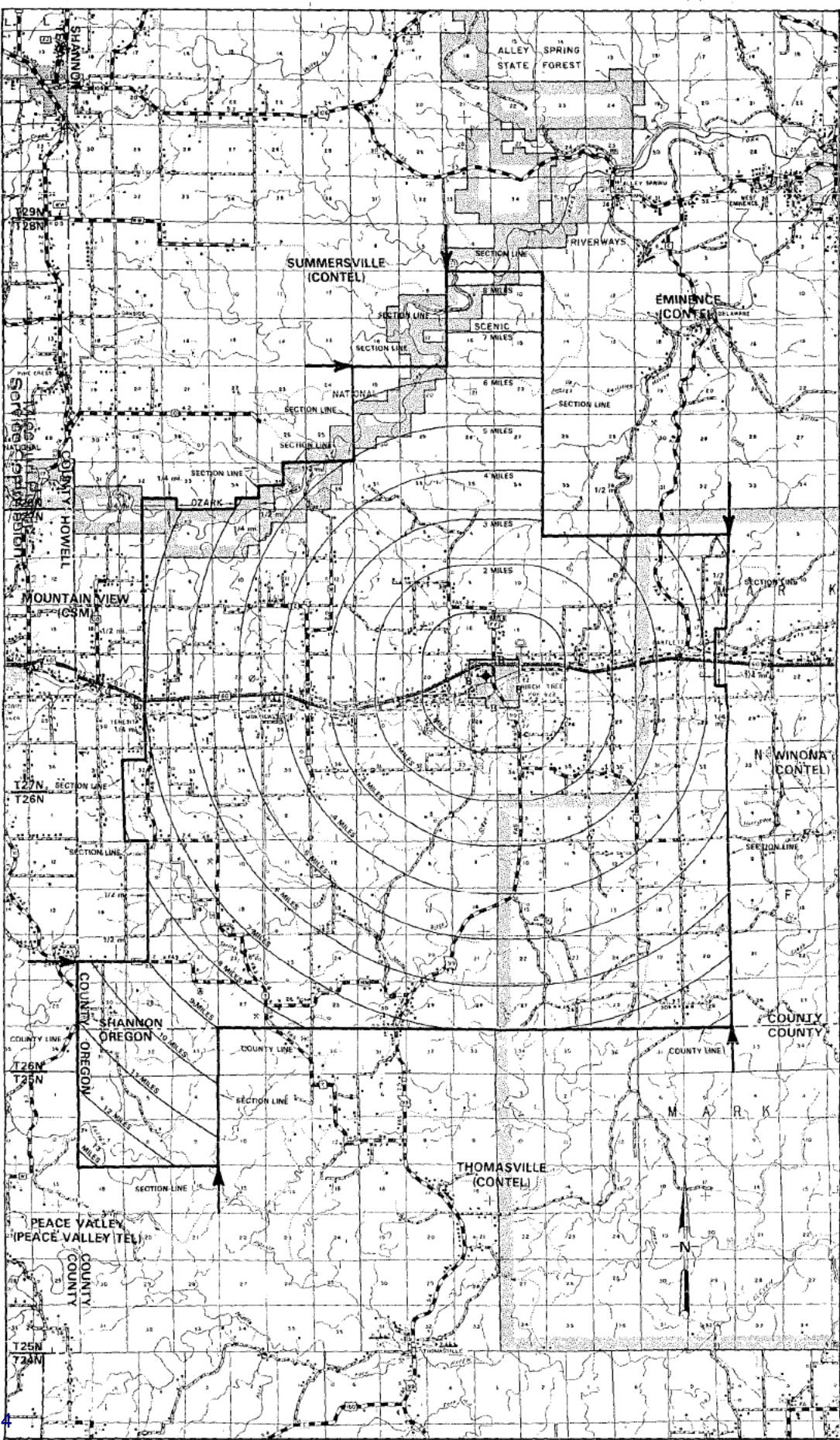

Issued: Nov. 13, 2000

Kenneth Matzdorff
Chief Operating Officer
Kansas City, MO
FILED DEC 13 2000
Effective: Dec. 13, 2000

CANCELLED
October 1, 2014
Missouri Public
Service Commission
JI-2015-0080

R6W

R6W R5W

R5W R4W



Missouri Public
Service Commission

REC'D NOV 13

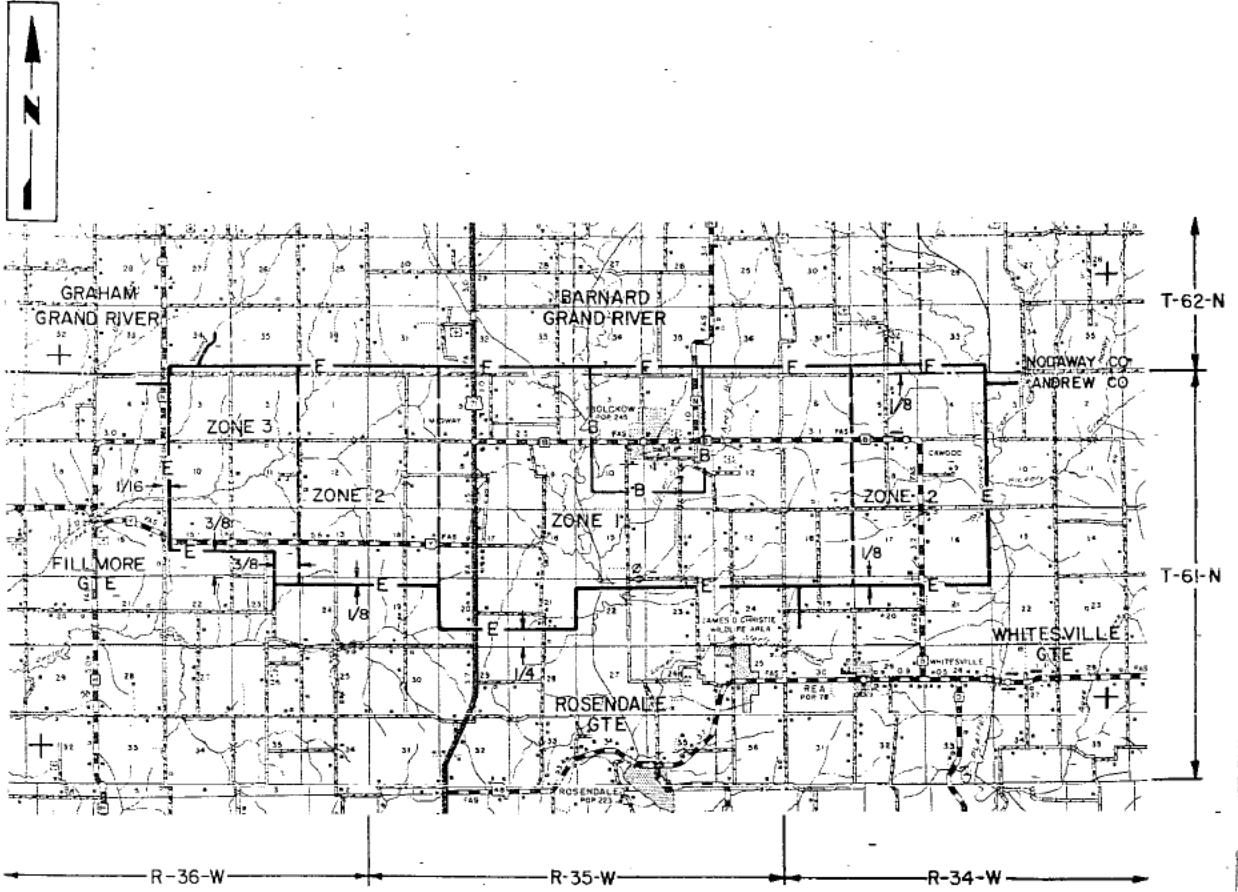

Missouri Public
Service Commission

FILED DEC 13 2000

Kenneth Matzdorff
Chief Operating Officer
Kansas City, MO

Issued: Nov. 13, 2000

Effective: Dec. 13, 2000

REC'D NOV 13 2000

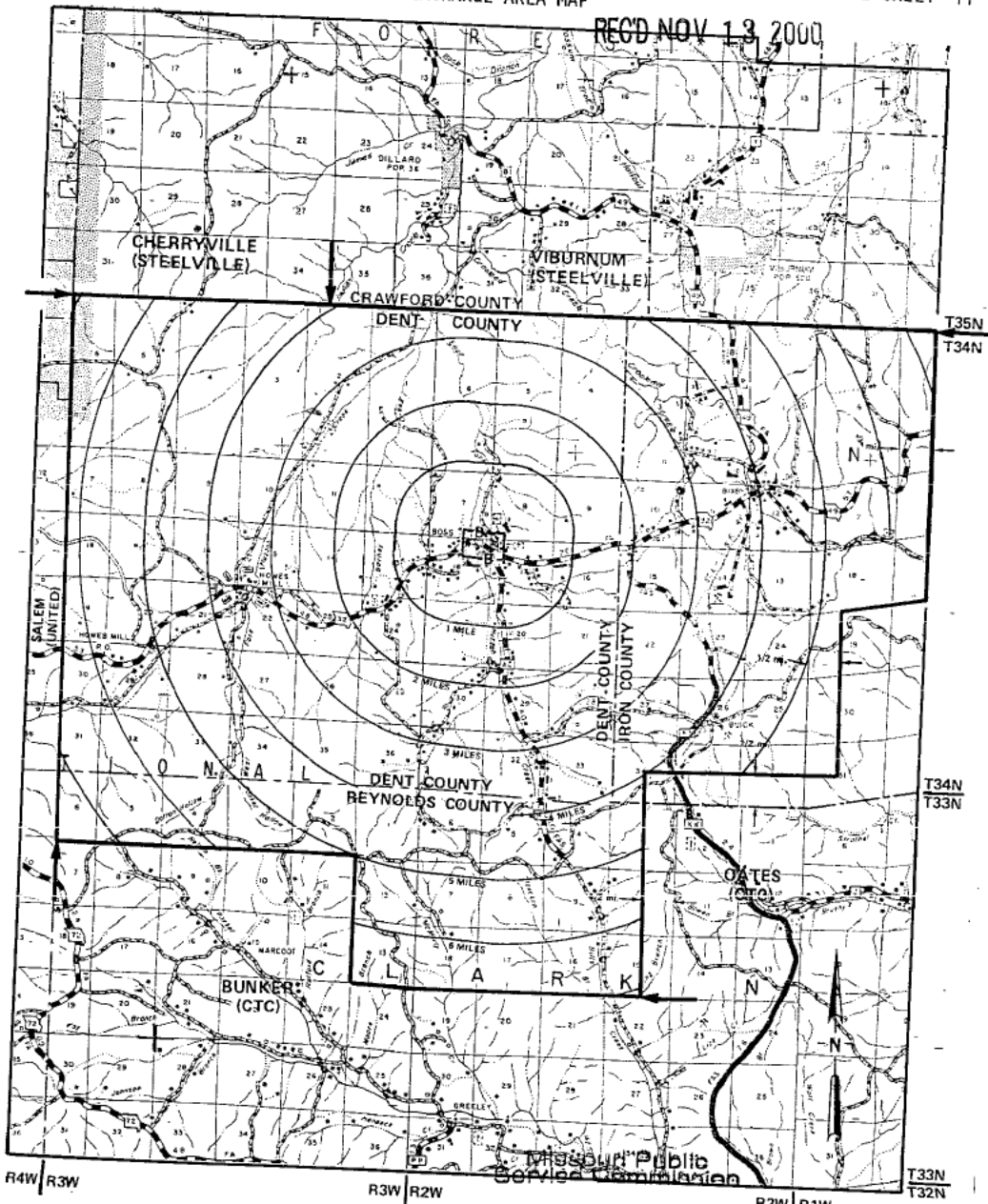

Issued: Nov. 13, 2000

Kenneth Matzdorff
Chief Operating Officer
Kansas City, MO

FILED DEC 13 2000

Effective: Dec. 13, 2000

CANCELLED
October 1, 2014
Missouri Public
Service Commission
JI-2015-0080

EAB
ZONE
BRA

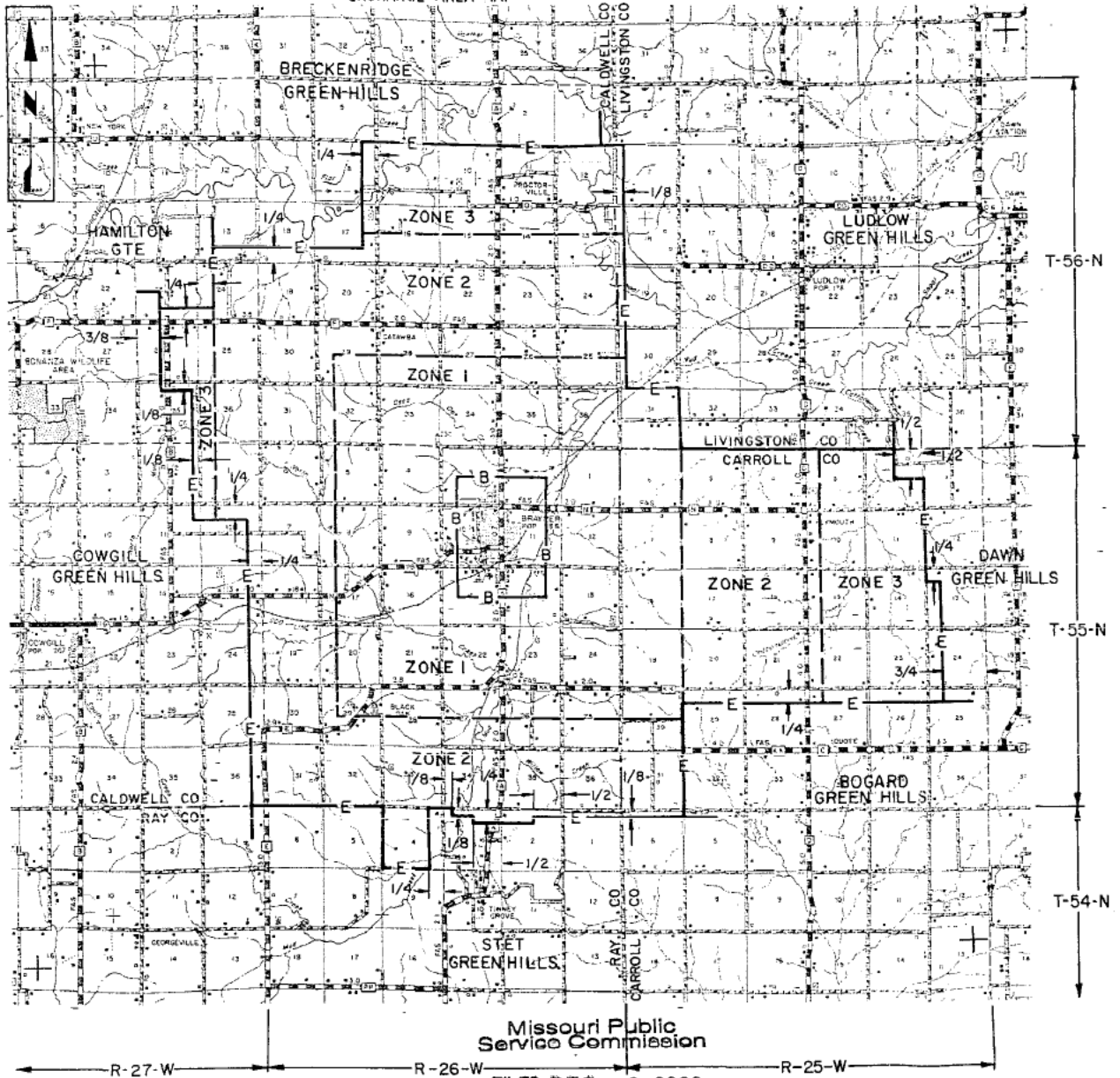

Issued: Nov. 13, 2000

Kenneth Matzdorff
Chief Operating Officer
Kansas City, MO

Missouri Public
Service Commission
FILED DEC 13 2000

Effective: Dec. 13, 2000

REC'D NOV 13 2000

EAS _____
BRA _____ B _____

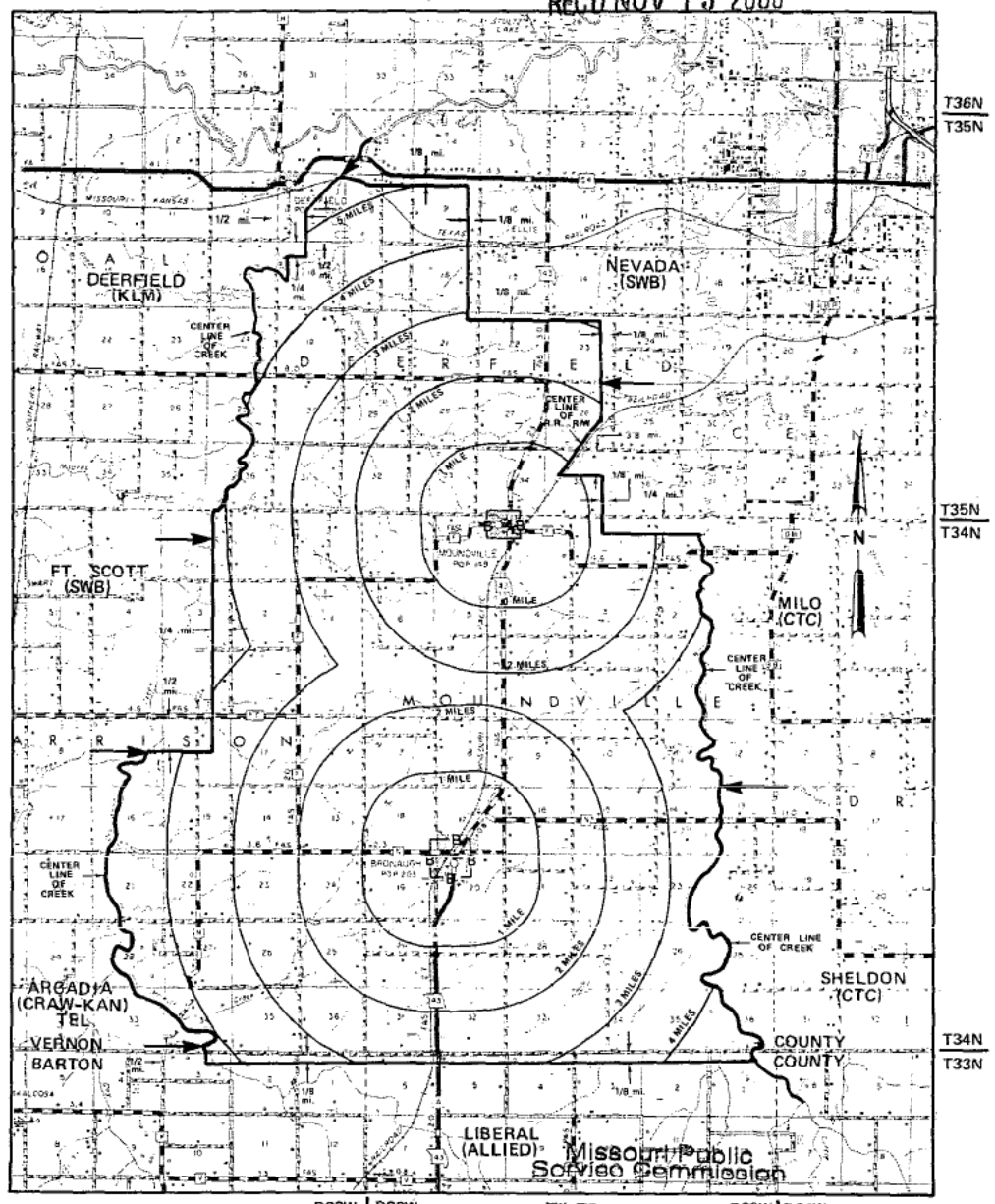

R33W | R32W | R31W
R33W | R32W | R31W

FILED DEC 13 2000

Issued: Nov. 13, 2000

Kenneth Matzdortt
Chief Operating Officer
Kansas City, MO

Effective: Dec. 13, 2000

CANCELLED
October 1, 2014
Missouri Public
Service Commission
JI-2015-0080

REC'D NOV 13 2000

BRUNSWICK EXCHANGE
CHARITON & CARROLL COUNTIES
EXCHANGE AREA MAP

LEGEND

EAB	=====	E	=====
ZONE	=====	B	=====
BRA	=====		=====

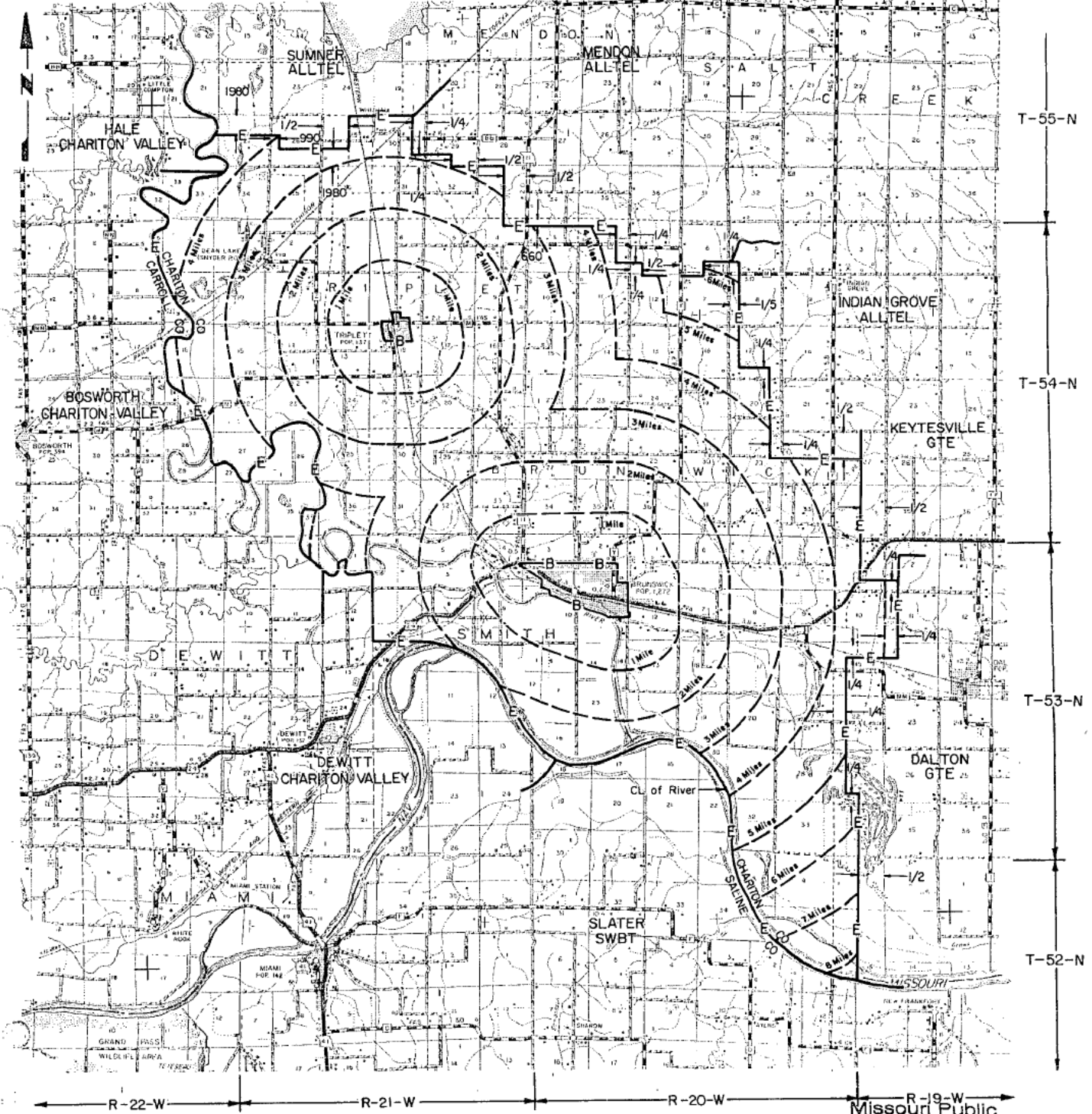

Issued: Nov. 13, 2000

Kenneth Matzdorff
Chief Operating Officer
Kansas City, MO

Effective: Dec. 13, 2000

Missouri Public
Service Commission

FILED DEC 13 2000

CANCELLED
October 1, 2014
Missouri Public
Service Commission
JI-2015-0080

LEGEND

EAB
BRA B

BUNKER EXCHANGE
DENT, SHANNON, & REYNOLDS COUNTIES
EXCHANGE AREA MAP

PSC MO. NO. 7

REC'D NOV 13 2000

Original Sheet 15

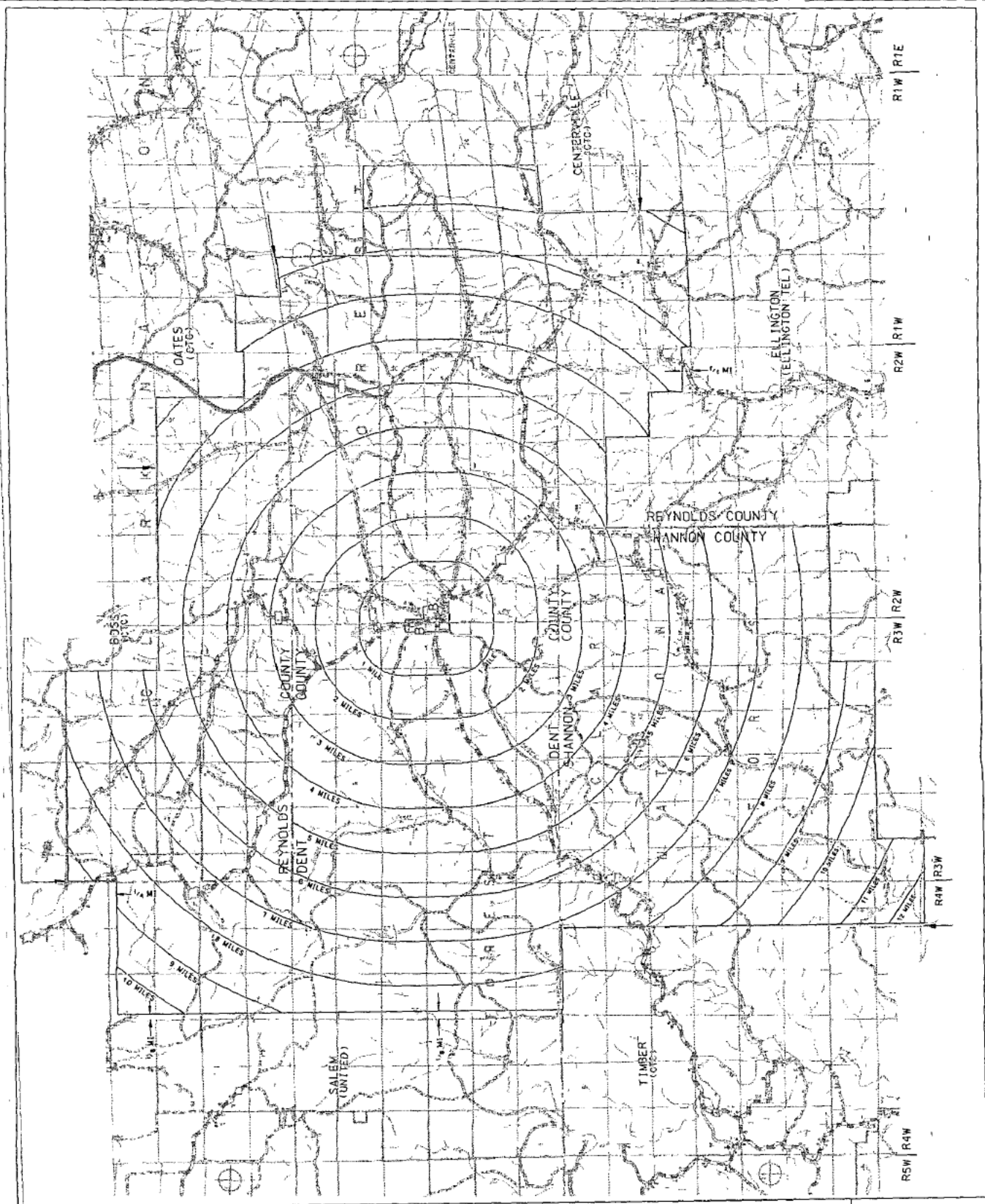

T33N
T32N

T32N
T31N

Missouri Public Service Commission

CANCELLED
October 1, 2014
Missouri Public Service Commission
JI-2015-0080

Kenneth Matzdorff
Chief Operating Officer
Kansas City, MO

Effective Dec. 13, 2000

FILED DEC 13 2000

LEGEND

EAB _____
BRA _____ B _____

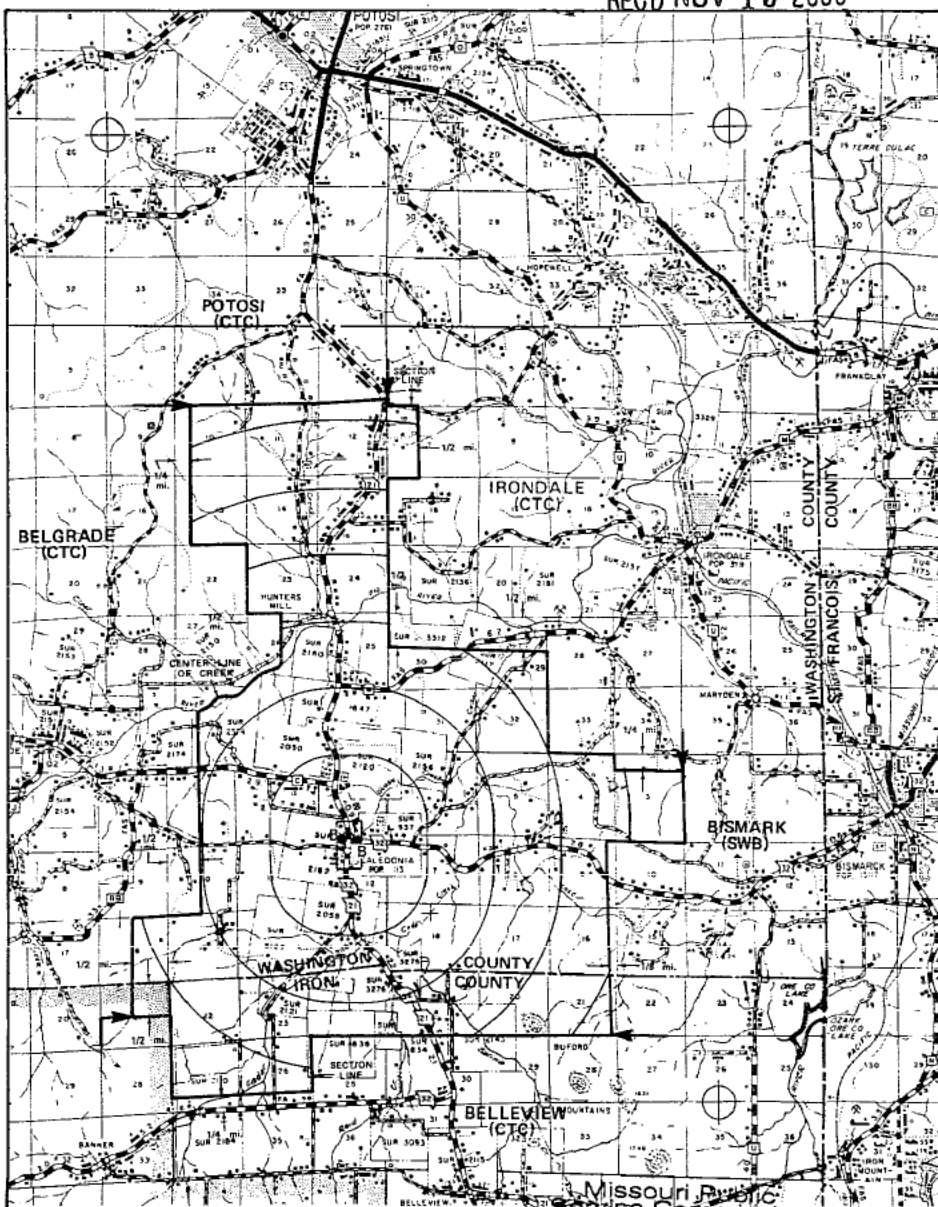

R2E | R3E R3E | R4E

Issued: Nov. 13, 2000

Kenneth Matzdorff
Chief Operating Officer
Kansas City, MO

FILED DEC 13 2000

Effective Dec. 13, 2000

CAMERON EXCHANGE
CALDWELL, CLINTON, DEKALB & DAVIES COUNTIES
EXCHANGE AREA MAP

REC'D NOV 13 2000

LEGEND

EAB	---	E	---
ZONE	---	B	---
BRA	---		---

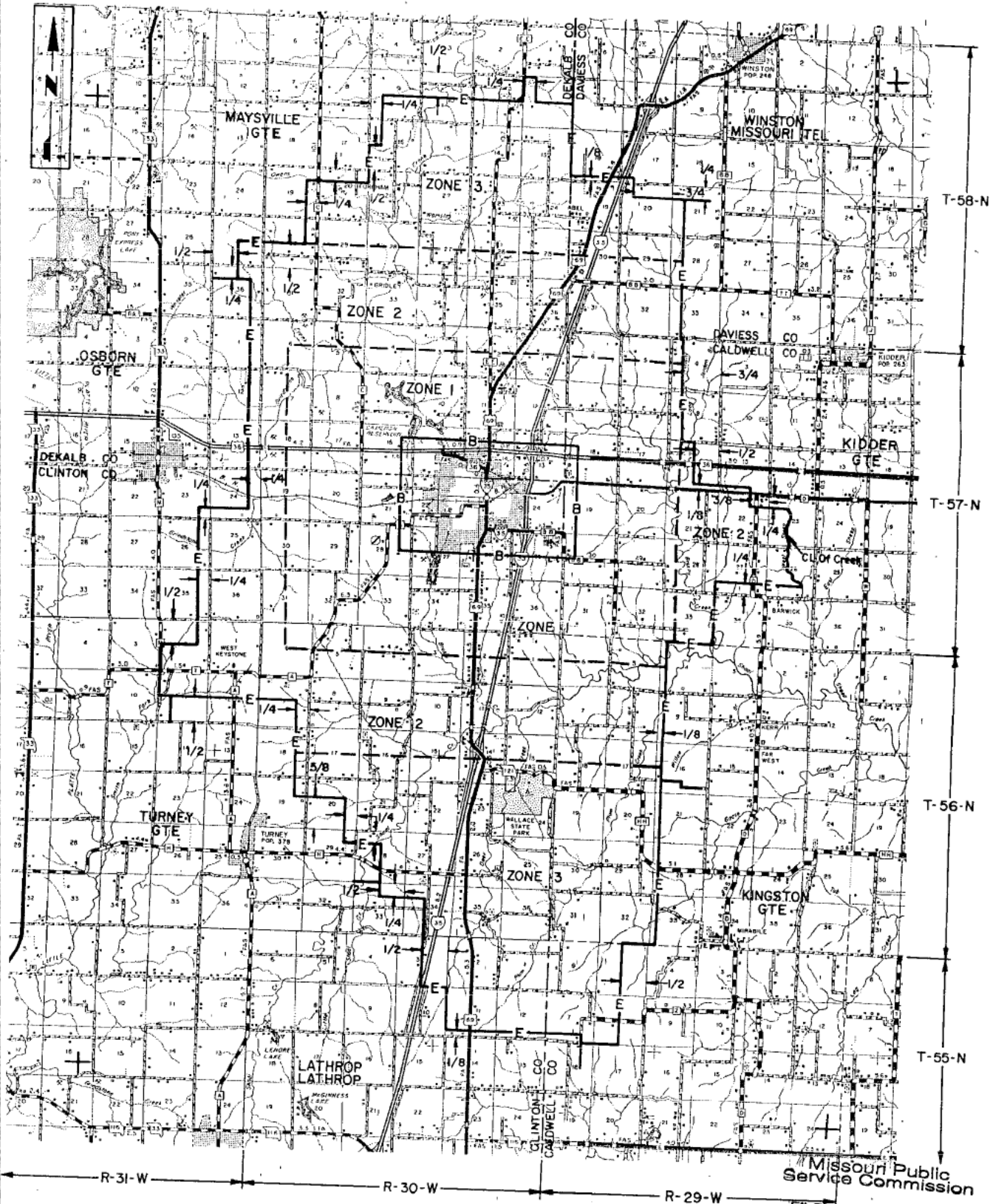

Issued: Nov. 13, 2000

Kenneth Matzdorff
Chief Operating Officer
Kansas City, MO

Effective: Dec. 13, 2000

Missouri Public
Service Commission

FILED DEC 13 2000

CANCELLED
October 1, 2014
Missouri Public
Service Commission
JI-2015-0080

REC'D NOV 19 2000

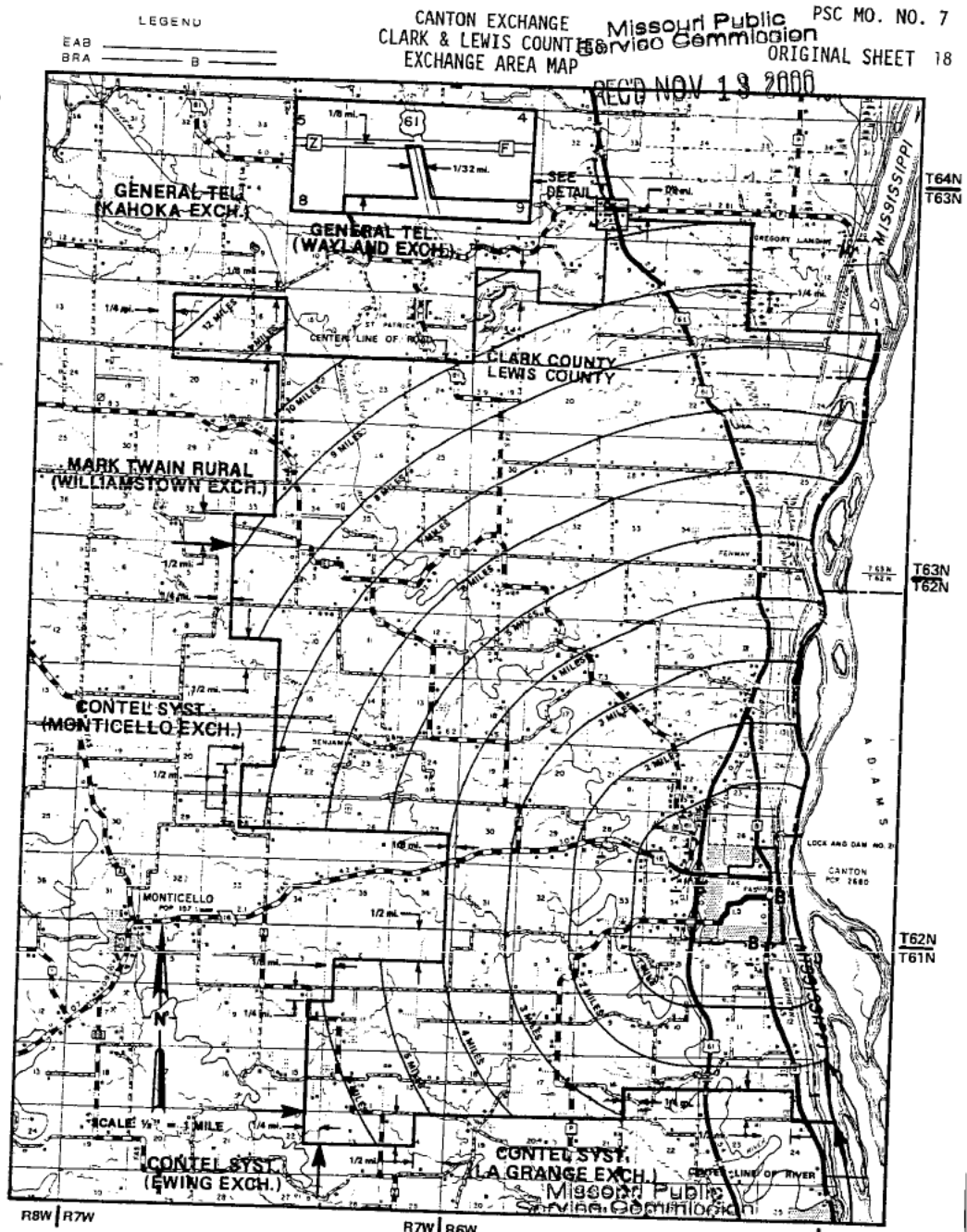

Issued: Nov. 13, 2000

Kenneth Matzdorff
Chief Operating Officer
Kansas City, MO

FILED DEC 13 2000

Effective: Dec. 13, 2000

CANCELLED
October 1, 2014
Missouri Public
Service Commission
JI-2015-0080

LEGEND
EAB _____
BRA _____ B _____

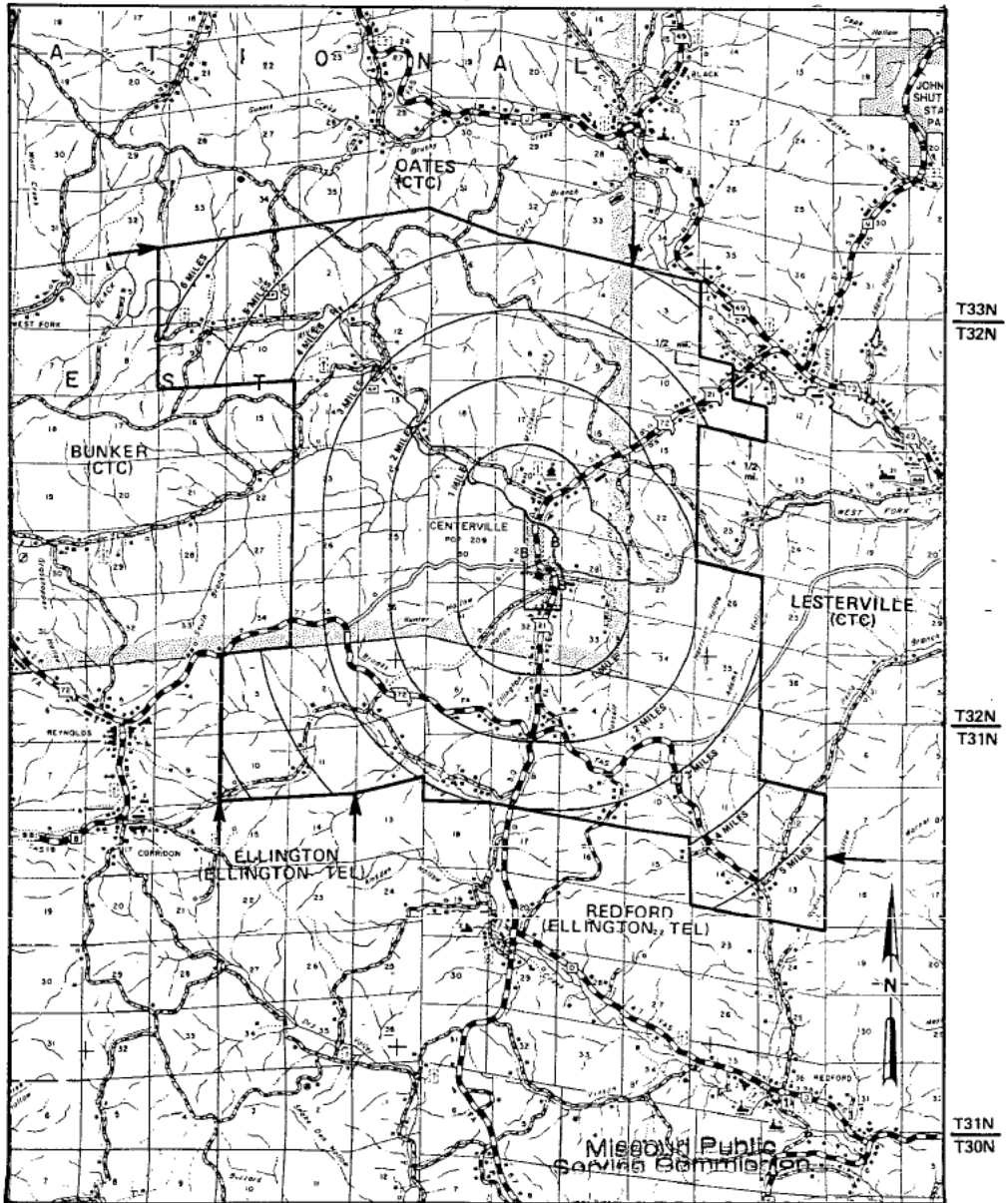

Issued: Nov. 13, 2000

R1W | R1E
Kenneth Matzdorff
Chief Operating Officer
Kansas City, MO

Effective: Dec. 13, 2000

FILED DEC 13 2000

FAR
BFA
LEGEND
SCALE 1/4" = 1 MILE

Missouri Public Service Commission
CLARENCE EXCHANGE
SHELBY, MONROE & MACON COUNTIES
EXCHANGE AREA MAP
NOV 19 ORIGINAL SHEET 20

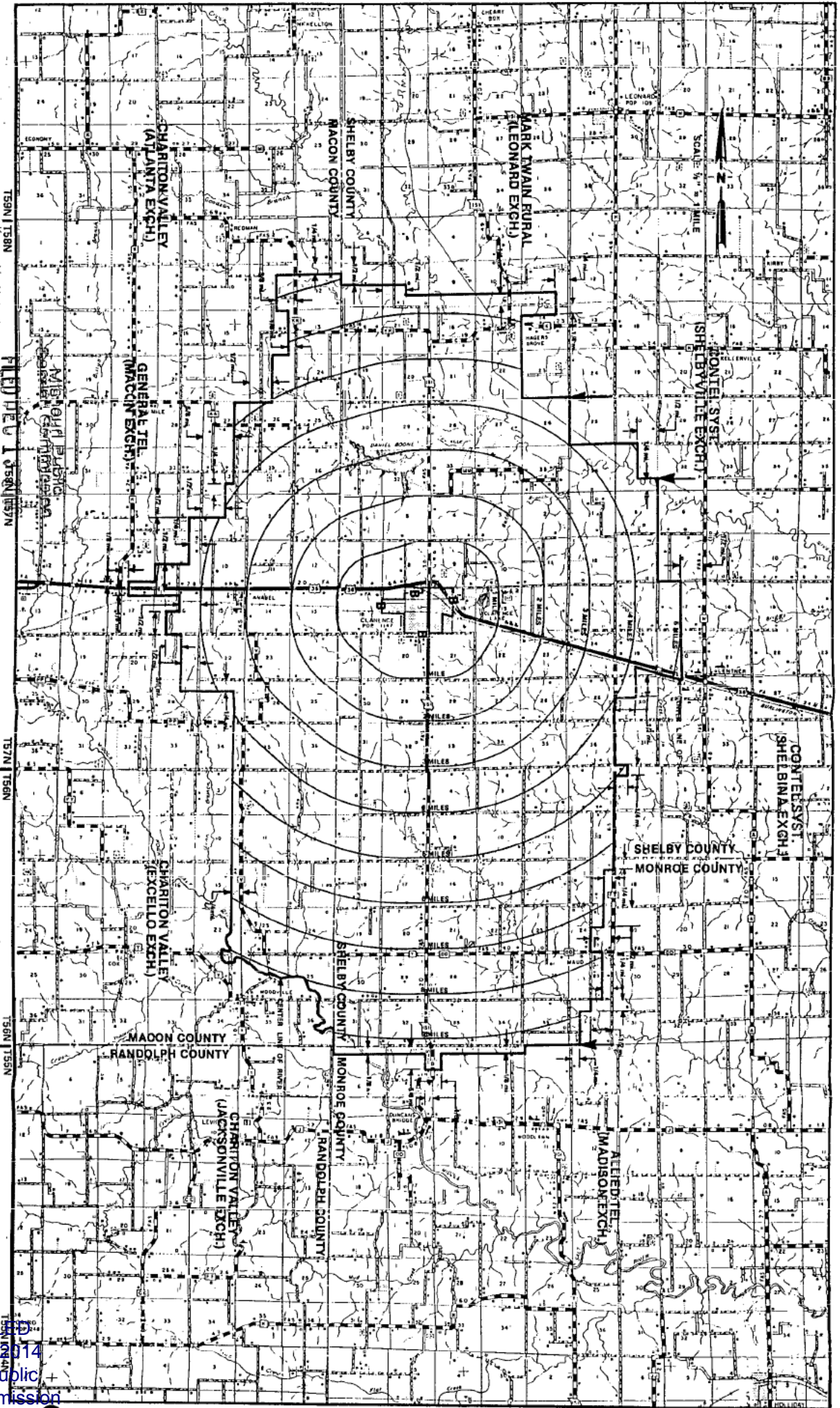

Issued: Nov. 13, 2000

Kenneth Matzdorff
Chief Operating Officer
Kansas City, MO

Effective: Dec. 13, 2000

CANCELLED
October 1, 2014
Missouri Public
Service Commission
JI-2015-0080

REC'D NOV 19 2000

LEGEND

EAB	—	E	—
ZONE	—	B	—
BRA	—		—

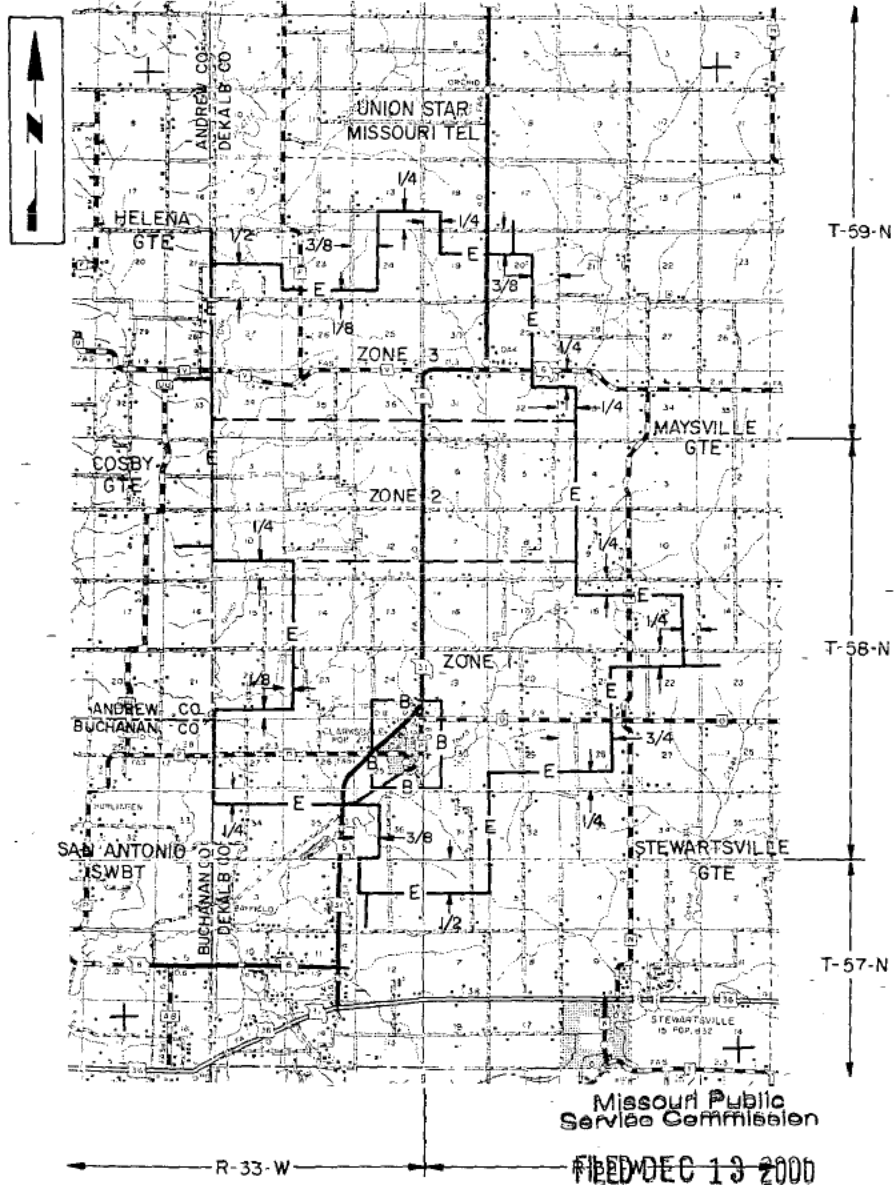

Issued: Nov. 13, 2000

Kenneth Matzdorff
Chief Operating Officer
Kansas City, MO

Effective: Dec. 13, 2000

LEGEND

EAB	=====	E	=====
ZONE	=====	B	=====
BRA	=====		=====

Missouri Public
Service Commission

REC'D NOV 13 2000



Missouri Public
Service Commission

FILED DEC 13 2000

Kenneth Matzdorff
Chief Operating Officer
Kansas City, MO

Issued: Nov. 13, 2000

Effective: Dec. 13, 2000

LEGEND
EAB _____
BRA _____

CONCORDIA EXCHANGE
LAFAYETTE, JOHNSON & SALINE COUNTIES
EXCHANGE AREA MAP

Missouri Public
Utilities Commission
ORIGINAL SHEET 23
REC'D NOV 13 2000

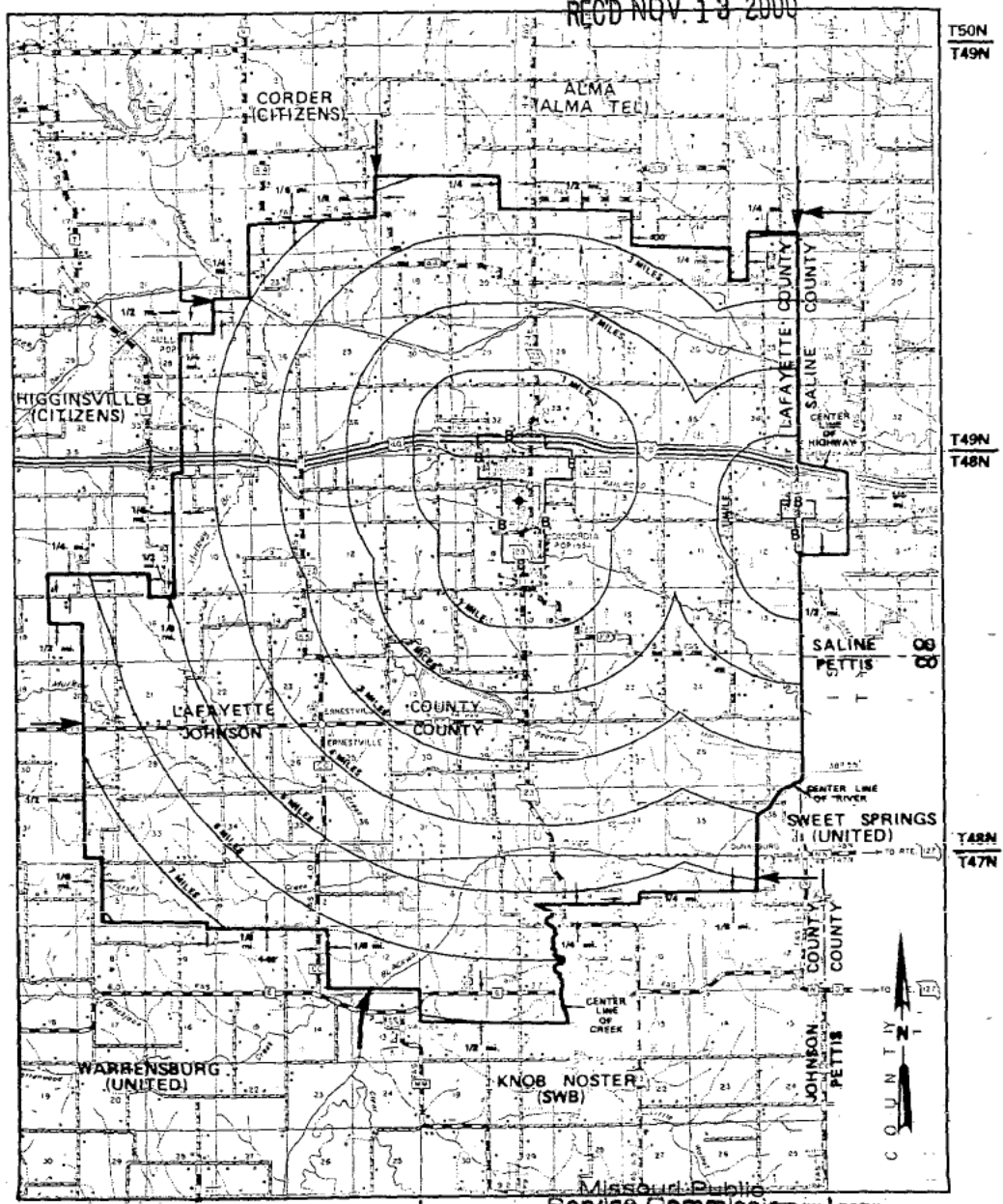

Issued: Nov. 13, 2000

Kenneth Matzdorff
Chief Operating Officer
Kansas City, MO

Missouri Public
Service Commission

FILED DEC 13 2000

Effective: Dec. 13, 2000

CANCELLED
October 1, 2014
Missouri Public
Service Commission
JI-2015-0080

COSBY EXCHANGE
ANDREW COUNTY
EXCHANGE AREA MAP



Missouri Public
Service Commission

REC'D NOV 13 2000

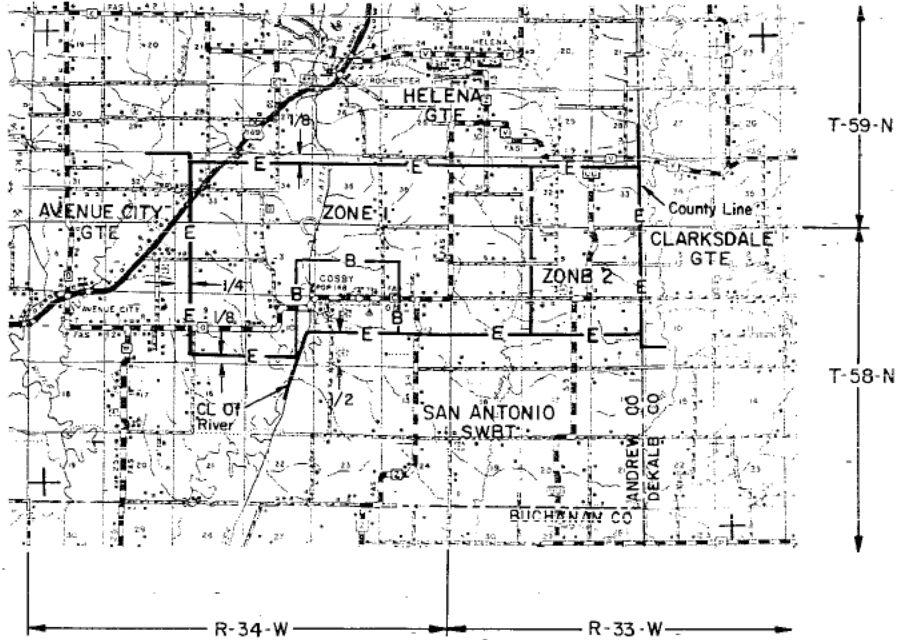

Missouri Public
Service Commission

FILED DEC 13 2000

Kenneth Matzdorff
Chief Operating Officer
Kansas City, MO

Issued: Nov. 13, 2000

Effective: Dec. 13, 2000

LEGEND
EAB _____
BRA _____ B _____



Issued: Nov. 13, 2000

Kenneth Matzdorff
Chief Operating Officer
Kansas City, MO

Effective Dec. 13, 2000

Missouri Public Service Commission
FILED DEC 13 2000

LEGEND
EAS _____
BRA _____ B _____

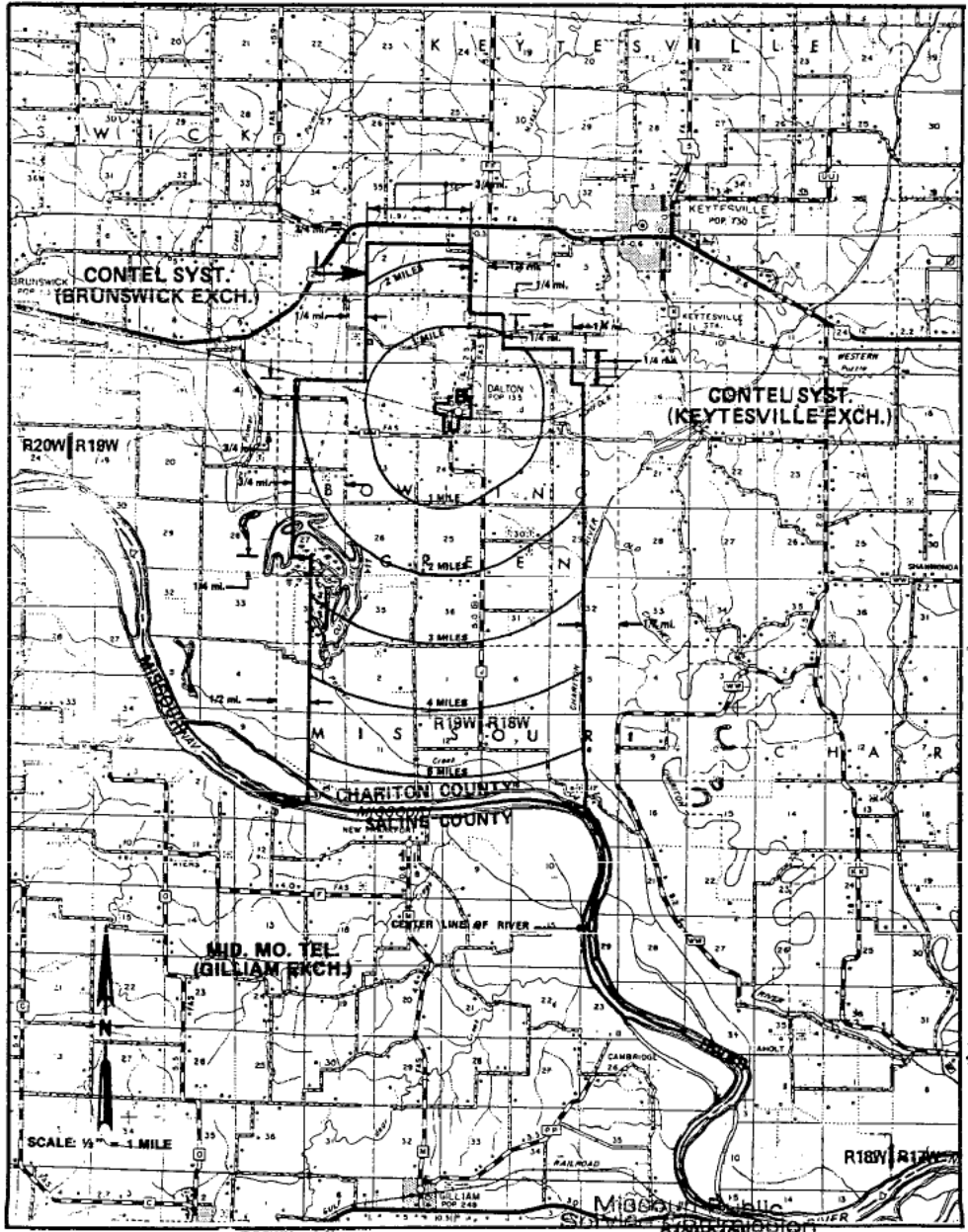

Issued: Nov. 13, 2000
Kenneth Matzdorff
Chief Operating Officer
Kansas City, MO
FILED DEC 13 2000
Effective: Dec. 13, 2000

CANCELLED
October 1, 2014
Missouri Public
Service Commission
JI-2015-0080

EASTON EXCHANGE
BUCHANAN & CLINTON COUNTIES
EXCHANGE AREA MAP



Missouri Public
Service Commission

REC'D NOV 13 2000

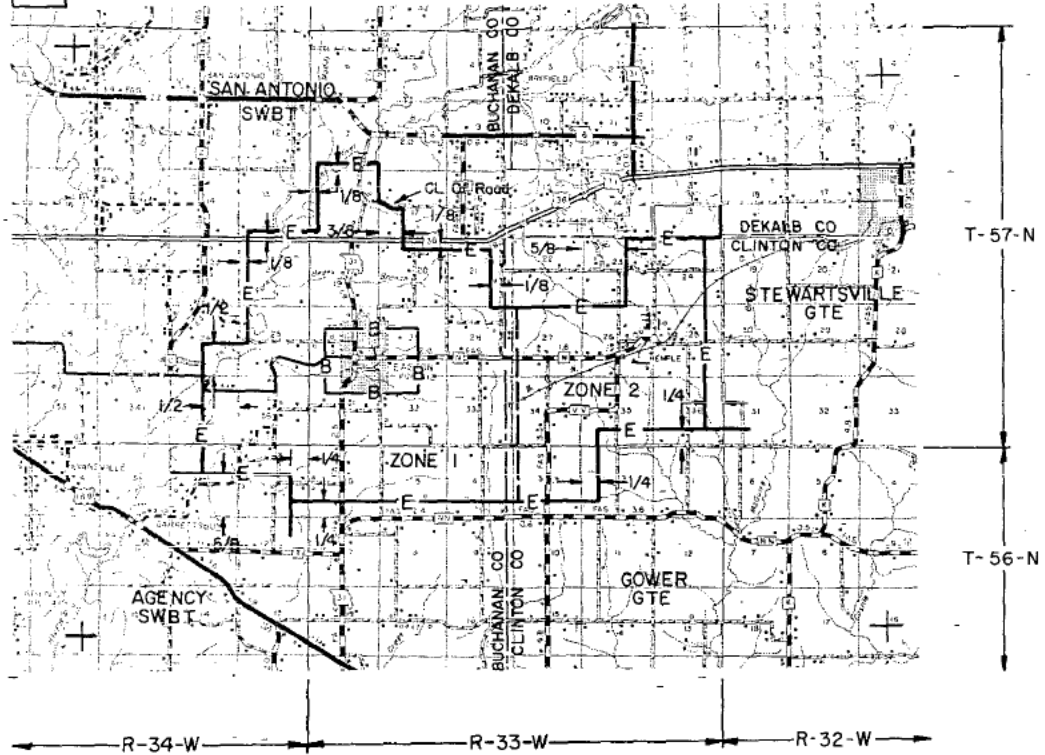

Missouri Public
Service Commission

FILED DEC 13 2000

Kenneth Matzdorff
Chief Operating Officer
Kansas City, MO

Issued: Nov. 13, 2000

Effective: Dec. 13, 2000

CANCELLED
October 1, 2014
Missouri Public
Service Commission
JI-2015-0080

Missouri Public
Service Commission
SC MO. NO. 7
EDGAR SPRINGS
DENT & PHELPS COUNTY
EXCHANGE AREA MAP
NOV 13 2000

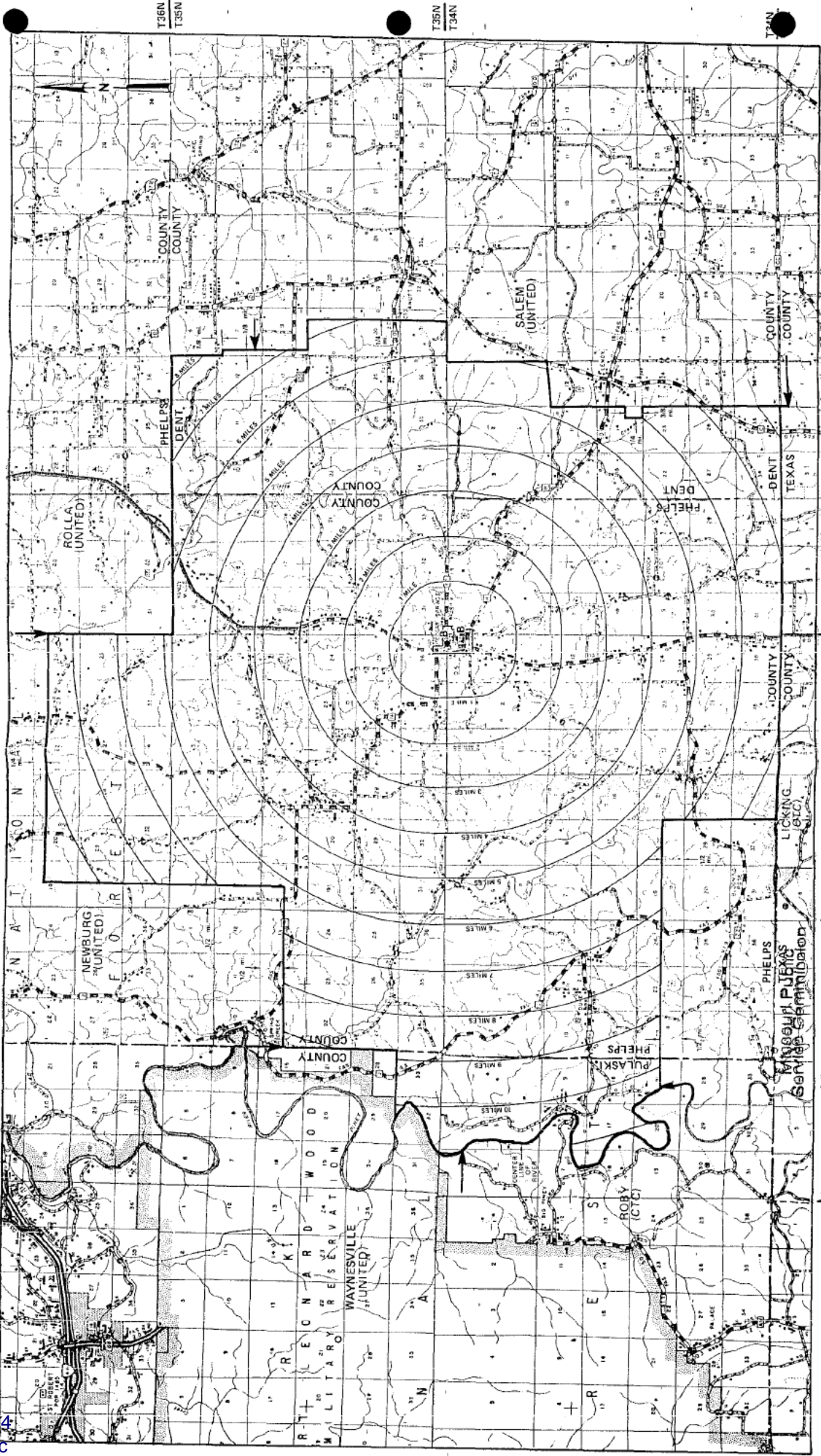

Missouri Public
Service Commission
R11W | R10W | R9W
Kenneth Natzdorff
Chief Operating Officer
Kansas City, MO
Effective: Dec. 13, 2000

Filed DEC 13 2000
R11W | R10W | R9W
Effective: Dec. 13, 2000