

26. EXCHANGE AREA/BASE RATE BOUNDARY MAP - MINDENMINES

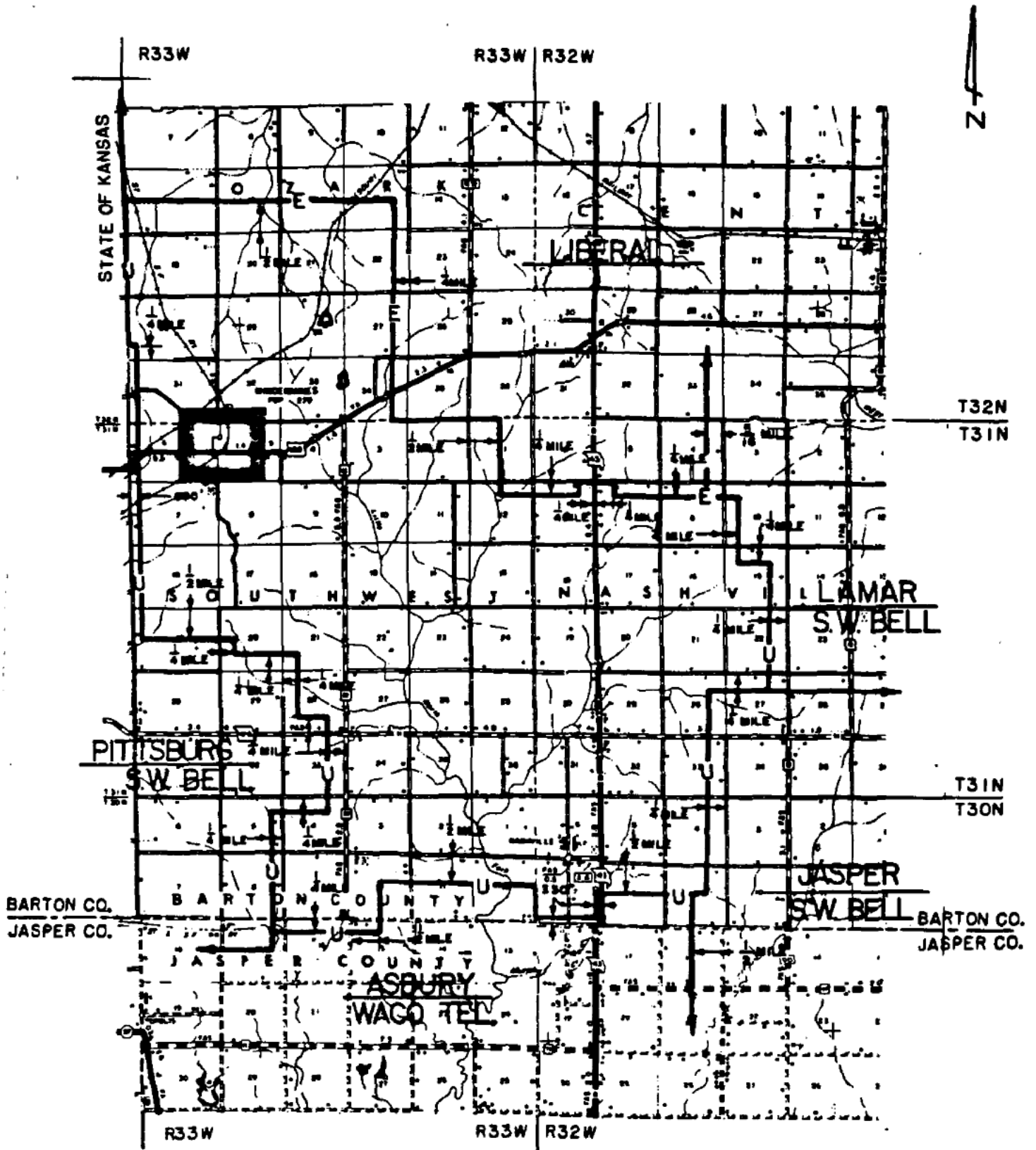

26. EXCHANGE AREA/BASE RATE BOUNDARY MAP - MORRISVILLE

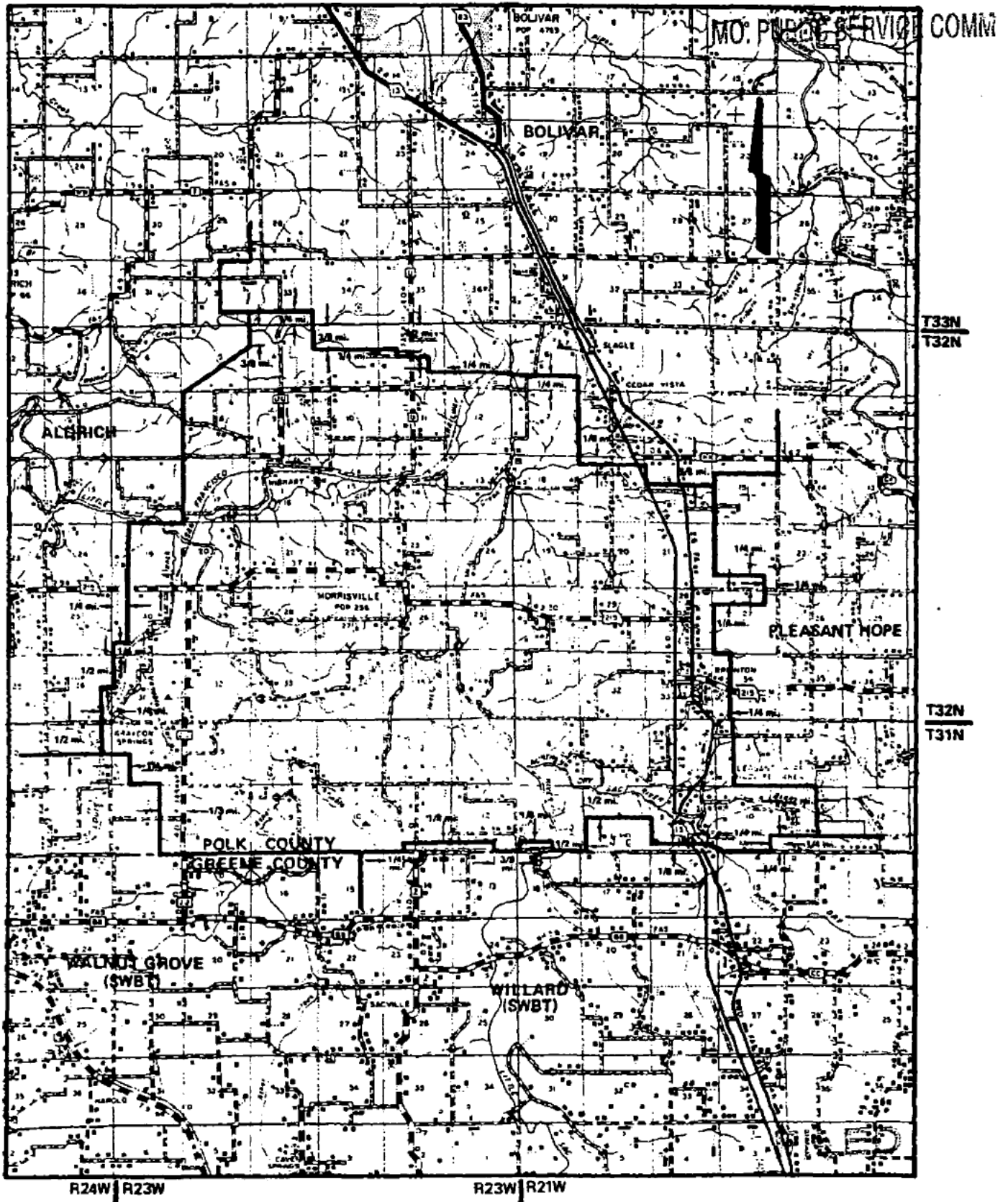

26. EXCHANGE AREA/BASE RATE BOUNDARY MAP - MYRTLE

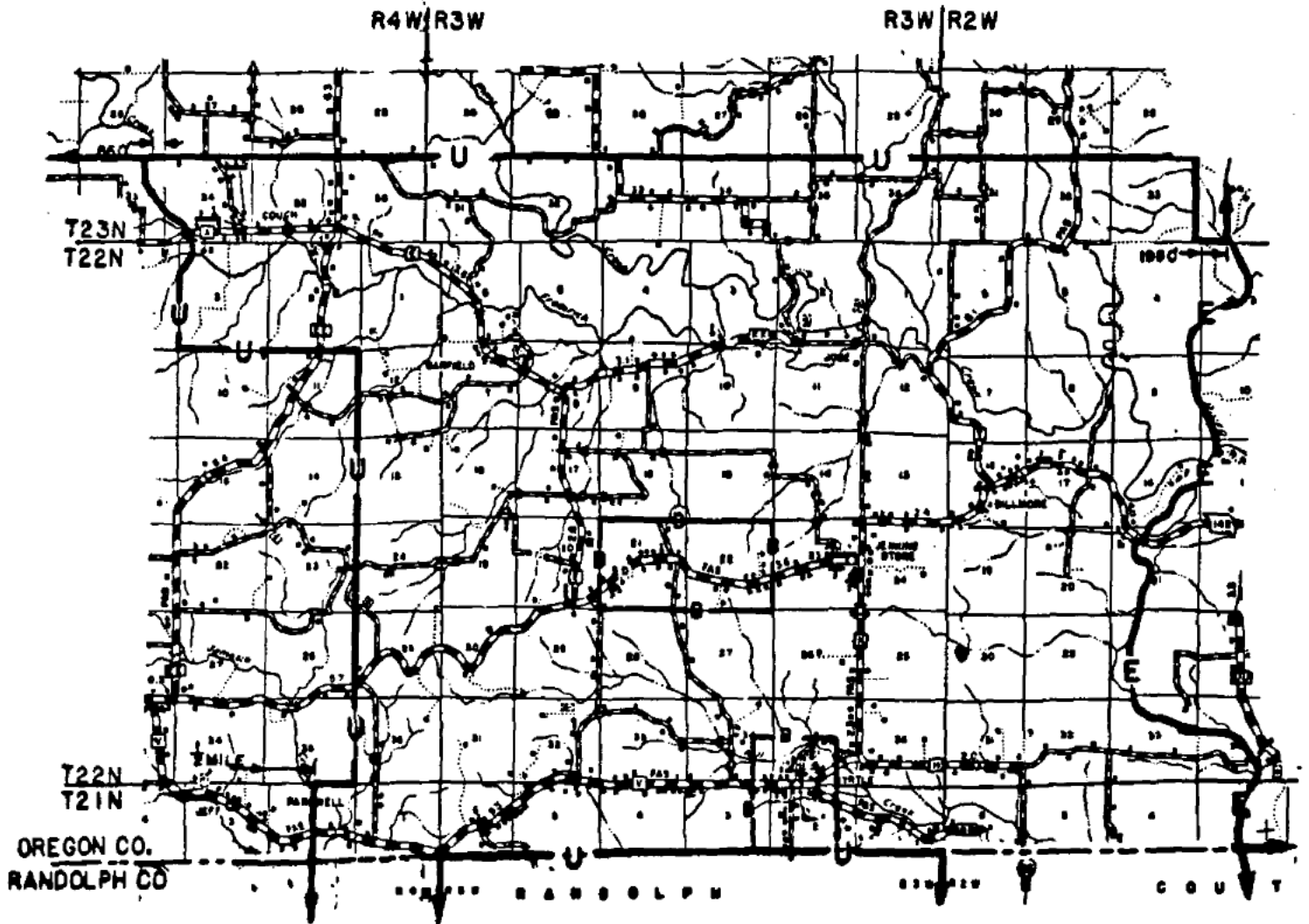

26. EXCHANGE AREA/BASE RATE BOUNDARY MAP - NAYLOR

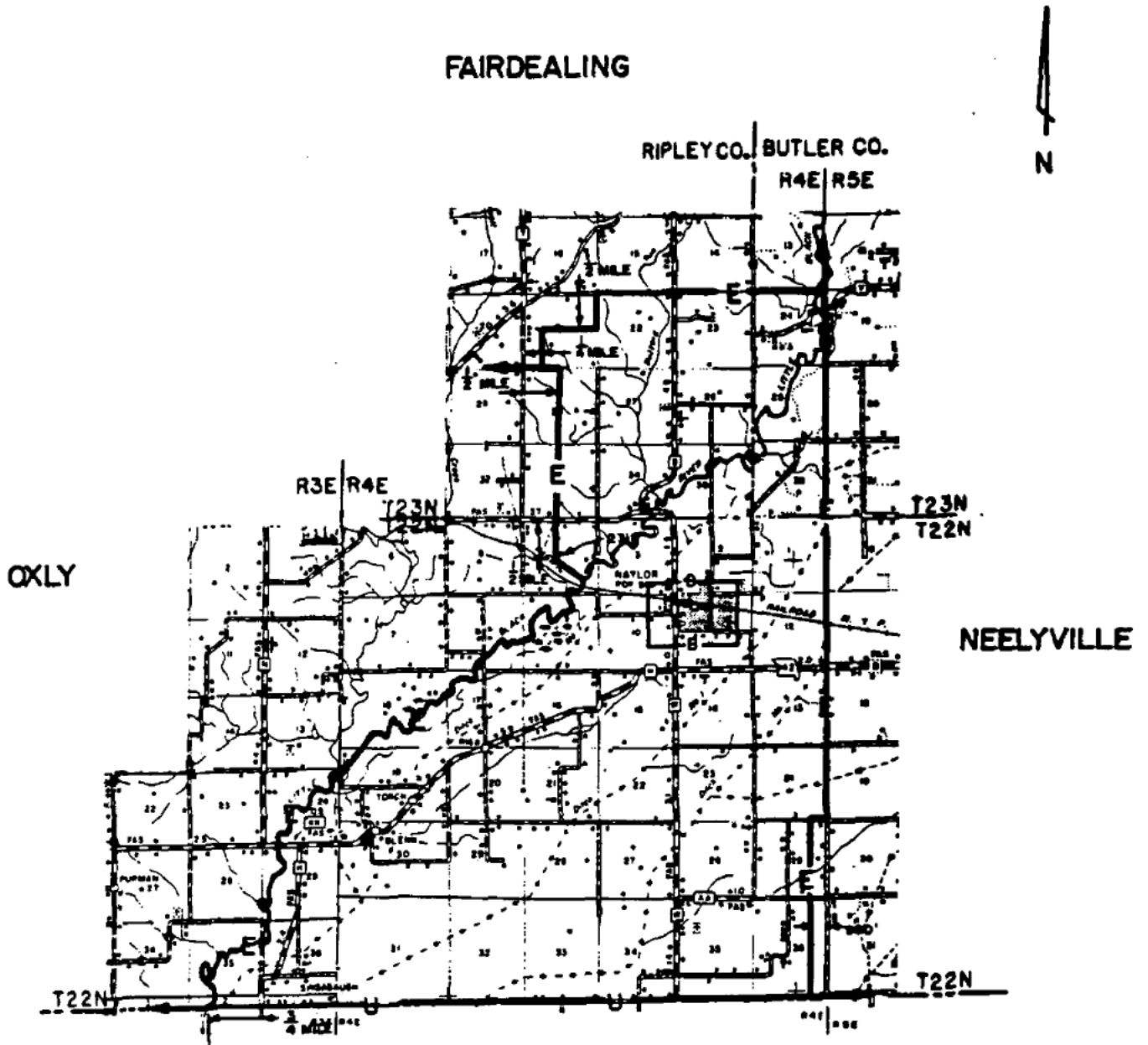

26. EXCHANGE AREA/BASE RATE BOUNDARY MAP - NEELYVILLE

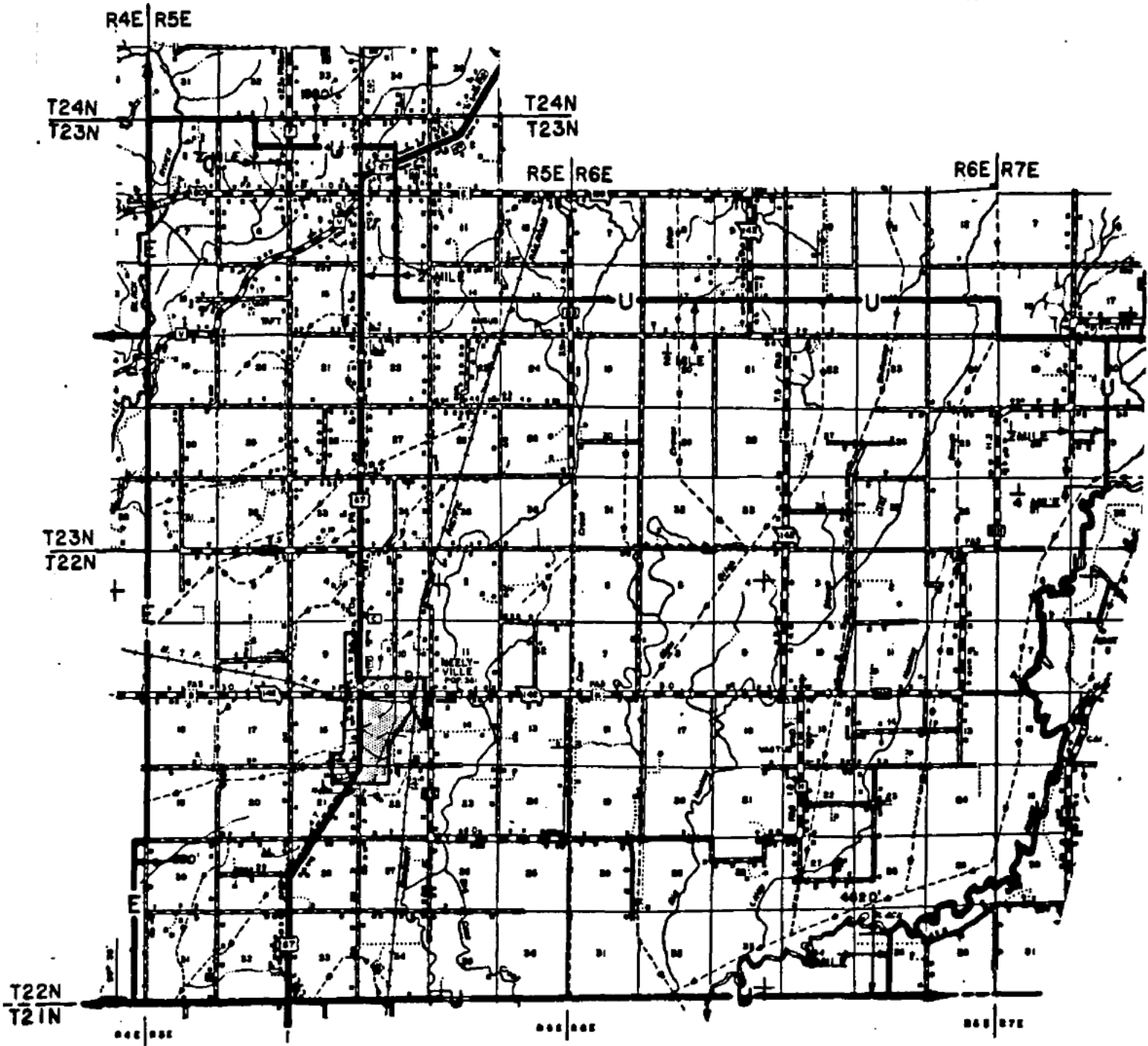

CANCELLED
August 20, 2015
Missouri Public
Service Commission
JI-2016-0057

ISSUED: December 9, 2005
ISSUED BY: Vice President
Little Rock, Arkansas

EFFECTIVE: January 9, 2006

26. EXCHANGE AREA/BASE RATE BOUNDARY MAP - NEW HARTFORD

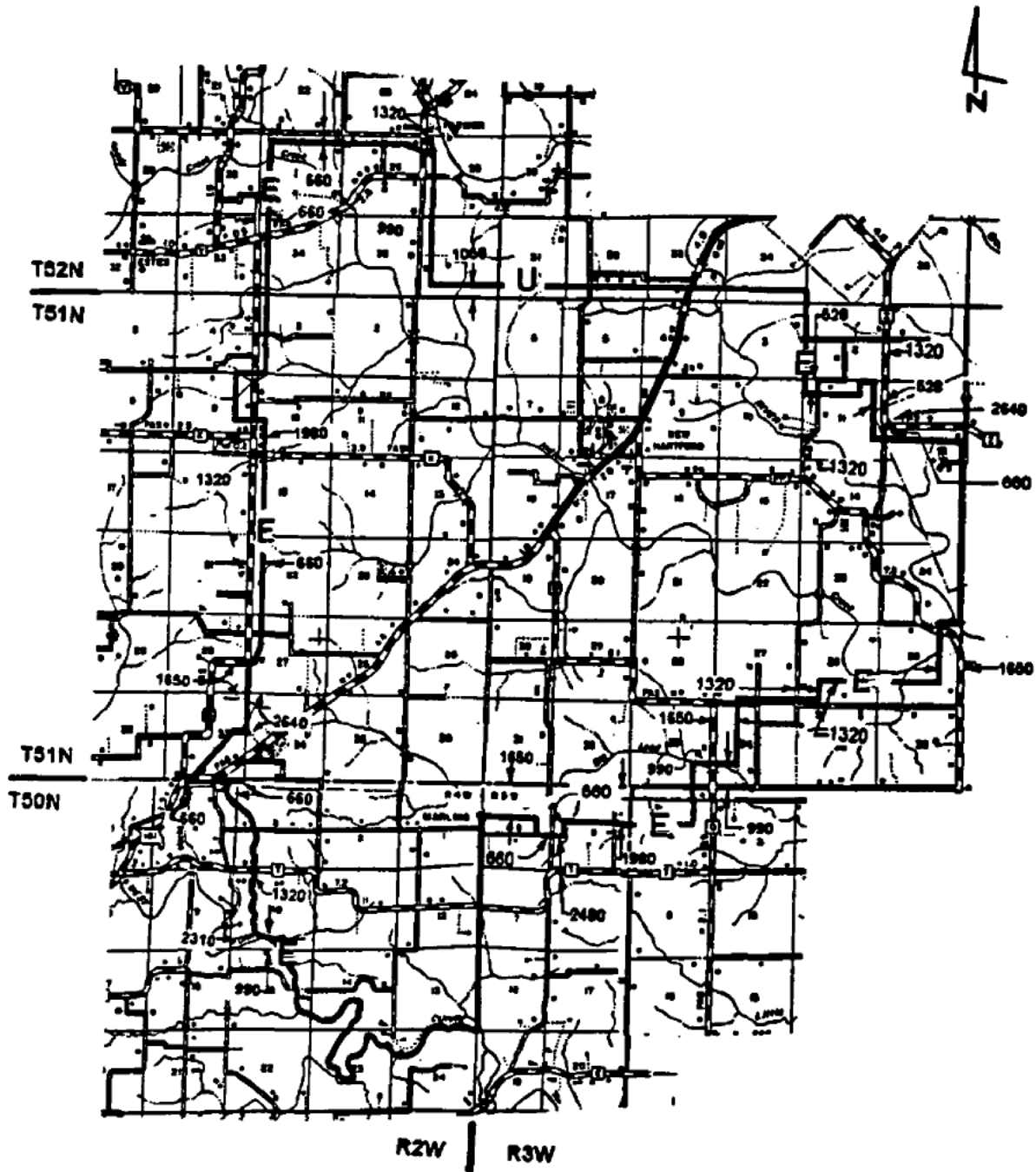

26. EXCHANGE AREA/BASE RATE BOUNDARY MAP - OLNEY

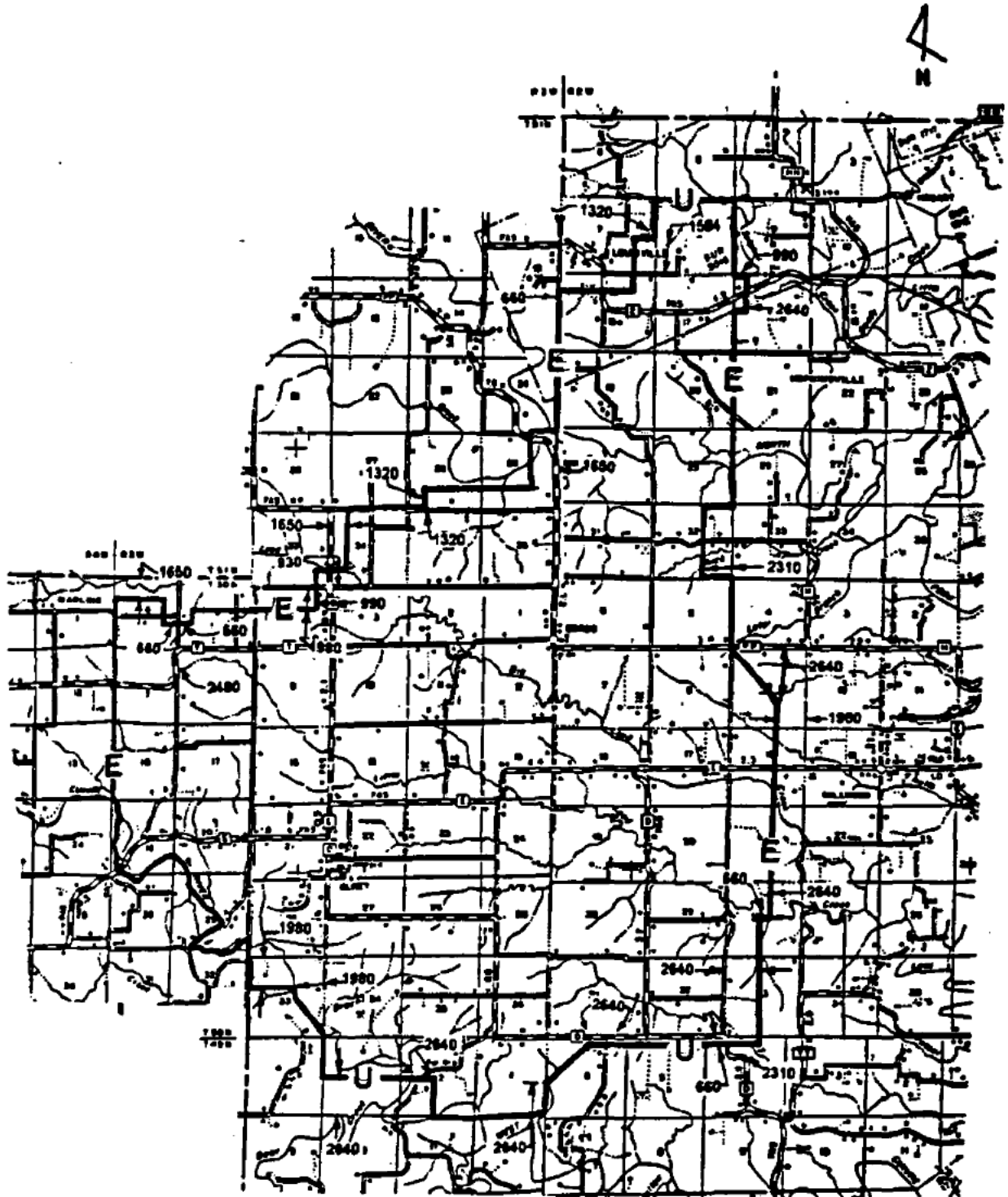

26. EXCHANGE AREA/BASE RATE BOUNDARY MAP - OXLY

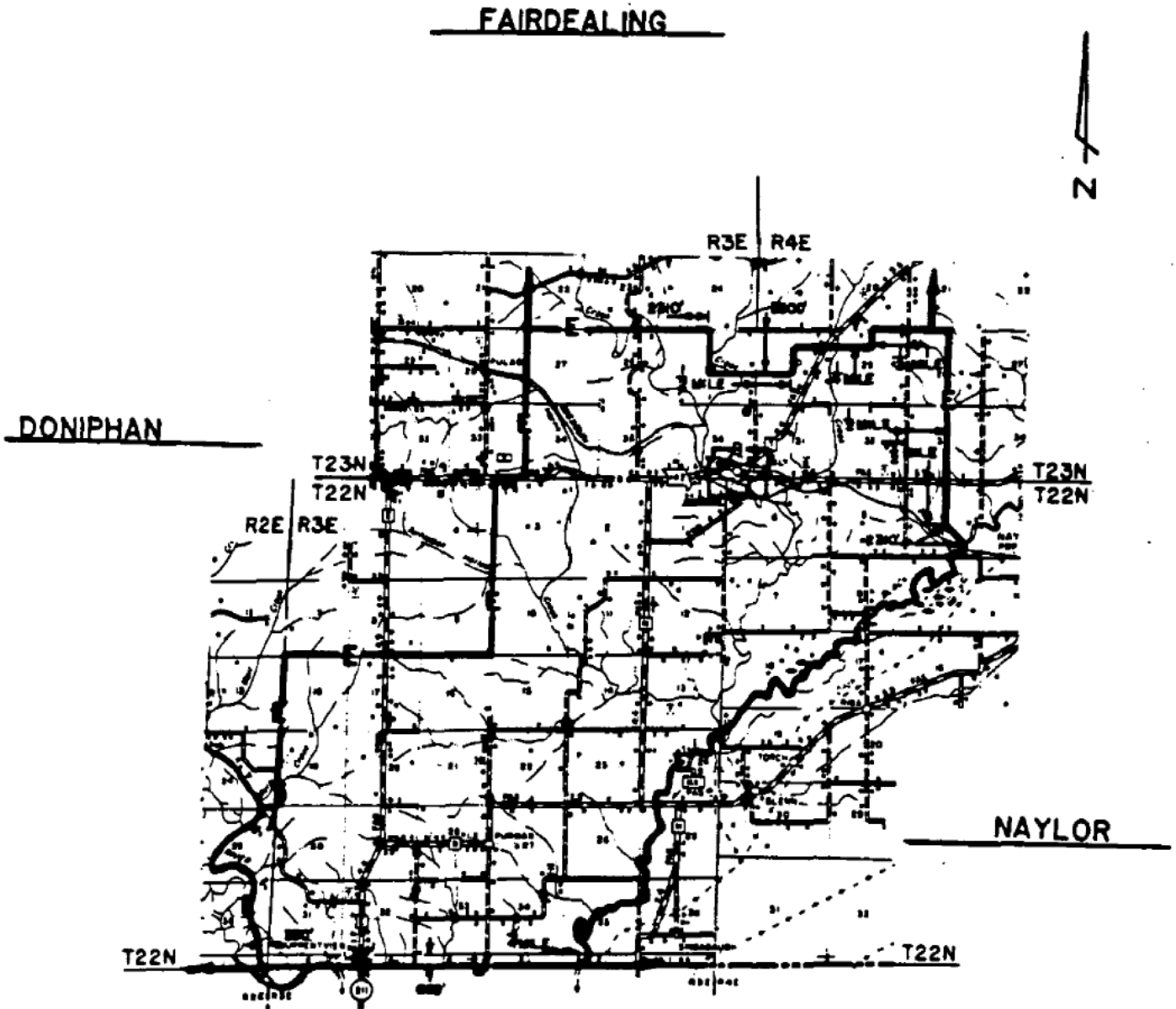

26. EXCHANGE AREA/BASE RATE BOUNDARY MAP - PATTERSON

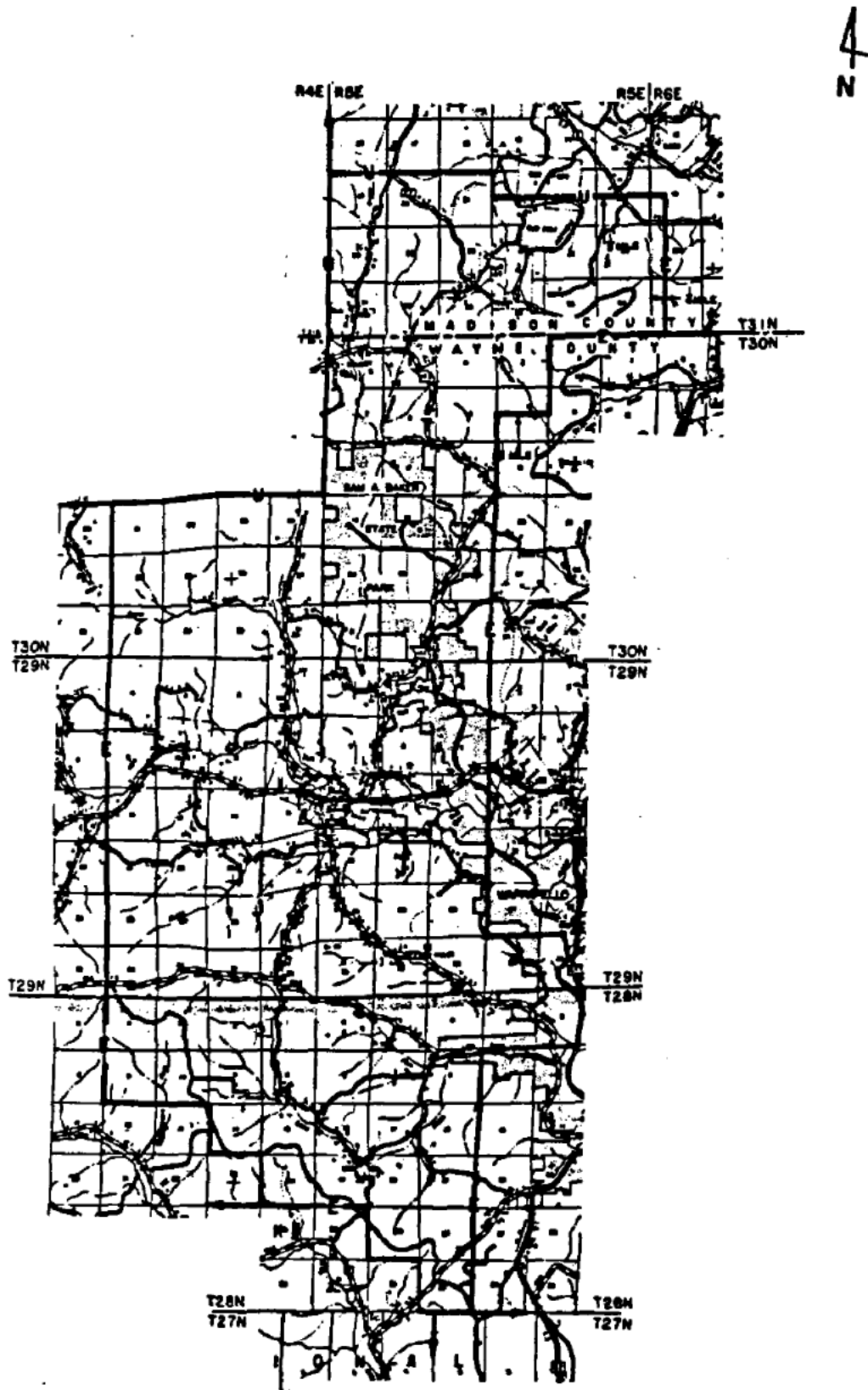

CANCELLED
August 20, 2015
Missouri Public
Service Commission
JI-2016-0057

ISSUED: December 9, 2005
ISSUED BY: Vice President
Little Rock, Arkansas

EFFECTIVE: January 9, 2006

26. EXCHANGE AREA/BASE RATE BOUNDARY MAP - PATTONSBURG

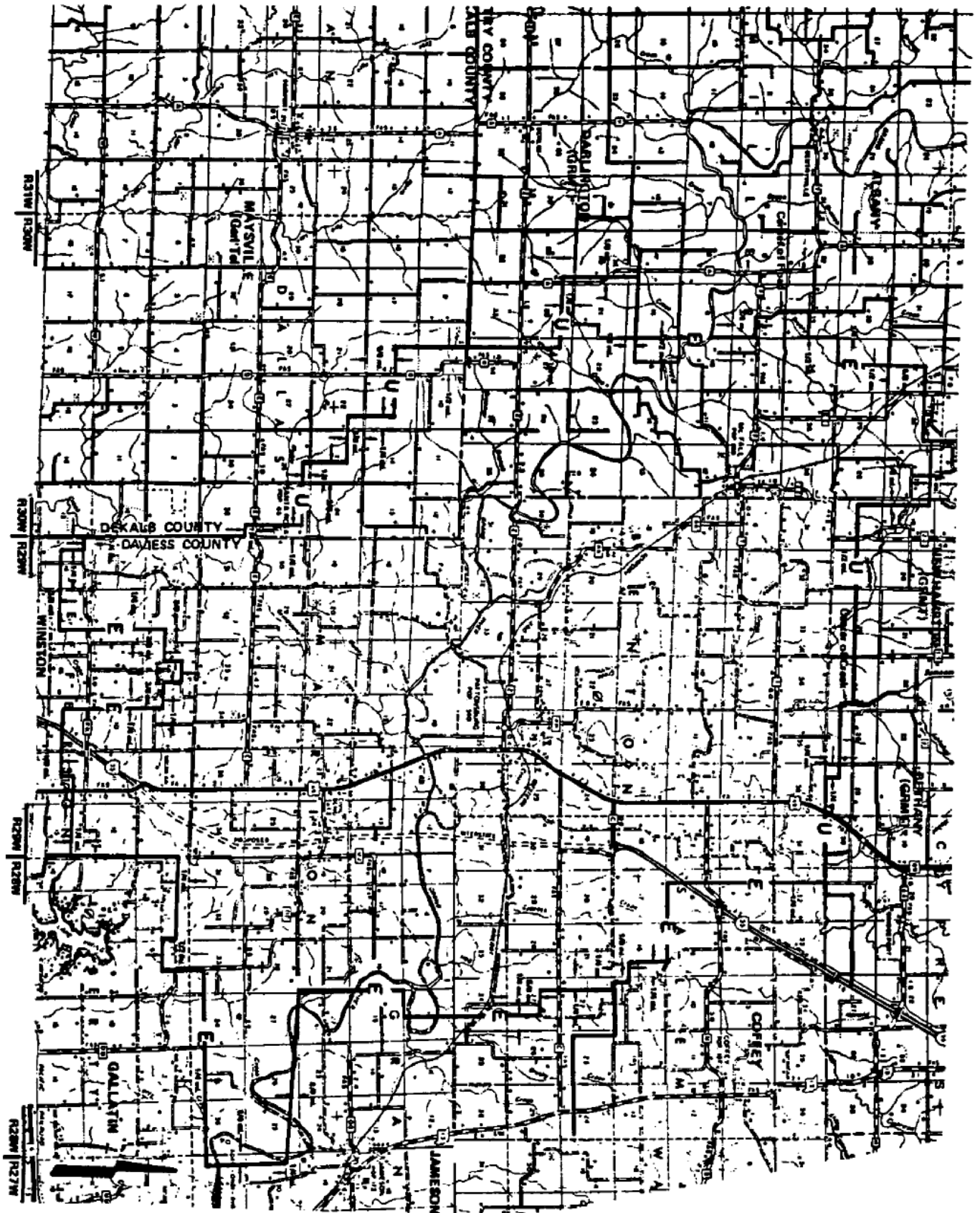

26. EXCHANGE AREA/BASE RATE BOUNDARY MAP - PIEDMONT

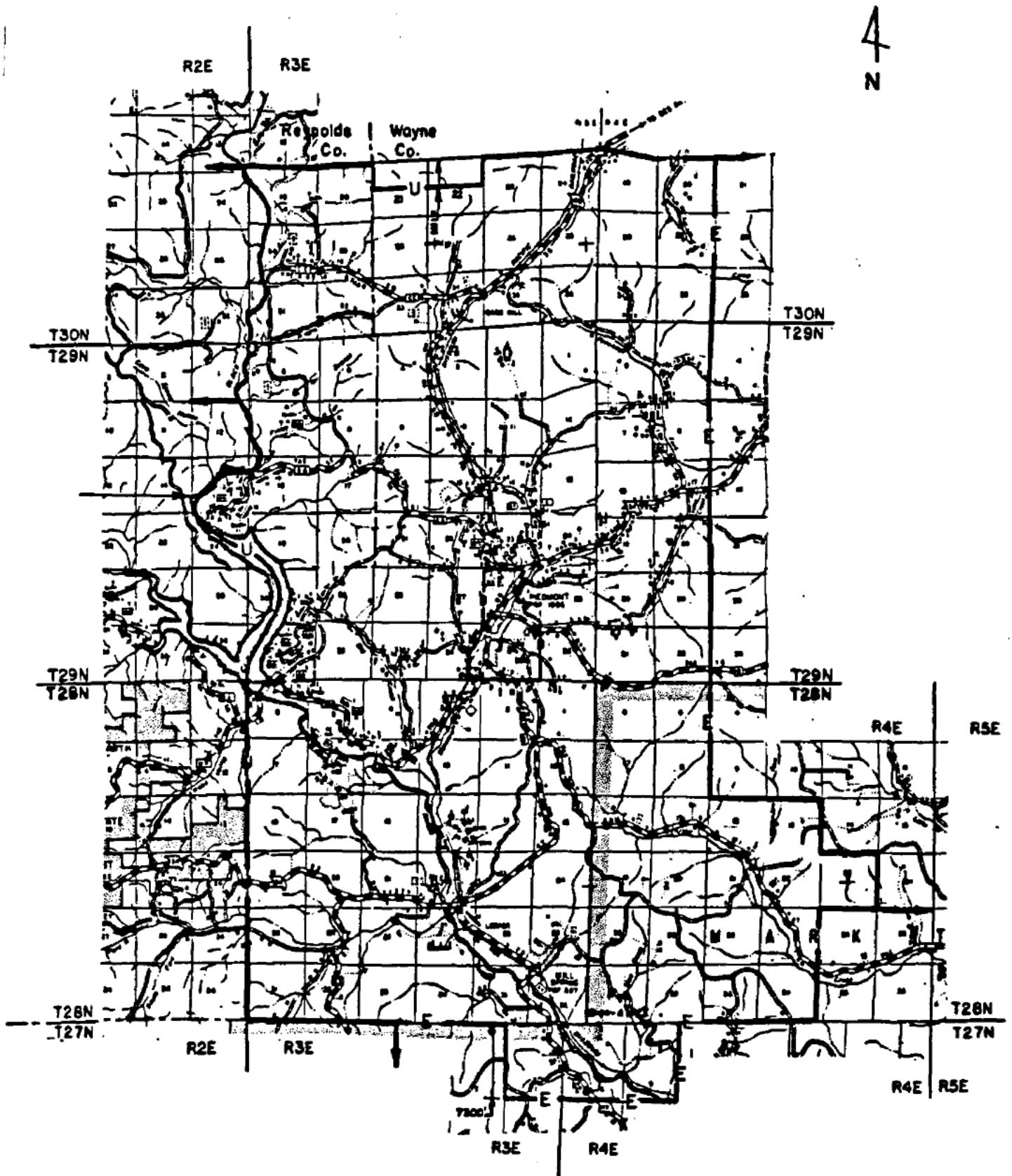

CANCELLED
August 20, 2015
Missouri Public
Service Commission
JI-2016-0057

ISSUED: December 9, 2005
ISSUED BY: Vice President
Little Rock, Arkansas

EFFECTIVE: January 9, 2006

26. EXCHANGE AREA/BASE RATE BOUNDARY MAP - PLEASANT HOPE

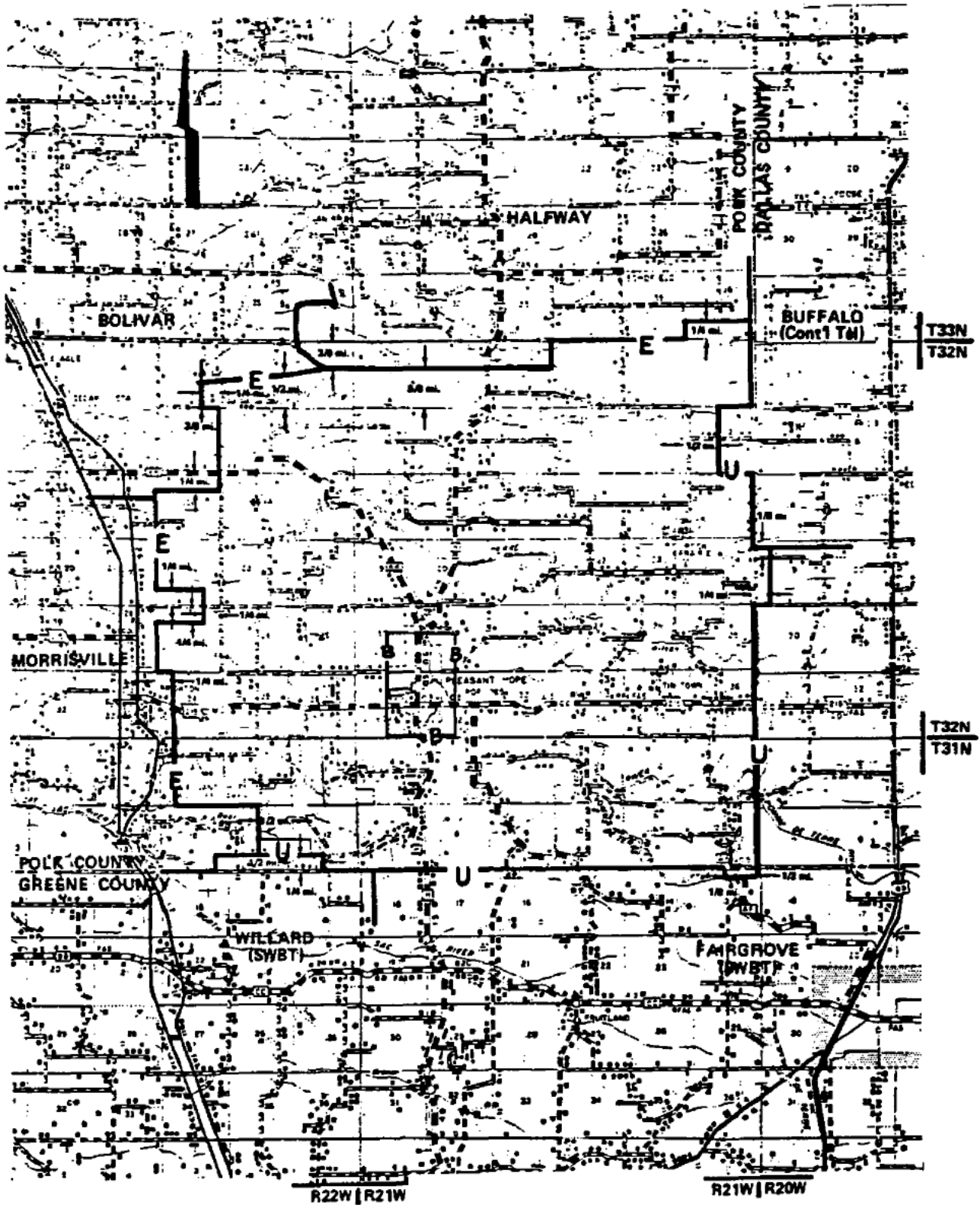

CANCELLED
August 20, 2015
Missouri Public
Service Commission
JI-2016-0057

ISSUED: December 9, 2005
ISSUED BY: Vice President
Little Rock, Arkansas

EFFECTIVE: January 9, 2006

26. EXCHANGE AREA/BASE RATE BOUNDARY MAP - POLK

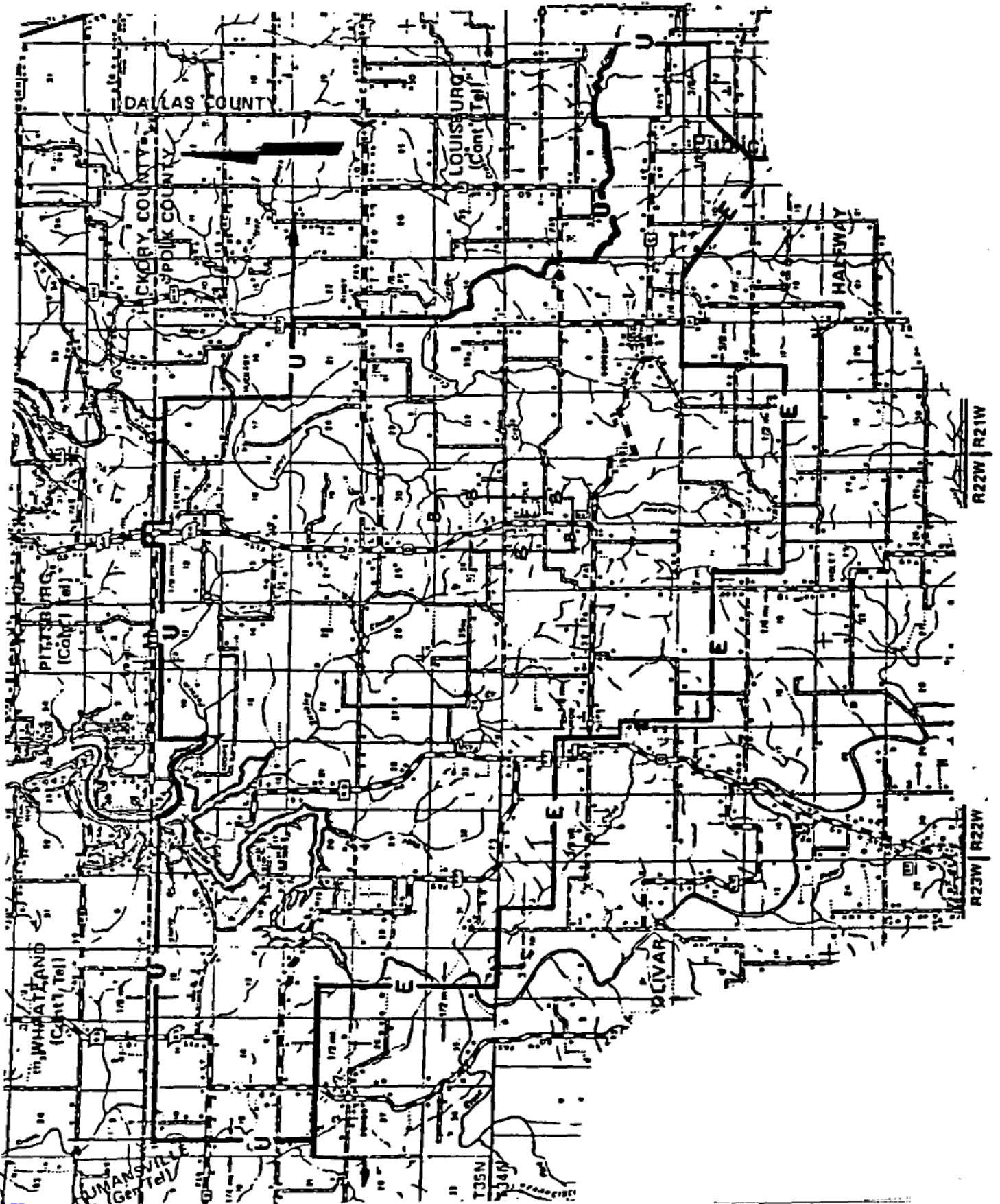

CANCELLED
August 20, 2015
Missouri Public
Service Commission
JI-2016-0057

ISSUED: December 9, 2005
ISSUED BY: Vice President
Little Rock, Arkansas

EFFECTIVE: January 9, 2006

26. EXCHANGE AREA/BASE RATE BOUNDARY MAP - PONDER

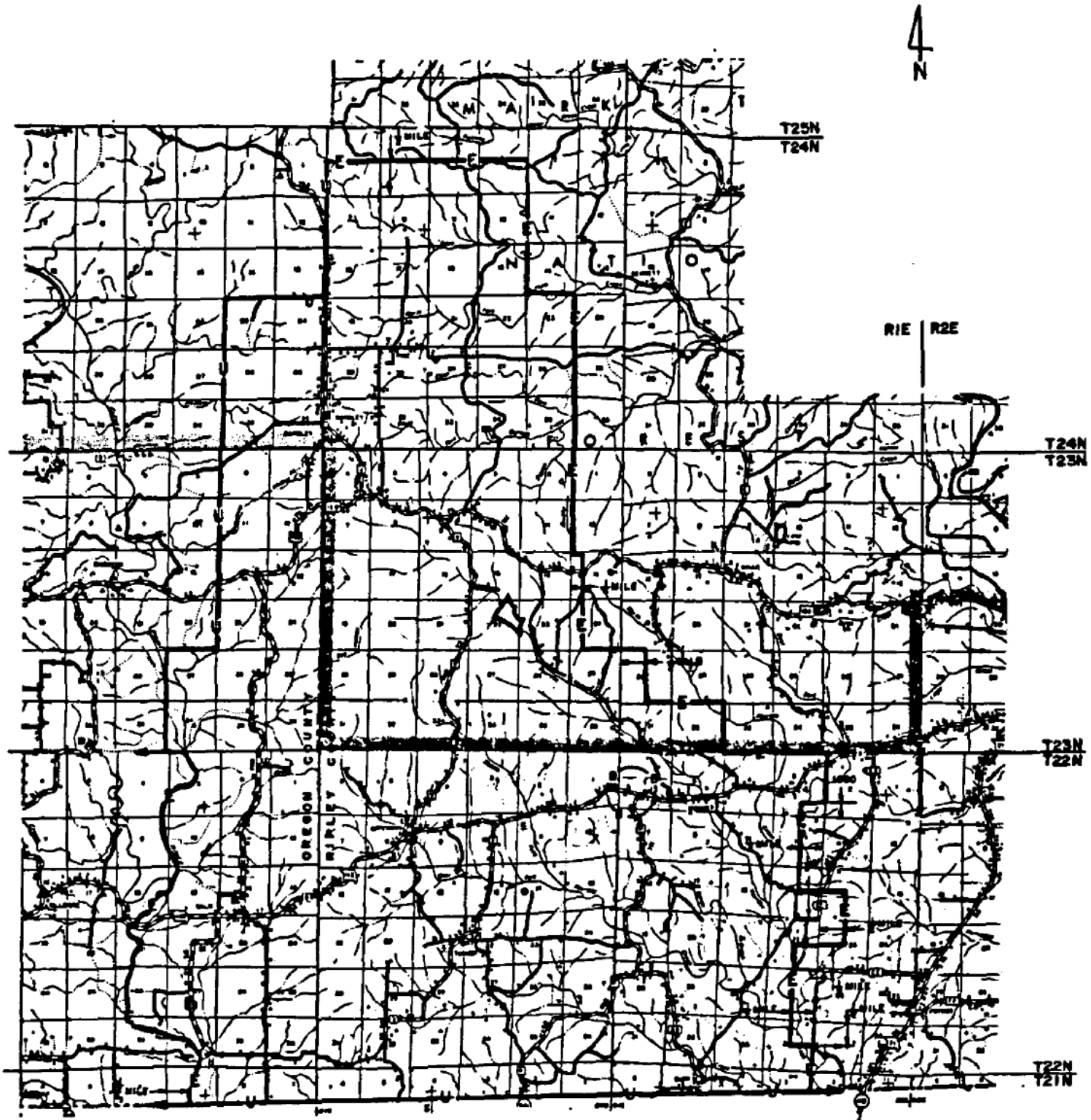

CANCELLED
August 20, 2015
Missouri Public
Service Commission
JI-2016-0057

ISSUED: December 9, 2005
ISSUED BY: Vice President
Little Rock, Arkansas

EFFECTIVE: January 9, 2006

26. EXCHANGE AREA/BASE RATE BOUNDARY MAP - PURDY

4

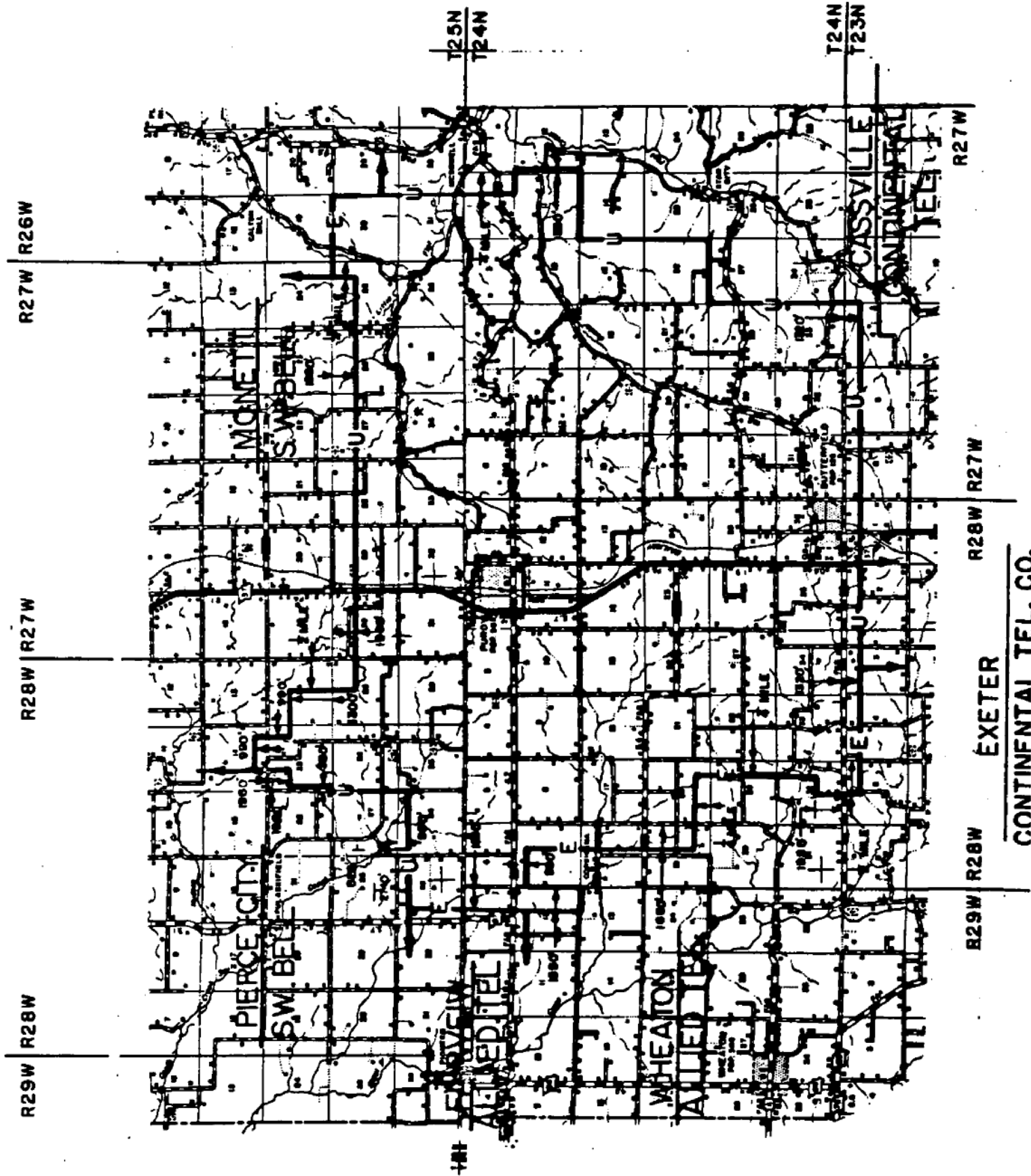

CANCELLED
August 20, 2015
Missouri Public
Service Commission
JI-2016-0057

ISSUED: December 9, 2005
ISSUED BY: Vice President
Little Rock, Arkansas

EFFECTIVE: January 9, 2006

EXETER
CONTINENTAL TEL. CO.

26. EXCHANGE AREA/BASE RATE BOUNDARY MAP - ROTHVILLE

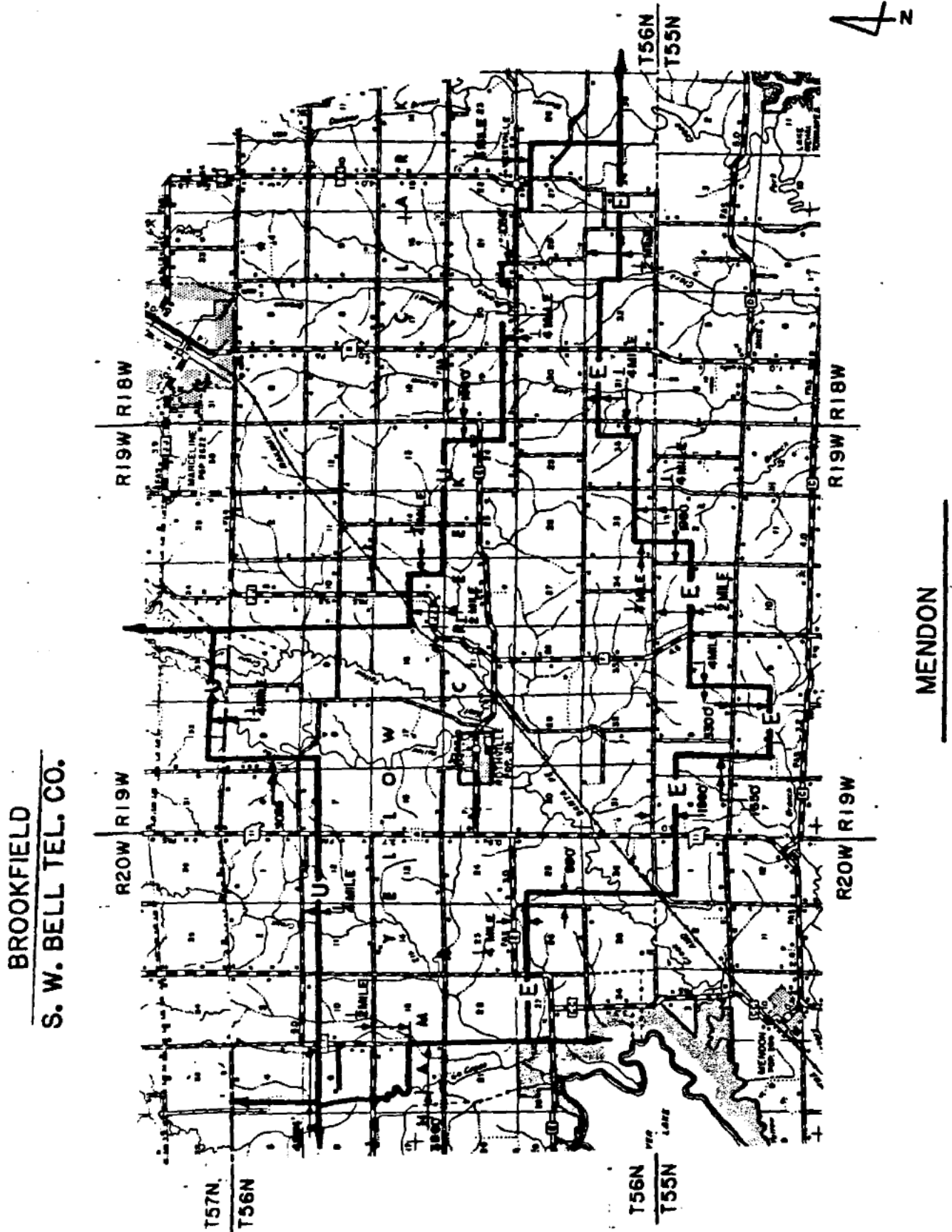

BROOKFIELD
S. W. BELL TEL. CO.

MENDON

CANCELLED
August 20, 2015
Missouri Public
Service Commission
JI-2016-0057

ISSUED: December 9, 2005
ISSUED BY: Vice President
Little Rock, Arkansas

EFFECTIVE: January 9, 2006

26. EXCHANGE AREA/BASE RATE BOUNDARY MAP - SILEX

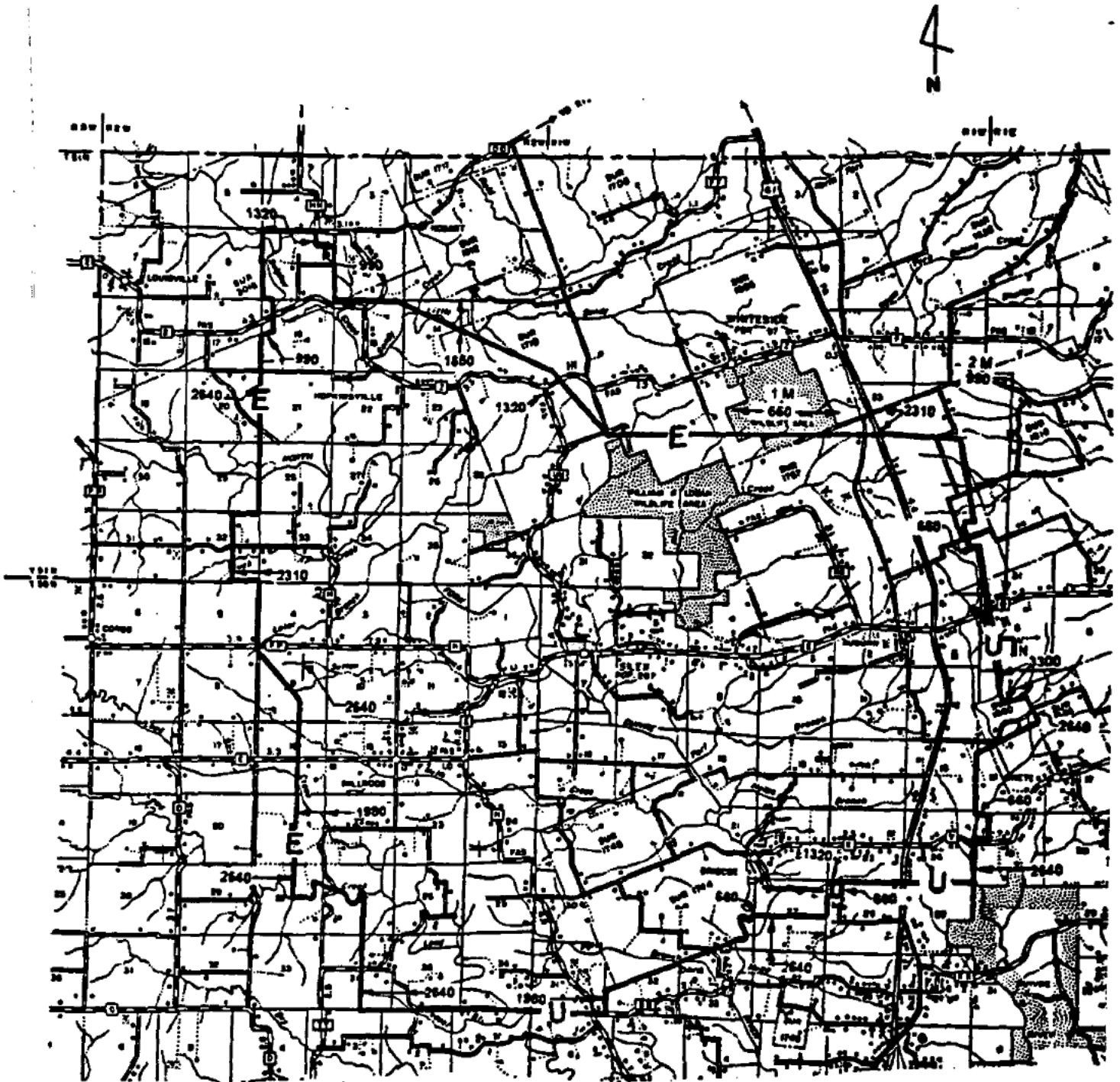

26. EXCHANGE AREA/BASE RATE BOUNDARY MAP - ST. ELIZABETH

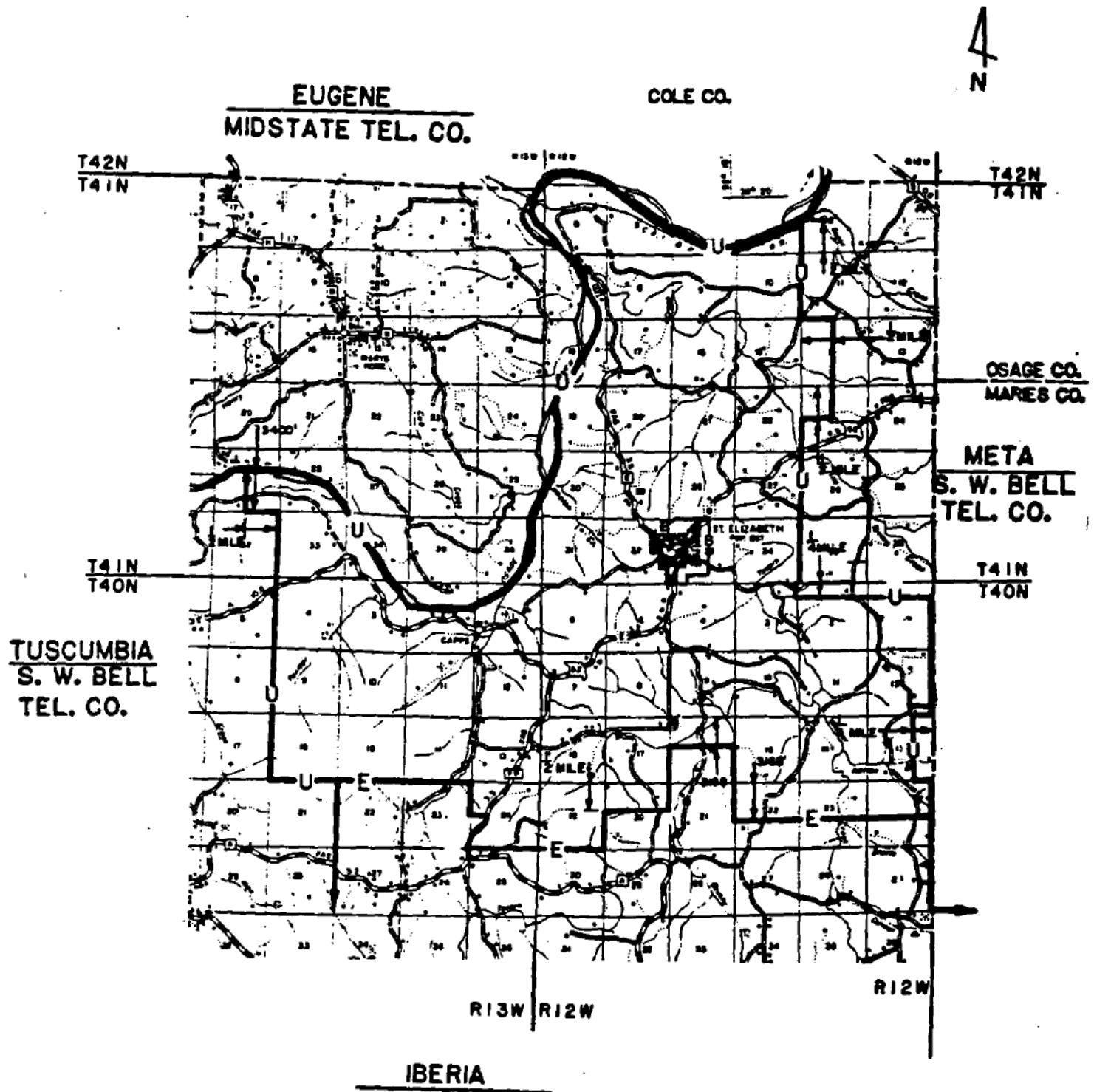

26. EXCHANGE AREA/BASE RATE BOUNDARY MAP - STARK CITY

GRANBY
GRANBY TEL. CO.

PIERCE CITY
S. W. BELL TEL. CO.

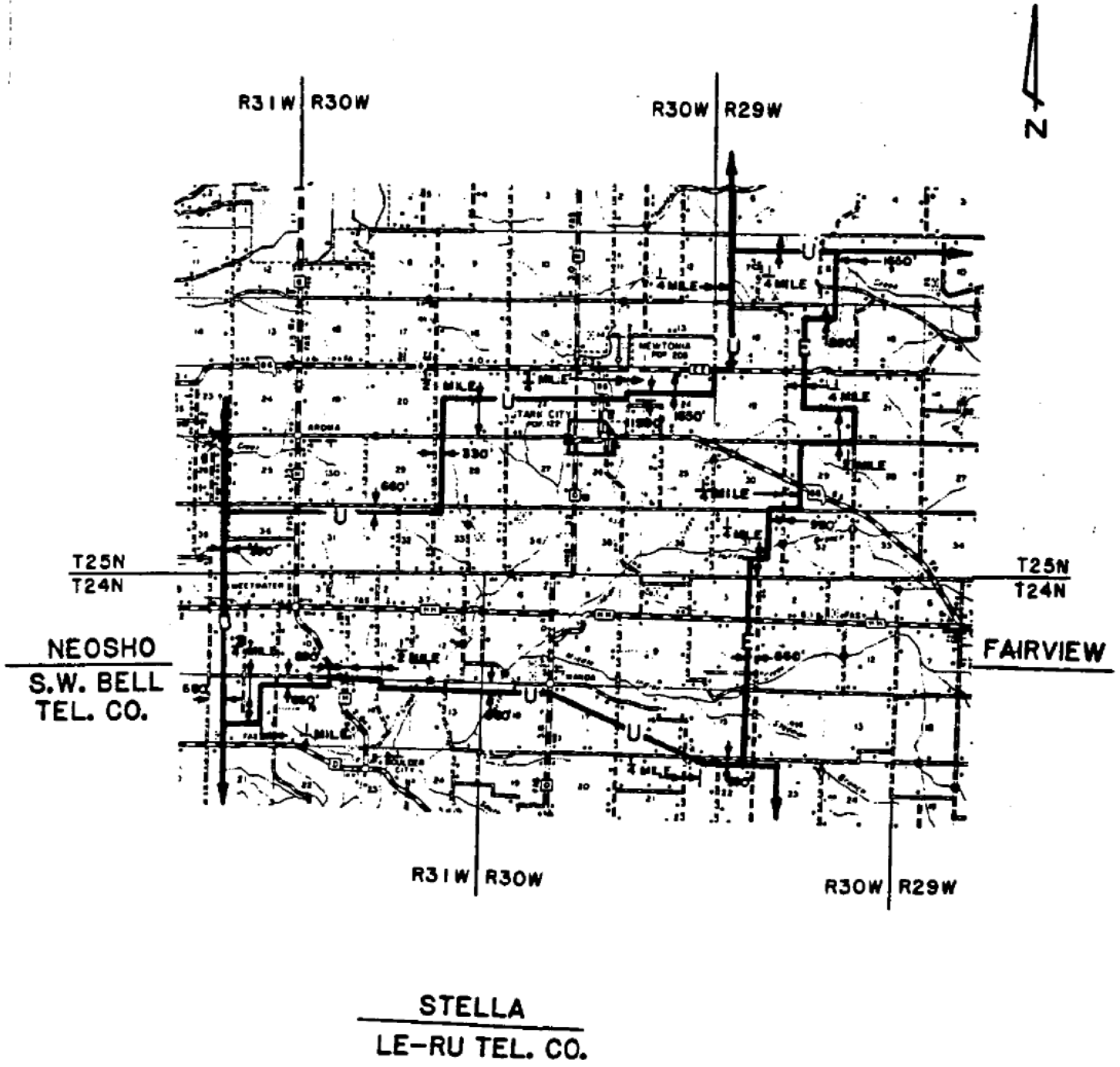

26. EXCHANGE AREA/BASE RATE BOUNDARY MAP - STOCKTON

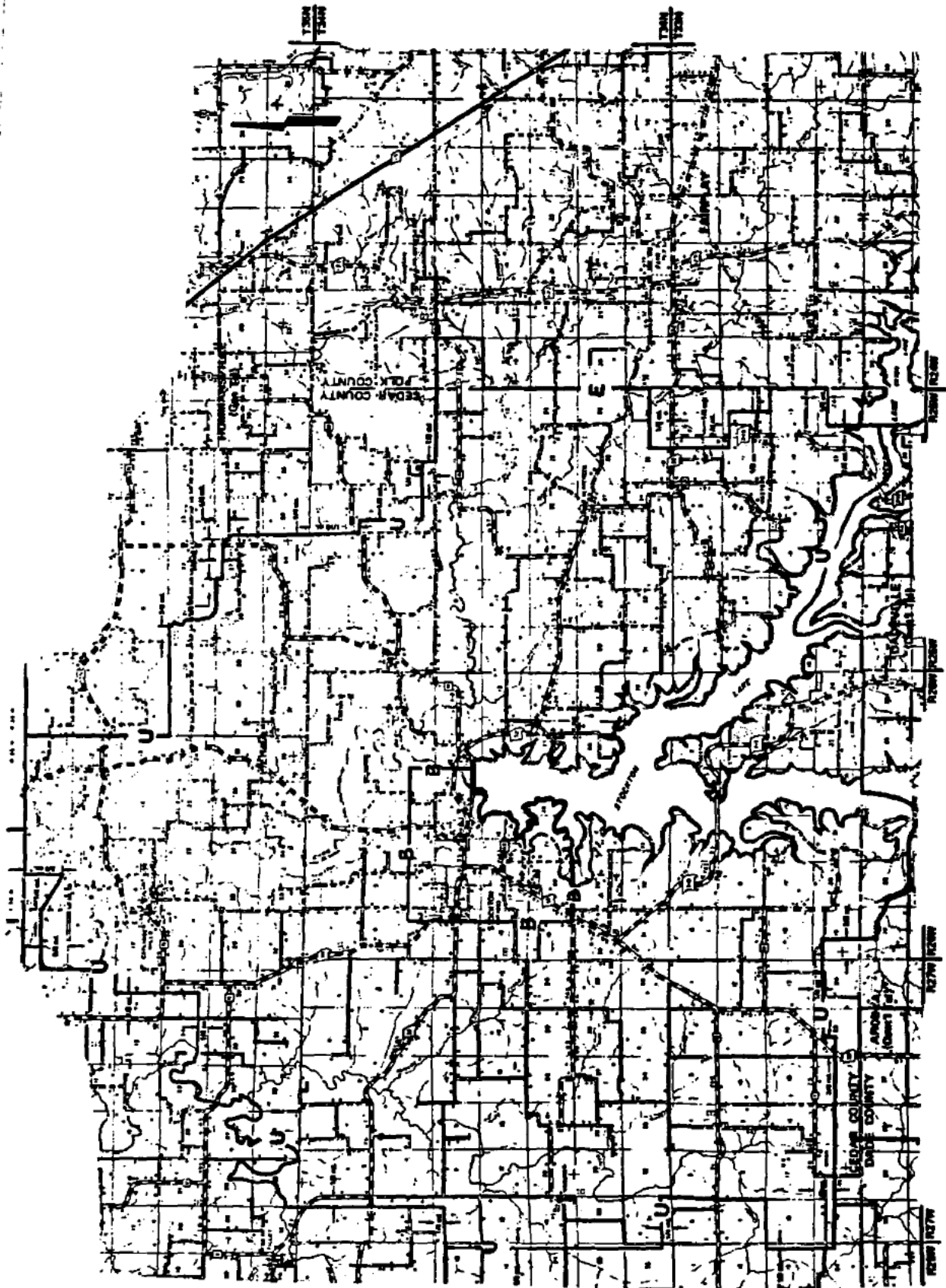

CANCELLED
August 20, 2015
Missouri Public
Service Commission
JI-2016-0057

ISSUED: December 9, 2005
ISSUED BY: Vice President
Little Rock, Arkansas

EFFECTIVE: January 9, 2006

26. EXCHANGE AREA/BASE RATE BOUNDARY MAP - STOTTS CITY

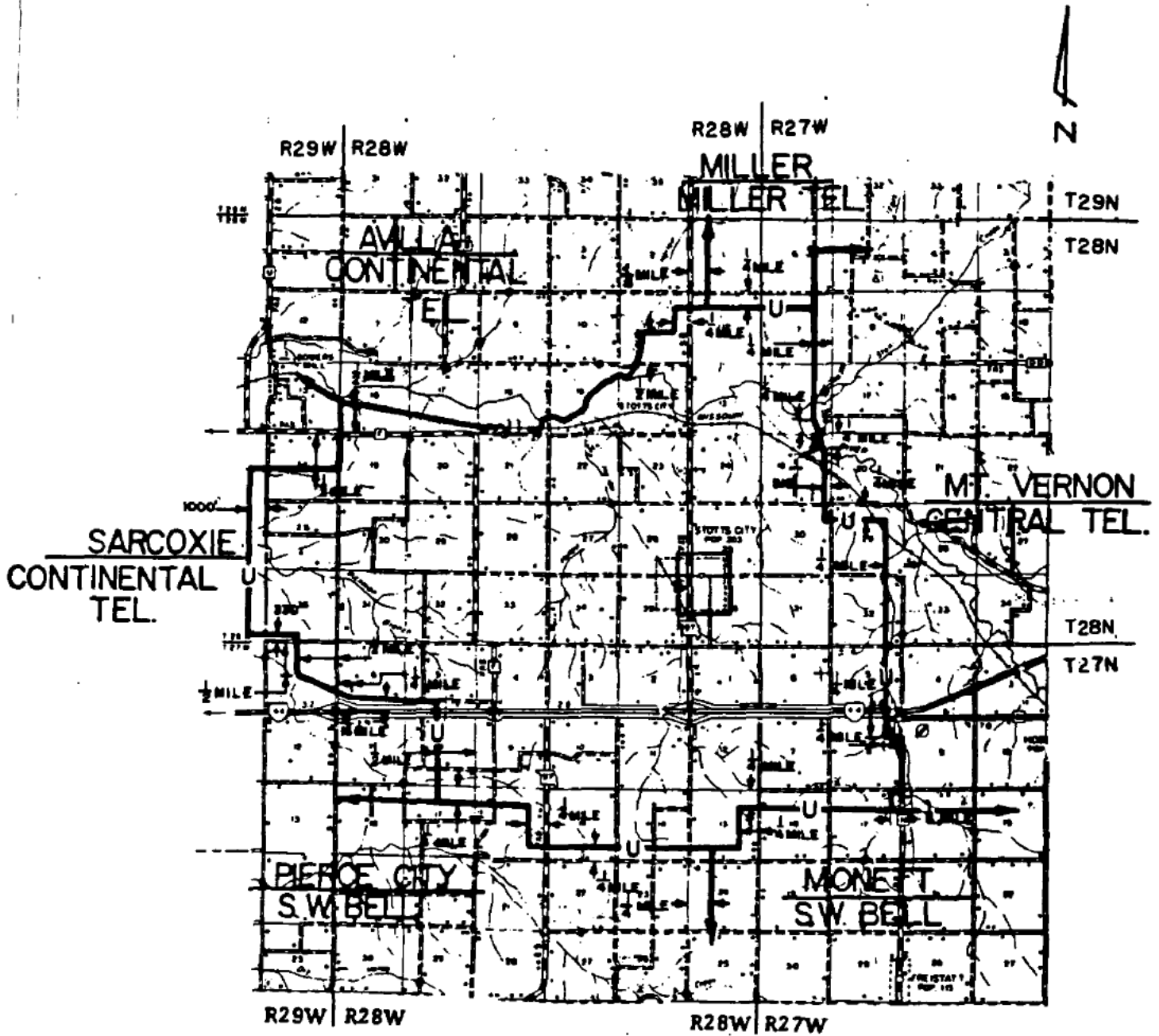

26. EXCHANGE AREA/BASE RATE BOUNDARY MAP - STOVER

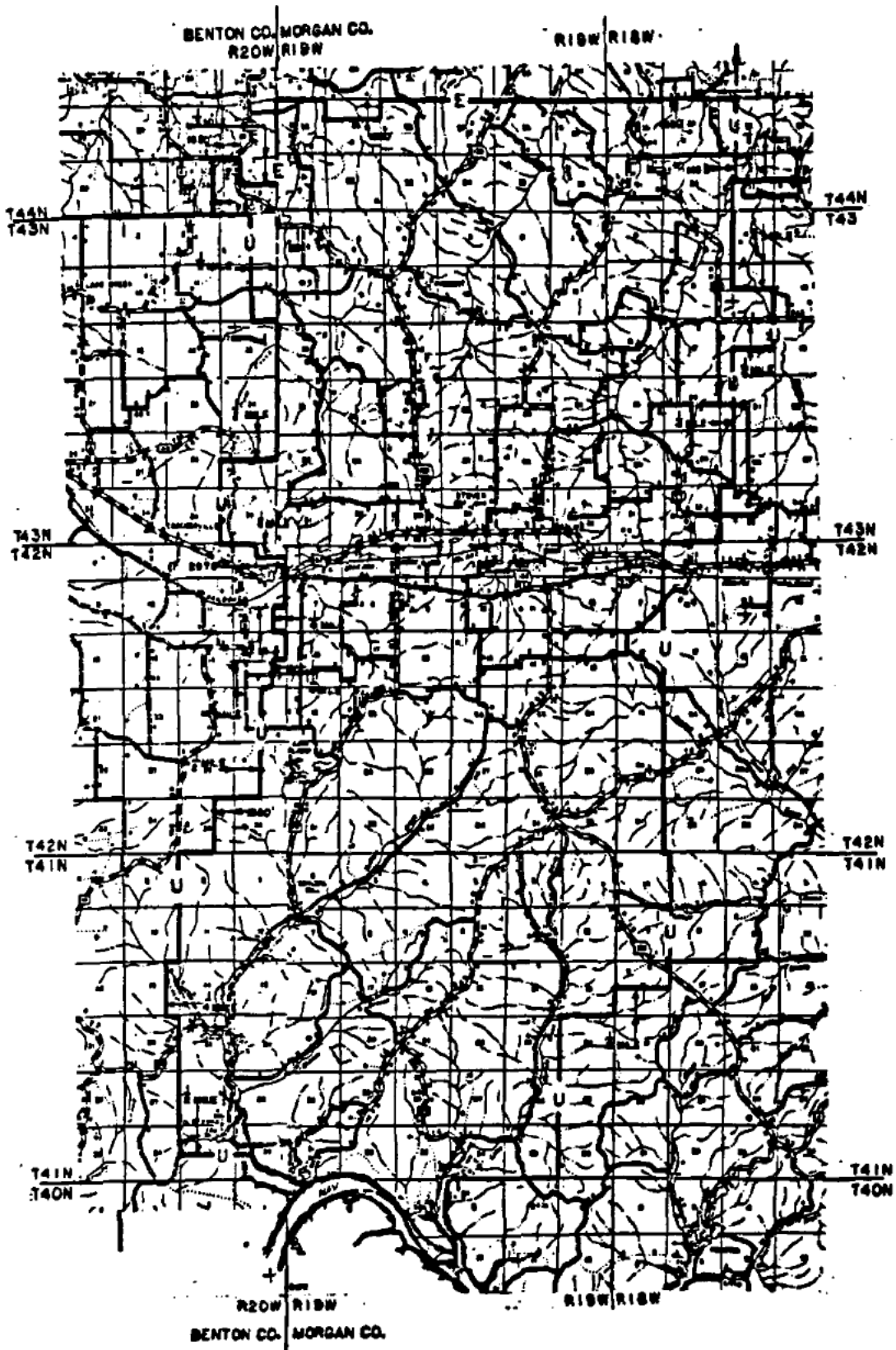

4
N

26. EXCHANGE AREA/BASE RATE BOUNDARY MAP - SUMNER

LACLEDE
ALLIED TEL. CO.

BROOKFIELD
S. W. BELL TEL. CO.

MEADVILLE
GRAND RIVER
MUT. TEL.

HALE
CHARITON
VALLEY
TEL. CO.

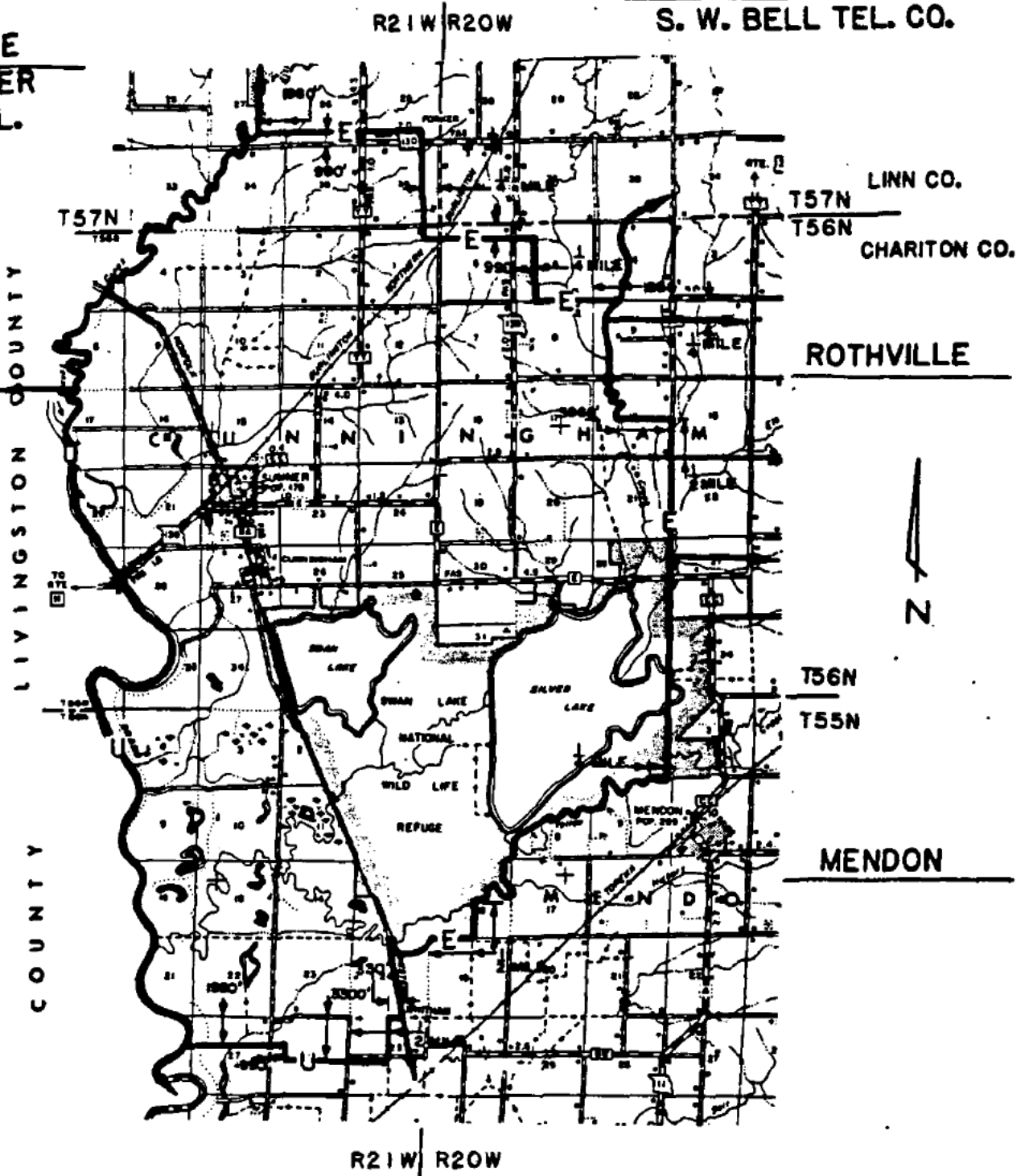

26. EXCHANGE AREA/BASE RATE BOUNDARY MAP - UNION STAR

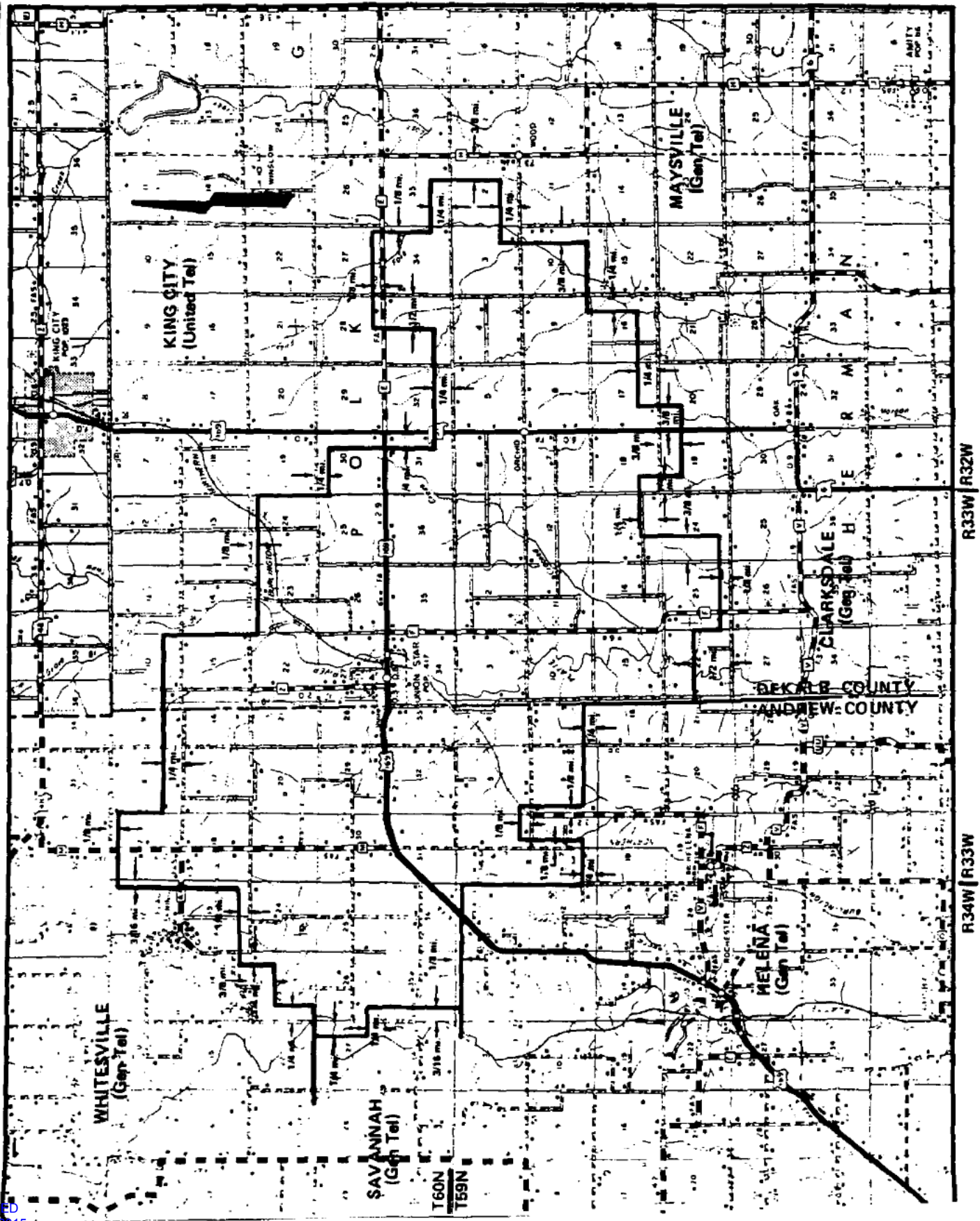

CANCELLED
August 20, 2015
Missouri Public
Service Commission
JI-2016-0057

ISSUED: December 9, 2005
ISSUED BY: Vice President
Little Rock, Arkansas

EFFECTIVE: January 9, 2006

26. EXCHANGE AREA/BASE RATE BOUNDARY MAP - VANDALIA

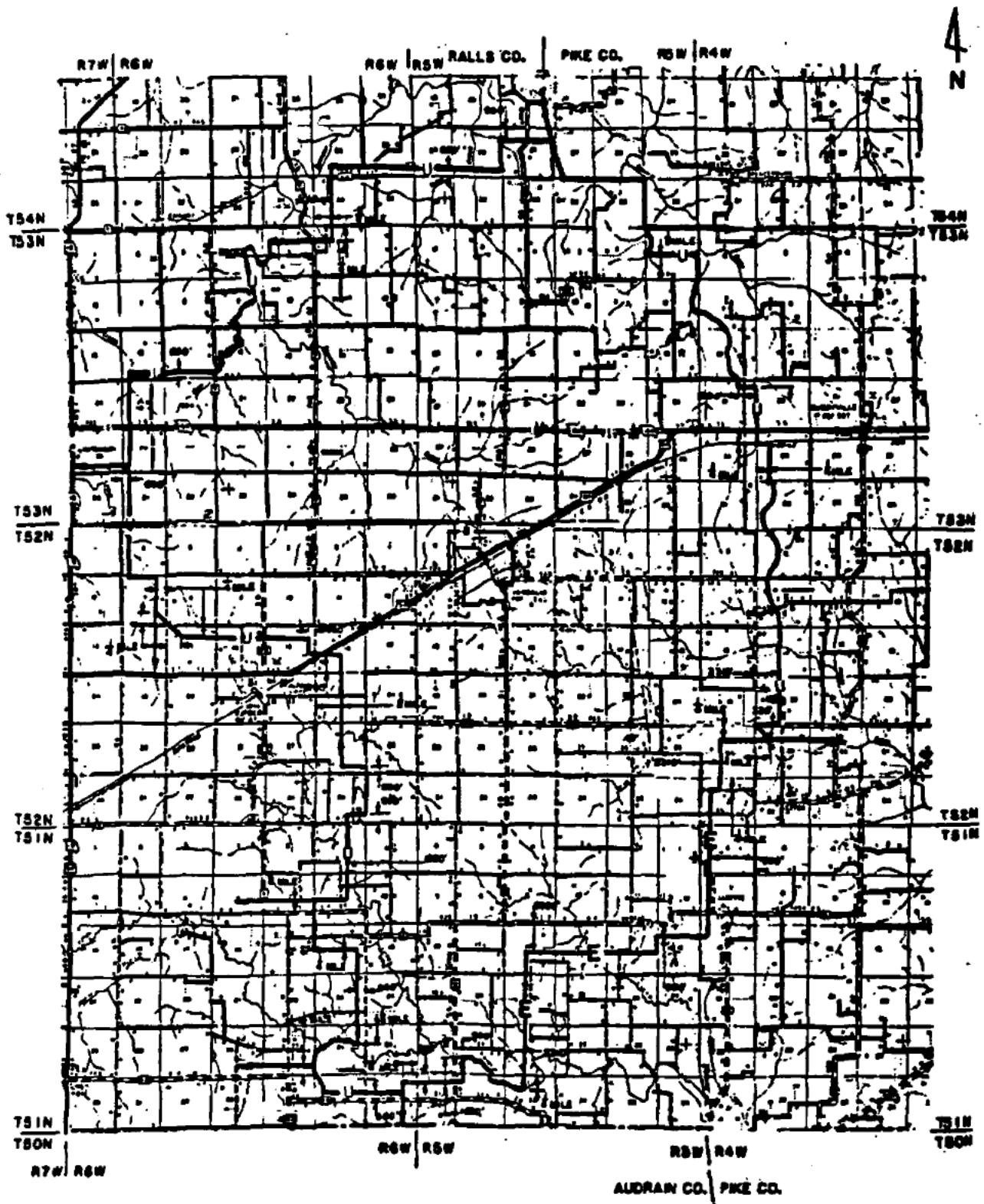

CANCELLED
August 20, 2015
Missouri Public
Service Commission
JI-2016-0057

ISSUED: December 9, 2005
ISSUED BY: Vice President
Little Rock, Arkansas

EFFECTIVE: January 9, 2006

26. EXCHANGE AREA/BASE RATE BOUNDARY MAP - VERONA

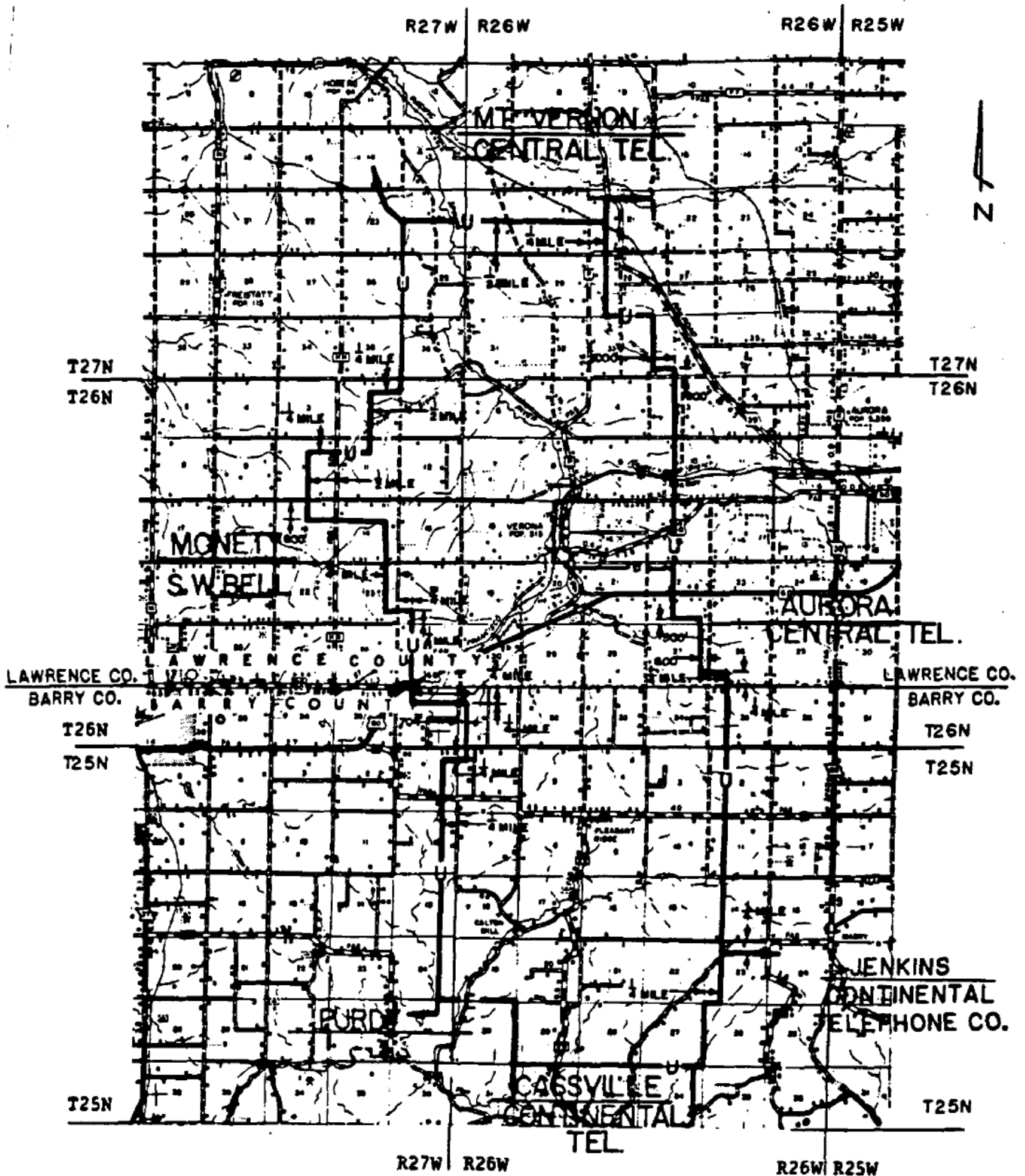

26. EXCHANGE AREA/BASE RATE BOUNDARY MAP - WAPPAPELLO PARK

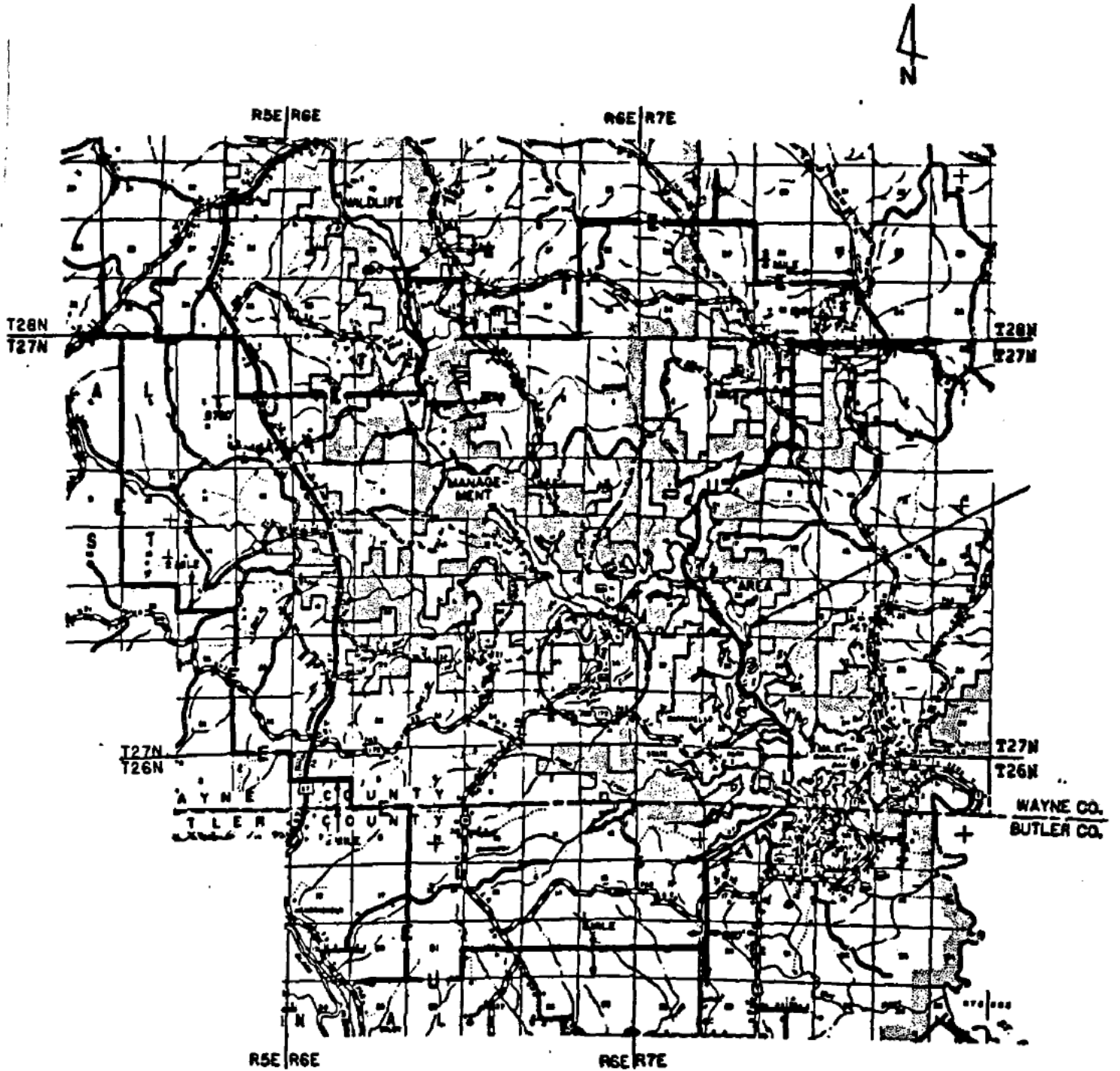

CANCELLED
August 20, 2015
Missouri Public
Service Commission
JI-2016-0057

ISSUED: December 9, 2005
ISSUED BY: Vice President
Little Rock, Arkansas

EFFECTIVE: January 9, 2006

26. EXCHANGE AREA/BASE RATE BOUNDARY MAP - WHEATON

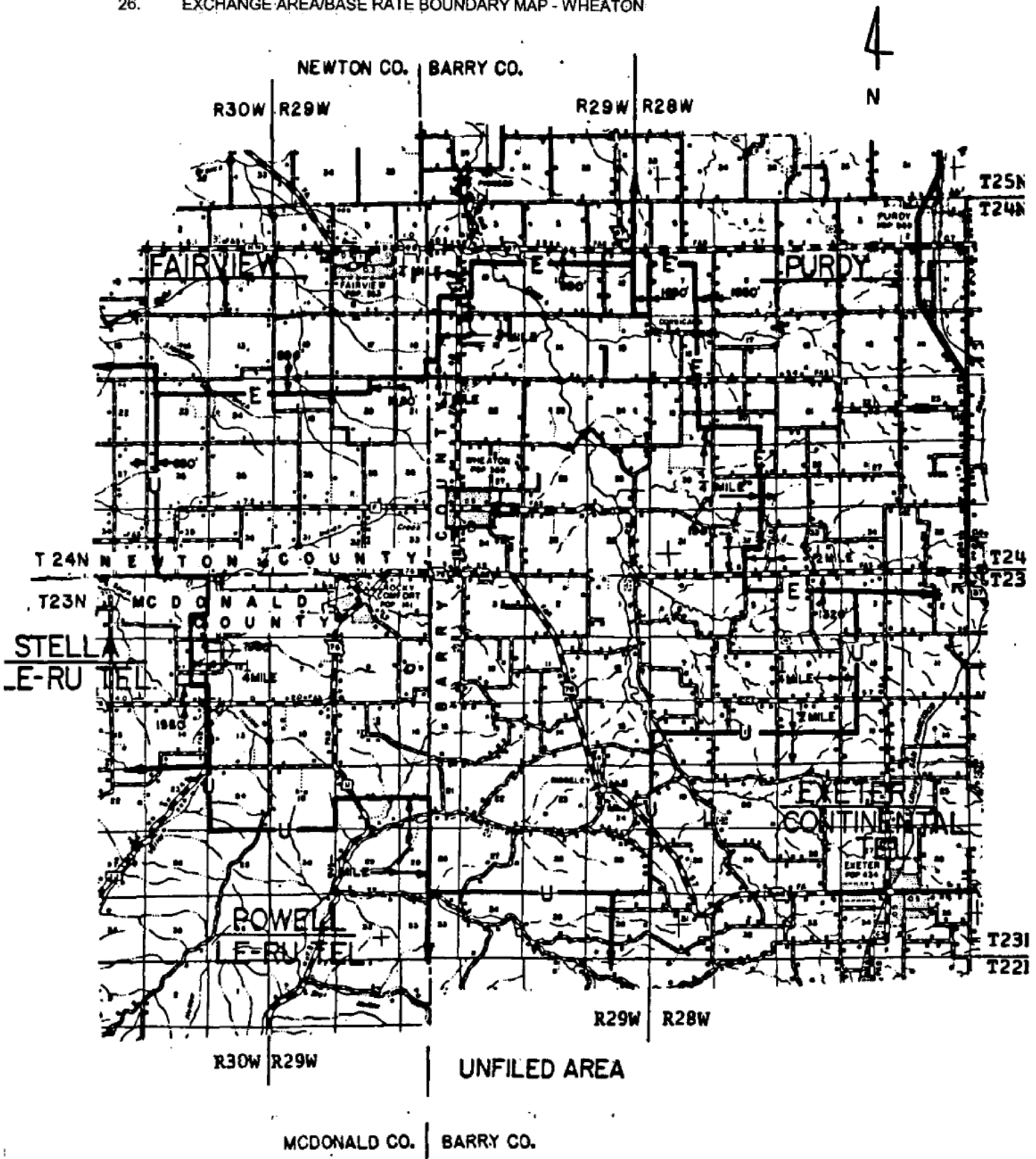

26. EXCHANGE AREA/BASE RATE BOUNDARY MAP - WILLIAMSVILLE



SCALE - 1/2 INCH = 1 MILE

EXCHANGE AREA BOUNDARY MAP

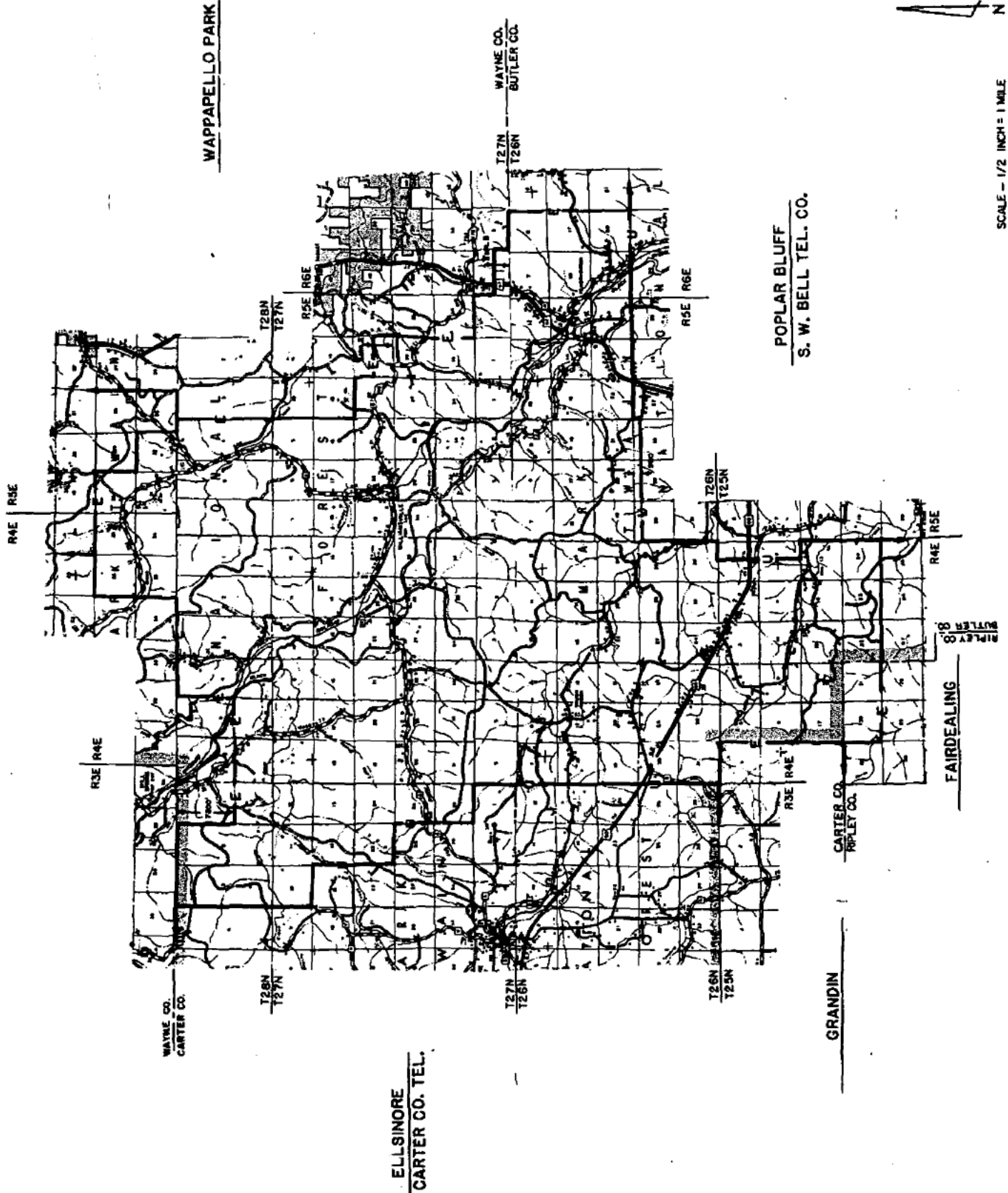

CANCELLED
August 20, 2015
Missouri Public
Service Commission
JI-2016-0057

ISSUED: December 9, 2005
ISSUED BY: Vice President
Little Rock, Arkansas

EFFECTIVE: January 9, 2006

26. EXCHANGE AREA/BASE RATE BOUNDARY MAP - WINSTON

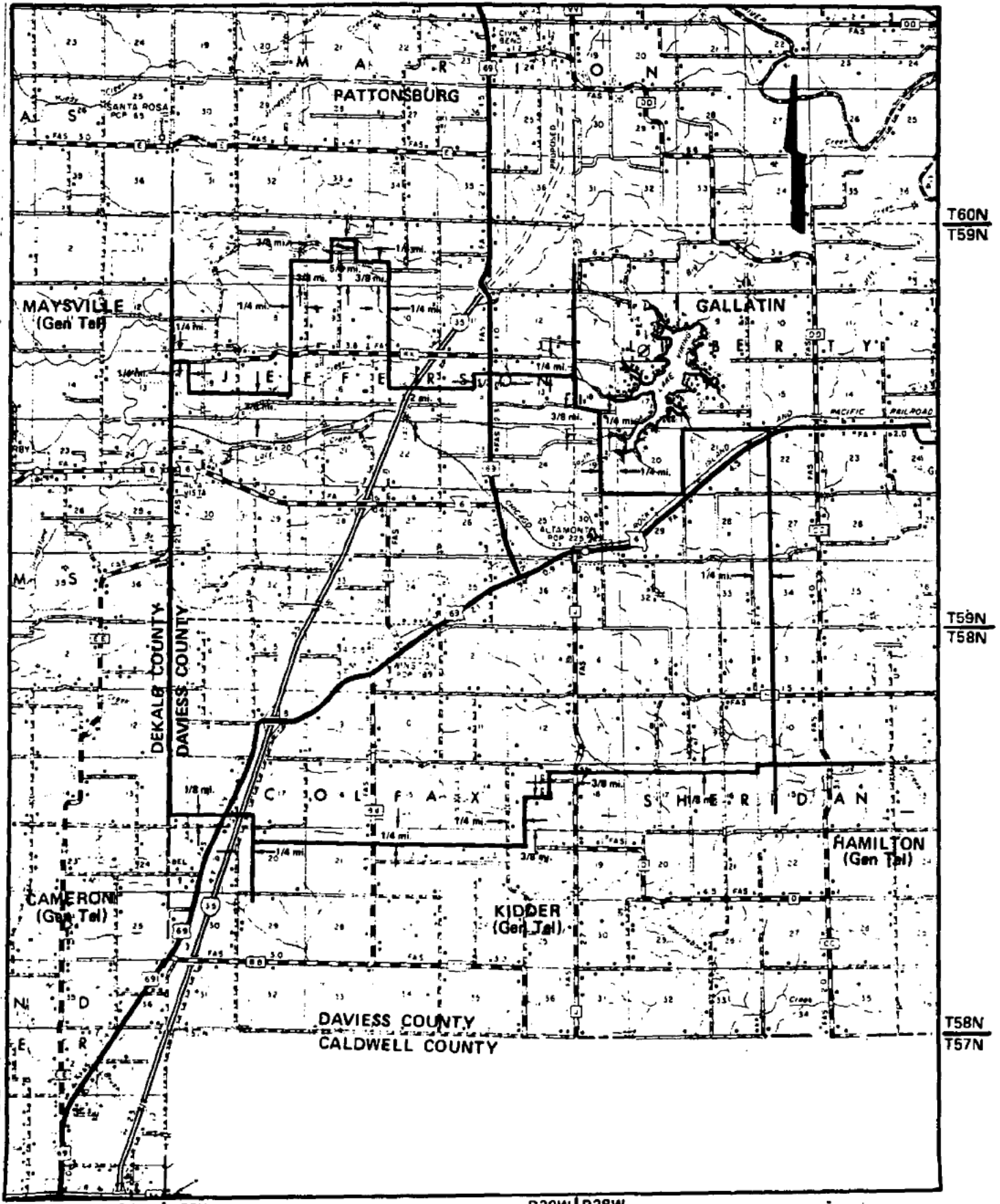

CANCELLED
August 20, 2015
Missouri Public
Service Commission
JI-2016-0057

ISSUED: December 9, 2005
ISSUED BY: Vice President
Little Rock, Arkansas

EFFECTIVE: January 9, 2006