

GENERAL AND LOCAL EXCHANGE TARIFF

As of November 13, 2008, the following statutory and rule provisions no longer apply to the Company as they have been waived* pursuant to §392.420 RSMo. 2008:

A. Rules

4 CSR 240-3.550(4) and (5)(A) – Held Order Records, Quality of Service Reports
4 CSR 240-32.060 – Engineering and Maintenance
4 CSR 240-32.070 – Quality of Service
4 CSR 240-32.080 – Service Objectives and Surveillance Levels
4 CSR 240-33.040 (1-3) and (5-10) – Billing and Payments Standards
4 CSR 240-33.045 – Identification and Placement of Charges on Bills

B. Statutes

Section 392.290 RSMo – Issuance of Stocks, Bonds and Other Indebtedness
Section 392.300 RSMo – Transfer of Property
Section 392.310 RSMo – Approval of Issuance of Stocks, Bonds, or Other Indebtedness
Section 392.320 RSMo – Certificate of Approval for Dividends
Section 392.330 RSMo – Account for Disposition of Proceeds
Section 392.340 RSMo – Reorganization

*See PSC Case No. IE-2009-0189.

Issued: December 12, 2008

Effective: January 11, 2009

Maurice Bosserman, President
Peace Valley Telephone Company, Inc.
P.O. Box 9, 7101 State Road W
Peace Valley, MO 65788

CANCELLED
June 1, 2013
Missouri Public
Service Commission
JI-2013-0439

FILED
Missouri Public
Service Commission
JI-2009-0444

LOCAL EXCHANGE SERVICE

General: Unless otherwise specified, the charges quoted for this tariff are for the period of one month and entitle the subscriber to telephone service and messages to all stations within the service area of Peace Valley Telephone Company.

	Local Exchange Service ¹ (Per Month)	
Business One-Party	\$16.00	(I)
Residence One-Party	\$16.00	(I)

¹Local Exchange Service includes touchtone functionality and the following custom calling features: Call Waiting, Cancel Call Waiting, Call Forwarding and Three-Way Calling.

Issued: September 5, 2014

Effective: December 1, 2014

CANCELLED
June 1, 2016
Missouri Public
Service Commission
JI-2016-0229

Maurice Bosserman
P.O. Box 9, 7101 State Road W
Peace Valley, Missouri 65788

FILED
Missouri Public
Service Commission
JI-2015-0099

LOCAL EXCHANGE SERVICE

General: Unless otherwise specified, the charges quoted for this tariff are for the period of one month and entitle the subscriber to telephone service and messages to all stations within the service area of Peace Valley Telephone Company.

	Local Exchange Service ¹ (Per Month)	
Business One-Party	\$14.00	(I)
Residence One-Party	\$14.00	(I)

¹Local Exchange Service includes touchtone functionality and the following custom calling features: Call Waiting, Cancel Call Waiting, Call Forwarding and Three-Way Calling.

Issued: April 11, 2013

CANCELED
December 1, 2014
Missouri Public
Service Commission
JI-2015-0099

Maurice Bosserman
P.O. Box 9, 7101 State Road W
Peace Valley, Missouri 65788

Effective: June 1, 2013

Filed
Missouri Public
Service Commission
JI-2013-0439

PEACE VALLEY TELEPHONE COMPANY

PSC Mo. No. 1
6th Revised Sheet No. 1
Cancels 5th Revised Sheet No. 1

LOCAL EXCHANGE SERVICE

General: Unless otherwise specified, the charges quoted for this tariff are for the period of one month and entitle the subscriber to telephone service and messages to all stations within the service area of Peace Valley Telephone Company.

	Local Exchange Service ¹ (Per Month)	(T)
Business One-Party	\$10.00	(D)(T)
Residence One-Party	\$10.00	(D)(T)

¹Local Exchange Service includes touchtone functionality and the following custom calling features: Call Waiting, Cancel Call Waiting, Call Forwarding and Three-Way Calling. (D)
(N)
(N)

CANCELLED
June 1, 2013
Missouri Public
Service Commission
JI-2013-0439

Issued: May 9, 2012

Maurice Bosserman
P.O. Box 9, 7101 State Road W
Peace Valley, Missouri 65788

June 1, 2012
Effective: ~~July 1, 2012~~

FILED
Missouri Public
Service Commission
IT-2012-0386; JI-2012-0715

LOCAL EXCHANGE SERVICE

General: Unless otherwise specified, the charges quoted for this tariff are for the period of one month and entitle the subscriber to telephone service and messages to all stations within the service area of Peace Valley Telephone Company.

	Rotary Dial <u>Access</u> ¹	Touch Tone Dial <u>Access</u>	(N)
Business One-Party	\$5.50	\$7.50	(D) (D)
Residence One-Party	\$4.50	\$6.50	(D) (D)

¹ This service is not available to new customers and is only available to existing customers at existing locations. (N)
(N)

Issued: September 22, 2011

Effective: October 22, 2011

CANCELLED
June 1, 2012
Missouri Public
Service Commission
IT-2012-0386; JI-2012-0715

Maurice Bosserman
P.O. Box 9, 7101 State Road W
Peace Valley, Missouri 65788

FILED
Missouri Public
Service Commission
JI-2012-0125

FORM NO. 13 P.S.C.MO. No. 1 ~~Original~~ SHEET No. 1
4th ~~Revised~~
Cancelling P.S.C.MO. No. 1 ~~Original~~ SHEET No. 1
3rd ~~Revised~~

PEACE VALLEY TELEPHONE COMPANY
Name of Issuing Corporation

For Peace Valley and White Church, Mo.
Community, Town or City

RECEIVED

LOCAL EXCHANGE SERVICE		DEC 4 1987
MISSOURI		
General: Unless otherwise specified, the charges quoted are for the period of one month and entitle the subscriber to telephone service and messages to all stations within the service area of Peace Valley Telephone Company.		
	<u>Rotary Dial Access</u>	<u>Touch Tone Dial Access</u>
Business One-Party	\$ 5.50	\$ 7.50
Business Two-Party	3.00	5.00
Business Four-Party	1.50	3.50
Residence One-Party	4.50	6.50
Residence Two-Party	2.50	4.50
Residence Four-Party	1.50	3.50

*Indicates new rate or text
+Indicates change

FILED
JAN 1 1988
86-26
Public Service Commission

DATE OF ISSUE December 3, 1987 28 DATE EFFECTIVE January 1, 1988
month day year month day year

ISSUED BY Quinter Bosserman Owner-Manager Peace Valley, Mo. 65788
name of officer title address

PEACE VALLEY TELEPHONE COMPANY
Name of Issuing Corporation

For Peace Valley and White Church, Mo.
Community, Town or City

RECEIVED

OCT 25 1983

General: Unless otherwise specified, the charges quoted in this tariff are for the period of one month and entitle the subscriber to telephone service and messages to all stations within the service area of the Peace Valley Telephone Company.

MISSOURI
Public Service Commission

	Rotary Dial Access (1)	Touch Tone Dial Access (1)
Buisness One-Party	\$ 5.50	\$ 7.50 *
Business Two-Party	3.00	5.00 *
Business Four-Party	1.50	3.50 *
Residence One-Party	4.50	6.50 *
Residence Two-Party	2.50	4.50 *
Residence Four-Party	1.50	3.50 *

CANCELLED

JAN 01 1988

BY 4th. R.S. #1
PUBLIC SERVICE COMMISSION
OF MISSOURI

- (1) The above rates do not include a company provided instrument. The Monthly charge for a company provided instrument is listed on Sheet 2 of this tariff.

*Indicates new rate or text
+Indicates change

FILED

DEC - 1 1983

Public Service Commission

DATE OF ISSUE 10 24 1983
month day year

DATE EFFECTIVE 12 1 1983
month day year

ISSUED BY Quinter Bosserman
name of officer

Owner-Manager
title

Peace Valley, Mo. 65788
address

{Revised}

{Revised}

PEACE VALLEY TELEPHONE CO.

Name of Issuing Corporation

For Peace Valley and White Church, MO

Community, Town or City

RECEIVED

DEC - 7 1982

General: Unless otherwise specified, the charges quoted in this tariff are for the period of one month and entitle the subscriber to telephone service and messages to all stations within the service area of Peace Valley Telephone Company.

Public Service Commission

Rotary Dial
Access (1)

Business One-Party	\$ 5.50
Business Two-Party	3.00
Business Four-Party	1.50
Residence One-Party	4.50
Residence Two-Party	2.50
Residence Four-Party	1.50

CANCELLED

DEC - 1 1983

BY 3rd RS
PUBLIC SERVICE COMMISSION
OF MISSOURI

- (1) The above rates do not include a company provided instrument. The monthly charge for a company provided instrument is listed on Sheet 2 of this tariff.

*Indicates new rate or text
+Indicates change

FILED

JAN - 1 1983

TAO 799

Public Service Commission

DATE OF ISSUE 12 5 1982
month day yearDATE EFFECTIVE 1 1 1983
month day year

ISSUED BY

Quintus Bozerman
name of officer

Owner-Manager PEACE VALLEY, MO
title address

05788

P. S. C. MO. No. 11st { ~~Original~~ } Revised SHEET No. 1Cancelling P. S. C. MO. No. 1Original { ~~Original~~ } Revised SHEET No. 1 and 2PEACE VALLEY TELEPHONE CO.

Name of Issuing Corporation

For PEACE VALLEY AND WHITE CHURCH, MO.

Community, Town or City

LOCAL EXCHANGE SERVICE

GENERAL

Unless otherwise specified, the charges quoted in this tariff are for the period of one month and entitle the subscriber to standard telephone equipment and messages to all stations, in exchanges, bearing the designation:

RECEIVED

SEP 13 1978

MISSOURI
Public Service Commission

RATES

WITHIN THE INITIAL RATE AREA: Dial Exchange Service

CLASS OF SERVICE				
	One-Party	Two-Party	Four-Party	Extensions
Business	\$ 6.50 +	\$ 4.00 +	\$ 2.50 **	\$ 1.00 **
Residence	5.50 +	3.50 +	2.50 **	1.00 **

CANCELLED

RATES (Rural)

OUTSIDE THE INITIAL RATE AREA. But Within the Exchange Area

CLASS OF SERVICE				
	One-Party	Two-Party	Four-Party	Extensions
Business	\$ 6.50 +	\$ 4.00 +	\$ 2.50 **	\$ 1.00 **
Residence	5.50 +	3.50 +	2.50 **	1.00 **

JAN - 1 1983
BY Sub RS 1
PUBLIC SERVICE COMMISSION
OF MISSOURI

FILED

DEC 1 - 1978

*Indicates new rate
+Indicates change

** Indicates Original rate

Public Service Commission

DATE OF ISSUE September 11, 1978
Month Day YearDATE EFFECTIVE November 1, 1978
Month Day YearISSUED BY Quinter Bosserman
Name of OfficerOwner
TitlePeace Valley, Mo. 65788
Address

DEC 1 1978

P. S. C. MO. No. 1{ Original } SHEET No. 1
{ Revised }

Cancelling P. S. C. MO. No. _____

{ Original } SHEET No. _____
{ Revised }Peace Valley Telephone Company
Name of Issuing CorporationFor Peace Valley, Missouri
Community, Town or City

LOCAL EXCHANGE SERVICE

GENERAL

Unless otherwise specified, the charges quoted in this tariff are for the period of one month and entitle the subscriber to standard ~~xxx~~ telephone equipment and messages to all stations, in exchanges, bearing the designation: /hand set

RATES

WITHIN THE INITIAL RATE AREA:

MAGNETO and C.B.

CLASS OF SERVICE				
Peace Valley				
	One-Party	Two-Party	Four-Party	Extensions
Business	\$4.00 *	\$ 3.00 *	\$ -	\$ 1.50 *
Residence	3.50 *	3.00 *	2.50 *	1.00 *
			Business	Residence
Additional charge for Desk Set Equipment above wall rate			\$ -	\$ -
Additional charge for Hand Set Equipment above wall rate			\$ -	\$ -
CANCELLED JUN 1 1978			STATE OF MISSOURI PUBLIC SERVICE COMMISSION	
			FILE	

Discounts applying to above rates: None

*Indicates new rate
+Indicates changeSTATE OF MISSOURI
PUBLIC SERVICE COMMISSIONCASE NO. 14,910

FILED

AUG 7 1962

PUBLIC SERVICE COMMISSION

DATE OF ISSUE July 3 1961
Month Day YearDATE EFFECTIVE AUG 7 - 1962
Month Day Year

ISSUED BY

Walter Bosserman
Name of OfficerOwner
TitlePeace Valley, Missouri
Address

Peace Valley Telephone Company
Name of Issuing CorporationFor Peace Valley White Church Area
Community, Town or City

RECEIVED

OCT 25 1983

Telephones:

Monthly Rate

MISSOURI
Public Service CommissionStandard Rotary Dial Telephone (1)
Standard Touch Tone Dial Telephone (1)

1.50 *

Miscellaneous Equipment:

Extension Bell (1)
Extension Gong (1)
Switches (1).50
.50
.50

Extension Service:

A. Extension service provides the user with the capability for originating calls from or receiving calls at instruments provided at locations in addition to the location of the main station where such instruments are connected to the same exchange access line as the Main station.

B. A station set rate is applicable to each telephone company provided instrument for use with extension service. Such instrument is provided at rates specified above.

CANCELLED

JAN 01 1988

BY 3rd R.S. #2
PUBLIC SERVICE COMMISSION
OF MISSOURI

(1) Limited Availability. See sheet No. 4.1.

FILED

DEC - 1 1983

*Indicates new rate or text

+Indicates change

Public Service Commission

DATE OF ISSUE 10 24 1983
month day yearDATE EFFECTIVE 12 1 1983
month day year

ISSUED BY Quinter Bosserman

Owner-Manager

Peace Valley, Mo. 65788

name of officer

title

address

Cancelling P.S.C.MO. No. 1SHEET No. 2

PEACE VALLEY TELEPHONE COMPANY

For

Area Served

Name of Issuing Corporation

Community, Town or City

RECEIVED

LOCAL EXCHANGE SERVICE

DEC - 7 1982

Telephones:

Monthly Rate

MISSOURI

Standard Telephone (1)

\$ 1.00

Public Service Commission

Miscellaneous Equipment:

Extension Bell	(1)	.50
Extension Gong	(1)	.50
Switches	(1)	.50

Extension Service:

A. Extension service provides the user with the capability for originating calls from or receiving calls at instruments provided at locations in addition to the location of the main station where such instruments are connected to the same exchange access line as the main station.

B. A station set rate is applicable to each telephone company provided instrument⁽¹⁾ for use with extension service. Such instrument is provided at rates specified above.

CANCELLED

DEC - 1 1983

BY 2nd RS 2
PUBLIC SERVICE COMMISSION
OF MISSOURI

(1) Limited Availability. See Sheet No. 4.1.

FILED

JAN - 1 1983

TAO 799

*Indicates new rate or text

+Indicates change

DATE OF ISSUE 12 5 1982
month day yearDATE EFFECTIVE 1 1 1983
month day yearISSUED BY Walter Boeserman Owner/Manager PEACE VALLEY MO,
name of officer title address

65788

{ Original }
{ Revised } SHEET No. 2

Cancelling P. S. C. MO. No. _____

{ Original }
{ Revised } SHEET No. _____Peace Valley Telephone Company
Name of Issuing CorporationFor Peace Valley, Missouri

Community, Town or City

LOCAL EXCHANGE SERVICE

RATES (Rural)

OUTSIDE THE INITIAL RATE AREA, But Within the Exchange Area.

CLASS OF SERVICE	Rate per Month Month	
	Business	Residence
A. Switching. Where the pole line and all equipment is owned by members of the association of the line and meets the exchange lines at the initial rate area limits	\$	\$
B. Company Owned. Where the company owns and maintains all equipment for rendering the service	2.50*	2.50*
C. Where the Subscriber owns and maintains the poles, wire and other line equipment and the company owns and maintains the instrument		
D. Where the company owns and maintains the pole line and all wire and the subscriber owns and maintains the instrument		
E. Mileage charges \$.50 per $\frac{1}{4}$ mile or fraction thereof airline measurement for city service outside the Base Rate Area.		

STATE OF MISSOURI
PUBLIC SERVICE COMMISSION
CASE NO. 14,910

CANCELLED

DEC 1 1978
BY ISX PS 1
PUBLIC SERVICE COMMISSION
OF MISSOURI

FILED

AUG 7 - 1962

Discounts applying to above rates. None

PUBLIC SERVICE COMMISSION

*Indicates new rate
+Indicates change

DATE OF ISSUE _____
Month Day YearDATE EFFECTIVE AUG 7 - 1962
Month Day Year

ISSUED BY

Walter Basserman
Name of OfficerOwner
TitlePeace Valley, Missouri
Address

{ Original
Revised }{ Original
Revised }Peace Valley Telephone Company
Name of Issuing Corporation

For _____

Peace Valley Telephone Company
Community Telephone**RECEIVED**

Local Exchange Service

DEC - 3 1986

MISSOURI

Public Service Commission

1. Extra Directory Listings

2. Unlisted Number

\$.50/month

3. Joint User Service

\$.75/month

SERVICE CHARGES

1. Installation of Service to Demarcation Point

\$3.25/month

2. Transfer or Name Change when no change in the
Demarcation Point is requested by the customer

\$ 10.00

3. Move or Change of Demarcation Point

\$ 5.00

4. Restoration of Service after suspension for which
the subscriber is responsible

\$ 10.00

5. DEMARCATIION POINT - The point of connection, provided and maintained by the telephone utility to which the inside station wiring becomes dedicated to an individual customer's use. For an individual customer dwelling, this point of connection will generally be immediately adjacent to the protector or the customer's side of the protector. The drop and block, including the protector, will continue to be provided by and remain the property of the telephone utility.

CANCELLED

APR 15 1997
BY 4th P.S. #3
Public Service Commission
MISSOURI

FILED
JAN - 1 1987
TAO 877
Public Service Commission

*Indicates new rate or text

+Indicates change

DATE OF ISSUE 12 2 1986
month day yearDATE EFFECTIVE 1 1 1987
month day yearISSUED BY Quinta Booserman
name of officerOwner
titlePEACE VALLEY, MO.
address 65788

PEACE VALLEY TELEPHONE COMPANY

For

Area Served

Name of Issuing Corporation

Community, Town or City

RECEIVED

LOCAL EXCHANGE SERVICE

DEC - 7 1982

EXTRA DIRECTORY LISTINGS:

Business MISSOURI \$.50

Per Month

Residence

Public Service Commission

UNLISTED NUMBER:

Business75

Per Month

Residence75

JOINT USER SERVICE:

Business 3.25

Per Month

Residence 3.25

MOVES AND CHANGE CHARGES:

Inside of Room 5.00

Inside of Building 5.00

Outside of Building 10.00

Change in Style of Instrument 15.00

SERVICE CONNECTION CHARGES:

Installation of telephone, either Main or Party line, in the city 10.00

Installation of telephone, either Main or Party line, in the country 10.00

Installation of Extension in City or Country 5.00

Service Connection or Name Change where the telephone is in place 5.00

For restoration of service after suspension for which the subscriber
is responsible, City 3.00For restoration of service after suspension for which the subscriber
is responsible, Country 3.00

CANCELLED

JAN 1 1987

BY 3rd P.S. 3
PUBLIC SERVICE COMMISSION
OF MISSOURI

FILED

JAN - 1 1983

TAO 799

*Indicates new rate or text

+Indicates change

DATE OF ISSUE 12 5 1982
month day yearDATE EFFECTIVE 1 1 1983
month day yearISSUED BY Walter Bosserman Owner-Manager PEACE VALLEY, MO
name of officer title address

65788

FORM NO. 13 P.S.C.MO. No. 1 / 57 { Original } SHEET No. 3
{ Revised }
Cancelling P.S.C.MO. No. 1 { Original } SHEET No. 3
{ Revised }

PEACE VALLEY TELEPHONE CO.
Name of Issuing Corporation

For Peace Valley, Missouri
Community, Town or City

LOCAL EXCHANGE SERVICE	
SEP 13 1978	
EXTRA DIRECTORY LISTINGS : Business	MISSOURI . . . \$.50
Per Month Residence	.50*
UNLISTED NUMBER : Business75*
Per Month Residence	.75*
JOINT USER SERVICE : Business	3.25
Residence	3.25
MISCELLANEOUS EQUIPMENT : Extension Bell50
Extension Gong	.50
Switches	.50
MOVES AND CHANGE CHARGES : Inside of Room	5.00
Inside of Building	5.00
Outside of Building	10.00
Change in style of instrument	5.00
SERVICE CONNECTION CHARGES :	
Installation of telephone, either Main or Party line, in the city	10.00
Installation of telephone, either Main or Party line, in the country	10.00
Installation of Extension in City or Country	5.00
Service Connection or Name Change where the telephone is in place	5.00
For restoration of service after suspension for which the subscriber is responsible, City	3.00
For restoration of service after suspension for which the subscriber is responsible, Country	3.00

*Indicates new rate or text
+Indicates change

RECEIVED
SEP 13 1978
Public Service Commission

CANCELLED
JAN - 1 1983
BY *Quil* PS-3
PUBLIC SERVICE COMMISSION
OF MISSOURI

FILED
DEC 1 - 1978
Public Service Commission

DATE OF ISSUE September 11, 1978 DATE EFFECTIVE December 1, 1978
month day year month day year

ISSUED BY Quinter Bosserman Owner Peace Valley, Mo.
name of officer title address

P. S. C. MO. No. 1

{Original} SHEET No. 3
{Revised}

Cancelling P. S. C. MO. No.

{Original} SHEET No.
{Revised}Peace Valley Telephone Company
Name of Issuing CorporationFor Peace Valley, Missouri
Community, Town or City

I X28065

LOCAL EXCHANGE SERVICE

Extra Directory Listings: Business.....	\$.50*
Residence.....	.25*
JOINT USER SERVICE	
Business.....	2.00*
Residence.....	1.25*
MISCELLANEOUS EQUIPMENT	
Extension Bell.....	.30*
Extension Gong.....	.50*
Switches.....	.25*
Portable telephone.....	-
MOVES AND CHANGE CHARGES:	
Inside of Room.....	3.00*
Inside of Building.....	3.00*
Outside of Building.....	5.00*
Change in style of instrument.....	-
SERVICE CONNECTION CHARGES:	
Installation of telephone, either Main or Party line, in the city.....	5.00*
Installation of telephone, either Main or Party line, in the country.....	5.00*
Installation of Extension in City or Country.....	3.00*
Service Connection or Name Change where the telephone is in place.....	3.00*
For restoration of service after suspension for which the subscriber is responsible, City.....	1.00*
For restoration of service after suspension for which the subscriber is responsible, Country.....	2.00*

CANCELLED
 DEC 1 1978
 BY 157RS3
 PUBLIC SERVICE COMMISSION
 OF MISSOURI

STATE OF MISSOURI
 PUBLIC SERVICE COMMISSION
 CASE NO. 14,910

FILED

AUG 7 - 1962

PUBLIC SERVICE COMMISSION

*Indicates new rate
 +Indicates change

DATE OF ISSUE July 3 1961
Month Day YearDATE EFFECTIVE AUG 7 - 1962
Month Day YearISSUED BY Quinter Basserman Owner Peace Valley, Missouri
Name of Officer Title Address

LOCAL EXCHANGE SERVICE

RECEIVED

6. Service Connections - Link Up Missouri

NOV 19 1997

A. Applicability of Link Up Missouri Service Connection Program

1. The Link Up Missouri Service Connection Program is a Federal Lifeline assistance program applicable to and designed to promote subscribership to the telephone network among low income residential households.

- a. Service Connection Charges, as set forth in this tariff¹, for initial installation of the main residential service access line, will be discounted at a rate of 50 percent, or \$30.00, whichever is less. These reduced charges shall be assessed only for a single residential telephone line per eligible household at the principle place of residence. +
- b. The customer may defer payment on up to \$200 of the above charges without interest for a period not to exceed one year. The deferred charges do not include any permissible security deposits required. Payments shall be equally paid over a twelve month period. +
- c. A qualifying low-income customer may choose with a or b, or both a and b as described above.
- d. Link Up assistance is available for a second or subsequent time only for a principal place of residence with an address different from the residence address where assistance was previously provided.
- e. The premises at which the residence service is requested must be the applicant's principal place of residence.
- f. There is only one telephone line serving the residence premises. The residence premises household (dwelling unit) shall consist of that portion of an individual house or building or one flat or apartment occupied by a single family or individuals functioning as one domestic establishment.
- g. Link Up will not be furnished on a Foreign Exchange service. *

¹ These do not include other charges that may be required at the initiation of service such as security, deposit, contributions in aid of construction, customer advances, etc.

*Indicates new rate or text
+Indicates change

JAN -1 1998

MISSOURI

Public Service Commission
Effective: January 1, 1998

Issued: November 25, 1997

Maurice Bosserman
Peace Valley Telephone Co.
Peace Valley, MO 65788

CANCELLED
April 27, 2012
Missouri Public
Service Commission
JI-2012-0527

Peace Valley Telephone Company
Name of Issuing Corporation

For _____

Peace Valley
Community Telephone Company**RECEIVED**

LOCAL EXCHANGE SERVICE

SEP 15 1988

MISSOURI

6. Service Connections - Link Up Missouri

Applicability of Link Up Missouri Service Connection Program

1. The Link Up Missouri Service Connection Program is a Federal Lifeline assistance program applicable to eligible residential subscribers, as defined below, and designed to promote subscribership to the telephone network among low income residential households.

- a. Service Connection Charges, as set forth in this tariff, for initial installation of the main residential service access line, will be discounted at a rate of 50 percent, not to exceed \$30.00. These reduced charges shall be assessed only for a single residential telephone line per eligible household at the principle place of residence.

2. Eligibility Requirements:

The following requirements shall be used by the company to determine the eligibility of a subscriber for Link Up Missouri Assistance.

- a. Subscribers must have lived at an address where there has been no telephone service for at least three months prior to the date that assistance is requested.
- b. Eligible subscribers must not have received this assistance within the last two years.
- c. Subscribers must not be a dependent for federal income tax purposes, unless the subscriber is more than 60 years of age.
- d. Subscriber is currently receiving MEDICAID/medical assistance payments from the State of Missouri, and has provided their Department of Social Services Client Number (DCN) to the Company.

Of the eligibility requirements listed above, items a., b., and c., will be certified by the subscriber, and item d. will be State certified by the Department of Social Services.

¹These do not include other charges that may be required for the initiation of service such as security, deposit, contribution of construction, customer advances, etc.

*Indicates new rate or text
+Indicates change

Public Service Commission**CANCELLED**

JAN 01 1988

SEP 15 1988

SEP 15 1988

SEP 15 1988

SEP 15 1988

SEP 15 1988

DATE OF ISSUE September 14, 1988
month day yearDATE EFFECTIVE SEP 26 1988
month day yearISSUED BY Quinter Bosserman, Owner
name of officerPeace Valley, MO 65788
title address

LOCAL EXCHANGE SERVICE

6. Service Connections – Link Up Missouri (Cont'd)

A. Applicability of Link Up Missouri Service Connection Program (Cont'd)

2. Eligibility Requirements

The following requirements shall be used by the company to determine the eligibility of a subscriber for Link Up Missouri Assistance.

a. The customer must participate in one of the following programs:

1. Medicaid
 2. Food Stamps
 3. Supplemental Security Income (SSI)
 4. Federal public housing assistance
 5. Low Income Home Energy Assistance Program
 6. Temporary Assistance to Needy Families (TANF)
 7. National Free Lunch Program
- (+)
(+)
(+)

b. The customer must sign, under penalty of perjury a document certifying:

1. He/she is receiving benefits from one of the programs in 2.a. above.
2. Name of the program(s) from which they are receiving benefits.
3. That he/she will notify the company if he/she no longer participates in the program(s) named in a. preceding.

*Indicates new rate or text
+Indicates change

Issued: May 19, 2005

Effective: June 22, 2005

Maurice Bosserman
Peace Valley Telephone Co.
Peace Valley, MO

CANCELLED
April 27, 2012
Missouri Public
Service Commission
JI-2012-0527

LOCAL EXCHANGE SERVICE

6. Service Connections – Link Up Missouri (Cont'd)

A. Applicability of Link Up Missouri Service Connection Program (Cont'd)

2. Eligibility Requirements

The following requirements shall be used by the company to determine the eligibility of a subscriber for Link Up Missouri Assistance.

a. The customer must participate in one of the following programs:

1. Medicaid
2. Food Stamps
3. Supplemental Security Income (SSI)
4. Federal public housing assistance
5. Low Income Home Energy Assistance Program
6. Persons with Income below 135% of Federal Poverty Level (*)
7. Temporary Assistance to Needy Families (TANF) (*)
8. National Free Lunch Program

b. The customer must sign, under penalty of perjury a document certifying:

1. He/she is receiving benefits from one of the programs in 2.a. above.
2. Name of the program(s) from which they are receiving benefits.
3. That he/she will notify the company if he/she no longer participates in the program(s) named in a. preceding.

*Indicates new rate or text

+Indicates change

LOCAL EXCHANGE SERVICE

RECEIVED

6. Service Connections - Link Up Missouri (Cont'd)

NOV 19 1997

A. Applicability of Link Up Missouri Service Connection Program (Cont'd)

MO. PUBLIC SERVICE COM.

2. Eligibility Requirements

The following requirements shall be used by the company to determine the eligibility of a subscriber for Link Up Missouri assistance.

- a. The customer must participate in one of the following programs:
 - 1. Medicaid
 - 2. Food Stamps
 - 3. Supplemental Security Income (SSI)
 - 4. Federal public housing assistance
 - 5. Low Income Home Energy Assistance Program
- b. The customer must sign, under penalty of perjury a document certifying:
 - 1. He/she is receiving benefits from one of the programs in 2.a. above.
 - 2. Name of the program(s) from which they are receiving benefits.
 - 3. That he/she will notify the company if he/she no longer participates in the program(s) named in a. preceding.

*Indicates new rate or text
+Indicates change

FILED

JAN -1 1998

MISSOURI

Public Service Commission
Effective: January 1, 1998

Issued: November 25, 1997

Maurice Bosserman
Peace Valley Telephone Co.
Peace Valley, MO 65788

FORM NO. 13

P.S.C.MO. No. 1

3rd

ORIGINAL SHEET NO. 4

Cancelling P.S.C.MO. No. 1

2nd

SHEET No. 4

DEC 8 1977

Peace Valley Telephone Company
Name of Issuing Corporation

For Peace Valley, Mo.

Community, Town

Howell County

Public Service Commission

EXCHANGE AREA BOUNDARY MAP

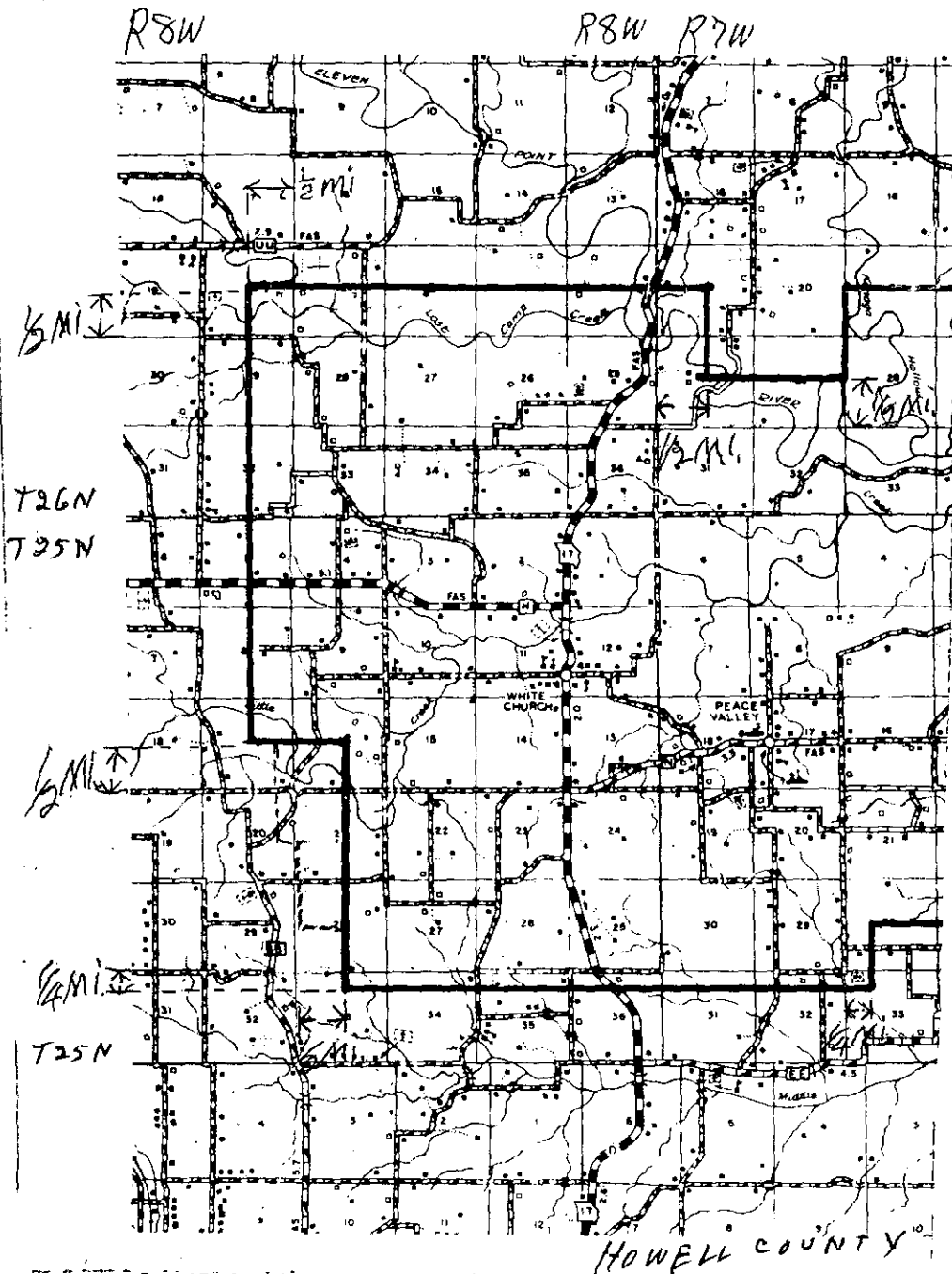

CANCELLED

JAN 28 2003

By 44RSK
Public Service Commission
MISSOURI*Indicates new rate or text
+Indicates changeDATE OF ISSUE December 5, 1977
month day yearDATE EFFECTIVE January 5, 1978
month day yearISSUED BY Quinter Bosserman
name of officer

Owner

Peace Valley, Mo. 65788
title Public Service Commission

FILED

SHEET No. 4.

SHEET No. 4

RECEIVED

DEC 3

1970

Peace Valley Telephone Co.
Name of Issuing Corporation

For

Peace Valley, Mo.

Community, Town or City
Howell, County

PUBLIC SERVICE COMMISSION

EXCHANGE AREA BOUNDARY MAP

DEC 3 1970

Public Service Commission

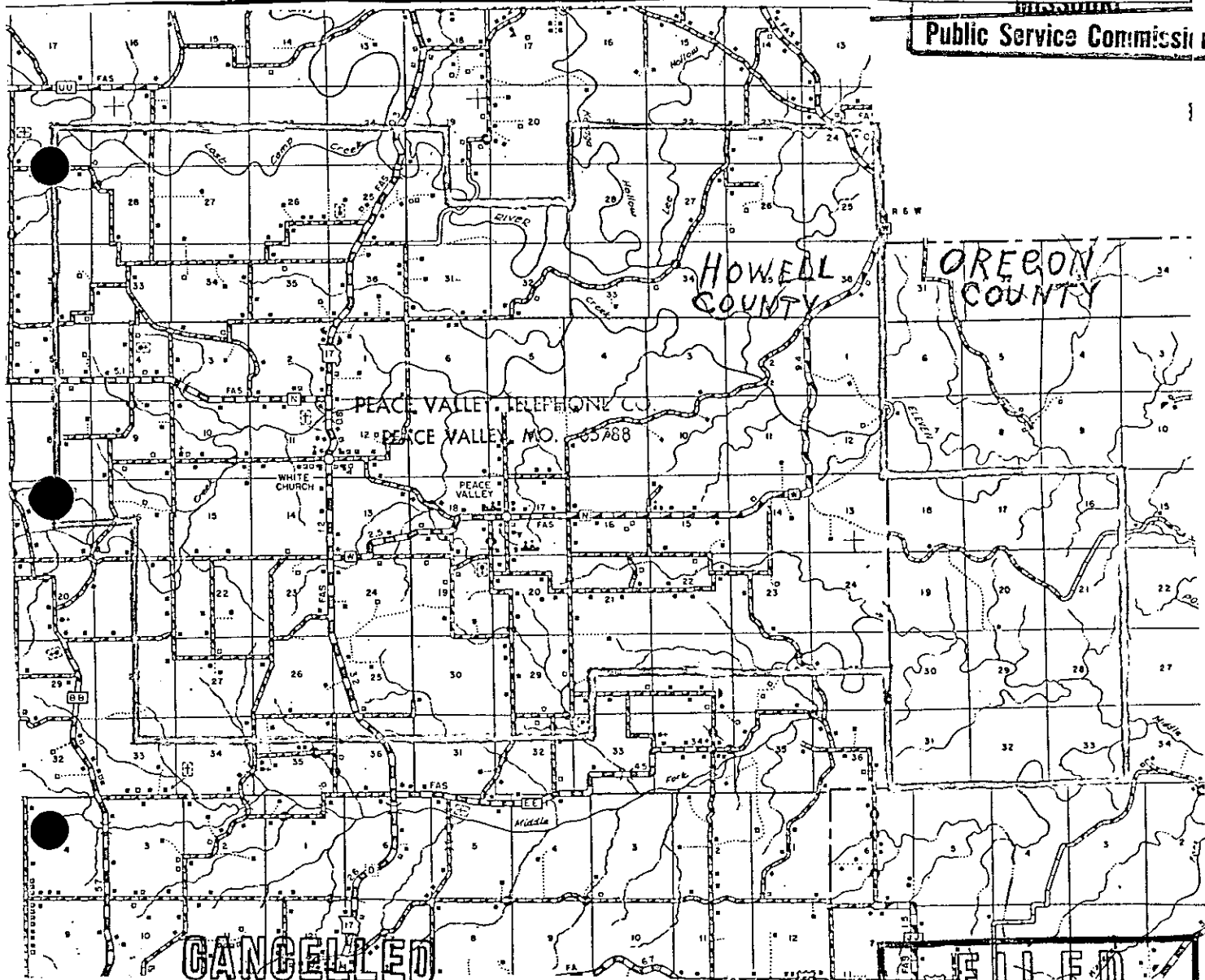

JAN 5 1978

BY 314 R.S. 4
PUBLIC SERVICE COMMISSION
*Indicates new rate or text
+Indicates change

JAN 4 1971

Public Service Commission

DATE OF ISSUE December 4, 1970
month day year

DATE EFFECTIVE January 4, 1971
month day year

ISSUED BY Quinter Bosserman
name of officer

Owner	Peace Valley, Mo.
title	address

65788

LIFELINE SERVICE

A. General Regulations

1. Lifeline service is available to qualifying low-income subscribers for single-party residence service.
2. The monthly discount will be the maximum amount allowed by the Missouri Public Service Commission and the Federal Communications Commission; however, this discount will not exceed the sum of the federal subscriber line charge and the recurring charges for voice telephony service. The monthly discount will be the same for Lifeline customers solely subscribing to voice telephony service and for Lifeline customers subscribing to a bundle of services.
3. Lifeline will not be furnished on a Foreign Exchange service.
4. Lifeline service shall not be disconnected for non-payment of toll charges.
5. Toll blocking provides a means of restricting access to the Long Distance Message Telecommunications Network. Toll blocking for the purposes of lifeline service will restrict 1+, 0+ and 0- (operator handled) calls.
 - a. If the customer chooses "toll blocking" the company will not charge a service deposit.
 - b. Toll blocking is offered to Lifeline subscribers at no charge.

(T)
|
(T)
(D)

*Indicates new rate or text
+Indicates change

(D)
(D)

Issued: March 28, 2012

Maurice Bosserman
Peace Valley Telephone Co.
Peace Valley, MO 65788

Effective: April 27, 2012

CANCELLED
December 2, 2016
Missouri Public
Service Commission
JI-2017-0103

FILED
Missouri Public
Service Commission
JI-2012-0527

LIFELINE SERVICE

REC'D MAY 31 2002

A. General Regulations

Service Commission

1. Lifeline service is available to qualifying low-income subscribers for single-party residence service.
2. Lifeline service is a reduction in the monthly local service charges normally paid by qualifying low-income consumers. Eligible Lifeline subscribers will receive a baseline credit equal to 100% of the Federal End User Subscriber Line Charge as specified in the Company's Interstate Access Tariff and a supplemental reduction of their residential access line rate for one party service of \$1.75. The components of the reduction to basic residential one-party rates are as follows: (+) (+) (+)

State reduction in local rate: \$1.75

Federal baseline Lifeline reduction: (a) (+)

The Federal baseline lifeline reduction shall be used to waive the consumers Federal End-User Common Line charge.

3. Lifeline will not be furnished on a Foreign Exchange service.
4. Lifeline service shall not be disconnected for non-payment of toll charges.
5. Toll blocking provides a means of restricting access to the Long Distance Message Telecommunications Network. Toll blocking for the purposes of lifeline service will restrict 1+, 0+ and 0- (operator handled) calls.
 - a. If the customer chooses "toll blocking" the company will not charge a service deposit.
 - b. Toll blocking is offered to Lifeline subscribers at no charge.

- (a) Baseline amount of Federal Credit is equal to 100% of the Federal End User Subscriber Line Charge as specified in the Company's Interstate Access Tariff. (*) (*)

Missouri Public

- * Indicates new rate or text
+ Indicates change

FILED JUL 01 2002

Service Commission

Peace Valley Telephone Company
of Peace Valley, Missouri

P.S.C. MO. No. 1
5th Revised Sheet No. 4.1
Replaces 4th Revised Sheet No. 4.1
Missouri Public

LIFELINE SERVICE

REC'D NOV 30 2001

A. General Regulations

Service Commission

1. Lifeline service is available to qualifying low-income subscribers for single-party residence service.
2. Lifeline service is a reduction in the monthly local service charges normally paid by qualifying low-income consumers. Eligible Lifeline subscribers will receive a total reduction of their basic local rate for residential one-party service of \$6.75. +
The components of the reduction to basic residential one-party rates are as follows:

State reduction in local rate: \$1.75

Federal baseline Lifeline reduction: \$5.00 +

The Federal baseline lifeline reduction shall be used to waive the consumers Federal End-User Common Line charge.

3. Lifeline will not be furnished on a Foreign Exchange service.
4. Lifeline service shall not be disconnected for non-payment of toll charges.
5. Toll blocking provides a means of restricting access to the Long Distance Message Telecommunications Network. Toll blocking for the purposes of lifeline service will restrict 1+, 0+ and 0- (operator handled) calls.
 - a. If the customer chooses "toll blocking" the company will not charge a service deposit.
 - b. Toll blocking is offered to Lifeline subscribers at no charge.

* Indicates new rate or text
+ Indicates change

CANCELLED

JUL 01 2002
6th RS 4.1
Public Service Commission
MISSOURI

Issued: November 30, 2001

Maurice Bosserman
Peace Valley Telephone Company
Peace Valley, MO 65788

Effective: January 1, 2002

Missouri Public

FILED JAN 01 2002

Service Commission

Peace Valley Telephone Company
of Peace Valley, Missouri

P.S.C. MO. NO. 1
4th Revised Sheet No. 4.1
Cancels 3rd Revised Sheet No. 4.1

RECEIVED

LOCAL EXCHANGE SERVICE

LIFELINE SERVICE

JAN 07 1998

A. General Regulations

MISSOURI
Public Service Commission

1. Lifeline service is available to qualifying low-income subscribers for single party residence service.
2. Lifeline service is a reduction in the monthly local service charges normally paid by qualifying low-income consumers. Eligible Lifeline subscribers will receive a total reduction of their basic local rate for residential one party service of \$5.25. The components of the reduction to basic residential one-party rates are as follows:

State reduction in local rate: \$1.75

Federal baseline Lifeline reduction: \$3.50

The Federal baseline lifeline reduction shall be used to waive the consumers Federal End-User Common Line charge.

3. Lifeline will not be furnished on a Foreign Exchange service.
4. Lifeline service shall not be disconnected for non-payment of toll charges.
5. Toll blocking provides a means of restricting access to the Long Distance Message Telecommunications Network. Toll blocking for the purposes of lifeline service will restrict 1+, 0+ and 0- (operator handled) calls.
 - a. If the customer chooses "toll blocking" the company will not charge a service deposit.
 - b. Toll blocking is offered to Lifeline subscribers at no charge.

+

CANCELLED

JAN 01 2002
54234.1
Public Service Commission
MISSOURI

FILED

FEB 10 1998

MO. PUBLIC SERVICE COMM

*Indicates new rate or text
+Indicates change

Issued: ~~JAN 08 1998~~

JAN 07 1998

Maurice Bosserman
Peace Valley Telephone Co.
Peace Valley, MO 65788

Effective: February 10, 1998

RECEIVED

LOCAL EXCHANGE SERVICE

LIFELINE SERVICE

NOV 19 1997

A. General Regulations

NO. PUBLIC SERVICE COM.

1. Lifeline service is available to qualifying low-income subscribers for single party residence service.
2. Lifeline service is a reduction in the monthly local service charges normally paid by qualifying low-income consumers. Eligible Lifeline subscribers will receive a total reduction of their basic local rate for residential one party service of \$5.25. The components of the reduction to basic residential one-party rates are as follows:

State reduction in local rate: \$1.75

Federal baseline Lifeline reduction: \$3.50

The Federal baseline lifeline reduction shall be used to waive the consumers Federal End-User Common Line charge.

3. Lifeline will not be furnished on a Foreign Exchange service.
4. Lifeline service shall not be disconnected for non-payment of toll charges.
5. Toll blocking provides a means of restricting access to the Long Distance Message Telecommunications Network. Toll blocking for the purposes of lifeline service will restrict 1+, 0+ and 0- (operator handled) calls.
 - a. If the customer chooses "toll blocking" the company will not charge a service deposit.
 - b. The rate for toll blocking will be charged on a monthly basis as specified in Service Restrictions.

CANCELLED

FEB 10 1998

FILED

By 4/11/RS#4.1
Public Service Commission
MISSOURI

JAN - 1 1998

*Indicates new rate or text
+Indicates change

MISSOURI
Public Service Commission

Issued: November 25, 1997

Maurice Bosserman
Peace Valley Telephone Co.
Peace Valley, MO 65788

Effective: January 1, 1998

FORM NO. 13

P.S.C.MO. No. 1

(XXXXXXXXXX)

SHEET No. 4.1

2nd

Revised

Cancelling P.S.C.MO. No. _____ 1

1st

QKNGDX

SHEET No. 4.1

PEACE VALLEY TELEPHONE COMPANY

For.

Area Served

Name of Issuing Corporation

Community, Town or City

RECEIVED

LOCAL EXCHANGE SERVICE

DEC 4 1987

HELD FOR FUTURE USE

MISSOURI

Public Service Commission

CANCELLED

JAN 01 1998

By 3rd RS #4.1
Public Service Commission
MISSOURI

FILED

JAN 1 1988

*Indicates new rate or text

+Indicates change

Public Service Commissioner

DATE OF ISSUE December 3, 1987
month day year

DATE EFFECTIVE January 1, 1988
month day year

ISSUED BY Quinter Bosserman Q.B. Owner-Manager Peace Valley, Mo. 65788
name of officer title address

FORM NO. 13 P.S.C.MO. No. 1 1st { Original } SHEET No. 4.1
{ Revised }
Cancelling P.S.C.MO. No. 1 { Original } SHEET No. 4.1
{ Revised }

PEACE VALLEY TELEPHONE COMPANY
Name of Issuing Corporation

For Area Served
Community, Town or City

RECEIVED
FEB 25 1986

Customer Premises Equipment

1. Effective January 1, 1983, in accordance with the order of the FCC in Docket 20828, customer premises equipment will be provided by the telephone company for use with new or existing service only so long as such equipment is available from telephone company supply acquired prior to January 1, 1983.
2. Customer premises equipment is defined for this tariff as all equipment located on the customer premises except over-voltage protection equipment, inside wiring, coin-operated or pay telephones, and multiplexing equipment to deliver multiple channels to the customer.
3. The telephone company will continue to provide maintenance for the telephone company provided customer premises equipment subject to the availability of replacement parts and/or equipment.
4. All embedded Customer Premises Equipment shall be detariffed and deregulated effective January 1, 1988, by authority of the Missouri Public Service Commission in Case No. TO-86-26.

CANCELLED

JAN 01 1988

BY 2nd P.S. #4.1
PUBLIC SERVICE COMMISSION
OF MISSOURI

*Indicates new rate or text
+Indicates change

FILED

MAR 1 1986
86-26

Public Service Commission

DATE OF ISSUE February 24, 1986 DATE EFFECTIVE March 1, 1986
month day year month day year
ISSUED BY Quinter Bosserman Owner-Manager Peace Valley, Mo. 65788
name of officer title address

PEACE VALLEY TELEPHONE COMPANY
Name of Issuing Corporation

For _____

Area Served
Community, Town or City

RULES AND REGULATIONS

RECEIVED

DEC - 7 1982

A. Customer Premises Equipment

MISSOURI

Public Service Commission

1. Effective January 1, 1983, in accordance with the order of the FCC in Docket 20828, customer premises equipment will be provided by the Telephone Company for use with new or existing service only so long as such equipment is available from Telephone Company supply acquired prior to January 1, 1983.
2. Customer premises equipment is defined for this tariff as all equipment located on the customer premises except over-voltage protection equipment, inside wiring, coin-operated or pay telephones, and multiplexing equipment to deliver multiple channels to the customer.
3. The Telephone Company will continue to provide maintenance for the Telephone Company provided customer premises equipment subject to the availability of replacement parts and/or equipment.

CANCELLED

MAR 1 1986

BY 1st R.S. # 4.1
PUBLIC SERVICE COMMISSION
OF MISSOURI

FILED

JAN - 1 1983

TAO 799

*Indicates new rate or text

+Indicates change

DATE OF ISSUE 12 5 1982
month day yearDATE EFFECTIVE 1 1 1983
month day yearISSUED BY Walter Bosserman owner-manager PEACE VALLEY, MO.
name of officer title address

65788

LOCAL EXCHANGE SERVICE

LIFELINE SERVICE (Cont'd)

B. Eligibility Requirements

1. An applicant must meet all of the following criteria in order to qualify for Lifeline Service.
 - a. To qualify for Lifeline the consumer must participate in one of the following programs:
 - 1) Mo HealthNet (f/k/a Medicaid) (T)
 - 2) Food stamps
 - 3) Supplemental Security Income (SSI)
 - 4) Federal Public Housing Assistance or Section 8
 - 5) Low Income Home Energy Assistance Program
 - 6) National School Free Lunch Program (T)
 - 7) Temporary Assistance for Needy Families, or (T)
 - 8) The customer's income, as defined in 47 CFR §54.400(f), is at or below 135% of the Federal Poverty Guideline (eff. June 1, 2012). (N)
2. The customer must sign, under penalty of perjury a document certifying:
 - a. He/she is receiving benefits from one of the programs in 1.a. above.
 - b. Name of the program(s) from which they are receiving benefits.
 - c. That he/she will notify the company if he/she no longer participates in the program(s) named in a. preceding.
3. The premises at which the residence service is requested must be the applicant's principal place of residence.
4. There is only one telephone line serving the residence premises. The residence premises household (dwelling unit) shall consist of that portion of an individual house or building or one flat or apartment occupied by a single family or individuals functioning as one domestic establishment.

LOCAL EXCHANGE SERVICE

LIFELINE SERVICE (Cont'd)

B. Eligibility Requirements

1. An applicant must meet all of the following criteria in order to qualify for Lifeline Service:
 - a. To qualify for Lifeline the consumer must participate in one of the following programs:
 - 1) Medicaid
 - 2) Food Stamps
 - 3) Supplemental Security Income (SSI)
 - 4) Federal public housing assistance
 - 5) Low Income Home Energy Assistance Program
 - 6) Temporary Assistance to Needy Families (TANF) (+)
 - 7) National Free Lunch Program (+)
2. The customer must sign, under penalty of perjury a document certifying:
 - a. He/she is receiving benefits from one of the programs in 1.a. above.
 - b. Name of the program(s) from which they are receiving benefits.
 - c. That he/she will notify the company if he/she no longer participates in the program(s) named in a. preceding.
3. The premises at which the residence is requested must be the applicant's principal place of residence.
4. There is only one telephone line serving the residence premises. The residence premises household (dwelling unit) shall consist of that portion of an individual house or building or one flat or apartment occupied by a single family or individuals functioning as one domestic establishment.

*Indicates new rate or text

+Indicates change

Issued: May 19, 2005

Effective: June 22, 2005

Maurice Bosserman
Peace Valley Telephone Co.
Peace Valley, MO

CANCELLED
April 27, 2012
Missouri Public
Service Commission
JI-2012-0527

LOCAL EXCHANGE SERVICE

LIFELINE SERVICE (Cont'd)

B. Eligibility Requirements

1. An applicant must meet all of the following criteria in order to qualify for Lifeline Service:
 - a. To qualify for Lifeline the consumer must participate in one of the following programs:
 - 1) Medicaid
 - 2) Food Stamps
 - 3) Supplemental Security Income (SSI)
 - 4) Federal public housing assistance
 - 5) Low Income Home Energy Assistance Program
 - 6) Persons with Income below 135% of Federal Poverty Level (*)
 - 7) Temporary Assistance to Needy Families (TANF)
 - 8) National Free Lunch Program (*)
2. The customer must sign, under penalty of perjury a document certifying:
 - a. He/she is receiving benefits from one of the programs in 1.a. above.
 - b. Name of the program(s) from which they are receiving benefits.
 - c. That he/she will notify the company if he/she no longer participates in the program(s) named in a. preceding.
3. The premises at which the residence is requested must be the applicant's principal place of residence.
4. There is only one telephone line serving the residence premises. The residence premises household (dwelling unit) shall consist of that portion of an individual house or building or one flat or apartment occupied by a single family or individuals functioning as one domestic establishment.

*Indicates new rate or text

+Indicates change

LOCAL EXCHANGE SERVICE

RECEIVED

NOV 19 1997

LIFELINE SERVICE (Cont'd)

B. Eligibility Requirements

MO. PUBLIC SERVICE COM.

1. An applicant must meet all of the following criteria in order to qualify for Lifeline Service:
 - a. To qualify for Lifeline the consumer must participate in one of the following programs:
 - 1) Medicaid
 - 2) Food stamps
 - 3) Supplemental Security Income (SSI)
 - 4) Federal public housing assistance
 - 5) Low Income Home Energy Assistance Program
2. The customer must sign, under penalty of perjury a document certifying:
 - a. He/she is receiving benefits from one of the programs in 1.a. above.
 - b. Name of the program(s) from which they are receiving benefits.
 - c. That he/she will notify the company if he/she no longer participates in the program(s) named in a. preceding.
3. The premises at which the residence service is requested must be the applicant's principal place of residence.
4. There is only one telephone line serving the residence premises. The residence premises household (dwelling unit) shall consist of that portion of an individual house or building or one flat or apartment occupied by a single family or individuals functioning as one domestic establishment.

FILED

JAN -1 1998

*Indicates new rate or text
+Indicates change

MISSOURI
Public Service Commission

Issued: November 25, 1997

Maurice Bosserman
Peace Valley Telephone Co.
Peace Valley, MO 65788

Effective: January 1, 1998

LOCAL EXCHANGE SERVICE

Lifeline Services

A. Missouri Universal Service Fund Low-Income Assistance

1. General-A low-income customer is any customer who requests or received residential essential local telecommunications service and who has been certified by the Department of Social Services (DSS) as economically disadvantaged. Qualified individuals will receive discounted services under either the low-income assistance or the disabled assistance program.
2. Regulations-Low income assistance is available to all residential customers who demonstrate, by self certifying with the company under penalty of perjury, that they are eligible for support by participation in:
 - a) Mo HealthNet (f/k/a Medicaid) (T)
 - b) Food Stamps
 - c) Supplemental Security Income (SSI)
 - d) Federal Public Housing Assistance or Section 8
 - e) Low Income Home Energy Assistance Program
 - f) National School Free Lunch Program (T)
 - g) Temporary Assistance for Needy Families, or (T)
 - h) The customer's income, as defined in 47 CFR §54.400(f), is at or below 135% of the Federal Poverty Guideline (eff. June 1, 2012). (N)
3. Eligible Services – Essential local telecommunications service is defined as two (2) way switched voice residential service within a local calling scope as determined by the commission, comprised of the following services and their recurring charges: (T)
 - a) Single line residential service, including touch-tone dialing and any applicable mileage or zone charges
 - b) Access to local emergency service, including, but not limited to, 911 service established by local authorities
 - c) Access to basic local operator services
 - d) Access to basic local directory assistance
 - e) Standard intercept service
 - f) Equal access to Inter-Exchange Carriers consistent with rules and regulations of the FCC
 - g) One (1) standard white pages directory listing
 - h) Toll blocking or toll control for qualifying low-income customers

Issued: March 28, 2012

Maurice Bosserman
Peace Valley Telephone Co.
Peace Valley, MO 65788

Effective: April 27, 2012

LOCAL EXCHANGE SERVICE

Lifeline Services

A. Missouri Universal Service Fund Low-Income Assistance

1. **General** – A low-income customer is any customer who requests or receives residential essential local telecommunications service and who has been certified by the Department of Social Services (DSS) as economically disadvantaged. Qualified individuals will receive discounted services under either the low-income assistance or the disabled assistance program.
2. **Regulations** – Low income assistance is available to all residential customers who demonstrate, by self certifying with the company under penalty of perjury, that they are eligible for support by participation in:
 - a) Medicaid
 - b) Food Stamps
 - c) Supplementary Security Income (SSI)
 - d) Federal Public Housing Assistance or section 8
 - e) Low Income Home Energy Assistance Program (LIHEAP)
 - f) Temporary Assistance for Needy Families (TANF)
 - g) National Free Lunch Program (*)
3. **Eligible Services** – Essential local telecommunications service is defined as two (2) way switched voice residential service within a local calling scope as determined by the commission, comprised of the following services and their recurring charges:
 - a) Single line residential service, including touch-tone dialing and any applicable mileage or zone charges
 - b) Access to local emergency services, including, but not limited to, 911 service established by local authorities
 - c) Access to basic local operator services
 - d) Access to basic local directory assistance
 - e) Standard intercept service
 - f) Equal access to Inter-Exchange Carriers consistent with rules and regulations of the FCC
 - g) One (1) standard white pages directory listing
 - h) Toll blocking or toll control for qualifying low-income customers (*)

*Indicates new rate or text

+Indicates change

Issued: May 19, 2005

Effective: June 22, 2005

Maurice Bosserman
Peace Valley Telephone Co.
Peace Valley, MO

CANCELLED
April 27, 2012
Missouri Public
Service Commission
JI-2012-0527

LOCAL EXCHANGE SERVICE

Lifeline Services

A. **Missouri Universal Service Fund Low-Income Assistance**

1. **General** – A low-income customer is any customer who requests or receives residential essential local telecommunications service and who has been certified by the Department of Social Services (DSS) as economically disadvantaged. Qualified individuals will receive discounted services under either the low-income assistance or the disabled assistance program.
2. **Regulations** – Low income assistance is available to all residential customers who demonstrate, by self certifying with the company under penalty of perjury, that they are eligible for support by participation in:
 - a) Medicaid
 - b) Food Stamps
 - c) Supplementary Security Income (SSI)
 - d) Federal Public Housing Assistance or section 8
 - e) Low Income Home Energy Assistance Program (LIHEAP)
3. **Eligible Services** – Essential local telecommunications service is defined as two (2) way switched voice residential service within a local calling scope as determined by the commission, comprised of the following services and their recurring charges:
 - a) Single line residential service, including touch-tone dialing and any applicable mileage or zone charges
 - b) Access to local emergency services, including, but not limited to, 911 service established by local authorities
 - c) Access to basic local operator services
 - d) Access to basic local directory assistance
 - e) Standard intercept service
 - f) Equal access to Inter-Exchange Carriers consistent with rules and regulations of the FCC
 - g) One (1) standard white pages directory listing
 - h) Toll blocking or toll control for qualifying low-income customers

*Indicates new rate or text

+Indicates change

Local Exchange Service

Lifeline Services (cont'd)

4. **Support Amount** – Customers eligible under the established criteria can receive a discount from their bill for essential local telecommunications service equal to the amounts approved by the Missouri Public Service Commission and the Federal Communications Commission. The amount of combined federal and state lifeline support for any customer will not exceed the sum of the federal Subscriber Line Charge (SLC) and the recurring charges for essential local telecommunications services (including the basic service rate, Touch-Tone calling charge, extended area service additive, and mileage additives, if any).

B. Missouri Universal Service Fund Disabled Assistance

1. **General** – A disabled customer, or a dependent of a disabled customer, is a customer who requests or receives essential local telecommunications service, as defined in this tariff, and meets the eligibility requirements set forth in this tariff.
2. **Regulations** – Disabled assistance is available to all residential customer who demonstrate, by self certifying with the company under penalty of perjury, that they, or a dependent, are totally and permanently disabled or blind and receiving any of the following:
 - a) Federal Supplemental Security income benefits
 - b) Veterans Administration benefits
 - c) State blind pension pursuant to Section 209.010 to 209.160, RSMo
 - d) State aid to blind persons pursuant to Section 209.240 RSMo.
 - e) State supplemental payments pursuant to Section 208.030, RSMo Section 660.100.2 RSMo 2000.
3. **Support Amount** – Customers eligible under the established criteria can receive a discount equal to the amount approved by the Missouri Public Service Commission from their bill for essential local telecommunications service. The amount of state lifeline support for any customer will not exceed the recurring charges for essential local telecommunications services (including the basic service rate, Touch-Tone calling charge, extended area service additive, and mileage additives, if any).

*Indicates new rate or text

+Indicates change

Issued: March 22, 2005

Effective: April 21, 2005

LOCAL EXCHANGE SERVICE

Missouri Universal Service Fund

1. Company will place on each retail end-user customer's bill, a surcharge equal to the Missouri Universal Service Fund percentage assessment ordered by the commission.
2. The surcharge will appear as a separate line item detailed as "Missouri Universal Service Fund."
3. The surcharge percentage will be applied to the total of each customer's charges for intrastate regulated telecommunications services that meet the definition of net jurisdictional revenues at 4 CSR 240-31.010(12).

*Indicates new rate or text

+Indicates change

Issued: March 22, 2005

Effective: April 21, 2005

CANCELLED
December 2, 2016
Missouri Public
Service Commission
JI-2017-0103

Maurice Bosserman
Peace Valley Telephone Co.
Peace Valley, MO

PEACE VALLEY TELEPHONE COMPANY
Name of Issuing Corporation

For

Area Served

Community, Town or City

RECEIVED
DISCUSS

Rules and Regulations

FEB 26 1986

A. SALE OF TERMINAL EQUIPMENT

MISSOURI

Public Service Commission

1. The Company may offer for sale to the general public items of telephone equipment, terminal equipment, and telephone accessory equipment that is not included in the Company's rate base for regulatory purposes. Applicable warranty coverage, if any, for specific items will be provided by the Company, in a written format, at the time of purchase.
2. Embedded telephone sets and ancillary equipment shall be offered for sale. The charge for single line Company owned equipment shall be the net book value plus the cost of the transaction up to December 31, 1987. The minimum charge for multi-line Company owned equipment shall not be less than net book value plus cost of transaction.

A. NONRECURRING MAINTENANCE CHARGES

1. A nonrecurring charge of \$4.00 will apply for each visit to a customer's premises or service location in connection with a service difficulty or testing when it is determined that the difficulty was due to a condition in customer provided equipment or facilities.
2. In situations where impairment or interruption of service is caused by tampering with Company wiring or equipment, the customer instigating such tampering or the person causing the damage will be billed the full cost of labor and materials required to reestablish normal service.

CANCELLED

JAN 01 1988

BY 2nd P.S. #4.2
PUBLIC SERVICE COMMISSION*Indicates new rate or text
+Indicates change

FILED

MAR 1 1986

86-26

Public Service Commission

DATE OF ISSUE February 24, 1986
month day yearDATE EFFECTIVE March 1, 1986
month day yearISSUED BY Quinter Bosserman
name of officerOwner-Manager
titlePeace Valley, Mo. 65788
address

FORM NO. 13 P.S.C.MO. No. 1 { Original } SHEET No. 4.2
{ Revised }
Cancelling P.S.C.MO. No. _____ { Original } SHEET No. _____
{ Revised }

Peace Valley Telephone Company For Area Served
Name of Issuing Corporation Community, Town or City

RECEIVED

MAR 19 1985

MISSOURI
Public Service Commission

Rules and Regulations

A. SALE OF TERMINAL EQUIPMENT

1. The Company May offer for sale to the general public items of telephone equipment, terminal equipment, and telephone accessory equipment that is not included in the Company's rate base for regulatory purposes. Applicable warranty coverage, if any, for specific items will be provided by the Company, in written format, at the time of purchase.
2. Installed telephone sets and ancillary equipment existing on the customer's premise may be offered for sale. The minimum charge for such Company equipment in Account 1031 shall be \$ 5.00
3. The Company will establish and maintain separate and identifiable accounts with direct sale items in accordance with uniform system of accounts.

A. NONRECURRING MAINTENANCE CHARGES

1. A nonrecurring charge of \$ 4.00 will apply for each visit to a customer's premises or service location in connection with a service difficulty or testing when it is determined that the difficulty was due to a condition in customer provided equipment or facilities.
2. In situations where impairment or interruption of service is caused by tampering with Company wiring or equipment, the customer instigating such tampering or the person causing the damage will be billed the full cost of labor and materials required to reestablish normal service.

CANCELLED

MAR 1 1986

*Indicates new rate or text
+Indicates change

12 R.S. # 4.2
PUBLIC SERVICE COMMISSION
OF MISSOURI

FILED

JUN - 1 1985

Public Service Commission

DATE OF ISSUE March 16, 1985 DATE EFFECTIVE June 1, 1985
month day year month day year
ISSUED BY Quinter Bosserman Owner-Manager March 16, 1985
name of officer title address
Zip Code 65788 Peace Valley, Mo.

FORM NO. 13

P.S.C.MO. No. 1{ Original } SHEET No. 4.3
~~Revised~~

Cancelling P.S.C.MO. No. _____

{ Original } SHEET No. _____
~~Revised~~Peace Valley Telephone Co., Inc. For Peace Valley

Name of Issuing Corporation

Community, Town or City

RECEIVEDGeneral Services**DEC 6 1991**

* Custom Calling Service

MO. PUBLIC SERVICE COMM.

A. General

1. Custom Calling Service consists of one or more of the following features which provide special kinds of customer-controlled communications features on individual service lines. Custom Calling Service is available only through central offices which, at the Company's option, are appropriately equipped. Operating specifics may vary by central office equipment type but can be described generally as:

- a. Call Waiting--Provides a signal to a customer using the telephone that another call is being attempted to his number. The customer can "hold" the original call to answer the incoming call.
- b. Cancel Call Waiting--Allows customer to dial an access code to cancel call waiting for the duration of the call in progress.
- c. Call Forwarding--Permits all calls directed to a customer number to be routed on to another dialable number, predetermined and activated by the customer.
- d. Remote Call Forwarding--A customer can have calls forwarded to a directory number in another toll area. Normal Direct Distance Dialing toll charge will be applied to your bill if call is answered at the forwarded number.

*Indicates new rate or text
+Indicates change

CANCELLED
OCT - 5 1997
By let RS # 4.3
Public Service Commission
MISSOURI

FILED**JAN 10 1992**

Public Service Commission

DATE OF ISSUE December 10, 1991
month day yearDATE EFFECTIVE January 10, 1992
month day yearISSUED BY Bernice Bosserman

Secretary-Treasurer

P.O. Box 9

name of officer

title

address

Peace Valley, MO

Peace Valley Telephone Co., Inc.

For Peace Valley

Name of Issuing Corporation

Community **RECEIVED**

DEC 6 1991

General Services continued

MO. PUBLIC SERVICE COMM.

- e. Call Forward Remote Access--Supports call forwarding activation and deactivation from a location other than the subscriber's home station.
- f. Three-Way Calling--Allows for the addition of a third number to a connection made between two numbers without the assistance of a company operator. (See Note)
- g. Speed Calling-Short List--Permits customer calling to other telephone numbers through the dialing of a code rather than an entire telephone number. Capacity is 8 numbers dialable by speed dialing code.
- h. Speed Calling-Long List--Same as Item (g) above except capacity is for 30 numbers dialable by speed dialing code.
- i. Ring Again--Allows a subscriber who receives a busy station to receive a special ring indicating that a previously busy line has become idle within a prescribed time period.
- j. Teen Service--Allows a customer to have two directory numbers on the same single-party line so that a subscriber can receive calls dialed to separate numbers without installing a second line.

Note: Transmission on calls forwarded and three way calling may vary upon the distance and routing required to complete such calls; therefore the normal grade of end to end calling cannot be guaranteed on such calls.

*Indicates new rate or text

+Indicates change

FILED

JAN 10 1992

Public Service Commission

DATE OF ISSUE December 10, 1991
month day yearDATE EFFECTIVE January 10, 1992
month day yearISSUED BY Bernice Bosserman

Secretary-Treasurer

P.O. Box 9

name of officer

title

address
Peace Valley, MO

Replacing P.S.C.MO. No.

Original Sheet No. 4.5

Peace Valley Telephone Co., Inc.
Name of Issuing Corporation

For Peace Valley
Community, Town or City

SEP - 2 1997

General Services continued

MO. PUBLIC SERVICE COMM

B. Rates

	<u>Monthly Rate</u>	<u>Connection Charge</u>
a. Call Waiting	\$ 1.50	\$ 2.00
b. Cancel Call Waiting	\$ 1.00	\$ 2.00
c. Call Forwarding	\$ 1.00	\$ 2.00
d. Remote Call Forwarding	\$ 1.25	\$ 2.00
e. Call Forward Remote Access	\$ 1.50	\$ 2.00
f. Three-Way Calling	\$ 2.50	\$ 2.00
g. Speed Calling-Short List	\$ 1.50	\$ 2.00
h. Speed Calling-Long List	\$ 2.00	\$ 2.00
i. Ring Again	\$ 1.00	\$ 2.00
j. Teen Service	\$ 1.50	\$ 2.00
k. Line Hunting (after 1st Line)	\$ 5.00	\$ 2.00
Any four above features, excluding Line Hunting	\$ 4.50	\$ 8.00

*Indicates new rate or text

+Indicates change

FILED

OCT - 5 1997

MISSOURI
Public Service Commission

DATE OF ISSUE September 5, 1997 DATE EFFECTIVE October 5, 1997
 month day year month day year
 ISSUED BY Bernice Bosserman Secretary-Treasurer P.O. Box 9
 name of officer title address

CANCELLED
June 1, 2012
Missouri Public
Service Commission
IT-2012-0386; JI-2012-0715

FORM NO. 13

P.S.C.MO. No. 1{ Original } SHEET No. 4.5
{ Revised }

Cancelling P.S.C.MO. No. _____

{ Original } SHEET No. _____
{ Revised }Peace Valley Telephone Co., Inc. For Peace Valley

Name of Issuing Corporation

Community, Town or City

RECEIVED

General Services continued

DEC 6, 1991

MO. PUBLIC SERVICE COMM.

B. Rates

	Monthly Rate	Connection Charge
a. Call Waiting	\$ 1.50	\$ 2.00
b. Cancel Call Waiting	\$ 1.00	\$ 2.00
c. Call Forwarding	\$ 1.00	\$ 2.00
d. Remote Call Forwarding	\$ 1.25	\$ 2.00
e. Call Forward Remote Access	\$ 1.50	\$ 2.00
f. Three-Way Calling	\$ 2.50	\$ 2.00
g. Speed Calling-Short List	\$ 1.50	\$ 2.00
h. Speed Calling-Long List	\$ 2.00	\$ 2.00
i. Ring Again	\$ 1.00	\$ 2.00
j. Teen Service	\$ 1.50	\$ 2.00
Any four above features	\$ 4.50	\$ 8.00

CANCELLED

OCT -5 1997

By Let R.S. 4.5
Public Service Commission
MISSOURI

FILED

JAN 10 1992

*Indicates new rate or text

+Indicates change

Public Service Commission

DATE OF ISSUE December 10, 1991
month day yearDATE EFFECTIVE January 10, 1992
month day yearISSUED BY Bernice Bosserman

name of officer

Secretary-Treasurer

title

P.O. Box 9

address

Peace Valley, MO

Cancelling P.S.C.MO. No. _____

Peace Valley Telephone Co.
Name of Issuing CorporationFor Peace Valley, Missouri
Community, Town or City

RECEIVED

RULES AND REGULATIONS

SEP 13 1978

ESTABLISHMENT AND MAINTENANCE OF CREDIT

MISSOURI
Public Service Commission

1. Establishment of Credit

The telephone company is not obligated to furnish service to any individual or firm that has an unpaid and undisputed delinquent account for service previously rendered by the company at the same or different address, until arrangements have been made to liquidate such previous indebtedness to the company.

2. Deposits or Guarantees

- a. The telephone company may require a deposit or guarantee as a condition of service if the customer or prospective customer has an unpaid and undisputed account with a telephone utility which accrued within the last two (2) years or if such delinquent account was paid within the last six (6) months.
- b. In lieu of a deposit the company may accept a written guarantee.
- c. As a condition of continued service to an existing customer the company may require a deposit or guarantee if undisputed charges in two out of the last twelve (12) billing periods becomes delinquent.
- d. No deposit or guarantee will be required because of race, sex, creed, national origin, marital status, age, number of dependents, source of income or geographical area of residence.

3. Amount of Deposit or Guarantee

The deposit or guarantee shall not exceed estimated charges for two (2) months service based on the average bill during the preceeding twelve (12) months or estimated for the next twelve (12) months by the customer and the company. Concurrent with the establishment of new service, the customer may post a deposit in two (2) equal monthly installments or as otherwise agreed upon.

CANCELLED

MAY - 5 1981

1st RS 9

*Indicates new rate or term
+Indicates change

PUBLIC SERVICE COMMISSION
OF MISSOURI

FILED

NOV 1 - 1978

Public Service Commission

DATE OF ISSUE September 11, 1978
month day yearDATE EFFECTIVE November 1, 1978
month day yearISSUED BY Quinter Basserman Owner
name of officerPeace Valley, Mo.
title address

RULES AND REGULATIONS
4 CSR - 240-33.040 and 4 CSR 240-33.050

RECEIVED

ESTABLISHMENT AND MAINTENANCE OF CREDIT (Cont'd)

NOV 19 1997

- d. If within the first six (6) months of establishing service, the customer incurs toll or other charges in any one (1) billing period which are greater than 400% of the amount of the deposit previously required, an additional deposit may be required.
- e. In lieu of a deposit the Telephone Company may accept a written guarantee. The guarantee shall be limited to an amount not exceeding the cash deposit provided for in these tariffs.
- f. No deposit or guarantee shall be required by the Telephone Company because of race, sex, creed, national origin, marital status, age, number of dependents, source of income, condition of physical handicap or geographical area or residence of the subscriber.

A service deposit will not be required for Lifeline Service, if the qualifying low-income customer voluntarily elects toll blocking, where available. If toll blocking is unavailable a service deposit may be charged.

- g. A deposit shall be subject to the following terms:

It shall not exceed estimated charges for two (2) months service based on the average bill during the preceding twelve (12) months or in the case of new applicants for service the average monthly bill for all residence subscribers.

It shall bear interest of nine (9) percent per annum which shall be credited annually upon the account of the customer or paid upon the return of the deposit, whichever occurs first. Interest shall not accrue on any deposit after the date on which a reasonable effort has been made to return it to the customer.

The deposit along with the accrued interest shall be promptly refunded or credited against charges stated on subsequent bills upon satisfactory payment of all undisputed charges

CANCELLED

OCT 30 2000
By *2nd RS #9.1*
Public Service Commission
MISSOURI

FILED

*Indicates new rate or text
+Indicates change

JAN -1 1998

Issued: November 25, 1997

Maurice Bosserman
Peace Valley Telephone Co.
Peace Valley, MO 65788

MISSOURI
Public Service Commission
Effective: January 1, 1998

FORM NO. 13 P.S.C.MO. No. 1 {Original} SHEET No. 9.1
{Revised}
Cancelling P.S.C.MO. No. 1 {Original} SHEET No.
{Revised}
Peace Valley Telephone Co. For Peace Valley, Missouri
Name of Issuing Corporation Community, Town or City
RECEIVED

RULES AND REGULATIONS	
4 CSR - 240-33.040 and 4 CSR 240-33.050	APR - 3 1981
ESTABLISHMENT AND MAINTENANCE OF CREDIT (cont.)	
MISSOURI Public Service Commission	
<p>d. If within the first six (6) months of establishing service, the customer incurs toll or other charges in any one (1) billing period which are greater than 400% of the amount of the deposit previously required, an additional deposit may be required.</p> <p>e. In lieu of a deposit the Telephone Company may accept a written guarantee. The guarantee shall be limited to an amount not exceeding the cash deposit provided for in these tariffs.</p> <p>f. No deposit or guarantee shall be required by the Telephone Company because of race, sex, creed, national origin, marital status, age, number of dependents, source of income, condition of physical handicap or geographical area or residence of the subscriber.</p> <p>g. A deposit shall be subject to the following terms:</p> <p>It shall not exceed estimated charges for two (2) months service based on the average bill during the preceding twelve (12) months or in case of new applicants for service the average monthly bill for all residence subscribers.</p> <p>It shall bear interest of nine (9) percent per annum which shall be credited annually upon the account of the customer or paid upon the return of the deposit, whichever occurs first. Interest shall not accrue on any deposit after the date on which a reasonable effort has been made to return it to the customer.</p> <p>The deposit along with the accrued interest shall be promptly refunded or credited to the account of the customer on subsequent bills upon satisfactory proof of all undisputed charges.</p> <p>*Indicates new rate or text +Indicates change</p>	
CANCELLED JAN 01 1988 BY <u>LS #91</u> Public Service Commission MISSOURI MAY - 6 1981	

DATE OF ISSUE APRIL 1, 1981 DATE EFFECTIVE May 6, 1981
month day year month day year
ISSUED BY Walter Baseman Owner-Manager Peace Valley, Mo.
name of officer title address

RULES AND REGULATIONS

4 CSR - 240-33.040 and 4CSR 240-33.050

APR - 3 1981

ESTABLISHMENT AND MAINTENANCE OF CREDIT (cont.)

- g. during the last twelve (12) billing periods. The Telephone Company may withhold the refunding of a deposit pending the resolution of dispute with respect to charges secured by such deposit.

The deposit shall be credited with accrued interest to the charge stated on the final bill and the balance if any shall be returned to the subscriber within twenty-one (21) days after the rendition of a final bill upon the discontinuance or termination of service.

The Telephone Company shall permit a customer concurrent with the beginning of service, to post a deposit in two (2) equal monthly installments or as otherwise agreed upon by the subscriber and the Telephone Company.

A guarantor as provided for by (G. l.e.) shall be released upon satisfactory payment of all undisputed charges during the last twelve (12) billing periods. Payment of a charge is satisfactory if received prior to the date upon which the charges become delinquent provided it is not in dispute.

h. Deposit not to Effect Regular Collection Practices:

The fact that a deposit has been made shall in no way relieve the applicant or subscriber from complying with the Telephone Company's regulations as to advance payments and the prompt payments of bills on presentation; nor constitute a waiver or modification of the regular practices of the Telephone Company providing for the discontinuance of the service for non-payment of any sums due the Telephone Company for service rendered. The Company may discontinue service to any subscriber failing to pay current bills without regard to the fact that such subscriber has made a deposit with the Company

*Indicates new rate or text

+Indicates change

DATE OF ISSUE April 1, 1981 DATE EFFECTIVE May 6, 1981
month day year month day year
ISSUED BY Quinter Basserman Manager-Owner Peace Valley, Mo.
name of officer title address

Cancelling P.S.C.MO. No. _____

{ Original } SHEET No. _____
{ Revised }Peace Valley Telephone Company
Name of Issuing CorporationFor Peace Valley, Missouri
Community, Town or City

RECEIVED

RULES AND REGULATIONS

SEP 13 1978

ESTABLISHMENT AND MAINTENANCE OF CREDIT (Continued)

MISSOURI
Public Service Commission

4. Interest to be Paid in Deposit

The deposit will bear interest of six (6) percent per annum which will be credited annually upon the account of the customer or paid upon the return of the deposit, whichever occurs first. Interest shall not accrue on any deposit after the date on which a reasonable effort has been made to return it to the customer. Records will be kept of any such efforts made to return the deposit.

CANCELLED

MAY - 6 1981

5. Return of Deposit or Release of Guarantee

Upon satisfactory payment of all undisputed charges during the last twelve (12) billing periods, the deposit, with accrued interest, will be promptly refunded or credited against charges stated on subsequent bills, or a written guarantee shall be released. Payment of a charge is satisfactory if received prior to the date upon which the charge becomes delinquent provided it is not in dispute.

BY 1st RS 10
PUBLIC SERVICE COMMISSION

6. Deposit Not to Affect Regular Collection Practices

The fact that a deposit has been made shall in no way relieve the applicant or subscriber from complying with the Telephone Company's regulations as to advance payments and the prompt payment of bills on presentation; nor constitute a waiver or modification of the regular practices of the Telephone Company providing for the discontinuance of service for non-payment of any sums due the Telephone Company for services rendered. The Company may discontinue service to any subscriber failing to pay current bills without regard to the fact that such subscriber has made a deposit with the Company to secure payment of such bills or has furnished the company with a guarantee in writing of such bills.

7. Discontinuance of Service for Failure to Establish Credit

Service may be discontinued for failure to establish, or maintain, credit, as authorized above. At least five (5) days prior to the date of the proposed discontinuance, the company will mail, by first class mail, or deliver to the customer, a written notice containing a statement of the reasons for the proposed discontinuance, how the customer may avoid the discontinuance and the cost of reconnection.

*Indicates new rate or text

+Indicates change

NOV 1 - 1978

DATE OF ISSUE September 11, 1978
month day yearDATE EFFECTIVE November 1, 1978
month day yearISSUED BY Quinta Bosserman
name of officer

Owner

Peace Valley, Mo.

title

address

Peace Valley Telephone Co.
Name of Issuing Corporation

For _____

Peace Valley, Missouri
Community, Town or City

IVED

RULES AND REGULATIONS

4 CSR - 240-33.040 and 4 CSR 240-33.050

APR - 3 1981

ESTABLISHMENT AND MAINTENANCE OF CREDIT (cont.)

- h. to secure a payment of such bills or has furnished the company with a guarantee in writing of such bills.

- i. Record of previous accounts:

The Telephone Company maintains a record of previous accounts by name, address and telephone number.

- j. Restoral of Service Charges:

Where service has been discontinued for failure to establish credit as authorized above, the regular restoral of service charge will be made and collected by the Company.

BILLING AND PAYMENT

- a. The Company will during the first billing period in which a customer receives service provide the customer with an itemized account of charges for equipment and service for which he has contracted. The Company will render a separate bill for concurrent residence service unless otherwise requested by the customer.

The Company will after the initial bill for new service render a bill during each billing period for monthly recurring charges in advance and toll charges in arrears. Special billing arrangements may be established for service provided to governmental agencies.

- c. The customer is responsible for all charges in conjunction with the services furnished him including collect toll messages which have been accepted at the customer's telephone.

*Indicates new rate or text

+Indicates change

MAY - 6 1981

CANCELLED

JAN 01 1988.

BY Let. R.C. #10.1
PUBLIC SERVICE COMMISSION
OF MISSOURIDATE OF ISSUE April 1, 1981
month day yearDATE EFFECTIVE May 6, 1981
month day yearISSUED BY Quinter Bossertman
name of officerOwner-Manager
titlePeace Valley, Mo.
address

PEACE VALLEY TELEPHONE COMPANY
OF PEACE VALLEY, MISSOURI

P.S.C. MO. NO. 1
2nd Revised Sheet No. 11
Cancels 1st Revised Sheet No. 11

RULES AND REGULATIONS
4 CSR 240.33.040 AND 4 CSR 240-33.050

RECEIVED

SEP 25 2000

MISSOURI
Public Service Commission

BILLING AND PAYMENT (Cont'd)

- d. The Company will render bills on a cyclical basis whereby the customer receives his bill on or about the same day of each month. Billing cycles may be altered by sending an insert or other written notice explaining the alteration not less than 30 days prior to the effective date of the alteration. This notification is not required when a customer requests a number change or when the customer disconnects and reconnects service or transfers service from one premises to another, which may affect the customer's billing cycle.
- e. Bills are due as specified on the bill and may be paid at any business office of the Company or at any agency authorized to receive such payments. The customer shall have at least 21 days from the rendition of the bill to pay the charges stated.
- f. For billing purposes, each month is presumed to have 30 days.
- g. Retroactive billing adjustments may be made for a period not to exceed three years.

FILED

OCT 30 2000

MISSOURI
Public Service Commission

Issued: September 29, 2000

Issued by: Maurice Bosserman
Peace Valley Telephone Company
Peace Valley, Missouri

Effective: October 30, 2000

CANCELLED
October 1, 2010
Missouri Public
Service Commission
JI-2011-0089

{Original}
{Revised}{Original}
{Revised}Peace Valley Telephone Co.
Name of Issuing CorporationFor Peace Valley, Mo.
Community, Town or City

RECEIVED

RULES AND REGULATIONS

4 CSR - 240-33.040 and 4 CSR 240-33.050

APR - 3 1981

BILLING AND PAYMENT (cont.)

MISSOURI

Public Service Commission

- d. The Company will render bills on a cyclical basis whereby the customer receives his bill on or about the same day of each month. Billing cycles may be altered by sending an insert or other written notice explaining the alteration not less than 30 days prior to the effective date of the alteration. This notification is not required when a customer request a number change or when the customer disconnects and reconnects service or transfers service from one premises to another, which may affect the customer's billing cycle.
- e. Bills are due as specified on the bill and may be paid at any business office of the Company or at any agency authorized to receive such payments.
- f. The customer shall have at least 21 days from the rendition of a bill to pay the charges stated except when the customer has had service discontinued within the last 12 months or where the customer incurs toll or other charges at any time during the billing period which are equal to at least 400% of the amount of the deposit or guarantee previously required from the customer, in which case payment may be demanded for the toll charges by a telephone call to the customer followed by written notification of such demand sent by first class mail. If the toll charges remain unpaid for 10 days from rendition of written notification or a mutually established late payment arrangement or 21 days from rendition of the bill, such charges will be deemed delinquent.
- g. For billing purposes, each month is presumed to have 30 days.
- h. Retroactive billing adjustments may be made for a period not to exceed three years.

CANCELLED

OCT 30 2000

By *And P.S. #11*
Public Service Commission
MISSOURI*Indicates new rate or text
+Indicates change

MAY - 6 1981

DATE OF ISSUE April 1, 1981
month day yearDATE EFFECTIVE May 6, 1981
month day yearISSUED BY *Quinter Bossman* Owner-Manager Peace Valley, Mo.
name of officer title address

Cancelling P.S.C.MO. No. _____

{ Original } SHEET No. _____
{ Revised }

Peace Valley Telephone Co.

For _____

Peace Valley, Mo.

Name of Issuing Corporation

Community, Town or City

SEP 13 1978

RULES AND REGULATIONS

MISSOURI

Public Service Commission

BILLING AND PAYMENT

The subscriber shall receive a bill during each billing period. Failure to receive a bill does not relieve the subscriber of the responsibility for payment for telephone service.

Residential subscribers shall have at least twenty-one (21) days from the rendition of the bill to pay the charges stated thereon. Payment shall be made at the office of the telephone company or an authorized collection agency.

Demand for payment of toll charges may be made on less than twenty-one (21) days in the event a residential customer's service has been discontinued in accordance with "Discontinuance of Service" as reflected elsewhere in this tariff.

Total bills remaining unpaid twenty-two (22) days after rendition, or toll bills remaining unpaid five (5) days after demand, whichever is less, shall be considered delinquent.

DISCONTINUANCE OF SERVICE

1. Service may be discontinued for any of the following reasons:

- A. Non-payment of an undisputed delinquent charge.
- B. Failure to post a required deposit or guarantee.
- C. Unauthorized use of the telephone company's equipment in a manner which creates an unsafe condition or creates the possibility of damage or destruction to such equipment.
- D. Failure to substantially comply with the terms of a settlement agreement.
- E. Refusal after reasonable notice to permit inspection, maintenance, or replacement of the telephone company's equipment.
- F. Material misrepresentation of identity in obtaining telephone utility service.

G. As provided by state or federal law.

*Indicates new rate or text

+Indicates change

CANCELLED
MAY - 6 1981
BY 1st RS 11
PUBLIC SERVICE COMMISSION
OF MISSOURI

FILED

NOV 1 - 1978

DATE OF ISSUE September 11, 1978
month day yearDATE EFFECTIVE November 1, 1978
month day yearISSUED BY Quenter Bosserman
name of officer

Owner

Peace Valley, Mo.

title

address

RULES AND REGULATIONS

RECEIVED

DISCONTINUANCE OF SERVICE

NOV 19 1997

1. Service may be discontinued for any of the following reasons:

MO. PUBLIC SERVICE COMMISSION

- a. Non-payment of an undisputed delinquent charge.
 - b. Failure to post a required deposit or guarantee.
 - c. Unauthorized use of the telephone company's equipment in a manner which creates an unsafe condition or creates the possibility of damage or destruction to such equipment.
 - d. Failure to substantially comply with the terms of a settlement agreement.
 - e. Refusal after reasonable notice to permit inspection, maintenance, or replacement of the telephone company's equipment.
 - f. Material misrepresentation of identity in obtaining telephone utility service.
 - g. As provided by state or federal law.
 - h. Non-payment of undisputed, delinquent state or interstate long distance service charges billed by the company or undisputed, delinquent exchange service charges including any FCC approved end user charge or both, with the exception of Lifeline Service.
2. The failure to pay charges not subject to Commission jurisdiction shall not constitute cause for discontinuance of service except as indicated in 1.h above.
3. A written notice shall be sent by first class mail five (5) days prior to discontinuance of service.
4. Service may be discontinued during normal business hours on or after the date specified in the notice of discontinuance. Service shall not be discontinued on a day when the offices of the telephone company are not open to facilitate reconnection of service, or on a day immediately preceding such day. Service shall not be discontinued for non-payment of a delinquent charge until five (5) days after a charge has become delinquent.

CANCELLED

OCT 30 2000
By *5th RS# 12*
Public Service Commission
MISSOURI

FILED

JAN - 1 1998

*Indicates new rate or text
+Indicates change

**MISSOURI
Public Service Commission**

Issued: November 25, 1997

**Maurice Bosserman
Peace Valley Telephone Co.
Peace Valley, MO 65788**

Effective: January 1, 1998

FORM NO. 13

P.S.C.MO. No. 1(Original) SHEET No. 12
3rd (Revised)Cancelling P.S.C.MO. No. 1(Original) SHEET No. 12
2nd (Revised)PEACE VALLEY TELEPHONE COMPANY
Name of Issuing CorporationFor Peace Valley, MO
Community

RECEIVED

DEC 4 1987

RULES AND REGULATIONS

MISSOURI

Public Service Commission

DISCONTINUANCE OF SERVICE

1. Service may be discontinued for any of the following reasons:

- A. Non-payment of an undisputed delinquent charge.
- B. Failure to post a required deposit or guarantee.
- C. Unauthorized use of the telephone company's facilities in a manner which creates an unsafe condition or creates the possibility of damage or destruction to such facilities.
- D. Failure to substantially comply with the terms of a settlement agreement.
- E. Refusal after reasonable notice to permit inspection, maintenance, or replacement of the telephone company's facilities.
- F. Material misrepresentation of identity in obtaining telephone utility service.
- G. As provided by state or federal law.
- H. Nonpayment of undisputed, delinquent state or interstate long distance service charges billed by the company or undisputed, delinquent exchange service charges including any FCC approved end user charge or both.

2. The failure to pay charges not subject to Commission jurisdiction shall not constitute cause for discontinuance of service as noted in 1.H. above.

3. A written notice shall be sent by first class mail five (5) days prior to discontinuance of service.

4. Service may be discontinued during normal business hours on or after the date specified in the notice of discontinuance. Service shall not be discontinued on a day when the offices of the telephone company are not open to facilitate reconnection of service, or on a day immediately preceding such day. Service shall not be discontinued for nonpayment of a delinquent charge until five (5) days after a charge has become delinquent.

*Indicates new rate or text

+Indicates change

CANCELLED

JAN 01 1988

By 4th RS#12
Public Service Commission
MISSOURI

FILED

JAN 1 1988

Public Service Commission

DATE OF ISSUE December 3, 1987 DATE EFFECTIVE January 1, 1988
month day year month day yearISSUED BY Quinter Bosserman Owner-Manager Peace Valley, Mo. 65788
name of officer title address

FORM NO. 13

P.S.C.MO. No. 1

Second

~~Original~~SHEET No. 12Cancelling P.S.C.MO. No. 1

First

~~Original~~SHEET No. 12

Peace Valley Telephone Company

Name of Issuing Corporation

For

Peace Valley, MO

Community, Town or City

RULES AND REGULATIONS

RECEIVED

MAR 10 1985

MISSOURI

Public Service Commission

DISCONTINUANCE OF SERVICE

1. Service may be discontinued for any of the following reasons.

- A. Non-payment of an undisputed delinquent charge.
- B. Failure to post a required deposit or guarantee.
- C. Unauthorized use of the telephone company's equipment in a manner which creates an unsafe condition or creates the possibility of damage or destruction to such equipment.
- D. Failure to substantially comply with the terms of a settlement agreement.
- E. Refusal after reasonable notice to permit inspection, maintenance, or replacement of the telephone company's equipment.
- F. Material misrepresentation of identity in obtaining telephone utility service.
- G. As provided by state or federal law.
- H. Nonpayment of undisputed, delinquent state or interstate long distance service charges billed by the company or undisputed, delinquent exchange service charges including any FCC approved end user charge or both.

CANCELLED

JAN 01 1988

BY 3rd R.S. #12
PUBLIC SERVICE COMMISSION
OF MISSOURI

- 2. The failure to pay charges not subject to Commission jurisdiction shall not constitute cause for discontinuance of service except as noted in 1H above.
- 3. A written notice shall be sent by first class mail five (5) days prior to discontinuance of service.
- 4. Service may be discontinued during normal business hours on or after the date specified in the notice of discontinuance. Service shall not be discontinued on a day when the offices of the telephone company are not open to facilitate reconnection of service, or on a day immediately preceeding such day. Service shall not be discontinued for non-payment of a delinquent charge

FILED

JUN - 1 1985

Public Service Commission

*Indicates new rate or text
+Indicates change

DATE OF ISSUE March 16, 1985
month day yearDATE EFFECTIVE June 1, 1985
month day yearISSUED BY Quinter Bosserman
name of officerOwner-Manager
titlePeace Valley, MO. 65788
address

Peace Valley Telephone Company
Name of Issuing CorporationFor Peace Valley, Missouri
Community, Town or City

RULES AND REGULATIONS

4 CSR - 240-33.040 and 4 CSR 240-33.050

APR - 3 1981

DISCONTINUANCE OF SERVICE

1. Service may be discontinued for any of the following reasons: ^{Commission}

- A. Non-payment of an undisputed delinquent charge.
- B. Failure to post a required deposit or guarantee.
- C. Unauthorized use of the telephone company's equipment in a manner which creates an unsafe condition or creates the possibility of damage or destruction to such equipment
- D. Failure to substantially comply with the terms of a settlement agreement.
- E. Refusal after reasonable notice to permit inspection, maintenance, or replacement of the telephone company's equipment.
- F. Material misrepresentation of identity in obtaining telephone utility service.
- G. As provided by state or federal law.

CANCELLED

JUN 1 1985

BY 2nd R.S. #12
PUBLIC SERVICE COMMISSION
OF MISSOURI

- 2. The failure to pay charges not subject to Commission jurisdiction shall not constitute cause for discontinuance of service.
- 3. A written notice shall be sent by first class mail five (5) days prior to discontinuance of service.
- 4. Service may be discontinued during normal business hours on or after the date specified in the notice of discontinuance. Service shall not be discontinued on a day when the offices of the telephone company are not open to facilitate reconnection of service, or on a day immediately preceeding such day. Service shall not be discontinued for non-payment of a delinquent charge

*Indicates new rate or text

+Indicates change

MAY - 6 1981

DATE OF ISSUE April 1, 1981
month day yearDATE EFFECTIVE May 6, 1981
month day yearISSUED BY Quinter Basserman Owner-Manager Peace Valley, Mo.
name of officer title address

Cancelling P.S.C.MO. No. _____

{ Original } SHEET No. _____
{ Revised }Peace Valley Telephone Co.
Name of Issuing CorporationFor Peace Valley, Mo.
Community, Town or City

RULES AND REGULATIONS

SEP 13 1978

DISCONTINUANCE OF SERVICE (CONTINUED)

MISSOURI
Public Service Commission

2. The failure to pay charges not subject to Commission jurisdiction shall not constitute cause for discontinuance of service.
3. A written notice shall be sent by first class mail five (5) days prior to discontinuance of service.
4. Service may be discontinued during normal business hours on or after the date specified in the notice of discontinuance. Service shall not be discontinued on a day when the offices of the telephone company are not open to facilitate reconnection of service, or on a day immediately preceeding such day. Service shall not be discontinued for non-payment of a delinquent charge until five (5) days after a charge has become delinquent.
5. At least twenty-four (24) hours preceeding a discontinuance of service the telephone company shall make an effort to contact the subscriber and advise them of the discontinuance and what action must be taken to avoid it.
6. Discontinuance of service shall be postponed for a time not in excess of twenty-one (21) days if the telephone is necessary to obtain emergency medical assistance for a person who is a member of the household where the telephone service is provided and where such person is under the care of a physician. Any person who alleges such emergency shall if requested provide the telephone company with reasonable evidence of such necessity.

Notwithstanding any other provisions of this tariff, service to a customer may be discontinued at any time after written notice has been sent, certified mail, to such customer at his last known address and at the address where the service to be discontinued is provided if such customer:

- A. Incurs charges not covered by a deposit or guarantee and evidences an intent not to pay such charges when due; or
- B. Damages or evidences an intent to damage telephone utility equipment.
8. The notice required by Section (7) of this rule shall state how a customer has evidenced an intent not to pay charges when due or evidences an intent to damage telephone utility equipment.

*Indicates new rate or text

+Indicates change

NOV 1 - 1978

Public Service Commission

DATE OF ISSUE September 11, 1978
month day yearDATE EFFECTIVE November 1, 1978
month day year

ISSUED BY

Quinter Bosserman
name of officer

Owner

Peace Valley, Mo.
title address

CANCELLED

MAY - 6 1981

BY let
PUBLIC SERVICE COMMISSION
OF MISSOURI

FORM NO. 13 P.S.C.MO. No. 1 ^{Original} SHEET No. 12.1
1st ^{Revised}
Cancelling P.S.C.MO. No. 1 ^{Original} SHEET No. 12.1
~~REVISED~~

PEACE VALLEY TELEPHONE COMPANY For Peace Valley, Missouri
Name of Issuing Corporation Community, Town or City

RECEIVED

RULES AND REGULATIONS

DEC 4 1987

MISSOURI

Public Service Commission

DISCONTINUANCE OF SERVICE (Continued)

5. At least twenty-four (24) hours preceding a discontinuance of service the telephone company shall make an effort to contact the subscriber and advise them of the discontinuance and what action must be taken to avoid it.
6. Discontinuance of service shall be postponed for a time not in excess of twenty-one (21) days if the telephone is necessary to obtain emergency medical assistance for a person who is a member of the household where the telephone service is provided and where such person is under the care of a physician. Any person who alleges such emergency shall, if requested, provide the telephone company with reasonable evidence of such necessity.
7. Notwithstanding any other provisions of this tariff, service to a customer may be discontinued at any time after written notice has been sent to such customer at his last known address and at the address where the service to be discontinued is provided if such customer:
 - A. Incurs charges not covered by a deposit or guarantees and evidences an intent not to pay such charges when due; or
 - B. Damages or evidences an intent to damage telephone utility facilities.
8. The notice required by Section (7) of this of this rule shall state how a customer has evidenced an intent not to pay charges when due or evidences an intent to damage telephone utility facilities.

CANCELLED

OCT 30 2000

By And RS #12.1
Public Service Commission
MISSOURI

FILED

JAN 1 1988

86-26
Public Service Commission

*Indicates new rate or text
+Indicates change

DATE OF ISSUE December 3, 1987 DATE EFFECTIVE January 1, 1988
month day year month day year
ISSUED BY Quinter Bosserman OB Owner-Manager Peace Valley, Mo. 65788
name of officer title address

Peace Valley Telephone Company For Peace Valley, Missouri
Name of Issuing Corporation Community, Town or City

RULES AND REGULATIONS

4 CSR - 240-33.040 and 4 CSR 240-33.050

APR - 3 1981

DISCONTINUANCE OF SERVICE (cont.)

4. until five (5) days after a charge has become delinquent.
5. At least twenty-four (24) hours preceeding a discontinuance of service the telephone company shall make an effort to contact the subscriber and advise them of the discontinuance and what action must be taken to avoid it.
6. Discontinuance of service shall be postponed for a time not in excess of twenty-one (21) days if the telephone is necessary to obtain emergency medical assistance for a person who is a member of the household where the telephone service is provided and where such person is under the care of a physician. Any person who alleges such emergency shall if requested provide the telephone company with reasonable evidence of such necessity.
7. Notwithstanding any other provisions of this tariff, service to a customer may be discontinued at any time after written notice has been sent to such customer at his last known address and at the address where the service to be discontinued is provided if such customer:
 - A. Incurs charges not covered by a deposit or guarantee and evidences an intent not to pay such charges when due; or
 - B. Damages or evidences an intent to damage telephone utility equipment.
8. The notice required by Section (7) of this rule shall state how a customer has evidenced an intent not to pay charges when due or evidences an intent to damage telephone utility equipment.

*Indicates new rate or text
+Indicates change

MAY - 6 1981

DATE OF ISSUE April 1 1981
month day yearDATE EFFECTIVE May 6, 1981
month day year

ISSUED BY Walter Bosserman Owner-Manager Peace Valley, Mo.
name of officer title address

CANCELLED

JAN 01 1988

BY Let. R.S. #12.1
PUBLIC SERVICE COMMISSION
OF MISSOURI

{Revised}

{Original}

{Revised}

Peace Valley Telephone Company
Name of Issuing CorporationFor Peace Valley, Missouri
Community, Town or City

RULES AND REGULATIONS

4 CSR - 240-33.040 and 4 CSR 240-33.050 APR - 3 1981

DISCONTINUANCE OF SERVICE (cont.)

9. The telephone company may render a special toll billing to any customer who incurs toll or other charges at any time during the billing period which are equal to at least 400% of the amount of the deposit or guarantee previously required from such customers. Customers shall be informed of special toll billing by first class mail and the toll charges contained on the special toll billing shall become delinquent ten (10) days thereafter.

CANCELLED

OCT 30 2000

By 16RS #12.2
Public Service Commission
MISSOURI*Indicates new rate or text
+Indicates change

MAY - 6 1981

DATE OF ISSUE April 1, 1981
month day yearDATE EFFECTIVE May 6, 1981
month day year

ISSUED BY

Walter BossermanOwner-Manager
titlePeace Valley, Mo.
address

P.S.C. MO. No. 1

Peace Valley Telephone Company

First Revised Sheet No. 13
Replaces Original Sheet No. 13
For Peace Valley, Missouri

ACCESS SERVICE TARIFF CONCURRENCE

Access Services

Access services are those services which are described in the Access Services Tariff of Oregon Farmers Mutual Telephone Company. These services are offered by the Company to intrastate interexchange customers (ICs) in accordance with the rules and regulations specified in the Access Services Tariff of Oregon Farmers Mutual Telephone Company and approved by the Missouri Public Service Commission, and in any amendments thereto and authorized by the Missouri Public Service Commission or applicable law. The Company does not concur in the rates for access services of Oregon Farmers Mutual Telephone Company. Rates for these services are set out in the following pages of this concurrence.

Provision of Services

The Company, to the extent that such services are or can be made available with reasonable effort, and after provisions has been made for the Company's telephone exchange services, will provide to an intrastate IC, upon reasonable notice, services of the type offered in Oregon Farmers Mutual Telephone Company's Access Services Tariff pursuant to the terms and conditions specified therein and at the rates specified in the following pages of this concurrence. The Company's concurrence in Oregon Farmers Mutual Telephone Company's Access Services Tariff shall not be construed or deemed a representation that all services and service components described therein are available from the Company.

Cancellation Rights

The Company reserves the right to cancel and make void the above concurrence statement, subject to requirements as may be ordered by the Missouri Public Service Commission, at any and such time as it appears that such cancellation is in the best interest of the Company and/or its customers.

RECEIVED

NOV 3 1986

MISSOURI

Public Service Commission

FILED

JAN 1 1987

Public Service Commission

Issued: 11/3/86

Quinter Bosserman
Owner/Manager

Peace Valley, Missouri 65788

Effective: 1/1/87

~~XXXXXX~~

Cancelling P.S.C.MO. No.

Original SHEET No.

Revised

PEACE VALLEY TELEPHONE COMPANY

For Peace Valley, Missouri

Name of Issuing Corporation

Community

RECEIVEDACCESS SERVICES TARIFF CONCURRENCE

DEC 27 1983

Access Services

Access services are those services which are described in Section 1.1, et seq., of the Access Services Tariff of Southwestern Bell Telephone Company. These services are offered by the Company to intrastate interexchange customers (ICs) in accordance with the rules, regulations and system of charges specified in the Access Services Tariff filed by Southwestern Bell Telephone Company and approved by the Missouri Public Service Commission.

Provision of Services

The Company, to the extent that such services are or can be made available with reasonable effort, and after provision has been made for the Company's telephone exchange services, will provide to an intrastate IC, upon reasonable notice, services of the type offered in Southwestern Bell Telephone Company's Access Services Tariff at the rates and charges and pursuant to the terms and conditions specified therein. The Company's concurrence in Southwestern Bell Telephone Company's Access Services Tariff shall not be construed or deemed a representation that all services and service components described therein are available from the Company.

CANCELLED

JAN 1 1987

BY Lot R.S. 13
PUBLIC SERVICE COMMISSION
OF MISSOURI

FILED

JAN - 1 1984

84 - 62

Public Service Commission

*Indicates new rate or text

+Indicates change

DATE OF ISSUE December 27, 1983 DATE EFFECTIVE January 1, 1984
month day year month day yearISSUED BY Quinter Bosserman Owner/Manager Peace Valley, Missouri
name of officer title address

P.S.C. MO. No. 1

Peace Valley Telephone Company

9th Revised Sheet No. 13.1
Cancels 8th Revised Sheet No. 13.1
For Peace Valley, MO

ACCESS SERVICES TARIFF CONCURRENCE

12. Rates and Charges (Cont'd)

12.1 Peace Valley Telephone Company (Cont'd)

12.1.1 Carrier Common Line Access Service

	<u>Rate</u>	<u>Tariff Section Reference</u>	
(A) Intrastate Carrier Common Line Access, per minute			(T)
- Originating	\$0.053018	3.6	
- Terminating	\$0.000000	3.6	(R)
(B) Reserved for Future Use			(D)
(C) Reserved for Future Use			(D)

12.1.2 Switched Access Service

(A) <u>Local Transport -- Installation</u> <u>Per Entrance Facility</u>		6.2(A)(1)	(D)	(N)
- Voice Grade Two-Wire	\$450.00			
- Voice Grade Four-Wire	\$450.00			
- High Capacity DS1	\$330.00			
- High Capacity DS3	\$445.00			
(B) <u>Local Transport -- Premium Access</u>				
1. <u>Entrance Facility</u> <u>Per Termination</u>		6.2(A)(1)		
- Voice Grade Two-Wire	\$ 76.23			
- Voice Grade Four-Wire	\$ 121.99			
- High Capacity DS1	\$ 371.65			
- High Capacity DS3	\$3,393.45			
2. <u>Direct Trunked</u> <u>Transport</u>		6.2(A)(2)		
a. Direct Trunked Facility Per Mile				
- Voice Grade Two-Wire	\$ 5.43			
- Voice Grade Four-Wire	\$ 5.43			
- High Capacity DS1	\$ 25.46			
- High Capacity DS3	\$ 221.81			
b. Direct Trunked Termination Per Termination				
- Voice Grade Two-Wire	\$ 54.57			
- Voice Grade Four-Wire	\$ 54.57			
- High Capacity DS1	\$ 132.12			
- High Capacity DS3	\$ 848.34			

Issued: May 02, 2012
CANCELED
July 2, 2013
Missouri Public
Service Commission
JI-2013-0518

Maurice Bosserman
Owner/Manager
Peace Valley, Missouri 65788

Effective: July 01, 2012
FILED
Missouri Public
Service Commission
TT-2012-0317, YI-2012-0651

Peace Valley Telephone Company

P.S.C. MO No. 1
8th Revised Sheet No. 13.1
Replaces 7th Revised Sheet No. 13.1

ACCESS SERVICES TARIFF CONCURRENCE

12. Rates and Charges

12.1 Peace Valley Telephone Corp

12.1.1 Carrier Common Line Access Service

	Rate Per Access Minute	Tariff Section Reference
(A) Intrastate/ InterLATA Carrier Common Line Access, per minute		
- Originating	\$.053018	3.6
- Terminating	\$.105212	3.6
(B) Intrastate/ IntraLATA Carrier Common Line Access, per minute		
-Originating	\$.053018	3.6
-Terminating	\$.105212	3.6

(D)

(C) Initial and Allocation Lists		(T)
Nonrecurring Charge per ASR	\$50.00	
- Initial List per Customer Account	\$ 0.03	
- Allocation List per Listing	\$ 0.03	

12.1.2 Switched Access Service

(A) <u>Nonrecurring Charges</u>		
Per Line or Trunk Connected	\$204.88	6.7.1(A)
(B) <u>Local Transport*</u>		
1. FGC Premium Access, per Minute	\$0.0241	6.2(A)
2. FGA and FGB Premium Access, Per Minute		
<u>Call Miles</u>		
0 to 1	\$0.0066	6.2(A)
Over 1 to 25	\$0.0139	6.2(A)
Over 25 to 50	\$0.0525	6.2(A)
Over 50	\$0.0823	6.2(A)

* The Local Transport rate includes non-chargeable Interface Groups and Optional Features as set forth in 6.2(A)(1) and 6.2(A)(2).

CANCELED
July 1, 2012
Missouri Public
Service Commission

TT-2012-0317 YI-2012-0651
Issued: June 11, 2003

Maurice Bosserman
Owner/Manager
Peace Valley Telephone Company
Peace Valley, MO 65788

Effective: July 12, 2003

Peace Valley Telephone Company

P.S.C. MO No. 1
 7th Revised Sheet No. 13.1
 Replaces 6th Revised Sheet No. 13.1
 REC'D AUG 01 2002
 Service Commission

ACCESS SERVICES TARIFF CONCURRENCE

12. Rates and Charges

12.1 Peace Valley Telephone Corp

12.1.1 Carrier Common Line Access Service

	Rate Per Access Minute	Tariff Section Reference
(A) Intrastate/ InterLATA Carrier Common Line Access, per minute		
- Originating	\$0.053018	3.6
- Terminating	\$0.105212	3.6
(B) Intrastate/ IntraLATA Carrier Common Line Access, per minute		
- Originating	\$0.053018	3.6
- Terminating	\$0.105212	3.6
(C) IntraLATA Equal Access Cost Recovery Charge per Originating Intrastate Access Minute of Use	\$0.00675	3.6(F)(6)
To be monitored for a period of no more than 3 years, then subsequently removed		
(D) Initial and Allocation Lists		
- Nonrecurring Charge per ASR	\$50.00	
- Initial List per Customer Account	\$ 0.03	
- Allocation List per Listing	\$ 0.03	

12.1.2 Switched Access Service

(A) <u>Nonrecurring Charges</u> Per Line or Trunk Connected	\$204.88	6.7.1(A)
(B) <u>Local Transport*</u>		
1. FGC Premium Access, per Minute	\$0.0241	6.2(A)
2. FGA and FGB Premium Access, Per Minute		
<u>Call Miles</u>		
0 to 1	\$0.0066	6.2(A)
Over 1 to 25	\$0.0139	6.2(A)
Over 25 to 50	\$0.0525	6.2(A)
Over 50	\$0.0823	6.2(A)

- The Local Transport rate includes non-chargeable Interface Groups and Optional Features as set forth in 6.2(A)(1) and 6.2(A)(2).

CANCELLED

By *SHRS13.1* 12 2003
 Public Service Commission
 MISSOURI

Missouri Public

FILED SEP 01 2002

Issued: August 1, 2002

Maurice Bosserman
 Owner/Manager

Effective: September 1, 2002

Peace Valley Telephone Company
 Peace Valley, MO 65788

Peace Valley Telephone Company

P.S.C. MO No. 1
6th Revised Sheet No. 13.1
Replaces 5th Revised Sheet No. 13.1

ACCESS SERVICES TARIFF CONCURRENCE

12. Rates and Charges

12.1 Peace Valley Telephone Corp

12.1.1 Carrier Common Line Access Service

Rate Per Access <u>Minute</u>	Tariff Section <u>Reference</u>
-------------------------------------	---------------------------------------

(A) Intrastate/ InterLATA
Carrier Common Line Access,
per minute

- Originating	\$0.053018	3.6
- Terminating	\$0.105212	3.6

Intrastate/ IntraLATA
Carrier Common Line Access,
per minute

-Originating	\$0.053018	3.6
-Terminating	\$0.105212	3.6

(C) IntraLATA Equal Access Cost \$0.00242 3.6(F)(6)
Recovery Charge per Originating
Intrastate Access Minute of Use

To be monitored for a period of no more than 3
years, then subsequently removed

(D) Initial and Allocation Lists
- Nonrecurring Charge per ASR \$50.00
- Initial List per Customer Account \$ 0.03
- Allocation List per Listing \$ 0.03

RECEIVED

FEB 21 2001

MISSOURI
Public Service Commission

12.1.2 Switched Access Service

(A) Nonrecurring Charges

Per Line or Trunk Connected	\$204.88	6.7.1(A)
-----------------------------	----------	----------

(B) Local Transport*

1. FGC Premium Access, per Minute	\$0.0241	6.2(A)
--------------------------------------	----------	--------

2. FGA and FGB Premium Access,
Per Minute

Call Miles

0 to 1	\$0.0066	6.2(A)
Over 1 to 25	\$0.0139	6.2(A)
Over 25 to 50	\$0.0525	6.2(A)
Over 50	\$0.0823	6.2(A)

* The Local Transport rate includes non-chargeable Interface Groups and Optional Features
as set forth in 6.2(A)(1) and 6.2(A)(2).

FILED
01-118
APR 16 2001

MISSOURI
Public Service Commission

Issued: February 21, 2001

Maurice Bosserman
Owner/Manager
Peace Valley Telephone Company
Peace Valley, MO 65788

Effective: April 16, 2001

Missouri Public Service Commission

REC'D JUN 12 2000

Peace Valley Telephone Company

P.S.C. MO No. 1
5th Revised Sheet No. 13.1
Replaces 4th Revised Sheet No. 13.1

ACCESS SERVICES TARIFF CONCURRENCE

12. Rates and Charges

12.1 Peace Valley Telephone Corp

12.1.1 Carrier Common Line Access Service

	Rate Per Access Minute	Tariff Section Reference	
(A) Intrastate/ InterLATA Carrier Common Line Access, per minute			
- Originating	\$0.07150	3.6	
- Terminating	\$0.12260	3.6	
(B) Intrastate/ IntraLATA Carrier Common Line Access, per minute			(T)
- Originating	\$0.04687	3.6	
- Terminating	\$0.08035	3.6	
(C) IntraLATA Equal Access Cost Recovery Charge per Originating Intrastate Access Minute of Use	\$0.00242	3.6(F)(6)	(I)
To be monitored for a period of no more than 3 years, then subsequently removed			
(D) Initial and Allocation Lists			(T)
- Nonrecurring Charge per ASR	\$50.00		
- Initial List per Customer Account	\$ 0.03		
- Allocation List per Listing	\$ 0.03		(T)

12.1.2 Switched Access Service

(A) <u>Nonrecurring Charges</u>			
Per Line or Trunk Connected	\$204.88	6.7.1(A)	
(B) <u>Local Transport*</u>			
1. FGC Premium Access, per Minute	\$0.0241	6.2(A)	
2. FGA and FGB Premium Access, Per Minute			
<u>Call Miles</u>			
0 to 1	\$0.0066	6.2(A)	
Over 1 to 25	\$0.0139	6.2(A)	
Over 25 to 50	\$0.0525	6.2(A)	
Over 50	\$0.0823	6.2(A)	

CANCELLED

APR 16 2001

By 6-16-01 6513.1
Public Service Commission
MISSOURI

- The Local Transport rate includes non-chargeable Interface Groups and Optional Features as set forth in 6.2(A)(1) and 6.2(A)(2).

Note: The Carrier Common Line (CCL) rates shown as 12.1.1(A) are interim and subject to refund pursuant to the Commission's orders in Cases No. TO-99-254 and TO-99-531, or as these decisions may be subsequently modified by a final decision on appeal.

Missouri Public
Service Commission

FILED JUL 12 2000

Issued: June 12, 2000

Maurice Bosserman
Owner/Manager

Effective: July 12, 2000

Peace Valley Telephone Company
Peace Valley, MO 65788

Peace Valley Telephone Company

4th Revised Sheet No. 13.1

Cancels 3rd Revised Sheet No. 13.1

For Peace Valley, Missouri

ACCESS SERVICES TARIFF CONCURRENCE

Missouri Public
Service Commission

12. Rates and Charges

REC'D JAN 05 2000

12.1 Peace Valley Telephone Corp12.1.1 Carrier Common Line Access Service

	Rate Per Access Minute	Tariff Section Reference
(A) Intrastate/interLATA		
Carrier Common Line Access, per minute		
- Originating	\$0.07150	3.6
- Terminating	\$0.12260	3.6
(A) Intrastate/intraLATA		
Carrier Common Line Access, per minute		
- Originating	\$0.04687	3.6
- Terminating	\$0.08035	3.6
(C) IntraLATA Equal Access Cost Recovery Charge		
Per Originating Intrastate Access Minute of Use	N/A	3.6(F)(6)
To be monitored for a period of no more than 3 years, then Subsequently removed		

(D) Initial and Allocation Lists

Nonrecurring Charge Per ASR \$50.00	Initial List Per Customer Account \$0.03	Allocation List Per Listing \$0.03
--	---	--

12.1.2 Switched Access Service

(A) <u>Nonrecurring Charges</u>		
Per Line or Trunk Connected	\$204.88	6.7.1(A)
(B) <u>Local Transport*</u>		
1. FGC Premium Access, per Minute	\$0.0241	6.2(A)
2. FGA and FGB Premium Access, per Minute		
Call Miles		
0 to 1.....	\$0.0066	6.2(A)
Over 1 to 25.....	\$0.0139	6.2(A)
Over 25 to 50.....	\$0.0525	6.2(A)
Over 50.....	\$0.0823	6.2(A)

* The Local Transport rate includes non-chargeable Interface Groups and Optional Features as set forth in 6.2(A)(1) and 6.2(A)(2).

Note: The Carrier Common Line (CCL) rates shown as 12.1.1(A) are interim and subject to refund pursuant to the Commission's orders in Cases No. TO-99-254 and TO-99-531, or as these decisions may be subsequently modified by a final decision on appeal.

CANCELLED

JUL 12 2000

5th RS 13.1

Public Service Commission
MISSOURIMissouri Public
Service Commission

FILED FEB 17 2000

Peace Valley Telephone Company

3RD
2nd Revised Sheet No. 13.1

Cancels 1st Revised Sheet No. 13.1

For Peace Valley, Missouri

ACCESS SERVICES TARIFF CONCURRENCE

Missouri Public
Service Commission

12. Rates and Charges

REC'D SEP 16 1999

12.1 Peace Valley Telephone Corp

12.1.1 Carrier Common Line Access Service

(A) Intrastate/interLATA

Carrier Common Line Access,
per minute

- Originating

- Terminating

Rate
Per Access
MinuteTariff
Section
Reference

\$0.07150

3.6

\$0.12260

3.6

Art Kuss
getting
corrected
page.
12-9-99

(B) Intrastate/intraLATA

Carrier Common Line Access,
per minute

- Originating

- Terminating

\$0.04687

3.6

\$0.08035

3.6

(I)

(I)

(C) IntraLATA Equal Access Cost Recovery Charge

Per Originating Intrastate
Access Minute of Use

N/A

3.6(F)(6)

(N)

To be monitored for a period of no more than 3 years, then
Subsequently removed

(D) Initial and Allocation Lists

Nonrecurring
Charge
Per ASR
\$50.00Initial List
Per Customer
Account
\$0.03Allocation List
Per Listing
\$0.03

12.1.2 Switched Access Service

(N)

(A) Nonrecurring Charges

Per Line or Trunk Connected

\$204.88

6.7.1(A)

(B) Local Transport*

1. FGC Premium Access,
per Minute

\$0.0241

6.2(A)

2. FGA and FGB Premium Access, per Minute

Call Miles

0 to 1.....

\$0.0066

6.2(A)

Over 1 to 25.....

\$0.0139

6.2(A)

Over 25 to 50.....

\$0.0525

6.2(A)

Over 50.....

\$0.0823

6.2(A)

* The Local Transport rate includes non-chargeable Interface Groups and Optional Features as set forth in 6.2(A)(1) and 6.2(A)(2).

Note: The Carrier Common Line (CCL) rates shown as 12.1.1(A) are interim and subject to refund pursuant to the Commission's orders in Cases No. TO-99-254 and TO-99-531, or as these decisions may be subsequently modified by a final decision on appeal.

(N)

(N)

(N)

Missouri Public
Service Commission

Issued: Sept. 16, 1999

Maurice Bosserman
Owner/Manager

Effective: Oct. 16, 1999

FILED OCT 16 1999

CANCELLED

FEB 17 2000

4th RS 13.1

By
Public Service Commission
MISSOURI

Peace Valley Telephone Company

2nd Revised Sheet No . 13.1

Cancels 1st Revised Sheet No . 13.1

ACCESS SERVICES TARIFF CONCURRENCE

12. Rates and Charges12.1 Peace Valley Telephone Company

Rate

Tarriff
Section
Reference**RECEIVED**

SEP 23 1994

12.1.1 Carrier Common Line Access Service(A) Intrastate InterLATA
Carrier Common Line Access,
per minute

MO. PUBLIC SERVICE COMM.

-Originating	\$0.0715	3.6
-Terminating	\$0.1226	3.6

(B) Intrastate IntraLATA
Carrier Common Line Access(1) Full Level Volume
900,679 Access Minutes

(2) Full Level, per minute

-Originating	\$0.0212	3.6(E)
-Terminating	\$0.0363	3.6(E)

CANCELLED

(3) Discount Level, per minute

-Originating	\$0.0124	3.6(E)
-Terminating	\$0.0213	3.6(E)

OCT 16 1999
By 3rd RS#13.1
Public Service Commission
MISSOURI12.1.2 Switched Access Service(A) Nonrecurring Charges

Per Line or Trunk Connected	\$204.88	6.7.1(A)
-----------------------------	----------	----------

(B) Local Transport*

1. FGC Premium Access, per minute	.0241	6.2(A)
-----------------------------------	-------	--------

2. FGA and FGB Premium Access, per minute

<u>Call Miles</u>		
0 to 1.....	.0066	6.2(A)
Over 1 to 25.....	.0139	6.2(A)
Over 25 to 50.....	.0525	6.2(A)
Over 50.....	.0823	6.2(A)

FILEDOCT 23 1994
95 - 89MISSOURI
Public Service Commission

*The Local Transport rate includes non-chargeable Interface Groups and Optional Features as set forth in 6.2(A)(1) and 6.2(A)(2).

Issued:

Maurice Bosserman

Effective: OCT 23 1994

SEP 19 1994

Owner/Manager

Peace Valley, Missouri 65788

P.S.C. MO. No. 1

Peace Valley Telephone Company

1st Revised Sheet No. 13.1
Cancels Original Sheet No. 13.1
For Peace Valley, Missouri

ACCESS SERVICES TARIFF CONCURRENCE

12. Rates and Charges

12.1 Peace Valley Telephone Company

12.1.1 Carrier Common Line Access Service

(A) Intrastate InterLATA
Carrier Common Line Access,
per minute

- Originating	\$0.0715	3.6
- Terminating	\$0.1226	3.6

(B) Intrastate IntraLATA
Carrier Common Line Access

(1) Full Level Volume
652,849 Access Minutes

(2) Full Level, per minute

- Originating	\$0.0273	3.6(E)
- Terminating	\$0.0468	3.6(E)

(3) Discount Level, per minute

- Originating	\$0.0160	3.6(E)
- Terminating	\$0.0274	3.6(E)

12.1.2 Switched Access Service

(A) Nonrecurring Charges

Per Line or Trunk Connected	\$204.88	6.7.1(A)
-----------------------------	----------	----------

(B) Local Transport*

Per Access
Minute

1. FGC Premium Access, per minute	.0241	6.2(A)
-----------------------------------	-------	--------

2. FGA and FGB Premium Access, per minute		
--	--	--

Call Miles

0 to 10066	6.2(A)
Over 1 to 250139	6.2(A)
Over 25 to 500525	6.2(A)
Over 500823	6.2(A)

* The Local Transport rate includes non-chargeable Interface Groups and Optional Features as set forth in 6.2(A)(1) and 6.2(A)(2).

Issued: 5/2/88

Quinter Bosserman
Owner/Manager
Peace Valley, Missouri

Effective: 7/1/88

RECEIVED

MAY 2 1988

MISSOURI
Public Service Commission

Tariff
Section
Reference

Rate

CANCELLED

OCT 23 1994
BY 2nd RS 13.1
Public Service Commission
MISSOURI

(N)

(N)

FILED

JUL 1 1988
6.2(A) 222 et al.
Public Service Commission

P.S.C. MO. No. 1

Peace Valley Telephone Company

Original Sheet No. 13.1
For Peace Valley, Missouri

ACCESS SERVICES TARIFF CONCURRENCE

12. Rates and Charges

12.1 Peace Valley Telephone Company

12.1.1 Carrier Common Line Access Service

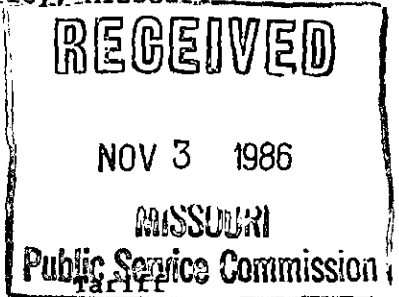

Section
Rate Reference

Carrier Common Line Access, per min.

- Originating	\$0.0715	3.6
- Terminating	\$0.1226	3.6

12.1.2 Switched Access Service

(A) Nonrecurring Charges

Per Line or Trunk Connected	\$204.88	6.7.1(A)
-----------------------------	----------	----------

(B) Local Transport*

Per Access
Minute

1. FGC Premium Access	.0241	6.2(A)
-----------------------	-------	--------

2. FGA and FGB Premium Access		
-------------------------------	--	--

CANCELLED

JUL 1 1988

BY *1st P.S. #13.1*

Public Service Commission
MISSOURI

Call Miles

0 to 1.....	.0066	6.2(A)
Over 1 to 25.....	.0139	6.2(A)
Over 25 to 50.....	.0525	6.2(A)
Over 50.....	.0823	6.2(A)

* The Local Transport rate includes non-chargeable Interface Groups and Optional Features as set forth in 6.2(A)(1) and 6.2(A)(2).

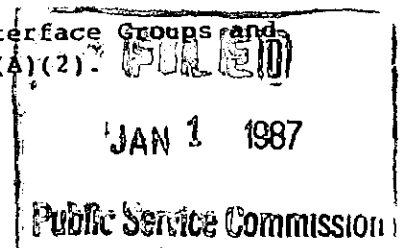

Issued: 11/3/86

Quinter Bosserman

Effective: 1/1/87

Owner/Manager

Peace Valley, Missouri 65788

P.S.C. MO. No. 1

Peace Valley Telephone Company

4th Revised Sheet No. 13.1.1.a
Cancels 3rd Revised Sheet No. 13.1.1.a
For Peace Valley, MO

ACCESS SERVICES TARIFF CONCURRENCE

12. Rates and Charges (Cont'd)

12.1 Peace Valley Telephone Company (Cont'd)

12.1.2 Switched Access Service (Cont'd)

		Rate per Access Minute	Tariff Section Reference	
(D)	<u>Toll VoIP-PSTN Traffic</u>			
(1)	<u>Local Switching</u>			
(a)	Originating, per Access Minute	*	2.3.11(E)(1)(a)	
(b)	Terminating, per Access Minute	**	2.3.11 (E)(1)(a)	(T)(I)
(2)	<u>Information Surcharge</u>			
(a)	Originating, per Access Minute	*	2.3.11 (E)(1)(b)	
(b)	Terminating, per Access Minute	**	2.3.11 (E)(1)(b)	(T)(I)
(3)	<u>Tandem Switched Transport</u>			
(a)	<u>Tandem Switched Facility</u>			
	Per Originating Access Minute, Per Mile	*	2.3.11 (E)(2)	
	Per Terminating Access Minute, Per Mile	**	2.3.11 (E)(2)	(T)(I)
(b)	<u>Tandem Switched Termination</u>			
	Per Originating Access Minute	*	2.3.11 (E)(2)	
	Per Terminating Access Minute	**	2.3.11 (E)(2)	(T)(I)

* The Company's intrastate originating access rates apply until June 30, 2014.

** The Company concurs with the rates of NECA's Tariff FCC No. 5 for this element, which can be viewed at (N)
https://www.neca.org/Tariff_5_Landing_Page.aspx

Issued: May 15, 2013

CANCELED
July 1, 2014
Missouri Public
Service Commission
JL-2014-0490

Maurice Bosserman
Owner/Manager
Peace Valley, Missouri 65788

Effective: July 2, 2013

FILED
Missouri Public
Service Commission
JI-2013-0518

P.S.C. MO. No. 1

Peace Valley Telephone Company

3rd Revised Sheet No. 13.1.1.a
Cancels 2nd Revised Sheet No. 13.1.1.a
For Peace Valley, MO

ACCESS SERVICES TARIFF CONCURRENCE

12. Rates and Charges (Cont'd)

12.1 Peace Valley Telephone Company (Cont'd)

12.1.2 Switched Access Service (Cont'd)

		<u>Rate per Access Minute</u>	<u>Tariff Section Reference</u>	
(D)	<u>Toll VoIP-PSTN Traffic</u>			
(1)	<u>Local Switching</u>			
(a)	Originating, per Access Minute	*	2.3.11(E)(1)(a)	(C)
(b)	Terminating, per Access Minute	\$0.044902	2.3.11 (E)(1)(a)	
(2)	<u>Information Surcharge</u>			
(a)	Originating, per Access Minute	*	2.3.11 (E)(1)(b)	(C)
(b)	Terminating, per Access Minute	\$0.000494	2.3.11 (E)(1)(b)	
(3)	<u>Tandem Switched Transport</u>			
(a)	<u>Tandem Switched Facility</u> Per Originating Access Minute, Per Mile	*	2.3.11 (E)(2)	(C)
	Per Terminating Access Minute, Per Mile	\$0.000402	2.3.11 (E)(2)	
(b)	<u>Tandem Switched Termination</u> Per Originating Access Minute	*	2.3.11 (E)(2)	(C)
	Per Terminating Access Minute	\$0.002090	2.3.11 (E)(2)	

* The Company's intrastate originating access rates apply until June 30, 2014.

Issued: July 2, 2012

CANCELED
July 2, 2013
Missouri Public
Service Commission
JI-2013-0518

Maurice Bosserman

Owner/Manager
Peace Valley, Missouri 65788

Effective: July 13, 2012

FILED
Missouri Public
Service Commission
IT-2013-0005; YI-2013-0010

P.S.C. MO. No. 1

Peace Valley Telephone Company

2nd Revised Sheet No. 13.1.1.a
Cancels 1st Revised Sheet No. 13.1.1.a
For Peace Valley, MO

ACCESS SERVICES TARIFF CONCURRENCE

12. Rates and Charges (Cont'd)

12.1 Peace Valley Telephone Company (Cont'd)

12.1.2 Switched Access Service (Cont'd)

	Rate per Access Minute	Tariff Section Reference	
(D) <u>Toll VoIP-PSTN Traffic</u>			(N)
(1) <u>Local Switching</u>			
(a) Originating, per Access Minute	\$0.044902	2.3.11(E)(1)(a)	
(b) Terminating, per Access Minute	\$0.044902	2.3.11 (E)(1)(a)	
(2) <u>Information Surcharge</u>			
(a) Originating, per Access Minute	\$0.000494	2.3.11 (E)(1)(b)	
(b) Terminating, per Access Minute	\$0.000494	2.3.11 (E)(1)(b)	
(3) <u>Tandem Switched Transport</u>			
(a) <u>Tandem Switched Facility</u> Per Originating Access Minute, Per Mile	\$0.000402	2.3.11 (E)(2)	
Per Terminating Access Minute, Per Mile	\$0.000402	2.3.11 (E)(2)	
(b) <u>Tandem Switched Termination</u> Per Originating Access Minute	\$0.002090	2.3.11 (E)(2)	
Per Terminating Access Minute	\$0.002090	2.3.11 (E)(2)	(N)

CANCELLED
July 13, 2012
Missouri Public
Service Commission
IT-2013-0005; YI-2013-0010

Issued: March 21, 2012

Maurice Bosserman
Owner/Manager
Peace Valley, Missouri 65788

Effective: April 20, 2012

FILED
Missouri Public
Service Commission
JI-2012-0499

P.S.C. MO. No. 1

Peace Valley Telephone Company

1st Revised Sheet No. 13.1.1.a
Cancels Original Sheet No. 13.1.1.a
For Peace Valley, MO

ACCESS SERVICES TARIFF CONCURRENCE

RECEIVED

APR 06 1995

MO. PUBLIC SERVICE COMM.

(D)

RESERVED FOR FUTURE USE

(D)

FILED

MAY 10 1995

MISSOURI
Public Service Commission

APR 10 1995

MAY 10 1995

Issued:

CANCELLED
April 20, 2012
Missouri Public
Service Commission
JI-2012-0499

Maurice Bosserman

Owner/Manager

Peace Valley, Missouri 65788

Effective:

P.S.C. MO. No. 1

Peace Valley Telephone Company

2nd Revised Sheet No. 13.1.1
Cancels 1st Revised Sheet No. 13.1.1
For Peace Valley, MO

ACCESS SERVICES TARIFF CONCURRENCE

12. Rates and Charges (Cont'd)

12.1 Peace Valley Telephone Company (Cont'd)

12.1.2 Switched Access Service (Cont'd)

(B) Local Transport – Premium Access (Cont'd)

	<u>Rate</u>	<u>Tariff Section Reference</u>
3. <u>Multiplexing</u>		
<u>Per Arrangement</u>		6.2(A)(4)
- DS-1 to Voice	\$ 298.84	
- DS-3 to DS-1	\$ 774.02	
4. <u>Tandem Switched Transport</u>		
a. <u>Tandem Switched Facility</u>		6.2(A)(3)(b)
- Per Originating Access Minute		
Per Mile	\$0.000402	
- Per Terminating Access Minute		
Per Mile	\$0.000402	
b. <u>Tandem Switched Termination</u>		6.2(A)(3)(c)
- Per Originating Access Minute		
Per Termination	\$0.021764	
- Per Terminating Access Minute		
Per Termination	\$0.002090	
c. <u>Tandem Switching</u>		6.2(A)(3)(a)
- Per Originating Access Minute		
Per Tandem	\$0.005272	
- Per Terminating Access Minute		
Per Tandem	\$0.005272	

(C) End Office Premium Access

1. <u>Local Switching</u>		6.2(B)(1)	
- originating	\$0.026700		
- terminating	\$0.044902		
2. <u>Transitional Rate Element</u>		6.2(B)(2)	(R)
- terminating	\$0.0532937*		
3. <u>Information Surcharge</u>		6.2(B)(3)	
(Per 100 Access Minutes)			
- originating	\$0.0397		
- terminating	\$0.0494		

* This rate is effective only from July 1, 2012 through June 30, 2013.

Issued: October 1, 2012
CANCELED
July 2, 2013
Missouri Public
Service Commission
JI-2013-0518

Maurice Bosserman
Owner/Manager
Peace Valley, Missouri 65788

Effective: October 31, 2012

Filed
Missouri Public
Service Commission
JI-2013-0164

P.S.C. MO. No. 1

Peace Valley Telephone Company

1st Revised Sheet No. 13.1.1
Cancels Original Sheet No. 13.1.1
For Peace Valley, MO

ACCESS SERVICES TARIFF CONCURRENCE

12. Rates and Charges (Cont'd)

12.1 Peace Valley Telephone Company (Cont'd)

12.1.2 Switched Access Service (Cont'd)

(B) <u>Local Transport – Premium Access</u> (Cont'd)		Tariff Section Reference	
	<u>Rate</u>		(N)
3. <u>Multiplexing</u>			
<u>Per Arrangement</u>		6.2(A)(4)	
- DS-1 to Voice	\$ 298.84		
- DS-3 to DS-1	\$ 774.02		
4. <u>Tandem Switched Transport</u>			
a. <u>Tandem Switched Facility</u>		6.2(A)(3)(b)	
- Per Originating Access Minute			
Per Mile	\$0.000402		
- Per Terminating Access Minute			
Per Mile	\$0.000402		
b. <u>Tandem Switched Termination</u>		6.2(A)(3)(c)	
- Per Originating Access Minute			
Per Termination	\$0.021764		
- Per Terminating Access Minute			
Per Termination	\$0.002090		
c. <u>Tandem Switching</u>		6.2(A)(3)(a)	
- Per Originating Access Minute			
Per Tandem	\$0.005272		
- Per Terminating Access Minute			
Per Tandem	\$0.005272		(N)
(C) <u>End Office</u>			
<u>Premium Access</u>			
1. <u>Local Switching</u>		6.2(B)(1)	(T)
- originating	\$0.026700		(I)
- terminating	\$0.044902		(I)
2. <u>Transitional Rate Element</u>		6.2(B)(2)	
- terminating	\$0.055080*		(N)
3. <u>Information Surcharge</u>		6.2(B)(3)	
(Per 100 Access Minutes)			
- originating	\$0.0397		
- terminating	\$0.0494		(T)

* This rate is effective only from July 1, 2012 through June 30, 2013.

Issued: May 02, 2012

Maurice Bosserman
Owner/Manager
Peace Valley, Missouri 65788

Effective: July 01, 2012

CANCELLED
October 31, 2012
Missouri Public
Service Commission
JI-2013-0164

FILED
Missouri Public
Service Commission
TT-2012-0317, YI-2012-0651

P.S.C. MO. No. 1

Peace Valley Telephone Company

Original Sheet No. 13.1.1
For Peace Valley, Missouri

ACCESS SERVICES TARIFF CONCURRENCE

12. Rates and Charges (Cont'd)

12.1 Peace Valley Telephone Company (Cont'd)

12.1.2 Switched Access Service (Cont'd)

RECEIVED

NOV 3 1986

MISSOURI
Public Service Commission

Rate Tariff
per Access Section
Minute Reference

(C) End Office
Premium Access

1. Local Switching

LS2 (Feature Group C&B (WATS))	.0118	6.2(B)(1)
LS1 (Feature Group A & B)	0077	6.2(1)(1)

2. Line Termination

a. Common	0149	6.2(B)(2)
b. Special Access	0149	6.2(7)(2)

3. Directory Assistance

Info. Surcharge	.397	6.2(2)(2)
-----------------	------	-----------

(Per 100 Access Minutes)

FILED

JAN 1 1987

Public Service Commission

Issued: 11/3/86

CANCELED

July 1, 2012

Missouri Public

Service Commission

TT-2012-0317, YI-2012-0651

Quinter Bosserman

Owner/Manager

Peace Valley, Missouri 65788

Effective: 1/1/87

Peace Valley Telephone Company

Original Sheet No. 13.1.1.a
For Peace Valley, Mo.

ACCESS SERVICES TARIFF CONCURRENCE

RECEIVED

12. Rates and Charges

APR 13 1993

12.1 Peace Valley Telephone Company

MISSOURI
Public Service Commission

The rates included in the following rate categories for intrastate intraLATA access service are interim and subject to refund only to the extent required to comply with the Commission's Orders in Case No. TO-92-306:

Intrastate IntraLATA Carrier Common Line Access

Switched Access Service

Local Transport

End Office

Interest will be paid on any calculated refund amount from the due date of the bill rendered which includes the amount to be refunded until the payment of said amount. Interest will be paid at a rate equal to the prime rate (as published in the Wall Street Journal) less one percent. The interest rate will be adjusted semi-annually based on the rate in effect on the first business day after December 31 and June 30.

(N)

CANCELLED

MAY 10 1995
BY let R.S. #13.1.1.a
Public Service Commission
MISSOURI

FILED

MAY 17 1993
92 - 306
MO. PUBLIC SERVICE COMM.

Issued: 4/19/93

Quinter Bosserman
Owner/Manager
P.O. Box 9
Peace Valley, Missouri 65788

Effective: 5/17/93

P.S.C. MO. No. 1

Peace Valley Telephone Company

Original Sheet No. 13.2
For Peace Valley, Missouri

ACCESS SERVICES TARIFF - CONCURRENCE

12. Rates and Charges (Cont'd)

12.1 Peace Valley Telephone Company (Cont'd)

12.1.3 Special Access Service

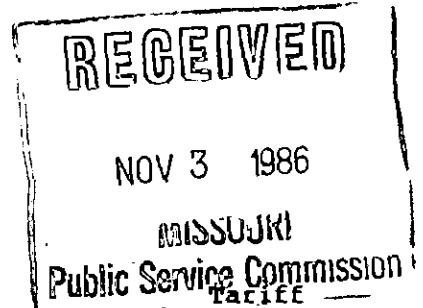

	Monthly Rates	Nonrecurring Charges	Section Reference
(A) <u>Channel Termination, per termination*</u>			
(1) Voice Grade Channel			
Two-wire	\$23.40	\$82.40	7.1.1(A)
Four-wire	\$7 45	\$82.40	7.1 1(A)
(2) Metallic Channel			
Two-Wire	15.99	\$80.02	7.1.1(A)
(B) <u>Channel Mileage, (applies to both Voice Grade and Metallic Channels)</u>			
(1) Channel Mileage Facility - Per Mile	1.70	None	7.1.1(B)(1)
(2) Channel Mileage Termination - Per Termination	31.54	None	7.1.1(B)(2)
(C) <u>Special Access Surcharge</u>			
- Per Voice Grade Equivalent	25.00	None	7.4.4

CANCELLED

OCT 01 2000

By *1st RS#13.2*
Public Service Commission,
MISSOURI

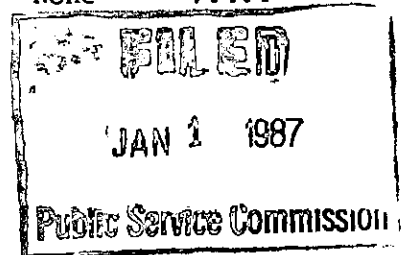

Issued: 11/3/86

Quinter B...
Owner/Manager
Peace Valley, Missouri 65788

Effective: 1/1/87

P.S.C. MO. No. 1

Peace Valley Telephone Company

Original Sheet No. 13.4
For Peace Valley, Missouri

ACCESS SERVICES TARIFF CONCURRENCE

12. Rates and Charges (Cont'd)

12.1 Peace Valley Telephone Company (Cont'd)

12.1.4 Billing and Collection Service

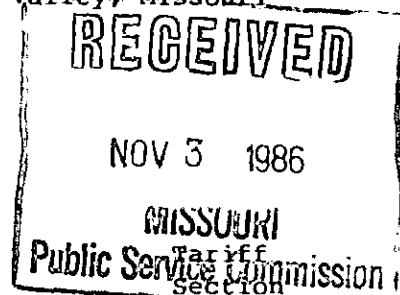

	<u>Rates</u>	<u>Reference</u>
(A) Recording, per customer message	.0483	8.1.1(A)
(B) Provision of Message Detail, per message	ICB	8.1.1(B)
(C) Magnetic Tape, per tape	\$17.48	8.1.1(B) and 8.2.1(E)
(D) Rating Service, per message	.0134	8.2.1(A)
(E) Bill Processing Svc., per message	.0459	8.2.1(B)
(F) Special Billing Service, per bill		8.2.1(C)
(G) Data Transmission, per message		8.2.1(D)
(H) Provision of Sample Message Data, per record processed	.0163	8.2.1(E)
(I) Program Development		
Basic per hour	\$57.74	8.2.1(F)
Premium per hour	\$80.07	8.2.1(F)
(J) Message Billed Service, in which one or more messages or message service related rate elements are billed, per bill rendered to a customer end user account per month	\$.82	8.2.1(G)

CANCELLED
APR 15 1997
BY 1st R.S. #134
Public Service Commission
MISSOURI

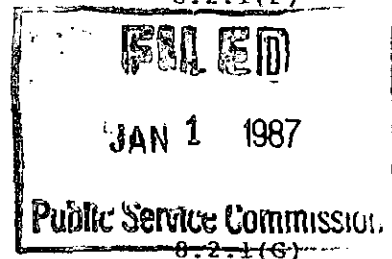

Issued: 11/3/86

Quinter Bosserman
Owner/Manager
Peace Valley, Missouri 65788

Effective: 1/1/87

P.S.C. MO. No. 1

Peace Valley Telephone Company

1st Revised Sheet No. 13.5
Cancels Original Sheet No. 13.5
For Peace Valley, Missouri

ACCESS SERVICES TARIFF CONCURRENCE

RECEIVED

12. Rates and Charges (Cont'd)

JUL 7 1995

12.1 Peace Valley Telephone Company (Cont'd)

**MISSOURI
Public Service Commission**

12.1.5 Miscellaneous Services

	Basic time, scheduled working hours	Overtime, outside scheduled working hours	Tariff Section Reference
(A) Additional Engineering Periods			
Per engineer, 1/2 hour or fraction thereof,	\$17.32	\$20.55	9.1
(B) Additional Labor			
Per technician, 1/2 hour or fraction thereof,	\$14.15	\$19.05	9.2
(C) Maintenance of Service			
Per technician, 1/2 hour or fraction thereof,	\$14.15	\$19.05	9.3
(D) Programming Services			
Per programmer, 1/2 hour or fraction thereof,	\$28.87	\$40.04	9.3
(E) Presubscription			
Per line per request	\$5.00	NA	9.3.3
(F) Operator Transfer Service			
Per call transferred	\$0.30	NA	9.3.4

CANCELLED

OCT 16 1999

By *2nd RS #13.5*
**Public Service Commission
MISSOURI**

(N)

(N)

Issued: July 7, 1995

**Maurice Bosserman
Owner/Manager
Peace Valley, Missouri 65788**

Effective: August 7, 1995

FILED

AUG 7 1995

MO. PUBLIC SERVICE COM-

P.S.C. MO. No. 1

Peace Valley Telephone Company

Original Sheet No. 13.5
For Peace Valley, Missouri

ACCESS SERVICES TARIFF CONCURRENCE

12. Rates and Charges (Cont'd)

12.1 Peace Valley Telephone Company (Cont'd)

12.1.5 Miscellaneous Services

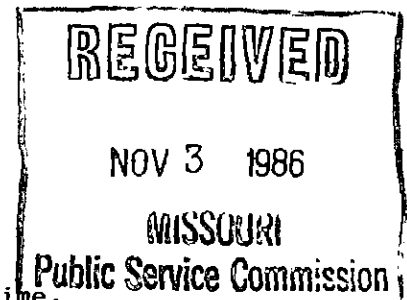

	Basic time, scheduled working hours	Overtime, outside scheduled working hours	Tariff Section Reference
(A) Additional Engineering Periods			
Per engineer, 1/2 hour or fraction thereof,	17.32	20.55	9.1
(B) Additional Labor			
Per technician, 1/2 hour or fraction thereof,	14.15	19.05	9.2
(C) Maintenance of Service			
Per technician, 1/2 hour or fraction thereof,	14.15	19.05	9.3
(D) Programming Services			
Per programmer, 1/2 hour or fraction thereof,	28.87	40.04	9.3

CANCELLED
AUG 7 1995
BY *W.R.S. #13.5*
Public Service Commission
MISSOURI

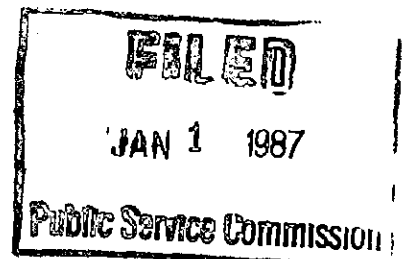

Issued: 11/3/86

Quinter Bosserman
Owner/Manager
Peace Valley, Missouri 65788

Effective: 1/1/87

P.S.C. Mo.-NO. 1

PEACE VALLEY TELEPHONE CO.

1st Revised Sheet 14
Replaces Original Sheet 14
For Peace Valley, Missouri

Rates for these services for customers in the exchanges listed below
are contained in the Long Distance Message Telecommunications Service
Tariff and the Wide Area Telecommunications Service Tariff of CONTEL
of Missouri:

Peace Valley

RECEIVED

MAY 2 1988

MISSOURI
Public Service Commission

(N)

(N)

(D)

(b)

CANCELLED

OCT 30 2000
By *2nd RS#H*
Public Service Commission
MISSOURI

FILED

JUL 1 1988
84-222 et al.
Public Service Commission

Issued: 5/2/88

Effective: 7/1/88

Issued By:

Quinter Bosserman
Owner/Manager
Highway W
Peace Valley, MO 65788

Cancelling P.S.C.MO. No. _____

Original (SHEET No. _____
Revised (

PEACE VALLEY TELEPHONE COMPANY

For _____

Peace Valley, Missouri

Name of Issuing Corporation

Community, Town or City

MESSAGE TOLL SERVICE CONCURRENCEMessage Toll Service

The Company concurs in the rates, charges and conditions governing intrastate intra-LATA Message Toll Service, as set forth in Southwestern Bell Telephone Company's tariff for such service, on file with and approved by the Public Service Commission of the State of Missouri, and in any amendments thereto and authorized by the Missouri Public Service Commission or applicable law.

Message Toll Service Cancellation Rights

The Company reserves the right to cancel and make void the above concurrence statement, subject to requirements as may be ordered by the Missouri Public Service Commission, at any and such time as it appears that such cancellation is in the best interest of the Company and/or its customers.

CANCELLED

JUL 1 1988

BY let P.S. #14

Public Service Commission

MISSOURI

*Indicates new rate or text

+Indicates change

FILED

JAN - 1 1984

84 - 62

Public Service Commission

DATE OF ISSUE December 27, 1983
month day yearDATE EFFECTIVE January 1, 1984
month day yearISSUED BY Quinter Bosserman Owner/Manager Peace Valley, Missouri
name of officer title address

Peace Valley Telephone Company

For Peace Valley, Missouri
1st Revised Sheet 15
Cancels Original Sheet 15

PRIVATE LINE TARIFF CONCURRENCE

RECEIVED

Private Line Concurrence

MAY 2 1988

The Company concurs in the rules and regulations governing intrastate intra-LATA interexchange Private Line Service as set forth in Oregon Farmers Mutual Telephone Company's tariff on file with the Missouri Public Service Commission approved by the Public Service Commission of the State of Missouri, and in any amendments thereto as authorized by the Missouri Public Service Commission or applicable law. The Company does not concur in the rates for private line service of Oregon Farmers Mutual Telephone Company. Rates for these services are set out in the following pages of this concurrence.

Private Line Cancellation Rights

The Company reserves the right to cancel and make void the above concurrence statement, in whole or in part, subject to requirements as may be ordered by the Missouri Public Service Commission, at any and such time as it appears that such cancellation is in the best interest of the Company and/or its customers.

FILED

JUL 1 1988
84-222 et al.
Public Service Commission

Issued: 5/2/88

Quinter Bosserman
Owner/Manager
Peace Valley, Missouri

Effective: 7/1/88

FORM NO. 13 . P.S.C.MO. No. 1{ Original } SHEET No. 15
{ ~~XXXXXX~~ }

Cancelling P.S.C.MO. No. _____

{ Original } SHEET No. _____
{ Revised }PEACE VALLEY TELEPHONE COMPANY
Name of Issuing CorporationFor Peace Valley, Missouri
Community, Town or City

PRIVATE LINE CONCURRENCE

RECEIVED

DEC 27 1983

Private Line

The Company concurs in the rates, charges and regulations governing intrastate intra-LATA interexchange Line Service as set forth in Southwestern Bell Telephone Company's tariff on file with and approved by the Public Service Commission of the State of Missouri, and in any amendments thereto as authorized by the Missouri Public Service Commission or applicable law.

MISSOURI
Public Service CommissionPrivate Line Cancellation Rights

The Company reserves the right to cancel and make void the above concurrence statement, in whole or in part, subject to requirements as may be ordered by the Missouri Public Service Commission, at any and such time as it appears that such cancellation is in the best interest of the Company and/or its customers.

CANCELLED

JUL 1 1988

BY 1st R.S. #15Public Service Commission
MISSOURI

FILED

JAN - 1 1984
84 - 62

Public Service Commission

*Indicates new rate or text

+Indicates change

DATE OF ISSUE December 27, 1983 DATE EFFECTIVE January 1, 1984
month day year month day yearISSUED BY Quinter Bosserman Owner/Manager Peace Valley, Missouri
name of officer title address

PEACE VALLEY TELEPHONE CO.

2nd Revised Sheet 16
Replaces 1st Revised Sheet 16
For Peace Valley, Missouri

RECEIVED

DISTANCE LEARNING COMMUNICATIONS SERVICES

MAY 5 1994

DISTANCE LEARNING COMMUNICATIONS SERVICES CONCURRENCE

MO. PUBLIC SERVICE COMM.

The Company concurs in the rules and regulations governing intrastate interexchange Distance Learning Communications Service as set forth in Oregon Farmers Mutual Telephone Company's Tariff on file with and approved by the Public Service Commission of the State of Missouri, and in any amendments thereto as authorized by the Missouri Public Service Commission or applicable law. The Company does not concur in the rates for Distance Learning Communications Service of Oregon Farmers Mutual Telephone Company. Rates for these services are set out in the following pages of this concurrence.

PROVISION OF SERVICES

The Company, to the extent that such services are or can be made available with reasonable effort, and after provisions have been made for the Company's telephone exchange services, will provide to customers, upon reasonable notice, services of the type offered in Oregon Farmers Mutual Telephone Company's Distance Learning Communications Services Tariff pursuant to the terms and conditions specified therein and at the rates specified in the following pages of this concurrence. The Company's concurrence in Oregon Farmers Mutual Telephone Company's Distance Learning Communications Services Tariff shall not be construed or deemed a representation that all services and service components described therein are available from the Company.

CANCELLATION RIGHTS

The Company reserves the right to cancel and make void the above concurrence statement, subject to requirements as may be ordered by the Missouri Public Service Commission, at any and such time as it appears that such cancellation is in the best interest of the Company and/or its customers.

FILED

JUL 19 1994

MO. PUBLIC SERVICE COMM.

Issued: May 5, 1994

Maurice Bosserman

Effective: ~~May 5, 1994~~

President

JUL 19 1994

Peace Valley, Missouri 65788

P.S.C. Mo.-NO. 1

PEACE VALLEY TELEPHONE CO.

1st Revised Sheet 16
Replaces Original Sheet 16
For Peace Valley, Missouri

RECEIVED

Held For Future Use

MAY 2 1988

MISSOURI
Public Service Commission

(D)

CANCELLED

JUL 19 1994
BY 2nd R.S. #16
Public Service Commission
MISSOURI

FILED

JUL 1 1988
84-222 et al.
Public Service Commission (D)

Issued: 5/2/88

Issued By:

Quinter Bosserman
Owner/Manager
Highway W
Peace Valley, MO 65788

Effective: 7/1/88

Cancelling P.S.C.MO. No. _____

{ Original } SHEET No. _____
{ Revised }PEACE VALLEY TELEPHONE COMPANY
Name of Issuing CorporationFor Peace Valley, Missouri
Community, Town or City

WIDE AREA TELECOMMUNICATIONS SERVICE CONCURRENCE

RECEIVED

DEC 27 1983

MISSOURI

Public Service Commission

Wide Area Telecommunications Service

The Company concurs in the rates, charges and regulations governing intrastate Wide Area Telecommunications Service, as set forth in Southwestern Bell Telephone Company's tariff for such service, on file with and approved by the Public Service Commission of the State of Missouri, and in any amendments thereto and authorized by the Missouri Public Service Commission or applicable law.

Wide Area Telecommunications Service Cancellation Rights

The Company reserves the right to cancel and make void the above concurrence statement, subject to requirements as may be ordered by the Missouri Public Service Commission, at any and such time as it appears that such cancellation is in the best interest of the Company and/or its customers.

CANCELLED

JUL 1 1988

BY let R.S. #16Public Service Commission
MISSOURI

FILED

JAN - 1 1984

84 - 62

Public Service Commission

*Indicates new rate or text

+Indicates change

DATE OF ISSUE December 27, 1983 DATE EFFECTIVE January 1, 1984
month day year month day yearISSUED BY Quinter Bosserman Owner/Manager Peace Valley, Missouri
name of officer title address

PEACE VALLEY TELEPHONE CO.

Original Sheet 16.1
For Peace Valley, Missouri

RECEIVED

MAY 5 1994

DISTANCE LEARNING COMMUNICATIONS SERVICES

MO. PUBLIC SERVICE COMM.

INDEX

SHEET

4.6	RATES AND CHARGES - DISTANCE LEARNING 1.....	16.2
4.6.1	Channels.....	16.2
4.6.2	Hubbing.....	16.2
4.6.3	Quad Split Video.....	16.2
4.6.4	Additional Services.....	16.2
4.7	RATES AND CHARGES - DISTANCE LEARNING 2.....	16.3
4.7.1	Channels.....	16.3
4.7.2	Hubbing.....	16.3
4.7.3	Quad Split Video.....	16.3
4.7.4	Additional Services.....	16.3
4.8	RATES AND CHARGES - DISTANCE LEARNING A.....	16.4
4.8.1	Channels.....	16.4
4.8.2	Hubbing.....	16.5
4.8.3	Additional Services	16.5
4.9	OTHER SERVICES.....	16.6

FILED

JUL 19 1994

MO. PUBLIC SERVICE COMM.

Issued: May 5, 1994

Maurice Bosserman

Effective: ~~May 5, 1994~~

President

JUL 19 1994

Peace Valley, Missouri 65788

PEACE VALLEY TELEPHONE CO.

Original Sheet 16.2
For Peace Valley, Missouri

RECEIVED

DISTANCE LEARNING COMMUNICATIONS SERVICES

MAY 5 1994

4.6 RATES AND CHARGES - DISTANCE LEARNING 1

MO. PUBLIC SERVICE COMM.

4.6.1 Channels

		Monthly Rate	Service Charge
A.	<u>Local Distribution Channel</u>		
1.	First 1/4 mile or fraction thereof, per channel	\$ 867.30	\$ 400.00
2.	Each additional 1/4 mile or fraction thereof, per channel	\$ 3.70	N/A
B.	<u>Interoffice Channel</u>		
1.	Interexchange Interoffice Channel -		
	Fixed (two required per interoffice channel)	\$ 29.00	\$ 267.00
	Mileage -Rate per V-H mile or fraction thereof, per channel	\$ 19.30	N/A
4.6.2	<u>Hubbing (per location)</u>	\$ 40.40	\$ 133.00
4.6.3	<u>Quad Split Video (per installation)</u>	\$4,680.50	\$1,600.00
4.6.4	<u>Additional Services</u>		
A.	Freeze Frame Video (per location)	\$ 53.30	N/A
B.	Far End Camera Control (per location)	\$ 53.30	N/A
C.	Gateway Access (per port)	\$ 23.20	\$ 53.00

FILED

JUL 19 1994

MO. PUBLIC SERVICE COMM.

Issued: May 5, 1994

Maurice Bosserman

Effective: ~~Issued 1994~~

President

JUL 19 1994

Peace Valley, Missouri 65788

PEACE VALLEY TELEPHONE CO.

Original Sheet 16.3
For Peace Valley, Missouri

RECEIVED

DISTANCE LEARNING COMMUNICATIONS SERVICES

MAY 5 1994

4.7 RATES AND CHARGES - DISTANCE LEARNING 3

		Monthly Rate	Service Charge
4.7.1	<u>Channels</u>		
A.	<u>Local Distribution Channel</u>		
1.	First 1/4 mile or fraction thereof, per channel	\$1,335.70	\$ 400.00
2.	Second through eighth 1/4 mile or fraction thereof, per channel	\$ 52.40	N/A
3.	Each additional 1/4 mile or fraction thereof, per channel	\$ 21.50	N/A
B.	<u>Interoffice Channel</u>		
1.	Interexchange Interoffice Channel -		
	Fixed (two required per interoffice channel)	\$ 98.80	\$ 267.00
	Mileage -Rate per V-H mile or fraction thereof, per channel	\$ 57.60	N/A
4.7.2	<u>Hubbing (per location)</u>	\$ 200.70	\$ 133.00
4.7.3	<u>Quad Split Video (per installation)</u>	\$2,465.60	\$1,600.00
4.7.4	<u>Additional Services</u>		
A.	Freeze Frame Video (per location)	\$ 53.30	N/A
B.	Far End Camera Control (per location)	\$ 53.30	N/A
C.	Gateway Access (per port)	\$ 52.50	\$ 53.00

FILED

JUL 19 1994

MO. PUBLIC SERVICE COMM.

Issued: May 5, 1994

Maurice Bosserman
President
Peace Valley, Missouri 65788Effective: June 1, 1994
JUL 19 1994

PEACE VALLEY TELEPHONE CO.

1st Revised Sheet 16.4
 Cancels Original Sheet 16.4
 For Peace Valley, Missouri

RECEIVED

DISTANCE LEARNING COMMUNICATIONS SERVICES

OCT 12 1994

4.8 RATES AND CHARGES - DISTANCE LEARNING A

Monthly
Rate

MO. PUBLIC SERVICE COMM.
 Service
Charge

4.8.1 ChannelsA. Local Distribution Channel

1.	First 1/4 mile or fraction thereof, per channel	\$ 524.10	\$ 800.00
2.	Second through eighth 1/4 mile or fraction thereof, per channel	\$ 52.40	N/A
3.	Each additional 1/4 mile or fraction thereof, per channel	\$ 21.50	N/A
4.	Channels Received, per channel received	\$ 98.80	N/A

B. Interoffice Channel

1. Interexchange Interoffice Channel -

Fixed (two
 required per interoffice
 channel)

\$ 0.00 \$ 80.00 (I)

Mileage -Rate per V-H mile or
 fraction thereof, per channel

\$ 160.30 N/A

FILED

OCT - 1 1994

MISSOURI
 Public Service Commission

Issued: September 1, 1994

Maurice Bosserman

Effective: October 1, 1994

President

Peace Valley, Missouri 65788

PEACE VALLEY TELEPHONE CO.

Original Sheet 16.4
For Peace Valley, Missouri

RECEIVED

DISTANCE LEARNING COMMUNICATIONS SERVICES

MAY 5 1994

4.8 RATES AND CHARGES - DISTANCE LEARNING A

MO. PUBLIC SERVICE COMM.

4.8.1 Channels

Monthly
Rate Service
 Charge

A. Local Distribution Channel

- | | | | |
|----|---|-----------|-----------|
| 1. | First 1/4 mile or fraction thereof, per channel | \$ 524.10 | \$ 800.00 |
| 2. | Second through eighth 1/4 mile or fraction thereof, per channel | \$ 52.40 | N/A |
| 3. | Each additional 1/4 mile or fraction thereof, per channel | \$ 21.50 | N/A |
| 4. | Channels Received, per channel received | \$ 98.80 | N/A |

B. Interoffice Channel

1. Interexchange Interoffice Channel -

Fixed (two required per interoffice channel)

\$ 0.00 \$ 0.00

Mileage -Rate per V-H mile or fraction thereof, per channel

\$ 160.30 N/A

CANCELLED

OCT 01 1994
BY 1st R.S. #16.4
Public Service Commission
MISSOURI

FILED

JUL 19 1994

MO. PUBLIC SERVICE COMM.

Issued: May 5, 1994

Maurice Bosserman
President
Peace Valley, Missouri 65788

Effective: ~~May 5, 1994~~
JUL 19 1994

P.S.C. MO. -No. 1

PEACE VALLEY TELEPHONE CO.

1st Revised Sheet 16.5
Cancels Original Sheet 16.5
For Peace Valley, Missouri

RECEIVED

DISTANCE LEARNING COMMUNICATIONS SERVICES

OCT 12 1994

4.8 RATES AND CHARGES - DISTANCE LEARNING A

	Monthly <u>Rate</u>	MO. PUBLIC SERVICE COMM. Service <u>Charge</u>	
4.8.2 <u>Hubbing (per location)</u>	\$ 551.20	\$ 267.00	
4.8.3 <u>Additional Services</u>			
A. Gateway Access			
1) Gateway Access 1 (per port)	\$ 859.00	\$ 800.00	
2) Gateway Access 3 (per port)	\$ 445.40	\$ 800.00	(T)

FILED

OCT - 1 1994

MISSOURI
Public Service Commission

Issued: September 1, 1994

Maurice Bosserman

Effective: October 1, 1994

President

Peace Valley, Missouri 65788

CANCELLED
July 11, 2015
Missouri Public
Service Commission
JI-2015-0360

P.S.C. MO. -No. 1

PEACE VALLEY TELEPHONE CO.

Original Sheet 16.5
For Peace Valley, Missouri

RECEIVED

DISTANCE LEARNING COMMUNICATIONS SERVICES

MAY 5 1994

4.8 RATES AND CHARGES - DISTANCE LEARNING A

	Monthly Rate	MO. PUBLIC SERVICE COMM. Service Charge
4.8.2 <u>Hubbing (per location)</u>	\$ 551.20	\$ 267.00
4.8.3 <u>Additional Services</u>		
A. Gateway Access		
1) Gateway Access 1 (per port)	\$ 859.00	\$ 800.00
2) Gateway Access 2 (per port)	\$ 445.40	\$ 800.00

CANCELLED

OCT 01 1994

BY 1st R.S. #16.5
Public Service Commission
MISSOURI

FILED

JUL 19 1994

MO. PUBLIC SERVICE COMM.

Issued: May 5, 1994

Maurice Bosserman
President
Peace Valley, Missouri 65788

Effective: ~~January 1, 1994~~
JUL 19 1994

PEACE VALLEY TELEPHONE CO.

Original Sheet 16.6
For Peace Valley, Missouri

RECEIVED

DISTANCE LEARNING COMMUNICATIONS SERVICES

MAY 5 1994

4.9 OTHER SERVICES

MO. PUBLIC SERVICE COMM.

A. Authorized Use in Conjunction with Lease or Rental of
Customer's Facilities

Authorized Use (per hour or fraction thereof) \$10.00

B. Discounts for Multiple-Year Periods

1. Three Years - 25%
2. Five Years - 35%
3. Ten Years - 50%

FILED

JUL 19 1994

MO. PUBLIC SERVICE COMM.

Issued: May 5, 1994

Maurice Bosserman

Effective: ~~January 1, 1994~~

President

JUL 19 1994

Peace Valley, Missouri 65788

PAYPHONE SERVICE

RECEIVED

A. General Regulations (Cont'd)

JAN 15 1997

10. Installation Charges and the appropriate NID material charge apply when a premises visit is made for the sole purpose of installing a payphone. **MISSOURI Public Service Commission**
11. The Company shall not be liable for shortages of coins collected and deposited at the subscriber's equipment. The limit of the Company's liability for end user fraud of whatever nature occurring at or in association with the subscriber's equipment shall be governed by provisions of this Tariff and rule or regulations of the Missouri Public Service Commission. In case of conflict between the tariff provisions and Commission rules and regulations, the rule or regulations shall prevail.
12. Off-Premise Extensions are not permitted.
13. Local messages from Payphones are charged at no higher than twenty-five (25) cents for each call. Upon implementation of the FCC rules preempting state regulations of payphone rates, this subsection will not apply.
14. The Multiline Business Subscriber Line Charge, found in the interstate access tariff, is applicable to all payphone Instrument and CO Implemented coin lines.

B. Responsibility of the Customer

1. The Customer for the purposes of this tariff is defined as the Payphone Service Provider.
2. The customer shall be responsible for the installation, operation and maintenance of the customer-provided instrument, plus all ancillary equipment, such as booths, shelves, lighting, directories, etc., used in connection with this service. The customer is responsible to comply with the requirements set forth in the American With Disabilities Act of 1990.

The customer-provided instrument must be registered in compliance with Part 68 of the FCC's Registration Program. In addition, the customer must comply with the Missouri Public Service Commission's Rules and Regulations regarding the use of customer-provided pay telephones.

CANCELLED

APR 15 1999
By *SR*
Public Service Commission
MISSOURI

FILED

APR 15 1997

MO.PUBLICSERVICECOMM

Issued: April 3, 1997

Maurice Bosserman
Peace Valley Telephone Co.
Peace Valley, MO 65788

Effective: April 15, 1997

PAYPHONE SERVICE

Missouri Public
Service Commission

G. Rates and Charges

REC'D MAR 11 1999

1. Exchange Access Line

<u>Description</u>	<u>Rotary Dial Access</u>	<u>Touch Tone Dial Access</u>
Instrument Implemented Payphone Service, 2-Way Service	\$5.00	\$7.50
Instrument Implemented Payphone Service, 1-Way Service	\$5.00	\$7.50
CO Implemented Coin Line	\$5.00	\$7.50

2. Features and Functions

	<u>Monthly Rate</u>	<u>NRC</u>
Answer Supervision	\$ 0.83	
Coin Collection and Return	\$ 1.38	
Special Number Assignment		\$ 5.00
Selective Class of Call Screening	\$ 2.00	

3. Held for Future Use

+

4. A "local message" from Customer Provided Payphone Service served by a given exchange, is a completed local call originating at such service and terminating at any service which may be called without a toll charge.

5. Installation Charges, as specified elsewhere in this Tariff, apply in addition to other charges specified for CO Implemented Coin Line or Instrument Implemented Payphone Service.

6. Where Custom Calling Service is desired, the charges as specified in the appropriate Sections of this Tariff are applicable for Instrument Implemented Payphone Service.

7. Rates and Charges contemplate a normal business exchange access line service installation.

CANCELLED
June 1, 2016
Missouri Public
Service Commission
JI-2016-0229

Missouri Public
Service Commission

FILED APR 15 1999

Issued: March 16, 1999

Maurice Bosserman
Peace Valley Telephone Co.
Peace Valley, MO 65788

Effective: April 15, 1999

RECEIVED

PAYPHONE SERVICE

JAN 15 1997

G. Rates and Charges

1. Exchange Access Line

Description

Rotary Dial
Access

Touch Tone
Dial Access

Instrument Implemented Payphone
Service, 2-Way Service

\$5.00

\$7.50

Instrument Implemented Payphone
Service, 1-Way Service

\$5.00

\$7.50

CO Implemented Coin Line

\$5.00

\$7.50

2. Features and Functions

Monthly Rate

NRC

Answer Supervision

\$ 0.83

Coin Collection and Return

\$ 1.38

Special Number Assignment

\$ 5.00

Selective Class of Call Screening

\$ 2.00

3. Local messages per call \$0.25

4. A "local message" from Customer Provided Payphone Service served by a given exchange, is a completed local call originating at such service and terminating at any service which may be called without a toll charge.

5. Installation Charges, as specified elsewhere in this Tariff, apply in addition to other charges specified for CO Implemented Coin Line or Instrument Implemented Payphone Service.

6. Where Custom Calling Service is desired, the charges as specified in the appropriate Sections of this Tariff are applicable for Instrument Implemented Payphone Service.

7. Rates and Charges contemplate a normal business exchange access line service installation.

CANCELLED

APR 15 1999

By *[Signature]*
Public Service Commission
MISSOURI

FILED

APR 15 1997

MO.PUBLICSERVICECOMM

Issued: April 3, 1997

Maurice Bosserman
Peace Valley Telephone Co.
Peace Valley, MO 65788

Effective: April 15, 1997