

OVERLAND

see

St. Louis District Exchange Rates

under

St. Louis

June 1, 1937

NO SUPPLEMENT TO THIS TARIFF WILL BE ISSUED EXCEPT FOR THE PURPOSE OF CANCELING THIS TARIFF.

Oak Ridge, Mo.
FIRST REVISED SHEET 1-A
REPLACING ORIGINAL SHEET 1-A

P. S. C. Mo. No. 2
SOUTHEAST MISSOURI TELEPHONE COMPANY
INITIAL RATE AREA MAP

RECEIVED
MAR 21 1950
MISSOURI
Public Service Comm.

FILED
MAR 21 1950
Case No 11742
Public Service Commission

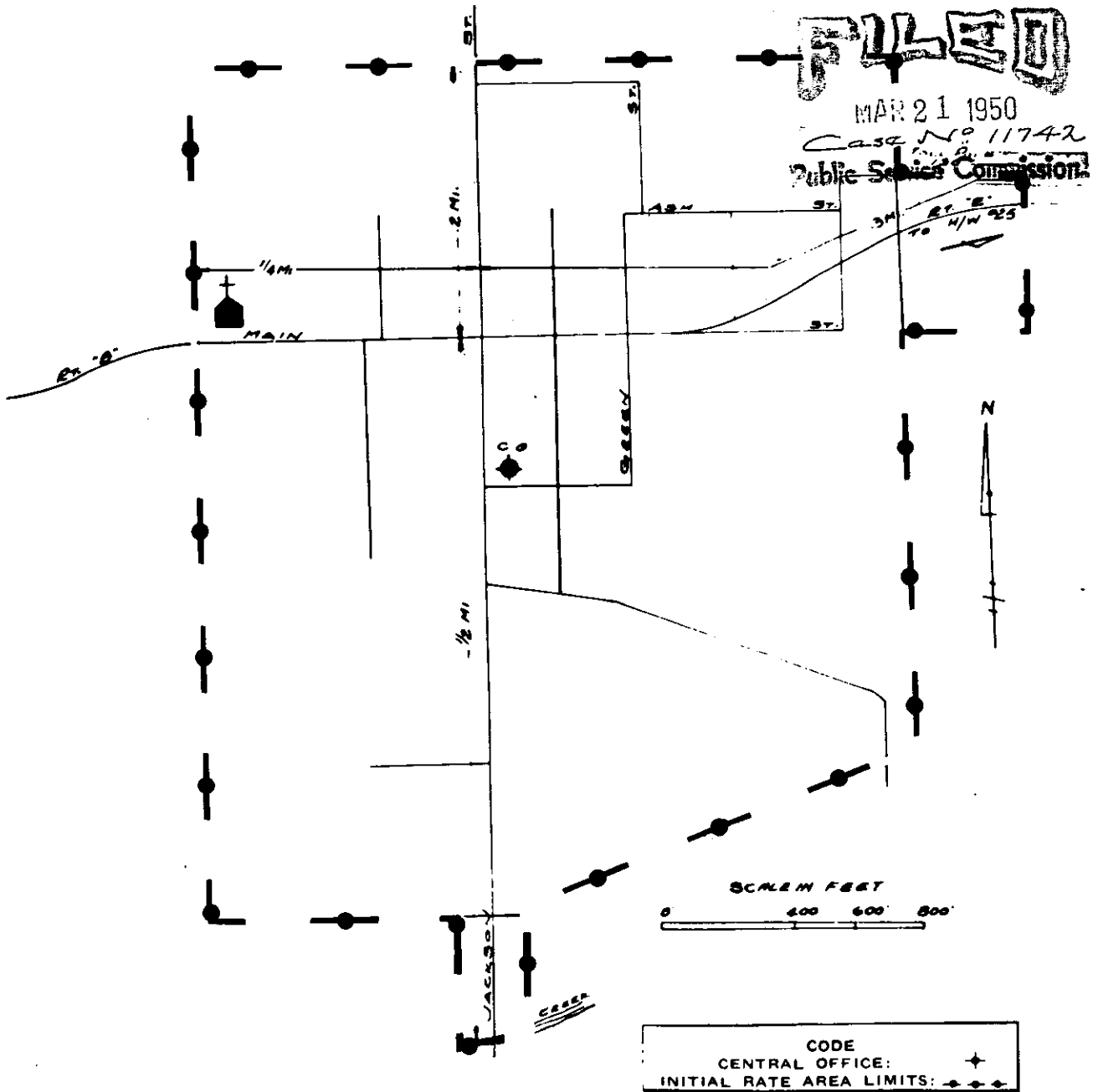

OAK RIDGE, MO.

Issued: March 20, 1950

By C. W. BOUTIN, President and General Manager
Cape Girardeau, Mo.

Effective: March 21, 1950

CANCELLED
June 29, 2007
TO-2002-185
Missouri Public
Service Commission

NO SUPPLEMENT TO THIS TARIFF WILL BE ISSUED EXCEPT FOR THE PURPOSE OF CANCELING THIS TARIFF.

P. S. C. Mo. No. 17

EXCHANGE AREA MAP

Oak Ridge, Missouri
5th REVISED SHEET 3
REPLACING 4th REVISED SHEET 3

FEB 14 1977

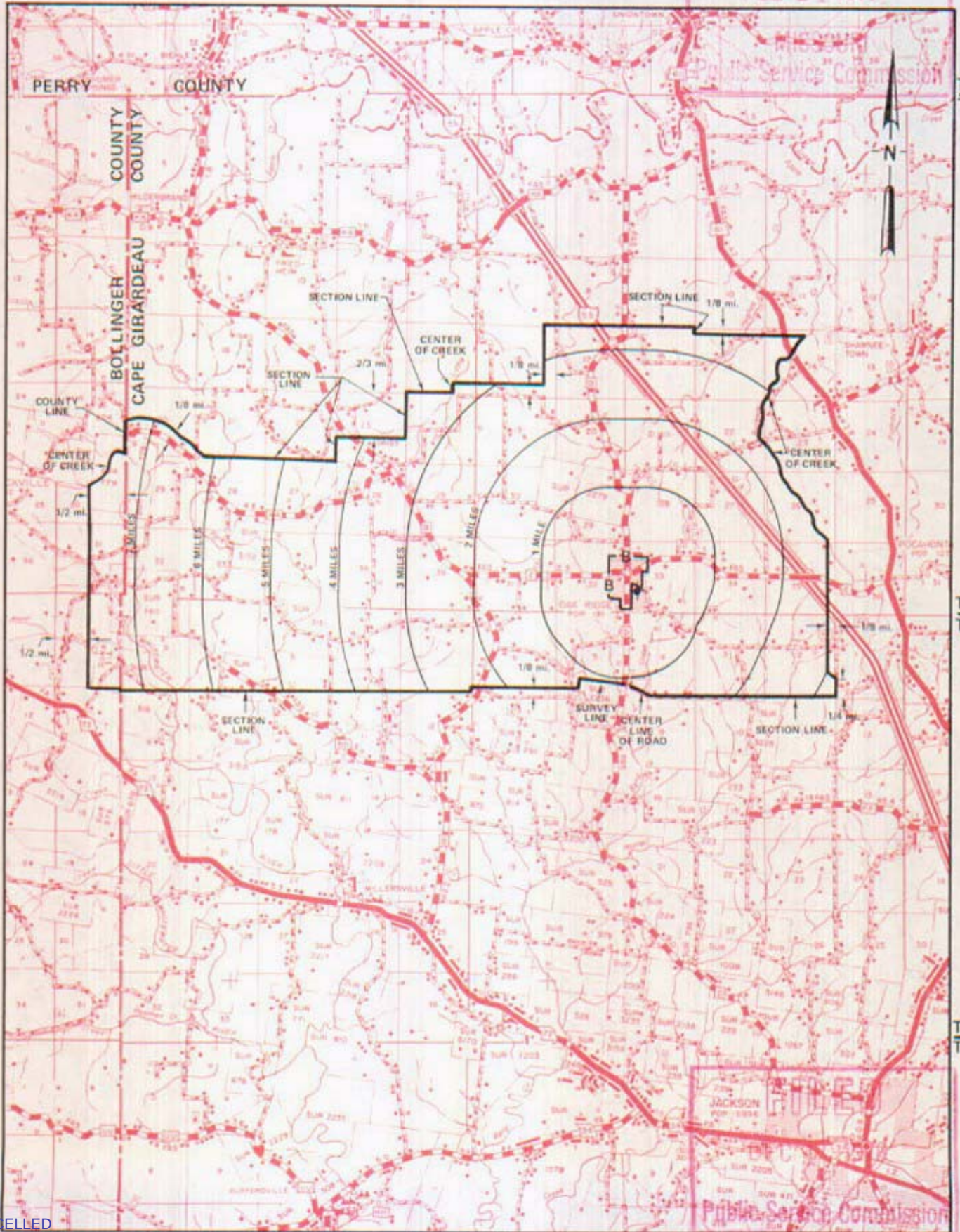

T34N
T33N

T33N
T32N

T32N
T31N

CANCELLED
June 29, 2007
TO-2002-185
Missouri Public
Service Commission

R10E | R11E

R11E | R12E

R12E | R13E

By R. R. SHOCKLEY, Vice President, Missouri
Southwestern Bell Telephone Company

DEC 1 1978

NO SUPPLEMENT TO THIS TARIFF WILL BE ISSUED EXCEPT FOR THE PURPOSE OF CANCELING THIS TARIFF.

P. S. C. Mo. No. 17

Old Appleton, Missouri

EXCHANGE AREA MAP

7th REVISED SHEET 3 REPLACING 6th REVISED SHEET 3

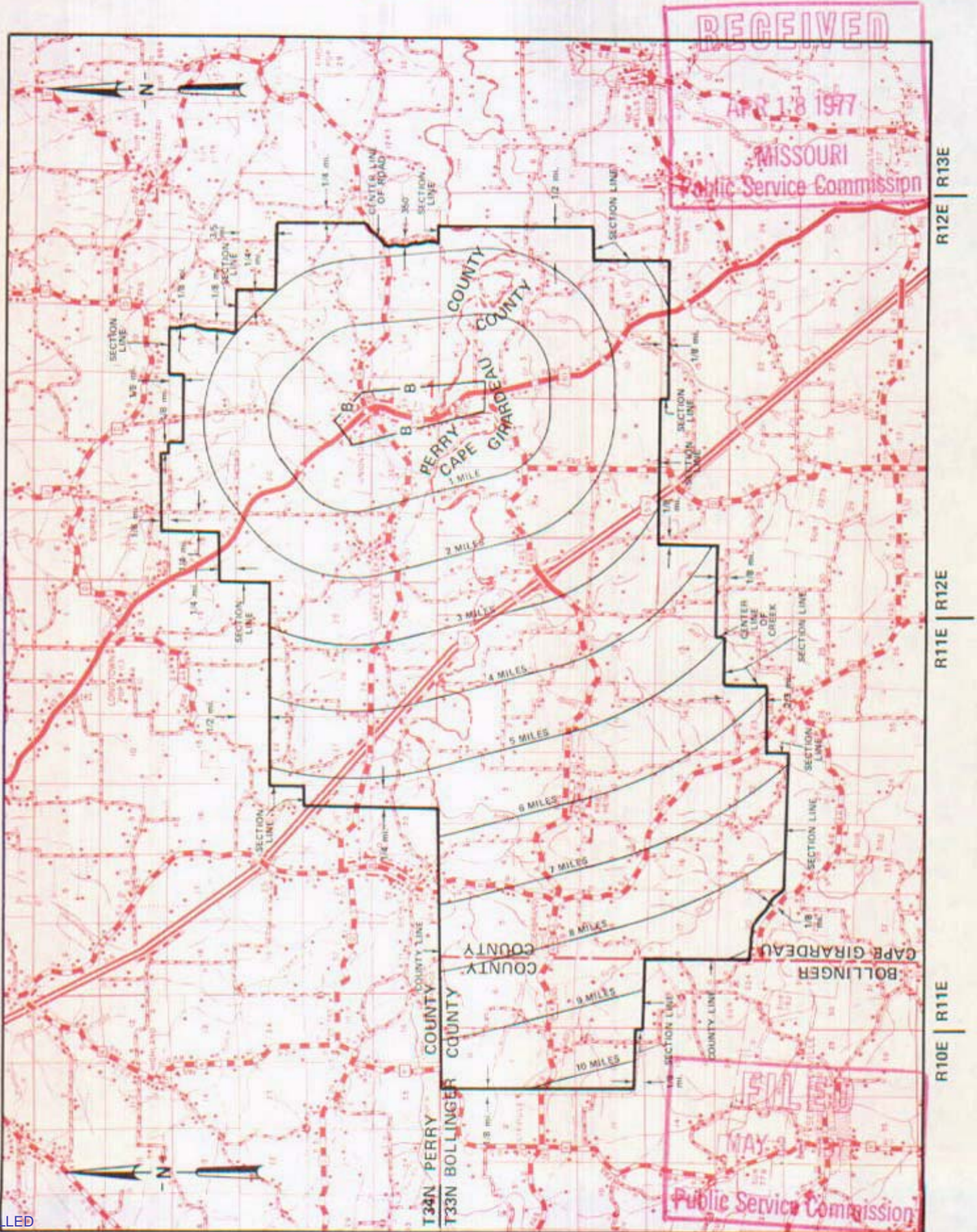

CANCELLED
June 29, 2007
TO-2002-185
Missouri Public
Service Commission

T34N

April 20, 1977

By R. R. SHOCKLEY, Vice President, Missouri
Southwestern Bell Telephone Company

SBC PSC MO #17
Oran, Missouri
Original Sheet 2
Replacing 1st Revised Sheet 1-A
Southeast Missouri Telephone Company
P.S.C. Mo. No. 2

Non-Scannable Map

**(Is viewable in the Data Center
200 Madison Street, 1st Floor
Jefferson City MO)**

EXCHANGE AREA MAP

6th REVISED SHEET 3
REPLACING 5th REVISED SHEET 3

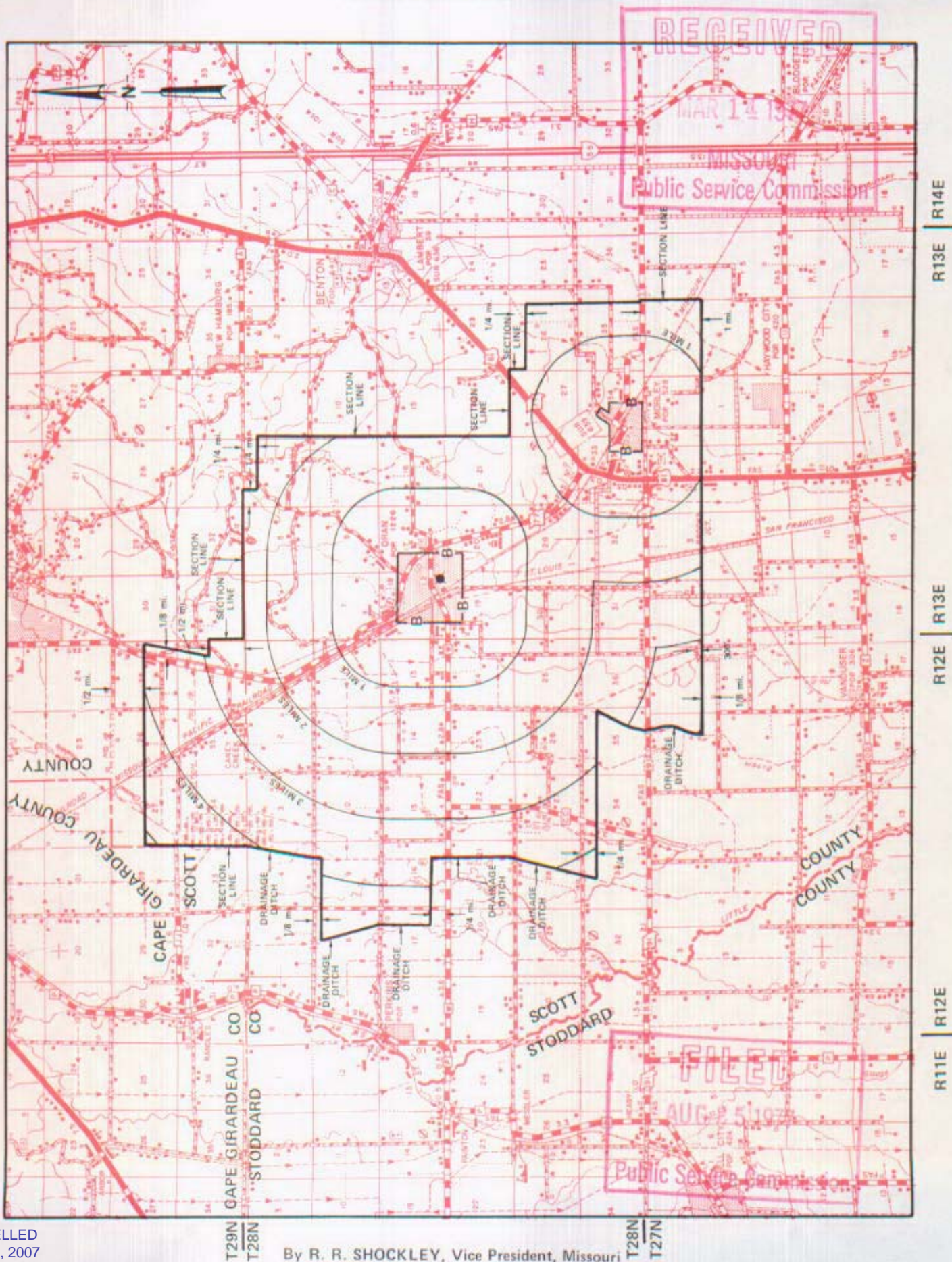

R11E R12E R13E R14E

T29N T28N T28N T27N

By R. R. SHOCKLEY, Vice President, Missouri
Southwestern Bell Telephone Company
St. Louis, Missouri

CANCELLED
June 29, 2007
TO-2002-185
Missouri Public
Service Commission
Issued: March 15, 1977

AUG 25 1977
Effective:

No supplement to this tariff will be issued except for the purpose of canceling this tariff.

P. S. C. Mo.-No. 17

OSAGE BEACH, MISSOURI
ORIGINAL SHEET 2
REPLACING 2ND REVISED SHEET 2
OF THE OZARK CENTRAL TELEPHONE COMPANY

This exchange has been consolidated with the Lake Ozark exchange. For local rates applicable to Osage Beach please refer to the Lake Ozark-Osage Beach Local Exchange Tariffs.



FILED

APR 1 - 1968

PUBLIC SERVICE COMMISSION

Issued: March 1, 1968

Effective: April 1, 1968

By R. R. SHOCKLEY, Vice President and General Manager
Southwestern Bell Telephone Company
St. Louis, Missouri

CANCELLED
June 29, 2007
TO-2002-185
Missouri Public
Service Commission

No supplement to this tariff will be issued except for the purpose of canceling this tariff.

P. S. C. Mo.-No. 17

OSAGE BEACH, MISSOURI
5TH REVISED SHEET 3
REPLACING 4TH REVISED SHEET 3

This exchange has been consolidated with the Lake Ozark exchange. For local rates applicable to Osage Beach please refer to the Lake Ozark-Osage Beach Local Exchange Tariffs.

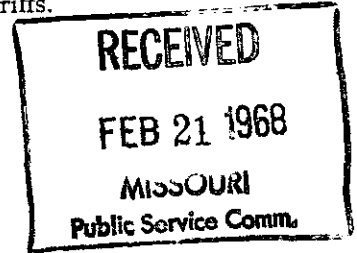

FILED

APR 1 - 1968

PUBLIC SERVICE COMMISSION

Issued: March 1, 1968

Effective: April 1, 1968

By R. R. SHOCKLEY, Vice President and General Manager
Southwestern Bell Telephone Company
St. Louis, Missouri

CANCELLED
June 29, 2007
TO-2002-185
Missouri Public
Service Commission