SECTION IV

LOCAL EXCHANGE SERVICE

GENERAL:

Unless otherwise specified the charges quoted in this tariff are for the period of one month and entitle the subscriber to telephone service and messages to all stations within the service area of the Westboro Exchange.

Extended Area Service:	Coin, Iowa Northboro, Iowa	Touch Tone <u>Access (1)</u>
Business 1-Party		\$22.00 ²
Residence 1-Party		\$22.50 ²

*

COMBINATION SERVICE: Total of individual business and individual residence service above.

LOCAL EXCHANGE SERVICE AREA: Westboro, Missouri, and Surrounding Area

A map reflecting the Exchange Service Area is on file in this office and with the Missouri Public Service Commission and is available to the public for its inspection.

(1) The above rates include Automatic Callback and Automatic Recall Custom Calling Services.

²Rates and charges shown on this tariff sheet are for informational purposes only and are not subject to the jurisdiction of the Missouri Public Service Commission.

*Indicates new rate or text
+Indicates change

Iamo Telephone Company
Name of Issuing Corporation

For All Missouri Exchanges
Community, Town or City
Atchison and Nodaway Counties

PART IV LOCAL EXCHANGE SERVICE	<p>RECEIVED</p> <p>NOV 13 1978</p> <p>MISSOURI Public Service Commission</p>
Westboro, Missouri, Exchange Area Map:	

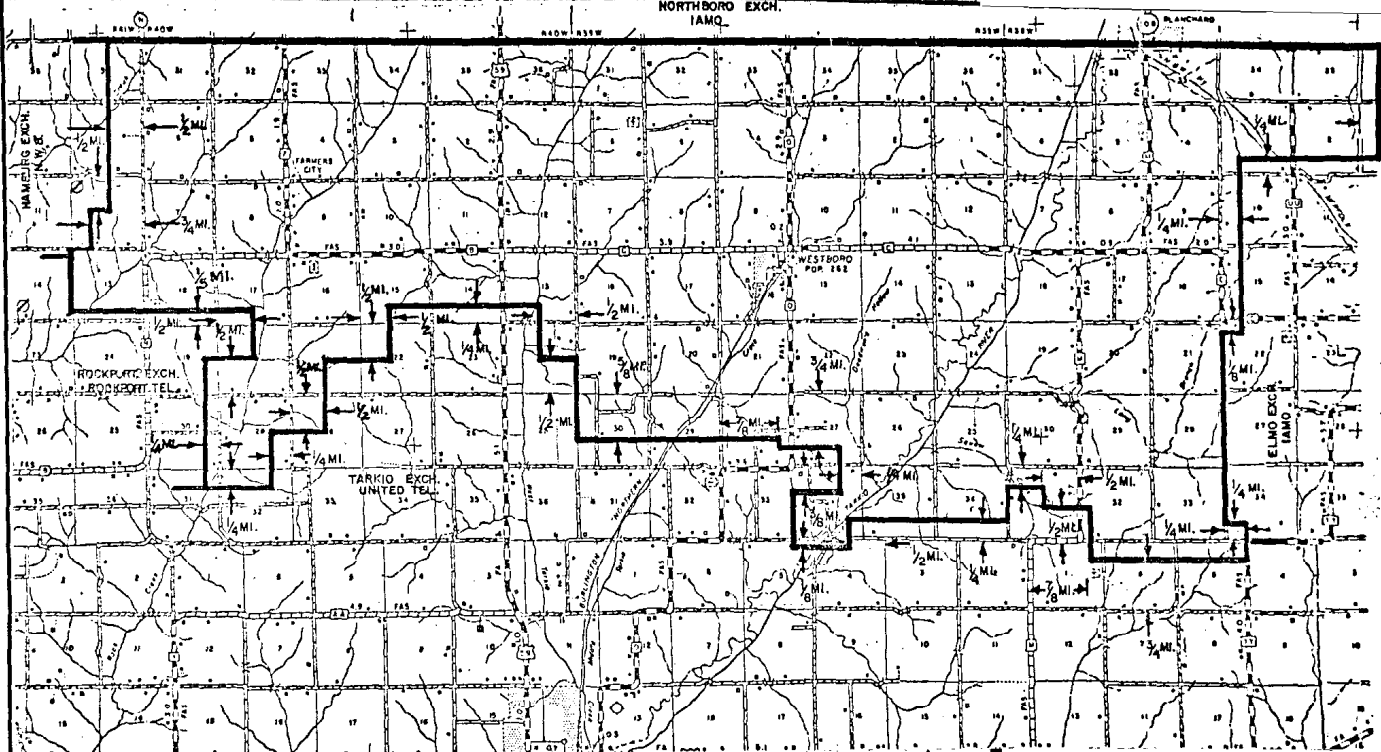

*Indicates new rate or text
+Indicates change

FILED
 JAN 1 - 1979
 Public Service Commission

DATE OF ISSUE November 1, 1978 DATE EFFECTIVE January 1, 1979
month day year month day year

ISSUED BY Junior Howard President Furlington, Mo
name of officer title address

SECTION IV

LOCAL EXCHANGE SERVICE

GENERAL:

Unless otherwise specified the charges quoted in this tariff are for the period of one month and entitle the subscriber to telephone service and messages to all stations within the service area of the Burlington Junction Exchange.

Extended Area Service: Elmo, Missouri
Clearmont, Missouri

	Touch Tone <u>Access (1)</u>
Business 1-Party	\$22.00 ²
Residence 1-Party	\$22.50 ²

*

COMBINATION SERVICE: Total of individual business and individual residence service above.

LOCAL EXCHANGE SERVICE AREA: Burlington Junction, Missouri and Surrounding Area

A map reflecting the Exchange Service Area is on file in this office and with the Missouri Public Service Commission and is available to the public for its inspection.

(1) The above rates include Automatic Callback and Automatic Recall Custom Calling Services.

²Rates and charges shown on this tariff sheet are for informational purposes only and are not subject to the jurisdiction of the Missouri Public Service Commission.

*Indicates new rate or text
+Indicates change

Iamo Telephone Company For All Missouri Exchanges
Name of Issuing Corporation Community, Town or City
Atchison and Nodaway Counties

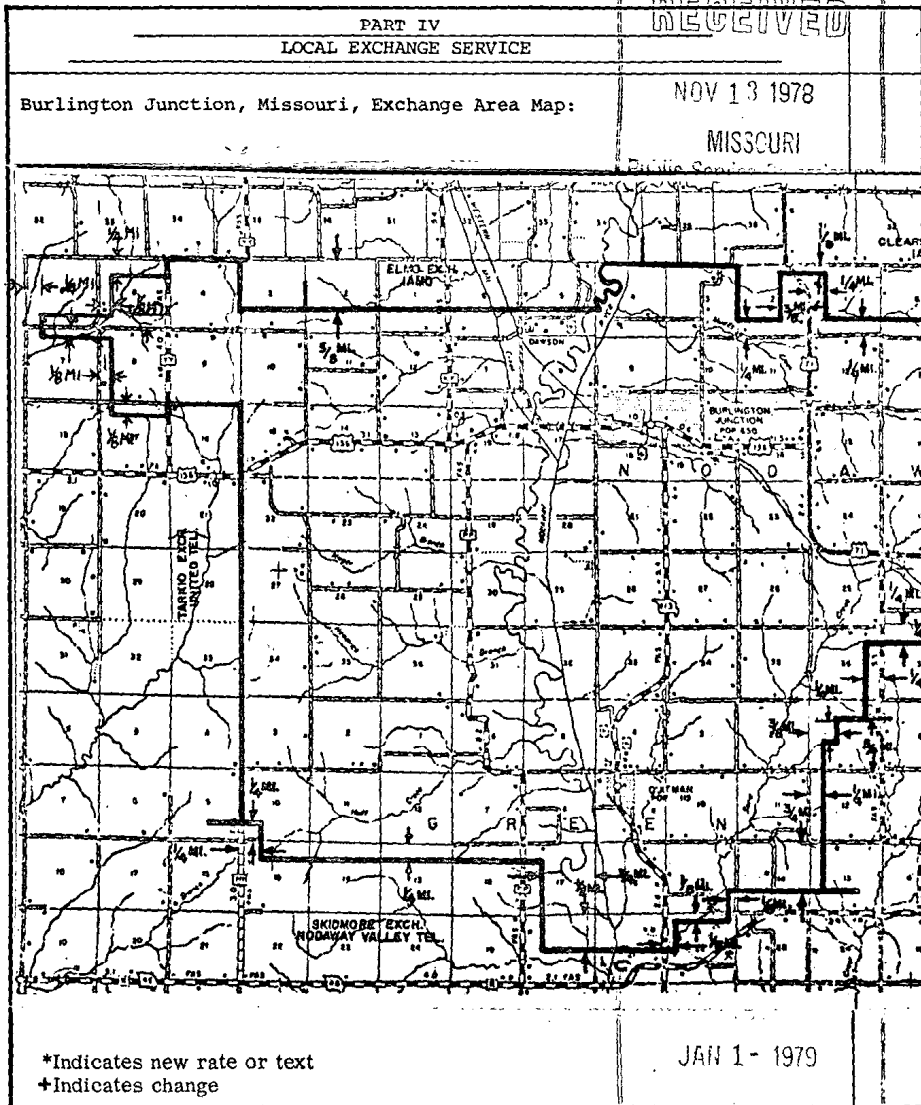

DATE OF ISSUE November 1, 1978 DATE EFFECTIVE January 1, 1979
month day year month day year

ISSUED BY James Stewart, President Burlington Jct Mo.
name of officer title address

Public Service Commission

SECTION IV

LOCAL EXCHANGE SERVICE

GENERAL:

Unless otherwise specified the charges quoted in this tariff are for the period of one month and entitle the subscriber to telephone service and messages to all stations within the service area of the Clearmont Exchange.

Extended Area Service: Elmo, Missouri
Burlington Junction, Missouri

	Touch Tone <u>Access (1)</u>
Business 1-Party	\$22.00 ²
Residence 1-Party	\$22.50 ²

*

COMBINATION SERVICE: Total of individual business and individual residence service above.

LOCAL EXCHANGE SERVICE AREA: Clearmont, Missouri and Surrounding Area

A map reflecting the Exchange Service Area is on file in this office and with the Missouri Public Service Commission and is available to the public for its inspection.

(1) The above rates include Automatic Callback and Automatic Recall Custom Calling Services.

²Rates and charges shown on this tariff sheet are for informational purposes only and are not subject to the jurisdiction of the Missouri Public Service Commission.

*Indicates new rate or text
+Indicates change

Iamo Telephone Company
Name of Issuing Corporation

For All Missouri Exchanges
Community, Town or City
Atchison and Nodaway Counties

RECEIVED

PART IV
LOCAL EXCHANGE SERVICE

NOV 13 1978

MISSOURI
Public Service Commission

Clearmont, Missouri, Exchange Area Map:

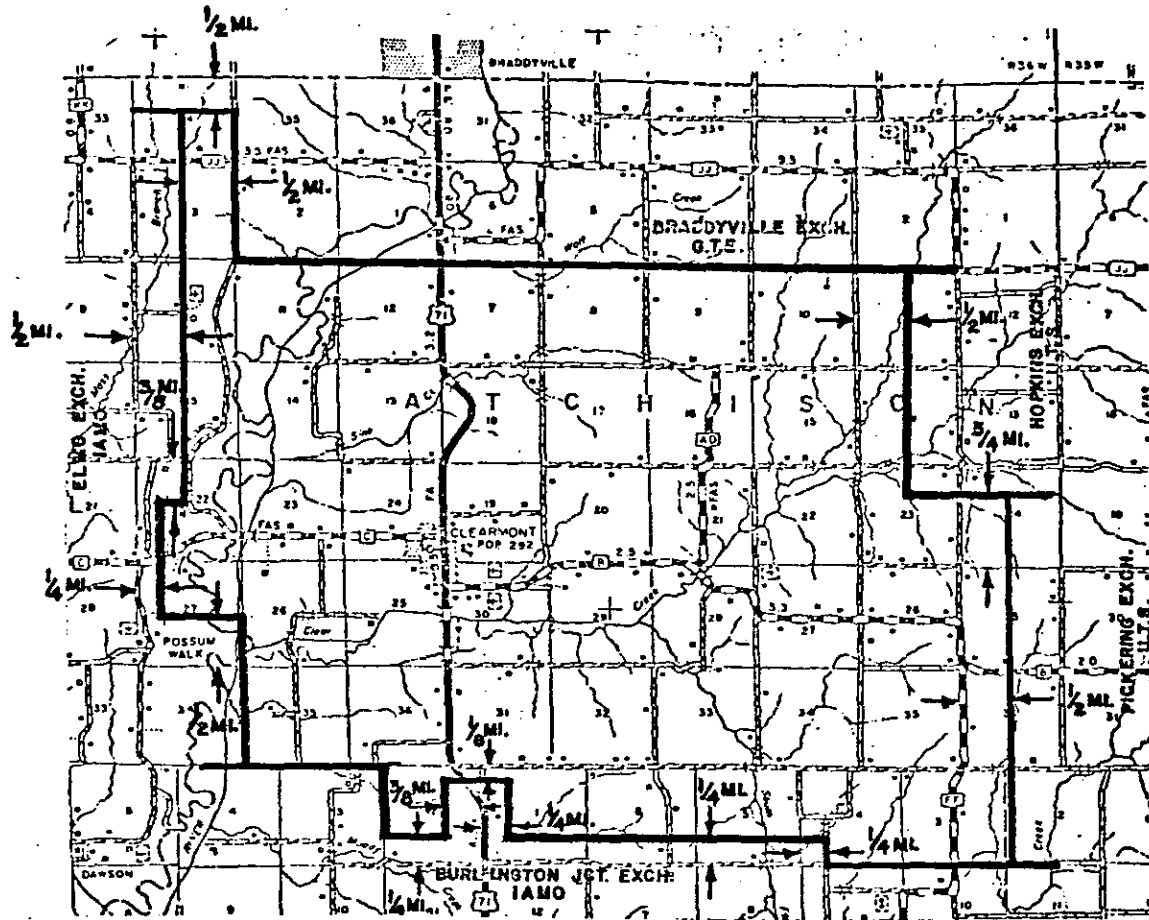

*Indicates new rate or text
+Indicates change

FILED
JAN 1 - 1979
Public Service Commission

DATE OF ISSUE November 1, 1978 DATE EFFECTIVE January 1, 1979
month day year month day year

ISSUED BY Junior Howard President Burlington Jct. Mo.
name of officer title address

SECTION IV

LOCAL EXCHANGE SERVICE

GENERAL:

Unless otherwise specified the charges quoted in this tariff are for the period of one month and entitle the subscriber to telephone service and messages to all stations within the service area of the Elmo Exchange.

Extended Area Service: Burlington Junction, Missouri
Clearmont, Missouri

	Touch Tone <u>Access (1)</u>
Business 1-Party	\$22.00 ²
Residence 1-Party	\$22.50 ²

*

COMBINATION SERVICE: Total of individual business and individual residence service above.

LOCAL EXCHANGE SERVICE AREA: Elmo, Missouri and Surrounding Area

A map reflecting the Exchange Service Area is on file in this office and with the Missouri Public Service Commission and is available to the public for its inspection.

(1) The above rates include Automatic Callback and Automatic Recall Custom Calling Services.

²Rates and charges shown on this tariff sheet are for informational purposes only and are not subject to the jurisdiction of the Missouri Public Service Commission.

*Indicates new rate or text
+Indicates change

Iamo Telephone Company For All Missouri Exchanges
Name of Issuing Corporation Community, Town or City
Atchison and Nodaway Counties

RECEIVED

PART IV
LOCAL EXCHANGE SERVICE

NOV 13 1978

Elmo, Missouri, Exchange Area Map:

MISSOURI
Public Service Commission

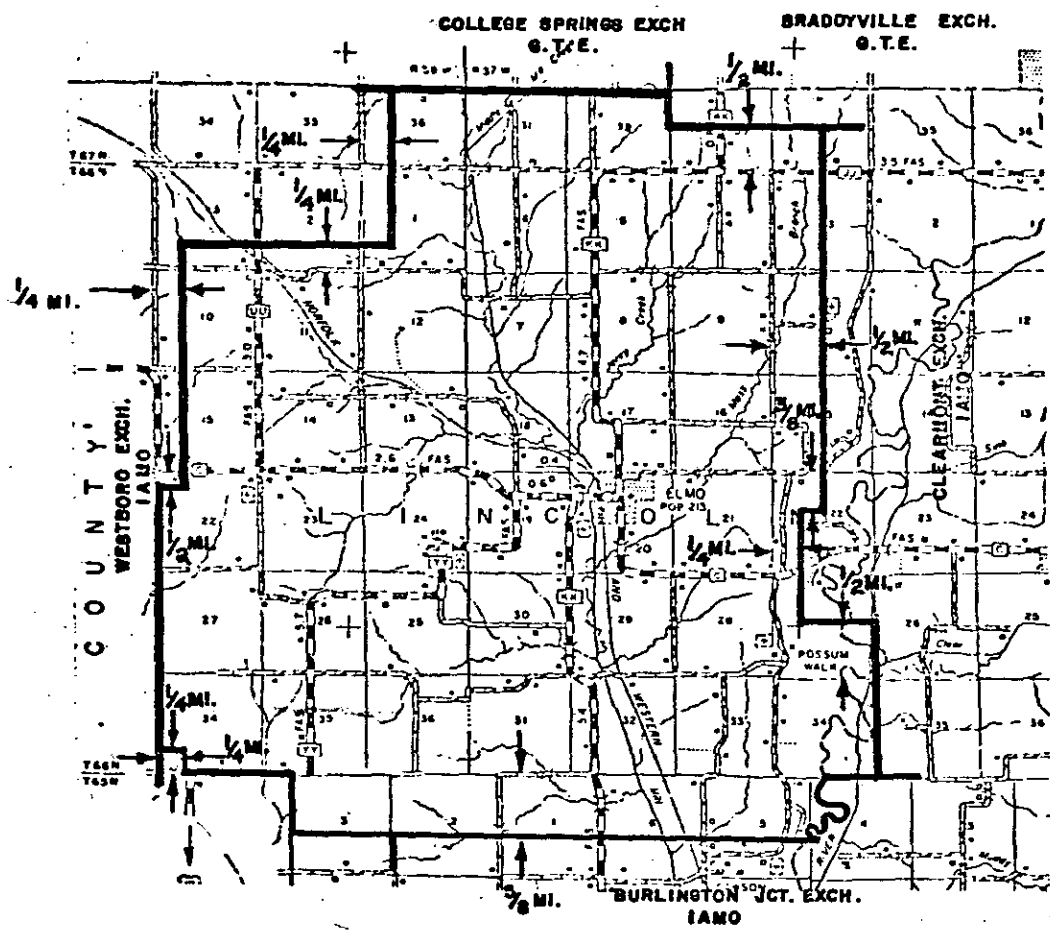

FILED
JAN 1 - 1979
Public Service Commission

*Indicates new rate or text
+Indicates change

DATE OF ISSUE November 1, 1978 DATE EFFECTIVE January 1, 1979
month day year month day year

ISSUED BY Junior Howard President Burlington Jct Mo
name of officer title address