

Spectra Communications Group, LLC #7  
Eldorado Springs Exchange  
St. Clair, Cedar & Vernon Counties  
Exchange Area Map  
Original Sheet 29

# Non-Scannable Map

(Are viewable in the Data Center  
200 Madison Street, 1<sup>st</sup> Floor  
Jefferson City MO)

Spectra Communications Group, LLC

Missouri Public Service Commission PSC MO. NO. 7  
ELLISINORE EXCHANGE  
CARTER COUNTY  
EXCHANGE AREA MAP  
RECD NOV 13 2000 ORIGINAL SHEET 30

LEGEND  
EAB \_\_\_\_\_  
ARA \_\_\_\_\_ B \_\_\_\_\_

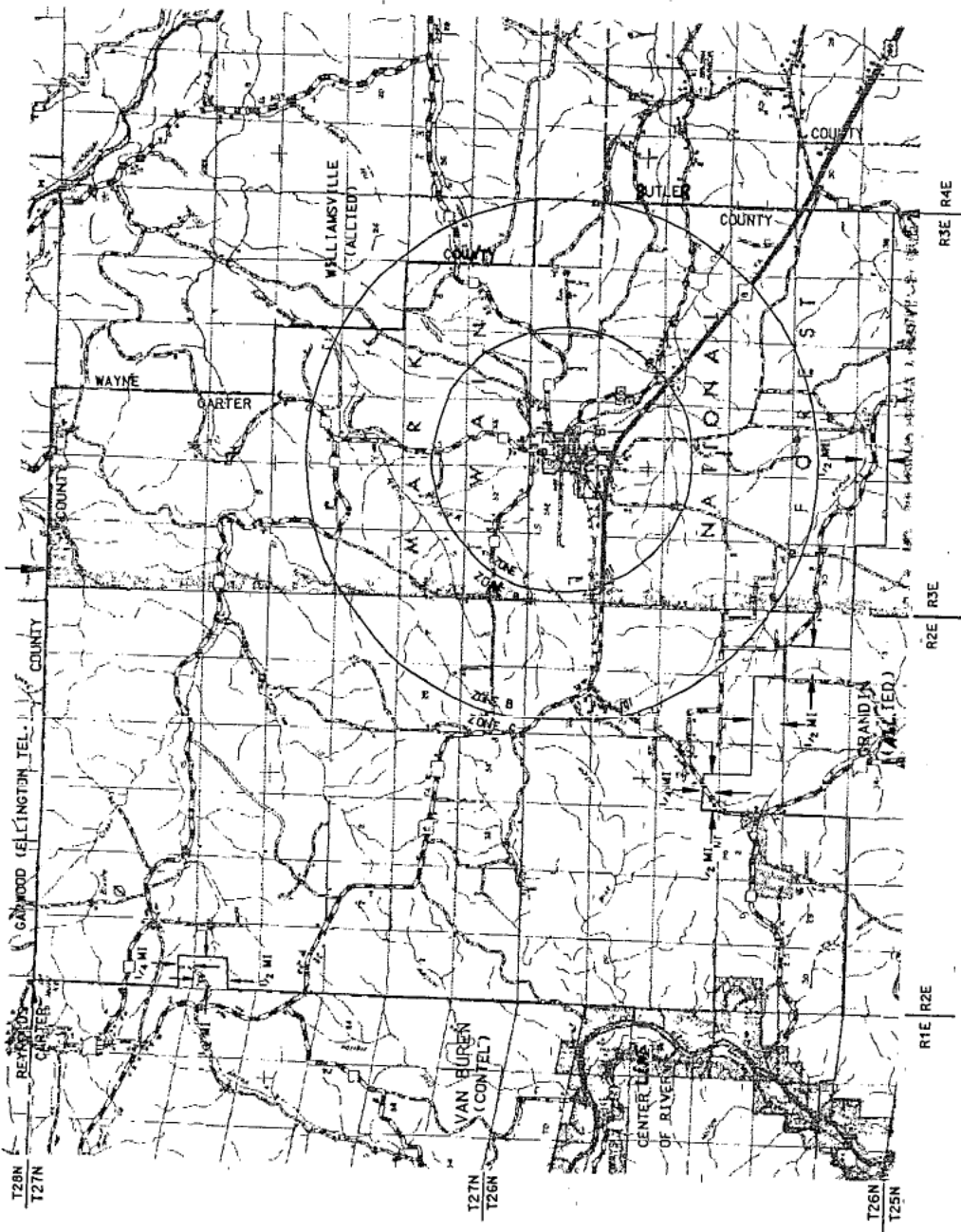

Issued: Nov. 13, 2000

Kenneth Matzdorff  
Chief Operating Officer  
Kansas City, MO

Effective: Dec. 13, 2000

Missouri Public Service Commission

FILED DEC 13 2000

ELMER EXCHANGE  
MACON COUNTY  
EXCHANGE AREA MAP

Missouri Public  
Service Commission ORIGINAL SHEET 31

EAB \_\_\_\_\_  
BRA \_\_\_\_\_ B \_\_\_\_\_

REC'D NOV 13 2000

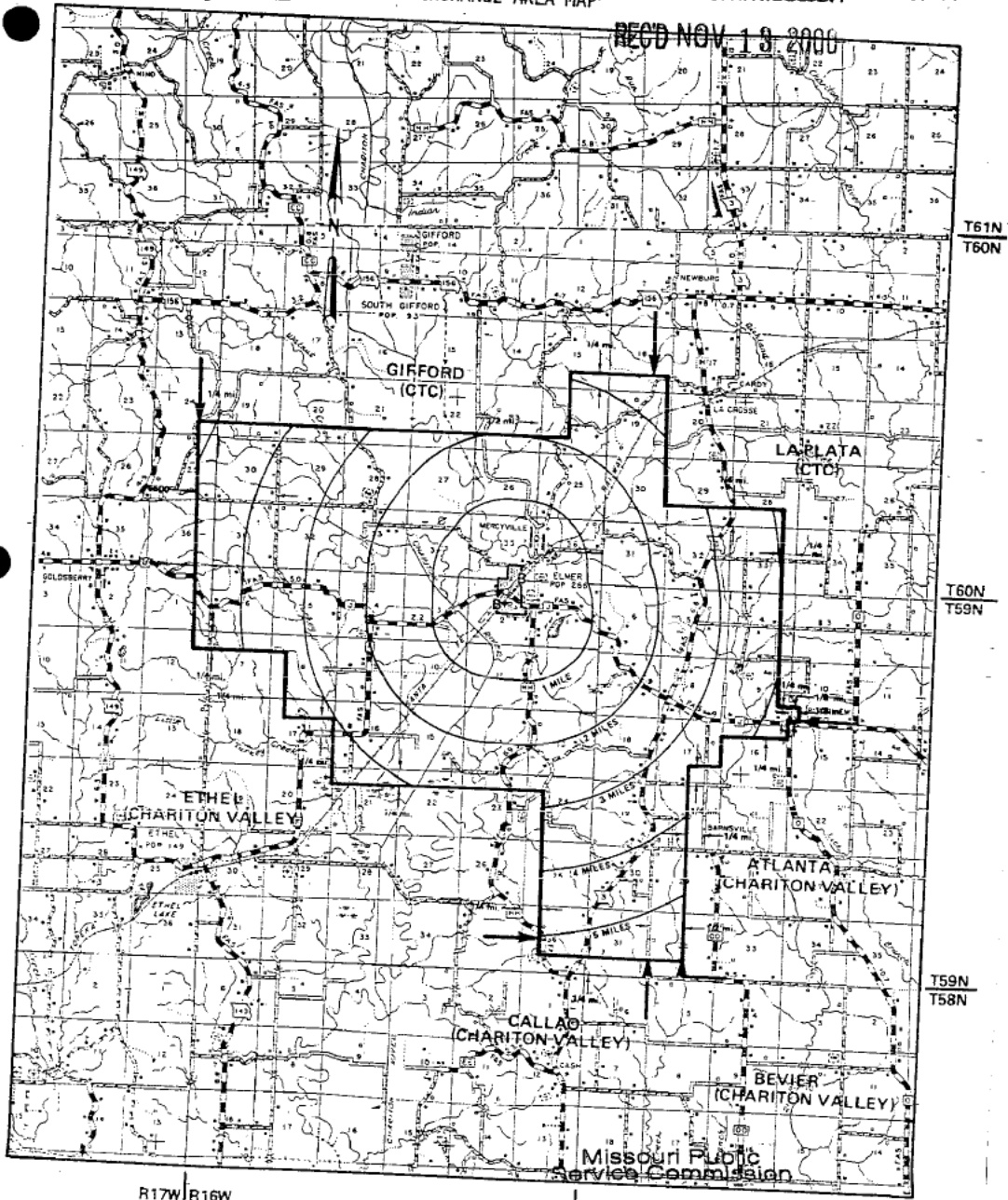

R17W | R16W

Issued: Nov. 13, 2000

Kenneth Matzdorff  
Chief Operating Officer  
Kansas City, MO

R16W | R15W  
FILED DEC 13 2000

Effective: Dec. 13, 2000

MISSOURI PUBLIC SERVICE COMMISSION  
REC'D NOV 18 2000

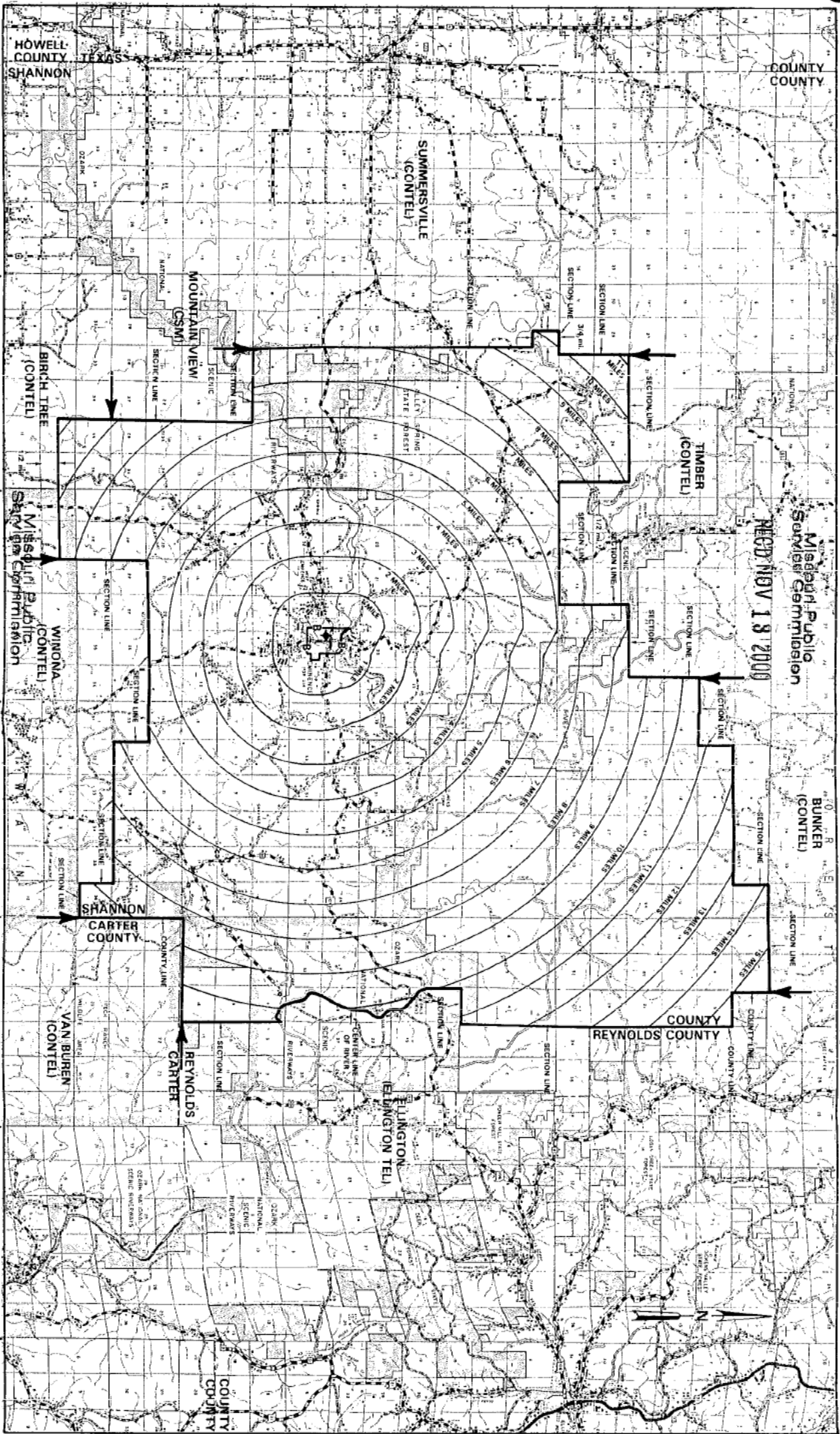

Issued: Nov. 13, 2000

Keneth Matzdorf  
Chief Operating Officer  
Kansas City, MO

MISSOURI PUBLIC SERVICE COMMISSION  
DEC 13 2000  
Effective: Dec. 13, 2000

LEGEND  
EAB \_\_\_\_\_  
BRA \_\_\_\_\_ B \_\_\_\_\_

MISSOURI PUBLIC SERVICE COMMISSION  
EVERTON EXCHANGE  
DADE & LAWRENCE COUNTIES  
EXCHANGE AREA MAP

ORIGINAL SHEET . 33

REC'D NOV 13 2000

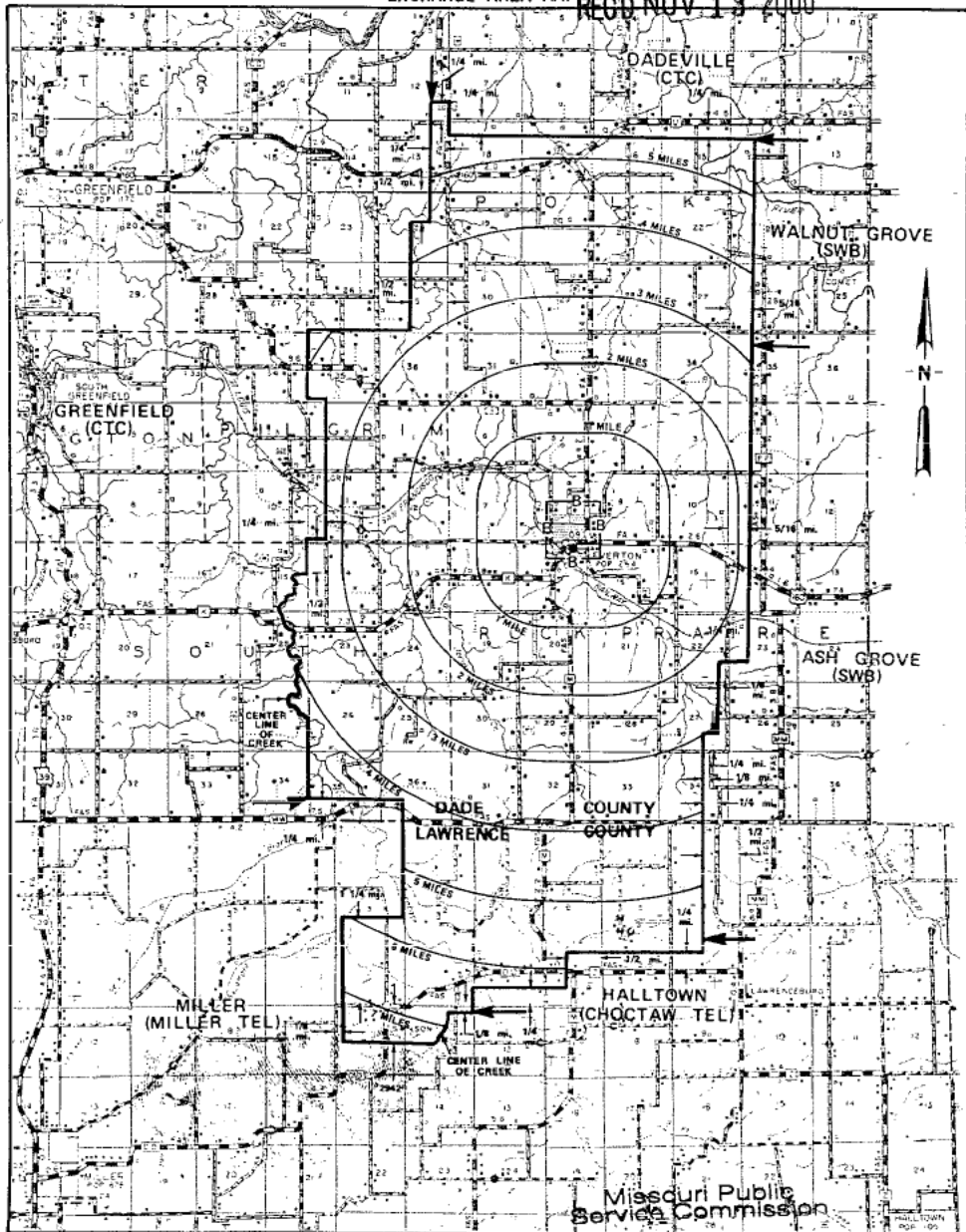

R27W R26W Kenneth Matzdorff  
Nov. 13, 2000 Chief Operating Officer  
Issued: Kansas City, MO

R26W R25W FILED DEC 13 2000

Effective: Dec. 13, 2000

LEGEND  
EAB  
BRA

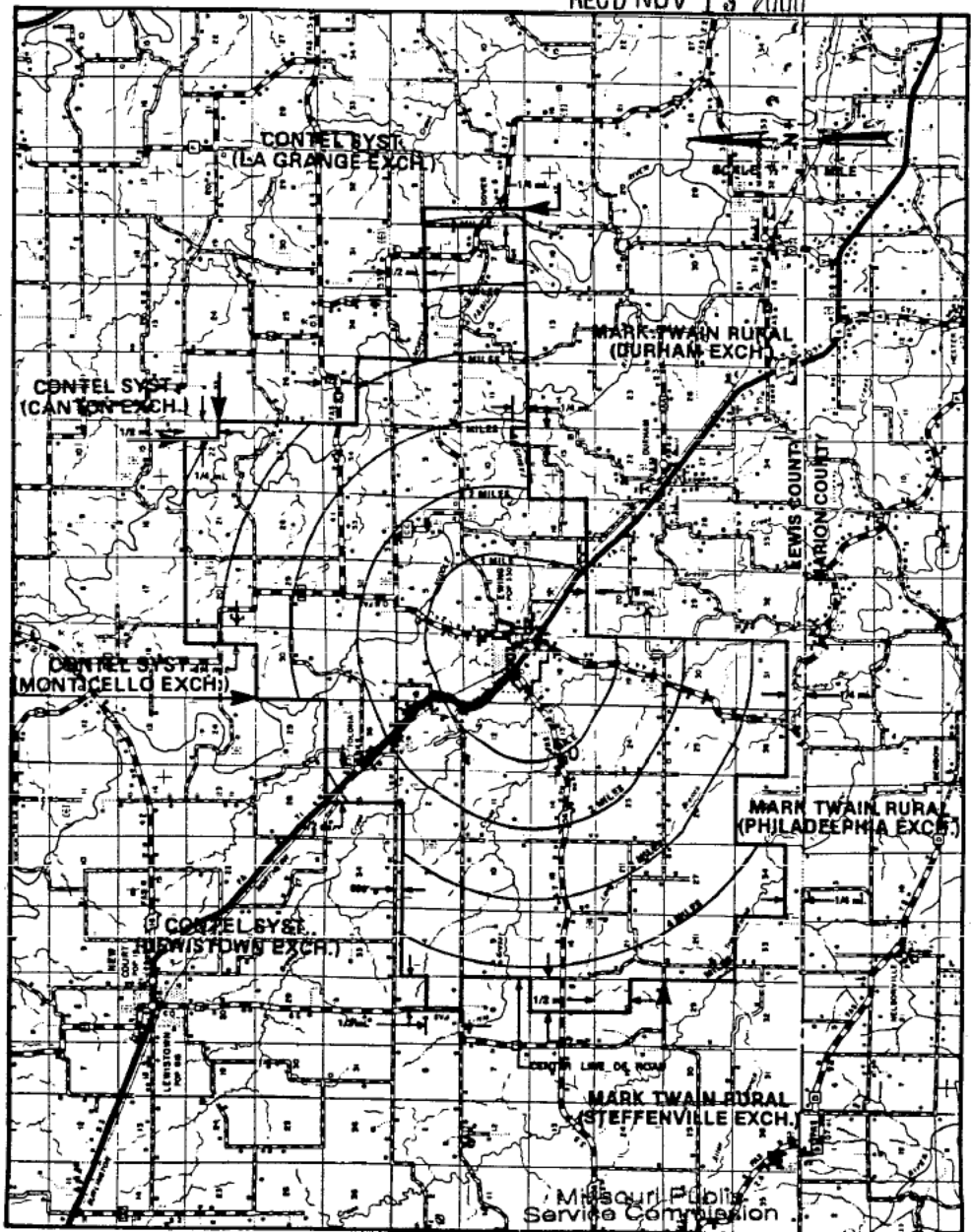

R6Y  
R7Y

R7Y  
R8Y

R8Y  
R9Y

Issued: Nov. 13, 2000

T61N T60N  
Kenneth Matzdorff  
Chief Operating Officer  
Kansas City, MO  
FILED DEC 13 2000  
T60N T59N

Effective: Dec. 13, 2000

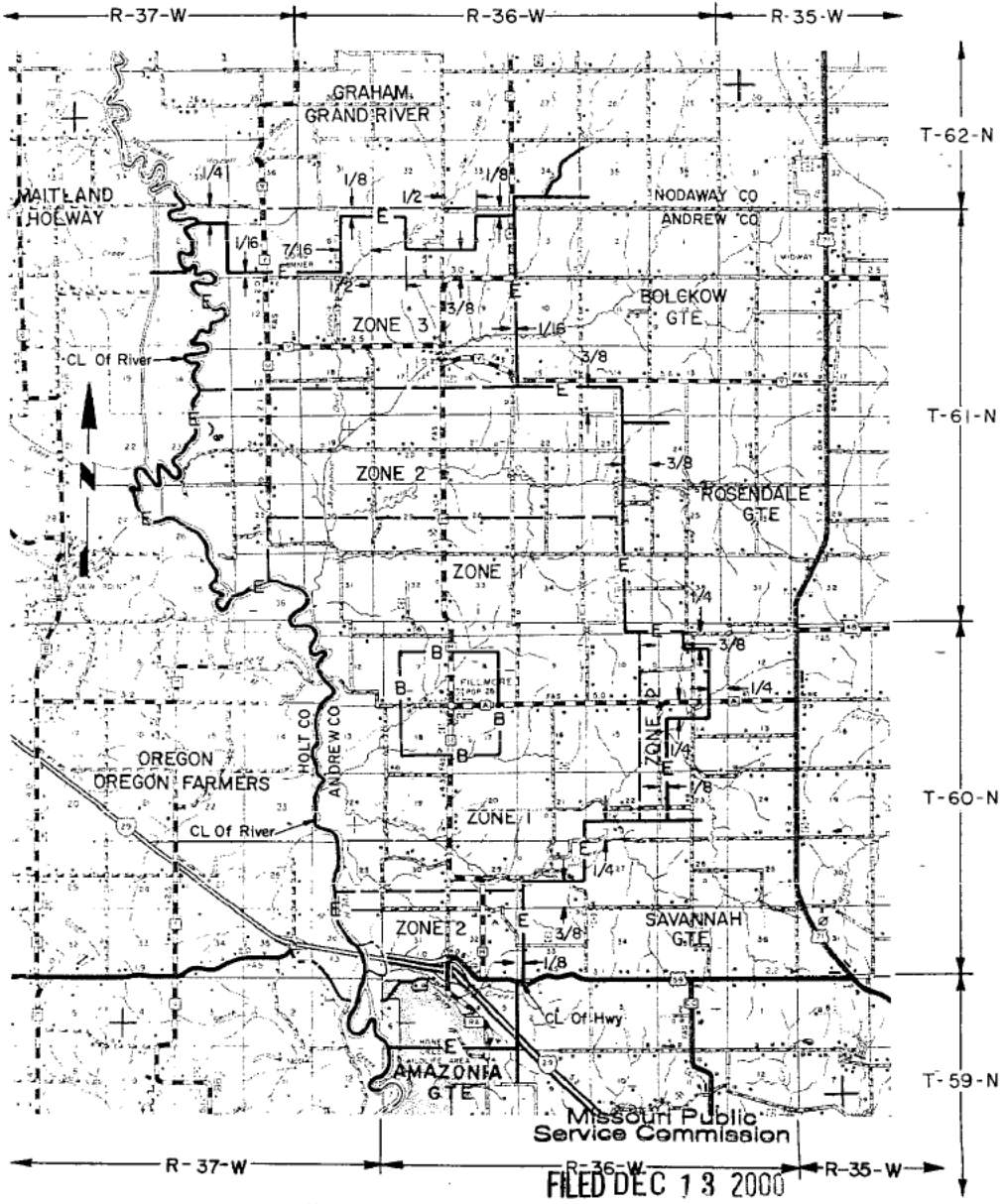
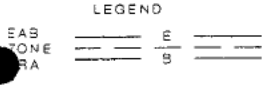

FILED DEC 13 2000

Issued: Nov. 13, 2000

Kenneth Matzdorff Chief Operating Officer Kansas City, MO

Effective: Dec. 13, 2000

FREMONT EXCHANGE  
CARTER & OREGON COUNTIES  
EXCHANGE AREA MAP

ORIGINAL SHEET 36

REC'D NOV 13 2000

LEGEND  
EAB \_\_\_\_\_  
BRA \_\_\_\_\_ B \_\_\_\_\_

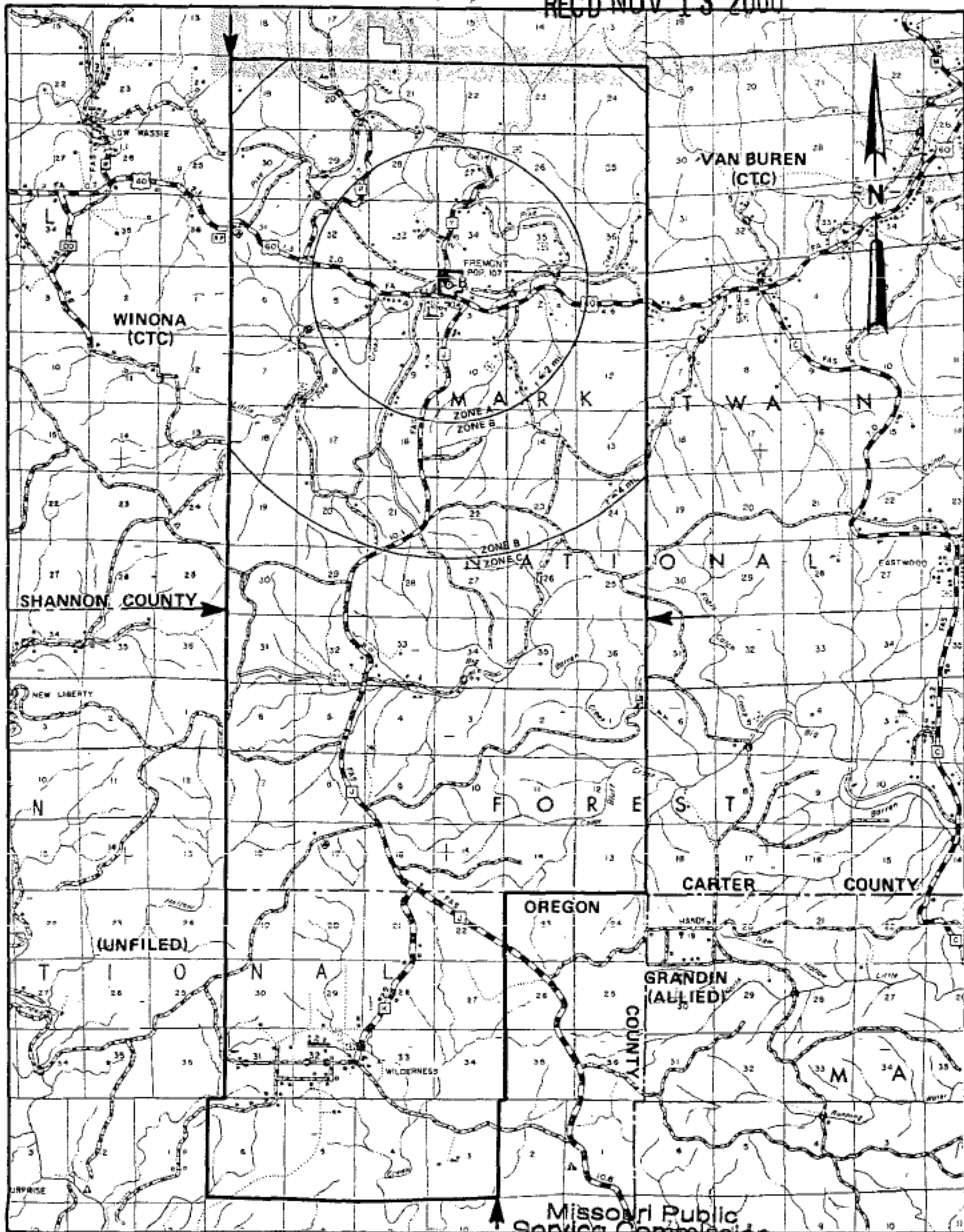

Issued: Nov. 13, 2000  
 Kenneth Matzdorff  
 Chief Operating Officer  
 Kansas City, MO

Missouri Public Service Commission  
 R2W R1W  
 FILED DEC 13 2000  
 Effective: Dec. 13, 2000



LEGEND

MISSOURI PUBLIC SERVICE COMMISSION  
PSC MO. NO. 7  
GOLDEN CITY EXCHANGE SERVICE AREA  
BARTON, DADE, JASPER & LAWRENCE COUNTIES  
ORIGINAL SHEET 37  
EXCHANGE AREA MAP RECD NOV 13 2000

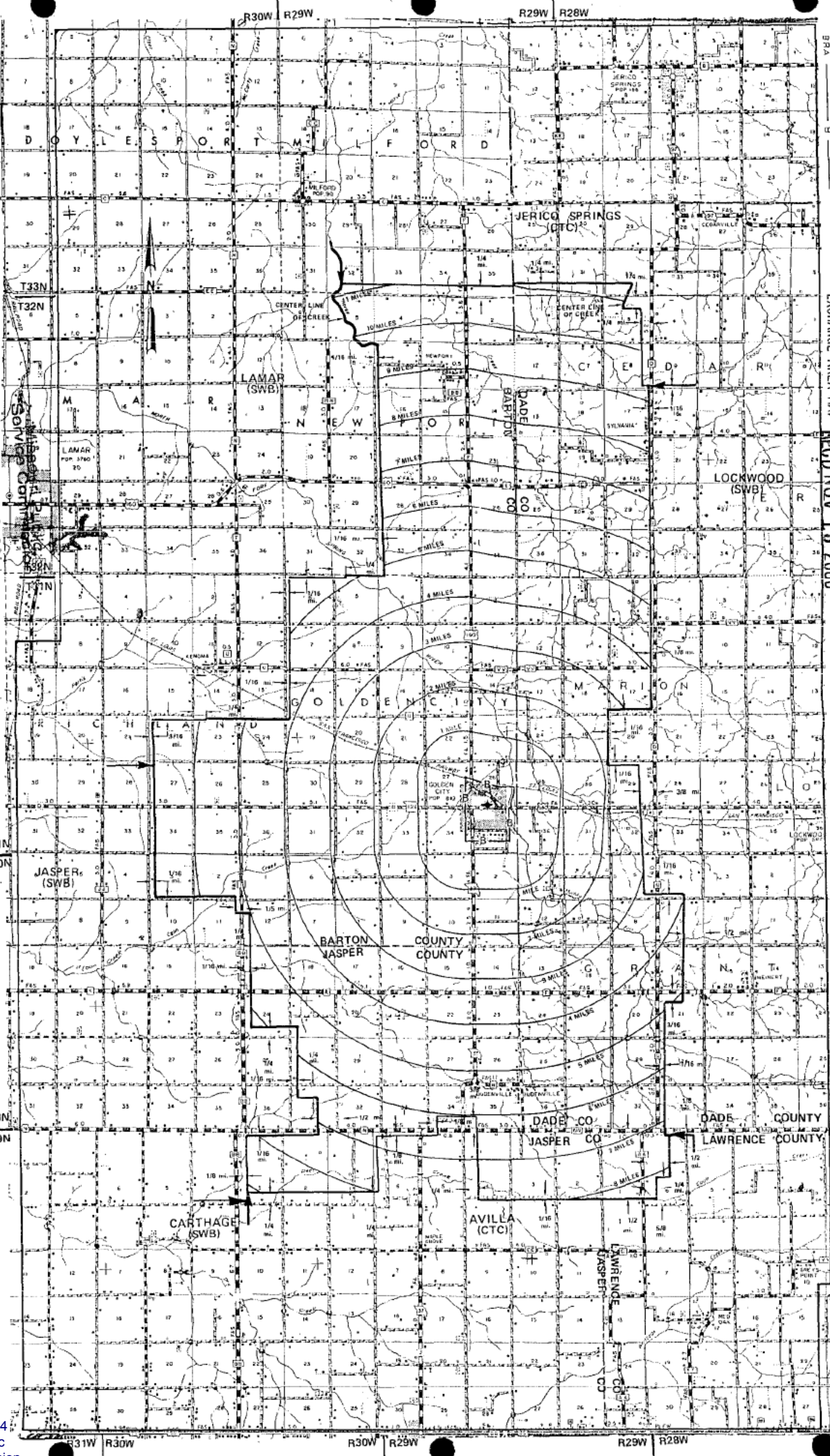

Issued: Nov. 13, 2000

Kenneth Matzdorff  
Chief Operating Officer  
Kansas City, MO  
FILED DEC 13 2000  
Effective: Dec. 13, 2000

LEGEND  
EAB \_\_\_\_\_  
BRA \_\_\_\_\_ B \_\_\_\_\_

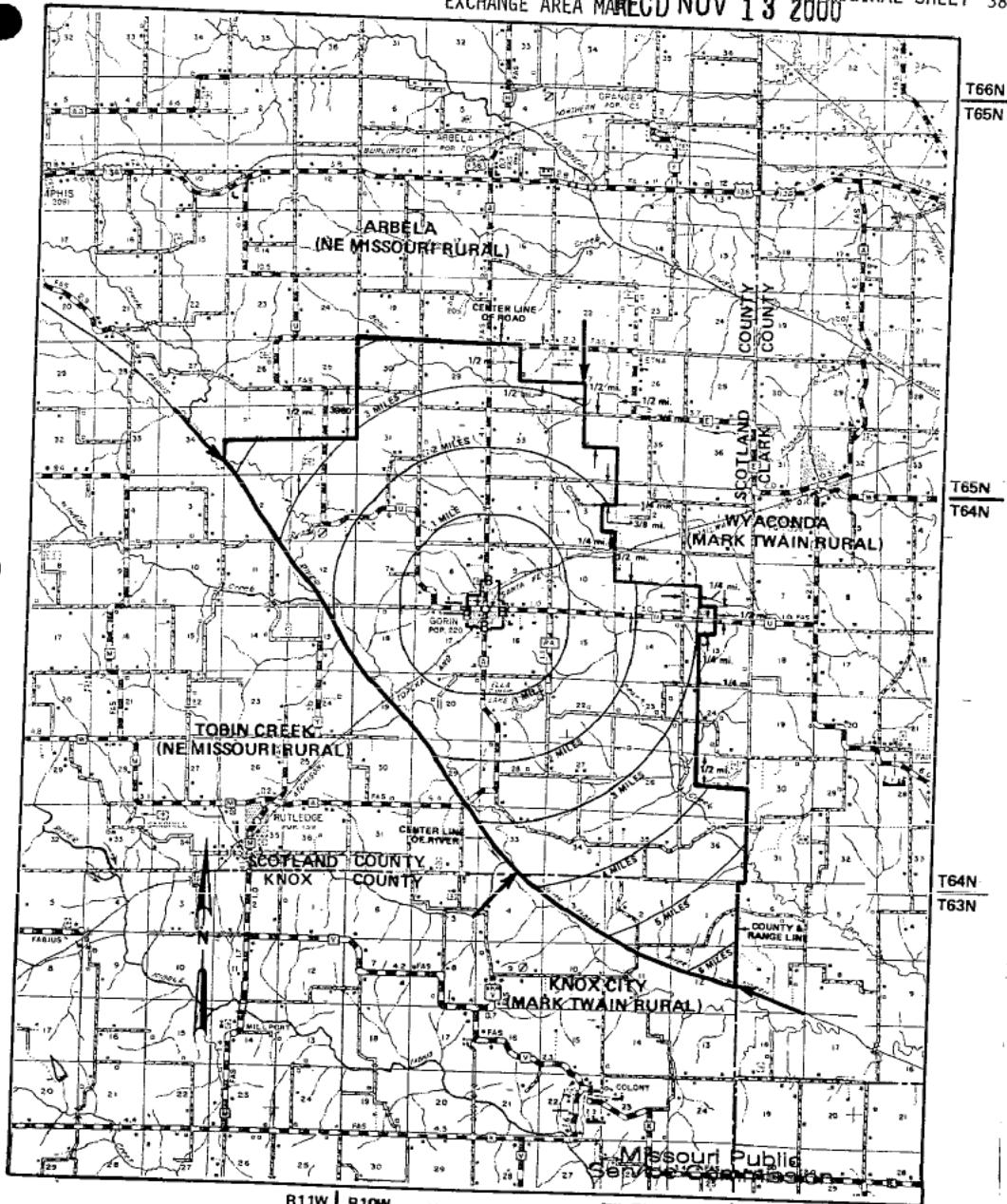

Issued: Nov. 13, 2000

R11W | R10W  
Kenneth Matzdorf  
Chief Operating Officer  
Kansas City, MO  
Missouri Public Service Commission  
FILED DEC 13 2000

Effective: Dec. 13, 2000

GOWER EXCHANGE  
CLINTON & BUCHANAN COUNTIES  
EXCHANGE AREA MAP

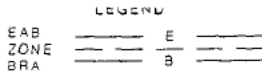

Missouri Public  
Service Commission

RECD NOV 13 2000

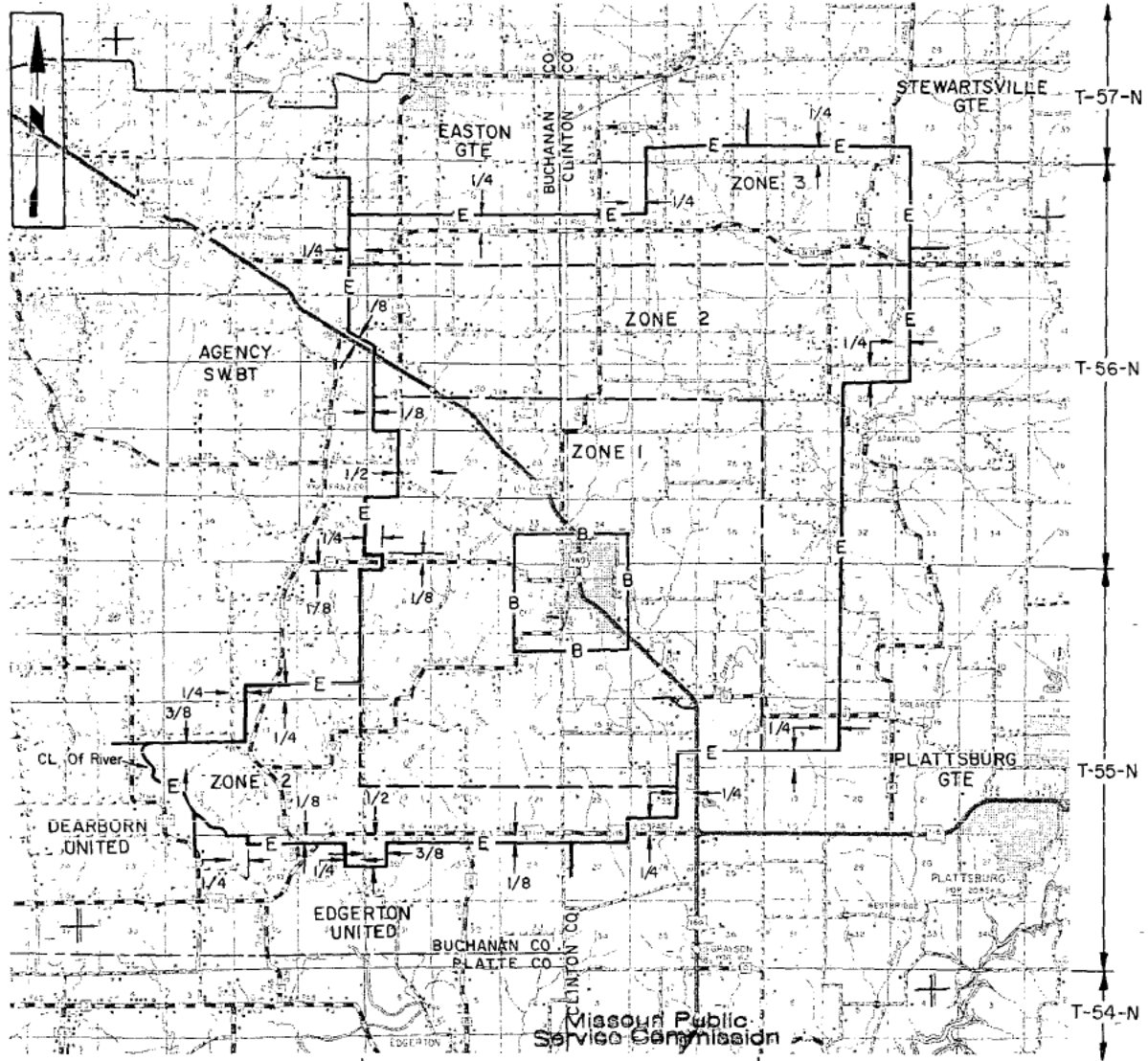

Missouri Public  
Service Commission

FILED DEC 13 2000

R-34-W      P-33-W      R-32-W

Issued: Nov. 13, 2000

Kenneth Matzdorff  
Chief Operating Officer  
Kansas City, MO

Fairs

Effective: Dec. 13, 2000

GREENFIELD EXCHANGE  
DADE COUNTY  
EXCHANGE AREA MAP

RECD NOV 13 2000

ORIGINAL SHEET 40

LEGEND

EAB \_\_\_\_\_  
BRA \_\_\_\_\_ B \_\_\_\_\_

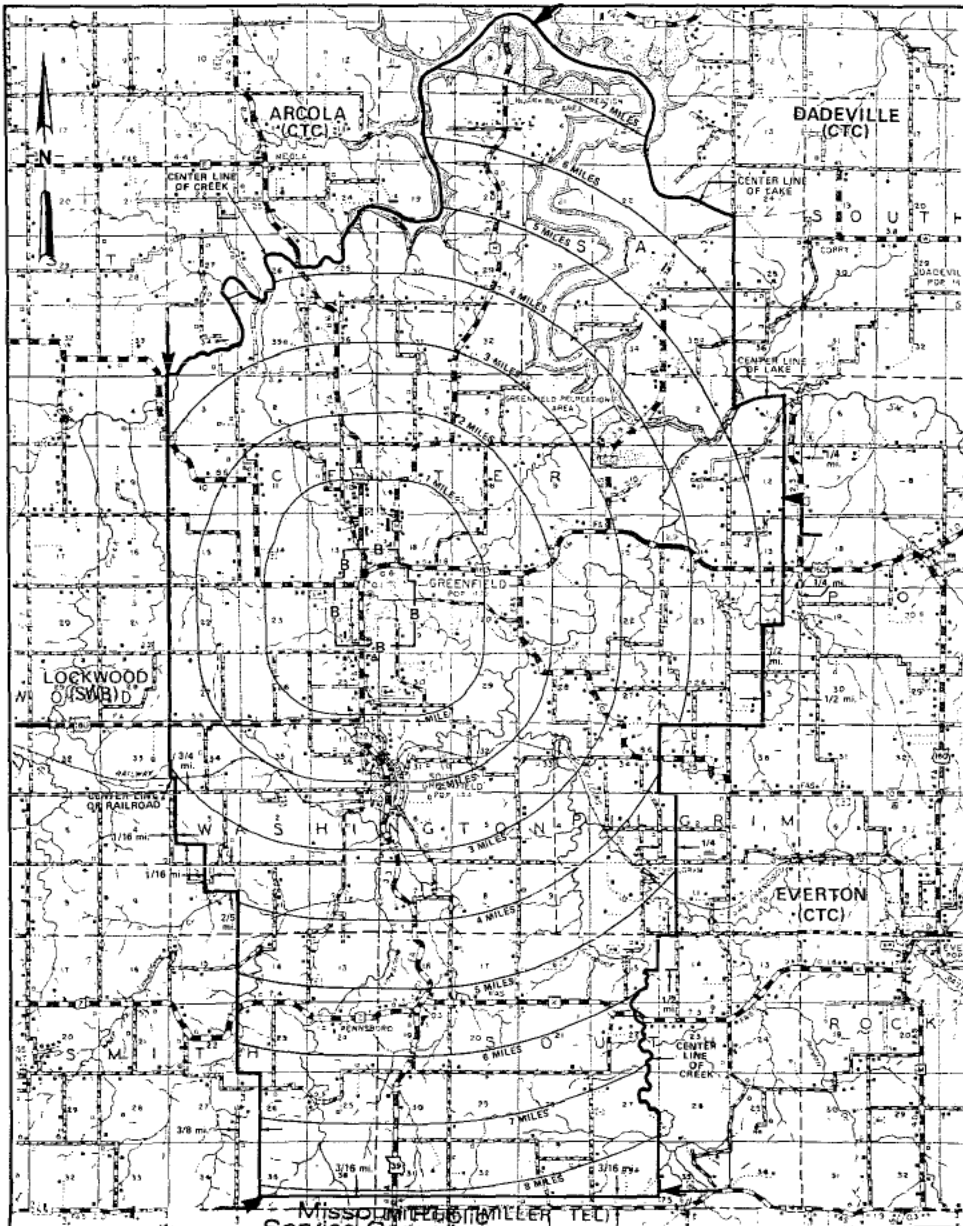

Missouri Public Service Commission

R27W | R26W

Kenneth Matzdorff

R26W | R25W

Chief Operating Officer  
Kansas City, MO

Issued: Nov. 13, 2000

FILED DEC 13 2000

Effective: Dec. 13, 2000

LEGEND  
EAB \_\_\_\_\_  
BRA \_\_\_\_\_ B \_\_\_\_\_

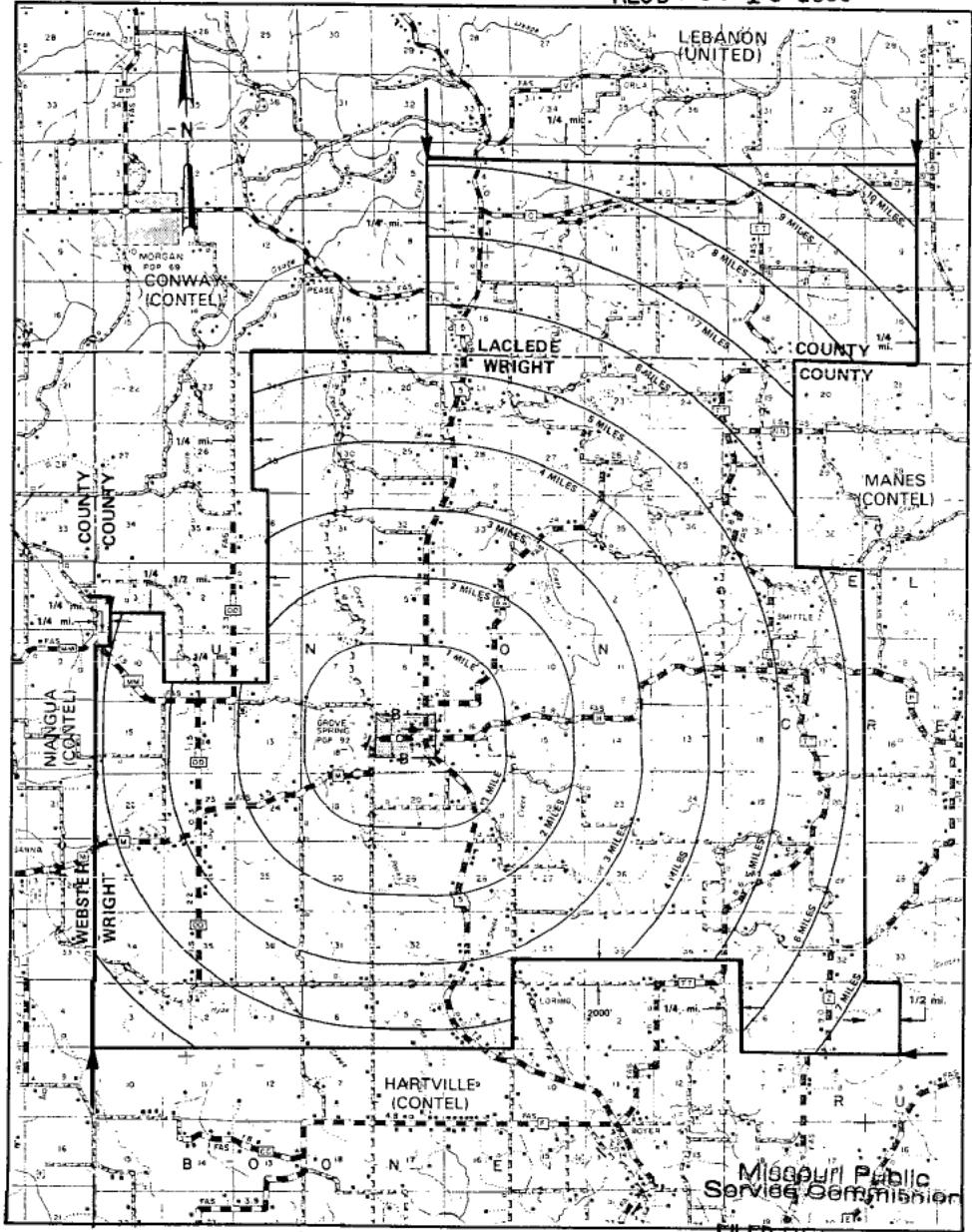

T33N  
T32N  
T32N  
T31N  
T31N  
T30N

R16W | R15W

R15W | R14W RECD DEC 10 2000

Issued: Nov. 13, 2000

Gerald D. Harris  
Regional Director - External Affairs  
Wentzville, Missouri

Effective: Dec. 13, 2000

LEGEND  
EAB \_\_\_\_\_ E \_\_\_\_\_  
ZONE \_\_\_\_\_ B \_\_\_\_\_  
BRA \_\_\_\_\_

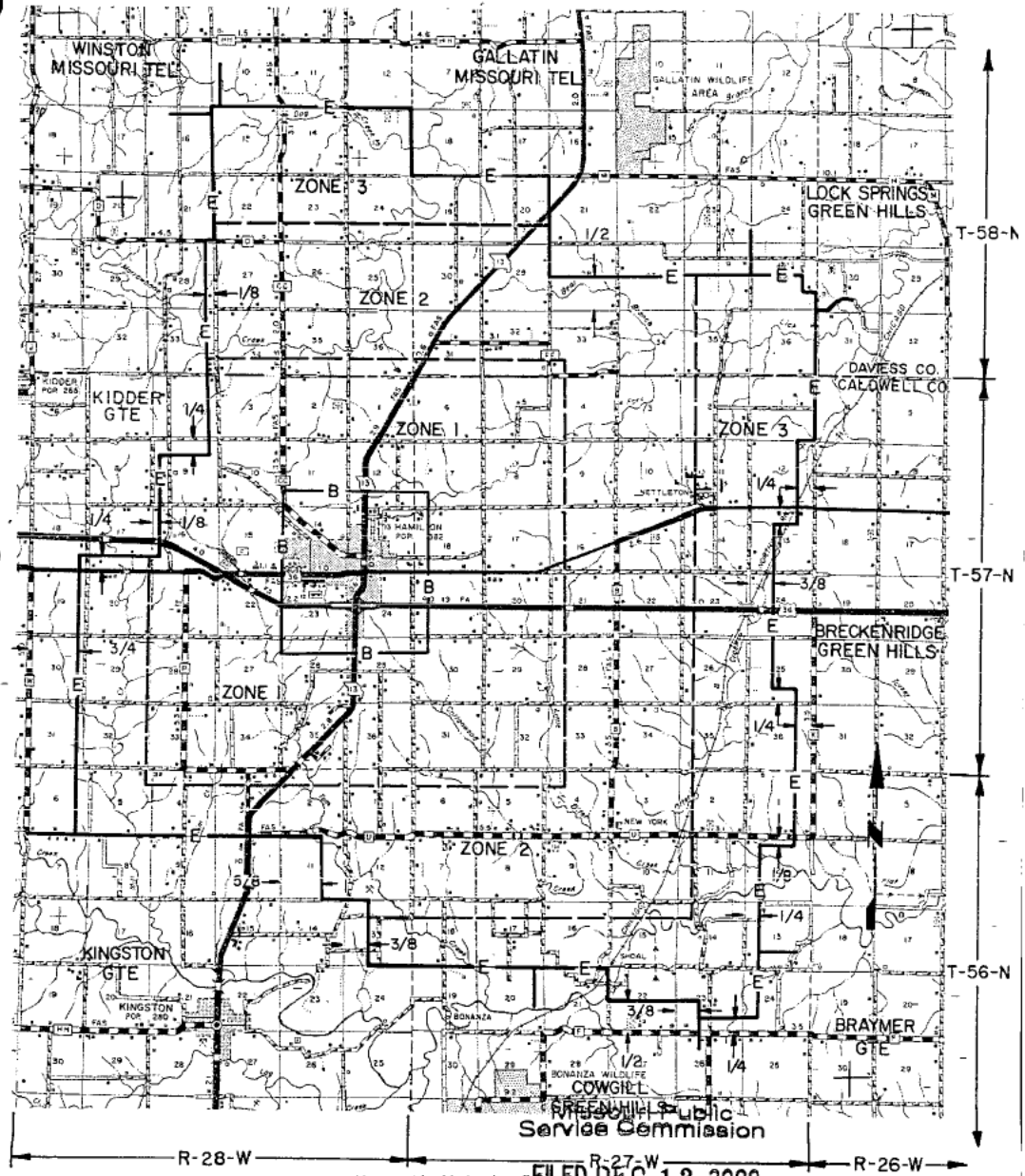

Issued: Nov. 13, 2000

Kenneth Matzdorff  
Chief Operating Officer  
Kansas City, MO

FILED DEC 13 2000

Effective: Dec. 13, 2000

LEGEND  
EAB \_\_\_\_\_  
BRA \_\_\_\_\_

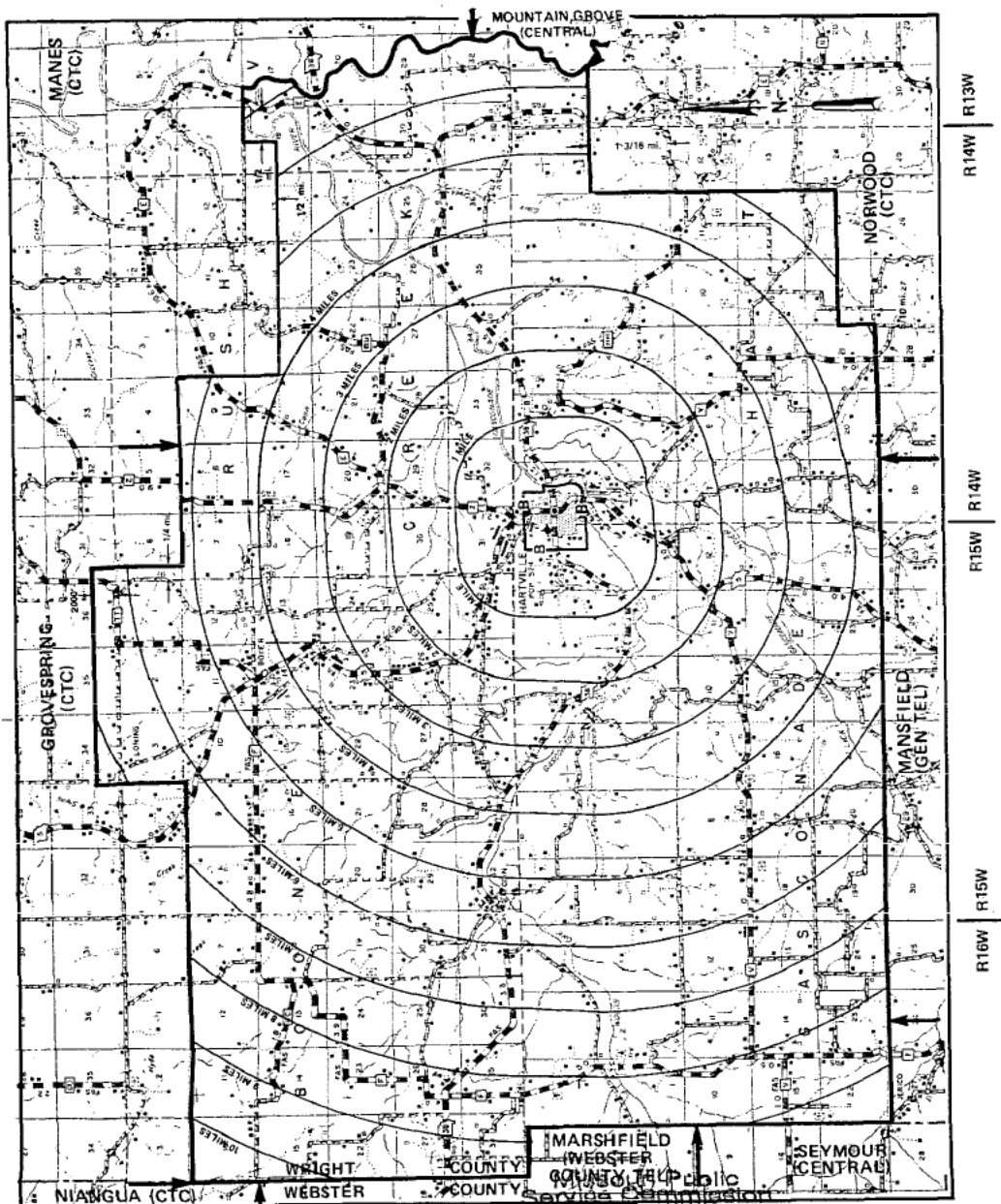

Issued: Nov. 13, 2000  
Kenneth Matzdorff  
Chief Operating Officer  
Kansas City, MO

FILED DEC 13 2000

Effective: Dec. 13, 2000

HELENA EXCHANGE  
ANDREW COUNTY  
EXCHANGE AREA MAP

Missouri Public  
Service Commission

REC'D NOV 13 2000

LEGEND

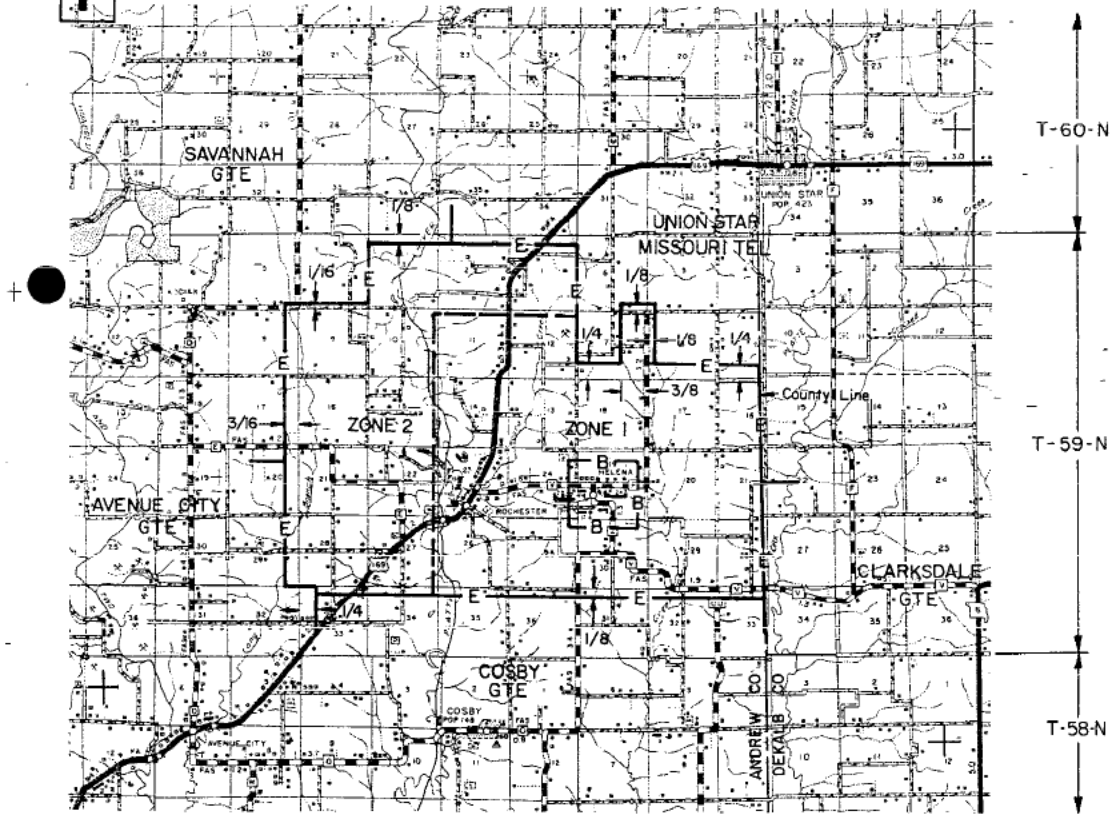

Missouri Public  
Service Commission

FILED DEC 13 2000

Issued: Nov. 13, 2000

Kenneth Matzdorff  
Chief Operating Officer  
Kansas City, MO

Effective: Dec. 13, 2000



LEGEND  
EAB  
BRA

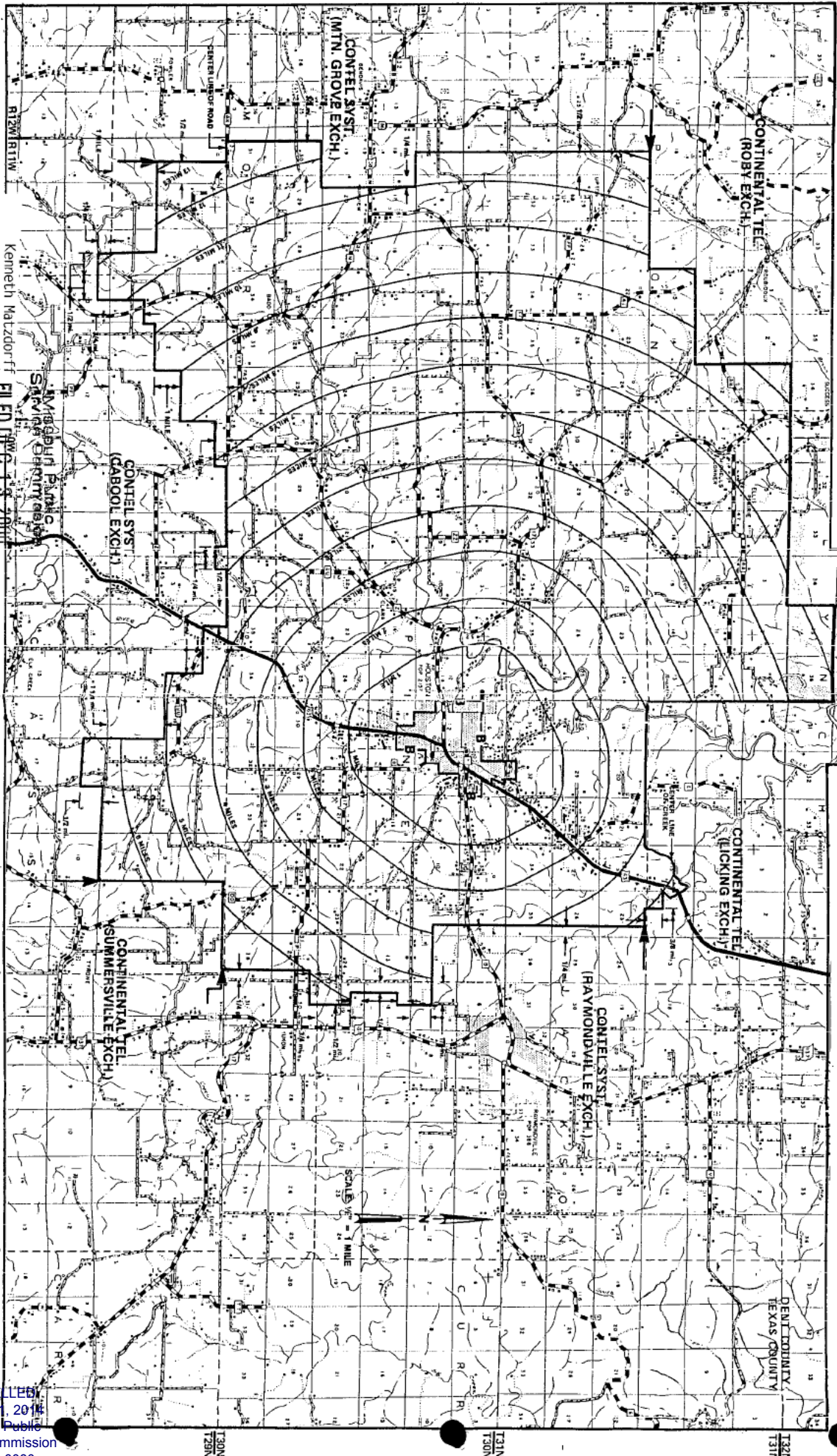

Issued: Nov. 13, 2000

Kenneth Matzdorff  
Chief Operating Officer  
Kansas City, MO

Effective: Dec. 13, 2000

RTW/RSW

RSW/RSW

RSW/RSW



EAB  
BRA  
LEGEND  
B

HUNNEWELL EXCHANGE Missouri Public Service Commission  
SHELBY COUNTY EXCHANGE AREA MAP ORIGINAL SHEET 47  
PSC MO. NO. 7  
RECD NOV 13 2000



R10W/R9W  
Issued Nov. 13, 2000

Kenneth Matzdorff  
Chief Operating Officer  
Kansas City, MO

Missouri Public Service Commission  
FILED NOV 13 2000

R8W/R7W

LEGEND  
EAB \_\_\_\_\_  
BRA \_\_\_\_\_ B \_\_\_\_\_

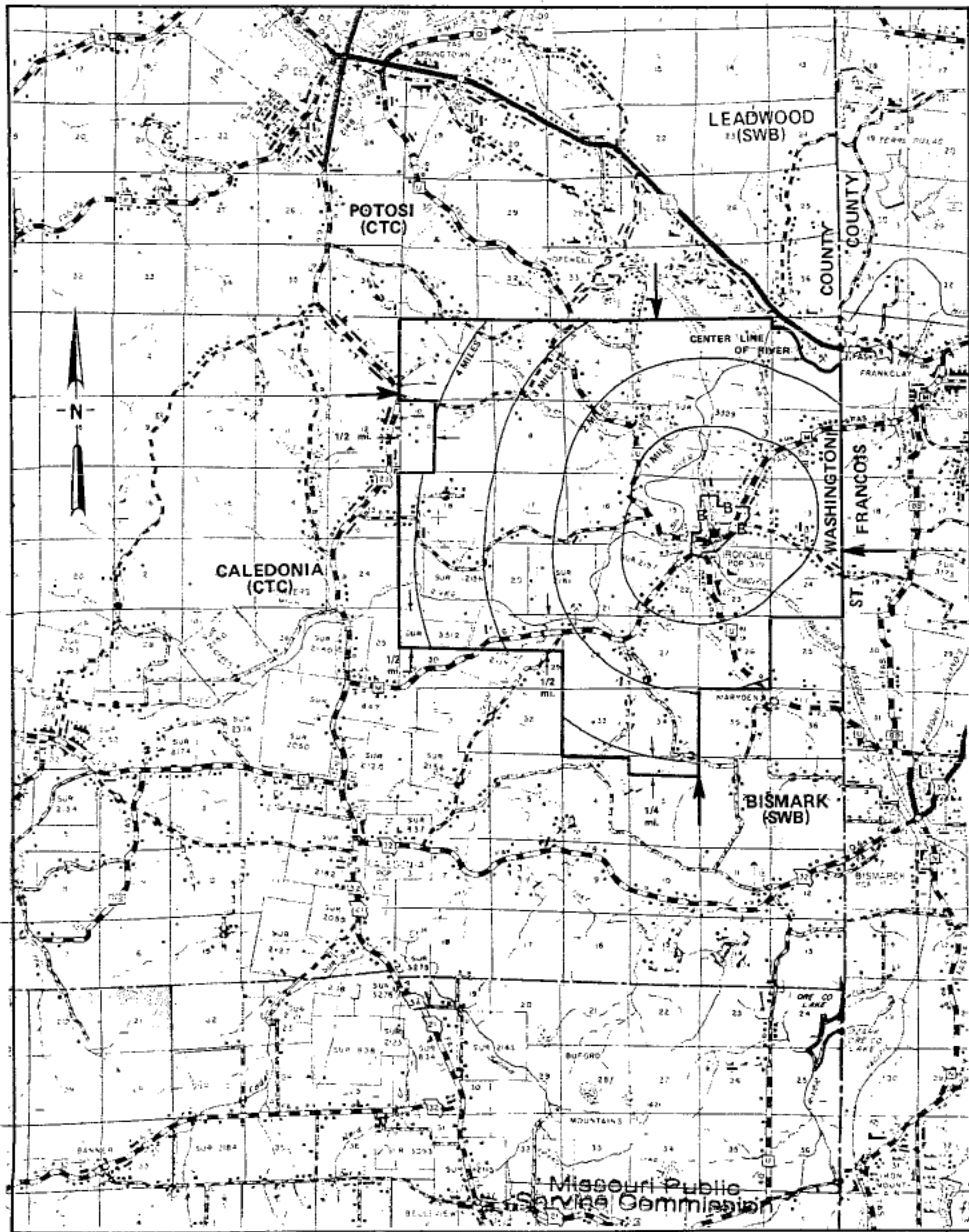

Nov. 13, 2000

Kenneth Matzdorf  
Chief Operating Officer  
Kansas City MO

FILED DEC 13 2000 R3E R4E

Dec. 13, 2000

Issued:

Effective:

IRONTON EXCHANGE  
IRON, MADISON, ST. FRANCOIS  
& REYNOLDS COUNTIES  
EXCHANGE AREA MAP  
PSC NO. NO. 7  
Missouri Public  
Service Commission  
ORIENTAL SHEET 49  
REC'D NOV 13 2000

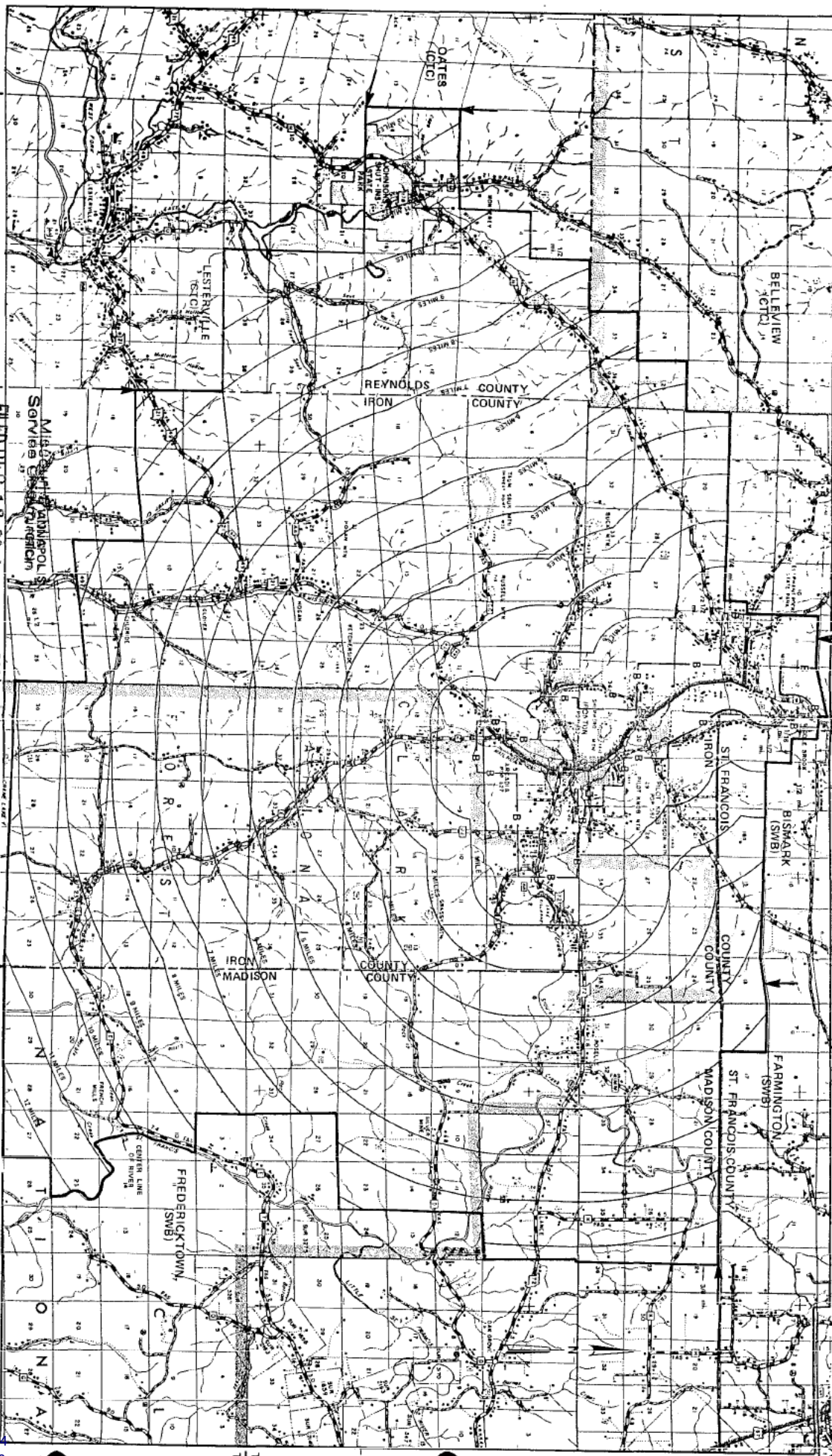

Issued: Nov. 13, 2000

Kenneth Matzdorff  
Chief Operating Officer  
Kansas City, MO

FILED DEC 13 2000

Effective: Dec. 13, 2000

EXCHANGE AREA MAP  
CEDAR, DADE, VERNON & BARTON COUNTIES

Missouri Public Service Commission  
SHEET 50

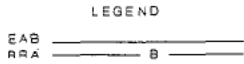

REC'D NOV 13 2000

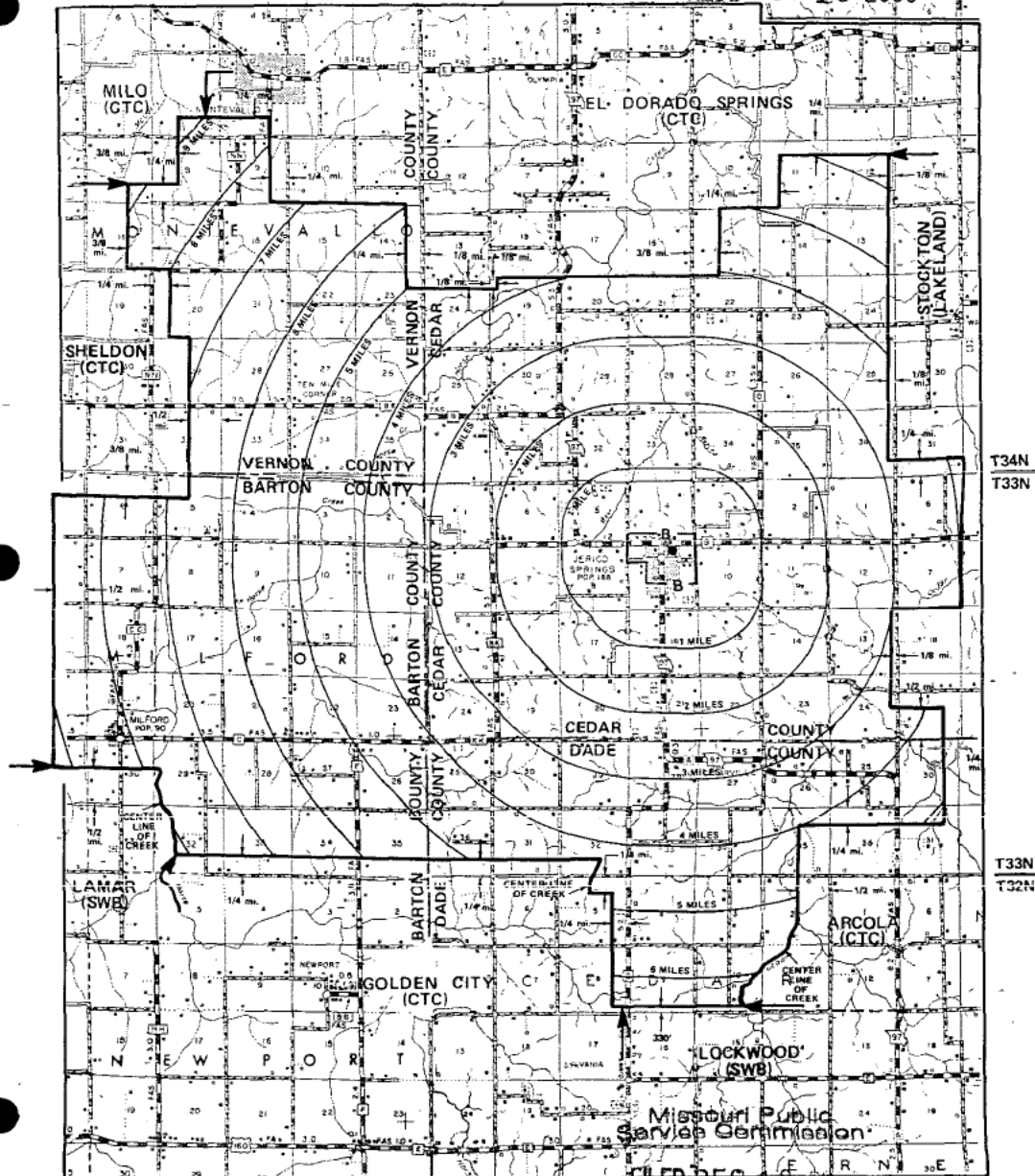

H30W | R29W

Issued: Nov. 13, 2000

Kenneth Matzdorff  
Chief Operating Officer  
Kansas City, MO

FILED DEC 13 2000

R28W | R27W

Effective: Dec. 13, 2000

REC'D NOV 13 2000

KAHOKA EXCHANGE  
CLARK COUNTY  
EXCHANGE AREA MAP

LEGEND

EAB ——— E ———  
 ZONE ——— B ———  
 BRA ———

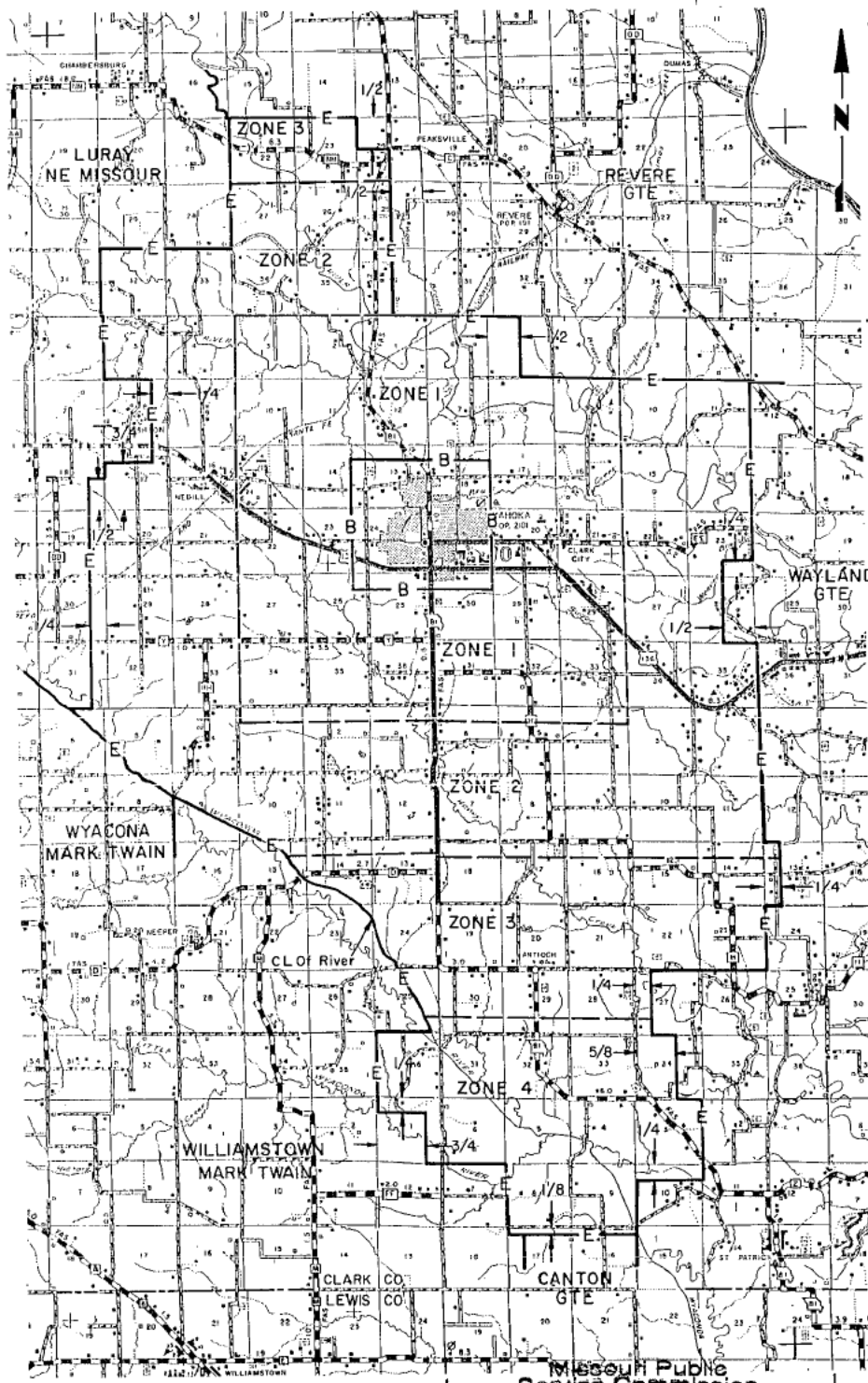

Missouri Public Service Commission

FILED DEC 13 2000

Issued: Nov. 13, 2000

Kenneth Matzdorff  
Chief Operating Officer  
Kansas City, MO

Effective: Dec. 13, 2000

REC'D NOV 13 2000

EAB \_\_\_\_\_  
BRA \_\_\_\_\_ B \_\_\_\_\_

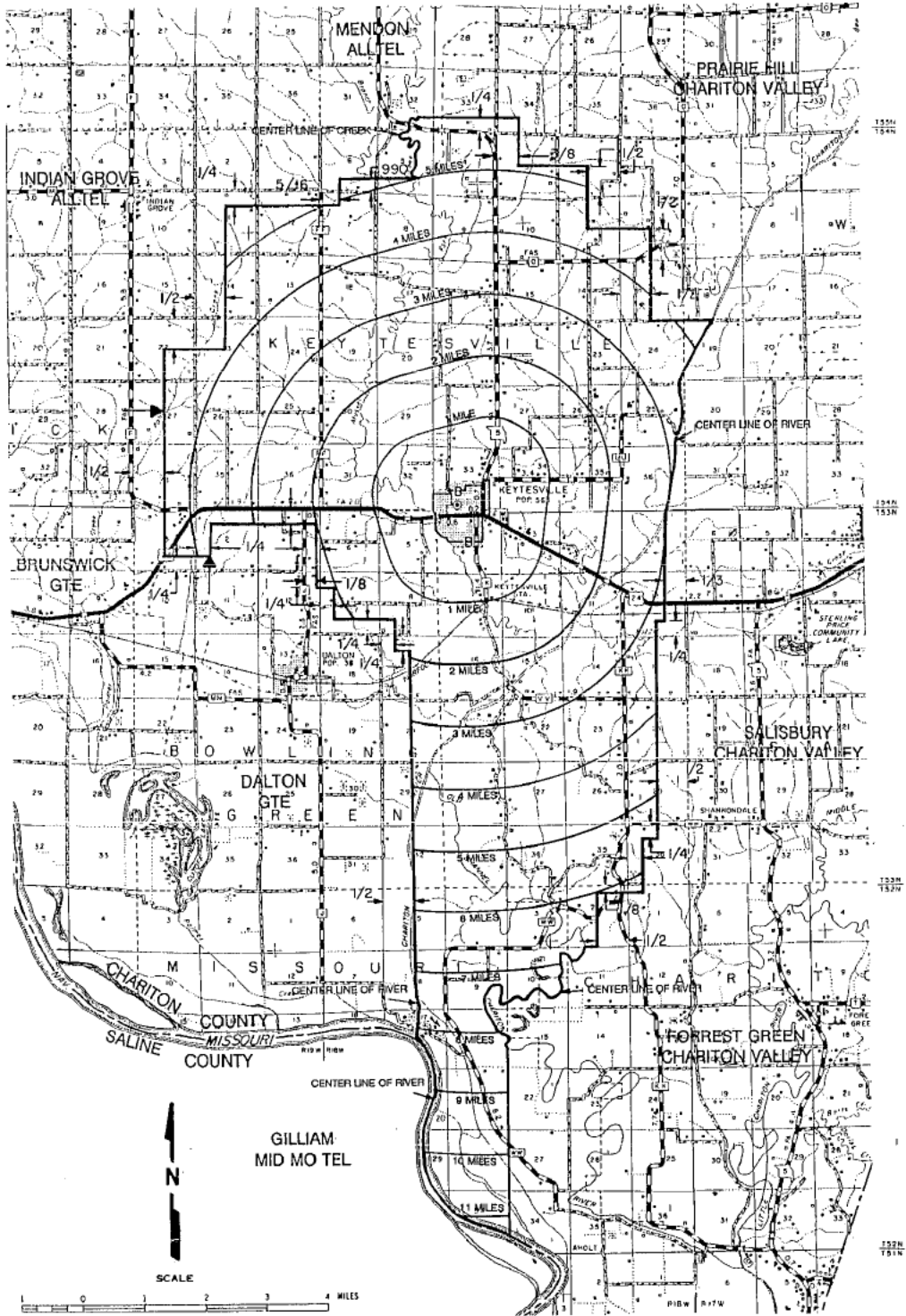

Issued: Nov. 13, 2000

Kenneth Matzdorff  
Chief Operating Officer  
Kansas City, MO

Missouri Public  
Service Commission

Effective: Dec. 13, 2000

FILED DEC 13 2000



KIDDER EXCHANGE  
CALDWELL & DAVIESS COUNTIES  
EXCHANGE AREA MAP

ORIGINAL SHEET 53

Missouri Public  
Service Commission



RECD NOV 13 2000

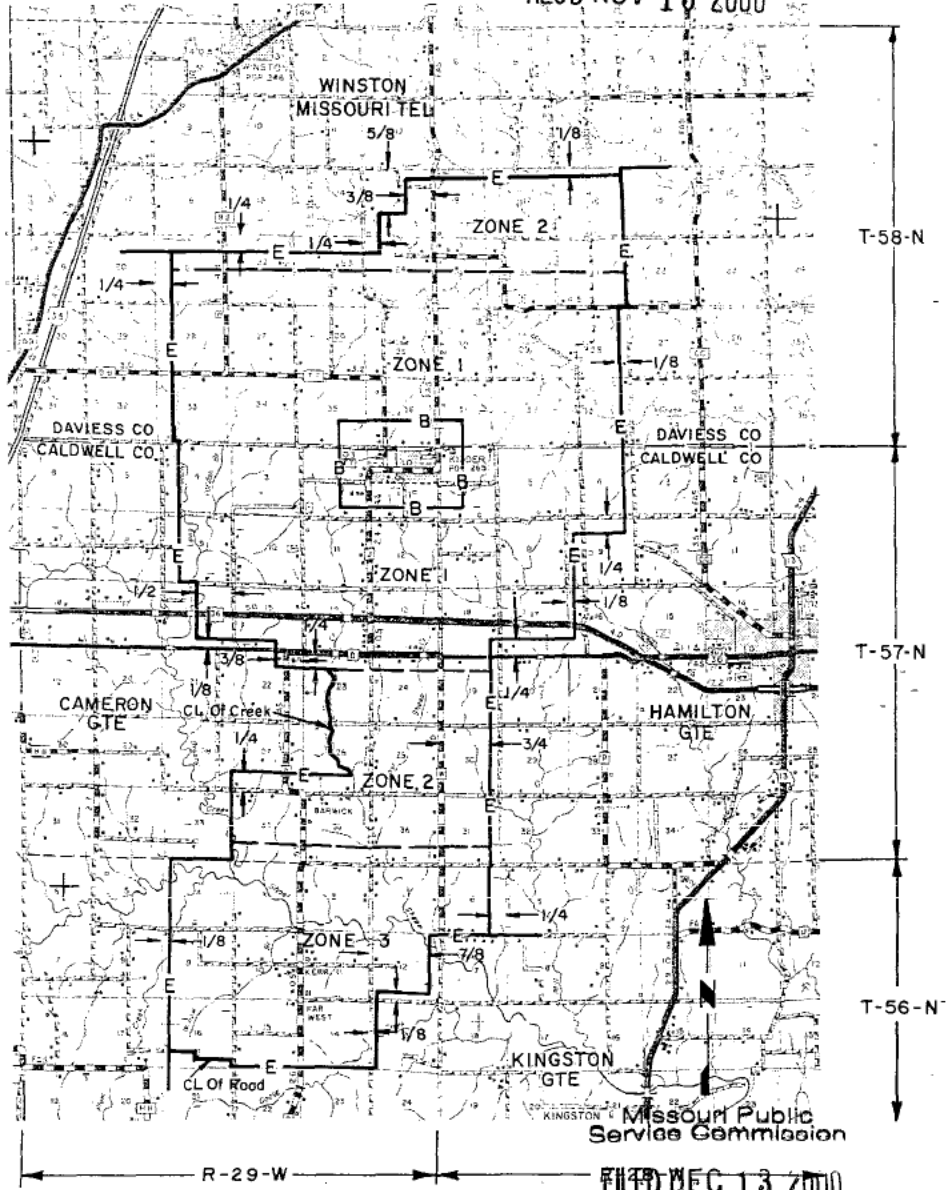

Missouri Public  
Service Commission  
FILED DEC 13 2000

Issued: Nov. 13, 2000

Kenneth Matzdorff  
Chief Operating Officer  
Kansas City, MO

Effective: Dec. 13, 2000

KINGSTON EXCHANGE  
CALDWELL COUNTY Missouri Public ORIGINAL SHEET 54  
EXCHANGE AREA Service Commission

LEGEND

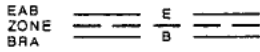

RECD NOV 13 2000

RECEIVED

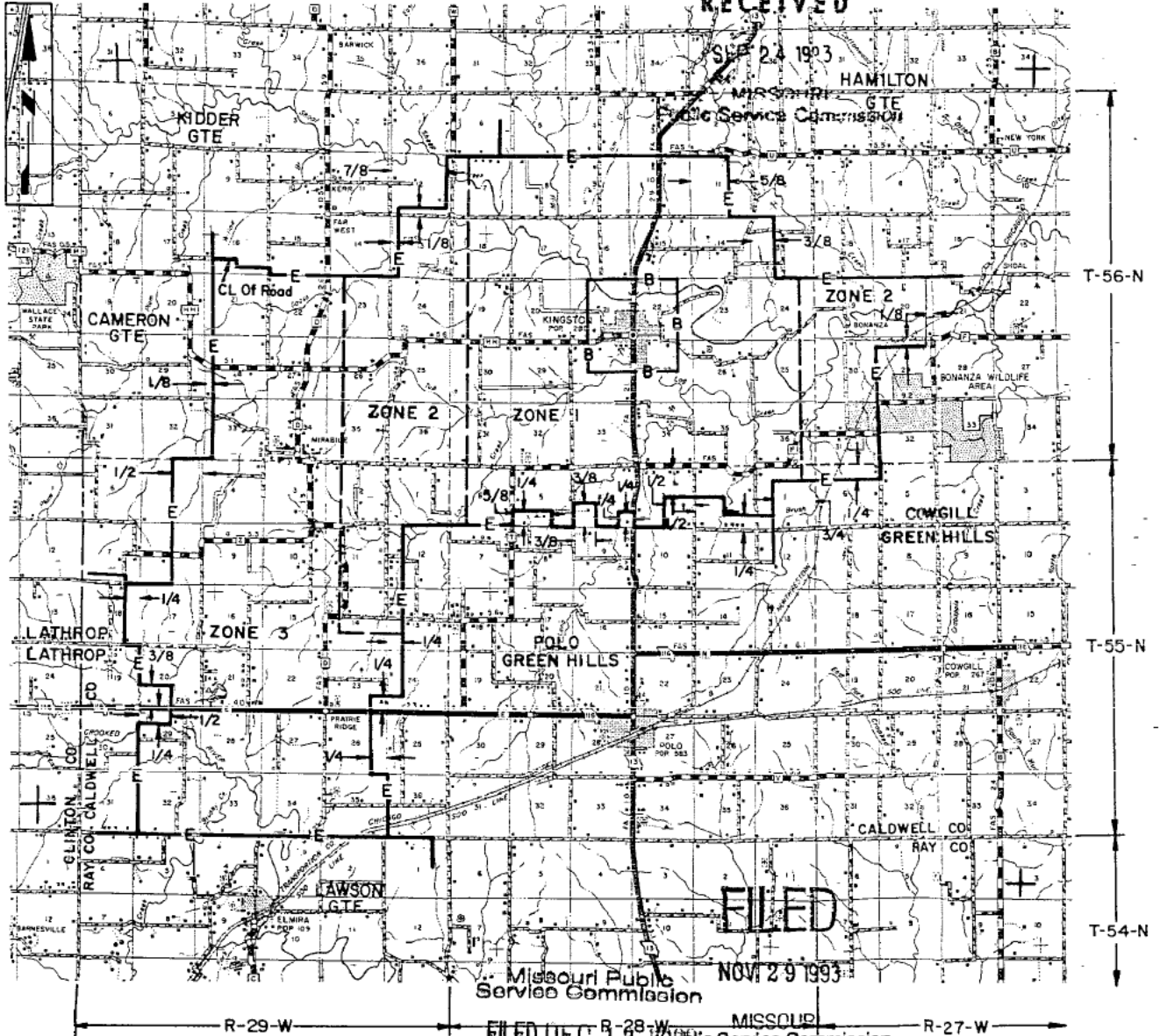

FILED

Missouri Public Service Commission  
NOV 29 1993  
FILED DEC 13 2000  
MISSOURI Public Service Commission

Issued: Nov. 13, 2000

Kenneth Matzdorff  
Chief Operating Officer  
Kansas City, MO

Effective: Dec. 13, 2000

LA BELLE EXCHANGE  
KNOX & LEWIS COUNTIES Missouri Public  
EXCHANGE AREA MAP Service Commission ORIGINAL SHEET 55

LEGEND  
EAB \_\_\_\_\_  
BRA \_\_\_\_\_ B \_\_\_\_\_

REC'D NOV 13 2000

T61N  
T60N

T63N  
T62N

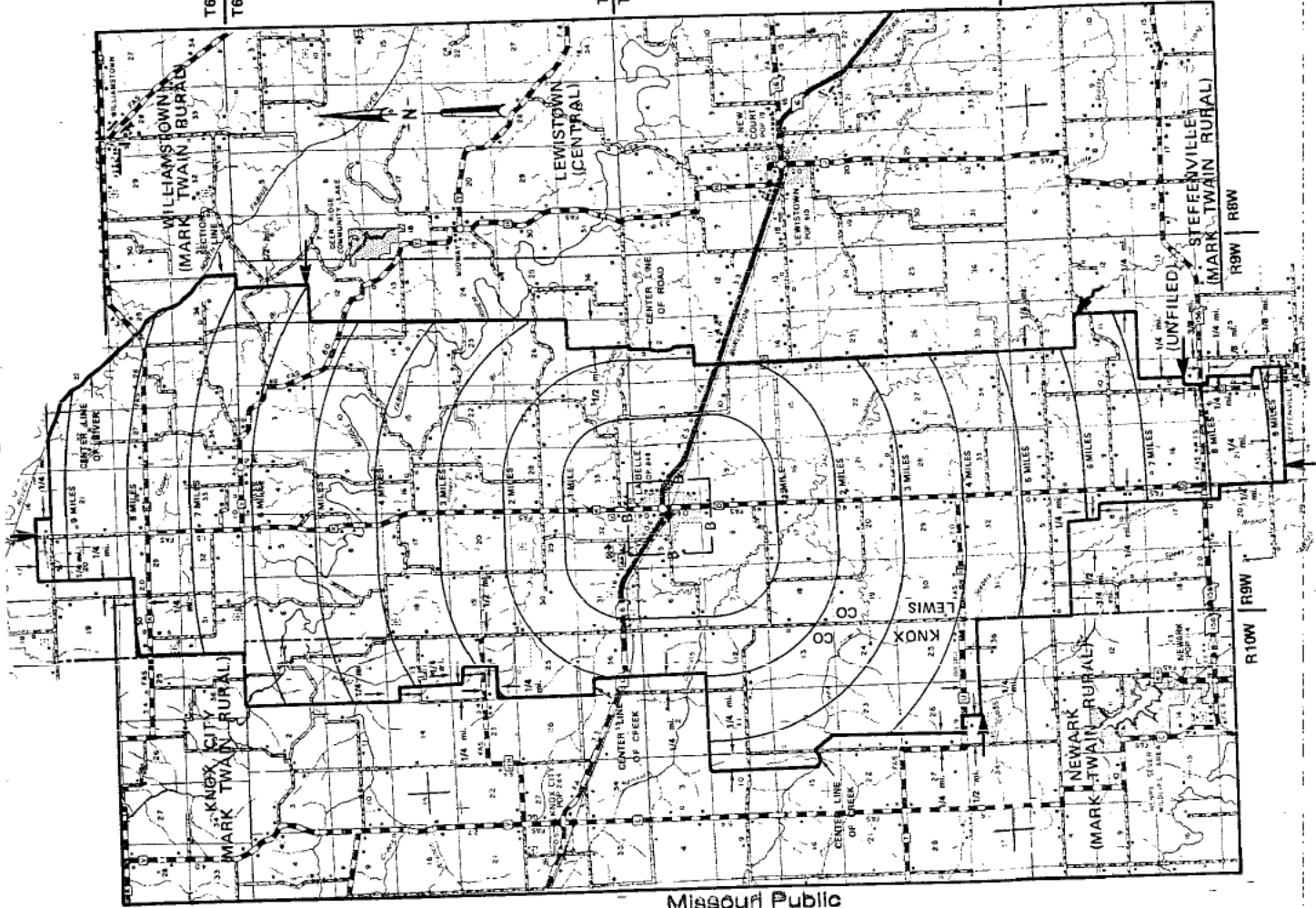

Missouri Public  
Service Commission

FILED DEC 13 2000

Kenneth Matzdorff  
Chief Operating Officer  
Kansas City, MO

Issued: Nov. 13, 2000

Effective: Dec. 13, 2000

LEGEND  
EAB  
BRA

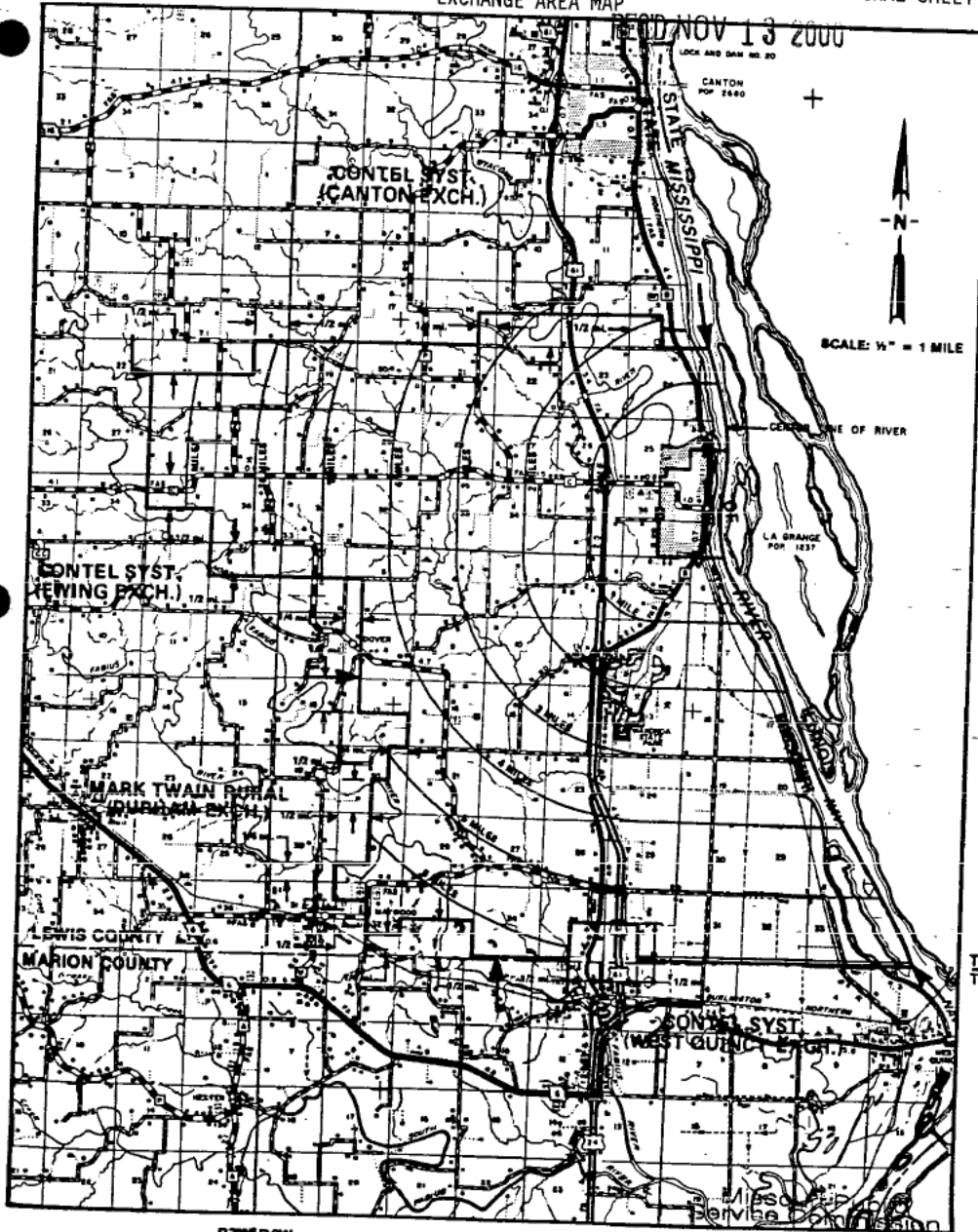

Issued: Nov. 13, 2000

Kenneth Matzdorff  
Chief Operating Officer  
Kansas City, MO

FILED DEC 13 2000

Effective: Dec. 13, 2000

Missouri Public Service Commission, PSC NO. 7  
LA PLATA EXCHANGE  
KNOX, ADAIR & MACON COUNTY  
EXCHANGE AREA MAP  
REVISED NOV 13 2000 ORIGINAL SHEET .57

LEGEND

6.8  
6.4  
6.0  
5.6  
5.2  
4.8  
4.4  
4.0  
3.6  
3.2  
2.8  
2.4  
2.0  
1.6  
1.2  
0.8  
0.4  
0.0

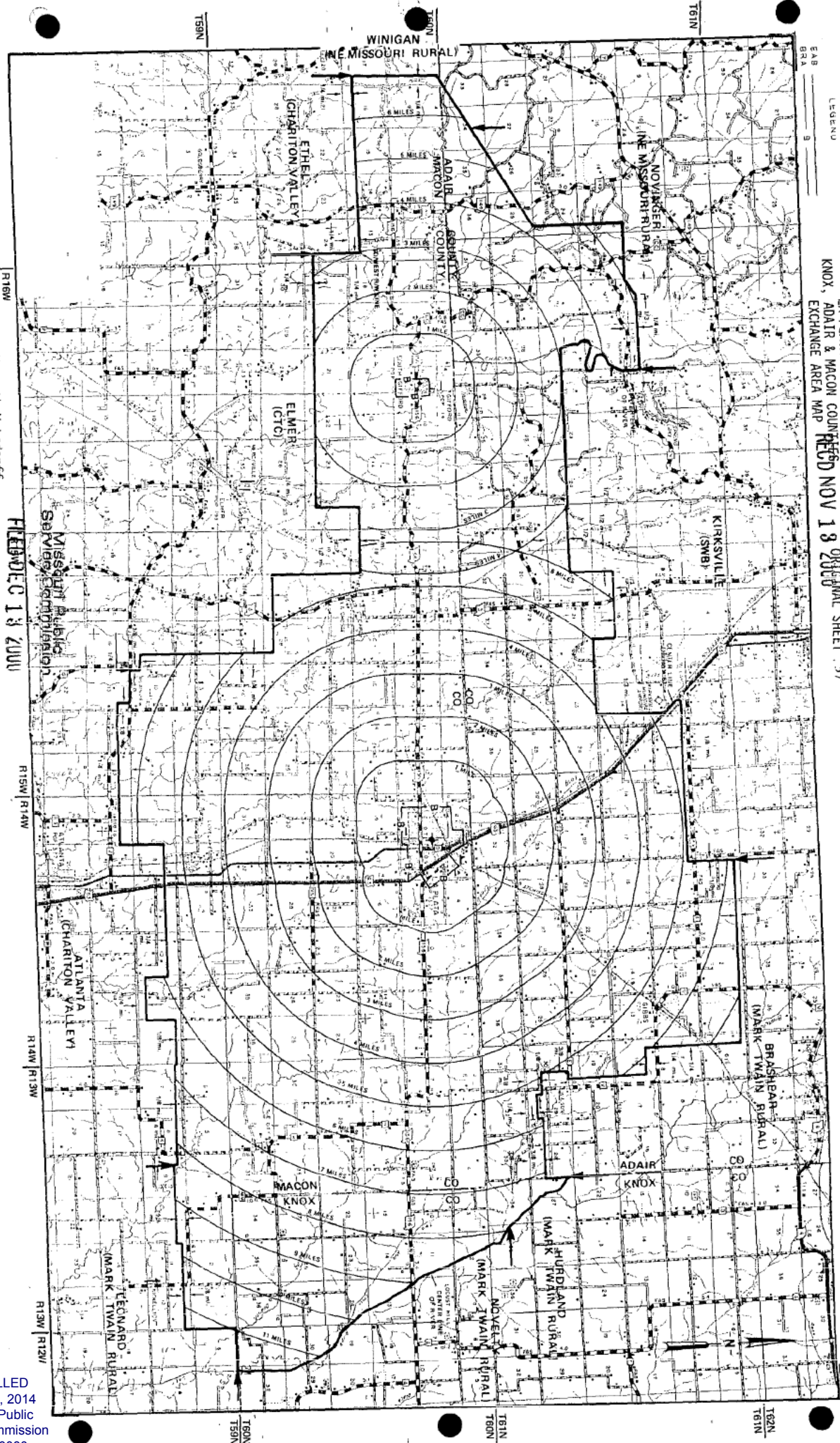

Kenneth Matzdorff  
Chief Operating Officer  
Kansas City, MO

Effective: Dec. 13, 2000

MISSOURI PUBLIC SERVICE COMMISSION  
REVISED DEC 13 2000

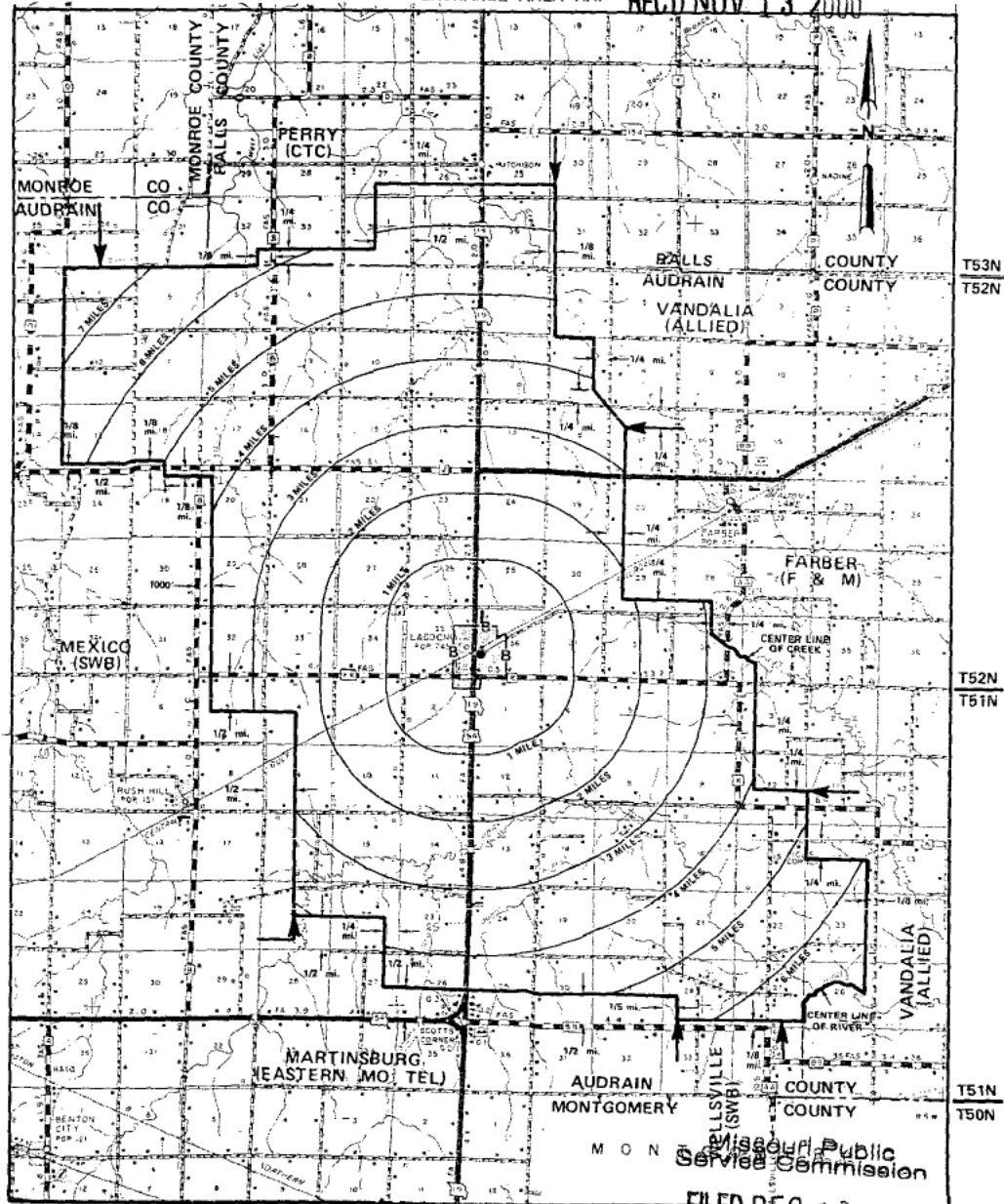

R8W | R7W

R7W | R6W

Issued: Nov. 13, 2000

Kenneth Matzdorff  
Chief Operating Officer  
Kansas City, MO

Effective: Dec. 13, 2000

FILED DEC 13 2000