

Notice of *Ex Parte* Contact

TO: Data Center
All Parties in Case No. **EC-2007-0106**

FROM: Chairman Jeff Davis

DATE: December 4, 2006

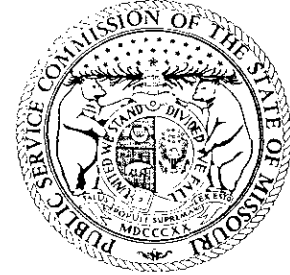

On December 4, 2006 I received the attached letter by facsimile from Mr. Richard D. Smith regarding Ameren. The Commission is currently considering the issues discussed in this document in case **EC-2007-0106** which is a contested case. In contested cases, the Commission is bound by the same *ex parte* rule as a court of law.

Although communications from members of the public and members of the legislature are always welcome, those communications must be made known to all parties to a contested case so that those parties have the opportunity to respond. According to the Commission's rules (4 CSR 240-4.020(8)), when a communication (either oral or written) occurs outside the hearing process, any member of the Commission or Regulatory Law Judge who received the communication shall prepare a written report concerning the communication and submit it to each member of the Commission and the parties to the case. The report shall identify the person(s) who participated in the *ex parte* communication, the circumstances which resulted in the communication, the substance of the communication, and the relationship of the communication to a particular matter at issue before the Commission.

Therefore, I submit this report pursuant to the rules cited above. This will ensure that any party to this case will have notice of the attached information and a full and fair opportunity to respond to the comments contained therein.

cc: Commissioners
Executive Director
Secretary/Chief Regulatory Law Judge
General Counsel

Richard D. Smith
12787 John Smith Road
Potosi, MO 63664
December 4, 2006

Mr. Jeff Davis, Chairman
Missouri Public Service Commission
P.O. Box 360
Jefferson City, MO 65102

Regarding Case No. EC-2007-0106

Dear Sir:

If we cannot be part of a rural electric cooperative again, then I am requesting that our area , the center of the John Smith Road, (the old R.E.A. leg 51 which is now Ameren UE) could be tied to leg 56, the Potosi Hwy. U area, which is seldom without service. I had already submitted this proposal in April 2006. In late June or the first of July, Alan Bax of the Public Service Commission called and told me this proposal was set to go into effect in the Spring of 2007. We mentioned this to your electrical engineer when he was in this area in November. We have not heard anything about this matter since.

Connecting to leg 56 would really help our area of approximately 40 houses because the substation is at Potosi for leg 56, only 5 miles away. We drove to the area where the new substation is supposed to be built at Belgrade, which is about 12 miles from my house. I don't believe the substation at Belgrade will help us much because most of this year's outages were within a 1 mile radius from here. I have been told that the proposed substation at Belgrade would have only 2 miles of new conductors toward our area. That would leave 10 miles of a heavily wooded area with the old lines still in usage towards my home. We need new conductors on the entire line. Current conductors were installed in 1951.

Page 2

Case No. EC-2007-0106

Even as I finish this letter, we are in our 90th hour of outage from the current storm. Leg 56 was restored at 3:15 p.m. on Sunday afternoon, December 3, 2006.

We would certainly appreciate it if the Commission would consider our request to include our approximately 40 house group with leg 56. A map of the area I am talking about is included.

Sincerely,

A handwritten signature in cursive script that reads "Richard D. Smith". The signature is written in dark ink and is positioned below the word "Sincerely,".

Richard D. Smith

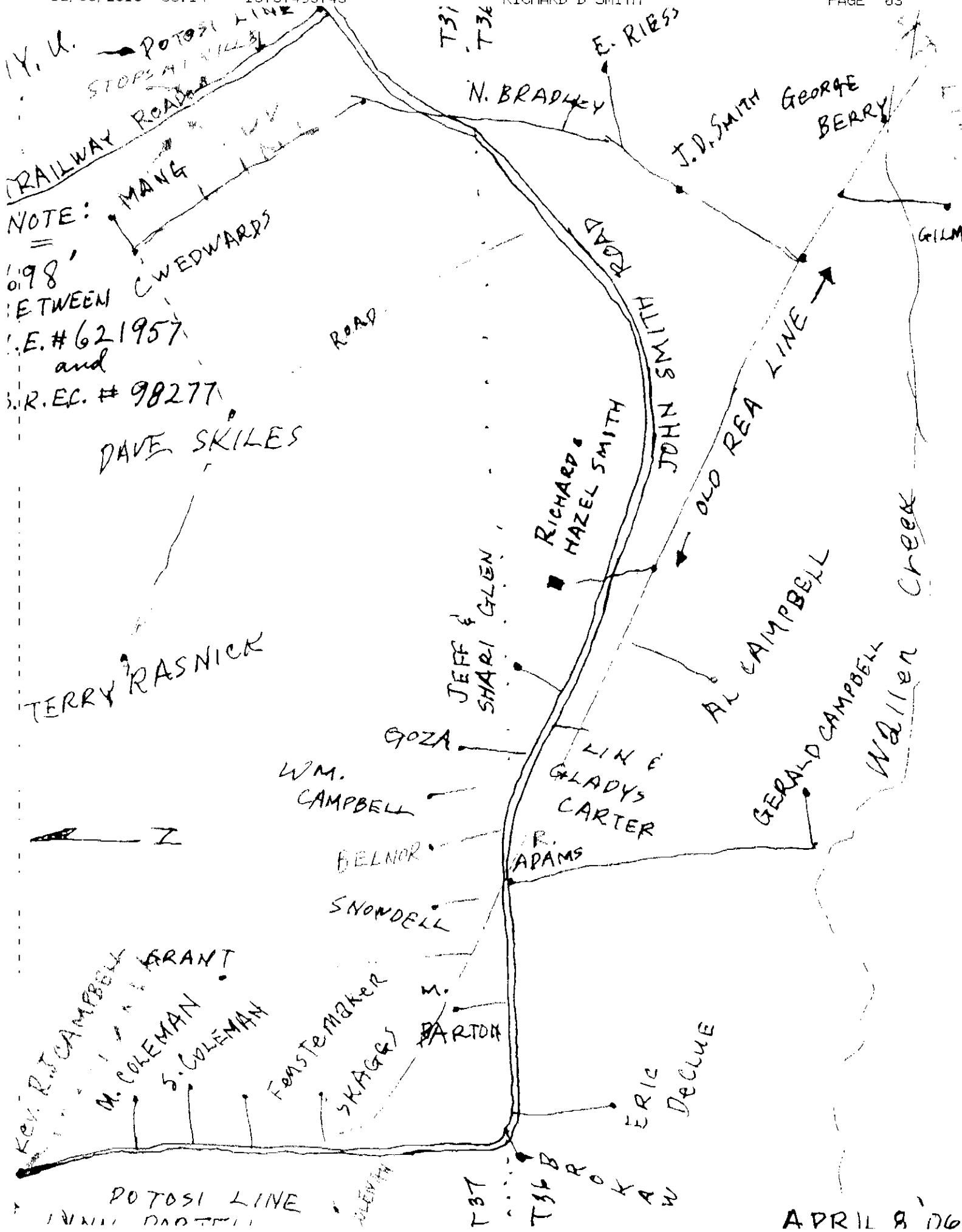

Y. U. — POTOSI LINE
STOPS AT WALLER CREEK
RAILWAY ROAD
NOTE: MANG
698'
BETWEEN
E. #621957
and
R.E.C. #98277
DAVE SKILES

T31
T36

E. RIES

N. BRADLEY

T.D. SMITH
GEORGE BERRY

GILM

ROAD

RICHARD
HAZEL SMITH

JOHN SMITH

OLD REA LINE

AL CAMPBELL

GERALD CAMPBELL
WALLER CREEK

GOZA

WM.
CAMPBELL

GLADYS
CARTER

R.
ADAMS

BELNOR

SNOWDELL

Rev. R.J. CAMPBELL
M. COLEMAN
S. COLEMAN

Fenstermaker
SHAGGS

M.
PARTON

ERIC
DECLUE

POTOSI LINE
WALLER CREEK

T37

T36 BROWN

APRIL 8 '76