

**NEW LONDON TELEPHONE COMPANY  
d/b/a RALLY NETWORKS**

**PSC Mo. No. 8  
Third Revised Adoption Notice  
Replaces Second Revised Adoption Notice**

(T)

**ADOPTION NOTICE**

**GENERAL AND LOCAL EXCHANGE TARIFF**

New London Telephone Company d/b/a Rally Networks hereby adopts, ratifies, and makes its own in every respect, as if the same had been originally filed by it, all tariffs of New London Telephone Company filed with and approved by the Missouri Public Service Commission before the effective date of this tariff.

(T)

This tariff contains the descriptions, regulations, and rates applicable to the furnishing of service and facilities for telecommunications services provided by New London Telephone Company d/b/a Rally Networks within the State of Missouri. This tariff is on file with the Missouri Public Service Commission and copies may be inspected during normal business hours, at the Company's principal place of business.

(T)

FILED - Missouri Public Service Commission - 10/31/2022 - TN-2023-0140 - Y1-2023-0072

---

Issued: October 21, 2022

Issued by: Garrin Bott, President  
101 Main Street, P.O. Box 175  
New Florence, MO 63363-0175

Effective: October 31, 2022

**P.S.C. MO. No. 8**

**NEW LONDON TELEPHONE COMPANY  
d/b/a MISSOURICOM**

---

(T)

SECOND AMENDED TITLE PAGE  
REPLACES FIRST AMENDED TITLE PAGE

(T)

NEW LONDON TELEPHONE COMPANY  
d/b/a MISSOURICOM

(T)

SCHEDULE OF RATES  
FOR  
TELEPHONE SERVICE  
APPLYING TO THE FOLLOWING TERRITORIES  
NEW LONDON, MISSOURI

---

Issued: August 23, 2018

Issued by: Garrin Bott, President  
101 Main Street, P.O. Box 175  
New Florence, MO 63363-0175

Effective: September 2, 2018

FILED  
Missouri Public  
Service Commission  
IN-2019-0055, JI-2019-0020

**GENERAL EXCHANGE TARIFF**

**P.S.C. MO No. 7**  
**NEW LONDON TELEPHONE COMPANY.**  
d/b/a TDS Telecom  
Missouri

Section 1  
Original Contents Sheet 1

---

**TABLE OF CONTENTS**

SECTION 1	Table of Contents, General Subject Index and Symbols
SECTION 2	General Rules and Regulations
SECTION 3	Definitions
SECTION 4	Local Exchange Service
SECTION 5	Miscellaneous Service Arrangements
SECTION 6	Service Connection Charges
SECTION 7	Directory Services
SECTION 8	Optional Services
SECTION 9	Construction Charges
SECTION 10	Private Line Service
SECTION 11	Access Service

---

ISSUED: February 27, 2013

EFFECTIVE: March, 29, 2013

By: Joel Dohmeier, Vice-President

FILED  
Missouri Public  
Service Commission  
JI-2013-0373

**GENERAL EXCHANGE TARIFF**

**P.S.C. MO No. 7**  
**NEW LONDON TELEPHONE COMPANY.**  
d/b/a TDS Telecom  
Missouri

Section 2  
Original Sheet 1

---

**GENERAL REGULATIONS**

**CONCURRENCE**

New London Telephone Company, d/b/a TDS Telecom hereby assents to, adopts and concurs in the General Regulations as set forth in Section 2 of Stoutland Telephone Company, d/b/a TDS Telecom tariff, on file with the Missouri Public Service Commission and makes itself a party thereto and obligates itself to observe the provisions therein with the exceptions listed below.

**EXCEPTIONS**

*No Exceptions*

---

ISSUED: February 27, 2013

EFFECTIVE: March 29, 2013

By: Joel Dohmeier, Vice-President

FILED  
Missouri Public  
Service Commission  
JI-2013-0373

**GENERAL EXCHANGE TARIFF**

**P.S.C. MO No. 7**  
**NEW LONDON TELEPHONE COMPANY.**  
d/b/a TDS Telecom  
Missouri

Section 3  
Original Sheet 1

---

**DEFINITIONS**

**CONCURRENCE**

New London Telephone Company, d/b/a TDS Telecom hereby assents to, adopts and concurs in the Definitions as set forth in Section 3 of Stoutland Telephone Company, d/b/a TDS Telecom tariff, on file with the Missouri Public Service Commission and makes itself a party thereto and obligates itself to observe the provisions therein with the exceptions listed below.

**EXCEPTIONS**

*No Exceptions*

---

ISSUED: February 27, 2013

EFFECTIVE: March 29, 2013

By: Joel Dohmeier, Vice-President

FILED  
Missouri Public  
Service Commission  
JI-2013-0373

**GENERAL EXCHANGE TARIFF**

**P.S.C. MO. No. 8  
NEW LONDON TELEPHONE COMPANY  
d/b/a MISSOURICOM**

**Section 4  
Third Revised Sheet 1  
Cancels Second Revised Sheet 1**

**LOCAL EXCHANGE SERVICE**

**CONCURRENCE**

New London Telephone Company d/b/a Missouriicom hereby assents to, adopts and concurs in the Local Exchange Service as set forth in Section 4 of Stoutland Telephone Company d/b/a Missouri tariff, on file with the Missouri Public Service Commission and makes itself a party thereto and obligates itself to observe the provisions therein with the exceptions listed below.

(T)  
(T)

**EXCEPTIONS**

**BASIC ACCESS LINE SERVICE**

Local rates for Residential and Business services are available at the Company's website:

<https://missouricom.co/tariff-charges/>

(N)  
|  
(N)

GENERAL EXCHANGE TARIFF

P.S.C. MO No. 8  
NEW LONDON TELEPHONE COMPANY  
Missouri

Section 4  
First Revised Sheet 2  
Replaces Original Sheet 2

LOCAL EXCHANGE SERVICE

EXCEPTIONS - Continued

SYSTEM PLUS CENTREX SERVICE (SPCS)

B. SYSTEM FEATURES

j. Speed Calling 6

Allows a user to place calls to a previously designated list of six (6) frequently dialed numbers.

E. RATES AND CHARGES

b. The monthly rates for  
Simulated Facility Trunks are:

	Business Monthly <u>Rate</u>	Residence Monthly <u>Rate</u>	
1) 1 to 6 Trunks, each	\$24.10	\$14.30	(l)
2) 7 and above, each	\$23.45	\$13.70	(l)

ISSUED: April 29, 2016

EFFECTIVE: June 1, 2016

By: Garrin Bott, President

FILED  
Missouri Public  
Service Commission  
JI-2016-0305

GENERAL EXCHANGE TARIFF

P.S.C. MO No. 7  
NEW LONDON TELEPHONE COMPANY.  
d/b/a TDS Telecom  
Missouri

Section 4  
Original Sheet 3

LOCAL EXCHANGE SERVICE

EXCHANGE BOUNDARY MAP

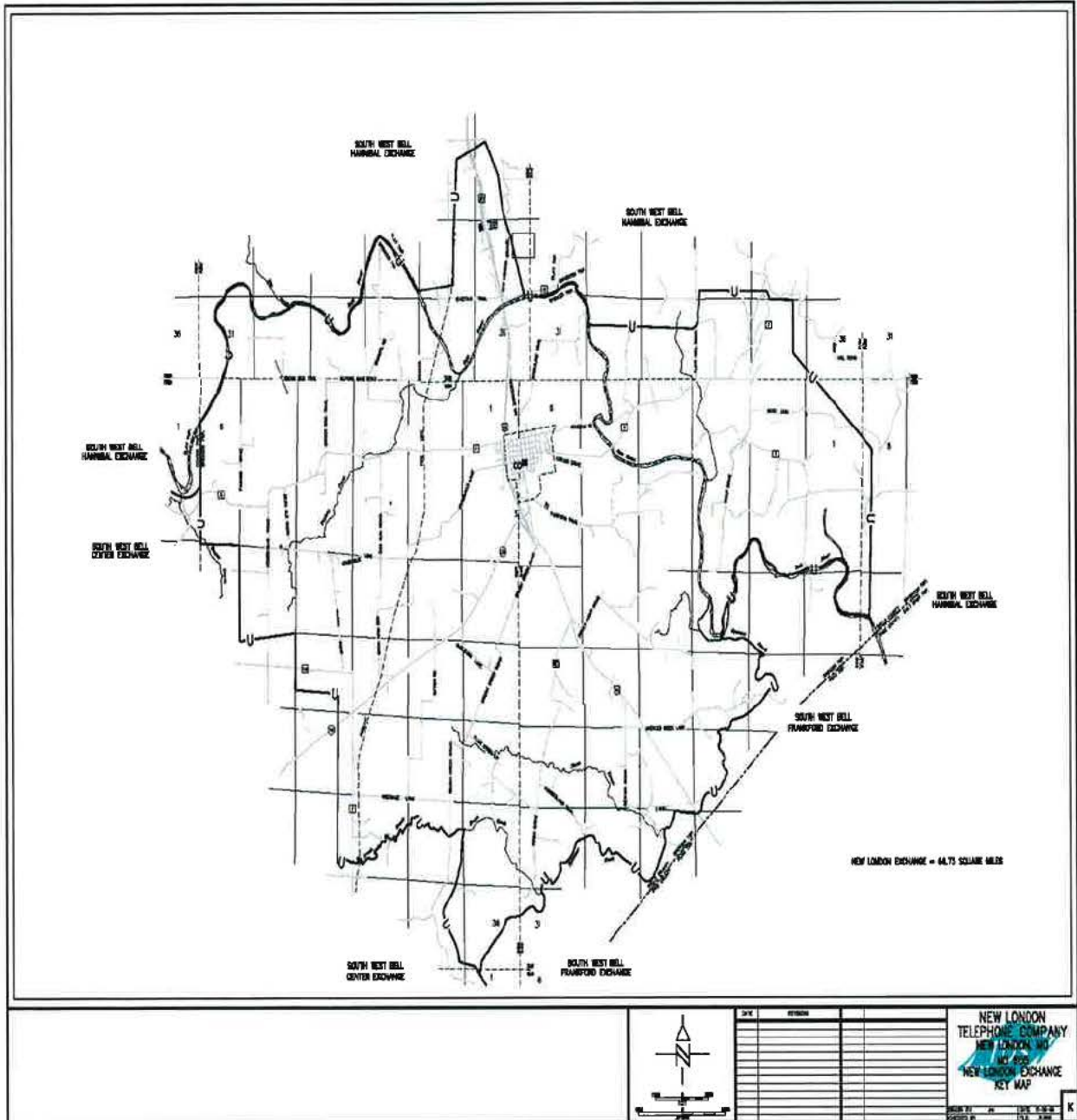

ISSUED: February 27, 2013

EFFECTIVE: March 29, 2013

By: Joel Dohmeier, Vice-President

FILED  
Missouri Public  
Service Commission  
JI-2013-0373



**GENERAL EXCHANGE TARIFF**

**P.S.C. MO No. 7**  
**NEW LONDON TELEPHONE COMPANY.**  
d/b/a TDS Telecom  
Missouri

Section 4  
First Revised Sheet 4  
Cancels Original Sheet 4

---

**LOCAL EXCHANGE SERVICE**

Reserved for Future Use

(T)

(D)

(D)

---

ISSUED: May 17, 2013

EFFECTIVE: June 17, 2013

By: Joel Dohmeier, Vice-President

FILED  
Missouri Public  
Service Commission  
JI-2013-0539

**GENERAL EXCHANGE TARIFF**

**P.S.C. MO No. 7**  
**NEW LONDON TELEPHONE COMPANY.**  
d/b/a TDS Telecom  
Missouri

Section 4  
First Revised Sheet 5  
Cancels Original Sheet 5

---

**LOCAL EXCHANGE SERVICE**

Reserved for Future Use

(T)

(D)

(D)

---

ISSUED: May 17, 2013

EFFECTIVE: June 17, 2013

By: Joel Dohmeier, Vice-President

FILED  
Missouri Public  
Service Commission  
JI-2013-0539

GENERAL EXCHANGE TARIFF

P.S.C. MO No. 8  
NEW LONDON TELEPHONE COMPANY  
Missouri

Section 5  
First Revised Sheet 1  
Replaces Original Sheet 1

MISCELLANEOUS SERVICES

**CONCURRENCE**

New London Telephone Company hereby assents to, adopts and concurs in the Miscellaneous Services as set forth in Section 5 of Stoutland Telephone Company tariff on file with the Missouri Public Service Commission and makes itself a party thereto and obligates itself to observe the provisions therein with the exceptions listed below.

**EXCEPTIONS**

**TOTAL TALK PACK<sup>1</sup>**

C.	RATES		(D)
			(D)
		<u>Rate Per Month</u>	
1.	Residence <sup>2</sup> Local Bundle, per line	\$30.70	(I)
2.	Business <sup>3</sup> Local Bundle, per line	\$39.05	(I)

**STAR PACKAGES<sup>4</sup>**

C.	RATES		
		<u>Rate Per Month</u>	
1.	<u>Residence</u>		
	a) 3 STAR Standard Package, per line	\$31.99 <sup>4</sup>	
	b) 4 STAR Standard Package, per line	\$41.99 <sup>4</sup>	(I)
	c) 5 STAR Standard Package, per line	\$51.99 <sup>4</sup>	(I)
			(I)
2.	Package Upgrade	\$ 5.00	
3.	Package Change Fee	\$ 7.50	

<sup>1</sup> Customers must also subscribe to Direct Long Distance.

<sup>2</sup> This service is grandfathered to existing Residential customers effective January 7, 2009. The service will not be available to new customers after this date.

<sup>3</sup> This service is grandfathered to existing Business customers effective December 30, 2010. The service will not be available to new customers after this date.

<sup>4</sup> This service is grandfathered to existing customers effective June 1, 2016. The service will not be available to new customers after this date.

ISSUED: April 29, 2016

EFFECTIVE: June 1, 2016

By: Garrin Bott, President

FILED  
Missouri Public  
Service Commission  
JI-2016-0305

GENERAL EXCHANGE TARIFF

P.S.C. MO No. 8  
NEW LONDON TELEPHONE COMPANY  
Missouri

Section 5  
Fourth Revised Sheet 2  
Replaces Third Revised Sheet 2

MISCELLANEOUS SERVICES

**EXCEPTIONS** – Continued

**SAFETY LINE SERVICE**<sup>2</sup>

C. RATES AND CHARGES

	<u>Monthly Rate</u>	
Bundle Base Rate – DSL Market A	\$53.95 <sup>1</sup>	(I)
Bundle Base Rate – DSL Market B	\$59.20 <sup>1</sup>	(I)

**SECURITY LINE SERVICE**<sup>3</sup>

C. RATES AND CHARGES

	<u>Monthly Rate</u>	
Bundle Base Rate – DSL Market A	\$43.95 <sup>1</sup>	(I)
Bundle Base Rate – DSL Market B	\$49.20 <sup>1</sup>	(I)

<sup>1</sup> Other data speeds may be available for an additional charge

<sup>2</sup> This service is grandfathered to existing customers effective August 1, 2012. The service will not be available to new customers after this date.

<sup>3</sup> This service is grandfathered to existing customers effective June 1, 2016. The service will not be available to new customers after this date.

---

ISSUED: April 29, 2016

EFFECTIVE: June 1, 2016

By: Garrin Bott, President

FILED  
Missouri Public  
Service Commission  
JI-2016-0305

**GENERAL EXCHANGE TARIFF**

**P.S.C. MO. No. 8  
NEW LONDON TELEPHONE COMPANY  
d/b/a MISSOURICOM**

**Section 6  
1<sup>st</sup> Revised Sheet 1  
Cancels Original Sheet 1**

---

**SERVICE CONNECTION CHARGES**

**CONCURRENCE**

New London Telephone Company d/b/a Missouriicom hereby assents to, adopts and concurs in (T)  
the Service Connection Charges as set forth in Section 6 of Stoutland Telephone Company d/b/a (T)  
Missouricom tariff, on file with the Missouri Public Service Commission and makes itself a  
party thereto and obligates itself to observe the provisions therein with the excepts listed below.

(D)

**GENERAL EXCHANGE TARIFF**

**P.S.C. MO No. 8**  
**NEW LONDON TELEPHONE COMPANY**  
Missouri

Section 7  
First Revised Sheet 1  
Replaces Original Sheet 1

---

**DIRECTORY SERVICES**

**HOLD FOR FUTURE USE**

(D)

(D)

---

ISSUED: February 17, 2016

EFFECTIVE: March 18, 2016

By: Garrin Bott, President

**FILED**  
**Missouri Public**  
**Service Commission**  
**JI-2016-0217**

GENERAL EXCHANGE TARIFF

P.S.C. MO No. 7  
NEW LONDON TELEPHONE COMPANY.  
d/b/a TDS Telecom  
Missouri

Section 8  
Original Sheet 1

OPTIONAL SERVICES

**CONCURRENCE**

New London Telephone Company, d/b/a TDS Telecom hereby assents to, adopts and concurs in the Optional Services as set forth in Section 8 of Stoutland Telephone Company, d/b/a TDS Telecom tariff, on file with the Missouri Public Service Commission and makes itself a party thereto and obligates itself to observe the provisions therein with the exceptions listed below.

**EXCEPTIONS**

**CUSTOM CALLING SERVICES**

B. Service Descriptions

11. Personal Ringing Service – *Not Available*

D. Rates And Discounts

1. Rates

<u>One Service Per Line</u>	<u>Rate Per Month</u>	<u>Trans Code</u>	<u>Activation Code</u>	<u>Deactivation Code</u>
h. Home Intercom-Basic	0.75	CCHI	N/A	N/A
k. Personal Ringing	N/A	N/A	N/A	N/A

ISSUED: February 27, 2013

EFFECTIVE: March 29, 2013

By: Joel Dohmeier, Vice-President

FILED  
Missouri Public  
Service Commission  
JI-2013-0373

**GENERAL EXCHANGE TARIFF**

**P.S.C. MO No. 7**  
**NEW LONDON TELEPHONE COMPANY.**  
d/b/a TDS Telecom  
Missouri

Section 9  
Original Sheet 1

---

**CONSTRUCTION CHARGES**

**CONCURRENCE**

New London Telephone Company, d/b/a TDS Telecom hereby assents to, adopts and concurs in the Construction Charges as set forth in Section 9 of Stoutland Telephone Company, d/b/a TDS Telecom tariff, on file with the Missouri Public Service Commission and makes itself a party thereto and obligates itself to observe the provisions therein with the exceptions listed below.

**EXCEPTIONS**

*No Exceptions*

---

ISSUED: February 27, 2013

EFFECTIVE: March 29, 2013

By: Joel Dohmeier, Vice-President

FILED  
Missouri Public  
Service Commission  
JI-2013-0373



GENERAL EXCHANGE TARIFF

P.S.C. MO No. 7  
NEW LONDON TELEPHONE COMPANY.  
d/b/a TDS Telecom  
Missouri

Section 10  
Original Sheet 1

---

PRIVATE LINE SERVICES

**CONCURRENCE**

New London Telephone Company, d/b/a TDS Telecom hereby assents to, adopts and concurs in the Private Line Services as set forth in Section 10 of Stoutland Telephone Company, d/b/a TDS Telecom tariff, on file with the Missouri Public Service Commission and makes itself a party thereto and obligates itself to observe the provisions therein with the exceptions listed below.

**EXCEPTIONS**

*No Exceptions*

---

ISSUED: February 27, 2013

EFFECTIVE: March 29, 2013

By: Joel Dohmeier, Vice-President

FILED  
Missouri Public  
Service Commission  
JI-2013-0373

GENERAL EXCHANGE TARIFF

P.S.C. MO No. 7  
NEW LONDON TELEPHONE COMPANY.  
d/b/a TDS Telecom  
Missouri

Section 11  
Second Revised Sheet 1  
Cancels First Revised Sheet 1

ACCESS SERVICES

CONCURRENCE

New London Telephone Company. d/b/a TDS Telecom hereby assents to, adopts and concurs in the Access Services as set forth in Section 11 of Stoutland Telephone Company, d/b/a TDS Telecom tariff, on file with the Missouri Public Service Commission and makes itself a party thereto and obligates itself to observe the provisions therein with the exceptions listed below.

EXCEPTIONS

D. RATES AND CHARGES

1. Common Line Access Service

		<u>Rate</u>	<u>Tariff Section Reference</u>
(a)	<u>Intrastate Carrier Common Line Access</u>		
	-Originating	\$0.013191	3.6
	-Terminating	\$0.00	3.6

2. Switched Access Service

		<u>Rate</u>	<u>Tariff Section Reference</u>
(b)	<u>Local Transport</u>		
	4. <u>Tandem Switched Transport</u>		
	b. <u>Tandem Switched Termination</u>		
	Per Access Minute Per Termination		6.2.(A)(3)(c)
	-Originating	\$0.010782	

(D)

ISSUED: May 30, 2014

EFFECTIVE: July 1, 2014

By: Joel Dohmeier, Vice-President

FILED  
Missouri Public  
Service Commission  
JI-2014-0516

**GENERAL EXCHANGE TARIFF**

**P.S.C. MO. No. 8  
NEW LONDON TELEPHONE COMPANY  
d/b/a MISSOURICOM**

**Section 11  
Original Sheet No. 1.1**

**ACCESS SERVICES**

	<u>Rate</u>	(N)
(c) <u>8YY (Toll Free) Originating Access Services</u>		
(1) Carrier Common Line (CCL)	**	
(2) End Office Switching	**	
(3) Joint Tandem Switched Transport	**	
(4) Toll Free Data Base Access	**	(N)

\*\*The Company concurs with the rates, terms and conditions of NECA's Tariff FCC No. 5 for this element, which (T)  
can be viewed at <https://www.neca.org/member-services/tariff-5>

Issued: June 15, 2021

Garrin Bott, President  
101 Main Street, P.O. Box 175  
New Florence, MO 63363-0175

Effective: July 1, 2021

**FILED**  
Missouri Public  
Service Commission  
JI-2021-0241

GENERAL EXCHANGE TARIFF

P.S.C. MO No. 7  
NEW LONDON TELEPHONE COMPANY.  
d/b/a TDS Telecom  
Missouri

Section 11  
Original Sheet 2

---

ACCESS SERVICES

D. RATES AND CHARGES (Continued)

3 Special Access Service

	<u>Monthly Rates</u>	<u>Nonrecurring Charges</u>	<u>Tariff Section Reference</u>
a. Channel Termination, per termination*			
(2) Metallic Channel Two-Wire	Not Available		7.1.1(A)

\* The Channel Termination rate includes non-chargeable Channel Interfaces as set forth in 7.1.4.

5 Miscellaneous Services

e. Operator Transfer Service                      Not Available

---

ISSUED: February 27, 2013

EFFECTIVE: March 29, 2013

By: Joel Dohmeier, Vice-President

FILED  
Missouri Public  
Service Commission  
JI-2013-0373