

Name of Utility: Confluence Rivers Utility Operating Company, Inc.
Service Area: All Service Areas

Rules & Regulations Governing Rendering of Water Service

AREA MAP FOR MAJESTIC LAKES DEVELOPMENT PLAN

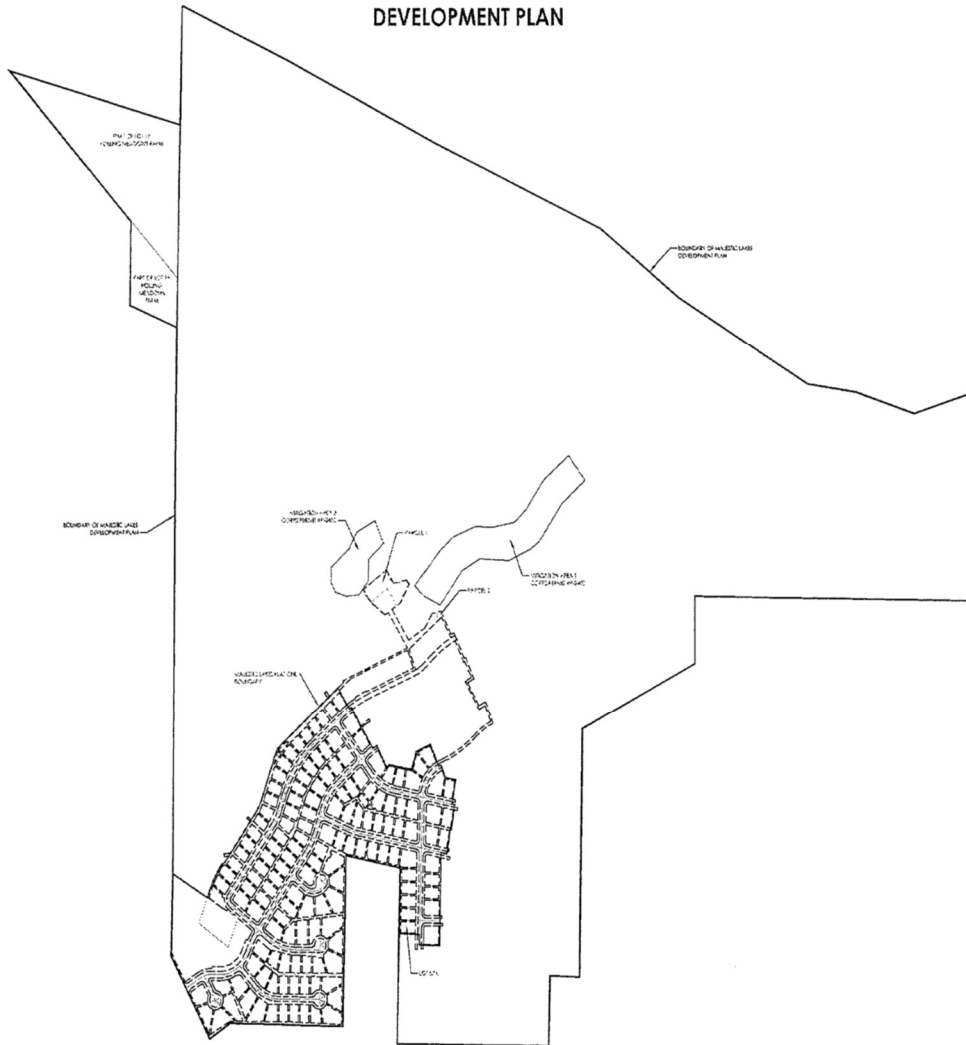

- * Indicates new rate or text
- + Indicates change

DATE OF ISSUE May 13, 2019
Month Day Year

DATE EFFECTIVE June 13, 2019
Month Day Year

ISSUED BY Josiah Cox, President, 500 Northwest Plaza Drive, Suite 500, St. Ann, MO 63074
name of officer, title, address

Name of Utility: Confluence Rivers Utility Operating Company, Inc.
 Service Area: All Service Areas

Rules & Regulations Governing Rendering of Water Service

Legal Description of Service Area – Majestic Lakes

0240-16 Majestic Lakes Service Area
 Lincoln County, Missouri

The area served consists of part of Sections 10, 11 and 15, Township 48 North, Range 1 East of the 5th P.M., Lincoln County, Missouri and being more particularly described as follows:

Beginning at the northeast corner of said Section 15; thence along the east line of said Section 15 S00°59'42"W 1332.37 feet; thence leaving said east line N88°15'24"W 197.30 feet; thence S01°41'03"W 376.36 feet; thence N89°14'34"W 1015.49 feet; thence N01°28'05"E 942.30 feet; thence N79°30'42"W 370.02 feet; thence S01°27'38"W 916.99 feet; thence N87°30'56"W 355.33 feet; thence N89°19'54"W 396.80 feet; thence S58°59'48"W 162.25 feet to the east right-of-way line of Missouri Route "MM"; thence along said east right-of-way line N29°55'58"W 514.00 feet; thence leaving said east right-of-way line N01°33'16"E 440.76 feet; thence N00°38'06"E 837.38 feet; thence N00°38'06"E 1393.35 feet; thence N00°52'17"E 717.14 feet; thence N69°22'02"W 334.89 feet; thence N00°53'53"E 454.40 feet; thence N45°08'32"W 1087.11 feet to the right-of-way line of Rolling Meadows Drive; thence along said right-of-way line along a curve deflecting to the left having a radius of 60.00 feet, an arc length of 32.06 feet, a chord course of N29°33'10"E 31.68 feet; thence leaving said right-of-way line S75°45'08"E 1119.78 feet; thence N01°15'48"E 637.83 feet to the centerline of the Cuivre River; thence along the centerline of the Cuivre River the following courses: S67°31'44"E 770.62 feet, S65°37'42"E 1066.16 feet, S67°23'37"E 490.95 feet, S67°23'40"E 716.99 feet, S54°25'47"E 644.56 feet, S61°43'00"E 986.96 feet, S82°17'04"E 325.80 feet, S73°13'04"E 407.39 feet, N73°48'28"E 423.55 feet; thence leaving said centerline S00°04'18"W 1127.42 feet; thence N89°11'12"W 1882.05 feet; thence S00°06'19"W 364.02 feet; thence S64°57'24"W 834.48 feet to the point of beginning.

DATE OF ISSUE May 13, 2019
 Month Day Year

DATE EFFECTIVE June 12, 2019
 Month Day Year

ISSUED BY Josiah Cox, President, 500 Northwest Plaza Drive, Suite 500, St. Ann, MO 63074
 name of officer, title, address

Name of Utility: Confluence Rivers Utility Operating Company, Inc.
Service Area: All Service Areas

Rules & Regulations Governing Rendering of Water Service

Schedule of Rates – Majestic Lakes

Availability:

These rates are available to any water customer on Company’s mains for supplying water service requested:

\$35.00/month

Taxes:

Any applicable Federal, State, or local taxes computed on billing basis shall be added as separate items in rendering each bill.

Late Charges:

Billings will be made and distributed at monthly intervals. Bills will be rendered net, bearing the last date on which payment will then be considered delinquent. The period after which payment will then be considered delinquent is 21 days after rendition of the bill. A charge of \$5.00 or three percent (3%) per month times the unpaid balance, whichever is more, will be added to delinquent amounts.

- * Indicates new rate or text
- + Indicates change

DATE OF ISSUE May 13, 2019
Month Day Year

DATE EFFECTIVE June 12, 2019
Month Day Year

ISSUED BY Josiah Cox, President, 500 Northwest Plaza Drive, Suite 500, St. Ann, MO 63074
name of officer, title, address