

NO SUPPLEMENT TO THIS TARIFF WILL BE ISSUED EXCEPT FOR THE PURPOSE OF CANCELING THIS TARIFF.

P. S. C. Mo. No. 17

Pacific, Missouri

2nd REVISED SHEET 2  
1st REVISED SHEET 2

### BASE RATE AREA MAP

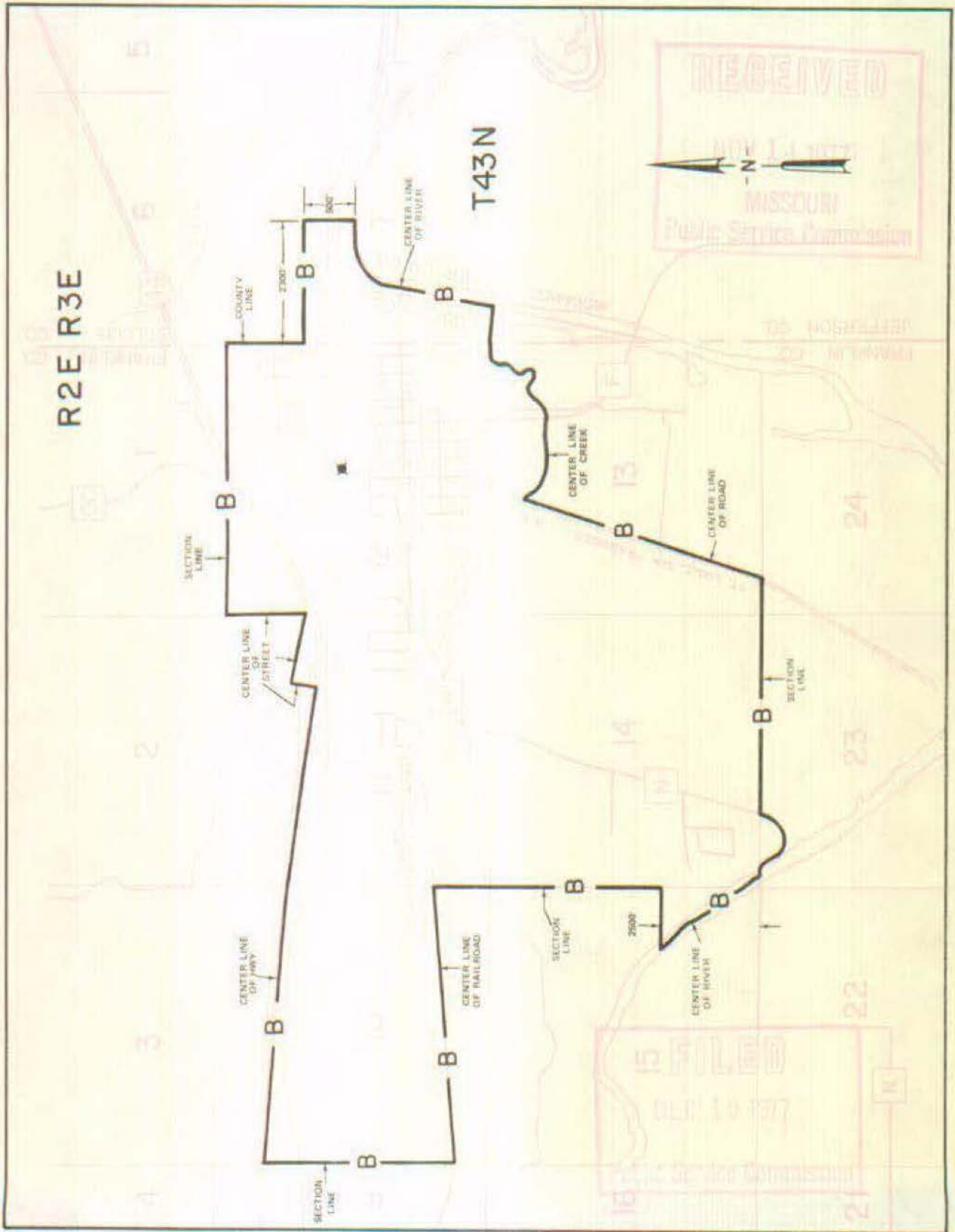

By R. R. SHOCKLEY, Vice President, Missouri  
Southwestern Bell Telephone Company

Issued: November 18, 1977

St. Louis, Missouri

Effective: December 19, 1977

EXCHANGE AREA MAP

9th REVISED SHEET 3  
REPLACING 8th REVISED SHEET 3

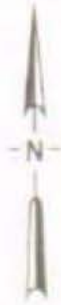
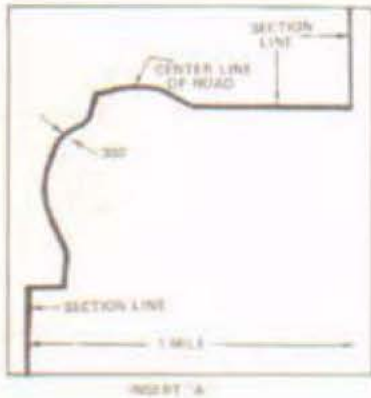
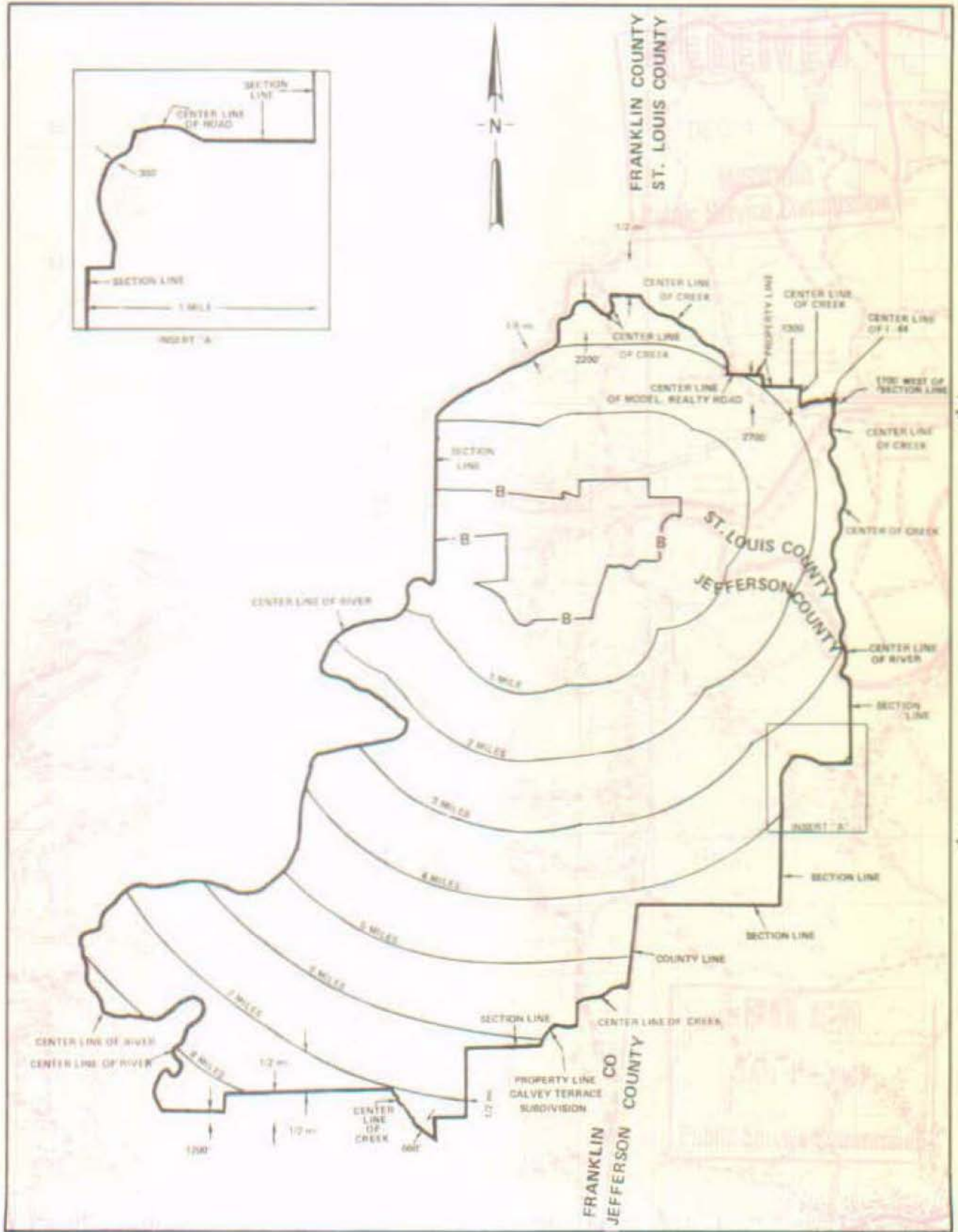

R1E | R2E

R2E | R3E

By R.D. BARRON, PRESIDENT—MISSOURI DIVISION  
Southwestern Bell Telephone Company  
St. Louis, Missouri

SBC PSC MO #17  
Patton, Missouri  
1<sup>st</sup> Revised Sheet 2  
Replacing Original Sheet 2

# Non-Scannable Map

(Is viewable in the Data Center  
200 Madison Street, 1<sup>st</sup> Floor  
Jefferson City MO)



NO SUPPLEMENT TO THIS TARIFF WILL BE ISSUED EXCEPT FOR THE PURPOSE OF CANCELING THIS TARIFF.

P. S. C. Mo. No. 17

Patton, Missouri

EXCHANGE AREA MAP

11th REVISED SHEET 3 REPLACING 10th REVISED SHEET 3

RECEIVED

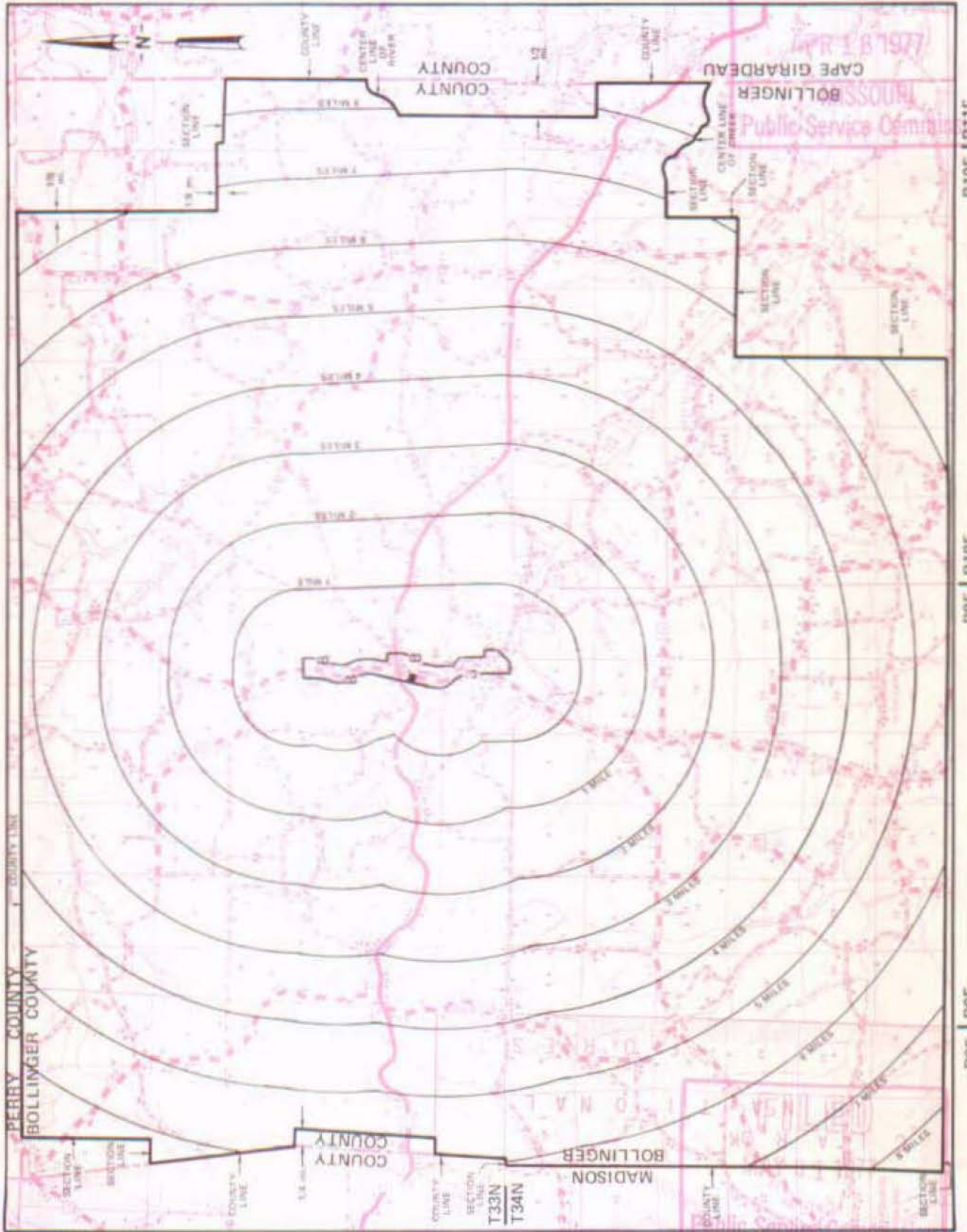

T32N  
T33N

By R. R. SHOCKLEY, Vice President, Missouri  
Southwestern Bell Telephone Company  
St. Louis, Missouri

T34N  
T35N

Issued: April 20, 1977

Effective: May 31, 1977

PATTONVILLE

SEE

St. Louis District Exchange Rates

under

St. Louis

June 1, 1937

NO SUPPLEMENT TO THIS TARIFF WILL BE ISSUED EXCEPT FOR THE PURPOSE OF CANCELING THIS TARIFF.

Paynesville, Missouri  
ORIGINAL SHEET 2  
REPLACING ORIGINAL SHEET 1-A

P. S. C. Mo. No. 17

BASE RATE AREA MAP

RECEIVED  
OCT 14 1950  
MISSOURI  
Public Service Comm.

FILED

NOV 15 1950

PUBLIC SERVICE COMMISSIC

PAYNESVILLE, MO.

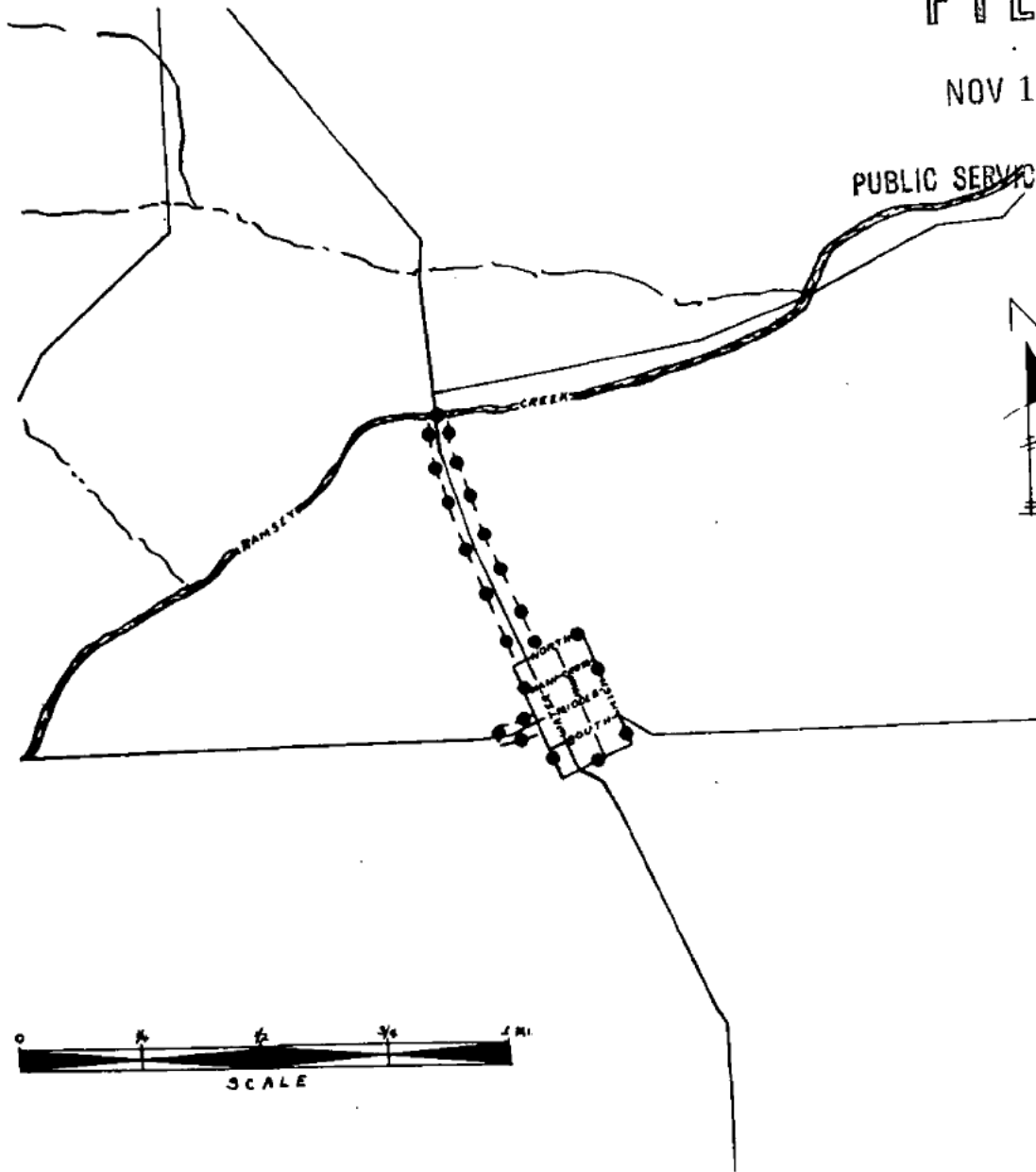

CODE	
BELL CENTRAL OFFICE:	◆
BASE RATE AREA LIMITS:	◆—◆—◆

Issued: October 16, 1950

Effective: November 15, 1950

By H. R. TOWLES, General Manager  
Southwestern Bell Telephone Company  
St. Louis, Mo.



NO SUPPLEMENT TO THIS TARIFF WILL BE ISSUED EXCEPT FOR THE PURPOSE OF CANCELING THIS TARIFF.

# P. S. C. Mo. No. 17 EXCHANGE AREA MAP

**RECEIVED**  
Paynesville, Missouri  
8th REVISED SHEET 3  
REPLACING 7th REVISED SHEET 3  
JUL 11 1977  
MISSOURI  
Public Service Commission

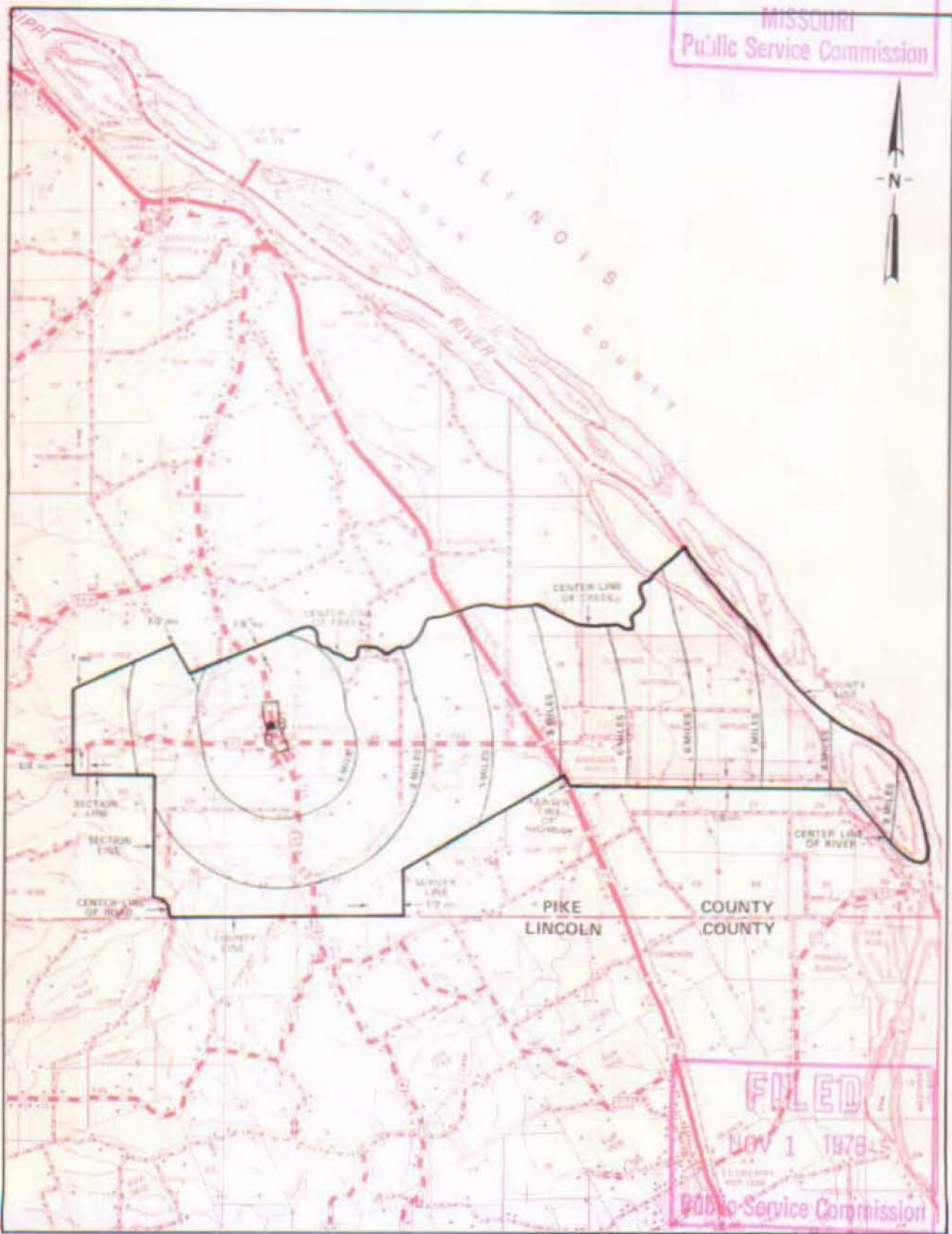

T54N  
T53N

T53N  
T52N

T52N  
T51N

**FILED**  
NOV 1 1978  
Public Service Commission

R1W | R1E

R1E | R2E

By R. R. SHOCKLEY, Vice President, Missouri  
Southwestern Bell Telephone Company  
St. Louis, Missouri

NOV 1 - 1978

Issued: July 11, 1977

Effective: \_\_\_\_\_

SBC PSC MO #17  
Perryville, Missouri  
2<sup>nd</sup> Revised Sheet 2  
Replacing 1<sup>st</sup> Revised Sheet 2

# Non-Scannable Map

(Is viewable in the Data Center  
200 Madison Street, 1<sup>st</sup> Floor  
Jefferson City MO)



NO SUPPLEMENT TO THIS TARIFF WILL BE ISSUED EXCEPT FOR THE PURPOSE OF CANCELING THIS TARIFF.

### P. S. C. Mo. No. 17 EXCHANGE AREA MAP

Perryville, Missouri

13th REVISED SHEET 3  
REPLACING 12th REVISED SHEET 3

RECEIVED  
NOV 7, 1991

MO. PUBLIC SERVICE COMM.

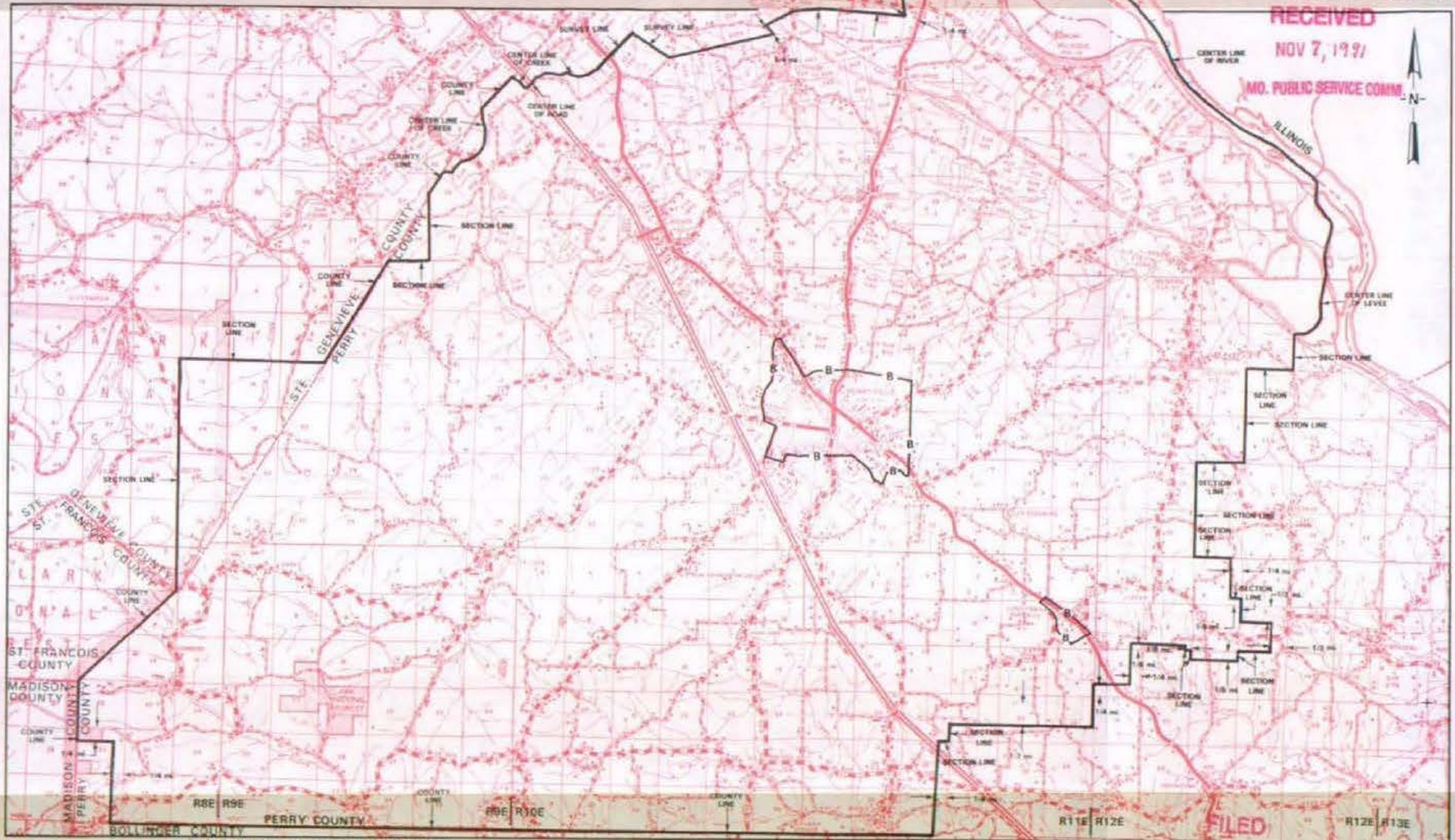

T36N  
T35N

T35N  
T34N

FILED

Issued: November 12, 1991

By R. D. BARRON, President, Missouri Division  
Southwestern Bell Telephone Company  
St. Louis, Missouri

DEC 18, 1991

Effective: December 18, 1991

Public Service Commission

NO SUPPLEMENT TO THIS TARIFF WILL  
BE ISSUED EXCEPT FOR THE PURPOSE OF  
CANCELING THIS TARIFF.

Pierce City, Missouri  
FIRST REVISED SHEET 2  
REPLACING ORIGINAL SHEET 2

P. S. C.-Mo. No. 17

**BASE RATE AREA MAP**

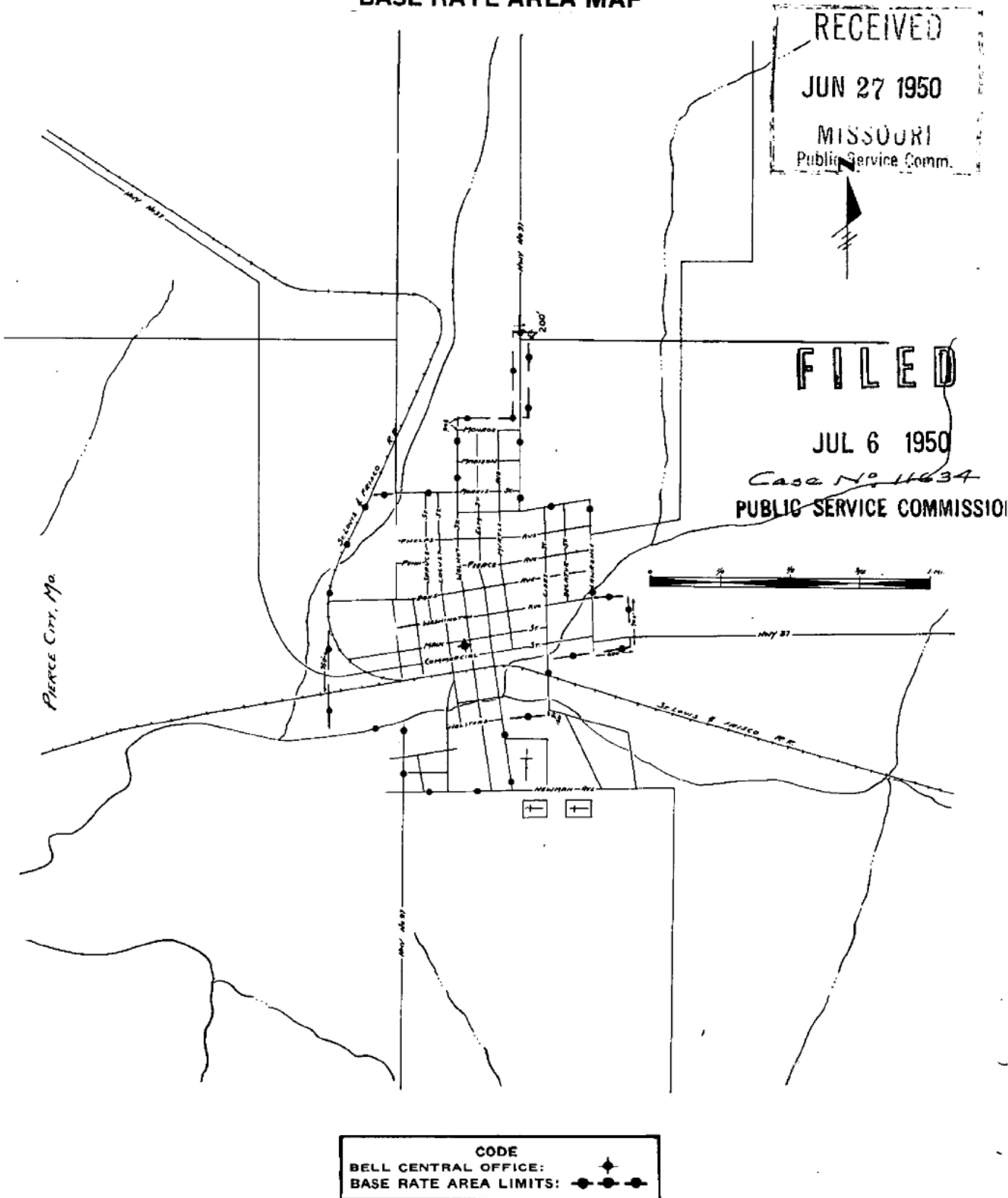

Issued: June 27, 1950

By H. R. TOWLES, General Manager  
Southwestern Bell Telephone Company  
St. Louis, Missouri

Effective: July 6, 1950



NO SUPPLEMENT TO THIS TARIFF WILL BE ISSUED EXCEPT FOR THE PURPOSE OF CANCELING THIS TARIFF.

Pierce City, Missouri

# P. S. C. Mo. No. 17 EXCHANGE AREA MAP

11th REVISED SHEET 3  
REPLACING 10th REVISED SHEET 3

RECEIVED

JUL 6 1990

MISSOURI  
Public Service Commission

T27N  
T26N

T26N  
T25N

T25N  
T24N

R29W | R28W

R28W | R27W

R30W | R29W

By R. D. BARRON, PRESIDENT, MISSOURI DIVISION  
Southwestern Bell Telephone Company  
St. Louis, Missouri

Effective: August 10, 1990

Issued: July 9, 1990

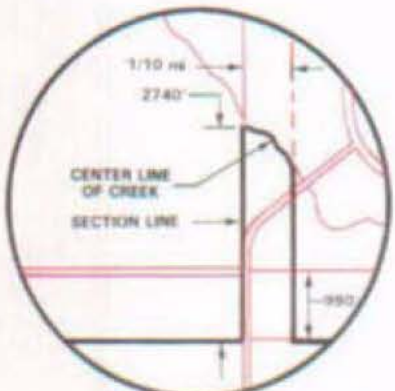

INSERT "A"



SEE INSERT "A"

FILED  
AUG 10 1990

Public Service Commission



NO SUPPLEMENT TO THIS TARIFF WILL BE ISSUED EXCEPT FOR THE PURPOSE OF CANCELING THIS TARIFF.

Missouri Portion-Pittsburg, Kansas

P. S. C. Mo. No. 17

REPLACING 100th REVISED SHEET 1A

EXCHANGE AREA MAP

RECEIVED  
11th REVISED SHEET 1A  
DEC 1 1977  
MISSOURI  
Public Service Commission

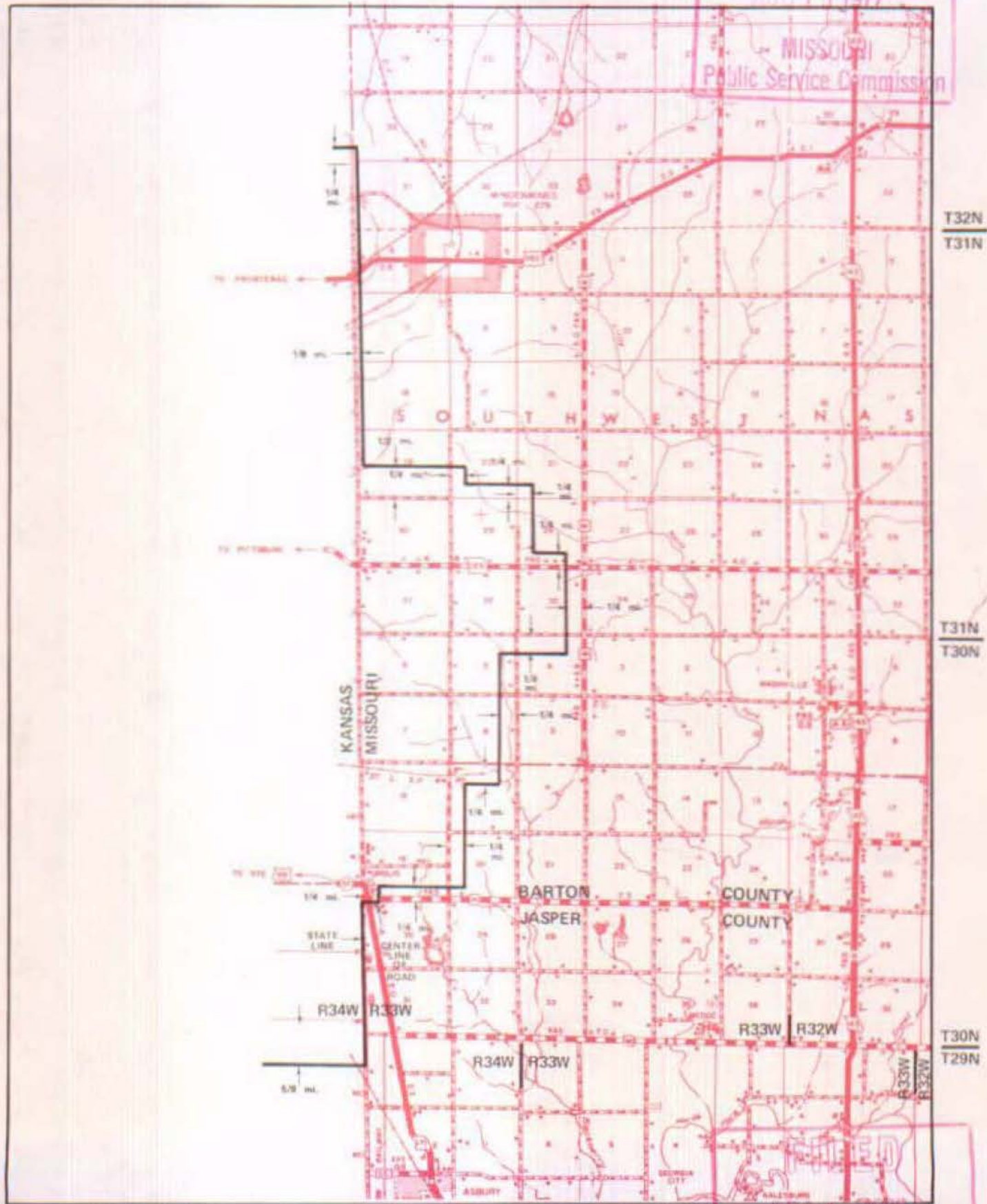

By R. R. SHOCKLEY, Vice President, Missouri  
Southwestern Bell Telephone Company  
St. Louis, Missouri

FILED  
DEC 1 1978  
Public Service Commission  
Effective: DEC 1 1978

SBC PSC MO #17

Pocahontas – New Wells, Missouri  
Original Sheet 2

# Non-Scannable Map

(Is viewable in the Data Center  
200 Madison Street, 1<sup>st</sup> Floor  
Jefferson City MO)



NO SUPPLEMENT TO THIS TARIFF WILL BE ISSUED EXCEPT FOR THE PURPOSE OF CANCELING THIS TARIFF.

P. S. C. Mo. No. 17

Pocahontas-New Wells, Missouri

### EXCHANGE AREA MAP

4th REVISED SHEET 3  
REPLACING 3rd REVISED SHEET 3

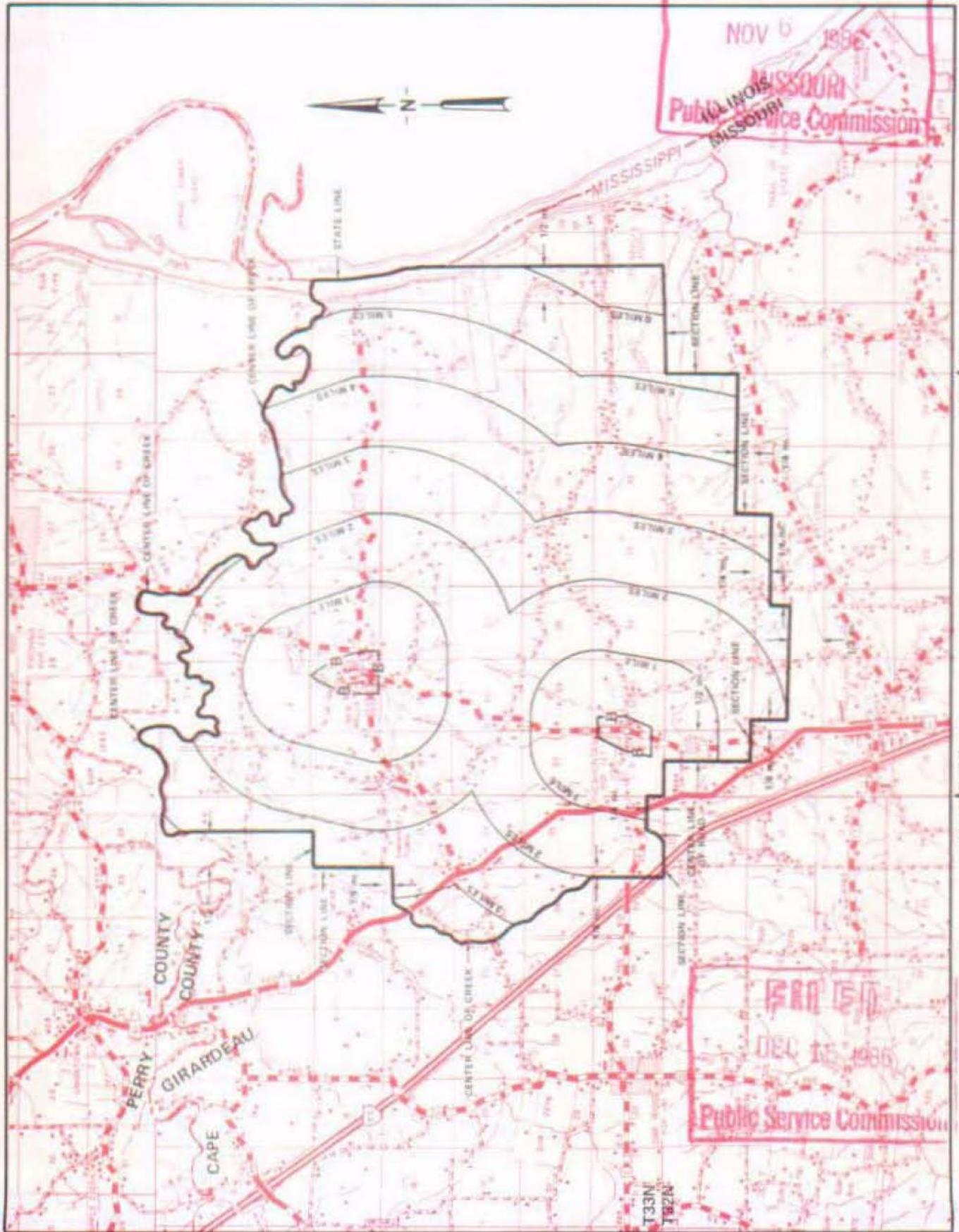

NOV 6 1986  
MISSOURI  
Public Service Commission

FR 150  
DEC 15 1986  
Public Service Commission

By R. D. BARRON, President, Missouri Division  
Southwestern Bell Telephone Company  
St. Louis, Missouri

Issued: NOVEMBER 10, 1986

Effective: DECEMBER 15, 1986



NO SUPPLEMENT TO THIS TARIFF WILL BE ISSUED EXCEPT FOR THE PURPOSE OF CANCELING THIS TARIFF.

P. S. C. Mo. No. 17

Pond, Missouri

BASE RATE AREA MAP

REPLACING 5th REVISED SHEET 2  
4th REVISED SHEET 2

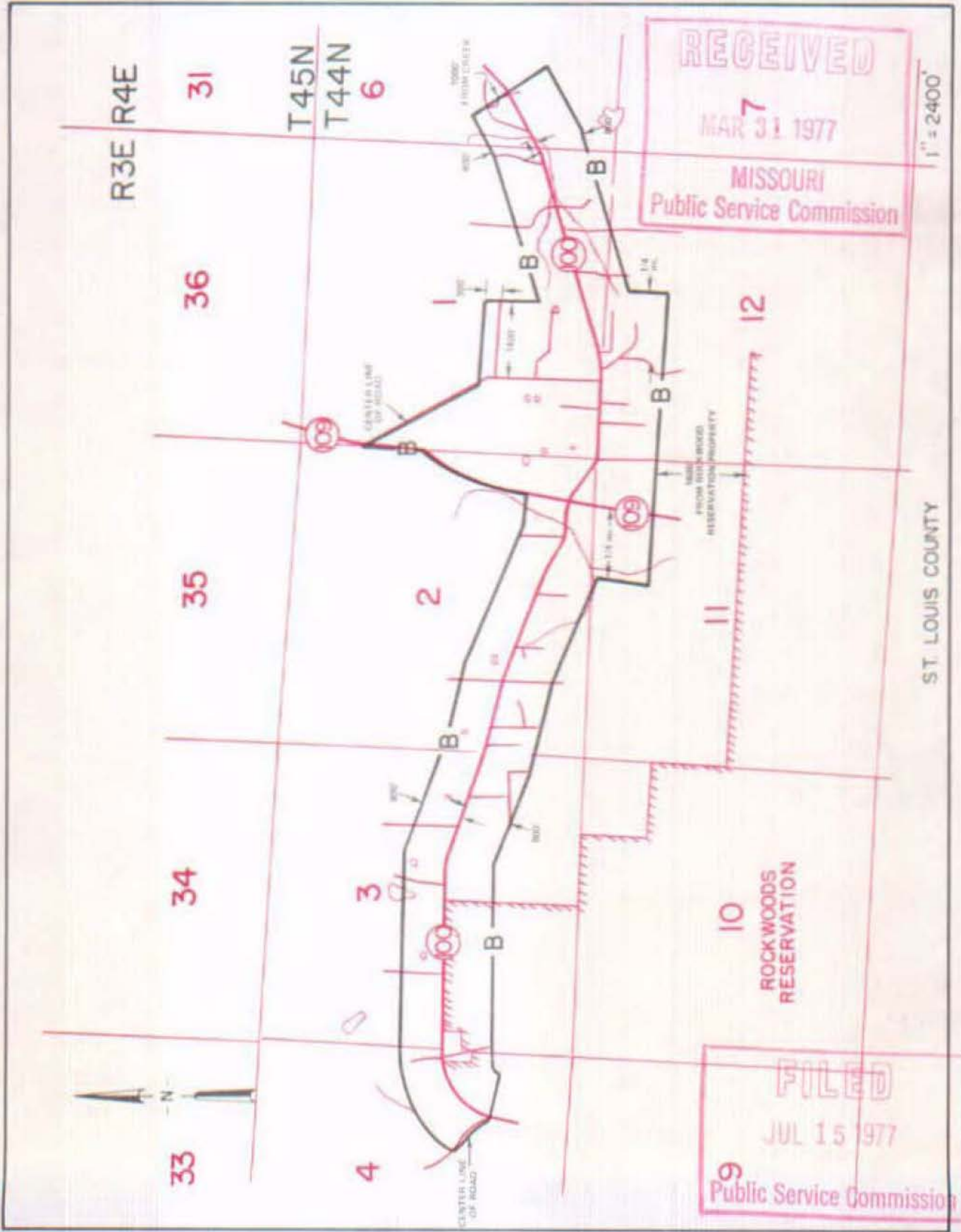

By R. R. SHOCKLEY, Vice President, Missouri  
Southwestern Bell Telephone  
St. Louis, Missouri

Issued: APR 4 1977

Effective: JUL 15 1977



NO SUPPLEMENT TO THIS TARIFF WILL BE ISSUED EXCEPT FOR THE PURPOSE OF CANCELING THIS TARIFF.

# P. S. C. Mo. No. 17 EXCHANGE AREA MAP

Pond, Missouri  
16th REVISED SHEET 3  
REPLACING 15th REVISED SHEET 3

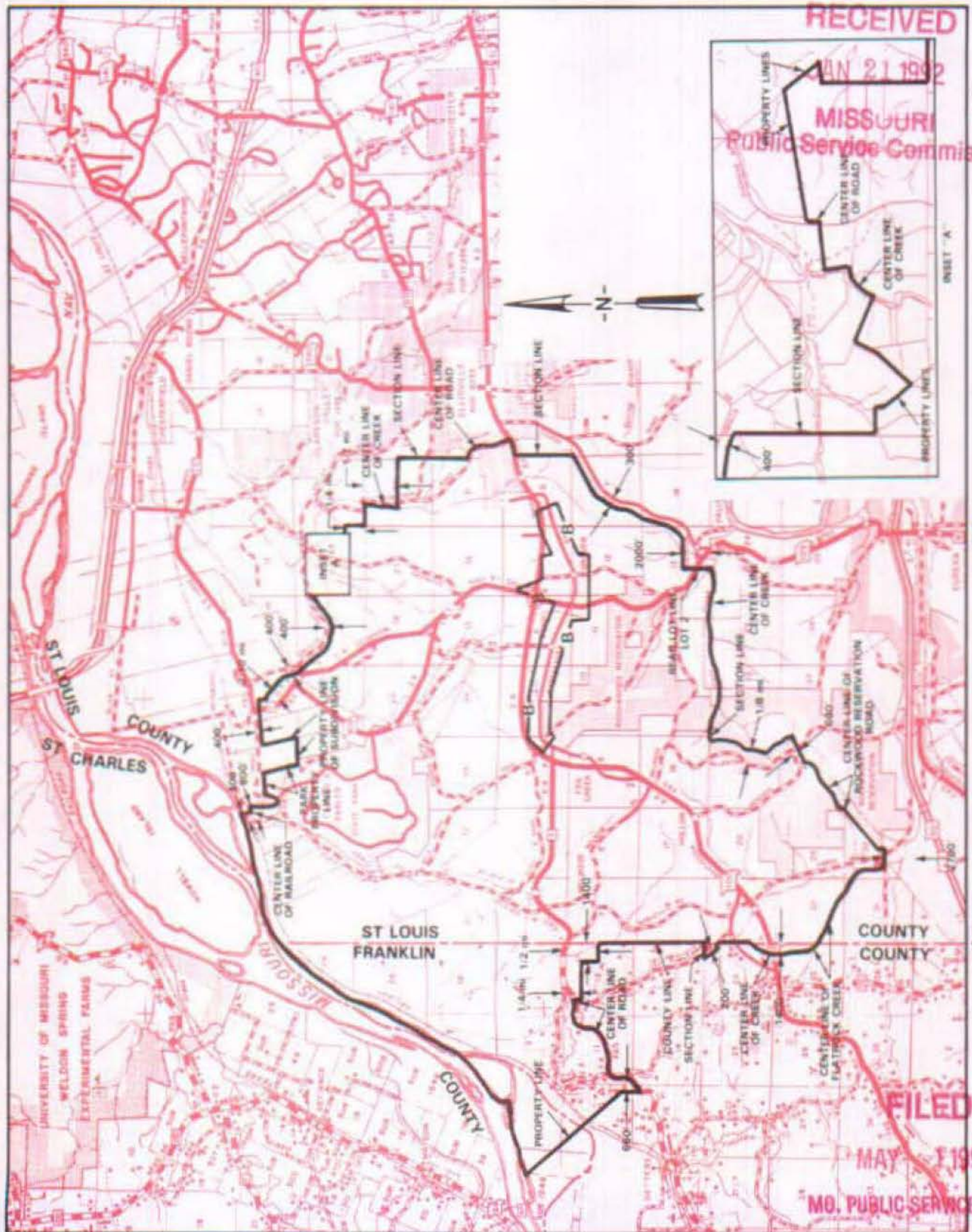

RECEIVED

JAN 21 1992

MISSOURI  
Public Service Commission

R5E  
R4E

R4E  
R3E

R3E  
R2E

FILED

MAY 1 1992

MO. PUBLIC SERVICE COMM.

T46N | T45N

T45N | T44N

T44N | T43N

JAN 23 1992

By R. D. BARRON, President, Missouri Division  
Southwestern Bell Telephone Company  
St. Louis, Missouri

MAY 01 1992

Issued: \_\_\_\_\_

Effective: \_\_\_\_\_



NO SUPPLEMENT TO THIS TARIFF WILL BE ISSUED EXCEPT FOR THE PURPOSE OF CANCELING THIS TARIFF.

15th REVISED SHEET 3  
REPLACING 14th REVISED SHEET 3

### P. S. C. Mo. No. 17 EXCHANGE AREA MAP

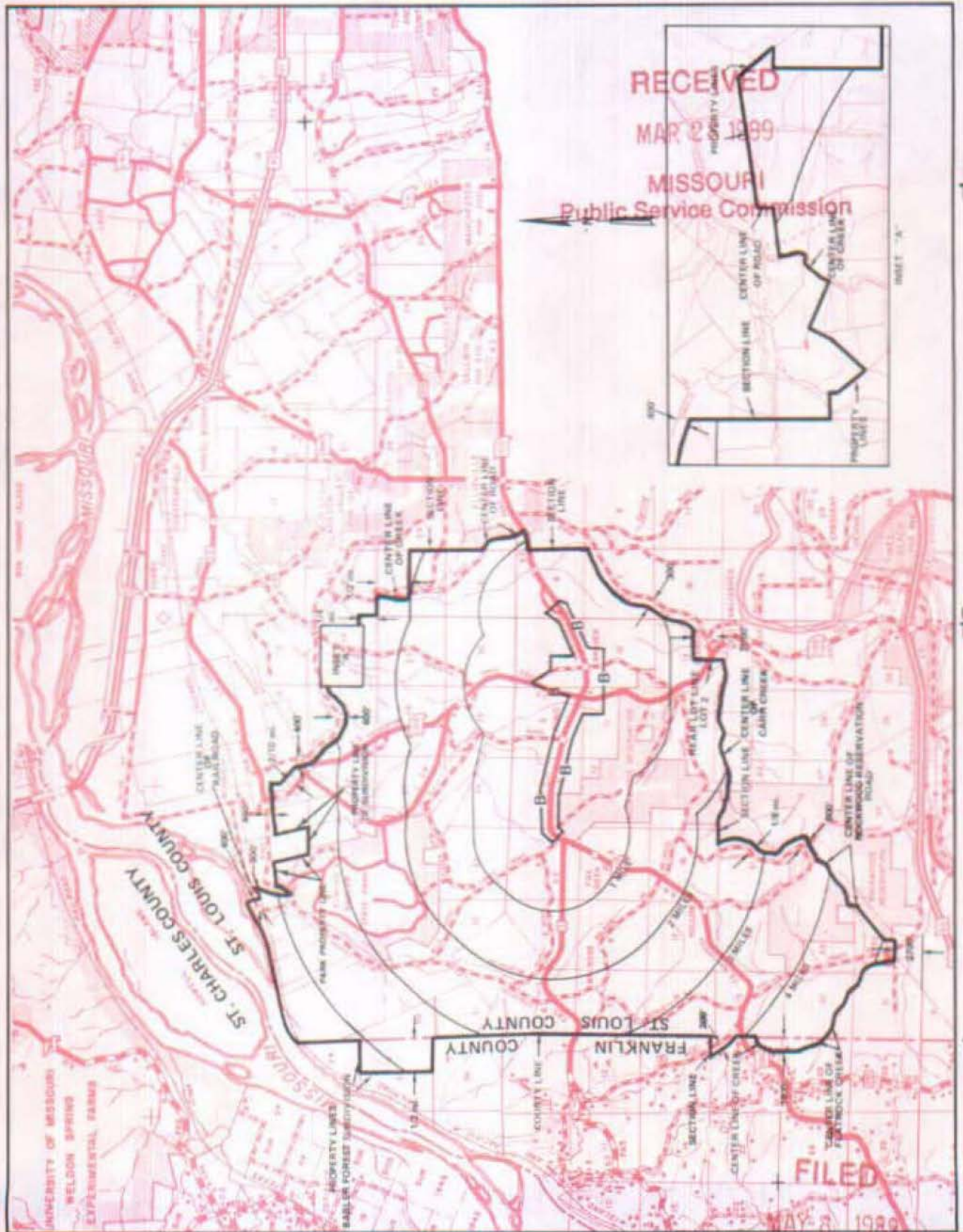

R5E  
R4E

R4E  
R3E

R3E  
R2E

T46N | T45N

T45N | T44N

T44N | T43N

By R. D. BARRON, PRESIDENT, MISSOURI DIVISION  
Southwestern Bell Telephone Company  
St. Louis, Missouri

Public Service Commission

Issued: April 7, 1989

Effective: May 8, 1989



SBC PSC MO #17  
Poplar Bluff, Missouri  
1<sup>st</sup> Revised Sheet 2  
Replacing Original Sheet 2

# Non-Scannable Map

(Is viewable in the Data Center  
200 Madison Street, 1<sup>st</sup> Floor  
Jefferson City MO)

NO SUPPLEMENT TO THIS TARIFF WILL BE ISSUED EXCEPT FOR THE PURPOSE OF CANCELING THIS TARIFF.

### P. S. C. Mo. No. 17 EXCHANGE AREA MAP

Poplar Bluff, Missouri

REPLACING REVISED SHEET 3  
REVISED SHEET 3

RECEIVED

DEC 23 1997

MO. PUBLIC SERVICE COMM

T26N  
T25N

T25N  
T24N

T24N  
T23N

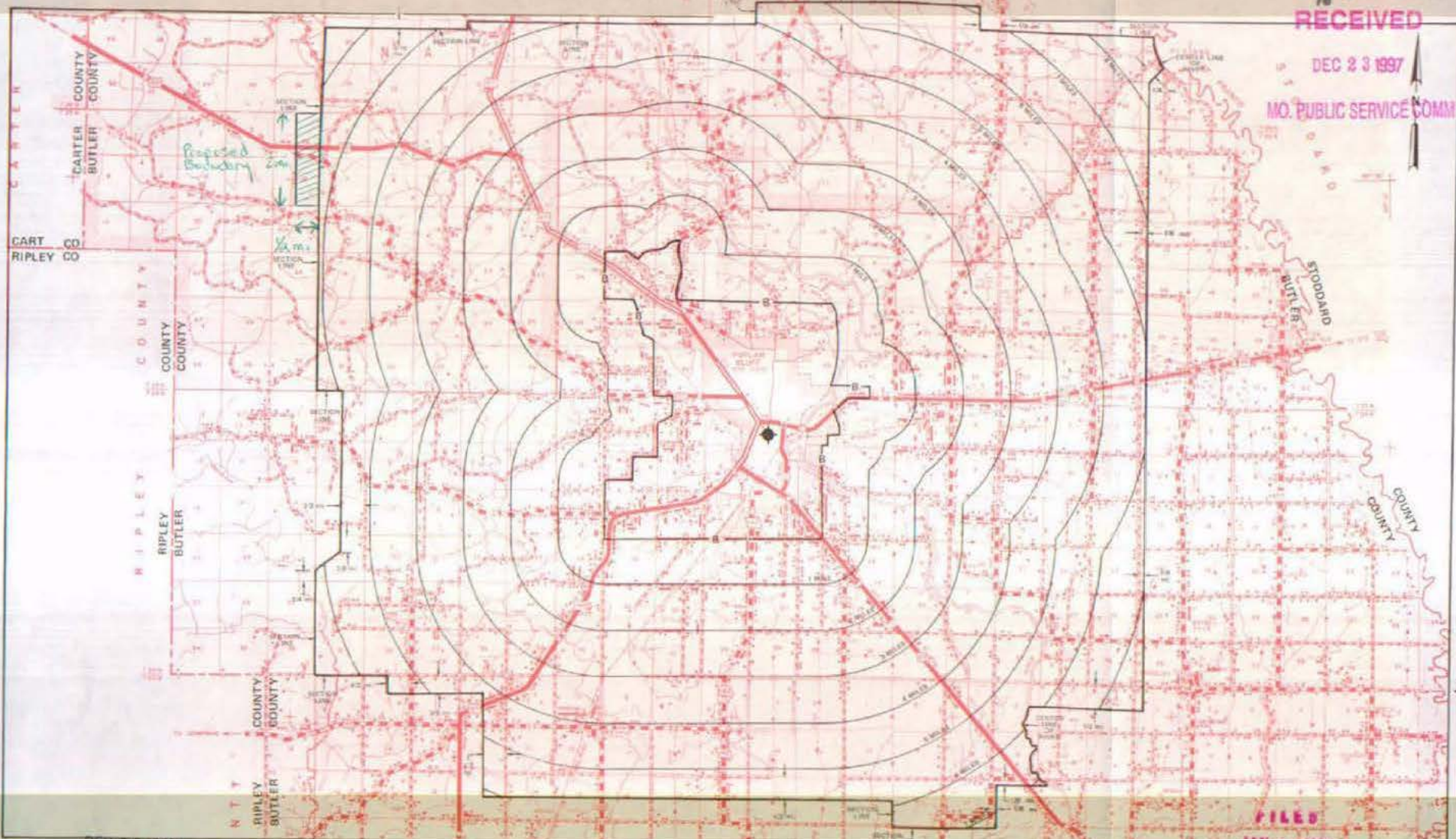

DEC 23 1997

FILED  
JAN 23 1998  
JAN 23 1998

Issued: ~~SEPTEMBER 20, 1996~~

By **R. H. SLOAN**, Vice President, Missouri  
Southwestern Bell Telephone Company  
St. Louis, Missouri

MO. PUBLIC SERVICE COMM  
Effective: APR 1, 1998



NO SUPPLEMENT TO THIS TARIFF WILL BE ISSUED EXCEPT FOR THE PURPOSE OF CANCELING THIS TARIFF.

P. S. C. Mo. No. 17

Portage Des Sioux, Missouri

BASE RATE AREA MAP

3rd REVISED SHEET 2  
REPLACING 2nd REVISED SHEET 2

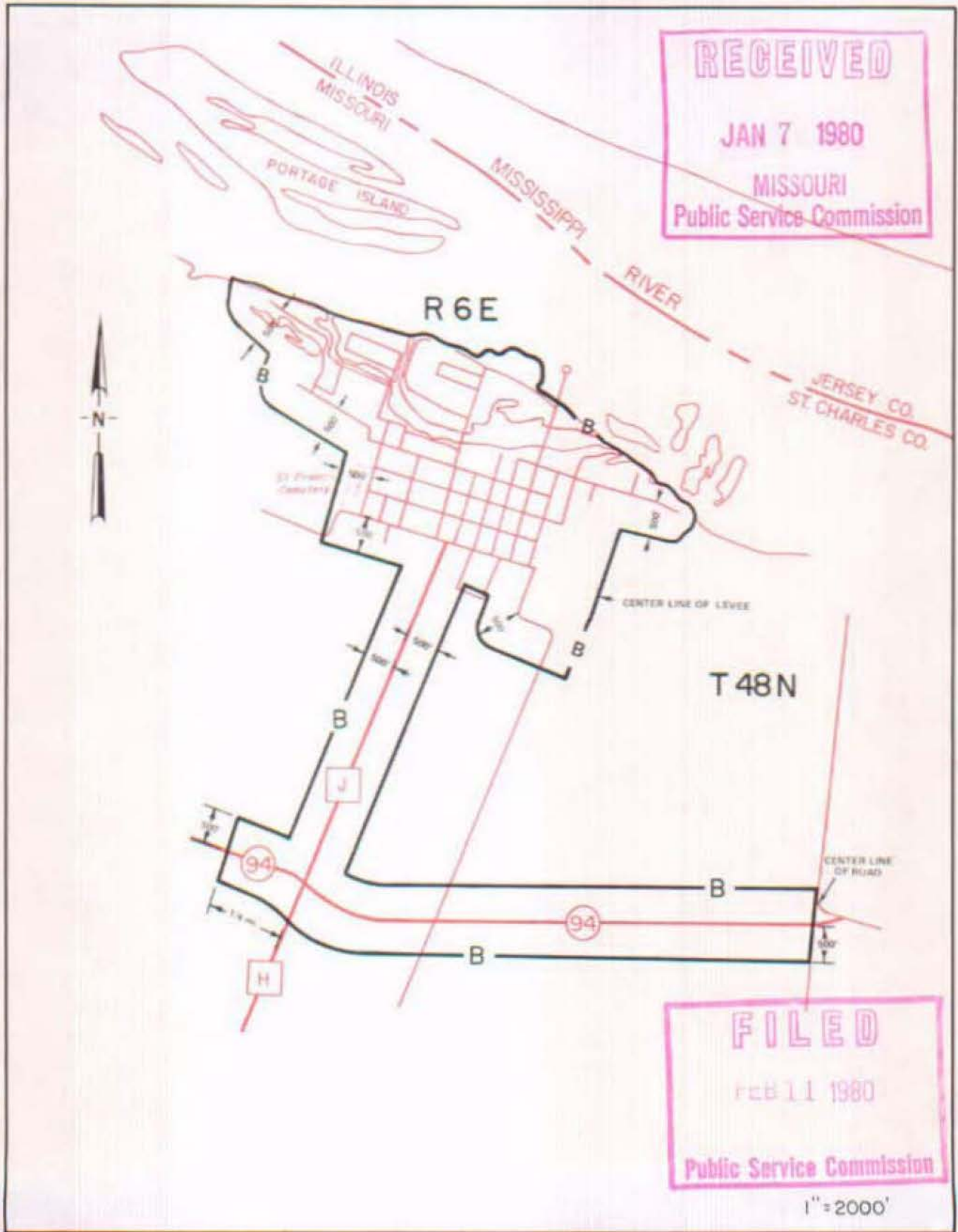

By R. R. SHOCKLEY, Vice President, Missouri  
Southwestern Bell Telephone  
St. Louis, Missouri

Issued: JANUARY 11, 1980

Effective: FEBRUARY 11, 1980



NO SUPPLEMENT TO THIS TARIFF WILL BE ISSUED EXCEPT FOR THE PURPOSE OF CANCELING THIS TARIFF.

P. S. C. Mo. No. 17

Portage Des Sioux, Missouri

EXCHANGE AREA MAP

6th REVISED SHEET 3  
REPLACING 5th REVISED SHEET 3

RECEIVED  
JAN 7 1980  
MISSOURI  
Public Service Commission

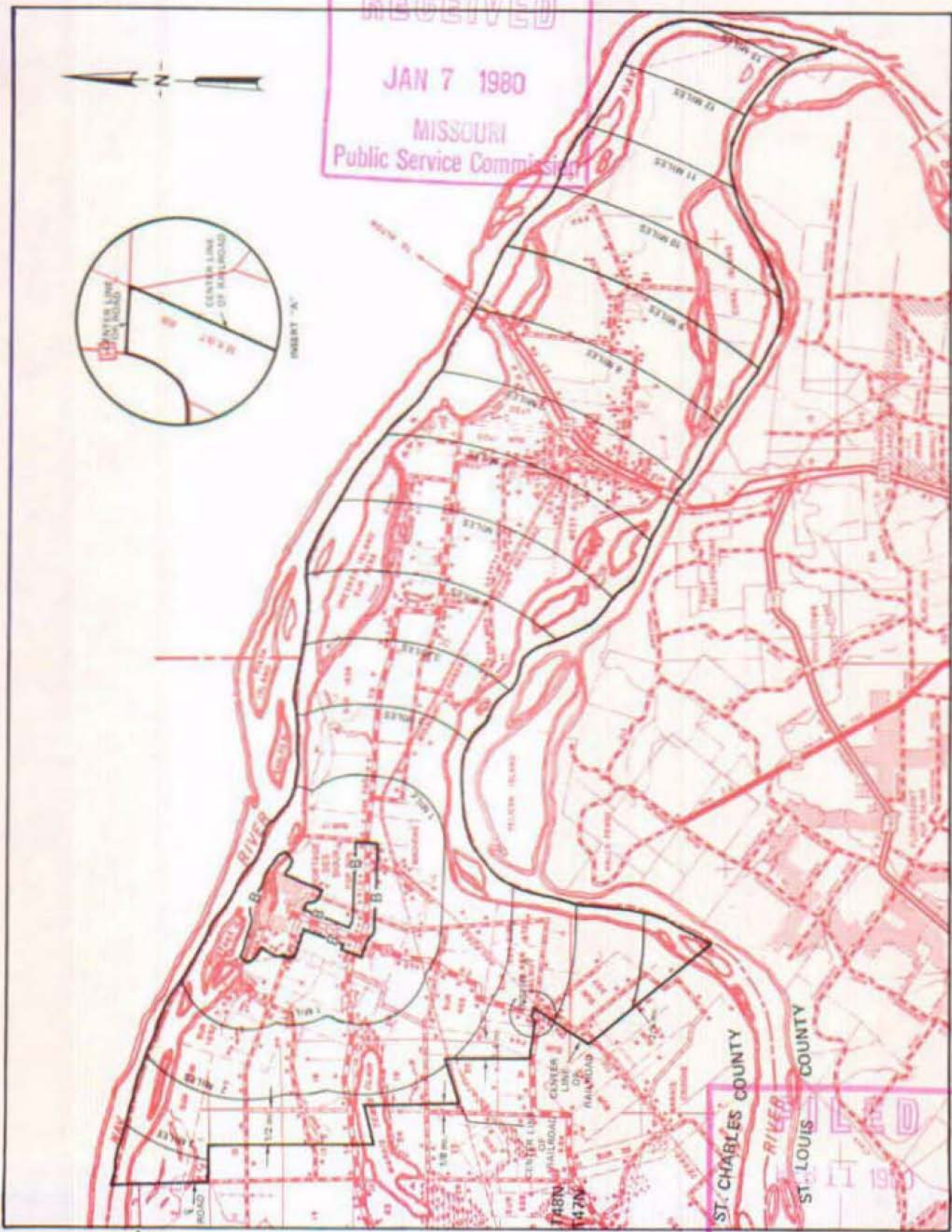

R7E R8E

R6E R7E

R5E R6E

T49N  
T48N

By R. R. SHOCKLEY, Vice President, Missouri  
Southwestern Bell Telephone Company

RECEIVED  
JAN 11 1980  
MISSOURI  
Public Service Commission

NO SUPPLEMENT TO THIS TARIFF WILL BE ISSUED EXCEPT FOR THE PURPOSE OF CANCELING THIS TARIFF.

Portageville, Mo.  
FIRST REVISED SHEET 1-A  
REPLACING ORIGINAL SHEET 1-A

P. S. C. Mo. No. 2  
SOUTHEAST MISSOURI TELEPHONE COMPANY  
INITIAL RATE AREA MAP

RECEIVED  
MAR 21 1950  
MISSOURI  
Public Service Comm.

PORTAGEVILLE, Mo.

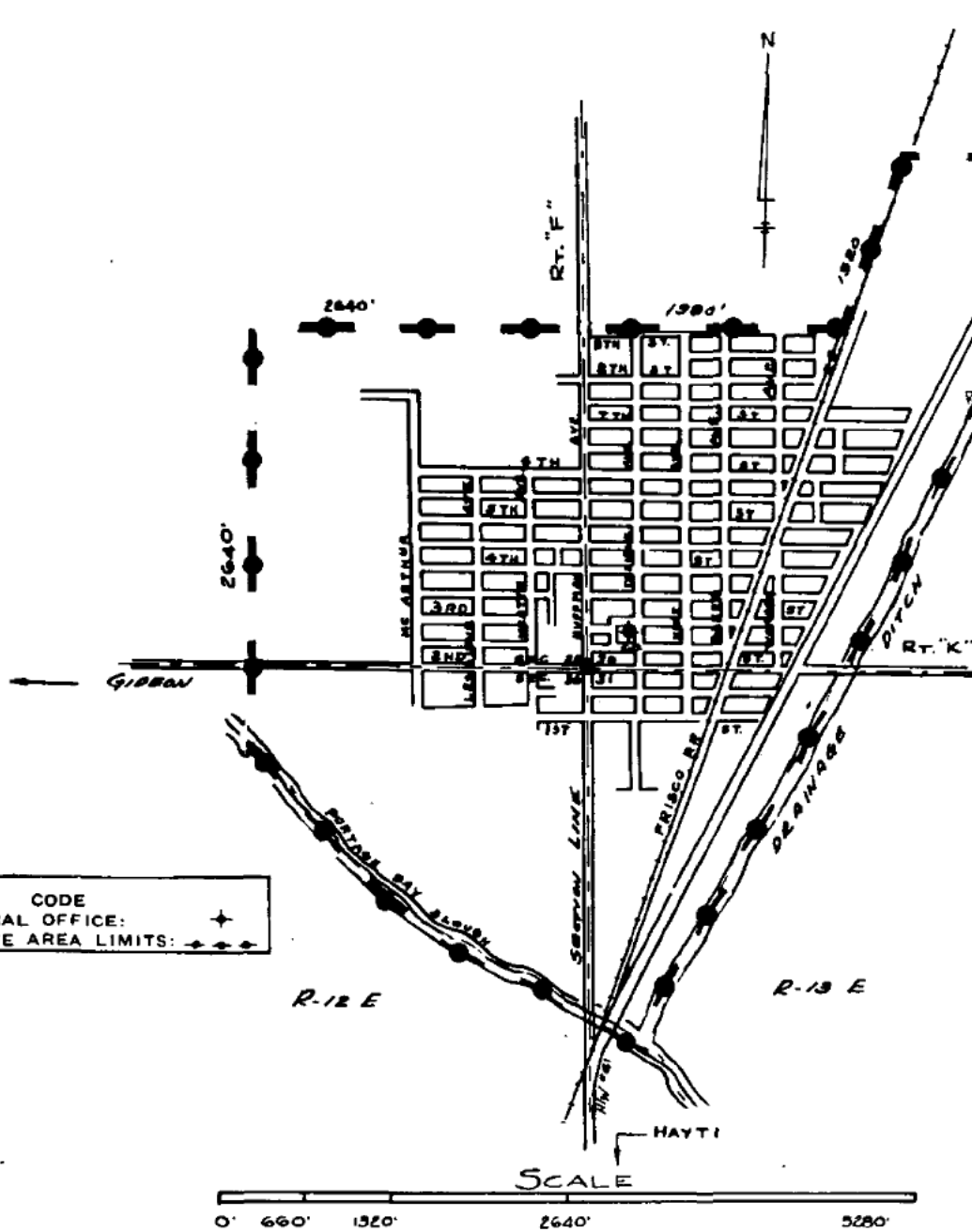

FILED  
MAR 21 1950  
Case No. 11742  
Public Service Commission

CODE  
CENTRAL OFFICE: +  
INITIAL RATE AREA LIMITS: - - - -

Issued: March 20, 1950

Effective: March 21, 1950

By C. W. BOUTIN, President and General Manager  
Cape Girardeau, Mo.



NO SUPPLEMENT TO THIS TARIFF WILL BE ISSUED EXCEPT FOR THE PURPOSE OF CANCELING THIS TARIFF.

P. S. C. Mo. No. 17  
**EXCHANGE AREA MAP**

Portageville, Missouri  
1<sup>st</sup> REVISED SHEET 2  
REPLACING ORIGINAL SHEET 2

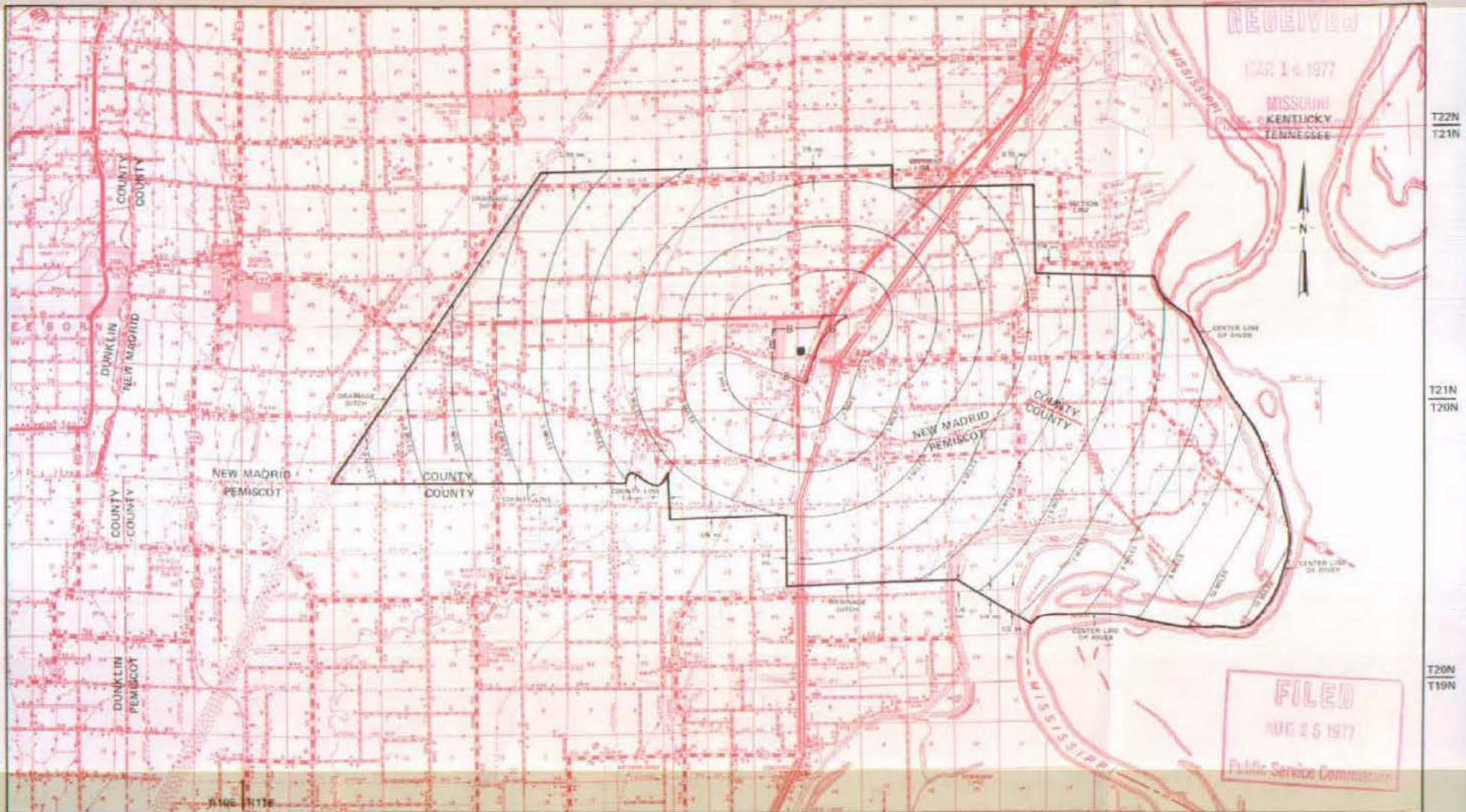

RECEIVED  
MAR 14 1977  
MISSOURI  
KENTUCKY  
TENNESSEE

FILED  
AUG 25 1977  
Public Service Commission

By R. R. SHOCKLEY, Vice President, Missouri  
Southwestern Bell Telephone Company  
St. Louis, Missouri

R11E | R12E

R12E | R13E

R13E | R14E

Issued March 15, 1977

Effective: AUG 25 1977



P.S.C. Mo.-No. 39  
Multiparty Elimination Designation  
Exchange Area Map

No supplement to this  
tariff will be issued  
except for the purpose  
of canceling this tariff.

Puxico, Missouri  
1st Revised Sheet 1  
Replacing Original Sheet 1

**RECEIVED**

**JUL 29 1993**

**MO. PUBLIC SERVICE COMM.**

This page is being held for future use.

**FILED**

**AUG 31 1993**

**MO. PUBLIC SERVICE COMM.**

Issued: **JUL 30 1993**

Effective: **AUG 31 1993**

By A. D. ROBERTSON, Assistant Vice President-External Affairs  
Southwestern Bell Telephone Company  
St. Louis, Missouri

NO SUPPLEMENT TO THIS TARIFF WILL  
BE ISSUED EXCEPT FOR THE PURPOSE OF  
CANCELING THIS TARIFF.

P. S. C. Mo. No. 17  
BASE RATE AREA MAP

Puxico, Missouri  
ORIGINAL SHEET 2  
REPLACING SOUTHEAST MISSOURI  
TELEPHONE COMPANY P. S. C. No. 2  
1st REVISED SHEET 1-A

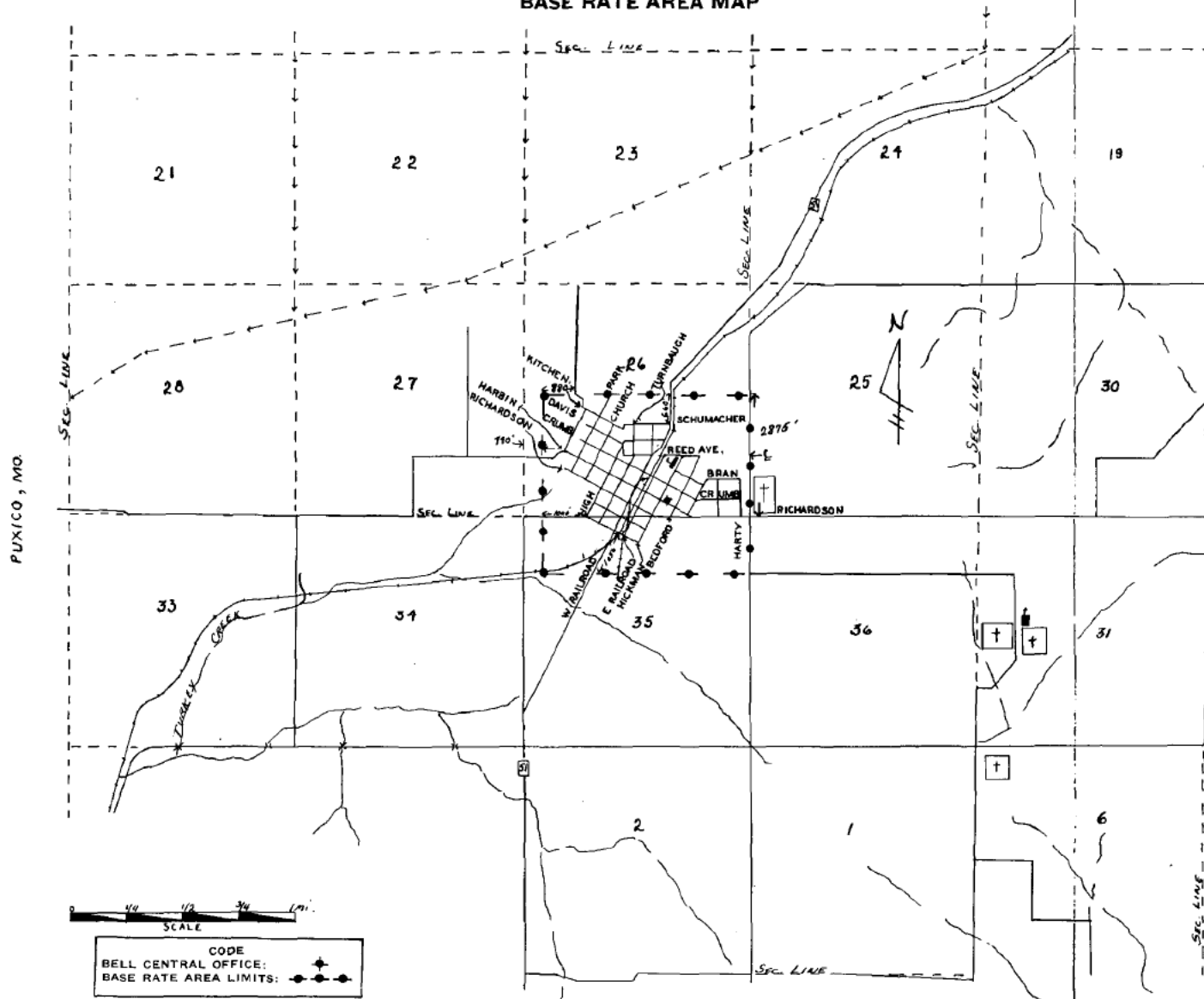

RECEIVED  
DEC 7 1955  
MISSOURI  
Public Service Comm.

FILED

JAN 8 1956

PUBLIC SERVICE COMMISSION

~~CANCELLED~~

~~SEP 27 1970~~

BY  
PUBLIC SERVICE COMMISSION  
OF MISSOURI

Issued: December 8, 1955

By J. R. PETERSON, General Manager  
Southwestern Bell Telephone Company  
St. Louis, Missouri

Effective: January 8, 1956

SBC PSC MO #17  
Puxico, Missouri  
Puxico West Island Bra  
Original Sheet 2A

# Non-Scannable Map

(Is viewable in the Data Center  
200 Madison Street, 1<sup>st</sup> Floor  
Jefferson City MO)



NO SUPPLEMENT TO THIS TARIFF WILL BE ISSUED EXCEPT FOR THE PURPOSE OF CANCELING THIS TARIFF.

P. S. C. Mo. No. 17  
EXCHANGE AREA MAP

REG. Puxico, Missouri  
12th REVISED SHEET 3  
REPLACING 12th REVISED SHEET 3  
FEB 14 1977

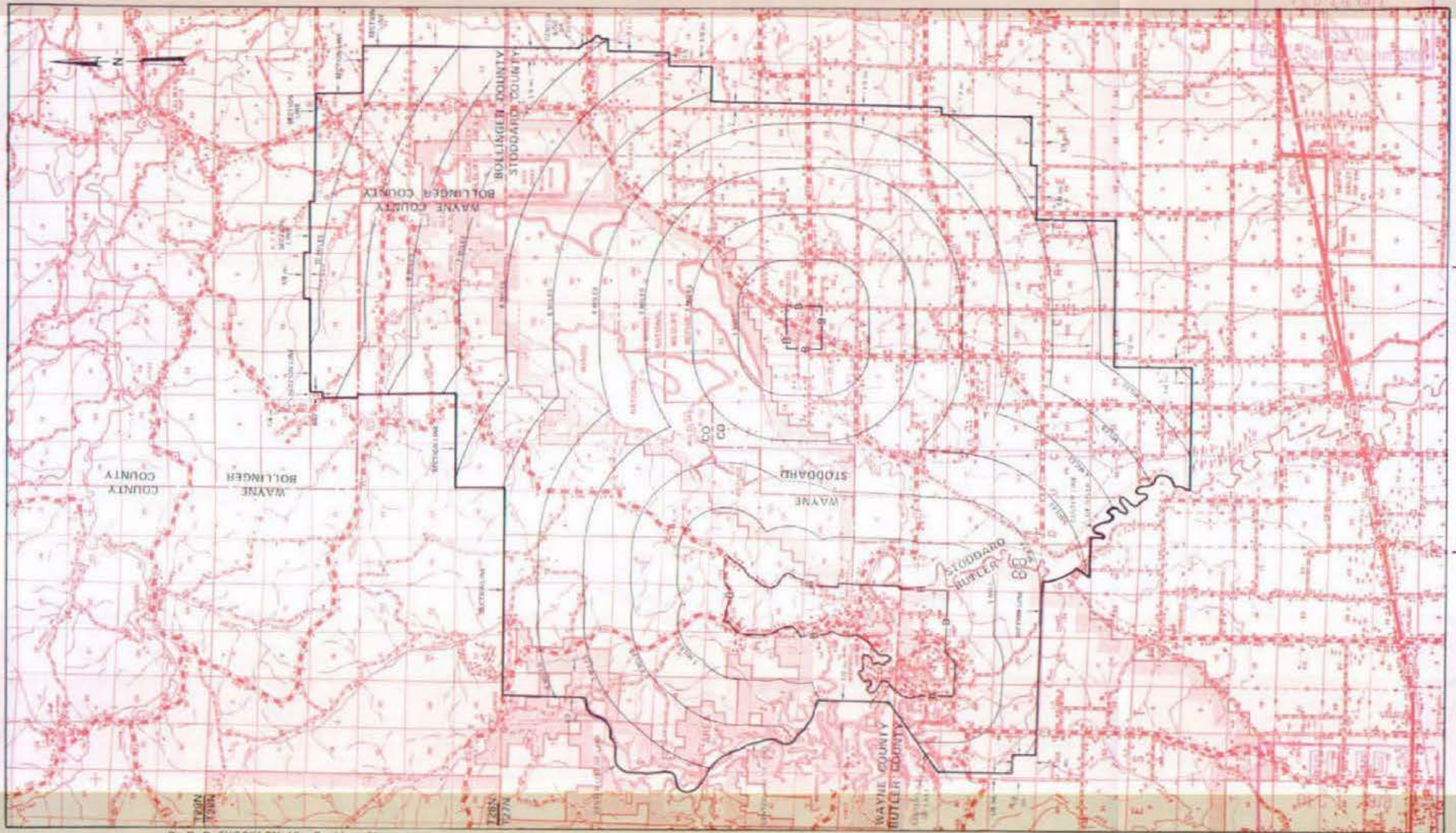

By R. R. SHOCKLEY, Vice President, Missouri  
Southwestern Bell Telephone Company  
St. Louis, Missouri

Issued: February 15, 1977

Public Service Commission  
Effective: DEC 1 1976