

NO SUPPLEMENT TO THIS TARIFF WILL BE ISSUED EXCEPT FOR THE PURPOSE OF CANCELING THIS TARIFF.

P. S. C. Mo. No. 17

Essex, Missouri

EXCHANGE AREA MAP

3rd REVISED SHEET 3 REPLACING 2nd REVISED SHEET 3

APR 14 1977

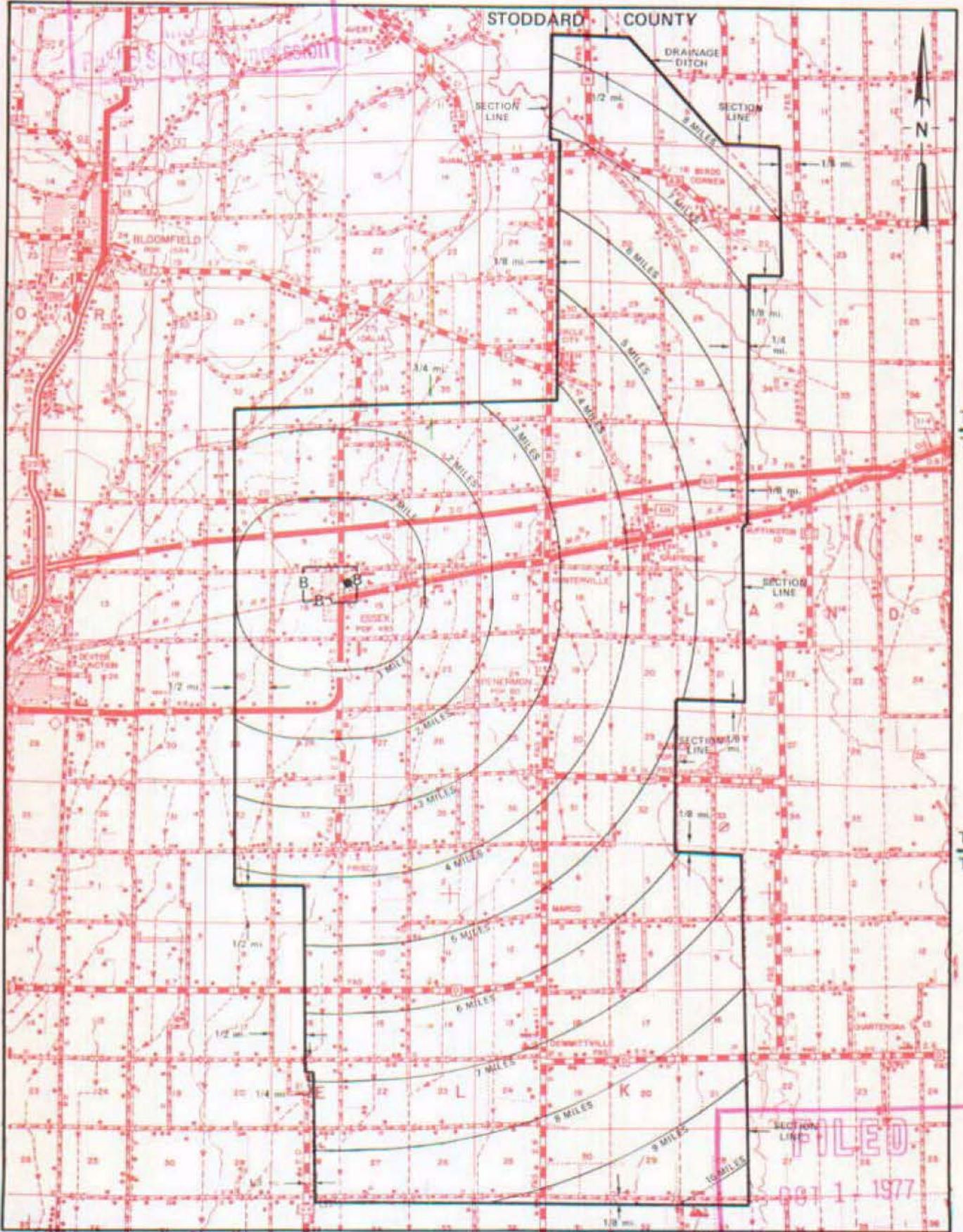

T26N  
T25N

T25N  
T24N

R10E | R11E | R11E | R12E

CANCELLED  
October 12, 2012  
Missouri Public  
Service Commission  
JI-2013-0120

By R. R. SHOCKLEY, Vice President, Missouri  
Southwestern Bell Telephone Company  
St. Louis, Missouri

FILED  
OCT 1 1977  
Public Service Commission

Issued: April 15, 1977

Effective: OCT 1 1977



NO SUPPLEMENT TO THIS TARIFF WILL BE ISSUED EXCEPT FOR THE PURPOSE OF CANCELING THIS TARIFF.

Excelsior Springs, Missouri

# P. S. C. Mo. No. 17 EXCHANGE AREA MAP

7th REVISED SHEET 3  
REPLACING 6th REVISED SHEET 3

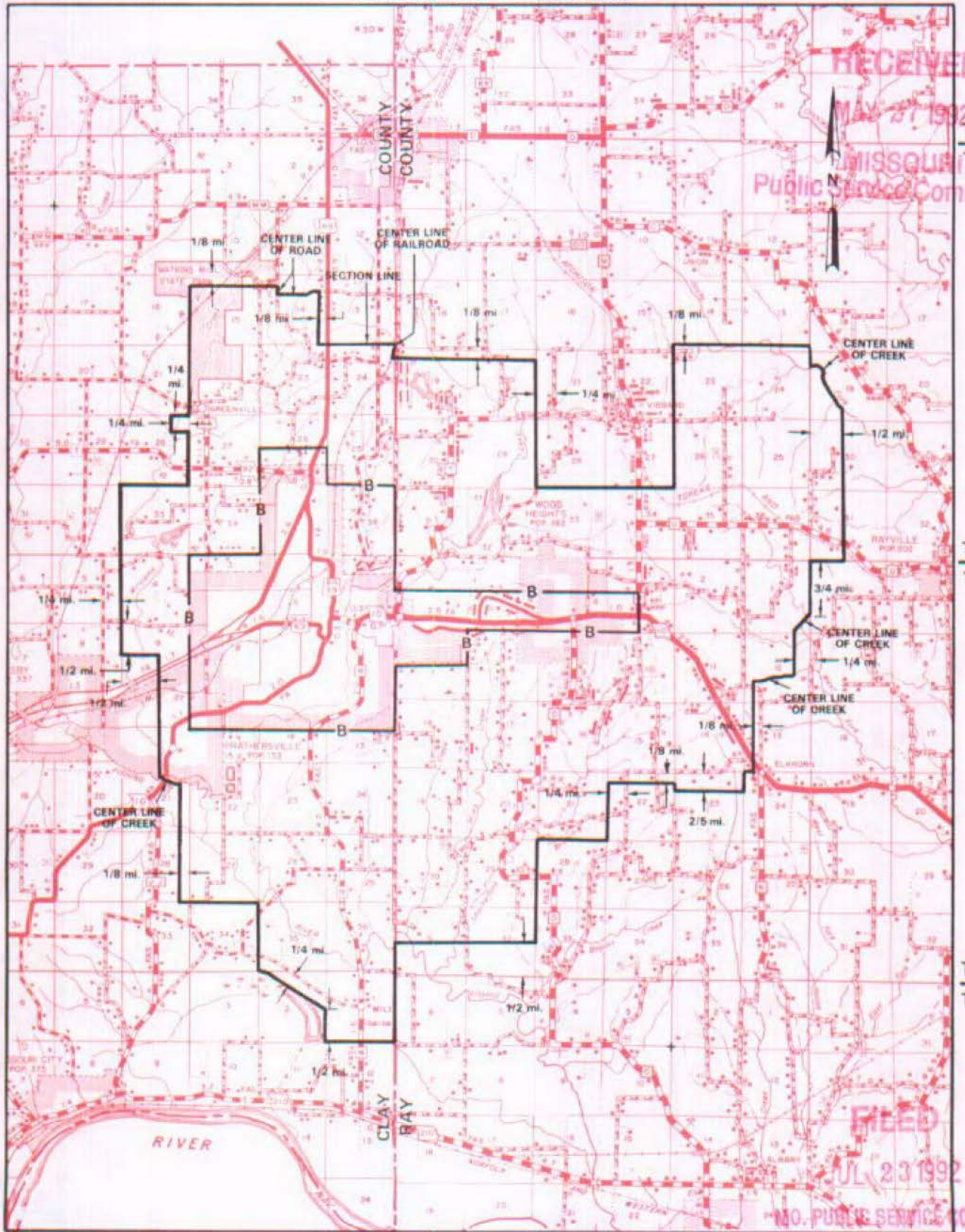

RECEIVED  
 MAY 21 1992  
 MISSOURI  
 Public Service Commission

T54N  
 T53N

T53N  
 T52N

T52N  
 T51N

FILED  
 JUL 23 1992  
 MO. PUBLIC SERVICE COMM.

R30W | R29W | R29W | R28W

CANCELLED  
 August 6, 2009  
 Missouri Public  
 Service Commission  
 JI-2010-0012  
 JUN 02 1992

By R. D. BARRON, PRESIDENT, MISSOURI DIVISION  
 Southwestern Bell Telephone Company  
 St. Louis, Missouri

Effective: JUL 23 1992