

NO SUPPLEMENT TO THIS TARIFF WILL BE ISSUED EXCEPT FOR THE PURPOSE OF CANCELING THIS TARIFF.

P. S. C. Mo. No. 17

EXCHANGE AREA MAP

Macks-Creek, Missouri  
**RECEIVED**  
6th REVISED SHEET 3  
REPLACING 5th REVISED SHEET 3

FEB 14 1977

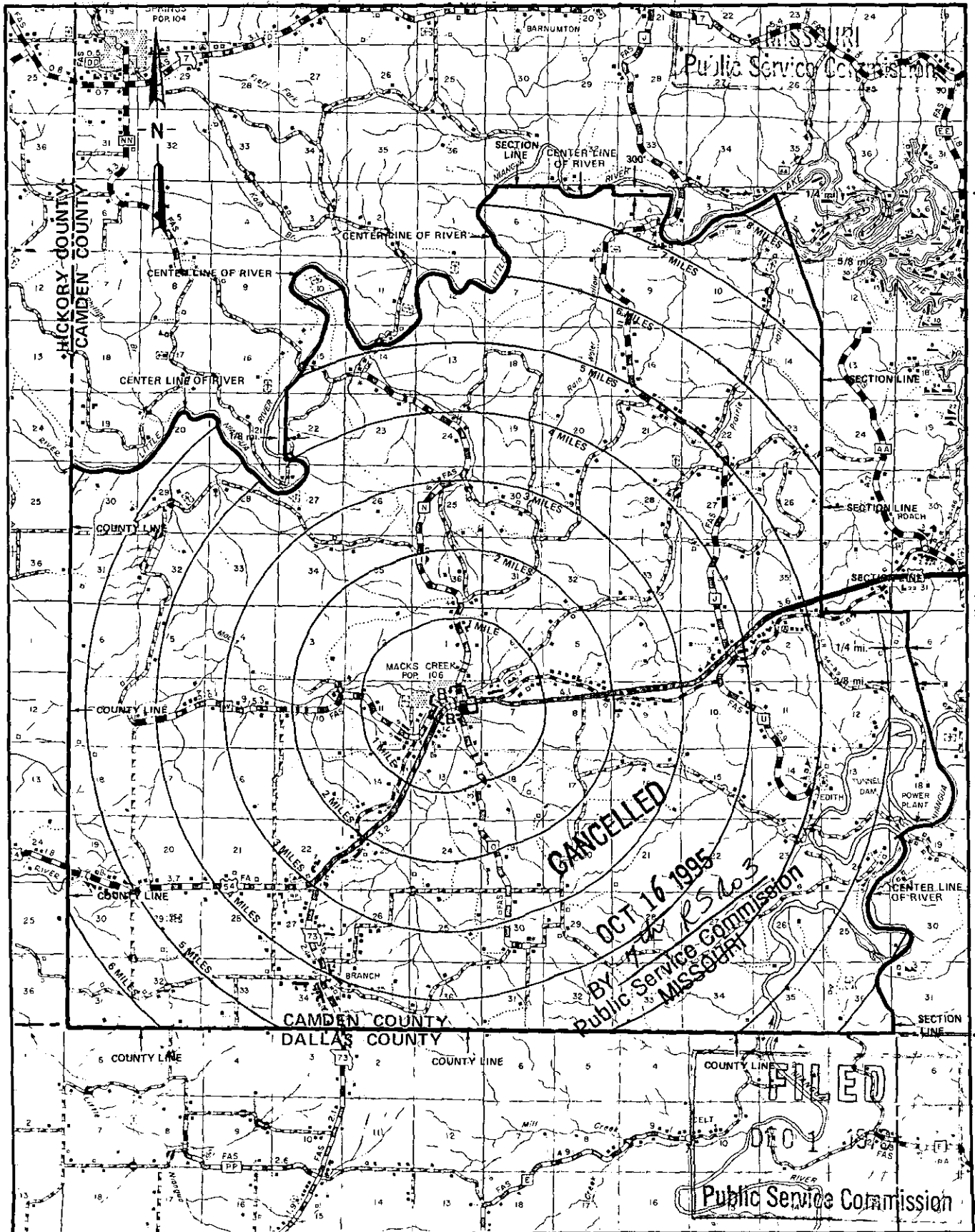

T39N  
T38N

T38N  
T37N

T37N  
T36N

R20W | R19W

R19W | R18W

R18W | R17W

By R. R. SHOCKLEY, Vice President, Missouri  
Southwestern Bell Telephone Company

St. Louis, Missouri

DEC 1 1978

Issued: February 15, 1977

Public Service Commission

NO SUPPLEMENT TO THIS TARIFF WILL BE ISSUED EXCEPT FOR THE PURPOSE OF CANCELING THIS TARIFF.

P. S. C. Mo. No. 17  
EXCHANGE AREA MAP

RECEIVED  
Malden, Missouri  
9th REVISED SHEET 3  
REPLACING 8th REVISED SHEET 3  
FEB 14 1977

MISSOURI  
Public Service Commission

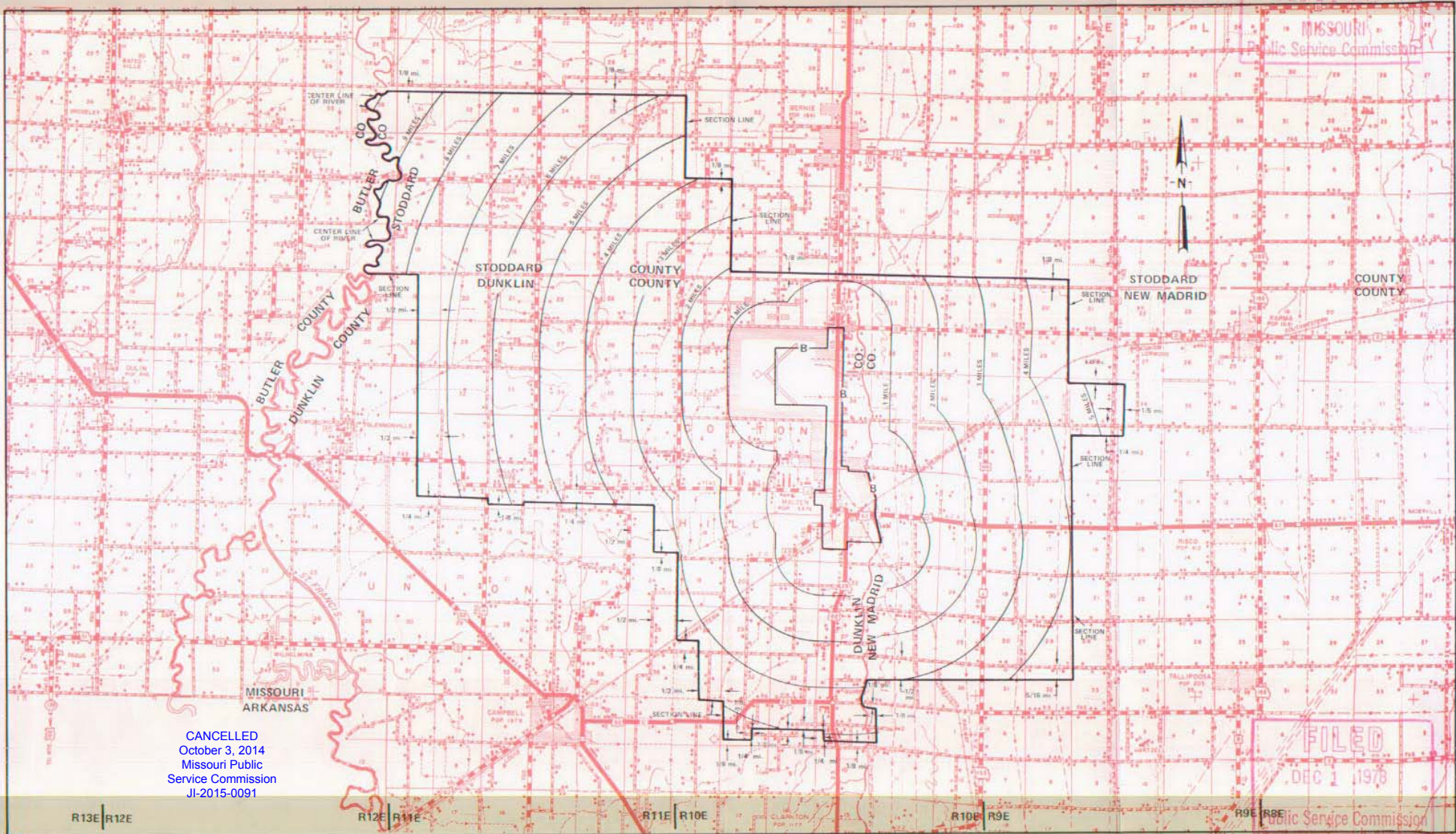

T24N  
T23N

T23N  
T22N

T22N  
T21N

CANCELLED  
October 3, 2014  
Missouri Public  
Service Commission  
JI-2015-0091

FILED  
DEC 1 1978

Public Service Commission

R13E R12E

R12E R11E

R11E R10E

R10E R9E

R9E R8E

By R. R. SHOCKLEY, Vice President, Missouri  
Southwestern Bell Telephone Company  
St. Louis, Missouri

Issued: February 15, 1977

DEC 1 1978  
Effective: \_\_\_\_\_

SBC PSC MO #17  
Maxville, Missouri  
14<sup>th</sup> Revised Sheet 2  
Replacing 13<sup>th</sup> Revised Sheet 2

# Non-Scannable Map

(Is viewable in the Data Center  
200 Madison Street, 1<sup>st</sup> Floor  
Jefferson City MO)

SBC Missouri  
Exchange & Base Rate Area Map  
Maxville  
PSC MO No. 17  
13<sup>th</sup> Revised Sheet 2

# Non-Scannable Map

(Viewable in the Data Center  
located at:  
200 Madison Street, 1<sup>st</sup> Floor  
Jefferson City MO)

SBC Missouri  
Exchange & Base Rate Area Map  
Maxville  
PSC MO No. 17  
12<sup>th</sup> Revised Sheet 2

# Non-Scannable Map

(Viewable in the Data Center  
located at:  
200 Madison Street, 1<sup>st</sup> Floor  
Jefferson City MO)

NO SUPPLEMENT TO THIS TARIFF WILL BE ISSUED EXCEPT FOR THE PURPOSE OF CANCELING THIS TARIFF.

P. S. C. Mo. No. 17

Monett, Missouri

EXCHANGE AREA MAP

8th REVISED SHEET 3 REPLACING 7th REVISED SHEET 3

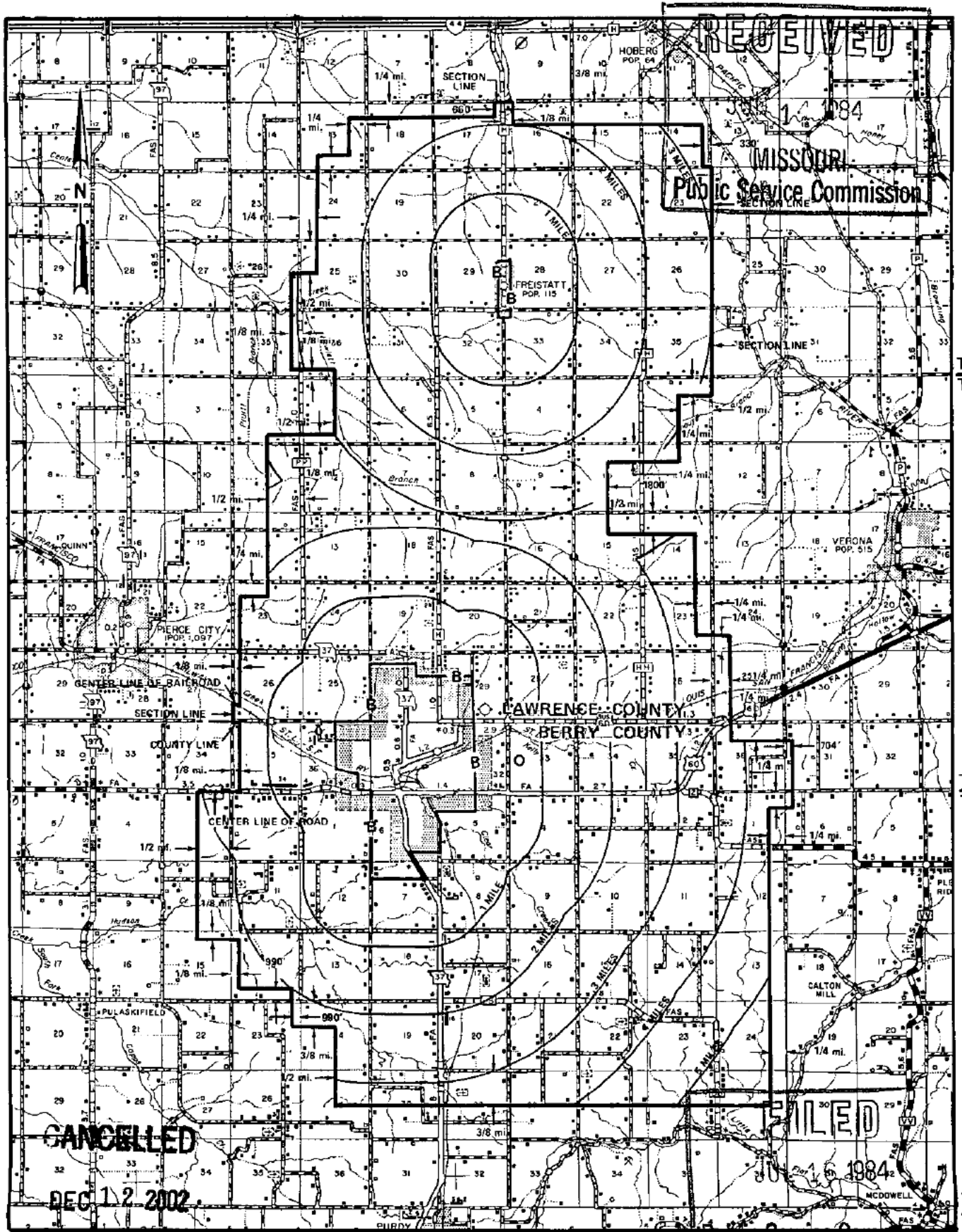

Public Service Commission MISSOURI By R. D. BARRON, President, Missouri Division Southwestern Bell Telephone Company St. Louis, Missouri

Issued: JUNE 15, 1984

Effective: JULY 16, 1984

NO SUPPLEMENT TO THIS TARIFF WILL BE ISSUED EXCEPT FOR THE PURPOSE OF CANCELING THIS TARIFF.

P. S. C. Mo. No. 17  
EXCHANGE AREA MAP

Montgomery Missouri  
Public Service Commission  
6th REVISED SHEET 3  
RELACING 5th REVISED SHEET 3  
FEB 14 1977

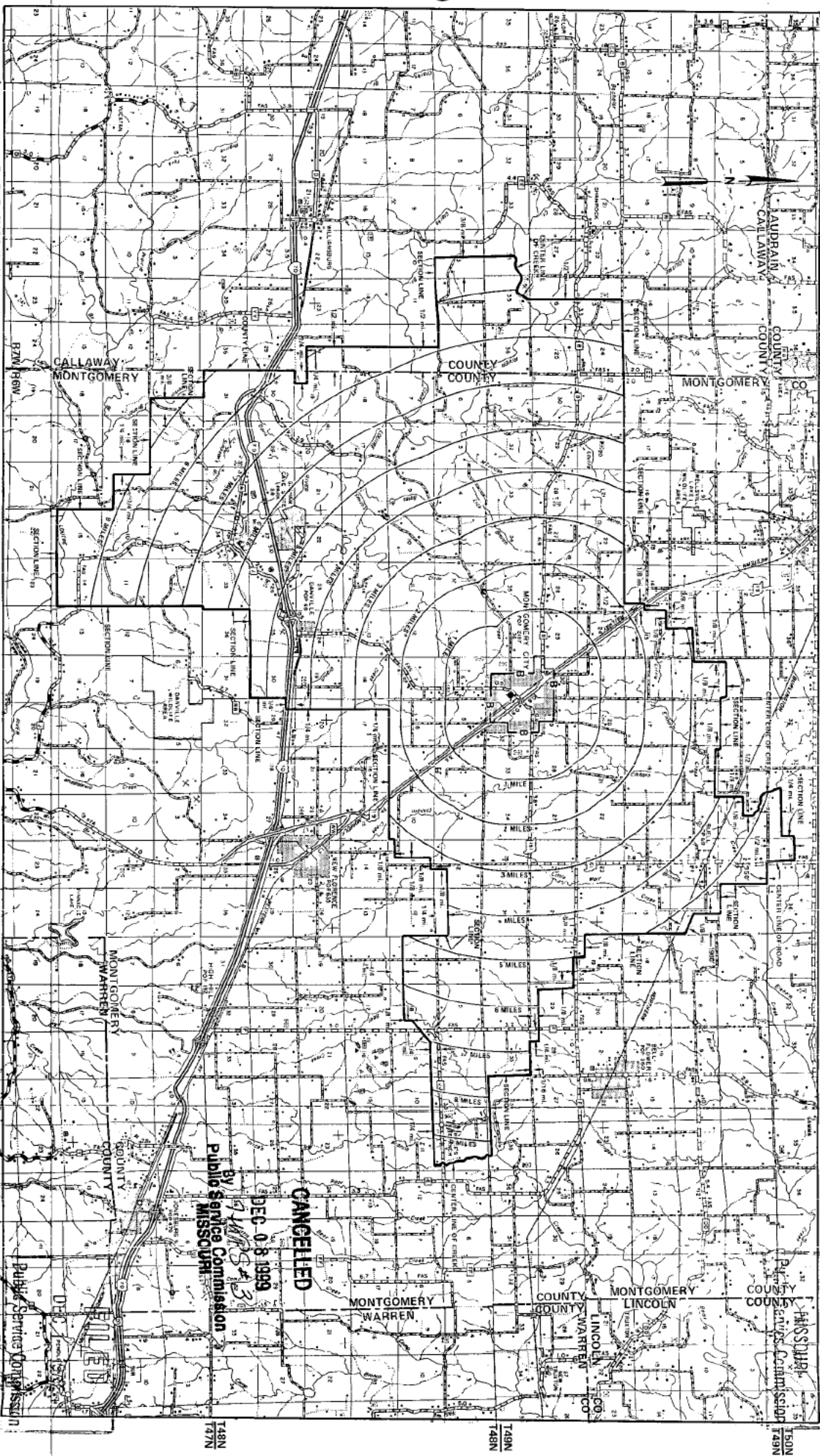

Issued: February 15, 1977

By R. R. SHOCKLEY, Vice President, Missouri  
Southwestern Bell Telephone Company  
St. Louis, Missouri

ROW/RSW

RSW/RSW

RAW/RAW

Effective: DEC 1 1978

**CANCELLED**  
DEC 08 1999  
By Public Service Commission  
MISSOURI