

SBC PSC MO #17
Macks Creek, Missouri
Original Sheet 2

Non-Scannable Map

(Is viewable in the Data Center
200 Madison Street, 1st Floor
Jefferson City MO)

NO SUPPLEMENT TO THIS TARIFF WILL BE ISSUED EXCEPT FOR THE PURPOSE OF CANCELING THIS TARIFF.

P. S. C. Mo. No. 17

Macks Creek, Missouri

EXCHANGE AREA MAP

7th REVISED SHEET 3 REPLACING 6th REVISED SHEET 3

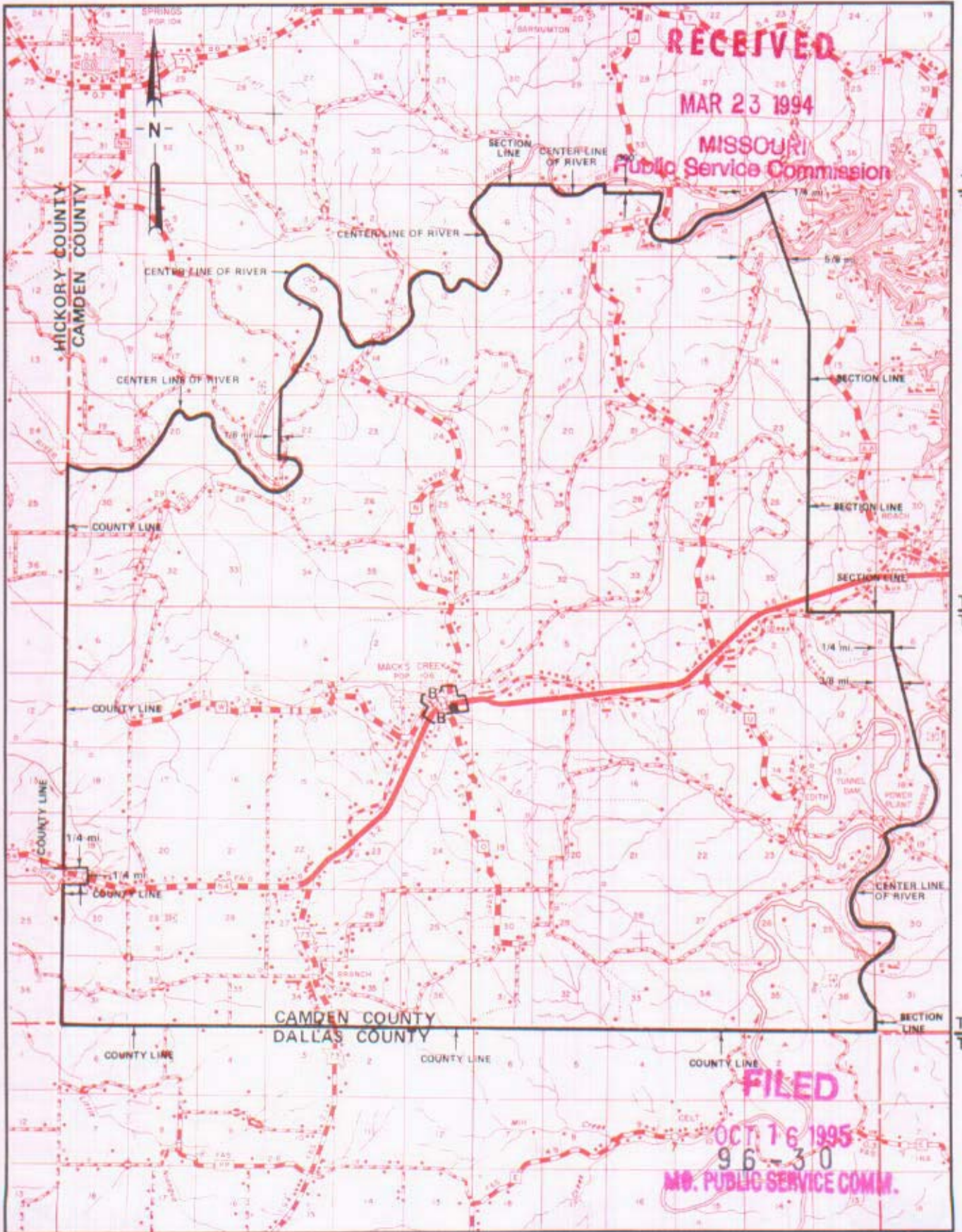

R20W | R19W

R19W | R18W

R18W | R17W

By HORACE WILKINS JR., President, Missouri Southwestern Bell Telephone Company St. Louis, Missouri

Issued: March 23, 1994

Effective: October 16, 1995

CANCELLED - Missouri Public Service Commission - 05/01/2024 - TN-2024-0278 - JI-2024-0142

NO SUPPLEMENT TO THIS TARIFF WILL BE ISSUED EXCEPT FOR THE PURPOSE OF CANCELING THIS TARIFF.

P. S. C. Mo. No. 17

EXCHANGE AREA MAP

Macks-Creek, Missouri
RECEIVED
6th REVISED SHEET 3
REPLACING 5th REVISED SHEET 3

FEB 14 1977

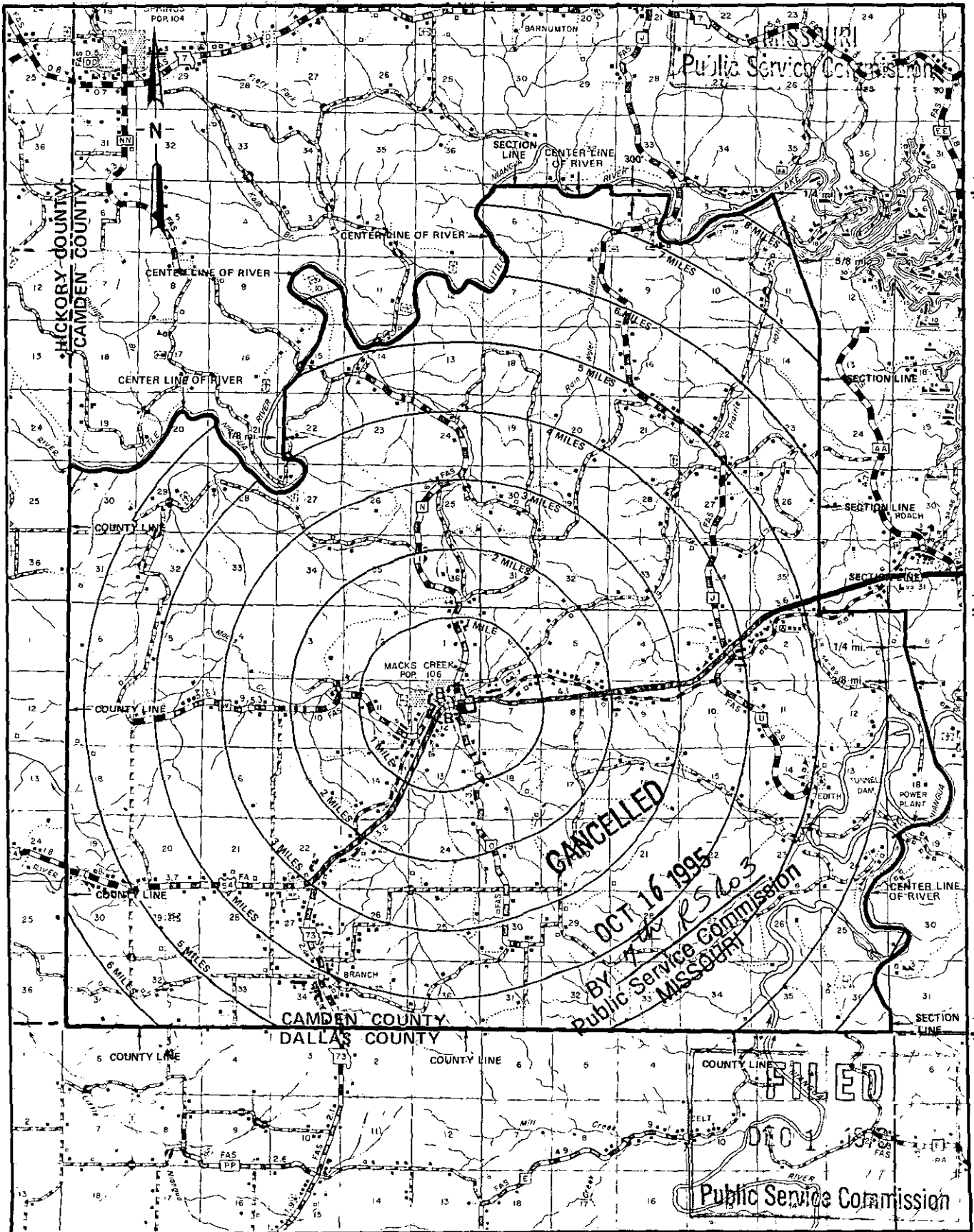

T39N
T38N

T38N
T37N

T37N
T36N

R20W | R19W

R19W | R18W

R18W | R17W

By R. R. SHOCKLEY, Vice President, Missouri
Southwestern Bell Telephone Company

DEC 1 1978

Issued: February 15, 1977

St. Louis, Missouri

SBC PSC MO #17
Malden, Missouri
2nd Revised Sheet 2
Replacing 1st Revised Sheet 2

Non-Scannable Map

(Is viewable in the Data Center
200 Madison Street, 1st Floor
Jefferson City MO)

Southwestern Bell Telephone
Company d/b/a AT&T Missouri

P.S.C. Mo. No. 17
EXCHANGE AREA MAP

Malden, Missouri
10th Revised Sheet 3
Replacing 9th Revised Sheet 3

CANCELLED - Missouri Public Service Commission - 05/01/2024 - TN-2024-0278 - JI-2024-0142

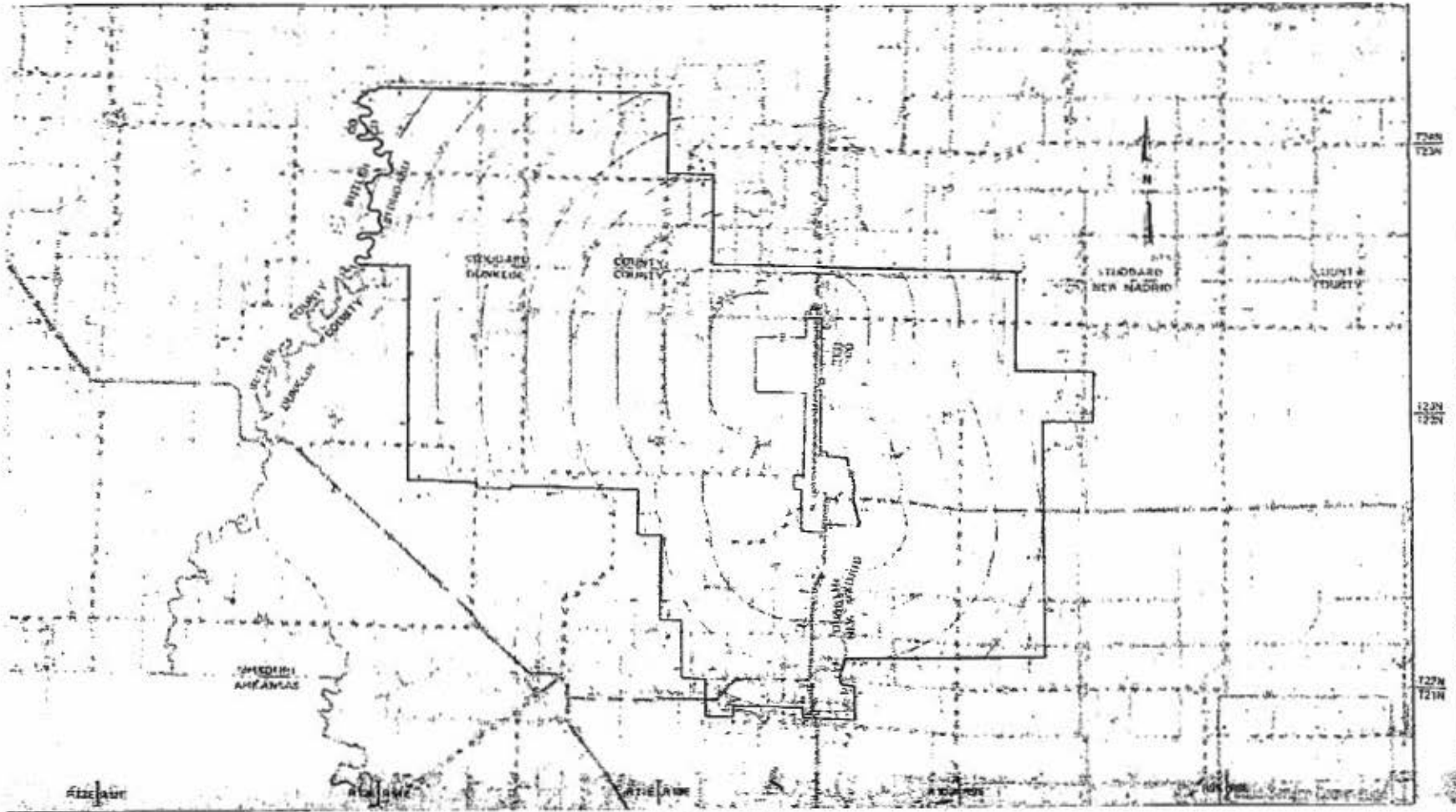

ISSUED: SEPTEMBER 3, 2014

By JOHN SONDAG, President- Missouri
St. Louis, Missouri

EFFECTIVE: OCTOBER 3, 2014

FILED
Missouri Public
Service Commission
JI-2015-0091

NO SUPPLEMENT TO THIS TARIFF WILL BE ISSUED EXCEPT FOR THE PURPOSE OF CANCELING THIS TARIFF.

P. S. C. Mo. No. 17
EXCHANGE AREA MAP

RECEIVED
Malden, Missouri
9th REVISED SHEET 3
REPLACING 8th REVISED SHEET 3
FEB 14 1977

MISSOURI
Public Service Commission

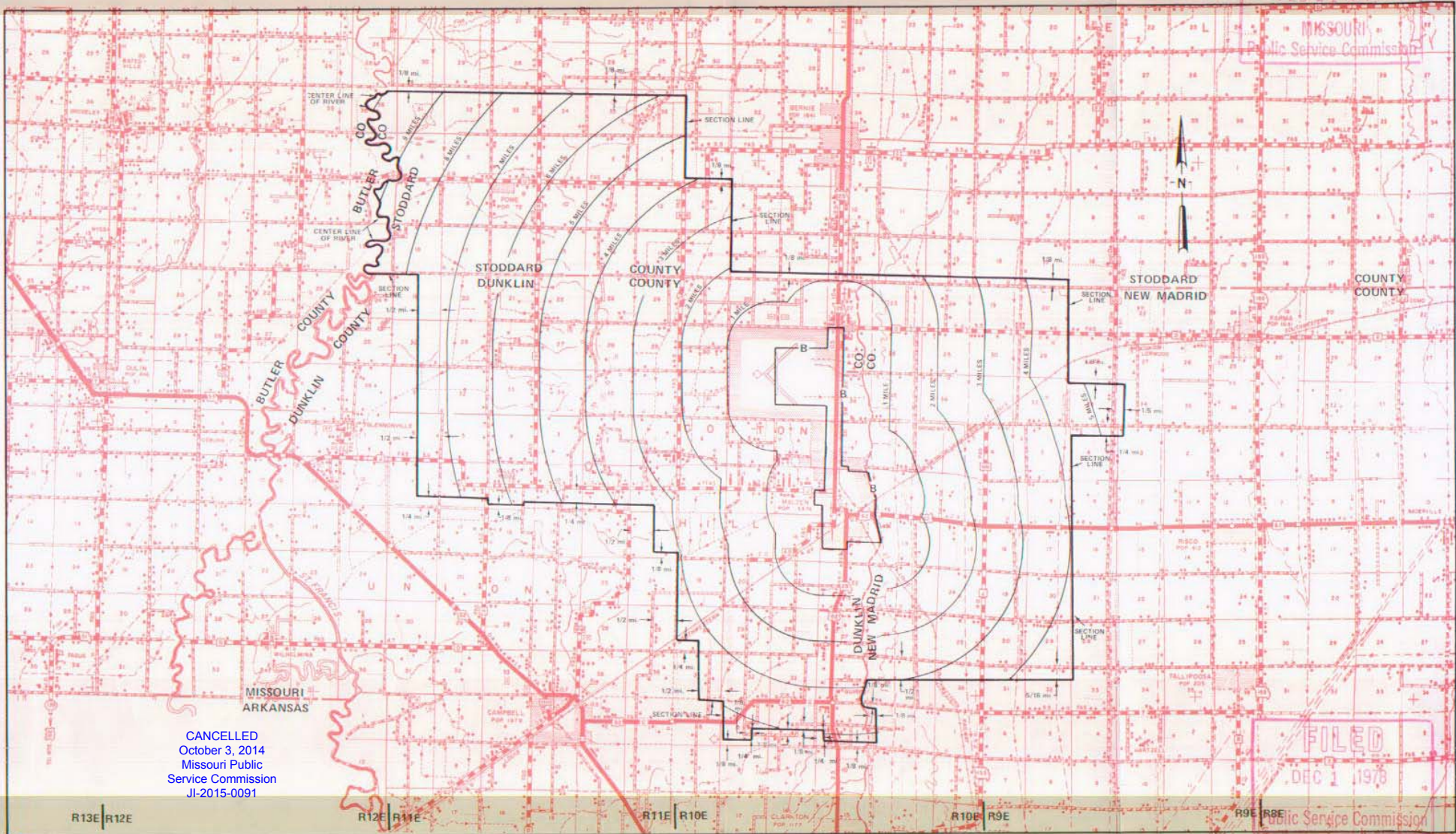

CANCELLED
October 3, 2014
Missouri Public
Service Commission
JI-2015-0091

FILED
DEC 1 1978

Public Service Commission

By R. R. SHOCKLEY, Vice President, Missouri
Southwestern Bell Telephone Company
St. Louis, Missouri

Issued: February 15, 1977

Effective: DEC 1 1978

SBC PSC MO #17
Manchester, Missouri
18th Revised Sheet 2
Replacing 17th Revised Sheet 2

Non-Scannable Map

(Is viewable in the Data Center
200 Madison Street, 1st Floor
Jefferson City MO)

SBC PSC MO #17

Marble Hill-Lutesville, Missouri

Original Sheet 2

Replacing Southeast Missouri

Telephone Co.

P.S.C. Mo. No. 2

1st Revised Sheet 1-A

Non-Scannable Map

(Is viewable in the Data Center
200 Madison Street, 1st Floor
Jefferson City MO)

SBC PSC MO #17

Marble Hill - Lutesville, Missouri

11th Revised Sheet 3

Replacing 10th Revised Sheet 3

Non-Scannable Map

(Is viewable in the Data Center
200 Madison Street, 1st Floor
Jefferson City MO)

SBC PSC MO #17
Marceline, Missouri
1st Revised Sheet 2
Replacing Original Sheet 2
Linn County

Non-Scannable Map

(Is viewable in the Data Center
200 Madison Street, 1st Floor
Jefferson City MO)

NO SUPPLEMENT TO THIS TARIFF WILL BE ISSUED EXCEPT FOR THE PURPOSE OF CANCELING THIS TARIFF.

P. S. C. Mo. No. 17 EXCHANGE AREA MAP

Marceline, Missouri

RECEIVED
9th REVISED SHEET 3
REPLACING 8th REVISED SHEET 3

AUG 24 1979

MISSOURI
Public Service Commission

COUNTY
COUNTY



T58N
T57N

CO T57N
CO T56N

T56N
T55N

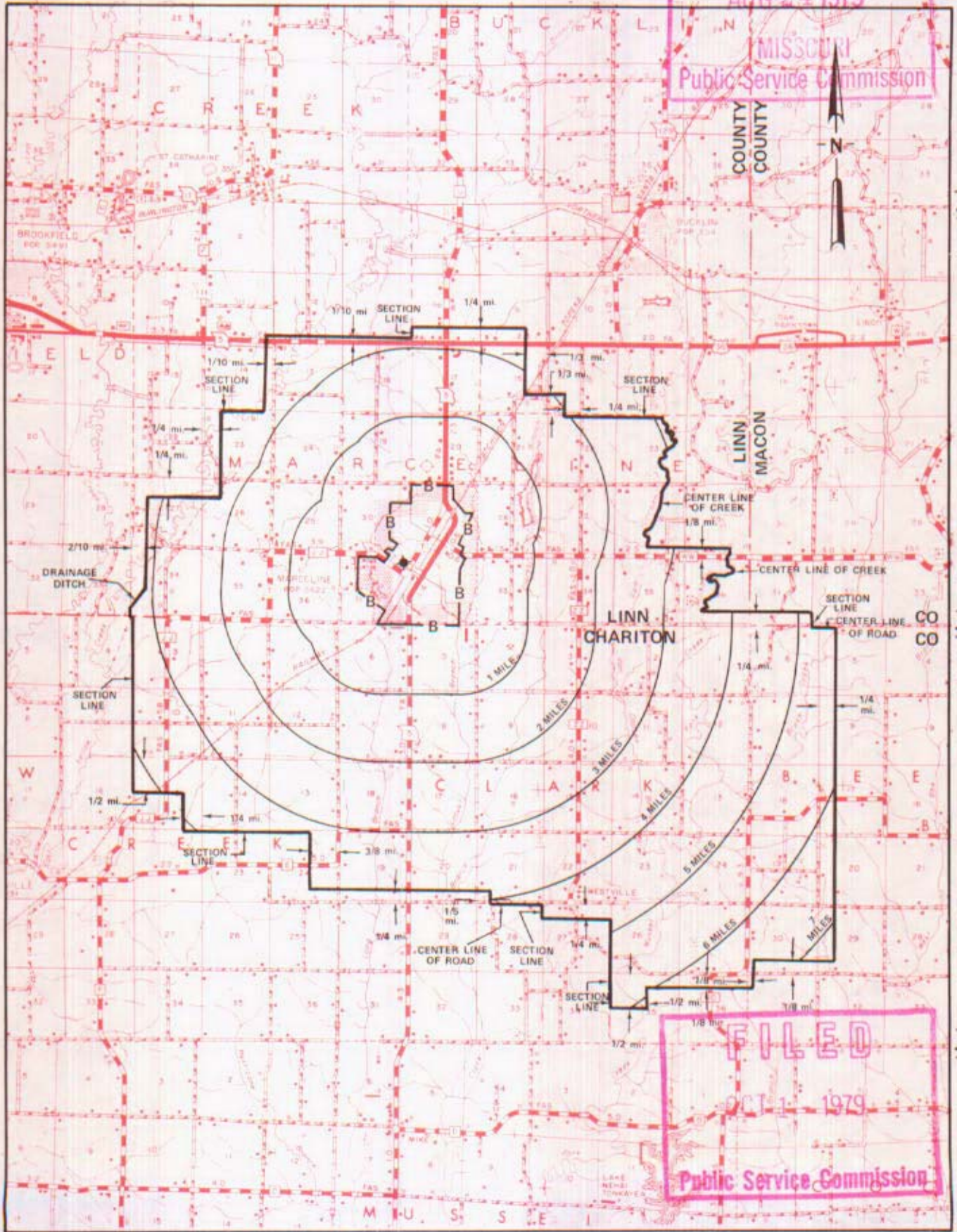

R19W | R18W

R18W | R17W

By R. R. SHOCKLEY, Vice President, Missouri
Southwestern Bell Telephone Company
St. Louis, Missouri

OCT 1 1979

Issued: AUGUST 28, 1979

Effective: _____

FILED
OCT 1 1979
Public Service Commission

CANCELLED - Missouri Public Service Commission - 05/01/2024 - TN-2024-0278 - JI-2024-0142

NO SUPPLEMENT TO THIS TARIFF WILL BE ISSUED EXCEPT FOR THE PURPOSE OF CANCELING THIS TARIFF.

P. S. C. Mo. No. 17

Marionville, Missouri
ORIGINAL SHEET 2
REPLACING ORIGINAL SHEET 1-A

BASE RATE AREA MAP

RECEIVED
MAR 8 1949
MISSOURI
Public Service Comm.

FILED
APR 7 1949

Public Service Commission



U.S. HWY 60

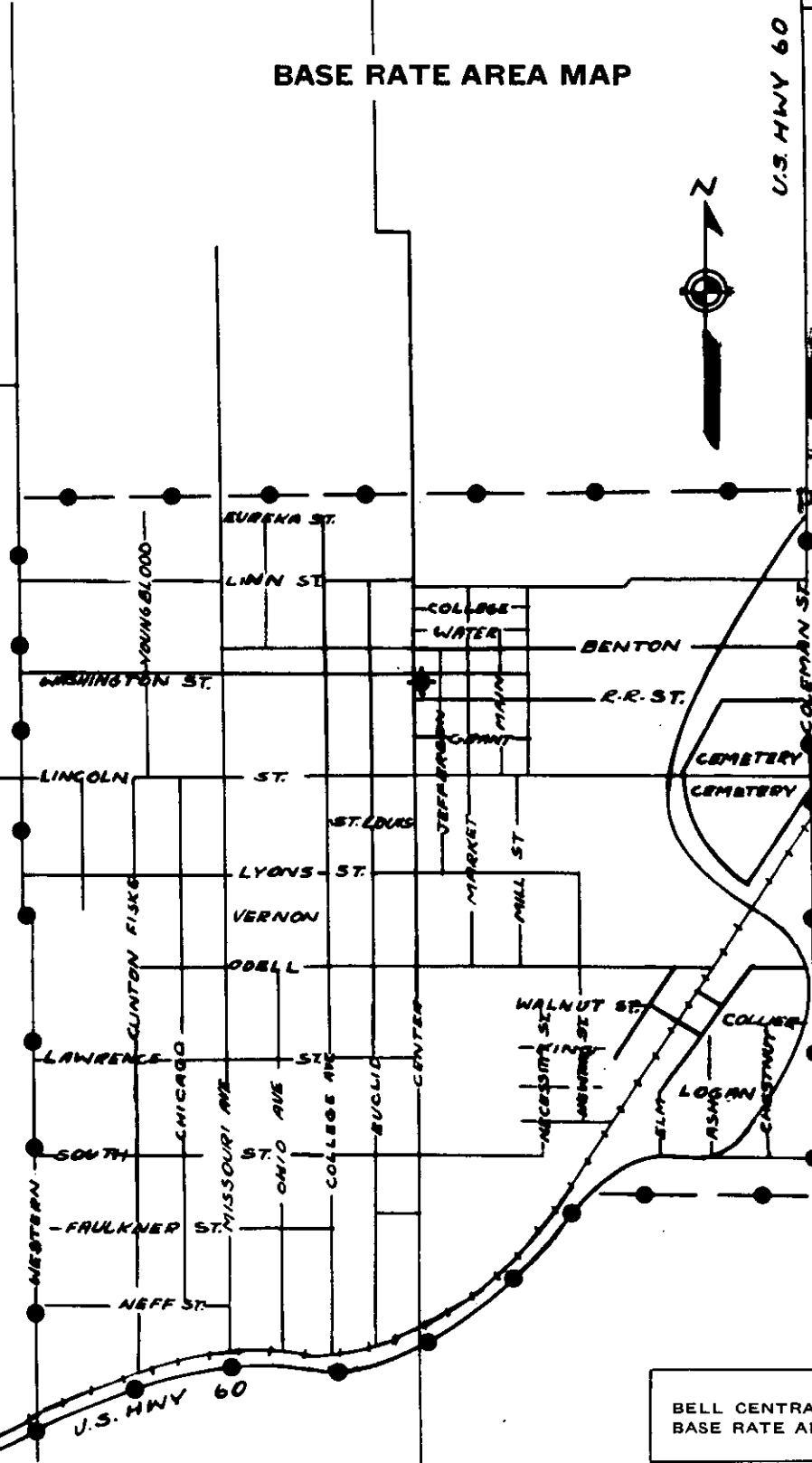

CODE
BELL CENTRAL OFFICE:
BASE RATE AREA LIMITS:

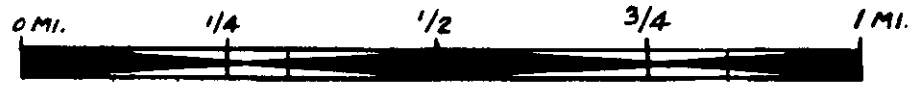

Issued: March 7, 1949

Effective: April 7, 1949

By M. L. PEARCY, General Manager
Southwestern Bell Telephone Company
St. Louis, Missouri

CANCELLED - Missouri Public Service Commission - 05/01/2024 - TN-2024-0278 - JI-2024-0142

MARIONVILLE MO.

CANCELLED - Missouri Public Service Commission - 05/01/2024 - TN-2024-0278 - JI-2024-0142

Schedule for Marquand cancelled

Jul 1, 1932

Exchange abandoned. Subscribers
trunked to Patton and considered
Patton subscribers.

CANCELLED - Missouri Public Service Commission - 05/01/2024 - TN-2024-0278 - JI-2024-0142

NO SUPPLEMENT TO THIS TARIFF WILL BE ISSUED EXCEPT FOR THE PURPOSE OF CANCELING THIS TARIFF.

P. S. C. Mo. No. 17 BASE RATE AREA MAP

Marshall, Missouri

2nd REVISED SHEET 2
REPLACING 1st REVISED SHEET 2

RECEIVED

AUG 14 1991

MISSOURI
Public Service Commission

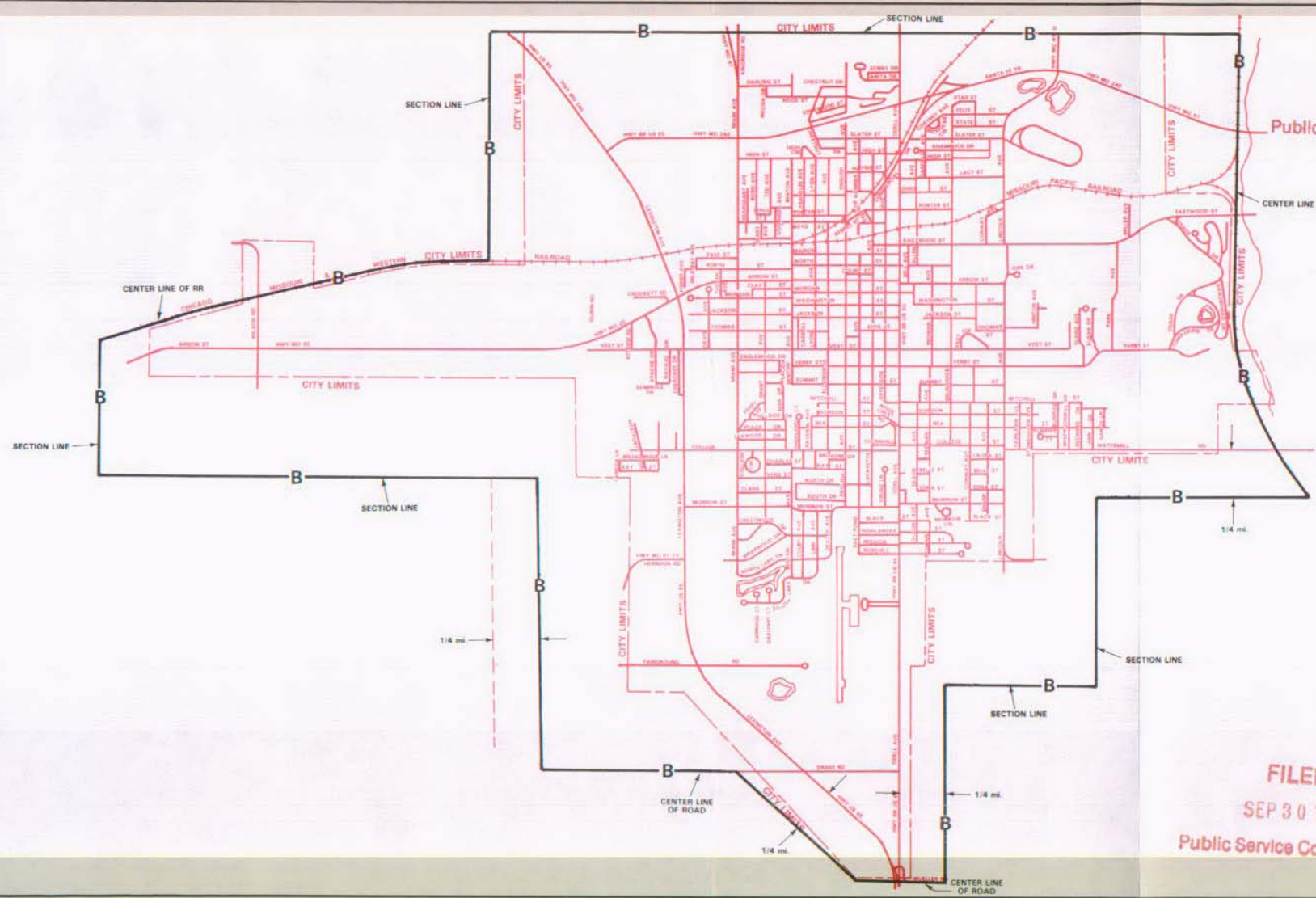

FILED
SEP 3 0 1991
Public Service Commission

Issued: AUG 23 1991

By R. D. BARRON, PRESIDENT, MISSOURI DIVISION
Southwestern Bell Telephone Company
St. Louis, Missouri

Effective: SEP 3 0 1991

SBC PSC MO #17
Marshall, Missouri
1st Revised Sheet 2
Replacing Original Sheet 2

Non-Scannable Map

(Is viewable in the Data Center
200 Madison Street, 1st Floor
Jefferson City MO)

CANCELLED - Missouri Public Service Commission - 05/01/2024 - TN-2024-0278 - JI-2024-0142

NO SUPPLEMENT TO THIS TARIFF WILL BE ISSUED EXCEPT FOR THE PURPOSE OF CANCELING THIS TARIFF.

P. S. C. Mo. No. 17 EXCHANGE AREA MAP

Marshall, Missouri

14th REVISED SHEET 3
REPLACING 13th REVISED SHEET 3

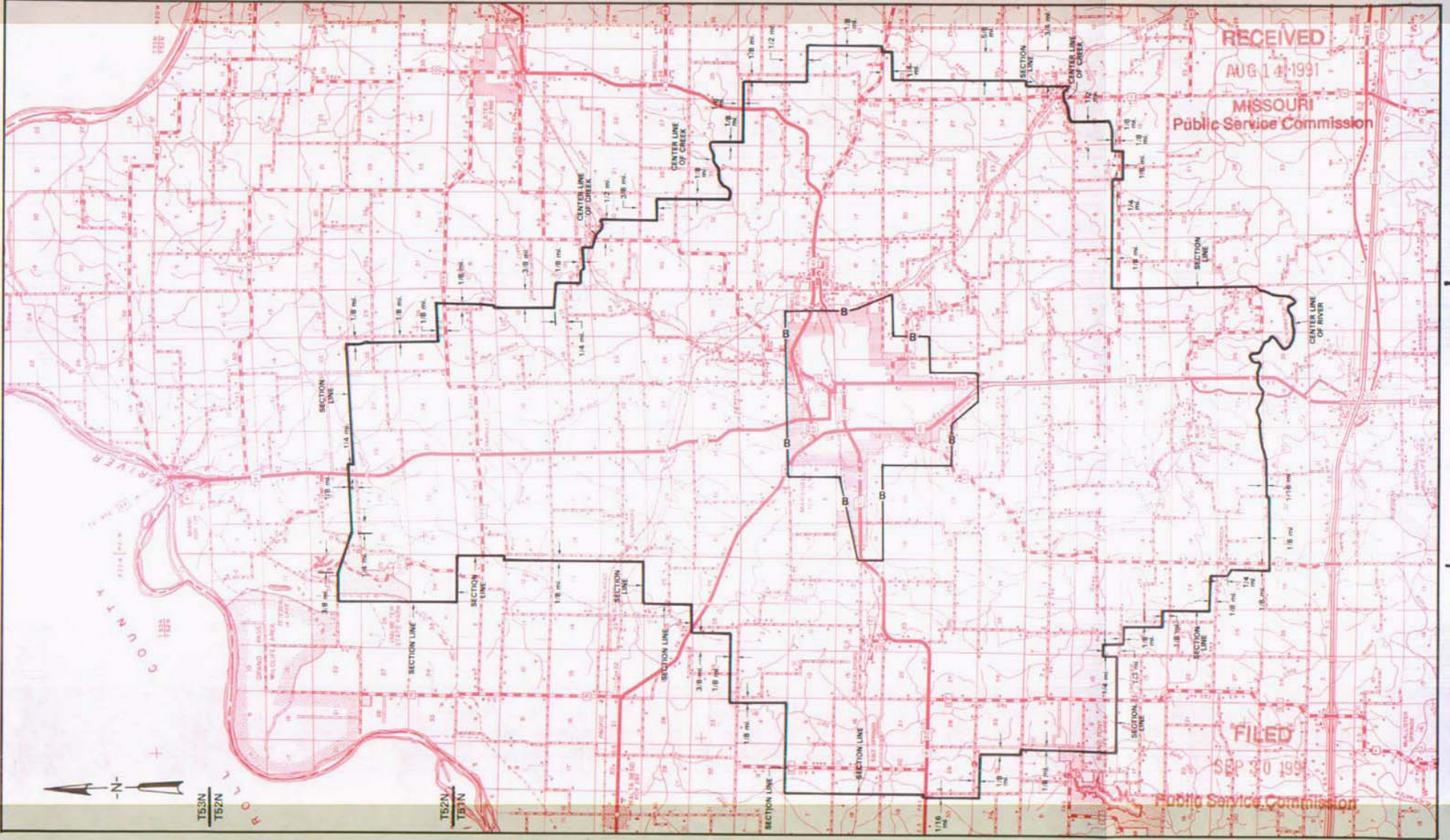

AUG 23 1991

Issued: _____

By R. D. BARRON, PRESIDENT, MISSOURI DIVISION
Southwestern Bell Telephone Company
St. Louis, Missouri

T51N
T50N

T50N
T49N

T49N
T48N

Effective: SEP 30 1991

NO SUPPLEMENT TO THIS TARIFF WILL BE ISSUED EXCEPT FOR THE PURPOSE OF CANCELING THIS TARIFF.

P. S. C. Mo. No. 17 EXCHANGE AREA MAP

Marshall, Missouri
13th REVISED SHEET 3
REPLACING 12th REVISED SHEET 3

CANCELLED - Missouri Public Service Commission - 05/01/2024 - TN-2024-0278 - JI-2024-0142

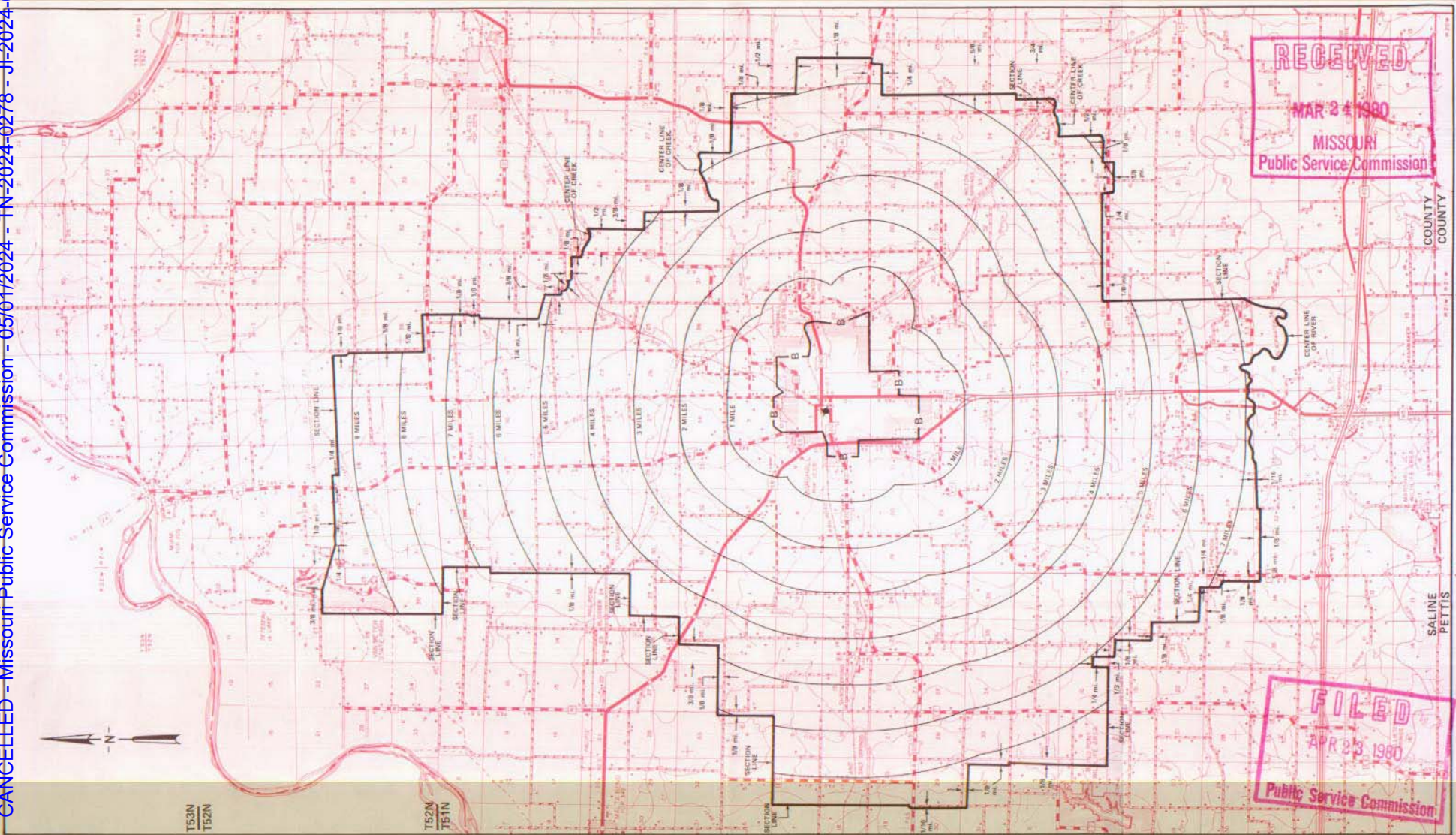

RECEIVED
MAR 24 1980
MISSOURI
Public Service Commission

FILED
APR 23 1980
Public Service Commission

By R. R. SHOCKLEY, Vice President, Missouri
Southwestern Bell Telephone Company
St. Louis, Missouri

Issued: MARCH 24, 1980

Effective: APRIL 23, 1980

SBC PSC MO #17

Marston, Missouri

Original Sheet 2

Southeast Missouri Telephone Company

P.S.C. Mo. No. 2

First Revised Sheet 1-A

Non-Scannable Map

(Is viewable in the Data Center
200 Madison Street, 1st Floor
Jefferson City MO)

NO SUPPLEMENT TO THIS TARIFF WILL BE ISSUED EXCEPT FOR THE PURPOSE OF CANCELING THIS TARIFF.

P. S. C. Mo. No. 17

EXCHANGE AREA MAP

Marston, Missouri
RECEIVED
 2nd REVISED SHEET 3
 REPLACING 1st REVISED SHEET 3
 DEC 10 1978
 MISSOURI
 Public Service Commission

CANCELLED - Missouri Public Service Commission - 05/01/2024 - TN-2024-0278 - JI-2024-0142

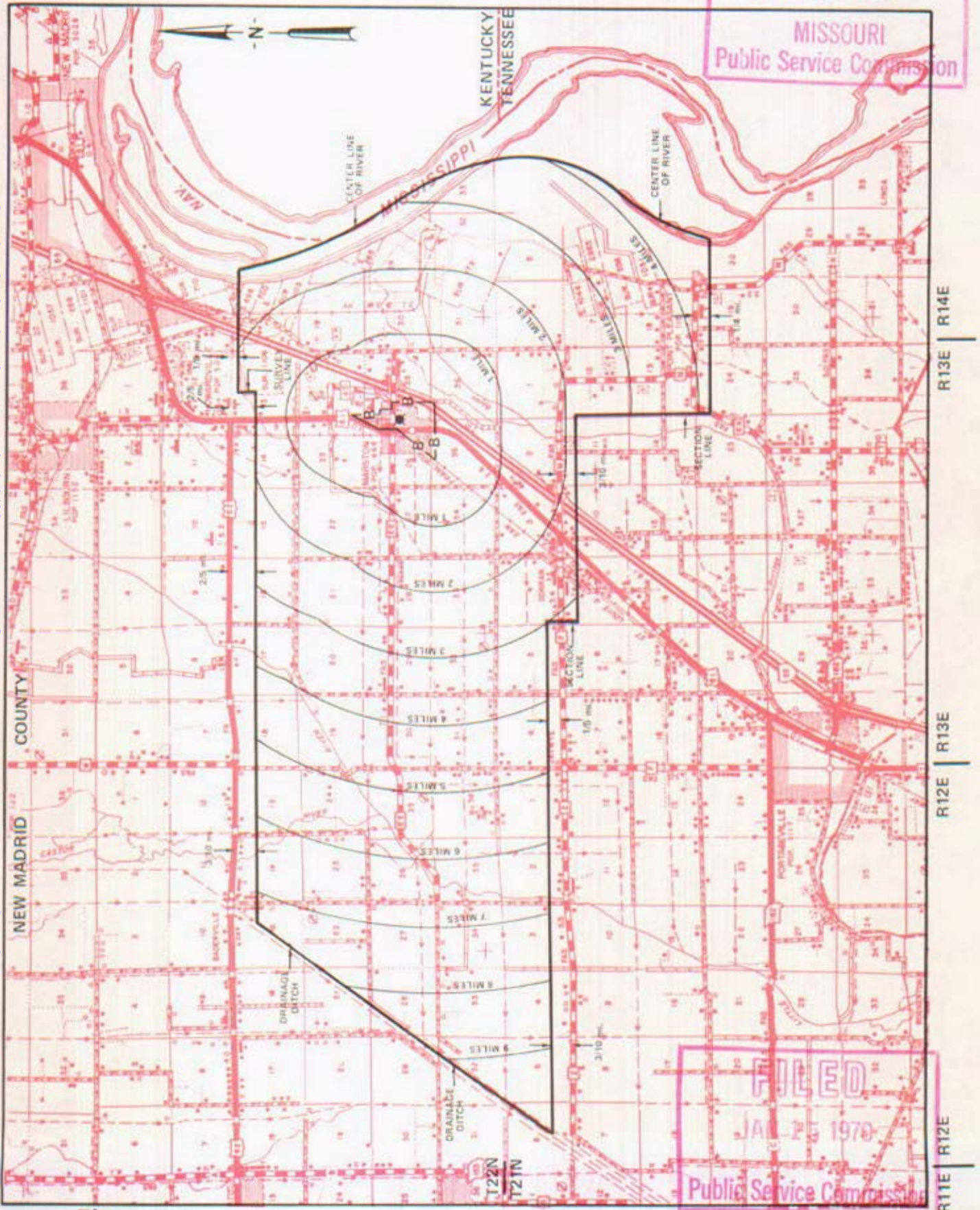

DEC 15 1978

By R. R. SHOCKLEY, Vice President, Missouri Southwestern Bell Telephone Company

FILED
 JAN 5 1979
 Public Service Commission

ATTENTION

AT&T Missouri
PSC MO No. 17
Maxville, Missouri
15th Revised Sheet 2 Replacing 14th Revised Sheet 2

This tariff page contains a map that is not available electronically.

To obtain a copy of the document, please send a written request to the Data Center.

E-mail: datacenter-psc@psc.mo.gov

Regular Mail: Missouri Public Service Commission
Data Center
P.O. Box 360
Jefferson City, MO 65102

Fax: 573-522-6176

Please call the Data Center at 573-751-7496 if you have any questions.

SBC PSC MO #17
Maxville, Missouri
14th Revised Sheet 2
Replacing 13th Revised Sheet 2

Non-Scannable Map

(Is viewable in the Data Center
200 Madison Street, 1st Floor
Jefferson City MO)

SBC Missouri
Exchange & Base Rate Area Map
Maxville
PSC MO No. 17
13th Revised Sheet 2

Non-Scannable Map

(Viewable in the Data Center
located at:
200 Madison Street, 1st Floor
Jefferson City MO)

SBC Missouri
Exchange & Base Rate Area Map
Maxville
PSC MO No. 17
12th Revised Sheet 2

Non-Scannable Map

(Viewable in the Data Center
located at:
200 Madison Street, 1st Floor
Jefferson City MO)

CANCELLED - Missouri Public Service Commission - 05/01/2024 - TN-2024-0278 - JI-2024-0142

MEHLVILLE

SEE

St. Louis District Exchange Rates

under

"St. Louis"

June 1, 1937

NO SUPPLEMENT TO THIS TARIFF WILL BE ISSUED EXCEPT FOR THE PURPOSE OF CANCELING THIS TARIFF.

Meta, Missouri

1st REVISED SHEET 2
REPLACING OZARK CENTRAL TELEPHONE COMPANY
P.S.C. No. 1
ORIGINAL SHEET 2

P. S. C. No. 17 BASE RATE AREA MAP

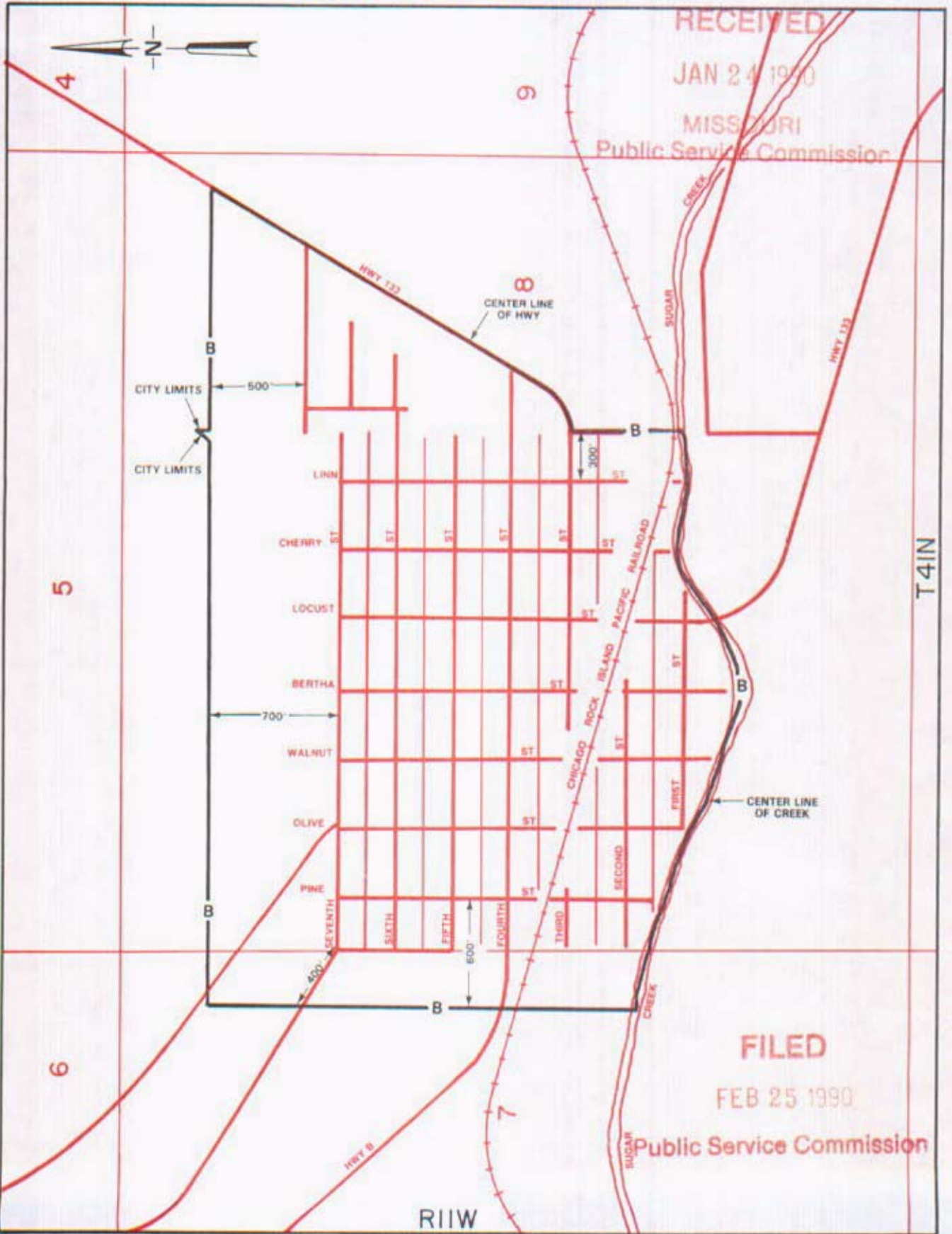

CANCELLED - Missouri Public Service Commission - 05/01/2024 - TN-2024-0278 - JI-2024-0142

By R. D. BARRON, PRESIDENT, MISSOURI DIVISION
Southwestern Bell Telephone Company
St. Louis, Missouri

Issued: JAN 24 1990

Effective: FEB 25 1990

NO SUPPLEMENT TO THIS TARIFF WILL BE ISSUED EXCEPT FOR THE PURPOSE OF CANCELING THIS TARIFF.

Meta, Missouri

10th REVISED SHEET 3
REPLACING 9th REVISED SHEET 3

P. S. C. Mo. No. 17 EXCHANGE AREA MAP

RECEIVED

JAN 24 1990
MISSOURI
Public Service Commission

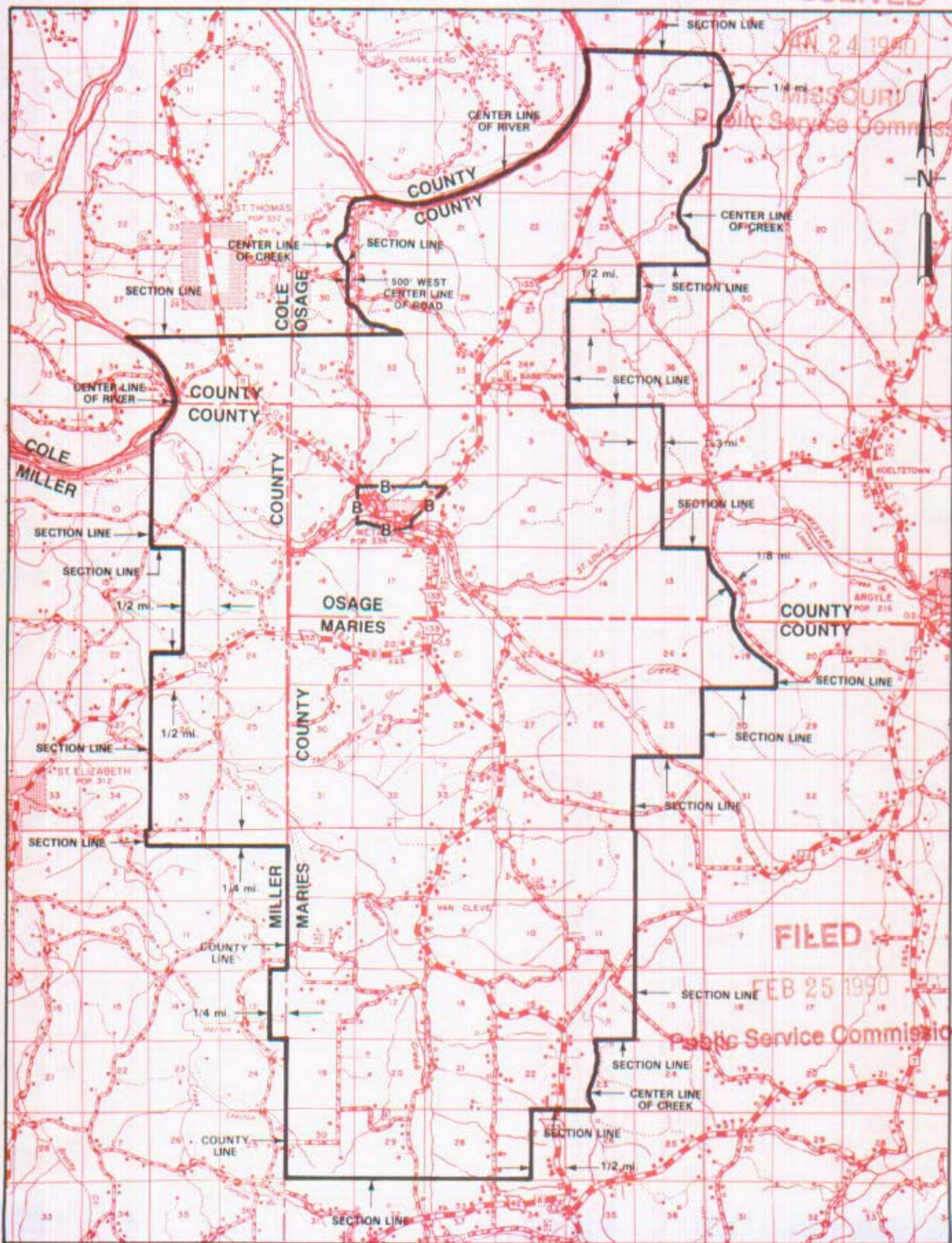

T42N
T41N

T41N
T40N

FILED

FEB 25 1990

Public Service Commission

R12W | R11W

R11W | R10W

By R. D. BARRON, PRESIDENT, MISSOURI DIVISION
Southwestern Bell Telephone Company
St. Louis, Missouri

Issued: JAN 24 1990

Effective: FEB 25 1990

CANCELLED - Missouri Public Service Commission - 05/01/2024 - TN-2024-0278 - IJ-2024-0142

SBC PSC MO #17
Mexico, Missouri
4th Revised Sheet 2
Replacing 3rd Revised Sheet 2

Non-Scannable Map

(Is viewable in the Data Center
200 Madison Street, 1st Floor
Jefferson City MO)

NO SUPPLEMENT TO THIS TARIFF WILL BE ISSUED EXCEPT FOR THE PURPOSE OF CANCELING THIS TARIFF.

P. S. C. Mo. No. 17 EXCHANGE AREA MAP

Mexico, Missouri

15th REVISED SHEET 3
REPLACING 14th REVISED SHEET 3

CANCELLED - Missouri Public Service Commission - 05/01/2024 - TN-2024-0278 - JI-2024-0142

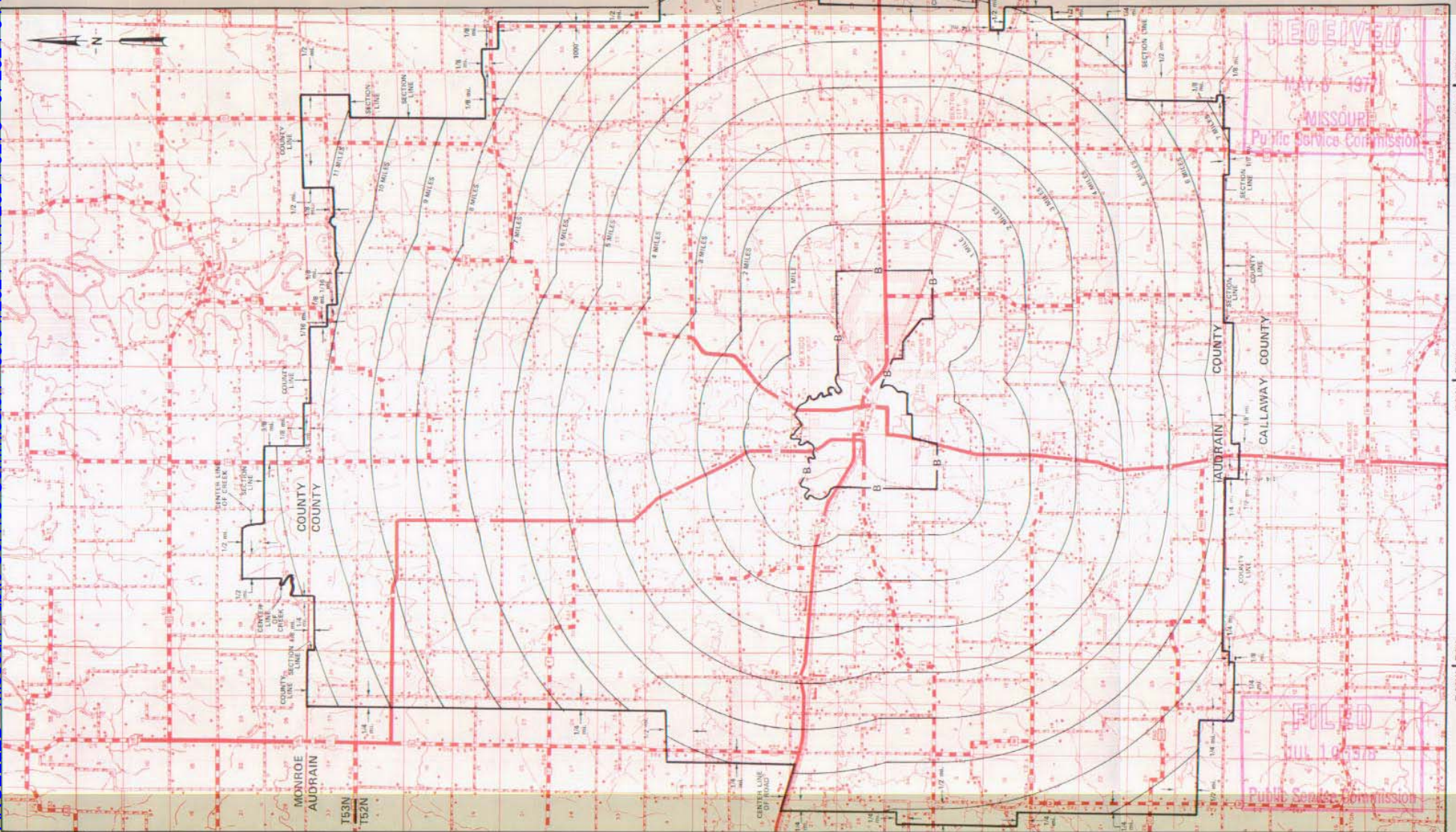

RECEIVED
MAY 6 1977
MISSOURI
Public Service Commission

FILED
JUL 10 1978
Public Service Commission

Issued: May 10, 1977

By R. R. SHOCKLEY, Vice President, Missouri
Southwestern Bell Telephone Company
St. Louis, Missouri

T52N
T51N

T51N
T50N

T50N
T49N

Effective: JUL 10 1978

R7W | R7W

R9W | R8W

R10W | R9W

SBC PSC MO #17
Moberly, Missouri
3rd Revised Sheet 2
Replacing 2nd Revised Sheet 2

Non-Scannable Map

(Is viewable in the Data Center
200 Madison Street, 1st Floor
Jefferson City MO)

NO SUPPLEMENT TO THIS TARIFF WILL BE ISSUED EXCEPT FOR THE PURPOSE OF CANCELING THIS TARIFF.

13th REVISED SHEET 3
REPLACING 12th REVISED SHEET 3

P. S. C. Mo. No. 17 EXCHANGE AREA MAP

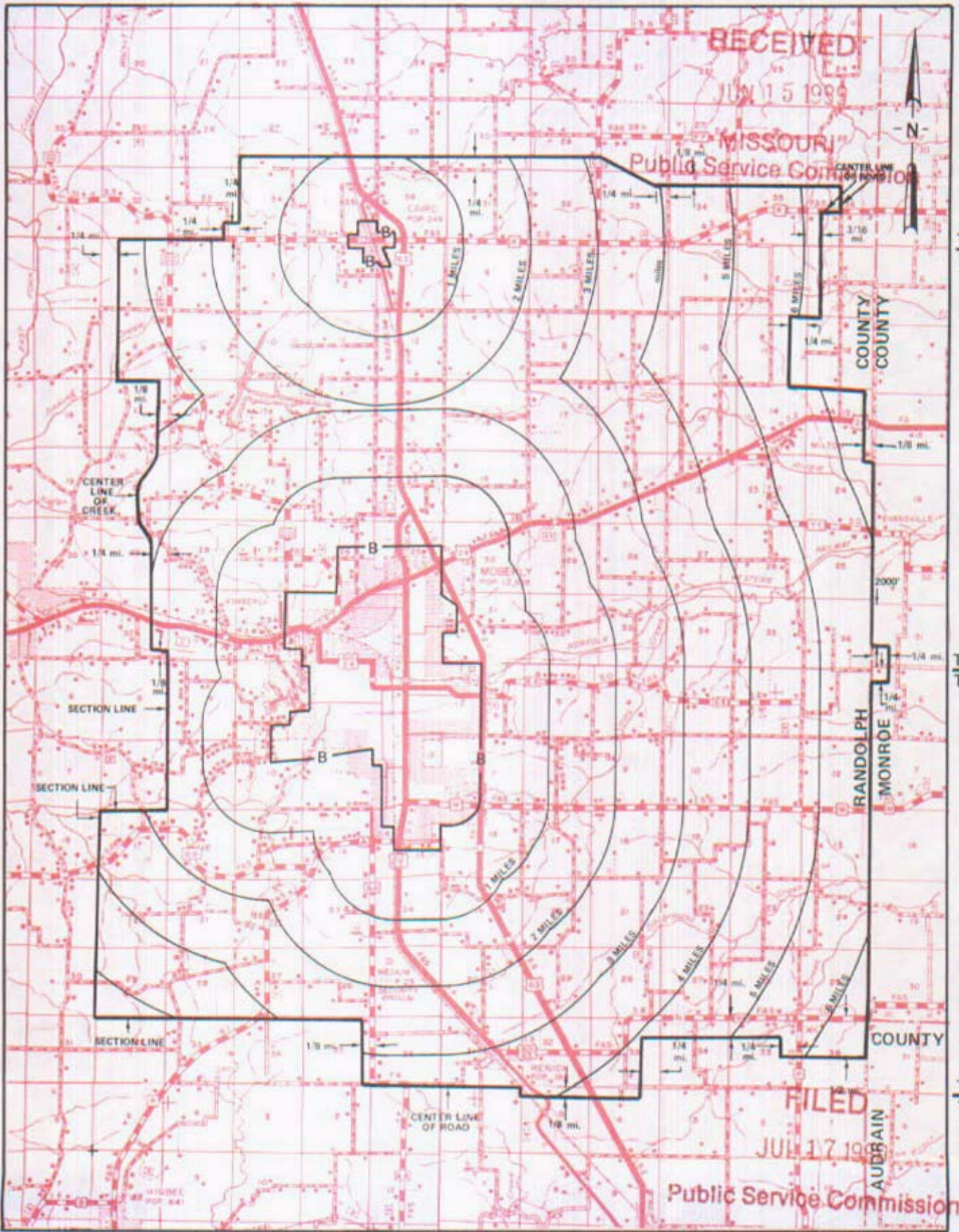

CANCELLED - Missouri Public Service Commission - 05/01/2024 - TN-2024-0278 - JI-2024-0142

R15W | R14W

R14W | R13W

R13W | R12W

JUL 15 1989

By R. D. BARRON, PRESIDENT, MISSOURI DIVISION
Southwestern Bell Telephone Company
St. Louis, Missouri

JUL 17 1989

Issued:

Effective:

NO SUPPLEMENT TO THIS TARIFF WILL BE ISSUED EXCEPT FOR THE PURPOSE OF CANCELING THIS TARIFF.

P. S. C. Mo. No. 17

Monett, Missouri

6th REVISED SHEET 2
REPLACING 5th REVISED SHEET 2

BASE RATE AREA MAP

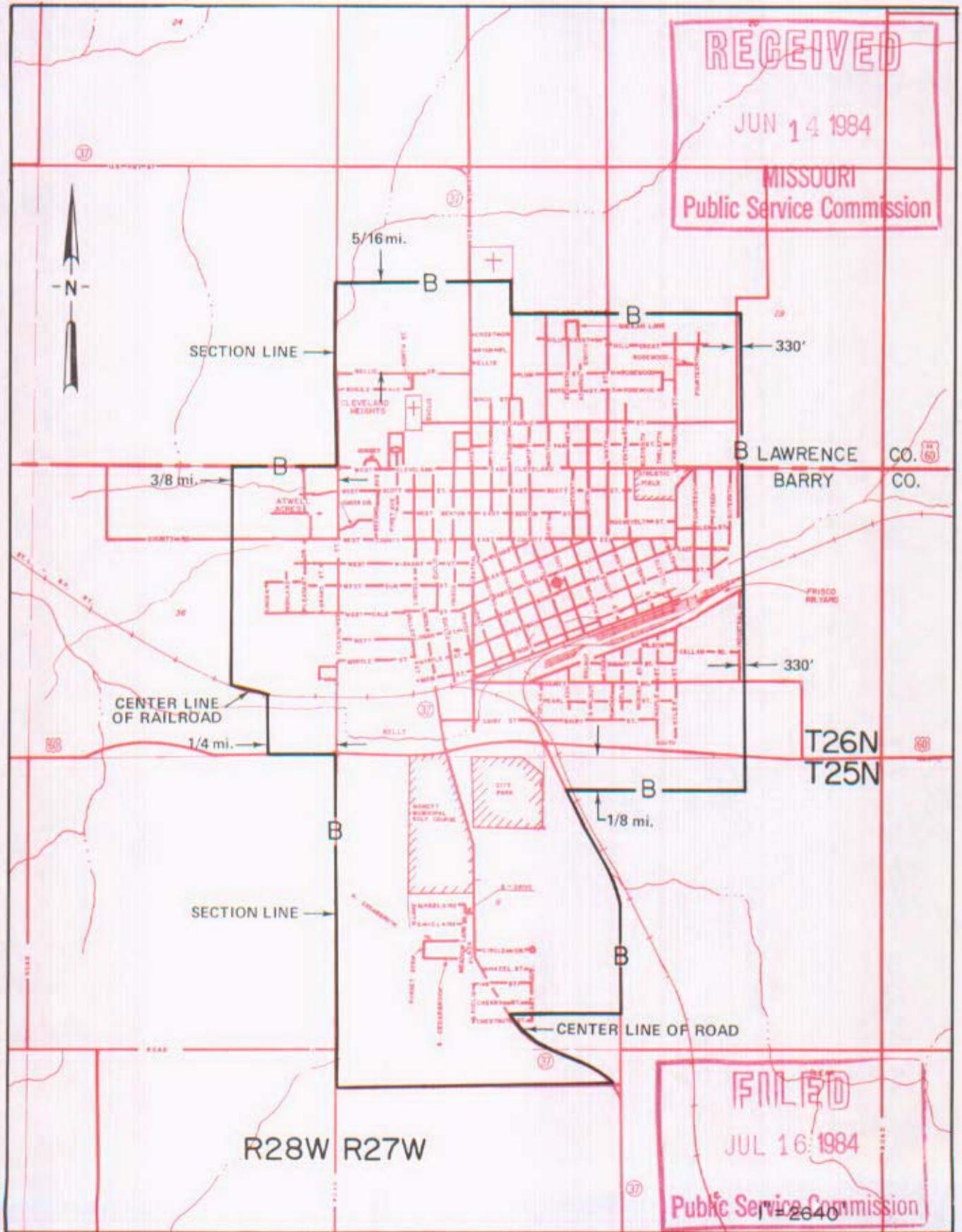

CANCELLED - Missouri Public Service Commission - 05/01/2024 - TN-2024-0278 - JI-2024-0142

Issued: JUN 15 1984

By R.D. BARRON, President, Missouri Division
Southwestern Bell Telephone Company
St. Louis, Missouri

Effective: JUL 16 1984

NO SUPPLEMENT TO THIS TARIFF WILL BE ISSUED EXCEPT FOR THE PURPOSE OF CANCELING THIS TARIFF.

P. S. C. Mo. No. 17

Monett, Missouri

Missouri Public

EXCHANGE AREA MAP

REPLACING

9th REVISED SHEET 3
7th REVISED SHEET 3

REC'D NOV 12 2002

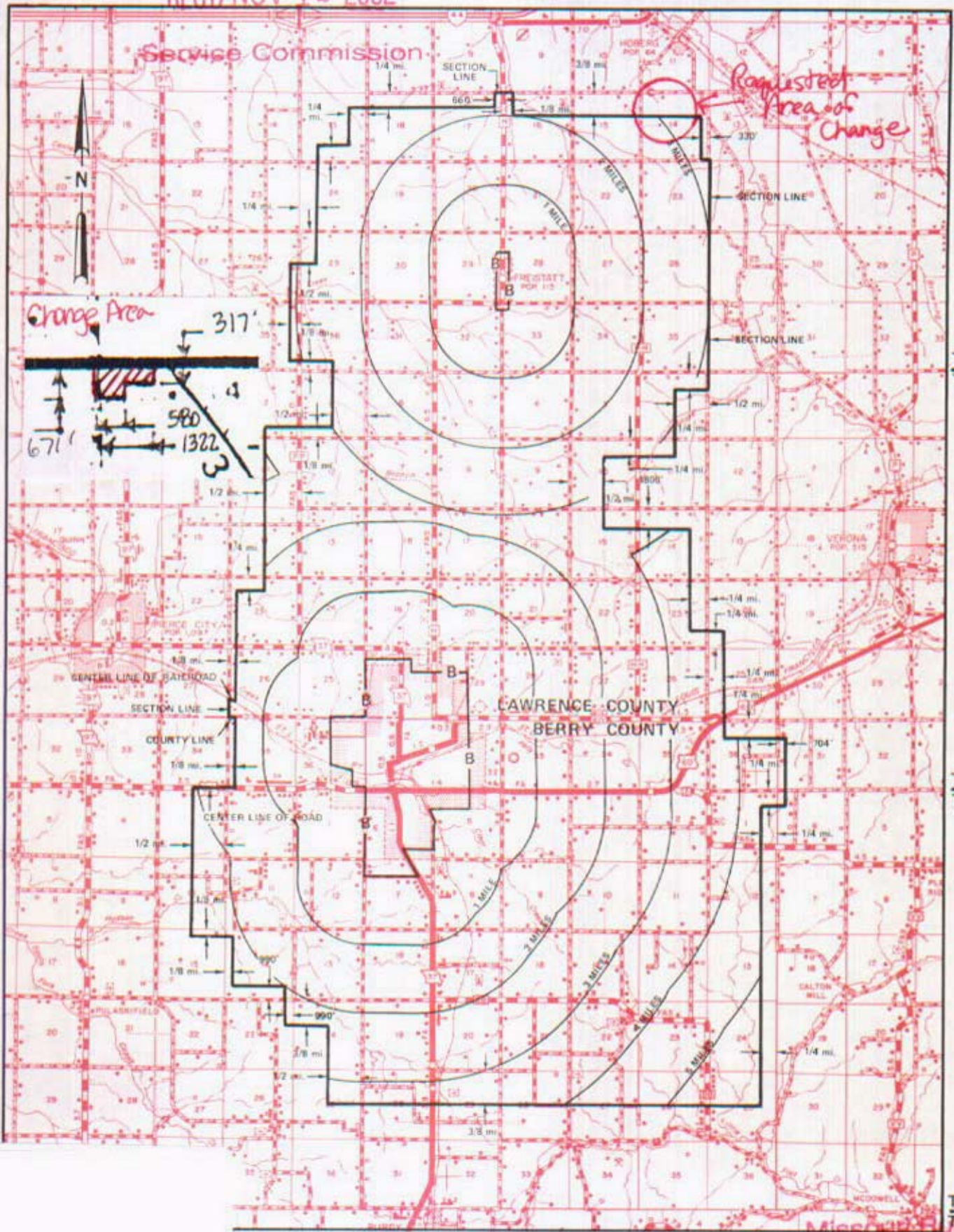

T27N
T26N

T26N
T25N

T25N
T24N

R28W | R27W

R27W | R26W

By Cindy Brinkley, President Missouri
Southwestern Bell Telephone, L.P., d/b/a Southwestern Bell Telephone Company
St. Louis, Missouri

FILED DEC 12 2002

CANCELLED - Missouri Public Service Commission - 05/01/2024 - TN-2024-0278 - JI-2024-0142

NO SUPPLEMENT TO THIS TARIFF WILL BE ISSUED EXCEPT FOR THE PURPOSE OF CANCELING THIS TARIFF.

P. S. C. Mo. No. 17

Monett, Missouri

EXCHANGE AREA MAP

8th REVISED SHEET 3 REPLACING 7th REVISED SHEET 3

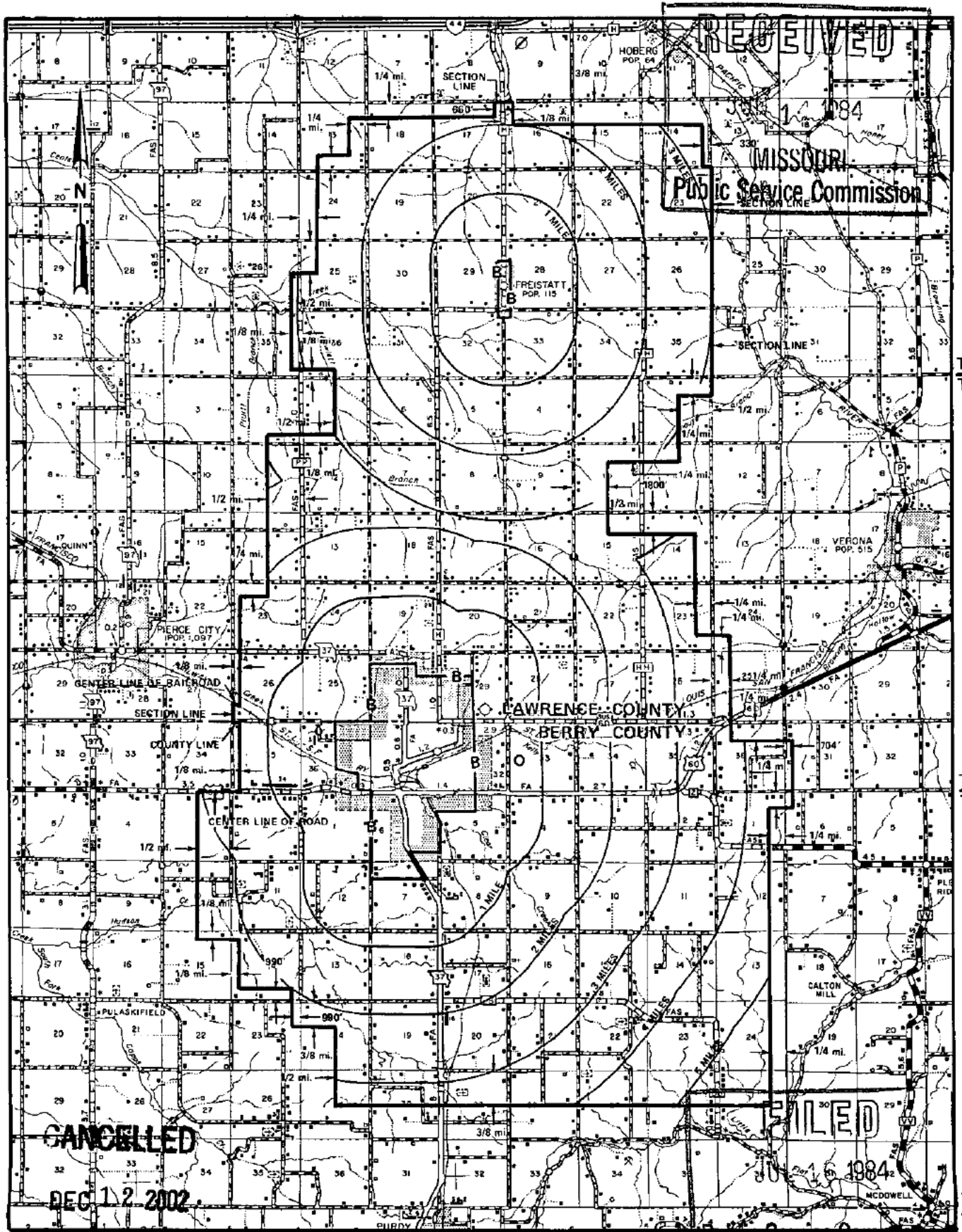

T27N
T26N

T26N
T25N

T25N
T24N

Public Service Commission MISSOURI

R28W | R27W
By R. D. BARRON, President, Missouri Division
Southwestern Bell Telephone Company
St. Louis, Missouri

Public Service Commission
R27W | R26W

Issued: JUNE 15, 1984

Effective: JULY 16, 1984

SBC PSC MO #17
Montgomery City, Missouri
1st Revised Sheet 2
Replacing Original Sheet 2

Non-Scannable
Map

(Is viewable in the Data Center
200 Madison Street, 1st Floor
Jefferson City MO)

CANCELLED - Missouri Public Service Commission - 05/01/2024 - TN-2024-0278

NO SUPPLEMENT TO THIS TARIFF WILL BE ISSUED EXCEPT FOR THE PURPOSE OF CANCELING THIS TARIFF.

P. S. C. Mo. No. 17
EXCHANGE AREA MAP

Missouri Public Service Commission
REPLACING REVISED SHEET 3
6th

REC'D NOV 08 1999

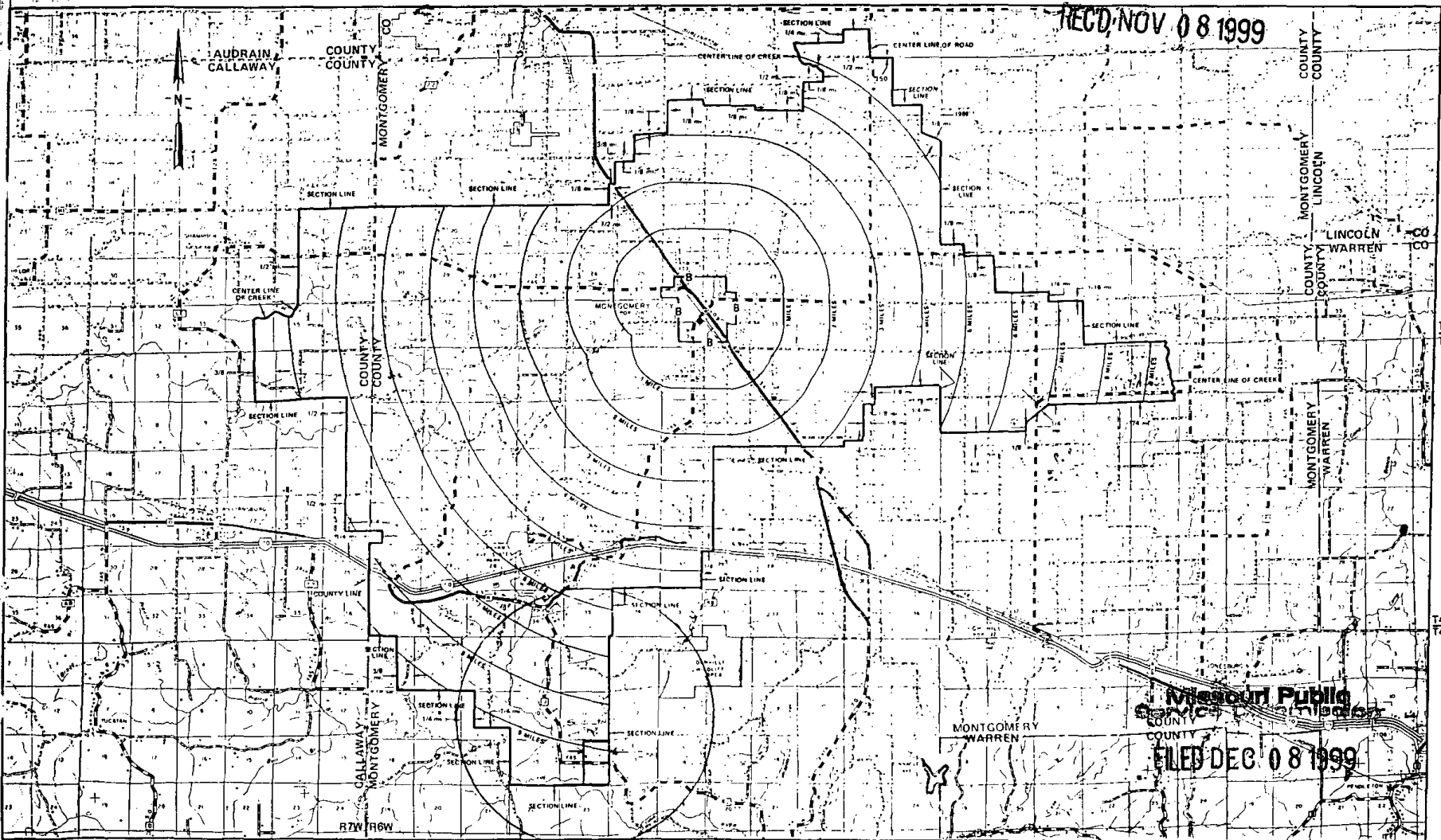

T50N

T49N

T49N

T48N

T48N

T47N

Missouri Public Service Commission
FILED DEC 08 1999

NO SUPPLEMENT TO THIS TARIFF WILL BE ISSUED EXCEPT FOR THE PURPOSE OF CANCELING THIS TARIFF.

P. S. C. Mo. No. 17
EXCHANGE AREA MAP

RECEIVED
Montgomery City, Missouri
6th REVISED SHEET 3
REPLACING 5th REVISED SHEET 3
FEB 14 1977

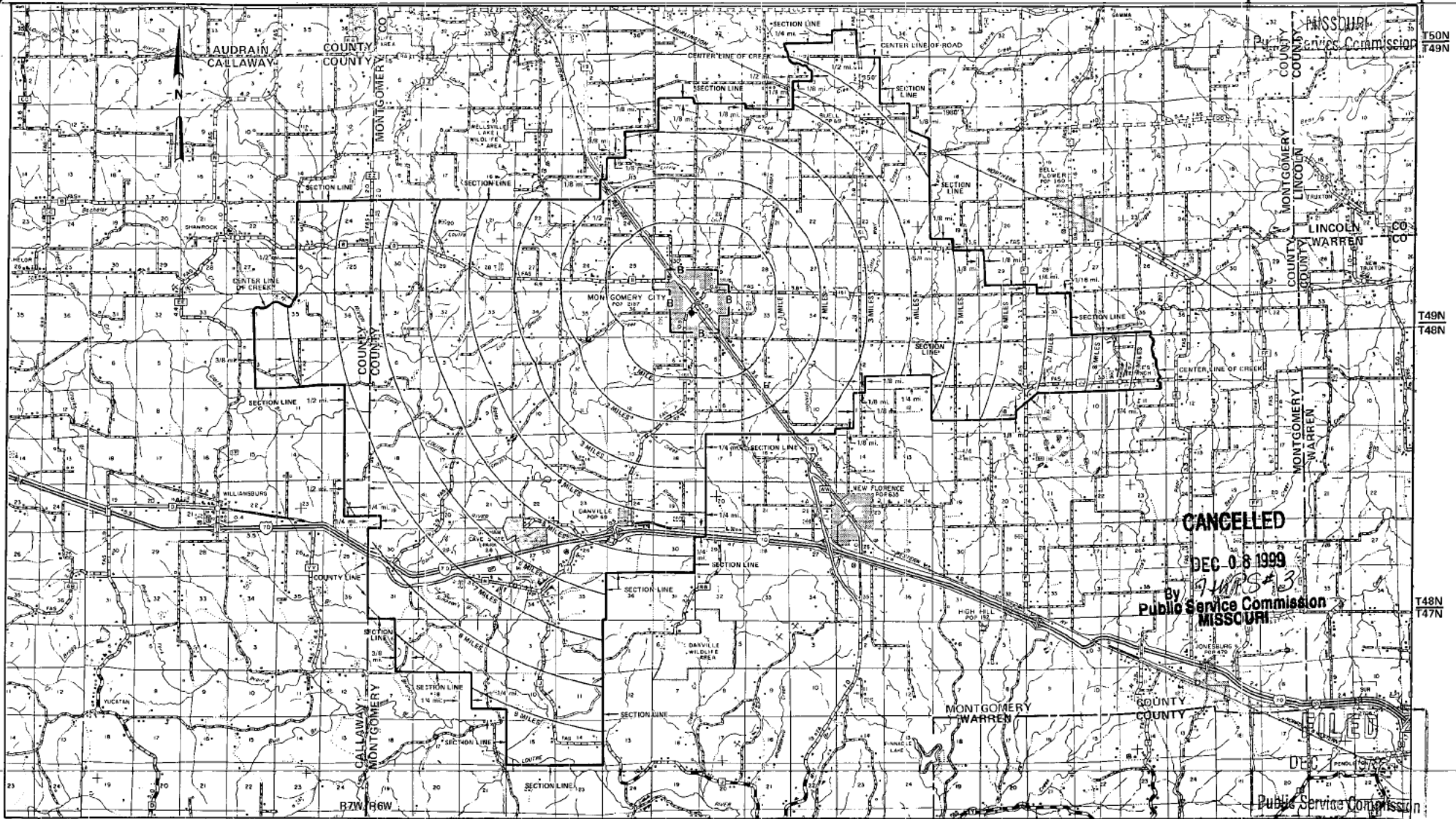

CANCELLED

DEC 0 8 1999
By Public Service Commission
MISSOURI

FILED

Public Service Commission

R8W/R7W

By R. R. SHOCKLEY, Vice President, Missouri
Southwestern Bell Telephone Company

R6W/R5W

R5W/R4W

R4W/R3W

Issued: February 15, 1977

St. Louis, Missouri

DEC 1 1978
Effective:

NO SUPPLEMENT TO THIS TARIFF WILL BE ISSUED EXCEPT FOR THE PURPOSE OF CANCELING THIS TARIFF.

P. S. C. Mo. No. 17

Morehouse, Missouri

APR 14 1977

EXCHANGE AREA MAP

4th REVISED SHEET 3
REPLACING 3rd REVISED SHEET 3

MISSOURI
Public Service Commission

CANCELLED - Missouri Public Service Commission - 05/01/2024 - TN-2024-0278 - JI-2024-0142

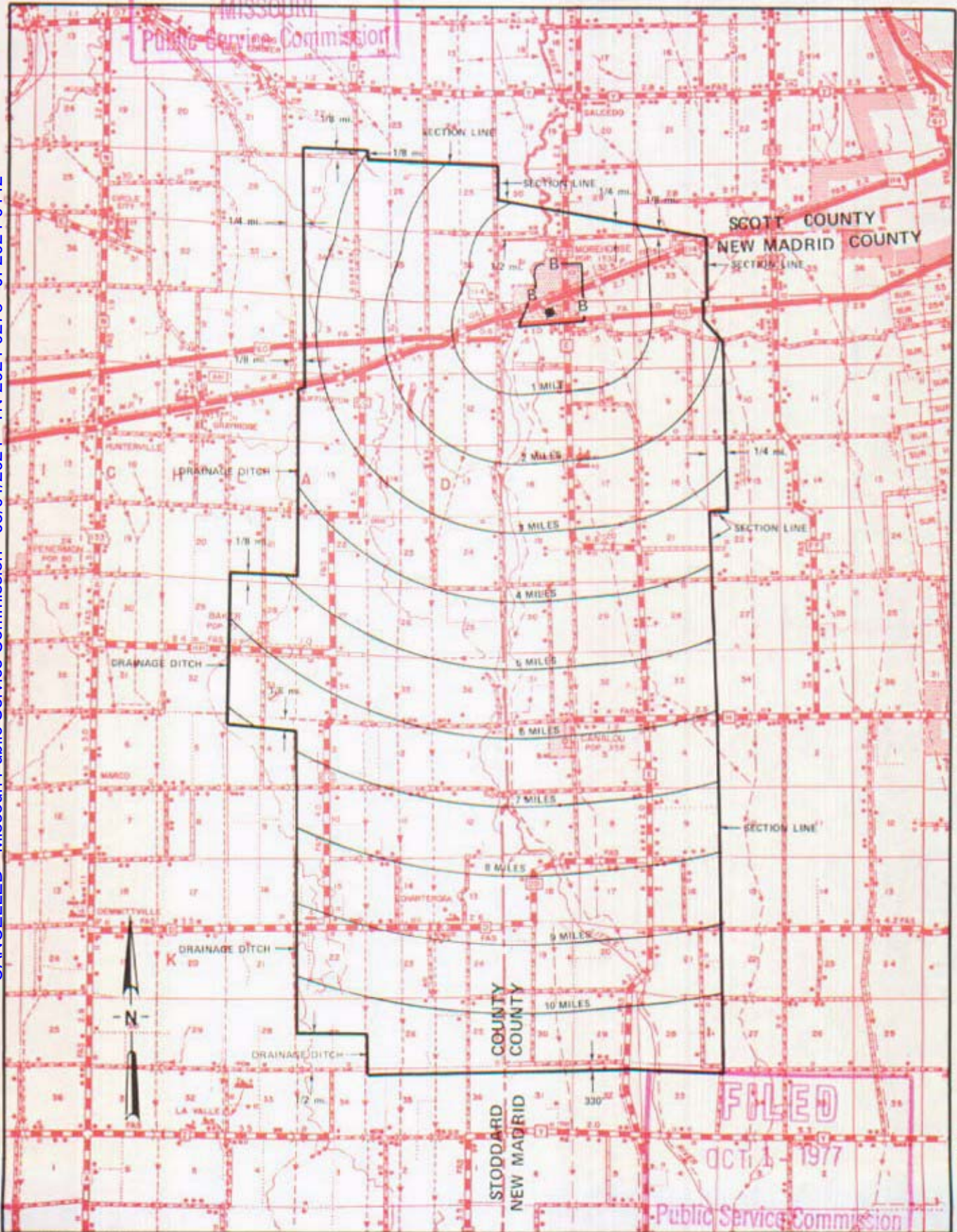

T26N
T25N

T25N
T24N

T24N
T23N

FILED
OCT 1 1977

Public Service Commission

By R. R. SHOCKLEY, Vice President, Missouri
Southwestern Bell Telephone Company

Issued: April 15, 1977

OCT 1 1977