

CANCELLED - Missouri Public Service Commission - 05/01/2024 - TN-2024-0278 - JI-2024-0142

OVERLAND

see

St. Louis District Exchange Rates

under

St. Louis

June 1, 1937

NO SUPPLEMENT TO THIS TARIFF WILL BE ISSUED EXCEPT FOR THE PURPOSE OF CANCELING THIS TARIFF.

Oak Ridge, Mo.  
FIRST REVISED SHEET 1-A  
REPLACING ORIGINAL SHEET 1-A

P. S. C. Mo. No. 2  
SOUTHEAST MISSOURI TELEPHONE COMPANY  
INITIAL RATE AREA MAP

RECEIVED  
MAR 21 1950  
MISSOURI  
Public Service Comm.

FILED  
MAR 21 1950  
Case No 11742  
Public Service Commission

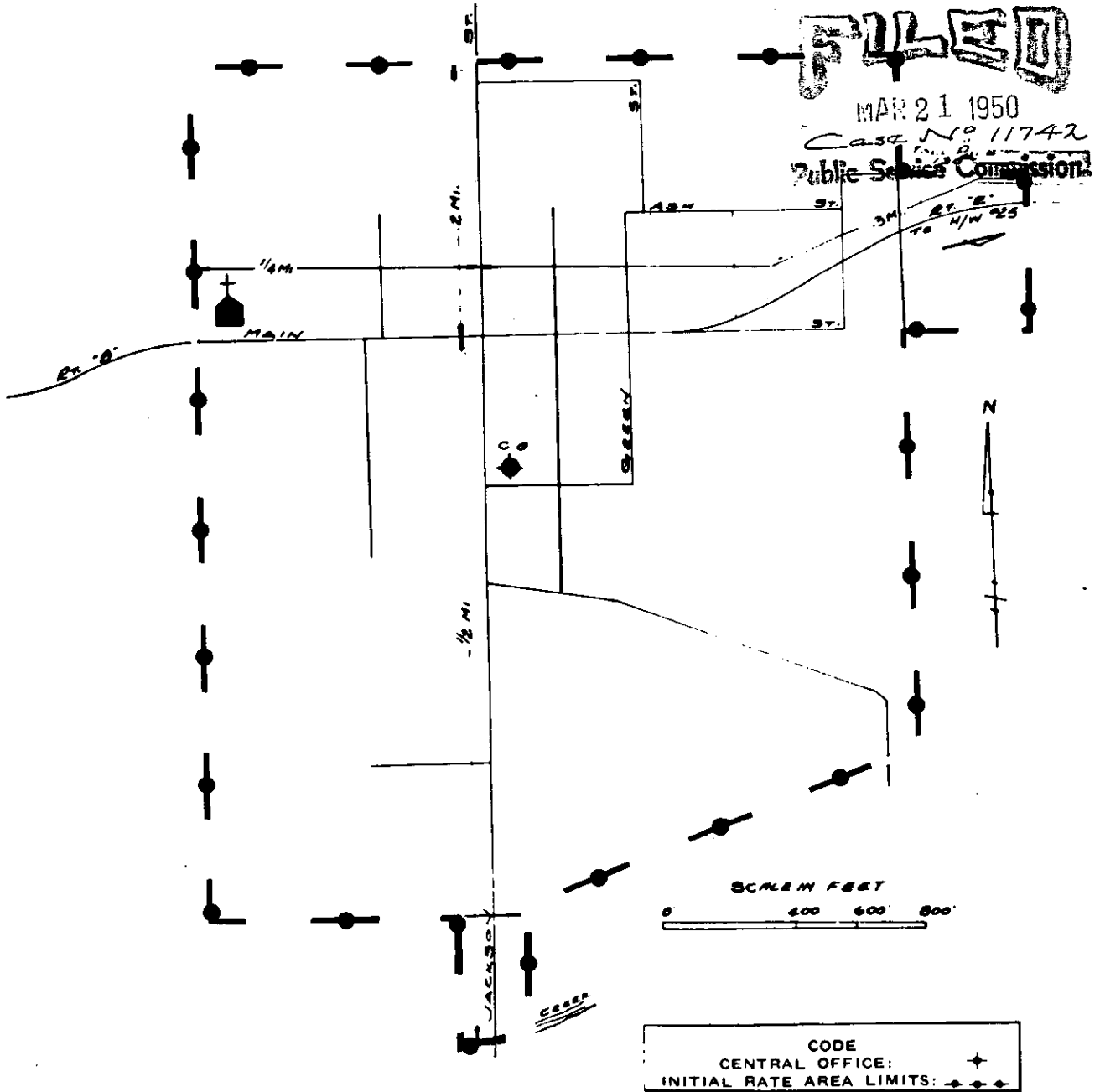

Issued: March 20, 1950

By C. W. BOUTIN, President and General Manager  
Cape Girardeau, Mo.

Effective: March 21, 1950

CANCELLED - Missouri Public Service Commission - 05/01/2024 - TN-2024-0278 - JI-2024-0142

OAK RIDGE, MO.



NO SUPPLEMENT TO THIS TARIFF WILL BE ISSUED EXCEPT FOR THE PURPOSE OF CANCELING THIS TARIFF.

P. S. C. Mo. No. 17

# EXCHANGE AREA MAP

Oak Ridge, Missouri  
RECEIVED  
5th REVISED SHEET 3  
REPLACING 4th REVISED SHEET 3

FEB 14 1977

CANCELLED - Missouri Public Service Commission - 05/01/2024 - TN-2024-0278 - JI-2024-0142

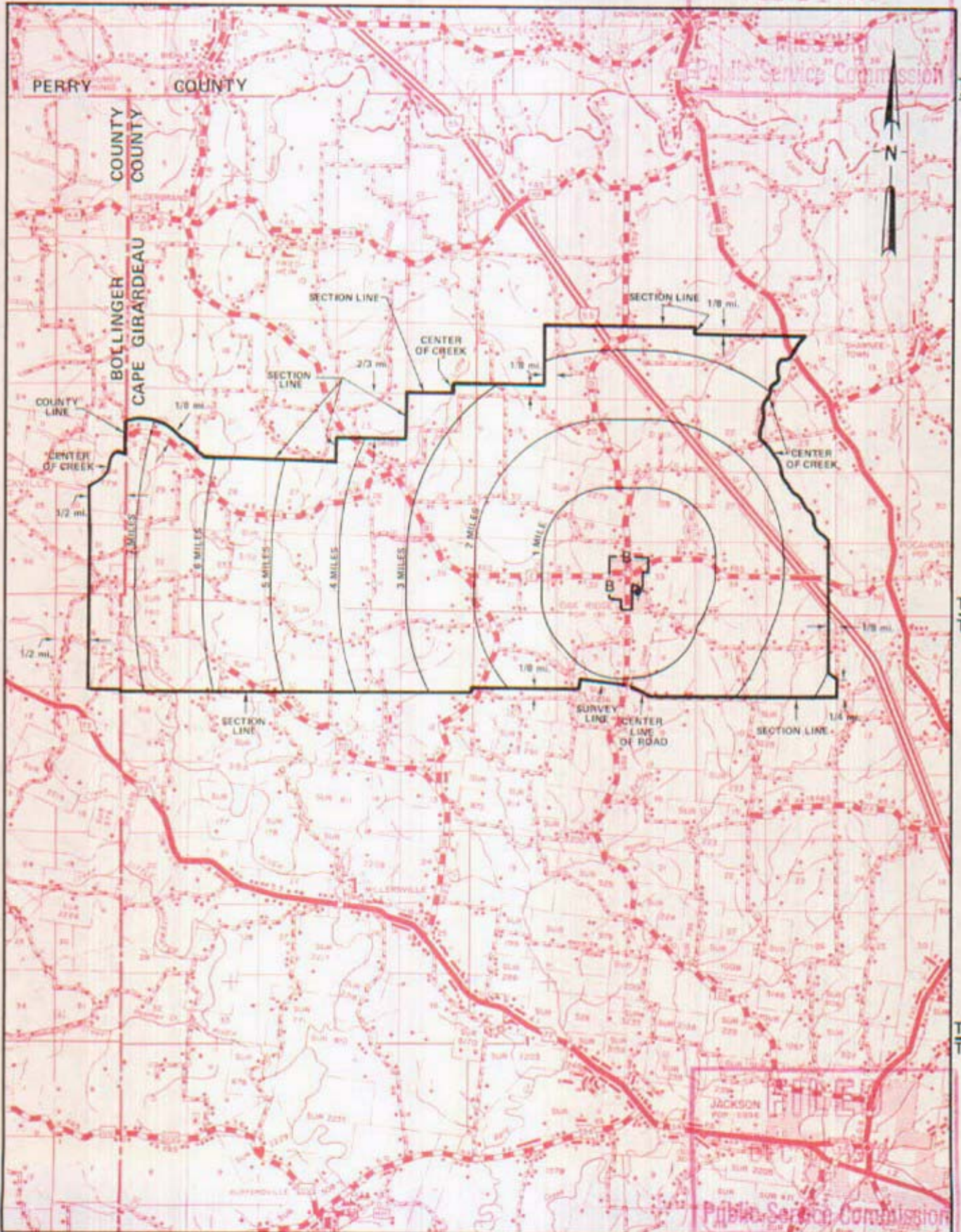

R10E | R11E

R11E | R12E

R12E | R13E

By R. R. SHOCKLEY, Vice President, Missouri  
Southwestern Bell Telephone Company

DEC 1 1978

February 15 1977



NO SUPPLEMENT TO THIS TARIFF WILL BE ISSUED EXCEPT FOR THE PURPOSE OF CANCELING THIS TARIFF.

P. S. C. Mo. No. 17

Old Appleton, Missouri

# EXCHANGE AREA MAP

7th REVISED SHEET 3  
REPLACING 6th REVISED SHEET 3

CANCELLED - Missouri Public Service Commission - 05/01/2024 - TN-2024-0278 - JI-2024-0142

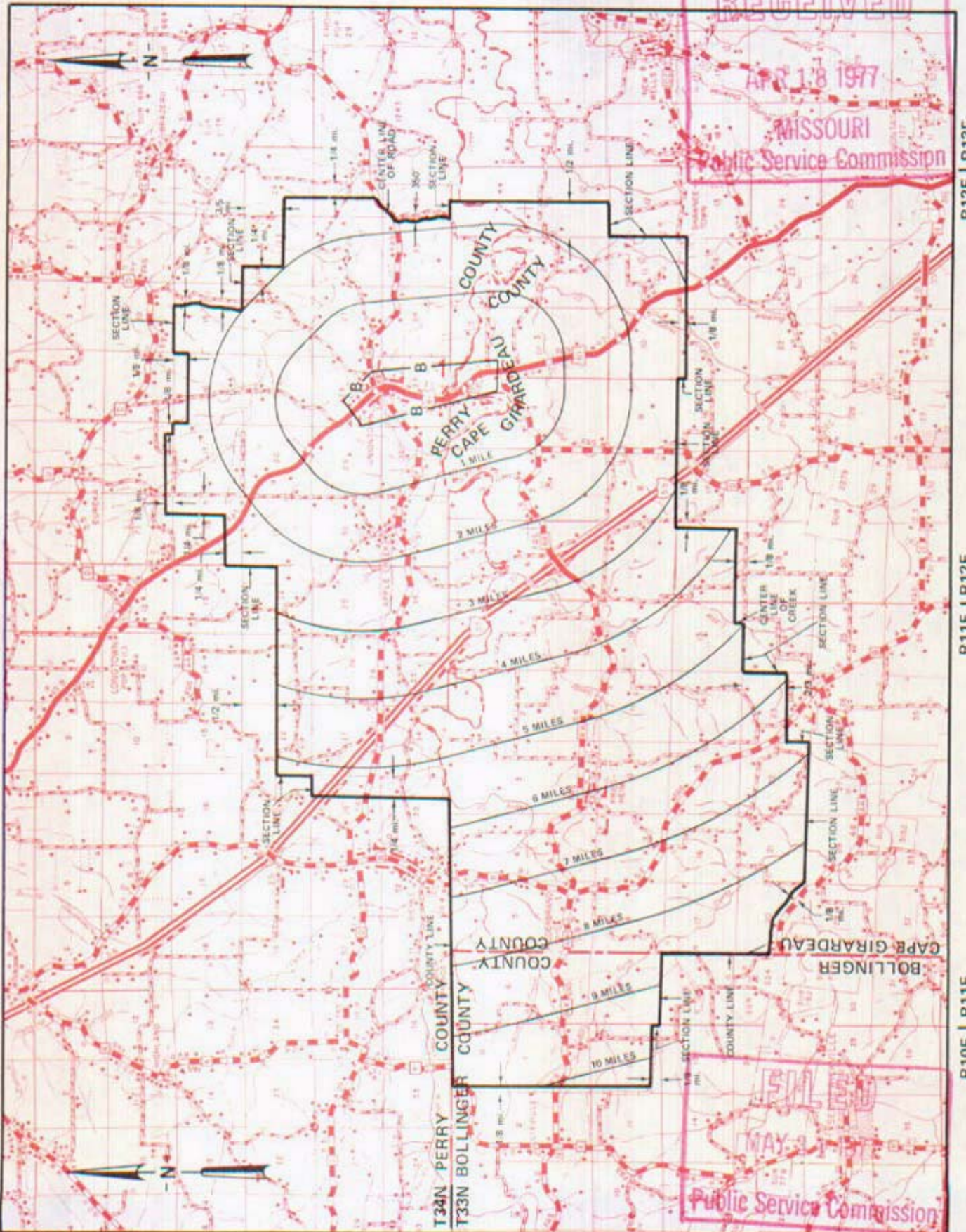

T35N  
T34N

By R. R. SHOCKLEY, Vice President, Missouri  
Southwestern Bell Telephone Company

April 20, 1977

**SBC PSC MO #17**

**Oran, Missouri**

**Original Sheet 2**

**Replacing 1<sup>st</sup> Revised Sheet 1-A**

**Southeast Missouri Telephone Company**

**P.S.C. Mo. No. 2**

# **Non-Scannable Map**

**(Is viewable in the Data Center  
200 Madison Street, 1<sup>st</sup> Floor  
Jefferson City MO)**



NO SUPPLEMENT TO THIS TARIFF WILL BE ISSUED EXCEPT FOR THE PURPOSE OF CANCELING THIS TARIFF.

P. S. C. Mo. No. 17

Oran, Missouri

EXCHANGE AREA MAP

6th REVISED SHEET 3 REPLACING 5th REVISED SHEET 3

CANCELLED - Missouri Public Service Commission - 05/01/2024 - TN-2024-0278 - JI-2024-0142

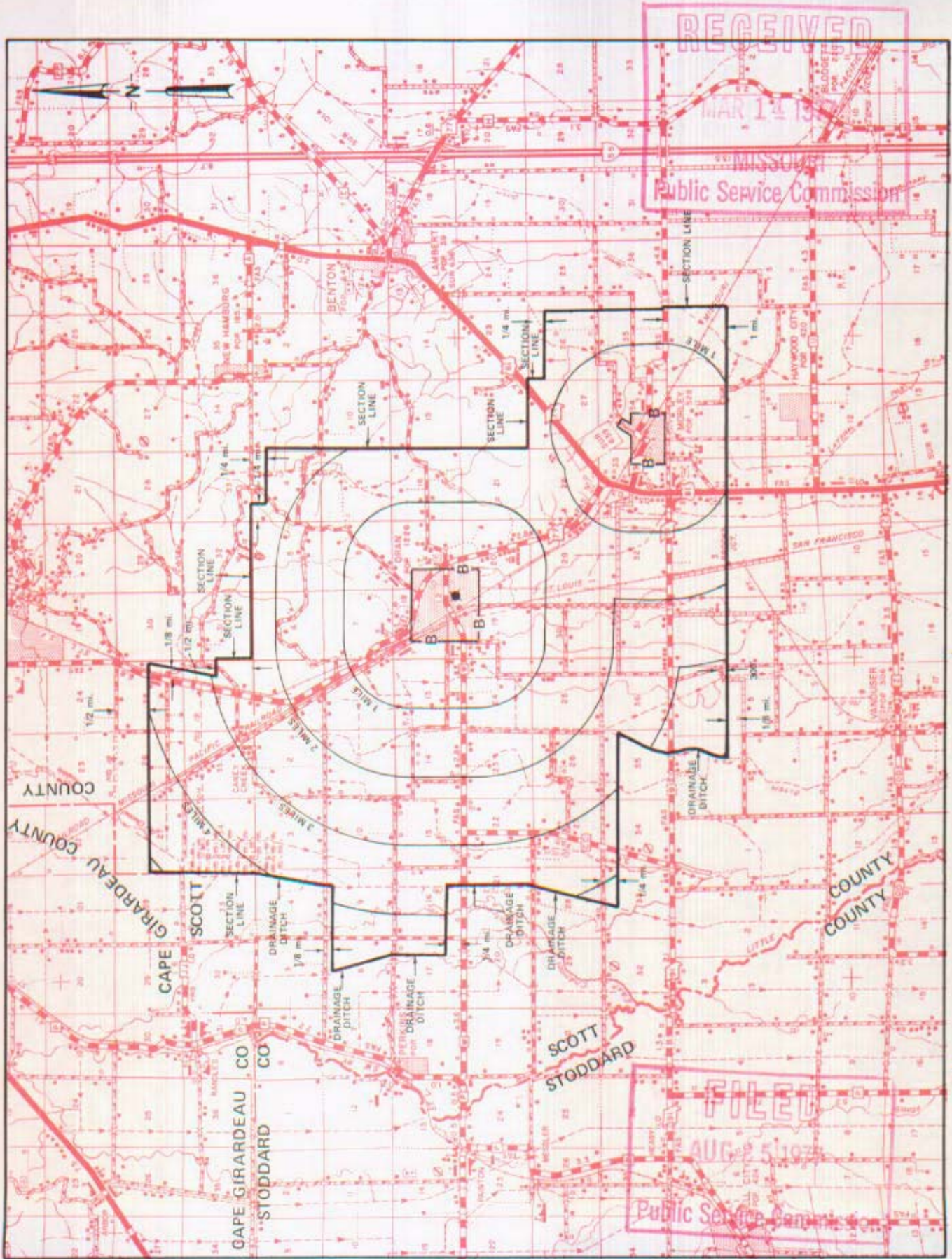

By R. R. SHOCKLEY, Vice President, Missouri Southwestern Bell Telephone Company

Issued: March 15, 1977

St. Louis, Missouri

Effective: AUG 25 1977

No supplement to this tariff will be issued except for the purpose of canceling this tariff.

P. S. C. Mo.-No. 17

OSAGE BEACH, MISSOURI  
ORIGINAL SHEET 2  
REPLACING 2ND REVISED SHEET 2  
OF THE OZARK CENTRAL TELEPHONE COMPANY

This exchange has been consolidated with the Lake Ozark exchange. For local rates applicable to Osage Beach please refer to the Lake Ozark-Osage Beach Local Exchange Tariffs.

RECEIVED  
FEB 21 1968  
MISSOURI  
Public Service Commis

CANCELLED - Missouri Public Service Commission - 05/01/2024 - TN-2024-0278 - JI-2024-0142

FILED

APR 1 - 1968

PUBLIC SERVICE COMMISSION

Issued: March 1, 1968

Effective: April 1, 1968

By R. R. SHOCKLEY, Vice President and General Manager  
Southwestern Bell Telephone Company  
St. Louis, Missouri



No supplement to this tariff will be issued except for the purpose of canceling this tariff.

P. S. C. Mo.-No. 17

OSAGE BEACH, MISSOURI  
5TH REVISED SHEET 3  
REPLACING 4TH REVISED SHEET 3

This exchange has been consolidated with the Lake Ozark exchange. For local rates applicable to Osage Beach please refer to the Lake Ozark-Osage Beach Local Exchange Tariffs.

RECEIVED  
FEB 21 1968  
MISSOURI  
Public Service Comm.

CANCELLED - Missouri Public Service Commission - 05/01/2024 - TN-2024-0278 - JI-2024-0142

FILED

APR 1 - 1968

PUBLIC SERVICE COMMISSION

Issued: March 1, 1968

Effective: April 1, 1968

By R. R. SHOCKLEY, Vice President and General Manager  
Southwestern Bell Telephone Company  
St. Louis, Missouri