

NO SUPPLEMENT TO THIS TARIFF WILL BE ISSUED EXCEPT FOR THE PURPOSE OF CANCELING THIS TARIFF.

P. S. C. Mo. No. 17

Pacific, Missouri

2nd REVISED SHEET 2
1st REVISED SHEET 2

BASE RATE AREA MAP

CANCELLED - Missouri Public Service Commission - 05/01/2024 - TN-2024-0278 - JI-2024-0142

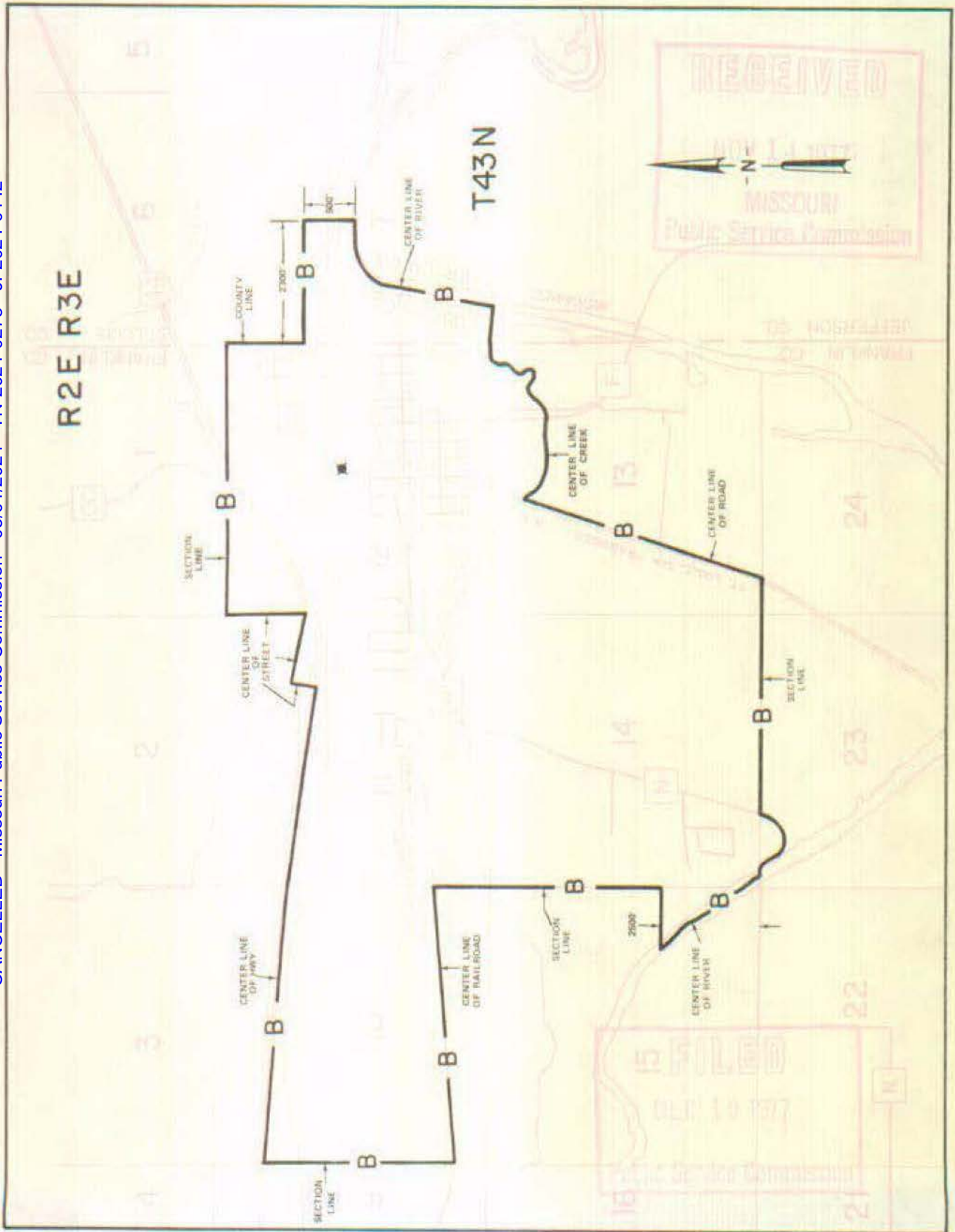

By R. R. SHOCKLEY, Vice President, Missouri
Southwestern Bell Telephone Company
St. Louis, Missouri

Issued: November 18, 1977

Effective: December 19, 1977

EXCHANGE AREA MAP

9th REVISED SHEET 3
REPLACING 8th REVISED SHEET 3

CANCELLED - Missouri Public Service Commission - 05/01/2024 - TN-2024-0278 - JI-2024-0142

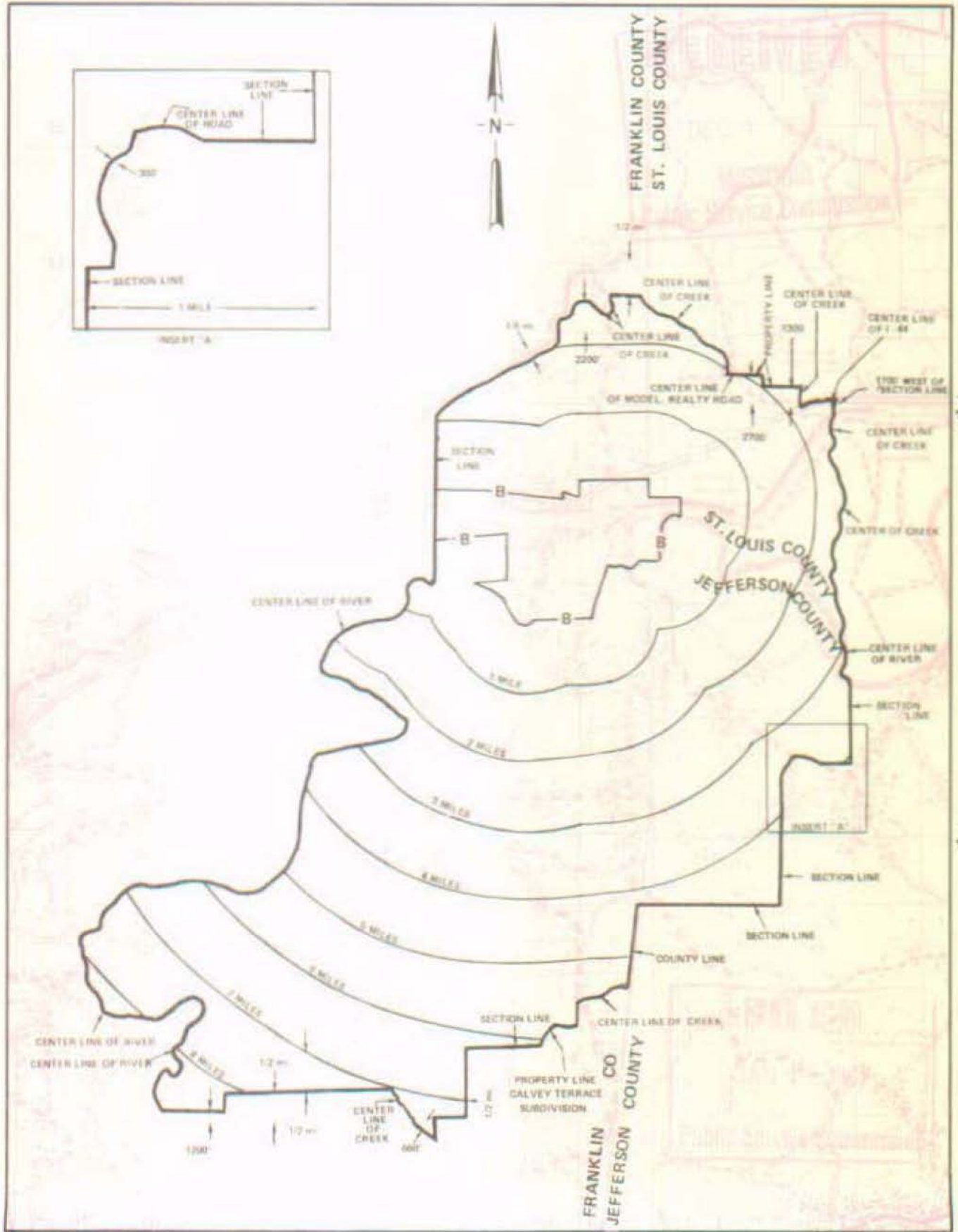

R1E | R2E

R2E | R3E

By R.D. BARRON, PRESIDENT—MISSOURI DIVISION
Southwestern Bell Telephone Company
St. Louis, Missouri

SBC PSC MO #17
Patton, Missouri
1st Revised Sheet 2
Replacing Original Sheet 2

Non-Scannable Map

(Is viewable in the Data Center
200 Madison Street, 1st Floor
Jefferson City MO)

NO SUPPLEMENT TO THIS TARIFF WILL BE ISSUED EXCEPT FOR THE PURPOSE OF CANCELING THIS TARIFF.

P. S. C. Mo. No. 17

Patton, Missouri

EXCHANGE AREA MAP

11th REVISED SHEET 3 REPLACING 10th REVISED SHEET 3

RECEIVED

APR 18 1977

MISSOURI PUBLIC SERVICE COMMISSION

Public Service Commission

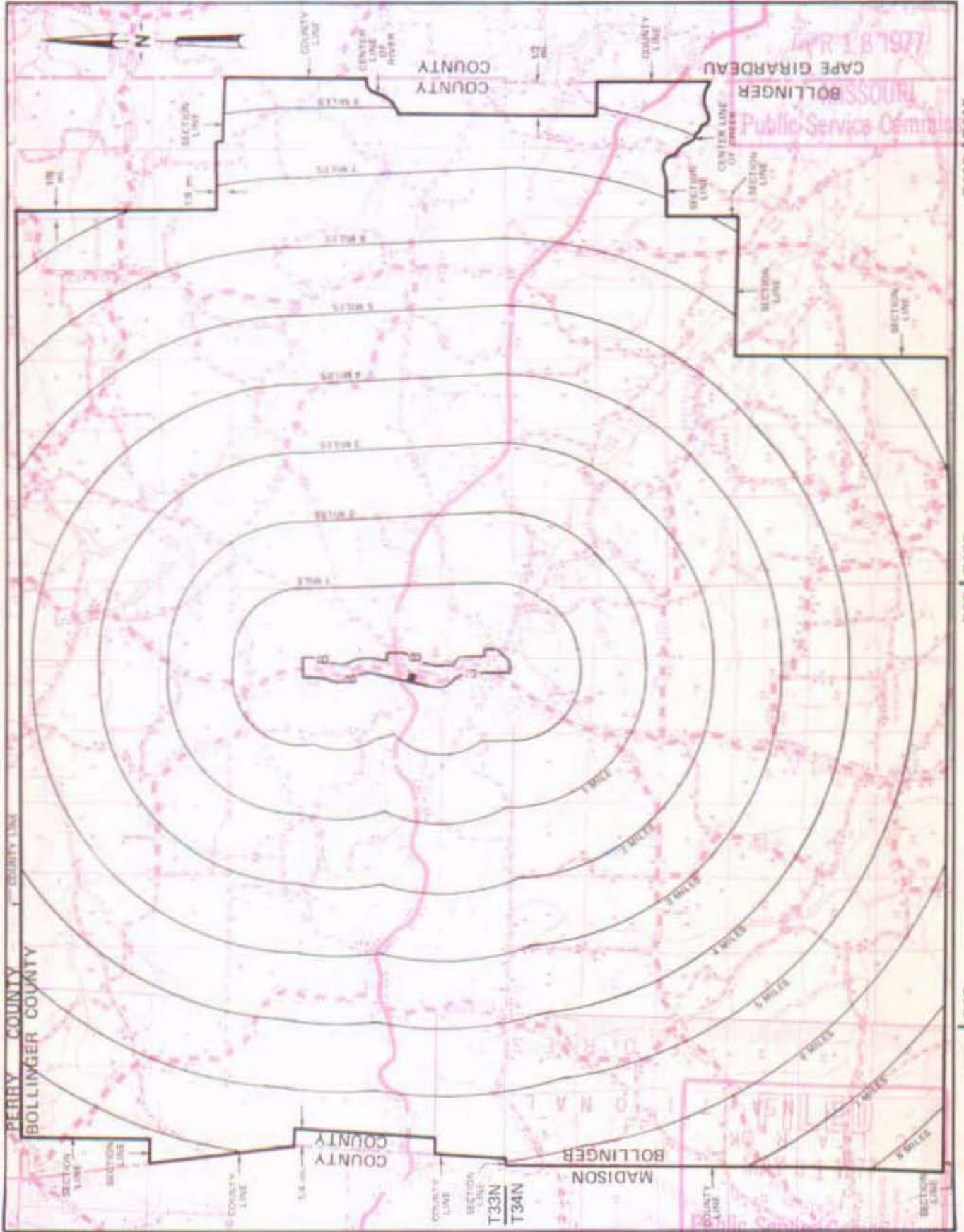

CANCELLED - Missouri Public Service Commission - 05/01/2024 - TN-2024-0278 - JI-2024-0142

By R. R. SHOCKLEY, Vice President, Missouri Southwestern Bell Telephone Company St. Louis, Missouri

Issued: April 20, 1977

Effective: May 31, 1977

CANCELLED - Missouri Public Service Commission - 05/01/2024 - TN-2024-0278 - JI-2024-0142

PATTONVILLE

SEE

St. Louis District Exchange Rates

under

St. Louis

June 1, 1937

NO SUPPLEMENT TO THIS TARIFF WILL BE ISSUED EXCEPT FOR THE PURPOSE OF CANCELING THIS TARIFF.

Paynesville, Missouri
ORIGINAL SHEET 2
REPLACING ORIGINAL SHEET 1-A

P. S. C. Mo. No. 17

BASE RATE AREA MAP

RECEIVED
OCT 14 1950
MISSOURI
Public Service Comm.

FILED

NOV 15 1950

PUBLIC SERVICE COMMISSIC

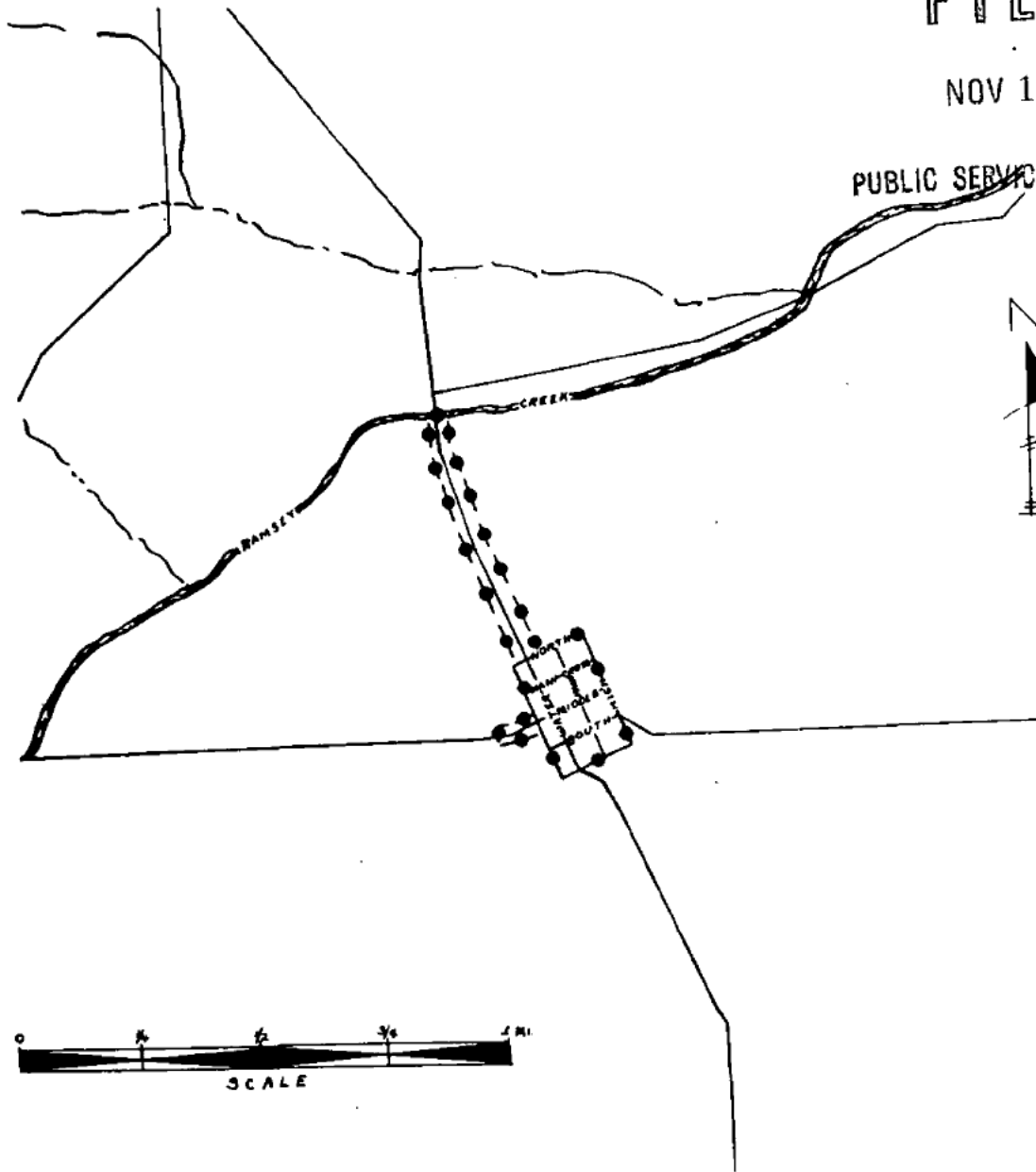

CODE
BELL CENTRAL OFFICE: ◆
BASE RATE AREA LIMITS: ◆◆◆

CANCELLED - Missouri Public Service Commission - 05/01/2024 - TN-2024-0278 - JI-2024-0142

Issued: October 16, 1950

Effective: November 15, 1950

By H. R. TOWLES, General Manager
Southwestern Bell Telephone Company
St. Louis, Mo.

NO SUPPLEMENT TO THIS TARIFF WILL BE ISSUED EXCEPT FOR THE PURPOSE OF CANCELING THIS TARIFF.

P. S. C. Mo. No. 17 EXCHANGE AREA MAP

RECEIVED
Paynesville, Missouri
8th REVISED SHEET 3
REPLACING 7th REVISED SHEET 3
JUL 11 1977
MISSOURI
Public Service Commission

CANCELLED - Missouri Public Service Commission - 05/01/2024 - TN-2024-0278 - JI-2024-0142

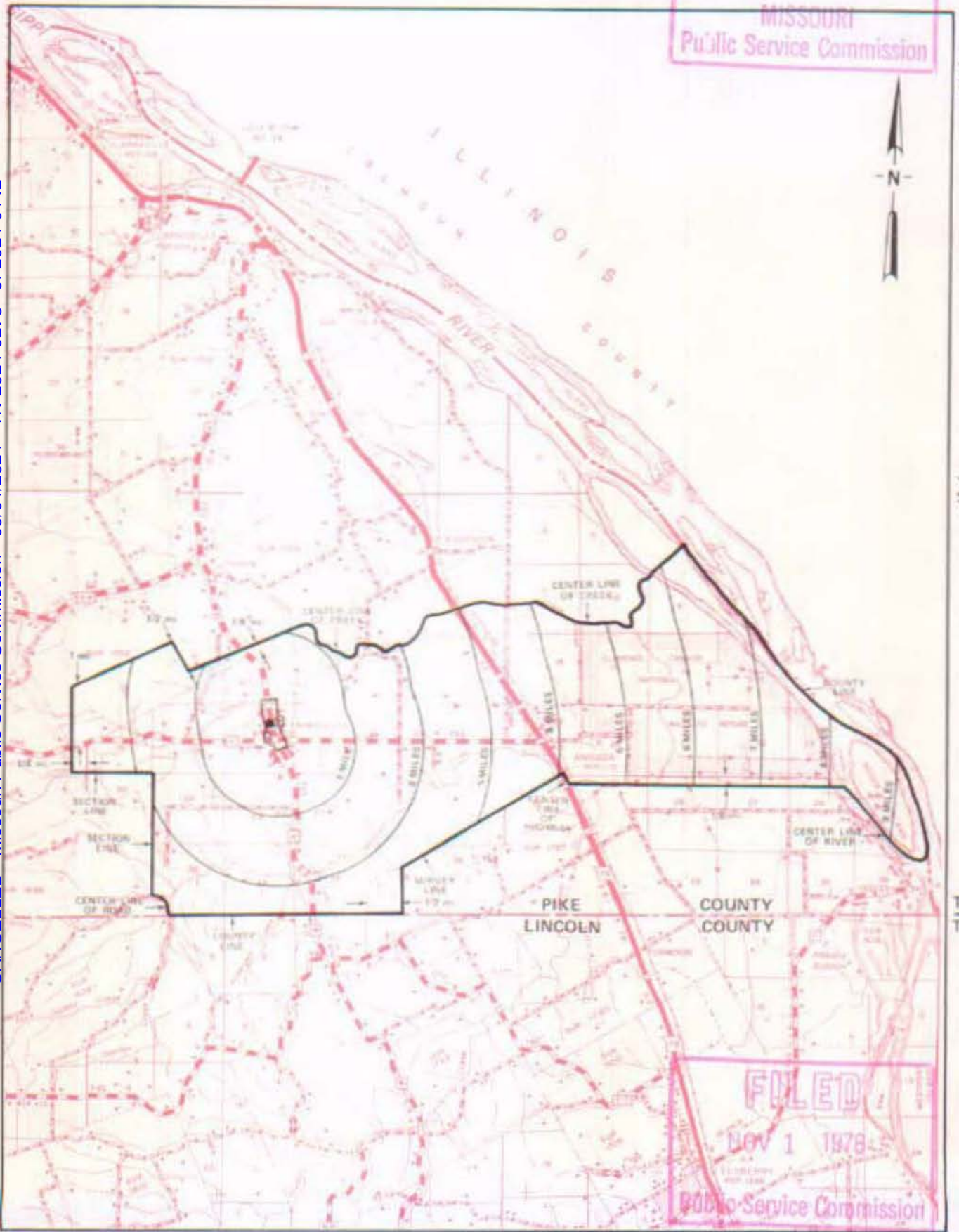

T54N
T53N

T53N
T52N

T52N
T51N

FILED
NOV 1 1978
Public Service Commission

R1W | R1E

R1E | R2E

By R. R. SHOCKLEY, Vice President, Missouri
Southwestern Bell Telephone Company
St. Louis, Missouri

NOV 1 - 1978

Issued: July 11, 1977

Effective: _____

SBC PSC MO #17
Perryville, Missouri
2nd Revised Sheet 2
Replacing 1st Revised Sheet 2

Non-Scannable Map

(Is viewable in the Data Center
200 Madison Street, 1st Floor
Jefferson City MO)

CANCELLED - Missouri Public Service Commission - 05/01/2024 - TN-2024-0278 - JI-2024-0142

NO SUPPLEMENT TO THIS TARIFF WILL BE ISSUED EXCEPT FOR THE PURPOSE OF CANCELING THIS TARIFF.

P. S. C. Mo. No. 17 EXCHANGE AREA MAP

Perryville, Missouri

13th REVISED SHEET 3
REPLACING 12th REVISED SHEET 3

RECEIVED
NOV 7, 1991

MO. PUBLIC SERVICE COMM.

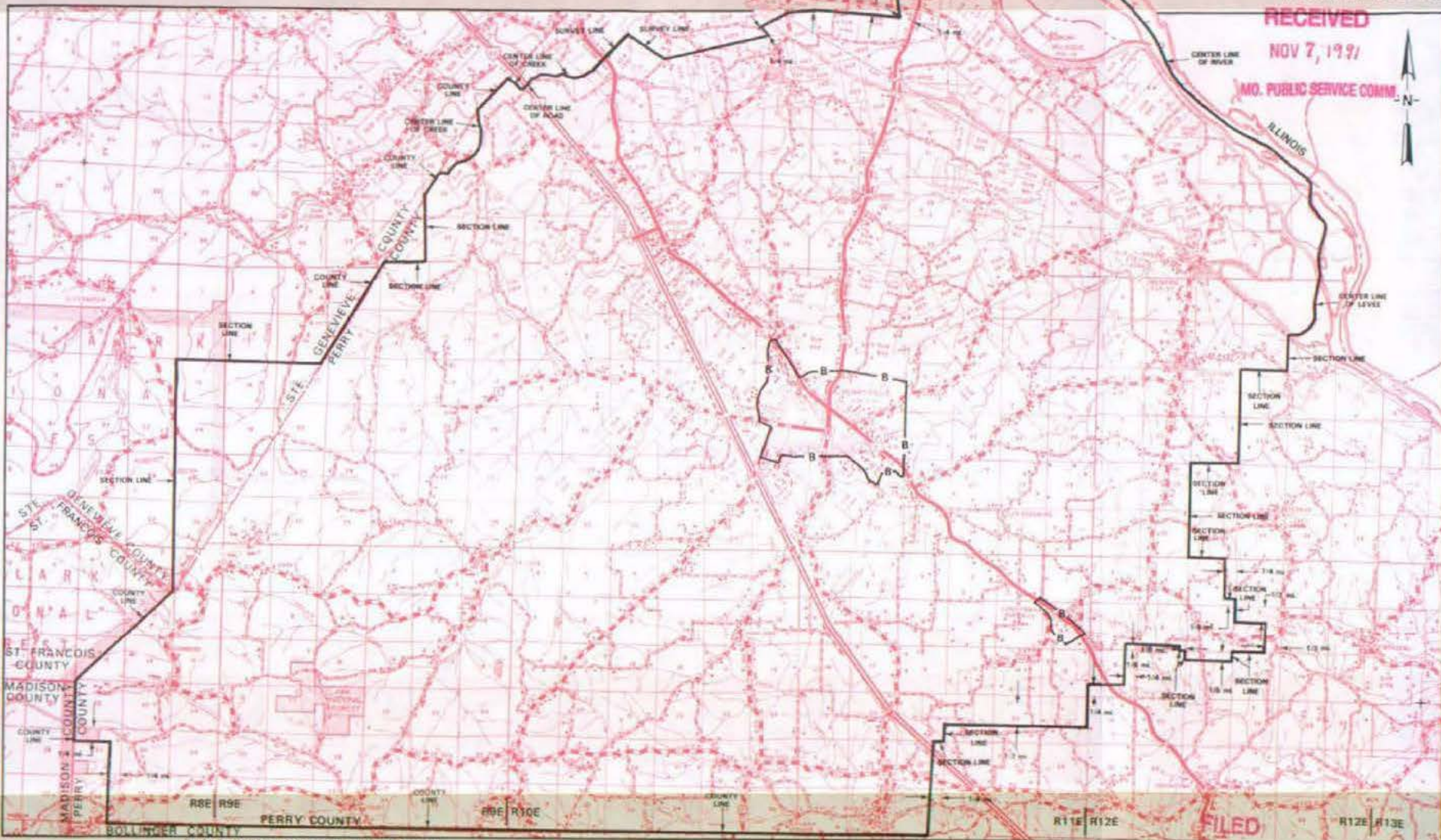

T36N
T35N

T35N
T34N

FILED

DEC 18, 1991

Effective: December 18, 1991

Public Service Commission

Issued: November 12, 1991

By R. D. BARRON, President, Missouri Division
Southwestern Bell Telephone Company
St. Louis, Missouri

No Supplement to this tariff will be issued except for the purpose of canceling this tariff.

Missouri Portion-
Pittsburg, Kansas Exchange
32nd Revised Sheet 1
Replacing 31st Revised Sheet 1

LOCAL EXCHANGE TARIFF

I. GENERAL

This Tariff is governed, except as otherwise specified herein, by all other Tariffs of the Southwestern Bell Telephone Company on file in the State of Missouri, which are hereby made a part of this Tariff. Unless otherwise specified, the charges quoted in this Tariff or in any other Missouri Tariff are for periods of one month, are payable monthly in advance and entitle the customer to exchange telephone service within the Atchison Exchange Area. This Exchange Area includes, in addition to the Missouri Portion, certain territories in the State of Kansas comprising the Cities of Pittsburg, Frontenac and vicinity, as shown on the Exchange Area Map for this exchange.

II. RATES

- A. The rates for main service do not include a Telephone Company-provided instrument.
- B. Within the Missouri Portion of the exchange, rates will be frozen until March 1, 1995. Urban mileage charges as set forth in Paragraph C. and D. following, apply as applicable, in addition to exchange rates when service is provided outside the Basic Rate Area. Exchange rates are as follows:

1. Flat Rate Service	Current Rates(1)	
	<u>Business</u>	<u>Residence</u>
One-Party	\$17.56(CR)	\$ 9.51(CR)
Lifeline	N/A	(2)
One-Party Multiline	20.60	N/A
PBX Trunk	29.20	14.70

- (1) See Sheet 1.01 for maximum allowable rates.
- (2) A customer eligible under established criteria can receive a discount from his or her bill for residential essential local telecommunications services, in accordance with P.S.C. Mo. – No. 24, Local Exchange Tariff, Section 1.2.2.E, regarding Lifeline Service.

Issued: October 17, 2005

Effective: December 1, 2005

By CINDY BRINKLEY, President-SBC Missouri
Southwestern Bell Telephone, L.P., d/b/a SBC Missouri
St. Louis, Missouri

No Supplement to this tariff will be issued except for the purpose of canceling this tariff.

Missouri Portion-
Pittsburg, Kansas Exchange
31st Revised Sheet 1
Replacing 30th Revised Sheet 1

(RT)

LOCAL EXCHANGE TARIFF

I. GENERAL

This Tariff is governed, except as otherwise specified herein, by all other Tariffs of the Southwestern Bell Telephone Company on file in the State of Missouri, which are hereby made a part of this Tariff. Unless otherwise specified, the charges quoted in this Tariff or in any other Missouri Tariff are for periods of one month, are payable monthly in advance and entitle the customer to exchange telephone service within the Atchison Exchange Area. This Exchange Area includes, in addition to the Missouri Portion, certain territories in the State of Kansas comprising the Cities of Pittsburg, Frontenac and vicinity, as shown on the Exchange Area Map for this exchange.

II. RATES

- A. The rates for main service do not include a Telephone Company-provided instrument.
- B. Within the Missouri Portion of the exchange, rates will be frozen until March 1, 1995. Urban mileage charges as set forth in Paragraph C. and D. following, apply as applicable, in addition to exchange rates when service is provided outside the Basic Rate Area. Exchange rates are as follows:

		Current Rates(1)	
		Business	Residence
1.	Flat Rate Service		
	One-Party	\$17.91	\$ 9.70
	Lifeline	N/A	(2)
	One-Party Multiline	20.60	N/A
	PBX Trunk	29.20	14.70

CANCELLED

DEC 01 2005
By *32nd RS 1*
**Public Service Commission
MISSOURI**

(CT)(CR)

(AT)

(AT)

- (1) See Sheet 1.01 for maximum allowable rates.
- (2) A customer eligible under established criteria can receive a discount from his or her bill for residential essential local telecommunications services, in accordance with P.S.C. Mo. - No. 24, Local Exchange Tariff, Section 1.2.2.E, regarding Lifeline Service.

Issued: April 1, 2005

Effective: May 1, 2005

By CINDY BRINKLEY, President-SBC Missouri
Southwestern Bell Telephone, L.P., d/b/a SBC Missouri
St. Louis, Missouri

TO-1998-0329

**FILED
MO PSC**

No Supplement to this tariff will be issued except for the purpose of canceling this tariff.

Missouri Portion-
Pittsburg, Kansas, Exchange
30th Revised Sheet 1
Replacing 29th Revised Sheet 1

**SOUTHWESTERN BELL TELEPHONE COMPANY
LOCAL EXCHANGE TARIFF**

I. GENERAL

This Tariff is governed, except as otherwise specified herein, by all other Tariffs of the Southwestern Bell Telephone Company on file in the State of Missouri, which are hereby made a part of this Tariff. Unless otherwise specified, the charges quoted in this Tariff or in any other Missouri Tariff are for periods of one month, are payable monthly in advance and entitle the customer to exchange telephone service within the Atchison Exchange Area. This Exchange Area includes, in addition to the Missouri Portion, certain territories in the State of Kansas comprising the Cities of Pittsburg, Frontenac and vicinity, as shown on the Exchange Area Map for this exchange.

II. RATES

- A. The rates for main service do not include a Telephone Company-provided instrument.
- B. Within the Missouri Portion of the exchange, rates will be frozen until March 1, 1995. Urban mileage charges as set forth in Paragraph C. and D. following, apply as applicable, in addition to exchange rates when service is provided outside the Basic Rate Area. Exchange rates are as follows:

1. Flat Rate Service	Current Rates(1)	
	<u>Business</u>	<u>Residence</u>
One-Party	\$17.91(CR)	\$ 9.70(CR)
Lifeline(2)	N/A	6.20(CR)
One-Party Multiline	20.60	N/A
PBX Trunk	29.20	14.70

CANCELLED

MAY 01 2005
316RS1
Public Service Commission
MISSOURI

- (1) See Sheet 1.01 for maximum allowable rates.
- (2) See P.S.C. Mo. – No. 24, Local Exchange Tariff, Section 1.2.2.E, for description, terms and conditions related to Lifeline Service.

Issued: October 15, 2004

Effective: December 1, 2004

By CINDY BRINKLEY, President-SBC Missouri
Southwestern Bell Telephone, L.P., d/b/a SBC Missouri
St. Louis, Missouri

FILED
MO PSC

No Supplement to this tariff will be issued except for the purpose of canceling this tariff.

Missouri Portion-
Pittsburg, Kansas, Exchange
29th Revised Sheet 1
Replacing 28th Revised Sheet 1
Missouri Public

SOUTHWESTERN BELL TELEPHONE COMPANY Service Commission
LOCAL EXCHANGE TARIFF

REC'D MAY 10 2004

I. GENERAL

This Tariff is governed, except as otherwise specified herein, by all other Tariffs of the Southwestern Bell Telephone Company on file in the State of Missouri, which are hereby made a part of this Tariff. Unless otherwise specified, the charges quoted in this Tariff or in any other Missouri Tariff are for periods of one month, are payable monthly in advance and entitle the customer to exchange telephone service within the Atchison Exchange Area. This Exchange Area includes, in addition to the Missouri Portion, certain territories in the State of Kansas comprising the Cities of Pittsburg, Frontenac and vicinity, as shown on the Exchange Area Map for this exchange.

II. RATES

- A. The rates for main service do not include a Telephone Company-provided instrument.
- B. Within the Missouri Portion of the exchange, rates will be frozen until March 1, 1995. Urban mileage charges as set forth in Paragraph C. and D. following, apply as applicable, in addition to exchange rates when service is provided outside the Basic Rate Area. Exchange rates are as follows:

		Current Rates(1)	
		Business	Residence
1.	Flat Rate Service		
(AT)	One-Party Lifeline(2)	\$18.40	\$ 9.97
	One-Party Multiline	N/A	6.47(NR)
	PBX Trunk	20.60	N/A
		29.20	14.70

CANCELLED

DEC 01 2004

By *BAHRS I*
Public Service Commission
MISSOURI

- (CT) (1) See Sheet 1.01 for maximum allowable rates.
- (AT) (2) See P.S.C. Mo. - No. 24, Local Exchange Tariff, Section 1.2.2.E, for description, terms and conditions related to Lifeline Service.

Issued: May 10, 2004

Effective: June 9, 2004

By CINDY BRINKLEY, President-SBC Missouri
Southwestern Bell Telephone, L.P., d/b/a SBC Missouri
St. Louis, Missouri

Missouri Public
Service Commission

FILED JUN 09 2004

No Supplement to this tariff will be issued except for the purpose of canceling this tariff.

Missouri Portion-
Pittsburg, Kansas, Exchange
28th Revised Sheet 1
Replacing 27th Revised Sheet 1
Missouri Public

SOUTHWESTERN BELL TELEPHONE COMPANY
LOCAL EXCHANGE TARIFF

REC'D OCT 15 2003

I. GENERAL

Service Commission

This Tariff is governed, except as otherwise specified herein, by all other Tariffs of the Southwestern Bell Telephone Company on file in the State of Missouri, which are hereby made a part of this Tariff. Unless otherwise specified, the charges quoted in this Tariff or in any other Missouri Tariff are for periods of one month, are payable monthly in advance and entitle the customer to exchange telephone service within the Atchison Exchange Area. This Exchange Area includes, in addition to the Missouri Portion, certain territories in the State of Kansas comprising the Cities of Pittsburg, Frontenac and vicinity, as shown on the Exchange Area Map for this exchange.

II. RATES

- A. The rates for main service do not include a Telephone Company-provided instrument.
- B. Within the Missouri Portion of the exchange, rates will be frozen until March 1, 1995. Urban mileage charges as set forth in Paragraph C. and D. following, apply as applicable, in addition to exchange rates when service is provided outside the Basic Rate Area. Exchange rates are as follows:

	Current Rates(1)	
	Business	Residence
1. Flat Rate Service		
One-Party	\$18.40(CR)	\$ 9.97
One-Party Multiline	20.60	N/A
PBX Trunk	29.20	14.70

(1) See Sheet 1.02 for maximum allowable rates.

CANCELLED
JUN 09 2004
By [Signature]
Public Service Commission
MISSOURI

Issued: October 15, 2003

Effective: December 1, 2003

By CINDY BRINKLEY, President-SBC Missouri
Southwestern Bell Telephone, L.P., d/b/a SBC Missouri
St. Louis, Missouri

Missouri Public
Service Commission

FILED DEC 01 2003

No Supplement to this tariff will be issued except for the purpose of canceling this tariff.

Missouri Portion-
Pittsburg, Kansas, Exchange
27th Revised Sheet 1
Replacing 26th Revised Sheet 1

SOUTHWESTERN BELL TELEPHONE COMPANY
LOCAL EXCHANGE TARIFF

Missouri Public
Service Commission

I. GENERAL

REC'D OCT 15 2002

This Tariff is governed, except as otherwise specified herein, by all other Tariffs of the Southwestern Bell Telephone Company on file in the State of Missouri, which are hereby made a part of this Tariff. Unless otherwise specified, the charges quoted in this Tariff or in any other Missouri Tariff are for periods of one month, are payable monthly in advance and entitle the customer to exchange telephone service within the Atchison Exchange Area. This Exchange Area includes, in addition to the Missouri Portion, certain territories in the State of Kansas comprising the Cities of Pittsburg, Frontenac and vicinity, as shown on the Exchange Area Map for this exchange.

II. RATES

- A. The rates for main service do not include a Telephone Company-provided instrument.
- B. Within the Missouri Portion of the exchange, rates will be frozen until March 1, 1995. Urban mileage charges as set forth in Paragraph C. and D. following, apply as applicable, in addition to exchange rates when service is provided outside the Basic Rate Area. Exchange rates are as follows:

	Current Rates(1)	
	<u>Business</u>	<u>Residence</u>
1. Flat Rate Service		
One-Party	\$18.41(CR)	\$9.97(CR)
One-Party Multiline	20.60	N/A
PBX Trunk	29.20	14.70

CANCELLED

DEC 01 2003
28th RS 1
Missouri Public Service Commission

(MT)

Missouri Public
Service Commission

(MT)

(CT)

(1) See Sheet 1.02 for maximum allowable rates.

FILED DEC 01 2002

Issued: October 15, 2002

Effective: December 1, 2002

By CINDY BRINKLEY, President-Missouri
Southwestern Bell Telephone, L.P., d/b/a Southwestern Bell Telephone Company
St. Louis, Missouri

No supplement to this tariff will be issued except for the purpose of canceling this tariff.

MISSOURI PORTION-PITTSBURG, KANSAS, EXCHANGE
26th Revised Sheet 1
Replacing 25th Revised Sheet 1

Missouri Public

SOUTHWESTERN BELL TELEPHONE COMPANY LOCAL EXCHANGE TARIFF

REC'D OCT 01 2001

I. GENERAL

Service Commission

This Tariff is governed, except as otherwise specified herein, by all other Tariffs of the Southwestern Bell Telephone Company on file in the State of Missouri, which are hereby made a part of this Tariff. Unless otherwise specified, the charges quoted in this Tariff or in any other Missouri Tariff are for periods of one month, are payable monthly in advance and entitle the customer to exchange telephone service within the Atchison Exchange Area. This Exchange Area includes, in addition to the Missouri Portion, certain territories in the State of Kansas comprising the Cities of Pittsburg, Frontenac and vicinity, as shown on the Exchange Area Map for this exchange.

II. RATES

A. The rates for main service do not include a Telephone Company-provided instrument.

B. Within the Missouri Portion of the exchange, rates will be frozen until March 1, 1995. Urban mileage charges as set forth in Paragraph C. and D. following, apply as applicable, in addition to exchange rates when service is provided outside the Basic Rate Area. Exchange rates are as follows:

CURRENT RATES (1)

1. Flat Rate Service

	<u>Business</u>	<u>Residence</u>
One-Party	\$18.24(CR)	\$9.89(CR)
One-Party Multiline	20.60	N/A
PBX Trunk	29.20	14.70

C. The following urban mileage charge applies to those customers provided exchange service located outside the base rate area:

CURRENT RATES (1)

	<u>USOC</u>	<u>Month Rate</u>
Urban Mileage Charge, per line	1LS1H	\$4.53(CR)

D. The following urban mileage charge applies to former two-party customers who were located two miles beyond the Suburban Service Area boundary prior to the conversion of the exchange to on-party service. The charge applies to "existing installations, at existing locations, for existing customers":

CURRENT RATES (1)

	<u>USOC</u>	<u>Month Rate</u>
Urban Mileage Charge, per line	XUDV3	\$3.39(CR)

CANCELLED

DEC 01 2002

By 2744 RSI
Public Service Commission
MISSOURI

(1) See Sheet 1.01 for maximum allowable rates.

Issued: October 1, 2001

Effective: December 1, 2001

By JAN NEWTON, President-Missouri
Southwestern Bell Telephone Company
St. Louis, Missouri

Missouri Public

FILED DEC 01 2001

Service Commission

No supplement to this tariff will be issued except for the purpose of canceling this tariff.

MISSOURI PORTION-PITTSBURG, KANSAS, EXCHANGE
 25th Revised Sheet 1
 Replacing 24th Revised Sheet 1

Missouri Public Service Commission

SOUTHWESTERN BELL TELEPHONE COMPANY LOCAL EXCHANGE TARIFF

REC'D OCT 02 2000

I. GENERAL

This Tariff is governed, except as otherwise specified herein, by all other Tariffs of the Southwestern Bell Telephone Company on file in the State of Missouri, which are hereby made a part of this Tariff. Unless otherwise specified, the charges quoted in this Tariff or in any other Missouri Tariff are for periods of one month, are payable monthly in advance and entitle the customer to exchange telephone service within the Atchison Exchange Area. This Exchange Area includes, in addition to the Missouri Portion, certain territories in the State of Kansas comprising the Cities of Pittsburg, Frontenac and vicinity, as shown on the Exchange Area Map for this exchange.

II. RATES

- A. The rates for main service do not include a Telephone Company-provided instrument.
- B. Within the Missouri Portion of the exchange, rates will be frozen until March 1, 1995. Urban mileage charges as set forth in Paragraph C. and D. following, apply as applicable, in addition to exchange rates when service is provided outside the Basic Rate Area. Exchange rates are as follows:

1. Flat Rate Service

- One-Party
- One-Party Multiline
- PBX Trunk

CANCELLED

DEC 01 2001

By *2647RS1*
 Public Service Commission
 MISSOURI

CURRENT RATES (1)	
Business	Residence
\$18.38(CR)	\$9.96(CR)
20.60	N/A
29.20	14.70

- C. The following urban mileage charge applies to those customers provided exchange service located outside the base rate area:

Urban Mileage Charge, per line

CURRENT RATES (1)	
USOC	Month Rate
ILSIH	\$4.56(CR)

- D. The following urban mileage charge applies to former two-party customers who were located two miles beyond the Suburban Service Area boundary prior to the conversion of the exchange to on-party service. The charge applies to "existing installations, at existing locations, for existing customers":

Urban Mileage Charge, per line

CURRENT RATES (1)	
USOC	Month Rate
XUDV3	\$3.42(CR)

Missouri Public Service Commission

(1) See Sheet 1.01 for maximum allowable rates.

FILED DEC 01 2000

Issued: October 2, 2000

Effective: December 1, 2000

By JAN NEWTON, President-Missouri
 Southwestern Bell Telephone Company
 St. Louis, Missouri

No supplement to this tariff will be issued except for the purpose of canceling this tariff.

MISSOURI PORTION-PITTSBURG, KANSAS, EXCHANGE
24th Revised Sheet 1
Replacing 23rd Revised Sheet 1

RECEIVED

SOUTHWESTERN BELL TELEPHONE COMPANY LOCAL EXCHANGE TARIFF 2 1 1997
NOV 2 1 1997

I. GENERAL

MO. PUBLIC SERVICE COM.

This Tariff is governed, except as otherwise specified herein, by all other Tariffs of the Southwestern Bell Telephone Company on file in the State of Missouri, which are hereby made a part of this Tariff. Unless otherwise specified, the charges quoted in this Tariff or in any other Missouri Tariff are for periods of one month, are payable monthly in advance and entitle the customer to exchange telephone service within the Atchison Exchange Area. This Exchange Area includes, in addition to the Missouri Portion, certain territories in the State of Kansas comprising the Cities of Pittsburg, Frontenac and vicinity, as shown on the Exchange Area Map for this exchange.

II. RATES

- (RT) A. The rates for main service do not include a Telephone Company-provided instrument.
- B. Within the Missouri Portion of the exchange, rates will be frozen until March 1, 1995. Urban mileage charges as set forth in Paragraph C. and D. following, apply as applicable, in addition to exchange rates when service is provided outside the Basic Rate Area. Exchange rates are as follows:

1. Flat Rate Service	<u>Business</u>	<u>Residence</u>
One-Party	\$18.55	\$10.05
One-Party Multiline	20.60	N/A
PBX Trunk	29.20	14.70

- (RT) C. The following urban mileage charge applies to those customers provided exchange service located outside the base rate area:

	<u>USOC</u>	<u>Month Rate</u>
Urban Mileage Charge, per line	1LS1H	\$4.60

- D. The following urban mileage charge applies to former two-party customers who were located two miles beyond the Suburban Service Area boundary prior to the conversion of the exchange to on-party service. The charge applies to "existing installations, at existing locations, for existing customers":

	<u>USOC</u>	<u>Month Rate</u>
Urban Mileage Charge, per line	XUDV3	\$3.45

CANCELLED

FILED

DEC 0 1 2000

DEC 24 1997

By *25th RSI*
Public Service Commission
MISSOURI

MISSOURI
Public Service Commission

Issued: NOV 24 1997

Effective: DEC 24 1997

By PRISCILLA HILL-ARDOIN, President-Missouri
Southwestern Bell Telephone Company
St. Louis, Missouri

No supplement to this tariff will be issued except for the purpose of canceling this tariff.

MISSOURI PORTION-PITTSBURG, KANSAS, EXCHANGE
 23rd Revised Sheet 1
 Replacing 22nd Revised Sheet 1

JUL 26 1990

SOUTHWESTERN BELL TELEPHONE COMPANY
 LOCAL EXCHANGE TARIFF

MISSOURI

Public Service Commission

I. GENERAL

This Tariff is governed, except as otherwise specified herein, by all other Tariffs of the Southwestern Bell Telephone Company on file in the State of Missouri, which are hereby made a part of this Tariff. Unless otherwise specified, the charges quoted in this Tariff or in any other Missouri Tariff are for periods of one month, are payable monthly in advance and entitle the customer to exchange telephone service within the Pittsburg Exchange Area. This Exchange Area includes, in addition to the Missouri Portion, certain territories in the State of Kansas comprising the Cities of Pittsburg, Frontenac and vicinity, as shown on the Exchange Area Map for this exchange.

(C)

II. RATES

A. The rates for main service do not include a Telephone Company-provided instrument, except for Semi-Public Service, which includes one station equipped with a coin-collecting device.

(CP) B. Within the Missouri portion of the exchange, rates will be frozen until March 1, 1995. Urban mileage charges as set forth in Paragraph C. and D. following, apply as applicable, in addition to exchange rates when service is provided outside the Base Rate Area. Exchange rates are as follows:

	<u>Business</u>	<u>Residence</u>
1. Flat Rate Service		
(RT) One Party	(RT) \$18.55	(RT) \$10.05
(RT) Semi-Public	(RT) 8.68	(DR) N/A
(RT) One Party Multi-Line	(RT) 20.60	(DR) N/A
PBX Trunk	(RT) 29.20	(RT) 14.70

CANCELLED

(CP) C. The following urban mileage charge applies to those customers provided exchange service located outside the base rate area:

	<u>USOC</u>	<u>Monthly Rate</u>
Urban Mileage Charge, per line	1LS1H	\$4.60

DEC 2 1997
 By 244 RS#1
 Public Service Commission
 MISSOURI

(CP) D. The following urban mileage charge applies to former two-party customers who were located two miles beyond the Suburban Service Area boundary prior to the conversion of the exchange to one-party service. The charge applies to "existing installations, at existing locations, for existing customers":

	<u>USOC</u>	<u>Monthly Rate</u>
Urban Mileage Charge, per line	XUDV3	\$3.45

Issued: JUL 30 1990

Effective: SEP 18 1990

FILED

By R. D. BARRON, President-Missouri Division
 Southwestern Bell Telephone Company
 St. Louis, Missouri

SEP 18 1990

Public Service Commission

**P.S.C. Mo. - No. 17
LOCAL EXCHANGE - MISSOURI PORTION TARIFF**

Southwestern Bell Telephone
Company d/b/a AT&T Missouri

Section 6
17th Revised Sheet 1.1
Replacing 16th Revised Sheet 1.1

MISSOURI PORTION - PITTSBURG, KANSAS EXCHANGE

2. RATES (cont'd)

- C. The following urban mileage charge applies to those customers provided exchange service located outside the base rate area:

	<u>Current Rates(1)(2)</u>		
	<u>USOC</u>	<u>Monthly Rate</u>	
Urban Mileage Charge, per line	1LS1H	\$1.94	(CR)

- D. The following urban mileage charge applies to former two-party customers who were located two miles beyond the Suburban Service Area boundary prior to the conversion of the exchange to one-party service. The charge applies to "existing installations, at existing locations, for existing customers":

	<u>Current Rates(1)(2)</u>		
	<u>USOC</u>	<u>Monthly Rate</u>	
Urban Mileage Charge, per line	XUDV3	\$3.26	

- (1) For the period of November 26, 2008 through November 25, 2012, prices for residence basic local service in the following exchanges will be governed by Section 392.245.5(7) RSMo.
(2) For the period of November 26, 2008 through November 25, 2012, prices for business basic local service in the following exchanges will be governed by Section 392.245.5(7) RSMo.

Issued: August 2, 2013

Effective: August 3, 2013

CANCELLED
May 1, 2014
Missouri Public
Service Commission
JI-2014-0379

By JOHN SONDAG, President - Missouri
St. Louis, Missouri

FILED
Missouri Public
Service Commission
JI-2014-0053

P.S.C. Mo. - No. 17
LOCAL EXCHANGE - MISSOURI PORTION TARIFF

Southwestern Bell Telephone
Company d/b/a AT&T Missouri

Section 6
16th Revised Sheet 1.1
Replacing 15th Revised Sheet 1.1

15th Revised Sheet 1.1 was previously 15th Revised Sheet 1.01 (AT)

MISSOURI PORTION - PITTSBURG, KANSAS EXCHANGE (AT)

2. RATES (cont'd)

- C. The following urban mileage charge applies to those customers provided exchange service located outside the base rate area:

	Current Rates(1)(2) (AT)	
	<u>USOC</u>	<u>Monthly Rate</u>
Urban Mileage Charge, per line	1LS1H	\$4.36

- D. The following urban mileage charge applies to former two-party customers who were located two miles beyond the Suburban Service Area boundary prior to the conversion of the exchange to one-party service. The charge applies to "existing installations, at existing locations, for existing customers":

	Current Rates(1)(2) (AT)	
	<u>USOC</u>	<u>Monthly Rate</u>
Urban Mileage Charge, per line	XUDV3	\$3.26

(RT)
|
(RT)

- (1) For the period of November 26, 2008 through November 25, 2012, prices for residence basic local service in the following exchanges will be governed by Section 392.245.5(7) RSMo.
(2) For the period of November 26, 2008 through November 25, 2012, prices for business basic local service in the following exchanges will be governed by Section 392.245.5(7) RSMo.

(RT)
(RT)
(AT)
|
(AT)

Issued: July 2, 2009

Effective: July 12, 2009

CANCELED
August 3, 2013
Missouri Public
Service Commission
JI-2014-0053

By DAVID NICHOLS, President - Missouri
St. Louis, Missouri

Filed
Missouri Public
Service Commission
JI-2010-0004

**P.S.C. Mo. - No. 17
Missouri Portion-**

Southwestern Bell Telephone
Company d/b/a AT&T Missouri

Pittsburg, Kansas Exchange
15th Revised Sheet 1.01
Replacing 14th Revised Sheet 1.01

LOCAL EXCHANGE TARIFF

II. RATES (cont'd)

- C. The following urban mileage charge applies to those customers provided exchange service located outside the base rate area:

	Current Rates	
	USOC	Monthly Rate
Urban Mileage Charge, per line	1LS1H	\$4.36

- D. The following urban mileage charge applies to former two-party customers who were located two miles beyond the Suburban Service Area boundary prior to the conversion of the exchange to one-party service. The charge applies to "existing installations, at existing locations, for existing customers":

	Current Rates	
	USOC	Monthly Rate
Urban Mileage Charge, per line	XUDV3	\$3.26

1. Flat Rate Service	Maximum Rates	
	Business	Residence
One-Party Lifeline	\$17.95(CR) N/A	\$9.72(CR) (1)
	USOC	Monthly Rate
Urban Mileage Charge, per line	1LS1H	\$4.46(CR)
	USOC	Monthly Rate
Urban Mileage Charge, per line	XUDV3	\$3.33(CR)

- (1) A customer eligible under established criteria can receive a discount from his or her bill for residential essential local telecommunications services, in accordance with P.S.C. Mo. – No. 24, Local Exchange Tariff, Section 1.2.2.E, regarding Lifeline Service.

Issued: December 31, 2007

Effective: February 16, 2008

By CINDY BRINKLEY, President – Missouri
St. Louis, Missouri

Cancelled
July 12, 2009
Missouri Public
Service Commission
JI-2010-0004

FILED
Missouri Public
Service Commission

P.S.C. Mo. - No. 17

Missouri Portion-

Southwestern Bell Telephone, L.P.
d/b/a AT&T Missouri

Pittsburg, Kansas Exchange
14th Revised Sheet 1.01
Replacing 13th Revised Sheet 1.01

LOCAL EXCHANGE TARIFF

II. RATES (cont'd)

- C. The following urban mileage charge applies to those customers provided exchange service located outside the base rate area:

	Current Rates	
	<u>USOC</u>	<u>Monthly Rate</u>
Urban Mileage Charge, per line	1LS1H	\$4.36

- D. The following urban mileage charge applies to former two-party customers who were located two miles beyond the Suburban Service Area boundary prior to the conversion of the exchange to one-party service. The charge applies to "existing installations, at existing locations, for existing customers":

	Current Rates	
	<u>USOC</u>	<u>Monthly Rate</u>
Urban Mileage Charge, per line	XUDV3	\$3.26

1. Flat Rate Service	Maximum Rates	
	<u>Business</u>	<u>Residence</u>
One-Party	\$17.60(CR)	\$9.53(CR)
Lifeline	N/A	(1)

	<u>USOC</u>	<u>Monthly Rate</u>
Urban Mileage Charge, per line	1LS1H	\$4.36

	<u>USOC</u>	<u>Monthly Rate</u>
Urban Mileage Charge, per line	XUDV3	\$3.26

(1) A customer eligible under established criteria can receive a discount from his or her bill for residential essential local telecommunications services, in accordance with P.S.C. Mo. – No. 24, Local Exchange Tariff, Section 1.2.2.E, regarding Lifeline Service.

Issued: October 17, 2006

Effective: December 1, 2006

By CINDY BRINKLEY, President – Missouri
St. Louis, Missouri

CANCELLED
February 16, 2008
Missouri Public
Service Commission

Filed
Missouri Public
Service Commission

No Supplement to this tariff will be issued except for the purpose of canceling this tariff.

Missouri Portion-
Pittsburg, Kansas, Exchange
13th Revised Sheet 1.01
Replacing 12th Revised Sheet 1.01

(RT)

LOCAL EXCHANGE TARIFF

II. RATES (cont'd)

- C. The following urban mileage charge applies to those customers provided exchange service located outside the base rate area:

	Current Rates	
	<u>USOC</u>	<u>Monthly Rate</u>
Urban Mileage Charge, per line	1LS1H	\$4.36(CR)

- D. The following urban mileage charge applies to former two-party customers who were located two miles beyond the Suburban Service Area boundary prior to the conversion of the exchange to one-party service. The charge applies to "existing installations, at existing locations, for existing customers":

	Current Rates	
	<u>USOC</u>	<u>Monthly Rate</u>
Urban Mileage Charge, per line	XUDV3	\$3.26(CR)

1. Flat Rate Service	Maximum Rates	
	<u>Business</u>	<u>Residence</u>
One-Party	\$17.56(CR)	\$9.51(CR)
Lifeline	N/A	(1)

	<u>USOC</u>	<u>Monthly Rate</u>
Urban Mileage Charge, per line	1LS1H	\$4.36(CR)

	<u>USOC</u>	<u>Monthly Rate</u>
Urban Mileage Charge, per line	XUDV3	\$3.26(CR)

- (1) A customer eligible under established criteria can receive a discount from his or her bill for residential essential local telecommunications services, in accordance with P.S.C. Mo. – No. 24, Local Exchange Tariff, Section 1.2.2.E, regarding Lifeline Service.

Issued: October 17, 2005

Effective: December 1, 2005

By CINDY BRINKLEY, President-SBC Missouri
Southwestern Bell Telephone, L.P., d/b/a SBC Missouri
St. Louis, Missouri

Cancelled

December 1, 2006

Missouri Public
Service Commission

Filed

Missouri Public
Service Commission

No Supplement to this tariff will be issued except for the purpose of canceling this tariff.

Missouri Portion-
Pittsburg, Kansas, Exchange
12th Revised Sheet 1.01
Replacing 11th Revised Sheet 1.01

(RT)

LOCAL EXCHANGE TARIFF

II. RATES (cont'd)

- C. The following urban mileage charge applies to those customers provided exchange service located outside the base rate area:

	Current Rates	
	<u>USOC</u>	<u>Monthly Rate</u>
Urban Mileage Charge, per line	1LS1H	\$4.45

- D. The following urban mileage charge applies to former two-party customers who were located two miles beyond the Suburban Service Area boundary prior to the conversion of the exchange to one-party service. The charge applies to "existing installations, at existing locations, for existing customers:"

	Current Rates	
	<u>USOC</u>	<u>Monthly Rate</u>
Urban Mileage Charge, per line	XUDV3	\$3.33

	Maximum Rates	
	<u>Business</u>	<u>Residence</u>
1. Flat Rate Service		
One-Party	\$17.91	\$9.70
Lifeline	N/A	(1)

(CT)(CR)

	<u>USOC</u>	<u>Monthly Rate</u>
	Urban Mileage Charge, per line	1LS1H

	<u>USOC</u>	<u>Monthly Rate</u>
	Urban Mileage Charge, per line	XUDV3

- (AT) (1) A customer eligible under established criteria can receive a discount from his or her bill for residential essential local telecommunications services, in accordance with P.S.C. Mo. – No. 24, Local Exchange Tariff, Section 1.2.2.E, regarding Lifeline Service.

(AT)

Issued: April 1, 2005

Effective: May 1, 2005

CANCELLED

By CINDY BRINKLEY, President-SBC Missouri
Southwestern Bell Telephone, L.P., d/b/a SBC Missouri
St. Louis, Missouri

DEC 01 2005

TO-1998-0329

13th RS 1.01
Public Service Commission
MISSOURI

FILED
MO PSC

No Supplement to this tariff will be issued except for the purpose of canceling this tariff.

Missouri Portion-
Pittsburg, Kansas, Exchange
11th Revised Sheet 1.01
Replacing 10th Revised Sheet 1.01

SOUTHWESTERN BELL TELEPHONE COMPANY
LOCAL EXCHANGE TARIFF

II. RATES (cont'd)

- C. The following urban mileage charge applies to those customers provided exchange service located outside the base rate area:

	Current Rates	
	USOC	Monthly Rate
Urban Mileage Charge, per line	1LS1H	\$4.45(CR)

- D. The following urban mileage charge applies to former two-party customers who were located two miles beyond the Suburban Service Area boundary prior to the conversion of the exchange to one-party service. The charge applies to "existing installations, at existing locations, for existing customers:"

	Current Rates	
	USOC	Monthly Rate
Urban Mileage Charge, per line	XUDV3	\$3.33(CR)

1. Flat Rate Service	Maximum Rates	
	Business	Residence
One-Party Lifeline(1)	\$17.91(CR)	\$9.70(CR)
	N/A	6.20(CR)
	USOC	Monthly Rate
Urban Mileage Charge, per line	1LS1H	\$4.45(CR)
	USOC	Monthly Rate
Urban Mileage Charge, per line	XUDV3	\$3.33(CR)

CANCELLED

MAY 01 2005

Public Service Commission
MISSOURI

(1) See P.S.C. Mo. – No. 24, Local Exchange Tariff, Section 1.2.2.E, for description, terms and conditions related to Lifeline Service.

Issued: October 15, 2004

Effective: December 1, 2004

By CINDY BRINKLEY, President-SBC Missouri
Southwestern Bell Telephone, L.P., d/b/a SBC Missouri
St. Louis, Missouri

**FILED
MO PSC**

No Supplement to this tariff will be issued except for the purpose of canceling this tariff.

Missouri Portion-
Pittsburg, Kansas, Exchange
10th Revised Sheet 1.01
Replacing 9th Revised Sheet 1.01
Missouri Public

SOUTHWESTERN BELL TELEPHONE COMPANY Service Commission
LOCAL EXCHANGE TARIFF

REC'D MAY 10 2004

II. RATES (cont'd)

C. The following urban mileage charge applies to those customers provided exchange service located outside the base rate area:

(CT)

	Current Rates	
	<u>USOC</u>	<u>Monthly Rate</u>
Urban Mileage Charge, per line	1LS1H	\$4.57

D. The following urban mileage charge applies to former two-party customers who were located two miles beyond the Suburban Service Area boundary prior to the conversion of the exchange to one-party service. The charge applies to "existing installations, at existing locations, for existing customers:"

(CT)

	Current Rates	
	<u>USOC</u>	<u>Monthly Rate</u>
Urban Mileage Charge, per line	XUDV3	\$3.42

1. Flat Rate Service

(AT)

One-Party
Lifeline(1)

CANCELLED

DEC 01 2004

By *11/11/RS/1.01*
Public Service Commission
MISSOURI

	Maximum Rates	
	<u>Business</u>	<u>Residence</u>
One-Party Lifeline(1)	\$18.40	\$9.97
	N/A	6.47(NR)
	Current Rates	
	<u>USOC</u>	<u>Monthly Rate</u>
Urban Mileage Charge, per line	1LS1H	\$4.57
	Current Rates	
	<u>USOC</u>	<u>Monthly Rate</u>
Urban Mileage Charge, per line	XUDV3	\$3.42

(RT)

(FC)(AT) (1) See P.S.C. Mo. – No. 24, Local Exchange Tariff, Section 1.2.2.E, for description, terms and conditions related to Lifeline Service.

Issued: May 10, 2004

Effective: June 9, 2004

By CINDY BRINKLEY, President-SBC Missouri
Southwestern Bell Telephone, L.P., d/b/a SBC Missouri
St. Louis, Missouri

Missouri Public
Service Commission

FILED JUN 09 2004

No Supplement to this tariff will be issued except for the purpose of canceling this tariff.

Missouri Portion-
Pittsburg, Kansas, Exchange
9th Revised Sheet 1.01
Replacing 8th Revised Sheet 1.01

SOUTHWESTERN BELL TELEPHONE COMPANY
LOCAL EXCHANGE TARIFF

Missouri Public

II. RATES (cont'd)

REC'D OCT 15 2003

- C. The following urban mileage charge applies to those customers provided exchange service located outside the base rate area:

Service Commission

	Current Rates(1)	
	USOC	Monthly Rate
Urban Mileage Charge, per line	1LS1H	\$4.57

- D. The following urban mileage charge applies to former two-party customers who were located two miles beyond the Suburban Service Area boundary prior to the conversion of the exchange to one-party service. The charge applies to "existing installations, at existing locations, for existing customers:"

	Current Rates(1)	
	USOC	Monthly Rate
Urban Mileage Charge, per line	XUDV3	\$3.42

1. Flat Rate Service

One-Party

Maximum Rates	
Business	Residence
\$18.40(CR)	\$9.97

Urban Mileage Charge, per line

Urban Mileage Charge, per line

USOC	Monthly Rate
1LS1H	\$4.57

USOC	Monthly Rate
XUDV3	\$3.42

CANCELLED
JUN 09 2004
by 104H (S) 01
Public Service Commission
MISSOURI

(1) See Sheet 1.02 for maximum allowable rates.

Issued: October 15, 2003

Effective: December 1, 2003

By CINDY BRINKLEY, President-SBC Missouri
Southwestern Bell Telephone, L.P., d/b/a SBC Missouri
St. Louis, Missouri

Missouri Public
Service Commission

FILED DEC 01 2003

No Supplement to this tariff will be issued except for the purpose of canceling this tariff.

Missouri Portion-
Pittsburg, Kansas, Exchange
8th Revised Sheet 1.01
Replacing 7th Revised Sheet 1.01

SOUTHWESTERN BELL TELEPHONE COMPANY
LOCAL EXCHANGE TARIFF

Missouri Public
Service Commission

II. RATES (cont'd)

REC'D OCT 15 2002

(MT)

- C. The following urban mileage charge applies to those customers provided exchange service located outside the base rate area:

	Current Rates(1)	
	USOC	Monthly Rate
Urban Mileage Charge, per line	1LS1H	\$4.57(CR)

- D. The following urban mileage charge applies to former two-party customers who were located two miles beyond the Suburban Service Area boundary prior to the conversion of the exchange to one-party service. The charge applies to "existing installations, at existing locations, for existing customers:"

(MT)

	Current Rates(1)	
	USOC	Monthly Rate
Urban Mileage Charge, per line	XUDV3	\$3.42(CR)

CANCELLED

- 1. Flat Rate Service

One-Party

DEC 01 2003
9:45 AM
Missouri Public Service Commission
MISSOURI

Urban Mileage Charge, per line

Urban Mileage Charge, per line

	Maximum Rates	
	Business	Residence
One-Party	\$18.41(CR)	\$9.97(CR)
	USOC	Monthly Rate
Urban Mileage Charge, per line	1LS1H	\$4.57(CR)
	USOC	Monthly Rate
Urban Mileage Charge, per line	XUDV3	\$3.42(CR)

Missouri Public
Service Commission

(MT)

- (1) See Sheet 1.02 for maximum allowable rates.

FILED DEC 01 2002

Issued: October 15, 2002

Effective: December 1, 2002

By CINDY BRINKLEY, President-Missouri
Southwestern Bell Telephone, L.P., d/b/a Southwestern Bell Telephone Company
St. Louis, Missouri

No supplement to this tariff will be issued except for the purpose of canceling this tariff.

MISSOURI PORTION-PITTSBURG, KANSAS, EXCHANGE
7th Revised Sheet 1.01
Replacing 6th Revised Sheet 1.01

Missouri Public

SOUTHWESTERN BELL TELEPHONE COMPANY LOCAL EXCHANGE TARIFF

REC'D OCT 01 2001

Service Commission

1. Flat Rate Service	<u>MAXIMUM RATES</u>	
	<u>Business</u>	<u>Residence</u>
One-Party	\$18.24 (CR)	\$9.89 (CR)

Urban Mileage Charge, per line	<u>MAXIMUM RATES</u>	
	<u>USOC</u> ILSIH	<u>Monthly Rate</u> \$4.53 (CR)

Urban Mileage Charge, per line	<u>MAXIMUM RATES</u>	
	<u>USOC</u> XUDV3	<u>Monthly Rate</u> \$3.39 (CR)

CANCELLED

DEC 01 2002
By *SMRSI.01*
Public Service Commission
MISSOURI

Issued: October 1, 2001

Effective: December 1, 2001

By JAN NEWTON, President-Missouri
Southwestern Bell Telephone Company
St. Louis, Missouri

Missouri Public

FILED DEC 01 2001

Service Commission

No supplement to this tariff will be issued except for the purpose of canceling this tariff.

MISSOURI PORTION-PITTSBURG, KANSAS, EXCHANGE
6th Revised Sheet 1.01
Replacing 5th Revised Sheet 1.01

SOUTHWESTERN BELL TELEPHONE COMPANY LOCAL EXCHANGE TARIFF

Missouri Public Service Commission

REC'D OCT 02 2000

(AT)

1. Flat Rate Service

MAXIMUM RATES

	<u>Business</u>	<u>Residence</u>
One-Party	\$18.38	\$9.96

One-Party

MAXIMUM RATES

Urban Mileage Charge, per line

	<u>USOC</u>	<u>Monthly Rate</u>
	ILSIH	\$4.56

(AT)

Urban Mileage Charge, per line

MAXIMUM RATES

	<u>USOC</u>	<u>Monthly Rate</u>
	XUDV3	\$3.42

CANCELLED

DEC 01 2001

By *JMR* Public Service Commission MISSOURI

Missouri Public Service Commission

FILED DEC 01 2000

Issued: October 2, 2000

Effective: December 1, 2000

By JAN NEWTON, President-Missouri
Southwestern Bell Telephone Company
St. Louis, Missouri

No supplement to this tariff will be issued except for the purpose of canceling this tariff.

MISSOURI PORTION-PITTSBURG, KANSAS, EXCHANGE
5th Revised Sheet 1.01
Replacing 4th Revised Sheet 1.01

SOUTHWESTERN BELL TELEPHONE COMPANY
LOCAL EXCHANGE TARIFF

RECEIVED

JUL 26 1990

MISSOURI
Public Service Commission

II. RATES--(Continued)

(RT)

(RT)

CANCELLED

DEC 01 2000
By *Wth RSI.01*
Public Service Commission
MISSOURI

FILED

SEP 18 1990

Public Service Commission

Issued: JUL 30 1990

Effective: SEP 18 1990

By R. D. BARRON, President-Missouri Division
Southwestern Bell Telephone Company
St. Louis, Missouri

NO SUPPLEMENT TO THIS TARIFF WILL BE ISSUED EXCEPT FOR THE PURPOSE OF CANCELING THIS TARIFF.

Pierce City, Missouri
FIRST REVISED SHEET 2
REPLACING ORIGINAL SHEET 2

P. S. C.-Mo. No. 17

BASE RATE AREA MAP

RECEIVED
JUN 27 1950
MISSOURI
Public Service Comm.

FILED

JUL 6 1950

Case No. 11634
PUBLIC SERVICE COMMISSION

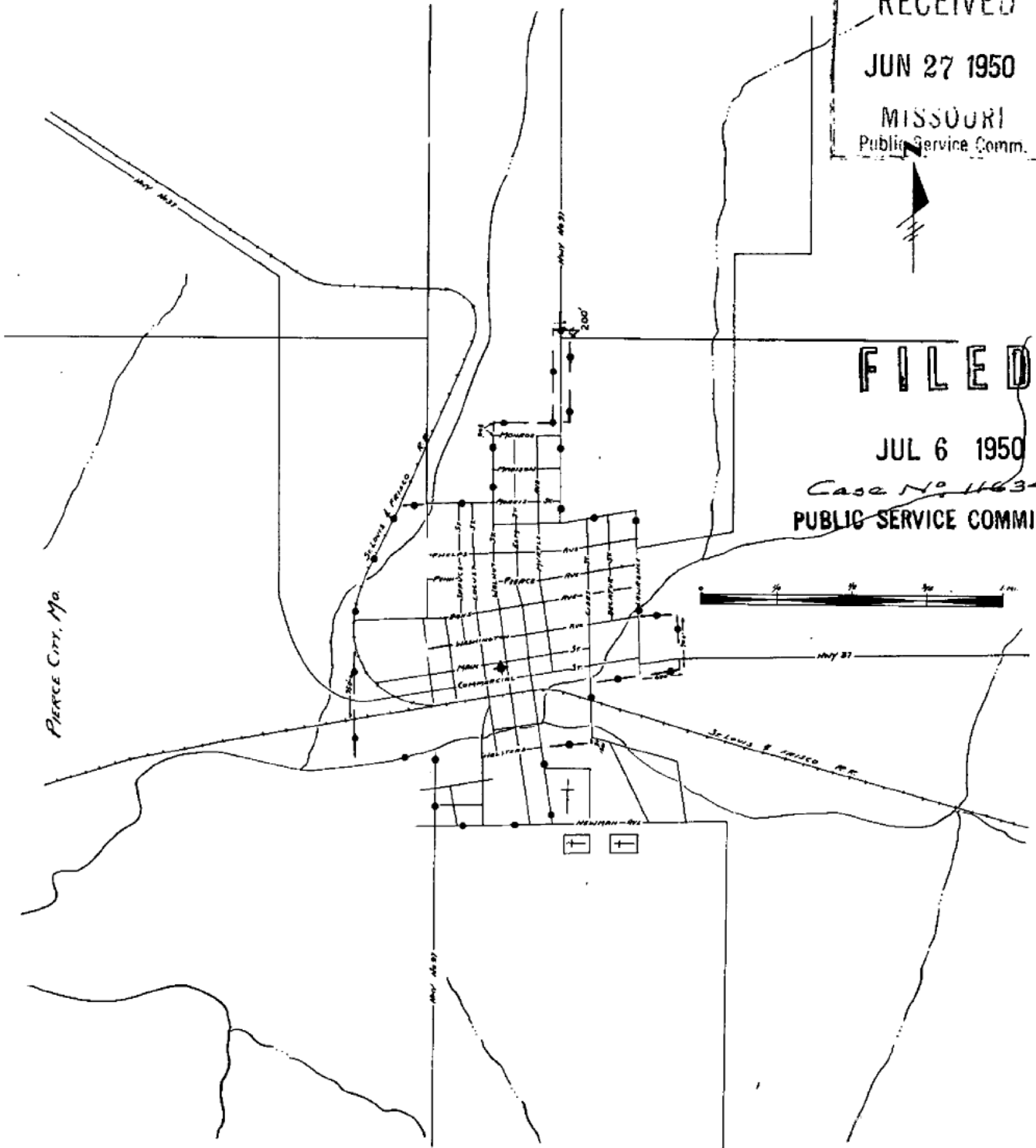

CODE
BELL CENTRAL OFFICE: 
BASE RATE AREA LIMITS: 

CANCELLED - Missouri Public Service Commission - 05/01/2024 - TN-2024-0278 - JI-2024-0142

Issued: June 27, 1950

By H. R. TOWLES, General Manager
Southwestern Bell Telephone Company
St. Louis, Missouri

Effective: July 6, 1950

NO SUPPLEMENT TO THIS TARIFF WILL BE ISSUED EXCEPT FOR THE PURPOSE OF CANCELING THIS TARIFF.

Missouri Portion-Pittsburg, Kansas

P. S. C. Mo. No. 17

REPLACING 10th REVISED SHEET 1A

EXCHANGE AREA MAP

RECEIVED
11th REVISED SHEET 1A
AUG 10 1977
MISSOURI
Public Service Commission

CANCELLED - Missouri Public Service Commission - 05/01/2024 - TN-2024-0278 - JI-2024-0142

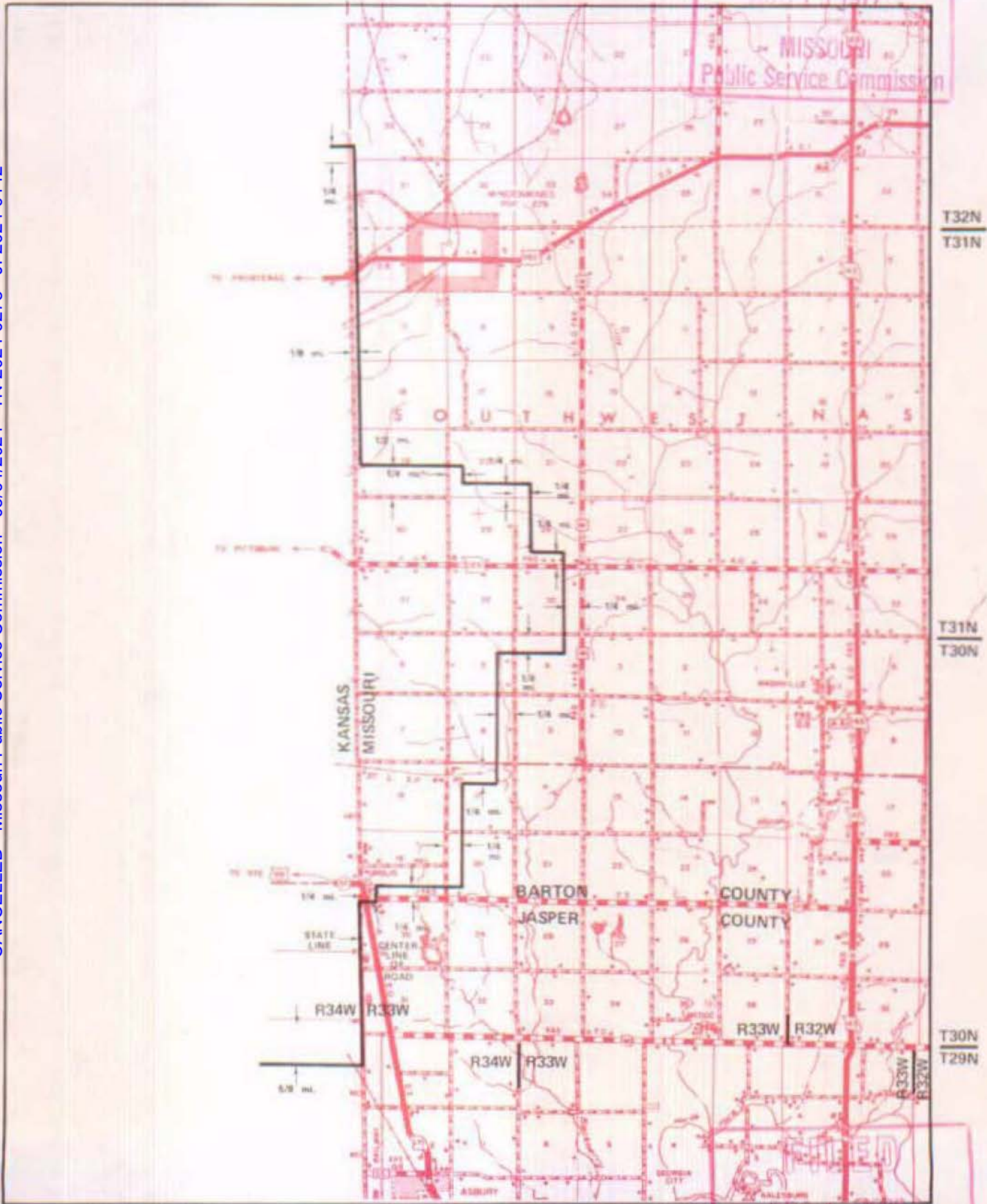

By R. R. SHOCKLEY, Vice President, Missouri
Southwestern Bell Telephone Company
St. Louis, Missouri

FILED
DEC 1 1978
Public Service Commission
Effective: DEC 1 1978

Issued: August 26, 1977

SBC PSC MO #17

Pocahontas – New Wells, Missouri
Original Sheet 2

Non-Scannable Map

(Is viewable in the Data Center
200 Madison Street, 1st Floor
Jefferson City MO)

NO SUPPLEMENT TO THIS TARIFF WILL BE ISSUED EXCEPT FOR THE PURPOSE OF CANCELING THIS TARIFF.

P. S. C. Mo. No. 17

Pond, Missouri

BASE RATE AREA MAP

REPLACING 5th REVISED SHEET 2
4th REVISED SHEET 2

CANCELLED - Missouri Public Service Commission - 05/01/2024 - TN-2024-0278 - JI-2024-0142

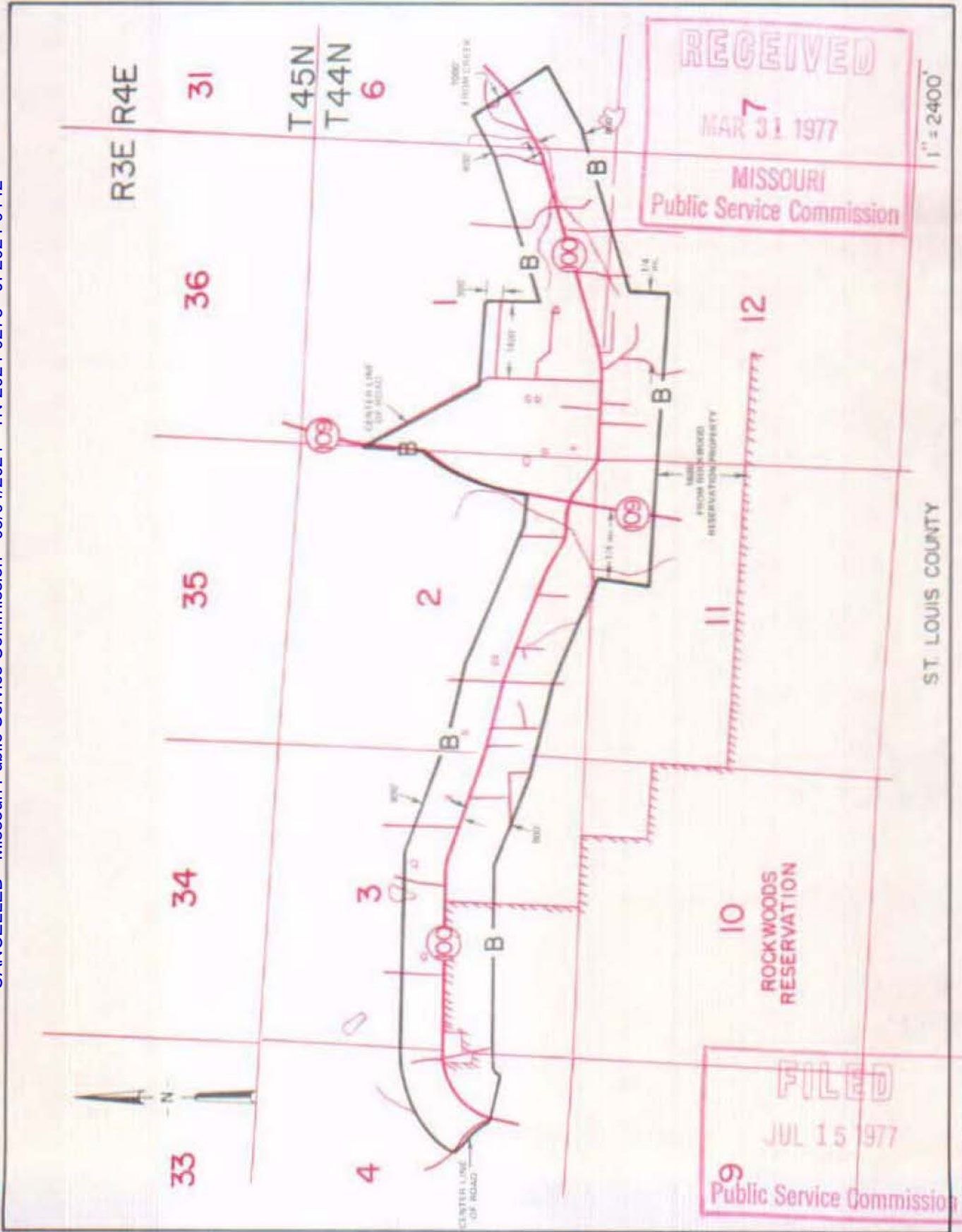

By R. R. SHOCKLEY, Vice President, Missouri
Southwestern Bell Telephone
St. Louis, Missouri

Issued: APR 4 1977

Effective: JUL 15 1977

NO SUPPLEMENT TO THIS TARIFF WILL BE ISSUED EXCEPT FOR THE PURPOSE OF CANCELING THIS TARIFF.

P. S. C. Mo. No. 17 EXCHANGE AREA MAP

Pond, Missouri
16th REVISED SHEET 3
REPLACING 15th REVISED SHEET 3

CANCELLED - Missouri Public Service Commission - 05/01/2024 - TN-2024-0278 - JI-2024-0142

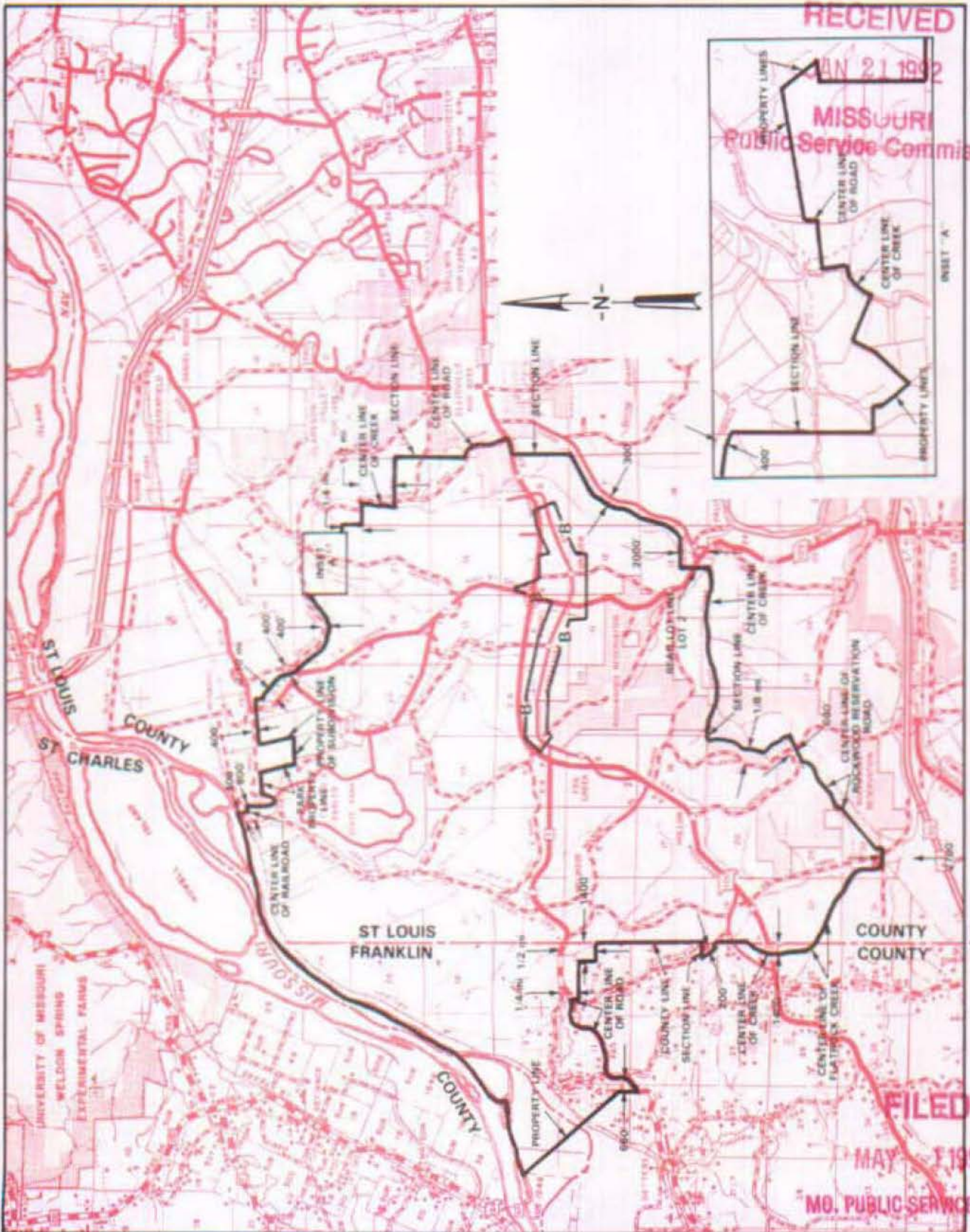

RECEIVED
JAN 21 1992
MISSOURI
Public Service Commission

R5E
R4E

R4E
R3E

R3E
R2E

FILED
MAY 1 1992
MO. PUBLIC SERVICE COMM.

T46N | T45N T45N | T44N T44N | T43N

JAN 23 1992

By R. D. BARRON, President, Missouri Division
Southwestern Bell Telephone Company
St. Louis, Missouri

MAY 01 1992

Issued: _____

Effective: _____

NO SUPPLEMENT TO THIS TARIFF WILL BE ISSUED EXCEPT FOR THE PURPOSE OF CANCELING THIS TARIFF.

15th REVISED SHEET 3
REPLACING 14th REVISED SHEET 3

P. S. C. Mo. No. 17 EXCHANGE AREA MAP

CANCELLED - Missouri Public Service Commission - 05/01/2024 - TN-2024-0278 - JI-2024-0142

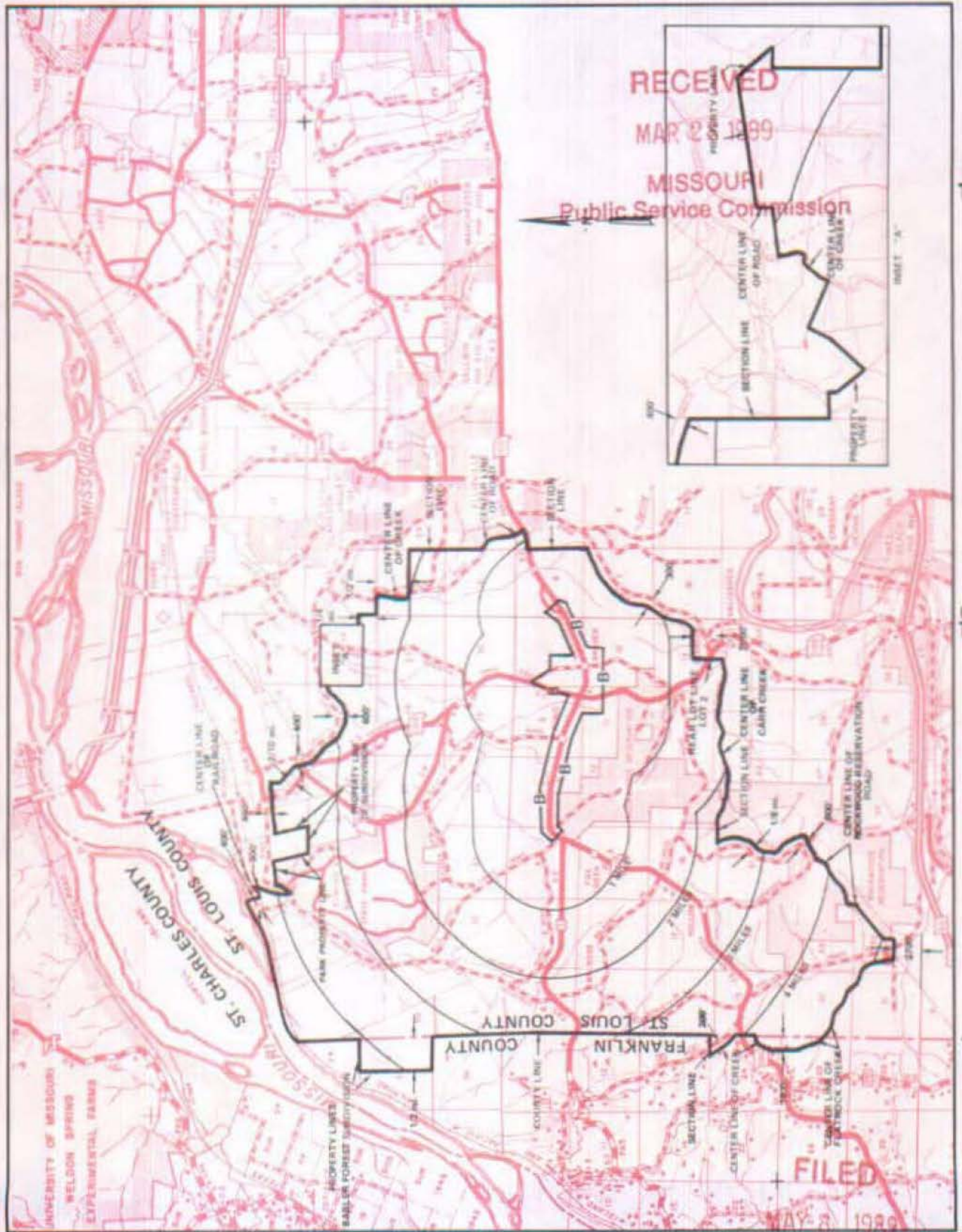

RECEIVED

MAR 2 1989

MISSOURI
Public Service Commission

R5E
R4E

R4E
R3E

R3E
R2E

FILED

MAY 8 1989

T46N | T45N

T45N | T44N

T44N | T43N

By R. D. BARRON, PRESIDENT, MISSOURI DIVISION
Southwestern Bell Telephone Company
St. Louis, Missouri

Public Service Commission

Issued: April 7, 1989

Effective: May 8, 1989

SBC PSC MO #17
Poplar Bluff, Missouri
1st Revised Sheet 2
Replacing Original Sheet 2

Non-Scannable
Map

(Is viewable in the Data Center
200 Madison Street, 1st Floor
Jefferson City MO)

CANCELLED - Missouri Public Service Commission - 05/01/2024 - TN-2024-0278 - JI-2024-0142

NO SUPPLEMENT TO THIS TARIFF WILL BE ISSUED EXCEPT FOR THE PURPOSE OF CANCELING THIS TARIFF.

P. S. C. Mo. No. 17 EXCHANGE AREA MAP

Poplar Bluff, Missouri
REPLACING REVISED SHEET 3
REVISED SHEET 3

RECEIVED

DEC 23 1997

MO. PUBLIC SERVICE COMM

T26N
T25N

T25N
T24N

T24N
T23N

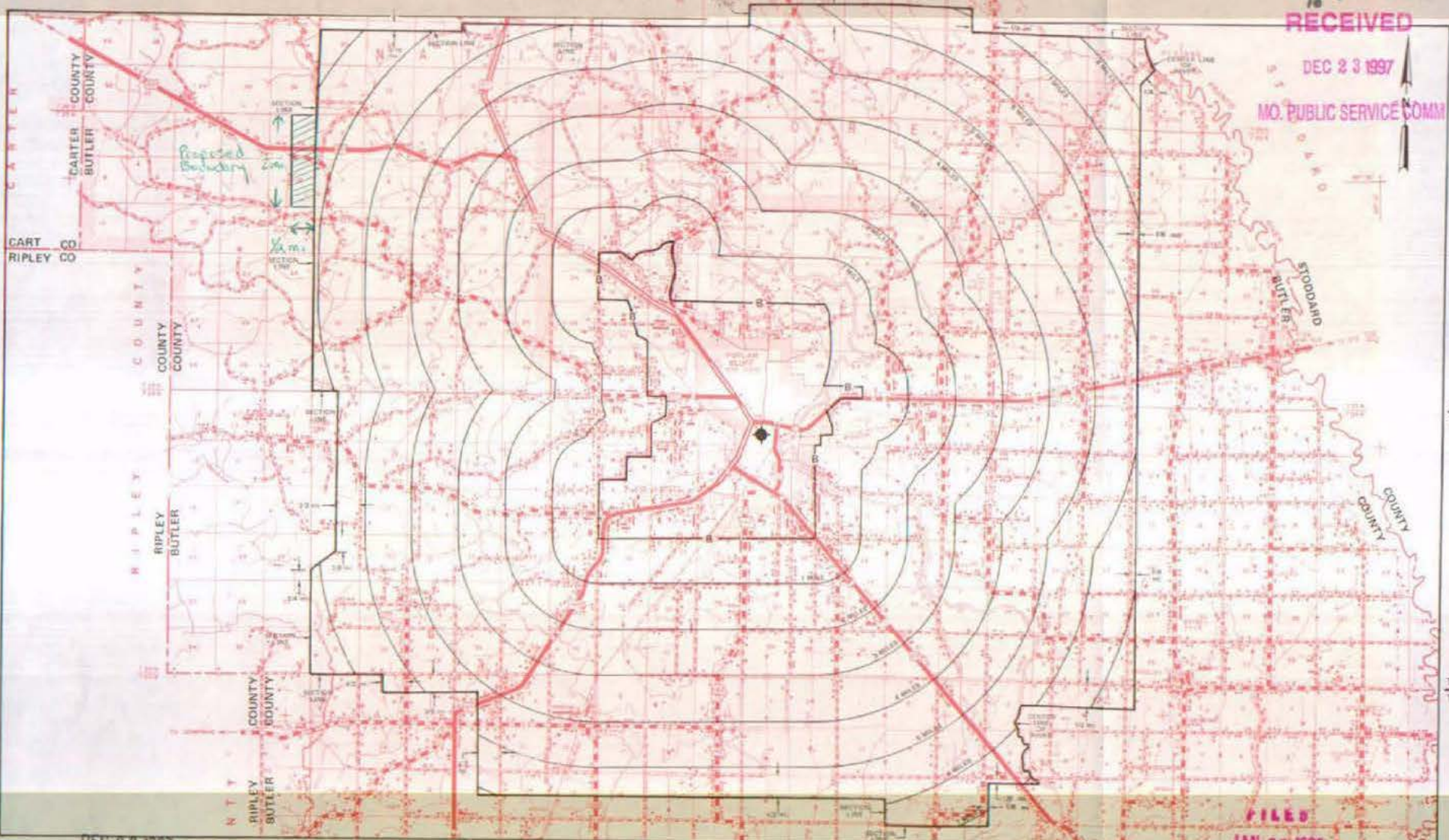

DEC 23 1997

FILED
JAN 23 1998

JAN 23 1998

Issued: ~~SEPTEMBER 20, 1996~~

Prissville Hill-Arden

By **R. H. SLOAN**, Vice President, Missouri
Southwestern Bell Telephone Company
St. Louis, Missouri

MO. PUBLIC SERVICE COMM
Effective: APR 1, 1998

NO SUPPLEMENT TO THIS TARIFF WILL BE ISSUED EXCEPT FOR THE PURPOSE OF CANCELING THIS TARIFF.

P. S. C. Mo. No. 17
EXCHANGE AREA MAP

RECEIVED
PLACING 9th REVISED SHEET 3
SEP 25 1978
MISSOURI
Public Service Commission

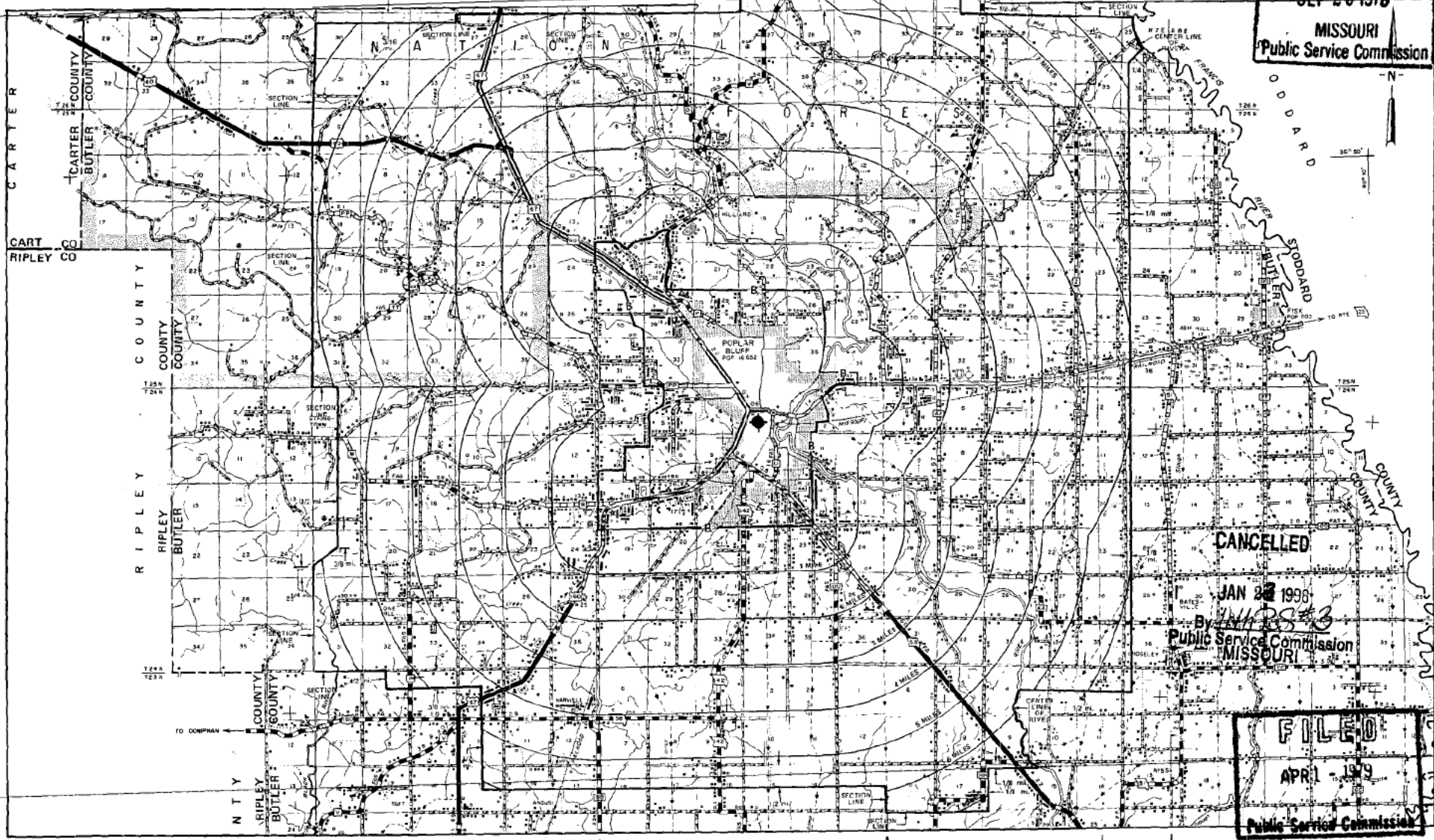

CANCELLED
JAN 22 1998
By *[Signature]*
Public Service Commission
MISSOURI

FILED
APR 1 - 1979
Public Service Commission

NO SUPPLEMENT TO THIS TARIFF WILL BE ISSUED EXCEPT FOR THE PURPOSE OF CANCELING THIS TARIFF.

P. S. C. Mo. No. 17

Portage Des Sioux, Missouri

BASE RATE AREA MAP

3rd REVISED SHEET 2
REPLACING 2nd REVISED SHEET 2

CANCELLED - Missouri Public Service Commission - 05/01/2024 - TN-2024-0278 - JI-2024-0142

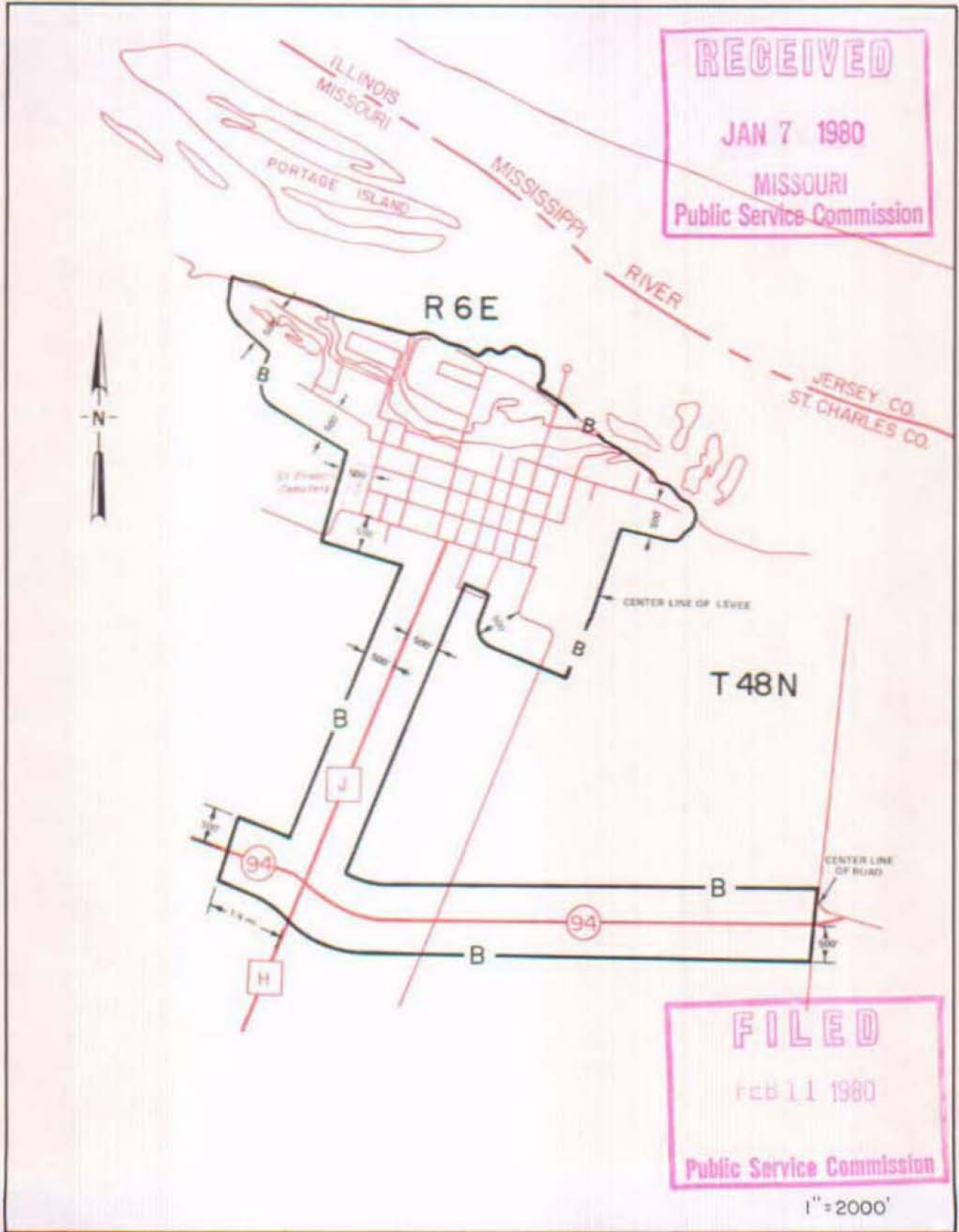

By R. R. SHOCKLEY, Vice President, Missouri
Southwestern Bell Telephone
St. Louis, Missouri

Issued: JANUARY 11, 1980

Effective: FEBRUARY 11, 1980

NO SUPPLEMENT TO THIS TARIFF WILL BE ISSUED EXCEPT FOR THE PURPOSE OF CANCELING THIS TARIFF.

P. S. C. Mo. No. 17

Portage Des Sioux, Missouri

EXCHANGE AREA MAP

6th REVISED SHEET 3
REPLACING 5th REVISED SHEET 3

RECEIVED
JAN 7 1980
MISSOURI
Public Service Commission

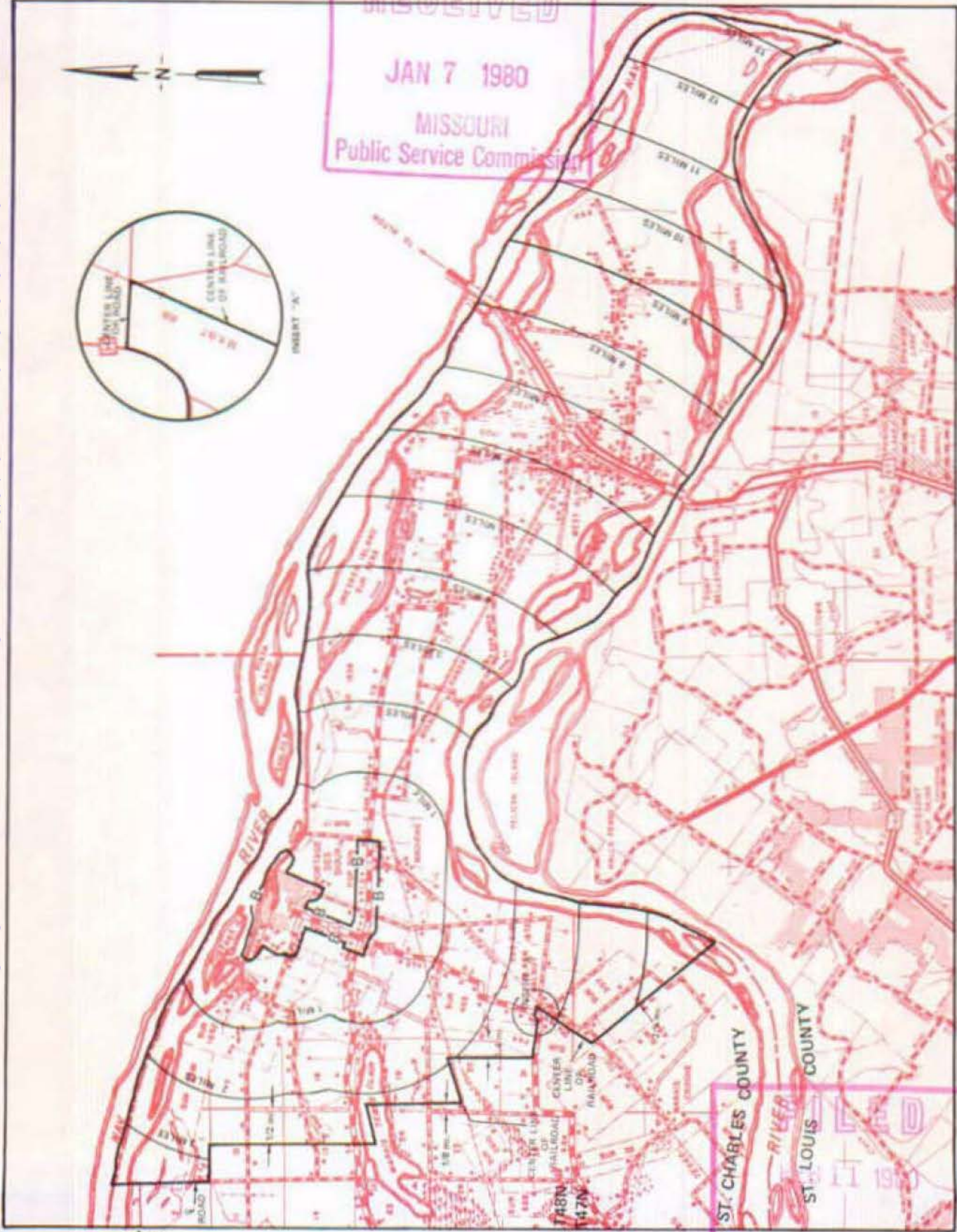

R7E R8E

R6E R7E

R5E R6E

T49N
T48N

By R. R. SHOCKLEY, Vice President, Missouri
Southwestern Bell Telephone Company

RECEIVED
JAN 11 1980
MISSOURI
Public Service Commission

CANCELLED - Missouri Public Service Commission - 05/01/2024 - TN-2024-0278 - JI-2024-0142

NO SUPPLEMENT TO THIS TARIFF WILL BE ISSUED EXCEPT FOR THE PURPOSE OF CANCELING THIS TARIFF.

Portageville, Mo.
FIRST REVISED SHEET 1-A
REPLACING ORIGINAL SHEET 1-A

P. S. C. Mo. No. 2
SOUTHEAST MISSOURI TELEPHONE COMPANY
INITIAL RATE AREA MAP

RECEIVED
MAR 21 1950
MISSOURI
Public Service Comm.

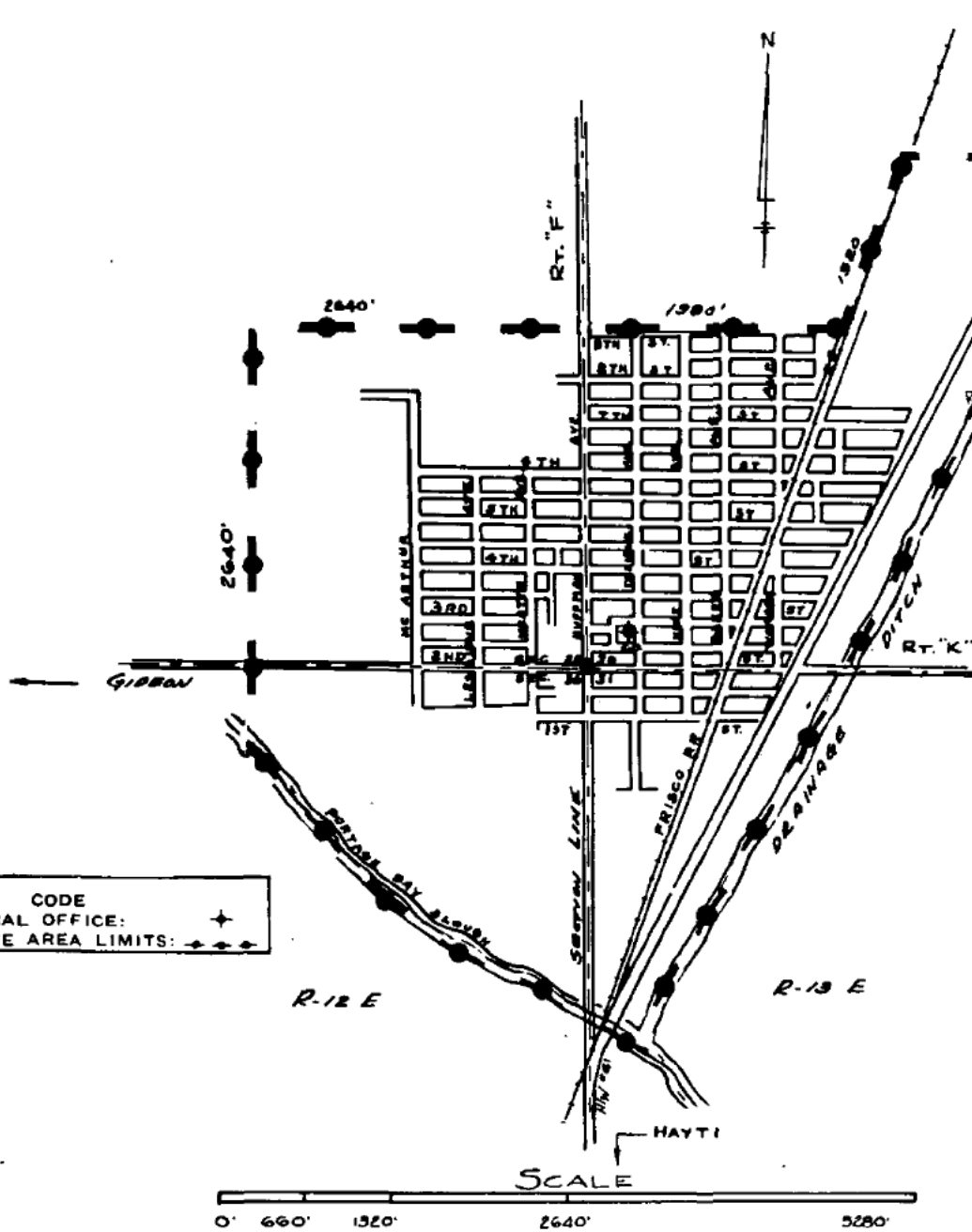

FILED
MAR 21 1950
Case No. 11742
Public Service Commission

CANCELLED - Missouri Public Service Commission - 05/01/2024 - TN-2024-0278 - JI-2024-0142

PORTAGEVILLE, Mo.

Issued: March 20, 1950

Effective: March 21, 1950

By C. W. BOUTIN, President and General Manager
Cape Girardeau, Mo.

NO SUPPLEMENT TO THIS TARIFF WILL BE ISSUED EXCEPT FOR THE PURPOSE OF CANCELING THIS TARIFF.

P. S. C. Mo. No. 17
EXCHANGE AREA MAP

Portageville, Missouri
14th REVISED SHEET 2
REPLACING ORIGINAL SHEET 2

CANCELLED - Missouri Public Service Commission - 05/01/2024 - TN-2024-0278 - JJ-2024-0142

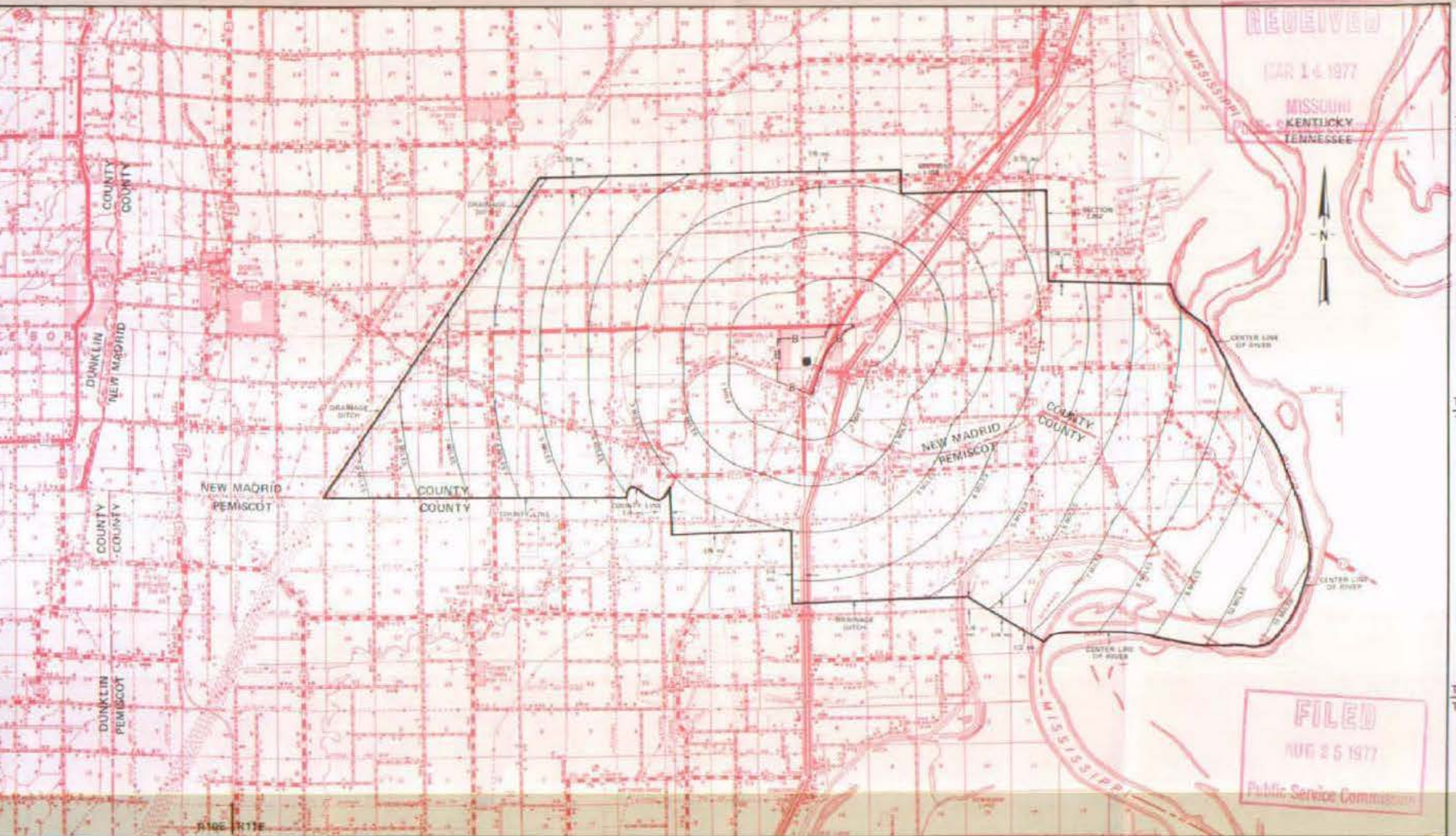

By R. R. SHOCKLEY, Vice President, Missouri
Southwestern Bell Telephone Company
St. Louis, Missouri

R11E | R12E

R12E | R13E

R13E | R14E

Issued March 15, 1977

Effective AUG 25 1977

P.S.C. Mo.-No. 39
Multiparty Elimination Designation
Exchange Area Map

No supplement to this
tariff will be issued
except for the purpose
of canceling this tariff.

Puxico, Missouri
1st Revised Sheet 1
Replacing Original Sheet 1

RECEIVED

JUL 29 1993

MO. PUBLIC SERVICE COMM.

This page is being held for future use.

CANCELLED - Missouri Public Service Commission - 05/01/2024 - TN-2024-0278 - JI-2024-0142

FILED

AUG 31 1993

MO. PUBLIC SERVICE COMM.

Issued: **JUL 30 1993**

Effective: **AUG 31 1993**

By A. D. ROBERTSON, Assistant Vice President-External Affairs
Southwestern Bell Telephone Company
St. Louis, Missouri

NO SUPPLEMENT TO THIS TARIFF WILL
BE ISSUED EXCEPT FOR THE PURPOSE OF
CANCELING THIS TARIFF.

P. S. C. Mo. No. 17
BASE RATE AREA MAP

Puxico, Missouri
ORIGINAL SHEET 2
REPLACING SOUTHEAST MISSOURI
TELEPHONE COMPANY P. S. C. Mo. No. 2
1st REVISED SHEET 1-A

CANCELLED - Missouri Public Service Commission - 05/01/2024 - TN-2024-0278 - JI-2024-0142

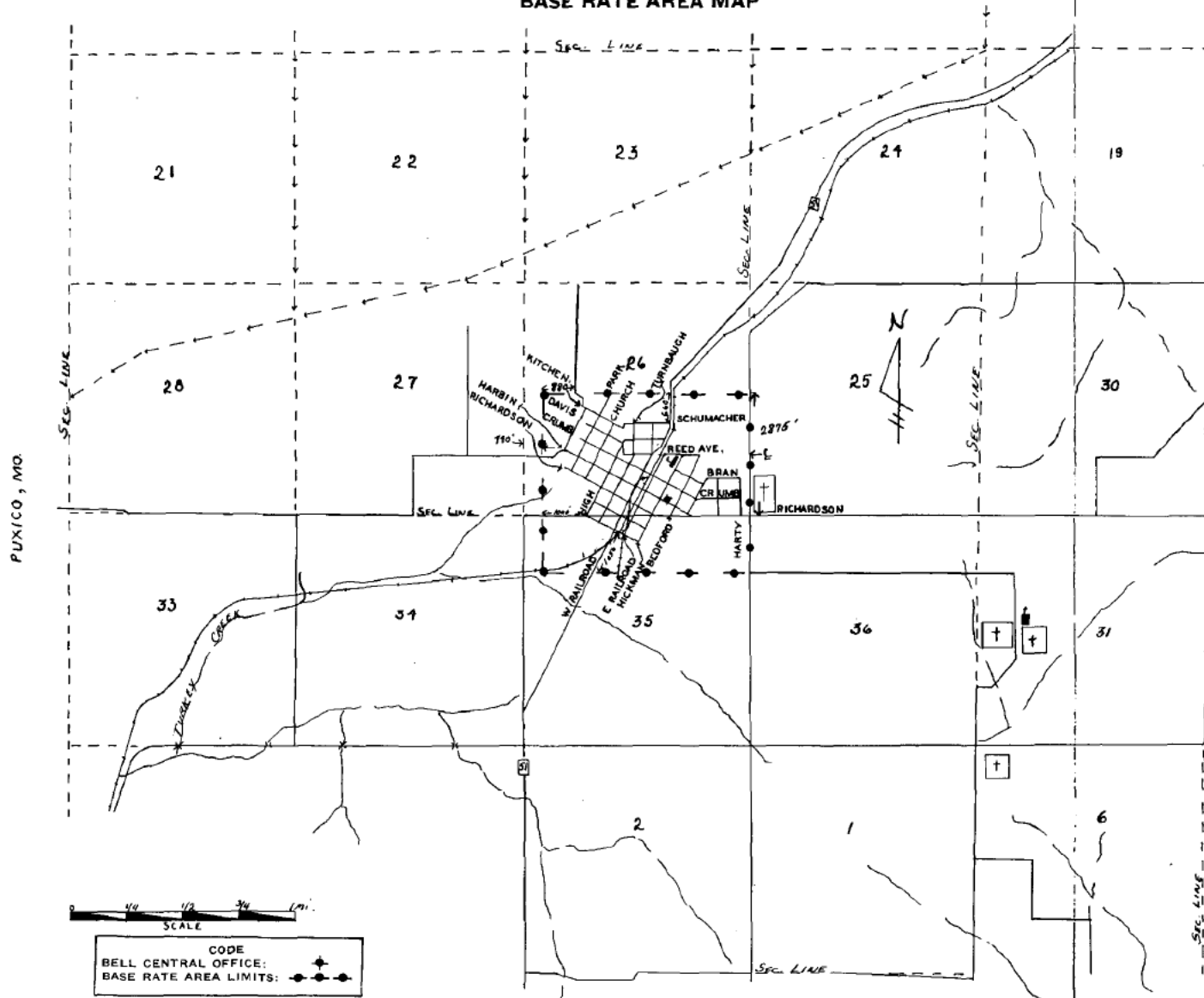

RECEIVED
DEC 7 1955
MISSOURI
Public Service Comm.

FILED
JAN 8 1956

MISSOURI PUBLIC SERVICE COMMISSION

~~CANCELLED~~
SEP 27 1970
BY PUBLIC SERVICE COMMISSION
OF MISSOURI

Issued: December 8, 1955

By J. R. PETERSON, General Manager
Southwestern Bell Telephone Company
St. Louis, Missouri

Effective: January 8, 1956

SBC PSC MO #17
Puxico, Missouri
Puxico West Island Bra
Original Sheet 2A

Non-Scannable Map

(Is viewable in the Data Center
200 Madison Street, 1st Floor
Jefferson City MO)

CANCELLED - Missouri Public Service Commission - 05/01/2024 - TN-2024-0278 - JI-2024-0142

NO SUPPLEMENT TO THIS TARIFF WILL BE ISSUED EXCEPT FOR THE PURPOSE OF CANCELING THIS TARIFF.

P. S. C. Mo. No. 17
EXCHANGE AREA MAP

REG. Puxico, Missouri
12th REVISED SHEET 3
REPLACING 12th REVISED SHEET 3
FEB. 14, 1977

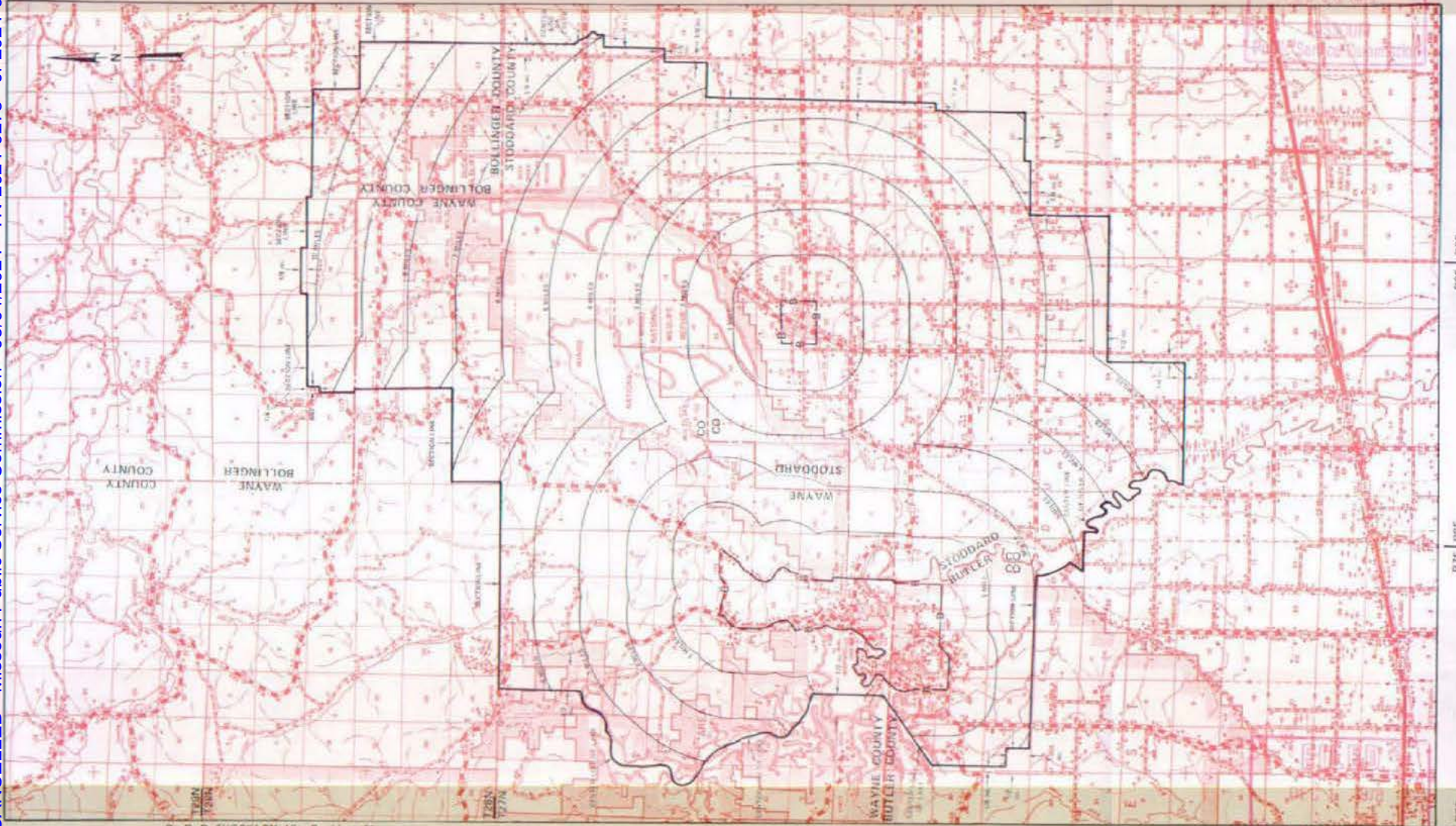

By R. R. SHOCKLEY, Vice President, Missouri
Southwestern Bell Telephone Company
St. Louis, Missouri

Issued: February 15, 1977

Public Service Commission

Effective: DEC 1 1976