

Pearl's II Eden for Elders
611 North College
Princeton, MO 64673
Phone 660-748-4407
FAX 660-748-4409 (office) or 660-748-3961 (nursing)

This document is page 1 of _____ pages

FAX to: _____

Phone: _____

FAX: 573-522-2509

Date: 9/19/23

Time: _____

From: _____

Notes:

2 parts

The information contained in this message is intended for the exclusive use of the addressee or addressee's authorized agent. This message is privileged and confidential or may contain proprietary or sensitive information. It shall not be copied or disseminated except as directed by the addressee. Any unauthorized use, copying, or dissemination of this message or its contents is prohibited. If you receive this in error, please advise the sender immediately and return this message and any copies to our office immediately.



Missouri Public Service Commission Manufactured Housing & Modular Unit Program Inspection Request/Consumer Complaint Form

Please print legibly or type.

CONSUMER INFORMATION (REQUIRED)	OFFICE USE ONLY	
Name Oragunior: Gudy Pruitt: Ann Shroyer	File Name	
Address 20374 Gate Pl.	Inspector	
City/State/Zip Princeton MD 64673	Received by:	
County Mercer	Date of Inquiry:	
Work Phone	Date of Receipt:	
Home Phone 660-748-3764	HOME INFORMATION (REQUIRED)	
Other Phone 660-223-3936	<input type="checkbox"/> New or <input type="checkbox"/> Used <input type="checkbox"/> Single or <input type="checkbox"/> Multi-Section	
MANUFACTURER INFORMATION (REQUIRED)		Set Up: Basement <input type="checkbox"/> Foundation <input type="checkbox"/> Piers <input type="checkbox"/>
Name Legacy Housing Corporation	HUD Label #.	Serial #. (REQUIRED)
Address 4801 Mark IV Parkway	Model	Size of Home:
City/State/Zip Forth Worth TX 76106	Manufacture Date:	Delivery Date:
DEALER INFORMATION (REQUIRED)		Has the home been moved from original location? Yes <input type="checkbox"/> No <input type="checkbox"/>
Name Sun-Flower Mobile Home	Are you the first owner of the home? Yes <input type="checkbox"/> No <input type="checkbox"/>	
Address 1102 Roseport RD	INSTALLER INFORMATION (IF KNOWN)	
City/State/Zip Wathena KS 66090	Name:	Decal #:
REASON FOR REQUEST (REQUIRED)		
List each concern separately. Do not write concerns in paragraph form.		
1.	See ATTACHMENTS	
2.		
3.		
4.		
5.		
6.		
7.		
8.		
9.		
10.		
11.		
12.		
13.		
14.		
15.		
Attach additional sheets if necessary.		
Signature of Consumer: (REQUIRED)		Date:
This form must be completed in full and submitted with a copy of the Bill of Sale or Purchase Agreement. (REQUIRED)		
RETURN TO:	Manufactured Housing & Modular Unit Program	PHONE: 800-819-3180
	P.O. Box 360, Jefferson City, MO 65102 or	
	200 Madison Street, 5 th Floor, Jefferson City, MO 65101	FAX: 573-522-2509

Reason for request

Kitchen & Dining Room

- 1) Caulking on the counter does not touch.
- 2) Faucett sticks out past sink.
- 3) Plug ends are not Flush, push in too far or angled outward.
- 4) Stable holes are showing.
- 5) Nails in trim are not complete nail into the wall.
- 6) ceiling over the counter showing board from the frame.
- 7) Cabinets trim split with screws

Bathroom # 2

- 1) Ask for 5 Handicap Bars only Received one (My daughter is disabled)
- 2) The tub is not sealed with caulking on the outside right corner.
- 3) Spray foam in water heater not trimmed.
- 4) Stool guts was not working (we replaced with new guts)
- 5) The trim over sink does not fasten down.
- 6) Cabinet above the sink the paper has peeled back.
- 7) Electric plug ends do not flush with plate.
- 8) Caulking and counter do not touch.

Hallway

- 1) Carpet cut to short from the wall in between Bedroom 1 – 2
- 2) Sheet wall been broken.
- 3) Sheet wall has nail holes.
- 4) Two different trims (Plastic & Board)
- 5) The frame trim is broken in the hallway entrance.
- 6) Ceiling trim nails are not flush they stick out.
- 7) Wall is not flush having a dip covering with trim.
- 8) Door frame to bedroom # 3 has a split.

Bedroom # 4

- 1) Door has insulation not been cleaned off.
- 2) The ceiling dry wall is cracked.
- 3) Dry wall has holes was not replaced.
- 4) Staples are showing.
- 5) Electrical plug ends are not flush.

Reason for request

Master Bedroom

- 1) Window without screen
- 2) Plug ends are not flush.
- 3) Water stain on underneath carpet
- 4) Broke wall trim

Master Bathroom

- 1) Order carpet wasn't put in.
- 2) Nail holes in linen closet
- 3) Trim too short in lined closet corner
- 4) Sink 1 & 2 caulking not touching the counter.
- 5) All trim is not nailed around the shower frame.
- 6) The bathroom ceiling is discolored in the entrance way.
- 7) The Shower wall is discolored.
- 8) Wall trim in bedroom & bathroom was put back and broken.

Office area & Closet

- 1) Caulking on counter not touching.
- 2) Trim doesn't match (Plastic and Board)
- 3) No trim inside of closet frame & Corners
- 4) Staples showing & trim with staples holes.
- 5) Frame Broken around door.

Livingroom

- 1) The trim was not fastened down.
- 2) Door frame not covered with trim.
- 3) Cap in door frame
- 4) Door frame is not straight.
- 5) Corner walls had holes and filled in with caulking.
- 6) Livingroom ceiling has water stains.
- 7) The Livingroom & kitchen dining room was spray paint to cover up water stains.
- 8) Front door entrance vinyl was order not received.

Reason for request

Bedroom # 3

- 1) No walk-in closet.
- 2) Window trim does not fasten to frame.
- 3) Trim not nailed.
- 4) Staples showing
- 5) There is a floor gap in the doorway that is not level, and the trim is not corrected.
- 6) Shelves are not straight+
- 7)

Bedroom # 2

- 1) Broke Trim
- 2) Staples showing
- 3) Door trim not secured correctly.
- 4) Shelves are not straight.

Utilities

- 1) The furnace ceiling filled up with caulking.
- 2) The trim not flush on ceiling
- 3) Shelving not on straight (bracket is crooked and bent over the washer dry area)
- 4) The shelving on the wall is not straight.
- 5) The screws are not straight they are in crooked.

Outside

- 1) Windows are not flush.
- 2) The back door has a crack around the doorknob.
- 3) Master Bedroom has not screen
- 4) Window insulation is showing around the window frame.
- 5) Window frame not together in the corners
- 6) Vent is not flush up against the siding.

Notes

- Attics need more insulation.
- There are 18 electrical plug ends that are not flush with the plate.
- There are 10 windows on the outside that are not flush with siding.
- All shelving in the (Closets, utilities room)
- The master bedroom wall is bowed out from the door frame.
-

CERTIFICATE OF ORIGIN
MANUFACTURED HOME

IDENTIFICATION NUMBER
L212791A/B

TRADE NAME	MODEL	YEAR	DATE OF TITLE TRANSFER	
LEGACY HOUSING	S-2468-42A	2022	4/26/2022	
WIDTH	LENGTH (INCLUDING HITCH)	LENGTH (EXCLUDING HITCH)	WEIGHT	INVOICE
24	68	64	46,014.00	L212791A/B

The undersigned certifies that: The home is the property of the manufacturer; this is the first transfer; and ownership (subject to payment being received) is properly transferred to the following:

DEALER: SUNFLOWER MOBILE HOMES LLC
1008 ROSEPORT RD
WATHENA, KS 66090

MANUFACTURER: LEGACY HOUSING CORP
103 NORTH NEAL
COMMERCE, TX 75428

BY: Dama Camb

MFG 1056

ASSIGNMENT NO. 1	<p>FOR VALUE RECEIVED, I THE UNDERSIGNED, TRANSFER THE MOBILE/MANUFACTURED HOME DESCRIBED ON THE FACE OF THIS CERTIFICATE TO NAME OF PURCHASER(S) _____</p> <p>ADDRESS _____</p> <p>AND CERTIFY TO THE BEST OF MY KNOWLEDGE, INFORMATION AND BELIEF UNDER PENALTY OF LAW, THAT THE MOBILE/MANUFACTURED HOME IS NEW AND HAS NOT BEEN REGISTERED IN THIS OR ANY STATE AND AT THE TIME OF DELIVERY THE MOBILE/MANUFACTURED HOME WAS SUBJECT TO THE FOLLOWING SECURITY INTERESTS AND NONE OTHER AND WARRANT TITLE TO THE MOBILE/MANUFACTURED HOME.</p> <p style="text-align: center;">AMOUNT OF LIEN DATE OF LIEN KIND OF LIEN IN FAVOR OF</p> <hr/> <p>LIENHOLDER'S ADDRESS _____</p> <p>DEALER <u>Star Home Mobile Homes LLC</u> BY: <u>[Signature]</u> AUTHORIZED SIGNATURE OF DEALER TITLE OR POSITION _____</p> <p>State of _____</p> <p>County of _____</p> <p style="text-align: center;">Being duly sworn upon oath says that the statements set forth are true and correct. Subscribed and sworn to me before me this _____ day of _____, 20____ Notary Seal</p> <p style="text-align: center;">USE NOTARIZATION ONLY IF REQUIRED IN TITLING JURISDICTION</p>
ASSIGNMENT NO. 2	<p>FOR VALUE RECEIVED, I THE UNDERSIGNED, TRANSFER THE MOBILE/MANUFACTURED HOME DESCRIBED ON THE FACE OF THIS CERTIFICATE TO NAME OF PURCHASER(S) _____</p> <p>ADDRESS _____</p> <p>AND CERTIFY TO THE BEST OF MY KNOWLEDGE, INFORMATION AND BELIEF UNDER PENALTY OF LAW, THAT THE MOBILE/MANUFACTURED HOME IS NEW AND HAS NOT BEEN REGISTERED IN THIS OR ANY STATE AND AT THE TIME OF DELIVERY THE MOBILE/MANUFACTURED HOME WAS SUBJECT TO THE FOLLOWING SECURITY INTERESTS AND NONE OTHER AND WARRANT TITLE TO THE MOBILE/MANUFACTURED HOME.</p> <p style="text-align: center;">AMOUNT OF LIEN DATE OF LIEN KIND OF LIEN IN FAVOR OF</p> <hr/> <p>LIENHOLDER'S ADDRESS _____</p> <p>DEALER _____ BY: _____ AUTHORIZED SIGNATURE OF DEALER TITLE OR POSITION _____</p> <p>State of _____</p> <p>County of _____</p> <p style="text-align: center;">Being duly sworn upon oath says that the statements set forth are true and correct. Subscribed and sworn to me before me this _____ day of _____, 20____ Notary Seal</p> <p style="text-align: center;">USE NOTARIZATION ONLY IF REQUIRED IN TITLING JURISDICTION</p>
ASSIGNMENT NO. 3	<p>FOR VALUE RECEIVED, I THE UNDERSIGNED, TRANSFER THE MOBILE/MANUFACTURED HOME DESCRIBED ON THE FACE OF THIS CERTIFICATE TO NAME OF PURCHASER(S) _____</p> <p>ADDRESS _____</p> <p>AND CERTIFY TO THE BEST OF MY KNOWLEDGE, INFORMATION AND BELIEF UNDER PENALTY OF LAW, THAT THE MOBILE/MANUFACTURED HOME IS NEW AND HAS NOT BEEN REGISTERED IN THIS OR ANY STATE AND AT THE TIME OF DELIVERY THE MOBILE/MANUFACTURED HOME WAS SUBJECT TO THE FOLLOWING SECURITY INTERESTS AND NONE OTHER AND WARRANT TITLE TO THE MOBILE/MANUFACTURED HOME.</p> <p style="text-align: center;">AMOUNT OF LIEN DATE OF LIEN KIND OF LIEN IN FAVOR OF</p> <hr/> <p>LIENHOLDER'S ADDRESS _____</p> <p>DEALER _____ BY: _____ AUTHORIZED SIGNATURE OF DEALER TITLE OR POSITION _____</p> <p>State of _____</p> <p>County of _____</p> <p style="text-align: center;">Being duly sworn upon oath says that the statements set forth are true and correct. Subscribed and sworn to me before me this _____ day of _____, 20____ Notary Seal</p> <p style="text-align: center;">USE NOTARIZATION ONLY IF REQUIRED IN TITLING JURISDICTION</p>

NO POSTAGE
NECESSARY
IF MAILED
IN THE
UNITED STATES

BUSINESS REPLY MAIL
FIRST-CLASS MAIL PERMIT NO. 394 FORT WORTH TX

POSTAGE WILL BE PAID BY ADDRESSEE

LEGACY HOUSING CORPORATION
4801 MARK IV PKWY
FORT WORTH TX 76106-9943

TO BE COMPLETED
AFTER SECOND SALE
RATED LINE AND MAIL TO LEGACY HO

PLEASE DETACH AND RETURN
WARRANTY REGISTRATION

OWNER/PURCHASER: David Ruff
 STREET ADDRESS: 20514 Gate Road
 CITY: Pinetta STATE: NC ZIP: 27043 HOME/MOBILE PHONE: 440-273-3984
 RETAILER/SELLER: Sunking York Homes DATE SOLD: 11/01/2021
 STREET ADDRESS: 1102 Wessing Rd CITY: Charlotte
 CITY: Charlotte STATE: NC ZIP: 28200 PHONE: 919-365-3211
 LOCATION OF HOME: Subdiv
 STREET ADDRESS: 20314 Gate Road CITY: Pinetta STATE: NC ZIP: 27043 PHONE: 440-273-3984
 CITY: Pinetta STATE: NC ZIP: 27043 PHONE: 440-273-3984
 DATE OF MFG: 2/28/22 SERIAL NO.: 1212791A1B
 MODEL NO.: S-2468-47A

DESIGN WIND ZONE		DESIGN ROOF LOAD		THERMAL ZONE	
WIND ZONE I	15 PSF	SOUTH: 20 PSF	ZONE I		
WIND ZONE II	100 MPH	MIDDLE: 30 PSF	ZONE II		
WIND ZONE III	110 MPH	NORTH: 40 PSF	ZONE III		
OTHER	MPH				

KEEP THIS BOOKLET WITH YOUR HOME. THE
 OF THE HOUSING AND GOVERNMENT ACT
 OF 1974 PROVIDES FOR THE PROTECTION
 AGAINST CERTAIN CONSTRUCTION AND
 SAFETY HAZARDS IN YOUR HOME. TO
 HELP ASSURE YOUR PROTECTION, THE
 MANUFACTURER OF YOUR HOME NEEDS
 THE INFORMATION THAT THE WARRANTY
 CARD THIS PAGE WHEN COMPLETED AND
 MAILED WILL SUPPLY IF YOU BOUGHT YOUR
 HOME FROM A RETAILER. PLEASE BE SURE
 THAT YOUR RETAILER HAS COMPLETED AND
 MAILED A CARD FOR YOU. THIS WILL ENSURE
 THAT YOUR HOME IS REGISTERED IN OUR
 WARRANTY INFORMATION CENTER. IF YOU
 ACQUIRED YOUR HOME FROM SOMEONE
 WHO IS NOT A RETAILER, YOU SHOULD
 PROMPTLY FILL OUT AND SEND A CARD TO
 THE MANUFACTURER. IS IMPORTANT THAT
 YOU KEEP THIS BOOKLET AND GIVE IT TO ANY
 PERSON WHO BUYS THE HOME FROM YOU.



Sales Order

Date: 8/18/2021

Dealership: Sunflower Mobile Homes LLC (the "Dealer")

The Dealer has today purchased from Legacy the following unit(s), manufactured in accordance with the attached specifications:

Model No.	Order No.	Size	Total Invoice Price
1. <u>S-2468-42A</u>	<u>44604</u>	<u>24x68</u>	<u>\$ 82,418.31</u>
2. _____	_____	_____	\$ _____
3. _____	_____	_____	\$ _____
4. _____	_____	_____	\$ _____
5. _____	_____	_____	\$ _____
6. _____	_____	_____	\$ _____
Total Order Price			<u>\$ 82,418.31</u>

Handwritten note: #2 Attachment to #1 See High Light

The estimated off-line date range for this order is between 6 months and 12 months.

This order is an unconditional sales order authorized for production.

Signature: _____

Print Name: _____

Additional Terms and Conditions

If, for any reason, including without limitation, a request by Dealer and/or factory, this order is subject to changes to material surcharges and the invoice will be based on prices in effect on the date of the invoice (including changes to material surcharge).

Except for unit(s) transported directly from Legacy's factory to Dealer's licensed retail sales facility, Dealer accepts any and all unit(s) as-is, where-is, and with all faults (other than latent defects) upon shipment from Legacy's factory. If any of the above units are transported from Legacy's factory directly to Dealer's licensed retail sales facility, then Dealer has ten days following arrival of such unit(s) at Dealer's licensed retail sales facility to report any defect, after which Dealer accepts such unit(s) as-is, where-is, and with all faults (other than latent defects). Notwithstanding the foregoing, if a unit is moved from Dealer's licensed retail sales facility, then Dealer accepts such unit(s) as-is, where-is, and with all faults (other than latent defects) upon removal from the licensed retail sales facility.

Dealer has five days to pick up a unit after it comes off-line. Thereafter, the Dealer will be charged a storage fee of \$10 per floor per day.

If a unit is consigned by Legacy, it must be transported directly to Dealer's licensed retail sales facility, unless Dealer receives from Legacy written authorization to the contrary. If a unit is consigned by Legacy, movement from Dealer's retail lot is prohibited without prior written authorization from Legacy. Dealer agrees to pay a fine of \$1,000 if a consigned unit is moved without prior written authorization from Legacy.

Handwritten signatures:
[Signature] - Owner
[Signature] (sales)

League S-2468-42A 24x68 Home Order

[Redacted]		744
Aug 14, 2021		80-333/1019 02
Pay to the Order of	<u>Sun Home Mobile Homes</u>	\$ <u>8,241.83</u>
	<u>Eight thousand two hundred and forty one and 83/100</u>	Dollars
Farmers Bank of Northern Missouri		
For	<u>2021 Ultra Light Home</u>	[Redacted]

Transfer
8/14/21
Herly
Hillary

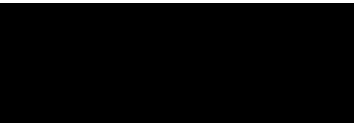

745
80-333/1019
02

8/16/2021
 Date

Pay to the Order of Sun-flower Mobile Homes \$ 8,241.⁸³/₁₀₀
Eight Thousand Two Hundred Forty-One ⁸³/₁₀₀ Dollars  Security Features Details on Back.

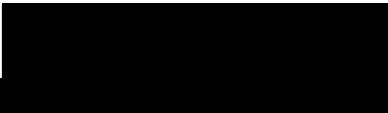
Farmers Bank
 of Northern Missouri

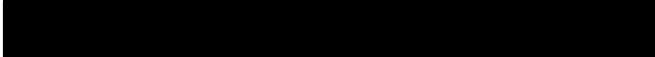
For 2021 Ultra Wide Home 





Extend shower/tub combo where H2O tank is (replace with linen closet)

5 Must have handicap bars in shower area

Fwd:

From: Ashley Snider (ashley@hhresolutions.com)

To: judycampbell27@yahoo.com

Date: Monday, April 5, 2021, 05:24 PM CDT

Here is the optional information within the order.

Best Regards,
Ashley Snider
Sunflower Mobile Homes
Receptionist

----- Forwarded message -----

From: <officeprinter@hhresolutions.com>

Date: Mon, Apr 5, 2021 at 5:17 PM

Subject:

To: <ashley@hhresolutions.com>



scan.pdf

632.2kB

CONFIRMATION ORDER

Serial #:
Invoice:
Order#: 44604
Prod. #:

Plant: 2 Legacy Housing Corporation
Dealer: DISPLAY
FORT WORTH, TX
Retail Customer: SunFlwr Pruitt Home 2468 42A
Salesperson: DeBusk, Shane

4/5/2021
Page 1 of 2

Model: S-2468-42A Model Year: 2021 Size: 24x68 Beds: 4
Desc: S-2468-42A 24 x 68 4/2 Sq Feet: 1,536.00 Floors: 2 Baths: 2.0

Qty	Part	Description/Memo	Price	Color/Location
-----	------	------------------	-------	----------------

***** EXTERIOR *****

1.00	010.0535	Blue Exterior Vinyl Siding	Opt	\$0.00
1.00	010.1601	4" Hardie Fascia (Standard) (Pick Colors)	Opt	\$0.00 Sycamore
1.00	010.297	Weather Wood Shingles (Standard)	Opt	\$0.00
1483.00	010.58	Radiant Barrier	Opt	\$444.90
1.00	010.6126	In-Swing Steel NO storm Front Door	Opt	\$0.00
1.00	010.80	16" Dormer W/ Smart Trim Columns (Pick Colors)	Opt	\$0.00 Sycamore
128.00	010.91	Royal Brown Gutters (Per Side)	Opt	\$512.00 Front Side & Back Side Ship Loose
1.00	010.983	Low-E Windows	Cmpnt	

***** APPLIANCES & CABINETS *****

1.00	020.000266	Charcoal Ash Cabinets	Opt	\$0.00
1.00	020.00053	Mocha Fantastico Countertops	Opt	\$0.00
1.00	020.011	Electric Range - Black (Standard)	Opt	\$0.00
1.00	020.101	Dishwasher - Black	Opt	\$395.00
1.00	020.301	Omit Refrigerator	Opt	(\$259.00)
1.00	020.43	Kitchen Sink - Stainless Steel Double Bowl 8" Deep	Opt	\$95.00

***** FRAME & FLOORING *****

2.00	030.001	Extra Idler Axle	Opt	\$590.00
1.00	030.005	Reinforced Frame (DW)	Opt	\$590.00
1.00	030.4133	096L Light Oak Linoleum	Opt	\$0.00
5.00	030.41912	Sahara Carpet/Tile Exchange	Opt	\$425.00 Mstr BR & Bath, LVR, BR 4, BR3

***** PLUMBING *****

1.00	040.02	Electric Water Heater - 50 gallon	Opt	\$175.00
1.00	040.3106	Metal Upgrade Faucets W/ Ceramic Lavy (All) - 8	Opt	\$224.00
6.00	040.4104	Silver Grab Bar 5 bars in Shower area - 1 Bar near Toilet	Opt	\$330.00 Locations on Floorplan Bathroom #2 Tub and Toilet
1.00	040.43	Hand Wand in Shower or Tub/Shower (Standard)	Opt	\$0.00
1.00	040.55	Shut Off Valves Throughout	Opt	\$195.00
2.00	040.554	Elongated Toilets	Opt	\$40.00

BASE PRICE:
OPTIONS:
ASSOCIATION:
VIP DISCOUNT
FREIGHT:

TOTAL INVOICE PRICE: ** continued **

CONFIRMATION ORDER

Serial #:
 Invoice:
 Order#: 44604
 Prod. #:

Plant: 2 Legacy Housing Corporation
 Dealer: DISPLAY
 FORT WORTH, TX
 Retail Customer: SunFwr Pruitt Home 2468 42A
 Salesperson: DeBusk, Shane

4/5/2021
 Page 2 of 2

Qty	Part	Description/Memo		Price	Color/Location
ELECTRICAL					
1.00	050.002	Wire & Brace for Ceiling Fan - Master Bedroom	Opt	\$45.00	
1.00	050.003	Wire & Brace for Ceiling Fan - Bedroom 2	Opt	\$45.00	
1.00	050.004	Wire & Brace for Ceiling Fan - Bedroom 3	Opt	\$45.00	
1.00	050.005	Wire & Brace for Ceiling Fan - Bedroom 4	Opt	\$45.00	
1.00	050.008	Wire & Brace for Ceiling Fan - Living Room	Opt	\$45.00	
1.00	050.0161	LED Lighting	Cmpnt		
1.00	050.0246	Heat Pump Ready Thermostat (if Applicable)	Opt	\$0.00	
INSULATION & HVAC					
1.00	060.001	Insulation 11-11-21 (Standard)	Opt	\$0.00	
1.00	060.009	Thermal Zone III	Opt	\$95.00	
1.00	060.019	015 Electric Furnace 1676-84 ; 3244-76	Opt	\$0.00	
ROOF & CEILING					
1483.00	070.002	Taped Ceiling Seams w/ Light Acoustic	Opt	\$296.60	
WALLS					
1.00	080.0019	Optional Window - Master Bath	Opt	\$295.00	See Plans
1.00	080.00191	Optional Window - Master Bedroom	Opt	\$295.00	See Plans
1.00	080.0021	Optional Window - Bedroom 2	Opt	\$295.00	Bedroom 2
1.00	080.0023	Optional Window - Bedroom 3	Opt	\$295.00	Bedroom 3
1.00	080.0042	54" Curved Shower Rod With backing 1 tub	Opt	\$69.00	Bath #2
1.00	080.0047	Open Sill - Main Panel (Standard)	Opt	\$0.00	
DECOR					
9.00	090.0017	Upgrade Porpoise Interior Doors & Trim	Opt	\$270.00	
SPECIALS					
1.00	100.0101	Energy Efficient Envelope Package (Pkg)	Opt	\$0.00	
MISCELLANEOUS					
1483.00	110.554	Material/Labor Adjustment	Opt	\$9,372.56	
1.00	110.83	Priority Build (DW) Dealer	Opt	\$1,695.00	
64.00	12.215	Wind Zone III (Smart Panel Only)	Opt	\$1,536.00	
1.00	Association Dues	Association Dues	Opt	\$125.00	
0	Storage Fees	Storage Fees Surcharge	Opt	\$0.00	
FACTORY SELECT					
1.00	120.201	Select Wallboards, Carpet, Tile, Countertops	Opt	\$495.00	

SHIP VIA:
 FINANCE CO:
 DEALER PO:
 DEALER AUTHORIZED SIGNATURE:

BASE PRICE:	\$44,795.00
OPTIONS:	\$18,991.06
ASSOCIATION:	\$125.00
VIP DISCOUNT	
FREIGHT:	\$9,560.00
MHI FEES:	\$35.00
HUD FEES:	\$145.00
Tax	
TOTAL INVOICE PRICE:	\$73,651.06

#24604

Swiflow Homes

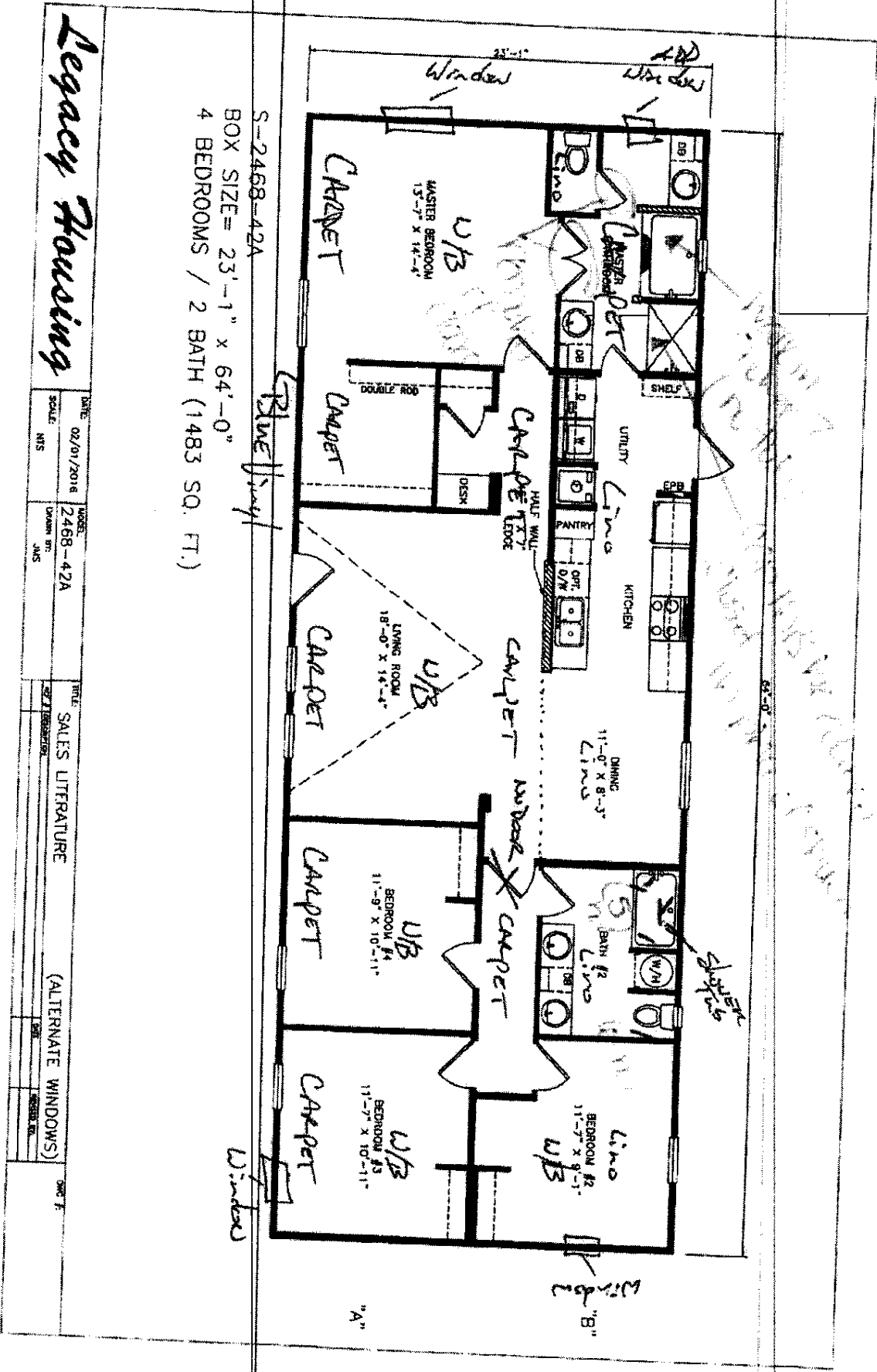



Sales Order

Date: 8/14/2021

Dealership: Sunflower Mobile Homes LLC (the "Dealer")

The Dealer has today purchased from Legacy the following unit(s), manufactured in accordance with the attached specifications:

Model No.	Order No.	Size	Total Invoice Price
1. S-2468-L2A	44604	24x68	\$82,418.31
2.			\$
3.			\$
4.			\$
5.			\$
6.			\$
Total Order Price			\$ 82,418.31

The estimated off-line date range for this order is between 6 Months and 12 Months

This order is an unconditional sales order authorized for production.

Signature: V. Ann Shroyer

Judy Pruitt

Print Name: V. Ann Shroyer

Jessica Pruitt

Additional Terms and Conditions

If, for any reason, including without limitation, a request by Dealer and/or factory, this order is subject to changes to material surcharges and the invoice will be based on prices in effect on the date of the invoice (including changes to material surcharge).

Except for unit(s) transported directly from Legacy's factory to Dealer's licensed retail sales facility, Dealer accepts any and all unit(s) as-is, where-is, and with all faults (other than latent defects) upon shipment from Legacy's factory. If any of the above units are transported from Legacy's factory directly to Dealer's licensed retail sales facility, then Dealer has ten days following arrival of such unit(s) at Dealer's licensed retail sales facility to report any defect, after which Dealer accepts such unit(s) as-is, where-is, and with all faults (other than latent defects). Notwithstanding the foregoing, if a unit is moved from Dealer's licensed retail sales facility, then Dealer accepts such unit(s) as-is, where-is, and with all faults (other than latent defects) upon removal from the licensed retail sales facility.

Dealer has five days to pick up a unit after it comes off-line. Thereafter, the Dealer will be charged a storage fee of \$10 per floor per day.

If a unit is consigned by Legacy, it must be transported directly to Dealer's licensed retail sales facility, unless Dealer receives from Legacy written authorization to the contrary. If a unit is consigned by Legacy, movement from Dealer's retail lot is prohibited without prior written authorization from Legacy. Dealer agrees to pay a fine of \$1,000 if a consigned unit is moved without prior written authorization from Legacy.

Signature: Ashley Snider (Sales) owner

Sunflower Mobile Homes

1102 Roseport Rd
 Wathena, KS 66090 US
 +91 33653217
 russel.hanson@hresolutions.com
 www.SunflowerMobileHomes.com

**SUNFLOWER**

Mobile Home Sales & Rentals

Estimate**ADDRESS**

Junior & Judy Pruitt
 20374 Gate Place
 Princeton, MO 64673
 United States

ESTIMATE # 1164**DATE 03/15/2021****EXPIRATION 04/15/2021****DATE**

	QTY	RATE	AMOUNT
Home Purchase Legacy Model Cherry Ln S-2468-42A	1	66,995.00	66,995.00
Options Home Upgrades	1	14,408.47	14,408.47
Dealer Costs/Fees State Fees	1	545.00	545.00
Freight Permits, insurance, fuel, labor, overhead (Minimum \$1500 per section)	106	13.00	1,378.00
Freight Shipping from manufacturer site	1	14,820.00	14,820.00
Dealer Costs/Fees	1	15,678.25	15,678.25
General Construction Overhead	1	1,741.26	1,741.26
Mfg Home Setup Double Setup home per spec on foundation, block, level, anchor, laq, install jacks, beams, siding, ridge shingles. (Labor only)	1,632	3.90	6,364.80
Mfg Home Interior Setup DW	1,632	2.00	3,264.00

	QTY	RATE	AMOUNT
8x8x16 Standard Concrete Block	152	1.88	285.76T
4x8x16 Cap Blocks	38	1.55	58.90T
2x8x16 Hardwood Planks	76	2.19	166.44T
1x8x16 Hardwood Planks	38	1.19	45.22T
1x6x6 Hardwood Wedge Shims	2	19.27	38.54T
Anchor System X12 Concrete anchor system	2	154.97	309.94T
Skirting Install White vinyl skirt with vented panel every 10 ft, CCA 4x4 lumber track base. Labor Only	1,632	0.75	1,224.00
Vinyl Skirting Material White vinyl skirt with vented panel every 10 ft. (Material Only)	184	8.78	1,615.52
New A/C Unit w/ Installation	1,632	2.34	3,818.88
Discount	1	-3,000.00	-3,000.00

Legacy Model Order S-24x68-42A

SUBTOTAL

129,757.98

From: 1102 Roseport Road
Wathena, KS 66090

TAX

76.46

TOTAL

\$129,834.44To: 20374 Gate Place
Princeton, MO 64637

Accepted By

Accepted Date

Estimate 1164 from Sunflower Mfg Home Sales & Transport

From: Sunflower Mobile Homes (quickbooks@notification.intuit.com)

To: judycampbell27@yahoo.com

Cc: russel.hanson@hhresolutions.com

Date: Thursday, August 5, 2021, 09:59 AM CDT

Dear Junior & Judy Pruitt,

Thank you for providing us the opportunity to earn your business. Please review the estimate below, and feel free to contact us if you have any questions. If all looks good, please return a signed copy to proceed to scheduling. We look forward to working with you!

Have a great day,
Sunflower Mfg Home Sales & Transport

----- Estimate -----

1102 Roseport Rd
Wathena, MO 66090 US
913 365-3217
www.SunflowerMobileHomes.com

Estimate #: 1164
Date: 03/15/2021
Exp. Date: 04/15/2021
\$118,081.91

Address:

Junior & Judy Pruitt
20374 Gate Place
Princeton, MO 64673
United States

	Qty	Rate	Amount
Home Purchase	1	44,795.00	44,795.00
Options	1	27,518.31	27,518.31
Dealer Costs/Fee	1	545.00	545.00
Freight	1	9,560.00	9,560.00
Dealer Costs/Fee	1	15,678.25	15,678.25
General Construc	1	1,741.26	1,741.26
Freight	106	10.00	1,060.00
Mfg Home Setup D	1632	4.00	6,528.00
Mfg Home Interio	1632	2.00	3,264.00
8x8x16 Standard	152	1.88	285.76T
4x8x16 Cap Block	38	1.55	58.90T
2x8x16 Hardwood	76	2.19	166.44T
1x8x16 Hardwood	38	1.19	45.22T

Deemed Confidential in its Entirety

1x6x6 Hardwood W	2	19.27	38.54T
Anchor System 10	9	6.22	55.98T
Anchor System Gr	9	12.87	115.83T
Skirting Install	1632	0.75	1,224.00
Vinyl Skirting M	1632	0.93	1,517.76
New A/C Unit w/	1632	2.34	3,818.88

SubTotal:	\$118,017.13
Tax:	\$64.78

Total:	\$118,081.91

Legacy Model Order S-24x68-42A

From: 1102 Roseport Road
Wathena, KS 66090

To: 20374 Gate Place
Princeton, MO 64637



Estimate_1164_from_Sunflower_Mobile_Homes.pdf
54.6kB

Sunflower Mobile Homes

1102 Roseport Rd
 Wathena, MO 66090 US
 913 365-3217
 russel.hanson@hhresolutions.com
 www.SunflowerMobileHomes.com

**SUNFLOWER**

Mfg Home Sales & Transport

Estimate**ADDRESS**

Junior & Judy Pruitt
 20374 Gate Place
 Princeton, MO 64673
 United States

ESTIMATE # 1164**DATE 03/15/2021****EXPIRATION 04/15/2021****DATE**

	QTY	RATE	AMOUNT
Home Purchase Legacy Model Cherry Ln S-2468-42A	1	44,795.00	44,795.00
Options Home Upgrades	1	27,518.31	27,518.31
Dealer Costs/Fees State Fees	1	545.00	545.00
Freight Shipping from builder site	1	9,560.00	9,560.00
Dealer Costs/Fees	1	15,678.25	15,678.25
General Construction Overhead	1	1,741.26	1,741.26
Freight Permits, insurance, fuel, labor, overhead	106	10.00	1,060.00
Mfg Home Setup Double (Set on piers/runners) Setup home per specifications on concrete piers/runners	1,632	4.00	6,528.00
Mfg Home Interior Setup DW	1,632	2.00	3,264.00
8x8x16 Standard Concrete Block	152	1.88	285.76T
4x8x16 Cap Blocks	38	1.55	58.90T

	QTY	RATE	AMOUNT
2x8x16 Hardwood Planks	76	2.19	166.44T
1x8x16 Hardwood Planks	38	1.19	45.22T
1x6x6 Hardwood Wedge Shims	2	19.27	38.54T
Anchor System 10 ft Straps	9	6.22	55.98T
10 ft straps & split bolts	9	12.87	115.83T
Anchor System Ground Auger Anchors	1,632	0.75	1,224.00
Skirting Install White vinyl skirt with vented panel every 10 ft, CCA 4x4 lumber track base. Labor Only	1,632	0.93	1,517.76
Vinyl Skirting Material White vinyl skirt with vented panel every 10 ft. (Material Only)	1,632	2.34	3,818.88

Legacy Model Order S-24x68-42A

From: 1102 Roseport Road
Wathena, KS 66090

To: 20374 Gate Place
Princeton, MO 64637

SUBTOTAL 118,017.13
 TAX 64.78
TOTAL \$118,081.91

Accepted By

Accepted Date

Estimate 1164 from Sunflower Mfg Home Sales & Transport

From: Sunflower Mobile Homes (quickbooks@notification.intuit.com)

To: judycampbell27@yahoo.com

Date: Tuesday, May 4, 2021, 03:59 PM CDT

Dear Junior & Judy Pruitt,

Thank you for providing us the opportunity to earn your business. Please review the estimate below, and feel free to contact us if you have any questions. If all looks good, please return a signed copy to proceed to scheduling. We look forward to working with you!

Have a great day,
Sunflower Mfg Home Sales & Transport

----- Estimate Summary -----

Estimate # : 1164

Estimate Date: 03/15/2021

Expiration Date: 04/15/2021

Total: \$109,170.12

The complete version has been provided as an attachment to this email.



Estimate_1164_from_Sunflower_Mobile_Homes.pdf

54.5kB

Sunflower Mobile Homes

1102 Roseport Rd
 Wathena, MO 66090 US
 913 365-3217
 russel.hanson@hhresolutions.com
 www.SunflowerMobileHomes.com

**SUNFLOWER**

Mobile Homes, Delivery & Transport

Estimate**ADDRESS**

Junior & Judy Pruitt
 20374 Gate Place
 Princeton, MO 64673
 United States

ESTIMATE # 1164**DATE 03/15/2021****EXPIRATION 04/15/2021****DATE**

	QTY	RATE	AMOUNT
Home Purchase	1	73,651.06	73,651.06
Legacy Model S-2468-42A			
Dealer Costs/Fees	1	13,438.50	13,438.50T
General Construction	1	1,724.97	1,724.97T
Overhead			
Freight	106	10.00	1,060.00
Permits, insurance, fuel, labor, overhead			
Mfg Home Setup	1,632	4.00	6,528.00
Double (Set on piers/runners)			
Setup home per specifications on concrete piers/runners			
Mfg Home Interior	1,632	2.00	3,264.00T
Setup DW			
2x8x16 Hardwood Planks	76	2.19	166.44T
1x8x16 Hardwood Planks	38	1.19	45.22T
1x6x6 Hardwood Wedge Shims	2	19.27	38.54T
Anchor System 10 ft Straps	9	6.22	55.98T
10 ft straps & split bolts			

	QTY	RATE	AMOUNT
Anchor System Ground Auger Anchors	9	12.87	115.83T
Skirting Install White vinyl skirt with vented panel every 10 ft, CCA 4x4 lumber track base. Labor Only.	1,632	0.75	1,224.00T
Vinyl Skirting Material White vinyl skirt with vented panel every 10 ft. (Material Only)	1,632	0.93	1,517.76T
8x8x16 Standard Concrete Block	152	1.88	285.76T
4x8x16 Cap Blocks	38	1.55	58.90T
New A/C Unit w/ Installation	1,632	2.34	3,818.88T

Legacy Model Order S-24x68-42A

SUBTOTAL 106,993.84
TAX 2,176.28
TOTAL \$109,170.12

From: 1102 Roseport Road
Wathena, KS 66090

To: 20374 Gate Place
Princeton, MO 64637

Accepted By

Accepted Date

Sunflower Mobile Homes

1102 Roseport Rd
 Wathena, MO 66090 US
 913 365-3217
 russel.hanson@hhresolutions.com
 www.SunflowerMobileHomes.com

**SUNFLOWER**

Mfg Home Sales & Transport

Estimate**ADDRESS**

Junior & Judy Pruitt
 20374 Gate Place
 Princeton, MO 64673
 United States

ESTIMATE # 1164**DATE 03/15/2021****EXPIRATION 04/15/2021****DATE**

	QTY	RATE	AMOUNT
Home Purchase Legacy Model Cherry Ln S-2468-42A	1	44,795.00	44,795.00
Options Home Upgrades	1	28,913.76	28,913.76
Dealer Costs/Fees State Fees	1	545.00	545.00
Freight Shipping from builder site	1	9,560.00	9,560.00
Dealer Costs/Fees	1	15,678.25	15,678.25
General Construction Overhead	1	1,741.26	1,741.26
Freight Permits, insurance, fuel, labor, overhead	106	10.00	1,060.00
Mfg Home Setup Double (Set on piers/runners) Setup home per specifications on concrete piers/runners	1,632	4.00	6,528.00
Mfg Home Interior Setup DW	1,632	2.00	3,264.00
8x8x16 Standard Concrete Block	152	1.88	285.76T
4x8x16 Cap Blocks	38	1.55	58.90T

	QTY	RATE	AMOUNT
2x8x16 Hardwood Planks	76	2.19	166.44T
1x8x16 Hardwood Planks	38	1.19	45.22T
1x6x6 Hardwood Wedge Shims	2	19.27	38.54T
Anchor System 10 ft Straps 10 ft straps & split bolts	9	6.22	55.98T
Anchor System Ground Auger Anchors	9	12.87	115.83T
Skirting Install White vinyl skirt with vented panel every 10 ft, CCA 4x4 lumber track base. Labor Only	1,632	0.75	1,224.00
Vinyl Skirting Material White vinyl skirt with vented panel every 10 ft. (Material Only)	1,632	0.93	1,517.76
New A/C Unit w/ Installation	1,632	2.34	3,818.88

Legacy Model Order S-24x68-42A

SUBTOTAL

119,412.58

From: 1102 Roseport Road
Wathena, KS 66090

TAX

64.78

TOTAL

\$119,477.36To: 20374 Gate Place
Princeton, MO 64637

Accepted By

Accepted Date