

Case No. GA-2007-0289, et al.
Missouri Gas Energy – The Empire District Gas Co.
Photographs of Seven Bridges Development and Vicinity

FILED
November 7, 2007
Data Center
Missouri Public
Service Commission

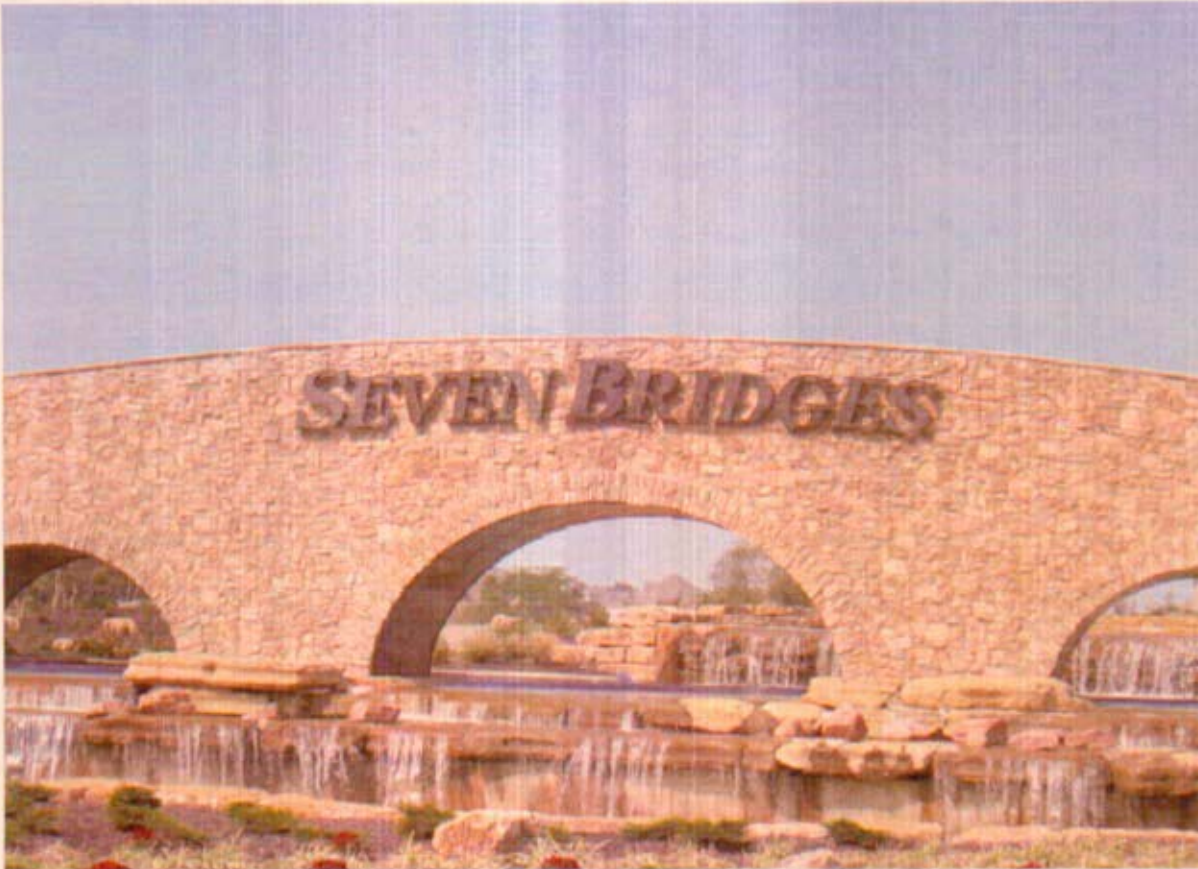

Photo 1

Entrance to
Seven Bridges
Development,
Platte County

West off County
Road N

(October 4, 2007)



Photo 2

Homes in
Seven Bridges
Development,
Platte County

As seen from
County Road N

(October 4, 2007)

Staff Exhibit No. 15
Case No(s). GA-2007-0289
Date 10/25/07 Rptr MW

Case No. GA-2007-0289, et al.
Missouri Gas Energy – The Empire District Gas Co.
Photographs of Seven Bridges Development and Vicinity

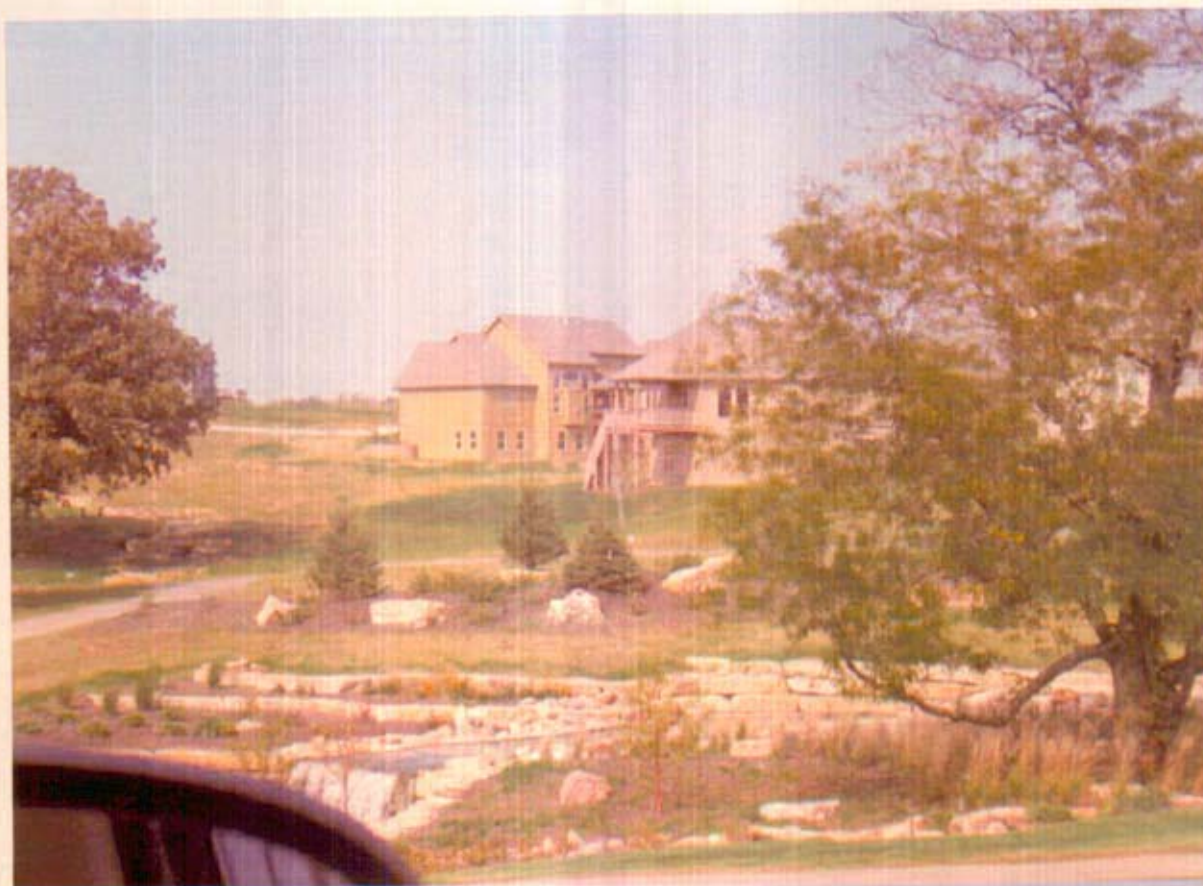

Photo 3

Homes in
Seven Bridges
Development,
Platte County

As seen from
Entrance

(October 4, 2007)



Photo 4

Club House in
Seven Bridges
Development,
Platte County

Off County Road N

(October 4, 2007)

Case No. GA-2007-0289, et al.
Missouri Gas Energy – The Empire District Gas Co.
Photographs of Seven Bridges Development and Vicinity



Photo 5

126th Street Cul de
Sac on East side
of Prairie Creek,
Platte County

Off Running Horse
Road

(October 4, 2007)



Photo 6

126th Street Cul de
Sac on East side
of Prairie Creek,
Platte County
View across
Prairie Creek

Off Running Horse
Road

(October 4, 2007)

Case No. GA-2007-0289, et al.
Missouri Gas Energy – The Empire District Gas Co.
Photographs of Seven Bridges Development and Vicinity

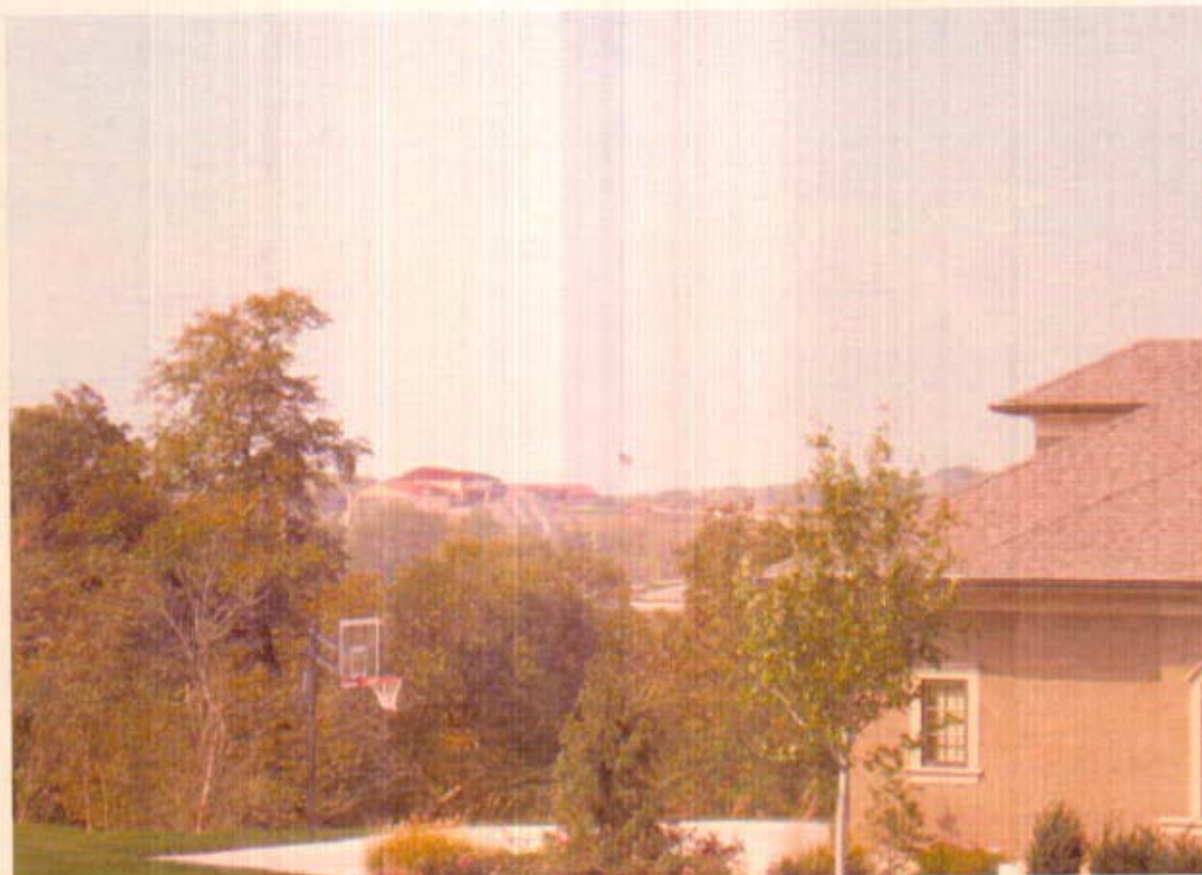

Photo 7

Oakmont Estates
Cul de Sac on
East side of Prairie
Creek,
Platte County

Off Running Horse
Road

View across
Prairie Creek to
Seven Bridges
Club House

(October 4, 2007)



Photo 8

Oakmont Estates
Cul de Sac on
East side of Prairie
Creek,
Platte County

Off Running Horse
Road

View of Prairie
Creek valley

(October 4, 2007)

Case No. GA-2007-0289, et al.
Missouri Gas Energy – The Empire District Gas Co.
Photographs of Seven Bridges Development and Vicinity



Photo 9
Platte County
South of Platte
City

Oakmont
Estates
Cul de Sac

126th Street
Cul de Sac,