

PRINT	DATE	REVISIONS
REV. 1	W.O.	SYM
REV. 2	W.O.	SYM

ON 10/23/13 ADD NOTES:
 13/15/13: ADDED MONITORING WELLS TO PERMITS 402 AND 401 W

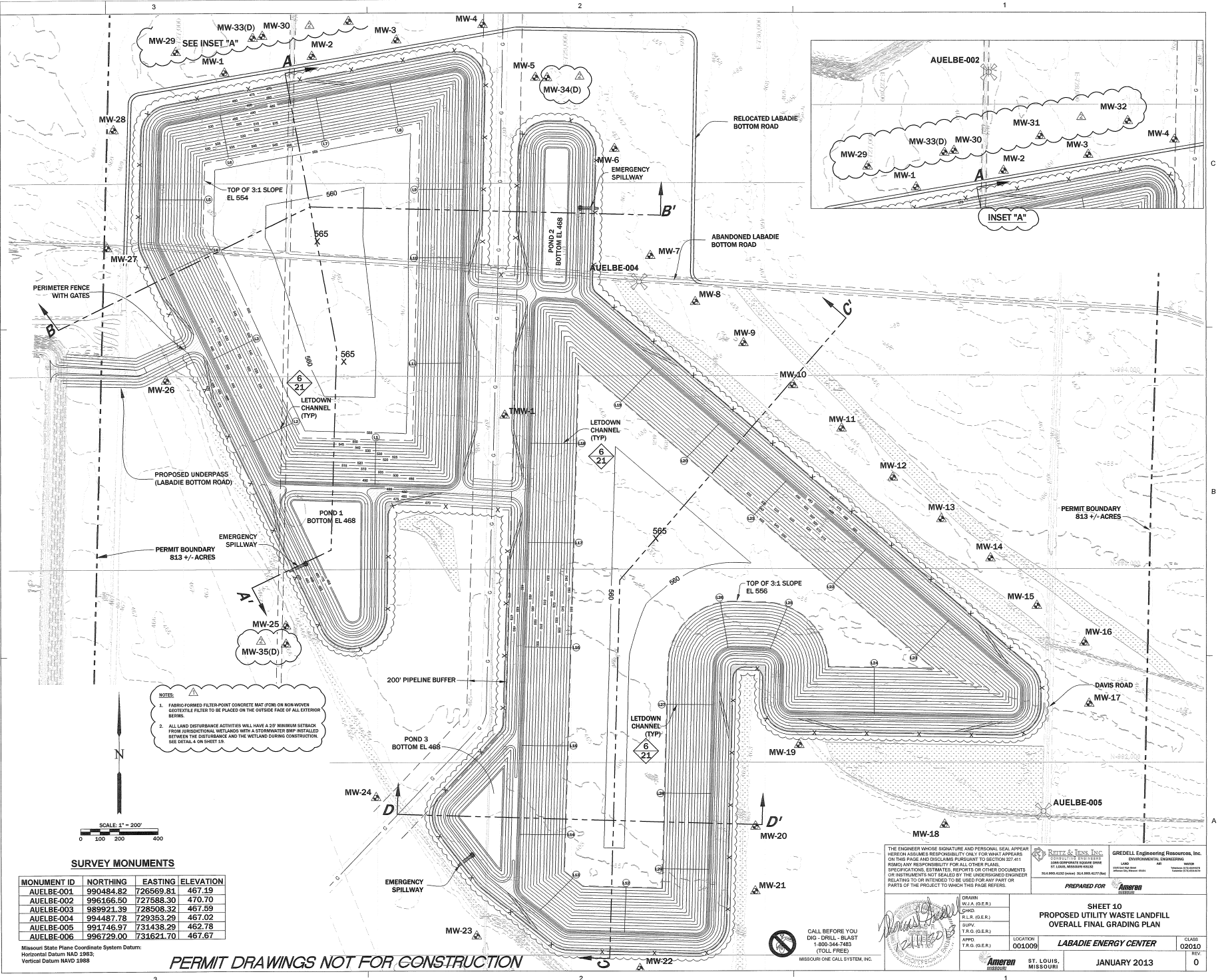

- NOTES**
- FABRIC FORMED FILTER POINT CONCRETE MAT FROM NON WOVEN GEOTEXTILE FILTER TO BE PLACED ON THE OUTSIDE FACE OF ALL EXTERIOR BEAMS.
 - ALL LAND DISTURBANCE ACTIVITIES WILL HAVE A 20' MINIMUM SETBACK FROM JURISDICTIONAL WETLANDS WITH A STORMWATER BMP INSTALLED BETWEEN THE DISTURBANCE AND THE WETLAND DURING CONSTRUCTION. SEE DETAIL-4 ON SHEET 15.

SURVEY MONUMENTS

MONUMENT ID	NORTHING	EASTING	ELEVATION
AUELBE-001	990484.82	726569.81	467.19
AUELBE-002	996166.50	727588.30	470.70
AUELBE-003	989921.39	728508.32	467.59
AUELBE-004	994487.78	729353.29	467.02
AUELBE-005	991746.97	731438.29	462.78
AUELBE-006	996729.00	731621.70	467.67

Missouri State Plane Coordinate System Datum:
 Horizontal Datum NAD 1983;
 Vertical Datum NAVD 1988

PERMIT DRAWINGS NOT FOR CONSTRUCTION

THE ENGINEER WHOSE SIGNATURE AND PERSONAL SEAL APPEAR HEREON ASSUMES RESPONSIBILITY ONLY FOR WHAT APPEARS ON THIS PAGE AND DISCLAIMS PURSUANT TO SECTION 327.411 MISSOURI CONSTITUTION AND SECTION 178.01 MISSOURI STATUTES ANY RESPONSIBILITY FOR ALL OTHER PLANS, SPECIFICATIONS, ESTIMATES, REPORTS OR OTHER DOCUMENTS OR INSTRUMENTS NOT SEALED BY THE UNDERSIGNED ENGINEER RELATING TO OR INTENDED TO BE USED FOR ANY PART OR PARTS OF THE PROJECT TO WHICH THIS PAGE REFERS.

REITZ & TENS, INC.
 ENVIRONMENTAL ENGINEERING
 314.980.4332 (PHONE) 314.980.4377 (FAX)
 314.980.4333 (TOLL FREE)

PREPARED FOR: **Ameren**

SHEET 10
PROPOSED UTILITY WASTE LANDFILL
OVERALL FINAL GRADING PLAN

LOCATION: **LABADIE ENERGY CENTER**

CLASS: **02010**
 REV: **0**

DATE: **JANUARY 2013**

ST. LOUIS, MISSOURI

AMEREN ENERGY